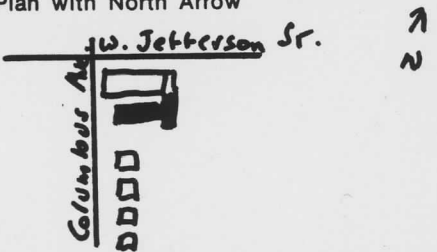

OHIO HISTORIC INVENTORY

<p>1. No. <u>29.</u></p> <p>2. County <u>Erie</u></p> <p>3. Location of Negatives <u>Old House Guild</u></p>	<p>4. Present Name(s)</p> <p>5. Other Name(s) <u>Sts. Peter & Paul Rectory</u></p>																
<p>6. Specific Location <u>510 Columbus Ave.</u></p> <p>7. City or Town If Rural, Township & Vicinity <u>Sandusky</u></p> <p>8. Site Plan with North Arrow </p>	<p>16. Thematic Category <u>19th Century-Religious</u></p> <p>17. Date(s) or Period <u>1871</u></p> <p>18. Style or Design <u>Italianate</u></p> <p>19. Architect or Builder</p> <p>20. Contractor or Builder</p> <p>21. Original Use, if apparent <u>rectory</u></p> <p>22. Present Use <u>rectory</u></p> <p>23. Ownership Public <input type="checkbox"/> Private <input checked="" type="checkbox"/></p> <p>24. Owner's Name & Address, if known <u>Bishop of Toledo</u> <u>c/o 510 Columbus Ave.</u></p> <p>25. Open to Public? Yes <input type="checkbox"/> No <input checked="" type="checkbox"/></p> <p>26. Local Contact Person or Organization <u>Old House Guild</u></p> <p>27. Other Surveys in Which Included</p>	<p>28. No. of Stories <u>2 1/2</u></p> <p>29. Basement? Yes <input checked="" type="checkbox"/> No <input type="checkbox"/></p> <p>30. Foundation Material <u>limestone</u></p> <p>31. Wall Construction <u>Limestone</u></p> <p>32. Roof Type & Material <u>shingle</u> <u>int. gable w/returns</u></p> <p>33. No. of Bays Front <u> </u> Side <u> </u></p> <p>34. Wall Treatment <u>rock faced ashlar</u></p> <p>35. Plan Shape <u>irregular</u></p> <p>36. Changes (Explain in #42) Addition <input checked="" type="checkbox"/> Altered <input type="checkbox"/> Moved <input type="checkbox"/></p> <p>37. Condition Interior <u>excellent</u> Exterior <u>excellent</u></p> <p>38. Preservation Underway? Yes <input checked="" type="checkbox"/> No <input type="checkbox"/></p> <p>39. Endangered? By What? Yes <input type="checkbox"/> No <input checked="" type="checkbox"/></p> <p>40. Visible from Public Road? Yes <input checked="" type="checkbox"/> No <input type="checkbox"/></p> <p>41. Distance from and Frontage on Road <u>15' x 40.2'</u></p>															
<p>9. Coordinates Lat. _____ Long. _____ U.T.M. Reference <table border="1" style="display: inline-table; border-collapse: collapse;"> <tr> <td>1</td><td>7</td> <td>3</td><td>5</td><td>7</td><td>2</td><td>4</td><td>0</td> <td>4</td><td>5</td><td>9</td><td>0</td><td>1</td><td>3</td><td>0</td> </tr> </table> Zone _____ Easting _____ Northing _____</p> <p>10. Site Building <input checked="" type="checkbox"/> Structure <input type="checkbox"/> Object <input type="checkbox"/></p> <p>11. On National Register? Yes <input type="checkbox"/> No <input checked="" type="checkbox"/></p> <p>12. Is It Eligible? Yes <input checked="" type="checkbox"/> No <input type="checkbox"/></p> <p>13. Part of Estab. Hist. Dist.? Yes <input type="checkbox"/> No <input checked="" type="checkbox"/></p> <p>14. District Potent'l? Yes <input type="checkbox"/> No <input type="checkbox"/></p> <p>15. Name of Established District</p>	1	7	3	5	7	2	4	0	4	5	9	0	1	3	0	<p>42. Further Description of Important Features <u>This house of cut limestone has roof brackets and returns. Curved gable windows with two over two window panes and stone lintels and sills are decorative touches. Other windows have rectangular stone lintels and sills. There is a bay window on the north and west side. Both porches have the original cut wood trim. The south wing is a very early addition. A rear addition was added in the 1950's when the rectory was connected with the church.</u></p>	<p style="text-align: center; font-size: 2em;">Photo</p>
1	7	3	5	7	2	4	0	4	5	9	0	1	3	0			
<p>43. History and Significance <u>This rectory was built to house the Irish priests who served in the "Irish" church next door. First resident here was Father Robert Sidley, who had been pastor at Holy Angels until the church was built here. The "Irish" tradition continued until 1970, when the first pastor of non-Irish descent was assigned here. The Italianate style house was built for \$5,000. Pictures exist before the addition of the south wing.</u></p>																	
<p>44. Description of Environment and Outbuildings <u>The rectory is on a large lot with a yard to the south in a neighborhood of apartments and small businesses and churches.</u> <u>Lot 20, Columbus Ave. 40.2' x 198'. Less than one acre.</u></p>																	
<p>45. Sources of Information <u>Peeke, Centennial History of Erie Co. (Sandusky, 1925)</u> <u>Sts Peter & Paul Church (Sandusky, 1971)</u> <u>Erie Co. tax records</u></p>	<p>46. Prepared by <u>Damm & Guss</u></p> <p>47. Organization <u>Old House Guild</u></p> <p>48. Date <u>3/15/81</u> 49. Revision Date(s)</p>																

9/8/82

United States Department of the Interior
National Park Service

Substantive Review

Sts. Peter & Paul Rectory (Sandusky MRA)
Erie County
OHIO

Working No. 9/8/82-2427
Fed. Reg. Date: _____
Date Due: 10/7/82 - 10/23/82
Action: ACCEPT
 RETURN 10/20/82
 REJECT

- resubmission
- nomination by person or local government
- owner objection
- appeal

Federal Agency: _____

Substantive Review: sample request appeal NR decision

Reviewer's comments:

*PROBLEM WITH SIGNIFICANCE AND
RULE ABOUT NOMINATION OF ENTIRE
BUILDING. SEE ALSO RETURN SHEET
FOR CHURCH.*

Recom. / Criteria RETURN
Reviewer Mar Myl
Discipline A-1-
Date 10.20.82
 see continuation sheet

Nomination returned for: technical corrections cited below
 substantive reasons discussed below

1. Name

2. Location

3. Classification

Category	Ownership	Status	Present Use
	Public Acquisition	Accessible	

4. Owner of Property

5. Location of Legal Description

6. Representation in Existing Surveys

has this property been determined eligible? yes no

7. Description

Condition		Check one	Check one
<input type="checkbox"/> excellent	<input type="checkbox"/> deteriorated	<input type="checkbox"/> unaltered	<input type="checkbox"/> original site
<input type="checkbox"/> good	<input type="checkbox"/> ruins	<input type="checkbox"/> altered	<input type="checkbox"/> moved date _____
<input type="checkbox"/> fair	<input type="checkbox"/> unexposed		

Describe the present and original (if known) physical appearance

- summary paragraph
- completeness
- clarity
- alterations/integrity
- dates
- boundary selection

*PLEASE PROVIDE FURTHER DESCRIPTION WHICH
INDICATES WHETHER OR NOT IT IS APPROPRIATE TO
NOMINATE THE PROPERTY INDIVIDUALLY, OR AS
PART OF THE CHURCH ~~COMPLEX~~.*

8. Significance

Period _____ Areas of Significance—Check and justify below

Specific dates _____ Builder/Architect _____

Statement of Significance (in one paragraph)

ALTHOUGH THE THEMATIC CATEGORY CHECKED IS RELIGION,
SHOULD IT NOT BE IMMIGRATION?

- summary paragraph
 completeness
 clarity
 applicable criteria
 justification of areas checked
 relating significance to the resource
 context
 relationship of integrity to significance
 justification of exception
 other

~~THE~~ RELIGIOUS CRITERIA CONSIDERATION NOT DIRECTLY ADDRESSED.

9. Major Bibliographical References

10. Geographical Data

Acres of nominated property _____

Quadrangle name _____

USGS References _____

Verbal boundary description and justification _____

11. Form Prepared By

12. State Historic Preservation Officer Certification

The evaluated significance of this property within the state is:

national state local

State Historic Preservation Officer signature _____

title _____ date _____

13. Other

- Maps
 Photographs
 Other

Questions concerning this nomination may be directed to _____

Signed Bruce MacDougal / NB Date 10/20/82 Phone: 202 272-3504

Comments for any item may be continued on an attached sheet

OHIO HISTORIC INVENTORY

1. No. 27.	4. Present Name(s)
2. County Erie	5. Other Name(s) Sts. Peter & Paul Church
3. Location of Negatives Old House Guild	

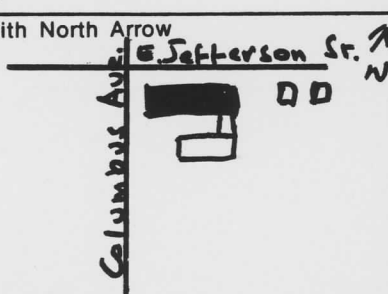
6. Specific Location Columbus Ave. at E. Jefferson St.	16. Thematic Category Architecture; 19th Century-Religious	28. No. of Stories 1														
7. City or Town If Rural, Township & Vicinity Sandusky	17. Date(s) or Period 1865	29. Basement? Yes <input checked="" type="checkbox"/> No <input type="checkbox"/>														
8. Site Plan with North Arrow 	18. Style or Design Victorian Gothic	30. Foundation Material limestone														
9. Coordinates Lat. _____ Long. _____ U.T.M. Reference <table border="1" style="display: inline-table; border-collapse: collapse;"> <tr><td>17</td><td>3</td><td>5</td><td>7</td><td>2</td><td>6</td><td>0</td></tr> <tr><td>4</td><td>5</td><td>9</td><td>0</td><td>1</td><td>6</td><td>0</td></tr> </table>	17	3	5	7	2	6	0	4	5	9	0	1	6	0	19. Architect or Engineer attributed to Patrick Charles Keely	31. Wall Construction limestone
17	3	5	7	2	6	0										
4	5	9	0	1	6	0										
	20. Contractor or Builder	32. Roof Type & Material gable-shingle														
	21. Original Use, if apparent	33. No. of Bays Front _____ Side Side														
	22. Present Use	34. Wall Treatment rock faced ashlar														
	23. Ownership Public <input type="checkbox"/> Private <input checked="" type="checkbox"/>	35. Plan Shape rectangle														
	24. Owner's Name & Address, if known Bishop of Toledo c/o 510 Columbus Ave. <i>Sandusky</i>	36. Changes Addition <input checked="" type="checkbox"/> (Explain in #42) Altered <input type="checkbox"/> Moved <input type="checkbox"/>														
	25. Open to Public? limited Yes <input checked="" type="checkbox"/> No <input type="checkbox"/>	37. Condition Interior fair Exterior very good														
	26. Local Contact Person or Organization Old House Guild	38. Preservation Underway? Yes <input checked="" type="checkbox"/> No <input type="checkbox"/>														
	27. Other Surveys in Which Included	39. Endangered? By What? Yes <input type="checkbox"/> No <input checked="" type="checkbox"/>														
		40. Visible from Public Road? Yes <input checked="" type="checkbox"/> No <input type="checkbox"/>														
		41. Distance from and Frontage on Road 25' x 92.8'														

42. Further Description of Important Features **A triple window in the tower and the three front doors were the Trinitarian theme often used by Keely. The arched stone window & door caps, buttresses with stone caps and piers with stone trim and caps all contribute to the Gothic mode. The Victorian painted & stained glass crucifixion scene above the main altar is intact. Four other colored glass windows designed to flank it are in the attic. The rectory was connected to the church in the late 1940's. The battlement steeple roof was added in the 1910's.**

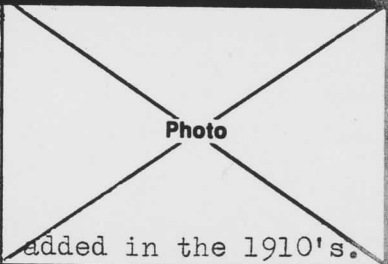

43. History and Significance **This is one of three Catholic churches in Sandusky, built to serve parishioners in the central and eastern part of the growing community. For years it was known as "the Irish church" because most of the members were Irish. It is significant both for its part in the history of the Irish in Sandusky and its design by one of the foremost church architects of the Victorian era.**

44. Description of Environment and Outbuildings
On the corner facing Sandusky's main street, the church is one block south of Washington Park, Sandusky's town square since 1818.
Lot 18, Columbus Ave. 92.8' x 198'. Less than one acre.

45. Sources of Information Sts. Peter & Paul Church (Sandusky, 1971) Peeke, Centennial History of Erie County (Sandusky, 1925) Erie Co. tax records	46. Prepared by Damm - Guss
	47. Organization Old House Guild
	48. Date 3/15/81
	49. Revision Date(s)

9/8/82

United States Department of the Interior
National Park Service

Substantive Review

Sts. Peter & Paul Church (Sandusky MRA)
Erie County
OHIO

Working No. 9/8/82-2427
Fed. Reg. Date: _____
Date Due: 10/7/82 - 10/23/82
Action: ACCEPT
 RETURN 10/20/82
 REJECT
Federal Agency: _____

- resubmission
- nomination by person or local government
- owner objection
- appeal

Substantive Review: sample request appeal NR decision

Reviewer's comments:

IT IS NOT CLEAR IF THE ~~PARISH~~ RECTORY, ^{SHOULD BE} INCLUDED IN THE NOMINATION. SINCE THE NATURE OF THE 1950'S CONNECTOR IS NOT DISCUSSED, IT IS NOT POSSIBLE TO TELL. SEE ALSO SIGNIFICANCE COMMENTS.

Recom. / Criteria RETURN
Reviewer MAC ADAM
Discipline A.H.
Date 10.20.82
 see continuation sheet

Nomination returned for: technical corrections cited below
 substantive reasons discussed below

1. Name

2. Location

3. Classification

Category	Ownership	Status	Present Use
	Public Acquisition	Accessible	

4. Owner of Property

5. Location of Legal Description

6. Representation in Existing Surveys

has this property been determined eligible? yes no

7. Description

Condition	Check one	Check one
<input checked="" type="checkbox"/> excellent	<input type="checkbox"/> deteriorated	<input type="checkbox"/> unaltered
<input type="checkbox"/> good	<input type="checkbox"/> ruins	<input type="checkbox"/> altered
<input type="checkbox"/> fair	<input type="checkbox"/> unexposed	<input type="checkbox"/> moved date _____

Describe the present and original (if known) physical appearance

- summary paragraph
- completeness
- clarity
- alterations/integrity
- dates
- boundary selection

PLEASE ~~BE~~ PROVIDE A DISCUSSION OF THE NATURE OF THE 1950'S CONNECTOR. IF IT IS AN ENCLOSED CONNECTOR THAT HAS FUNCTIONALLY JOINED THE TWO FORMERLY SEPARATE BUILDINGS BOTH SHOULD BE NOMINATED TO CENTER.

8. Significance

Period _____ Areas of Significance—Check and justify below _____

Specific dates _____ Builder/Architect _____

Statement of Significance (in one paragraph)

- summary paragraph
- completeness - IS THE BUILDING SIGNIFICANT AS THE WORK OF A LISTED ARCHITECT.
IF SO, PLEASE EXPLAIN HOW THIS WORK RELATES TO HIS OTHER WORK.
- clarity
- applicable criteria
- justification of areas checked IT IS MOST LIKELY APPROPRIATE TO NOMINATE THE BUILDING FOR ITS ARCHITECTURAL SIGNIFICANCE, IN ADDITION TO ITS ASSOCIATIVE SIGNIFICANCE IN RELATION TO THE IRISH IMMIGRANT COMMUNITY.
- relating significance to the resource
- context
- relationship of integrity to significance
- justification of exception RELIGIOUS BUILDING CRITERIA CONSIDERATION NOT DIRECTLY ADDRESSED.
- other

9. Major Bibliographical References

10. Geographical Data

Acres of nominated property _____

Quadrangle name _____

URBT References _____

Verbal boundary description and justification _____

11. Form Prepared By

12. State Historic Preservation Officer Certification

The evaluated significance of this property within the state is:

national state local

State Historic Preservation Officer signature _____

title _____ date _____

13. Other

- Maps
- Photographs
- Other

Questions concerning this nomination may be directed to BRUCE Mike Brown

Signed [Signature] Date 10/20/82 Phone: 202 272-3504

Comments for any item may be continued on an attached sheet

OHIO HISTORIC INVENTORY

Ohio Historic Preservation Office
Ohio Historical Center
Columbus, Ohio 43211

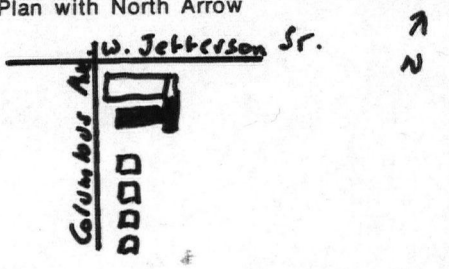
<p>1. No. 29.</p> <p>2. County <u>Erie</u></p> <p>3. Location of Negatives <u>Old House Guild</u></p>	<p>4. Present Name(s)</p> <p>5. Other Name(s) <u>Sts. Peter & Paul Rectory</u></p>																
<p>6. Specific Location <u>510 Columbus Ave.</u></p> <p>7. City or Town If Rural, Township & Vicinity <u>Sandusky</u></p> <p>8. Site Plan with North Arrow </p>	<p>16. Thematic Category <u>19th Century-Immigration</u></p> <p>17. Date(s) or Period <u>1871</u></p> <p>18. Style or Design <u>Italianate</u></p> <p>19. Architect or Engineer</p> <p>20. Contractor or Builder</p> <p>21. Original Use, if apparent <u>rectory</u></p> <p>22. Present Use <u>rectory</u></p> <p>23. Ownership Public <input type="checkbox"/> Private <input checked="" type="checkbox"/></p> <p>24. Owner's Name & Address, if known <u>Bishop of Toledo</u> <u>c/o 510 Columbus Ave.</u></p>	<p>28. No. of Stories <u>2 1/2</u></p> <p>29. Basement? Yes <input checked="" type="checkbox"/> No <input type="checkbox"/></p> <p>30. Foundation Material <u>limestone</u></p> <p>31. Wall Construction <u>Limestone</u></p> <p>32. Roof Type & Material <u>shingle</u> <u>int. gable w/returns</u></p> <p>33. No. of Bays Front Side</p> <p>34. Wall Treatment <u>rock faced ashlar</u></p> <p>35. Plan Shape <u>irregular</u></p> <p>36. Changes Addition <input checked="" type="checkbox"/> Altered <input type="checkbox"/> Moved <input type="checkbox"/></p> <p>37. Condition Interior <u>excellent</u> Exterior <u>excellent</u></p> <p>38. Preservation Underway? Yes <input checked="" type="checkbox"/> No <input type="checkbox"/></p> <p>39. Endangered? By What? Yes <input type="checkbox"/> No <input checked="" type="checkbox"/></p> <p>40. Visible from Public Road? Yes <input checked="" type="checkbox"/> No <input type="checkbox"/></p> <p>41. Distance from and Frontage on Road <u>15' x 40.2'</u></p>															
<p>9. Coordinates</p> <p>Lat. _____ Long. _____</p> <p>U.T.M. Reference</p> <table border="1" style="width:100%; text-align: center;"> <tr> <td>1</td><td>7</td><td>3</td><td>5</td><td>7</td><td>2</td><td>4</td><td>0</td><td>4</td><td>5</td><td>9</td><td>0</td><td>1</td><td>3</td><td>0</td> </tr> </table> <p>Zone _____ Easting _____ Northing _____</p> <p>10. Site <input type="checkbox"/> Structure <input type="checkbox"/> Building <input checked="" type="checkbox"/> Object <input type="checkbox"/></p> <p>11. On National Register? Yes <input type="checkbox"/> No <input checked="" type="checkbox"/></p> <p>12. Is It Eligible? Yes <input checked="" type="checkbox"/> No <input type="checkbox"/></p> <p>13. Part of Estab. Hist. Dist.? Yes <input type="checkbox"/> No <input checked="" type="checkbox"/></p> <p>14. District Potent'l? Yes <input type="checkbox"/> No <input type="checkbox"/></p> <p>15. Name of Established District</p>	1	7	3	5	7	2	4	0	4	5	9	0	1	3	0	<p>25. Open to Public? Yes <input type="checkbox"/> No <input checked="" type="checkbox"/></p> <p>26. Local Contact Person or Organization <u>Old House Guild</u></p> <p>27. Other Surveys in Which Included</p>	<p>42. Further Description of Important Features <u>This house of cut limestone has roof brackets and returns. Curved gable windows with two over two window panes and stone lintels and sills are decorative touches. Other windows have rectangular stone lintels and sills. There is a bay window on the north and west side. Both porches have the original cut wood trim. The south wing is a very early addition. A rear addition was added in the 1950's when the rectory was connected with the church.</u></p> <p>43. History and Significance <u>This rectory was built to house the Irish priests who served in the "Irish" church next door. First resident here was Father Robert Sidley, who had been pastor at Holy Angels until the church was built here. The "Irish" tradition continued until 1970, when the first pastor of non-Irish descent was assigned here. The Italianate style house was built for \$5,000. Pictures exist before the addition of the south wing.</u></p> <p>44. Description of Environment and Outbuildings <u>The rectory is on a large lot with a yard to the south in a neighborhood of apartments and small businesses and churches.</u> <u>Lot 20, Columbus Ave. 40.2' x 198'. Less than one acre.</u></p>
1	7	3	5	7	2	4	0	4	5	9	0	1	3	0			
<p>45. Sources of Information <u>Peeke, Centennial History of Erie Co. (Sandusky, 1925)</u> <u>Sts Peter & Paul Church (Sandusky, 1971)</u> <u>Erie Co. tax records</u></p>	<p>46. Prepared by <u>Damm & Guss</u></p> <p>47. Organization <u>Old House Guild</u></p> <p>48. Date <u>9/8/81</u></p> <p>49. Revision Date(s) <u>3/15/81</u></p>																

United States Department of the Interior
National Park Service

National Register of Historic Places
Inventory—Nomination Form

For NPS use only
received
date entered

Continuation sheet

Item number

Page 349

Multiple Resource Area
Thematic Group

Name Sandusky Multiple Resource Area
State Ohio

Nomination/Type of Review

Date/Signature

21. Zion Lutheran Church

Entered in the
National Register

for Keeper *Melona Byers 10/20/82*

Attest

~~22. Sts. Peter & Paul Rectory~~

Keeper

Combined with Church

Attest

✓ 23. Boeckling, G. A., House

Substantive Review

Keeper

True for 10/20/82

Attest

24. Stang, John, House

Entered in the
National Register

for Keeper *Melona Byers 10/20/82*

Attest

25. Hubbard, S. B., House

Entered in the
National Register

for Keeper *Melona Byers 10/20/82*

Attest

26. Taylor-Frohman House

Substantive Review

Keeper

True for 10/20/82

Attest

27. Cooke, Eleutheros, House
(1415 Columbus Ave.)

Entered in the
National Register

for Keeper *Melona Byers 10/20/82*

Attest

28. Graefe, Henry, House

Entered in the
National Register

for Keeper *Melona Byers 10/20/82*

Attest

29. Hinde & Dauch Paper Co.
(407 Decatur St.)

Substantive Review

Keeper

True for 10/20/82

Attest

30. St. Mary's Girls Grade
School

Entered in the
National Register

for Keeper *Melona Byers 10/20/82*

Attest

United States Department of the Interior
National Park Service

Substantive Review

Combined

Sts. Peter & Paul Rectory
(Sandusky MRA)
OH, Erie

Working No. 9-8, 82-2427

Fed. Reg. Date: _____

Date Due: 1/21/83

Action: ACCEPT
 RETURN
 REJECT

Federal Agency: _____

resubmission
 nomination by person or local government
 owner objection
 appeal

Substantive Review: sample request appeal NR decision

Reviewer's comments:

Combined with church

THE RECTORY IS ELIGIBLE AS PART OF THE CHURCH

Recom./Criteria _____

Reviewer _____

Discipline _____

Date _____

see continuation sheet

Nomination returned for: technical corrections cited below
 substantive reasons discussed below

1. Name

2. Location

3. Classification

Category Ownership Status Present Use
Public Acquisition Accessible

4. Owner of Property

5. Location of Legal Description

6. Representation in Existing Surveys

has this property been determined eligible? yes no

7. Description

Condition: excellent deteriorated good ruins fair unsound
Check one: unaltered altered
Check one: original site moved date _____

Describe the present and original (if known) physical appearance

- _____ summary paragraph
- _____ completeness
- _____ clarity
- _____ alterations/integrity
- _____ dates
- _____ boundary selection

8. Significance

Period _____ Area of Significance—Check and justify below

Specific dates _____ Builder/Architect _____

Statement of Significance (in one paragraph)

- _____ summary paragraph
- _____ completeness
- _____ clarity
- _____ applicable criteria
- _____ justification of areas checked
- _____ relating significance to the resource
- _____ context
- _____ relationship of integrity to significance
- _____ justification of exception
- _____ other

9. Major Bibliographical References

10. Geographical Data

Acreage of nominated property _____

Quadrangle name _____

UMT References _____

Verbal boundary description and justification _____

11. Form Prepared By

12. State Historic Preservation Officer Certification

The evaluated significance of this property within the state is:

_____ national _____ state _____ local

State Historic Preservation Officer signature _____

title _____ date _____

13. Other

- _____ Maps
- _____ Photographs
- _____ Other

Questions concerning this nomination may be directed to _____

Signed _____ Date _____ Phone: 202 272-3504

Comments for any item may be continued on an attached sheet

OHIO HISTORIC INVENTORY

1. No. 27.	4. Present Name(s)
2. County Erie	5. Other Name(s) Sts. Peter & Paul Church
3. Location of Negatives Old House Guild	

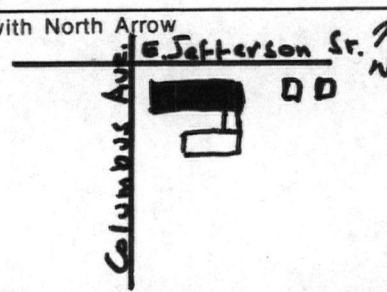
6. Specific Location Columbus Ave. at E. Jefferson St.	16. Thematic Category Architecture; 19th Century- Immigration	28. No. of Stories 1														
7. City or Town If Rural, Township & Vicinity Sandusky	17. Date(s) or Period 1865	29. Basement? Yes <input checked="" type="checkbox"/> No <input type="checkbox"/>														
8. Site Plan with North Arrow 	18. Style or Design Victorian Gothic	30. Foundation Material limestone														
9. Coordinates Lat. _____ Long. _____ U.T.M. Reference <table border="1"><tr><td>17</td><td>3</td><td>5</td><td>7</td><td>2</td><td>6</td><td>0</td><td>4</td><td>5</td><td>9</td><td>0</td><td>1</td><td>6</td><td>0</td></tr></table>	17	3	5	7	2	6	0	4	5	9	0	1	6	0	19. Architect or Engineer attributed to Patrick Charles Keely	31. Wall Construction limestone
17	3	5	7	2	6	0	4	5	9	0	1	6	0			
	20. Contractor or Builder	32. Roof Type & Material gable-shingle														
	21. Original Use, if apparent	33. No. of Bays Front _____ Side _____														
	22. Present Use	34. Wall Treatment rock faced ashlar														
	23. Ownership Public <input type="checkbox"/> Private <input checked="" type="checkbox"/>	35. Plan Shape rectangle														
	24. Owner's Name & Address, if known Bishop of Toledo c/o 510 Columbus Ave. Sandusky, OH	36. Changes (Explain in #42) Addition <input checked="" type="checkbox"/> Altered <input type="checkbox"/> Moved <input type="checkbox"/>														
	25. Open to Public? limited Yes <input checked="" type="checkbox"/> No <input type="checkbox"/>	37. Condition Interior fair Exterior very good														
	26. Local Contact Person or Organization Old House Guild	38. Preservation Underway? Yes <input type="checkbox"/> No <input checked="" type="checkbox"/>														
	27. Other Surveys in Which Included	39. Endangered? By What? Yes <input type="checkbox"/> No <input checked="" type="checkbox"/>														
		40. Visible from Public Road? Yes <input checked="" type="checkbox"/> No <input type="checkbox"/>														
		41. Distance from and Frontage on Road 25' x 92.8'														

42. Further Description of Important Features A triple window in the tower and the three front doors were the Trinitarian theme often used by Keely. The arched stone window & door caps, buttresses with stone caps and piers with stone trim and caps all contribute to the Gothic mode. The Victorian painted & stained glass crucifixion scene above the main altar is intact. Four other colored glass windows designed to flank it are in the attic. The rectory was connected to the church in the late 1940's. The battlement steeple roof was added in the 1910's.



43. History and Significance This is one of three Catholic churches in Sandusky, built to serve parishioners in the central and eastern part of the growing community. For years it was known as "the Irish church" because most of the members were Irish. It is significant both for its part in the history of the Irish in Sandusky and its design by one of the foremost church architects of the Victorian era.

44. Description of Environment and Outbuildings
On the corner facing Sandusky's main street, the church is one block south of Washington Park, Sandusky's town square since 1818.
Lot 18, Columbus Ave. 92.8' x 198'. Less than one acre.

45. Sources of Information Sts. Peter & Paul Church (Sandusky, 1971) Peeke, Centennial History of Erie County (Sandusky, 1925) Erie Co. tax records	46. Prepared by Damm - Guss
	47. Organization Old House Guild
	48. Date 9/8/82
	49. Revision Date(s) 3/15/81

Historic Resources of Sandusky

Saints Peter and Paul Church and Rectory

Description

For eighty-five years the church and rectory were two separate buildings. An addition to the south side of the church, including an enlarged sacristy, a baptistery, and two restrooms, was made in the late 1950s, according to recollections of the parishioners, but the church records do not document the exact date of the annex. The annex abuts the rectory and provides access through one door (See attached plan, with connection marked in red). The church is a semi-public building open from about 7:30 a.m. to 6:30 p.m. The rectory is a private residence. The connecting door is used for the convenience of the priests and is kept locked.

At about the same time the rectory was enlarged by the addition of a living room, a dining room, a breakfast room and several bedrooms, and the kitchen was enlarged.

Significance

Saints Peter and Paul Church is architecturally significant because it is attributed to Patrick C. Keely, the most important mid-19th century American Catholic architect. According to the Rev. Gerald Stein, an associate pastor during the 1940s and 1950s who wrote an unpublished history of the church, the architect for Saints Peter and Paul was "the same architect who designed St. Francis de Sales Church in Toledo." St. Francis de Sales was the cathedral of the Toledo Diocese and was designed by Keely. It is a brick Gothic Revival church very similar in plan to Saints Peter and Paul, with a central entrance tower of the same shape. The same general configuration was also found in the cathedral of the Diocese of Cleveland, also planned by Keely. (Sandusky is approximately midway between Toledo and Cleveland.) Patrick Keely (1819-1869) designed several hundred churches and cathedrals in the East, as well as others for both the Toledo and Cleveland Dioceses.

The additions to the church and rectory in the 1950s were made by Msgr. Henry Foran, pastor during the 1940s and 1950s until his death in 1959. In addition to the church annex and rectory expansion, the church and school were renovated, a large addition to the school was made, and a cooling system was installed in the church.

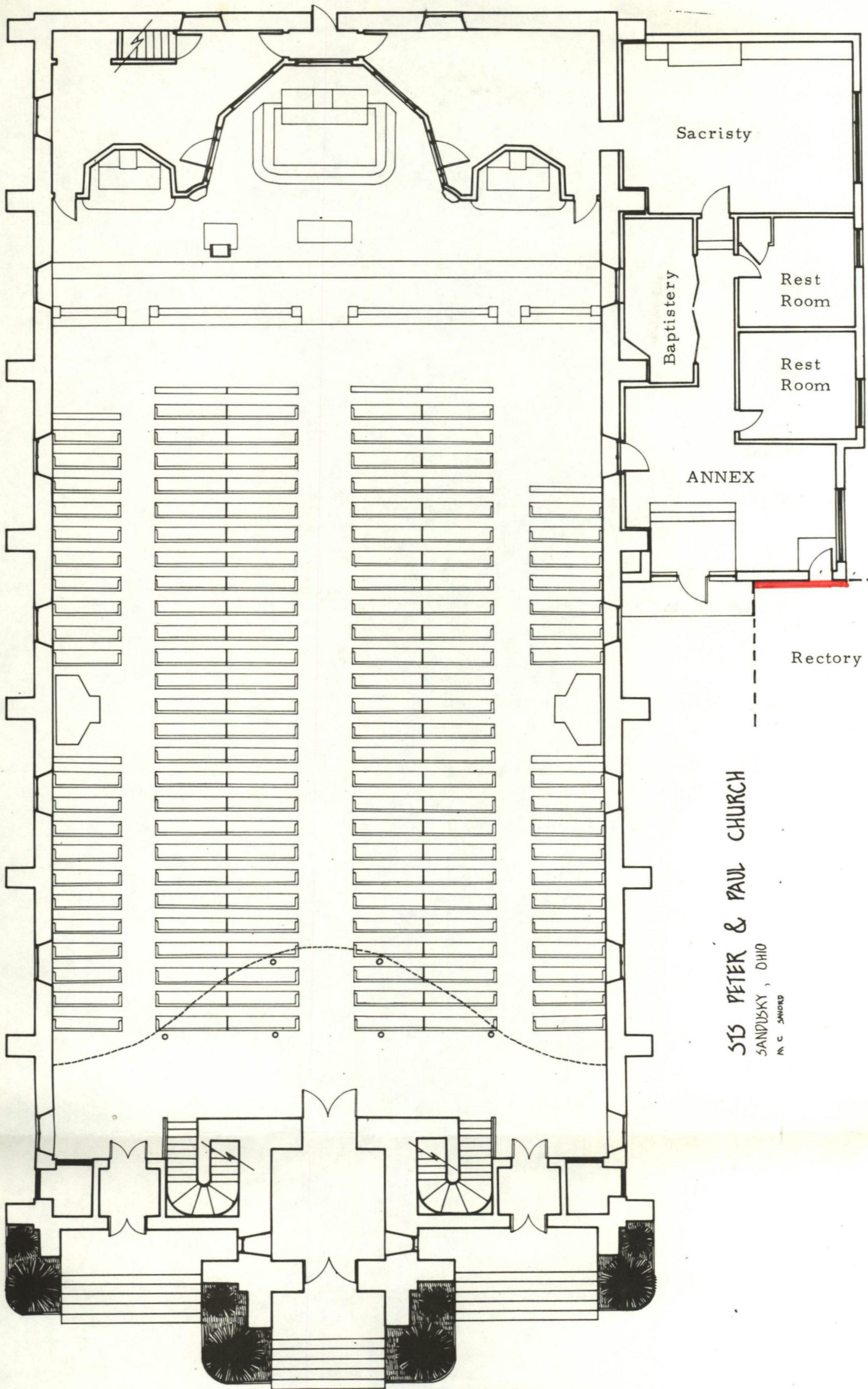

Sacristy

Baptistry

Rest Room

Rest Room

ANNEX

Rectory

STs PETER & PAUL CHURCH

SANDUSKY, OHIO

M. C. SANDORD

United States Department of the Interior
National Park Service

National Register of Historic Places
Inventory—Nomination Form

For NPS use only
received
date entered

Continuation sheet

Item number

Page 2 of 9

Multiple Resource Area
Thematic Group

Name Sandusky Multiple Resource Area
State Ohio

Nomination/Type of Review

Date/Signature

- 11. Coliseum Substantive Review Keeper Bruce Mac Donald 10/20/82
Attest _____
- 12. U.S. Coast Guard Building Entered in the National Register for Keeper Delores Byers 10/20/82
Attest _____
- 13. St. Mary's Rectory Entered in the National Register for Keeper Delores Byers 10/20/82
Attest _____
- 14. Stone's Block Substantive Review Keeper Bruce Mac Donald 10/20/82
Attest _____
- 15. Emmanuel Church Entered in the National Register for Keeper Delores Byers 10/20/82
Attest _____
- 16. Cooke, Eleutheros, House (410 Columbus Ave.) Entered in the National Register for Keeper Delores Byers 10/20/82
Attest _____
- 17. Cooke - Robertson House Substantive Review Keeper Bruce Mac Donald 10/20/82
Attest _____
- 18. Godfrey-Johnson House Entered in the National Register for Keeper Delores Byers 10/20/82
Attest _____
- 19. First Congregational Church Entered in the National Register for Keeper Delores Byers 10/20/82
Attest _____
- 20. Sts. Peter & Paul Church AND RECTORY Substantive Review Keeper Bruce Mac Donald 1/20/85
Attest _____

United States Department of the Interior
National Park Service

Substantive Review

AND RECTORY.

Sts. Peter & Paul Church (Sandusky MRA)
OH, Erie

Working No. 9.8.82-2427

Fed. Reg. Date: 2.7.84

Date Due: 1/20/83

Action: ACCEPT 1/20/83

RETURN

REJECT

Federal Agency: _____

- resubmission
- nomination by person or local government
- owner objection
- appeal

Substantive Review: sample request appeal NR decision

Reviewer's comments:

THE CHURCH AND RECTORY ARE ELIGIBLE
AS A UNIT. THE NAME SHOULD BE
CHANGED TO REFLECT THE HISTORICAL
SIGNIFICANCE
OF EACH AS PART OF A WHOLE.

Recom./Criteria Atc/accept

Reviewer Wm. Meyer

Discipline A-H

Date 1.20.83

see continuation sheet

Nomination returned for: technical corrections cited below
 substantive reasons discussed below

1. Name

2. Location

3. Classification

Category	Ownership	Status	Present Use
	Public Acquisition	Accessible	

4. Owner of Property

5. Location of Legal Description

6. Representation in Existing Surveys

has this property been determined eligible? yes no

7. Description

Condition		Check one	Check one
<input type="checkbox"/> excellent	<input type="checkbox"/> deteriorated	<input type="checkbox"/> unaltered	<input type="checkbox"/> original site
<input type="checkbox"/> good	<input type="checkbox"/> ruins	<input type="checkbox"/> altered	<input type="checkbox"/> moved date _____
<input type="checkbox"/> fair	<input type="checkbox"/> unexposed		

Describe the present and original (if known) physical appearance

- summary paragraph
- completeness
- clarity
- alterations/integrity
- dates
- boundary selection

8. Significance

Period _____ Areas of Significance—Check and justify below

Specific dates _____ Builder/Architect _____

Statement of Significance (in one paragraph)

- summary paragraph
- completeness
- clarity
- applicable criteria
- justification of areas checked
- relating significance to the resource
- context
- relationship of integrity to significance
- justification of exception
- other

9. Major Bibliographical References

10. Geographical Data

Acreage of nominated property _____

Geographic name _____

UNIT References _____

Verbal boundary description and justification _____

11. Form Prepared By

12. State Historic Preservation Officer Certification

The evaluated significance of this property within the state is:

national state local

State Historic Preservation Officer signature _____

title _____ date _____

13. Other

- Maps
- Photographs
- Other

Questions concerning this nomination may be directed to _____

Signed _____ Date _____ Phone: 202 272-3504

Comments for any item may be continued on an attached sheet



#27

Sts. Peter and Paul Church
Sandusky. Erie County. Ohio.
Janelle. 1979. OHG.

West & North sides looking
southeast.

9/8/82
Paul
Jefferson



ST. PETER AND PAUL
CATHOLIC CHURCH

MASSSES
SAT. 4:00 7:00 PM
SUN. 7:15 8:30 10:00 11:30 A.M.
WED. 6:30 8:00 10:00
CONFESSIONS SAT. 4:00 - 6:00 P.M.
ALLELUIA
HE IS RISEN

#29

Sts. Peter and Paul Rectory
Sandusky, Erie County, Ohio.
Janelle. 1979. OHG.

West & North sides looking
southeast.

9/8/82 ✓

Paul Rectory
bus ave.

Please refer to the map in the
Multiple Property Cover Sheet
for this property

Multiple Property Cover Sheet Reference Number: 64000649

TELEPHONE REPORT

OFFICE OF ARCHEOLOGY AND HISTORIC PRESERVATION

PROJECT: St Peter and Paul Church and Rectory

TO/FROM: Barbara Powers

DATE: 1/20/83

ADDRESS: Ohio SHPO

PHONE:

STAFF MEMBER: MacDougal

DIVISION:

REPORT:

Since the property consists of the two buildings, now joined I asked her if she saw any reason to not list them as the combined property and officially change the nomination name to reflect the change. She said that was fine; they will change their records to reflect the change.
