

PH 0664693

UNITED STATES DEPARTMENT OF THE INTERIOR  
NATIONAL PARK SERVICE

DATA SHEET

FOR NPS USE ONLY

RECEIVED

MAR 15 1978

DATE ENTERED

MAY 16 1978

NATIONAL REGISTER OF HISTORIC PLACES  
INVENTORY -- NOMINATION FORMSEE INSTRUCTIONS IN HOW TO COMPLETE NATIONAL REGISTER FORMS  
TYPE ALL ENTRIES -- COMPLETE APPLICABLE SECTIONS

## 1 NAME

HISTORIC Circleville Historic District

AND/OR COMMON

## 2 LOCATION

STREET & NUMBER  
(see continuation sheet)

CITY, TOWN

Circleville

VICINITY OF

NOT FOR PUBLICATION

CONGRESSIONAL DISTRICT

William Harsha - 6th

STATE

Ohio

CODE  
039COUNTY  
PickawayCODE  
129

## 3 CLASSIFICATION

## CATEGORY

☒ DISTRICT  
☐ BUILDING(S)  
☐ STRUCTURE  
☐ SITE  
☐ OBJECT

## OWNERSHIP

☐ PUBLIC  
☐ PRIVATE  
☒ BOTH  
**PUBLIC ACQUISITION**  
☐ IN PROCESS  
☐ BEING CONSIDERED

## STATUS

☒ OCCUPIED  
☐ UNOCCUPIED  
☐ WORK IN PROGRESS  
**ACCESSIBLE**  
☒ YES: RESTRICTED  
☐ YES: UNRESTRICTED  
☐ NO

## PRESENT USE

☐ AGRICULTURE  
☒ COMMERCIAL  
☐ EDUCATIONAL  
☐ ENTERTAINMENT  
☐ GOVERNMENT  
☐ INDUSTRIAL  
☐ MILITARY  
☐ MUSEUM  
☐ PARK  
☒ PRIVATE RESIDENCE  
☐ RELIGIOUS  
☐ SCIENTIFIC  
☐ TRANSPORTATION  
☐ OTHER:

## 4 OWNER OF PROPERTY

NAME  
Multiple public & private

STREET &amp; NUMBER

CITY, TOWN

VICINITY OF

STATE

## 5 LOCATION OF LEGAL DESCRIPTION

COURTHOUSE.  
REGISTRY OF DEEDS, ETC.

Pickaway County Courthouse

STREET &amp; NUMBER

Court &amp; Franklin

CITY, TOWN

Circleville

STATE

Ohio

## 6 REPRESENTATION IN EXISTING SURVEYS

TITLE

DATE

FEDERAL STATE COUNTY LOCAL

DEPOSITORY FOR  
SURVEY RECORDS

CITY, TOWN

STATE

## 7 DESCRIPTION

### CONDITION

☒ EXCELLENT  
☒ GOOD  
☐ FAIR

☐ DETERIORATED  
☐ RUINS  
☐ UNEXPOSED

### CHECK ONE

☐ UNALTERED  
☒ ALTERED

### CHECK ONE

☒ ORIGINAL SITE  
☐ MOVED DATE \_\_\_\_\_

### DESCRIBE THE PRESENT AND ORIGINAL (IF KNOWN) PHYSICAL APPEARANCE

Laid out in a circular pattern after its founding in 1810, the town of Circleville was completely "squared" by the mid 1860's. Most of the public buildings date from that period, though many of the homes were built much earlier. Homes and public buildings are generally well-cared for and provide a fine area of architectural continuity. The buildings represent the vernacular architecture of the midwest in the nineteenth century. The historic district encompasses most of the Indian earthworks including the circle within which the town was centered. The buildings within the northern half of the district make up the typical main street of this midwestern town, two -four story commercial buildings, lining either side of the main streets. The southern half is more residential; small gardens separate most of the buildings from each other and the street. Some noteworthy examples are:

PHOTO 4

The Circleville City Building: designed by William Doane and completed in 1861; the three story brick building shows the influence of the Romano-Tuscan style. The walls are arcaded, the first floor windows have fanlights above them, and the eaves are supported by wooden brackets. The slate roof has a round wooden cupola in the center. Little modified, the building is in excellent condition.

PHOTO 6A

Pickaway County Courthouse: originally a small Greek revival courthouse, architects Weary & Kramer nearly concealed the original building in their extensive modification of 188-1896. The building is two-storied, with hip roof and a square tower on the east side which pierces the pediment. Above the roofline, the tower has a louvered belfry. It is built of rock-faced stone with smooth stone pilasters; the center bay, next to the tower, is pedimented and is part of the original (1847) courthouse.

PHOTO 6

Sheriff's Office & Jail: a converted 2-story Queen Anne style residence built about 1890 of brick and stone, the building now houses the sheriff's office. Tall rectangular windows, belt courses of stone and a tower on the northeast corner are noteworthy features. The jail is in a three story brick addition to the rear of the home.

PHOTOS 3A & 3B

The Masonic Lodge: designed by J.T. Harris of Columbus, it was erected in 1876. The fine, 4-story Italianate structure has commercial uses on the first two floors with the upper two floors used for lodge and meeting rooms. It is brick with stone trim with handsome hoodmolds and an elaborately bracketed cornice topped by a broken pediment on the east facade.

PHOTO 1

The People's Bank (Marfield Bank): 133-135 W. Main St., built in 1848 and operated until 1877 by Samuel Marfield as a banking house. The 2-story brick and stone building is the only remaining structure with a portion of its property line still part of the original circular pattern. It was restored in 1972 by its present owners, the Pickaway County Historical Society.

PHOTO 2

The Old Building (Old Masonic Lodge), 115-119 W. Main St., built in 1837 by Dr. Edson Olds, the three-story brick building with parapet walls has rows of rectangular sash windows on the 2nd and 3rd floors. The 1st floor houses three stores, two of which have been there since the mid-1800's.

PHOTO 7

The Denny-Renick-May House, 225 S. Court St., built ca. 1835 by Samuel Denny, clerk of



UNITED STATES DEPARTMENT OF THE INTERIOR  
NATIONAL PARK SERVICE

**NATIONAL REGISTER OF HISTORIC PLACES  
INVENTORY -- NOMINATION FORM**

FOR NPS USE ONLY

RECEIVED

MAR 15 1978

DATE ENTERED

MAY 16 1978

Circleville Historic District  
Pickaway Co., Ohio

CONTINUATION SHEET

ITEM NUMBER 7

PAGE 2

courts and county auditor, the two-story L-shaped brick building with limestone cornices features an elaborate bracketed hood over the center door. It was acquired by the May family in 1916.

*PHOTOS 10A & 10B*

The Fickardt-Brunner House, 317 South Court Street, a 2-story Victorian structure featuring a projecting bay to the left of the main door. Windows in the bay have elaborate stone hoodmolds. The entrance has a pedimented and bracketed hood and the cornice is heavily bracketed with a deep, molded frieze. The home was built in 1840 and extensively remodeled in the late 1880's.

*PHOTO B*

The Caleb Atwater House, 126 E. Mound, a one-story mansard roofed brick building with additions. Built in 1850's it was the home of Atwater and his descendants.

*PHOTO 9*

The Moore House, 304 S. Court St., begun in 1818 and added to in 1844 when Samuel Moore became owner. The brick home has a heavily bracketed cornice and bracketed hoods over the doors. It was further refined and completed in 1870. There is a free-hanging stairway in the front hall. Samuel Moore was one of the most outstanding and public spirited citizens of Circleville. He died in 1902 and the home is still owned by members of the Moore family.

8. SIGNIFICANCE, continued, page 2

Dr. E.B. Olds erected a large 3-story brick block in 1839 and in so doing commenced the squaring of the circular plat. The building housed his office and his drug business, later known as the Circleville Drug Co., and the Olds and Baker Goods Store.

In 1854 T.K. Brunner opened his jewelry store in the block. The great grandson of Brunner now runs the shop. The Brunner Jewelers, oldest in Circleville, have been caretakers of the courthouse clock since it was installed in 1889. L.M. Butch Co., Jewelers, established in 1881, is also located in the Olds Buildings and is still operated by the Butch family.

Circleville has remained prosperous and has managed to preserve its buildings and its heritage. The district has an unusually fine collection of both residential and commercial architecture reflecting its history and the popular tastes and trends of the time.

## 8 SIGNIFICANCE

| PERIOD                                        | AREAS OF SIGNIFICANCE -- CHECK AND JUSTIFY BELOW |                                                 |                                                 |                                              |  |
|-----------------------------------------------|--------------------------------------------------|-------------------------------------------------|-------------------------------------------------|----------------------------------------------|--|
| <input type="checkbox"/> PREHISTORIC          | <input type="checkbox"/> ARCHEOLOGY-PREHISTORIC  | <input type="checkbox"/> COMMUNITY PLANNING     | <input type="checkbox"/> LANDSCAPE ARCHITECTURE | <input type="checkbox"/> RELIGION            |  |
| <input type="checkbox"/> 1400-1499            | <input type="checkbox"/> ARCHEOLOGY-HISTORIC     | <input type="checkbox"/> CONSERVATION           | <input type="checkbox"/> LAW                    | <input type="checkbox"/> SCIENCE             |  |
| <input type="checkbox"/> 1500-1599            | <input type="checkbox"/> AGRICULTURE             | <input type="checkbox"/> ECONOMICS              | <input type="checkbox"/> LITERATURE             | <input type="checkbox"/> SCULPTURE           |  |
| <input type="checkbox"/> 1600-1699            | <input checked="" type="checkbox"/> ARCHITECTURE | <input type="checkbox"/> EDUCATION              | <input type="checkbox"/> MILITARY               | <input type="checkbox"/> SOCIAL/HUMANITARIAN |  |
| <input type="checkbox"/> 1700-1799            | <input type="checkbox"/> ART                     | <input type="checkbox"/> ENGINEERING            | <input type="checkbox"/> MUSIC                  | <input type="checkbox"/> THEATER             |  |
| <input checked="" type="checkbox"/> 1800-1899 | <input type="checkbox"/> COMMERCE                | <input type="checkbox"/> EXPLORATION/SETTLEMENT | <input type="checkbox"/> PHILOSOPHY             | <input type="checkbox"/> TRANSPORTATION      |  |
| <input type="checkbox"/> 1900-                | <input type="checkbox"/> COMMUNICATIONS          | <input type="checkbox"/> INDUSTRY               | <input type="checkbox"/> POLITICS/GOVERNMENT    | <input type="checkbox"/> OTHER (SPECIFY)     |  |
|                                               |                                                  | <input type="checkbox"/> INVENTION              |                                                 |                                              |  |

SPECIFIC DATES

BUILDER/ARCHITECT

### STATEMENT OF SIGNIFICANCE

The Circleville Historic District contains an unusually fine collection of both residential and commercial architecture reflecting its history and the popular tastes and trends of the time. The town has remained prosperoud and has managed to preserve its buildings and its heritage. There are approx. 85 buildings in the historic district.

Established in January, 1810, Circleville was located amid some of the most significnat Indian earthworks in southern Ohio. The site was selected in order to preserve the works and the town was laid out within the circular enclosre. Ironically, the building of the town and its later growth has completely destroyed the prehistoric site. Archeologists have been consulted and have reported that it is unlikely that any significant archeological material remains. Early reports concerning the works are enclosed.

The courthouse was located at the center of the earthworks, and streets laid out in circles around it. Beyond the enclosrue, the residential area was laid out in a more conventional rectangular grid. However, the novel geometry of Circleville was soon found to be inconvenient and in 1836 a movement was started to have the circular plat squared. It was during this change that all traces of the circular earthworks were removed. The earthworks contained excellent clay for brick and Caleb Atwater, educator, minister, lawyer, author and pioneer in the movement to build the Ohio Canal system, reported in his Western Antiquities that the earthworks were "disappearing before us daily." Many buildings were razed in the courthouse area, accounting for the many mid-nineteenth century structures in the downtown area.

The early life of the town depended upon its being the county seat and at the crossroads between Columbus & Portsmouth and Cincinnati and Lancaster. The growth of Circleville was aided by the construction of the Ohio Canal which opened in Circleville in 1831. The canal opnened markets for the agricultural and livestock products of Pickaway County. These markets were maintained and added to by the growth of the railroads. Many were involved in the growth and history of Circleville.

The Masons, once located in the Olds Building, built a Masonic Lodge building at a cost of \$22,000. In constant use since its completion, it is an excellent example of High Victorian Italianate architecture. The Circleville City Building, also in continuous use since its completion, was designed by a local citizen, William Doane, a carriage manufacturer. The building contained the Mayor's office, council room, city offices, and city police department. The first story was leased to W.R. Hosler Packing Co. and J. Antill's retail confectionery. The building still suits the city's needs.



## 9 MAJOR BIBLIOGRAPHICAL REFERENCES

Goeldner, Paul. List of 19th Century Courthouses in Ohio. Historic American Buildings Survey, National Park Service, Washington, D.C. 20240  
Howe, Henry. Historical Collections of Ohio, Cincinnati, 1902, State of Ohio.  
Van Cleaf, Aaron R. History of Pickaway County, Ohio, Biographical Publishing Co., Chicago, 1906.  
Williams Brothers, History of Franklin and Pickaway Counties, Ohio, Chicago, 1880, Williams Brothers Publishing Co.

## 10 GEOGRAPHICAL DATA

ACREAGE OF NOMINATED PROPERTY ca. 35

UTM REFERENCES

A 1 7 3 3 3 1 2 5 4 3 8 5 2 4 5  
ZONE EASTING NORTHING  
C 1 7 3 3 2 5 1 5 4 3 8 4 8 7 1 0

B 1 7 3 3 2 9 0 5 4 3 8 4 7 4 0  
ZONE EASTING NORTHING  
D 1 7 3 3 2 8 1 5 4 3 8 5 3 8 1 0

VERBAL BOUNDARY DESCRIPTION

see continuation sheet

LIST ALL STATES AND COUNTIES FOR PROPERTIES OVERLAPPING STATE OR COUNTY BOUNDARIES

| STATE | CODE | COUNTY | CODE |
|-------|------|--------|------|
| STATE | CODE | COUNTY | CODE |

## 11 FORM PREPARED BY

NAME / TITLE

David Brook

Gretchen Klimoski

ORGANIZATION

DATE

SCOPS

Ohio Preservation Office

Sept. 1977

STREET & NUMBER

TELEPHONE

1982 Velma Ave

(614) 466-8727

CITY OR TOWN

STATE

Piketon

Columbus

Ohio

## 12 STATE HISTORIC PRESERVATION OFFICER CERTIFICATION

THE EVALUATED SIGNIFICANCE OF THIS PROPERTY WITHIN THE STATE IS:

NATIONAL     

STATE X

LOCAL     

As the designated State Historic Preservation Officer for the National Historic Preservation Act of 1966 (Public Law 89-665), I hereby nominate this property for inclusion in the National Register and certify that it has been evaluated according to the criteria and procedures set forth by the National Park Service.

STATE HISTORIC PRESERVATION OFFICER SIGNATURE

TITLE

DATE 3.8.78

FOR NPS USE ONLY

I HEREBY CERTIFY THAT THIS PROPERTY IS INCLUDED IN THE NATIONAL REGISTER

DIRECTOR, OFFICE OF ARCHEOLOGY AND HISTORIC PRESERVATION

ATTEST:

KEEPER OF THE NATIONAL REGISTER

DATE

REDEEMER ON THE NATIONAL REGISTER

DATE

UNITED STATES DEPARTMENT OF THE INTERIOR  
NATIONAL PARK SERVICE

**NATIONAL REGISTER OF HISTORIC PLACES  
INVENTORY -- NOMINATION FORM**

Circleville Historic District  
Pickaway County, Ohio

FOR NPS USE ONLY

RECEIVED MAR 15 1978

DATE ENTERED MAY 16 1978

CONTINUATION SHEET

ITEM NUMBER 10 PAGE 2

Verbal Boundary Description

Beginning at the center of the intersection of Pinckney, N. Court and Watt Streets, go east on Watt to the first alley ~~west~~ of Court St., south on the alley to the intersection with the only alley between and parallel to Watt and Main Streets, go east on said alley to intersection with north-south alley entering E. Main Street between 130 E. Main and the 2nd National Bank Building. Proceed south on the alley crossing E. Main following jog of alley between F.O.E. Lodge and 127-1/2 E. Main. Then south on alley crossing Franklin and Mound Streets to intersection with only east-west alley between and parallel to Mound and Union Streets. Proceed westerly to intersection with first north-south alley east of S. Court St., go south on alley crossing Union St. to southeast corner of 412 S. Court, Then proceed westerly across S. Courth following south boundary of 412 S. Court, and 403 S. Court to southwest corner of S. Court to first north south alley west of Court St. Then proceed northward on alley following jogs between 127 W. Mound St. and 144-1/2 W. Mound, crossing Franklin St. just west of the County Sheriff's Office to point of intersection with first east-west alley south of W. Main St. following jogs to Scioto St. in westerly direction. Proceed north on center of Scioto St., crossing W. Main St. to juncture with northwest corner of Cardinal Food lot, 160 W. Main, then easterly along north boundary of lot to first east-west alley north of W. Main St. Proceed easterly on alley to intersection with first north south alley west of N. Courth, north on said alley to center of Pinckney St. hence east to point of beginning.



UNITED STATES DEPARTMENT OF THE INTERIOR  
NATIONAL PARK SERVICE

**NATIONAL REGISTER OF HISTORIC PLACES  
INVENTORY -- NOMINATION FORM**

FOR NPS USE ONLY

RECEIVED

DATE ENTERED

MAY 16 1978

Circleville Historic District, Pickaway County, Ohio

CONTINUATION SHEET

ITEM NUMBER

PAGE

The boundaries as drawn represent the major concentration of historic buildings remaining in the town. To the west the area is intruded on by I-71 and some concentration of industrial buildings; to the other sides are newer residences and/or commercial buildings.

On the district map are noted the most outstanding structures in the district as well as the intrusions. Unless marked as a parking area, the areas between buildings contribute to the district with structures that are conforming though less spectacular than those specifically discussed in the nomination.

UNITED STATES DEPARTMENT OF THE INTERIOR  
NATIONAL PARK SERVICE

**NATIONAL REGISTER OF HISTORIC PLACES  
INVENTORY -- NOMINATION FORM**

FOR NPS USE ONLY

RECEIVED

MAR 15 1978

DATE ENTERED

MAY 16 1978

Circleville Historic District  
Pickaway Co., Ohio

CONTINUATION SHEET

ITEM NUMBER

PAGE

MAP  
CIRCLEVILLE  
HISTORIC DISTRICT

CIRCLEVILLE, OHIO

LOCATION OF  
REPRESENTATIVE BUILDINGS

1. People's (Marfield) Bank  
133-135 W. Main Street (photo 1)
2. Olds Building  
115-119 W. Main Street (photo 2)
3. Masonic Temple (photos 3a+3b)  
113-115 S. Court Street
4. Circleville City Building  
NW Corner of Franklin and  
S. Court Streets (photo 4)
5. Pickaway County Sheriff's  
Office and Jail (photo 5/  
Franklin Street (photo 6b)
6. Pickaway County Courthouse  
NW Corner of Franklin and  
S. Court Streets (photo 6a+6b)
7. Denny- Renick-May House  
225 S. Court St. (photo 7)
8. Caleb Atwater House  
126 E. Mound (photo 8)
9. Moore House  
304 S. Court Street (photo 9)
10. Fickardt-Brunner House  
317 S. Court Street (photo 10)  
a+b

INTRUSIONS

- A. General Telephone  
Co. of Ohio  
113 Pinckney Street
- B. Columbia Gas Co.  
134 N. Court St.
- C. Cardinal Food Store  
160 W. Main Street
- D. Bingham Drug Store  
140 W. Main Street

- E. 1st National Bank  
100 E. Main Street
- F. Jimmy's Townhouse  
Restaurant  
122 E. Main St.
- G. J.C. Penny Co.  
141 W. Main St.

- H. Scioto Bldg. and Loan  
120 S. Court St.
- I. Pettit's Appliance &  
Sports Shop  
130 S. Court Street
- J. Kochheiser Hardware  
116 W. Main Street

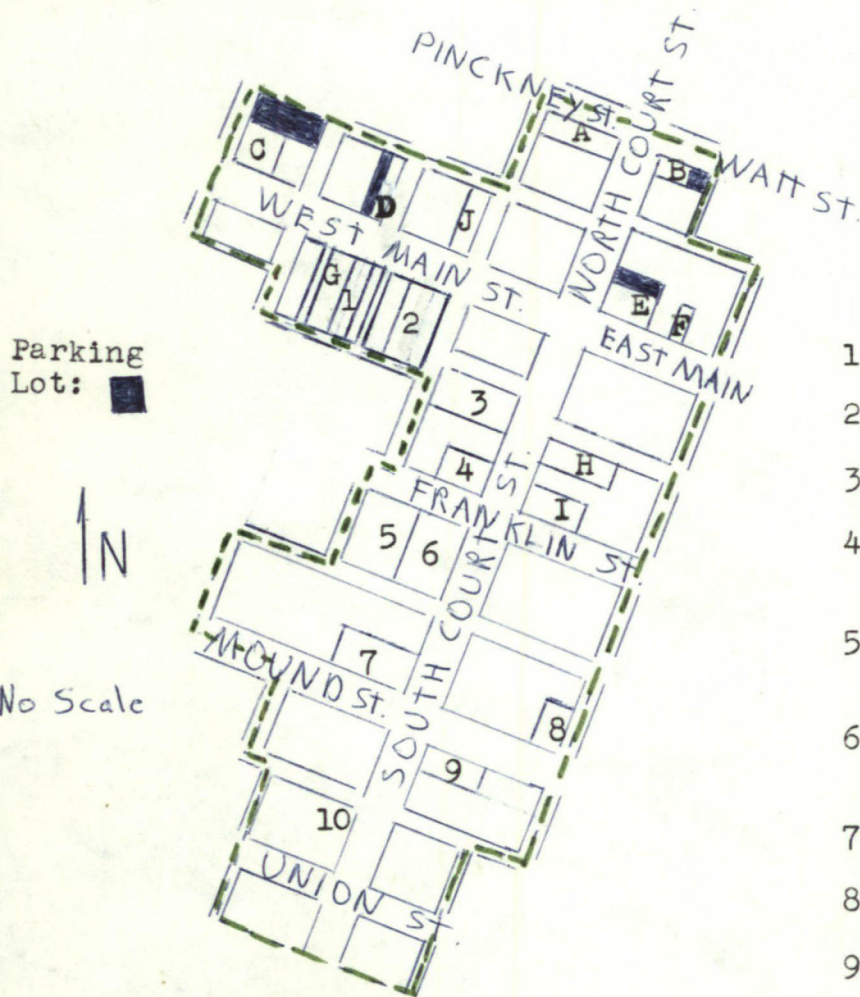



**Regional Office: South Central Ohio Preservation Society**

**Box 6 Piketon, Ohio 45661 (614) 289-2704 (614) 775-3961**

PROPERTY OWNERS IN  
CIRCLEVILLE HISTORIC DISTRICT  
CIRCLEVILLE, OHIO 43113

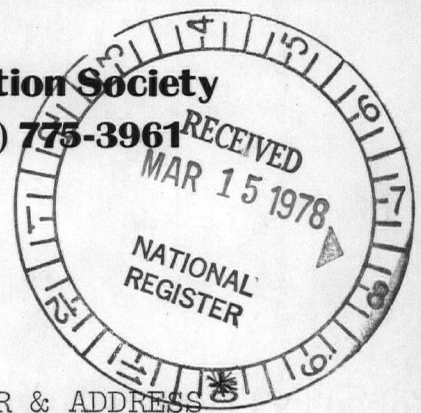

BLDG. ADDRESS

OWNER & ADDRESS

- |                                              |                                                                                                            |
|----------------------------------------------|------------------------------------------------------------------------------------------------------------|
| 1. Tradition House - 107 N. Court St.        | ✓ Chester Blue, 121 Wilson<br>✓ David Blue, R D. #5<br>Circleville, Ohio 43113                             |
| 2. The Other Place - 113 N. Court St.        | ✓ Earl Sharff, 602 Plaza Dr.<br>Circleville, Ohio 43113                                                    |
| 3. Pythian Castle, -114 N. Court St.         | ✓ Philos Lodge #64, Grand<br>Chancellor,<br>✓ Paul Reed, 842 Pershing Dr.<br>Circleville, Ohio 43113       |
| 4. Savings Bank - 118 N. Court St.           | ✓ Walter Garner, 235 Sunset Dr.<br>Circleville, Ohio 43113                                                 |
| 5. Mason Furniture Co. - 119 N. Court St.    | ✓ Mr. & Mrs. F.O. Patrick,<br>315 Wood Lane<br>Circleville, Ohio 43113                                     |
| 6. Crist Bldg - 121 N. Court St.             | ✓ J. F & C. D. Crist<br>835 Lancaster Pike<br>Circleville, Ohio 43113                                      |
| 7. State Liquor Store No. 26<br>112 N. Court | ✓ Dr. Goldschmidt, Dave<br>901 North Atwater St.<br>Circleville, Ohio 43113                                |
| 8. W.J. Weaver & Son - 126 N. Court St.      | ✓ Estate of Weldon, Helen & by<br>Weldon Wm. Partnership<br>410 South Court St.<br>Circleville, Ohio 43113 |
| 9. Columbia Gas of Ohio - 134 N. Court St.   | ✓ Columbus Hdqtrs.<br>109 N. Front St.<br>Circleville, Ohio 43113                                          |

\* Unless otherwise indicated all owner addresses are for Circleville, Ohio 43113

**Regional Office: South Central Ohio Preservation Society**  
**Box 6 Piketon, Ohio 45661 (614) 289-2704 (614) 775-3961**

10. East Side of South Court St. for National Registration of Downtown  
Circleville, Ohio 43113
11. 108 South Court St. ✓ Lucy's Beauty Shop-owned by Alice Lang Vance and  
Willa Ann Hamilton, Vance Ins. Ag. Bldg.  
Lexington, Kentucky 40507
12. 110 South Court St. ✓ H & R Tax Con. & Kay Dee Cosmetics Co.-owned by  
Alice Lang Vance and Willa Ann Hamilton, Vance  
Ins. Ag. Bldg. Lexington, Kentucky 40507
13. 112 South Court St. ✓ Fred's Shoe repair-owned by Alice Lang Vance and  
Willa Ann Hamilton, Vance Ins. Ag. Bldg.  
Lexington, Kentucky 40507
14. 114 South Court St. ✓ Giovanni's Pizza-owned by Harry Heffner Trust,  
2 Larchmont, Cincinnati, Ohio
15. 120 South Court St. ✓ Scioto Building & Loan-owned by Board of Directors,  
120 South Court St., Circleville, Ohio 43113
16. 122 South Court St. ✓ Saddle Shop-owned by Johnson, Paul & others  
584 Woodland Drive, Circleville, Ohio 43113
17. 124 South Court St. ✓ Brown Office Equipment-owned by Johnson, Paul  
& others, 584 Woodland Drive, Circleville,  
Ohio 43113
18. 126 South Court St. ✓ Margulis, Gussler, Hall & Hosterman Attorneys by  
Spires, Richard & Sue, 402 East Main St.-owned by  
Johnson, Paul & others, 584 Woodland Drive,  
Circleville, Ohio 43113
19. 128, 130 S. Court St. ✓ Pettits Appliance & Sports Shop by Pettit,  
Richard & Joan, 568 Springhollow Rd., Circleville  
Ohio 43113
20. 113 South Court St. ✓ Sherwin-Williams Paint Co.-owned by Masonic  
Temple Assoc. P.O. Box #103, Circleville, Ohio 43113
21. 115 South Court St. ✓ Nationwide Auto Parts. Owned by Masonic Temple  
Assoc. P.O. Box #103, Circleville, Ohio 43113
22. 117 South Court St. ✓ Henn House & Dry Cleaning by Barnhill, Frank  
& Martha, 106 Park St. Circleville, Ohio 43113
23. 119 South Court St. ✓ Christopher's Don Boutique by Clifton Motor Sales  
Inc., 1395 South Court St., Circleville, Ohio 43113
24. 121 South Court St. ✓ Christopher's Don Boutique by Clifton Motor Sales  
Inc., 1395 South Court St., Circleville, Ohio 43113



**Regional Office: South Central Ohio Preservation Society**  
**Box 6 Piketon, Ohio 45661 (614) 289-2704 (614) 775-3961**

25. 123 South Court St. ✓ Heiskell, W.D. & Son Realtors by Clifton Motor  
Sales Inc., 1395 South Court St., Circleville  
Ohio 43113
26. 125 South Court St. ✓ City Hall-owned by City of Circleville, Circleville,  
Ohio, 43113

**Regional Office: South Central Ohio Preservation Society**  
**Box 6 Piketon, Ohio 45661 (614) 289-2704 (614) 775-3961**

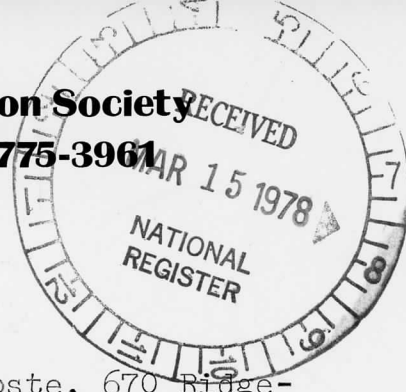

Center of town-South Court from  
 Franklin St. to Mound St.

27. 204 South Court St. ✓ Parking lot-owned by Dieter Droste, 670 Ridge-wood Drive, Circleville, Ohio 43113
28. 206 South Court St. Knight Travel Service-owned by ✓ Dr. John Bowers, 815 Arbor Rd., Circleville, Ohio 43113. Dr. ✓ Paul Routzan, 946 Circle Drive, Circleville, Ohio 43113
29. 206½ South Court St. ✓ Credit Bureau-owned by Dr. John Bowers, 815 Arbor Rd, Dr. Paul Routzan, 946 Circle Drive, Circleville, Ohio 43113
30. 210 South Court St. ✓ Weldon, Lemuel B. Attorney-owned by Weldon, Lemuel, 137 West Union St. Circleville, Ohio 43113
31. 216 South Court St. Johnson, Lawrence-Insurance-owned jointly by. ✓ Judge Guy Cline, 110 Park St., Ashville, Ohio ✓ Gorden, Julius, 585 Plaza Drive, and Gorden, Ben ✓ 112 Northridge Rd., Circleville, Ohio 43113
32. 224 South Court St. ✓ Post Office-Federal Government GSA, chg.
33. 225 South Court St. ✓ Resident of Stout, Wm. and owner 225 S. Court St.
34. 221 South Court St. ✓ Pickaway Co. Offices car reg. House ~~No~~ owned by County Commissioner Pickaway County, Courthouse Circleville, O. 43113
35. 205 South Court St. ✓ Court House owned by County Commissioners Pickaway County, Courthouse, Circleville, O. 43113
36. 139 West Franklin St. ✓ Sheriff's Office and Jail, County Commissioners, 205 South Court St.
37. 114 West Franklin St. ✓ Water Department, City of Circleville
38. 117-119 East Franklin Fitzpatrick's Printery, George Helwagen, P.O. Box 187
39. 123 East Franklin St. ✓ Circle Auto Parts, INc., Julia Winner, 150 Watt Street
40. 109 East Mound St. (Welfare Department, County Commissioners, Pickaway Co. Court-house, Circleville, O.
41. 115 East Mound St., ✓ Pickaway Arms Restaurant, Martin & Trudy Sharrett, 163 Montclair Avenue, Circleville
42. 123 East Mound St. ✓ Mader Funeral Home, Lincoln Mader, 160 Pickaway Street
43. 126 East Mound St. ✓ David and Trudy Yates residence, 126 East Mound Street
44. 127 West Mound St. ✓ St. Phillips Rectory, Church Warden and Vestry, 410 South Court Street, Circleville
45. 132 West Mound St. ✓ Catholic School, Clarence E. Elwell, Bishop of Columbus, St. Joseph Catholic Church, 134 West Mound St., Circleville, O.
46. 134 West Mound St. ✓ St. Joseph's Church and Rectory, "
47. 116 East Mound St. ✓ Allan and Diane Berger, residence. 114 1/2 S. Court St.

**Ohio Historic Preservation Office**

**Ohio Historical Center I-71 & 17th Avenue Columbus, Ohio 43211 (614) 466-8727**



SOUTH COURT STREET

MOUND ST. TO UNION ST.

1. 303 South Court St. ✓Carl C. Leist, 205 Northridge Rd., Circleville,  
Ohio 43113
2. 304 South Court St. ✓Phillip Moore II and brother, 304 South Court  
Street, Circleville, Ohio 43113
3. 307 South Court St. ✓Harold W. & Pauline Clifton, Residence, 307 S. Court St.
4. 313 South Court St. ✓Bruce N. Valentine, residence & office, 313 S. Court St
5. 316 South Court St. ✓Eva Shulze-Lenuel B. Welson, Attorney, 210  
South Court St., Circleville, Ohio 43113
6. 317 South Court St. ✓John H. Eveland-Mrs. Harold O. Eveland,  
150 W. Mound, Circleville, Ohio 43113
7. 318 South Court St. ✓Louise Bennett, residence, 318 South Court Street  
Circleville, Ohio 43113
8. 324 South Court St. ✓Matilda Heffner, residence, Harry W. Heffner Estate,  
324 South Court Street, Circleville, O.
9. 325 South Court St. ✓Geo. Foresman, residence, George & Katharine F. Harman,  
325 South Court Street, Circleville
10. 403 South Court St. ✓Alda Bartley-George Young, Attorney, 103½ E.  
Main Street, Circleville, Ohio 43113
11. 410 South Court St. ✓William W. Weldon, residence, 410 South Court Street,  
Circleville, Ohio 43113

East Main St. National Registration for Downtown Circleville, Ohio 43113

12. 100 East Main St. First National Bank-owned by Directors of First National Bank, Circleville, Ohio 43113
13. 101½ East Main St. International Order of Odd Fellow Bldg - Odd Fellow Bldg Association, Circleville, Ohio 43113
14. 101 East Main St. Boyers Restaurant-Odd Fellow Bldg Association Circleville, Ohio 43113
15. 103 East Main St. Hatfield Ins. & Hatfield Realty-Odd Fellow Bldg. Association, Circleville, Ohio 43113
16. 103½ East Main St. George Young Lawyer & Tom Tootle Lawyer-Loof Lodge room #32-Odd Fellow Bldg Association, Circleville, Ohio 43113
17. 105 East Main St. Burton Jewellery-Odd Fellow Bldg Association, Circleville, Ohio 43113
18. 107 East Main St. Center Sentry Hardware & Western Union-Odd Fellow Bldg Association, Circleville, Ohio 43113
19. 107½ East Main St. vacant - same as 107 East Main
20. 111 East Main St. Main Barber Shop-Odd Fellow Bldg. Association Circleville, Ohio 43113
21. 112 East Main St. Parking Lot for First National Bank-owned by First National Bank Directors.
22. 113 East Main St. Macks-Tire.-owned by David McDonald, 982 Dunkle Rd., Circleville, Ohio 43113
23. 113½ East Main St. Joe Goeller Dentist-owned by David McDonald, 982 Dunke Rd., Circleville, Ohio 43113
24. 114 East Main St. Columbus & Southern Ohio Electric Co.-owned by Col. & Southern O. Electric Co., 215 North Front St. Cols. Ohio 43215
25. 116 East Main St. U.S.A. Recruiting St.-owned by Dick Petit, 568 Spring Hollow Road, Circleville, Ohio 43113
26. 120 East Main St. Investors Loan Corp.-owned by Dick Petit, 586 Spring Hollow Rd., Circleville, Ohio 43113
27. 120½ East Main St. Betty Conrod-owned by Dick Petit, 586 Spring Hollow Rd., Circleville, Ohio 43113
28. 117 East Main St. Tootle Pumpkin Inn-by Bob Tootle East Main St. Circleville, Ohio 43113
29. 119 East Main St. Youth Center-by Bob Tootle East Main St. Circleville, O. 43113
30. 119½ East Main St. Mary E. Jones-by Bob Tootle East Main St. Circleville, O. 43113



31. 121 East Main St. ✓ Evans Reality-Evans, John Lincoln Dr.,  
Circleville, O. 43113
32. 121½ East Main St. ✓ Linda Haskins, -by John-Lincoln Dr., Circleville  
O. 43113
33. 122 East Main St. ✓ Jimmey's Townhouse-by David Block, 889 Atwater  
St., Circleville, Ohio 43113
34. 124 East Main St. ✓ Stonerocks T.V.-by Mrs. Scheiber, Charles,  
595 Ridgewood, Circleville, O. 43113.
35. 124½ East Main St. vacant Same as 124 East Main St.
36. 125 East Main St. ✓ Moats Auto Sales used cars lot-by Moats  
Harold, 117 Parks St., Circleville, O. 43113
37. 127 East Main St. ✓ Maures Mk. (Grocery)-by Moats, Grace, 118 Park  
St., Circleville, O. 43113
38. 127½ East Main St. - vacant Same as 127 East Main St.
39. 128 East Main St. ✓ Norman, Merle Cosmotics Studio by Barnes, Geo.  
619 N. Court St., Circleville, O. 43113
40. 130 East Main St. ✓ Barnes, Geo. Reality-by Geor. Barnes, 619  
N. Court St., Circleville, O. 43113
41. 130½ East Main St. ✓ Clarence Thomlison-by Geo. Barnes, 619 N. Court  
St., Circleville, O. 43113

North Side West Main St. for National Registration of Downtown  
Circleville, Ohio 43113

Center of town-Court St. to Scioto Sts.

42. 102 West Main St. ✓ Revco Drug Store-owned by Wm. F. Crist,  
835 Lancaster Pke., Circleville, O. 43113
43. 104 West Main St. ✓ Revco Drug Store-owned by Wm. F. Crist,  
835 Lancaster Pke., Circleville, O. 43113
44. 106 West Main St. ✓ Sharff's Women Apparel-Sharff, Mrs. Pearl, 5661  
Colliss Ave., Miami, Florida 33140
45. 108 West Main St. ✓ Keith's Men's Shop-by Hawk, Keith, 16 West Main  
s St. Logan, Ohio 43138
46. 110 West Main St. ✓ Central Gift-Hamilton, Marie, 153 West High St.  
Circleville, Ohio 43113
47. 112 West Main St. ✓ Montgomery Ward-Fabb, Mrs. Charles, new Rt. 35  
Washington C.H., Ohio
48. 114 West Main St. ✓ J. Born Floors-Barnes, Geo., 619 North Court St.  
Circleville, O. 43113
49. 116 West Main St. ✓ Kochheiser Hardware-Clifton, Harry, 1150 N.  
Court St., Circleville, O. 43113
50. 118 West Main St. ✓ Kochheiser Hardware-Clifton, Harry, 1150 N.  
Court St., Circleville, O. 43113
51. 120 West Main St. ✓ Monique Fabrics-by Crist, Wm. F., 835 Lancaster  
Pke., Circleville, O. 43113
52. 124 West Main St. ✓ Western Auto-Magill, John, 119 Seyfert Ave.  
Circleville, Ohio 43113
53. 126 West Main St. ✓ Western Auto-Magill, John, 119 Seyfert Ave.  
Circleville, Ohio 43113
54. 128-130 W. Main St. ✓ Colony House-by Robie, Mrs. Phil, 5012 N.  
Concord, Ashville, Ohio
55. 132 West Main St. ✓ Little Singer Sewing-by Smith, Robert, R.D.#4  
Circleville, O. 43113
56. 134-136 & 138 W. Main Lindsey's Donut Shop-Lindsey, Gene, 554 Green  
Acre Ct. Circleville, O. 43113
57. 140, 142 & 144 W. Main Bignman Drug by Clifton, Harry 1150 N. Court  
St., Circleville, O. 43113
58. 148, 148 & 150 W. Main ✓ Parking Lot due to big fire.-by Harry Clifton  
1150 N. Court St., Circleville, O. 43113



59. 152 West Main St. ✓ Circleville Reality by Alkire, Mrs. Harold  
554 N. Pickaway St., Circleville, O. 43113  
Colligan Water Softner.
60. 154 West Main St. ✓ Schreiner Photos-Schreiner, 213 E. Mound St.  
Circleville, O. 43113
61. 156 West Main St. ✓ Cablevision-owned by Haning Plumbing Inc.  
431 W. Fair Ave. Lancaster, Ohio 43130
62. 158 West Main St. ✓ Alkire T.V., Owned by-Haning Plumbing Inc.  
431 W. Fair Ave., Lancaster, Ohio 43130
63. 160,162,164W. Main ✓ Ward's Cardinal Market-by Skinner, Warden  
R.D. #5, Circleville, O. 43113
64. 166 West Main St. ✓ Parking lot for Wards, Market-by Skinner, Warden  
R.D. #5, Circleville, O. 43113

West Main

65. 101 West Main St. G.C. Murphy Co., J. Boyd Stout, 812 Arbor Rd. Circleville, O. 43113. ✓ Children of Mrs. Frances W. Beery, 137 Pinckney St..
66. 107 West Main St. ✓ City Loan-Third National Bank Directors, 166 E. Main St., Circleville, O. 43113
67. 109 West Main St. Blocks Shoe Store-David Block, 889 Atwater Ave., Circleville, Ohio 43113. ✓ children of Mrs. Frances W. Beery, 137 Pinckney St., Circleville, Ohio, 43113
68. 111½ West Main St. Blocks Shoe Store-David Block, 889 Atwater Ave., Circleville, Ohio 43113. ✓ children of Mrs. Frances W. Beery, 137 Pinckney St.
69. 113 West Main St. vacant
- 115 West Main St. ✓ L.M. Butch-(1st and 2nd floors) Mrs. Joe Bell 581 N. Court St., Circleville, O. 43113
70. 117 West Main St. ✓ Capital Fin. - Mrs. Joe Bell, 581 N. Court St. Circleville, O. 43113
71. 119 West Main St. ✓ (1st & 2nd floors) Brunner Estate-Mrs. H.O. Eveland, 150 W. Mount St., Circleville, O. 43113
72. 3rd floor of 115, 117, 119 W. Main St. ✓ Schottenstein Realty, 5301 GateHouse Dr., Columbus, Ohio
73. 121 West Main St. ✓ (old) Merit's-Mrs. Ted Lewis, 115 Central Park NY, NY,
74. 123 West Main St. ✓ Youth Center-Mrs. Ted Lewis, 115 Central Park West NY, NY
75. 125 West Main St. ✓ Caddy Miller-Fissell Estate---103 Seyfert, Circleville, O. 43113
76. 127 West Main St. ✓ Lindsey's-Eugene Lindsey, 554 Green Acre Ct., Circleville, O. 43113
77. 129 West Main St. ✓ King's Dept. Store-William F. Crist, 835 Lancaster Pike, Circleville, O. 43113
78. 133-135 W. Main St. ✓ Chamber of Commerce-Pickaway County Historical Society, 162 W. Union St., Circleville, O. 43113
79. 137 West Main St. ✓ J.C. Penney Co.-Bernard R. Rubin, 2525 Berwick Blve., Columbus, Ohio 43209
80. 147 West Main St. ✓ Washington's Corner-Larry McFadden, 569 Hickory Lane, Circleville, O. 43113
81. 149-151 W. Main St. ✓ Deb and Children's Shop-Dorothy Jonnes, 149 W. Main St., Circleville, O. 43113



82. 155 West Main St. ✓ Ford's Furn. Ned Harden, 146 Park Place,  
Circleville, O. 43113
83. 159 West Main St. ✓ Weaver Furn. Mrs. Ernest Weaver, R.D.#5  
Circleville, O. 43113
84. 167 West Main St. ✓ Knopf's Furn. Jim Ford, 512 S. Court St.,  
Circleville, O. 43113
85. 201 West Main St. ✓ Gorden Auto Parts & Glass-Ben Gorden, 112  
Northridge, Circleville, O. 43113

MAY 16 1978



Circleville Historic District,  
Pickaway Co., Ohio  
Map of original plat of the  
town, 1836 from Van Cleaf,  
History of Pickaway County

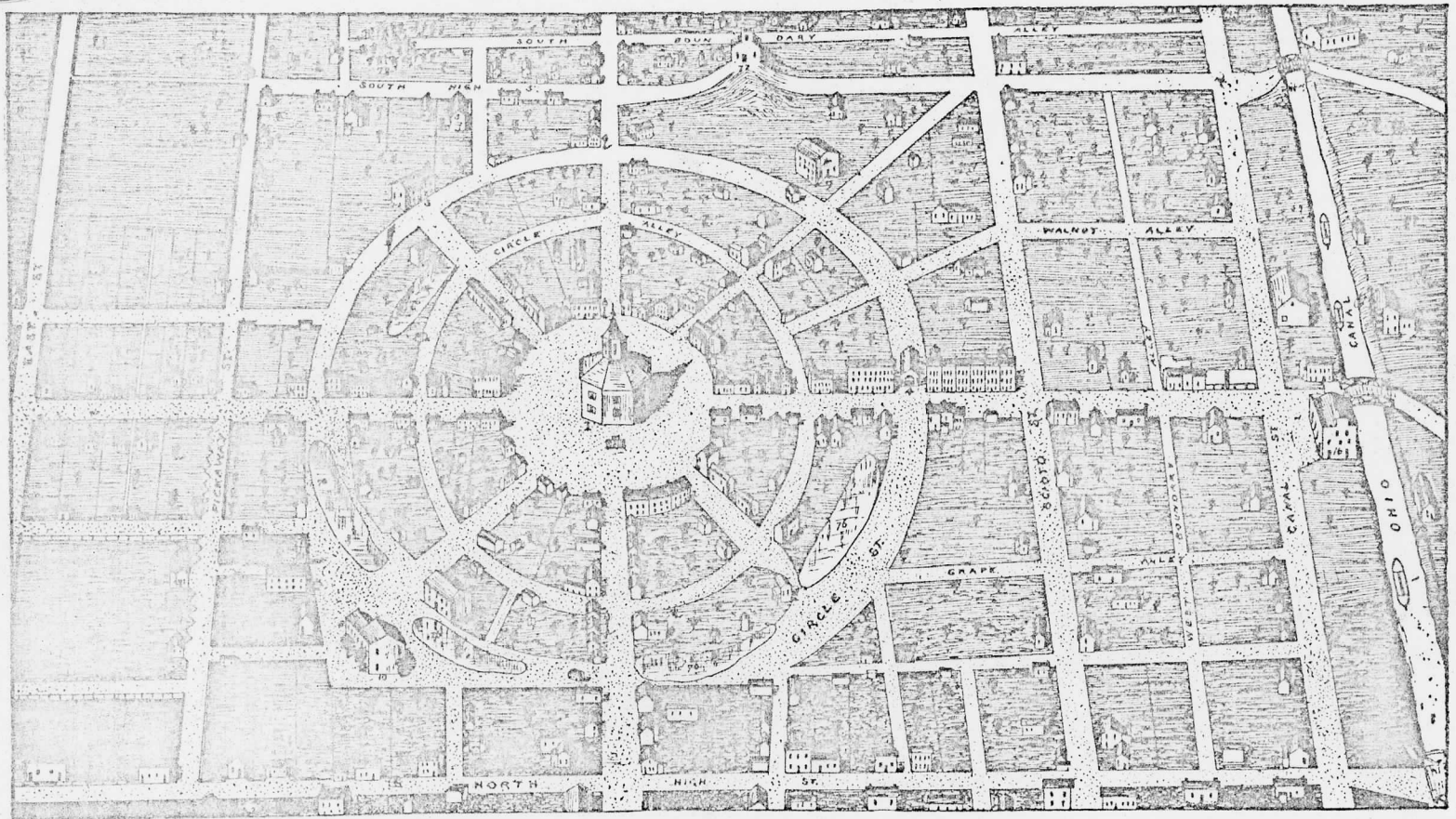

BIRD'S-EYE VIEW OF CIRCLEVILLE IN 1836, LOOKING SOUTH  
(DRAWN BY G. F. WITTICH)



Reps Making of Urban Cincinnati  
Princeton University Press, 1965

His plan was less satisfactory where the diagonals crossed the intersections of the gridiron streets. Instead of cutting back the sharply pointed lots at this point or providing smaller circles or squares as L'Enfant had done, Ralston retained the precise corners resulting from the geometrical pattern. Some of the city's present traffic problems stem from this failure to modify the scheme at these intersections. It might also have been more in keeping with the concept of Baroque planning to leave open at least a portion of the blocks surrounding the central circle. The governor's mansion, started in 1827, must have been invisible from the diagonal approaches as the lots surrounding the circle were built on. A more satisfactory solution from the visual standpoint has resulted in modern times with the erection of the Soldiers' and Sailors' Monument standing over 300 feet high on the site of the old governor's residence. Here at least is a visual exclamation point marking the center of the city and, very nearly, the center of the state itself.

Jeffersonville and Marietta were not the only early towns of the Ohio valley with distinctive plans. Perhaps the most unusual was that for the county seat of Pickaway County, Ohio. The county had been created by the legislature in 1810, and three commissioners were appointed to select a site for its administrative center. In their search they came across another of the mound-building Indians' strange creations—a circle tangent to a square. They chose this unique site, and Daniel Driesbach, who was directed to prepare the plan for the town, imaginatively conceived of a design that would utilize the circular mounds as the right-of-way for the principal street (Fig. 99). He



MAR 15 1978

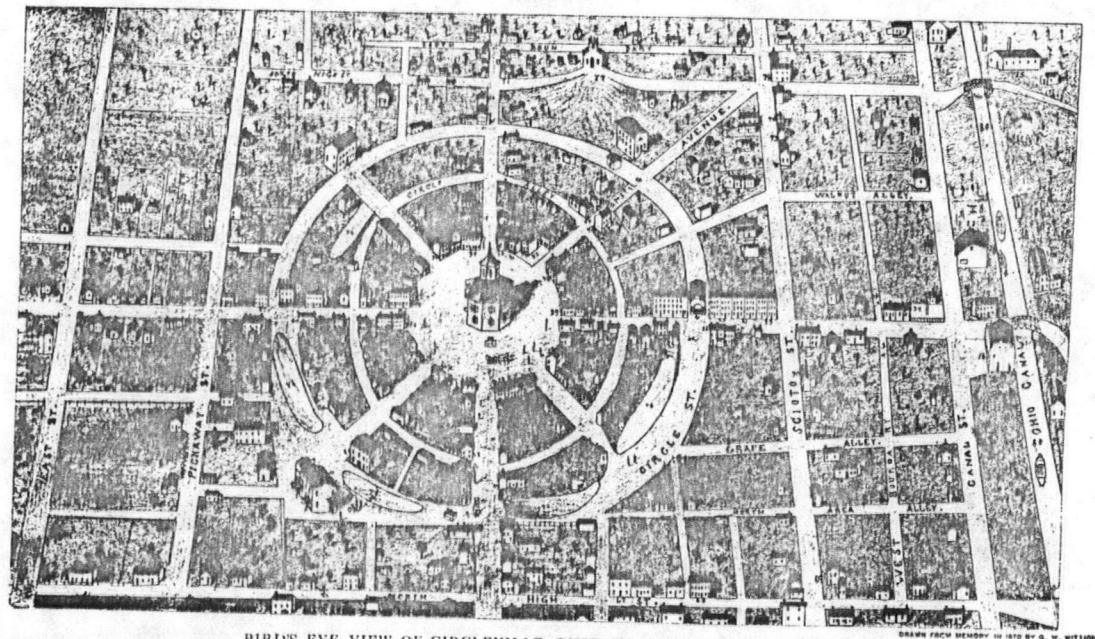

BIRD'S EYE VIEW OF CIRCLEVILLE, OHIO, IN 1836, LOOKING SOUTH.

Court House.  
County Offices.  
County Jail and Sheriff's Dwelling.  
Market House.  
Presbyterian Church.  
Episcopal Church.  
Lutheran Church.  
Methodist Church.  
Private School.  
Honey House.  
Masonic Tavern.  
Red Lion Tavern, by Jacob Try.  
Café Hotel, by Cradelaugh.

15. National House.  
16. Rogers & Martin's Warehouse.  
17. Wilkes & Ward's Lumber Yard.  
18. Finley's Warehouse.  
19. J. & H. Sauer's Provision Store.  
20. Block built by James Bell.  
21. Block built by M. M. Gage.  
22. Block built by N. S. Gage.  
23. Block built by Sam. Rogers.  
24. Block built by Francis Kimmer.  
25. Bank of C. H. Lawrence, Chs.  
26. Walley & Duncan's Grocery.  
27. M. Bough's Tin Shop.  
28. Howard's Hat Store.

29. Westenhaver's Grocery and Bakery.  
30. Samuel Rogers' Store.  
31. C. H. Cronin's Store.  
32. Jacob Lutz's Store.  
33. Francis Kimmer's Store.  
34. Mrs. Jackson's Residence.  
35. M. M. Green's Residence.  
36. Fowler's Tavern.  
37. Dr. E. B. Old's Drug Store.  
38. Huston's Residence.  
39. Hoffendörfer's Grocery.  
40. Huston's Store.  
41. H. Sage's Jewelry Store.  
42. Jenkin's Grocery.

43. Israel Dars's Residence.  
44. H. Sage's Residence.  
45. Dr. Luckey's Office.  
46. Dr. Luckey's Residence.  
47. Geo. C. Gephart's Residence.  
48. Wm. McLean Cabinet Shop.  
49. Geo. W. Dwyer's Res. and Office.  
50. W. B. Thrall's Residence.  
51. Michael May's Residence.  
52. W. McCallister's Residence.  
53. S. Hoffendörfer's Residence.  
54. S. Marfield's Residence.  
55. Dr. E. B. Old's Residence.  
56. Geo. Green's Residence.

57. Wm. P. Dars's Residence.  
58. Thos. Padrick's Residence.  
59. Joseph Old's Residence.  
60. James Bell's Residence.  
61. James Bell's Tannery.  
62. J. C. Johnson's Residence.  
63. Hy. Foreman's Residence.  
64. Religious Telescope Office.  
65. Circleville Herald Office.  
66. F. G. Whitlick's Book Bindery.  
67. M. Myer's Chairshop and Res.  
68. Wilkes' Brewery.  
69. F. Williamson's Residence.  
70. Hays' Residence.

71. H. Lawrence's Residence.  
72. Tamm Cronin's Residence.  
73. H. Robinson's Residence.  
74. Thos. Wilkes' Residence.  
75. T. Dars's Foundry.  
76. Parts of Circular Ditch.  
77. Moses Gibson.  
78. Lutheran Cemetery.  
79. M. Arthur's Block, in progress.  
80. Ohio Canal.

laid out eight other streets radiating outward from a central open space set aside for the courthouse. The name of the town was almost inevitable, and Circleville it became. In fact, the circular portion of the town was actually a double octagon, thus permitting all properties to be bounded by straight, rather than curved lines.

But, like that of Jeffersonville, the plan of Circleville had but a brief life. Some of the more enterprising residents concluded that its design wasted otherwise valuable urban land between the circle and the enclosing square. There were complaints, too, that the open area about the courthouse had become a foraging spot for local swine. These persons approached the state legislature with a request to permit the replanning of the town, and in 1837 an act was passed authorizing the replatting of the circular portions of the town with the consent of the property owners concerned. The legislature also created what was doubtless America's first private redevelopment corporation to carry out this task. The name chosen for this concern indicates that its founders did not lack an appreciation for the humorous aspects of their proposed project, for they were chartered as "a body corporate and politic . . . by the name and style of the 'Circleville Squaring Company.'"

The old order had its adherents, and the company secured the necessary consents from owners of land in only two quadrants of the city. For eleven years company activities hung suspended while the town remained half square and half circular. Not until 1849 did landowners in the northeast quarter of the town capitulate. Then once again several years were to pass while negotiations took place with

Figure 99. View of Circleville, Ohio: 1836



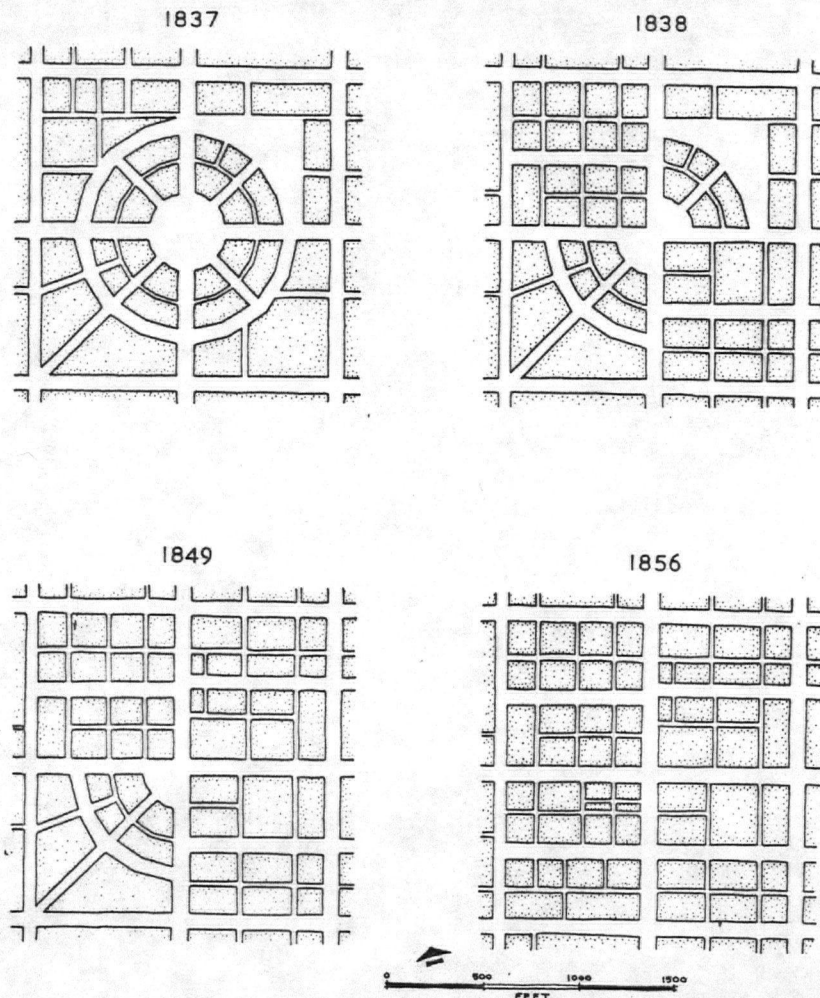

Fig. 100. Redevelopment of Circleville,  
Ohio: 1837-1856

the remaining supporters of the original plan. Finally, in March 1856, the new plan was accepted. The squaring of Circleville had been achieved (Fig. 100).

Thus, gradually, the Ohio Valley was settled by pioneers for whom town life was an important aspect of a developing culture. The difficulties were many and the hardships great. Not all of the towns laid out by these settlers were particularly attractive, but many, like Marietta, have much of the charm of the still unspoiled New England communities of an earlier era. Some attempts at real urban elegance failed completely, as at Hygeia. Other unusual plans of both interest and merit were replaced by conventional designs, as in Jeffersonville and Circleville. There still remains impressive evidence that these early colonizers of a great internal land empire were not unaware of the values of urban beauty and the amenities of town life. These features of town planning were submerged in the later 19th century under the tide of speculation. Land came to be regarded as a commodity for personal enrichment rather than a resource to be managed wisely by the citizens and their governmental institutions. What remains of the original townscape deserves the utmost efforts by present residents to protect and preserve this unique heritage of the pioneers who first pushed beyond the eastern mountains and established the early frontier towns in the pleasant rolling lands of the Ohio Valley.

MAR 15 1978



Property Circleville Historic District

State Ohio

Working Number 3,15,78,2671

78002171  
Pickaway

## TECHNICAL

Photos 18  
Maps 2#12 needs level, date  
alwaysD. Simmons CONTROL  
OK 5.4.78  
3.15.78

HISTORIAN

OF 85 BUILDINGS IN THE DISTRICT, ONLY A DOZEN  
ARE EITHER PHOTOGRAPHED OR DESCRIBED. ~~WHAT COMPARISON~~  
~~THE REST OF THE DISTRICT? HOW DO THE BUILDINGS CONTRIBUTE TO~~  
~~THE CHARACTER OF THE DISTRICT? WHY ARE THE INTERVIEWS LABELED AS SUCH?~~  
A BOUNDARY JUSTIFICATION IS NEEDED.

ARCHITECTURAL HISTORIAN

~~CALL~~ ~~JUST~~  
ACCEPT.  
H. Bink 3/24/78

NOTHING OF THE ORIGINAL CIRCULAR PLAN REMAINS. FROM PHOTOGRAPHS,  
THE DISTRICT SEEMS TO BE A WELL-PRESERVED 19TH C. COMMERCIAL  
CENTER W/ MINOR MODIFICATIONS AT GROUND STORY LEVEL.

ARCHEOLOGIST

CONTINUATION SHEET RECEIVED 4/4/78.

ACCEPT.  
H. Bink 4/4/78

More photos - of remaining buildings would  
also be helpful. Agree with 1st reviewer.  
Call for clarification.

- Continuation sheet still a little weak but -

OTHER  
accept  
Bravman  
3.28.78  
4.10.78

HAER

Inventory \_\_\_\_\_

Review \_\_\_\_\_

as above comments indicate, this is not  
an outstanding nomination in terms of information presented. Accept  
and I would have preferred minor changes in boundaries. However, photos  
convey significance of district. Strong architectural  
Statement of mid-late 19th C area

REVIEW UNIT CHIEF

BRANCH CHIEF

Thurman  
5.3.78

KEEPER

D. Bink  
5/16/78

National Register Write-up

Send-back \_\_\_\_\_

Entered MAY 16 1978

Federal Register Entry

6.6.78

Re-submit \_\_\_\_\_

INT:2106-74



May 31, 2011

Ms. Carol D. Shull, Keeper of the  
National Register  
National Park Service  
National Register of Historic Places  
1201 Eye Street, NW (2280)  
Washington DC 20005

Dear Ms. Shull:

Following, please find information regarding properties included within the boundary of the Circleville Historic District, Pickaway County, Ohio, listed on May 16, 1978 (Reference number 78002171). The following properties have been demolished or have lost integrity through alteration.

167 West Main Street (demolished 2010)  
158, 160, 162, West Main Street (demolished 1990s)  
164 & 166 West Main Street (significantly altered/loss of integrity 1970s)

Sincerely,

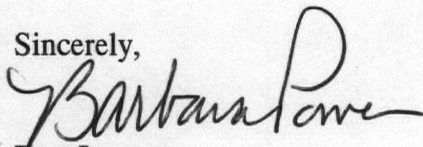
*for*   
Burt Logan

Executive Director and CEO  
State Historic Preservation Officer

OHIO HISTORICAL SOCIETY

Ohio Historic Preservation Office

1982 Velma Avenue, Columbus, Ohio 43211-2497 ph: 614.298.2000 fx: 614.298.2037

[www.ohiohistory.org](http://www.ohiohistory.org)

UNITED STATES DEPARTMENT OF THE INTERIOR  
NATIONAL PARK SERVICE

NATIONAL REGISTER OF HISTORIC PLACES  
EVALUATION/RETURN SHEET

REQUESTED ACTION: ADDITIONAL DOCUMENTATION

PROPERTY NAME: Circleville Historic District

MULTIPLE  
NAME:

STATE & COUNTY: OHIO, Pickaway

DATE RECEIVED: 6/17/11

DATE OF PENDING LIST:

DATE OF 16TH DAY:

DATE OF 45TH DAY:

8/02/11

DATE OF WEEKLY LIST:

REFERENCE NUMBER: 78002171

NOMINATOR: STATE

REASONS FOR REVIEW:

APPEAL: N DATA PROBLEM: N LANDSCAPE: N LESS THAN 50 YEARS: N  
OTHER: N PDIL: N PERIOD: N PROGRAM UNAPPROVED: N  
REQUEST: N SAMPLE: N SLR DRAFT: N NATIONAL: N

COMMENT WAIVER: N

☒ ACCEPT ☐ RETURN ☐ REJECT 7.28.11 DATE

ABSTRACT/SUMMARY COMMENTS:

Additional Documentation Approved

RECOM./CRITERIA Accept

REVIEWER Robert H. Beall

DISCIPLINE History

TELEPHONE \_\_\_\_\_

DATE 7-28-11

DOCUMENTATION see attached comments Y/N see attached SLR Y/N

If a nomination is returned to the nominating authority, the nomination is no longer under consideration by the NPS.





BANK.

ORE

ATION TIME  
SAVE TO  
e SAVINGS  
NOW

CHAMBER  
COMMERCE

Back to School

Circleville Historic District  
Pickaway Co., Ohio  
Photo: L. Koe-Krompecher  
Negative: Athens, Ohio

Peoples Bank (Marfield Bank)  
139 W. Main, north elevation

#1818 MAR 15 1978 MAY 16 1978

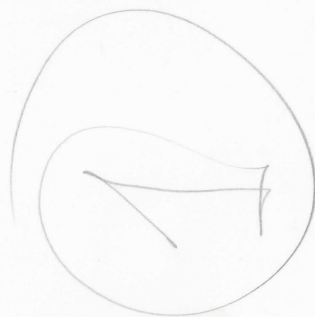

PROPERTY OF THE NATIONAL REGISTER





L.M. BUTCH Co.



Diamonds

T.K. BRUNNER & SON

QUALITY DIAMONDS  
JEWELLED WATCHES  
WATCH CRYSTALS FITTED

MENS SHOES

MENS SHOES

MENS SHOES



Circleville Historic District  
Pickaway Co., Ohio  
Photo: L. Koe-Krompecher  
Negative: Athens, Ohio

PROPERTY OF THE NATIONAL REGISTER

Olds Building, 115-119 W. Main  
north facade

MAY 16 1978

#2

MAR 15 1978

2



**NATION-WISE**  
**AUTO PARTS**  
DRIVERS DISCOUNT STORES

**SHERWIN-WILLIAMS**





Masonic Temple  
113-115 S. Court Street  
Circleville Historic District  
Circleville, Ohio (Pickaway County)  
Photographer: Miriam Barnhart  
November, 1976  
Negative: M. Barnhart, 200 Northridge  
Rd., Circleville, Ohio 43113  
View of facade. Looking west.

MAY 16 1978

MAR 15 1978

No. 3218

PROPERTY OF THE NATIONAL REGISTER





PROPERTY OF THE NATIONAL REGISTER

Circleville Historic District  
Pickaway Co., Ohio  
Photo: Larry Beers, 1975  
Negative: OHS

MAY 16 1978

Circleville City Building,  
south & East side.

#4/18

MAR 15 1978





PROPERTY OF THE NATIONAL REGISTER

Circleville Historic District,  
Pickaway Co., Ohio  
Photo: Larry Beers, 1975  
Negative: OHS  
Pickaway County Sheriff's Office

g Jail, east facade

MAY 16 1978

MAR 15 1978 AS 2/18





Circleville H.D., Pickaway Co.,  
Ohio  
Photo: Larry Beers, 1975  
Negative: OHS  
Pickaway County Courthouse,

east facade

MAY 16 1978

MAR 15 1978

#6 of 18

PROPERTY OF THE NATIONAL REGISTER







CIRCLEVILLE HISTORIC DISTRICT

DENNY-MAY HOUSE, 225 S. COURT ST., VIEW

Circleville Historic District  
Pickaway Co., Ohio  
Photo: L. Koe-Krompecher  
Negative: Athens Ohio

MAY 16 1978

Denny-May House, 225 S. Court,  
looking northwest.

MAR 15 1978

#7  
8/8

PROPERTY OF THE NATIONAL REGISTER







CIRCLEVILLE HISTORIC DISTRICT

Circleville Historic District  
Pickaway Co., Ohio  
Photo: L. Koe-Krompecher  
Negative: Athens Ohio

MAY 16 1978

CALEB ATWATER HOUSE, 126 E. MOUND ST., EAST AND SOUTH

Caleb Atwater House,  
126 E. Mound, E & S facades

MAR 15 1978

#8 g/18

PROPERTY OF THE NATIONAL REGISTER

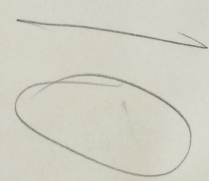







CIRCLEVILLE HISTORIC DISTRICT

THE MOORE HOUSE, 304 S. COURT ST., NORTH FACADE.

PROPERTY OF THE NATIONAL REGISTER

Circleville Historic District  
Pickaway Co., Ohio  
Photo: L.Koe-Krompecher  
Negative: Athens, Ohio

MAY 16 1978

The Moore House, 304 S. Court  
St., north facade

MAR 15 1978

#9918





CIRCLEVILLE HISTORIC DISTRICT

FICKARDT - BRUNNER HOUSE, 317 S. COURT ST  
TOWARD SOUTHWEST.

Circleville Historic District  
Pickaway Co., Ohio  
Photo: L. Koe-Krompecher  
Negative: Athens, Ohio

MAY 16 1978

Fickardt-Brunner House,  
317 S. Court St., looking  
SW

MAR 15 1978 #10218

PROPERTY OF THE NATIONAL REGISTER







Circleville Historic District  
Pickaway Co., Ohio  
Photo: L. Koe-Krompecher  
Negative: Athens Ohio

MAY 16 1978

Detail of Fickardt-Brunner  
House, 317 S. Court St.,  
looking SW.

# 11818

MAR 15 1978

5.

PROPERTY OF THE NATIONAL REGISTER





Circleville Historic District  
Pickaway Co., Ohio  
Photo: L. Beers  
Negative: OHS

MAY 16 1978

S. Court looking SW showing  
Denny-Renick-May House on  
left

MAR 15 1978 #12g/8

PROPERTY OF THE NATIONAL REGISTER

th Court  
Denny-Renick-May House on left  
seen by Laszlo Koe-Krompacher in 72 or 73





PROPERTY OF THE NATIONAL REGISTER

Circleville Historic District  
Pickaway Co., Ohio  
Photo: Larry Beers, 1975  
Negative: OHS

MAY 16 1978

Court Street, south, Masonic  
Building is at right center;  
Murphy's has since been  
sandblasted.

MAR 15 1978 130418





Court House Circleville O.

0498

Pickaway Co. Courthouse and Circleville  
City Hall circa 1910  
Circleville Historic District  
Circleville, Pickaway Co., Ohio  
Photographer unknown  
Negative: Ned Harden, Box 349  
Circleville, Ohio 43113  
View of facade of courthouse and facade  
and south side of city hall. Looking  
to the northwest

MAR 15 1978

No. 13218

MAY 16 1978

PROPERTY OF THE NATIONAL REGISTER





S. Court Street streetscape circa 1895  
Circleville Historic District  
Circleville, Pickaway County, Ohio  
Photographer unknown  
Negative: Ned Harden Box 349  
Circleville, Ohio 43113  
View of what is now G.C.Murphy Store,  
Masonic Temple and Courthouse.  
Looking southwesterly.

MAY 16 1978

MAR 15 1978

14 218  
No 400

PROPERTY OF THE NATIONAL REGISTER

PICKAWAY HISTORICAL PHOTOS  
Ned W. Harden, - Box 349 Circleville, O.

9/10



Masonic Temple, Circleville, O.



Masonic Temple circa 1895  
Circleville Historic District  
Circleville, Pickaway Co., Ohio  
Photographer unknown

Negative: Ned W. Harden, Box 349  
Circleville, Ohio 43113  
View of facade. Looking to the west.

MAR 15 1978

MAY 16 1978

15218

No.

PICKAWAY HISTORICAL PHOTOS  
Ned W. Harden, - Box 349 Circleville, O.

SLIDE

PROPERTY OF THE NATIONAL REGISTER

B-1





Charteed 1812

Present picture taken 1949.

Circleville Historic District  
Pickaway co, Ohio

Pythian Castle, photo from  
1949.

MAY 16 1978

MAR 15 1978

17 9/18

PROPERTY OF THE NATIONAL REGISTER

PROPERTY OF THE NATIONAL REGISTER

171



PYTHIAN CASTLE

THE SAVINGS BANK



Remodeling comp  
August 1973

Circleville Historic District  
Pickaway Co., Ohio  
Photo: L. Beers

MAY 16 1978

Pythian Castle, 114 N. Court  
Remodeled, 1973

MAR 15 1978

Bay 18



UNITED STATES  
DEPARTMENT OF THE INTERIOR  
GEOLOGICAL SURVEY

STATE OF OHIO  
DEPARTMENT OF HIGHWAYS  
DEPARTMENT OF NATURAL RESOURCES  
DIVISION OF GEOLOGICAL SURVEY

CIRCLEVILLE QUADRANGLE  
OHIO  
7.5 MINUTE SERIES (TOPOGRAPHIC)

Circleville Historic District  
Circleville, Pickaway Co.,  
Ohio  
A. Zone  
17 E. 333125  
N. 4385245  
B. 17 E. 332905  
N. 4384740  
C. 17 E. 332595  
N. 4384870  
D. 17 E. 332805  
N. 4385380

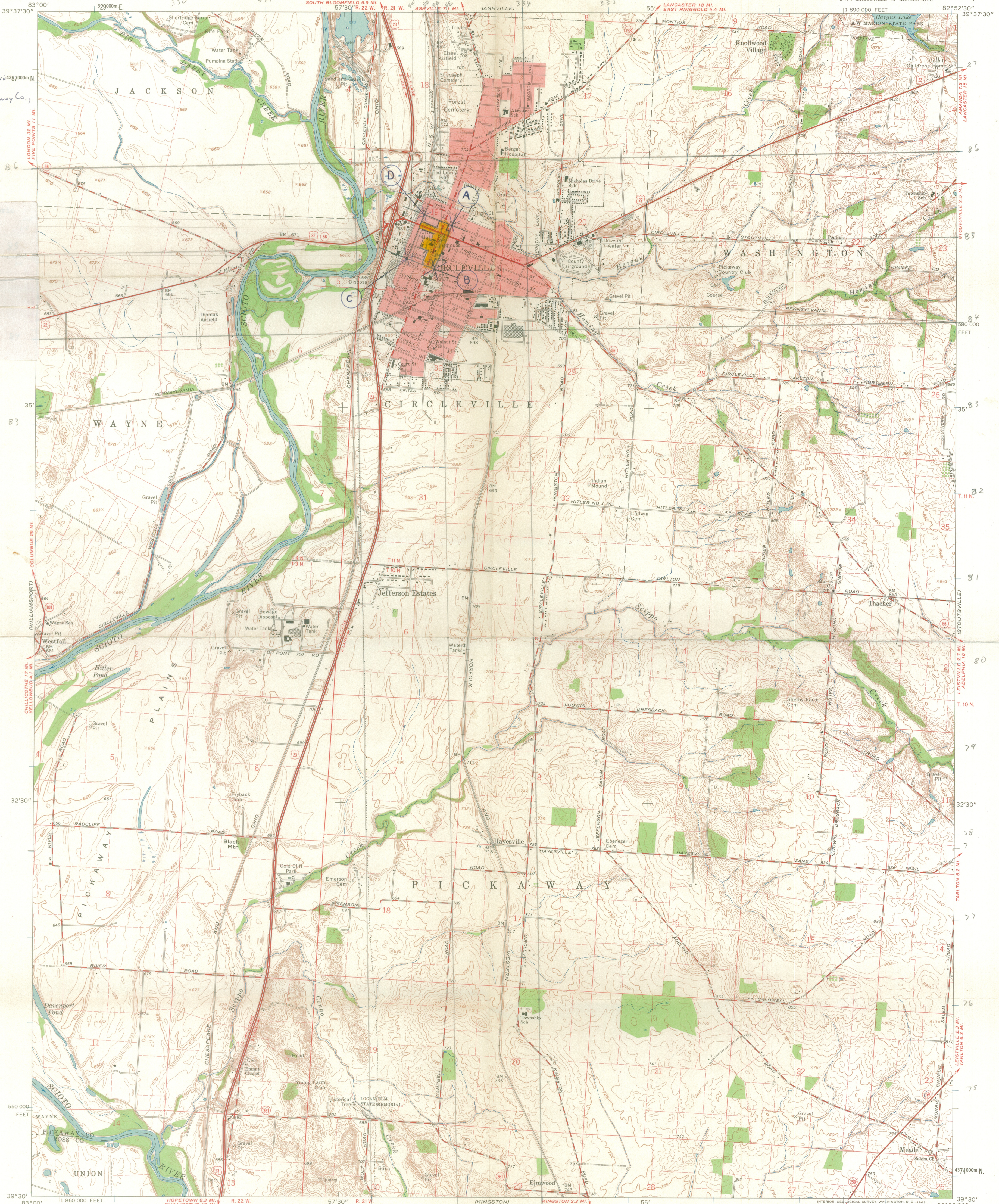

Maped, edited, and published by the Geological Survey  
Control by USGS and USC&GS

Topography by photogrammetric methods from aerial  
photographs taken 1960. Field checked 1961

Polyconic projection. 1927 North American datum  
10,000-foot grid based on Ohio coordinate system, south zone  
1000-meter Universal Transverse Mercator grid ticks,  
zone 17, shown in blue

Fine red dashed lines indicate selected fence and field lines where  
generally visible on aerial photographs. This information is unchecked

Red tint indicates area in which only landmark buildings are shown

Area west of the Scioto River lies within the Virginia Military District

Area within R. 22 W. based on the Scioto River Base

Area within R. 21 W. based on the Ohio River Base

TRUE NORTH  
MAGNETIC NORTH  
APPROXIMATE MEAN  
DECLINATION, 1961

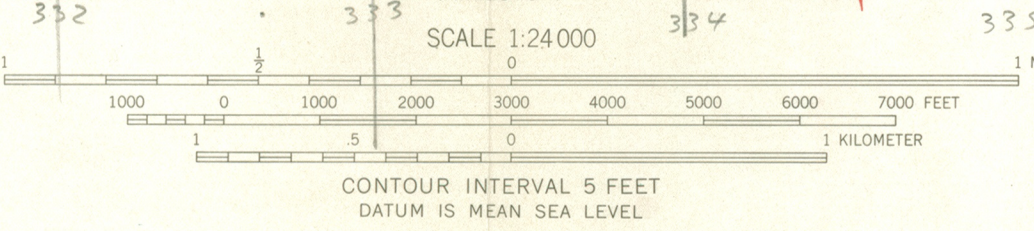

ROAD CLASSIFICATION  
Heavy-duty ——— Light-duty ———  
Medium-duty ——— Unimproved dirt ———  
U.S. Route ——— State Route ———



CIRCLEVILLE, OHIO  
SW 1/4 CIRCLEVILLE 15' QUADRANGLE  
N 3930 - W 8252.5/7.5

1961

MAY 16 1978

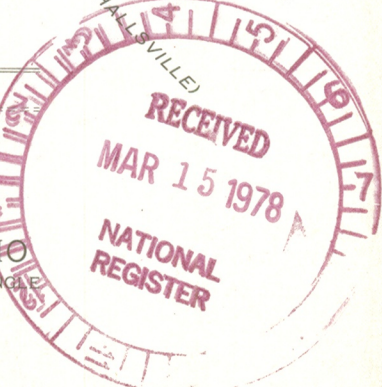





# United States Department of the Interior

NATIONAL PARK SERVICE  
WASHINGTON, D.C. 20240

IN REPLY REFER TO:  
H34-880

MAR 23 1978

Dear Property Owner:

As you have probably already been informed by State or local representatives, the property you own is included in a district that has been nominated by the State for listing in the National Register which is that list of evidences of the past deemed worthy of keeping for the future by the Secretary of the Interior. This nomination is pending in our office.

Since you may not have been aware of potential benefits and provisions of the Tax Reform Act of 1976 when the district including your property was originally considered by the State for nomination, we are sending informative material at this time. If you wish to make comments about your property or the district relative to the National Register "Criteria for Evaluation" (see enclosed green leaflet), we will be pleased to consider them as an adjunct to our evaluation of placing your property in the National Register. Comments should be made within 30 days of the date of this letter and should be addressed to Dr. William J. Murtagh, Keeper of the National Register, National Park Service, Department of the Interior, Washington, D.C. 20240.

Information concerning standards for rehabilitation may be obtained from Technical Preservation Services, Office of Archeology and Historic Preservation, National Park Service, Department of the Interior, Washington, D.C. 20240.

Questions concerning the National Register program or the implementation of the historic preservation provisions of the Tax Reform Act should also be addressed to the Keeper of the National Register. Inquiries must include the name of the district (see address label) and property address to be properly handled.

Sincerely yours,

William J. Murtagh  
Keeper of the National Register

Enclosures

Columbus Headquarters  
109 N. Front Street  
Circleville, Ohio 43113

Re: Circleville Historic District  
124 N. Court St.





# United States Department of the Interior

NATIONAL PARK SERVICE  
WASHINGTON, D.C. 20240

IN REPLY REFER TO:  
H34-880

MAR 23 1978

Dear Property Owner:

As you have probably already been informed by State or local representatives, the property you own is included in a district that has been nominated by the State for listing in the National Register which is that list of evidences of the past deemed worthy of keeping for the future by the Secretary of the Interior. This nomination is pending in our office.

Since you may not have been aware of potential benefits and provisions of the Tax Reform Act of 1976 when the district including your property was originally considered by the State for nomination, we are sending informative material at this time. If you wish to make comments about your property or the district relative to the National Register "Criteria for Evaluation" (see enclosed green leaflet), we will be pleased to consider them as an adjunct to our evaluation of placing your property in the National Register. Comments should be made within 30 days of the date of this letter and should be addressed to Dr. William J. Murtagh, Keeper of the National Register, National Park Service, Department of the Interior, Washington, D.C. 20240.

Information concerning standards for rehabilitation may be obtained from Technical Preservation Services, Office of Archeology and Historic Preservation, National Park Service, Department of the Interior, Washington, D.C. 20240.

Questions concerning the National Register program or the implementation of the historic preservation provisions of the Tax Reform Act should also be addressed to the Keeper of the National Register. Inquiries must include the name of the district (see address label) and property address to be properly handled.

Sincerely yours,

William J. Murtagh  
Keeper of the National Register

Enclosures

Dr. John Lincoln

Circleville, Ohio 43113

Re: Circleville Historic District



3/28/78

TELEPHONE REPORT

9:10

1. CALL ☒ TO: ☐ FROM (Name)

GRETCHEN KLIMOSKI

2. ADDRESS (Tel. No. if needed)

OHIO SHPO'S OFFICE  
(614) 466-8727

3. SUBJECT, PROJECT NO., ETC.

CIRCLEVILLE HISTORIC DISTRICT

4. DETAILS OF DISCUSSION

I REQUESTED THAT GRETCHEN SEND A CONTINUATION  
SHEET WITH THE FOLLOWING INFORMATION:

- = BOUNDARY JUSTIFICATION
- = WHAT COMPRISES BLANK SPACES ON MAP;  
DO THESE BLENDS CONTRIBUTE?

GRETCHEN WILL REPLY BY MAIL A.S.A.P.

CONTINUATION SHEET RECEIVED 4/4/78.

H. Smith

NAME OF PERSON PLACING/RECEIVING CALL

TITLE

OFFICE

H. Smith

ARCH. HISTORIAN

N.R.





FRANK E. BARNHILL  
MAYOR

614-474 ~~8484~~ 2965  
8484

## City of Circleville

DEPARTMENT OF PUBLIC SERVICE  
CITY HALL, CIRCLEVILLE, OHIO 43113

ATWOOD P. JONES  
DIRECTOR OF PUBLIC SERVICE

March 31, 1978

Mr. William J. Murtaugh  
Keeper of the National Register  
U. S. Department of the Interior  
National Park Service  
Washington, D. C. 20240

Dear Mr. Murtaugh:

This letter is in response to your letter of March 23, 1978 concerning your reference H-34-880, the Circleville Historic District.

The Water & Sewer Department building located at 114 West Franklin Street in Circleville, Ohio was originally constructed in 1952 and an addition was built on in 1976. Since this building is relatively new and has no architectural or historical features I cannot understand why this building should be put on the National Register. I am sure that within the proposed district there are many buildings that will meet the criteria that has been established for historic buildings to be placed on the National Register. I believe that placing fairly new buildings on the Register by means of an historic district severely limits the possible future use of federal aid in any activity associated with reconstructing or renewing the building.

Based upon the above information, I believe that the relatively new building within the proposed district should be deleted from the proposal and that buildings of significant architectural and historical value should be placed on the National Register on their individual merit.

If you have any questions on this matter, please do not hesitate to contact me.

Very truly yours,

*Atwood P. Jones*

Atwood P. Jones  
Director of Public Service

APJ:S



8-30-12

614-754-2962

8-1-8

City of Louisville



DEPARTMENT OF PUBLIC SAFETY  
CHIEF OF POLICE

ATWOOD

FRANK E. BROWN

TRIP

MALE

TO: [illegible]  
FROM: [illegible]  
SUBJECT: [illegible]

FOR: [illegible]  
RE: [illegible]

[illegible text block]

[illegible text block]

[illegible text block]

|                                          |             |
|------------------------------------------|-------------|
| THE NATIONAL REGISTER OF HISTORIC PLACES |             |
| DATE REC'D                               | APR 07 1978 |
| INDIVIDUAL RESPONSE (ATTACHED)           |             |
| INTERVIEW ( )                            |             |
| REVIEW ( )                               |             |
| DATE ACTION TAKEN                        | 4/11        |
| INITIALS                                 | S.S. called |

TELEPHONE REPORT

DATE

4/11

TIME OF CALL

AM  
PM

1. CALL ☒ TO; ☐ FROM (Name)

Atwood Jones

2. ADDRESS (Tel. No. if needed)

614-474-2965

3. SUBJECT, PROJECT NO., ETC.

Wileville H.D.

4. DETAILS OF DISCUSSION

Mr. Jones' main concern was to register opposition. I assured him that letter would be included in file, and sent follow-up slip acknowledging same per his request. Also explained Advisory Council role, EO 11593, effect of listing on non-contributing structures.

NAME OF PERSON PLACING/RECEIVING CALL

TITLE

OFFICE

Sheffield

880



|                                                                                      |       |                                    |                         |
|--------------------------------------------------------------------------------------|-------|------------------------------------|-------------------------|
| DATE: 5/22/78                                                                        |       | NUMBER: <b>POR- 4747</b>           |                         |
| FROM: HARSNA, William H.<br>M.C. 5/9/78                                              |       | REMARKS:<br><br>Reply For Dir Sig. |                         |
| DESIGNATION:<br><br>HCRS                                                             |       |                                    |                         |
| RFRD: OAHF                                                                           | RFRD: | RFRD:                              | RFRD:                   |
| DATE: 5/22                                                                           | DATE: | DATE:                              | DATE:                   |
| SUBJECT: RE: Appliaction to place an area of<br>downtown Circleville, Ohio on the NR |       |                                    | ACK'D:                  |
| ( 5/22<br>505                                                                        |       |                                    | DATE REPLY DUE:<br>5/30 |
|                                                                                      |       |                                    | SIGNED:                 |
| BOR 8 - 12a<br>DEC. 1971                                                             |       | BUREAU OF OUTDOOR RECREATION       |                         |

WILLIAM H. HARSHA  
6TH DISTRICT, OHIO

COMMITTEE:  
RANKING MINORITY MEMBER  
PUBLIC WORKS

*Congress of the United States*

HOUSE OF REPRESENTATIVES  
WASHINGTON, D.C. 20515

May 9, 1978

OAHF  
WASHINGTON OFFICE:  
2457 RAYBURN HOUSE OFFICE BUILDING  
WASHINGTON, D.C. 20515

DISTRICT OFFICES:  
285 MAIN STREET  
BATAVIA, OHIO 45103  
POST OFFICE BUILDING  
HILLSBORO, OHIO 45133

Mr. Ira Whitlock, Chief  
Congressional Liaison Division  
National Park Service  
Interior Building  
Washington, D.C. 20240

Dear Mr. Whitlock:

It has recently been brought to my attention by Ms. Pauline Clifton, 307 South Court Street, Circleville, Ohio 43113, a member of the Task Force for the Historic Survey of Ohio, that the application to place an area of downtown Circleville, Ohio on the National Register of Historic Places has been in the Washington office since mid-February.

I would greatly appreciate any effort on your part to see that a decision is reached in the near future. I am, of course, hoping for a favorable designation.

If I may be of any service to you in reaching a decision in this matter, please do not hesitate to call upon me.

Thanking you for your time and assistance, I am

Sincerely yours,

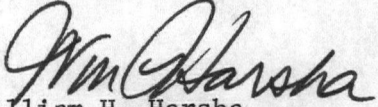
  
William H. Harsha  
Representative to Congress

WHH:bf

BOR Mail Control No. PO R 4747



ENTRIES IN THE NATIONAL REGISTER

STATE OHIO

Date Entered MAY 16 1978

Name

Location

Circleville Historic District

Circleville  
Pickaway County

Also Notified

Hon. John H. Glenn, Jr.

Hon. Howard M. Metzenbaum

Hon. William H. Harsha

State Historic Preservation Officer

Dr. Thomas H. Smith

Director, The Ohio Historical Society

Interstate 71 at 17th Avenue

Columbus, Ohio 43211

NR

Mott

5/17/78

Pickaway Co.  
Ohio

H32-NR

MAY 24 1978

Honorable William H. Harsha  
House of Representatives  
Washington, D.C. 20515

Dear Mr. Harsha:

Thank you for your inquiry on behalf of Ms. Pauline Clifton concerning the nomination of the Circleville Historic District, Circleville, Ohio, to the National Register of Historic Places.

We are pleased to inform you that the Circleville Historic District was entered in the National Register on May 16, 1978. Enclosed is a leaflet which describes the National Register program.

We appreciate your interest in historic preservation.

Sincerely,

/Sgd/ William J. Murtagh

[[for]] Chris Therral Delaporte  
Director

Enclosure

cc: Dr. Thomas H. Smith  
Director, The Ohio Historical Society  
Interstate 71 at 17th Avenue  
Columbus, Ohio 43211

bcc: Director's Reading File  
Assoc. Dir., Connally, Chief, OAHP  
FHR-Lumpkin, FHR-CL, CL  
NR

POR-4747

FHR:B Handy:cs:5-24-78 523-0431

BASIC FILE RETAINED IN NR

Handy  
5-24-78  
Lebowich  
for Cole/  
Hemington  
5/29/78  
hatty  
to Rogers &  
Cole



# NATIONAL REGISTER DATA SHEET

|                                                                                                                                                                                                                                        |  |                                                                                                                                                       |  |                                                                                                                                                        |  |                                                                                                                                                                                                     |  |                                                                                                                                                                                      |  |
|----------------------------------------------------------------------------------------------------------------------------------------------------------------------------------------------------------------------------------------|--|-------------------------------------------------------------------------------------------------------------------------------------------------------|--|--------------------------------------------------------------------------------------------------------------------------------------------------------|--|-----------------------------------------------------------------------------------------------------------------------------------------------------------------------------------------------------|--|--------------------------------------------------------------------------------------------------------------------------------------------------------------------------------------|--|
| ① NAME as it appears on federal register:<br>Circleville Historic District                                                                                                                                                             |  |                                                                                                                                                       |  | ② OTHER NAMES:                                                                                                                                         |  | ③ date of entry:<br>MAY 16 1978                                                                                                                                                                     |  | ④ county code:<br>129                                                                                                                                                                |  |
| ⑤ LOCATION street & number<br>Main and Court Sts.                                                                                                                                                                                      |  | city / town<br>Circleville                                                                                                                            |  | vicinity of                                                                                                                                            |  | state<br>OH                                                                                                                                                                                         |  | county<br>Pickaway                                                                                                                                                                   |  |
| ⑦ OWNER <input type="checkbox"/> PRIVATE <input type="checkbox"/> STATE <input type="checkbox"/> MUNICIPAL <input type="checkbox"/> COUNTY <input checked="" type="checkbox"/> MULTIPLE <input type="checkbox"/> FEDERAL (agency name) |  |                                                                                                                                                       |  |                                                                                                                                                        |  | ⑧ ADMINISTRATOR:                                                                                                                                                                                    |  |                                                                                                                                                                                      |  |
| ⑨ EXISTING SURVEYS <input type="checkbox"/> HABS <input type="checkbox"/> HAER <input type="checkbox"/> NHL                                                                                                                            |  | ⑩ FUNDED? <input type="checkbox"/> YES <input type="checkbox"/> NO                                                                                    |  | ⑪ CONGRESS. DISTRICT 6th                                                                                                                               |  | ⑫ SOURCE of NOMINATION <input checked="" type="checkbox"/> STATE <input type="checkbox"/> FEDERAL                                                                                                   |  | ⑬ NPS REGION:<br>MW                                                                                                                                                                  |  |
| ⑭ WITHIN NATIONAL REGISTER HISTORIC DISTRICT?<br><input type="checkbox"/> YES, NAME <input type="checkbox"/> NO                                                                                                                        |  | ⑮ WITHIN NATIONAL HISTORIC LANDMARK?<br><input type="checkbox"/> YES, NAME <input type="checkbox"/> NO                                                |  | ⑯ ACREAGE                                                                                                                                              |  | if state who prepared form?<br>SCOPS and SHPO staff<br><input type="checkbox"/> LOCAL <input type="checkbox"/> PRIVATE ORGANIZATION                                                                 |  |                                                                                                                                                                                      |  |
| ⑯ CONDITION<br><input type="checkbox"/> excellent<br><input type="checkbox"/> good<br><input type="checkbox"/> fair                                                                                                                    |  | <input type="checkbox"/> deteriorated<br><input type="checkbox"/> ruins<br><input type="checkbox"/> unexposed<br><input type="checkbox"/> unexcavated |  | <input type="checkbox"/> altered<br><input type="checkbox"/> unaltered<br><input type="checkbox"/> reconstructed<br><input type="checkbox"/> excavated |  | ⑰ features:<br>INTERIOR <input type="checkbox"/> SUBSTANTIALLY INTACT-1<br><input type="checkbox"/> NOT INTACT-0<br><input type="checkbox"/> UNKNOWN-4<br><input type="checkbox"/> NOT APPLICABLE-7 |  | EXTERIOR <input type="checkbox"/> SUBSTANTIALLY INTACT-2<br><input type="checkbox"/> NOT INTACT-0<br><input type="checkbox"/> UNKNOWN-5<br><input type="checkbox"/> NOT APPLICABLE-8 |  |
| ⑱ ACCESS <input type="checkbox"/> YES-Restricted <input type="checkbox"/> YES-Unrestricted <input type="checkbox"/> No Access <input type="checkbox"/> Unknown                                                                         |  | ⑲ ADAPTIVE USE <input type="checkbox"/> YES <input type="checkbox"/> NO                                                                               |  | ⑳ SAVED? <input type="checkbox"/> YES                                                                                                                  |  | ㉑ IS PROPERTY A HISTORIC DISTRICT? <input type="checkbox"/> yes <input type="checkbox"/> no                                                                                                         |  |                                                                                                                                                                                      |  |
| ㉒ AREAS OF SIGNIFICANCE :                                                                                                                                                                                                              |  | <input type="checkbox"/> ENGINEERING-11                                                                                                               |  | <input type="checkbox"/> LANDSCAPE ARCH.-15                                                                                                            |  | <input type="checkbox"/> POLITICS / GOVT.-21                                                                                                                                                        |  | <input type="checkbox"/> RECREATION-28                                                                                                                                               |  |
| <input type="checkbox"/> ARCHEOLOGY-prehistoric-2                                                                                                                                                                                      |  | <input type="checkbox"/> COMMERCE-6                                                                                                                   |  | <input type="checkbox"/> ENTERTAINMENT-26                                                                                                              |  | <input type="checkbox"/> LAW-16                                                                                                                                                                     |  | <input type="checkbox"/> RELIGION-22                                                                                                                                                 |  |
| <input type="checkbox"/> ARCHEOLOGY-historic-1                                                                                                                                                                                         |  | <input type="checkbox"/> COMMUNICATIONS-7                                                                                                             |  | <input type="checkbox"/> EXPLORATION-12                                                                                                                |  | <input type="checkbox"/> LITERATURE-17                                                                                                                                                              |  | <input type="checkbox"/> SCIENCE-23                                                                                                                                                  |  |
| <input type="checkbox"/> AGRICULTURE-3                                                                                                                                                                                                 |  | <input type="checkbox"/> CONSERVATION-8                                                                                                               |  | <input type="checkbox"/> HEALTH-27                                                                                                                     |  | <input type="checkbox"/> MILITARY-18                                                                                                                                                                |  | <input type="checkbox"/> SOCIAL / HUMANITARIAN-24                                                                                                                                    |  |
| <input type="checkbox"/> ARCHITECTURE-4                                                                                                                                                                                                |  | <input type="checkbox"/> ECONOMICS-9                                                                                                                  |  | <input type="checkbox"/> INDUSTRY-13                                                                                                                   |  | <input type="checkbox"/> MUSIC-19                                                                                                                                                                   |  | <input type="checkbox"/> SOCIAL / CULTURAL-30                                                                                                                                        |  |
| <input type="checkbox"/> ART-5                                                                                                                                                                                                         |  | <input type="checkbox"/> EDUCATION-10                                                                                                                 |  | <input type="checkbox"/> INVENTION-14                                                                                                                  |  | <input type="checkbox"/> PHILOSOPHY-20                                                                                                                                                              |  | <input type="checkbox"/> TRANSPORTATION-25                                                                                                                                           |  |
| ㉓ functions<br>WHEN HISTORICALLY SIGNIFICANT:<br>CURRENTLY:                                                                                                                                                                            |  | ㉔ dates of initial construction:<br>major alterations:<br>historic events:                                                                            |  | ㉕ ETHNIC GROUP<br>ASSOCIATION                                                                                                                          |  | ㉖ CLAIMS: explain<br>'first' <input type="checkbox"/><br>'oldest' <input type="checkbox"/><br>'only' <input type="checkbox"/>                                                                       |  |                                                                                                                                                                                      |  |
| ㉗ architectural style(s):                                                                                                                                                                                                              |  | ㉘ architect:                                                                                                                                          |  | ㉙ master builder:                                                                                                                                      |  | ㉚ engineer:                                                                                                                                                                                         |  |                                                                                                                                                                                      |  |
| ㉛ landscape architect / garden designer:                                                                                                                                                                                               |  | ㉜ interior decorator:                                                                                                                                 |  | ㉝ artist:                                                                                                                                              |  | ㉞ artisan:                                                                                                                                                                                          |  | ㉟ builder/contractor:                                                                                                                                                                |  |
| ㊱ NAMES give role & date<br>PERSONAL:<br><br>EVENTS:<br><br>INSTITUTIONAL:                                                                                                                                                             |  |                                                                                                                                                       |  |                                                                                                                                                        |  |                                                                                                                                                                                                     |  |                                                                                                                                                                                      |  |
| ㊲ NATIONAL REGISTER WRITE-UP                                                                                                                                                                                                           |  |                                                                                                                                                       |  |                                                                                                                                                        |  |                                                                                                                                                                                                     |  |                                                                                                                                                                                      |  |