

DATA SHEET

Form 10-300
(Rev. 6-72)

UNITED STATES DEPARTMENT OF THE INTERIOR
NATIONAL PARK SERVICE

NATIONAL REGISTER OF HISTORIC PLACES INVENTORY - NOMINATION FORM

(Type all entries - complete applicable sections)

STATE: Ohio
COUNTY: Miami
FOR NPS USE ONLY
ENTRY DATE JUN 30 1975

1. NAME

COMMON:
Troy Public Square

AND/OR HISTORIC:

2. LOCATION

STREET AND NUMBER:
Public Square (see continuation sheet)

CITY OR TOWN: **Troy** CONGRESSIONAL DISTRICT: **4th--Tennyson Guyer (R)**

STATE: **Ohio** CODE: **039** COUNTY: **Miami** CODE: **109**

3. CLASSIFICATION

CATEGORY (Check One)	OWNERSHIP	STATUS	ACCESSIBLE TO THE PUBLIC
<input checked="" type="checkbox"/> District <input type="checkbox"/> Building <input type="checkbox"/> Site <input type="checkbox"/> Structure <input type="checkbox"/> Object	<input type="checkbox"/> Public <input checked="" type="checkbox"/> Private <input type="checkbox"/> Both	Public Acquisition: <input type="checkbox"/> In Process <input type="checkbox"/> Being Considered	<input checked="" type="checkbox"/> Occupied <input type="checkbox"/> Unoccupied <input type="checkbox"/> Preservation work in progress
PRESENT USE (Check One or More as Appropriate)			
<input type="checkbox"/> Agricultural <input checked="" type="checkbox"/> Commercial <input type="checkbox"/> Educational <input type="checkbox"/> Entertainment	<input type="checkbox"/> Government <input type="checkbox"/> Industrial <input type="checkbox"/> Military <input type="checkbox"/> Museum	<input checked="" type="checkbox"/> Park <input type="checkbox"/> Private Residence <input type="checkbox"/> Religious <input type="checkbox"/> Scientific	<input checked="" type="checkbox"/> Transportation <input type="checkbox"/> Other (Specify) _____ _____ _____

4. OWNER OF PROPERTY

OWNER'S NAME:
Multiple Public and Private

STREET AND NUMBER:

CITY OR TOWN: _____ STATE: _____ CODE: _____

5. LOCATION OF LEGAL DESCRIPTION

COURTHOUSE, REGISTRY OF DEEDS, ETC:
Miami County Recorder's Office

STREET AND NUMBER:
County Safety Building, West Main Street

CITY OR TOWN: **Troy** STATE: **Ohio** CODE: **039**

6. REPRESENTATION IN EXISTING SURVEYS

TITLE OF SURVEY: **Survey of Historical Features Miami River, Little Miami River, Mill Creek Basins Southwestern Ohio**

DATE OF SURVEY: **1970** Federal State County Local

DEPOSITORY FOR SURVEY RECORDS:
Ohio Historical Society

STREET AND NUMBER:
The Ohio Historical Center

CITY OR TOWN: **Columbus** STATE: **Ohio** CODE: **039**

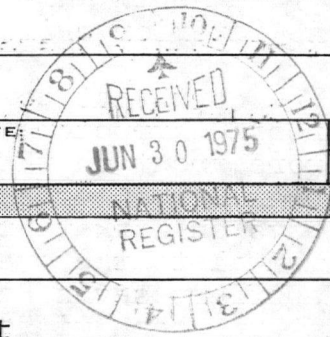

STATE: Ohio
COUNTY: Miami
ENTRY NUMBER JUN 30 1975
DATE JUN 30 1975

SEE INSTRUCTIONS

FOR NPS USE ONLY

7. DESCRIPTION

CONDITION	(Check One)					
	<input checked="" type="checkbox"/> Excellent	<input type="checkbox"/> Good	<input type="checkbox"/> Fair	<input type="checkbox"/> Deteriorated	<input type="checkbox"/> Ruins	<input type="checkbox"/> Unexposed
	(Check One)			(Check One)		
	<input checked="" type="checkbox"/> Altered	<input type="checkbox"/> Unaltered	<input type="checkbox"/> Moved	<input checked="" type="checkbox"/> Original Site		

DESCRIBE THE PRESENT AND ORIGINAL (if known) PHYSICAL APPEARANCE

SEE INSTRUCTIONS

Troy Public Square is the commercial hub of this thriving rural county seat and market town of 17,187 people. Originally platted in 1808 to be the Court House Square, it lost its courthouse to West Main Street in 1841. The Square has evolved into a traffic circle with a small fountain park in the center and parking areas in the four corners. Six of the seven buildings that flank the gateways into the Square are pivotal to the historic district, one at the east gateway south side is a twentieth century bank building of no significance but not a notable intrusion, and the eighth site at the west gateway north side is a small city park which replaces a building destroyed by fire in 1970. The buildings of the district are with few exceptions constructed of brick that has been painted and have boxed cornices with frieze and brackets.

On the northwest corner of the North Market Street corridor is the three story Mayo-Harter Building of 1848, the eldest appearing of the pivotal structures. The store fronts have been modernized but without extensive use of artificial materials. Commercial renovation is contemplated. The painted brick facade of five bays on the Square and the Market Street side of four bays have mixed 6/6 and 2/2 double hung sash windows with shutters, stone lintels and sills. The gable faces the Square with a boxed cornice, frieze and returns. Four interior chimneys are spaced along the wall. The north wall has a straight gable with flared ends and one interior chimney right of the ridge.

The northeast corner has the Buckeye Building. This flat roofed structure was built c. 1847 and renovated in 1871. The store front on the Square has been butchered; however, on Market Street it still has some authenticity. The north four bays on Market Street have received a variegated painting detrimental to the overall appearance of the structure. The facade offers seven bays on each face of mixed 2/2 and 1/1 double hung sash windows that have Eastlake head molds. The eaves are boxed cornice with frieze and elongated paired scroll saw brackets with pendant. A pair of interior side chimneys show on the Square.

The north corridor beyond the Mayo-Harter Building is "Commercial Row," a block of minor shops built in part around 1839, after the fire of 1824. The row has recently been rehabilitated. On the west are two buildings then a landscaped city parking lot. Water Street just half a block from the Miami River Bridge terminates the District.

To the east we have the three story plus mansard

**NATIONAL REGISTER OF HISTORIC PLACES
INVENTORY - NOMINATION FORM**

(Continuation Sheet)

STATE	Ohio	
COUNTY	Miami	
FOR NPS USE ONLY		
ENTRY NUMBER		DATE
		JUN 30 1975

(Number all entries) Troy Public Square.

2. Location.

Verbal Description: The district includes all buildings directly facing on the Square, less the Harr's Building intrusion at the southwest corner, plus the buildings facing North Market Street to the corner of Water Street (nos. 1-24); East Main Street to the corner of Mulberry Street (nos. 1-121), excepting intrusions at nos. 100,113,117, and 120; South Market Street to the corner of Franklin Street (nos. 1-17) excepting intrusions at nos. 15 and 17; and West Main Street to Cherry Street (nos. 2-12). The district includes thirty-three (33) buildings relevant to the district, six (6) that do not add nor particularly detract and seven (7) buildings that intrude a ratio of 18%.



8. SIGNIFICANCE

PERIOD (Check One or More as Appropriate)

<input type="checkbox"/> Pre-Columbian	<input type="checkbox"/> 16th Century	<input type="checkbox"/> 18th Century	<input type="checkbox"/> 20th Century
<input type="checkbox"/> 15th Century	<input type="checkbox"/> 17th Century	<input checked="" type="checkbox"/> 19th Century	

SPECIFIC DATE(S) (If Applicable and Known) See Below

AREAS OF SIGNIFICANCE (Check One or More as Appropriate)

<input type="checkbox"/> Aboriginal	<input type="checkbox"/> Education	<input type="checkbox"/> Political	<input checked="" type="checkbox"/> Urban Planning
<input type="checkbox"/> Prehistoric	<input type="checkbox"/> Engineering	<input type="checkbox"/> Religion/Philosophy	<input checked="" type="checkbox"/> Other (Specify)
<input type="checkbox"/> Historic	<input type="checkbox"/> Industry	<input type="checkbox"/> Science	<u>Local History</u>
<input type="checkbox"/> Agriculture	<input type="checkbox"/> Invention	<input type="checkbox"/> Sculpture	_____
<input checked="" type="checkbox"/> Architecture	<input type="checkbox"/> Landscape	<input type="checkbox"/> Social/Humanitarian	_____
<input type="checkbox"/> Art	<input type="checkbox"/> Architecture	<input type="checkbox"/> Theater	_____
<input checked="" type="checkbox"/> Commerce	<input type="checkbox"/> Literature	<input checked="" type="checkbox"/> Transportation	_____
<input type="checkbox"/> Communications	<input type="checkbox"/> Military		_____
<input type="checkbox"/> Conservation	<input type="checkbox"/> Music		_____

STATEMENT OF SIGNIFICANCE

Troy Public Square with the corridors leading onto it is in character a mid-Victorian commercial district of which the Southwestern Ohio Survey says, the building "comprises one of the best preserved groups of their kind in Ohio."

Troy like Washington, D.C. was created to be a seat of government when the Ohio General Assembly decided that it was time to carve Miami County (population then 2,500) out of Montgomery County in 1802. A committee of three selected the wooded site on high ground at a bend of the Great Miami River. Andrew Wallace, grandfather of General Lewis Wallace who wrote Ben-Hur, a Tale of Christ, laid out the town in 1807 with the Public Square on the highest ground.

Pivotal buildings in the district are the Mayo-Harter Building (c. 1848) built by Henry Mayo which housed the Samuel K. Harter Hardware Store for fifty years. The Buckeye Building was erected in 1847 by Aaron Tullis but achieved its present appearance in 1871. The Coleman-Allen Building is another built earlier (1855) but renovated to add a mansard story in 1866. The Dye Building (c. 1871) contained W.H.H. Dye's bank and the high ceilinged third floor was a very active ballroom. A novelty store chain recently abandoned the Dye Building, moving to a shopping center. The building is threatened. Across Market Street the Dunlap Building (c. 1871) was the second location for Troy's first telephone exchange after it was renovated c. 1877. The "Bee Hive Corner" on Main Street typifies the 1870's.

The corridors have some notable buildings. The Hatfield House, originally the Washington Hotel (c. 1835) has been enlarged at least twice and achieved its final appearance in the 1870's. The north corridor on North Market Street has Commercial Row, part of which dates back to 1839. Commercial Row has been recently rehabilitated. The south corridor has the district's two eye sores at the

SEE INSTRUCTIONS

9. MAJOR BIBLIOGRAPHICAL REFERENCES

Wheeler, Thomas Bemis. Troy--The Nineteenth Century. Troy, Ohio: The Troy Historical Society, 1970.
 Bravo, Mrs. Robert and Fraula, Mrs. Louis (ed.). Historic Troy, Ohio. Troy, Ohio: Troy Historical Society, 1974.
 Troy Historical Society Archives. Mrs. Virginia Boese, Director.

10. GEOGRAPHICAL DATA

VTM
OK
HL

LATITUDE AND LONGITUDE COORDINATES DEFINING A RECTANGLE LOCATING THE PROPERTY			O R	LATITUDE AND LONGITUDE COORDINATES DEFINING THE CENTER POINT OF A PROPERTY OF LESS THAN TEN ACRES		
CORNER	Easting	Northing		LATITUDE		LONGITUDE
	Degrees	Minutes	Seconds	Degrees	Minutes	Seconds
Zone 16						
NW A	738 570		4435 850			
NE B	738 830		4435 710			
SE C	738 720		4435 490			
SW D	738 460		4435 620			
APPROXIMATE ACREAGE OF NOMINATED PROPERTY:				9.69 Acres		
LIST ALL STATES AND COUNTIES FOR PROPERTIES OVERLAPPING STATE OR COUNTY BOUNDARIES						
STATE:	CODE	COUNTY:	CODE			
STATE:	CODE	COUNTY:	CODE			
STATE:	CODE	COUNTY:	CODE			
STATE:	CODE	COUNTY:	CODE			

SEE INSTRUCTIONS

11. FORM PREPARED BY

NAME AND TITLE:
 Loren S. Gannon, Jr., Preservation Officer

ORGANIZATION: Montgomery County Historical Society DATE: Mar. 20, 1975

STREET AND NUMBER:
The Old Court House, P. O. Box 461

CITY OR TOWN: Dayton STATE: Ohio 45402 CODE: 039

12. STATE LIAISON OFFICER CERTIFICATION

As the designated State Liaison Officer for the National Historic Preservation Act of 1966 (Public Law 89-665), I hereby nominate this property for inclusion in the National Register and certify that it has been evaluated according to the criteria and procedures set forth by the National Park Service. The recommended level of significance of this nomination is:

National State Local

Name: [Signature]

Title: State Historic Preservation Officer

Date: June 16, 1975

NATIONAL REGISTER VERIFICATION

I hereby certify that this property is included in the National Register.

[Signature]
 Director, Office of Archeology and Historic Preservation

Date: 6/30/75

ATTEST:

[Signature]
 Keeper of The National Register

Date: 6-30-75

**NATIONAL REGISTER OF HISTORIC PLACES
INVENTORY - NOMINATION FORM**

(Continuation Sheet)

STATE	Ohio
COUNTY	Miami
FOR NPS USE ONLY	
ENTRY NUMBER	DATE
	JUN 30 1975

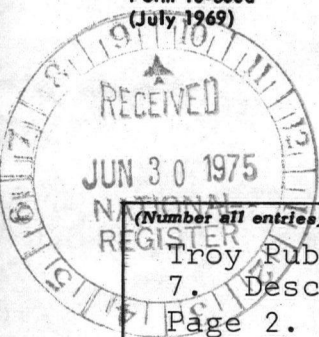

(Number all entries)

Troy Public Square.
7. Description.
Page 2.

Coleman-Allen Building on the north side of East Main Street. The building was built in 1855 and renovated into Second Empire in 1866. There are eight long bays on the Square and six narrow ones on Main Street. The tall rectangular windows with shaped head molds and stone sills are of mixed type with transomed four light split casements on the second floor, two light 1/1 double hung sash mullion windows and 1/1 double hung sash. The cornice is boxed with frieze and has paired brackets alternating with paired consoles. The design is unusual in that the brackets are centered in each bay. The concave mansard of patterned polychrome slate has six decorated semicircular dormers (four on the Square) evenly distributed without regard to the fenestration below. Two bays of the mansard on Main Street have been replaced by a fourth story with cornice and shed roof. Two interior chimneys are in the mansard of the west wall.

The east corridor is the longest, extending two blocks. It is anchored by the natural brick Hatfield House on the northwest corner of East Main and Mulberry Streets. This structure is a very plain Victorian of 1841 renovated c. 1871. There are four bays on Main and eleven on Mulberry with 2/2 double hung sash windows, plain stone lintels and sills. The two center bays on Main are transomed entrances to offices. The third bay on Mulberry is a Victorian double door with transom and bracketed cornice hood. The fourth and ninth bays are transomed doors. A wood balcony connects the ninth bay and a transomed door in the tenth on the second level. An angle iron multistory fire escape is in the third and fourth bays. The eave is boxed cornice with panelled frieze and brackets. Five interior chimneys line the east wall, one is west and one is central toward the rear on the low hip roof.

The south side of the East Main Street corridor is rather nondescript but includes several minor buildings of antiquity. The intrusions are K's Lunch and Western Auto at 117 and 113 respectively on the north side and a Chrysler dealership (no. 120) and Penney's store (no. 100) on the south side.

South Market Street, the principle gateway, has the Dye Building on the east and the Dunlap Building on the west. The very large Dye Building c. 1871 faces on Market

NATIONAL REGISTER OF HISTORIC PLACES
INVENTORY - NOMINATION FORM

(Continuation Sheet)

STATE	
Ohio	
COUNTY	
Miami	
FOR NPS USE ONLY	
ENTRY NUMBER	DATE
	JUN 30 1975

(Number all entries)

7 Troy Public Square.

7. Description.

Page 3.

Street. The store front is relatively intact and restorable. The facade is unusually plain with twelve bays of rectangular windows on Main and eight bays on the Square. The second story windows are 6/6 double hung sash and the very tall 9/9 windows of the third story service a ballroom. The eaves are boxed cornice with frieze and closely spaced elongated brackets. The back wall has a stepped gable. The roof is a truncated slate hip with three interior chimneys on each commercial face, several others on the gable and south wall.

The three story Dunlap Building (c. 1871), across Market Street, has a seven bay varigated facade (constructed c. 1876). The store front is heavily modified. The three bays at the corner and seven on the Square are Italianate. The corner has stone quoins. The floor length 1/1 double hung sash windows of the second story are semicircular and the third segmental with hood molds and stone sills labelled. Three horizontal oval attic windows are on the Main Street facade. A stairway with a fixed canopy leads to a second story three bay wrought iron balcony and a door in the third bay of the seven bay side on the Square. An angle iron fire escape services the third floor at the sixth bay. The cornice of the flat roof is boxed with a panelled frieze and paired brackets. The central three bay facade, each bay framed by pilasters, has central doors leading onto balconies with wrought iron balustrade and supported by iron consoles. The second level has a panelled door and the third a French door. The single light windows and the door of the second story are segmental. The four light windows and the door of the third floor approximate semicircular. The left (south) two bay facade is framed by pilasters at the margins with 1/1 double hung sash windows on reduced scale that have hood molds joined by belt courses, again segmental on the second level and semicircular on the third. The five left bays have a common belt course between tiers, an elaborate Victorian cornice with panelled frieze and bracket and an imbricated mansard with decorated semicircular dormers in each bay and dividers between the two facades. The roof line is common of the entire seven bays on Market Street.

The south corridor terminates at Franklin Street on the west side with the four story Lollis Hotel built in 1854. The nine bay Main Street facade has modernized store fronts

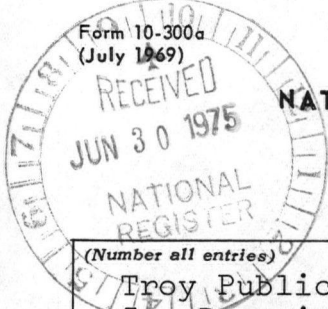

Form 10-300a
(July 1969)

UNITED STATES DEPARTMENT OF THE INTERIOR
NATIONAL PARK SERVICE

**NATIONAL REGISTER OF HISTORIC PLACES
INVENTORY - NOMINATION FORM**

(Continuation Sheet)

STATE	Ohio	
COUNTY	Miami	
FOR NPS USE ONLY		
ENTRY NUMBER		DATE
		JUN 30 1975

(Number all entries)

Troy Public Square.
7. Description.
Page 4.

on the street level. The center bay of the second and third stories are segmental transomed doorways leading onto wrought iron balconies which have been supplemented on the three upper levels by an angle iron fire escape. The 1/1 double hung windows have decorated shaped and bracketed hood molds and stone lug sills. The tenth bay, Franklin Street facade side, has a store front on the seventh through the ninth bays. The upper levels are similar to the facade with the balconies in the fourth bay. The flat roof has boxed eaves with plain frieze and extended paired brackets alternating with consoles at each bay.

The two most jarring intrusions are at the south margin of the district next door to each other across from the Lollis House. At the corner is the General Telephone Company Building (17 S. Market) in glaring mid-twentieth century industrial modern, its only merit being the use of brick arches. Next door the Troy Hardware Company's (15 S. Market) Victorian facade has been sheathed in corrugated metal, an esthetic atrocity.

On the south shoulder of the west gateway is the Bee Hive Corner built in 1874. Boothe's Men's Wear has modernized the store front on West Main. There is a transomed doorway with head mold near the fifth bay on the Square and the sixth and seventh bay is a store front. This building is notable for its brick work. The walls are recessed in two double bay sections on the facade and in each bay on the side. The top margin of the recessed bays are corbelled and dentiled and capitols on the narrow advancing plains form pilasters. The windows are 4/4 double hung sash with wrought iron bracketed segmental hood molds and stone sills. The third bay on the second story on the Square is a doorway with side lights and transom approached by a wrought iron balcony and exterior stairway. An angle iron fire escape is on the right of the facade. The eaves are metal boxed cornice with wide frieze, brackets and antefixes. The roof is a truncated hip with two chimneys in each side.

The buildings on the west corridor are in general early twentieth century and make no particular contribution to the district. However, West Main is a government and residential section in which several dispersed structures are subjects of individual nominations to the National Register not

**NATIONAL REGISTER OF HISTORIC PLACES
INVENTORY - NOMINATION FORM**

(Continuation Sheet)

STATE	Ohio	
COUNTY	Miami	
FOR NPS USE ONLY		
ENTRY NUMBER		DATE
		JUN 30 1975

(Number all entries)

Troy Public Square.
7. Description.
Page 5.

appropriately a part of the Troy Public Square District.

The pivotal building on the Square and in the corridors are in general connected by buildings of comparable style and some on a minor plane are relics of the 1840's most of which contribute to the district. The stone block facade of the eclectic First National Bank (1929) in Romanesque Modernism of the twenties is out of step but has some value in its own right.

8. Significance.

the southeast end but it also has the Lollis Hotel (1854) formerly the Morris House for a long time Troy's largest building. Next door Asa Mayo built (1854) an identical structure except he combined the third and fourth floor for Troy's first theater, complete with stage, orchestra, and balcony. Mayo's Hall which seated five hundred people held the school graduation exercises, plays, musicals, literary programs and many public dinners from 1854 to 1866. Across the street is the Eli Kelly Building of 1887 that held his music and book store.

The architectural scene of the second half of the nineteenth century is well preserved in Troy. There is a positive movement afoot in Troy which hopes to utilize the historic and scenic quality of this commercial district to provide a more viable economic foundation for preservation in the face of growing challenges from shopping centers on the community's periphery.



**NATIONAL REGISTER OF HISTORIC PLACES
INVENTORY - NOMINATION FORM**

(Continuation Sheet)

STATE Ohio	
COUNTY Miami	
FOR NPS USE ONLY	
ENTRY NUMBER	DATE
	JUN 30 1975

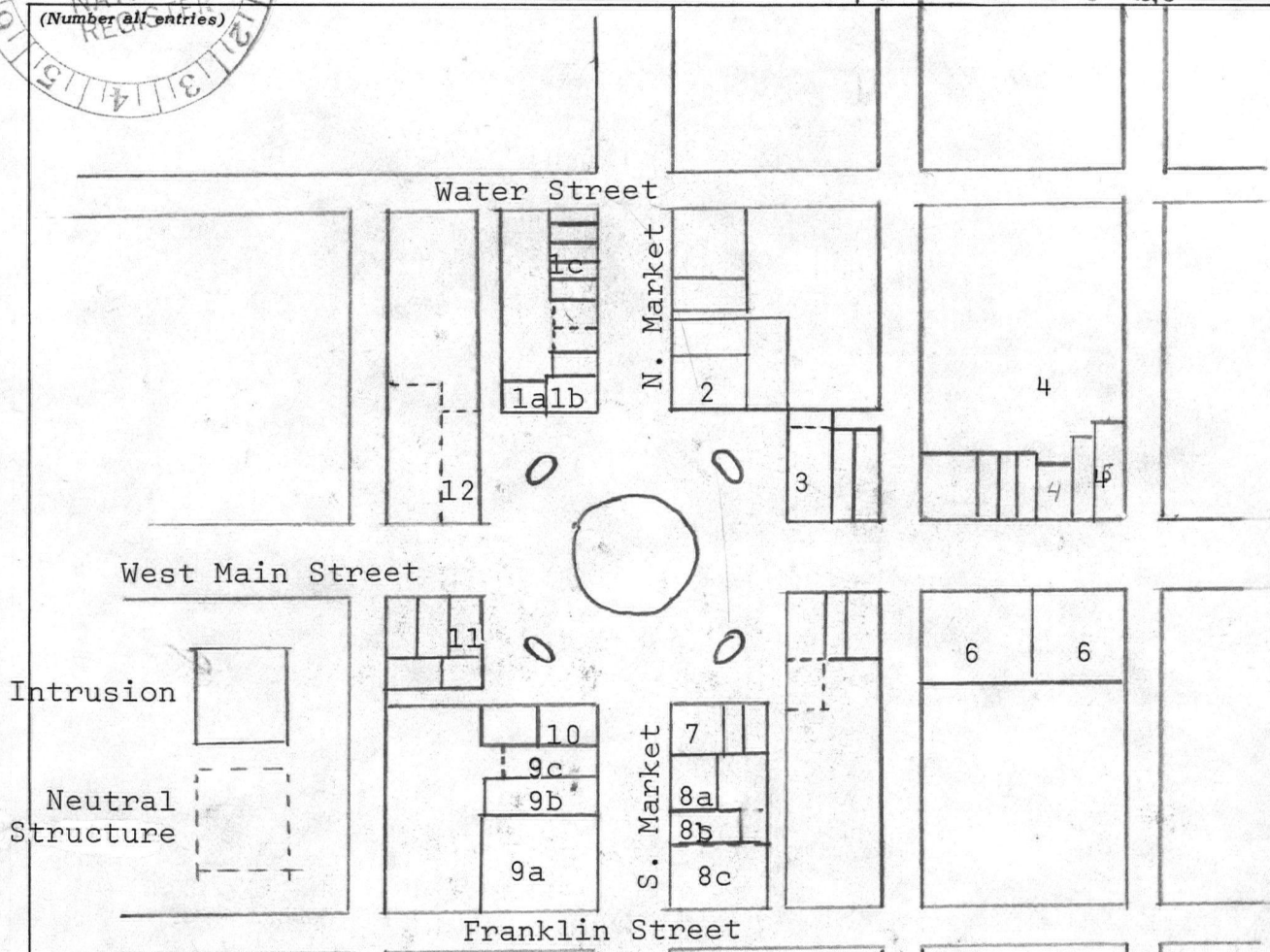
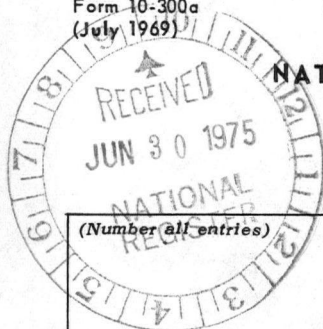

- | | |
|---|---|
| 1a. Mayo Bldg. 1847 | 8a. Kelly Bldg. 1887 (East-lake) |
| 1b. Mayo-Harter Bldg. c. 1848 (early) | 8b. Troy Hardware (intrusion) |
| 1c. Commercial Row (Generic) | 8c. General Telephone Bldg. (intrusion) |
| 2. Buckeye Bldg. c. 1847 and 1871 (Second Empire) | 9a. Lollis Hotel (Generic) |
| 3. Coleman-Allen Bldg. 1853 and 1866 | 9b. Mayo's Hall 1854 |
| 4. North side, east corridor with intrusion | 9c. First National Bank 1929 |
| 5. Hatfield House 1841 and c. 1871 (Generic) | 10. Dunlap Bldg. c. 1871 and 1876 (varigated) |
| 6. South side, east corridor with intrusion | 11. "Bee Hive Corner" 1874 (Generic) |
| 7. Dye Bldg. c. 1871 (Generic) | 12. City Park |

Property Troy Public Square
State Ohio Working Number 6.30.75.1201

Miami

TECHNICAL

Photos 12
Maps 1

CONTROL

.OK ^{cm} 6.30.75

Only a few intrusions. However every area checked as significant should be justified in statement of significance. Architectural justification is ok.

HISTORIAN

Accept
E. Smith
6-30-75

ARCHITECTURAL HISTORIAN

ACCEPT
H. J. ...
6/30/75

ARCHEOLOGIST

OTHER

HAER

Inventory _____
Review _____

REVIEW UNIT CHIEF

Accept
Cole
6-30-75

BRANCH CHIEF

KEEPER

accept
H. J. ...
6-30-75

National Register Write-up _____ Send-back _____
Federal Register Entry 8-5-75 Re-submit _____

Entered JUN 30 1975

INT:2106-74



TROY PUBLIC SQUARE DISTRICT JAN 75

MIAMI COUNTY, OHIO

#9 NORTH SIDE OF EAST MAIN STREET FROM THE PUBLIC SQUARE TO THE LIMIT OF TOWN DISTRICT

AT

Form No. 10-301a
(7/72)

UNITED STATES DEPARTMENT OF THE INTERIOR
NATIONAL PARK SERVICE

NATIONAL REGISTER OF HISTORIC PLACES
PROPERTY PHOTOGRAPH FORM

(Type all entries - attach to or enclose with photograph)

STATE	Ohio
COUNTY	Miami
FOR NPS USE ONLY	
ENTRY NUMBER	DATE
JUN 30 1975	

SEE INSTRUCTIONS

1. NAME			
COMMON: Troy Public Square Historic District			
AND/OR HISTORIC:			
2. LOCATION			
STREET AND NUMBER: Intersection of Main Street and Market Street			
CITY OR TOWN: Troy			
STATE: Ohio	CODE 039	COUNTY: Miami	CODE 109
3. PHOTO REFERENCE			
PHOTO CREDIT: Loren S. Gannon, Jr.			
DATE OF PHOTO: January 1975			
NEGATIVE FILED AT: Montgomery County Historical Society, The Old Court House, P. O. Box 461, Dayton, Ohio 45402			
4. IDENTIFICATION			
DESCRIBE VIEW, DIRECTION, ETC. North side of East Main Street from the Public Square to the limit of the district at the Hatfield House facing east and the Western and Auto and K's Lunch intrusion. #10812			

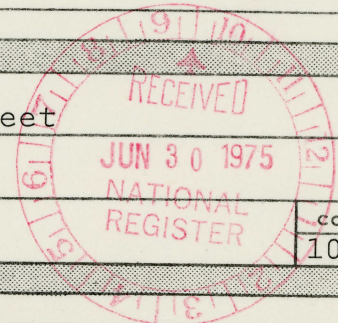

#4

U.S. GOVERNMENT PRINTING OFFICE: 876-167

PROPERTY OF THE NATIONAL REGISTER

#10812



#11

Form No. 10-301a
(7/72)

UNITED STATES DEPARTMENT OF THE INTERIOR
NATIONAL PARK SERVICE

**NATIONAL REGISTER OF HISTORIC PLACES
PROPERTY PHOTOGRAPH FORM**

(Type all entries - attach to or enclose with photograph)

STATE Ohio	
COUNTY Miami	
FOR NPS USE ONLY	
ENTRY NUMBER	DATE
	JUN 30 1975

SEE INSTRUCTIONS

1. NAME			
COMMON: Troy Public Square Historic District			
AND/OR HISTORIC:			
2. LOCATION			
STREET AND NUMBER: Intersection of Main Street and Market Street			
CITY OR TOWN: Troy			
STATE: Ohio	CODE 039	COUNTY: Miami	CODE 109
3. PHOTO REFERENCE			
PHOTO CREDIT: Loren S. Gannon, Jr.			
DATE OF PHOTO: January 1975			
NEGATIVE FILED AT: Montgomery County Historical Society, The Old Court House, P. O. Box 461, Dayton, Ohio 45402			
4. IDENTIFICATION			
DESCRIBE VIEW, DIRECTION, ETC. South side west corridor from the east. <i>See caption on the photograph.</i> #20812			

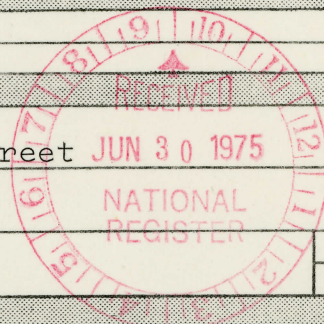

#11

PROPERTY OF THE NATIONAL REGISTER

#20812



#8 TROY PUBLIC SQUARE DISTRICT JAN 1975, MIAMI COUNTY, OHIO SOUTH CORRIDOR EAST SIDE TWO BAD INTRUSIONS AT FRANKLIN STREET AND THE KELLY BUILDING 1887

Form No. 10-301a
(7/72)

UNITED STATES DEPARTMENT OF THE INTERIOR
NATIONAL PARK SERVICE

NATIONAL REGISTER OF HISTORIC PLACES
PROPERTY PHOTOGRAPH FORM

(Type all entries - attach to or enclose with photograph)

STATE	Ohio
COUNTY	Miami
FOR NPS USE ONLY	
ENTRY NUMBER	DATE
JUN 30 1975	

SEE INSTRUCTIONS

1. NAME			
COMMON: Troy Public Square Historic District			
AND/OR HISTORIC:			
2. LOCATION			
STREET AND NUMBER:			
Intersection of Main Street and Market Street			
CITY OR TOWN:			
Troy			
STATE:	CODE	COUNTY:	CODE
Ohio	039	Miami	109
3. PHOTO REFERENCE			
PHOTO CREDIT: Loren S. Gannon, Jr.			
DATE OF PHOTO: January 1975			
NEGATIVE FILED AT: The Montgomery County Historical Society, The Old Court House, P. O. Box 461, Dayton, Ohio 45402			
4. IDENTIFICATION			
DESCRIBE VIEW, DIRECTION, ETC.			
South corridor east side two bad intrusions at Franklin Street and the Kelly Building 1887.			
#30312			#8

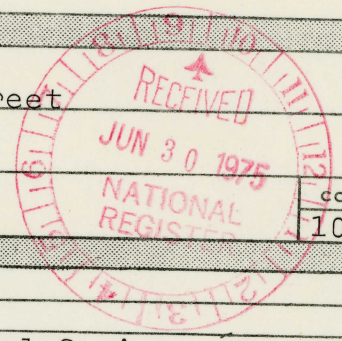

U.S. GOVERNMENT PRINTING OFFICE: 876-167

PROPERTY OF THE NATIONAL REGISTER

#30312



TROY PUBLIC SQUARE DISTRICT JAN 25 MIAMI COUNTY, OHIO. WEST CORRIDOR NORTH SIDE SHOWING CITY PARK AND MAYFLOWER THEATER
#12 FROM SOUTH EAST

Form No. 10-301a
(7/72)

UNITED STATES DEPARTMENT OF THE INTERIOR
NATIONAL PARK SERVICE

NATIONAL REGISTER OF HISTORIC PLACES
PROPERTY PHOTOGRAPH FORM

(Type all entries - attach to or enclose with photograph)

STATE Ohio	
COUNTY Miami	
FOR NPS USE ONLY	
ENTRY NUMBER	DATE
	JUN 30 1975

SEE INSTRUCTIONS

1. NAME

COMMON: Troy Public Square Historic District
AND/OR HISTORIC:

2. LOCATION

STREET AND NUMBER:

Intersection of Main Street and Market Street

CITY OR TOWN:

Troy

STATE:

Ohio

CODE

039

COUNTY:

Miami

CODE

109

3. PHOTO REFERENCE

PHOTO CREDIT: Loren S. Gannon, Jr.

DATE OF PHOTO: January 1975

NEGATIVE FILED AT: Montgomery County Historical Society, The Old
Court House, P. O. Box 461, Dayton, Ohio 45402

4. IDENTIFICATION

DESCRIBE VIEW, DIRECTION, ETC.

West corridor north side showing City Park and Mayflower
Theater from southeast.

#40812

#12

U.S. GOVERNMENT PRINTING OFFICE: 876-167

PROPERTY OF THE NATIONAL REGISTER

#40812



FIRST NATIONAL TRUST COMPANY
ERECTED 1929
FIRST NATIONAL BANK

JEWEL FR'S
FRIENDSHIP HOUSE

NEAL'S FARMS

DOLLAR GENERAL STORES

WEST 55 SOUTH 75

55

10 TROY PUBLIC SQUARE DISTRICT JAN 25

MIAMI COUNTY OHIO

THE SOUTHWEST CORNER OF MARKET STREET ON THE PUBLIC SQUARE FROM THE EAST

SHOWING

Form No. 10-301a
(7/72)

UNITED STATES DEPARTMENT OF THE INTERIOR
NATIONAL PARK SERVICE

NATIONAL REGISTER OF HISTORIC PLACES

PROPERTY PHOTOGRAPH FORM

(Type all entries - attach to or enclose with photograph)

STATE	Ohio
COUNTY	Miami
FOR NPS USE ONLY	
ENTRY NUMBER	DATE
	JUN 30 1975

SEE INSTRUCTIONS

1. NAME			
COMMON: Troy Public Square Historic District			
AND/OR HISTORIC:			
2. LOCATION			
STREET AND NUMBER: Intersection of Main Street and Market Street			
CITY OR TOWN: Troy			
STATE: Ohio	CODE 039	COUNTY: Miam	CODE 109
3. PHOTO REFERENCE			
PHOTO CREDIT: Loren S. Gannon, Jr.			
DATE OF PHOTO: January 1975			
NEGATIVE FILED AT: The Montgomery County Historical Society, The Old Court House, P. O. Box 461, Dayton, Ohio 45402			
4. IDENTIFICATION			
DESCRIBE VIEW, DIRECTION, ETC. The southwest corner of Market Street on the Public Square from the east showing the Dunlap Building and the Harr's Building (intrusion). #50212			

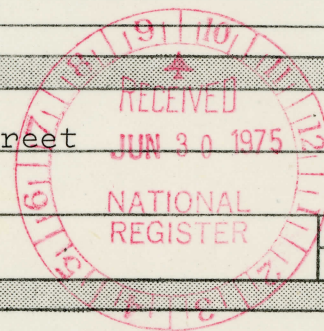

PROPERTY OF THE NATIONAL REGISTER

#50212



B) 1207 PUBLIC SQUARE DISTRICT APRIL 1923 MIAMI COUNTY OHIO SOUTH WEST CORNER FROM THE NORTH EAST
SHOWING FROM LEFT TO RIGHT THE LOLLIS HOTEL, MAY'S HALL, THE FIRST NATIONAL BANK

Form No. 10-301a
(7/72)

UNITED STATES DEPARTMENT OF THE INTERIOR
NATIONAL PARK SERVICE

NATIONAL REGISTER OF HISTORIC PLACES
PROPERTY PHOTOGRAPH FORM

(Type all entries - attach to or enclose with photograph)

STATE	
Ohio	
COUNTY	
Miami	
FOR NPS USE ONLY	
ENTRY NUMBER	DATE
	JUN 30 1975

SEE INSTRUCTIONS

1. NAME			
COMMON: Troy Public Square Historic District			
AND/OR HISTORIC:			
2. LOCATION			
STREET AND NUMBER:			
Intersection of Main Street and Market Street			
CITY OR TOWN:			
Troy			
STATE:		CODE	COUNTY:
Ohio		039	Miami
3. PHOTO REFERENCE			
PHOTO CREDIT: Loren S. Gannon, Jr.			
DATE OF PHOTO: January 1975			
NEGATIVE FILED AT: Montgomery County Historical Society, The Old Court House, P. O. Box 461, Dayton, Ohio 45402			
4. IDENTIFICATION			
DESCRIBE VIEW, DIRECTION, ETC.			
Southwest corner from the northeast showing from left to right the Lollis Hotel, May's Hall, and the First National Bank.			
#60812			
#9			

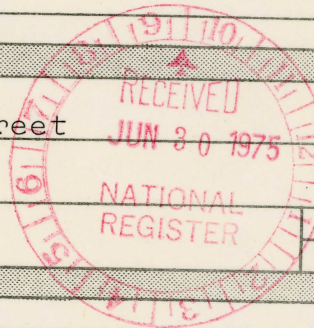

U.S. GOVERNMENT PRINTING OFFICE: 876-167

PROPERTY OF THE NATIONAL REGISTER

#60812

W. J. on
Main Public Square



Form No. 10-301a
(7/72)

UNITED STATES DEPARTMENT OF THE INTERIOR
NATIONAL PARK SERVICE

**NATIONAL REGISTER OF HISTORIC PLACES
PROPERTY PHOTOGRAPH FORM**

(Type all entries - attach to or enclose with photograph)

STATE Ohio	
COUNTY Miami	
FOR NPS USE ONLY	
ENTRY NUMBER JUN 30 1975	DATE

SEE INSTRUCTIONS

1. NAME			
COMMON: Troy Public Square Historic District			
AND/OR HISTORIC:			
2. LOCATION			
STREET AND NUMBER: Intersection of Main Street and Market Street			
CITY OR TOWN: Troy			
STATE: Ohio	CODE 039	COUNTY: Miami	CODE 109
3. PHOTO REFERENCE			
PHOTO CREDIT: Loren S. Gannon, Jr.			
DATE OF PHOTO: January 1975			
NEGATIVE FILED AT: Montgomery County Historical Society, The Old Court House, P. O. Box 461, Dayton, Ohio 45402			
4. IDENTIFICATION			
DESCRIBE VIEW, DIRECTION, ETC. Southeast corridor, south side, from the northwest with intrusion #6.			
# 70812			

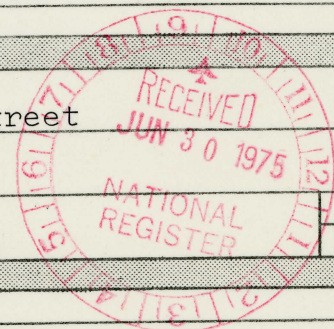

U.S. GOVERNMENT PRINTING OFFICE: 876-167

PROPERTY OF THE NATIONAL REGISTER

#70812



TROY PUBLIC SQUARE DISTRICT APR 1973 MIAMI COUNTY OHIO NORTH WEST CORNER FROM THE SOUTH SHOWING
#1 FROM LEFT TO RIGHT THE MAYO BUILDING, MAYO HARTER BUILDING COMMERCIAL ROW AND THE LIMIT OF THE DISTRICT

Miami Co., Ohio

Form No. 10-301a
(7/72)

UNITED STATES DEPARTMENT OF THE INTERIOR
NATIONAL PARK SERVICE

NATIONAL REGISTER OF HISTORIC PLACES
PROPERTY PHOTOGRAPH FORM

(Type all entries - attach to or enclose with photograph)

STATE Ohio	
COUNTY Miami	
FOR NPS USE ONLY	
ENTRY NUMBER JUN 30 1975	DATE

SEE INSTRUCTIONS

1. NAME		
COMMON: Troy Public Square Historic District		
AND/OR HISTORIC:		
2. LOCATION		
STREET AND NUMBER: Intersection of Main Street and Market Street		
CITY OR TOWN: Troy		
STATE: Ohio	CODE 039	COUNTY: Miami
3. PHOTO REFERENCE		
PHOTO CREDIT: Loren S. Gannon, Jr.		
DATE OF PHOTO: January 1975		
NEGATIVE FILED AT: Montgomery County Historical Society, The Old Court House, P. O. Box 461, Dayton, Ohio 45402		
4. IDENTIFICATION		
DESCRIBE VIEW, DIRECTION, ETC. From left to right, the Mayo Building, Mayo-Harter Building, Commercial Row, and the limit of the district. Northwest corner from the South #80812		

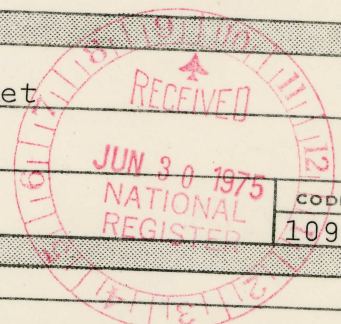

U.S. GOVERNMENT PRINTING OFFICE: 876-167

PROPERTY OF THE NATIONAL REGISTER

Toward East Market

#80812



Troy Public Square District Jan 25

Miami County Ohio

#2 The Buckeye Building

Form No. 10-301a
(7/72)

UNITED STATES DEPARTMENT OF THE INTERIOR
NATIONAL PARK SERVICE

NATIONAL REGISTER OF HISTORIC PLACES
PROPERTY PHOTOGRAPH FORM

(Type all entries - attach to or enclose with photograph)

STATE	Ohio
COUNTY	Miami
FOR NPS USE ONLY	
ENTRY NUMBER	DATE
JUN 30 1975	

SEE INSTRUCTIONS

1. NAME			
COMMON: Troy Public Square Historic District			
AND/OR HISTORIC:			
2. LOCATION			
STREET AND NUMBER: Intersection of Main Street and Market Street			
CITY OR TOWN: Troy			
STATE:	CODE	COUNTY:	CODE
Ohio	039	Miami	109
3. PHOTO REFERENCE			
PHOTO CREDIT: Loren S. Gannon, Jr.			
DATE OF PHOTO: January 1975			
NEGATIVE FILED AT: Montgomery County Historical Society, The Old Court House, P. O. Box 461, Dayton, Ohio 45402			
4. IDENTIFICATION			
DESCRIBE VIEW, DIRECTION, ETC. The northeast corner of Market Street and the Public Square showing the Buckeye Building at the corner and the east side of the corridor to the parking lot at the end.			
			#2

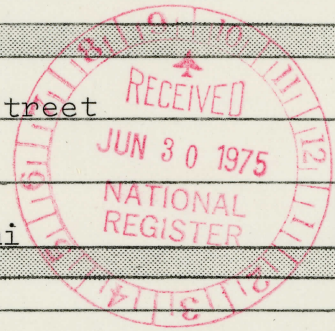

#90812

PROPERTY OF THE NATIONAL REGISTER

#90812



TROY PUBLIC SQUARE DISTRICT JAN 75

#3 MIAMI TROY OHIO

COLEMAN - ALLEN BUILDING FROM SOUTHWEST AND PART OF THE EAST CORRIDOR.

Form No. 10-301a
(7/72)

UNITED STATES DEPARTMENT OF THE INTERIOR
NATIONAL PARK SERVICE

NATIONAL REGISTER OF HISTORIC PLACES

PROPERTY PHOTOGRAPH FORM

(Type all entries - attach to or enclose with photograph)

STATE	Ohio
COUNTY	Miami
FOR NPS USE ONLY	
ENTRY NUMBER	DATE
JUN 30 1975	

SEE INSTRUCTIONS

1. NAME			
COMMON: Troy Public Square Historic District			
AND/OR HISTORIC:			
2. LOCATION			
STREET AND NUMBER: Intersection of Main Street and Market Street			
CITY OR TOWN: Troy			
STATE: Ohio	CODE 039	COUNTY: Miami	CODE 109
3. PHOTO REFERENCE			
PHOTO CREDIT: Loren S. Gannon, Jr.			
DATE OF PHOTO: January 1975			
NEGATIVE FILED AT: Montgomery County Historical Society, The Old Court House, P. O. Box 461, Dayton, Ohio 45402			
4. IDENTIFICATION			
DESCRIBE VIEW, DIRECTION, ETC. Coleman-Allen Building from southwest and part of the east corridor. #100812			

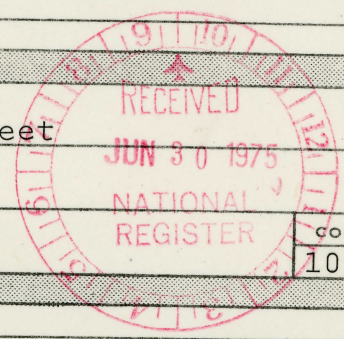

#3

U.S. GOVERNMENT PRINTING OFFICE: 876-167

PROPERTY OF THE NATIONAL REGISTER

#100812



HATFIELD HOUSE

K's

#5 TROY PUBLIC SQUARE DISTRICT JAN 75 MIAMI COUNTY OHIO NOTIFIED NEWS FROM THE SOUTH

Form No. 10-301a
(7/72)

UNITED STATES DEPARTMENT OF THE INTERIOR
NATIONAL PARK SERVICE

NATIONAL REGISTER OF HISTORIC PLACES
PROPERTY PHOTOGRAPH FORM

(Type all entries - attach to or enclose with photograph)

STATE	
Ohio	
COUNTY	
Miami	
FOR NPS USE ONLY	
ENTRY NUMBER	DATE
JUN 30 1975	

SEE INSTRUCTIONS

1. NAME			
COMMON: Troy Public Square Historic District			
AND/OR HISTORIC:			
2. LOCATION			
STREET AND NUMBER:			
Intersection of Main Street and Market Street			
CITY OR TOWN:			
Troy			
STATE:	CODE	COUNTY:	CODE
Ohio	039	Miami	109
3. PHOTO REFERENCE			
PHOTO CREDIT: Loren S. Gannon, Jr.			
DATE OF PHOTO: January 1975			
NEGATIVE FILED AT: The Montgomery County Historical Society, The Old Court House, P. O. Box 461, Dayton, Ohio 45402			
4. IDENTIFICATION			
DESCRIBE VIEW, DIRECTION, ETC.			
Hatfield House from the south. See the caption on the photograph.			
#5			

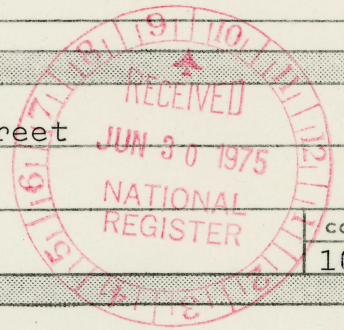

#110912

PROPERTY OF THE NATIONAL REGISTER

#110912



TROY PUBLIC SQUARE DISTRICT JAN 75

MIAMI COUNTY OHIO

#7 THE SOUTH EAST CORNER OF MARKET STREET AND THE PUBLIC SQUARE SQUARE

THE DYE

Form No. 10-301a
(7/72)

UNITED STATES DEPARTMENT OF THE INTERIOR
NATIONAL PARK SERVICE

NATIONAL REGISTER OF HISTORIC PLACES
PROPERTY PHOTOGRAPH FORM

(Type all entries - attach to or enclose with photograph)

STATE	Ohio
COUNTY	Miami
FOR NPS USE ONLY	
ENTRY NUMBER	DATE
	JUN 30 1975

SEE INSTRUCTIONS

1. NAME			
COMMON: Troy Public Square Historic Distric			
AND/OR HISTORIC:			
2. LOCATION			
STREET AND NUMBER: Intersection of Main Street and Market Street			
CITY OR TOWN: Troy			
STATE: Ohio	CODE 039	COUNTY: Miami	CODE 109
3. PHOTO REFERENCE			
PHOTO CREDIT: Loren S. Gannon, Jr.			
DATE OF PHOTO: January 1975			
NEGATIVE FILED AT: The Montgomery County Historical Society, The Old Court House, P. O. Box 461, Dayton, Ohio 45402			
4. IDENTIFICATION			
DESCRIBE VIEW, DIRECTION, ETC. The southeast corner of Market Street and the Public Square showing the Dye Building from the northwest.			
			#7

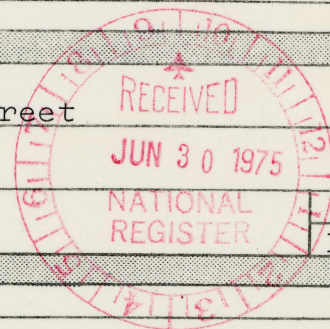

#120812

U.S. GOVERNMENT PRINTING OFFICE: 876-167

PROPERTY OF THE NATIONAL REGISTER

#120812

NATIONAL REGISTER OF HISTORIC PLACES
PROPERTY MAP FORM

(Type all entries - attach to or enclose with map)

STATE Ohio	
COUNTY Miami	
FOR NPS USE ONLY	
ENTRY NUMBER	DATE
	JUN 30 1975

SEE INSTRUCTIONS

1. NAME

COMMON: Troy Public Square Historic District
AND/OR HISTORIC:

2. LOCATION

STREET AND NUMBER:
Intersection of Main Street and Market Street

CITY OR TOWN:
Troy

STATE:
Ohio

CODE
039

COUNTY:
Miami

CODE
109

3. MAP REFERENCE

SOURCE:
U. S. Geological Survey 7.5 minute survey Troy Quadrangle

SCALE: 1:24,000

DATE: 1961

4. REQUIREMENTS

- TO BE INCLUDED ON ALL MAPS
1. Property boundaries where required.
 2. North arrow.
 3. Latitude and longitude reference.

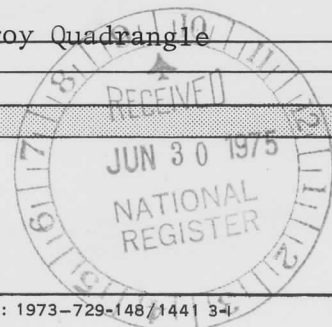

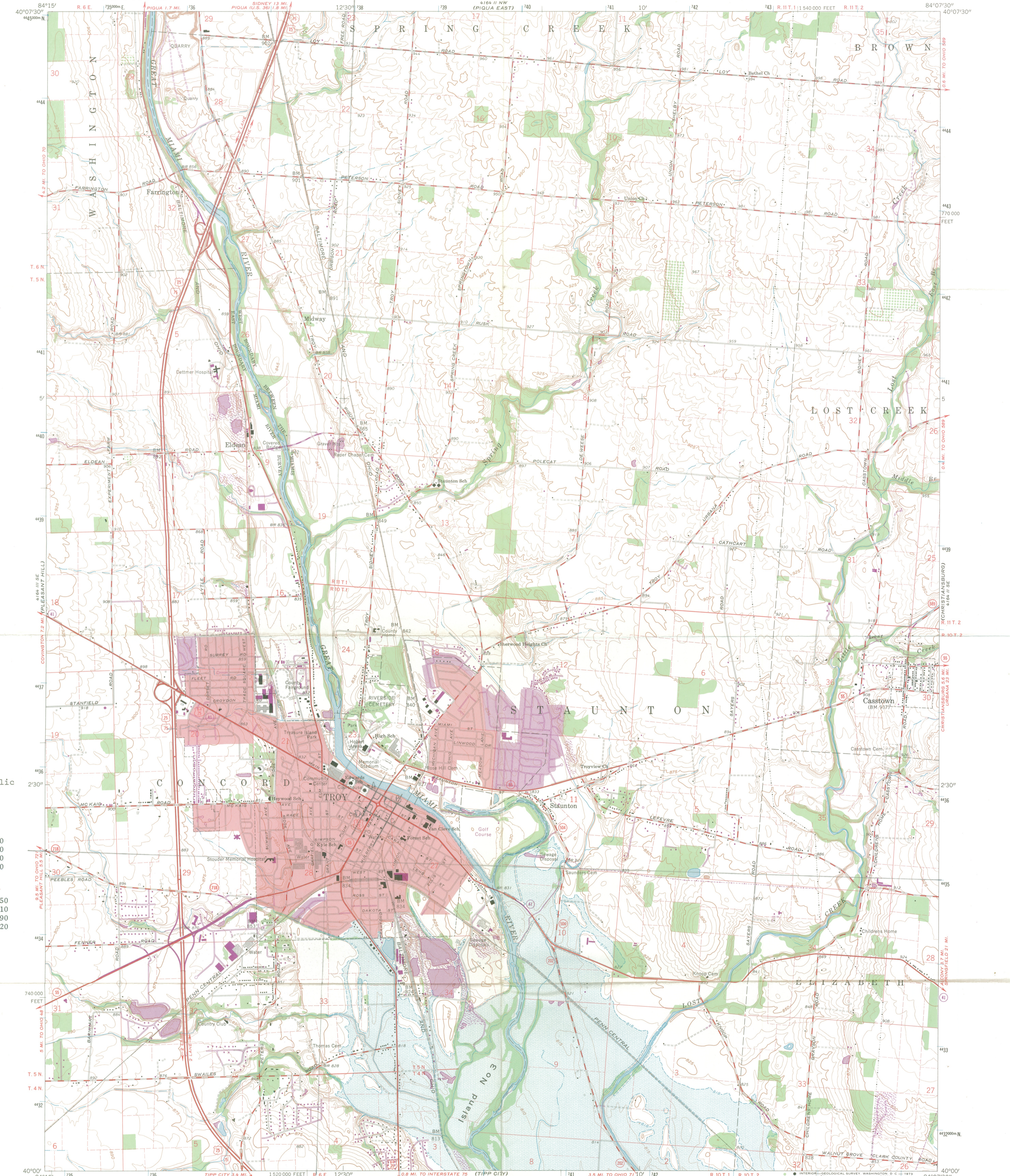

Troy Public Square
Zone 16
Easting
A 738 570
B 738 830
C 738 720
D 738 460
Northing
A 4435 850
B 4435 710
C 4435 490
D 4435 620

Mapped, edited, and published by the Geological Survey
Control by USGS and USC&GS
Topography by photogrammetric methods from aerial photographs taken 1957 and 1959-60. Field checked 1961
Polyconic projection. 1927 North American datum
10,000-foot grid based on Ohio coordinate system, south zone
1000-meter Universal Transverse Mercator grid ticks, zone 16, shown in blue
Red tint indicates areas in which only landmark buildings are shown
Land lines based on the Great Miami River Base
Areas covered by dashed light-blue pattern are subject to controlled inundation to 818 feet by Taylorsville Dam
Fine red dashed lines indicate selected fence and field lines where generally visible on aerial photographs. This information is unchecked

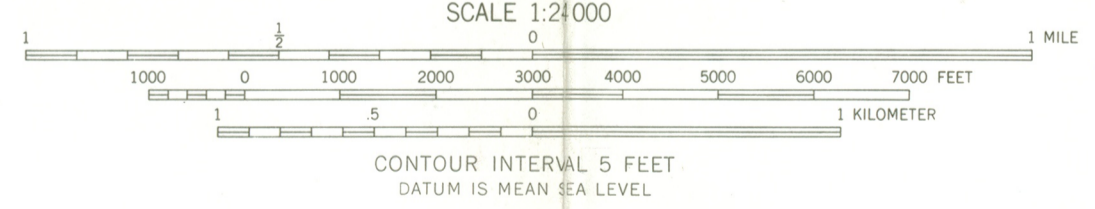
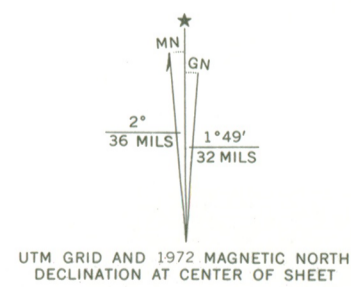

THIS MAP COMPLIES WITH NATIONAL MAP ACCURACY STANDARDS
FOR SALE BY U.S. GEOLOGICAL SURVEY, WASHINGTON, D. C. 20242
A FOLDER DESCRIBING TOPOGRAPHIC MAPS AND SYMBOLS IS AVAILABLE ON REQUEST



QUADRANGLE LOCATION
Revisions shown in purple compiled in cooperation with State of Ohio agencies from aerial photographs taken 1972. This information not field checked
Purple tint indicates extension of urban areas

ROAD CLASSIFICATION

Heavy duty	Light duty
Medium-duty	Unimproved dirt
Interstate Route	U. S. Route
	State Route

TROY, OHIO
N 4000—W 8407.5/7.5
1961
PHOTOREVISED 1972
AMS 4164 II SW—SERIES W852



ENTRIES IN THE NATIONAL REGISTER

STATE OHIO

Date Entered JUN 30 1975

Name

Location

Troy Public Square

Troy
Miami County

Also Notified

Hon. John H. Glenn, Jr.
Hon. Robert Taft, Jr.
Hon. Tennyson Guyer
Regional Director, Midwest Region

State Historic Preservation Officer
Dr. Thomas H. Smith
Director
The Ohio Historical Society
Interstate 71 at 17th Avenue
Columbus, Ohio 43211

PR MMott/row 7/11/75

NATIONAL REGISTER DATA SHEET

KP

1 NAME as it appears on federal register: Troy Public Square 2 OTHER NAMES:

3 date of entry: 6-30-75 4 county code: 109

5 LOCATION street & number: Property surrounding jct. of Main & Market Sts. Troy city / town: Troy vicinity of: OH state: MI county: Miami 6 NPS REGION: Midwest

7 OWNER: PRIVATE STATE MUNICIPAL COUNTY MULTIPLE FEDERAL (agency name) Public & Private 8 ADMINISTRATOR:

9 EXISTING SURVEYS: HABS HAER NHL 10 FUNDED? YES NO 11 CONGRESS. DISTRICT: 4 12 SOURCE OF NOMINATION: STATE FEDERAL

13 WITHIN NATIONAL REGISTER HISTORIC DISTRICT? YES NAME: Troy Public Sq. NO 14 WITHIN NATIONAL HISTORIC LANDMARK? YES NAME: NO 15 ACREAGE: 9.69 if state who prepared form? Loren J. Gannon LOCAL PRIVATE ORGANIZATION

16 CONDITION: deteriorated altered original site excellent ruins unaltered moved good unexposed reconstructed unknown fair unexcavated excavated

17 features: INTERIOR: SUBSTANTIALLY INTACT-1 NOT INTACT-0 UNKNOWN-4 NOT APPLICABLE-7 EXTERIOR: SUBSTANTIALLY INTACT-2 NOT INTACT-0 UNKNOWN-5 NOT APPLICABLE-8 ENVIRONS: SUBSTANTIALLY INTACT-3 NOT INTACT-0 UNKNOWN-6 NOT APPLICABLE-9

18 ACCESS: YES - Restricted YES - Unrestricted No Access Unknown 19 ADAPTIVE USE: YES NO 20 SAVED? YES NO IS PROPERTY A HISTORIC DISTRICT? yes no

21 AREAS OF SIGNIFICANCE: ARCHEOLOGY - prehistoric-2 COMMERCE-6 ENGINEERING-11 LANDSCAPE ARCH.-15 POLITICS / GOVT.-21 RECREATION-28 ARCHEOLOGY - historic-1 COMMUNICATIONS-7 ENTERTAINMENT-26 LAW-16 RELIGION-22 SETTLEMENT-29 AGRICULTURE-3 CONSERVATION-8 EXPLORATION-12 LITERATURE-17 SCIENCE-23 URBAN PLANNING-31 ARCHITECTURE-4 ECONOMICS-9 HEALTH-27 MILITARY-18 SOCIAL / HUMANITARIAN-24 OTHER (SPECIFY) History ART-5 EDUCATION-10 INDUSTRY-13 MUSIC-19 SOCIAL / CULTURAL-30 TRANSPORTATION-25

22 CLAIMS: explain 'first' 'oldest' 'only'

23 functions: WHEN HISTORICALLY SIGNIFICANT: Commercial district CURRENTLY: same 24 dates of initial construction: 19th - 20th C major alterations: historic events: creation of Miami Co., 1802 25 ETHNIC GROUP ASSOCIATION:

26 architectural style(s): mixed - 19th C 27 architect: 28 master builder: 29 engineer:

30 landscape architect / garden designer: 31 interior decorator: 32 artist: 33 artisan: 34 builder / contractor:

35 NAMES give role & date: PERSONAL: Andrew Wallace - planned town; grandfather of Gen. Lewis Wallace - who wrote Ben Hur EVENTS: INSTITUTIONAL:

36 NATIONAL REGISTER WRITE-UP

Town's commercial center - includes the predominantly brick, 2-3 story commercial structures surrounding a small park with fountain, originally the town square; notable are the recently renovated "Commercial Row" (c. 1839), the eclectic Kelly Building (1867), and Italianate and Second Empire Dunlap Building (1870's).
 Postal area of town created as seat of Miami County; commercial renovation is contemplated.