

United States Department of the Interior
National Park Service

National Register of Historic Places
Registration Form

1124

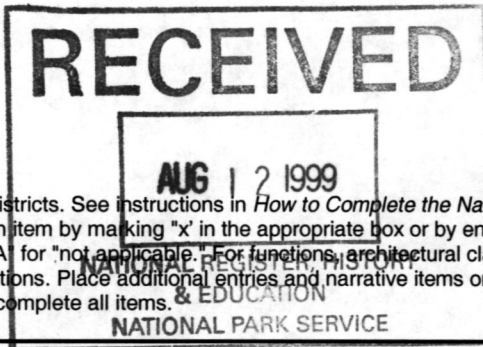

This form is for use in nominating or requesting determinations for individual properties and districts. See instructions in *How to Complete the National Register of Historic Places Registration Form* (National Register Bulletin 16A). Complete each item by marking "X" in the appropriate box or by entering the information requested. If an item does not apply to the property being documented, enter "N/A" for "not applicable." For functions, architectural classification, materials, and areas of significance, enter only categories and subcategories from the instructions. Place additional entries and narrative items on continuation sheets (NPS Form 10-900a). Use a typewriter, word processor, or computer, to complete all items.

1. Name of Property

historic name Tweddle Farmstead

other name/site number N/A

2. Location

street & town 263 Beaver Dam Road not for publication

city or town Montgomery vicinity

state New York code NY county Orange code 071 zip code 12549

3. State/Federal Agency Certification

As the designated authority under the National Historic Preservation Act, as amended, I hereby certify that this nomination request for determination of eligibility meets the documentation standards for registering properties in the National Register of Historic Places and meets the procedural and professional requirements set forth in 36 CFR Part 60. In my opinion, the property meets does not meet the National Register criteria. I recommend that this property be considered significant nationally statewide locally. (See continuation sheet for additional comments.)

[Signature]
Signature of certifying official/Title
Deputy Commissioner for Historic Preservation

2 August '99
Date

State of Federal agency and bureau

In my opinion, the property meets does not meet the National Register criteria. (See continuation sheet for additional comments.)

Signature of certifying official/Title

Date

State or Federal agency and bureau

4. National Park Service Certification

I hereby certify that the property is:

- entered in the National Register. See continuation sheet.
- determined eligible for the National Register See continuation sheet.
- determined not eligible for the National Register.
- removed from the National Register.
- other, (explain): _____

[Signature]
Signature of the Keeper
Edson H. Beall

Date of Action

9/9/99

Tweddles Farmstead
Name of Property

Orange County, New York
County and State

5. Classification

Ownership of Property
(check as many boxes as apply)

- public-local
- private
- public-State
- public-Federal

Category of Property
(check only one box)

- district
- building(s)
- site
- structure
- object

Number of Resources within Property
(Do not include previously listed resources in the count.)

Contributing	Noncontributing	
003		buildings
001		sites
001	004	structures
		objects
005	004	Total

Name of related multiple property listing
(Enter "N/A" if property is not part of a multiple property listing.)

N/A

Number of contributing resources previously listed in the National Register

N/A

6. Function or Use

Historic Function
(Enter categories from instructions)

Domestic/Single Dwelling
Agricultural

Current Function
(Enter categories from instructions)

Domestic/Single Dwelling
Agricultural

7. Description

Architectural Classification
(Enter categories from instructions)

Mid-19th Century/Greek Revival

Materials
(Enter categories from instructions)

foundation Stone
walls Wood
roof Asphalt shingles
other

Narrative Description

(Describe the historic and current condition of the property on one or more continuation sheets.)

*Tweddle Farmstead
Montgomery, Orange County*

**NATIONAL REGISTER OF HISTORIC PLACES
CONTINUATION SHEET**

Section number 7 Page 1

The Tweddle Farmstead occupies a 100-acre parcel of land on the eastern side of Beaver Dam Road in the developing southeastern section of the Town of Montgomery. Beaver Dam Road is characterized by farmland used for the planting of crops and the grazing of cows as well as sections that have been transformed into residential neighborhoods. Diagonally across the road is the Gideon Pelt on Farmstead, which is listed on the National Register and protected through the Farmland Protection Act. The Pelt on Farmstead includes an eighteenth century stone farmhouse that had been updated and expanded in the Greek Revival era.

The house and barns are set back from Beaver Dam Road and are sited within close proximity of each other. Beaver Dam Road marks the western boundary of the property and the topography from the road to the house and outbuildings is relatively level and then gently declines to Beaver Dam Brook which runs through the property. From the brook the landscape rises to Interstate Route 84, the eastern boundary of the property.

Surrounding the house are grassy lawns, which spread out to the springhouse and barns. Adjacent to the south wall of the house is a patio with pool and grill (one non-contributing structure). The buried ruins of what was once a workshop are located behind the house and are a contributing component of this nomination. A short distance to the east and adjacent to two small ponds is the stone springhouse (historic; contributing). North of the springhouse is the wagonhouse (historic; contributing) and a little further to the northeast is the barn (historic; contributing) along with three concrete silos (non-historic; non-contributing). Five large maple trees on the front lawn of the house also contribute to the setting of the house.

The heavy black outline on the attached county tax map identifies the boundaries of the nominated property. The boundary line coincides with the current legal boundaries of the Tweddle Farmstead holdings on the eastern side of Beaver Dam Road. This property is not located within an historic district.

Contributing buildings: 4
Contributing sites: 1
Non-contributing elements 4

The Tweddle Farmstead consists of a pioneer/Greek Revival era farmhouse, an assortment of aged maples on the front lawn of the house, a springhouse, wagonhouse, barn and buried foundation ruin on a one hundred acre tract located on the east side of Beaver Dam Road in the Town of Montgomery.

*Tweddle Farmstead
Montgomery, Orange County*

**NATIONAL REGISTER OF HISTORIC PLACES
CONTINUATION SHEET**

Section number 7 Page 2

The house, initially erected in the early 1800s and then remodeled and extended about 1830, is a one and a half story five-bay center hall structure with a one story rear wing attached to the rear portion of the major block. With the exception of the south half of the rear wing, the house rests on a raised stone foundation and both sections are surmounted by gable roofs. The main block contains a standing seam tin roof, which is pierced at the ridge on both gable ends by brick chimneys. Contemporary asphalt shingles cover the roof of the east gable, which is pierced at the ridge by a large chimney. A narrow twentieth century gable dormer protrudes from the center of the east face of the main block. The house primarily features one-over-one double hung sash windows, which are flanked by louvered shutters, all of which date to the later part of the Victorian era. Original clapboard siding is maintained in a fine state of preservation. The house contains one historic porch, which protects the front doorway.

The front of the house, which is, oriented westward displays a variety of design features associated with the Greek Revival era. Most indicative of this period is the front doorway. It contains a heavy six-paneled door which is flanked by a set of sidelights that are also flanked by a set of wide pilasters topped by square ornamental corner blocks with circular patterns cut out within the blocks interior. Above the door and sidelights is a transom and an ornamental rectangular block is incorporated into the molding centrally above the transom. Below each sidelight is a narrow recessed paneled field trimmed with simple molding. The transom and sidelights contained applied molding and decorative rosettes, which have been removed and are in the process of restoration.

Other Greek Revival period details include the square columns of the front porch and the block stone work of the front foundation wall.

Windows are symmetrically arranged on the front facade of the main block with two windows on each side of the main doorway. Fenestration on the south gable consists of four windows, two on the first floor, which are equally spaced from each corner and two smaller second floor windows which are a few feet closer to each other than those on the first. The north gable also contains four windows but in addition has a doorway. Like the south gable, the north contains two windows on the first floor and two on the second (at one time there were three windows on the second floor). A doorway trimmed in Greek Revival era molding is located adjacent to eastern most window. Fenestration on the rear wall of the main block and on the three walls of the rear wing are not symmetrical.

Other Greek Revival period details include the square columns of the front porch and the block stonework of the front foundation wall.

*Tweddle Farmstead
Montgomery, Orange County*

**NATIONAL REGISTER OF HISTORIC PLACES
CONTINUATION SHEET**

Section number 7 Page 3

Interior room configurations and nearly all-nineteenth century fabric survives. Woodwork in the halls along with the adjacent parlors is high Greek Revival in style. Front doorway moldings are identical on the interior with that already noted on the exterior with the exception that there is no ornamental rectangular block over the center of the transom. Architraves stretch from the floor to just below the ceiling and enclose a single paneled field below each window. The upper corners of the windows and doors in these rooms contain ornamental corner blocks. The parlor mantels contain two columns which support a wide entablature above which is a thick mantel shelf (the mantel from the south parlor--now the master bedroom--is currently stored in the basement). The chimney in the north parlor has a small warming cupboard with board and batten door. The south parlor contains a molded plaster cornice, which is in an excellent state of preservation. To the rear of the north parlor is a square hall or reception room, which contains simple step-down molding. A doorway in the hall opens to an enclosed stairway to the second floor.

It is theorized that when the main block of the house was built, it was intended at some future date, perhaps when money was available, to build a formal stairway to the second floor. This would explain why the end rooms on the second floor contain hand split lath in the plaster ceilings (as seen from the attic) and the middle room ceilings have the newer sawn lath.

Second floor woodwork is extremely plain and the early doorways contain board and batten doors.

The north portion of the rear block is said to date to the early part of the nineteenth century and served as the original dwelling. When the main block of the house was built, this dwelling may have been positioned on its present site. Family tradition holds that when the pioneer house was built, it had been moved in pieces from a nearby location.

The wing contains two hearths, one in the basement and one above in what today serves as a family room. The hearth in the basement once contained a crane and a beehive bake oven, which was replaced years ago with a window. The room above probably served as a dining room and a simple mantel surrounds the fireplace opening.

The house also retains a good portion of its original hardware including Greek Revival era box locks, brass doorknobs and escutcheon plates.

On the front lawn of the Tweddle Farmhouse are five large maples, which may have been planted when the main block of the house was built. East of the farmhouse is a buried foundation ruin of a workshop. A stone springhouse which dates to the later part of the nineteenth century is located east of the ruin. Northwest is the wagonhouse, which

*Tweddle Farmstead
Montgomery, Orange County*

**NATIONAL REGISTER OF HISTORIC PLACES
CONTINUATION SHEET**

Section number 7 Page 4

may date to the middle of the nineteenth century. It is sided with wide plank siding. Northeast of the wagonhouse is a large barn constructed in 1935 after the original barns were destroyed by fire. Two concrete silos are adjacent to the barn and date to the 1950s. A third silo is located south of the barn and dates to 1976.

8. Description

Applicable National Register Criteria

(Mark "x" in one or more boxes for the criteria qualifying the property for National Register listing.)

- A** Property is associated with events that have made a significant contribution to the broad patterns of our history.
- B** Property is associated with the lives of persons significant in our past.
- C** Property embodies the distinctive characteristics of a type, period, or method of construction or represents the work of a master, or possesses high artistic values, or represents a significant and distinguishable entity whose components lack individual distinction.
- D** Property has yielded, or is likely to yield, information important in prehistory or history.

Criteria Considerations

(Mark "x" in all the boxes that apply.)

Property is:

- A** owned by a religious institution or used for religious purposes.
- B** removed from its original location.
- C** a birthplace or grave.
- D** a cemetery.
- E** a reconstructed building, object, or structure.
- F** a commemorative property.
- G** less than 50 years of age or achieved significance within the past 50 years.

Narrative Statement of Significance

(Explain the significance of the property on one or more continuation sheets.)

Areas of Significance

(enter categories from instructions)

Architecture

Period of Significance

ca.1800-ca.1900

Significant Dates

ca.1800, ca.1830

Significant Persons

(Complete if Criterion B is marked above)
N/A

Cultural Affiliation

N/A

Architect/Builder

N/A

9. Major Bibliographical References

Bibliography

(Cite the books, articles, and other sources used in preparing this form on one or more continuation sheets.)

Previous documentation on file (NPS):

- preliminary determination of individual listing (36 CFR 67) has been requested
- previously listed in the National Register
- previously determined eligible by the National Register
- designated a National Historic Landmark
- recorded by Historic American Buildings Survey # _____
- recorded by Historic American Engineering Record # _____

Primary location of additional data:

- State Historic Preservation Office
- Other State agency
- Federal agency
- Local government
- University
- Other Name of repository: _____

*Tweddle Farmstead
Montgomery, Orange County*

**NATIONAL REGISTER OF HISTORIC PLACES
CONTINUATION SHEET**

Section number 8 Page 1

The Tweddle Farmstead is a fine example of survival in the Town of Montgomery. The farmhouse is architecturally significant as an intact example of Greek Revival detailing. Its significance is enhanced by the accompanying farm related out buildings and landscape features. As a collective unit, these resources reflect the Town's development as a prosperous rural agrarian community and are likely to yield information on the agricultural practices of the Walkill and lower Hudson Valley regions.

Bergoon Van Alst and his wife, Jane, settled on the Tweddle Farmstead early in the nineteenth century. Tweddle family tradition holds that Bergoon constructed the small rear wing of the dwelling from lumber taken from a nearby home which stood on a hill where Interstate Route 84 cuts through today. In April of 1829 Bergoon sold the house and 115 acres to George Van Alst and moved to a farm in the northwestern corner of the Town of Montgomery which was recently placed on the National Register (Dickerson Hills Farm). Shortly after George took title, he constructed the spacious front block of the house. The veil of time has forever concealed Van Alst's intentions but it is thought that when his home was built, he did not have the money to finish the second floor or put in a formal center hall staircase with hard wood banister, spindles, and newel posts. This explains why the central hall lacks a staircase and why the second floor gable rooms were finished first leaving the central section open to the attic crawl space. Whatever his intentions at the time, a formal staircase was never built and the central portion of the second floor was finished into rooms in the Victorian era.

In February of 1868, the farm was sold to Thomas Tweddle of New York City for \$15,000. Thomas was successful in the soda and mineral water business and tradition holds that he purchased the farm for his son John, so as to remove him from the city environment. Two months prior John married Phoebe Comfort, a local girl and less than a year later Harry, their first of four children was born. Around this time the Montgomery and Erie Railroad cut through the property on the west side of Beaver Dam Road thus increasing the value of the surrounding farmland.

John may have been responsible for the construction of the large barn with cupola, which stood adjacent to an earlier barn that probably, dated to George Van Alst's ownership.

Harry gained ownership of the farm around the turn of the century and it was probably at this time that window sashes were replaced with the more fashionable one-over-ones and the unfinished rooms on the second floor were completed. During Harry's tenure the original barns were destroyed by fire and replaced with the present barn. The current owners built the silos.

As previously noted, the Tweddle Farmstead embodies a variety of design features associated with the Greek Revival era. These include the front and side doorways, the cut stonework of the front foundation wall, the parlor mantelpieces, the molded plaster cornice of the south parlor, and woodwork of the first floor of the main block. Similar features can be found in a handful of properties around the Town of Montgomery. The front doorway bears many similarities to that at the Gideon Pelton Farmhouse on Rockefeller Lane and of the Brach Farmhouse on River Road. Interior first

*Tweddle Farmstead
Montgomery, Orange County*

**NATIONAL REGISTER OF HISTORIC PLACES
CONTINUATION SHEET**

Section number 8 Page 2

floor finishes are also similar to that at the Tweddle Farmhouse. Interior parlor moldings and mantels are nearly identical to those of the nearby Weed Farmhouse, which was abandoned and then destroyed by fire in 1990. The cut stonework of the foundation at the Weed Farmhouse was also similar to that at Tweddles.

*Tweddle Farmstead
Montgomery, Orange County*

**NATIONAL REGISTER OF HISTORIC PLACES
CONTINUATION SHEET**

Section number 9 Page 1

Bibliography

- Beers, F.W., County Atlas Of Orange New York. Chicago, Ill.: Andteas, Baskin & Burr, 1875.
- Beers, S.N., French, F.F., Wood, W.E., Map of Orange And Rockland Co's New York. Philadelphia, PA. Corey & Bachman, 1859.
- Eager, Samuel W., An Outline History Of Orange County. Newburgh, N.Y.:S.T. Callahan, 1846-7.
- Eurlch, Robert C. and Willlams, Robert L., Old Houses Of Hanover. Middletown, N.Y.: Town of Montgomery, 1994.
- Hughes, Michael, Farm Map Of The Town Of Montgomery Orange Co., Philadelphia, PA. 1862.
- Ms. Deed, Bergoon Van Alst and wife to George Van Alst, in the possession of Mr. and Mrs. Robert K. Tweddle, Beaver Dam Road, Montgomery, N.Y., April 1, 1829.
- Ms. Deed, Edward Harvey Genung and others to Harry Tweddle, Orange County Hall of Records, Goshen, N.Y., 1899 (Liber 441, page 523).
- Ms. Deed, George Van Alst to Thomas B. Tweddle, Orange County Hall of Records, Goshen, N.Y., 1868 (Book 206, page 276).
- Ms. Deed, Homer Ramsdell and wife and Mary L. Powell to George Van Alst, Orange County Hall of Records, Goshen, N.Y., 1861 (Book 206, page 275).
- Ms. Mortgage, Edward Harvey Genung, Mary Elizabeth Genung, Frederick M. Genung and Ella Genung to J.B. Tuthill, Orange County Hall of Records, Goshen, N.Y., 1895 (Liber 358, page 287).
- Ms. Mortgage, Harry Tweddle and wife to The Columbus Trust Company, Orange County Hall of Records, Goshen, N.Y., 1905 (Liber 411, page 509).
- Ms. Mortgage, Robert K. Tweddle and Dorothy L. Tweddle to United States of America, Orange County Hall of Records, Goshen, N.Y. 1955 (Liber 1137, page 13).
- Ruttenber, E.M. and Clark, L.H., History Of Orange County, New York, Philadelphia, PA.: Everts and Peck, 1881.
- Tweddle, Mr. and Mrs. Robert, interviewed by Robert L. Willlams, Tweddle Farmstead, Beaver Dam Road, Montgomery, N.Y., 1999.

Tweddles Farmstead
Name of Property

Orange County, New York
County and State

10. Geographical Data

Acreage of Property 167 acres

UTM References

(Place additional boundaries of the property on a continuation sheet.)

1 18 564901 4595218
Zone Easting Northing

2 18 564593 4594839
Zone Easting Northing

3 18 563960 4595015
Zone Easting Northing

4 18 564077 4595526
Zone Easting Northing

See continuation sheet

Verbal Boundary Description

(Describe the boundaries of the property on a continuation sheet.)

Boundary Justification

(Explain why the boundaries were selected on a continuation sheet.)

11. Form Prepared By

name/title Robert L. Williams
organization Historian, Town of Montgomery date May 11, 1999
street & number 67 Union Steet telephone 518-457-1567
city or town Montgomery state NY zip code 12549

Additional Documentation

Submit the following items with the completed form:

Continuation Sheets

Maps

- A **USGS map** (7.5 or 15 minute series) indicating the property's location.
- A **Sketch map** for historic districts and properties having large acreage or numerous resources.

Photographs

Representative black and **white photographs** of the property.

Additional items

(Check with the SHPO or FPO for any additional items)

Property Owner

(Complete this item at the request of SHPO or FPO.)

name/title R & D Tweddle
street & number 263 Beaver Dam Road telephone n/a
city or town Montgomery state NY zip code 12549

Paperwork Reduction Act Statement: This information is being collected for applications to the National Register of Historic Places to nominate properties for listing or determine eligibility for listing, to list properties, and to amend existing listings. Response to this request is required to obtain a benefit in accordance with the National Historic Preservation Act, as amended (16 U.S.C. 470 *et seq.*).

Estimated Burden Statement: Public reporting burden for this form is estimated to average 18.1 hours per response including time for reviewing instructions, gathering and maintaining data, and completing and reviewing the form. Direct comments regarding this burden estimate or any aspect of this form to the Chief, Administrative Services Division, National Park Service, P.O. Box 37127, Washington, DC 20013-7127; and the Office of Management and Budget, Paperwork Reductions Projects (1024-0018), Washington, DC 20503.

*Tweddle Farmstead
Montgomery, Orange County*

**NATIONAL REGISTER OF HISTORIC PLACES
CONTINUATION SHEET**

Section number 10 Page 1

10. Geographical Data

UTM References (continued)

5. 18 564150 4595498
6. 18 564496 4595288
7. 18 564676 4595385

Verbal Boundary Description

The boundary for the nominated property is shown as the heavy black outline on the accompanying Town of Rochester Tax Map entitled **Tweddle Farm, Montgomery, Orange County, New York.**

Boundary Justification

The boundary for the nomination has been drawn to coincide with the current legal lot for the property.

Tweddle Farmstead
Montgomery, Orange County

**NATIONAL REGISTER OF HISTORIC PLACES
CONTINUATION SHEET**

Section number Photographs

Tweddle Farmstead

Montgomery, Orange County

Photo by: Robert L. Williams, June, 1999

Town Historian, 67 Union Street, Montgomery, NY

Neg. at: NYS OPRHP, P.O. Box 189, Waterford, NY

Photographs

1. East facade
2. Entrance detail (east facade)
3. North elevation
4. Basement entry (west elevation)
5. Interior detail
6. Interior detail
7. Interior detail
8. Barn and n/c silos
9. Wagon barn



Tweddle Farmstead
Montgomery, Orange County

NATIONAL REGISTER OF HISTORIC PLACES
CONTINUATION SHEET

Section number MAP

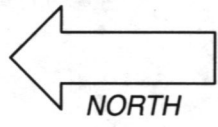
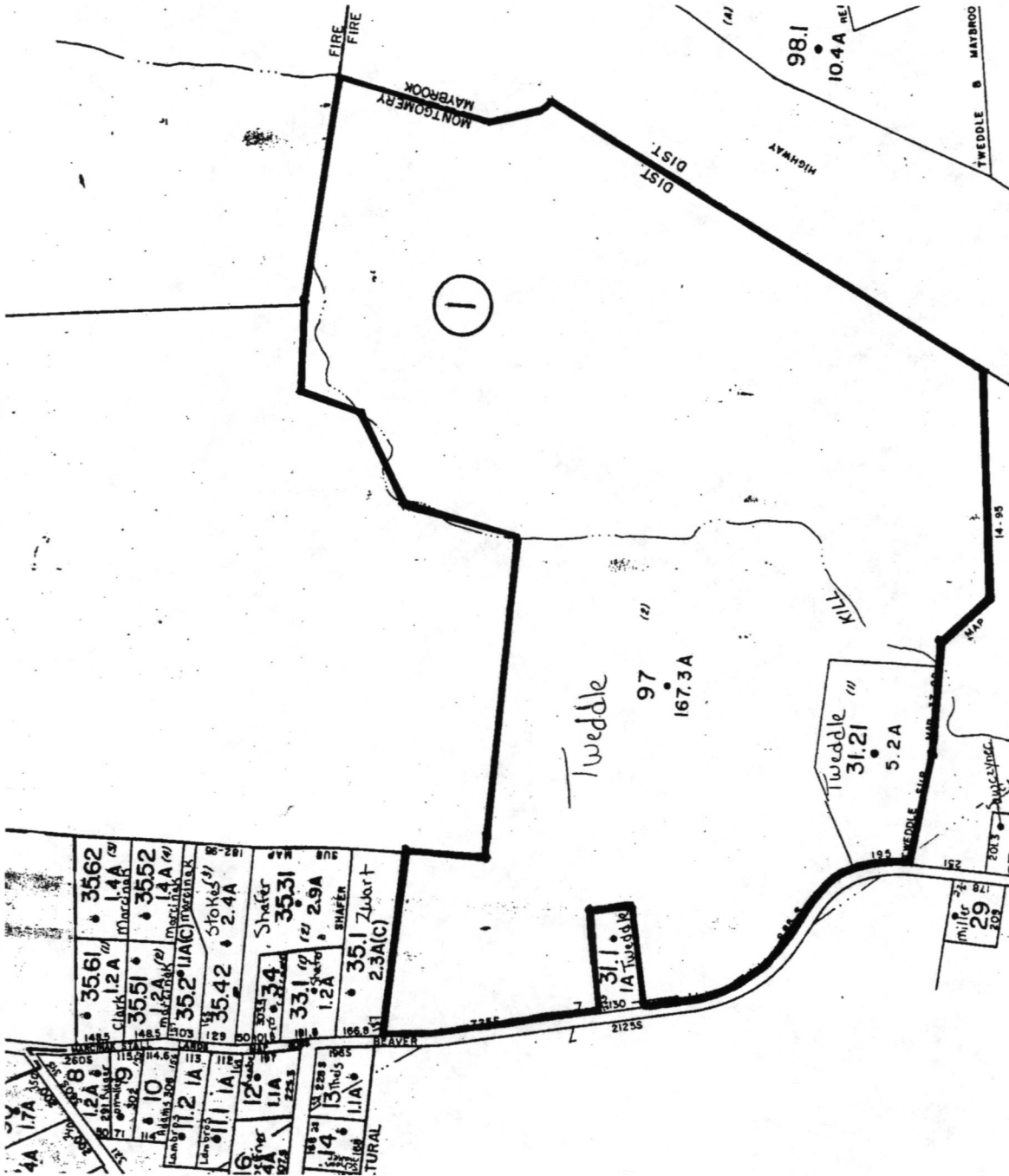
Tweddle Farmstead
Montgomery, Orange County, New York



scale 1 inch equals 582 feet
 boundary 
 photo key 

Tweddle Farmstead
Montgomery, Orange County

NATIONAL REGISTER OF HISTORIC PLACES
CONTINUATION SHEET

Section number MAP

Tweddle Farmstead
Montgomery, Orange County, New York
SITE PLAN

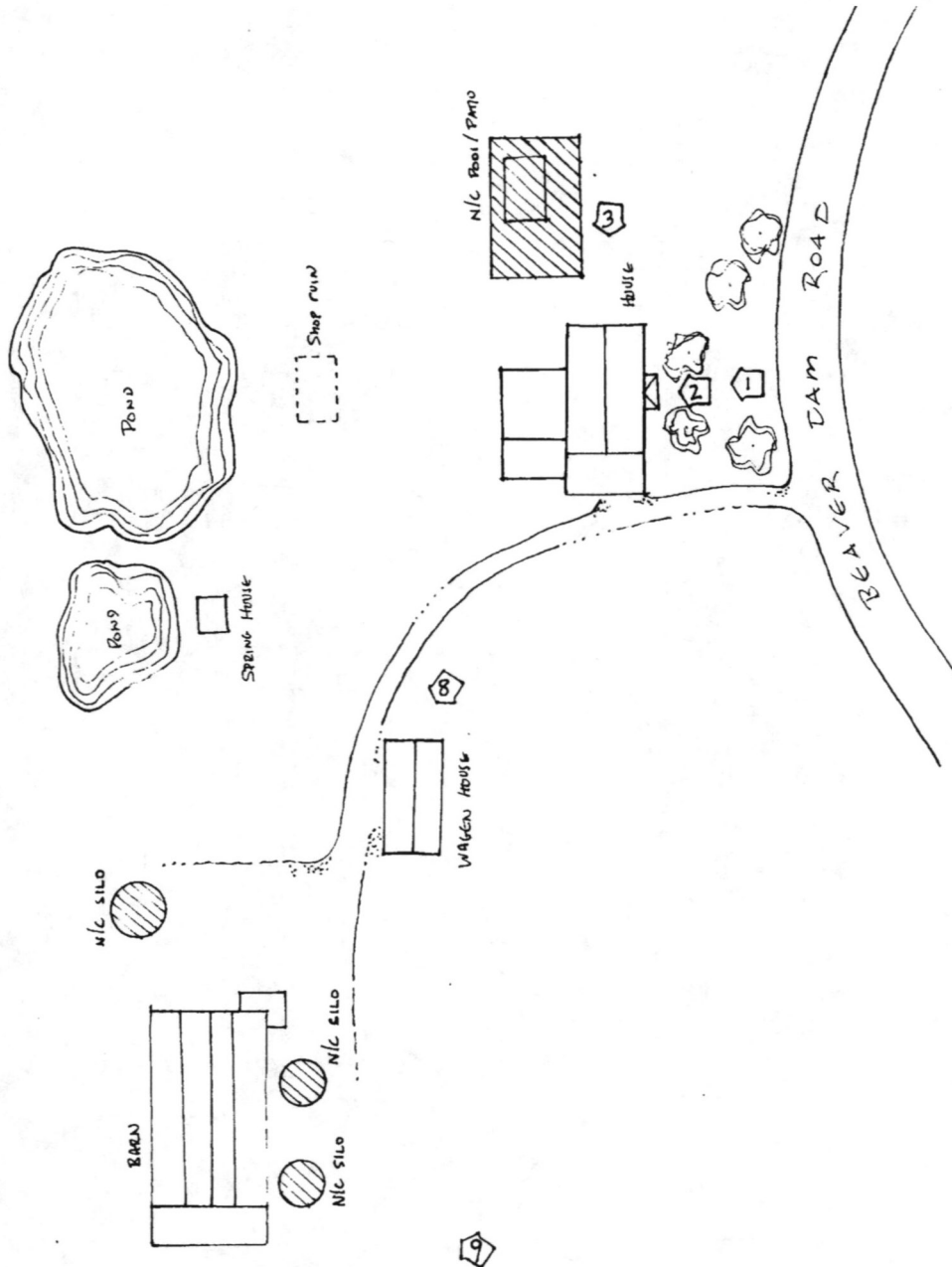

UNITED STATES DEPARTMENT OF THE INTERIOR
NATIONAL PARK SERVICE

NATIONAL REGISTER OF HISTORIC PLACES
EVALUATION/RETURN SHEET

REQUESTED ACTION: NOMINATION

PROPERTY Tweddle Farmstead
NAME:

MULTIPLE
NAME:

STATE & COUNTY: NEW YORK, Orange

DATE RECEIVED: 8/12/99 DATE OF PENDING LIST: 8/24/99
DATE OF 16TH DAY: 9/09/99 DATE OF 45TH DAY: 9/26/99
DATE OF WEEKLY LIST:

REFERENCE NUMBER: 99001134

REASONS FOR REVIEW:

APPEAL: N DATA PROBLEM: N LANDSCAPE: N LESS THAN 50 YEARS: N
OTHER: N PDIL: N PERIOD: N PROGRAM UNAPPROVED: N
REQUEST: N SAMPLE: N SLR DRAFT: N NATIONAL: N

COMMENT WAIVER: N

ACCEPT RETURN REJECT 9/9/99 DATE

ABSTRACT/SUMMARY COMMENTS:

RECOM./CRITERIA _____

REVIEWER _____ DISCIPLINE _____

TELEPHONE _____ DATE _____

DOCUMENTATION see attached comments Y/N see attached SLR Y/N



Tweddle Farm

Montgomery, Orange Co.

Photo 1



1
Tweedle Faem
Montgomery, Orange Co.
Photo 2



Tweddle Faem
Montgomery, Orange Co
Photo 3



Tweddle Farm
Montgomery, Orange Co.
Photo 4



Tweddle Farm
Montgomery, Orange Co.
Photos



Tweddle Farm
Montgomery, Orange Co.
Photo 6



Tweddle Farm
Montgomery, Orange Co.
Photo 7



Tweddle Farm
Montgomery, Orange C.
Photo 8



Tweddle Farm
Montgomery, Orange Co.
Photo 9



*Twiddle From
Montgomery, Orange Co.
Walden Quad
Zone 18 Scale 1:24,000*

- 564901 4595218
- 564953 4594839
- 564960 4595015
- 564977 4595226
- 564980 4595498
- 564996 4595298
- 564976 4595385

Published by the New York State Department of Transportation, in cooperation with the U.S. Department of Transportation, Federal Highway Administration.

Map base from 1957 U.S. Geological Survey 7.5-minute quadrangle.

Map revisions made using aerial photographs dated 1990, construction plans, official records and other sources. Features revised include: highways and other transportation facilities; civil and public land boundaries; recreation sites; hydrography; and buildings. Gray tint indicates developed areas in which only landmark buildings are shown. Darker gray tint indicates open water features.

Revisions may not comply with National Map Accuracy Standards.

Correspondence concerning this and other Department of Transportation maps should be directed to: Map Information Unit, New York State Department of Transportation, State Campus, Building 4, Room 105, Albany, New York 12232.

Revisions by E.A. Herman

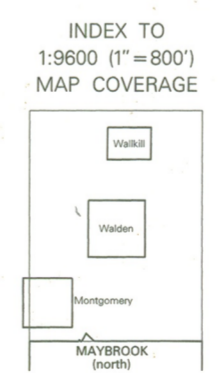
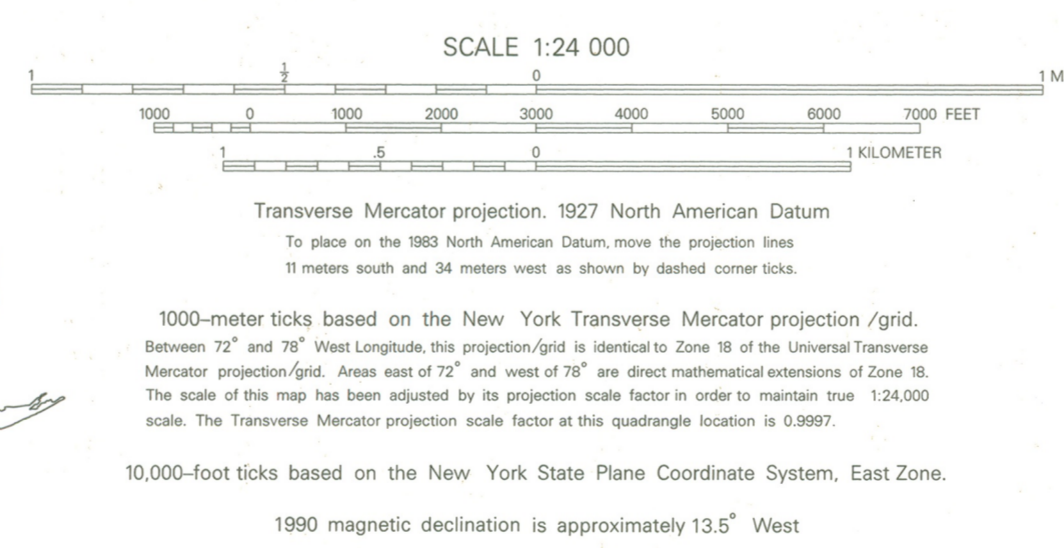

BOUNDARIES:

- State
- County
- Town or City
- Incorporated Village
- State / Federal Land

ROADS:

- Posted Touring Route
- Interstate
- U.S.
- State
- County
- State Highway (SH) number and limit
- County road
- Interchange number
- Divided
- Wide mall
- Narrow mall or barrier
- Undivided
- 4 or more lanes
- Less than 4 lanes
- Vehicle track; trail



GOVERNMENT CENTER
TOWN OF MONTGOMERY

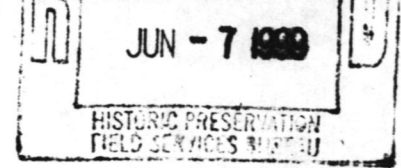

OFFICE OF SUPERVISOR

Carl Helstrom, Supervisor
110 Bracken Road
Montgomery, N.Y. 12549
Tel: 914-457-2600
Fax: 914-457-2603

June 3, 1999

Ms. Ruth L. Pierpont, Director
Historic Preservation Field Services Bureau
NYS Office of Parks, Recreation and Historic Preservation
Peebles Island
P.O. Box 189
Waterford, New York 12188-0189

RE: Tweddles Farmhouse
Montgomery, Orange County

Dear Ms. Pierpont:

This is to confirm the Town of Montgomery Town Board's whole hearted support of the proposed designation of Tweddles Farmhouse to the National and State Registers of Historic Places as mentioned in your letter dated May 18, 1999.

Sincerely,

Carl Helstrom
Supervisor

CH/dl