

UNITED STATES DEPARTMENT OF THE INTERIOR  
NATIONAL PARK SERVICE  
NATIONAL REGISTER OF HISTORIC PLACES  
REGISTRATION FORM

This form is for use in nominating or requesting determinations for individual properties or districts. See instructions in How to Complete the National Register of Historic Places Registration Form (National Register Bulletin 16A). Complete each item by marking "x" in the appropriate box or by entering information requested. If an item does not apply to the property being documented, enter "N/A" for "not applicable." For functions, architectural classifications, materials, and areas of significance, enter only categories and subcategories from the instructions. Place additional entries and narrative items on continuation sheets (NPS Form 10-900a). Use a typewriter, word processor, or computer, to complete all items.

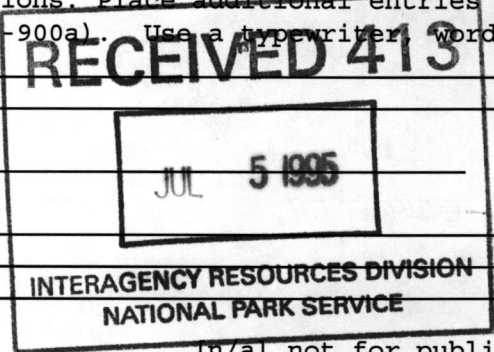

1. Name of Property

historic name The Hornbeck Stone House

other names/site number n/a

2. Location

street & number 149 Whitfield Road

[n/a] not for publication

city, town Rochester

[n/a] vicinity

state New York code NY county Ulster code 111 zip code 12404

3. State/Federal Agency Certification

As the designated authority under the National Historic Preservation Act of 1966, as amended, I hereby certify that this  nomination  request for determination of eligibility meets the documentation standards for registering properties in the National Register of Historic Places and meets the procedural and professional requirements set forth in 36 CFR Part 60. In my opinion, the property  meets  does not meet the National Register criteria. I recommend that this property be considered significant  nationally  statewide  locally. ([ ] See continuation sheet for additional comments.)

J.W. Alden  
Deputy Commissioner for Historic Preservation  
Signature of certifying official

26 June '95  
Date

State or Federal agency and bureau

In my opinion, the property  meets  does not meet the National Register criteria. ([ ] See continuation sheet for additional comments.)

Signature of commenting or other official

Date

State or federal agency and bureau

4. National Park Service Certification

- I hereby, certify that this property is:
- entered in the National Register.
- See continuation sheet.
- determined eligible for the National Register.  see continuation sheet.
- determined not eligible for the National Register.
- removed from the National Register.
- other, (explain:)

for  
Signature of keeper Edson H. Beall Date of Action 8-10-95  
Entered in the National Register  
Entered in the National Register

The Hornbeck Stone House

Ulster County, New York

Name of Property

County and State

**5. Classification**

<b>Ownership of Property</b> (Check as many boxes as apply)	<b>Category of Property</b> (check only one box)	<b>Number of Resources within Property</b> (do not include previously listed resources in the count)
----------------------------------------------------------------	-----------------------------------------------------	---------------------------------------------------------------------------------------------------------

<input checked="" type="checkbox"/> private <input type="checkbox"/> public-local <input type="checkbox"/> public-State <input type="checkbox"/> public-Federal	<input checked="" type="checkbox"/> building(s) <input type="checkbox"/> district <input type="checkbox"/> site <input type="checkbox"/> structure <input type="checkbox"/> object	<table border="0"> <tr> <td style="text-align: center;">Contributing</td> <td style="text-align: center;">Noncontributing</td> <td></td> </tr> <tr> <td style="text-align: center;">1</td> <td style="text-align: center;">3</td> <td style="text-align: right;">buildings</td> </tr> <tr> <td></td> <td></td> <td style="text-align: right;">sites</td> </tr> <tr> <td></td> <td></td> <td style="text-align: right;">structures</td> </tr> <tr> <td></td> <td></td> <td style="text-align: right;">objects</td> </tr> <tr> <td style="text-align: center;">1</td> <td style="text-align: center;">3</td> <td style="text-align: right;">Total</td> </tr> </table>	Contributing	Noncontributing		1	3	buildings			sites			structures			objects	1	3	Total
Contributing	Noncontributing																			
1	3	buildings																		
		sites																		
		structures																		
		objects																		
1	3	Total																		

<b>Name of related multiple property listings</b> (enter "N/A" if property is not part of a multiple property listing)	<b>Number of contributing resources previously listed in the National Register</b>
------------------------------------------------------------------------------------------------------------------------	------------------------------------------------------------------------------------

<b>The Historic and Architectural Resources of the Town of Rochester, Ulster County, New York</b>	<u>n/a</u>
---------------------------------------------------------------------------------------------------	------------

**6. Function or Use**

**Historic Function**  
(enter categories from instructions)

DOMESTIC/single dwelling

DOMESTIC/secondary structure

\_\_\_\_\_

\_\_\_\_\_

\_\_\_\_\_

\_\_\_\_\_

**Current Functions**  
(enter categories from instructions)

DOMESTIC/single dwelling

DOMESTIC/secondary structure

\_\_\_\_\_

\_\_\_\_\_

\_\_\_\_\_

\_\_\_\_\_

**7. Description**

**Architectural Classification**  
(enter categories from instructions)

OTHER/vernacular

\_\_\_\_\_

\_\_\_\_\_

**Materials**  
(enter categories from instructions)

foundation Stone

walls Stone

roof Wood shingles

other \_\_\_\_\_

\_\_\_\_\_

**Narrative Description**

(describe the historic and current condition of the property on one or more continuation sheets.)

United States Department of the Interior  
National Park Service

The Hornbeck Stone House  
Rochester, Ulster County, New York

NATIONAL REGISTER OF HISTORIC PLACES  
CONTINUATION SHEET

Section number 7 Page 2



The Hornbeck house is located in a rural setting in the town of Rochester, Ulster County, New York. The property is on the east side of Upper Whitfield Road about one mile west of the eastern intersection with Bakertown Road. The nominated property sits upon an irregularly shaped 11.3 acre parcel of land that is bounded on the west by Whitfield Road, on the north by a small residential lot, and to the south and east by overgrown former fields. The property is bisected by the North Peterskill which runs behind (east) the house in a small gully south towards the Rondout. Abutting the property to the northeast, high on a sandy knoll directly behind the house and the stream, is the historic Whitfield Cemetery and a short stretch of Airport Road. The property is surrounded by limited development dating mostly from the nineteenth century. Directly across the road from the house to the northwest is a small farm with an historic lime kiln. This house is one of three historic stone dwellings in the immediate vicinity of the Whitfield Cemetery. The house is approached by a driveway from the south, off Whitfield Road. The front (west) facade of the stone house is highly visible from the road. The property also contains three non-contributing buildings (a ca. 1930 chicken coop, a twentieth century, one-story garage and a small one-story frame shed).

The vernacular **Hornbeck house** is a one-and-one-half story stone dwelling built upon a rectangular plan in two sections. The single-room section to the south is one bay wide and appears to have been added to an earlier original three bay section to the north. The larger north section includes an undivided room with a central interior hearth and chimney at each gable end (the original south end now being within the house). The stone wall of the earlier original south gable end divides the two sections of the house. There is no apparent hearth or chimney at the later south gable end. There are two present entries to the house. One is along the front (west) facade north of center on the larger house section. The other is on the south gable end near the west corner. A former third entry is apparent at the southern-most window on the front facade. Seams in the stonework indicate that the opening for this window was raised after the original construction from floor level to its current height. The windows are all twentieth-century replacements having mostly two-over-two sash. The south and west facades are covered by a wrap-around porch on battered pillars from the early twentieth century. Major renovations were done beginning ca. 1993. Since then, a section of the porch along the west half of the south facade was removed and three evenly spaced shed-roofed dormers were created from a central three-quarter width dormer from the early twentieth century. The new dormers cap the front gable roof with a single window unit in the middle and a pair of double units to each side. The gable end walls have stonework up to the level of the second floor ceiling with clapboard above to the ridge. The south-facing gable-end door abuts a full-size ground floor window which might be interpreted as a sidelight.

The Hornbeck house is similar to four other stone houses in Rochester that have a single sidelight beside the front door. Of these five, only one other (# 54, the Markle

United States Department of the Interior  
National Park Service

The Hornbeck Stone House  
Rochester, Ulster County, New York

NATIONAL REGISTER OF HISTORIC PLACES  
CONTINUATION SHEET

Section number 7 Page 3

---

house[1]) has an operable double hung sash, the remaining three (# 11 the Rider house, # 40 the Osterhoudt house, and # 49 the Baker house) have fixed sash for providing light only. The large size of this window adjacent to the door precludes its description as a sidelight but its function is the same. The sidelight in each house illuminates an otherwise dark foyer or hall separated by partitions from the main rooms. The smaller single light most likely reflects a modest household without significant means to pay for a more elaborate and formal entry as is seen in many of the other local stone houses. The larger opening here may be an expansion of an earlier and smaller sidelight similar to those found elsewhere, but viewed as inadequate by the occupant.

---

1. These numbers reference entries in the *The Historic and Architectural Resources of the Town of Rochester, Ulster County, New York* (see Appendix A) ..

Name of Property

County and State

8. Statement of Significance

Applicable National Register Criteria

(Mark an "x" in one or more boxes for the criteria qualifying the property for National Register listing.)

- [ ] A Property is associated with events that have made a significant contribution to the broad patterns of our history.
[ ] B Property is associated with the lives of persons significant in our past.
[X] C Property that embodies the distinctive characteristics of a type, period, or method of construction or represents the work of a master, or possesses high artistic values, or represents a significant and distinguishable entity whose components lack individual distinction.
[ ] D Property has yielded, or is likely to yield, information important in pre-history or history.

Area of Significance

(Enter categories from instructions.)

Architecture

Period of Significance

ca.1750

Significant Dates

ca.1750

Criteria Considerations

(Mark "X" in all the boxes that apply.)

- [ ] A owned by a religious institution or used for religious purposes.
[ ] B removed from its original location.
[ ] C a birthplace or grave.
[ ] D a cemetery.
[ ] E a reconstructed building, object or structure.
[ ] F a commemorative property.
[ ] G less than 50 years of age or achieved significance within the past 50 years.

Significant Person

(Complete if Criterion B is marked above.)

n/a

Cultural Affiliation

n/a

Architect/Builder

n/a

Narrative Statement of Significance

(Explain the significance of the property on one or more continuation sheets.)

9. Major Bibliographical References

Bibliography

(Cite the books, articles, and other sources used in preparing this form on one or more continuation sheets.)

Previous documentation on file (NPS): Primary location of additional data:

- [ ] preliminary determination of individual listing (36 CFR 67) has been requested [X] State historic preservation office
[ ] previously listed in the National Register [ ] Other State agency
[ ] previously determined eligible by the National Register [ ] Federal agency
[ ] designated a National Historic Landmark [ ] Local government
[ ] recorded by Historic American Building Survey # [ ] University
[ ] recorded by Historic American Engineering Record # [ ] Other

Name of repository:

United States Department of the Interior  
National Park Service

The Hornbeck Stone House  
Rochester, Ulster County, New York

NATIONAL REGISTER OF HISTORIC PLACES  
CONTINUATION SHEET

Section number 8 Page 2

---

The Hornbeck house is significant as an outstanding regional example of a mid-eighteenth-century stone dwelling architecture. This vernacular house is historically and architecturally significant as an example of the linear stone dwelling house architecture typically found in the Hudson Valley region and in Ulster County, New York. [2] The characteristic features of this style include stone construction, multiple asymmetrical entrances, and a simple gable roof. Early nineteenth-century modifications that include eyebrow windows are also typical of that period. This house is one of seventy-one stone or brick houses (both former and existing) identified in Rochester which were built before 1944; sixty-four were built before 1850 and of these fifty-six are extant. The linear one and one-half story stone house was the predominant form of stone dwelling architecture in Ulster County, and in the town of Rochester from the late seventeenth century until the mid nineteenth century.

The Hornbeck house with its intact stone house and setting remains a rare surviving example of the subsistence farming household in the upland areas of Ulster County. Despite alterations to the dwelling over the past two centuries, the building nevertheless remains an important local landmark that recalls the early development of this area of Ulster County.

---

2. See the multiple property registration document titled, *The Historic and Architectural Resources of the Town of Rochester, Ulster County, New York*, Section F, Property Type 1, Residential Architecture.

**10. Geographical Data**

**Acreage of property** 11.3 acres

**UTM References**

(Place additional UTM references on a continuation sheet.)

1	1 8	5 6 4 7 6 3	4 6 2 9 5 4 6	2	1 8	5 6 4 7 0 6	4 6 2 9 4 6 7
	Zone	Easting	Northing		Zone	Easting	Northing
3	1 8	5 6 4 5 0 9	4 6 2 9 4 7 5	4	1 8	5 6 4 5 7 7	4 6 2 9 6 3 8
	Zone	Easting	Northing		Zone	Easting	Northing
5	1 8	5 6 4 7 6 9	4 6 2 9 6 2 2	6			
	Zone	Easting	Northing		Zone	Easting	Northing

**Verbal Boundary Description**

(Explain the boundaries of the property on a continuation sheet.)

**Boundary Justification**

(Explain why the boundaries were selected on a continuation sheet.)

**11. Form Prepared By**

name/title Harry Hansen (edited by: J.A. Bonafide, Program Analyst, NYSOPRHP)  
organization Kyserike Restorations, Inc date April, 1995  
street & number 2545 Lucas Turnpike telephone (914) 687-0854  
city or town High Falls state NY zip code 12440

**Additional Documentation**

Submit the following items with the completed form:

**Continuation Sheets**

**Maps**

- A **USGS map** (7.5 or 15 minute series) indicating the property's location.
- A **Sketch map** for historic districts and properties having large acreage or numerous resources.

**Photographs**

Representative **black and white photographs** of the property.

**Additional items**

(check with the SHPO or FPO for any additional items)

**Property Owner**

(Complete this item at the request of SHPO or FPO.)

name n/a  
street & number \_\_\_\_\_  
city or town \_\_\_\_\_ state \_\_\_\_\_ zip code \_\_\_\_\_

**Paperwork Reduction Act Statement:** This information is being collected for applications to the National Register of Historic Places to nominate properties for listing or determine eligibility for listing, to list properties, and to amend existing listings. Response to this request is required to obtain a benefit in accordance with the National Historic Preservation Act, as amended (16 U.S.C. 470 et seq.).

**Estimated Burden Statement:** Public reporting burden for this form is estimated to average 18.1 hours per response including the time for reviewing instructions, gathering and maintaining data, and completing and reviewing the form. Direct comments regarding this burden estimate or any aspect of this form to the Chief, Administrative Services Division, National Park Service, P.O. Box 37127, Washington, DC 20013-7127; and the Office of Management and Budget, Paperwork Reductions Project (1024-0018), Washington, DC 20503.

United States Department of the Interior  
National Park Service

The Hornbeck Stone House  
Rochester, Ulster County, New York

NATIONAL REGISTER OF HISTORIC PLACES  
CONTINUATION SHEET

Section number 9 Page 2

---

### 9. Major Bibliographical References

Early Architecture in Ulster County. Kingston, N.Y.: Junior League of Kingston, N.Y., Inc. 1974.

Benepe, Barry, ed. *Early Architecture in Ulster County.* Kingston, N.Y.: Junior League of Kingston, 1974.

Hansen, Harry. *Town of Rochester, Ulster County, New York: Historic Resources Reconnaissance Survey.* Report to the Town of Rochester Historic Preservation Commission, Accord, New York, 1993.

Hansen, Harry. "Town of Rochester, Ulster County, New York Historic Resources Reconnaissance Survey." Report presented to the Town of Rochester Historic Preservation Commission, Rochester, New York, 1993.

Larsen, Neil. "The Masonry Architecture of Ulster County, New York: An Evolution 1665-1935." Essays presented to meeting of the Vernacular Architecture Forum, Kingston, New York, 7-10 May 1986.

Piwonka, Ruth. "Town of Marbletown Ulster County, New York Historic Resources Reconnaissance Survey." Report presented to the Town of Marbletown Historic Preservation Commission, Rochester, New York, 1993.

Reynolds, Helen Wilkinson. Dutch Houses in the Hudson Valley Before 1776. New York: Payson and Clarke, 1929: reprint ed., New York: Dover Publications, 1965.

Teller, Myron S. *The Early Stone Houses of Ulster County, New York.* Kingston, N. Y.: Ulster County Historical Society, 1959.

United States Department of the Interior  
National Park Service

The Hornbeck Stone House  
Rochester, Ulster County, New York

NATIONAL REGISTER OF HISTORIC PLACES  
CONTINUATION SHEET

Section number 10 Page 2

---

#### **10. Geographical Data**

##### **Verbal Boundary Description**

The boundary for the nominated property is shown as the heavy black outline on the accompanying map entitled "The Hornbeck Stone House, Rochester, Ulster County, New York" and is further identified as bolck 1, lot 12.110 of Tax Map 69.003.

##### **Boundary Justification**

The boundary for the nomination has been drawn to coincide with the current legal lot for the property.

# The Hornbeck Stone House

Rochester, Ulster County, New York

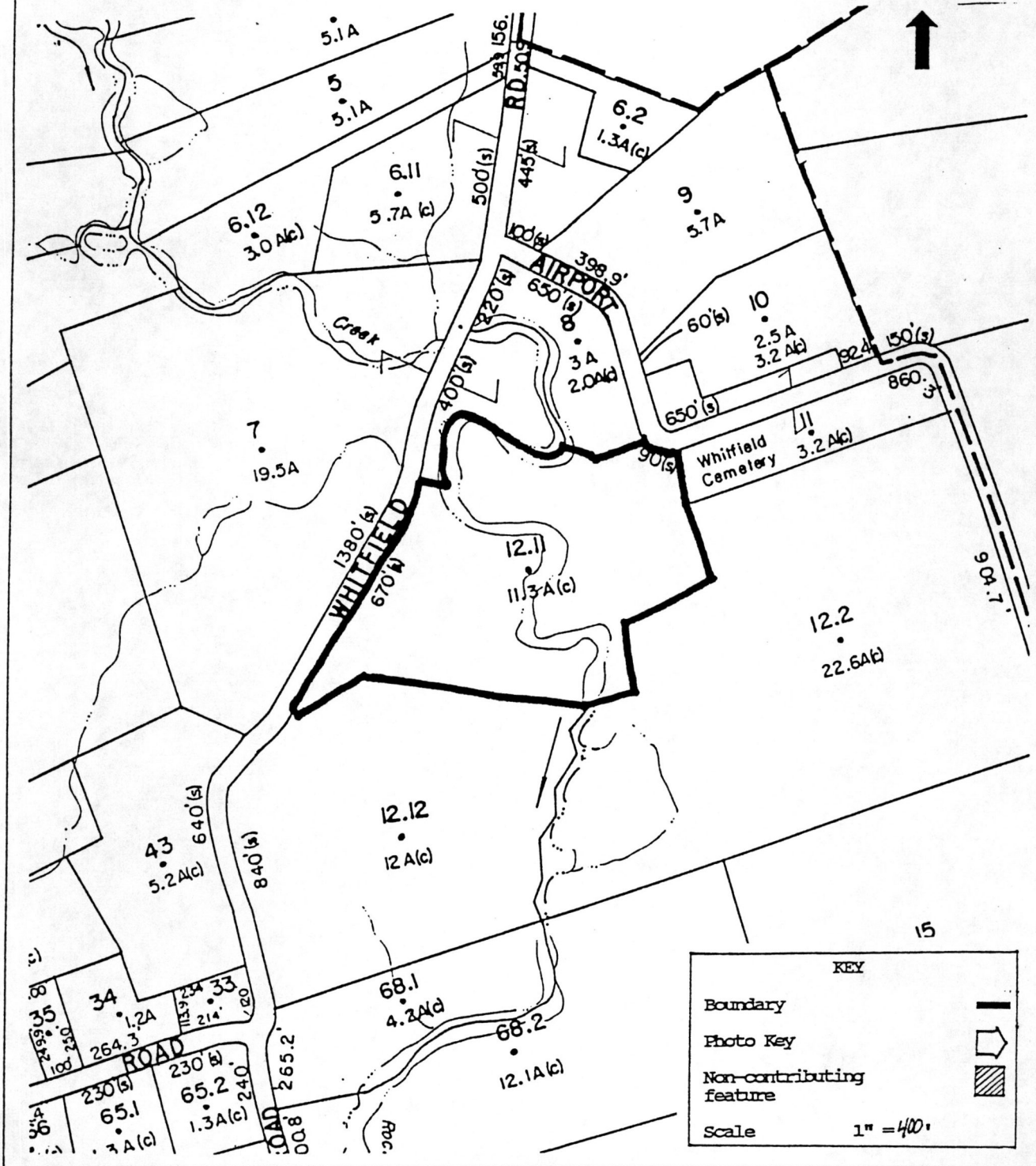

# The Hornbeck Stone House

Rochester, Ulster County, New York  
(Site Plan)

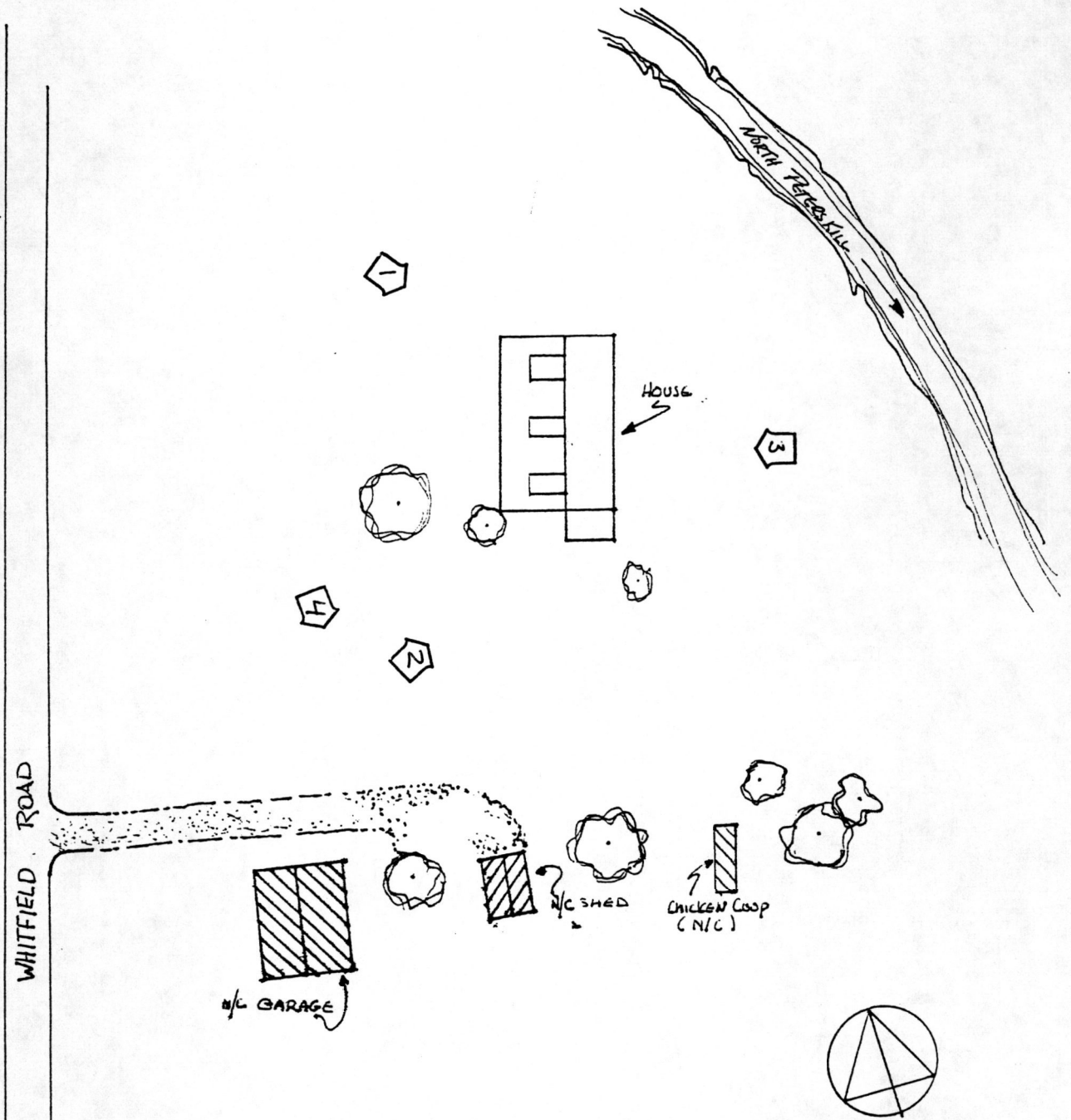

KEY	
Boundary	—
Photo Key	⬠
Non-contributing feature	▨
Scale	1" = '

UNITED STATES DEPARTMENT OF THE INTERIOR  
NATIONAL PARK SERVICE

NATIONAL REGISTER OF HISTORIC PLACES  
EVALUATION/RETURN SHEET

REQUESTED ACTION: NOMINATION

PROPERTY NAME: Hornbeck Stone House

MULTIPLE NAME: Rochester MPS

STATE & COUNTY: NEW YORK, Ulster

DATE RECEIVED: 7/05/95      DATE OF PENDING LIST: 7/18/95  
DATE OF 16TH DAY: 8/03/95      DATE OF 45TH DAY: 8/19/95  
DATE OF WEEKLY LIST:

REFERENCE NUMBER: 95000957

NOMINATOR: STATE

REASONS FOR REVIEW:

APPEAL: N    DATA PROBLEM: N    LANDSCAPE: N    LESS THAN 50 YEARS: N  
OTHER: N    PDIL: N    PERIOD: N    PROGRAM UNAPPROVED: N  
REQUEST: N    SAMPLE: N    SLR DRAFT: N    NATIONAL: N

COMMENT WAIVER: N

ACCEPT     RETURN     REJECT    8-10-95 DATE

ABSTRACT/SUMMARY COMMENTS:

Entered in the  
National Register

RECOM./CRITERIA \_\_\_\_\_

REVIEWER \_\_\_\_\_ DISCIPLINE \_\_\_\_\_

TELEPHONE \_\_\_\_\_ DATE \_\_\_\_\_

DOCUMENTATION see attached comments Y/N see attached SLR Y/N



The Hornbeck Stone House  
Rochester, Ulster County, N.Y.  
Photo by: H. Hansen, 1995  
Neg. at: H. Hansen, Stone Ridge, N.Y.

Photo 1, ~~East~~ FACADE  
West

ACC-051095149741 13 JAN 1996



The Hornbed Stone House

Rochester, Ulster County, N.Y.

Photo by: H. Hansen, 1995

Neg. at: H. Hansen, Stone Ridge, N.Y.

Photo 2, NORTH elevation



The Hornbeck Stone House

Rochester, Ulster County, N.Y.

Photo by: H. Hansen, 1995

Neg. at: H. Hansen, Stone Ridge, N.Y.

Photo 3, East elevation



The Hornbeck Stone House  
Rochester, Ulster County, N.Y.  
Photo by: H. Hansen, 1995  
Neg. at: H. Hansen, Stone Ridge, N.Y.

Photo 4, w/c WTBUILDINGS

1-17

Please refer to the map in the  
Multiple Property Cover Sheet  
for this property

Multiple Property Cover Sheet Reference Number: 64500464