

UNITED STATES DEPARTMENT OF THE INTERIOR  
NATIONAL PARK SERVICE  
NATIONAL REGISTER OF HISTORIC PLACES  
REGISTRATION FORM

This form is for use in nominating or requesting determinations for individual properties or districts. See instructions in How to Complete the National Register of Historic Places Registration Form (National Register Bulletin 16A). Complete each item by marking "x" in the appropriate box or by entering information requested. If an item does not apply to the property being documented, enter "N/A" for "not applicable." For functions, architectural classifications, materials, and areas of significance, enter only categories and subcategories from the instructions. Place additional entries and narrative items on continuation sheets (NPS Form 10-900a). Use a typewriter, word processor, or computer, to complete all items.

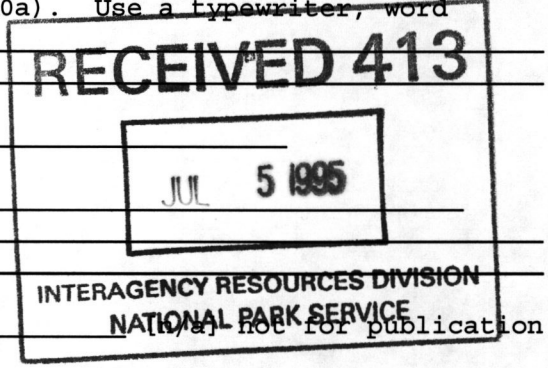

1. Name of Property

historic name Krom Stone House and Dutch Barn

other names/site number n/a

2. Location

street & number Airport Road

city, town Rochester [n/a] vicinity

state New York code NY county Ulster code 111 zip code 12404

3. State/Federal Agency Certification

As the designated authority under the National Historic Preservation Act of 1966, as amended, I hereby certify that this  nomination  request for determination of eligibility meets the documentation standards for registering properties in the National Register of Historic Places and meets the procedural and professional requirements set forth in 36 CFR Part 60. In my opinion, the property  meets  does not meet the National Register criteria. I recommend that this property be considered significant  nationally  statewide  locally. ([ ] See continuation sheet for additional comments.)

J.W. Alderman  
Deputy Commissioner for Historic Preservation  
Signature of certifying official

26 June '95  
Date

State or Federal agency and bureau

In my opinion, the property  meets  does not meet the National Register criteria. ([ ] See continuation sheet for additional comments.)

Signature of commenting or other official

Date

State or federal agency and bureau

4. National Park Service Certification

I hereby certify that this property is:  
 entered in the National Register.  
 See continuation sheet.  
 determined eligible for the National Register. [ ] see continuation sheet.  
 determined not eligible for the National Register.  
 removed from the National Register.  
 other, (explain:)

for  
Signature of keeper Edson R. Beall Date of Action

Name of Property

County and State

**5. Classification**

<b>Ownership of Property</b> (Check as many boxes as apply)	<b>Category of Property</b> (check only one box)	<b>Number of Resources within Property</b> (do not include previously listed resources in the count)
--	---	---

<input checked="" type="checkbox"/> private <input type="checkbox"/> public-local <input type="checkbox"/> public-State <input type="checkbox"/> public-Federal	<input checked="" type="checkbox"/> building(s) <input type="checkbox"/> district <input type="checkbox"/> site <input type="checkbox"/> structure <input type="checkbox"/> object	<table border="0"> <tr> <td style="text-align: center;">Contributing</td> <td style="text-align: center;">Noncontributing</td> <td></td> </tr> <tr> <td style="text-align: center;">3</td> <td style="text-align: center;">1</td> <td style="text-align: right;">buildings</td> </tr> <tr> <td colspan="2"></td> <td style="text-align: right;">sites</td> </tr> <tr> <td colspan="2"></td> <td style="text-align: right;">structures</td> </tr> <tr> <td colspan="2"></td> <td style="text-align: right;">objects</td> </tr> <tr> <td style="text-align: center;">3</td> <td style="text-align: center;">1</td> <td style="text-align: right;">Total</td> </tr> </table>	Contributing	Noncontributing		3	1	buildings			sites			structures			objects	3	1	Total
Contributing	Noncontributing																			
3	1	buildings																		
		sites																		
		structures																		
		objects																		
3	1	Total																		

<b>Name of related multiple property listings</b> (enter "N/A" if property is not part of a multiple property listing) <i>The Historic and Architectural Resources of the Town of Rochester, Ulster County, New York</i>	<b>Number of contributing resources previously listed in the National Register</b> <p style="text-align: center;">n/a</p>
---	--

**6. Function or Use**

<b>Historic Function</b> (enter categories from instructions) <u>DOMESTIC/single dwelling</u> <u>DOMESTIC/secondary structure</u> <u>AGRICULTURAL/agricultural outbuilding</u> <hr/> <hr/> <hr/> <hr/>	<b>Current Functions</b> (enter categories from instructions) <u>DOMESTIC/single dwelling</u> <u>DOMESTIC/secondary structure</u> <u>DOMESTIC/secondary structure</u> <hr/> <hr/> <hr/> <hr/>
---	--

**7. Description**

<b>Architectural Classification</b> (enter categories from instructions)  <u>OTHER/vernacular</u> <hr/> <hr/>	<b>Materials</b> (enter categories from instructions)  foundation <u>Stone</u> walls <u>Stone</u> <hr/> <hr/> roof <u>Metal</u> other _____ <hr/> <hr/>
---	--

**Narrative Description**

(describe the historic and current condition of the property on one or more continuation sheets.)

United States Department of the Interior  
National Park Service

Krom Stone House and Dutch Barn  
Rochester, Ulster County, New York

NATIONAL REGISTER OF HISTORIC PLACES  
CONTINUATION SHEET

RECEIVED 413

JUL 5 1995

INTERAGENCY RESOURCES DIVISION  
NATIONAL PARK SERVICE

Section number 7 Page 2

The Krom house is located in a rural setting in the town of Rochester, Ulster County, New York. The property is on the east side of Airport Road. The nominated property sits upon an irregularly shaped 100 acre parcel of land that is bounded on west by airport road and on the north east and south by fields. The stone house is completely hidden from the road. The house is not visible from the road because it sits over the rise of a small knoll and is surrounded by dense evergreen plantings. The house is reached by a long driveway heading east off Airport Road. The north side of the drive is densely planted with a white pine hedge row, beyond which there is an open field. The driveway passes along the north side of the house, past a small shed northeast of the house and then wraps south around the end of the house towards the barn complex below. The front (south) facade of the house is obscured by dense overgrown plantings of evergreens that screen any views. The barns are located off in the distance to the south where the drive turns west to return to Airport Road. The barn complex is a complicated arrangement of additions sheltered behind a low rise to the northwest. The nominated property contains three (3) contributing buildings (ca. 1730 stone house, ca. 1800 Dutch barn with additions, ca. 1870 shed) and one (1) non-contributing building (ca. 1980 house trailer).

The Whitfield community (formerly Newtown) is a loosely joined neighborhood without a traditional village style settlement. There are a number of nearby historic features to the west, the closest being Whitfield Cemetery; further west are the Hornbeck stone house (# 46[1]) and the Charles DePuy stone house (# 48), both of which are on Whitfield Road. To the north and south are two unidentified frame houses (# 33 & 209).

The main block of the **Krom House** is a vernacular one-and-one half story stone dwelling on a linear plan. The stone has recently (since 1966) been covered over with stucco. The front (south) facade has five evenly spaced bays with a central entry. The steep gable roof is capped by two central gable-end chimneys; to the south there is a recent shallow pitched shed-roofed dormer behind a one-bay front porch with a shed roof. The gable ends are stucco clad with the exception of the peak which has clapboard from the second floor ceiling level to the ridge. All of the windows are replacements with one over one sash. A one-and-one half story wing extends off the west end of the back (north). It has a gable roof and one story shed roofed open porch and enclosed mud-room off to the east. A 1929 photograph toward the southeast shows this addition as being a stone walled one-story extension with a roof that continued from the main pitch. The historic photograph also shows a granary door in the west gable entering the loft area of the house. [Reynolds, plate 78, p. 261.] This area has also been stuccoed and these details are now hidden. The east gable end has a small gable roofed entry to the basement that has been added since 1966. To the west, there is an open foundation for an extension that is now overgrown with bramble.

1. These numbers reference entries in the *The Historic and Architectural Resources of the Town of Rochester, Ulster County, New York* (see Appendix A)..

United States Department of the Interior  
National Park Service

Krom Stone House and Dutch Barn  
Rochester, Ulster County, New York

NATIONAL REGISTER OF HISTORIC PLACES  
CONTINUATION SHEET

Section number 7 Page 3

---

The **shed** lies just east of the main house. It is a small one-story frame building with a gable roof.

The initial **barn** has a Dutch H framework and is oriented north-south. This barn, which has been extensively added to, had four original bents and gable roof. The anchor beams of the H frame extend through the columns and are secured by a pair of oak trenails. A three-bay nineteenth-century English style barn with a gable end of the original barn and offset to the east, so that only one-half of the gable ends from the two barns butted. Another nineteenth-century expansion of the initial barn extended to the west, perpendicular to the original structure and across its full width. This addition was itself extended again, also in the nineteenth century. These two subsequent additions, along with a cross gable to the east on the original Dutch barn, not dwarf and mask the original construction, which can only be realized from the hay mow. A new pole-barn addition with a shed roof extends off to the north. The ground floor has been extensively renovated to contain horse stalls.

The non-contributing house trailer is modern and lies near the barns to the northwest.

**8. Statement of Significance**

**Applicable National Register Criteria**

(Mark an "x" in one or more boxes for the criteria qualifying the property for National Register listing.)

- A** Property is associated with events that have made a significant contribution to the broad patterns of our history.
- B** Property is associated with the lives of persons significant in our past.
- C** Property that embodies the distinctive characteristics of a type, period, or method of construction or represents the work of a master, or possesses high artistic values, or represents a significant and distinguishable entity whose components lack individual distinction.
- D** Property has yielded, or is likely to yield, information important in pre-history or history.

**Criteria Considerations**

(Mark "X" in all the boxes that apply.)

- A** owned by a religious institution or used for religious purposes.
- B** removed from its original location.
- C** a birthplace or grave.
- D** a cemetery.
- E** a reconstructed building, object or structure.
- F** a commemorative property.
- G** less than 50 years of age or achieved significance within the past 50 years.

**Area of Significance**

(Enter categories from instructions.)

Architecture

**Period of Significance**

ca.1730, 1800-1880

**Significant Dates**

ca.1730

**Significant Person**

(Complete if Criterion B is marked above.)

n/a

**Cultural Affiliation**

n/a

**Architect/Builder**

n/a

**Narrative Statement of Significance**

(Explain the significance of the property on one or more continuation sheets.)

**9. Major Bibliographical References**

**Bibliography**

(Cite the books, articles, and other sources used in preparing this form on one or more continuation sheets.)

**Previous documentation on file (NPS): Primary location of additional data:**

- |   |  |
|---|--|
| <input type="checkbox"/> preliminary determination of individual listing (36 CFR 67) has been requested | <input checked="" type="checkbox"/> State historic preservation office |
| <input type="checkbox"/> previously listed in the National Register                                     | <input type="checkbox"/> Other State agency                            |
| <input type="checkbox"/> previously determined eligible by the National Register                        | <input type="checkbox"/> Federal agency                                |
| <input type="checkbox"/> designated a National Historic Landmark  | <input type="checkbox"/> Local government                              |
| <input type="checkbox"/> recorded by Historic American Building Survey # _____                          | <input type="checkbox"/> University                                    |
| <input type="checkbox"/> recorded by Historic American Engineering Record # _____                       | <input type="checkbox"/> Other   |

Name of repository: \_\_\_\_\_

United States Department of the Interior  
National Park Service

Krom Stone House and Dutch Barn  
Rochester, Ulster County, New York

NATIONAL REGISTER OF HISTORIC PLACES  
CONTINUATION SHEET

Section number 8 Page 2

---

The Krom house is significant as an outstanding regional example of a mid-eighteenth-century stone dwelling architecture. This vernacular house is historically and architecturally significant as an example of the linear stone dwelling house architecture typically found in the Hudson Valley region and in Ulster County, New York. [2] The characteristic features of this style include stone construction, a linear plan, and a simple gable roof. Twentieth-century modifications that include stucco and a gable roof over the north wing are also typical of that period. This house is one of seventy-one stone or brick houses (both former and existing) identified in Rochester which were built before 1944; sixty-four were built before 1850 and of these fifty-six are extant. The linear one-and-one-half story stone house was the predominant form of stone dwelling architecture in Ulster County, and in the Town of Rochester from the late seventeenth century until the mid nineteenth century.

The property is also historically and architecturally significant for the Dutch barn dating from before the mid-nineteenth century. [3] To date, only nine barns of this era remain standing in the town of Rochester (# 3, 32, 40, 43, 51, 58, 65, 84 & 90). Originally, there were many more. As one of the few extant examples in any condition and as an illustration of barn evolution and use, this barn complex is an important example. The barn is also significant for the two nineteenth-century additions. This barn's evolution documents the changing agrarian lifestyles of the inhabitants of the Town of Rochester.

This property is acknowledged as the Krom homestead. [Tanner, p. 74; and Reynolds, p. 210.] The Krom family was important in the early settlement of the Town of Rochester. A number of second and third generation Krom family stone houses are found to the west.

---

2. See the multiple property registration document titled, *The Historic and Architectural Resources of the Town of Rochester, Ulster County, New York*, Section F, Property Type 1, Residential Architecture.

3. See the multiple property registration document titled, *The Historic and Architectural Resources of the Town of Rochester, Ulster County, New York*, Section F, Property Type 2, Domestic and Agricultural Outbuildings.

Name of Property

County and State

10. Geographical Data

Acreage of property 100 acres

UTM References

(Place additional UTM references on a continuation sheet.)

Table with 8 columns: Zone, Easting, Northing. Contains UTM coordinates for zones 1 through 8.

Verbal Boundary Description

(Explain the boundaries of the property on a continuation sheet.)

Boundary Justification

(Explain why the boundaries were selected on a continuation sheet.)

11. Form Prepared By

name/title Harry Hansen (edited by: J.A. Bonafide, Program Analyst, NYSOPRHP)
organization Kyserike Restorations, Inc date April, 1995
street & number 2545 Lucas Turnpike telephone (914) 687-0854
city or town High Falls state NY zip code 12440

Additional Documentation

Submit the following items with the completed form:

Continuation Sheets

Maps

- A USGS map (7.5 or 15 minute series) indicating the property's location.
A Sketch map for historic districts and properties having large acreage or numerous resources.

Photographs

Representative black and white photographs of the property.

Additional items

(check with the SHPO or FPO for any additional items)

Property Owner

(Complete this item at the request of SHPO or FPO.)

name n/a
street & number
city or town state zip code

Paperwork Reduction Act Statement: This information is being collected for applications to the National Register of Historic Places to nominate properties for listing or determine eligibility for listing, to list properties, and to amend existing listings. Response to this request is required to obtain a benefit in accordance with the National Historic Preservation Act, as amended (16 U.S.C. 470 et seq.).

Estimated Burden Statement: Public reporting burden for this form is estimated to average 18.1 hours per response including the time for reviewing instructions, gathering and maintaining data, and completing and reviewing the form. Direct comments regarding this burden estimate or any aspect of this form to the Chief, Administrative Services Division, National Park Service, P.O. Box 37127, Washington, DC 20013-7127; and the Office of Management and Budget, Paperwork Reductions Project (1024-0018), Washington, DC 20503.

United States Department of the Interior  
National Park Service

Krom Stone House and Dutch Barn  
Rochester, Ulster County, New York

NATIONAL REGISTER OF HISTORIC PLACES  
CONTINUATION SHEET

Section number 9 Page 2

---

### 9. Major Bibliographical References

- Early Architecture in Ulster County. Kingston, N.Y.: Junior League of Kingston, N.Y., Inc. 1974.
- Hansen, Harry. "Town of Rochester, Ulster County, New York Historic Resources Reconnaissance Survey." Report presented to the Town of Rochester Historic Preservation Commission, Rochester, New York, 1993.
- Larsen, Neil. "The Masonry Architecture of Ulster County, New York: An Evolution 1665-1935." Essays presented to meeting of the Vernacular Architecture Forum, Kingston, New York, 7-10 May 1986.
- Piwonka, Ruth. "Town of Marbletown Ulster County, New York Historic Resources Reconnaissance Survey." Report presented to the Town of Marbletown Historic Preservation Commission, Rochester, New York, 1993.
- Reynolds, Helen Wilkinson. Dutch Houses in the Hudson Valley Before 1776. New York: Payson and Clarke, 1929: reprint ed., New York: Dover Publications, 1965.

United States Department of the Interior  
National Park Service

Krom Stone House and Dutch Barn  
Rochester, Ulster County, New York

NATIONAL REGISTER OF HISTORIC PLACES  
CONTINUATION SHEET

Section number 10 Page 2

---

#### **10. Geographical Data**

##### **Verbal Boundary Description**

The boundary for the nominated property is shown as the heavy black outline on the accompanying map entitled "Krom Stone House and Dutch Barn, Rochester, Ulster County, New York" and is further identified as block 2. lot 44 of Tax Map 69.003.

##### **Boundary Justification**

The boundary for the nomination has been drawn to coincide with the current legal lot for the property.

# Krom Stone House and Dutch Barn

Rochester, Ulster County, New York

(Site Plan)

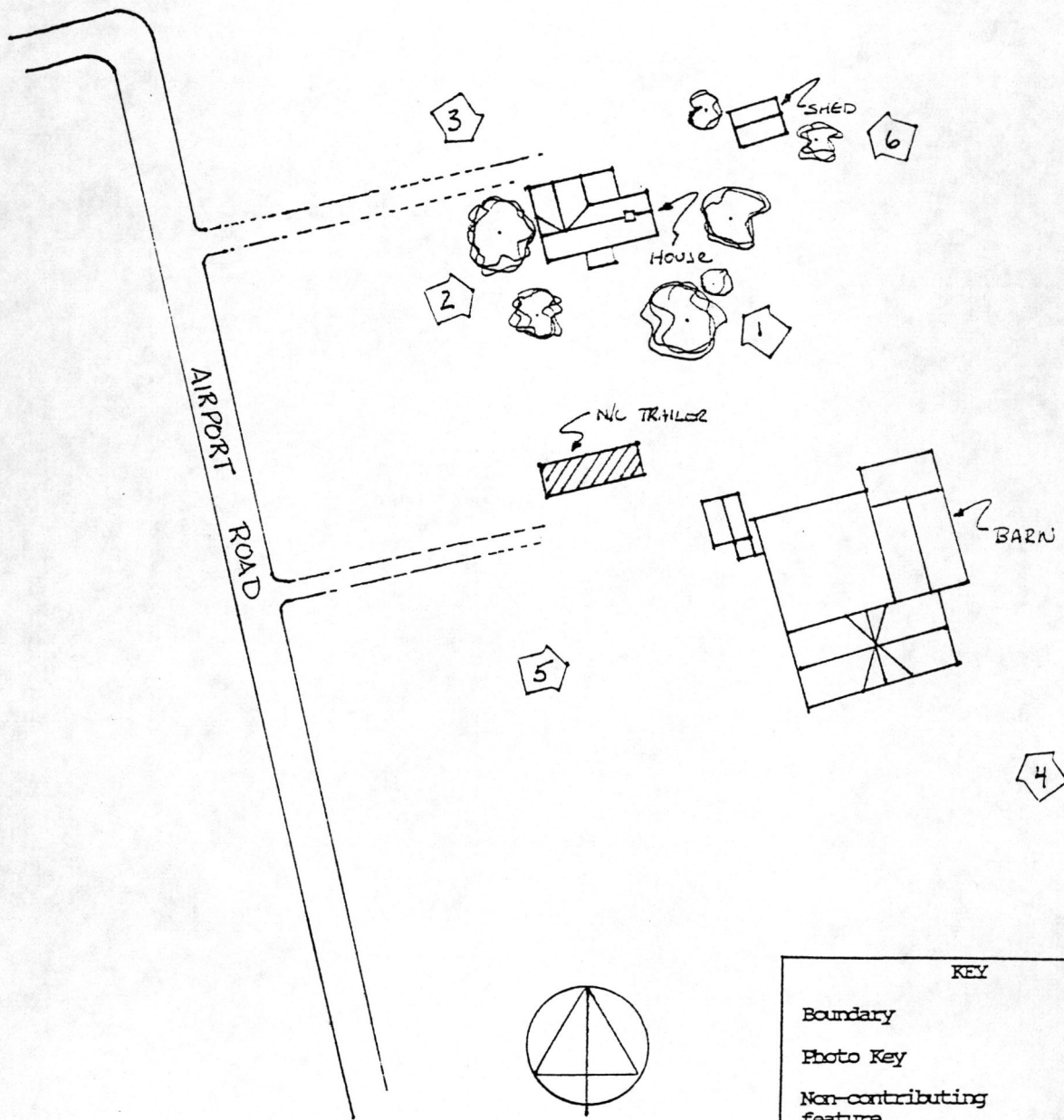

KEY	
Boundary	---
Photo Key	⬠
Non-contributing feature	▨
Scale	1" = 1'



UNITED STATES DEPARTMENT OF THE INTERIOR  
NATIONAL PARK SERVICE

NATIONAL REGISTER OF HISTORIC PLACES  
EVALUATION/RETURN SHEET

REQUESTED ACTION: NOMINATION

PROPERTY NAME: Krom Stone House and Dutch Barn

MULTIPLE NAME: Rochester MPS

STATE & COUNTY: NEW YORK, Ulster

DATE RECEIVED: 7/05/95      DATE OF PENDING LIST: 7/18/95  
DATE OF 16TH DAY: 8/03/95      DATE OF 45TH DAY: 8/19/95  
DATE OF WEEKLY LIST:

REFERENCE NUMBER: 95000955

NOMINATOR: STATE

REASONS FOR REVIEW:

APPEAL: N	DATA PROBLEM: N	LANDSCAPE: N	LESS THAN 50 YEARS: N
OTHER: N	PDIL: N	PERIOD: N	PROGRAM UNAPPROVED: N
REQUEST: N	SAMPLE: N	SLR DRAFT: N	NATIONAL: N

COMMENT WAIVER: N

ACCEPT     RETURN     REJECT    6-10-95 DATE

ABSTRACT/SUMMARY COMMENTS:

Entered in the  
National Register

RECOM./CRITERIA \_\_\_\_\_

REVIEWER \_\_\_\_\_ DISCIPLINE \_\_\_\_\_

TELEPHONE \_\_\_\_\_ DATE \_\_\_\_\_

DOCUMENTATION see attached comments Y/N see attached SLR Y/N



Krom Stone House & Dutch Barn  
Rochester, Ulster County, N.Y.  
Phot by: H. Hansen, 1995  
Neg. at: H. Hansen, Stone Ridge, N.Y.

Photo 1, NORTH & EAST elevations



Krom Stone House & Dutch Barn  
Rochester, Ulster County, N.Y.

Photo by: H. Hansen, 1995

Neg. at: H. Hansen, Stone Ridge, N.Y.

Photo 2, west elevation



Krom Stone House & Dutch Barn  
Rochester, Ulster County, N.Y.  
Photo by: H. Hansen, 1995  
Neg. at: H. Hansen, Stone Ridge, N.Y.  
Photo 3, west elevation



Krom Stone House & Dutch Barn  
Rochester, Ulster County, N.Y.,  
Photo by: H. Hansen, 1995  
Neg. at: H. Hansen, Stone Ridge, N.Y.

Photo 4, Barn Complex



Krom Stone House & Dutch Barn  
Rochester, Ulster County, N.Y.  
Photo by: H. Hansen, 1995  
Neg. at: H. Hansen, Stone Ridge, N.Y.

Photo 5, Barn Complex



Krom Stone House & Dutch Basin  
Rochester, Ulster County, N.Y.

Photo by: H. Hansen, 1995

Neg. at: H. Hansen, Stone Ridge, N.Y.

Photo 6, sled

ACC-0510951960139 1995

2-32

Please refer to the map in the  
Multiple Property Cover Sheet  
for this property

Multiple Property Cover Sheet Reference Number: 64500464