

UNITED STATES DEPARTMENT OF THE INTERIOR  
NATIONAL PARK SERVICE  
NATIONAL REGISTER OF HISTORIC PLACES  
REGISTRATION FORM

FORM NO. 1022-0018, NPS FORM

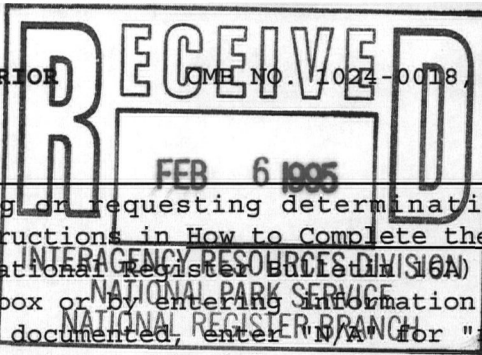

This form is for use in nominating or requesting determinations for individual properties or districts. See instructions in How to Complete the National Register of Historic Places Registration Form (National Register Bulletin 16A). Complete each item by marking "x" in the appropriate box or by entering information requested. If an item does not apply to the property being documented, enter "N/A" for "not applicable." For functions, architectural classifications, materials, and areas of significance, enter only categories and subcategories from the instructions. Place additional entries and narrative items on continuation sheets (NPS Form 10-900a). Use a typewriter, word processor, or computer, to complete all items.

**1. Name of Property**

historic name Main Street Historic District

other names/site number \_\_\_\_\_

**2. Location**

streets Main and Center Sts; West Ave.; Proctor Pl. [ ] not for publication

city Medina [ ] vicinity

state New York code NY county Orleans code 073 zip code 14103

**3. State/Federal Agency Certification**

As the designated authority under the National Historic Preservation Act of 1966, as amended, I hereby certify that this  nomination [ ] request for determination of eligibility meets the documentation standards for registering properties in the National Register of Historic Places and meets the procedural and professional requirements set forth in 36 CFR Part 60. In my opinion, the property  meets [ ] does not meet the National Register criteria. I recommend that this property be considered significant [ ] nationally [ ] statewide  locally. ([ ] See continuation sheet for additional comments.)

David S. Pellegrini  
Director, Field Services Bureau

2/22/95  
Date

NYS Office of Parks, Recreation and Historic Preservation

In my opinion, the property [ ] meets [ ] does not meet the National Register criteria. ([ ] See continuation sheet for additional comments.)

Signature of commenting or other official  
State or federal agency and bureau

Date

**4. National Park Service Certification**

- I hereby certify that this property is:
- entered in the National Register.
- [ ] See continuation sheet.
- [ ] determined eligible for the National Register. [ ] see continuation sheet.
- [ ] determined not eligible for the National Register.

Signature of keeper

Date of Action

Beta A. Swase 3/23/95

[ ] removed from the National Register.

[ ] other: \_\_\_\_\_

5. Classification

Ownership of Property/Category of Property/Number of Resources within Property
(Check as many (check box) (do not include previously listed
boxes as apply) resources in the count)

Table with 3 columns: Ownership/Category, Number of Resources, and Resource Type. Rows include private, public-local, public-State, public-Federal, building(s), district, site, structure, object, buildings, sites, structures, objects, Total, and Number of contributing resources previously listed in the National Register: NA.

NAME OF RELATED MULTIPLE PROPERTY DOCUMENTATION FORM:

NA

6. Function or Use

Historic Function

COMMERCE/TRADE; business, financial
institution, specialty store
GOVERNMENT; village hall
RELIGION; church
RECREATION/CULTURE; opera house,
theater
AGRICULTURE; cold storage warehouse

Current Function

COMMERCE/TRADE; business, financial
institution, specialty store
GOVERNMENT; village hall
RELIGION; church
LANDSCAPE; village park
VACANT

7. Description

Architectural Classification

(enter categories from instructions)

LATE VICTORIAN; Italianate, Queen
Anne, Romanesque Revival, Richard-
sonian Romanesque
EARLY 20TH C; Neoclassical

Materials

(enter categories from instructions)

foundation stone, concrete
walls brick, stone, frame
roof metal, asphalt, built-up roofing
other

Narrative Description

See attached continuation sheets.

United States Department of the Interior  
National Park Service

NATIONAL REGISTER OF HISTORIC PLACES  
CONTINUATION SHEET

Main Street Historic District  
Medina, Orleans County, New York

Section 7, Description, page 1

---

Description

The Main Street Historic District is located in the historic commercial section of Medina, an Orleans County, New York village with a population of approximately 7,000. The district is centered at the intersection of Main and East and West Center Streets (State Routes 63 and 31). Main Street is a wide thoroughfare with diagonal on-street parking on both sides. A large turning basin on the Erie Canal is located east of Main Street. The district includes the intact historic commercial sections along both the east and west sides of Main Street and portions of the adjacent side streets of East and West Center Streets, Proctor Place, and West Avenue. The approximately 11.31-acre district includes 49 contributing buildings, three non-contributing buildings, and one non-contributing site. The majority of the buildings in the district are commercial although a church, a railroad station, City Hall, and cold storage warehouses are interspersed among the commercial buildings as well. The district features buildings exhibiting a range of mid-to-late nineteenth and early-twentieth century architectural styles. Dating from ca. 1845 to ca. 1910 (the majority date from the 1870s to early 1900s), buildings in the district are predominantly two- to three-story, attached brick or stone buildings, many with Italianate style design and decoration. Most display regular fenestration, are tall and vertically oriented, and feature a variety of stone, wood, brick or metal ornamentation, particularly at storefronts, at windows, and at cornices. General similarities in scale, use of materials, rooflines, and setbacks from the street provide visual cohesiveness and uniformity throughout the district. The buildings are generally in continuous rows along both sides of Main Street. Most buildings feature street-level storefronts with large display windows and recessed entrances, some with transoms. While many of the storefronts in the district have been altered by modern materials, a large number still retain their ornamental cast iron, particularly pilasters. (Some of the storefronts along Main Street have recently

United States Department of the Interior  
National Park Service

NATIONAL REGISTER OF HISTORIC PLACES  
CONTINUATION SHEET

Main Street Historic District  
Medina, Orleans County, New York

Section 7, Description, page 2

---

been sympathetically rehabilitated under the Medina Commercial Revitalization Project in compliance with the Secretary of the Interior's *Standards for Rehabilitation*, and in consultation with the New York State Historic Preservation Office.) Upper stories are reserved for apartments, offices, and/or storage space. In general, the buildings (particularly the upper stories) retain a remarkably high level of integrity of design, materials, and craftsmanship. As a group, they also possess integrity of setting and location.

Boundaries for the district are delineated on the attached district map. In all cases, boundaries follow existing lot or right-of-way lines. The boundaries are drawn to include the entire extent of intact properties directly related to the development of Medina's commercial core. Excluded are areas with higher concentrations of non-historic buildings, heavily altered historic buildings, and several historic buildings which are not contiguous with the historic core of the community.

At the north end of the district, the boundaries exclude an empty lot, a modern gas station, and an auto dealership (west side of Main); and a heavily altered historic building (329-331 Main, Starlite Drycleaning) and modern bank with parking lot (east side of Main).

The west boundary of the district, moving north to south, follows the lot lines along the east side of Proctor Place. Immediately outside the district to the west of Proctor Place (north of West Center Street) is a modern concrete block restaurant building, the National Register-listed Post Office, the Moose Lodge building, and an asphalt parking lot. Further outside the district to the west the area becomes residential in character with stone, brick and frame houses of generally good period integrity ranging from the Federal to the Bungalow style. Two buildings fronting onto West Center Street (#108 and #111-115) are included within the district boundaries.

United States Department of the Interior  
National Park Service

NATIONAL REGISTER OF HISTORIC PLACES  
CONTINUATION SHEET

Main Street Historic District  
Medina, Orleans County, New York

Section 7, Description, page 3

---

South of West Center Street, the west boundary continues along following the rear lot lines of the properties on the west side of Main Street. Excluded properties to the west (south of West Center Street) include a large asphalt parking lot, a modern gas station (currently used as a bank), and the visually prominent First Baptist Church (1870-73), constructed of Medina sandstone. A small portion of the west boundary extends over to the east side of West Avenue and incorporates the former New York Central Railroad Station.

The southern boundary of the district incorporates the early- twentieth-century cold storage warehouses on either side of the railroad tracks. This boundary is drawn to exclude a modern church facility, a Sugarcreek Store and gas station, and the residential neighborhood to the south. The residences in this area are predominantly nineteenth and early twentieth century, one and one-half to two and one-half story, frame houses of noticeably less architectural integrity and distinction than the commercial district.

The eastern boundary follows the rear lot lines behind properties along the east side of Main Street. Most of these property lines, with the exception of the northernmost properties, back up to the west edge of Mill Street. Excluded from the eastern boundary, north of East Center Street, is Mill Street and a municipal parking lot adjacent to the turning basin on the Erie Canal. To the south of East Center Street, areas excluded from the district's east boundary include the continuation of Mill Street and another parking lot. While industrial buildings and a raceway were once located where these two parking lots are today none of these features has survived, thus leaving these areas devoid of integrity of setting.

The boundaries have been drawn to include a small number of contiguous commercial properties on East Center Street. Excluded from the East Center Street boundary to the east is a modern brick pharmacy building with surrounding parking lot and the National Register-eligible St. John's Episcopal

United States Department of the Interior  
National Park Service

NATIONAL REGISTER OF HISTORIC PLACES  
CONTINUATION SHEET

Main Street Historic District  
Medina, Orleans County, New York

Section 7, Description, page 4

---

Church, on the south side of the street. Built in 1833 of Medina sandstone, St. John's is one of the oldest public buildings in Medina.

Excluded on the north side of East Center Street is a modern, gable-roofed, frame building (law office), an early-twentieth-century concrete block commercial building with a heavily altered storefront, an early-twentieth-century brick commercial building, a modern restaurant, and a gas station.

The visually cohesive block on the west side of Main Street, north of West Center Street, is notable for its concentration of two and three-story Italianate style buildings constructed of locally quarried, light gray, Medina sandstone. These buildings include: 408 Main (1881); The J.A. French Block, 410-412 Main (1868); The E.M. Card Block, 414-416 Main (1867); The J.D. Kearney Block, 418-422 Main (1867); 424 Main (ca. 1867); and The Bent Block, 444 Main (1864-65). Common details found on these buildings include random ashlar walls with stone quoins, round or segmentally-arched windows with stone sills and keystone drip moldings, and stone stringcourses. One of the visually prominent buildings in this section of Main Street is the Fuller Block (1875) at 428 Main Street. This three-story, five-bay wide, brick commercial building retains a high level of architectural integrity and design. Typical Italianate features shown here include round-arched windows with arched drip moldings, intricate brick corbelling, and a bracketed cornice.

The remaining section on the west side of Main Street, south of West Center Street, is more diverse in character with different building types, eras of construction, and styles. Building types represented in this section include commercial structures, a church, city hall, a railroad station, and a cold storage warehouse/packing house facility. Construction dates range from 1855 up to 1911. Architectural styles include Italianate, Romanesque Revival, Richardsonian Romanesque, Neo-classical, Art Deco (storefront), and vernacular.

United States Department of the Interior  
National Park Service

NATIONAL REGISTER OF HISTORIC PLACES  
CONTINUATION SHEET

Main Street Historic District  
Medina, Orleans County, New York

Section 7, Description, page 5

---

The oldest building in this section of Main Street is Paddock's Hotel, built in 1855, at the southwest corner of Main and West Center Street. This three-story, brick commercial building features double-hung sash with pedimented crowns and a bracketed cornice. Although the storefronts at the front (Main Street) facade have been modernized much of the historic cast ironwork, manufactured by W.H. Cheney of Rochester, is intact at the two storefronts on the north (West Center Street) elevation. The two-story, brick building at 508-510 Main, south of Paddock's Hotel was built about 1873 as an addition to the hotel and thus features the same pedimented window hoods. The storefront at the brick Italianate style building at 512 Main is an excellent example of Art Deco inspired design as shown by the use of black and red Carrara glass. The former Central Bank of Medina (1890/1926 remodelled facade) at 514 Main Street is the only Neo-classical style building in the district. The Romanesque Revival First Presbyterian Church (1872) at 520 Main Street is the only example of religious architecture in the district. Unlike most of the other buildings in the district the church is set back several feet from the sidewalk. Characteristic features of the Romanesque Revival style shown here include round-arched window and door openings, an arched corbel table, a facade articulated by engaged buttresses, and a square tower. The S.A. Cook Building (1911), at the northwest corner of Main Street and Park Avenue, is an excellent example of early-twentieth-century commercial architecture. Its long, horizontal orientation and simple detailing provides a contrast to the surrounding Victorian era buildings. City Hall (1908), located at the southwest corner of Main Street and Park Avenue, is the only government building in the district and the only example of Richardsonian Romanesque inspired design as illustrated by the use of rugged, rock-faced Medina sandstone and round-arched head moldings over the first floor windows.

Included within the district, though located well back from the west side of Main Street, along the railroad tracks, is the former New York Central Railroad Station (1908).

United States Department of the Interior  
National Park Service

NATIONAL REGISTER OF HISTORIC PLACES  
CONTINUATION SHEET

Main Street Historic District  
Medina, Orleans County, New York

Section 7, Description, page 6

---

Presently used as a Senior Citizen's Center this hipped roof, stone building retains a high level of architectural integrity of materials, craftsmanship, and design. It is built of coursed, rock-faced Medina sandstone with contrasting areas of brown brick (around doors and windows) and stucco with half-timbering (in cross gable).

The southwestern end of the district is terminated by the visually prominent Medina Cold Storage Warehouse at 630 Main Street. The large, three-story, vernacular warehouse (1907) is constructed of a mix of gray and dark reddish-brown Medina sandstone with dark quoins. A modern refrigerated warehouse has recently been added to the rear of the historic warehouse. A frame packing house (1920-22) with stone foundation and novelty siding is attached on the south side.

The block of four buildings located at the bend in the road on the east side of Main Street at the northern end of the district generally have low to moderate levels of architectural integrity, yet as a group contribute to the overall historic feeling of the district. The northernmost building is the brick, Italianate style Brennan's Hall (1880), 333 Main Street, which retains the original cast iron pilasters at the storefront and round-arched windows with hoods on the second floor. Two doors down is the Butts Building, 337-339 Main Street, built in 1927 as an auto showroom. This two-story, brick building with stone trim features a simplified classical inspired design with full-height pilasters and a pediment above the entrance. The original storefront has been infilled with newer brick and smaller windows. The former Bancroft Hotel at 343-347 Main Street stands on the foundation of a ca. 1835 building. This structure has undergone many alterations through the years. It acquired its present appearance in 1927 after a fire had caused extensive damage to the upper floors and tower which had to be removed. The front block is built of Medina sandstone with segmentally arched windows on the second floor and at the main entrance. The brick storefront with its large display windows and multipaned, leaded

United States Department of the Interior  
National Park Service

NATIONAL REGISTER OF HISTORIC PLACES  
CONTINUATION SHEET

Main Street Historic District  
Medina, Orleans County, New York

Section 7, Description, page 7

---

transoms is a good, intact example of early-twentieth-century storefront design.

The block of buildings on the east side of Main Street between the access road leading to the municipal parking lot and East Center Street are predominantly brick Italianate structures, most erected in the 1870s, with a generally moderate to high level of architectural integrity (particularly at the upper stories). The Journal-Register Building (ca. 1873) at 409-413 Main Street is notable for its intact ornamental cast iron pilasters at the storefronts. The only building with a stone facade in this block is 415 Main Street (ca. 1870) featuring gray Medina sandstone of random ashlar. #417-419 Main Street (1891) is one of three Queen Anne influenced buildings in the district as characterized by its projecting bay windows with lattice panels. The small-scaled buildings with heavily modernized facades at 427 and 429 Main Street are non-contributing. Research reveals that the three-story building at 435 Main Street, erected in 1846, is the oldest surviving building in the district. This building is constructed of stone with a brick facade. The flat-linteled windows have fanciful crowns with a palmette design in the center. The upper part of the facade with its dentils and bracketed cornice matches that of the adjacent building at 431-433 Main Street perhaps indicating that it was altered to match its later neighbor. This row of buildings terminates with the corner building at 447 Main Street (1871) which retains some of the original ornamental cast iron pilasters at the otherwise modernized storefronts. The upper facade is divided into three bays by brick pilasters. Round-arched windows feature decorative stone drip moldings. The facade is crowned by brick corbelling and recessed brick panels. The buildings in this block have rear elevations which overlook the Erie Canal beyond the municipal parking lot. Here, as elsewhere in the district, many of the buildings have front facades of brick with rear walls of stone.

The block on the east side of Main Street between East Center Street and the railroad tracks features a mix of two

United States Department of the Interior  
National Park Service

NATIONAL REGISTER OF HISTORIC PLACES  
CONTINUATION SHEET

Main Street Historic District  
Medina, Orleans County, New York

Section 7, Description, page 8

---

and three-story brick and stone commercial buildings, many in the Italianate style, with widely varying degrees of architectural integrity. The lot at the southeast corner of Main and East Center Streets, is the village-owned Rotary Park (1991). This non-contributing site features a frame gazebo, sidewalks, grassy areas, and young trees. This was the site of a nineteenth-century commercial building which was destroyed by fire in 1971. Of special note in this block are the recently restored buildings at 539-545 Main Street (ca. 1880) and 547-549 Main Street (1903). #539-545 Main Street is a good example of Italianate commercial architecture featuring four storefronts with large transomed display windows and recessed entrances with transoms as well. The second floor has segmentally arched, double-hung wood windows with stone sills and elaborate keystoned drip moldings; and a stringcourse, bracketed eaves, and cornice above. #547-549 Main Street, known as the W.R. Curry Building (1903), is an outstanding Queen Anne style, brick building with recessed storefronts, oriel windows, stringcourses of rockfaced stone, latticework parapet panels, and corbelled brick piers. The only non-contributing building in this block is the vacant theater at 601-611. The main block of this early-twentieth-century building has been heavily altered by the installation of a stone veneer at the first floor facade and the removal of three oriel windows above. The large-scale Austin and Dye Cold Storage Warehouse (1901) at 613-615 Main Street, north of the train tracks, is the terminus at the southeastern end of the district. Like its companion building diagonally across the street at 630 Main Street, this is a vernacular, three-story structure built of locally quarried Medina sandstone. The window and door openings on the first floor have round-arched heads.

In addition to the Bent Block at 444 Main Street and Paddock's Hotel at 500-506 Main Street which have side elevations facing West Center Street, two buildings in the district front onto West Center: The Hart House, 111-115 West Center (ca. 1876), and The Downs and Kearney Block, 108 West Center (1899-1900). Built originally as a hotel, the

United States Department of the Interior  
National Park Service

NATIONAL REGISTER OF HISTORIC PLACES  
CONTINUATION SHEET

Main Street Historic District  
Medina, Orleans County, New York

Section 7, Description, page 9

---

Hart House is one of the district's most impressive, intact High Victorian Italianate buildings. This three-story, five-bay-wide, brick building features full-height, brick pilasters, segmentally-arched windows with stone crowns, brick corbelling, and a bracketed cornice. The Downs and Kearney Block, on the north side of the street, is a three-story, Medina sandstone, commercial building recently converted into apartments. The former storefronts on the first floor have been filled with a stone veneer and new windows. Full-height pilasters divide the upper facade, which is largely intact, into five bays. Queen Anne inspired oriel windows with decorative panels are located in each bay.

Around the corner at 413 and 415 Proctor Place are two contributing late-nineteenth-century, brick vernacular commercial buildings. The patterned red and black brickwork displayed in the arched lintels, stringcourse, and cornice of 413 Proctor Place enlivens an otherwise simple, vernacular facade.

The following buildings fronting onto East Center Street are included in the district: #109-113 East Center (ca. 1880s), Cooper Block at 110-114 East Center (1875), Maher Bros. Block at 116-120 East Center (1873/facade, 1903), J.S. Kelly Block, 122-128 East Center (1907). Despite storefront alterations the Cooper Block is one of the district's most prominent Italianate buildings. The side and rear walls of this building are constructed of Medina sandstone, while the facade is brick. Although the storefronts have been altered with new paneling and windows, most of the ornamental cast iron pilasters are intact. The upper stories have four-over-four, double-hung wood windows with segmentally-arched hoods. The facade is crowned by an arched corbel table. The Maher Brothers Block is the only Neo-Renaissance facade in the district. While the storefronts have been modernized the upper facade retains the original large Roman arches and rusticated brick pilasters.

United States Department of the Interior  
National Park Service

NATIONAL REGISTER OF HISTORIC PLACES  
CONTINUATION SHEET

Main Street Historic District  
Medina, Orleans County, New York

Section 7, Description, page 10

---

The archaeological potential for industrial remains in areas in and adjacent to the historic district has not been evaluated. Based on historic maps and photographs there may be subsurface remains in locations behind the buildings on the east side of Main Street where industrial buildings and warehouses once stood. (Most of the area has been paved over with macadam parking lots.)

The Main Street Historic District retains a high level of visual and architectural integrity and continues to reflect its historic identity as the commercial core of this Erie Canal village. The district has only three non-contributing buildings and one non-contributing site, and the impact of these on the continuity of the historic district is relatively minor.

An Annotated Building List describing each of the buildings in the historic district follows.

United States Department of the Interior  
National Park Service

NATIONAL REGISTER OF HISTORIC PLACES  
CONTINUATION SHEET

Main Street Historic District  
Medina, Orleans County, New York

Section 7, Description, page 11

---

Annotated Building List

MAIN STREET - EAST SIDE

Brennan's Hall/Brennan's Carriage Manufacture 333 Main Street Photo 15	1880, front; 1875, rear Contributing
--	--

Two-story, four-bay-wide, Italianate commercial building with brick facade; located at the northern boundary of the district. The storefront retains the original decorative cast iron pilasters manufactured by "S. Shorer, Rochester, N.Y," but has been altered by inappropriate modern plywood infill panels, modern replacement windows, and new doors. The second story has four, one-over-one, round-arched, double-hung wood windows with stone hood moldings and keystones. A stone beltcourse runs across the facade below the windows. Brick pilasters divide the second story into bays and connect to corbelled brickwork above. The upper part of the facade has four recessed brick panels, a stone block in the center with the building name "Brennan's Hall" and the date "1880," and a plain metal cornice. Attached to the rear of this building are the remains of a slightly wider, two-story stone building (1875) which backs up to the Erie Canal. This structure stands today as a mere shell, its roof and many of its original doors and windows are gone.

The rear building was built in 1875 by Lawrence Brennan, a local blacksmith, as a carriage manufacture. The front block was built five years later and may have served as the office and commercial space for the carriage company. The building is vacant today.

United States Department of the Interior  
National Park Service

NATIONAL REGISTER OF HISTORIC PLACES  
CONTINUATION SHEET

Main Street Historic District  
Medina, Orleans County, New York

Section 7, Description, page 12

---

335 Main Street  
Photo 15

ca. 1900  
Contributing

Three-story, brick commercial building with remodelled early-to-mid twentieth century facade. The storefront has large display windows and a recessed entrance with a glazed, wood frame door. A soldier course of bricks divides the first and second floors. The second floor has a group of three, one-over-one, double-hung windows with a rowlock course of bricks at the sill and a soldier course at the lintel. The wood-shingled mansard roof forms the third story. Two, one-over-one, double-hung windows with segmentally arched tops project from the front of the mansard.

Butts Building  
337-339 Main Street  
Photo 15

1927;  
facade altered in 1982  
Contributing

Two-story, four-bay-wide, brick commercial building currently used as a hair salon and appliance showroom. The facade is divided by five brick pilasters on stone pedestals, which extend to the plain brick parapet. The pilasters have modernistic triglyphs on the capitals. The north entrance has been infilled with aluminum paneling and modern double doors. The main entrance in the center bay has modern aluminum double doors with aluminum transom and sidelights, and the original stone pediment above. The original display windows on either side of the main entrance have been replaced by brick infill and small modern windows. Two of the second floor bays which originally had elaborate leaded glass transoms have been infilled with aluminum paneling. The building is crowned by a curved pediment with the building's date of construction and name in granite: "1927 Butts 1927."

The Butts Building was built in 1927 by Clark H. Butts as an auto showroom and shop. Frank W. Mallison was the architect of this steel frame building that took the place of a low



United States Department of the Interior  
National Park Service

NATIONAL REGISTER OF HISTORIC PLACES  
CONTINUATION SHEET

Main Street Historic District  
Medina, Orleans County, New York

Section 7, Description, page 14

---

(343-347 Main Street - cont'd)  
gable-roofed stone structure. In the early 1860s it housed a bank, grocery store, and meeting halls for the Masonic Lodge and the Odd Fellows. H.N. Bancroft acquired the building in 1872 and remodelled it into the Bancroft Hotel. Changes made during that era included the addition of a mansard roof to form a fourth floor, a tall clock tower, and a two-story, full-width front porch. Under Bancroft's ownership the property became an elegant hotel for canal travelers and local citizens. The basement of this building once housed the village jail. The building later became White's Hotel in 1886 and underwent additional remodeling. The hotel was heavily damaged by fire in January 1923. In 1927 the building was purchased by Medina Machine and Parts and the upper floors and upper portion of the tower removed, the storefronts were remodelled, and an addition built at the rear.

Medina Journal-Register Building  
409-413 Main Street  
Photos 15 & 16

ca. 1873  
Contributing

This two-story, brick Italianate building has housed the Medina Journal since 1920. The facade is divided into three bays by brick pilasters. Although the storefronts have been altered by the installation of new display windows, new doors, and some infill panels (left-hand storefront), the original cast iron pilasters with fanciful capitals and a base bearing the manufacturer's name: "W.H. Cheney, Rochester, N.Y." are intact. There are two entrances at the facade; left-hand one for the Medina Pennysaver and the right-hand one for the Medina Journal. At the interior of the left-hand entrance is a nineteenth century wood door with a dentilled wooden sill. Beneath all the display windows are wood panels. The middle storefront entrance is gone, with only the pilasters remaining and windows inserted in the opening. Separating the first and second floors is a metal and wooden entablature with brackets and dentils. The second story windows are four-over-four, round-arched,

United States Department of the Interior  
National Park Service

NATIONAL REGISTER OF HISTORIC PLACES  
CONTINUATION SHEET

Main Street Historic District  
Medina, Orleans County, New York

Section 7, Description, page 15

---

(409-413 Main Street - cont'd)  
double-hung wood sash with keystone drip moldings and stone sills. The upper facade is terminated by brick corbelling and seven recessed brick panels. The north wall of the building is brick and the rear (east) wall is stone.

The present building is on the site of an earlier building known as the Card Block that housed the Empire Hotel. The Card Block was damaged by fire on September 19, 1869. The present building was rebuilt by Edwin M. Card about 1873 on the foundation of the earlier structure.

415 Main Street  
Photos 15 & 16

ca. 1870  
Contributing

Three-story, three-bay-wide, gray Medina sandstone commercial building with modern storefront. The storefront has been altered by the installation of a veneer of Medina sandstone, modern display windows with wood paneling below, and a new wood sign band. The second and third floors retain a high degree of period architectural integrity with the original random ashlar stonework and stone quoins. The windows are the original, segmentally arched, four-over-four, double-hung wood sash with elaborately carved stone hood moldings and keystones. The building retains the original bracketed cornice.

417-419 Main Street  
Photos 15 & 16

1891  
Contributing

Three-story, brick commercial building with modernized storefronts. Both of the storefronts have modern stone veneer front, aluminum windows, new doors, and a new awning. The facade at the second and third floors features oriel windows, each bay having three windows with one-over-one, double-hung sash. There are decorative wood panels with a gridwork design and circular insets above the second floor windows. The third floor oriel windows are crowned by a

United States Department of the Interior  
National Park Service

NATIONAL REGISTER OF HISTORIC PLACES  
CONTINUATION SHEET

Main Street Historic District  
Medina, Orleans County, New York

Section 7, Description, page 16

---

(417-419 Main Street - cont'd)  
full-width frieze band of decorative squares and a cornice. The upper facade has recessed brick panels, corbelling, and a bracketed cornice. The rear (east) elevation has been modernized at the basement and first floors by the installation of new vertical wood siding and a pent roof. The second and third floors at the rear elevation are brick with four, one-over-one windows on each floor.

This building was erected in 1891 on the original foundation of an earlier building which was destroyed by fire. In 1913 this building was owned by the local chapter of the Odd Fellows. This fraternal organization was organized in 1869.

H.A. Bickle Block  
421-425 Main Street  
Photos 15 & 16

1877  
Contributing

Three-story, six-bay-wide, brick Italianate commercial building with one-story section attached on the south side. The storefronts retain some of their original, decorative cast iron pilasters manufactured by "W.H. Cheney, Rochester, NY." The capitals of these pilasters are obscured by the ceiling of the added canopy. There are large display windows with wood paneling below and two recessed entrances to the department store with modern aluminum doors. The original round-arched windows on the second floor have been replaced with four, straight-linteled windows. The round-arched, four-over-four, double-hung wood windows with stone hood moldings and keystones are intact on the third floor. The name "H.A.Bickle" appears in a stone block in the center of the facade above the third floor windows. The upper facade features elaborate recessed brick panels, a string mold, and a partially bracketed cornice. The upper part of the facade in the one-story section appears to be faced with twentieth-century replacement brick with vertical striations.

United States Department of the Interior  
National Park Service

NATIONAL REGISTER OF HISTORIC PLACES  
CONTINUATION SHEET

Main Street Historic District  
Medina, Orleans County, New York

Section 7, Description, page 17

---

(421-425 Main Street - cont'd)

The H.A. Bickle Block was erected in 1877. It housed the D.D. Holdredge Furniture Store in the early 1900s. The building has been the home of Kennedy's Clothing Store since 1974. Kennedy's was founded in Medina in 1931, originally located at 422 Main Street.

427 Main Street  
Photo 16

ca. 1874  
Non-contributing

This two-story building has a stone veneer on the first floor, and an aluminum paneled second floor. The storefront features a modern recessed glazed door, a transom with aluminum infill, modern aluminum windows, and an aluminum canopy.

429 Main Street  
Photo 16

ca. 1874  
Non-contributing

Two-story, two-bay-wide commercial building with modern stone veneer at the storefront and flush wood siding at the second floor. Two, four-over-four, round-arched, double-hung wood windows are intact on the second floor. The original cornice configuration is unknown; a metal cover currently covers the roof edge. The rear (east) elevation has concrete block at the lower level and a brick wall above.

431-433 Main Street  
Photo 14

ca. 1857  
Contributing

This three-story, six-bay-wide, Italianate brick building has two altered storefronts. The north storefront (431 Main) has original cast iron pilasters at either end. There is a concrete watertable with aluminum paneling at the base of the large modern display windows. The recessed entrance has a modern door with a paneled transom. An aluminum canopy spans the storefront, with aluminum paneling above.

United States Department of the Interior  
National Park Service

NATIONAL REGISTER OF HISTORIC PLACES  
CONTINUATION SHEET

Main Street Historic District  
Medina, Orleans County, New York

Section 7, Description, page 18

---

(431-433 Main Street - cont'd)

The south storefront (433 Main) has been modernized by a cobblestone veneer and is divided by two pilasters. Within each bay is a small, modern window, with the south recessed entrance containing a modern, glazed door. The storefront cornice with modillions is intact at #433.

Windows on the upper floor have segmentally-arched crowns. The second floor of the building has different window types above each storefront unit. Above #431 Main the three bays have modern one-over-one, double-hung windows, while in the three bays above #433 each window opening has pairs of two, two-over-two, double-hung windows. These windows all have a segmentally arched drip moldings with ornate scrolls. The third floor windows are all four-over-four, double-hung with wood sills and the same drip moldings as the second floor. The upper facade features dentilled brickwork and a bracketed cornice.

435 Main Street  
Photo 14

1846  
Contributing

Three-story, four-bay-wide, commercial building with brick facade. The storefront has large display windows with wood panels below, a recessed entrance with sidelights and transom, and a wood frame door with multiple panes. The facade at the second and third floors is largely intact with four, flat-linteled windows featuring fanciful crowns with scroll designs and palmettes. The second floor windows are one-over-one, double-hung replacement sash, while the third floor window openings each have pairs of narrow, two-over-two, double-hung sash. The upper facade design which matches that of the #431-435 Main Street, has a row of brick dentils, a brick string course, and a bracketed and dentilled cornice. The rear (east) elevation of this building is constructed of stone with stone quoins.

United States Department of the Interior  
National Park Service

NATIONAL REGISTER OF HISTORIC PLACES  
CONTINUATION SHEET

Main Street Historic District  
Medina, Orleans County, New York

Section 7, Description, page 19

---

(435 Main Street - cont'd)

This building is believed to be the oldest surviving structure on Main Street, dating back to 1846. Its facade detailing, especially the bracketed cornice, appears to date from second half of the nineteenth century. The building was constructed for a Mr. Burroughs. It once housed the Swan, Ives & Co., a grocery store (1860 map).

437-441 Main Street  
Photo 14

1871  
Contributing

Three-story, ten-bay-wide, brick Italianate commercial building with altered storefronts. The storefront at #437 has a modern brick base, large aluminum display windows, new wood pilasters, and an aluminum door with transom. The storefront at #439 has blue and gray Carrara glass panels including the sign panel with the former store name "Metz Brothers." This storefront has large display windows, and a recessed entrance with a glazed, wood frame door, sidelights, and transom. The storefront at #441 retains the original cast iron end pilasters manufactured by "W.H. Cheney, Rochester, NY." This storefront has large display window with wood replacement panels below and above. The recessed entryway has white, beige and black tile flooring. The door is a modern aluminum frame door with a partially infilled transom above. The second and third floors of the building feature the original four-over-four, round-arched, double-hung wood sash with arched hood moldings and keystones. The upper facade is notable for its brick corbelling and recessed brick panels. The original bracketed cornice, as shown in historic photographs, has been removed and a modern metal cap installed in its place. The rear (east) elevation is of stone construction with the exception of #437 which is brick.

This commercial building was erected in 1871. The former Metz Brothers Men's Clothing Store was located at #439 from 1949 up until 1991. The founding of this store dates back to the mid-1800s and was originally located at a site across

United States Department of the Interior  
National Park Service

NATIONAL REGISTER OF HISTORIC PLACES  
CONTINUATION SHEET

Main Street Historic District  
Medina, Orleans County, New York

Section 7, Description, page 20

---

(437-441 Main Street - cont'd)  
the street. When it closed its doors in 1991 it was  
considered the oldest clothing store in Orleans County.

443-445 Main Street  
Photo 14

1871  
Contributing

Three-story, brick Italianate commercial building. The storefront at #443 retains the original cast iron pilasters at either end. This storefront has large display windows with wood panels below, a recessed entrance with a glazed, wood frame door, and a wood panel above. A leaded, colored glass transom spans this storefront. The entrance to the stair is in the center bay of the first floor and features a wood paneled door with glazing in the upper half and a multipaned transom above. The storefront at #445 has been drastically altered by the removal of the original storefront walls, windows, door and transom, thus forming a recessed porch. Cast iron pilasters manufactured by "W.H. Cheney, Rochester, NY" are still intact. The brick wall at this modernized, recessed storefront is new as are the doors and center window.

The facade above the storefronts is divided into three bays by tall pilasters. The end bays have three windows on each floor. The center bay has paired windows. The second floor at #443 has been altered recently by the installation of new brick infill, three new, flat-linteled, vinyl windows, and a new cornice above. The remaining window openings on the facade have segmentally arched tops with stone hood moldings, keystones, and stone sills. Some of these openings retain the original four-over-four, double-hung wood sash, while others have replacement sash. The paired windows at the center bay have elaborate stone surrounds.

The upper part of the facade has been altered. Only the recessed brick panels remain intact. Other details including the original string molding, bracketed cornice, and round-arched central parapet are missing. The present cornice at #443 is a recent installation.

United States Department of the Interior  
National Park Service

NATIONAL REGISTER OF HISTORIC PLACES  
CONTINUATION SHEET

Main Street Historic District  
Medina, Orleans County, New York

Section 7, Description, page 21

---

447 Main Street  
Photo 14

1871  
Contributing

Three-story, brick, Italianate commercial building located at the northeast corner of Main and East Center Streets. The storefronts have large, modern display windows, and recessed entrances with aluminum frame doors, sidelights, and transoms. Some of the original ornamental cast iron pilasters, manufactured by "W.H. Cheney, Rochester, NY" are still intact. The original storefront cornice appears to have been removed and is now sheathed with metal panels. The second and third floors are divided by brick pilasters into three bays with two windows in the end bays and three in the center. The windows are one-over-one, double-hung wood sash with round-arched tops and elaborate hood moldings with keystones. Historic photos show that the windows were originally four-over-four, double-hung. The upper facade is ornamented with recessed brick panels and brick corbelling. The side elevation on East Center Street is divided by pilasters into six bays with single or paired windows in each bay.

This commercial building was erected in 1871. It housed the JCPenney Store from 1937 up until 1994. The former 1930s-era Penney's sign on this building, made of metal with a porcelain finish, was removed in 1994 and placed in the JCPenney Archives Museum in Dallas, Texas. The building is currently vacant.

Rotary Park  
Lot at southeast corner of  
Main and East Center Streets

1991  
Non-contributing site

This village-owned park is located on the site of a former commercial building which was destroyed by fire in the late 1960s. The park has a frame gazebo (1991), sidewalks, grassy areas, and trees.

United States Department of the Interior  
National Park Service

NATIONAL REGISTER OF HISTORIC PLACES  
CONTINUATION SHEET

Main Street Historic District  
Medina, Orleans County, New York

Section 7, Description, page 22

---

509 Main Street

1859  
Contributing

This three-story, four-bay-wide, commercial building is constructed of Medina sandstone with a brick facade. The storefront has been modernized. The storefront has an aluminum base and display windows, with a slightly recessed entrance containing aluminum doors and a transom. The upper two floors of the facade have early-twentieth-century brickwork. The second floor has three windows--the middle window openings being two bays wide--with stone sills. The two end windows are single panes with transoms while the middle window has three panes with two transoms. The four third floor window openings are intact with stone sills, but all sash are missing. Above the third floor are three brick rectangular panels below a dentilled cast iron cornice. The cornice has brackets on either end. The north and west sides of this building are constructed of Medina sandstone.

511 Main Street

ca. 1850s  
Contributing

This three-story, four-bay wide, brick commercial building once had an elaborate stepped parapet with fanciful scroll brackets, modillions, and cornice. The present cornice is a replacement. The storefront has large aluminum display windows with wood panels below, and a recessed entrance with a glazed, wood frame door and transom above. The second and third floors have one-over-one, double-hung replacement windows with metal panels in the upper part. The windows have decorative stone crowns. Of special note in the center bay of the third floor is the pair of window with a trefoil top and pointed crown.

United States Department of the Interior  
National Park Service

NATIONAL REGISTER OF HISTORIC PLACES  
CONTINUATION SHEET

Main Street Historic District  
Medina, Orleans County, New York

Section 7, Description, page 23

---

513 Main Street

ca. 1860s  
Contributing

This three-story, three-bay wide building with coursed ashlar facade originally had a stepped parapet with fanciful scroll brackets, modillions, and cornice. Also missing are the drip moldings at the round-arched windows, and the ornamental cast iron balcony balustrades at the center bay of the second and third floors. The windows have one-over-one, double-hung sash. The original windows (or possibly French doors) in the center bays have been removed. The storefront has large display windows with a marble base below, a recessed entrance, and leaded glass transoms across the entire front. One of the original cast iron pilasters is intact at the right side.

This building was constructed in the 1860s for owner Prentice Knight.

515-519 Main Street

ca. 1873  
Contributing

Two-story, nine-bay-wide, brick Italianate commercial building with three storefronts, each with recessed entrances. The storefront at #515 has been altered by the installation of modern aluminum windows, door, and transom. The storefront at #517 retains the original ornamental cast iron pilasters (manufactured by Cheney of Rochester) at each end and has a glazed transom across the front. This storefront has aluminum frame windows with wood paneling below. The storefront at #519 has also been remodelled with a glazed, paneled door, and large display windows with wood panels below. The architectural integrity of the second story facade is only partly intact; the major change occurring at #515 where the original segmentally arched windows have been replaced by metal casement windows and the upper part of the original window openings bricked in. The four segmentally arched, one-over-one, double-hung windows at #517 have decorative stone drip moldings with keystones.

United States Department of the Interior  
National Park Service

NATIONAL REGISTER OF HISTORIC PLACES  
CONTINUATION SHEET

Main Street Historic District  
Medina, Orleans County, New York

Section 7, Description, page 24

---

(515-519 Main Street - cont'd)

The windows at #519 have round heads with stone drip moldings and keystones. The upper facade of the building has decorative brick corbelling, recessed brick panels, and a metal cornice.

521-525 Main Street

ca. 1870s  
Contributing

This two-story, six-bay-wide, brick commercial building features heavily altered storefronts with modern replacement brick and aluminum windows and doors. The second story facade is intact with four-over-four, double-hung wood sash with stone sills and segmentally arched drip moldings and keystones. The upper facade has elaborate brick corbelling, recessed brick panels, and a metal cornice molding.

The building was constructed for brothers John and Charles Bland in the 1870s.

Swan Block  
527-537 Main Street  
Photos 12 & 13

1860  
Contributing

This two-story, fourteen-bay-wide commercial building is an excellent example of Medina sandstone construction. The storefronts at #527 and #529 retain their original ornamental cast iron pilasters and dentilled storefront cornice. There are large display windows with wood panels below, and recessed entrances with transoms above. The original stairway door (between #527 and 529) has been closed off and paneled over. The storefronts at #531-537 have been severely altered. These now feature modern brick infill, aluminum windows and doors, and a modern shed-roofed canopy. The facade at the second floor features random ashlar with stone quoins. The second floor windows have segmentally arched stone lintels. The upper facade has an ornate dentilled cornice with paired brackets. An original

United States Department of the Interior  
National Park Service

NATIONAL REGISTER OF HISTORIC PLACES  
CONTINUATION SHEET

Main Street Historic District  
Medina, Orleans County, New York

Section 7, Description, page 25

---

(527-537 Main Street - cont'd)  
segment of the cornice has been removed over the four end  
bays of #537.

This building was constructed in 1860 for Isaac Swan.

539-545 Main Street  
Photo 12

ca. 1880  
Contributing

This two-story, fourteen-bay-wide, brick commercial building is an excellent example of Italianate commercial architecture. The building was restored in 1988. The first floor has four recessed storefronts with large display windows and recessed entrances with transoms above. A cornice separates the first and second floors. The second floor windows are one-over-one, double-hung sash with stone sills and ornamental drip moldings with keystones. The building is terminated by a stringcourse and cornice.

This building was constructed ca. 1880 for Warren Ide. In 1912 part of this building housed the Martin and Brace hardware and farm implements store.

W.R. Curry Building  
547-549 Main Street  
Photo 11 & 12

1903  
Contributing

The W.R. Curry Building is a two-story, three-bay-wide, Queen Anne style, brick commercial building. The building was restored in 1988. The present storefronts feature large display windows and recessed entrances with glass transoms above. The second floor has two oriel windows in the end bays with one-over-one, double-hung windows and elliptical-shaped pediments with ornamental scroll designs. The paired double-hung windows in the center bay have rock-faced stone sills and lintels. The same stonework is also used at the four horizontal stringcourses on the facade. The upper facade features four corbelled brick piers with recessed

United States Department of the Interior  
National Park Service

NATIONAL REGISTER OF HISTORIC PLACES  
CONTINUATION SHEET

Main Street Historic District  
Medina, Orleans County, New York

Section 7, Description, page 26

---

(547-549 Main Street - cont'd)  
panels. Between these piers in the end bays are wooden lattice parapet panels. The center parapet panel has the original building owner's name "WR Curry" and the date "1903." The south elevation borders an alleyway.

601-611 Main Street  
Photos 11 & 17

Dates of building  
from north to south:  
ca. 1892, 1910, ca. 1908, 1906  
Non-contributing

This vacant property has been heavily altered making it non-contributing. In its current state the property incorporates four different buildings. The two-story, north section (built ca. 1892) has a visible, partial date of "18\_\_\_" in the covered parapet above the second floor. The main, two-story theater block (to the right) was built in 1910. The lower facade of this two-story theater has been remodelled with a stone veneer and new arches; the upper facade is brick. A modern marquee projects from the main block. The next building is a two-story, two-bay brick structure (built ca. 1908) with filled-in window openings and a dentilled cornice. The southernmost building is a one-story, two-bay brick structure with a filled-in archway featuring a Medina sandstone base, columns, arch and keystone with the date of "1906". To the right of the archway is a tall opening which leads through an alley. The upper part of this building has two recessed brick panels and a dentilled cornice. All of the buildings have rear walls built of Medina sandstone.

The north part of this property was once the Orleans Mills and S.P. Blood and Co. Established in 1892, the building date is still partially visible in the upper floor. A flour mill was located on the site of this building as early as the 1830s. The remains of the historic raceway are still located beneath the current building. The middle section of this theater was originally the Cook Theater, built in 1910 and was two stories tall and three bays wide. The Cook

United States Department of the Interior  
National Park Service

NATIONAL REGISTER OF HISTORIC PLACES  
CONTINUATION SHEET

Main Street Historic District  
Medina, Orleans County, New York

Section 7, Description, page 27

---

(601-611 Main Street - cont'd)

Theater later changed names to the Delmar Theater and the Diana Theater. The two-story building attached to the south of the theater block was once a machine shop run by E.H. Barrett and later was Audie's Service Station. The far south building was once Watson Barry's coalyard office.

Austin and Dye Cold Storage Co./  
Austin and Rowley Cold Storage Co.  
613-615 Main Street  
Photos 11 & 17

1901  
Contributing

This three-story, four-bay-wide, Medina sandstone building with quoins currently houses a carpet store. The first floor has an entrance in the left bay with an overhead garage door and T-11 paneling above. The round-arched opening to the right of the garage door has one-over-one, double-hung wood windows. The store entrance has a modern metal door, surrounding modern T-111 paneling, and the original fanlight above. The round-arched bay to the right of this entrance has modern, one-over-one, double-hung windows with stone sills and infill panels. The second and third floors have window openings with stone sills and flat lintels. A modern replacement window has been installed in a widened second floor bay. Below the bracketed wood cornice, in the center bay of the building, is a stone plaque dated 1901.

This stone vernacular building was constructed in 1901 originally used as a cold storage warehouse for apples, peaches, and pears by the Austin and Dye Cold Storage Company. In 1920 it became known as the Warehouse A of the Austin and Rowley Cold Storage Company (Warehouse B was diagonally across the street at 630 Main Street). A railroad siding once served this building.

United States Department of the Interior  
National Park Service

NATIONAL REGISTER OF HISTORIC PLACES  
CONTINUATION SHEET

Main Street Historic District  
Medina, Orleans County, New York

Section 7, Description, page 28

---

MAIN STREET - WEST SIDE

408 Main Street  
Photos 1 & 3

1881  
Contributing

This two-story, four-bay-wide, Italianate building is constructed of random ashlar, Medina sandstone. The storefront has been modernized with a veneer of stone, aluminum door and windows, and a modern awning. The second floor has one-over-one, double-hung round-arched windows with keystoned drip moldings. The upper facade has an ornamental cornice with scroll brackets and modillions.

This building was constructed about 1870 for owner J.A. French. It was one of a group of buildings in this section of Main Street which were built following an 1866 fire. Prior to the fire, this side of Main Street had a row of frame commercial structures.

J.A. French Block  
410-412 Main Street  
Photos 1 & 3

1868  
Contributing

This three-story, seven-bay-wide, Italianate commercial building houses two storefronts and is built of random ashlar, Medina sandstone. The storefront at #410 Main retains the original cast iron pilasters with Corinthian capitals. There is a recessed entry with a new glazed door, and transom covered with plywood. The transoms over the display windows are also covered with plywood. There is a center stair entrance with a replacement door. The storefront at 412 Main also retains the cast iron pilasters but the capitals are missing. The transoms here are covered by plywood. There is an aluminum door at the recessed entrance.

United States Department of the Interior  
National Park Service

NATIONAL REGISTER OF HISTORIC PLACES  
CONTINUATION SHEET

Main Street Historic District  
Medina, Orleans County, New York

Section 7, Description, page 29

---

(410-412 Main Street - cont'd)

The second and third floors have most of the original four-over-four, double-hung wood windows but the three near the north end of the third floor are covered by plywood panels. The center bay on the second and third floors features the original paired French doors with paneling below, and there are remnants of cast iron brackets of the former balconies in this location. Quoins frame the center bay and are used at the north end of the building as well. Above the center bay of the third floor is the inscription "J.A. French's Block, 1868." The original cornice has been removed and replaced by an aluminum covering.

This building was constructed in 1868 for owner J.A. French. It was one of a group of buildings in this section of Main Street which were built following an 1866 fire. Prior to the fire, this side of Main Street had a row of frame commercial structures.

E.M. Card Block  
414-416 Main Street  
Photos 1 & 3

1867  
Contributing

This three-story, five-bay-wide, Medina sandstone building has the same random ashlar masonry as the Kearney and French Blocks. The storefront at #414 Main is modernized with new brick in the lower half. The door and window are also new, and there are new wooden pilasters. #416 Main is also an altered storefront with a recessed entry. There is a glazed wood door and original transom infilled with a wood panel. The display windows are modern aluminum.

A double bay separates the Kearney and the Card Blocks, and retains an historic glazed, wood paneled, round-arched door. The second floor windows of the Card Block are one-over-one, double-hung with round-arched stone drip moldings and keystones. The third floor windows are four-over-four, double-hung with the same moldings. The three north bays

United States Department of the Interior  
National Park Service

NATIONAL REGISTER OF HISTORIC PLACES  
CONTINUATION SHEET

Main Street Historic District  
Medina, Orleans County, New York

Section 7, Description, page 30

---

(414-416 Main Street - cont'd)  
are framed by quoins. The original cornice appears to have been removed and is now sheathed with metal. This building was constructed about 1868 for Edwin M. Card (who also owned the other Card Block across the street at 409-413 Main Street). It was one of a group of buildings in this section of Main Street which were built following an 1866 fire. Prior to the fire, this side of Main Street had a row of frame commercial structures.

J.D. Kearney Block  
418-422 Main Street  
Photos 1-3

1867  
Contributing

Three-story, eight-bay-wide, Medina sandstone Italianate building with three storefronts. The storefront at # 418 Main is largely intact with original cast iron pilasters that have Corinthian capitals, and a recessed entrance with a two-pane transom and sidelights. #420 Main has an altered storefront with a recessed entrance and wood paneling. The original pilasters may be intact beneath the wood. #422 Main is a mid-twentieth-century storefront with large aluminum display windows and a recessed entrance with an Art Deco-inspired glazed, wood frame door with transom and sidelights.

The second floor has one-over-one, double-hung wood windows with keystone drip moldings joined by a continuous stringcourse. The third floor windows are four-over-four, double-hung with stone sills, and the same drip moldings and string course as below. The four center bays are framed by quoins, and above the center bay of the third floor is an inscription "J.D. Kearney's Block, 1867." The upper portion of the facade has a stone stringcourse and a modern aluminum cornice cap.

This building was constructed in 1867 for owner John D. Kearney. Kearney owned a quarry of Medina sandstone quarry nearby. The J.D. Kearney Block was one of a group of

United States Department of the Interior  
National Park Service

NATIONAL REGISTER OF HISTORIC PLACES  
CONTINUATION SHEET

Main Street Historic District  
Medina, Orleans County, New York

Section 7, Description, page 31

---

(418-422 Main Street - cont'd)

buildings in this section of Main Street built following an 1866 fire. Prior to the fire, this side of Main Street had a row of frame commercial structures.

424 Main Street  
Photos 1 & 3

Ca. 1867  
Contributing

Three-story, three-bay-wide, Italianate commercial building constructed of gray Medina sandstone. The storefront appears to date from the 1930s or '40s and features Carrara glass panels and angled display windows. Some of the Carrara glass is missing or chipped. The recessed entrance has a glazed, wood frame with a transom above. The facade at the second and third floors is random ashlar, gray Medina sandstone with quoins. Windows are one-over-one, double-hung wood with round-arched tops on the second floor and segmentally arched on the third floor. Windows are crowned by keystone hood moldings. Horizontal stringcourses run between the windows and the quoins on both the second and third floors. The original bracketed cornice has been replaced by a plain metal cover.

This building was built ca. 1867 for owner Edna Bowen. #424 Main Street was one of a group of buildings in this section of Main Street built following an 1866 fire. Prior to the fire, this side of Main Street had a row of frame commercial structures.

426 Main Street  
Photos 1 & 4

1875  
Contributing

Three-story, three-bay-wide, brick Italianate commercial building. Modernized storefront has large aluminum display windows with wood panels below, a recessed entrance with a glazed, wood frame door and screened transom above. The door leading to the stair (right bay) is wood with glazing

United States Department of the Interior  
National Park Service

NATIONAL REGISTER OF HISTORIC PLACES  
CONTINUATION SHEET

Main Street Historic District  
Medina, Orleans County, New York

Section 7, Description, page 32

---

(426 Main Street - cont'd)  
in the upper part and a transom, and has some surrounding white Carrara glass. The second and third floors retain a high level of period architectural integrity. Both floors have the original two-over-two, double-hung, round-arched wood sash with stone hood moldings and keystones. Vertical, recessed brick panels enliven the facade. A stone stringcourse is located below the sill of the third floor windows. The upper part of the facade has elaborate recessed brick panels, corbelling, and a triangular parapet wall in the center. The original cornice has been removed and is now sheathed in metal. This building was constructed in 1875 for owner Michael Slack.

Fuller Block  
428 Main Street  
Photos 1 & 4

1875  
Contributing

This three-story, five-bay-wide, brick Italianate commercial building houses the G.C. Murphy Store. There are three mid-twentieth-century storefronts, all with recessed entrances that have white, red, and gray mosaic tile flooring in the front with the store name "G.C. Murphy Co." The large display windows have a granite base, all containing metal panels with a decorative initial "M". The storefronts are separated by brick piers and have aluminum doors with transoms above. The ceiling of the entrance has wood paneling. The entrance at the north end has a wood paneled door on large hinges and infilled transoms above.

Both the second and third floors feature repetitive fenestration with two-over-two, round-arched, double-hung wood windows with keystoned drip moldings. Stone beltcourses run across the facade on both floors. Brick pilasters on the second and third floors divide the facade into five bays. Above the center, third floor bay is the original building owner's name "Fuller," with the date "1875" in stone. The upper facade is ornamented with brick

United States Department of the Interior  
National Park Service

NATIONAL REGISTER OF HISTORIC PLACES  
CONTINUATION SHEET

Main Street Historic District  
Medina, Orleans County, New York

Section 7, Description, page 33

---

(428 Main Street - cont'd)  
corbelling and an elaborate cornice with brackets and modillions. The cornice rises to a peak above the center bay.

Projecting from the rear (west) stone wall of the building is a one-story concrete block addition.

Cousins Darwin and Darius Fuller constructed this building in 1875 on the former site of the Methodist Church which was destroyed in a fire. The Fuller Block has been home to Murphy's Store since about 1947.

436-440 Main Street  
Photo 5

Ca. 1860s-70s  
Contributing

Two-story, ten-bay-wide, brick Italianate commercial building with altered storefronts. The two storefronts have recessed entrances with aluminum frame doors, large display windows and modern paneling. Shingled shed roofs have been installed above the two storefronts. The second floor has segmentally arched, one-over-one, double-hung wood sash with keystone hood moldings. Four of the window openings have been filled with plywood panels. Above the windows is corbelled brickwork, recessed brick panels, and a decorative cornice. The west elevation of the building is of stone construction. A one-story, shed-roofed, brick addition projects from the rear.

Bent's Block/Bent's Opera House  
444 Main Street  
Photos 6 & 19

1864-65  
Contributing

This three-story, nine-bay-wide, random ashlar, Medina sandstone building is currently used as a Fleet Bank and a religious center. Quoins mark the corners of this Italianate style building. The first floor facade has a new stone veneer front with an arcade and brick piers. The

United States Department of the Interior  
National Park Service

NATIONAL REGISTER OF HISTORIC PLACES  
CONTINUATION SHEET

Main Street Historic District  
Medina, Orleans County, New York

Section 7, Description, page 34

---

(444 Main Street - cont'd)  
first floor also has new aluminum frame windows and doors. On the second floor the windows are four-over-four, double-hung wood sash, with segmentally arched, stone drip moldings and stone sills. The center bay, which is outlined by quoins, spans the second and third floors and is now covered by a wood panel. The third floor also has four-over-four, round-arched, double-hung windows with segmentally arched drip moldings. The building name "Bents Block" appears on the stone crown in the upper part of the center bay. The upper facade has a wood replacement parapet wall with a central fan design.

The first floor of the south elevation has two aluminum windows and double doors in the original openings. The entrance has a new hood with the original segmentally arched crown stating "Bents Hall." The outline of a former frame newsstand can be seen on this elevation, east of the entrance. The second and third floor windows are the same design as the front elevation. The original cornice is intact on this elevation with fanciful brackets.

Bents Opera House was once the center of Medina's social and cultural life. Historic photographs reveal that there were originally three storefront entrances on the front facade, and an open staircase on the south elevation which has now been enclosed. There were also second and third floor balconies at the front facade accessed from the double doors in the center bay. The front facade was originally crowned by a bracketed cornice and a central pediment. The interior of the former theater, located on the third floor, is intact with a balcony and stage.

The contractors of this building were John Parsons and John Ryan. Waldron and Wesley Snell were hired as the carpenters.

United States Department of the Interior  
National Park Service

NATIONAL REGISTER OF HISTORIC PLACES  
CONTINUATION SHEET

Main Street Historic District  
Medina, Orleans County, New York

Section 7, Description, page 35

---

Paddock's Hotel/Moore's Hotel/Medina House 1855  
500-506 Main Street Contributing  
(and 107-109 West Center Street)  
Photos 6 & 20

Located at the southwest corner of Main and West Center Street this brick commercial building is three stories tall with six bays on the Main Street facade and fifteen bays on the West Center Street elevation. A frame oriel projects from the north elevation above an opening which leads to a courtyard behind the building. The two storefronts at the front of the building (#500-506 Main) have been altered with aluminum panels, windows, and doors. The storefronts at the side of the building at #107-109 W. Center retain some of the original cast iron pilasters manufactured by W.H. Cheney of Rochester. #109 West Center is the most intact storefront with its cast iron pilasters, wood frame windows, and recessed entrance with transom above. Fenestration in this building is repetitive with six-over-six, double-hung sash on the third floor and two-over-two and one-over-one, double-hung sash on the second floor. Windows have stone sills and pedimented crowns. Some of the original window openings on the first floor of the north elevation have been bricked in. The building is terminated by bracketed eaves and a cornice.

This building was erected in 1855 by Jerome Paddock and was known as Paddock's Hotel. It was later owned by Samuel Tibbetts who changed the name to the Medina House. An historic print reveals that the building was once crowned by a polygonal cupola. The Union Bank was located in this building from about 1875 up until their closure in 1931. Sometime during the late nineteenth century the Main Street facade was altered by the installation of storefronts with ornamental cast iron.

United States Department of the Interior  
National Park Service

NATIONAL REGISTER OF HISTORIC PLACES  
CONTINUATION SHEET

Main Street Historic District  
Medina, Orleans County, New York

Section 7, Description, page 36

---

508-510 Main Street  
Photo 6

1873  
Contributing

Two story, three-bay-wide, brick commercial building with two storefronts. The storefront at #508 has large display windows with wood panels below, and a recessed entrance with a glazed, wood frame door with a large transom above. The storefront at #510 is similar to #508 and retains the original cast iron pilasters manufactured by W.H. Cheney of Rochester. The three windows on the second floor have pedimented crowns. The facade is terminated by a replacement frieze board, dentils, and bracketed cornice.

This building was constructed in 1873 by Samuel Tibbetts as an addition to the Medina House hotel (500-506 Main Street).

512 Main Street  
Photo 6

1871;  
ca. 1930s-40s storefront  
Contributing

This two-story, brick, Italianate commercial building is three bays wide at the front. The first floor storefront is an excellent intact example of the Art Deco style as shown by the red and black Carrara glass. The recessed entrance has a glazed, wood frame door with a covered transom above. The intact Italianate style second story facade features round-arched, four-over-four, double-hung wood windows with stone drip moldings and keystones. The upper facade is ornamented with brick corbelling, recessed brick panels, and a metal cornice.

This building was rebuilt after a fire in 1871. It once housed a shoe store and a doctor's office.

United States Department of the Interior  
National Park Service

NATIONAL REGISTER OF HISTORIC PLACES  
CONTINUATION SHEET

Main Street Historic District  
Medina, Orleans County, New York

Section 7, Description, page 37

---

Central Bank of Medina  
514 Main Street  
Photos 6 & 7

1890; 1926 facade remodelled  
Contributing

This two-story, stone-clad, Neo-classical bank building is three-bays wide with a center entrance. The facade is articulated by monumental, Doric order pilasters. Above the pilaster is a wide entablature with a dentilled cornice and a classical attic above. The entrance is crowned by a stone console table with decorative scrolls and a shield above. The original doors have been replaced by modern aluminum frame doors. The windows are modern aluminum replacements with snap-in muntins. The side and rear walls of the bank are brick.

This building was the former Lewis Shoe Store, built by Michael Cooper in 1890. The Central Bank of Medina remodelled the facade in the Neo-classical style in 1926. The building is now owned by Marine Midland Bank.

First Presbyterian Church  
520 Main Street  
Photos 7 & 8

1872; 1955 (rear addition)  
Contributing

This Romanesque Revival style brick church maintains its original function as a church. It is built on the site of an 1836 stone church that burned in an 1870 fire. The main block of the present church is three bays wide with round-arched, stained glass windows, and a tower to the north. The building is constructed atop a coursed, ashlar foundation of Medina sandstone. The facade bays are defined by engaged buttresses. The center entrance is round-arched with a stained glass transom just above the double doors. The arched corbel table, a characteristic feature of the Romanesque Revival, is seen in the upper facade just below the wooden cornice. An arched corbel table can also be found in the tower. The church is setback several feet from the sidewalk, unlike the surrounding commercial buildings along Main Street which are built at the sidewalk. Behind

United States Department of the Interior  
National Park Service

NATIONAL REGISTER OF HISTORIC PLACES  
CONTINUATION SHEET

Main Street Historic District  
Medina, Orleans County, New York

Section 7, Description, page 38

---

(520 Main Street - cont'd)  
the church is a modern, two-story, concrete block addition,  
used as an education building.

S.A. Cook Building  
526-540 Main Street  
Photo 8

1911  
Contributing

This two-story, buff-colored brick building is twelve bays wide with ten storefronts. This is an excellent example of early-twentieth-century commercial architecture as shown by its long, horizontal orientation. It was built on the site of a former Gothic Revival inspired frame commercial building which burned in 1907. The storefronts feature large display windows; recessed entrances with glazed, wood frame doors with brass handles and kickplates, and transoms; and storefront cornice. Each storefront is defined from above by groups of three windows featuring smooth stone sills and brick jack arch lintels. There is a dentilled wooden cornice above the second floor windows, above which is a long brick parapet with a stone cap. The parapet rises at the building's center with the name "S.A. Cook Building" in raised brick. Behind the building to the west is an asphalt parking lot.

City Hall  
600 Main Street  
Photo 9

1908  
Contributing

This two and one-half story, nine-bay-wide, Richardsonian Romanesque inspired government building is constructed of rock-faced, reddish-brown, Medina sandstone with a early-to-mid twentieth century cinder block addition on the west side (which houses the Fire Department). A small passageway connects the rear addition with the main block. A smooth-finished stone watertable is located above the foundation. First floor windows are one-over-one, double-hung wood with round-arched, keystone lintels above. A stone porch with

United States Department of the Interior  
National Park Service

NATIONAL REGISTER OF HISTORIC PLACES  
CONTINUATION SHEET

Main Street Historic District  
Medina, Orleans County, New York

Section 7, Description, page 39

---

(600 Main Street - cont'd)

classical stone piers is located at the center entrance. The entrance consists of a pair of glazed, wood frame doors with a transom and sidelights. Above this is a large round-arched fanlight. The third floor windows have continuous smooth, stone stringcourses bordering at top and bottom. Above the top stringcourse are the overhanging eaves of the hipped roof. Many of the original interior features such as window and door moldings, doors, and stairs are still intact.

610 Main Street

ca. 1902  
Contributing

Two-story, rectangular plan, commercial building with modern siding over the brick at the facade. This building has retained its original mansard roof and dormers with segmentally arched pediments. The dormers have one-over-one, double-hung windows. Historic photographs reveal that the facade originally had two storefronts with recessed entrances and large display windows with transoms. The storefronts have been replaced with modern casement windows, decorative stucco and half-timbering, and an awning.

The building was constructed about 1902 for John S. Kelly by Dewitt Grinnell, contractor.

Dye Cold Storage Co./

Austin & Rowley Cold Storage Co./

Medina Cold Storage

630 Main Street

1907 (stone warehouse);  
1920-22 (frame packing house);  
1981 (refrig. warehouse addition)  
Contributing

This large cold storage building has a mix of gray and reddish brown Medina sandstone, with quoins at the corners. The main block is three stories with both original and infilled window openings. The north elevation has double

United States Department of the Interior  
National Park Service

NATIONAL REGISTER OF HISTORIC PLACES  
CONTINUATION SHEET

Main Street Historic District  
Medina, Orleans County, New York

Section 7, Description, page 40

---

(630 Main Street - cont'd)  
doors which once led out to a loading dock which has recently been removed. A large aluminum addition was added on the west side of the building in 1981. On the south side of the building is a one-story, frame packing house with novelty siding and a stone foundation. This addition was erected in the early 1920s and incorporated a gable-roofed, frame railroad depot which was moved here from the tracks in 1908. Between the two buildings is a courtyard with a shed-roofed loading dock.

This stone vernacular building was originally used for the cold storage of apples, peaches, pears and other fruit. It began as the Dye Cold Storage, then became the Austin and Rowley Co., and finally Medina Cold Storage. A railroad siding once served this building. The building has been modernized as a refrigerated warehouse.

WEST AVENUE - EAST SIDE

New York Central Railroad Station  
615 West Avenue  
Photo 10

1908  
Contributing

Contributing, one-story, hipped roof train station constructed of coursed, rock-faced Medina sandstone. Dark brown brick is used around some of window and door openings to contrast with the reddish-colored sandstone. Windows are one-over-one wood sash with lattice designs in the upper sash. Transoms with lattice muntins are also used above the door openings. Door types on the trackside (south) elevation include two hinged, paneled doors with glazing in the upper part, and sliding, tongue and groove, double doors for baggage. The broad overhanging eaves of the station are ornamented with paired wood brackets. The roof, now sheathed in asphalt shingles, was originally clay tile. A one and one-half story, cross-gabled bay is located in the center of the south elevation. The upper gable end of this

United States Department of the Interior  
National Park Service

NATIONAL REGISTER OF HISTORIC PLACES  
CONTINUATION SHEET

Main Street Historic District  
Medina, Orleans County, New York

Section 7, Description, page 41

---

(615 West Avenue - cont'd)  
features stucco and decorative half-timbering and a band of three square windows. Many of the interior finishes and features are intact.

This structure was built in 1908 as a passenger station for the New York Central Railroad. It now serves as the Medina Senior Citizens Center. (The freight station is located to the west, beyond the boundaries of the historic district.)

EAST CENTER STREET - NORTH SIDE

109-113 East Center Street  
Photo 22

ca. 1880s  
Contributing

This two-story, brick commercial building with altered storefronts is located at the corner of East Center and Mill Streets. The storefront at #109 has a flush metal door, aluminum display windows, and black Carrara glass at the base and at the signboard. The storefront at #113 has a modern brick base, new display windows with wood muntins, a recessed aluminum door, and a modern aluminum sign band. The original second floor windows have been removed, and the upper part of the opening partially bricked in, and new, shorter, double-hung windows installed. The upper facade has a stringcourse and bracketed cornice with modillions

This building was erected in the 1880s for a Mr. Ratcliffe. A mill race once ran to this building.

United States Department of the Interior  
National Park Service

NATIONAL REGISTER OF HISTORIC PLACES  
CONTINUATION SHEET

Main Street Historic District  
Medina, Orleans County, New York

Section 7, Description, page 42

---

EAST CENTER STREET - SOUTH SIDE

Cooper Block  
110-114 East Center Street  
Photo 21

1875  
Contributing

Three-story, seven-bay-wide, commercial building with brick Italianate style facade. Seven of the original cast iron pilasters, manufactured by the Cheney Company of Rochester, NY, are intact at the storefronts. The storefronts have been substantially modernized with new materials including a stone veneer, vinyl panels and windows, and aluminum doors. The windows on the second and third floors are segmentally arched, four-over-four, double-hung wood sash with stone drip moldings and keystones. The date of the building "1875" appears in a stone block above the second floor, the center bay. The original building owner's name "Cooper" appears in stone panel above the third floor. The facade is crowned by an arched brick corbel table and a metal cornice.

The side and rear walls of the building are random Medina sandstone. A one-story, shed-roofed, concrete block addition is attached to the south side of the building. This building was constructed for a Mr. Cooper, a blacksmith, in 1875. A mill race once ran to this building.

Maher Bros. Block  
116-120 East Center Street  
Photo 21

1873/facade 1903  
Contributing

Three-story commercial building consisting of a U-shaped, Medina sandstone building (1873) in the rear with a Neo-Renaissance brick facade (1903). The two storefronts have been altered by the installation of new paneling, doors, and windows. Tall rusticated brick pilasters separate the facade into three bays. The two end bays each have three one-over-one, double-hung windows on the second floor and a group of three windows set into a large Roman arch on the third floor. Three brick recessed panels are located

United States Department of the Interior  
National Park Service

NATIONAL REGISTER OF HISTORIC PLACES  
CONTINUATION SHEET

Main Street Historic District  
Medina, Orleans County, New York

Section 7, Description, page 43

---

(116-120 East Center Street - cont'd)  
between the second and third floors. The center bay has pairs of one-over-one, double-hung windows on each floor and a stone block above with the business name "Maher Bro's" and the date "1903." The stone portion of the structure at the sides and rear has stone quoins at the corners. A one-story, frame addition projects from the rear facade. A large parking lot, which was once an industrial site, is located behind the building.

This building was erected in 1873 as the Davey Carriage Works. It was bought by the Maher Brothers, a furniture manufacture, in 1899. The original facade of the building was destroyed by fire in 1903 and was rebuilt.

J.S. Kelly Block  
122-128 East Center Street  
Photo 21

1907  
Contributing

One-story commercial building with brick facade located at the eastern boundary of the historic district. The four storefronts have been heavily altered by the installation of modern wood paneling, new windows and doors, and a projecting shed roofed canopy. The rusticated brick pilasters (lower portion obscured) divide the facade into four bays. The upper facade has brick corbelling and recessed panels. A stone block with "JS Kelly 1907" appears in the second bay from the right.

The eastern section of this building (east elevation and partial south elevation) is stone while the rest of the building is brick.

United States Department of the Interior  
National Park Service

NATIONAL REGISTER OF HISTORIC PLACES  
CONTINUATION SHEET

Main Street Historic District  
Medina, Orleans County, New York

Section 7, Description, page 44

---

WEST CENTER STREET - NORTH SIDE

Downs & Kearney Block  
108 West Center Street  
Photo 19

1899-1900  
Contributing

This three-story, five-bay wide, Medina sandstone building is located at the northeast corner of West Center Street and Proctor Place. It was originally built as a commercial building but has recently been converted to apartments. Alterations to the building include the removal of the original storefronts on the south elevation and the replacement of the original windows with new double-hung windows with metal panels in the upper part. A new stone front with modern windows and entrance have been installed on the first floor facade. The second and third floors of the south elevation are largely intact with tall stone pilasters dividing the facade into five bays. The oriel windows in each bay have decorative wood panels with recessed designs. Cornerstones with the dates 1899 and 1900 can be found in the upper part of each end pilaster. The facade is terminated by a cornice with classical acanthus leaf designs on the brackets and egg and dart moldings.

This building was erected in 1899-1900 for owners Frank Kearney and Fred L. Downs.

WEST CENTER STREET - SOUTH SIDE

Hart House/Robert H. Newell & Co.  
111-115 West Center Street  
Photo 20

ca. 1876  
Contributing

This three-story, five-bay-wide, brick building is an excellent example of High Victorian Italianate commercial architecture. It features elaborate Renaissance-inspired segmentally arched stone crowns with keystones at the window heads. Horizontal stone stringcourses extend from window to

United States Department of the Interior  
National Park Service

NATIONAL REGISTER OF HISTORIC PLACES  
CONTINUATION SHEET

Main Street Historic District  
Medina, Orleans County, New York

Section 7, Description, page 45

---

(111-115 West Center Street - cont'd)  
window and to the brick pilasters. The windows at the front facade are one-over-one, double-hung wood sash. The facade is terminated by brick corbelling and eaves with wood scroll brackets. The left-hand storefront retains one of the original cast iron pilasters manufactured by W.H. Cheney of Rochester. This storefront originally featured a pair of doors in the right-side. The main entrance to the building features sidelights and an arched transom above. Historic photographs reveal that a porch with a wood balustrade above once projecting from the entrance. The building also once had an ornamental cast iron balustrade at the third floor windows at the center of the facade. The right-hand storefront is a twentieth century addition.

The west elevation is thirteen bays wide with repetitive fenestration. A driveway is located west of the building. Part of the rear (south) elevation is of stone construction with a small brick addition.

This building was constructed about 1876 by Jacob Gorton. He sold it about 1880 to E. Kirk Hart and it then became the Hart House, a hotel. In the early 1900s it was one of four hotels in the village. It has been owned by Robert H. Newell & Co., manufacturers of shirts, since 1919.

PROCTOR PLACE - EAST SIDE

413 Proctor Place

ca. 1880  
Contributing

This two-story, six-bay-wide, vernacular brick building with Medina sandstone foundation currently houses a paint and wallpaper store. All bays have segmentally arched window openings; some of the first floor windows have been filled with brick. The remaining first floor windows are one-over-one, double-hung wood, with the two north windows having modern, snap-in muntins. The window and door lintels,

United States Department of the Interior  
National Park Service

NATIONAL REGISTER OF HISTORIC PLACES  
CONTINUATION SHEET

Main Street Historic District  
Medina, Orleans County, New York

Section 7, Description, page 46

---

(413 Proctor Place - cont'd)  
stringcourse, and corbelled cornice feature decorative red  
and black brickwork.

This building is an example of a vernacular brick mercantile  
building, and once housed a bakery. It was rebuilt about  
1880 following a fire.

415 Proctor Place

ca. 1892  
Contributing

Two-story, four-bay-wide brick vernacular building with  
stone foundation. The first floor has wooden double doors  
and an archway leading through the building. Windows are  
four-over-four, double-hung wood with stone sills, brick  
arches, and modern shutters. The facade is terminated by a  
corbelled brick cornice. A gravel parking lot is located  
behind the building.

The building was constructed about 1892 as a wagon  
manufacture. It later became a blacksmith shop. Deeds  
indicate that a right-of-way once went through the arched  
tunnel of the building.

8. Statement of Significance

Applicable National Register Criteria

(Mark an "x" in one or more boxes for the criteria qualifying the property for National Register listing.)

- [X] A Property is associated with events that have made a significant contribution to the broad patterns of our history.
[ ] B Property is associated with the lives of persons significant in our past.
[X] C Property that embodies the distinctive characteristics of a type, period, or method of construction or represents the work of a master, or possesses high artistic values, or represents a significant and distinguishable entity whose components lack individual distinction.
[ ] D Property has yielded, or is likely to yield, information important in pre-history or history.

Criteria Considerations: NA

- [ ] A owned by a religious institution or used for religious purposes.
[ ] B removed from its original location.
[ ] C a birthplace or grave.
[ ] D a cemetery.
[ ] E a reconstructed building, object or structure.
[ ] F a commemorative property.
[ ] G less than 50 years of age or achieved significance within the past 50 years.

Narrative Statement of Significance

See attached continuation sheets.

9. Major Bibliographical References

See attached continuation sheets

Previous documentation on file (NPS): Primary location of additional data:

- [ ] preliminary determination of individual listing (36 CFR 67) has been requested
[ ] previously listed in the National Register
[ ] previously determined eligible by the National Register
[ ] designated a National Historic Landmark
[ ] recorded by Historic American Building Survey #
[ ] recorded by Historic American Engineering Record #

Area of Significance

(Enter categories from instructions.)

- Agriculture
Transportation
Commerce
Politics/Government
Entertainment/Recreation
Architecture

Period of Significance

ca. 1845 - ca. 1945

Significant Dates

na

Significant Person

(Complete if Criterion B is marked above.)

na

Cultural Affiliation

na

Architect/Builder

na

Name of repository:
Division for Historic Preservation

United States Department of the Interior  
National Park Service

NATIONAL REGISTER OF HISTORIC PLACES  
CONTINUATION SHEET

Main Street Historic District  
Medina, Orleans County, New York

Section 8, Statement of Significance, page 1

---

### Statement of Significance

The Main Street Historic District is architecturally and historically significant as an intact village commercial center adjacent to the Erie Canal, which retains significant streetscapes and buildings illustrating the growth and development of Medina between 1825 and 1945. The district encompasses the village's historic commercial core along Main Street and the portions of the side streets of East and West Center Streets, Proctor Place, and West Avenue. Most of the buildings retain integrity of design, materials, and craftsmanship and, as a group, the buildings retain integrity of setting and location. The district includes representative examples of national architectural styles popular during the district's period of significance, ranging from Italianate to Neo-classical. It is distinguished by significant concentrations of buildings constructed of locally quarried Medina sandstone. While the majority of buildings in the district are commercial, other building types are represented as well including cold storage warehouses, a train station, a church, and a village hall (known as "City Hall"). Together, the historic streetscapes and buildings of Medina's Main Street Historic District retain a high degree of integrity and recall the historic development and evolution of this Orleans County community.

The development of Medina paralleled settlement patterns of other population centers within western New York following the Revolutionary War. The area that is now Medina was originally part of the Holland Purchase owned by a group of investors from the Netherlands, known as the Holland Land Company. In 1795 this company acquired 3.3 million acres that included most of western New York, west of the Genesee River. The Holland Land Company hired Joseph Ellicott to survey the land and to act as their land agent. He and his nephew, David E. Evans, opened the Holland Land Company's office in Batavia in 1801.

United States Department of the Interior  
National Park Service

NATIONAL REGISTER OF HISTORIC PLACES  
CONTINUATION SHEET

Main Street Historic District  
Medina, Orleans County, New York

Section 8, Statement of Significance, page 2

---

The land that became Medina was situated at the intersection of townships 14 and 15 and ranges 3 and 4, known later as Shelby and Ridgeway. In the early 1820s Ellicott and Evans acquired 1,400 acres of land in these two townships which they considered a good investment due to the untouched forests and the waterpower provided by Oak Orchard Creek.

Early settlement in these townships was slow. One of the earliest settlers was Samuel F. Gear who built a sawmill about 1805 for Ellicott on the falls of Oak Orchard Creek (located two miles south of present Medina). A salt works at a spring north of the present village was also established about the same time. Since no roads were cleared to provide access to the sawmill it soon fell into disrepair and closed.

Medina did not begin to be settled until it was confirmed that the Erie Canal would pass through here. It is, in fact, thanks to the Erie Canal that the village owes its very existence. The first dwellings where the village now stands were built for canal laborers and masons in the early 1820s.

The building of the Erie Canal was a turning point in the history of the nation, state, region, and the village of Medina. Construction on the canal began in 1817. Artemas Allen, Medina's first mason, was in charge of constructing an aqueduct for carrying the canal over Oak Orchard Creek. By 1823 the canal reached as far west as Rochester. By 1825 the canal was completed; extending from Albany to Buffalo, a distance of 363 miles.

The Erie Canal brought about a transformation in western New York by bringing the pioneer era to a close. Thanks to the canal, farmers had easy access to outside markets and the transition from subsistence to commercial farming had begun. Goods and produce could be shipped more easily and quickly than ever before. The Canal reduced the cost of transporting a ton of freight from New York City to Buffalo from about \$100 to \$10, and shortened the time required for

United States Department of the Interior  
National Park Service

NATIONAL REGISTER OF HISTORIC PLACES  
CONTINUATION SHEET

Main Street Historic District  
Medina, Orleans County, New York

Section 8, Statement of Significance, page 3

---

the trip from 20 to 8 days.<sup>1</sup> New communities like Medina, sprang up along its banks and older communities along its route grew in size.

The original canal was little more than a ditch; 40 feet wide at the surface, 28 feet at the bottom, with four feet of water. The capacity was soon found to be inadequate and the canal commissioners enlarged the canal in the period from 1835 up to about 1862. The canal was further widened and deepened early in this century to accommodate large boats.

In 1823 Ebenezer Mix was sent by the Holland Land Company to survey and layout a village at the point where the townships of Ridgeway and Shelby meet. The newly laid out village was located at a bend in the Erie Canal at about the halfway point on the canal between Rochester and Buffalo. Medina developed as a way station for barges to collect needed supplies, and also as an overnight stop for people traveling on the canal.

The opening of the canal in 1825 created an era of growth for the settlement. The combination of the transportation opportunities of the Erie Canal, the waterpower of Oak Orchard Creek, surrounding fertile land, and valuable beds of sandstone made Medina a boom town. People permanently settled here, built residences, and opened stores, hotels, and mills.

The village initially developed on the south bank of the canal with all of the early commercial buildings being constructed there. This area became known as the docks. Shops, markets, taverns, and warehouses were once located on the docks. Goods were received and shipped from here. Sylvanus Coan is credited with opening the first, small

---

<sup>1</sup>Clayton Mau, *The Development of Central and Western New York* (Dansville, NY: F. A. Owen Publishing Co., 1958) 215-216.

United States Department of the Interior  
National Park Service

NATIONAL REGISTER OF HISTORIC PLACES  
CONTINUATION SHEET

Main Street Historic District  
Medina, Orleans County, New York

Section 8, Statement of Significance, page 4

---

general store here in 1824 to serve the increasing population, mostly builders of the canal and later, its permanent settlers.

At the time of its incorporation in 1832, just seven years after the opening of the Erie Canal, Medina had grown to a bustling village. The 1840 census lists an estimated figure of 700 inhabitants in the village. Medina developed into a thriving Erie Canal village which served as the center of commercial, industrial, political, and social activity for the surrounding agrarian townships.

The village's original streets were laid out in 1826 with the land along Shelby Street (now Main Street), East Center Street, and the canal docks being the most developed. The majority of the early commercial buildings and residences were on Shelby and East Center Streets. In 1849 William Hedley purchased 78 acres of undeveloped land in the southwest part of the village and laid out streets, surveyed lots, and built homes. In 1871 Henry Bancroft developed the land in the northwest part of the village.

Mill races were built from Oak Orchard Creek, on the east side of the village, to power various mills and industrial sites in the village. In 1825 David Evans built a mill dam at the creek that connected to the canal by means of a raceway. This raceway ran along the east side of present Orient Street and emptied into the canal. Another mill race branched off of the first race and ran northerly along the west side of Main Street to the site of present City Hall. It then headed east under Main Street in a viaduct to David Evans' mill (later the site of the S.P. Blood & Co. Mill, 601 Main Street). The portion of this mill race beneath Main Street and the former mill site is reportedly still intact. Another branch extended from this raceway and ran north to the canal along the east side of present Mill Street. The following early mills and industries were dependent on the waterpower provided by the raceways as early as 1832: David E. Evans's Orleans Mills, W.R. Gwinn's custom mills, Simeon Bathgate's furnace, Ingersoll and

United States Department of the Interior  
National Park Service

NATIONAL REGISTER OF HISTORIC PLACES  
CONTINUATION SHEET

Main Street Historic District  
Medina, Orleans County, New York

Section 8, Statement of Significance, page 5

---

Bagley's Medina Tannery (which later became the T.S. Wilcox & Co. Flour Mill), Joseph Nixon's brewery, Clark's carding works, Ross's shingle factory, and Gwynne's sawmill.

The hotel business boomed in Medina after the opening of the Erie Canal. These early hotels accommodated new settlers, travellers, and local citizens, and were important for the prominent role they played as centers of social, recreational, cultural, and informal political activity. Uri Moore opened the first hotel in Medina in 1824 on Main Street, near the canal. This hotel, like many of the other early hotels and taverns, was destroyed by fire. The former Bancroft Hotel at 343-347 Main Street is located adjacent to the canal. This building has undergone many changes through the years, especially following a fire in 1923. Its history as a hotel began in 1872 when H.N. Bancroft acquired the existing Arcade Building and extensively remodelled it into a hotel. Under Bancroft's ownership the building became an elegant hotel for canal travelers and local citizens. It once featured a tall clock tower which became a popular observation point for viewing the surrounding landscape. The building later became White's Hotel in 1886. Another surviving hotel building in the district is the Hart House at 111-115 West Center Street, constructed about 1876. The Hart House is architecturally significant as a distinctive example of High Victorian Italianate hotel architecture. Distinguished by a high level of integrity of design, workmanship, and materials, the former hotel embodies a variety of typical characteristics of the style, including segmentally arched stone crowns, brick corbelling, and wide overhanging eaves with scroll brackets. Next door to this building at 500-506 Main is one of its former competitors originally known as Paddock's Hotel. Built in 1855 this three-story, brick structure is Medina's oldest surviving hotel building.

Medina enjoyed a period of accelerated growth with the coming of the railroads in the mid-nineteenth century. Trade and transportation gradually shifted from the canal to the expanding railroad network, although the canal continued

United States Department of the Interior  
National Park Service

NATIONAL REGISTER OF HISTORIC PLACES  
CONTINUATION SHEET

Main Street Historic District  
Medina, Orleans County, New York

Section 8, Statement of Significance, page 6

---

to be used for transporting bulk products such as stone, iron, and coal. In 1850 the Rochester, Lockport and Niagara Falls Railroad Company contracted to run its line through Medina. This railroad line was later acquired by the New York Central Railroad, followed by the Penn Central Railroad, and now is Conrail. These tracks are located near the southern end of the district. The railroads provided a means of transporting both passengers and freight quickly and inexpensively over great distances. Medina began to thrive on the rapid growth of an agricultural economy, the availability of natural resources, and the expanding railroad network which facilitated trade. The railroads encouraged the development of industry by establishing year round access to raw materials and by providing a reliable network for the distribution of manufactured goods. Products manufactured in Medina as well as the fruit, vegetables, and grains from the region had a faster means of reaching expanded markets. Later, with the advent of the automobile and the trucking industry, passengers no longer patronized the railroad and currently the line only transports limited freight. The New York Central Station at 615 West Avenue is significant as an outstanding, intact example of early-twentieth-century railroad architecture built of locally quarried Medina sandstone.

In the early 1900s the Rochester, Lockport and Buffalo Railroad (RL & B RR) provided trolley service to Medina. This electric railway line offered hourly passenger service both east and west bound between Rochester and Buffalo. The trolley line ran along East Center Street, up the center of Main Street north to Commercial Street, then on a private right-of-way to the Salt Works Road at West Center Street. Trolley service was discontinued in 1931 and the tracks removed thirty years later.

The transportation improvements brought by the railroads became the impetus for the establishment of several new industries and the expansion of existing ones in the village. The listings in the 1903 village directory offer a glimpse of the different types of industries and

United States Department of the Interior  
National Park Service

NATIONAL REGISTER OF HISTORIC PLACES  
CONTINUATION SHEET

Main Street Historic District  
Medina, Orleans County, New York

Section 8, Statement of Significance, page 7

---

manufacturers in Medina at the turn of the century. These include breweries, carriage, wagon and sleigh makers, cigar manufacturers, confectionery manufacturers, coopers, evaporators, extract and perfume manufacturers, foundries and machine shops, furniture manufacturers, grist, flour and feed mills, hardware manufacturers, harness makers, lumber manufacturers, marble and granite works, produce dealers, quarries, shirt manufacturers, a vinegar and cider manufacturer, and a woodworking mill.

The buildings in the district housed a variety of commercial and professional establishments during the early 1900s including: bakeries, barber shops, bicycle repair shops, blacksmith shops, coal dealers, shoe and boot stores, tobacco shops, florist shops, clothing stores, candy stores, grocery stores, hardware stores, harness dealers, hotels, jewelry stores, banks, and law and insurance offices.

The fruit industry played a key role in the local economy around the turn of the century and continues to be important today. Medina is located in Orleans County, one of New York state's major fruit growing regions. The combination of the moderating effect of Lake Ontario and a fertile, well-drained, growing soil make the county a good place to grow apples, peaches, pears, sour cherries, and other fruits. Probably no single industry contributed more to the growth of the village in the early twentieth century than the establishment of the H.J. Heinz Company plant in 1899. The plant was built near the railroad tracks at Genesee and Park Avenue (west of the historic district). This plant was one of Medina's major employers at the time. Among the products made here were cider vinegar and ketchup. (This plant is now owned by the Fisher-Price Toy Company.)

The two surviving cold storage warehouses, on the east and west sides of Main Street, along the railroad tracks, are significant as representative vernacular buildings associated with the agricultural economy of the village during the early twentieth century. The warehouse at 613-615 Main Street (presently a carpet store) was built in 1901

United States Department of the Interior  
National Park Service

NATIONAL REGISTER OF HISTORIC PLACES  
CONTINUATION SHEET

Main Street Historic District  
Medina, Orleans County, New York

Section 8, Statement of Significance, page 8

---

as the Austin and Dye Cold Storage Company. Medina's other cold storage facility at 630 Main Street was built south of the railroad tracks in 1907 by the Dye Cold Storage Company. About 1920 both warehouses came under the ownership of the Austin & Rowley Cold Storage Company with 613-615 Main Street becoming known as Warehouse A and 630 Main Street as Warehouse B. In addition to fruit storage, large blocks of ice were also made and stored in these facilities as well. A frame packing house was added on the south side of Warehouse B in the early 1920s. The last apple packing in these facilities ended with the advent of World War II. Warehouse B was converted from apple storage into a refrigerated warehouse and is now the Medina Cold Storage Company. Warehouse A was sold for commercial use in 1973.

Architecturally, the historic district reflects Medina's development as a commercial center during the nineteenth and early twentieth centuries. Very few buildings from the village's earliest decades (1820s-30s) have survived intact. Many of these early buildings were of frame construction and were destroyed by fire or razed to make way for more substantial structures of masonry construction. Within the district, the building at 343-347 Main Street can trace its beginnings back to ca. 1835 when it was known as the Arcade and housed stores, offices, and meeting halls. This building, which later became a hotel, has undergone a number of changes through the years so that the only original, intact portion is the foundation.

The district is distinguished by a visual cohesiveness and a high level of architectural design. As it exists today, it is largely the product of the rebuilding which followed various fires in the 1860s and 1870s. As a group, the buildings embody a variety of distinctive characteristics associated with late-nineteenth-century urban commercial architecture. The buildings illustrate the popular architectural styles and practices of the day. Characteristic of the type and period, the buildings are primarily two- and three-story attached rows distinguished by vertical orientations and a profusion of elaborate

United States Department of the Interior  
National Park Service

NATIONAL REGISTER OF HISTORIC PLACES  
CONTINUATION SHEET

Main Street Historic District  
Medina, Orleans County, New York

Section 8, Statement of Significance, page 9

---

ornamentation, particularly around window openings and along cornice lines. Dating primarily from the 1870s to the early 1900s, the buildings display a general consistency in scale, form, rooflines, orientations and set-backs from the street, high quality materials (brick or stone with stone or cast/pressed metal embellishment) and continuity, yet variety, in design.

The district is noted for its fine collection of buildings constructed of locally quarried Medina sandstone. During the construction of the canal, this sandstone was discovered in the area. The sandstone was near the surface and easy to mine. Quarries were established in the area from Medina to Holley. John Ryan is credited with opening the first quarry in 1837 in the Medina area. Medina sandstone varies in color from light gray to a deep reddish brown. The stone was originally shipped to other cities via the canal system.

With the advent of the railroad in mid-1800s the stone could be shipped to markets more quickly. In the early 1900s the demand for this building material reached its peak. In 1903 and 1904, 1,200 men were employed annually with an average payroll of \$3,000 per day for work in the 48 area quarries.

This sandstone invited the skills of local masons as illustrated by many of the fine stone buildings in the district ranging from vernacular to high style. An impressive row of Italianate style buildings constructed of light gray sandstone is located on the west side of Main Street and includes: #408 Main; The M.A. French Block at #410-412 Main; The E.M. Card Block at #414-416 Main; The J.D. Kearney Block at #418-422 Main; and #424 Main. These buildings feature random ashlar facades with stone quoins, sills, stringcourses, and arched head moldings with keystones. The stone used for the J.D. Kearney Block most likely came from the Kearney's quarry located on the north side of Medina, along the canal, west of Route 63. This row of buildings was erected ca. 1867-1870 following a fire which destroyed several frame buildings in this location.

United States Department of the Interior  
National Park Service

NATIONAL REGISTER OF HISTORIC PLACES  
CONTINUATION SHEET

Main Street Historic District  
Medina, Orleans County, New York

Section 8, Statement of Significance, page 10

---

One of the visually prominent sandstone buildings on Main Street is Bent's Opera House (1864-65), at the northwest corner of Main and West Center Streets. This prominent, three-story, Italianate building is constructed of gray, random ashlar, sandstone with smooth-finished stone quoins marking the corners and central bay. Despite major alterations to the first floor facade and replacement of the original pedimented parapet the building remains a significant example of Medina sandstone construction. The building is historically significant as well as the focal point of Medina's social, civic and artistic activities. The third floor was used as both a meeting hall and as an opera hall for theatrical and musical productions.

City Hall at 600 Main Street, built 1908, is an outstanding, intact example of civic architecture constructed of reddish brown Medina sandstone. The building was named City Hall by Medina's citizens in the hope that the village would one day be a city. The village, however, never applied for a city charter. This Richardsonian Romanesque inspired building features rockfaced, random ashlar with contrasting smooth-finished stone water-table, sills, arched hood moldings, keystones, stringcourses, and porch columns.

Some of the buildings in the district have rear and side walls built of Medina sandstone with facades of brick such as The Cooper Block at 110-114 East Center Street and the Medina Journal-Register Building at 409-413 Main Street.

Many of the buildings in the district are designed in Italianate style and represent the prosperous railroad era of the second half of the nineteenth century. Italianate buildings in the district feature round or segmentally arched, hooded windows, brick corbelling, and bracketed cornices. One of the district's most outstanding Italianate buildings is the Fuller Block (1875) at 428 Main Street. The second and third floors of this brick commercial building have repetitive fenestration with round-arched, two-over-two, double-hung wood windows and keystoned drip

United States Department of the Interior  
National Park Service

NATIONAL REGISTER OF HISTORIC PLACES  
CONTINUATION SHEET

Main Street Historic District  
Medina, Orleans County, New York

Section 8, Statement of Significance, page 11

---

moldings. The upper part of the facade is ornamented by brick corbelling and an elaborate cornice with both brackets and modillions. The cornice rises to a peak in the center bay. The Fuller Block was built by cousins Darwin and Darius Fuller on the site of the Methodist Church which was destroyed by fire in 1874. The G.C. Murphy Co. Store has been in this building since about 1947.

Other largely intact, representative examples of the Italianate style include: The Medina Journal-Register Building (ca. 1873) at 409-413 Main; The J.A. French Block (1868) at 410-412 Main; The E.M. Card Block (ca. 1868) at 414-416 Main; 415 Main (ca. 1870); The J.D. Kearney Block (1867) at 418-422 Main; 424 Main (ca. 1867); 426 Main Street (1875); 431-433 Main (ca. 1857); 437-441 Main (1871); Bent's Opera House (1864-65) at 442-444 Main; 447 Main (1871); 512 Main Street (1871); 539-545 Main (1880); The Cooper Block (1875) at 110-114 East Center; and The Hart House (ca. 1876) at 111-115 West Center.

While many of the storefronts have undergone various alterations through the years there are still several fine examples of late-nineteenth-century cast ironwork with ornamented pilasters, capitals, and some intact storefront cornices. Much of the ornamental cast iron in the district was manufactured by W.H. Cheney of Rochester, New York. Outstanding examples of cast ironwork include: Brennan's Hall (1880) at 333 Main; The Medina Journal Building (ca. 1873) at 409-413 Main; The J.A. French Block (1868), storefront at 412 Main; The J.D. Kearney Block (1867), storefront at 418 Main; 527-529 Main (1860); The Cooper Block (1875) at 110-114 East Center; and Paddock's Hotel (1855), storefronts at 107-109 West Center Street.

In addition to the existence of several late-nineteenth-century cast iron storefronts, the district also has examples of twentieth-century storefronts worth mentioning. The storefront at Limina's Jewelry at 512 Main Street is a fine example of Art Deco inspired design with black and red

United States Department of the Interior  
National Park Service

NATIONAL REGISTER OF HISTORIC PLACES  
CONTINUATION SHEET

Main Street Historic District  
Medina, Orleans County, New York

Section 8, Statement of Significance, page 12

---

Carrara glass. The Fuller Block storefronts at 428 Main, though not original, are a good example of mid-twentieth-century storefront design featuring recessed entrances with white, red and gray mosaic tile flooring and granite bases below the display windows.

Three of the buildings in the district reflect the influence of the picturesque Queen Anne style typified by projecting bays, a contrasting use of materials and textures, and decorative brickwork and woodwork. The best example is the W.R. Curry Building (1903) at 547-549 Main Street. This recently restored two-story, brick commercial building has two storefronts with large display windows and recessed entrances with transoms. The upper story of this nicely detailed building features oriel windows with ornamented, elliptical-shaped pediments, rockfaced, stone stringcourses, corbelled brick piers with recessed panels, and wooden lattice panels. The other Queen Anne structures include the brick building at 417-419 Main Street (1891) and the Medina sandstone Downs and Kearney Block (1899-1900) at 108 West Center Street. Though both have modernized first floor facades, the upper stories are intact and feature oriel windows with decorative wood panels.

The two attached, late-nineteenth-century, brick buildings at 413 and 415 Proctor Place are good examples of vernacular, mercantile architecture. Patterned red and black brickwork is used at the segmentally arched lintels, stringcourses, and corbelled cornice at 413 Proctor Place, built ca. 1880 as a bakery. #415 Proctor Place features segmentally arched lintels and a corbelled cornice. This building was erected about 1892 and served first as a wagon manufacture and later as a blacksmith shop. The large arched entrance accommodated horses and wagons. Deeds reveal that a public right-of-way originally led through the arched tunnel on the south side of the building.

Post-dating the majority of the buildings on Main Street are a few intact early-twentieth-century buildings that contribute to the significance of the district. Scattered

United States Department of the Interior  
National Park Service

NATIONAL REGISTER OF HISTORIC PLACES  
CONTINUATION SHEET

Main Street Historic District  
Medina, Orleans County, New York

Section 8, Statement of Significance, page 13

---

among the nineteenth-century buildings, the newer buildings reflect the continued vitality of the central business district and community during the early 1900s. The population of the village by the turn of the century had grown to over 5,000.

Contrasting with the predominant Victorian-era character of the district, these buildings reflect a variety of trends popular in American commercial architecture during the first quarter of the twentieth century. One of the most outstanding examples of the period is the Central Bank of Medina (1909) at 514 Main Street, a distinctive example of Neo-classical style commercial architecture. The bank is distinguished by a stone facade with monumental, Doric order pilasters, a classical console table with scroll brackets, and a dentilled cornice. The Maher Brothers Block at 116-120 East Center Street (1873; 1903, facade) has a Neo-Renaissance brick facade with rusticated brick pilasters and large, round-arched window openings. The original facade of this 1873 building was destroyed by fire in 1903 and was rebuilt by the Maher Brothers, a furniture manufacturing company. Both the Maher Brothers Block and the Central Bank of Medina convey a sense of early-twentieth-century classicism in contrast to the late-nineteenth-century eclecticism and romanticism surrounding them.

The S.A. Cook Building at 526-540 Main Street is an important example of early-twentieth-century commercial architecture as well. When it was built in 1911 its design was considered quite modern. This two-story, buff-colored brick building reflects the shift from narrow, vertically oriented commercial architecture to the long and horizontally oriented stores of the twentieth century. The facade has horizontal bands of windows at the second floor and is restrained in its ornamentation with a simple dentilled cornice and a central parapet with stone consoles. The building retains a high level of architectural integrity and is an important feature in the district.

United States Department of the Interior  
National Park Service

NATIONAL REGISTER OF HISTORIC PLACES  
CONTINUATION SHEET

Main Street Historic District  
Medina, Orleans County, New York

Section 8, Statement of Significance, page 14

---

Two other similar early-twentieth-century buildings with horizontal orientations, though partially altered, include the J.S. Kelly Block (1907) at 122-128 East Center Street, and the Butts Building (1927), a former auto showroom at 337-339 Main Street.

The commercial properties of the historic district are complemented by the First Presbyterian Church (1872) at 520 Main Street, an architecturally significant example of late-nineteenth-century religious architecture. The brick church exemplifies the popular Romanesque Revival style of the time distinguished by round-arched, stained glass windows, engaged buttresses, an arched corbel table, and a square tower. Unlike its commercial neighbors, the church maintains a deeper setback. Historically, the church congregation formed about 1829 and is important for its association with the early settlement years of the village. The congregation built a stone church on the Main Street site in 1836 which was destroyed by fire in 1870. The present brick church was erected in 1872. Carriage sheds, located behind the church, were razed in 1955 to make room for the education building.

The historic architectural character of the district has been retained in what is still a very viable and active commercial center for Orleans County. In 1989 the village received a grant from the State's Urban Development Corporation for facade rehabilitation. Since the start of this program, known as the Medina Commercial Revitalization Project, 15 buildings on Main Street have been rehabilitated. Paint, appropriate signage, roof and masonry repairs, and sympathetic facade designs have been completed under this program. The rehabilitation work was reviewed by the SHPO to assure that it was in keeping with the Secretary of the Interior's *Standards for Rehabilitation*. The rehabilitated buildings have contributed to local pride by enhancing the visual environment and by helping to preserve Medina's historic resources. Medina's history began with the building of the Erie Canal and this historic waterway

United States Department of the Interior  
National Park Service

NATIONAL REGISTER OF HISTORIC PLACES  
CONTINUATION SHEET

Main Street Historic District  
Medina, Orleans County, New York

Section 8, Statement of Significance, page 15

---

continues to play an important role in the village with the emphasis on historic tourism.

The Main Street Historic District is architecturally and historically significant as an intact village commercial center, which retains significant streetscapes and buildings illustrating the growth and development of the village between 1825 and 1945. Together, the historic streetscapes and buildings retain a generally high degree of integrity. Prominently situated adjacent to the Erie Canal, the district survives as an important collection of nineteenth- and early-twentieth-century commercial, civic, agricultural, and religious architecture in the heart of this village of 7,000 residents.

United States Department of the Interior  
National Park Service

NATIONAL REGISTER OF HISTORIC PLACES  
CONTINUATION SHEET

Main Street Historic District  
Medina, Orleans County, New York

Bibliography, Item 9, page 1

---

*Atlas of Niagara and Orleans Counties, New York.*  
Philadelphia, PA: D.G. Beers & Co., 1875.

Dick, Claudia, Ed Grinnell, and Bonnie Hartway. NYS  
Building - Structure Inventory Forms for various  
individual buildings on Main Street, East Center  
Street, and Proctor Place. Medina: Medina Chamber of  
Commerce, 1988-1992.

Gibson, Irene M. *Historic Sites in Orleans County, New  
York.* Albion, NY: Orleans County Historical  
Association, 1979.

Grinnell, Ed. Interview with Kathy Howe, July 15, 1994.

*History of Orleans County, New York.* 1879. Ovid, NY: W.  
E. Morrison & Co., 1979.

Kirwin, W.H. *Kirwin's Directory of the County of Orleans  
1879-80.* Lockport, NY: Union Printing & Publishing  
Co., 1879.

*Map of Niagara and Orleans Counties.* Philadelphia, PA:  
A.Z. Dawson, Publisher, 1860.

Mau, Clayton. *The Development of Central and Western New  
York.* Dansville: F.A. Owen Publishing Co., 1958.

Medina Chamber of Commerce. Vertical Files. Medina, NY.

Ogden, L.G. *New Century Atlas of Orleans County.*  
Philadelphia, PA: New Century Map Co., 1913.

Orleans County Historian's Office. Vertical files and  
historic photographs. Albion, NY.

Signor, Isaac S., ed. *Landmarks of Orleans County, New  
York.* Syracuse: D. Mason & Company, Publishers, 1894.

White, Cecilia A. *Medina Past and Present.* Medina:  
Village of Medina, 1982.

10. Geographical Data

Acreeage of property approx. 11.3 acres

UTM References

- 1: 18/224921/4790860 2. 18/224938/4790805
3. 18/224940/4790676 4. 18/224959/4790671
5. 18/224959/4790644 6. 18/224969/4790642
7. 18/224974/4790580 8. 18/224940/4790577
9. 18/224940/4790488 10: 18/224981/4790488
11: 18/224981/4790435 12: 18/224873/4790409
13: 18/224880/4790327 14: 18/224818/4790325
15: 18/224810/4790395 16: 18/224724/4790383
17: 18/224724/4790416 18: 18/224803/4790440
19: 18/224803/4790755 20: 18/224897/4790786
21: 18/224875/4790858

Verbal Boundary Description

The boundary coincides with legal lot lines of the nominated parcels as delineated on the attached county tax map.

Boundary Justification

The boundary is drawn to include all the land historically and currently associated with the buildings included in the district; most lots are relatively small village parcels (less than .25 acres) that are virtually covered by their entire respective building footprints.

11. Form Prepared By: Kathy Howe, Bero Associates, Rochester, NY

contact: Nancy L. Todd, Program Analyst
organization NYSHPO, Division for Historic Preservation date January 1995
street & number Peebles Island, PO Box 189 telephone 518-237-8643
city or town Waterford state NY zip code 12188-0189

Additional Documentation

Submit the following items with the completed form:

Continuation Sheets

Maps

- A USGS map (7.5 or 15 minute series) indicating the property's location.
A Sketch map for historic districts and properties having large acreage or numerous resources.

Photographs

Representative black and white photographs of the property.

Additional items

(check with the SHPO or FPO for any additional items)

Property Owner

(Complete this item at the request of SHPO or FPO.)

name
street & number
city or town state zip code

Main Street Historic District  
Medina, Orleans County  
Heavy black outlines  
defines boundary of  
nominated district

↑ N  
1" = 200'

← Residential →

← Residential →

← Residential →

← Residential →

Auto Dealer

Sinoco gas station

Starlite

Parking lot

canal

alley

large asphalt parking lot

alley was theater

RR tracks

Ace Hardware store LZOC

Co'd storage

Residential

Sugarbeet store

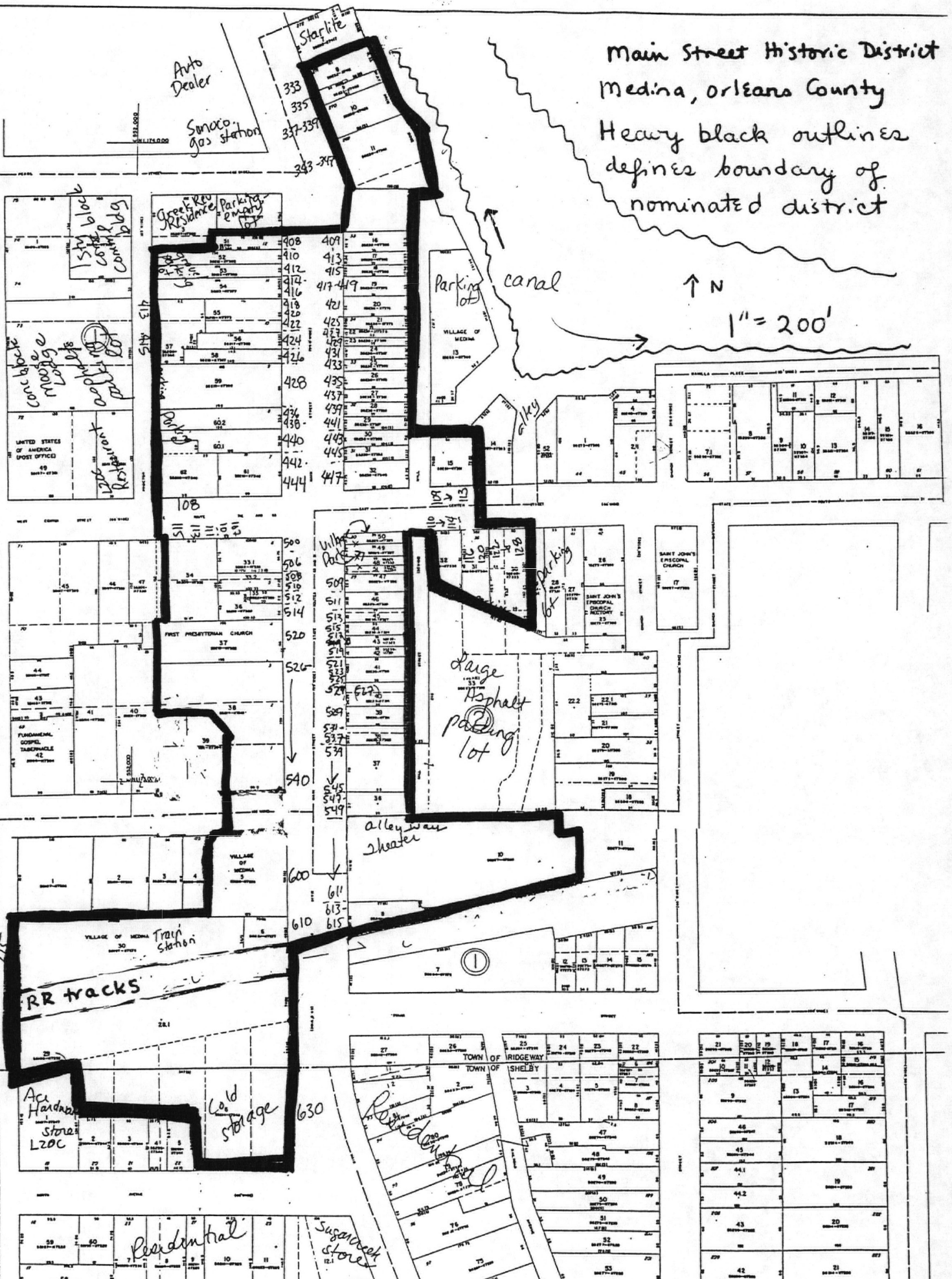

**United States Department of the Interior  
National Park Service**

**National Register of Historic Places  
Continuation Sheet**

Section number \_\_\_\_\_ Page \_\_\_\_\_

**SUPPLEMENTARY LISTING RECORD**

**NRIS Reference Number:** 95000213      **Date Listed:** 03/23/95

Main Street Historic District      Orleans      NY  
**Property Name**      **County**      **State**

N/A  
**Multiple Name**

**This property is listed in the National Register of Historic Places in accordance with the attached nomination documentation subject to the following exceptions, exclusions, or amendments, notwithstanding the National Park Service certification included in the nomination documentation.**

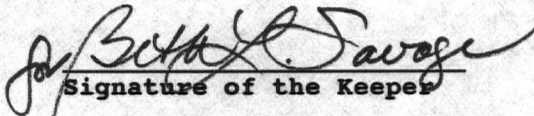
  
**Signature of the Keeper**

4/25/95  
**Date of Action**

=====  
**Amended Items in Nomination:**

**3. Classification: Category**

District is the appropriate category for this property.

This information was confirmed with Nancy Todd, NYSHPO, by telephone.

**DISTRIBUTION:**  
National Register property file  
Nominating Authority (without attachment)

UNITED STATES DEPARTMENT OF THE INTERIOR  
NATIONAL PARK SERVICE

NATIONAL REGISTER OF HISTORIC PLACES  
EVALUATION/RETURN SHEET

REQUESTED ACTION: NOMINATION

PROPERTY Main Street Historic District  
NAME:

MULTIPLE  
NAME:

STATE & COUNTY: NEW YORK, Orleans

DATE RECEIVED: 2/06/95 DATE OF PENDING LIST: 2/22/95  
DATE OF 16TH DAY: 3/10/95 DATE OF 45TH DAY: 3/23/95  
DATE OF WEEKLY LIST:

REFERENCE NUMBER: 95000213

NOMINATOR: STATE

REASONS FOR REVIEW:

APPEAL: N DATA PROBLEM: N LANDSCAPE: N LESS THAN 50 YEARS: N  
OTHER: N PDIL: N PERIOD: N PROGRAM UNAPPROVED: N  
REQUEST: N SAMPLE: N SLR DRAFT: Y NATIONAL: N

COMMENT WAIVER: N

ACCEPT  RETURN  REJECT 3/23/95 DATE

ABSTRACT/SUMMARY COMMENTS:

RECOM./CRITERIA

Accept A+C

REVIEWER

Savage

DISCIPLINE

Architectural History

TELEPHONE

DATE

3/23/95

DOCUMENTATION see attached comments Y/N see attached SLR Y/N

MEDINA CANAL FESTIVAL  
JULY 7-9



Main Street Historic District  
Medina, Orleans Co.

Photo: K. Howe, 1994

Neg: Bero Assoc., Rochester, NY

1. West side of Main, 408 Main at  
right.

973 06 N N 2 2

*A Cut Above!*  
WALK  
INS  
*Welcome*

798-2519

418  
UPPER

416  
UPPER

Knights of Columbus

Convent 001

Main Street Historic District  
Medina, Orleans Co.

Photo: K. Howe, 1994

Neg: Bero Assoc., Rochester, N.Y.

2. Detail of 418 Main St.



Main Street Historic District  
Medina, Orleans Co.

Photo: K. Howe, 1994

Neg: Bero Assoc., Rochester, N.Y.

3. 408-424 Main Street

973 06 N N 1 2



G. H. & CO.

Cordless  
Electric  
Motors

GOODWIN'S  
Hosiery &  
SHIRT  
SHOP

Cordless  
Electric  
Motors

4  
2  
4  
LO

Main Street Historic District  
Medina, Orleans Co.

Photo: K. Howe, 1994

Neg: Bero Assoc., Rochester, N.Y.

4. 426-428 Main St.

973 06 N N 1 2



BAUGH'S SHOES

NO PARKING  
IN FRONT OF  
STORE

NO PARKING  
IN FRONT OF  
STORE

Main Street Historic District  
Medina, Orleans Co.

Photo: K. Howe, 1994

Neg: Bero Assoc., Rochester, NY.

5. 436-440 Main St.



MARINE MIDLAND

MARINE  
MIDLAND  
BANK

Limin

THE GREAT GUY STORE



Main Street Historic District  
Medina, Orleans Co.

Photo: K. Howe, 1994

Neg: Bero Assoc., Rochester, N.Y.

6. West side of Main, 514 Main  
at left.

973 06 N N 90 226



ROSENBLUM  
PHARMACY INC.

MARINE

MARINE  
INSURANCE  
BANK

Main Street Historic District

Medina, Orleans Co.

Photo: K. Howe, 1994

Neg: Bero Assoc., Rochester, N.Y.

7. 520 Main St.



MUNICIPAL  
PARKING

CURT'S  
NEWS

THE BLACK

HOTEL

FRANK'S

BARBER SHOP

ST. JOHN'S  
BUILDING

Main Street Historic District  
Medina, Orleans Co.

Photo: K. Howe, 1994

Neg: Bero Assoc., Rochester, N.Y.

S. West side of Main, 540 Main at  
left.



WELLS  
COMMUNITY  
ALLIANCE

WELLS  
COMMUNITY  
ALLIANCE

Main Street Historic District  
Medina, Orleans Co.

Photo: K. Howe, 1994

Neg: Bero Assoc., Rochester, N.Y.

9. 600 Main St.



Main Street Historic District  
Medina, Orleans Co.

Photo: K. Howe, 1994

Neg: Bero Assoc., Rochester, N.Y.

10. 615 West Ave.

424.11 v. 10 p. 22

R2.



Main Street Historic District

Medina, Orleans Co.

Photo: K. Howe, 1994

Neg: Bero Assoc., Rochester, N.Y.

11. East side of Main, 613-615 ~~at~~  
Main at right.

974 06 N N-22



DO NOT  
ENTER

MEMBER  
OF THE  
CENTRAL  
FEDERAL

Main Street Historic District  
Medina, Orleans Co.

Photo: K. Howe, 1994

Neg: Beco Assoc., Rochester, N.Y.

12. East side of Main, 547-549  
Main at right.

974 06 N N-2 2



WE DO  
S P  
S N  
S N

ENG  
R  
R  
R

MONU  
M  
E  
N  
T

SPORTSWEAR DESIGN IMPRESSIONS

CES Monument Works  
We Do  
Engraving  
& Sign

SCREEN PRINTING EMBROIDERY ENGRAVING & SIGN

Family Restaurant  
FAMILY RESTAURANT  
Over 20 years of service

Main Street Historic District

Medina, Orleans Co.

Photo: K. Howe, 1994

Neg: Bero Assoc, Rochester, N.Y.

13. 527-537 Main St.



Main Street Historic District  
Medina, Orleans Co.

Photo: K. Howe, 1994

Neg: Bero Assoc., Rochester, N.Y.

14. East side of Main, 447 Main  
at right.

PEPSI MEDINA CANAL FESTIVAL PEPSI  
JULY 7, 8, 9



Main Street Historic District  
Medina, Orleans Co.

Photo: K. Howe, 1994

Neg: Bero Assoc., Rochester, N.Y.

15. 333-421 Main St.



MUNICIPAL  
PARKING  
LOT

JOURNAL-BUILDER

OPTICAL

MEDINA CANAL FESTIVAL  
JULY 28-29

Main Street Historic District  
Medina, Orleans Co.

Photo: K. Howe, 1994

Neg: Bero Assoc., Rochester, N.Y.

16. East side of Main, 409-413 Main  
at left.



Main Street Historic District  
Medina, Orleans Co.

Photo: K. Howe, 1994

Neg: Bero Assoc., Rochester, N.Y.

17. Rear of 601-615 Main St.



Main Street Historic District  
Medina, Orleans Co.

Photo: K. Howe, 1994

Neg: Bero Assoc., Rochester, N.Y.

18. Outside east edge of  
district.



Main Street Historic District

Medina, Orleans Co.

Photo: K. Howe, 1994

Neg: Bero Assoc., Rochester, N.Y.

19. 108 W. Center St. (at left)



ROBERT H. NEWELL & CO. INC.  
MANUFACTURING OFFICE

END  
31E

Main Street Historic District  
Medina, Orleans Co.

Photo: K. Howe, 1994

Neg: Bero Assoc, Rochester, NY.

20. West Center st, south side.

973 06 N N-2 2



Main Street Historic District  
Medina, Orleans Co.

Photo: K. Howe, 1994

Neg: Bero Assoc., Rochester, N.Y.

21. 110-128 E. Center St.



*Fine Designs Inc.*  
CUSTOM UPHOLSTERY

KWANDRANS

108  
S. HENRY ST.

Main Street Historic District

Medina, Orleans Co.

Photo: K. Howe, 1994

Neg: Bero Assoc., Rochester, N.Y.

22. 109-113 E. Center St.

NEW YORK STATE DEPARTMENT OF TRANSPORTATION



MEDINA QUADRANGLE NEW YORK 7.5 MINUTE SERIES PLANIMETRIC NW/4 MEDINA 15' QUADRANGLE

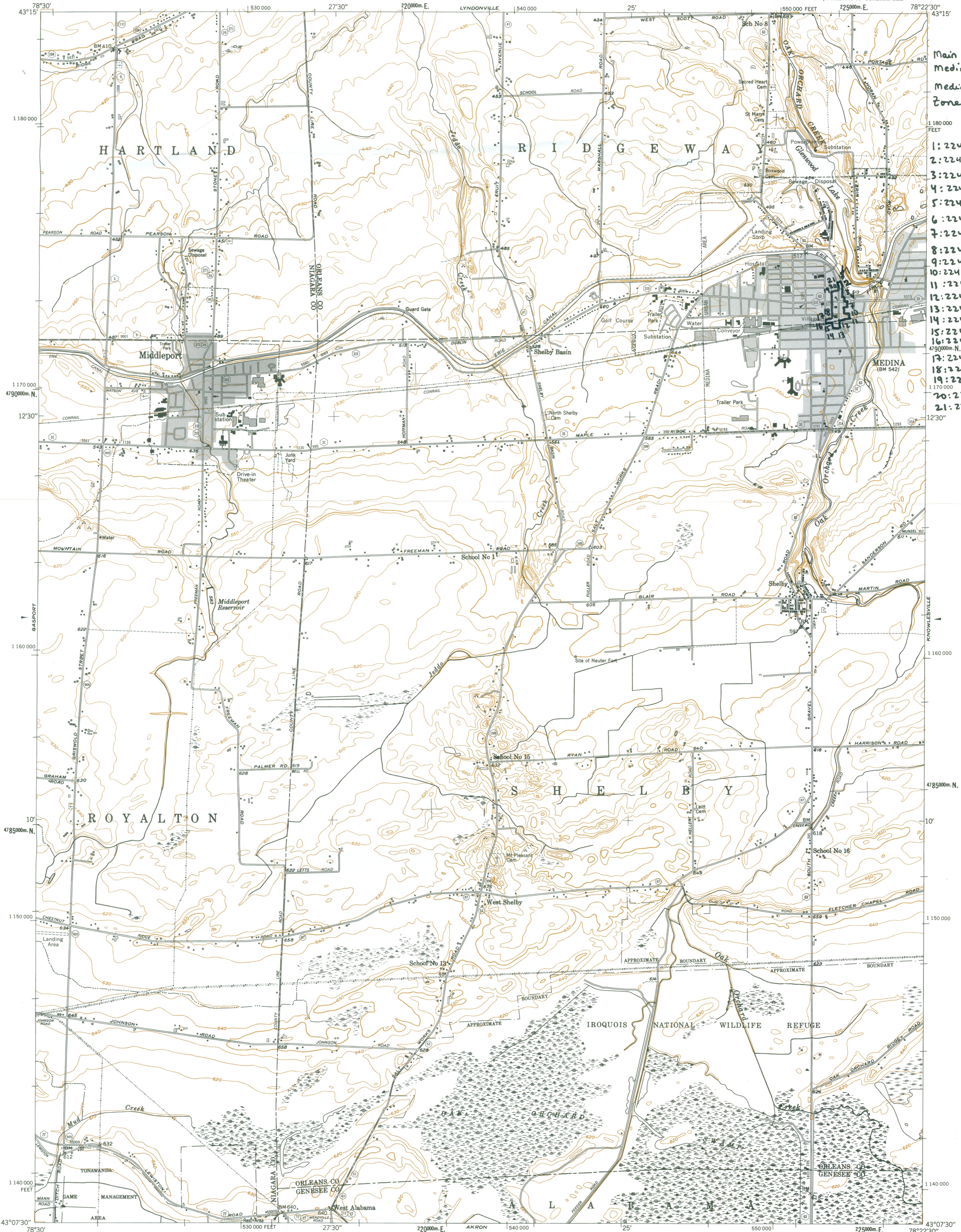

Main Street Historic District Medina, Orleans Co. Medina Quad Zone 18; 1:24,000

- 1: 224921 / 4790860
2: 224938 / 4790805
3: 224940 / 4790676
4: 224959 / 4790671
5: 224959 / 4790644
6: 224969 / 4790642
7: 224974 / 4790580
8: 224940 / 4790577
9: 224940 / 4790488
10: 224981 / 4790488
11: 224981 / 4790435
12: 224873 / 4790409
13: 224880 / 4790327
14: 224818 / 4790325
15: 224810 / 4790395
16: 224724 / 4790388
17: 224724 / 4790416
18: 224803 / 4790440
19: 224803 / 4790755
20: 224897 / 4790786
21: 224875 / 4790858

Prepared and published in 1976 by the New York State Department of Transportation, in cooperation with the U.S. Department of Transportation, Federal Highway Administration.
Map base from 1951 U.S. Geological Survey 7.5-minute quadrangle.
Map revisions made using 1974 aerial photography, construction plans, official records and other sources. Features revised include: highways and other transportation facilities; civil boundaries; recreation sites; hydrography; and buildings. Grey tint indicates intensively developed areas in which only landmark buildings are shown.
Revisions may not comply with National Map Accuracy Standards. Correspondence concerning this and other maps of the Department of Transportation should be directed to: Map Information Unit, New York State Department of Transportation, State Campus, Albany, New York 12232.
1976 revisions by A. R. Scarlata
SPECIAL TOPOGRAPHIC EDITION
Contours, at 10-foot intervals, shown unrevised from 1951 U.S. Geological Survey map. Datum is mean sea level.

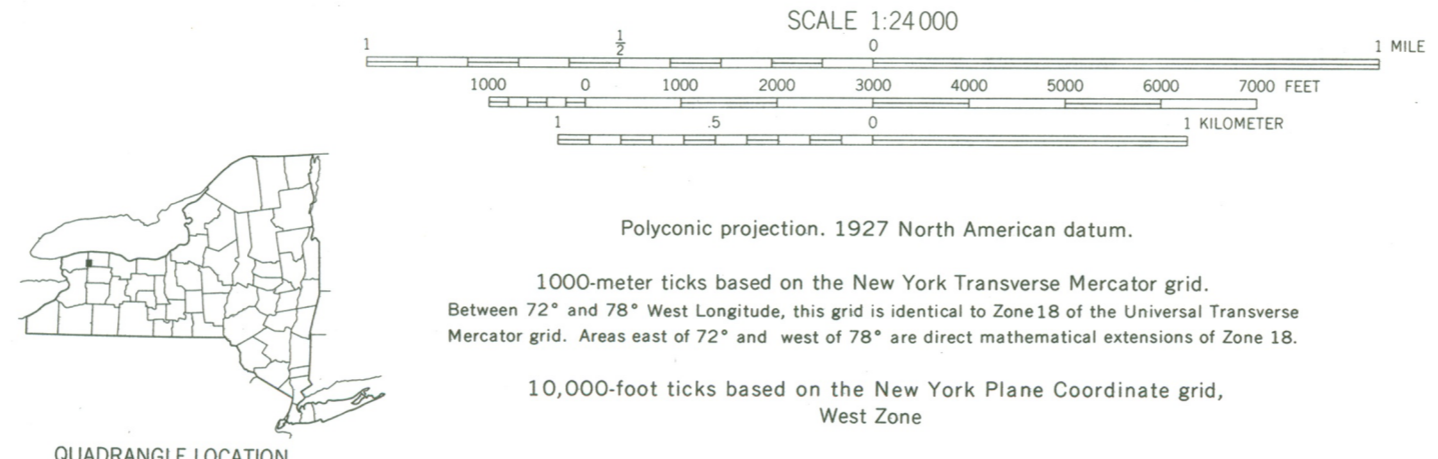

Table with 2 columns: Symbol and Description. Includes categories for Boundaries (State, County, Town or City, Incorporated Village, Federal-Aid Urban Area), Roads (Touring Route markers, Interstate, U.S., State, State Highway number and limit, County road, Interchange number), and Divided/Undivided highways and streets (Wide/ Narrow mall or barrier, 4 or more lanes/ Less than 4 lanes, Vehicle track/ trail).



COUNTY OF ORLEANS  
**DEPARTMENT OF HISTORY**

Albion, New York 14411  
(716) 589-4174

C.W. LATTIN  
County Historian

October 6, 1994

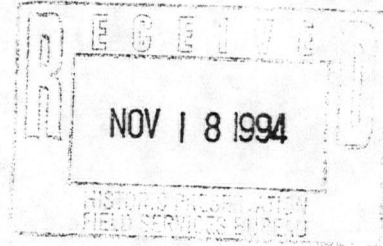

To Whom It May Concern:

As Orleans County Historian I wholly support the effort for the Medina Business District to be included on the National Register. With the recent nomination of the Village of Albion business district, it seems only fair and completely appropriate to also include Medina.

In fact, the Medina downtown section has no more gaps or intrusions than Albion. It is a street scape primarily of Italianate facades which are mostly intact. Unlike Albion, many of the store fronts continue to carry on active businesses. The Medina business district in relationship to the Erie Canal is an important feature advantageous to tourism. Many of the buildings employ the use of Medina Sandstone giving testament to the skills of long forgotten craftsmen.

Sincerely,  
*C.W. Lattin*  
C. W. Lattin

# Village of Medina

ORLEANS COUNTY

MEDINA, NEW YORK

14103

NOV 18 1994

VILLAGE CLERK PHONE 716/798-0710

MAYOR HERBERT E. BRANT  
TRUSTEES ERNEST J. ORGAR  
MELVIN H. MILLER  
LINDA M. DEYLE

JAMES E. HOBBS  
PATRICK M. O'BRIEN  
WILLIAM D. POOLE



CLERK-TREASURER E. MARGARET CROWLEY  
DEP. CLERK-TREAS. DEBORAH L. PADOLESKI  
COORDINATOR MARK D. WATTS  
ATTORNEY NORRIS L. WEBSTER

To : Whom It May Concern

From : Christopher M. Busch, Village Historian

Re : Support of Preservation Efforts

Date : October 17, 1994

In recent years a growing number of efforts have been made by several local individuals to preserve, restore, and protect the many fine historic buildings in Medina's downtown area. Many of these efforts have resulted in spectacular renovations, and have come to serve as a tremendous source of community pride. Further, a Historic and Architectural Review Board has been established to help ensure that downtown renovation efforts remain well-rooted in the spirit of historic preservation. In short, the local preservation movement has slowly but surely been gathering steam, and has accomplished many worthwhile things along the way. Those responsible are to be commended. Currently, a designation is being sought from the government that would place Medina among those locations worthy national historic recognition. Medina is indeed a treasure-trove of architecture constructed during a great and glorious period of our nation's history, and by virtue of that is certainly worthy of such designation. If nothing else it would go a long way in assisting local efforts aimed at protection of these landmarks in the future. But obviously it is more than that. It is a much deserved recognition of not only our own current efforts to preserve, but of our fore-father's vision as well. Like it or not, this community's architecture has graduated from being a local business district to an incredible preserve of period architecture that belongs to all people of future generations. It is a tremendous responsibility for all concerned. Therefore, it is with great enthusiasm that I wholeheartedly endorse this and all efforts aimed at preserving and protecting the rich architectural heritage of the Village of Medina. Should any additional assistance be required of me to this end, please do not hesitate to contact me.

# Village of Medina

ORLEANS COUNTY • MEDINA, NEW YORK 14103

VILLAGE CLERK PHONE 716/798-0710

MAYOR HERBERT E. BRANT  
TRUSTEES ERNEST J. ORGAR  
MELVIN H. MILLER  
LINDA M. DEYLE

JAMES E. HOBBS  
PATRICK M. O'BRIEN  
WILLIAM D. POOLE

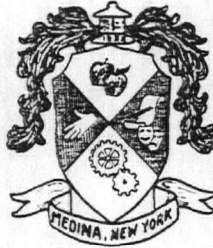

CLERK-TREASURER E. MARGARET CROWLEY  
DEP. CLERK-TREAS. DEBORAH L. PADOLESKI  
COORDINATOR MARK D. WATTS  
ATTORNEY NORRIS L. WEBSTER

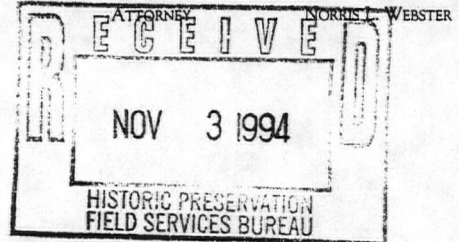

October 31, 1994

Ms. Nancy Todd  
N.Y.S. Office of Parks, Recreation, and Historic Preservation  
Empire State Plaza  
Agency Building #1  
Albany, New York 12238

Dear Ms. Todd:

Through a vigorous façade renovation program funded in part by Urban Development Corporation and partly by private investments by local property owners; along with a statutory Historic Preservation and Architectural Review Board, the Village of Medina has been able to retain and protect the historic flavor of its Central Business District.

This letter is to notify your Office of the Village of Medina's support for recognition of Medina's Central Business District as a nominee to the National Register of Historic Places.

Thank you for your consideration.

Respectfully submitted,

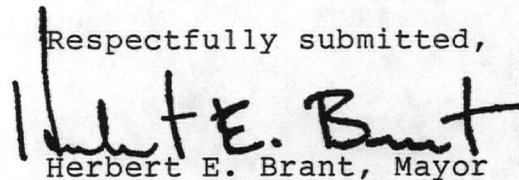
  
Herbert E. Brant, Mayor

CC: Board of Trustees  
Chamber of Commerce

*Nancy*

# HENRY G. POLLARD

415 PROCTOR PLACE  
MEDINA, NEW YORK 14103

November 5, 1994

Historic Preservation Field Services Bureau  
New York State Office of Parks, Recreation and Historic Preservation  
Peebles Island  
P.O. Box 189  
Waterford, New York 12188-0189

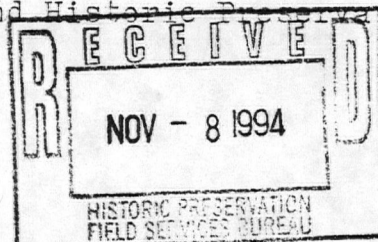

Attention: David S. Gillespie

Dear Mr. Gillespie:

I have your letter of November 1, 1994, advising that the building located at 413-415 Proctor Place, Medina, Orleans County, New York, is being considered for nomination to the National and State Registers of Historic Places.

As owner of this location, I am very pleased and proud that the building is being considered for this honor, and I definitely concur with the proposed nomination.

Records will indicate that 415 Proctor Place is one of the very oldest buildings in the Village of Medina; having been constructed shortly after 1830, and occupied as a blacksmith shop. It remained as an operating blacksmith shop until the 1920's when it became an agricultural equipment repair shop due to the scarcity of horses. In the 1860's, 413 Proctor Place was constructed and has a common wall with the original location.

When I purchased the building, it had been vacant for several years, and when it was converted to an insurance office, great care was taken to preserve the original architecture. The original blacksmith forge was still in the building, and this was preserved and remains as an item of great interest in the insurance office as of this date. Although the location functions as a modern insurance office, it has a museum -type of atmosphere with a large collection of antique blacksmith tools, and memorabilia related to the early history of Medina and Orleans County. Also--the walls of the office are decorated with over 100 antique authentic insurance fire marks which is the largest collection in up-state New York.

Many thanks for your consideration which I trust will result in the favorable nomination of this location into the registers of historic places.

Yours very truly,

A handwritten signature in cursive script that reads "Henry G. Pollard".

HENRY G. POLLARD



THE SENATE  
STATE OF NEW YORK

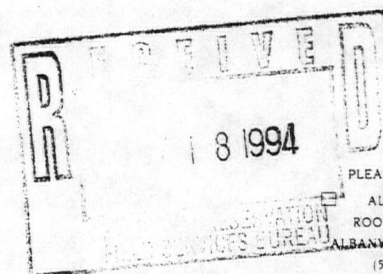

PLEASE RESPOND TO:  
ALBANY OFFICE  
ROOM 413, CAPITOL  
ALBANY, NEW YORK 12247  
(518) 455-2024

DISTRICT OFFICE  
60 PROFESSIONAL PARKWAY  
LOCKPORT, NEW YORK 14094  
(716) 438-0655

JOHN B. DALY  
SENATOR, 61ST DISTRICT  
CHAIRMAN, COMMITTEE ON  
CORPORATIONS, AUTHORITIES & COMMISSIONS  
CHAIRMAN  
LEGISLATIVE COMMISSION ON  
TOXIC SUBSTANCES & HAZARDOUS WASTES  
COMMITTEES  
CHILDREN & FAMILIES  
EDUCATION  
ENERGY  
ENVIRONMENTAL CONSERVATION  
FINANCE  
INSURANCE  
HOUSING

November 10, 1994

N.Y.S. Office of Historic Preservation  
State Office of Parks, Recreation  
& Historic Preservation  
National Parks Service

RE: Medina, N.Y. Application for National Register

To Whom It May Concern:

Over the past decade I have followed with interest and pride the outstanding progress of the Village of Medina in downtown facade restoration and the preservation of many priceless century old buildings. The effect has been noteworthy and has earned the community some awards -- rightly so.

A strong and coordinated effort of the Chamber of Commerce, village officials and community groups has brought true historic quality downtown, plus a very attractive central park and a now an expanded marine park. I am proud to have had a part in arranging some of the funding for two of these phases of improvement.

I'm aware that Medina has now applied to have the downtown area included in the National Register of Historic Places. This is altogether fitting and proper and I strongly urge the favorable consideration of your agencies in making this possible. The district is truly deserving.

Sincerely,

JOHN B. DALY  
State Senator

ROBERT E. WATERS

RECEIVED

NOV 18 1994

Nov. 10, 1994

NYS Office of Historic Preservation  
State Office of Parks, Recreation &  
Historic Preservation  
National Parks Service

In Regard to Medina N.Y. Application:

As an owner of a historic building in downtown Medina, N.Y. and a retired publisher of the local newspaper, let me enthusiastically and genuinely urge favorable action on Medina's application for inclusion of its main business district in the National Register of Historic Places.

This is altogether fitting and proper. Immense effort has been put into restoration of century old buildings... many of them made of native Medina sandstone. The local Chamber of Commerce, village leaders and local groups have joined with enthusiasm, dedication and dollars to create this historic panorama as well as a downtown park and a marine park which is on-going.

There is a great spill-over of public pride here. The "National Register" listing will reward a truly good program and spur continuation of effort.

Sincerely,

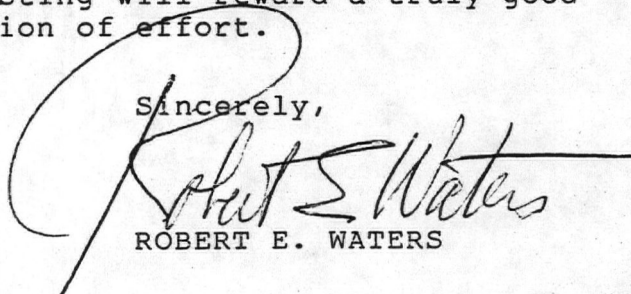

ROBERT E. WATERS

Robert E. Waters  
10933 W. Center St. Ext.  
Medina, N.Y. 14103

433 Main Street



Medina, NY 14103-1416

November 15, 1994

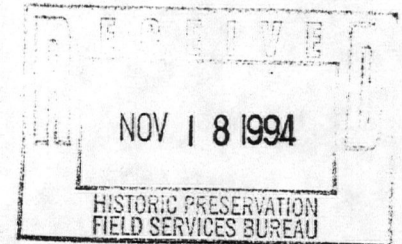

Nancy Todd, Field Representative  
N.Y.S. Office of Parks Recreation  
& Historic Preservation  
Empire State Plaza  
Agency Building #1  
Albany, New York 12238

Dear Nancy,

Enclosed you will please find letters of support to be included with the Medina Historic District nomination for State & National Register listing.

We hope our application will be successful and we look forward to hearing after the 1st. of the year. We also thank you for your genuine interest in Medina.

Sincerely,

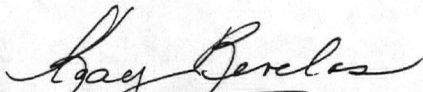
  
Catherine S. Revelas  
Executive Director

798-4287

Printed on Recycled Paper