

UNITED STATES DEPARTMENT OF THE INTERIOR
NATIONAL PARK SERVICE
NATIONAL REGISTER OF HISTORIC PLACES
REGISTRATION FORM

OMB NO. 1024-0018, NPS FORM

257

RECEIVED

FEB 18 1994

This form is for use in nominating or requesting determinations for individual properties or districts. See instructions in How to Complete the National Register of Historic Places Registration Form (National Register Bulletin 16A). Complete each item by marking "x" in the appropriate box or by entering information requested. If an item does not apply to the property being documented, enter "N/A" for "not applicable." For functions, architectural classifications, materials, and areas of significance, enter only categories and subcategories from the instructions. Place additional entries and narrative items on continuation sheets (NPS Form 10-900a). Use a typewriter, word processor, or computer, to complete all items.

1. Name of Property

historic name West Main Street / West James Street Historic District

other names/site number _____

2. Location

street & number W. Main St.; W. James St.; Elm St.; Center St. [] not for publication
Taylor Ave.

city, town Richfield Springs [] vicinity

state New York code NY county Otsego code 077 zip code 13439

3. State/Federal Agency Certification

As the designated authority under the National Historic Preservation Act of 1966, as amended, I hereby certify that this [x] nomination [] request for determination of eligibility meets the documentation standards for registering properties in the National Register of Historic Places and meets the procedural and professional requirements set forth in 36 CFR Part 60. In my opinion, the property [x] meets [] does not meet the National Register criteria. I recommend that this property be considered significant [] nationally [] statewide [x] locally. ([] See continuation sheet for additional comments.)

Julia S. Stojan
Deputy Commissioner for Historic Preservation
Signature of certifying official

2/4/94
Date

State or Federal agency and bureau _____

In my opinion, the property [] meets [] does not meet the National Register criteria. ([] See continuation sheet for additional comments.)

Signature of commenting or other official _____ Date _____

State or federal agency and bureau _____

4. National Park Service Certification

I hereby certify that this property is:
[x] entered in the National Register.
[] See continuation sheet.
[] determined eligible for the National Register. [] see continuation sheet.
[] determined not eligible for the National Register.
[] removed from the National Register.
[] other, (explain:)

Signature of keeper Edson H. Beall Date of Action 3/17/94
Entered in the National Register

W. Main St./ W. James St. Historic District, Richfield Springs, Otsego Co., NY
Name of Property County and State

5. Classification

| Ownership of Property (Check as many boxes as apply) | Category of Property (check only one box) | Number of Resources within Property (do not include previously listed resources in the count) | | |
|---|--|--|-----------------|------------|
| | | Contributing | Noncontributing | |
| <input checked="" type="checkbox"/> private | <input type="checkbox"/> building(s) | | | |
| <input checked="" type="checkbox"/> public-local | <input checked="" type="checkbox"/> district | <u>58</u> | <u>12</u> | buildings |
| <input type="checkbox"/> public-State | <input type="checkbox"/> site | <u>00</u> | <u>00</u> | sites |
| <input type="checkbox"/> public-Federal | <input type="checkbox"/> structure | <u>03</u> | <u>00</u> | structures |
| | <input type="checkbox"/> object | <u>00</u> | <u>00</u> | objects |
| | | <u>61</u> | <u>12</u> | Total |

Name of related multiple property listings (enter "N/A" if property is not part of a multiple property listing)

N/A

Number of contributing resources previously listed in the National Register

0

6. Function or Use

| Historic Function (enter categories from instructions) | Current Functions (enter categories from instructions) |
|---|---|
| <u>DOMESTIC / single dwellings</u> | <u>DOMESTIC / single dwellings</u> |
| <u>DOMESTIC / hotel</u> | <u>DOMESTIC / multiple dwellings</u> |
| <u>COMMERCE / specialty stores</u> | <u>COMMERCE / specialty stores</u> |
| <u>COMMERCE / financial institution</u> | |
| <u>SOCIAL / meeting hall</u> | <u>SOCIAL / meeting hall</u> |
| <u>EDUCATION / school</u> | <u>EDUCATION / school</u> |
| <u>EDUCATION / library</u> | <u>EDUCATION / library</u> |
| <u>RELIGION / church</u> | <u>RELIGION / church</u> |

7. Description

| Architectural Classification (enter categories from instructions) | Materials (enter categories from instructions) |
|--|---|
| <u>MID-19TH C. / Greek Rev., Gothic Rev.</u> | foundation <u>STONE, BRICK, CONCRETE</u> |
| <u>LATE VICT. / Italianate, Queen Anne,</u> | walls <u>WOOD / Weatherboard; shingle</u> |
| <u>Shingle Style</u> | <u>BRICK</u> |
| <u>LATE 20TH AND 20TH CENTURY REVIVALS /</u> | roof <u>ASPHALT, TILE, SLATE</u> |
| <u>Beaux Arts, Colonial Revival</u> | other _____ |

Narrative Description

(describe the historic and current condition of the property on one or more continuation sheets.)

United States Department of the Interior
National Park Service

NATIONAL REGISTER OF HISTORIC PLACES
CONTINUATION SHEET

West Main St./West James St.
Historic District
Richfield Springs, Otsego County

Section number 7 Page 3

West James St. contains 21 existing or former residences and 11 barns or garages. A non-contributing telephone exchange building built in 1967 is located at the northwest corner of West James Street and Taylor Avenue. Residences in this section of the historic district represent a cross-section of residential architecture in the village and include a small Federal/Greek Revival style plank-wall cottage built ca. 1830, a Greek Revival house built ca. 1840, a Gothic Revival house built ca. 1870, a finely detailed brick Italianate style house built in 1867, a Stick style mansion built in 1872, an elaborately detailed Shingle style residence built in 1885 and a number of houses built between 1875 and 1900 influenced by Queen Anne or Shingle Style architecture. Sidewalks are present on both sides of the street and front yard setbacks are minimal in all but several locations. Mature shade trees represent an important character-defining element of the streetscape. Two houses, nos. 5 and 11, retain contributing period iron fences and a third house at no. 19 retains original castellated stone gateposts with crenellated tops built ca. 1885.

The historic district includes a short length of Elm Street along its western edge establishing an important visual connection between West Main Street and West James Street. Three modest nineteenth century residences are located along the west side of the street. The east side of the street includes an open lawn adjacent to the 1872 Ward House and the St. John's Church complex at the north end. Significantly, the portico of the Richfield Springs Central School is located on axis with the centerline of Elm Street.

The northernmost block of Center Street between West James Street and West Main Street is also included within the historic district. The narrow, alley-like street provided access to the rear of businesses and hotels fronting on West Main Street. Three buildings are located on Center Street including an elongated nineteenth century storage barn and two frame shop buildings built ca. 1890. A fourth building oriented toward the street is an early nineteenth century storage barn associated with a former hardware store at 53 West Main Street.

An annotated building list describing each building in the district and cross referencing photographs follows:

| Address | Photo No. | Description |
|----------------------|-----------|--|
| <u>West Main St.</u> | | |
| 06 | 01 | Two-story frame residence built ca. 1855 with ca. 1920 Colonial Revival style alterations. Contributing carriage barn at rear. |
| 08 | 02 | Two-story frame residence built ca. 1850 and altered ca. 1890 in the Queen Anne style. Contributing carriage barn rear. |

United States Department of the Interior
National Park Service

NATIONAL REGISTER OF HISTORIC PLACES
CONTINUATION SHEET

West Main St./West James St.
Historic District
Richfield Springs, Otsego County

Section number 7 Page 8

- | | | |
|---|-----|--|
| 24 | 17 | Sarah Tunnicliff House. One-and-one-half-story frame Federal/Greek Revival style residence built ca. 1830. Plank wall construction. Contributing early 19th c. barn at rear. |
| 26 | 18 | Methodist Parsonage. Two-story frame Queen Anne style residence built in 1890. Wrap-around porch, second story sleeping porch and patterned shingled gables. Contributing frame garage at rear. |
| north side of W. James St., east of No. 19, west of Taylor Ave. | 19A | Telephone exchange. One-story brick building built in 1967. Non-contributing. |
| 27 | 38 | Two-story frame residence built ca. 1860 with contributing frame barn at rear. |
| 29 | 39 | Two-story frame residence built ca. 1890 with front porch and steeply pitched gable roof. |
| 30 | 19 | Two-story frame Italianate style residence built ca. 1870. During the 1880s it served as home to Caroline Bonaparte Benton, niece of Napoleon Bonaparte and daughter of Joseph Bonaparte, King of Spain. |
| 31 | 39 | Two-story frame residence with shingle exterior built ca. 1850. |
| 40 | 40 | Two-story frame Queen Anne style residence built ca. 1900. |
| 42 | 41 | Two-story frame residence built in 1914 with extensive modern alterations. Non-contributing. |
| 44 | | Two-story frame residence with segmentally arched windows built ca. 1870. |

United States Department of the Interior
National Park Service

NATIONAL REGISTER OF HISTORIC PLACES West Main St./West James St.
CONTINUATION SHEET Historic District
Richfield Springs, Otsego County

Section number 7 Page 9

Elm St.

| | | |
|----|----|--|
| 08 | 10 | Two-story frame Queen Anne style residence with elaborate gable decoration, altered first story fenestration. Built ca. 1880. |
| 10 | 10 | Two-story frame residence built ca. 1870 with hipped roof and contributing carriage barn at rear. |
| 14 | 11 | Two-story frame residence built ca. 1850 with ca. 1910 alterations. Contributing mid-nineteenth century carriage barn at rear. |

Center St.

| | | |
|--|-----|--|
| west side btwn. W. Main and W. James. ST. | 30A | Two-story frame storage barn built Ca. 1850. |
| east side, S. of W. Main | 30B | Palmer print shop. Two-story frame commercial building built in 1889. |
| east side, N. of W. James | 30B | Two-story frame barn built ca. 1890. |

8. Statement of Significance

Applicable National Register Criteria

(Mark an "x" in one or more boxes for the criteria qualifying the property for National Register listing.)

- [x] A Property is associated with events that have made a significant contribution to the broad patterns of our history.
[] B Property is associated with the lives of persons significant in our past.
[x] C Property that embodies the distinctive characteristics of a type, period, or method of construction or represents the work of a master, or possesses high artistic values, or represents a significant and distinguishable entity whose components lack individual distinction.
[] D Property has yielded, or is likely to yield, information important in pre-history or history.

Area of Significance

(Enter categories from instructions.)

SOCIAL HISTORY

ARCHITECTURE

Period of Significance

ca. 1830-1940

Significant Dates

Criteria Considerations

(Mark "X" in all the boxes that apply.)

- [] A owned by a religious institution or used for religious purposes.
[] B removed from its original location.
[] C a birthplace or grave.
[] D a cemetery.
[] E a reconstructed building, object or structure.
[] F a commemorative property.
[] G less than 50 years of age or achieved significance within the past 50 years.

Significant Person

(Complete if Criterion B is marked above.)

Cultural Affiliation

Architect/Builder

Dudley, Henry

Jordan, Myron A.

Gouge, Frederic H.

Narrative Statement of Significance

(Explain the significance of the property on one or more continuation sheets.)

9. Major Bibliographical References

Bibliography

(Cite the books, articles, and other sources used in preparing this form on one or more continuation sheets.)

Previous documentation on file (NPS): Primary location of additional data:

- [] preliminary determination of individual listing (36 CFR 67) has been requested [x] State historic preservation office
[] previously listed in the National Register [] Other State agency
[] previously determined eligible by the National Register [] Federal agency
[] designated a National Historic Landmark [] Local government
[] recorded by Historic American Building Survey # [] University
[] recorded by Historic American Engineering [] Other

Name of repository:

United States Department of the Interior
National Park ServiceNATIONAL REGISTER OF HISTORIC PLACES West Main St./West James St.
CONTINUATION SHEET Historic District
Richfield Springs, Otsego County

Section number 8 Page 2

The West Main Street / West James Street Historic District satisfies Criterion A for its association with the social and economic development of the village of Richfield Springs, and Criterion C for its significance as a distinguished collection of nineteenth and early twentieth century commercial, residential, educational and religious architecture. Representing a ca. 1830 - 1940 period of significance, buildings within the district reflect all major phases in the evolution of the village, including the turnpike and early spa period (ca. 1800-1860), the era of the large mineral springs resorts and rail transportation (ca. 1860-1920), and the early automobile era. (ca. 1920-1940). Architecturally, the historic district is marked by exceptional examples of Italianate, Gothic Revival, Stick Style, Queen Anne, Shingle Style, and Colonial Revival architecture, as well as vernacular interpretations of Greek Revival and Second Empire Style architecture. Intact streetscapes include a largely unbroken row of nineteenth century commercial buildings along the south side of West Main Street and an intact nineteenth century residential enclave along West James Street. Significant twentieth century contributions to the historic district include a 1910 library, a distinctive automobile dealership and garage and an imposing Colonial Revival style high school building constructed with Public Works Administration funding between 1938 and 1939.

The sulphur springs around which the village of Richfield Springs developed were well-known to the Iroquois who used the Ganowauges (stinking waters) as a curative to treat frostbite and other ailments. The springs are believed to have been discovered by Europeans in 1754, however, the location did not become the focus of permanent settlement until the 1790s. In 1791-1792, William Tunnickliff built a sawmill and gristmill near the western edge of the historic district, and a short time later, C. Robinson established a store at the corner of West Main Street and Elm Street in the district where St. John's Church currently stands. The extension of the Third Great Western Turnpike through the settlement in 1808 brought greater exposure to the springs and encouraged additional development at this location including the construction of a the Richfield Hotel in 1816. The hotel was located on West Main Street just east of the high school until 1955 when it was razed.

The commercial promotion of the sulphur springs was initiated by Dr. Horace Manley, who purchased the site of the Great White Sulphur Springs in 1820. Manley built a bath house at this site in the following year and brought 25 patients here to take the water cure. As the springs grew in popularity, demand for lodgings supported the construction of new and larger hotels including Page's Tavern in 1823 and the American Hotel in 1830. Hotels and collateral business establishments were built along both sides of the turnpike where a thriving Main Street business district emerged. Residential construction occurred throughout the village but eventually coalesced into neighborhoods separate from but immediately adjacent to the business district, particularly along James Street, Church Street and East Main Street.

Although little remains from the first forty years of architecture in the village, buildings from this period appear to have reflected design and construction practices typical of turnpike towns in Central New York and the Southern Tier region during this

United States Department of the Interior
National Park ServiceNATIONAL REGISTER OF HISTORIC PLACES West Main St./West James St.
CONTINUATION SHEET Historic District
Richfield Springs, Otsego County

Section number 8 Page 3

period. Buildings were characterized by rectangular plans and simple massing, balanced facades with Federal or early Greek Revival detailing, interlocking frames, clapboard exteriors, and often vertical plank wall construction. These buildings were also modest in scale. The only intact example of architecture from this period in the district is the ca. 1830 Sarah Tunnicliff house at 24 West James Street. The small one-and-one-half-story frame house provides an excellent representation of the construction practices described above and illustrates a vernacular interpretation of late Federal and early Greek Revival style detailing. The house is complemented by a contemporaneous barn at the rear of the lot.

Richfield Springs prospered as a mineral springs spa and by mid-century included a number of large frame hotels with capacities ranging from 100 to 500 guests each. The hotels were generally built along Main Street, east and west of Lake Street, and were characterized by long, one and two-story verandahs and porticos. The majority of the hotels of this period involved designs derived from the Greek Revival style. The ca. 1840 Brunswick Hotel at 47 West Main Street in the historic district is significant as the only hotel of this type to survive in the village. Despite storefront alterations at the front, the building retains its basic form, fenestration, portico at the facade and an unaltered guest room wing in back. Residential architecture in the village during this period also reflected Greek Revival style tastes, however few intact examples remain. The residence at 14 West James Street is representative of the type, and illustrates the wide entablatures, corner pilasters and trabeated entrance with sidelights commonly associated with the type. By 1860, the architectural design in the village began to reflect the influence of the Italianate style. The former Buchanan Hardware building at 53 West Main Street, built ca. 1860, is an early and well-preserved example of the transition from Greek Revival style form and design to the bracketed Italianate Style.

Richfield Springs incorporated as a village in 1861 with a permanent population of approximately 400. In 1870, a branch of the the Delaware, Lackawanna and Western Railroad was brought to the southern edge of the village to facilitate transportation to resort from major urban centers in the Northeast and Midwest. The railroad heralded a new era of growth and wealth in the village which continued into the first decade of the Twentieth Century. New hotels and boarding houses were built to accommodate the 2000-3000 guests which arrived each summer, and expensive summer estates were built in and around the village by prominent industrialists and businessmen, including Cyrus McCormick of McCormick Harvester Co., forerunner of International Harvester. By 1890, the year-round population of the village had increased four-fold to more than 1600 residents. Although the medicinal qualities of the sulfur springs continued to be a significant attraction, the village became an important part of the summer social scene for individuals of wealth. Among the more prominent summer residents and guests of the resort were Richard C. Croker, the infamous boss of New York's Tammany Hall, generals George McClellan and Joe Hooker, Admiral George Dewey, inventor Thomas Edison and writer Oscar Wilde. In addition to lavish private entertainment, social activities included the track, a daily coaching parade, tennis, cycling, rollerskating, golf, baseball, card playing, dancing, music and summer theatre. At least one hotel maintained a landscaped pleasure ground for strolling.

United States Department of the Interior
National Park Service

NATIONAL REGISTER OF HISTORIC PLACES
CONTINUATION SHEET

West Main St./West James St.
Historic District
Richfield Springs, Otsego County

Section number 9 Page 2

Major Bibliographic References:

Brown, Robert C. and Ronnie McCoy. A study of Early Hotels of Richfield Springs, Richfield Springs, N.Y.: Richfield Area Chamber of Commerce, 1991.

Hughes, Greta G., and Ella L. Winne, eds. The Town of Richfield, A Collection of Local History Articles, Richfield Springs, N.Y.: Richfield Springs Mercury, 1961.

Ward, Dr. Henry A. Annals of Richfield, Utica, N.Y.: Fierstone Printing House, 1897.

Richfield Springs, N.Y., Historical collections including issues of the Richfield Springs Mercury on file at the Richfield Springs Public Library, 59 West Main St.

United States Department of the Interior
National Park Service

NATIONAL REGISTER OF HISTORIC PLACES
CONTINUATION SHEET

West Main St./West James St.
Historic District
Richfield Springs, Otsego County

Section number 10 Page 2

UTM References:

Richfield Springs, N.Y. Quadrangle:

| | | | |
|--------|------------------|--------|------------------|
| 1. 18 | 500720 / 4744520 | 22. 18 | 501080 / 4744110 |
| 2. 18 | 500870 / 4744560 | 23. 18 | 501080 / 4744120 |
| 3. 18 | 500940 / 4744500 | 24. 18 | 500000 / 4744130 |
| 4. 18 | 500920 / 4744420 | 25. 18 | 500000 / 4744110 |
| 5. 18 | 500960 / 4744410 | 26. 18 | 500940 / 4744120 |
| 6. 18 | 500980 / 4744420 | 27. 18 | 500940 / 4744140 |
| 7. 18 | 501020 / 4744420 | 28. 18 | 500920 / 4744140 |
| 8. 18 | 501020 / 4744470 | 29. 18 | 500910 / 4744120 |
| 9. 18 | 501060 / 4744470 | 30. 18 | 500850 / 4744140 |
| 10. 18 | 501060 / 4744420 | 31. 18 | 500860 / 4744170 |
| 11. 18 | 501160 / 4744400 | 32. 18 | 500830 / 4744180 |
| 12. 18 | 501150 / 4744310 | 33. 18 | 500820 / 4744160 |
| 13. 18 | 501170 / 4744300 | 34. 18 | 500770 / 4744170 |
| 14. 18 | 501160 / 4744280 | 35. 18 | 500780 / 4744200 |
| 15. 18 | 501150 / 4744220 | 36. 18 | 500720 / 4744200 |
| 16. 18 | 501130 / 4744220 | 37. 18 | 500730 / 4744300 |
| 17. 18 | 501130 / 4744210 | 38. 18 | 500780 / 4744290 |
| 18. 18 | 501160 / 4744200 | 39. 18 | 500800 / 4744390 |
| 19. 18 | 501140 / 4744120 | 40. 18 | 500740 / 4744400 |
| 20. 18 | 501120 / 4744120 | 41. 18 | 500700 / 4744460 |
| 21. 18 | 501120 / 4744100 | | |

Verbal Boundary Description:

The boundary of the West Main Street / West James Street Historic District begins at a point northwest of the Richfield Springs High School and proceeds eastward, generally along the rear lot lines of properties at 6-36 West Main Street. At the northeast corner of the property at 6 West Main Street, the boundary turns southward, generally following the eastern lot lines of 11 West Main Street, 31 West James Street and 44 West James Street. At the southeast corner of the property at 44 West James Street, the boundary turns westward, generally following the rear lot lines of the properties between 2 and 44 West James Street, and the side lot line south of 14 Elm Street. At the southwest corner of the property at 14 Elm Street, the boundary continues northward along the rear lot lines of 8-14 Elm Street, along portions of the Elm Street and West Main Street right-of-ways and finally along the centerline of the Oquianis Creek to the point of origin, as illustrated in the attached historic district map.

Boundary Justification:

United States Department of the Interior
National Park Service

NATIONAL REGISTER OF HISTORIC PLACES
CONTINUATION SHEET

West Main St./West James St.
Historic District
Richfield Springs, Otsego County

Section number 10 Page 3

The boundaries of the historic district describe the limits of a cohesive historic district identified as a result of a comprehensive survey completed in 1992 and defined by the continuity of intact historic buildings from the ca. 1830 - 1940 period of significance in Richfield Springs. North of the district, the boundary separates the historic Richfield Springs Central School, an early automobile showroom and garage and several historic residences and commercial buildings from open land and later residential development. At the east, the boundary separates a row of contributing late nineteenth century commercial buildings on West Main Street and contributing nineteenth century residences on West James Street from extensively altered commercial buildings on West Main Street and Lake Street. At the south, the boundary separates a significant residential enclave on West James Street from later and less intact residential streetscapes on Park, Center and Division streets. At the west, the boundary includes three nineteenth century residences on Elm Street while excluding a non-historic ranch house and a modern filling station and convenience store.

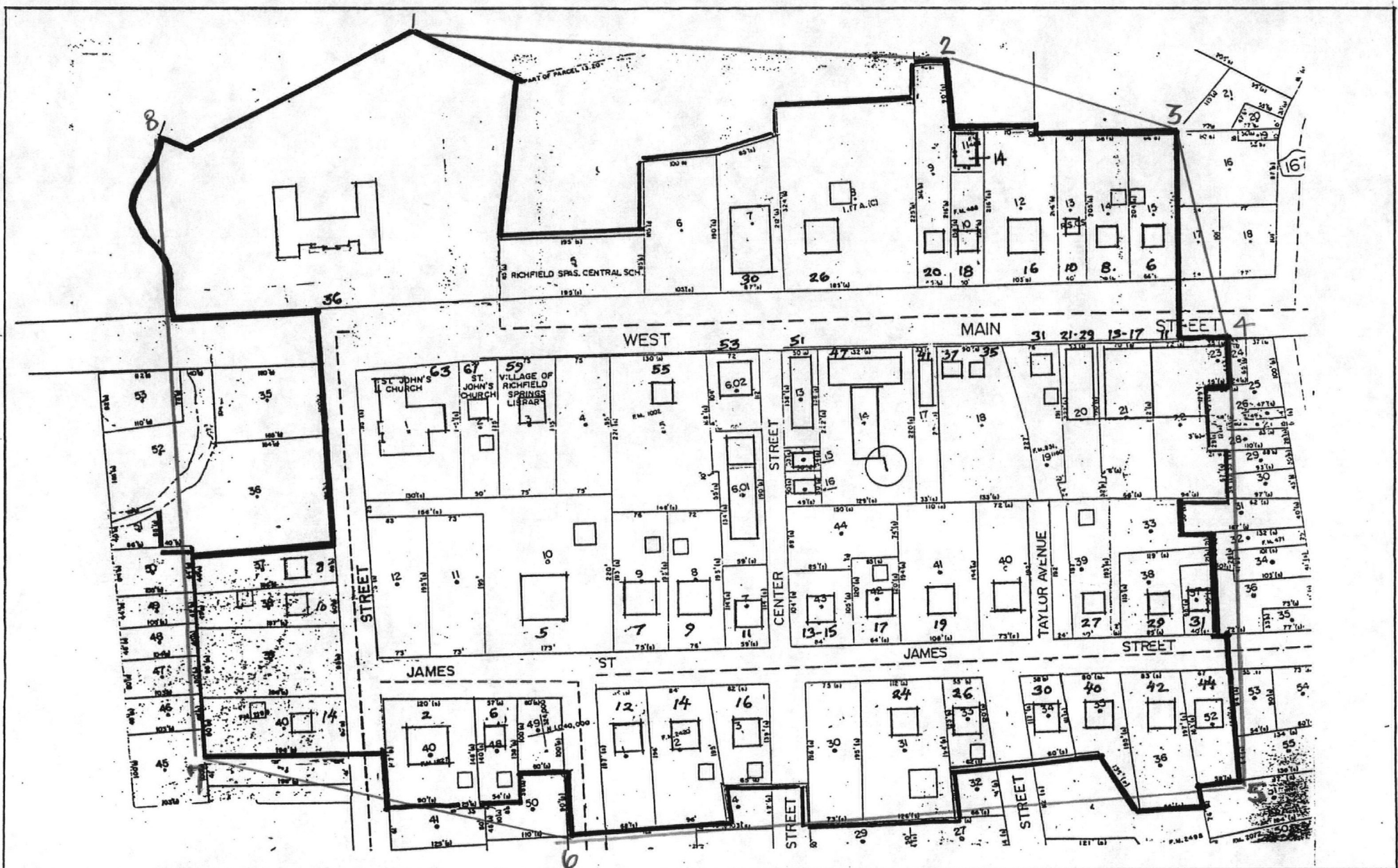

WEST MAIN ST. / WEST JAMES ST. HISTORIC DISTRICT

RICHFIELD SPRINGS, OTSEGO CO., NEW YORK

SCALE: 0 100 200 300 400 500

NATIONAL REGISTER DISTRICT BOUNDARY: 



UNITED STATES DEPARTMENT OF THE INTERIOR
NATIONAL PARK SERVICE

NATIONAL REGISTER OF HISTORIC PLACES
EVALUATION/RETURN SHEET

REQUESTED ACTION: NOMINATION

PROPERTY NAME: West Main Street--West James Street Historic District

MULTIPLE NAME:

STATE & COUNTY: NEW YORK, Otsego

DATE RECEIVED: 2/18/94 DATE OF PENDING LIST: 3/01/94
DATE OF 16TH DAY: 3/17/94 DATE OF 45TH DAY: 4/04/94
DATE OF WEEKLY LIST:

REFERENCE NUMBER: 94000257

NOMINATOR: STATE

REASONS FOR REVIEW:

APPEAL: N DATA PROBLEM: N LANDSCAPE: N LESS THAN 50 YEARS: N
OTHER: N PDIL: N PERIOD: N PROGRAM UNAPPROVED: N
REQUEST: N SAMPLE: N SLR DRAFT: N NATIONAL: N

COMMENT WAIVER: N

ACCEPT RETURN REJECT 3/17/94 DATE Entered in the National Register

ABSTRACT/SUMMARY COMMENTS:

RECOM./CRITERIA _____
REVIEWER _____
DISCIPLINE _____
DATE _____

DOCUMENTATION see attached comments Y/N see attached SLR Y/N

CLASSIFICATION

___ count ___ resource type

STATE/FEDERAL AGENCY CERTIFICATION

FUNCTION

___ historic ___ current

DESCRIPTION

___ architectural classification
___ materials
___ descriptive text

SIGNIFICANCE

Period Areas of Significance--Check and justify below

Specific dates Builder/Architect
Statement of Significance (in one paragraph)

___ summary paragraph
___ completeness
___ clarity
___ applicable criteria
___ justification of areas checked
___ relating significance to the resource
___ context
___ relationship of integrity to significance
___ justification of exception
___ other

BIBLIOGRAPHY

GEOGRAPHICAL DATA

___ acreage ___ verbal boundary description
___ UTMs ___ boundary justification

ACCOMPANYING DOCUMENTATION/PRESENTATION

___ sketch maps ___ USGS maps ___ photographs ___ presentation

OTHER COMMENTS

Questions concerning this nomination may be directed to

Phone

Signed

Date

RECOM. CRITERIA
REVIEWER
DISCIPLINE
DATE

ABSTRACT/SUMMARY COMMENTS

COMMENT WAIVER: N

REASONS FOR REVIEW:

NOMINATOR: STATE

DATE OF WEEKLY LIST:

DATE OF 15TH DAY:
DATE RECEIVED:

STATE & COUNTY: NEW YORK, Otsego

MULTIPLE
NAME:

PROPERTY
NAME:

REQUESTED ACTION: NOMINATION



West James St.
West Main Street/Historic District
Richfield Springs,
Otsego Co. NY

Monte Smith, 1993

Historic District Files at
72 East Main Street, Richfield Springs

Photo # /



West James St.
West Main Street Historic District
Richfield Springs
Otsego County, NY

Monte Smith, 1993

Historic District Files at
72 East Main Street, Richfield Springs

Photo # 2



SERVISTAR Anderson's Hardware

NEED SALT TODAY?
CARGILL SALT

Coke

AMERICAN
SALES

West James

West Main Street / Historic District
Richfield Springs
Otsego County, NY

Monte Smith, 1993

Historic District Files at
72 East Main Street, Richfield Springs

Photo # 3



West James St.
West Main Street/Historic District
Richfield Springs
Otsego County, NY
Monte Smith, 1993

Historic District Files at
72 East Main Street, Richfield Springs

Photo # 3A



J&S MARKET
EST. 1978

OPEN

AMERICAN STORES
INC.
RESTAURANT

West Main Street/^{West James St.} Historic District
Richfield Springs
Otsego County, NY

Monte Smith, 1993

Historic District Files at
72 East Main Street, Richfield Springs, NY

Photo # 5



West James St.
West Main Street / Historic District
Richfield Springs
Otsego County, NY
Monte Smith, 1993

Historic District Files at
72 East Main Street, Richfield Springs

Photo # 4



~~West~~ ^{West James St.} Main Street Historic District
Richfield Springs
Otsego County, NY

Monte Smith, 1993

Historic District Files at
72 East Main Street, Richfield Springs

Photo # 7



West James St.
West Main Street / Historic District
Richfield Springs
Otsego County, NY

Monte Smith, 1993

Historic District Files at
72 East Main Street, Richfield Springs

Photo # 8



West James St.

West Main Street / Historic Mill

Richfield Springs.

Otsego Co. NY.

Monte Smith 1993

Historic Mill Falls at

72 E. Main St., Richfield Sp.

Photo #9



West James St.

West Main Street / Historic District
Richfield Springs
Otsego County, NY

Monte Smith, 1993

Historic District Files at
72 East Main Street, Richfield Springs

Photo # 10



West James St.
West Main Street / Historic District
Richfield Springs
Otsego County, NY

Monte Smith, 1993

Historic District Files at
72 East Main Street, Richfield Springs

Photo # //



W JAMES ST

ELM ST

West James St.
West Main Street / Historic District
Richfield Springs
Otsego County, Ny

Monte Smith, 1993

Historic District Files at
72 East Main Street, Richfield Springs

Photo # 12



West James St.

West Main Street/Historic District

Richfield Springs

Otsego County, NY

Monte Smith, 1993

Historic District Files at

72 East Main Street, Richfield Springs

Photo # 13



West James St
West Main Street / Historic District
Richfield Springs
Otsego County, NY

Monte Smith, 1993

Historic District Files at
72 East Main Street, Richfield Springs

Photo # *14*



~~West Main Street~~ ^{West James St.} Historic District
Richfield Springs
Otsego County, NY

Monte Smith, 1993

Historic District Files at
72 East Main Street, Richfield Springs

Photo # 15



West James St.

West Main Street / Historic District
Richfield Springs,
Otsego County, NY

Monte Smith, 1993

Historic District Files at
72 East Main Street, Richfield Springs

Photo # 16



West James St.
West Main Street, Historic District
Richfield Springs
Otsego County, NY

Monte Smith, 1993

Historic District Files at
72 East Main Street, Richfield Springs

Photo # *17*



West James St.

West Main Street / Historic District
Richfield Springs
Otsego County, NY

Monte Smith, 1993

Historic District Files at
72 East Main Street, Richfield Springs

Photo # 18



West James St
West Main Street / Historic District
Richfield Springs
Otsego County, NY

Monte Smith, 1993

Historic District Files at
72 East Main Street, Richfield Springs

Photo # 19



NEW YORK
TELEPHONE
COMPANY

West James St.
West Main Street / Historic District
Richfield Springs
Otsego County, NY

Monte Smith, 1993

Historic District Files at
72 East Main Street, Richfield Springs

Photo # 19A



West James St.

West Main Street / Historic District
Richfield Springs
Otsego, County NY

Monte Smith, 1993

Historic District Files at
72 East Main St., Richfield Springs

Photo # 20



West James St.
West Main Street / Historic District
Richfield Springs,
Otsego County, NY

Monte Smith, 1993

Historic District Files at
72 East Main Street, Richfield Springs

Photo #: 21



West James St.

West Main Street / Historic District
Richfield Springs
Otsego County, NY

Monte Smith, 1993

Historic District Files at
72 East Main St., Richfield Springs

Photo # *22*



West James St.
West Main Street / Historic District
Richfield Springs
Otsego County, NY

Monte Smith, 1993
Historic District Files at
72 East Main St., Richfield Springs

Photo # 23



West James St.
West Main Street / Historic District
Richfield Springs
Otsego County, NY

Monte Smith, 1993

Historic District Files at
72 East Main Street, Richfield Springs

Photo # 24



West Main Street ^{West James St.} Historic District
Richfield Springs,
Otsego Co., NY
Monte Smith, 1993

Historic District Files at
72 East Main Street, Richfield Springs

Photo # 25



West James St.

West Main Street Historic List
Richfield Springs

Otsego County, NY

Monte Smith, 1993

Historic List Files at
72 E. Main Street, Richfield Spr.

Photo # 26



West James St.

West Main Street / Historic Dist

Richfield Springs

Otsego Co., N.Y.

Monte Smith, 1993

Historic District Files

72 E. Main Street, Richfield Spr.

Photo # 27



West James St.
Thru Main Street / Historic District
~~At~~ Rockfield Springs.

Otsego Co., NY.

Monte Smith, 1993

Historic District Files:

72 E. Main St. Rockfield Sp.

Photo # 28



INDIVIDUAL FINANCE AVAILABLE
OVER 1 MILLION HOMES FINANCED

Fleet Bank

West James St.

West Main Street Historic District

Richfield Springs

Otsego Co., N.Y.

Monte Smith, 1993

Historic District Files

72 E. Main St., Richfield Sp.

Photo # 29



3700 37th

V'S STORE
General Department Store

VIDEO FAX

FAX

NEW FLAVOR BAY
BRINGS STORE VIBES BY
PHARMACY CLASS

PHONE
AND
FAX
SERVICES
AVAILABLE
HERE

PHARMACY
SERVICES

West James St.
East Main Street, Historic District

Reichfield Springs

Otsego Co, N.Y.

Monte Smith, 1993

Historic Dist Files

72 E. Main St, Reichfield Spr.

Photo # 30



West Side Center St
West James St.

West Main St. Historic. Dist.

Richfield Spr.

Otsego Co. NY.

Monte Smith, 1993.

Historic Dist. Files

72 E. Main St.

Richfield Spr.

Photo: # 30A.



East Side Center St.
West James St.

West Main St. / Historic Dist.

Richfield Spr.

Otsego Co. NY.

Monte Smith. 1993

Historic Dist. Files 72 E. Main St.

Richfield Spr.

Photo #30 B.



Restivo's
RISTORANTE
aka THE BANK

PIZZERIA

Italian Lunch
RESTAURANT

OPEN

RESTAURANT

aka THE BANK

Italian Family
PIZZERIA
Call 858-2007

The Spangman
Cookin'
Natives

West James St.

West Main Street / Historic District

Richfield Springs.

Otsego Co., NY.

Monte Smith, 1993

Historic Dist Files

72 E. Main St; Richfield Spr.

Photo # 31



GO

FITNESS

SALE

Richie Carpet

Valley

West James St.
West Main Street / Historic District
Rockfield Springs.

Otsego Co., NY.

Monte Smith, 1993

Historic District Files
72 E. Main St. Rockfield Spr.

Photo # 32



West James St.

West Main Street/Historic District

Richfield Springs

Otsego Co., N.Y.

Monte Smith, 1993

Historic District Files

72 E. Main St., Richfield Spr.

Photo # 33



West James St.

West Main Street Historic District

Richfield Springs

Otsego Co, N.Y.

Monte Smith 1993

Historic District Files

72 E. Main St, Richfield Spr.

Photo # 34



West James St.

West Main Street/Historic Dist.

Richfield Springs.

Otsego Co. N.Y.

Photographer; Monte Smith 1993

Historic Dist. Files

72 E. Main St. Richfield Sprs.

Photo # 35



West James St.

West Main Street/Historic West
Rehfield Springs -
Otsego Co., NY
Monte Smith, 1993
Historic West Falls
72 E. Main St. Rehfield Spr.
Photo # 36



Clothing **RICK'S** Footwear

51
AND
10

DIMONS

100
AND
UP

MASON
TEMPLE

FRANKLIN
auto parts

FRANKLIN
auto parts

West James St.

West Main Street / Historic District
Richfield Springs

Otsego Co, NY.

Monte Smith, 1993

Historic District Files

72 East Main St. R. S.

Photo # 37



27 West James St

West Main St./West James St. Historic District

Richfield Springs

Otsego Co., New York

Photo by: Monte Smith, 1993

Neg. at: 72 East Main St., Richfield Springs

Photo No. 38



31 and 29 West James St

West Main St. / West James St. Historic District
Richfield Springs

Otsego Co., New York

Photo by: Monte Smith, 1993

Neg. at: 72 East Main St., Richfield Springs

Photo No. 39



40 West James St -
(next to 30 W James)

West Main St./West James St. Historic District
Richfield Springs
Otsego Co., New York

Photo by: Monte Smith, 1993

Neg. at: 72 East Main St., Richfield Springs

Photo No. 40



42 West James St

West Main St./West James St. Historic District
Richfield Springs
Otsego Co., New York

Photo by: Monte Smith, 1973

Neg. at: 72 East Main St., Richfield
Springs

Photo No. 41



| Easting | Northing |
|------------|----------|
| 1. 500720 | 4744520 |
| 2. 500870 | 4744530 |
| 3. 500940 | 4744500 |
| 4. 500920 | 4744420 |
| 5. 500960 | 4744410 |
| 6. 500980 | 4744420 |
| 7. 501020 | 4744420 |
| 8. 501020 | 4744470 |
| 9. 501060 | 4744470 |
| 10. 501060 | 4744420 |
| 11. 501160 | 4744420 |
| 12. 501150 | 4744310 |
| 13. 501170 | 4744300 |
| 14. 501160 | 4744280 |
| 15. 501180 | 4744220 |
| 16. 501180 | 4744220 |
| 17. 501130 | 4744210 |
| 18. 501160 | 4744200 |
| 19. 501140 | 4744200 |
| 20. 501120 | 4744200 |
| 21. 501120 | 4744100 |
| 22. 501080 | 4744110 |
| 23. 501080 | 4744120 |
| 24. 500900 | 4744130 |
| 25. 500900 | 4744110 |
| 26. 500940 | 4744120 |
| 27. 500940 | 4744140 |
| 28. 500920 | 4744140 |
| 29. 500940 | 4744140 |
| 30. 500940 | 4744140 |
| 31. 500860 | 4744160 |
| 32. 500860 | 4744170 |
| 33. 500860 | 4744170 |
| 34. 500770 | 4744170 |
| 35. 500780 | 4744200 |
| 36. 500720 | 4744200 |
| 37. 500730 | 4744200 |
| 38. 500780 | 4744210 |
| 39. 500800 | 4744210 |
| 40. 500740 | 4744210 |
| 41. 500700 | 4744210 |

NEW YORK STATE
DEPARTMENT OF TRANSPORTATION

RICHFIELD SPRINGS QUADRANGLE
NEW YORK
7.5 MINUTE SERIES PLANIMETRIC
SW/4 RICHFIELD SPRINGS 15' QUADRANGLE

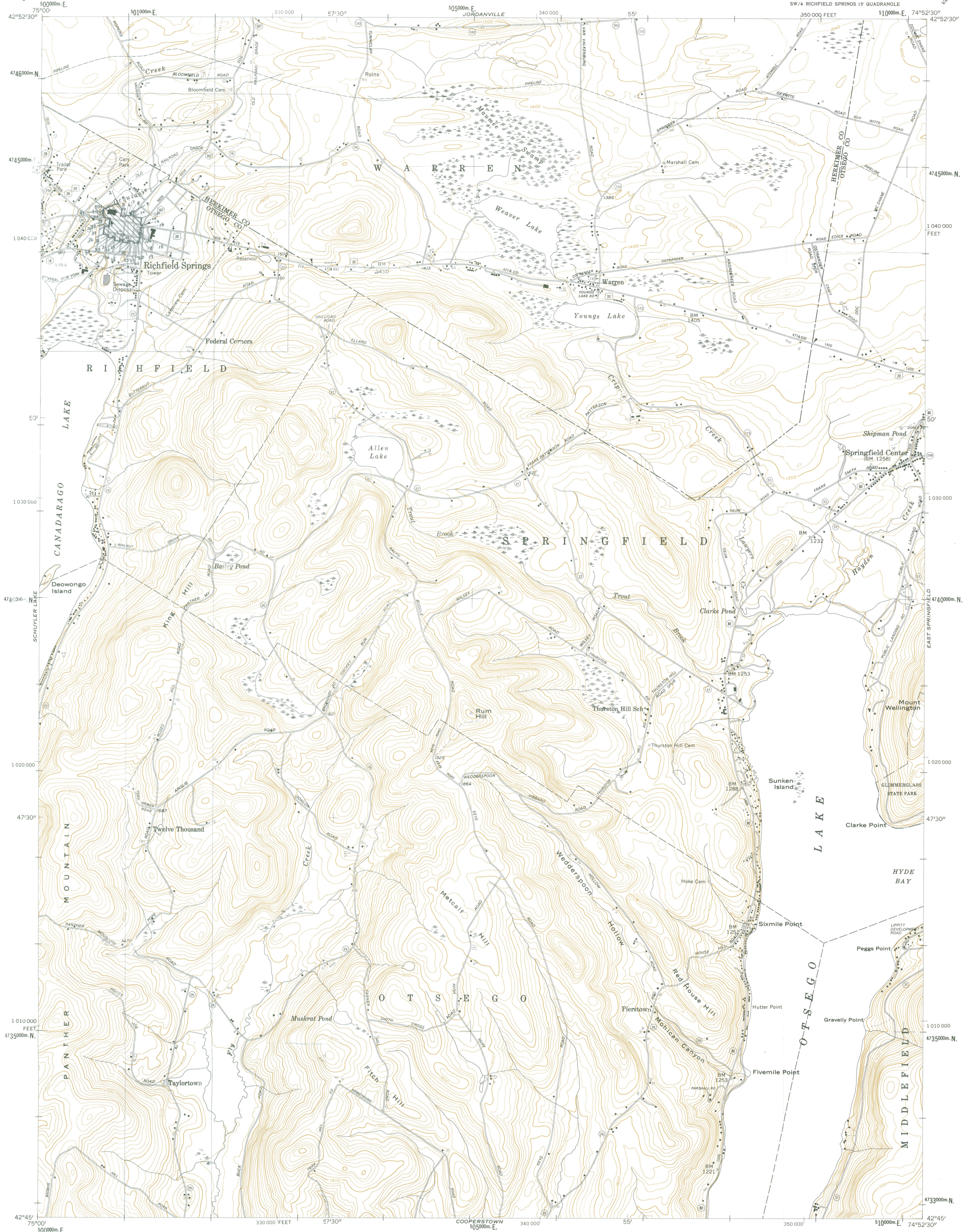

Prepared and published in 1974 by the New York State Department of Transportation, in cooperation with the U.S. Department of Transportation, Federal Highway Administration.

Map base from 1943 U.S. Geological Survey 7.5-minute quadrangle.

Map revisions made using 1973 aerial photography, construction plans, official records and other sources. Features revised include: highways and other transportation facilities; civil boundaries; recreation sites; hydrography; and buildings. Grey tint indicates intensely developed areas in which only landmark buildings are shown.

Revisions may not comply with National Map Accuracy Standards.

Correspondence concerning this and other maps of the Department of Transportation should be directed to: Map Information Unit, New York State Department of Transportation, State Campus, Albany, New York 12232.

1974 revisions by D. F. Dayger.

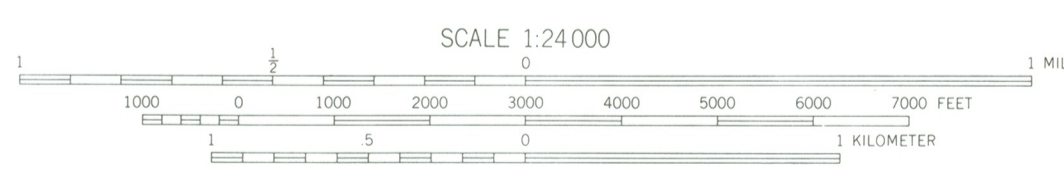

SCALE 1:24,000

Polyconic projection, 1927 North American datum.

1000-meter ticks based on the New York Transverse Mercator grid.

Between 72° and 78° West Longitude, this grid is identical to Zone 18 of the Universal Transverse Mercator grid. Areas east of 72° and west of 78° are direct mathematical extensions of Zone 18.

10,000-foot ticks based on the New York Plane Coordinate grid, East Zone.

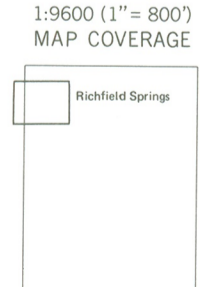

- BOUNDARIES:
- State.....
 - County.....
 - Town or City.....
 - Incorporated Village.....
 - Federal-Aid Urban Area.....
- ROADS:
- Touring Route markers.....
 - Interstate.....
 - U. S.
 - State.....
 - State Highway number and limit.....
 - County road.....
 - Interchange number.....
 - Divided highways and streets:
 - Wide mail.....
 - Narrow mail or barrier.....
 - Undivided highways and streets:
 - 4 or more lanes.....
 - Less than 4 lanes.....
 - Vehicle track; trail.....



Orin Lehman
Commissioner

New York State Office of Parks, Recreation and Historic Preservation
Historic Preservation Field Services Bureau
Peebles Island, PO Box 189, Waterford, New York 12188-0189

518-237-8643

November 1, 1993

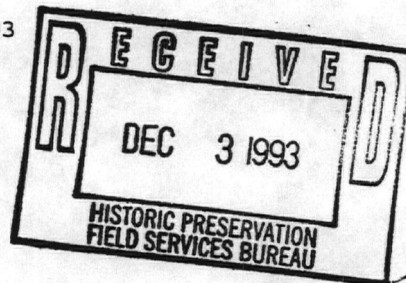

Mr. Francis Patterson
R.D. 3, RB 168
Richfield Springs, NY 13439

Re: West Main Street-James Street Historic District
Richfield Springs, Otsego County

Dear Mr. Patterson:

We are pleased to inform you that the property noted above will be considered by the State Review Board at its next meeting for nomination to the National and State Registers of Historic Places. These Registers are the federal and state governments' official lists of historic properties worthy of preservation. Listing in the Registers provides recognition of our national, state and local heritage and assistance in preserving it. Enclosed is a copy of the criteria under which properties are evaluated for listing.

Listing in the National and State Registers affords properties a measure of protection from the effects of federal and/or state sponsored or assisted projects, provides eligibility for certain federal tax provisions and renders certain properties eligible for federal and state preservation grants. There are no restrictions placed upon private owners of registered properties. The benefits of listing are explained more fully in the attached fact sheet.

Owners of private properties proposed for listing in the National Register must be given the opportunity to concur in or object to the listing. Each private property owner has one vote regardless of how many properties or what part of a single property that party owns. A notarized objection by the sole owner of a private property will prevent that property from being listed in the National Register. For properties or districts under multiple ownership, a majority of the owners must object in order to prevent the listing. If a property owner wishes to object to a proposed listing, he/she must submit a notarized acknowledgement that he/she is the owner of the property in question and that he/she objects to the proposed National Register listing. Objections must be submitted before the property is listed. Specific instructions for objecting to National Register listing are given in the enclosed fact sheet.

I do not want property listed

*Thank you
to SPB*

SWORN TO BEFORE ME THIS

30th ~~Nov~~ ^{Nov} DAY OF *Nov* 19 *93*

JEAN A. HUCKABONE
Notary Public, State of New York

Qualified in Otsego County
Reg. No. 4979318

Commission Expires March 25, 1995

Jean A. Huckabone

An Equal Opportunity/Affirmative Action Agency

November 7, 1993

Mr. Orin Lehman
Mr. Mark Peckham
New York State Office Of Parks, Recreation and Historic Preservation
Pebbles Island, PO Box 189
Waterford, New York 12188-0189

Re: West Main Street-James Street Historic District
Richfield Springs, Otsego County

Dear Mr. Peckham, Mr. Orin Lehman:

David A. and Ann E. Young being the owners of a residential house located at 6 West James Street in Richfield Springs oppose the listing of said property in the National Register.

Sincerely,

David A. Young Sr.
David A. Young

Ann E. Young
Ann E. Young
6 West James St.
Richfield Springs,
New York 13439

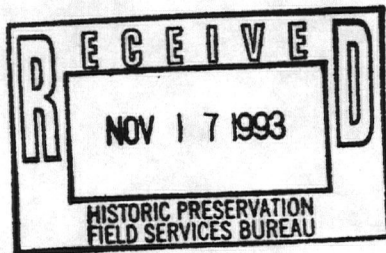

*Signed before me this 7th day
of November, 1993.*

*Monica Harris
Notary Public*

MONICA HARRIS
Notary Public, State of New York
Residing in Otsego County
My Commission Expires Aug. 31, 1994

Bh^r

~~DSC Draft reply for my signature~~
JEL 11/19

RECHFIELD SPRINGS HISTORIC DISTRICT ASSOC.
Richfield Springs, NY

November 16, 1994

Julia Stokes
Deputy Commissioner
Historic Preservation
Agency Building I
Empire State Plaza
Albany, NY 12238

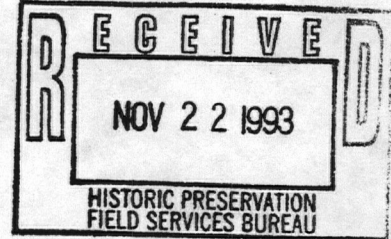
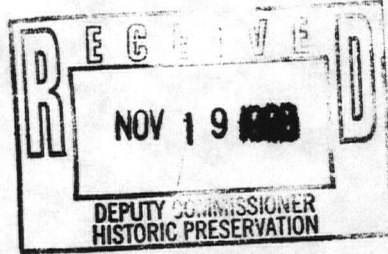

Dear Madam,

The Richfield Springs Historic District Association has been working for four years toward the goal of establishing the West Main St. Historic District. Our members feel strongly about preserving the remaining historic properties of what was a world class resort, and spa in the Victorian golden days. The buildings and architecture in the proposed historic district tell of an historic period in the life of Richfield Springs.

We urge your support for the finalization of our efforts.

Sincerely,

Barbara Wolfe
Barbara Wolfe
Secretary

BbF

DSG

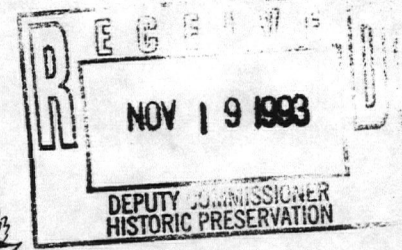
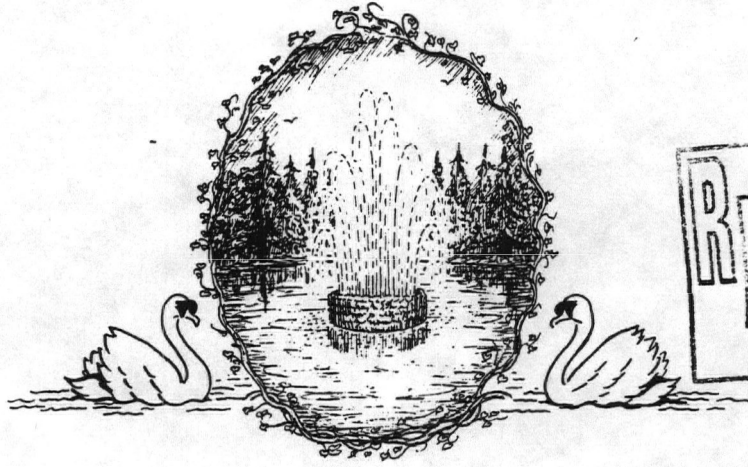

Richfield Area Improvement Association
 Post Office Box 374, Richfield Springs, New York 13439

November 17, 1993

Julia Stokes
 Deputy Commissioner
 Historic Preservation
 Agency Building I
 Empire State Plaza
 Albany, NY 12238

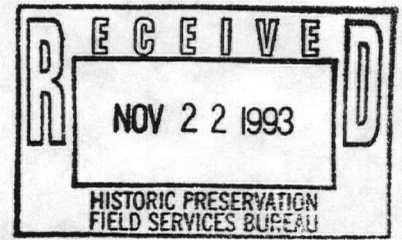

Dear Madam,

The Richfield Area Improvement Association urges you to have a favorable review of the proposed West Main St. Historic District. Our organization has supported the work of the Richfield Springs Historic District Assoc. and commends their work in preserving a segment of our village history which might otherwise be lost.

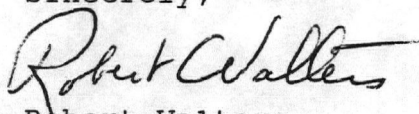
Sincerely,

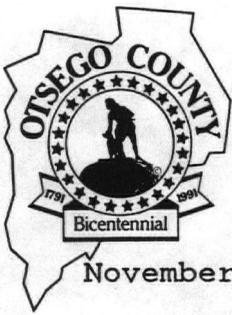
 Robert Walters
 Vice President

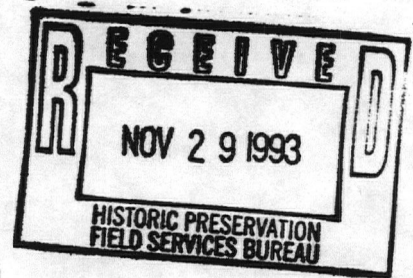

COUNTY OFFICE BUILDING • 197 MAIN STREET • COOPERSTOWN, NEW YORK 13326-1129
BOARD OF REPRESENTATIVES Tel. (607) 547-4202 Fax. No. 607-547-4260

November 24, 1993



Albert Caccese, Acting Commissioner
NYS Office of Parks, Recreation and
Historic Preservation
Historic Preservation Field Services Bureau
Peebles Island
PO Box 189
Waterford, NY 12188-0189

RE: West Main Street-James Street Historic District
Richfield Springs, Otsego County

Dear Mr. Caccese:

The Otsego County Board of Representatives feels that the West Main Street-James Street Historic District is historically significant and should be nominated to the National and State Registers of Historic Places. It is important to preserve our historic past for educational purposes and for tourism purposes.

Again, the Otsego County Board of Representatives strongly supports this nomination to the National and State Registers.

Sincerely,

Carl F. Higgins, Jr.

Carl F. Higgins, Chairman
Board of Representatives
Otsego County, New York



FORD

SMITH - COOPERSTOWN, INC.

Mercury - Jeep - Eagle

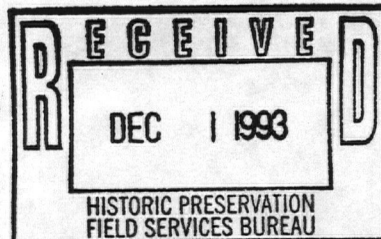

November 26, 1993

NYS Office of Parks, Recreation & Historic Preservation
Historic Preservation Field Services Bureau
Attn: Orin Lehman, State Historic Preservation Officer
PO Box 189, Peebles Island
Waterford, NY 12188-0189

Dear Mr. Lehman,

Edward C. Smith, President and William H. Smith, Secretary
owners of Smith - Cooperstown, Inc., object to the listing of
the property at 30 West Main Street, Richfield Springs, NY on
the National Register of Historic Places.

Sincerely,

Edward C. Smith, President

Sworn to before me this
26th day of Nov, 1993

Notary Public

NORMA ONYAN
Notary Public, State of New York
No. 4991625
Qualified in Otsego County
My Commission Expires 2/3/94

K

Entered

| | | |
|-------------|---|--------------|
| Refnumber | 94000257 | |
| Name | West Main Street -- West James Street +10 | |
| Date | 12/24/02 | |
| Code | Description | Tally |
| 01 | DOMESTIC | 29 |
| 01A | SINGLE DWELLING | |
| 01B | MULTIPLE DWELLING | |
| 01C | SECONDARY STRUCTURE | |
| 01D | HOTEL | |
| 01E | INSTITUTIONAL HOUSING | |
| 01F | CAMP | |
| 01G | VILLAGE SITE | |
| 02 | COMMERCE/TRADE | 14 |
| 02A | BUSINESS | |
| 02B | PROFESSIONAL | |
| 02C | ORGANIZATIONAL | |
| 02D | FINANCIAL INSTITUTION | |
| 02E | SPECIALTY STORE | |
| 02F | DEPARTMENT STORE | |
| 02G | RESTAURANT | |
| 02H | WAREHOUSE | |
| 02I | TRADE (ARCHEOLOGY) | |
| 03 | SOCIAL | |
| 03A | MEETING HALL | |
| 03B | CLUBHOUSE | |
| 03C | CIVIC | |
| 04 | GOVERNMENT | |
| 04A | CAPITOL | |
| 04B | CITY HALL | |
| 04C | CORRECTIONAL FACILITY | |
| 04D | FIRE STATION | |
| 04E | GOVERNMENT OFFICE | |
| 04F | DIPLOMATIC BUILDING | |
| 04G | CUSTOMHOUSE | |
| 04H | POST OFFICE | |
| 04I | PUBLIC WORKS | |
| 04J | COURTHOUSE | |
| 05 | EDUCATION | 2 |
| 05A | SCHOOL | |
| 05B | COLLEGE | |
| 05C | LIBRARY | |
| 05D | RESEARCH FACILITY | |
| 05E | EDUCATIONAL RELATED HOUSING | |
| 06 | RELIGION | 1 |
| 06A | RELIGIOUS STRUCTURE | |
| 06B | CEREMONIAL SITE | |
| 06C | CHURCH SCHOOL | |
| 06D | CHURCH RELATED RESIDENCE | |
| 07 | FUNERARY | |



RESEARCH INFORMATION CENTER

| Name | Code | Description | Date |
|------|-------------------------------|-------------|------|
| 01 | FUNERARY | | |
| 02 | CHURCH RELATED RESIDENCE | | |
| 03 | CHURCH SCHOOL | | |
| 04 | CEREMONIAL SITE | | |
| 05 | RELIGIOUS STRUCTURES | | |
| 06 | RELIGION | | |
| 07 | EDUCATIONAL REL. ED. BUILDING | | |
| 08 | RESEARCH FACILITY | | |
| 09 | LIBRARY | | |
| 10 | COLLEGE | | |
| 11 | SCHOOL | | |
| 12 | EDUCATION | | |
| 13 | COURTHOUSE | | |
| 14 | PUBLIC WORKS | | |
| 15 | POST OFFICE | | |
| 16 | CUSTOMER | | |
| 17 | DIPLOMAT BUILDING | | |
| 18 | GOVERNMENT OFFICE | | |
| 19 | STATION | | |
| 20 | CORRECTIONAL FACILITY | | |
| 21 | CITY HALL | | |
| 22 | CAPITOL | | |
| 23 | GOVERNMENT | | |
| 24 | CIVIC | | |
| 25 | CLUBHOUSE | | |
| 26 | MEETING HALL | | |
| 27 | SOCIAL | | |
| 28 | TRADE LABORATORY | | |
| 29 | WAREHOUSE | | |
| 30 | RESTAURANT | | |
| 31 | DEPARTMENT STORE | | |
| 32 | SPECIALTY STORE | | |
| 33 | FINANCIAL INSTITUTION | | |
| 34 | ORGANIZATIONAL | | |
| 35 | PROFESSIONAL | | |
| 36 | BUSINESS | | |
| 37 | COMMERCIAL BLDG | | |
| 38 | VILLAGE SITE | | |
| 39 | CAMP | | |
| 40 | INSTITUTIONAL HOUSING | | |
| 41 | HOTEL | | |
| 42 | SECONDARY STRUCTURE | | |
| 43 | MULTIPLE DWELLING | | |
| 44 | SINGLE DWELLING | | |
| 45 | DOMESTIC | | |

FUNCM

| | | |
|-----|--|---|
| 07A | CEMETERY | |
| 07B | GRAVES/BURIALS | |
| 07C | MORTUARY | |
| 08 | RECREATION AND CULTURE | |
| 08A | THEATER | |
| 08B | AUDITORIUM | |
| 08C | MUSEUM | |
| 08D | MUSIC FACILITY | |
| 08E | SPORT FACILITY | |
| 08F | OUTDOOR RECREATION | |
| 08G | FAIR | |
| 08H | MONUMENT/MARKER | |
| 08I | WORK OF ART (SCULPTURE, CARVING, ROCK ART) | |
| 09 | AGRICULTURE/SUBSISTENCE /// | 3 |
| 09A | PROCESSING | |
| 09B | STORAGE | |
| 09C | AGRICULTURAL FIELDS | |
| 09D | ANIMAL FACILITY | |
| 09E | FISHING FACILITY OR SITE | |
| 09F | AGRICULTURAL OUTBUILDINGS | |
| 09G | HORTICULTURE FACILITY | |
| 09H | IRRIGATION FACILITY | |
| 10 | INDUSTRY/PROCESSING/EXTRACTION | |
| 10A | MANUFACTURING FACILITY | |
| 10B | EXTRACTIVE FACILITY | |
| 10C | WATER WORKS | |
| 10D | ENERGY FACILITY | |
| 10E | COMMUNICATIONS FACILITY | |
| 10F | PROCESSING SITE | |
| 12 | HEALTH CARE | |
| 12A | HOSPITAL | |
| 12B | CLINIC | |
| 12C | SANATORIUM | |
| 12D | MEDICAL BUSINESS/OFFICE | |
| 12E | RESORT | |
| 13 | DEFENSE | |
| 13A | ARMS STORAGE | |
| 13B | FORTIFICATION | |
| 13C | MILITARY FACILITY | |
| 13D | BATTLE SITE | |
| 13E | COAST GUARD FACILITY | |
| 13F | NAVAL FACILITY | |
| 13G | AIR FACILITY | |
| 15 | LANDSCAPE | |
| 15A | PARKING LOT | |
| 15B | PARK | |
| 15C | PLAZA | |
| 15D | GARDEN | |
| 15E | FOREST | |
| 15F | UNOCCUPIED LAND | |
| 15G | UNDERWATER | |



RESEARCH INFORMATION CENTER

| Name | Date | Code | Description |
|------|------|------|-----------------------------|
| | | 01 | DOMESTIC |
| | | 01A | SINGLE DWELLING |
| | | 01B | MULTIPLE DWELLING |
| | | 01C | SECONDARY STRUCTURE |
| | | 110 | HOTEL |
| | | 01E | INSTITUTIONAL HOUSING |
| | | 01F | CAMP |
| | | 01G | VILLAGE SITE |
| | | 02 | COMMERCE/TRADE |
| | | 02A | BUSINESS |
| | | 02B | PROFESSIONAL |
| | | 02C | ORGANIZATIONAL |
| | | 02D | FINANCIAL INSTITUTION |
| | | 02E | SPECIALTY STORE |
| | | 02F | DEPARTMENT STORE |
| | | 02G | RESTAURANT |
| | | 02H | WAREHOUSE |
| | | 03 | TRADE (ARCHAEOLOGY) |
| | | 03 | SOCIAL |
| | | 03A | MEETING HALL |
| | | 03B | CLUBHOUSE |
| | | 03C | CIVIC |
| | | 04 | GOVERNMENT |
| | | 04A | CAPITOL |
| | | 04B | CITY HALL |
| | | 04C | CORRECTIONAL FACILITY |
| | | 04D | FIRE STATION |
| | | 04E | GOVERNMENT OFFICE |
| | | 04F | DIPLOMATIC BUILDING |
| | | 04G | CUSTOMHOUSE |
| | | 04H | POST OFFICE |
| | | 04I | PUBLIC WORKS |
| | | 04J | COURTHOUSE |
| | | 05 | EDUCATION |
| | | 05A | SCHOOL |
| | | 05B | COLLEGE |
| | | 05C | LIBRARY |
| | | 05D | RESEARCH FACILITY |
| | | 05E | EDUCATIONAL REL. ED HOUSING |
| | | 06 | RELIGION |
| | | 06A | RELIGIOUS STRUCTURE |
| | | 06B | CEREMONIAL SITE |
| | | 06C | CHURCH SCHOOL |
| | | 06D | CHURCH RELATED RESIDENCE |
| | | 07 | FUNERARY |

FUNCM

| | | |
|-------|-------------------------|-------|
| 15H | NATURAL FEATURE | |
| 15I | STREET FURNITURE/OBJECT | |
| 15J | CONSERVATION AREA | |
| 16 | TRANSPORTATION | |
| 16A | RAIL-RELATED | |
| 16B | AIR-RELATED | |
| 16C | WATER-RELATED | |
| 16D | ROAD-RELATED | |
| 16E | PEDESTRIAN RELATED | |
| 96 | WORK IN PROGRESS | |
| 97 | UNKNOWN | |
| 98 | VACANT/NOT IN USE | |
| 99 | OTHER XX | 5 |
| Total | | 61 54 |



RESEARCH INFORMATION CENTER

| Name | Date | Code | Description |
|------|------|------|--------------------------|
| | | 01 | DOMESTIC |
| | | 01A | SINGLE DWELLING |
| | | 01B | MULTIPLE DWELLING |
| | | 01C | SECONDARY STRUCTURE |
| | | 01D | HOTEL |
| | | 01E | INSTITUTIONAL HOUSING |
| | | 01F | CAMP |
| | | 01G | VILLAGE SITE |
| | | 02 | COMMERCIAL |
| | | 02A | BUSINESS |
| | | 02B | PROFESSIONAL |
| | | 02C | ORGANIZATIONAL |
| | | 02D | FINANCIAL INSTITUTION |
| | | 02E | SPECIALTY STORE |
| | | 02F | DEPARTMENT STORE |
| | | 02G | RESTAURANT |
| | | 02H | WAREHOUSE |
| | | 03 | TRADE (ARTS/TECHNOLOGY) |
| | | 03 | SOCIAL |
| | | 03A | MEETING HALL |
| | | 03B | CLUBHOUSE |
| | | 03C | CIVIC |
| | | 04 | GOVERNMENT |
| | | 04A | CAPITOL |
| | | 04B | CITY HALL |
| | | 04C | CORRECTIONAL FACILITY |
| | | 04D | FIRE STATION |
| | | 04E | GOVERNMENT OFFICE |
| | | 04F | DIPLOMATIC BUILDING |
| | | 04G | CUSTOMHOUSE |
| | | 04H | POST OFFICE |
| | | 04I | PUBLIC WORKS |
| | | 04J | COURTHOUSE |
| | | 05 | EDUCATION |
| | | 05A | SCHOOL |
| | | 05B | COLLEGE |
| | | 05C | LIBRARY |
| | | 05D | RESEARCH FACILITY |
| | | 05E | EDUCATIONAL REL. HOUSING |
| | | 06 | RELIGION |
| | | 06A | RELIGIOUS STRUCTURE |
| | | 06B | CEREMONIAL SITE |
| | | 06C | CHURCH SCHOOL |
| | | 06D | CHURCH RELATED RESIDENCE |
| | | 07 | FUNERARY |

Ek

FUNCM

| | | |
|-----------|--|-------------------------|
| Refnumber | 94000257 | |
| Name | West James Street historic district | |
| Date | | |
| Code | Description | Tally |
| 01 | DOMESTIC IIII IIII IIII IIII IIII IIII | 28 |
| 01A | SINGLE DWELLING | III IIII IIII IIII IIII |
| 01B | MULTIPLE DWELLING | III |
| 01C | SECONDARY STRUCTURE | |
| 01D | HOTEL | |
| 01E | INSTITUTIONAL HOUSING | |
| 01F | CAMP | |
| 01G | VILLAGE SITE | |
| 02 | COMMERCE/TRADE IIII IIII II | 10 21 |
| 02A | BUSINESS III IIII | |
| 02B | PROFESSIONAL | |
| 02C | ORGANIZATIONAL | |
| 02D | FINANCIAL INSTITUTION | |
| 02E | SPECIALTY STORE | |
| 02F | DEPARTMENT STORE | |
| 02G | RESTAURANT | |
| 02H | WAREHOUSE | |
| 02I | TRADE (ARCHEOLOGY) | |
| 03 | SOCIAL | |
| 03A | MEETING HALL | |
| 03B | CLUBHOUSE | |
| 03C | CIVIC | |
| 04 | GOVERNMENT | |
| 04A | CAPITOL | |
| 04B | CITY HALL | |
| 04C | CORRECTIONAL FACILITY | |
| 04D | FIRE STATION | |
| 04E | GOVERNMENT OFFICE | |
| 04F | DIPLOMATIC BUILDING | |
| 04G | CUSTOMHOUSE | |
| 04H | POST OFFICE | |
| 04I | PUBLIC WORKS | |
| 04J | COURTHOUSE | |
| 05 | EDUCATION II | 2 |
| 05A | SCHOOL II | |
| 05B | COLLEGE | |
| 05C | LIBRARY | |
| 05D | RESEARCH FACILITY | |
| 05E | EDUCATIONAL RELATED HOUSING | |
| 06 | RELIGION I | 1 |
| 06A | RELIGIOUS STRUCTURE I | |
| 06B | CEREMONIAL SITE | |
| 06C | CHURCH SCHOOL | |
| 06D | CHURCH RELATED RESIDENCE | |
| 07 | FUNERARY | |



RESEARCH INFORMATION CENTER

| Name | Code | Description | Date |
|--------------------------|------|-------------|------|
| LIBRARY | 01 | | |
| CHURCH BETA FEDERAL SIDE | 02 | | |
| CHURCH SCHOOL | 03 | | |
| CEREMONIAL BLDG | 04 | | |
| RELIGIOUS STRUCTURES | 05 | | |
| RELIGION | 06 | | |
| EDUCATIONAL BETA HOUSING | 07 | | |
| RESEARCH FACILITY | 08 | | |
| LIBRARY | 09 | | |
| COLLEGE | 10 | | |
| SCHOOL | 11 | | |
| EDUCATION | 12 | | |
| COURTHOUSE | 13 | | |
| PUBLIC WORKS | 14 | | |
| POST OFFICE | 15 | | |
| CUSTOMHOUSE | 16 | | |
| DIPLOMAT BLDG | 17 | | |
| GOVERNMENT OFFICE | 18 | | |
| TRAIN STATION | 19 | | |
| CORRECTIONAL FACILITY | 20 | | |
| CITY HALL | 21 | | |
| CAPITOL | 22 | | |
| GOVERNMENT | 23 | | |
| CIVIC | 24 | | |
| CLUBHOUSE | 25 | | |
| MEETING HALL | 26 | | |
| SOCIAL | 27 | | |
| THEATRE | 28 | | |
| VA HOUSE | 29 | | |
| RESTAURANT | 30 | | |
| DEPARTMENT STORE | 31 | | |
| SPECIALTY STORE | 32 | | |
| FINANCIAL INSTITUTION | 33 | | |
| ORGANIZATIONAL | 34 | | |
| PROFESSIONAL | 35 | | |
| BUSINESS | 36 | | |
| COMMERCIAL BLDG | 37 | | |
| VILLAGE SITE | 38 | | |
| CAMP | 39 | | |
| INSTITUTIONAL HOUSING | 40 | | |
| HOTEL | 41 | | |
| SECONDARY STRUCTURE | 42 | | |
| MULTIPLE DWELLING | 43 | | |
| SINGLE DWELLING | 44 | | |
| DOMESTIC | 45 | | |

FUNCM

| | | |
|-----|--|---|
| 07A | CEMETERY | |
| 07B | GRAVES/BURIALS | |
| 07C | MORTUARY | |
| 08 | RECREATION AND CULTURE | |
| 08A | THEATER | |
| 08B | AUDITORIUM | |
| 08C | MUSEUM | |
| 08D | MUSIC FACILITY | |
| 08E | SPORT FACILITY | |
| 08F | OUTDOOR RECREATION | |
| 08G | FAIR | |
| 08H | MONUMENT/MARKER | |
| 08I | WORK OF ART (SCULPTURE, CARVING, ROCK ART) | |
| 09 | AGRICULTURE/SUBSISTENCE / / / | B |
| 09A | PROCESSING / / / | |
| 09B | STORAGE | |
| 09C | AGRICULTURAL FIELDS | |
| 09D | ANIMAL FACILITY | |
| 09E | FISHING FACILITY OR SITE | |
| 09F | AGRICULTURAL OUTBUILDINGS | |
| 09G | HORTICULTURE FACILITY | |
| 09H | IRRIGATION FACILITY | |
| 10 | INDUSTRY/PROCESSING/EXTRACTION | |
| 10A | MANUFACTURING FACILITY | |
| 10B | EXTRACTIVE FACILITY | |
| 10C | WATER WORKS | |
| 10D | ENERGY FACILITY | |
| 10E | COMMUNICATIONS FACILITY | |
| 10F | PROCESSING SITE | |
| 12 | HEALTH CARE | |
| 12A | HOSPITAL | |
| 12B | CLINIC | |
| 12C | SANATORIUM | |
| 12D | MEDICAL BUSINESS/OFFICE | |
| 12E | RESORT | |
| 13 | DEFENSE | |
| 13A | ARMS STORAGE | |
| 13B | FORTIFICATION | |
| 13C | MILITARY FACILITY | |
| 13D | BATTLE SITE | |
| 13E | COAST GUARD FACILITY | |
| 13F | NAVAL FACILITY | |
| 13G | AIR FACILITY | |
| 15 | LANDSCAPE | |
| 15A | PARKING LOT | |
| 15B | PARK | |
| 15C | PLAZA | |
| 15D | GARDEN | |
| 15E | FOREST | |
| 15F | UNOCCUPIED LAND | |
| 15G | UNDERWATER | |



RESEARCH INFORMATION CENTER

| Name | Code | Description | Date |
|-----------------------------|------|-----------------------------|------|
| DOMESTIC | 01 | DOMESTIC | |
| SINGLE DWELLING | 01A | SINGLE DWELLING | |
| MULTIPLE DWELLING | 01B | MULTIPLE DWELLING | |
| SECONDARY STRUCTURE | 01C | SECONDARY STRUCTURE | |
| HOTEL | 01D | HOTEL | |
| INSTITUTIONAL HOUSING | 01E | INSTITUTIONAL HOUSING | |
| CAMP | 01F | CAMP | |
| VILLAGE SITE | 01G | VILLAGE SITE | |
| COMMERCE/TRADE | 02 | COMMERCE/TRADE | |
| BUSINESS | 02A | BUSINESS | |
| PROFESSIONAL | 02B | PROFESSIONAL | |
| ORGANIZATIONAL | 02C | ORGANIZATIONAL | |
| FINANCIAL INSTITUTION | 02D | FINANCIAL INSTITUTION | |
| SPECIALTY STORE | 02E | SPECIALTY STORE | |
| DEPARTMENT STORE | 02F | DEPARTMENT STORE | |
| RESTAURANT | 02G | RESTAURANT | |
| WAREHOUSE | 02H | WAREHOUSE | |
| TRADE/ARCHITECTURE | 03 | TRADE/ARCHITECTURE | |
| SOCIAL | 03 | SOCIAL | |
| MEETING HALL | 03A | MEETING HALL | |
| CLUBHOUSE | 03B | CLUBHOUSE | |
| CIVIC | 03C | CIVIC | |
| GOVERNMENT | 04 | GOVERNMENT | |
| CAPITOL | 04A | CAPITOL | |
| CITY HALL | 04B | CITY HALL | |
| CORRECTIONAL FACILITY | 04C | CORRECTIONAL FACILITY | |
| FIRE STATION | 04D | FIRE STATION | |
| GOVERNMENT OFFICE | 04E | GOVERNMENT OFFICE | |
| EMBASSY BUILDING | 04F | EMBASSY BUILDING | |
| CUSTOMHOUSE | 04G | CUSTOMHOUSE | |
| POST OFFICE | 04H | POST OFFICE | |
| PUBLIC WORKS | 04I | PUBLIC WORKS | |
| COURTHOUSE | 04J | COURTHOUSE | |
| EDUCATION | 05 | EDUCATION | |
| SCHOOL | 05A | SCHOOL | |
| COLLEGE | 05B | COLLEGE | |
| LIBRARY | 05C | LIBRARY | |
| RESEARCH FACILITY | 05D | RESEARCH FACILITY | |
| EDUCATIONAL RELATED HOUSING | 05E | EDUCATIONAL RELATED HOUSING | |
| RELIGION | 06 | RELIGION | |
| RELIGIOUS STRUCTURE | 06A | RELIGIOUS STRUCTURE | |
| CEREMONIAL SITE | 06B | CEREMONIAL SITE | |
| CHURCH SCHOOL | 06C | CHURCH SCHOOL | |
| CHURCH RELATED RESIDENCE | 06D | CHURCH RELATED RESIDENCE | |
| FUNERARY | 07 | FUNERARY | |

FUNCM

| | | |
|-------|-------------------------|----|
| 15H | NATURAL FEATURE | |
| 15I | STREET FURNITURE/OBJECT | |
| 15J | CONSERVATION AREA | |
| 16 | TRANSPORTATION | |
| 16A | RAIL-RELATED | |
| 16B | AIR-RELATED | |
| 16C | WATER-RELATED | |
| 16D | ROAD-RELATED | |
| 16E | PEDESTRIAN RELATED | |
| 96 | WORK IN PROGRESS | |
| 97 | UNKNOWN | |
| 98 | VACANT/NOT IN USE | |
| 99 | OTHER | |
| Total | 61 | 12 |



RESEARCH INFORMATION CENTER

| Name | Code | Date |
|-----------------------------|------|------|
| Funerary | 01 | |
| Church Related Residence | 02 | |
| Church School | 03 | |
| Ceremonial Site | 04 | |
| Religious Structure | 05 | |
| Religion | 06 | |
| Educational Related Housing | 07 | |
| Research Facility | 08 | |
| Library | 09 | |
| College | 10 | |
| School | 11 | |
| Education | 12 | |
| Courthouse | 13 | |
| Public Works | 14 | |
| Post Office | 15 | |
| Custodian | 16 | |
| Department Building | 17 | |
| Government Office | 18 | |
| Police Station | 19 | |
| Correctional Facility | 20 | |
| City Hall | 21 | |
| Cathedral | 22 | |
| Government | 23 | |
| Yield | 24 | |
| Clubhouse | 25 | |
| Meeting Hall | 26 | |
| Social | 27 | |
| Trade Association | 28 | |
| Warehouse | 29 | |
| Restaurant | 30 | |
| Department Store | 31 | |
| Specialty Store | 32 | |
| Financial Institution | 33 | |
| Professional | 34 | |
| Business | 35 | |
| Commercial Trade | 36 | |
| Village Site | 37 | |
| Camp | 38 | |
| Intentional Housing | 39 | |
| Hotel | 40 | |
| Secondary Structure | 41 | |
| Multiple Dwelling | 42 | |
| Single Dwelling | 43 | |
| Domestic | 44 | |