

UNITED STATES DEPARTMENT OF THE INTERIOR
NATIONAL PARK SERVICE
NATIONAL REGISTER OF HISTORIC PLACES
REGISTRATION FORM

OMB NO. 1024-0018, NPS FORM

1539
RECEIVED

DEC 16 1993

This form is for use in nominating or requesting determinations for individual properties or districts. See instructions in How to Complete the National Register of Historic Places Registration Form (National Register Bulletin 16A). Complete each item by marking "x" in the appropriate box or by entering information requested. If an item does not apply to the property being documented, enter "N/A" for "not applicable." For functions, architectural classifications, materials, and areas of significance, enter only categories and subcategories from the instructions. Place additional entries and narrative items on continuation sheets (NPS Form 10-900a). Use a typewriter, word processor, or computer, to complete all items.

1. Name of Property

historic name Tonawanda (25th Separate Company) Armory

other names/site number _____

2. Location

street & number 79 Delaware Avenue [] not for publication

city Tonawanda [] vicinity

state New York code NY county Erie code 029 zip code 14150-3416

3. State/Federal Agency Certification

As the designated authority under the National Historic Preservation Act of 1966, as amended, I hereby certify that this [X] nomination [] request for determination of eligibility meets the documentation standards for registering properties in the National Register of Historic Places and meets the procedural and professional requirements set forth in 36 CFR Part 60. In my opinion, the property [X] meets [] does not meet the National Register criteria. I recommend that this property be considered significant [] nationally [] statewide [X] locally. ([] See continuation sheet for additional comments.)

Julia S. Stokun
Deputy Commissioner for Historic Preservation

12/8/93
Date

NYS Office of Parks, Recreation and Historic Preservation

In my opinion, the property [] meets [] does not meet the National Register criteria. ([] See continuation sheet for additional comments.)

Signature of commenting or other official Date

State or federal agency and bureau

4. National Park Service Certification

- I hereby, certify that this property is:
- entered in the National Register.
[] See continuation sheet.
- [] determined eligible for the National Register. [] see continuation sheet.
- [] determined not eligible for the National Register.

John Signature of keeper Date of Action
Beth A. Savage 1-28-94

[] removed from the National Register.

[] other: _____

5. Classification

Ownership of Property/Category of Property/Number of Resources within Property

(Check as many boxes as apply) (check box) (do not include previously listed resources in the count)

[]private [x]building(s) Contributing Noncontributing
[]public-local []district 1 buildings
[x]public-State []site sites
[]public-Federal []structure structures
[]object objects
1 Total
Number of contributing resources previously listed in the National Register: NA

NAME OF RELATED MULTIPLE PROPERTY DOCUMENTATION FORM:

ARMY NATIONAL GUARD ARMORIES IN NEW YORK STATE

6. Function or Use

Historic Function

Current Function

DEFENSE; Armory
[]
[]
[]
[]
[]
[]

DEFENSE; Armory
[]
[]
[]
[]
[]
[]

7. Description

Architectural Classification

Materials

(enter categories from instructions)

(enter categories from instructions)

LATE VICTORIAN
Richardsonian Romanesque
other: Castellated style

foundation brick
walls brick with Warsaw blue granite trim
roof asphalt shingles
other

Narrative Description

See attached continuation sheets.

8. Statement of Significance

Applicable National Register Criteria

(Mark an "x" in one or more boxes for the criteria qualifying the property for National Register listing.)

- [X] A Property is associated with events that have made a significant contribution to the broad patterns of our history.
[] B Property is associated with the lives of persons significant in our past.
[X] C Property that embodies the distinctive characteristics of a type, period, or method of construction or represents the work of a master, or possesses high artistic values, or represents a significant and distinguishable entity whose components lack individual distinction.
[] D Property has yielded, or is likely to yield, information important in pre-history or history.

Criteria Considerations: NA

- [] A owned by a religious institution or used for religious purposes.
[] B removed from its original location.
[] C a birthplace or grave.
[] D a cemetery.
[] E a reconstructed building, object or structure.
[] F a commemorative property.
[] G less than 50 years of age or achieved significance within the past 50 years.

Area of Significance

(Enter categories from instructions.)

Military History

Architecture

Period of Significance

ca. 1896

Significant Dates

ca. 1896

Significant Person

(Complete if Criterion B is marked above.)

na

Cultural Affiliation

na

Architect/Builder

Isaac G. Perry

Narrative Statement of Significance

See attached continuation sheets.

9. Major Bibliographical References

See attached continuation sheets

Previous documentation on file (NPS): Primary location of additional data:

- [] preliminary determination of individual listing (36 CFR 67) has been requested
[] previously listed in the National Register
[] previously determined eligible by the National Register
[] designated a National Historic Landmark
[] recorded by Historic American Building Survey #
[] recorded by Historic American Engineering Record #
[X] State historic preservation office
[] Other State agency
[] Federal agency
[] Local government
[] University
[] Other

Name of repository:

Division for Historic Preservation

10. Geographical Data

Acreage of property less than one

UTM References

(Place additional UTM references on a continuation sheet.)

Table with 4 columns: A, B, C, D. Each column has Zone, Easting, and Northing fields with grid lines for data entry.

Verbal Boundary Description

The boundary coincides with the legal lot line of the nominated property as delineated on the attached county tax map.

Boundary Justification

The boundary was drawn to encompass the fullest extent of land historically and presently associated with the nominated armory which, in this case, coincides with the full parcel on which the building is sited.

11. Form Prepared By

name/title Nancy L. Todd, Program Analyst
organization NYSHPO, Division for Historic Preservation date December 1993
street & number Peebles Island, PO Box 189 telephone 518-237-8643
city or town Waterford state NY zip code 12188-0189

Additional Documentation

Submit the following items with the completed form:

Continuation Sheets

Maps

- A USGS map (7.5 or 15 minute series) indicating the property's location.
A Sketch map for historic districts and properties having large acreage or numerous resources.

Photographs

Representative black and white photographs of the property.

Additional items

(check with the SHPO or FPO for any additional items)

Property Owner

(Complete this item at the request of SHPO or FPO.)

name NYS Division of Military and Naval Affairs (DMNA)
street & number 330 Old Niskayuna Road
city or town Latham state NY zip code 12110

Paperwork Reduction Act Statement: This information is being collected for applications to the National Register of Historic Places to nominate properties for listing or determine eligibility for listing, to list properties, and to amend existing listings. Response to this request is required to obtain a benefit in accordance with the National Historic Preservation Act, as amended (16 U.S.C. 470 et seq.).

Estimated Burden Statement: Public reporting burden for this form is estimated to average 18.1 hours per response including the time for reviewing instructions, gathering and maintaining data, and completing and reviewing the form. Direct comments regarding this burden estimate or any aspect of this form to the Chief, Administrative Services Division, National Park Service, P.O. Box 37127, Washington, DC 20013-7127; and the Office of Management and Budget, Paperwork Reductions Project (1024-0018), Washington, DC 20503.

United States Department of the Interior
National Park Service

NATIONAL REGISTER OF HISTORIC PLACES
CONTINUATION SHEET

Tonawanda (25th Separate Company) Armory
Tonawanda, Erie County

Section 7, Description, page 1

Description

The Tonawanda (25th Separate Company) Armory, a brick and stone, castellated style edifice built in 1896, is located on the northeast corner of the intersection of Delaware and Benton Streets in the north-central section of the city. The surrounding neighborhood consists of scattered dwellings and modern commercial properties. The armory occupies nearly all of its relatively flat, 150' x 200' corner lot. A narrow lawn bordered by concrete sidewalks spans the front (west) of the armory along Delaware Street and a narrow parking lot, enclosed by a chain link fence with barbed wire, spans the south elevation of the building along Benton Street.

The armory consists of a two-story, hip-roofed administration building with an attached one and one-half story, gable-roofed drill shed. (All roofs are covered with modern asphalt shingles.) Both sections are of load-bearing red brick walls built upon a raised and battered foundation of roughly hewn, random-laid Warsaw blue granite. Fenestration throughout the building is generally regular; openings, both round-arched and flat-arched, occur singly or in groups of two or three, and contain one-over-one, double-hung sash.

The slightly asymmetrical, L-shaped administration building consists of a rectangular main block flanked by a five-story octagonal tower and a two-story round tower; a shallow, two-story ell extends northward from the northeast (rear) corner of the main block. The center three bays of the main block are arcaded, forming a two-tier front porch. The arches consist of massive, roughly hewn granite voussoirs resting on brick piers. The first-story porch remains open, but the second-story porch has been enclosed with glass panels. Three massive stone transoms between the upper and lower tiers bear the identification "25th SEP. CO. NGNY" in high relief block letters. A large, gable-roofed cross gable with four tall, narrow, round-arched windows crowns the main block.

The five-story octagonal engaged tower at the southwest corner of the main block features a raised basement and first story built of battered, random ashlar walls; the upper four stories are of brick. Rectangular and round-arched openings, most of which

United States Department of the Interior
National Park Service

NATIONAL REGISTER OF HISTORIC PLACES
CONTINUATION SHEET

Tonawanda (25th Separate Company) Armory
Tonawanda, Erie County

Section 7, Description, page 2

contain double-hung sash surrounded by brick and/or stone trim, are found in the tower's basement, first, second, third and fourth stories, while the fifth story features small, paired, round-arched windows, roughly hewn stone beltcourses, a molded cornice and a bricked-in parapet. The two-story engaged round tower at the northwest corner of the main block also features double-hung sash windows with stone and/or brick trim. The tower is surmounted by a low-pitched, conical roof.

The north and south elevations of the main block feature paired, double-hung sash; first-story windows are rectangular and have flat-arched stone lintels; second-story windows are round-arched and have brick trim. The south elevation is further distinguished by a large, hip-roofed dormer with three tall, narrow, round-arched windows. A two-story round tower with a conical roof is engaged in the southeast (rear) corner of the main block. A two-story, hip-roofed ell projects northward from the northeast (rear) corner of the main block, giving the administration building an L-shaped configuration. A narrow, four-story, round tower is attached to the northwest (front) corner of this ell.

The eight-bay-deep drill shed is divided by brick and granite buttresses with granite caps. Each bay contains a group of three tall, narrow, round-arched windows with brick trim. The two eastern (rear) bays on the south elevation are distinguished by a two and one-half story, engaged half-octagonal tower. This tower features tripartite, round-arched second-story windows, paired, rectangular attic windows, a granite beltcourse, and a corbelled brick cornice.

The rear (east) elevation of the drill shed features a centrally placed brick exterior chimney flanked by two sets of three tall, narrow, round-arched windows with brick trim.

The interior survives with a relatively high degree of integrity of design, materials and craftsmanship. Most room configurations survive intact, although some spaces have been subdivided with modern partitions. Notable features in the administration building include the original oak staircase, several elegant oak and tile mantels, white oak wainscoting, pressed metal ceilings with decorative cove moldings, and a variety of historic furnishings. The spindle frieze in the archway between the

United States Department of the Interior
National Park Service

NATIONAL REGISTER OF HISTORIC PLACES
CONTINUATION SHEET

Tonawanda (25th Separate Company) Armory
Tonawanda, Erie County

Section 7, Description, page 3

officers' meeting room and the office in the corner tower room is particularly noteworthy and resembles the spindle frieze seen in the Amsterdam Armory. The drill shed features a quartered oak floor and a wainscoted ceiling. Original lockers are located in the rear balcony, although the space beneath the balcony has been partitioned off into storage/office space. The front balcony, with its original panelled balustrade, survives intact.

A large, modern garage is located behind the armory. This one-story, flat-roofed building is non-contributing.

United States Department of the Interior
National Park Service

NATIONAL REGISTER OF HISTORIC PLACES
CONTINUATION SHEET

Tonawanda (25th Separate Company) Armory
Tonawanda, Erie County

Section 8, Significance, page 1

Statement of Significance

The Tonawanda (25th Separate Company) Armory, completed in 1896, is architecturally and historically significant as a remarkably intact, representative example of a late nineteenth century armory built to house a local unit of the New York State Army National Guard. Designed by State Architect Isaac Perry for the 25th Separate Company, the armory retains a high degree of integrity of design, materials, craftsmanship, feeling and association and embodies the three distinctive characteristics of the property type as discussed at length in the Multiple Property Documentation Form Army National Guard Armories in New York State (Section E: Historic Overview). First, it serves not only as a military facility and social club for the National Guardsmen, but also as a civic monument designed to symbolize governmental strength and presence within a community and to inspire fear, awe, pride and patriotism; second, in form and plan, it consists of an administration building with an attached drill shed at ground level; third, in design and decoration, it reflects the influence of medieval military architecture. The armory is also historically significant for its association with National Guard, an integral component of the American military system.

The armory was built in 1895, shortly after the formation of the 25th Separate Company. Initial construction attempts were thwarted by the discovery of quicksand on the site: the first foundation and a portion of the first south wall sank after the first day's work. Consequently, the entire armory rests on piles.

Typical of armories designed by State Architect Isaac Perry in upstate New York during the late nineteenth century, the Tonawanda Armory is a fortress-like, castellated style edifice designed to inspire fear and awe among the so-called "dangerous lower classes" (i.e., Anarchists, Socialists and Communists as well as most immigrants and laborers) and pride and patriotism among the law-abiding middle and upper classes. Like all other Perry-designed armories, the Tonawanda Armory reflects the influence of medieval military architecture and the Richardsonian Romanesque style, including bold, massive proportions, polychrome brick and stone masonry construction, a raised and battered stone foundation, soaring four- and five-story towers (originally with crenelated parapets), and massive, stone trimmed arcading.

United States Department of the Interior
National Park Service

NATIONAL REGISTER OF HISTORIC PLACES
CONTINUATION SHEET

Tonawanda (25th Separate Company) Armory
Tonawanda, Erie County

Section 8, Significance, page 2

The Tonawanda Armory is one of nearly twenty extant armories attributed to Perry. (According to currently available information, as many as forty armories are believed to have been designed [or overseen] by Perry.) The Tonawanda Armory is typical of Perry's designs for relatively prosperous mid-sized communities: although not as grand as Perry's armories in the major cities of Brooklyn and Buffalo, it is far grander than his designs for armories in smaller communities such as Hoosick Falls or Mohawk. Examples of armories nearly identical to the Tonawanda Armory are found in Hornell, Glens Falls, Whitehall, Hudson and Ogdensburg. (The Hornell and Glens Falls armories are already listed in the National Register and the other three were determined eligible in May 1993. See Section E [Historic Overview] of the MPDF for further discussion of Perry.)

The Tonawanda Armory is also historically significant under criterion A for its association with American military history in general and Army National Guard history in particular. The history of the National Guard (and the significance of its related armories) is discussed at length in Section E (Historic Overview) of the Multiple Property Documentation Form for Army National Guard Armories in New York State. In summary, the volunteer militia (i.e., the National Guard) has been, and to a large extent still is, the backbone of the American military system since the Colonial era. The Tonawanda Armory, like virtually all other National Guard armories, remains a prominent visual reminder of and monument to the pivotal role played by the volunteer militia in American military history.

Still in use (as of August 1993) as an active military facility, the highly intact Tonawanda Armory remains an imposing civic monument and important local landmark in the city, recalling the long and distinguished history of the New York National Guard.

United States Department of the Interior
National Park Service

NATIONAL REGISTER OF HISTORIC PLACES
CONTINUATION SHEET

Tonawanda (25th Separate Company) Armory
Tonawanda, Erie County

Section 9, Bibliography, page 1

Major Bibliographical References

Albany, New York. Division for Historic Preservation. Research files.

Fogelson, Robert M. America's Armories: Architecture, Society and Public Order. Boston: President and Fellows of Harvard College, 1989.

Haynes, Wesley. "Isaac G. Perry," M.A. Thesis, Columbia University, 1983.

Wright, Capt. Robert K., and Hylton-Greene, Renee. A Brief History of the Militia and the National Guard. Washington, D.C.: 1986.

Tonawanda 1:50

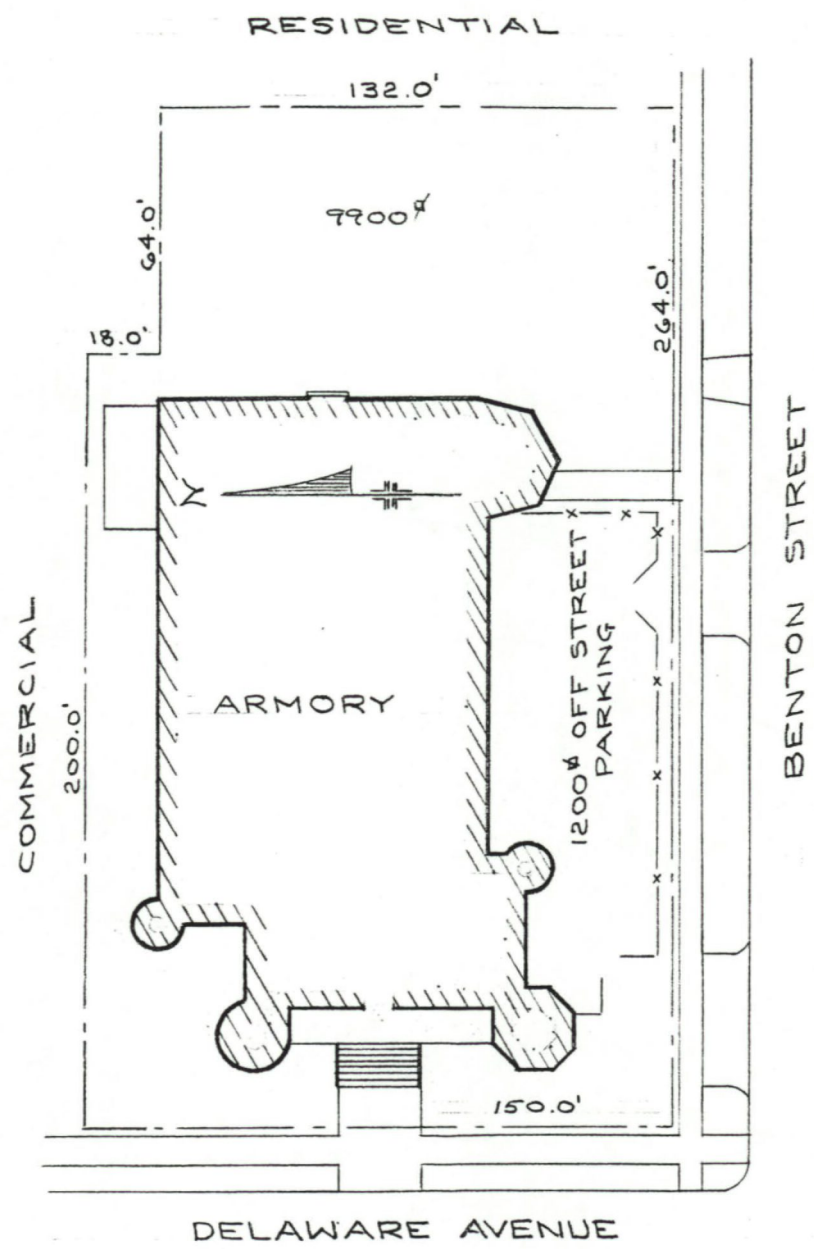

Tonawanda (25th Separate Company) Armory
Tonawanda, Erie County, New York

Plot plan, 1"=50'

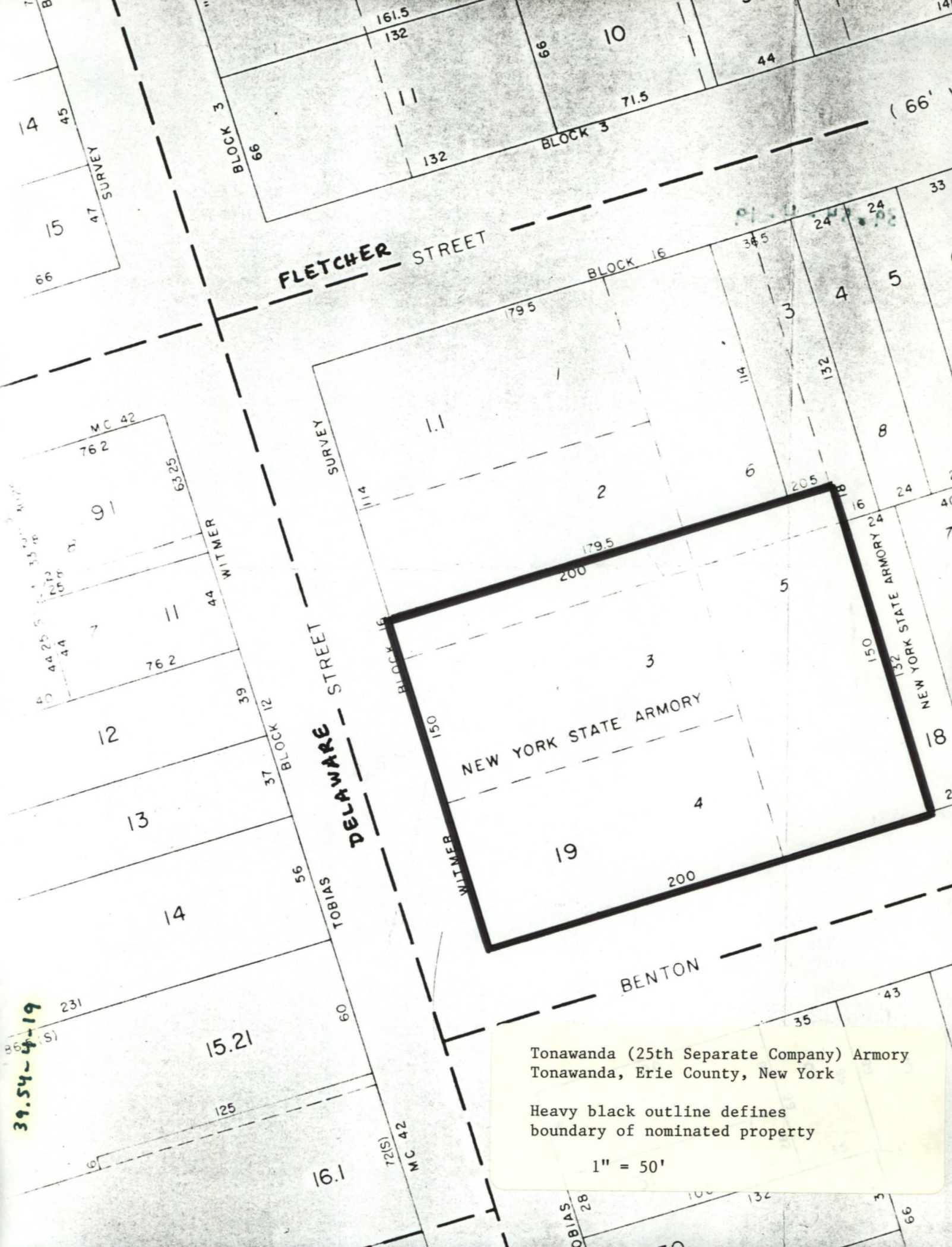

39.54-4-19

FLETCHER STREET

DELAWARE STREET

BENTON

NEW YORK STATE ARMORY

Tonawanda (25th Separate Company) Armory
Tonawanda, Erie County, New York

Heavy black outline defines
boundary of nominated property

1" = 50'

39.54 - 4 - 19



39.54 - 4 - 19

**United States Department of the Interior
National Park Service**

**National Register of Historic Places
Continuation Sheet**

Section number _____ Page _____

Army National Guard Armories in New York State MPS
NEW YORK

Date Listed

COVER

1/28/94

93001537 369th Regiment Armory

1/28/94

93001538 69th Regiment Armory

1/28/94

93001536 New Scotland Avenue (Troop B) Armory

1/28/94

93001539 Tonawanda (25th Separate Company) Armory

1/28/94

UNITED STATES DEPARTMENT OF THE INTERIOR
NATIONAL PARK SERVICE

NATIONAL REGISTER OF HISTORIC PLACES
EVALUATION/RETURN SHEET

REQUESTED ACTION: NOMINATION

PROPERTY NAME: Tonawanda (25th Separate Company) Armory

MULTIPLE NAME: Army National Guard Armories in New York State MPS

STATE & COUNTY: NEW YORK, Erie

DATE RECEIVED: 12/16/93 DATE OF PENDING LIST: 12/28/93
DATE OF 16TH DAY: 1/13/94 DATE OF 45TH DAY: 1/30/94
DATE OF WEEKLY LIST:

REFERENCE NUMBER: 93001539

NOMINATOR: STATE

REASONS FOR REVIEW:

APPEAL: N DATA PROBLEM: N LANDSCAPE: N LESS THAN 50 YEARS: N
OTHER: N PDIL: N PERIOD: N PROGRAM UNAPPROVED: N
REQUEST: N SAMPLE: N SLR DRAFT: N NATIONAL: N

COMMENT WAIVER: N

ACCEPT RETURN REJECT 1/28/94 DATE

ABSTRACT/SUMMARY COMMENTS:

One of 20 extant armories designed by State architect Isaac Perry, the Tonawanda Armory exemplifies the fortress-like late 19th-century Perry armory prototype.

RECOM./CRITERIA Accept atc
REVIEWER Javase
DISCIPLINE Architectural History
DATE 1-28-94

DOCUMENTATION see attached comments Y N see attached SLR Y N

CLASSIFICATION

count resource type

STATE/FEDERAL AGENCY CERTIFICATION

FUNCTION

historic current

DESCRIPTION

architectural classification
 materials
 descriptive text

SIGNIFICANCE

Period Areas of Significance--Check and justify below

Specific dates Builder/Architect
Statement of Significance (in one paragraph)

summary paragraph
 completeness
 clarity
 applicable criteria
 justification of areas checked
 relating significance to the resource
 context
 relationship of integrity to significance
 justification of exception
 other

BIBLIOGRAPHY

GEOGRAPHICAL DATA

acreage verbal boundary description
 UTMs boundary justification

ACCOMPANYING DOCUMENTATION/PRESENTATION

sketch maps USGS maps photographs presentation

OTHER COMMENTS

Questions concerning this nomination may be directed to

_____ Phone _____

Signed _____ Date _____



Tonawanda (25th Separate Co.) Armory

Tonawanda, Erie Co.

Photo: Historical Society of the Tonawandas, 1992

Neg: OPRHP, Albany

View ①:

front (west) and north elevations



~~Wawona~~ ~~Wawona~~ ~~Wawona~~ ~~Wawona~~ ~~Wawona~~ ~~Wawona~~ ~~Wawona~~ ~~Wawona~~ ~~Wawona~~ ~~Wawona~~

Tonawanda (25th Separate Co.) Armory

Tonawanda, Erie Co.

Photo: Historical Society of the Tonawandas, 1992

Neg: OPRHP, Albany

② View: Front (west) and south elevations



Tonawanda (25th Separate Co.) Armory

Tonawanda, Erie Co.

~~Photo~~ Neg: OPRHP

Photo: ~~Wings~~ Historical Society of the Tonawandas, 1992

View (3) : south and east (rear) elevations



Tonawanda (25th Separate Co.) Armory

Tonawanda, Erie Co.

NEG: ~~PRH11111~~ OPRHP, Albany

Photo: ~~many~~ Historical Society of the Tonawandas
1992

View (4): Turned and scroll-sawn woodwork
~~Turned and scroll-sawn woodwork~~



Tonawanda (25th Separate Co.) Armory

Tonawanda, Erie Co.

Neg: ~~Amidon~~ OPRHP

Photo: ~~Amidon~~ Historical Society of the Tonawandas
1992

View ⑤: mantelpiece



Tonawanda (25th Separate Co.) Armory
Tonawanda, Erie Co.

Neg: ~~W.H.H.~~: OPRHP, Albany

Photo: ~~W.H.H.~~ Historical Society of the Tonawanda, '92

View (6): Front (west) end of drill shed

NEW YORK STATE
DEPARTMENT OF TRANSPORTATION



TONAWANDA EAST QUADRANGLE
NEW YORK
7.5 MINUTE SERIES

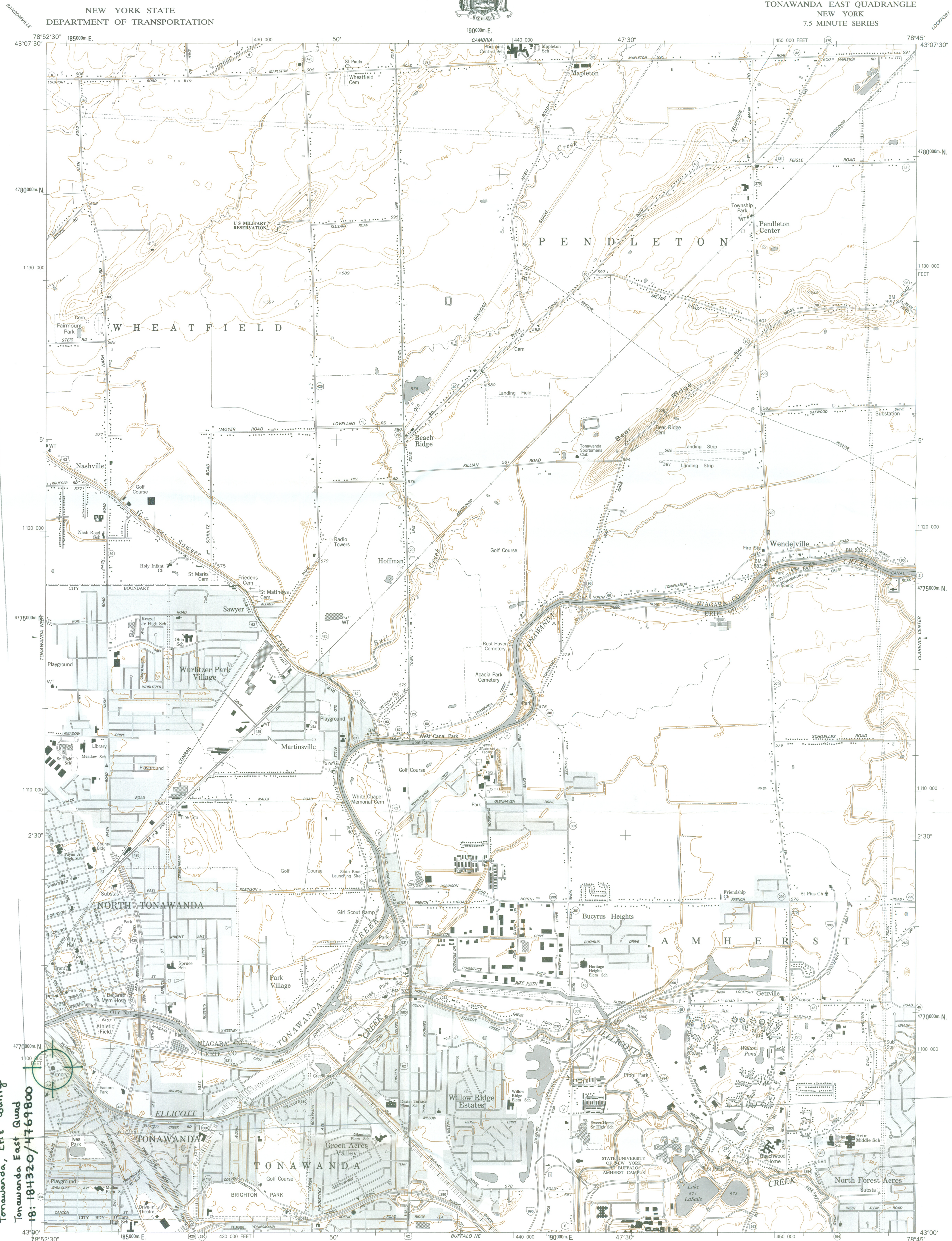

Tonawanda (25^m Separate Co.) Armory
Tonawanda, Erie County
18-18432-0/H16980

Published in 1988 by the New York State Department of Transportation, in cooperation with the U.S. Department of Transportation, Federal Highway Administration.

Map base from 1980 U.S. Geological Survey 7.5-minute quadrangle.
Map revisions made using aerial photography dated 1985, construction plans, official records and other sources. Features revised include: highways and other transportation facilities; civil boundaries; recreation sites; hydrography; and buildings. Gray tint indicates developed areas in which only landmark buildings are shown. Darker gray tint indicates open water features.

Revisions may not comply with National Map Accuracy Standards.
Correspondence concerning this and other maps of the Department of Transportation should be directed to: Map Information Unit, New York State Department of Transportation, State Campus, Albany, New York 12232.

Revisions by B. Mathenia



QUADRANGLE LOCATION

SCALE 1:24 000

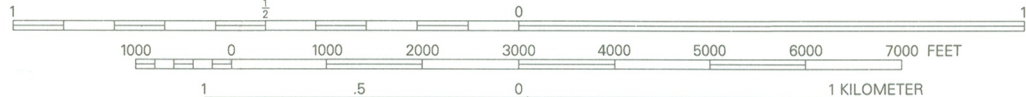

Polyconic projection, 1927 North American datum.

1000-meter ticks based on the New York Transverse Mercator grid.
Between 72° and 78° West Longitude, this grid is identical to Zone 18 of the Universal Transverse Mercator grid. Areas east of 72° and west of 78° are direct mathematical extensions of Zone 18.

10,000-foot ticks based on the New York State Plane Coordinate System, West Zone.

Magnetic declination for 1988 is approximately 10° West

INDEX TO
1:9600 (1"=800')
MAP COVERAGE

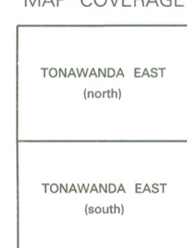

BOUNDARIES:

State
County
Town or City
Incorporated Village

ROADS:

Touring Route Markers:
Interstate
U.S.
State
State Highway number and limit
County road
Interchange number

Divided:
Wide mail
Narrow mail or barrier

Undivided:
4 or more lanes
Less than 4 lanes

Vehicle track; trail