

1551
RECEIVED
JUL 23 1990
NATIONAL REGISTER

BUILDING STRUCTURE INVENTORY FORM

USN:

NYS OFFICE OF PARKS, RECREATION
& HISTORIC PRESERVATION
DIVISION FOR HISTORIC PRESERVATION
(518) 474-0479

YOUR NAME: Tania Werbizky DATE: May 1990
YOUR ADDRESS: Ithaca, NY TELEPHONE: 607-277-5879
ORGANIZATION (if any): St. Lawrence-Eastern Ontario Commission

IDENTIFICATION

1. BUILDING NAME(S): Chaumont Grange Hall & Dairymen's League Building
Component #6
2. COUNTY: Jefferson TOWN Lyme VILLAGE Chaumont
3. STREET LOCATION: Main Street
4. OWNERSHIP: a. public b. private
5. PRESENT OWNER: Mr. John Logan ADDRESS: PO Box 76, 3 Mile Bay, NY
6. USE: Original: Grange Hall Present: Grange hall
7. ACCESSIBILITY TO PUBLIC: Exterior visible from public road: Yes No
Interior accessible: Explain No, private prop.

DESCRIPTION

8. BUILDING MATERIAL: a. clapboard b. stone c. brick d. board and batten
e. cobblestone f. shingle g. stucco other: metal siding
9. STRUCTURAL SYSTEM: (if known) a. wood frame with interlocking joints
b. wood frame with light members
c. masonry load bearing walls
d. metal (explain) _____
e. other _____
10. CONDITION: a. excellent b. good c. fair d. deteriorated
11. INTEGRITY: a. original site b. moved if so, when 1935, same lot
c. list major alterations and dates (if known): _____
See attached item #18
12. PHOTO: See attached
13. MAP: See attached

14. THREATS TO BUILDING: a. none known X b. zoning__ c. roads__
 d. developers__ e. deterioration__
 f. other_____
15. RELATED OUTBUILDINGS AND PROPERTY:
 a. barn__ b. carriage house__ c. garage__
 d. privy__ e. shed__ f. greenhouse__
 g. shop__ h. gardens__
 i. landscape features:_____
16. SURROUNDINGS OF THE BUILDING (check more than one if necessary)
 a. open land X b. woodland__
 c. scattered buildings__
 d. densely built-up__ e. commercial X
 f. industrial__ g. residential X
 h. other_____
17. INTERRELATIONSHIP OF BUILDING AND SURROUNDINGS:
 (indicate if building or structure is in an historic district)

See attached continuation sheets

18. OTHER NOTABLE FEATURES OF THE BUILDING AND SITE:
 (include interior features if known)

See attached continuation sheets

SIGNIFICANCE

19. DATE OF CONSTRUCTION: 1898

ARCHITECT: unknown

BUILDER: unknown

20. HISTORICAL AND ARCHITECTURAL IMPORTANCE:

See attached continuation sheets

21. SOURCES: See cover document, Bibliography, Item 9

22. THEME/AREA(S) OF SIGNIFICANCE: Architecture

CRITERIA: A, C

LEVEL OF SIGNIFICANCE: a. local X b. state__ c. national__

Continuation Sheet

Town of Lyme Multiple Resource Area
Lyme, Jefferson County, New York

Chaumont Grange Hall & Dairymen's League Building

17. The Chaumont Grange Hall & Dairymen's League Building is situated south of Main Street (State Route 12E) near the east bank of Horse Creek in the village of Chaumont, in the eastern part of the town of Lyme. Included in the nomination is a parcel of less than one acre of land historically associated with the property.

The building once stood directly on the bank of Horse Creek, on the site of a large nineteenth-century sawmill. After a 1935 flood washed away much of its limestone foundation, the building was moved to its present site some 40 feet to the east. It now rests on a level lot some 150 feet back from Main Street, facing north at a slight angle to a gravelled parking area and a small yard. Further north, beyond the modern bridge which carries Main Street across Horse Creek, is the Lyme Free Library, housed in a much altered 1830s farmhouse. Thick vegetation lines both banks of Horse Creek and screens the backs of buildings along Mill Street to the west and Horse Shoe Cove and Sawmill Bay to the south. On the adjoining lot to the east is a large house and horse barn, which is of the same approximate age as the grange building but which has been significantly altered.

Due to structural alterations and modern intrusions, the neighborhood has no historic district potential.

Contributing buildings: 1

18. The Chaumont Grange Hall & Dairymen's League Building is a two and one-half story, three-by-four-bay gable-front building, resting on a foundation consisting of a dry-mortar wall of limestone blocks under the west wall and freestanding concrete blocks under the two corners to the east. Its light wood frame is covered in wide horizontal planks and sheathed in turn with galvanized metal siding, stamped to simulate wood clapboards. Typical windows are two-over-two double-hung sash, with some missing or deteriorated sash replaced in 1987 by fixed four-light storm windows, original to the building. Typical doors are six-panelled, with three long over three short vertical panels. The medium-pitch gabled roof is covered in standing-seam metal.

The principal (north) facade of the building features an enclosed exterior stairway covering its eastern half, with a single window and flat roof at the top. To the right of this staircase are two other single windows, one on each floor. A wooden sign in the gable peak bearing the name "Chaumont Grange No. 855" was removed in 1987 as the building was being painted.

The east elevation constitutes a secondary facade for the building and originally played a more active role in its related activities. To the right is the single entrance door to the exterior staircase, while at each end of the four-bay elevation are single windows. The second bay, now blind, once featured a covered porch and a large opening through which milk

Continuation Sheet

Town of Lyme Multiple Resource Area
Lyme, Jefferson County, New York

Chaumont Grange Hall & Dairymen's League Building

and other dairy products were delivered into and marketed from the building. The opening was sealed after 1922 and the porch removed in 1935. In the third bay is the single entrance door to the ground floor. Since the building's move in 1935, its wooden steps have not been replaced and the door is not in general use. On the second floor above are four evenly spaced single windows. On the west elevation facing Horse Creek are four other single windows on each floor, while the south elevation, which once backed onto Horse Shoe Cove, features two single windows to a floor, flanking a blind central bay. The brick chimney which once rose from the south gable peak is no longer extant.

The building is entered through the single door on the exterior staircase, formerly used by members of the Grange and their guests. To the left of a small vestibule is a door to the ground floor, which consists of an open room divided down the center by a row of four square wood posts. Walls and ceiling are sheathed in plain horizontal planks painted in shades of green. Framing evidence on the south wall indicates the size of the former opening through which dairy products were passed. In the northwest corner of the room is a one-hole privy enclosed in walls of beaded tongue-and-groove boards, altered at an unknown date and restored in 1987 to its original configurations.

The exterior straight-run staircase leads up to a small landing and to the second floor meeting hall, also an open space but of higher architectural finish than the ground floor. Walls and ceiling are sheathed entirely in matchstick tongue-and-groove beaded boards, laid horizontally above a vertical wainscot and retaining their original varnish. Like other meeting halls in Lyme, the room is illuminated by three windows along each side and two more on the far wall. The ceiling is elevated into part of the attic space for better ventilation and acoustics, producing angled configurations between wall and ceiling. At the south end of the hall is a raised stage with a hand-painted backdrop depicting an agricultural panorama. An ornate wood-burning stove and a cast-iron gaslight fixture survive in place. In the northeast corner of the hall is a small enclosed kitchen, also with matchstick panelling and a single window but with no plumbing.

20. The Chaumont Grange Hall and Dairymen's League Building (c. 1898) is architecturally significant as an intact representative example of grange hall/meeting hall plan and design in the town of Lyme. Largely intact on the exterior and interior, the building exhibits characteristic features of traditional grange/meeting hall design, including two-story three-by-five bay elongated plan, large open space and a privy on the first story and a meeting hall on the second. It is unusual as a dual purpose community building, constructed in 1898 by the local Dairymen's League and leased and later owned by the Chaumont Grange, attesting to the common purpose and important role of the two organizations in the improvement of farming practices and marketing dairy products from the rural North Country

Continuation Sheet

Town of Lyme Multiple Resource Area
Lyme, Jefferson County, New York

Chaumont Grange Hall & Dairymen's League Building

community. The building exemplifies the traditional rural grange hall, developed nationally after the Civil War, in its form, plan and interior finishes but with several modifications, most notably the lack of a first story kitchen, due to its partial original use as the organizational and marketing base of the local Dairymen's League.

The National Grange system, or the "Order of the Patrons of Husbandry," was organized in 1867 specifically to restore agricultural conditions in the devastated South and, in general, State, to promote rural welfare throughout the country. In 1873 the New York State Grange was organized, with a more specific goal of uniting New York farmers against the major railroads, which were charging excessive freight costs in their fierce competition to ship Western goods to Eastern markets. In 1874 more than one hundred local granges were established throughout the State, including State Grange No. 126 at Three Mile Bay (see Three Mile Bay Historic District, Component #12). Its grange hall of c. 1874 was to set a precedent for later grange and community halls in Lyme.

By the 1890s the New York Grange system was at the height of its popularity. Not only did it provide a channel through which farmers could help control agriculture-related legislation and promote better rural education, but the grange hall served as the center of community life. Virtually everyone in the community belonged to at least one of the organizations which met in the hall, and virtually everyone attended the many lectures, plays, dinners and dances that were held there. In 1898, during the hay boom engendered by the New York City market, two new granges were organized in Lyme: Point Peninsula Grange (No. 1030) in 1905, and Chaumont Grange (No. 855) in 1898, with local farmers J.D. Warner as its first master and Dempster Wheeler as secretary.

In the same year the Chaumont Dairymen's League was established, closely following that of the Five States Milk Producers Association, the first organization of dairymen in New York State. The object of the league was much like that of the grange in the 1870s: to control the price of goods by controlling its delivery to the consumer. With this basic goal in common, the Dairymen's League and the Chaumont Grange joined forces to build a common facility, with the building owned by the league and the upper meeting hall leased to the grange.

The Chaumont Grange Hall and Dairymen's League Building followed the basic pattern for local grange and community halls of the period. The ground floor space was plainly detailed and utilitarian in purpose, in this case serving as a clearinghouse for the products of the league-owned farm on Morris Tract Road some miles away. Milk, butter, and cheese were marketed directly from the building to wholesale and retail customers, thus eliminating the middleman. The upstairs meeting hall also resembled other examples in Lyme, with its elevated ceiling, raised stage, kitchen facilities, and matchstick board panelling (see Three Mile Bay Historic District, Component #12, and Union Hall, Component #22); its hand-painted

Continuation Sheet

Town of Lyme Multiple Resource Area
Lyme, Jefferson County, New York

Chaumont Grange Hall & Dairymen's League Building

backdrop, however, is unique and indicates the popularity of the dramatic productions sponsored by the grange. Another distinguishing feature of the building is its galvanized metal siding. As one of three metal-clad buildings constructed in Chaumont following the great fire of 1897, it used standard stock-item sheets, stamped to simulate clapboards. The other two buildings, the George Brothers Building (Component #5) and the Masonic Hall (Chaumont Historic District, #3) featured components possibly ordered from a national builder's catalogue.

After World War I, the costs of pasteurization and other sanitation-related requirements forced many small dairy farmers in Lyme out of business, and the Dairymen's League disbanded in 1922. At that time the Chaumont Grange purchased and continued to use the building, though it and other granges throughout the state also suffered from modern technology. By the 1940s the pressures of mechanization had brought an end to the small farm in Lyme; agriculture became a large-scale activity, requiring fewer farms and fewer farmers. Too, modern means of communication had made obsolete many of the traditional roles of the grange. Like many others throughout the state, Grange No. 855 disbanded soon after World War II.

The building stood vacant and unused until 1987, when it was purchased by John Logan, noted North Country author, who has undertaken its rehabilitation for use as a museum while preserving its historic features.

United States Department of the Interior
National Park Service

7/23/90

National Register of Historic Places
Continuation Sheet

Section number _____ Page _____

Lyme MRA

Jefferson County, NEW YORK

COVER	Substantive Review	DATE LISTED
1. Angell Farm	<i>Both L. Sarge</i> 9-6-90	Determined Eligible <i>9-6-90</i>
2. Cedar Grove Cemetery	Substantive Review DOE/OWNER OBJECTION	<i>Eligible Both L. Sarge</i>
3. Chaumont Grange Hall and Dairyman's League Building	Entered in the National Register	<i>Helene Byer 9/6/90</i>
4. Chaumont Historic District	Entered in the National Register	<i>Helene Byer 9/6/90</i>
5. Chaumont House	Entered in the National Register	<i>Helene Byer 9/6/90</i>
6. Chaumont Railroad Station	Entered in the National Register	<i>Helene Byer 9/6/90</i>
7. District School No. 3	Entered in the National Register	<i>Helene Byer 9/6/90</i>
8. Evans--Gaige--Dillenback House	Entered in the National Register	<i>Helene Byer 9/6/90</i>
9. George Brothers Building	Entered in the National Register	<i>Helene Byer 9/6/90</i>
10. George House	Entered in the National Register	<i>Helene Byer 9/6/90</i>
11. Getman Farmhouse	Substantive Review	<i>Both L. Sarge 9-6-90</i>
12. Lance Farm	Entered in the National Register	<i>Helene Byer 9/6/90</i>
13. Point Salubrious Historic District	Entered in the National Register	<i>Helene Byer 9/6/90</i>
14. The Row	Entered in the National Register	<i>Helene Byer 9/6/90</i>
15. Old Stone Shop	Entered in the National Register	<i>Helene Byer 9/6/90</i>
16. Taft House	Entered in the National Register	<i>Helene Byer 9/6/90</i>

UNITED STATES DEPARTMENT OF THE INTERIOR
NATIONAL PARK SERVICE

NATIONAL REGISTER OF HISTORIC PLACES
EVALUATION/RETURN SHEET

REQUESTED ACTION: NOMINATION

PROPERTY NAME: Chaumont Grange Hall and Dairymen's League Building

MULTIPLE NAME: Lyme MRA

STATE & COUNTY: NEW YORK, Jefferson

DATE RECEIVED: 7/23/90 DATE OF PENDING LIST: 8/07/90
DATE OF 16TH DAY: 8/23/90 DATE OF 45TH DAY: 9/06/90
DATE OF WEEKLY LIST:

REFERENCE NUMBER: 90001337

NOMINATOR: STATE

REASONS FOR REVIEW:

APPEAL: N DATA PROBLEM: N LANDSCAPE: N LESS THAN 50 YEARS: N
OTHER: N PDIL: N PERIOD: N PROGRAM UNAPPROVED: N
REQUEST: N SAMPLE: N SLR DRAFT: N NATIONAL: N

COMMENT WAIVER: N

ACCEPT RETURN REJECT 9/6/90 DATE

Entered in the
National Register

ABSTRACT/SUMMARY COMMENTS:

RECOM./CRITERIA _____
REVIEWER _____
DISCIPLINE _____
DATE _____

DOCUMENTATION see attached comments Y/N see attached SLR Y/N

CLASSIFICATION

___count ___resource type

STATE/FEDERAL AGENCY CERTIFICATION

FUNCTION

___historic ___current

DESCRIPTION

___architectural classification
___materials
___descriptive text

SIGNIFICANCE

Period Areas of Significance--Check and justify below

Specific dates Builder/Architect
Statement of Significance (in one paragraph)

___summary paragraph
___completeness
___clarity
___applicable criteria
___justification of areas checked
___relating significance to the resource
___context
___relationship of integrity to significance
___justification of exception
___other

BIBLIOGRAPHY

GEOGRAPHICAL DATA

___acreage ___verbal boundary description
___UTMs ___boundary justification

ACCOMPANYING DOCUMENTATION/PRESENTATION

___sketch maps ___USGS maps ___photographs ___presentation

OTHER COMMENTS

Questions concerning this nomination may be directed to

_____ Phone _____

Signed _____ Date _____



JMN900034-MNMF1

Town of Lyme Multiple Resource Area
Point Salubrious Historic District

Chaumont Grange

Lyme, Jefferson County, New York

Photo By: T. Werbizky, 1988

Neg. at: Preservation League of NY State
Albany, NY

View: 1 : *North Facade*



JRN900034 NFNF1

Town of Lyme Multiple Resource Area

Chaumont Grange hall

Chaumont, Jefferson County, New York

Photo by: T. Werbizky, 1988

Neg. at: Preservation League of NY State
Albany, NY

View: *2 : INTERIOR*



JRN900034 NNNE1

Town of Lyme Multiple Resource Area

Chaumont Grange hall

Chaumont, Jefferson County, New York

Photo by: T. Werbizky, 1988



Neg. at: Preservation League of NY State
Albany, NY

View: *3* : *Interior*

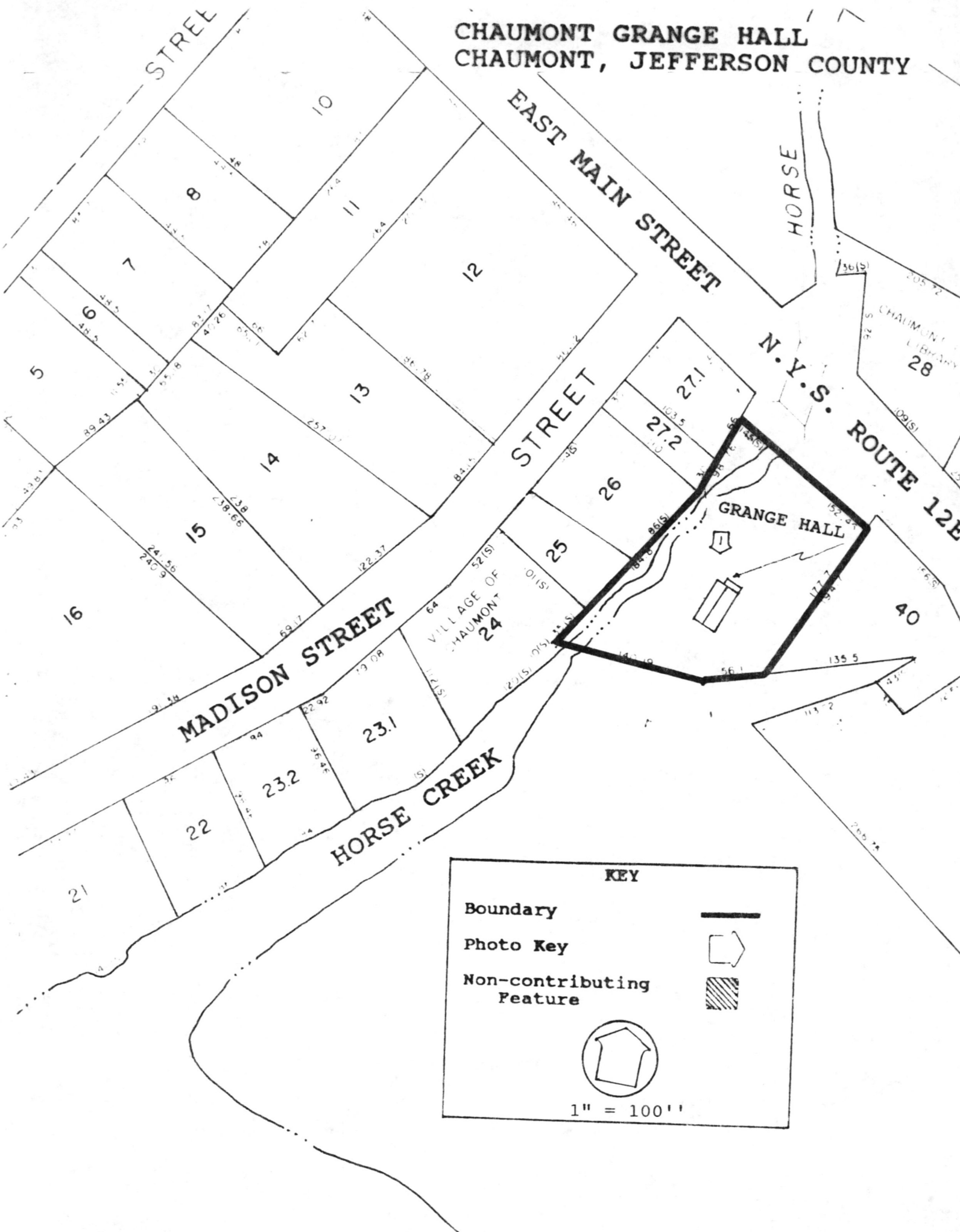
CHAUMONT GRANGE HALL
 CHAUMONT, JEFFERSON COUNTY



KEY

- Boundary 
- Photo Key 
- Non-contributing Feature 



1" = 100'

Chaumont Quadrangle
Scale 1:24,000
Zone 18

Chaumont Grange Hall & Dairymen's League Building
Component #6
18/409590/4879520

