

UNITED STATES DEPARTMENT OF THE INTERIOR
 NATIONAL PARK SERVICE
 NATIONAL REGISTER OF HISTORIC PLACES
 REGISTRATION FORM

OMB NO. 1024-0018, NPS FORM

1947
 OCT 10 1989

NATIONAL REGISTER

This form is for use in nominating or requesting determinations of eligibility for individual properties or districts. See instructions in Guidelines for Completing National Register Forms (National Register Bulletin 16). Complete each item by marking "x" in the appropriate box or by entering the requested information. If an item does not apply to the property being documented, enter "N/A" for "not applicable." For functions, styles, materials, and areas of significance, enter only the categories and subcategories listed in the instructions. For additional space use continuation sheets. Type all entries.

1. Name of Property

historic name East Bloomfield Historic District
 other names/site number _____

2. Location

street & number State, Main, South & Park Streets | | not for publication
 city, town East Bloomfield | | vicinity
 state New York code NY county Ontario code 069 zip code 14443

3. Classification

Ownership of property	Category	Number of resources within property	
		Contributing	Noncontributing
<input checked="" type="checkbox"/> private	<input type="checkbox"/> building(s)	79	11 buildings
<input checked="" type="checkbox"/> public-local	<input checked="" type="checkbox"/> district	2	_____ sites
<input type="checkbox"/> public-State	<input type="checkbox"/> site	3	_____ structures
<input type="checkbox"/> public-Federal	<input type="checkbox"/> structure	6	_____ objects
	<input type="checkbox"/> object	90	11 Total

Name of related multiple property listings: na Number of contributing resources previously listed in the National Register na

4. State/Federal Agency Certification

As the designated authority under the National Historic Preservation Act of 1966, as amended, I hereby certify that this nomination request for determination of eligibility meets the documentation standards for registering properties in the National Register of Historic Places and meets the procedural and professional requirements set forth in 36 CFR Part 60. In my opinion, this property meets does not meet the National Register criteria. See continuation sheet.

Signature of certifying official [Signature] Date 9/29/89
 Deputy Commissioner for Historic Preservation
 State or Federal agency and bureau
NYS Office of Parks, Recreation and Historic Preservation

In my opinion, the property meets does not meet the National Register criteria. See continuation sheet.

Signature of commenting or other official _____ Date _____
 State or federal agency and bureau _____

5. National Park Service Certification

I hereby certify that this property is:

- entered in the National Register. See continuation sheet.
- determined eligible for the National Register. see continuation sheet.
- determined not eligible for the National Register.
- removed from the National Register.
- other, (explain:)

Entered in the National Register
[Signature] 11/13/89
 Signature of keeper Date of Action

6. Function or Use

Historic Function
(enter categories from instructions)
domestic: single dwelling, hotel
religion: religious structure
commerce/trade: business
government: town hall, post office
funerary: cemetery
education: school; landscape: park

Current Functions
(enter categories from instructions)
domestic: single dwelling, multiple dwelling
religion: religious structure
commerce/trade: business
culture: museum
funerary: cemetery
landscape: park

7. Description

Architectural Classification
enter categories from instructions)

Federal, Greek Revival, Gothic Re-
vival, Italianate, Queen Anne, Stick/
Eastlake, Colonial Revival

Materials(enter categories from instructions)

foundation stone: limestone, cobblestone
walls wood: weatherboard
brick
roof shingle, asbestos

Describe present and historic physical appearance.

The East Bloomfield Historic District encompasses 49 residential, religious, commercial and civic properties in the historic core of the incorporated village of East Bloomfield. East Bloomfield is a small rural community of approximately three hundred acres, situated twenty miles south-southeast of Rochester and nine miles west of Canandaigua. The village is centered around the intersection of State Route 20C (Main Street) and U.S. Route 20 (State Street) and includes approximately two hundred buildings, a large portion of which were built during the community's heyday in the nineteenth century. Located near the geographic center of the rural agrarian town of East Bloomfield in west-central Ontario County, the village historically was one of two centers of commercial, political, social and religious activity for the surrounding township. The second center was the village of Holcomb, immediately adjacent to and east of East Bloomfield via State Route 20C. Holcomb emerged as a direct result of the advent of rail transportation in the township of East Bloomfield. Currently, Holcomb continues as the primary commercial center of the surrounding agrarian region, while East Bloomfield remains the center of most social, political and religious activity. (Plans are currently underway to conduct reconnaissance and intensive level surveys of Holcomb.) The nominated district, approximately 46 acres in extent, encompasses large portions of both sides of State Street (9-39 and 10-22, inclusive); both sides of South Avenue between State Street (Route 20) and Main Street (2-10 and 5-9); Elton Park; 4, 6 and 8 Park Street; the East Bloomfield Cemetery (Park Street); Pickle Park and the buildings around it (the former Farmers' Co-op, the former Gardner & Child General Store, the East Bloomfield Inn and the Bradley Building at 49, 51, 50-52 and 56-60 Main Street, respectively); and 59, 61, 62, 63, 65, 67, 69 and 75 West Main Street. With the exception of scattered groups of altered older dwellings along both sides of Main Street east of Pickle Park (towards Holcomb), the north side of west Main Street (west of #62) and both sides of South Street south of Route 20, nearly the entire historic core of the village is included in the East Bloomfield Historic District. The district, in general, and numerous individual buildings, in particular, retain remarkably high levels of integrity of design, setting, materials and craftsmanship. There are no intrusions within the district.

Historically, the village of East Bloomfield developed around two foci. The commercial core of the village became centered around the irregular intersection of Main Street and South Avenue (present-day Pickle Park), while religious and institutional development gravitated toward the intersection of South Avenue at State Street (Great Western Turnpike, i.e., Route 20), where a village square had been laid out in 1798. The former intersection retains several important early nineteenth century late Georgian and Federal style commercial buildings, including the former East Bloomfield Inn, the former Farmers' Co-op and Gardner & Child's general store. The intersection has suffered from a variety of incompatible, yet reversible, alterations to its stock of historic buildings; however, enough historic fabric remains at this location to be included within the proposed historic district.

United States Department of the Interior
National Park ServiceNATIONAL REGISTER OF HISTORIC PLACES
CONTINUATION SHEET

Section number 7 Page 2

East Bloomfield Historic District
East Bloomfield, Ontario County, New York

The latter intersection and the area immediately surrounding Elton Park (the village green) both retain a high degree of integrity and many of the village's most prominent historic resources, including two frame churches built in the 1830's with Greek and Gothic Revival style detailing (the First Congregational Church and the United Methodist Church, respectively), the East Bloomfield Academy (a large, three-story Greek Revival style brick civic building completed in 1838), the former Town Hall (a small, Greek Revival style frame building erected ca. 1845), an early cemetery containing outstanding examples of early and mid-nineteenth century funerary art, and a relatively early, large scale Civil War memorial, dedicated in 1868 and located at the center of Elton Park. Prominent early nineteenth century residences are located near both intersections, as well as on isolated locations on Main Street, South Avenue and Howard Avenue outside of the proposed historic district. (These properties beyond the district boundaries are currently being studied.)

Most of these early nineteenth century buildings near the two village foci are typically built of frame or brick construction in the Federal or Greek Revival styles and are generally two-story buildings with three- or five-bay facades. In general, East Bloomfield's early nineteenth century buildings reflect the New England architectural traditions imported by the village's first and second generations. The substantial construction of these buildings and their relative sophistication reflect an early period of affluence in the village on the Great Western Turnpike (Route 20). In general, most of these buildings retain good overall integrity; however, the physical integrity of several structures in the proposed historic district has been compromised by unsympathetic alterations or modern siding.

Examples of mid- to late-nineteenth century residential architecture occur toward the edges of the proposed historic district, particularly along State Street and Main Street. Virtually all of these buildings are built of frame construction. Common architectural styles of this period observed in the village include the Italianate style, often with low pitched roofs, bracketed cornices, and broad porches, and variations of the popular late nineteenth century Stick and Queen Anne styles. Integrity is generally high for the prominent examples of these residential buildings.

United States Department of the Interior
National Park ServiceNATIONAL REGISTER OF HISTORIC PLACES
CONTINUATION SHEET

Section number 7 Page 3

East Bloomfield Historic District
East Bloomfield, Ontario County, New York

The district boundary is drawn to include all of the contiguous, architecturally and/or historically significant resources that retain sufficient physical integrity to meet the National Register criteria. The boundary coincides with the legal lot lines of the village parcels associated with the nominated buildings. The eastern boundary of the district (i.e., beginning with 9 and 10 State Street) is drawn to exclude three modern suburban houses on the south side of State Street. The southern boundary of the district follows the rear property lines of the buildings along the south side of State Street, and excludes the altered older dwellings along both sides of South Street beyond 27 and 29 State Street. The western boundary of the district is drawn to exclude the group of three modern dwellings along the south side of State Street (beyond #39) and the collection of altered older dwellings along the north side of State Street (beyond #22). The boundary extends northwestward to encompass #75 West Main Street and all of the dwellings on the south side of West Main Street. Beyond #75 (further west) is open, undeveloped land, out of keeping with the relatively dense, urban character of the village proper. The boundary is also drawn to exclude the altered, older dwellings along the north side of West Main Street as well as the modern suburban development along Page Street. Both sides of Michigan Avenue, characterized by scattered, extensively altered older buildings and modern intrusions, are also excluded from the district. Main Street, east of the East Bloomfield Hotel and the former Farmers' Co-op, has suffered extensive loss of integrity and is therefore also excluded from the district. The East Bloomfield Fire Station, a modern cinder block building, is located just east of the former inn, providing a sharp visual terminus to the northeast corner of the district. The boundary then extends southeastward to encompass the entire extent of the East Bloomfield Cemetery, at which point it joins the rear property lines of the aforementioned properties at 10 and 12 State Street.

The district was identified as a result of a reconnaissance level survey of the village of East Bloomfield conducted by Virginia Schroeder (of the Historical Society of the Town of East Bloomfield) with additional intensive level survey documentation compiled by New York State Historic Preservation Office staff. During the survey process, five additional resources were identified which appear to meet the National Register criteria and may be nominated in the forthcoming East Bloomfield Multiple Resource Area nomination, pending completion of additional research documentation followed by evaluation against the

United States Department of the Interior
National Park Service

NATIONAL REGISTER OF HISTORIC PLACES
CONTINUATION SHEET

Section number 7 Page 4

East Bloomfield Historic District
East Bloomfield, Ontario County, New York

National Register criteria. Briefly, the five potentially eligible properties are as follows:

1. Abner Adams House, 2 Howard Avenue

Built ca. 1812, this Federal style brick house appears to satisfy criteria B and C for its association with prominent East Bloomfield community leader, land owner, and entrepreneur Abner Adams, and for its architectural significance as a representative example of early nineteenth century domestic architecture in the village.

2. St. Bridget's R. C. Church Complex, 15-17 Church Street

Built in 1874-75, this brick church appears to satisfy Criterion C as an intact example of Romanesque Revival style ecclesiastical architecture in the village. Additional research and documentation may reveal historical significance under Criterion A. The church property appears to include a contributing cemetery, established ca. 1870, a largely intact early twentieth century rectory and a non-contributing church hall built in 1964.

3. House at 25 Main Street

Believed to date from the 1870s/80, this two-story frame residence appears to satisfy Criterion C as a largely intact and representative example of late nineteenth century picturesque residential architecture combining elements of the Queen Anne and Stick styles.

4. House at 27 Main Street

Believed to have been built in the 1820s, this two-story frame residence appears to satisfy Criterion C as a largely intact and representative example of Federal style residential architecture in East Bloomfield.

5. House at 47 South Street

Believed to date from the 1820s, this two-story brick residence appears to satisfy Criterion C as a largely intact and representative example of Federal style residential architecture in East Bloomfield. Its use of

United States Department of the Interior
National Park Service

NATIONAL REGISTER OF HISTORIC PLACES
CONTINUATION SHEET

Section number 7 Page 5

East Bloomfield Historic District
East Bloomfield, Ontario County, New York

brick as a building material is particularly noteworthy. The property retains a semi-rural setting and a contributing nineteenth-century barn at the rear, suggesting a possible agricultural association.

In addition to the five aforementioned properties, the entire area along both sides of Mud Creek in the northwest quadrant of the village, particularly near Michigan Street, warrant further investigation for the purpose of identifying significant archeological sites related to East Bloomfield's nineteenth-century industrial activity. Mills, a foundry, an agricultural implement shop, and possibly other industrial concerns, were originally concentrated in this area. Archaeology was not within the scope of the present project, but should be investigated in the future by a 36 CFR 61 qualified archaeologist at the reconnaissance level.

The attached buildings list provides detailed descriptive summaries of each individual property included in the district. There are no non-contributing primary buildings, structures, objects or sites in the district. There are 49 properties encompassed by the district boundary, including 47 primary buildings and 2 primary sites (the park and cemetery). There are 32 contributing secondary buildings (including nineteenth-century carriage houses and barns and early twentieth century garages), yielding a total of 79 contributing buildings. There are also 2 contributing primary objects (the Civil War monument and triumphal arch, both of which are found in the park) and 4 contributing secondary objects (two hitching posts and two original [albeit non-functional] gas light lamp posts) in the district and 3 secondary structures (2 smokehouses and 1 pump house). There are 11 non-contributing secondary buildings in the district, primarily modern garages and sheds.

United States Department of the Interior
National Park Service

NATIONAL REGISTER OF HISTORIC PLACES
CONTINUATION SHEET

Section number 7 Page 6

East Bloomfield Historic District
East Bloomfield, Ontario County, New York

State Street (Rts. 5&20), south side.

9 State Street

ca. 1841

Henry W. Hamlin House : two-story, three-bay, L-shaped, front-gabled, frame residence with Greek Revival style features and a one-and-one-half-story, side-gabled, side wing (west), pedimented front gable contains semi-elliptical fan, six-over-six double-hung sash windows with wooden louvered shutters and simple wooden lintels, verandah with Doric order columns and turned balustrade spans front (north) of residence (west section enclosed) flaring into a circular section covered by an octagon roof which extends beyond the east corner of the residence, main entrance on verandah is surrounded by flat pilasters and a rectangular transom light and sidelights; contributing small, cobblestone smoke-house, front-gabled, one-and-one-half-story wooden-shingled barn with lean-to addition, clapboard, three-seated privy with chimney. (

11 State Street

ca. 1880

Large, four-bay, two-and-one-half-story frame residence with Stick-style features and Eastlake influence, cross-gabled, steeply pitched roof with wide overhanging eaves and exposed rafter ends, decorative, trussed gable ends and trussed, steeply pitched gable dormers with small windows, paired one-over-one double-hung sash windows on both elevations, floral carved panels over second elevation windows, flat horizontal bands separate the horizontal and vertical clapboards, corners are trimmed with flat, vertical bands, iron roof cresting surmounts the bay window (east) which is enhanced with curved brackets, paired doors on front porch which is supported by square posts with curved brackets, frieze on porch decorated with stickwork; contributing two-story, frame carriage house decorated with flat stickwork, steeply pitched, side-gabled roof with steeply pitched dormers decorated with diagonal, flat stickwork, steeply pitched, cross-gabled cupola decorated with flat stickwork.

United States Department of the Interior
National Park ServiceNATIONAL REGISTER OF HISTORIC PLACES
CONTINUATION SHEET

Section number 7 Page 7

East Bloomfield Historic District
East Bloomfield, Ontario County, NY

State Street (Rts 5&20), south side con't.

13 State Street

ca. 1794 - 1840's

John Keyes House: five-bay, two-story, cross-gabled, wooden shingled residence with Greek Revival style features, two-over-two double-hung sash windows with simple wooden lintels and wooden louvered shutters on both elevations, three-bay front porch (west) with Doric order columns, one-bay recessed front porch (east) with square posts and latticework; non-contributing modern, side-gabled garage with modern vertical siding (1988).

15 State Street

ca. 1855

Shepard House: three-bay, two-story, frame residence with Italianate features, low-hipped, metal roof surmounted by simple wooden railing, wide overhanging eaves, bracketed crowns above eight-over-eight double-hung sash windows with wooden, louvered shutters on first elevation, eight-over-eight double-hung sash windows with wooden, louvered shutters on second elevation, one-bay porch with chamfered, paired supports on pedestals, center, paneled entrance surrounded by slender sidelights, two rear additions contain Gothic-arched windows, contributing one and one-half story front-gabled, flush board, drive-through barn, clapboard pump house, large side-gabled, flush board barn connected in rear to a modern garage which is in turn connected to a new gable barn (new barn patterned after English-style barn recently burned).

17 State Street

ca. 1848

Pierce House: Greek Revival style temple-front frame residence with identical side wings, tall, dentil-edged pedimented portico supported by tall, Doric order columns, three frieze-band windows in pediment, frieze band under eaves is embellished with three frieze-band windows on either side of the residence, six-over-six double-hung sash windows with wooden, louvered shutters on first elevation, small, six-over-six double-hung sash windows with wooden louvered shutters on second elevation, vertical-paneled, center entrance surrounded by decorative sidelights, very prominent cobblestone foundation; contributing attached flush-board, gable-sided carriage barn topped by a very small cupola. Contributing cast iron horse-motif hitching post.

United States Department of the Interior
National Park ServiceNATIONAL REGISTER OF HISTORIC PLACES
CONTINUATION SHEET

Section number 7 Page 8

East Bloomfield Historic District
East Bloomfield, Ontario County, NY

State Street (Rts. 5 & 20), south side.

19 State Street

ca. 1847

Martz House: four-bay, two-story, cross gable, frame residence with Greek Revival style features, modern casement windows on first story, second-story dormer with paired one-over-one double-hung sash windows, remaining second-story windows are one-over-one double-hung sash windows, one-bay porch supported by slender posts with paneled entrance door surrounded by sidelights, entablature under eaves on both sides of residence with three frieze-band windows in frieze on west side; contributing vertical, side-gabled, flush board, barn with metal roof, horizontal, flush board, side-gabled barn with metal roof and entablature under the eaves, non-contributing modern shed.

23 State Street

ca. 1837

Hall House: four-bay, two-story, cross-gable, frame residence with Italianate style features, asymmetrical side-gabled, small, west wing with some Greek Revival trim and six-over-six double-hung sash windows with wooden louvered shutters (may have been doctor's office), four-over-four double-hung sash windows with wooden louvered shutters on both elevations, three-bay porch with split supports with geometric trim covered by a flared roof, one-story bay window (east); contributing long, side-gabled, one-and-one-story, clapboard barn (rafter in barn stamped 1841).

25 State Street

ca. 1892

Monahan House: substantial, cross-gable, two-story frame residence with some Queen Anne style features, one plate glass window on front of first story, one-over-one double-hung sash windows on both elevations, one-story bay window (east), front porch supported by turned posts on enclosed balustrade with spindlework in frieze, pediment of porch enhanced with half-timbered detailing, gables embellished with latticework; contributing small, side-gable, flush board barn.

United States Department of the Interior
National Park ServiceNATIONAL REGISTER OF HISTORIC PLACES
CONTINUATION SHEET

Section number 7 Page 9

East Bloomfield Historic District
East Bloomfield, Ontario County, NY

State Street (Rts. 5 & 20), south side.

27 State Street

ca. 1839

Mumford Hayes House: six-bay, two-story, cross-gable, frame residence with transitional Federal-Greek Revival influence, one-over-one double-hung sash windows with wooden louvered shutters and simple wood trim on both elevations, front, pedimented gable has semi-elliptical fan, prominent front porch spans three-quarters of front facade and is supported by square posts on pedestals and square, plain balusters; contributing early twentieth century, side-gable garage with novelty siding, two-over-two double-hung sash windows.

29 State Street

ca. 1808; 1860s; 1920s

Holloway Tavern: side-gable, five bay, two-story, frame residential/commercial building (built as an inn) with Federal style features, modern, side-gable, clapboard, side wing (west), decorative, crowned, six-over-six double-hung sash windows with wooden, louvered shutters on first story, six-over-six double-hung sash windows with wooden louvered shutters and plain, wooden trim on second story, rectangular, one-story, two-over-two double-hung sash bay windows (east), semi-elliptical fans in gable ends, center, front entrance encased in a modern, front-gable enclosure; contributing early twentieth century, one-and-one-half story, cinder block, front-gable storage building with decorative, pressed metal roof.

United States Department of the Interior
National Park Service

NATIONAL REGISTER OF HISTORIC PLACES
CONTINUATION SHEET

Section number 7 Page 10

East Bloomfield Historic District
East Bloomfield, Ontario County, New York

State Street (Rts. 5&20), south side con"t.

31 State Street

ca. 1892

Bridgland House: two-story, cross-gable, asbestos-sided residence with Queen Anne style features, latticework and imbricated shingles in the steep gables, paired one-over-one double-hung sash windows with wooden louvered shutters on both elevations, front porch embellished with turned posts, turned balusters, round arches with elaborate brackets at corners, latticework and imbricated shingles in porch gable and an entry door with a window bordered with colored glass panes, window bordered with colored glass panes (east), one-story bay window (east), rear, east side, entry porch has same detailing as front.

33 State Street

ca. 1874

Norton House: four-bay, two-story, asbestos-shingled residence with Italianate-bracketed style features, flat roof with widely projecting eaves with bracketed cornice, two-story rectangular bay (east), projecting center extension on front (north), pedimented crowns over two-over-two double-hung sash windows with wooden louvered shutters, elaborate wrap-around porch (north & west) supported by turned posts with scrollwork and a very intricate geometric frieze and balustrade (permission was given by present owners for porch design to be used on the Octagon House at the Genesee Country Museum at Mumford, NY); contributing front-gable, flush board barn with dropped-roof extension.

United States Department of the Interior
National Park Service

NATIONAL REGISTER OF HISTORIC PLACES
CONTINUATION SHEET

Section number 7 Page 11

East Bloomfield Historic District
East Bloomfield, Ontario County, New York

State Street (Rts 5&20), south side con't.

35 State Street

ca. 1875-1900

Cross-gable, one-and-one-half-story, asbestos-sided residence, two-bay porch with turned posts and square balusters, one-over-one double-hung sash windows; contributing small, one-story, front-gable, asphalt-shingled, carriage barn with flush board barn doors

37 State Street

ca. 1874

Edward Duffy House: cross-gable, two-story, frame residence with some Italianate detailing, six-over-six double-hung sash windows with wooden louvered shutters, square posts on pedestals are found on front porch which is enclosed with large twelve-paned windows, enclosed side entry porch (east) also enclosed with large twelve-paned windows; contributing side-gable, flush board barn with metal roof, non-contributing cement block greenhouse (ca. 1960).

39 State Street

ca. 1874

Congregational Church Parsonage: cross-gable, two-story, frame residence with some Italianate details, four-over-four double-hung sash windows with simple wooden lintels and wooden louvered shutters, one-bay front porch (north) supported by square posts on pedestals decorated with scrollwork, paired, entry doors on porch have carved tulip design in bottom panel and arched windows in top, east side entry porch also supported by square posts on pedestals with scrollwork; contributing front-gable, clapboard, carriage barn with pattern shingles in front gable, modern barn door; non-contributing modern, three-car garage (1987).

United States Department of the Interior
National Park ServiceNATIONAL REGISTER OF HISTORIC PLACES
CONTINUATION SHEET

Section number 7 Page 12

East Bloomfield Historic District
East Bloomfield, Ontario County, New York

State Street (Rts 5&20), north side.

22 State Street

ca. 1900

Parsons House: two-story, cross-gable, frame residence with some Queen Anne style features, paired one-over-one double-hung sash windows with wooden louvered shutters, patterned shingles embellish the gables, two-story bay window extension (east) with ornamental pendant and bracket at north corner of second story bay, shed-roof entry porch exhibits patterned shingles in its peak, a geometric frieze, turned posts with scrollwork, a paneled door with glass window pane and turned balustrade, side porch (east) has same detailing as front porch with a paneled door with window with a border of colored glass panes; non-contributing, small, modern, gambrel-roof barn.

20 State Street

ca. 1796

Former Hamlin Store: one and one-half-story, front-gable, frame residence (erected as a store), drop-roof addition (west), one casement window, one original, twelve-over-twelve double-hung sash window with wooden louvered shutters, one small, three-pane window on first story, one six-over-six double-hung sash window on second story, four-bay porch with slender, square posts with scrollwork; non-contributing attached, modern, clapboard garage.

United States Department of the Interior
National Park ServiceNATIONAL REGISTER OF HISTORIC PLACES
CONTINUATION SHEET

Section number 7 Page 13

East Bloomfield Historic District
East Bloomfield, Ontario County, New York

State Street (Rts. 5&20), north side.

18 State Street

ca. 1832-1834; 1860s

United Methodist Church: two-story, three-bay wide, four-bay deep, front-gable, vinyl-sided religious building with Gothic-style influence on a large corner lot, modern, paired steel entrance doors with modern transom light (1989) surmounted by original hood on consoles, various sized rectangular openings containing stained glass windows on both elevations, front gable is topped by two-square, bell towers with false louvered windows, cornice trim board under eaves, sanctuary on second story has cruciform configuration; non-contributing modern addition connected to church proper (1975).

United States Department of the Interior
National Park Service

NATIONAL REGISTER OF HISTORIC PLACES
CONTINUATION SHEET

Section number 7 Page 14

East Bloomfield Historic District
East Bloomfield, Ontario County, New York

State Street (Rts 5&20), north side con't.

Corner South Avenue and Routes 5&20

ca. 1798

Elton Park (Public Square) was part of the purchase of the Congregational Church from Benjamin Keyes in 1798. Keyes donated approximately an acre of land, included in the purchase, to be laid out as a public square. The unkept square was developed into a lovely park in 1847. In 1866 a Civil War Monument of granite and limestone was constructed by J. G. Batterson of Hartford, Conn. and placed in the center of the park in memory of the thirty-nine war dead. In 1901, an offer and donation of \$1000 was made to the Congregational Church that the park be named Elton Park in memory of Charlotte Augusta Steele Elton. The offer was accepted and the name adopted. In 1904, Mrs Elton's family donated the granite and brick archway on the southside of the park in her memory. The park contains 1.72 acres and since 1945 has been the responsibility of the Town of East Bloomfield.

16 State Street

ca. late 1860's

Parmelee House: five-bay, two-story, cross-gable, frame residence with some Greek Revival features, one-over-one double-hung sash windows with simple wooden lintels, one plate glass window on first elevation (east), one-story, full-width, entry porch supported by cushioned columns with plain balusters and covered by a flared roof; contributing one-story, front-gable, flush board carriage barn.

14 State Street

ca. 1830's - 1840's

One-and-one-half-story, side-gable, frame residence with one-story, side-gable, east wing with Greek Revival features, long four-over-four double-hung sash windows with wooden louvered shutters and simple wooden lintels, wide frieze under the eaves, main entrance surrounded by flat pilasters topped by entablature, prominent cobblestone foundation; contributing front-gable, clapboard carriage barn with Greek Revival trim.

United States Department of the Interior
National Park Service

NATIONAL REGISTER OF HISTORIC PLACES
CONTINUATION SHEET

Section number 7 Page 15

East Bloomfield Historic District
East Bloomfield, Ontario County, New York

State Street (Rts 5&20), north side con't.

12 State Street

ca. 1853

Thayer Gauss House: five-bay, two-story, cross-gable, wooden shingle-clad residence with Greek Revival features, one-over-one double-hung sash windows with wooden, paneled shutters, front facade exhibits pedimented front gable, two-story enclosed porch and two-story bay window with brackets with ornamental pendants on west corner, rectangular bay window extension with iron roof cresting (west), circular bay window extension with iron roof cresting (east); contributing one-and-one-half-story, front-gable, wooden shingle carriage barn with Greek Revival trim, fanlight above hay door, decorative barn doors (ca. 1900).

10 State Street

ca. 1854

Ward Davis House: three-bay, front-gable, two-story, L-shaped asbestos-sided residence with some Greek Revival style features and an one-and-one-half-story side wing (east), six-over-six double-hung sash windows with wooden louvered shutters and simple, wooden lintels, exterior wainscot under lower elevation windows, two-bay front porch supported by chamfered columns, second-story enclosed porch (east) (ca. 1890), metal roof; contributing side-gable, flush board carriage barn with modern doors; non-contributing modern-sided shed.

United States Department of the Interior
National Park Service

NATIONAL REGISTER OF HISTORIC PLACES
CONTINUATION SHEET

Section number 7 Page 16

East Bloomfield Historic District
East Bloomfield, Ontario County, New York

South Avenue, west side.

First Congregational Church Complex

10 South Avenue

ca. 1837

First Congregational Church: three-bay wide, five-bay deep, front-gable, two-story, frame, religious building with Greek Revival style features on a large corner lot, double bracketed cornice under eaves, tall portico with four, tall Doric order columns with a dentil-decorated pediment, arched, stained glass window with crown above large double, eight-paneled doors on portico, long, rectangular, stained glass windows with crowns on either side of center doors, square, four-faced, clock tower with flat pilasters on corners surmounts front gable, clock tower topped by square, dentil-edged, bell tower with flat pilasters and rectangular, louvered, false windows covered by a dome, dome surmounted by metal weather vane above which flies the angel Gabriel (metal object) (Gabriel is recorded as having been atop the first Congregational Meetinghouse built in 1801), ten, long, rectangular stained glass windows with crowns, very, prominent, cobblestone foundation; non-contributing modern clapboard-clad hyphen connects church to Fellowship Hall.

Fellowship Hall (Fronting Rts. 5&20) ca. 1862

Fellowship Hall: one-and-one-half-story, front-gable, frame religious building with Greek Revival features facing Rts. 5&20, three-bay porch with square posts and paneled door covered by a hipped roof, double bracketed cornice under eaves, long, six-over-six-over-six, double-hung sash window with crowns on east and west sides of building, rectangular, louvered, false window in front gable, small entry surmounted by hood on console (east).

United States Department of the Interior
National Park Service

NATIONAL REGISTER OF HISTORIC PLACES
CONTINUATION SHEET

Section number 7 Page 17

East Bloomfield Historic District
East Bloomfield, Ontario County, New York

South Avenue, west side con't.

8 South Avenue

ca. 1838

East Bloomfield Academy: three-story, six-bay wide, three-bay deep, side-gable, Academic building with Flemish-style brick work and Federal style features, wide frieze band on gable ends, twelve-over-twelve, double-hung sash windows with wooden, louvered shutters and stone lintels and sills, simple transom lights with stone lintels above paneled, entrance doors on front (east), lower elevation of rear wall (west) is constructed of fieldstone; contributing cast-iron hitching post with vine motif, two gaslights (east) (original village gaslights).

6 South Avenue

ca. 1851

Stephen Clark House: one and one-half-story, front-gable, L-shaped, wooden-shingle residence with Gothic-style features, widely projecting eaves enhanced with very pointed brackets, shed-roof, three-bay porch with square posts with scrollwork, framed crown door and square balusters, framed crown six-over-six double-hung sash windows on lower elevation, framed crown, small, six-over-six windows on front, upper elevation (east), eyebrow windows on north and south sides of upper elevation, one-story, circular bay window (south); contributing side-gable, two-story flush board barn.

4 South Avenue

ca. 1810-1820

Spencer Coleman Law Office: front-gable, one and one-half story, aluminum sided residence with mansard-style roof addition (north) (ca. 1890), two-bay porch with square posts with scrollwork covered by a flared roof, pedimented, one-over-one double-hung sash gable window in upper elevation of addition, one-over-one double-hung sash windows with modern louvered shutters in main house; non-contributing small, modern shed.

United States Department of the Interior
National Park ServiceNATIONAL REGISTER OF HISTORIC PLACES
CONTINUATION SHEET

Section number 7 Page 18

East Bloomfield Historic District
East Bloomfield, Ontario County, New YorkSouth Avenue, west side con't.

2 South Avenue

ca. 1805-1810

Dr. Ralph Wilcox House: five-bay, two-story, cross-gable, vinyl-sided residence with Federal style features, frontispiece entrance (south, front), frontispiece entrance (north) in later addition, six-over-one double-hung sash windows on both elevations, one plate glass window on lower, south elevation, paneled front entrance surrounded by semi-elliptical fanlight and sidelights, circular, two-story extension on north side, pedimented front gable contains fanlight as does north and south gable ends, brick foundation (main section); contributing three-bay, two-story, side-gable clapboard garage, one-story, side-gable, clapboard office building, one-story, side-gable, asbestos-sided office building with cornice trim, buildings are all connected.

United States Department of the Interior
National Park Service

NATIONAL REGISTER OF HISTORIC PLACES
CONTINUATION SHEET

Section number 7 Page 19

East Bloomfield Historic District
East Bloomfield, Ontario County, New York

West Main Street, south side.

59 West Main Street

ca. 1806-1815

Norton and Beach Storehouse: three-bay, side-gable, one-and-one-half-story, wooden shingle residence (built as a storehouse), one-over-one double-hung sash windows and one story bay window on front (north), enclosed one-story porch with one-over-one double-hung sash windows (east) (ca. 1924); contributing flush board, two-story, steeply pitched, front-gable barn with round window in front gable and drop-roof extensions on east and west sides (ca. 1900).

61 West Main Street

ca. 1849

Bani Bradley House: three-bay, two-story, front-gable, frame residence with Greek Revival features and an one-story side wing (east) with a porch with square columns, one-over-one double-hung sash windows with simple wooden lintels and wooden louvered shutters, main entrance framed by paneled pilasters and sidelights and topped by an entablature, frieze board runs under pediment in front gable and under eaves on sides and contains four frieze band windows, east side porch supported by square columns; contributing three-bay, side-gable, two-story, clapboard barn with Greek Revival trim and six-over-six double-hung sash windows,

63 West Main Street

ca. 1848

Laura Adams House: four-bay, cross-gable, two-and-one-half-story, frame residence, steep gables exhibit pattern shingles and paired, one-over-one double-hung sash windows in their peaks, two-over-two double-hung sash windows on both elevations, one-story, full-width porch (front, north) supported by slender, square posts with square balusters, side porch (east) same design as front porch.

United States Department of the Interior
National Park Service

NATIONAL REGISTER OF HISTORIC PLACES
CONTINUATION SHEET

Section number 7 Page 20

East Bloomfield Historic District
East Bloomfield, Ontario County, New York

West Main Street, south side con't.

65 West Main Street

ca. 1848

John McClean House: one-and-one-half-story, front-gable, wooden shingle residence with Greek Revival features and one-story west wing, six-over-six double-hung sash windows on both elevations, three-bay porch supported by square columns and square balusters, main entrance door flanked by flat pilasters and topped by cornice, entablature in front gable and wide frieze decorates east and west sides.

67 West Main Street

ca. 1835

Scribner-Pierpont Home: side-gable, one-and-one-half-story, aluminum sided residence with some Greek Revival features, side-gable, one-story, east wing with porch supported by square columns, four-over-four double-hung sash windows on lower elevation, three eyebrow windows under eaves, one-story bay window (front, north), cornice trim under eaves.

69 West Main Street

ca. 1874

Millard Parmele House: cross-gable, three-bay, two-story, frame residence, paired, one-over-one double-hung sash windows with crowns and wooden louvered shutters on both elevations (west side), one-over-one double-hung sash windows with crowns and wooden louvered shutters on both elevations (east side), two-bay porch with turned posts and turned balusters, paneled entry doors on porch have arched windows topped by crowns; non-contributing two-car, modern garage attached to rear of house.

United States Department of the Interior
National Park Service

NATIONAL REGISTER OF HISTORIC PLACES
CONTINUATION SHEET

Section number 7 Page 21

East Bloomfield Historic District
East Bloomfield, Ontario County, New York

West Main Street, south side con't.

75 West Main Street

ca. 1870

Charles Page House: elaborate, three-bay, two-and-one-half-story, frame residence with Italianate features and a two-story, paired one-over-one double-hung sash window extension (west), metal, flat roof surmounted by very decorative cupola embellished with double brackets, arched windows and a spire jutting from its flat roof, widely, projecting eaves supported by double brackets with decorative pendants, one-over-one double-hung sash windows with bracketed crowns on first story, second story has two-over-two double-hung sash windows with bracketed crowns, top half-story has small, arched windows in the frieze, wrap around porch (north and east) supported by Ionic order columns and turned balusters, segmental arch and transom enhance paired, main entry doors, rear entry porch (east) supported by square columns, porches on east side separated by elaborate, bracketed, two-story bay window extension; contributing two-story, cross-gable, steeply-pitched, frame barn with Gothic-style features, delicate scrollwork, arched windows, round medallions and verge board in center gable enhance barn, steeply-pitched cupola with arched windows and delicate scrollwork surmount the steep roof, modern barn doors, one-and-one-half-story flush board, storage barn (east) with two-over-two double-hung sash windows, one-and-one-half-story clapboard storage barn with two-over-two double-hung sash windows (west), small smokehouse.

United States Department of the Interior
National Park Service

NATIONAL REGISTER OF HISTORIC PLACES
CONTINUATION SHEET

Section number 7 Page 22

East Bloomfield Historic District
East Bloomfield, Ontario County, New York

West Main Street, north side.

62 West Main Street

ca. 1825

Porter House: three-bay, one-and-one-half-story, front-gable, frame residence with Federal-style features and one-story east and west side wings, six-over-six double-hung sash windows with simple wooden lintels and wooden louvered shutters, front gable enhanced by cornice and fanlight, slender pilasters decorate corners of building, main entry, paneled door flanked by sidelights and topped by transom light studded with gilt rosettes, east wing porch supported by cushioned columns, cobblestone foundation on rear is one-story high, metal roof, apiary in attic; contributing attached slightly to rear of west wing is woodshed-carriage house, semi-elliptical panels decorate top of carriage house doors (one old door, one modern door), one-and-one half-story, two-bay, side-gable barn with six-over-six double-hung sash windows (one old door, one modern door), cobblestone foundation.

56-60 Main Street

ca. 1806-1815

(Bradley Block)

Norton and Beach Store: five-bay, two-story, side-gable, composition sided, multi-family residence with Federal-style features, two-over-two double-hung sash windows with wooden louvered shutters on second elevation, two plate glass windows, two paneled doors with window panes and one paneled glass door on front facade (south) surmounted by hood on brackets with decorative pendants, modern railing on small porch.

50-52 Main Street

ca. 1812

East Bloomfield Tavern / Inn: five-bay wide, four-bay deep, side-gable, two-story, Flemish style brickwork commercial building with Federal style features, tall, two-tiered, pedimented portico with fanlight and square columns (ca. late 1950's), two-over-two double-hung sash windows with brick lintels, center entrance door surrounded by brick lintel, semi-elliptical fanlight and sidelights, semi-elliptical fanlights in gable ends, frieze board under eaves, board and batten addition (east, ca. late 1870's).

United States Department of the Interior
National Park Service

NATIONAL REGISTER OF HISTORIC PLACES
CONTINUATION SHEET

Section number 7 Page 23

East Bloomfield Historic District
East Bloomfield, Ontario County, New York

Main Street, south side.

Nathaniel Tupper House: one-and-a-half-story, vinyl-sided residence with double-hung sash windows, and foundation (front section), gable roof and clapboard barn with connected and barn

two-story, side-gable, brick, one-over-one double-hung sash windows (north), brick chimney, small, flush board siding, brick wall between house and barn

49 Main Street

ca. 1808

Farmers Store: two-story, front-gable, three-bay, Flemish-style brick commercial building with Federal style features, tall, pedimented two-tiered portico with square columns (late 1950's), large four-over-four double-hung sash windows and large, paneled door with stone lintel on second elevation, decorative wrought iron railing on second story porch, fanlight in front pediment, two large, plate glass, store-front windows and paneled door with window pane topped by stone lintel and transom light on first elevation, extension for apothecary alcove on east side.

51-55 Main street

ca. 1813

Child and Gardner Store: three-bay, front-gable, two-story, frame commercial building with some Federal style features, one-story, flat-roof, clapboard addition (East Bloomfield Post Office, ca. late 1930's), one-over-one double-hung sash windows on second elevation, two plate glass, store windows and two doors with window panes surmounted by narrow roof on brackets on first elevation, fanlight in front gable.

United States Department of the Interior
National Park ServiceNATIONAL REGISTER OF HISTORIC PLACES
CONTINUATION SHEET

Section number 7 Page 24

East Bloomfield Historic District
East Bloomfield, Ontario County, New York

South Avenue, east side.

3 South Avenue

ca. 1840

Brunson House: two-story, two-bay, cross-gable, vinyl sided multi-family residence with some Greek Revival features, eight-over-eight double-hung sash windows with wooden louvered shutters on second elevation, on first elevation six-over-six double-hung sash windows with wooden louvered shutters, enclosed porch with one-over-one double-hung sash windows (south), two eyebrow windows above porch with small, paneled wooden shutters.

5 South Avenue

ca. 1870s

Cross-gable, one-and-one-half-story frame residence, variety of kinds of windows all with wooden, louvered shutters, two-bay, front porch (west) with chamfered columns on pedestals with scrollwork, cornice trim under eaves, one-bay side entry porch with square posts and scrollwork; contributing front-gable, clapboard carriage barn with truss in front gable, modern garage doors.

7 South Avenue

ca. 1830

Front-gable one-and-one-half-story, frame residence, front-gable, one-story porch enclosure with one-over-one double-hung sash windows, two-over-two double-hung sash windows on second story; non-contributing attached, modern garage and modern shed.

United States Department of the Interior
National Park Service

NATIONAL REGISTER OF HISTORIC PLACES
CONTINUATION SHEET

Section number 7 Page 25

East Bloomfield Historic District
East Bloomfield, Ontario County, New York

South Avenue, east side con't.

9-15 South Avenue

ca. 1838

Ashley and Hatch Store: side-gable, two-story, four-bay, frame commercial building with some Federal style features, side-gable, one-story frame addition with one-over-one double-hung sash windows (south side), second elevation (front) has one-over-one double-hung sash windows, second elevation (north) has two twelve-over-twelve double-hung sash windows, three plate glass windows and two modern doors on lower elevation with frieze board above windows and doors.

United States Department of the Interior
National Park Service

NATIONAL REGISTER OF HISTORIC PLACES
CONTINUATION SHEET

Section number 7 Page 26

East Bloomfield Historic District
East Bloomfield, Ontario County, New York
Park Street, north side.

8 Park Street ca. 1838

Two-story, cross-gable wooden-shingle residence with some Italianate details, two-bay porch with chamfered columns and paneled door with window pane bordered with colored glass panes, one-over-one double-hung sash windows on both elevations, two-story bay window extension (front, south) under front gable, enclosed side entry porch; non-contributing front-gable, wooden sided, modern garage (ca. 1960).

6 Park Street ca. 1842

Old Town Hall: front-gable, one-story, frame municipal building with Greek Revival trim, six-paneled entrance door surmounted by hood on brackets, two-over-two double-hung sash windows, cornice trim under eaves.

Park Street ca. 1838 - ca. 1930

East Bloomfield Cemetery: Established in 1838, the East Bloomfield Cemetery now contains about ten acres of land. The cemetery contains outstanding examples of early and mid-nineteenth century funerary art and a large monument inscribed with the names of people not moved to this present cemetery. The cemetery was originally the property of the Congregational Church but since 1897 has been the responsibility of the East Bloomfield Cemetery Association.

4 Park Street ca. 1860

Parmenio Peck House: three-bay, front-gable, one-and-one-half-story, frame residence with Greek Revival features and a one-story side wing (south), six-over-six double-hung sash windows with wooden louvered shutters, three eyebrow windows (north), wrap around porch supported by square posts and square balusters (west, south); contributing small, front-gable, flush board barn with lean-to addition.

8. Statement of Significance

Certifying official has considered the significance of this property in relation to other properties: nationally statewide locally

Applicable National Register Criteria A B C D

Criteria Considerations A B C D E F G

Areas of significance
agriculture, architecture, art,
commerce, community planning and
development, education, explora-
tion/settlement, landscape archi-
ture, politics/government

Period of Significance
ca. 1798 - ca. 1930

Significant Dates
na

Cultural Affiliation
na

Significant Person
na

Architect/Builder
na

State significance of property, and justify criteria, criteria considerations, and areas and periods of significance noted above.

The East Bloomfield Village Historic District (ca. 1798 - ca. 1930) contains a broad range of architecturally and/or historically significant resources which, both individually and collectively, chronicle the historical development of the village from its advent as a small, yet prosperous, rural agrarian hamlet strategically located on the Great Western Turnpike through its continued vitality as the center of commercial, civic, small-scale industrial, religious and social activity for the surrounding farm region. The district satisfies criteria A and C in the areas of agriculture, architecture, art, commerce, community planning and development, education, exploration/settlement, landscape architecture and politics/government. As a whole, the district (which encompasses nearly the entire historic core of the village) is distinguished by an unusually intact collection of outstanding early to late-nineteenth century domestic, commercial, civic and religious architecture, an intact, well-landscaped village green (Elton Park) in the New England tradition of community planning and two fine examples of late nineteenth and early twentieth century public art, both of which grace Elton Park. In terms of broad patterns of settlement and community planning in central-western New York, the district satisfies criterion A as a remarkably intact example of the type of communities that prospered along the Great Western Turnpike (U.S. Route 20) in mid-, central and western New York: small bands of settlers moved westward during the late eighteenth century along the old Indian trail and Colonial thoroughfare in search of the great American "frontier." As they discovered virgin lands and bodies of water suitable for agriculture and small-scale industries, they staked out farmsteads, erected mills and established community centers of commerce, politics, education, social interaction and religious worship. As is the case with East Bloomfield, the focal point of nearly all of these communities along the Great Western Turnpike centered around a four-corner intersection with this major east-west transportation corridor. The district also satisfies criterion A in the area of agriculture because it contains a remarkably intact small-scale farm complex that illustrates the history of hops farming within the village proper.

United States Department of the Interior
National Park Service

NATIONAL REGISTER OF HISTORIC PLACES
CONTINUATION SHEET

Section number 8 Page 2

East Bloomfield Historic District
East Bloomfield, Ontario County, NY

Part I: Historic Overview

Much of the following narrative is a summary of an extensive reconnaissance level survey report prepared by Virginia Schroeder of the Historical Society of the Town of East Bloomfield. The original report and survey documentation, currently on file with in the Survey Division of the New York State Historic Preservation Office, covers the entire Bloomfield township, beginning with the sixteenth and seventeenth-century Seneca Indian villages and the eighteenth century Phelps & Gorham Purchase. For the purposes of the present district nomination, only those sections and contexts directly related to the development of the village proper are covered in the following historic overview. This general overview is followed by Part II (Historic Resources), an analysis of the nominated resources in terms of the National Register criteria.

Settlement Period

The earliest settlers in the present-day town of East Bloomfield arrived in the area in 1789-90. Prominent early pioneers included Deacon John Adams and his son, Abner Adams, General John Fellows, Nathaniel and Eber Norton, the Shepard family and Oliver Chapin. Farmsteads were established throughout the fertile region; wheat, corn, potatoes, beans and apples provided for ample subsistence farming (and, later, prosperous cash-crop farming) with the support of animal husbandry (particularly sheep raising). Farming and agrarian-related concerns continued to sustain the region economically throughout the nineteenth and much of the twentieth century. Early small-scale industries, including saw mills, a distillery, a tannery, and flour and grist mills, were set up along Fish Creek in the northeast quadrant of the town and along Mud Creek, a tributary of Fish Creek, in the northwest quad of the village. Industrial activity along Mud and Fish Creeks expanded and prospered throughout the first half of the nineteenth century.

Historically, the settlement of the present-day village began when Benjamin Keyes purchased Lots 45 and 46 from Oliver Phelps in 1794. Benjamin Keyes became known as the proprietor of the village. In 1794 John Keyes, son of Benjamin, built the first frame house in the village on the south side of the Great Western Turnpike (tax lot #26, 13 State Street) and, in 1796, Philo Hamlin built the village's first general store (on the north side of the turnpike, tax lot #62, 20 State Street). (Portions of

United States Department of the Interior
National Park ServiceNATIONAL REGISTER OF HISTORIC PLACES
CONTINUATION SHEET

Section number 8 Page 3

East Bloomfield Historic District
East Bloomfield, Ontario County, NY

both of these settlement period buildings may survive beneath later additions to both buildings; in their present conditions, 13 and 20 State Street contribute to the district as representative examples of vernacular domestic architecture in the village context.) The first proprietors of Philo Hamlin's store are believed to have been Nathaniel Norton and Elisha Beach. Norton was an early sheriff of Ontario County and later a member of the Ontario County legislature and Mr. Beach was Bloomfield's first postmaster.

The first significant community action in the village was the designation of a public open space. In 1798 the Congregational Church purchased five acres plus "additional land" from Benjamin Keyes for \$108. The "additional land" was specifically designated by Keyes to be laid out as a public park. In 1801 the first Congregational Meetinghouse was erected on the north side of the Great Western Turnpike at the southwest corner of the village green. Seven years later, the Holloway Inn/Tavern was built on the south side of the turnpike across the street from the meetinghouse. Five years later (i.e., completed in 1813), a brick school house was erected on the northeast corner of the village green and the following year, Mechanics Hall was built to the north of the Congregational meeting house and associated cemetery. Mechanics Hall was a co-operative manufactory designed to promote the early "industrialization" of various artisans' crafts and trades; products produced by East Bloomfield's skilled artisans included clocks, candlesticks, furniture, shoes and sleigh bells. Of this first phase of development around the public park, only the Holloway House and the village green survive. (See below; Part II: Historic Resources). The second phase of development around the village green consisted primarily of the replacement of the settlement period buildings: the old meeting house was replaced in 1837 by the current Congregational Church building; Mechanic Halls was razed when the East Bloomfield Academy was built in 1838; the school house was replaced in 1845 by the town hall; the original cemetery was relocated from its first location (just north of the meeting house) to its present location on the opposite side of the park (east of the Town Hall.) In addition, fashionable new residences were erected (particularly along the south edge of the park) during the second quarter of the nineteenth century, as was United Methodist Church (1832) on the east side of the park.

Concurrent with the early religious, civic and residential development around the village green was the commercial

United States Department of the Interior
National Park ServiceNATIONAL REGISTER OF HISTORIC PLACES
CONTINUATION SHEET

Section number 8 Page 4

East Bloomfield Historic District
East Bloomfield, Ontario County, NY

development along the block just north of the public park between the Great Western Turnpike and the Old North Road (Main Street, Route 20C). Shortly after Norton and Beach established their aforementioned store on State Street, they vacated their original place of business and relocated to the north side of Main Street just east of Michigan Avenue, thereby establishing East Bloomfield's second focal point of early development. (From then on, development efforts near the village green appear to have discouraged commercial concerns while fostering civic, religious and residential developments along its borders instead.) By 1814, the Norton & Beach commercial block (later known as the Bradley Block) consisted of a store, a storehouse, a barn and other buildings. Several years earlier, the massive East Bloomfield House (an inn, tavern and stagecoach stop like the aforementioned Holloway House) had also been erected on the north side of Main Street, while two more mercantile concerns had been built on the south side of Main Street near its intersection with South Avenue. Thus, the two foci of East Bloomfield were firmly established and the nascent village developed outward from the two cores.

Religion

Religion played an important part in the development of the village. The Reverend Zadoc Hunn, a Congregationalist from the same vicinity in Massachusetts as East Bloomfield's original pioneers, was the organizer and moderator of the "First Congregational Society of Bloomfield." Eight males and nine females were recorded as the original members. As previously mentioned, the first meeting house was started in 1801 and finished in 1808. The church was designed by Andrew Colton and built by Robert Powers. The Congregationalists were the first organized religious group in the town and the church was attended by the majority of the early pioneers.

The present United Methodist Church was built by the Universalists about 1832. There is no other information available on the Universalists at this time. The Universalists sold the building to the Episcopalians in 1842; they in turn sold the church to the Methodist Society in 1859. The Methodist Society had been organized in 1810 as part of Genesee Conference which later became the Bloomfield and Genesee Circuit. In 1830 the group was incorporated into the Second Society of the Methodist Episcopal Church of Bloomfield. In 1858, the society moved to the village and, in 1859, they purchased the present

United States Department of the Interior
National Park ServiceNATIONAL REGISTER OF HISTORIC PLACES
CONTINUATION SHEET

Section number 8 Page 5

East Bloomfield Historic District
East Bloomfield, Ontario County, NY

church under the name of the Second Methodist Society of East Bloomfield.

The Trinity Episcopal Church started in East Bloomfield with the nine Episcopalians worshipping in the various homes of its members. In 1838 they began to worship in the former Universalist Church. As their number increased, they were able to purchase the church building itself in 1842. Their "new" edifice was consecrated by Bishop Delancey as a Zion Church. Seventeen years later (i.e., in 1859), the Episcopalians sold the building to the aforementioned Methodists, but apparently continued to worship in the church. In 1871 the corner stone was laid for a new Episcopal church (St. Peters; pending investigation and evaluation) in the adjacent village of Holcomb.

The history of the Catholic Church is bound up with the early history of Ontario County. Missions were established on Boughton Hill (in the present-day town of Victor) and on Mud Creek (in East Bloomfield) when the Seneca Indians were living in the region. In 1668 the Seneca chiefs sent emissaries to Montreal requesting missionaries. The French enthusiastically granted their request, sending Father Garnier to establish a mission known as St. James at Gonondagan on Boughton Hill and Father Fremin to found St. Michael's at Gandougarae on Mud Creek in East Bloomfield. In 1669 Father Fremin left St. Michael's and Father Garnier remained alone to serve the missions. In later years, stone plaques were erected in Elton Park and on County Route 30 near the former St. Michael's mission by the State of New York in memory of Father Fremin's work in East Bloomfield. Father James T. Daugherty, Father Fremin's successor, was a tireless worker among the Indian tribes. In 1850 the Rev. Edmund O'Connor came frequently to attend the sixteen Catholic families living in East Bloomfield. In 1851 the first St. Bridget's church building was erected on Michigan Street in the village (north of the district boundaries). The 30' x 40' white frame building was completed in 1852 and Father O'Connor was pastor until 1856. The Rev. William Hughes came to Bloomfield in 1861. Father Hughes was a devout spiritual leader and the church grew in membership until it was evident that a larger building was needed. Father Hughes purchased several acres of land on Church Street, including enough land for a cemetery, and the cornerstone of the new brick edifice was laid in 1874. The church property is pending investigation and evaluation.

United States Department of the Interior
National Park Service

NATIONAL REGISTER OF HISTORIC PLACES
CONTINUATION SHEET

Section number 8 Page 6

East Bloomfield Historic District
East Bloomfield, Ontario County, NY

Education

Education has always been of primary importance to the people of Bloomfield. The first log schoolhouse was erected in the 1790s on Mud Creek, near the pioneer settlement, and Laura Adams, daughter of Deacon John Adams, was the first teacher. Other small schools were erected all over the township. In 1838, the trustees of the Congregational Church decided that a school of higher learning was needed in the village. Consequently, the East Bloomfield Academy was erected under the auspices and direction of the church. It first opened as a private boarding school in 1839, but a catalogue of "Officers and Students," published by the students in 1846, reveals that most of the students were local. The academy flourished in its first years but in the 1860s financial difficulties occurred. In 1876, it became a Union Free School, tax-supported and tuition free. The academy closed in 1909 when the new public school opened on Main Street (pending investigation and evaluation). Ownership of the academy building reverted to the Congregational Church as stipulated in the original agreement. In 1970, the building was purchased by the Historical Society of the Town of East Bloomfield and now houses the Historical Society Museum, The Academy Gift Shop and the Antique Wireless Association and Electronic Communications Museum.

Industry

Although no industrial-related resources are known to survive in the nominated district, a brief summary of industrial activity in the village proper will contribute to an understanding of the development of the community in general. A carding machine was established on Furnace Alley (now Michigan Street) in the early 1800s by Thomas H. Kellogg. This was an economical asset to the village because it was the first such establishment in the area; people involved in cloth production travelled many miles for its services and while they were "in town," they undoubtedly patronized the village's stores and taverns.

By the mid-1800's, East Bloomfield had become a busy and bustling village. Many agrarian-related businesses had grown within the village limits. The carriage and wagon factories of Mumford Hayes and S. Mayo and Sons were firmly established in the village and selling their excellent carriages all over the East. Mumford Hayes's Carriage Manufactory was located behind (south of) his residence at 27 State Street. He started his business in

United States Department of the Interior
National Park ServiceNATIONAL REGISTER OF HISTORIC PLACES
CONTINUATION SHEET

Section number 8 Page 7

East Bloomfield Historic District
East Bloomfield, Ontario County, NY

1839 and remained in business on that site for over thirty-seven years. Mr. Mayo began his wagon business about 1846, east of the Farmers Store on Main Street. When the business burned, he rebuilt on the north side of Main Street, where he continued until he was again destroyed by fire. He then moved to the old drill factory (see below) on Michigan Street for a short time and about 1880, he purchased the Hayes's factory and continued his work, until once again he was struck by fire, and, at this time, he retired. The Neenan Brothers began their carriage and wagon business in the late 1800's and made these products into the early 1900's when the need for the products diminished.

The Seymour Drill Co. started business in the mid-nineteenth century on Michigan St. and while the factory was under the ownership of Mr. Taft and Mr. Perkins in 1870, the company was awarded a bronze medal for the outstanding drill in the farm implement show at Utica, NY. The firm also produced a successful plaster sower.

Agriculture

Of course, most of East Bloomfield's agrarian activity occurred beyond the village boundaries in the vast, sparsely populated township. However, the far fringes of the village proper also supported several agrarian ventures, including, most notably, the hops grown on Charles Page's gentleman's farm on the western edge of the village. Hop raising was the leading industry in Bloomfield in the mid-nineteenth century. Page purchased the large farm on the west boundary of the village from George Thomson, who had been instrumental in initiating hop growing in the Bloomfield area. Page successfully ran the operation for twenty-five years. It was one of the largest and best-worked hopperies in the locality. Blue mold and insects were responsible for the demise of this industry in the East Bloomfield area.

Transportation

As previously discussed, the Great Western Turnpike (a.k.a. the Old Toll Road), played an important part in the development and success of the Bloomfield area. The farmers were able to transport their goods to other areas with the convenient access provided by this main thoroughfare. Slightly later, the opening of the Erie Canal in 1825 further boosted the economy of East Bloomfield. Route 64 and the Victor-Holcomb Road provided routes

United States Department of the Interior
National Park ServiceNATIONAL REGISTER OF HISTORIC PLACES
CONTINUATION SHEET

Section number 8 Page 8

East Bloomfield Historic District
East Bloomfield, Ontario County, NY

northward to Bushnell's Basin on the canal where the farmers were able to transport their products to Albany and other far away markets.

The Canandaigua and Niagara Falls Railroad was formed on March 4, 1851. Affectionately dubbed the "Peanut," the first train passed through the town of East Bloomfield on its way to Batavia on January 1, 1853, stopping to the east of the thriving hamlet of East Bloomfield. The location of this train stop spurred the sudden development of the hamlet of East Bloomfield Station. (This hamlet was incorporated as the village of Holcomb in 1916. The hamlet of East Bloomfield became incorporated as a village in 1917). Before the advent of the railroad, very little development had occurred in the area of what would become Holcomb. The Carter tavern was one of the few buildings in the vicinity but with the arrival of the railroad, business gradually developed around the four corners. By the turn of the century, Holcomb was slowly becoming the commercial center of the township, as it is today, and the village of East Bloomfield remained the social, political and religious center for the township. The East Bloomfield Bank, which had begun business in Bradley Hall in the village of East Bloomfield about 1876, erected a new building in Holcomb in 1903. When Holcomb became incorporated in 1916, a second post office was established in that village and the village of East Bloomfield was urged to join them in being one center. This offer was declined by the people of East Bloomfield as they preferred to retain their own identity. Public utilities came to both villages shortly after the turn of the century. Public water is still available only to the villages and to those in close proximity to the villages.

As this mid- and late nineteenth century surge of activity occurred in the village of Holcomb, the village of East Bloomfield began to move at a slower pace. Little new development occurred, with the exception of the construction of scattered dwellings, particularly near the fringes of the older historic core of the village. Due to this building hiatus, the historic building stock of the village survives with a remarkably high degree of integrity of design, materials, craftsmanship, setting, location, feeling and association. On November 4, 1811, John Melish made the following comments in his travel log about the village of East Bloomfield; the observations are applicable even today:

United States Department of the Interior
National Park Service

NATIONAL REGISTER OF HISTORIC PLACES
CONTINUATION SHEET

Section number 8 Page 9

East Bloomfield Historic District
East Bloomfield, Ontario County, NY

This is a very pretty village, adorned with a handsome church and spire. I was informed that this place began to settle about 21 years ago; the original temporary houses have nearly all given away to elegant frame and brick houses and the whole settlement indicated wealth and rapid improvements (Melish, unpaginated).

United States Department of the Interior
National Park Service

NATIONAL REGISTER OF HISTORIC PLACES
CONTINUATION SHEET

Section number 8 Page 10

East Bloomfield Historic District
East Bloomfield, Ontario County, NY

Part II: Historic Resources

One of the earliest and most significant components of the district is the substantially intact plan of the village. In 1798, four years after the first settlers established the location of the village proper, plans were made and land was set aside for the purpose of creating a public park. Clearly inspired by the settlers' hometown village greens in New England, the East Bloomfield village square and consequent village plan are dramatic illustrations of transplanted Yankee traditions in eighteenth-century community planning. Although not conscientiously landscaped or developed until 1847, the open land of the designated village square was the initial core around which the nascent village evolved. Typical of the lay-out of small New England farming communities, East Bloomfield's village square was the focal point around which the earliest and most prestigious public-related edifices were constructed, including the first Congregational Meetinghouse in 1801 (replaced by the present edifice in 1837), the brick schoolhouse in 1813 (replaced by the Old Town Hall in 1842), Mechanics Hall in 1814 (replaced by the East Bloomfield Academy in 1838) and the Methodist Church in 1832 (expanded ca. 1867). Early residences of prominent settlers were also clustered around the square, including the 1808 Holloway House/Tavern (which also served as an early inn). Typical of the first quarter of the nineteenth century, all of these buildings, especially the original Congregational Meetinghouse, the brick school, Mechanics Hall (none of which survives) and the Holloway House, reflected the influence of the Early Federal/Adamesque style.

The Holloway House, anchoring the southwest corner of the village green at 29 State Street, is a fine example of Federal style residential architecture. Beneath a veneer of contributing late nineteenth century modifications (including the addition of Victorian bay windows, lintels above windows and a new roofline with broadly projecting eaves), the Holloway House retains a variety of distinctive features associated with the Federal building tradition - such as its deep, broad proportions (reflecting its double-pile plan), central primary entrance, massive brick interior end chimneys, six-over-six, double-hung sash windows, slender corner pilasters and graceful fanlights with radiating tracery in the apexes of the gable ends. The

United States Department of the Interior
National Park ServiceNATIONAL REGISTER OF HISTORIC PLACES
CONTINUATION SHEET

Section number 8 Page 11

East Bloomfield Historic District
East Bloomfield, Ontario County, NY

original entrance (currently obscured by a small, 1949 gable-roofed vestibule) features the original paneled wooden door flanked by half- sidelights and surmounted by a narrow transom.

The house/inn was built ca. 1808 by Peter Holloway, a blacksmith by trade. Called Holloway's Tavern, it was the first public facility of its type (i.e., a tavern/inn) erected in the village. The house served as a stop on the Albany to Buffalo stage coach line and was a favorite local meeting place as well. Jonathan Child and Benjamin Gardner temporarily operated a store in the tavern in 1812 while they waited for their new commercial facility to be completed at 51 Main Street (also a contributing component of the district; see below). Subsequent owners during the first third of the nineteenth century, including Peter Bowen and the Keyes family, renamed the establishment "Bowen's Tavern" and "Keyes Tavern," respectively. In 1833 the building was purchased by Harlow Munson and converted into a private residence. The Munson family built a piazza on the rear of the house in 1879 and, in 1890, added a bay window on the east side (facing South Avenue) and installed a boardwalk in front of the house. Munson also converted two of the second-story bedrooms into a ballroom. A new roof with projecting eaves was also added during the last quarter of the nineteenth century.

Mr. & Mrs. Frank Munson re-converted Harlow Munson's residence back into a restaurant in 1910 and named it Locust Lawn. The Seel family purchased the establishment in 1939 and, in honor of the first owner/builder, renamed it the Holloway House. The prestigious facility continues under that name today and is run by owner/operators Fred and Doreen Wayne.

Unfortunately, a number of unsympathetic changes have occurred to both the building's exterior and interior as a result of the facility's evolution from an early nineteenth century roadside inn into a private residence and back into a public restaurant. Nonetheless, the Holloway House remains a significant example of early Federal style architecture as well as an important illustration of roadside service facilities for both travellers and local residents.

Like the Holloway House, the East Bloomfield Tavern (ca. 1812, Main Street) is historically and architecturally significant as an important example of an early nineteenth century inn/hotel on the stagecoach line. It, too, embodies the

United States Department of the Interior
National Park ServiceNATIONAL REGISTER OF HISTORIC PLACES
CONTINUATION SHEET

Section number 8 Page 12

East Bloomfield Historic District
East Bloomfield, Ontario County, NY

distinctive features of early Federal style architecture in a quasi-public/commercial facility.

The East Bloomfield Tavern occupies a prominent site on the north side of the triangular intersection of Main Street and South Avenue. A few years earlier, the Farmers' Co-op Store (see below) had been erected on the southeast corner of the intersection, thereby creating a second focal point (the village green being the primary focal point) around which community development (particularly commercial) occurred. The completion of the East Bloomfield Tavern in 1812 and, a year later, the construction of Child and Gardner's store next door to the Farmers' Co-op, firmly established this secondary anchor in the early village plan. Today, the triangular open greenspace/traffic island (Pickle Park) and surrounding historic architecture remain important reminders of patterns of land use and community development in East Bloomfield during the early nineteenth century.

On a smaller scale than either the Holloway or East Bloomfield Taverns, the aforementioned Farmers Store (ca. 1808, 49 Main Street) and Jonathan Child and Benjamin Gardner's store at 51 Main Street (ca. 1812) are extremely rare and relatively intact examples of very early nineteenth century commercial architecture. (While numerous monumental commercial/public buildings dating from the early nineteenth century survive throughout New York [and the Northeast in general] by virtue of their sheer size and importance to their local communities, few small-scale commercial structures - particularly frame ones such as Child & Gardner's store - have survived the fate of destruction by fire, demolition or extensive alterations.)

Both of these early Federal style commercial buildings feature two-story, three-bay gable-end facades oriented towards the street and gable roofs with restrained cornice returns. The Farmers Store, believed to have been erected by the local farmers' co-op (composed of farmers from the towns of Bloomfield and Richmond) operated as such until about the 1820s, at which time it evolved into a more traditional, profit-oriented mercantile establishment rather than a communal farmers' cooperative. The building has undergone several building programs. The first phase of remodeling (during the late nineteenth century) resulted in the addition of large, plate-glass store windows on either side of the central entrance. On the interior, pressed tin ceilings and oak and pine floors

United States Department of the Interior
National Park ServiceNATIONAL REGISTER OF HISTORIC PLACES
CONTINUATION SHEET

Section number 8 Page 13

East Bloomfield Historic District
East Bloomfield, Ontario County, NY

survive intact, as does the apothecary alcove with original cabinetry. Later, non-contributing alterations occurred during the 1960s: a large, two-story pedimented portico with square columns and wrought-iron balcony balustrades was added, second-story fenestration was changed, the second story was converted into a rental apartment and the former single open room on the first floor was subdivided with partitions.

Child & Gardner's Store, completed ca. 1813, has also undergone several phases of modification, but nonetheless retains its overall Federal character in terms of general design and ornamentation. The store originally featured a central entrance. Later, presumably during the post-Civil War period, the central entrance was walled over and two side entrances with large display windows were added. The display windows presumably contained multi-paned sash; by the turn of the twentieth century (or perhaps slightly later), large fixed plate glass windows were installed.

Contemporary with the East Bloomfield Tavern, the Holloway House and the two aforementioned stores is the Bradley Building. It was erected between 1808 and 1815 for Nathaniel Norton and Elisha Beach as a component of their large commercial block which anchored the northwest corner of the intersection of Main Street and South Avenue (just west of the East Bloomfield Tavern). By 1820, the block consisted of the store, a storehouse, a barn and several smaller dependencies. The former storehouse was moved to 59 West Main Street in the 1860s and converted into a residence. A fourth major component of the block, Bradley Hall (an Italianate style building completed ca. 1871), was destroyed by fire in 1985. The other dependencies had fallen into disrepair and were demolished. Over the years, the buildings within the Bradley Block complex had housed a number of mercantile concerns, including general stores, a hardware store, an ice cream parlor, a hat shop, a bank, the original post office and a dance hall. Today, only the Bradley Building survives; it has suffered a variety of unsympathetic modifications as a result of its conversion into multi-family housing. Nonetheless, it complements the streetscape in terms of general form and scale and, enhanced by its historical significance, is considered a contributing component of the district.

The Abner Adams House (ca. 1812), a gentleman's farmhouse, is contemporary with these early buildings in the comparatively dense core of the village. Located at the northwest fringes of

United States Department of the Interior
National Park ServiceNATIONAL REGISTER OF HISTORIC PLACES
CONTINUATION SHEET

Section number 8 Page 14

East Bloomfield Historic District
East Bloomfield, Ontario County, NY

the community, several block beyond the district boundaries, the former farmhouse is pending evaluation by the New York State Review Board and will be included in the forthcoming East Bloomfield Village Multiple Property Nomination. Like the Holloway and East Bloomfield Taverns, the Adams House is historically and architecturally significant under criteria A and C as a distinctive example of settlement period Federal style architecture. The Adams House is additionally significant under criterion B for its association with Abner Adams family, one of East Bloomfield's most prominent founding families.

For the purpose of better understanding the nominated district, the following preliminary architectural analysis of the Adams House is offered. A more thorough justification of the dwelling's significance in terms of the National Register criteria will be included when the building is nominated. Transitional in character, the Adams house displays the broad, deep horizontal proportions typical of the Georgian period as well as a spacious double-pile plan and twelve-over-twelve, double-hung sash windows. The influence of the Federal style is seen in the restrained, segmentally arched surround above the south (front) entrance, the round oculus centrally placed in the second story of the south facade, and the delicate, arched fanlights in the east and west gable ends. The two brick interior end chimneys are also typical of the Federal period.

When it was constructed in 1812, the setting of the house was rural and "wild" in character; later nineteenth- and twentieth-century development has encroached upon the former rural agrarian setting and has converted the neighborhood into a typical modern suburban enclave. Despite its altered setting, the Abner Adams House remains an important reminder of the second type of land use/development in East Bloomfield during the nineteenth century: concurrent with the relatively dense settlement of the village center around the public square was the continued exploitation of the fertile outskirts of the village and surrounding rural township.

On a far less pretentious scale than any of the previously discussed properties, the ca. 1813 saltbox dwelling at 47 Main Street (adjacent to the former Farmers' Co-op) illustrates Federal style architecture at the vernacular level. Unfortunately, in its present condition, the building lacks sufficient integrity to be included in the nominated district. Like the overall village-square plan of East Bloomfield, the

United States Department of the Interior
National Park ServiceNATIONAL REGISTER OF HISTORIC PLACES
CONTINUATION SHEET

Section number 8 Page 15

East Bloomfield Historic District
East Bloomfield, Ontario County, NY

modest saltbox is a vivid reminder of the New English origins of the community's earliest settlers. Although lacking a central chimney (and featuring interior end chimneys instead), the dwelling displays the typical rectangular configuration with rear lean-to. The interior plan, with its two rooms in the main block spanned by the rear kitchen lean-to, is also typical of New English salt box dwellings. If and when the dwelling is restored according to the Department of the Interior's Standards for Rehabilitation, the property can be evaluated and the district boundary may be amended to encompass 47 Main Street.

The Federal style persisted in East Bloomfield well into the 1820s and 1830s. The ca. 1825 Josiah Porter House at 62 West Main Street (on the northwest corner of Michigan and Main just west of the Bradley Block and the East Bloomfield Tavern) is an outstanding example of a relatively sophisticated Federal style dwelling. Distinguished attributes of the building include its finely crafted leaded-glass transom light studded with gilt rosettes, fluted entrance pilasters with delicate corner blocks, a round-arched louvered vent in the front gable end, a narrow cornice with slight returns, and slender corner boards. Other notable features of the building include its typical rectangular, gable-roofed form and its two-story, three-bay gable end oriented towards the street. As land within the village limits increased in value, narrower lots with shorter street frontages necessitated the re-orientation of buildings: the popular five-bay center-hall Georgian-inspired form (seen in the Holloway and Adams Houses) gave way to the more practical three-bay form (occasionally with side wings) during the Federal and Greek Revival periods. The latter form persisted well into the twentieth century in the denser sections of the village while the older, broader forms persisted on the village fringes and in surrounding rural areas where land was not at such an economic premium.

Two individual properties beyond the district boundaries, 47 South Street and 27 Main Street also appear to be architecturally significant examples of Federal style domestic architecture. Both are undergoing thorough investigation and will be evaluated against the National Register criteria. As was the case with the Abner Adams House, a brief discussion of these buildings will provide additional information for comparing and contrasting the historic resources included within the presently submitted historic district proposal. The rural house at 47 South Avenue, pretentiously rendered in brick, displays the

United States Department of the Interior
National Park ServiceNATIONAL REGISTER OF HISTORIC PLACES
CONTINUATION SHEET

Section number 8 Page 16

East Bloomfield Historic District
East Bloomfield, Ontario County, NY

typical Federal period rectangular gable-roofed form with two-story, three-bay facade and side wing. Federal-inspired ornamentation includes the finely crafted entrance with half-sidelights and simply molded wooden surround. The village dwelling at 27 Main Street features the same two-story, three-bay Federal period form so common in East Bloomfield and similarly pretentious detailing, including an elaborate entrance surround with segmentally arched fan and delicate half-sidelights as well as a louvered attic fan with decorative wooden keystones.

Although compromised by several substantial alterations and additions, the Dr. Ralph Wilcox House, occupying the prominent southwest corner of the intersection of Main Street and South Avenue, displays several sophisticated, finely crafted Federal style architectural details, including an arcaded, recessed entrance with gracefully arched woodwork and fanlight as well as prominent fanlights with intricate tracery in the pedimented front and side gable ends.

East Bloomfield continued to thrive throughout the Federal period and well into the Greek Revival period as a result of its prosperous agrarian economy, its strategic location on the Great Western Turnpike and its accessibility to the Erie Canal transportation route. The most imposing building erected during this era of tremendous prosperity was the East Bloomfield Academy (ca. 1838), a simple, yet sophisticated and monumental, example of Greek Revival style public architecture in East Bloomfield. The academy is additionally significant under criterion A for its pivotal role in the history of education in East Bloomfield as thoroughly discussed in Part I.

Another pivotal building of the period is the Methodist Church, originally built in 1832 in the late Federal/Early Greek Revival style and overlooking the southeast corner of the village green. Although its physical integrity of materials and craftsmanship has been compromised by the recent addition of modern siding and a new door, the church remains a contributing component of the district in terms of its integrity of location, setting, design (scale, massing, orientation, configuration), feeling and association within the streetscape.

Another highly significant building dating from the Greek Revival period is the former town hall (ca. 1842) at the northeast corner of the village green and adjacent to the western edge of the East Bloomfield Cemetery (established in 1839). The

United States Department of the Interior
National Park ServiceNATIONAL REGISTER OF HISTORIC PLACES
CONTINUATION SHEET

Section number 8 Page 17

East Bloomfield Historic District
East Bloomfield, Ontario County, NY

former town hall was built on land which previously had been occupied by the 1812 brick schoolhouse of District #8. (The schoolhouse was dismantled for some unknown reason in the late 1830s.) The town hall served the community until the late 1930s; it now serves as a storage building for the adjacent cemetery and the local boy scouts.

As previously mentioned, the present cemetery was established during the Greek Revival period. It is significant under criterion C in the area of art for its fine collection of outstanding examples of nineteenth-century funerary art in the form of carved headstones and small monuments.

Prior to establishing the present cemetery at the northeast corner of the village green, East Bloomfield's first cemetery was located next to (north of) the original Congregational Church on the lot now occupied by the East Bloomfield Academy. When the academy was built in 1838, the original cemetery was discontinued and the present cemetery (also owned by the Congregational Church) was opened. The Congregational Church had purchased the first parcel of land from Bani Bradley in 1838. The church also purchased a private cemetery (which adjoined Bradley's land) from the Carter Family and eventually the present cemetery emerged. Finally, the cemetery association (owners since 1897) acquired the land formerly associated with School District #8 (subsequently occupied by the aforementioned town hall). Well-landscaped with grassy lawns, a variety of mature trees and meandering pathways, the cemetery reflects the ideals of nineteenth-century design: bucolic, picturesque and naturalistic in character, serving as a strolling and quiet recreation ground for the local community as well as a final resting place.

Complementing the academy is the First Congregational Church (ca. 1837-38), an outstanding example of early nineteenth religious architecture in the tradition of Sir Christopher Wren and James Gibbs. Inspired by Wren's and Gibbs's Baroque churches in Great Britain, American builders were quick to copy the spacious, light and airy congregationally oriented church buildings, many of which were distinguished by imposing towers and/or porticos. Incorporating design features of the Greek Revival period, the First Congregational Church features a monumental pedimented portico surmounted by an engaged three-stage tower. The portico features paired, fluted columns and a full entablature embellished with triglyphs and metopes. The upper two stages of the tower feature engaged columns. (The

United States Department of the Interior
National Park ServiceNATIONAL REGISTER OF HISTORIC PLACES
CONTINUATION SHEET

Section number 8 Page 18

East Bloomfield Historic District
East Bloomfield, Ontario County, NY

clock face was added in 1851 and the bell in the louvered belfry dates from 1893.) The tower is surmounted by a domed roof, atop which rests a weather vane (depicting the angel Gabriel with traditional trumpet icon). According to church records, this weather vane adorned the original congregational meeting house erected in 1801 on the site of the present 1837 edifice.

The building is particularly notable for its use of cobblestone in the construction of its foundation. Although a fairly common building material in the central-western New York region, there are no extant examples of cobblestone buildings in the entire town of East Bloomfield. There are, however, several other examples of the use of cobbles as a foundation building material. These include the dwellings at 9 State Street (Henry W. Hamlin House), 17 State Street and 62 Main Street. In addition, there is one known outbuilding in the district constructed of cobbles: the smokehouse associated with the Henry W. Hamlin House.

The erection of the Congregational Lecture Hall in 1862 (and concurrent minor remodeling of the church) is an important illustration of the continued prosperity enjoyed by East Bloomfield during the Civil War era. Typical of the period, the Lecture Hall incorporates elements of the popular Italianate style, including, most notably, the wide frieze embellished with paired brackets and the paired, round-arched louvered vents with decorative woodwork in the apex of the front (south) gable end. (The hall was originally detached from the main body of the church; during the twentieth century, a small hyphen was built to connect the two buildings.) Also in 1862, the wide frieze of the church was embellished with paired scroll brackets, similar to, although fancier than, those applied to the Lecture Hall. Dominating the southwest corner of the village green, the First Congregational Church and lecture hall remain an outstanding, remarkably intact collection of nineteenth-century religious architecture in East Bloomfield.

On a far more modest scale, the main block of the Walters Commercial building (ca. 1838) on South Avenue is an important example of vernacular Greek Revival period commercial architecture. Although slightly altered during a number of building programs as the particular commercial use of the space changed to meet the different needs of new proprietors, the modest frame building remains an important reminder of small-scale, yet vital, commercial activity in East Bloomfield during

United States Department of the Interior
National Park ServiceNATIONAL REGISTER OF HISTORIC PLACES
CONTINUATION SHEET

Section number 8 Page 19

East Bloomfield Historic District
East Bloomfield, Ontario County, NY

the nineteenth and early twentieth centuries. (The one-story southwest wing is a modern, non-contributing addition.)

Another event of great significance during the mid-nineteenth century was the clearing, grading and ornamentation of the village green (later named Elton Park) in 1847. Until then, the public square had been an undeveloped, largely unkempt open space on which refuse had been dumped (including the remains of the uprooted oaks which had been cleared for the erection of both the Congregational meeting house and the former brick schoolhouse). The militia had drilled in the village green, farmers came to the square to peddle their wares, and animals roamed the area at will. A roadway ran across the park from the northwest to the southeast corner. In 1847, a group of progressive citizens received permission from the Congregational Church (the owners of the square at the time) to beautify the village green. The park was plowed, graded, sowed and enclosed with a picket fence to protect the previously planted hedge of Osage Orange. Although there had been plans at one time for a fountain, it never materialized.

The significance of the park is enhanced by the later addition of a Civil War monument (one contributing object). At the close of the war, J. G. Batterson, an artist and sculptor of Hartford, Connecticut, was commissioned to design and construct a monument. Completed on January 25, 1867 and dedicated on October 14, 1868, the 45-foot limestone and granite shaft bears the name of East Bloomfield's 39 war dead and the major battles in which they fought. The shaft is topped by a replica of a Union soldier facing south. The East Bloomfield monument is remarkably similar to the J. G. Batterson's monument in Deerfield, Massachusetts which was erected during the same period. The execution of this commemorative monument at such an early date (many of America's Civil War monuments were not constructed or sculpted until the 1870s, 1880s or even later) reflects the enlightened and progressive attitudes of East Bloomfield's citizens with regards to such controversial topics of the era. (The cannons were a slightly later donation to the park.)

The village green was named Elton Park in 1901 as a result of a gift of \$1,000 to the Congregational Church accompanied by a request from the family of Charlotte Augusta Steele Elton to officially name the park in her honor. In May, 1904, the brick and granite arch (one contributing object) on the south side of the park was donated by James Elton in memory of Charlotte Elton.

United States Department of the Interior
National Park ServiceNATIONAL REGISTER OF HISTORIC PLACES
CONTINUATION SHEET

Section number 8 Page 20

East Bloomfield Historic District
East Bloomfield, Ontario County, NY

Distinguished by finely crafted, classically inspired design features, the imposing portal is an outstanding example of turn-of-the-century public art in the City Beautiful and Park Movement traditions. In 1934, the State of New York and the Town of East Bloomfield erected a cairn (one contributing object) in memory of the Seneca Indians and as a reminder that Father Freeman held mass in the area in 1669. Later, non-contributing additions to the park include a drinking fountain (ca 1960) and picnic tables (ca. 1950). The present fences on the north and east sides date from 1986.

In terms of Greek Revival style domestic architecture in the multiple resource area, the East Bloomfield Historic District contains a number of remarkably intact dwellings dating primarily from the 1840s. All are concentrated along State Street and West Main Street, East Bloomfield's two primary residential thoroughfares. Characteristic of many villages throughout central and western New York, East Bloomfield's Greek Revival period buildings tend to employ the standard three-bay, rectangular, gable-roofed form with their gable end oriented towards the street as popularized during the Federal period. In East Bloomfield, builders also continued to employ the standard method of construction: heavy timber framing with interlocking joints and clapboard sheathing. Surprisingly, neither the district nor the village at large contains any examples of buildings built entirely of cobblestones, a building technique that was extremely popular in central and western New York (with a particularly high concentration in Ontario County) between the late 1830s and the early 1850s (i.e., concurrent primarily with the Greek Revival period.) As previously mentioned, the use of cobblestone as a building material in East Bloomfield is limited to foundations (extremely well-crafted examples this masonry technique, often embellished with prominent, smoothly finished quoins) and occasional minor outbuildings.

The earliest of East Bloomfield's Greek Revival buildings tend to be transitional in character in that they continue to reflect the persistence of the Federal taste. For example, the Hayes House (ca. 1839) at 27 State Street and the Henry W. Hamlin House at 9 State Street (ca. 1841) both display Adamesque louvered fans in their front gable ends and relatively understated, attenuated decorative and/or construction elements such as narrow corner boards. On the other hand, both also display pedimented front gable ends and wide entablatures so common during the Greek Revival period. The Hamlin House is

United States Department of the Interior
National Park ServiceNATIONAL REGISTER OF HISTORIC PLACES
CONTINUATION SHEET

Section number 8 Page 21

East Bloomfield Historic District
East Bloomfield, Ontario County, NY

particularly distinguished by its trabeated entrance with recessed door surrounded by wide pilasters, sidelights and transom light.

By the late 1840's, full-blown Greek Revival style dwellings characterize East Bloomfield's building stock. The imposing temple-front at 17 State Street is an outstanding example of Greek Revival style domestic architecture as popularized by the builder's books of Minard LeFever. Its stylish, upper class character is enhanced by its prominent setting on choice real estate anchoring the southwest corner of Elton Park. The dwelling at 61 West Main, located a slight distance from either of the village's two focal points, is a far less pretentious, yet equally finely crafted, embodiment of the mid-nineteenth century Greek Revival style vocabulary. The building is distinguished by its typical one and one-half story, three-bay facade, pedimented front gable end, and bold, heavy detailing and structural elements including a broad, simple entablature and a trabeated entrance with wide pilasters supporting a massive entablature. The entrance pilasters and square columns of the side porch are particularly notable for their simple, yet elegant, recessed-panel detailing.

As outlined in the historic overview, the 1850s and 60s were relatively slow and economically depressed years (compared to the first half of the century) for East Bloomfield. Consequently, little new construction occurred in these decades; those buildings that were erected tended to be smaller in scale and far less pretentious in ornamentation than was seen during the Georgian, Federal and Greek Revival periods. Typical examples of the 50s and 60s include the dwellings at 4 Park Street, 5 South Avenue and 10 State Street and the Methodist Parsonage at 16 State Street.

In general, these buildings tend to be simple, yet finely crafted, examples of mid-nineteenth century vernacular architecture; most feature either the standard L-shape form popularized throughout the state (and northeast in general) during the early Victorian/Italianate period or they feature the typical two-story, three-bay, rectangular form with gable end to the street. All feature minimal decorative detailing.

Several exceptions, however, reflect some unknown masterbuilders' or craftsmen's attempts to bring popular national tastes to the local level. For example, the small modest cottage

United States Department of the Interior
National Park ServiceNATIONAL REGISTER OF HISTORIC PLACES
CONTINUATION SHEET

Section number 8 Page 22

East Bloomfield Historic District
East Bloomfield, Ontario County, NY

at 6 South Avenue (ca. 1851), displays a profusion of decorative woodwork that represents the possible influence of A.J. Downing's patterns for Bracketed and Gothic-like dwellings. The house at 15 State Street (ca. 1855), with its low-pitched hipped roof and round-arched double-door entrance, is a restrained interpretation of the early Italianate style.

By the early 1870s, prosperity returned to East Bloomfield. New construction and/or the remodeling of the older buildings was executed on a far grander scale than during the previous two decades. The remarkably intact Charles Page House (ca. 1870), anchoring the northwest corner of the historic district at 72 West Main Street, is an outstanding example of Italianate style domestic architecture. The imposing edifice, prominently sited on the knoll of a large (4.8-acre) well-landscaped lot, embodies the distinctive features of the period and style: a cubic-massed main block surmounted by a low-pitched hipped roof with a prominent cupola, picturesquely placed wings and projecting bays, and a profusion of elaborate woodwork such as paired brackets with pendants under the broadly projecting eaves of the roofs and segmentally arched lintels above door and window openings. The significance of this particular property is enhanced by its bucolic setting and three remarkably intact, nineteenth-century outbuildings: two barns (built on cobblestone foundations) and a carriage house. The barns are important illustrations of the agrarian activity that occurred on Page's farm, while the carriage house is a pretentious and finely crafted support structure in the Picturesque tradition. Applied scroll-sawn woodwork, round-arched windows in the front cross-gable and prominent cupola, and saw-tooth woodwork distinguish the carriage house. The property is a clear testimony to the wealth and "good taste" of this prosperous hops farmer.

Other notable examples of relatively sophisticated post Civil War Victorian dwellings include the more restrained Italianate style building at 33 State Street (ca. 1874) and the Eastlake-inspired dwelling at 11 State Street (ca. 1880).

The period of significance defined for the district extends to encompass the first three decades during the twentieth century in order to incorporate several automobile-related resources as well as several examples of the Colonial Revival style remodeling of some of the village's older buildings. With the advent of the automobile, U.S. Route 20 (in East Bloomfield, a.k.a. State Street) continued to thrive as one of the state's and nation's

United States Department of the Interior
National Park ServiceNATIONAL REGISTER OF HISTORIC PLACES
CONTINUATION SHEET

Section number 8 Page 23

East Bloomfield Historic District
East Bloomfield, Ontario County, NY

primary east-west thoroughfares, much as it had during the eighteenth and nineteenth centuries (despite competition from the Erie Canal and rail transportation.) The widespread availability and affordability of the the automobile revolutionized the tourist industry by allowing tremendous flexibility in personal travel. Old inn, hotels and restaurants along Route 20 in New York flourished and new ones were constructed to take advantage of the increased influx of passersby. The Holloway House in East Bloomfield illustrates this pattern: converted back into a fashionable restaurant in 1910, the inn prospered for many decades (and still does) as a popular roadside attraction catering to "tourists" as well as to the local population. The inn was also "modernized" during the early twentieth century with the addition of a veneer of Colonial Revival style ornamentation, thus illustrating the popular building tradition of upgrading "old-fashioned" buildings into newer, more stylistically fashionable structures. Other examples of this trend include the addition of porches or verandahs to dwellings as seen, for example on the Henry W. Hamlin House at 9 State Street or the United Methodist Parsonage at 16 State Street.

Major new construction in East Bloomfield was virtually non-existent. Most new building activity occurred in the adjacent village of Holcomb. There were, however, a number of new garages built in East Bloomfield in response to the increasing number of automobiles purchased by village residents. Many are simple frame structures, some with restrained Colonial Revival style-inspired design features; all are representative examples of typical methods of construction, design, materials and craftsmanship employed in the execution of early twentieth century domestic dependencies in the region. In addition, all are graphic illustrations of new, "modern" modes of transportation during the early twentieth century.

United States Department of the Interior
National Park Service
NATIONAL REGISTER OF HISTORIC PLACES
CONTINUATION SHEET
Section number 9 Page 1
East Bloomfield Historic District
East Bloomfield, Ontario County, New York

Major Bibliographical Sources

- Armstrong, Kenneth. Early Agriculture of East Bloomfield.
East Bloomfield, NY. 1976.
- Bloomfield Bicentennial Committee. A Bicentennial Sketchbook
of Bloomfield, New York 1789-1976. Case-Sales, Corp.,
1976.
- Buell, Frederick. Early History of the Town of East Bloomfield.
East Bloomfield, NY. 1907.
- Canandaigua, New York. Ontario County Courthouse. Deed
Records.
- East Bloomfield, New York. East Bloomfield Historical Society
Records.
- East Bloomfield, New York. The One Hundredth Anniversary of
the Dedication of St. Bridget's Church 1875-1975.
Rochester, NY: Christopher Press Inc. 1975.
- Hamlin, Frank. Memoirs of Frank Harwood Hamlin. East
Bloomfield,
NY. 1917.
- Hopewell, New York. Ontario County Archives Records. Liber 2.
- Kendall, Henry, Rev. The Times of Old. Rochester, NY: A.
Strong & Co., 1852.
- McIntosh, W.H. History of Ontario County, New York 1788-1876.
Philadelphia, Penna. J.B. Lippincott & Co. 1876;
Reprint: Ovid, NY: W.E. Morrison & Co. 1976.
- Melish, John. Travels through the United States of America.
1811.
- Milliken, Charles. A History of Ontario County, New York.
Vol. 2; NY: Lewis
- Ontario County Times. Article from the Gazeteer of New York.
1813. Canandaigua, New York. 1950.
- Turner, O. History of the Phelps and Gorham Purchase and
Morris Reserve. Rochester, NY: William Alling, 1851;
Reprint: Geneseo, NY: James Brunner, 1976.

United States Department of the Interior
National Park Service

NATIONAL REGISTER OF HISTORIC PLACES
CONTINUATION SHEET

Section number 10 Page 1

East Bloomfield Historic District
East Bloomfield, Ontario County, New York

Item 10. Geographical Data:

Approximately 46 acres

UTM Reference points: Victor Quad, zone 18, 1:24,000

A: 301510/4751990
B: 301380/4751500
C: 301290/4751500
D: 300970/4751820
E: 300860/4751990
F: 300860/4752070
G: 301160/4752070
H: 301350/4752160

United States Department of the Interior
National Park Service

NATIONAL REGISTER OF HISTORIC PLACES
CONTINUATION SHEET

Section number 11 Page 1

East Bloomfield Historic District
East Bloomfield, Ontario County, New York

Preliminary research prepared by:

Mrs. Virginia Schroeder
Historical Society of the Town of East Bloomfield
10 State Street
Holcomb, New York 14469

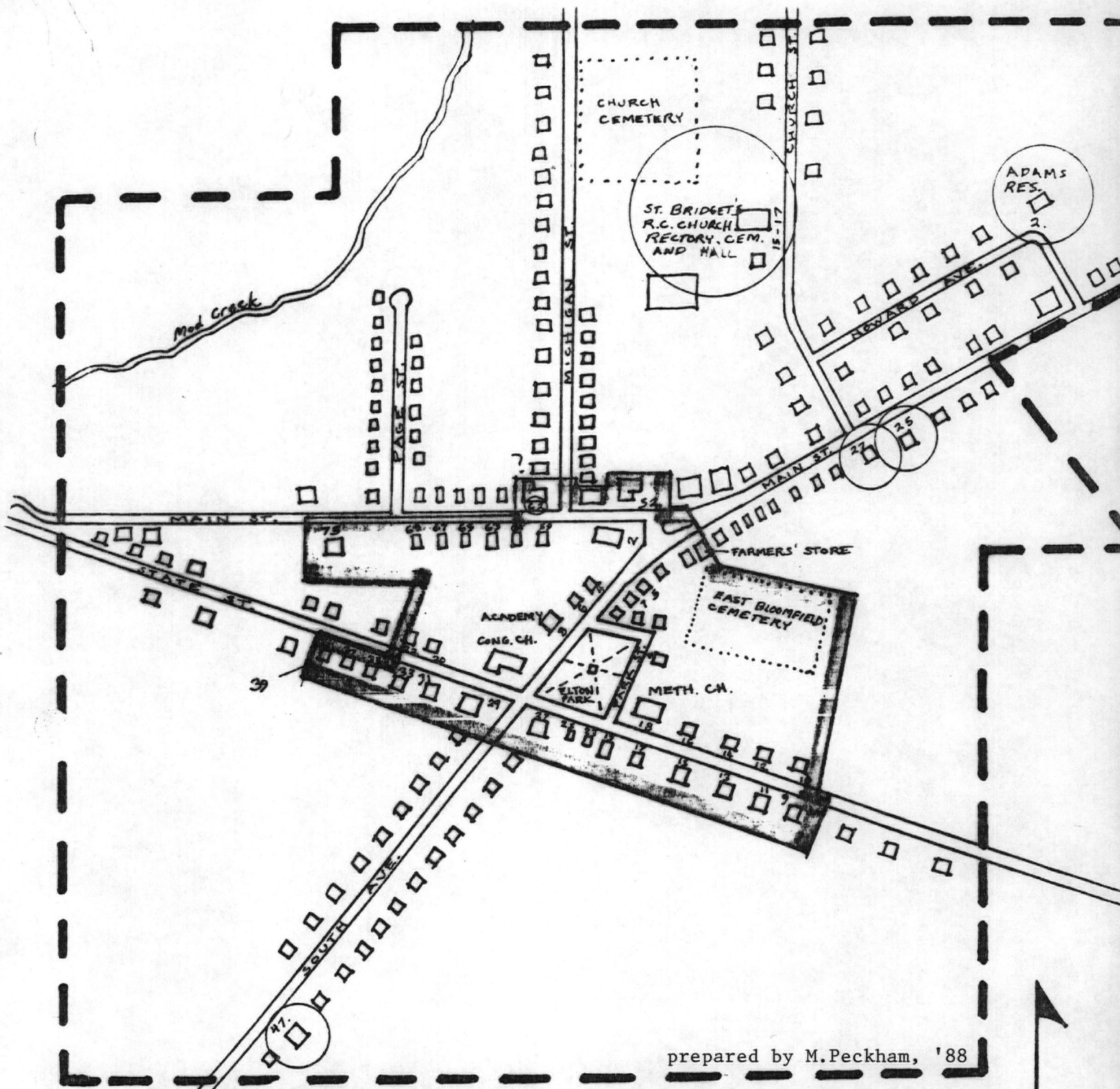

prepared by M. Peckham, '88

Attachment A: 1988 Intensive level survey map
 VILLAGE OF EAST BLOOMFIELD, Ontario Co.
 1988 HISTORIC RESOURCES SURVEY
 (NOT DRAWN TO SCALE)

LEGEND

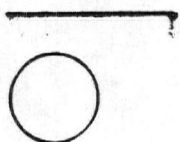

RECOMMENDED HISTORIC DISTRICT BOUNDARY
 Heavy dotted line defines village boundary
 POTENTIALLY ELIGIBLE INDIVIDUAL PROPERTIES

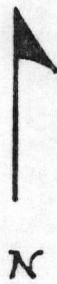

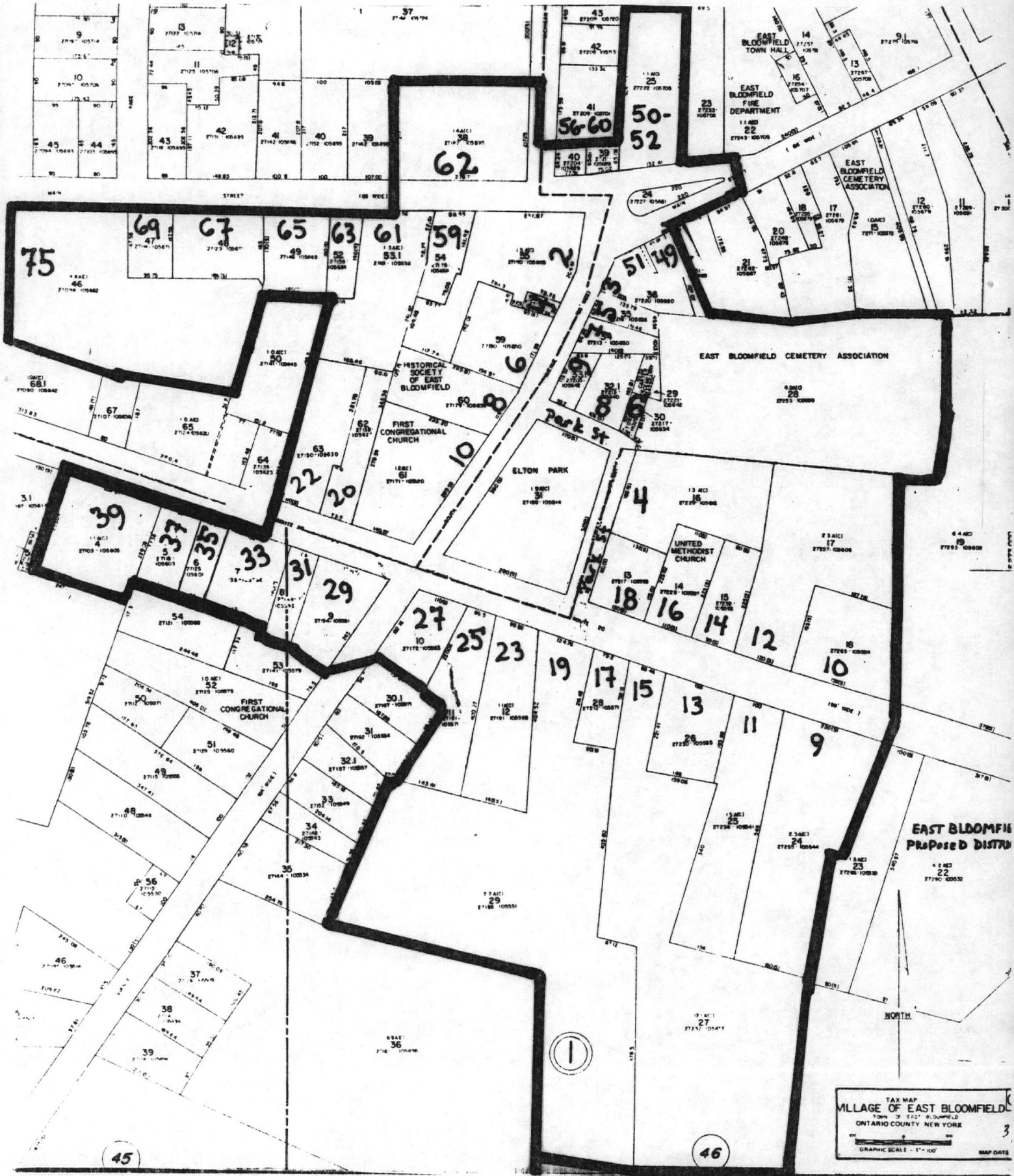

Site map, derived from local tax maps; heavy black outline defines boundary of nominated district; boundary follows legal lot lines of nominated village parcels.

EAST BLOOMFIELD HISTORIC DISTRICT

EAST BLOOMFIELD, ONTARIO COUNTY, NY

Scale: 1" = approx. 200'

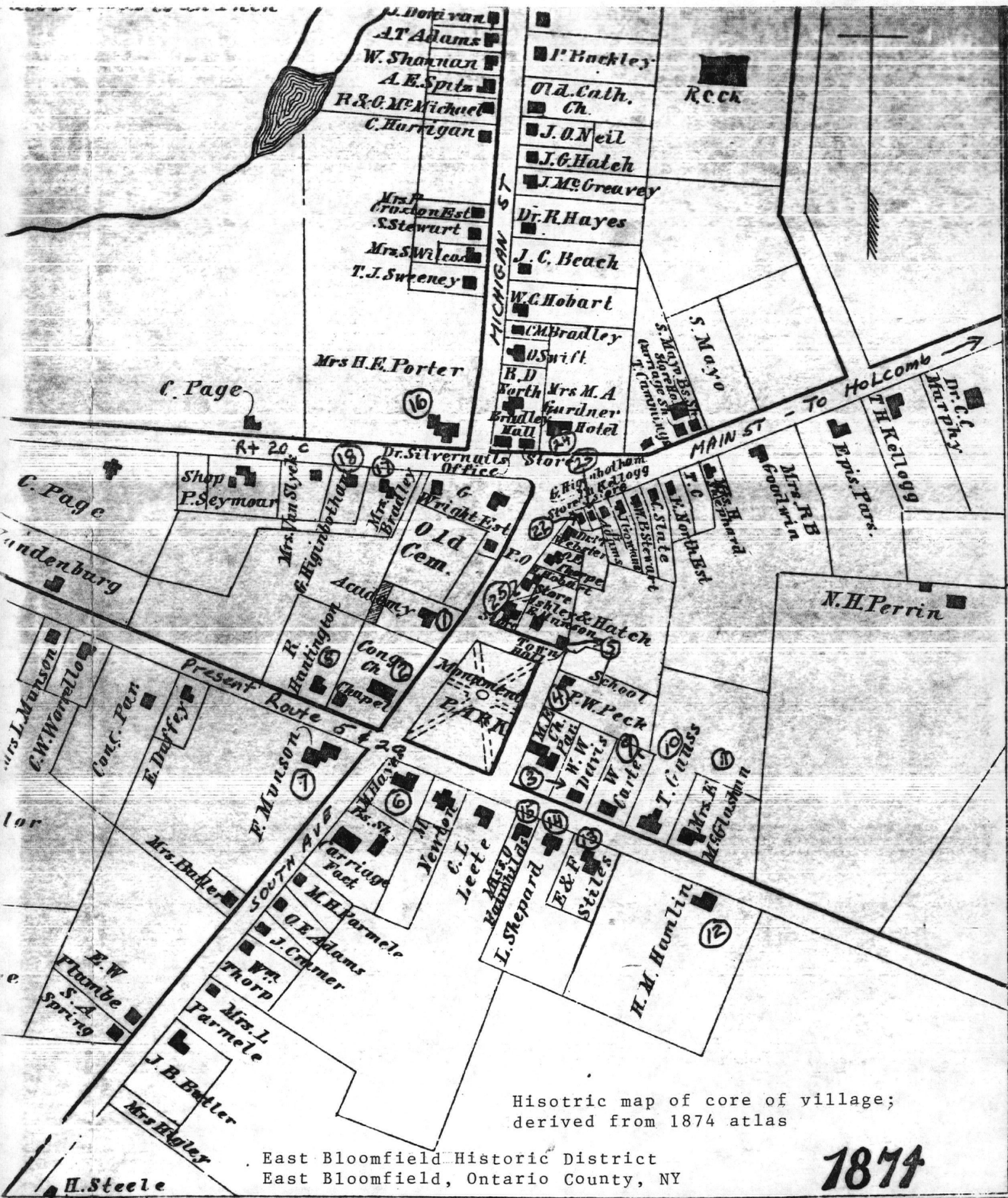

Historic map of core of village;
 derived from 1874 atlas

East Bloomfield Historic District
 East Bloomfield, Ontario County, NY

1874

UNITED STATES DEPARTMENT OF THE INTERIOR
NATIONAL PARK SERVICE

NATIONAL REGISTER OF HISTORIC PLACES
EVALUATION/RETURN SHEET

REQUESTED ACTION: NOMINATION

PROPERTY East Bloomfield Historic District
NAME:

MULTIPLE
NAME:

STATE & COUNTY: NEW YORK, Ontario

DATE RECEIVED: 10/10/89 DATE OF PENDING LIST: 10/25/89
DATE OF 16TH DAY: 11/10/89 DATE OF 45TH DAY: 11/24/89
DATE OF WEEKLY LIST:

REFERENCE NUMBER: 89001947

NOMINATOR: STATE

REASONS FOR REVIEW:

APPEAL: N DATA PROBLEM: N LANDSCAPE: Y LESS THAN 50 YEARS: N
OTHER: N PDIL: N PERIOD: N PROGRAM UNAPPROVED: N
REQUEST: N SAMPLE: N SLR DRAFT: N NATIONAL: N

COMMENT WAIVER: N

ACCEPT RETURN REJECT 11/13/89 DATE

Entered in the
National Register

ABSTRACT/SUMMARY COMMENTS:

RECOM./CRITERIA _____
REVIEWER _____
DISCIPLINE _____
DATE _____

DOCUMENTATION see attached comments Y/N see attached SLR Y/N

CLASSIFICATION

count resource type

STATE/FEDERAL AGENCY CERTIFICATION

FUNCTION

historic current

DESCRIPTION

architectural classification
 materials
 descriptive text

SIGNIFICANCE

Period Areas of Significance--Check and justify below

Specific dates Builder/Architect
Statement of Significance (in one paragraph)

summary paragraph
 completeness
 clarity
 applicable criteria
 justification of areas checked
 relating significance to the resource
 context
 relationship of integrity to significance
 justification of exception
 other

BIBLIOGRAPHY

GEOGRAPHICAL DATA

acreage verbal boundary description
 UTM's boundary justification

ACCOMPANYING DOCUMENTATION/PRESENTATION

sketch maps USGS maps photographs presentation

OTHER COMMENTS

Questions concerning this nomination may be directed to

_____ Phone _____

Signed _____ Date _____



East Bloomfield Historic District
East Bloomfield, Ontario County

Photo: N Todd, J. Altemus, 1989

Neg: OPRHP, Albany

View: Congregational Church
State St, looking west



East Bloomfield Historic District
East Bloomfield, Ontario County

Photo: NTodd, J. Altemus, 1989

NEG: OPRHP, Albany

View 2: Elton Park, looking northwest
with Civil War monument in
foreground and East Bloomfield
Academy in background

East Bloomfield Historic District
East Bloomfield, Ontario County
Photo: N Todd, J. Altemus, 1989
Neg: OPRHP, Albany

View 3: Cairn dedicated to the Seneca
Indian village of Gandougarae;
Elton Park, looking northwest
with Congregational Church
and Academy in background



East Bloomfield Historic District
East Bloomfield, Ontario County
Photo: N Todd, J. Altemus, 1989
Neg: OPRHP, Albany

View 4: Commemorative arch;
south edge of Elton Park



East Bloomfield Historic District

East Bloomfield, Ontario County

Photo: N. Todd, 1989

Neg: OPRHP, Albany

View 5: Methodist church, with 17
State Street in the background;
looking southeast



WEIGHT
LIMIT
7
TONS

East Bloomfield Historic District
East Bloomfield, Ontario County

Photo: N Todd, 1989

Neg: OPRHP, Albany

View 6: Methodist Church (foreground)
and former Town Hall (background);
looking north along Park Street



East Bloomfield Historic District
East Bloomfield, Ontario County

Photo: N Todd, 1989

Neg: OPRHP, Albany

Photo 7: 9 State Street



East Bloomfield Historic District
East Bloomfield, Ontario Co.
Photo: N. Todd, 1989
Neg: OPEHP, Albany
View 8: 11, 13, 15 State St



SPEED
LIMIT
35

East Bloomfield Historic District
East Bloomfield, Ontario Co.

Photo: N. Todd, 1989

Neg: OPRHP, Albany

View 9: 17, 19 State St



East Bloomfield Historic District
East Bloomfield, Ontario County
Photo: N. Todd, 1989

Neg: OPEHP, Albany

View 10: 23, 25, 27 State St



The
Holloway
House,
1802
DINNERS
An Old-Fashioned

V
CHECKED LODGING
IN BOSTON 1938



East Bloomfield Historic District

East Bloomfield, Ontario County

Photo: N Todd, 1989

Neg: OPRHP, Albany

View 11: Holloway Inn
29 State St



East Bloomfield Historic District
East Bloomfield, Ontario Co.

Photo: N. Todd, 1989

Neg: OPRHP, Albany

View 12: 29, 31, 33 State St



East Bloomfield Historic District
East Bloomfield, Ontario County
Photo: N Todd, J. Altemus, 1989
Neg: OPRHP, Albany
View 13: 10, 12 State St.



East Bloomfield Historic District
East Bloomfield, Ontario County

Photo: N. Todd, J. Altemus, 1989

Neg: OPRHP, Albany

View 14: 14 State St



East Bloomfield Historic District
East Bloomfield, Ontario County

Photo: N Todd, 1989

Neg: OPRHP, Albany

View 15: 10, 12, 14 State St.



East Bloomfield Historic District
East Bloomfield, Ontario County
Photo: N Todd, J. Altemus, 1989
Neg: OPRHP, Albany
View 16: 16 State Street



East Bloomfield Historic District

East Bloomfield, Ontario County

Photo: N Todd, J. Altmus, 1989

Neg: DPRHP, Albany

View: 17: Congregational Church Lecture Hall
and #20 and #22 State Street



East Bloomfield Historic District
East Bloomfield, Ontario County
Photo: N Todd, J. Altemus, 1989
Neg: OPRHP, Albany
View 18: 22 State St.



East Bloomfield Historic District
East Bloomfield, Ontario County
Photo: N. Todd, J. Altemus, 1989
Neg: OPRHP, Albany
View 19: 4 and 2 South Ave.

WALTER W. W. W. W. W.
DIED
FEBRUARY 25, 1875
AGED 67 YEARS
BORN
MAY 10, 1808

SARAH
WIFE OF BENJAMIN
CAUSS
DIED
MAY 21, 1847.

BENJAMIN CAUSS,
DIED
OCTOBER 5, 1854
AGED 89 YEARS.

*This individual was a soldier
of the Revolution and one
of the first settlers of this
country.*

1845

1845

East Bloomfield Historic District
East Bloomfield, Ontario County

Photo: N Todd, J. Altemus, 1989

Neg: OPRHP, Albany

View 20: East Bloomfield Cemetery

LOT RUE
Died Nov. 28, 1843.
Aged 69.

PATIENCE
Wife of
Lot Rue.
Died Sep. 18, 1847.
Aged 87.

MARIA WELLS
Lady
June 26,
1851.
Aged 40 yrs.

W. B. WINGFIELD
Died Dec 23, 1851.
Aged 57 yrs.

EVERT
Died April 18, 1851.
Aged 70 yrs.

ALMAREW
DIED
Aug. 14, 1862.
Aged 64 yrs.

East Bloomfield Historic District
East Bloomfield, Ontario County
Photo: N. Todd, 1989

Neg. OPRHF, Albany
View 21: East Bloomfield Cemetery



East Bloomfield Historic District
East Bloomfield, Ontario County
Photo: M Todd, J. Altemus, 1989
Neg: OPRHP, Albany
View: 22 : #8 Park St



Parkside
PIZZA
RESTAURANT

East Bloomfield Historic District
East Bloomfield, Ontario County

Photo: NTodd, J. Altmus, 1989

Neg: OPRHP, Albany, ny

View 23: 9 - 3 South Ave, looking
north; East Bloomfield Inn
in background



A black and white photograph of a street scene. On the left, a two-story white building is identified as the United States Post Office for East Bloomfield, New York. The building has a sign with the text "UNITED STATES POST OFFICE" and "EAST BLOOMFIELD, NEW YORK 14443". An American flag is flying on a pole in front of the building. A light-colored sedan is parked in front of the post office. To the right of the post office is a larger, two-story white house with a gabled roof and dark shutters. A dark minivan is parked in front of this house. Further to the right is a smaller, single-story house with a gabled roof and dark shutters. The background consists of bare trees and utility lines. The foreground is a paved street.

UNITED STATES POST OFFICE
EAST BLOOMFIELD, NEW YORK 14443

East Bloomfield Historic District
East Bloomfield, Ontario County

Photo: N Todd, J. Altemus, 1989

Neg: OPR40, Albany

View 24: 3, 5 South Ave, looking
south



ANTIQUES

UNITED STATES POST OFFICE
EAST BLOOMFIELD, NEW YORK 144

East Bloomfield Historic District
East Bloomfield, Ontario County

Photo: N. Todd, J. Altemus, 1989

Neg: OPHF, Albany

View 25: 49 (former Farmers Coop)
and 51 main st.



East Bloomfield Historic District
East Bloomfield, Ontario County

Photo: N. Todd, J. Altamus, 1989

Neg: OPRHP, Albany ny

View 26: 56-60 (Bradley Block)

and 50-52 (East Bloomfield Inn)

Main Street



East Bloomfield Historic District
East Bloomfield, Ontario County
Photo: N. Todd, & Altemus, 1989
neg: OPRHP, Albany ny
View 27: 62 W. main St.



East Bloomfield Historic District
East Bloomfield, Ontario County
Photo: N. Todd, J. Altman, 1989
Neg: OPRHP, Albany
View: 28: 61 W. Main St.



East Bloomfield Historic District
East Bloomfield, Ontario County

Photo: N. Todd, J. Altemus, 1989

Neg: OPRHP, Albany

View 29: 63 & 65 W. Main St.;
looking southwest



East Bloomfield Historic District
East Bloomfield, Ontario County
Photo: N. Todd, J. Altemus, 1989
Neg: OPRHP, Albany
Photo 30: 67 & 69 W. Main St.,
looking west



East Bloomfield Historic District
East Bloomfield, Ontario County
Photo: N Todd, J. Altschus, 1989
Neg: OPRHP, Albany ny
View 31: 69 & 75 W. main St.
looking southwest



East Bloomfield Historic District
East Bloomfield, Ontario County
Photo: N. Todd, J. Altman, 1989
Neg: OREHP, Albany NY
View: 32:75 w. main St.

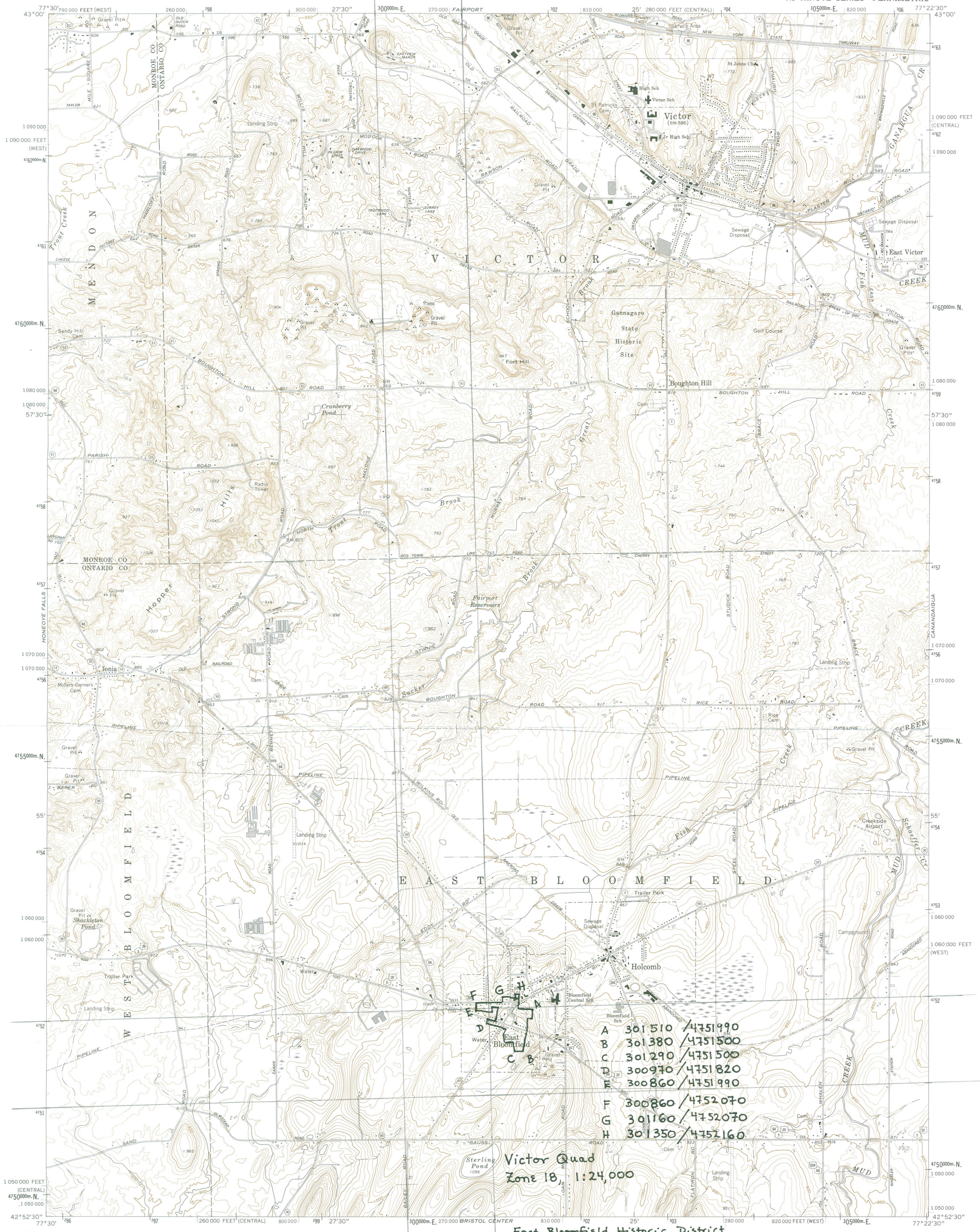

Victor Quad
Zone 18, 1:24,000
East Bloomfield, Ontario District
East Bloomfield, Ontario County ny

Prepared and published in 1979 by the New York State Department of Transportation, in cooperation with the U.S. Department of Transportation, Federal Highway Administration.
Map base from 1978 U.S. Geological Survey 7.5-minute quadrangle.
Map revisions made using 1977 aerial photography, construction plans, official records and other sources. Features revised include: highways and other transportation facilities; civil boundaries; recreation sites; hydrography; and buildings. Grey tint indicates intensely developed areas in which only landmark buildings are shown.
Revisions may not comply with National Map Accuracy Standards.
Correspondence concerning this and other maps of the Department of Transportation should be directed to: Map Information Unit, New York State Department of Transportation, State Campus, Albany, New York 12232.
1979 revisions by C. S. Conover

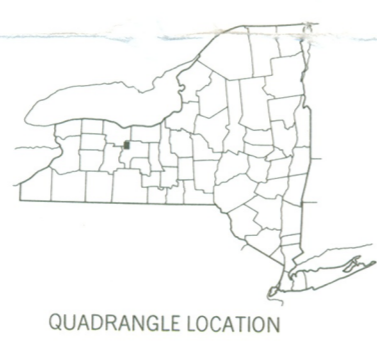

10,000-foot ticks based on the New York Plane Coordinate grid, Central and West Zones.
Magnetic declination for 1979 is approximately 10° West
SPECIAL TOPOGRAPHIC EDITION
Contours, at 10-foot intervals, shown unrevised from 1971 U.S. Geological Survey map. Datum is mean sea level.

INDEX TO 1:9600 (1" = 800') MAP COVERAGE

BOUNDARIES:	State.....	County.....	Town or City.....	Incorporated Village.....
ROADS:	Touring Route markers:	Interstate.....	U. S.	State.....
State Highway number and limit.....	County road.....	Interchange number.....	Divided highways and streets:	Wide mall.....
			Narrow mall or barrier.....	
			Undivided highways and streets:	4 or more lanes.....
			Less than 4 lanes.....	
			Vehicle track; trail.....	

RECEIVED
SEP 06 1989
C
PARKS, RECREATION & HIS. PRES.

65 West Main Street
East Bloomfield, New York
14443
September 1, 1989

SEP 6 1989

New York State Office of Parks, Recreation and Historic Preservation
Agency Building 1
Albany, New York 12238

Dear Commissioner:

Please be advised that we are the rightful owners of the property located at 65 West Main Street in the Village of East Bloomfield, state of New York and please be advised that we do not want to be considered for your listing of property with the National Register.

Sincerely,

Percy Gatling
Doris Gatling

Sworn before me this 1st day of September, 1989.

Percy Gatling

Percy Gatling

Doris Gatling

Doris Gatling

Elizabeth Stappenbeck

Elizabeth Stappenbeck

Notary

ELIZABETH STAPPENBECK
Notary Public, State of New York
Ontario County #4765410
Commission Expires Oct 31, 1990

RECEIVED
SEP 6 1989
DEPUTY COMMISSIONER
HISTORIC PRESERVATION