

2514

UNITED STATES DEPARTMENT OF THE INTERIOR  
NATIONAL PARK SERVICE

**NATIONAL REGISTER OF HISTORIC PLACES  
INVENTORY -- NOMINATION FORM**

FOR FEDERAL PROPERTIES

FOR NPS USE ONLY  
RECEIVED **OCT 05 1988**  
DATE ENTERED

SEE INSTRUCTIONS IN *HOW TO COMPLETE NATIONAL REGISTER FORMS*  
TYPE ALL ENTRIES -- COMPLETE APPLICABLE SECTIONS

**1 NAME** United States Post Offices in New York State -- 1858-1943 --  
HISTORIC Thematic Resources  
United States Post Office, Ithaca, Tompkins County  
AND/OR COMMON  
Ithaca Post Office

**2 LOCATION**

STREET & NUMBER  
213 N. Tioga Street  
CITY, TOWN Ithaca  
STATE New York  
VICINITY OF  
COUNTY Tompkins  
CODE 036  
CONGRESSIONAL DISTRICT  
CODE 109

**3 CLASSIFICATION**

CATEGORY	OWNERSHIP	STATUS	PRESENT USE	
<input type="checkbox"/> DISTRICT	<input checked="" type="checkbox"/> PUBLIC	<input checked="" type="checkbox"/> OCCUPIED	<input type="checkbox"/> AGRICULTURE	<input type="checkbox"/> MUSEUM
<input checked="" type="checkbox"/> BUILDING(S)	<input type="checkbox"/> PRIVATE	<input type="checkbox"/> UNOCCUPIED	<input type="checkbox"/> COMMERCIAL	<input type="checkbox"/> PARK
<input type="checkbox"/> STRUCTURE	<input type="checkbox"/> BOTH	<input type="checkbox"/> WORK IN PROGRESS	<input type="checkbox"/> EDUCATIONAL	<input type="checkbox"/> PRIVATE RESIDENCE
<input type="checkbox"/> SITE	<b>PUBLIC ACQUISITION</b>	<b>ACCESSIBLE</b>	<input type="checkbox"/> ENTERTAINMENT	<input type="checkbox"/> RELIGIOUS
<input type="checkbox"/> OBJECT	IN PROCESS	<input checked="" type="checkbox"/> YES: RESTRICTED	<input checked="" type="checkbox"/> GOVERNMENT	<input type="checkbox"/> SCIENTIFIC
	BEING CONSIDERED	<input type="checkbox"/> YES: UNRESTRICTED	<input type="checkbox"/> INDUSTRIAL	<input type="checkbox"/> TRANSPORTATION
		<input type="checkbox"/> NO	<input type="checkbox"/> MILITARY	<input type="checkbox"/> OTHER:

**4 AGENCY**

REGIONAL HEADQUARTERS: (If applicable)  
United States Postal Service, Northeast Region, F.R.E.B.O.  
STREET & NUMBER  
90 Church Street  
CITY, TOWN New York  
VICINITY OF  
STATE NY

**5 LOCATION OF LEGAL DESCRIPTION**

COURTHOUSE.  
REGISTRY OF DEEDS, ETC. Tompkins County Courthouse  
STREET & NUMBER  
320 N. Tioga Street  
CITY, TOWN Ithaca  
STATE NY

**6 REPRESENTATION IN EXISTING SURVEYS**

TITLE Statewide Inventory of Historic Resources  
United States Postal Service Inventory  
DATE 1978/1986  
X FEDERAL X STATE \_\_\_ COUNTY \_\_\_ LOCAL  
DEPOSITORY FOR SURVEY RECORDS New York State Office of Parks, Recreation and Historic Preservation  
CITY, TOWN Albany  
STATE NY

# 7 DESCRIPTION

CONDITION		CHECK ONE	CHECK ONE
<input type="checkbox"/> EXCELLENT	<input type="checkbox"/> DETERIORATED	<input type="checkbox"/> UNALTERED	<input checked="" type="checkbox"/> ORIGINAL SITE
<input checked="" type="checkbox"/> GOOD	<input type="checkbox"/> RUINS	<input checked="" type="checkbox"/> ALTERED	<input type="checkbox"/> MOVED      DATE _____
<input type="checkbox"/> FAIR	<input type="checkbox"/> UNEXPOSED		

DESCRIBE THE PRESENT AND ORIGINAL (IF KNOWN) PHYSICAL APPEARANCE

The Ithaca Post Office is located on the southeast corner of North Tioga Street and East Buffalo Street within the DeWitt Park Historic District (National Register listed 1971) in the city of Ithaca, Tompkins County, New York. The building is sited one block from the central business district and is in an area with a variety of important public and commercial buildings. The site is modestly landscaped on the west and north sides and has a driveway on the south side and large parking area on the east side. The building retains a high degree of integrity; the exterior of the original building remains almost exactly as it looked when completed and interior alterations are primarily of a relatively minor nature. The nomination includes one contributing building.

The post office is a one and one-half story building with a five-bay facade facing onto North Tioga Street. The limestone-clad building rests on a granite base. It has five arched openings on the front elevation that are separated by paired engaged Ionic columns; there are single columns at each end of the window ensemble. The central opening is the main entrance to the building. This entrance is reached via a flight of granite steps. The rectangular entrance with modern doors is surrounded by a carved molding and is topped by an entablature with a bracketed cornice. Above this entrance enframingent is a semicircular window with an ornate iron grille. The openings that flank the entrance have metal mullions that divide each opening into three double-hung sash windows topped by a tripartite fanlight. Each window arch is framed by a carved molding and each has a keystone in the form of a console bracket. At the ends of the front facade are rusticated limestone piers. A frieze with heavy carved panels and a bracketed cornice crowned by a balustrade complete the design of the main elevation. Arched dormer windows are partially visible behind the balustrade. The north and south facades of the post office are three bays wide with the bays separated by piers. There are three windows on the south facade and two windows and a secondary entrance on the north facing East Buffalo Street. Both entrance steps are flanked by modern lamp posts resting on granite pedestals. A five-bay brick extension (1935-6) projects to the east and is visible along East Buffalo Street. The addition is compatible with the earlier design and is a contributing feature of the nomination. Slightly recessed from the original building, it has simple stone keystones. The windows are flanked by brick piers and a simple limestone beltcourse runs across the building above the keystone level. The extension is crowned by a brick parapet. Behind this extension is a partially enclosed platform added in 1965 which does not contribute to the significance of the property. The addition extends around the south side of the 1936 extension.

**United States Department of the Interior  
National Park Service**

**National Register of Historic Places  
Inventory—Nomination Form**

For NPS use only

received

date entered

Ithaca Post Office, Ithaca, New York, Tompkins County

Continuation sheet

Item number

7

Page 2

The main entrance to the post office is through a modern aluminum vestibule which probably replaces an original vestibule. The monumental public lobby occupies four of the five bays of the main front and the three bays of the north facade. The postmaster's office and other offices are located along the south wall and the mail room occupies the remainder of this floor. The lobby has a ribbed barrel-vaulted ceiling with coffered transverse ribs. The walls are covered with green-veined white marble and are demarcated by pilasters from which the transverse arches spring. The baseboards are of green marble and the floors are of terrazzo with pink, grey, and white marble insets. The entrance to the postmaster's office has a marble surround with a cornice resting on carved brackets. The Art Deco style lamps date from the 1930s. The present screenline, aluminum vestibule, aluminum and glass partitions, and lockboxes are all modern additions.

# 8 SIGNIFICANCE

PERIOD	AREAS OF SIGNIFICANCE -- CHECK AND JUSTIFY BELOW			
<input type="checkbox"/> PREHISTORIC	<input type="checkbox"/> ARCHEOLOGY-PREHISTORIC	<input type="checkbox"/> COMMUNITY PLANNING	<input type="checkbox"/> LANDSCAPE ARCHITECTURE	<input type="checkbox"/> RELIGION
<input type="checkbox"/> 1400-1499	<input type="checkbox"/> ARCHEOLOGY-HISTORIC	<input type="checkbox"/> CONSERVATION	<input type="checkbox"/> LAW	<input type="checkbox"/> SCIENCE
<input type="checkbox"/> 1500-1599	<input type="checkbox"/> AGRICULTURE	<input type="checkbox"/> ECONOMICS	<input type="checkbox"/> LITERATURE	<input type="checkbox"/> SCULPTURE
<input type="checkbox"/> 1600-1699	<input checked="" type="checkbox"/> ARCHITECTURE	<input type="checkbox"/> EDUCATION	<input type="checkbox"/> MILITARY	<input type="checkbox"/> SOCIAL/HUMANITARIAN
<input type="checkbox"/> 1700-1799	<input type="checkbox"/> ART	<input type="checkbox"/> ENGINEERING	<input type="checkbox"/> MUSIC	<input type="checkbox"/> THEATER
<input type="checkbox"/> 1800-1899	<input type="checkbox"/> COMMERCE	<input type="checkbox"/> EXPLORATION/SETTLEMENT	<input type="checkbox"/> PHILOSOPHY	<input type="checkbox"/> TRANSPORTATION
<input checked="" type="checkbox"/> 1900-	<input type="checkbox"/> COMMUNICATIONS	<input type="checkbox"/> INDUSTRY	<input checked="" type="checkbox"/> POLITICS/GOVERNMENT	<input type="checkbox"/> OTHER (SPECIFY)
		<input type="checkbox"/> INVENTION		

SPECIFIC DATES 1909-1910; 1935-6 BUILDER/ARCHITECT James Knox Taylor

## STATEMENT OF SIGNIFICANCE

The Ithaca Post Office is architecturally significant as an outstanding example of classically inspired public architecture in New York State. Built in 1909-10 and extended in 1936, the building is an extremely sophisticated adaptation of late seventeenth century French Baroque architecture and is distinguished by its paired engaged Ionic columns, monumental arched bays and highly ornamented frieze. The post office is a superb representation of the skills of James Knox Taylor, one of the most talented architects to hold the position of Supervising Architect of the Treasury, who was responsible for some of the most distinguished post office designs in New York State. The building reflects the return to classical and Renaissance architectural forms in federal buildings (as opposed to the more eclectic Romanesque forms popular in the late nineteenth century) that was instituted by Taylor. Its sophisticated design most closely relates to two other post offices which Taylor designed for important cities in New York State and which are included in the nomination; Schenectady Post Office (1911-13) and Niagara Falls Post Office (1906-8). Retaining its integrity to a high degree, the Ithaca Post Office continues to be an important symbol of the ideals of the federal government in the city of Ithaca.

Ithaca, the county seat of Tompkins County, New York, was first settled by Europeans in the late eighteenth century. The community grew in the early nineteenth century due to its location on Lake Cayuga and its position on the Catskill Turnpike which ran between Bath and Catskill. The growth of local industries and the founding of Cornell University in 1865 gave impetus to the city's growth. By the late nineteenth century Ithaca had become one of the major cities in central New York.

The first postal station in Ithaca was established in 1804, but it was not until over a century later that a permanent post office building was erected in the city. In 1902, Congress authorized the construction of the Ithaca Post Office, but construction did not begin until 1909. The post office site was occupied by a residence and outbuildings in the nineteenth century but was vacant by 1900. Adjacent to the south was the Ithaca City

# 9 MAJOR BIBLIOGRAPHICAL REFERENCES

See cover form and attachment

## 10 GEOGRAPHICAL DATA

ACREAGE OF NOMINATED PROPERTY less than one acre

UTM REFERENCES

A	1	8	3	76	91	0	4	6	99	62	0
	ZONE		EASTING			NORTHING					

B											
	ZONE		EASTING			NORTHING					

VERBAL BOUNDARY DESCRIPTION

See attached site map

LIST ALL STATES AND COUNTIES FOR PROPERTIES OVERLAPPING STATE OR COUNTY BOUNDARIES

STATE	CODE	COUNTY	CODE
NA			
STATE	CODE	COUNTY	CODE
NA			

## 11 FORM PREPARED BY See also continuation sheet

NAME/TITLE Larry E. Gobrecht

National Register and Survey Coordinator

ORGANIZATION New York State Office of Parks, Recreation and Historic Preservation, Field Services Bureau DATE July 1986

STREET & NUMBER

Empire State Plaza, Agency Building One

TELEPHONE

(518) 474-0479

CITY OR TOWN

Albany

STATE

NY

## 12 CERTIFICATION OF NOMINATION

STATE HISTORIC PRESERVATION OFFICER RECOMMENDATION

YES

NO

NONE

STATE HISTORIC PRESERVATION OFFICER SIGNATURE

In compliance with Executive Order 11593, I hereby nominate this property to the National Register, certifying that the State Historic Preservation Officer has been allowed 90 days in which to present the nomination to the State Review Board and to evaluate its significance. The evaluated level of significance is State National  State  Local .

FEDERAL REPRESENTATIVE SIGNATURE

*William J. ...*

TITLE

Historic Preservation Coordinator

DATE

5/11/88

FOR NPS USE ONLY

I HEREBY CERTIFY THAT THIS PROPERTY IS INCLUDED IN THE NATIONAL REGISTER

DATE

DIRECTOR, OFFICE OF ARCHEOLOGY AND HISTORIC PRESERVATION

ATTEST:

*Beth J. Savage*

DATE

5-11-89

KEEPER OF THE NATIONAL REGISTER

**United States Department of the Interior  
National Park Service**

**National Register of Historic Places  
Inventory—Nomination Form**

Ithaca Post Office, Ithaca, New York, Tompkins County  
Continuation sheet

Item number

8

Page 2

For NPS use only

received

date entered

Hall and Annex (demolished in the 1960s).

The Ithaca Post Office was a major design of Supervising Architect of the Treasury Department James Knox Taylor (1857-1929). Taylor was born in Knoxville, Illinois and studied architecture at M.I.T. and with Cass Gilbert. Like his teacher, Taylor did not study at L'Ecole des Beaux-Arts in Paris, but as with Gilbert, his work is imbued with a Beaux-Arts spirit. Taylor worked in St. Paul and Philadelphia before entering the office of the Supervising Architect in 1895. He served as Supervising Architect of the Treasury Department from 1897 until 1912. It was under his leadership that classical and Renaissance design became the source of federal architectural projects. Prior to Taylor's appointment to the Treasury, most buildings designed by the supervising architect's office had been in the Romanesque Revival style. Influenced by the teachings of the Ecole des Beaux-Arts in Paris, Taylor established the hegemony of classical and Renaissance architecture for Federal projects. This is particularly evident in the large number of post offices he designed all across America. Most of these buildings were erected following the passage of the Public Buildings Omnibus Acts of 1902 and 1908, which allowed the authorization of large numbers of federal buildings under a single legislative bill. The Ithaca Post Office was one of eight New York State post offices authorized under the 1902 act. Among the other post offices designed by Taylor which are part of this nomination are those in Niagara Falls, Schenectady, Geneva, Lockport, Little Falls, Hudson, Penn Yan, Corning and Olean. For larger, or more important, cities such as Niagara Falls, Schenectady and Ithaca, Taylor was able to use his more sophisticated designs, which are characterized by stone facades and elaborate ornamentation. For less important cities, such as Little Falls, Penn Yan and Hudson, he used brick for the facades and less elaborate ornamentation.

Taylor's European-inspired federal designs reflect a major current in contemporary architecture and these works show Taylor's "splendid success in keeping abreast with the spirit of the times." The Ithaca Post Office was modeled after one of the great buildings of the French Baroque period--Hardouin-Mansart's Grand Trianon at Versailles (1687). The influence of the Grand Trianon is evident in the post office's symmetrical massing, in the use of tall round-arched windows with console keystones, in the presence of paired Ionic columns between the windows (the Grand Trianon has Ionic pilasters), and in the use of a roof balustrade with paneled pedestals. In 1935-6 a five-bay extension was added to the rear of the building under the direction of Louis Simon, Supervising Architect of the Treasury Department during this period. This extension is simpler than the original building, but its arched windows and piers follow the rhythm established on Taylor's building. The building retains its integrity and continues to be a monument, both to the influence of

**United States Department of the Interior  
National Park Service**

**National Register of Historic Places  
Inventory—Nomination Form**

For NPS use only  
received  
date entered

Ithaca Post Office, Ithaca, New York, Tompkins County

Continuation sheet

Item number

8

Page 3

French architectural ideas on early twentieth century American design  
and to the talents of James Knox Taylor.

Brickholder (1907)

**United States Department of the Interior  
National Park Service**

**National Register of Historic Places  
Inventory—Nomination Form**

Ithaca Post Office, Ithaca, New York, Tompkins County

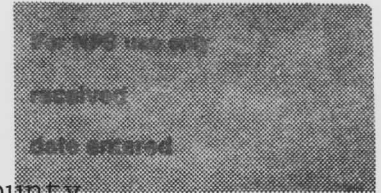

Continuation sheet

Item number

9

Page

2

BIBLIOGRAPHY

Brickbuilder (1907)

Historic Ithaca, Inc. "Historic Ithaca and Tompkins County."  
Ithaca, New York.

Sanborn Map Company. Ithaca. 1893, 1898, 1904, 1910, 1919, 1929,  
1929 updated to 1961.

**United States Department of the Interior  
National Park Service**

**National Register of Historic Places  
Inventory—Nomination Form**

Ithaca Post Office, Ithaca, New York,

Continuation sheet Tompkins County

Item number 11

Page 2

For NPS use only  
received  
date entered

Research and documentation prepared by:

Peter D. Shaver, Consultant  
132 Second Street  
Troy, NY 12180

Edith A. Connor, Consultant  
5 Waverly Place  
Albany, NY 12203

Andrew Dolkart, Consultant  
201 West 92nd Street -- 3F  
New York, NY 10025

UNITED STATES DEPARTMENT OF THE INTERIOR  
NATIONAL PARK SERVICE

NATIONAL REGISTER OF HISTORIC PLACES  
EVALUATION/RETURN SHEET

REQUESTED ACTION: NOMINATION

PROPERTY US Post Office--Ithaca  
NAME:

MULTIPLE US Post Offices in New York State, 1858-1943, TR  
NAME:

STATE & COUNTY: NEW YORK, Tompkins

DATE RECEIVED: 10/05/88 DATE OF PENDING LIST: 10/18/88  
DATE OF 16TH DAY: 11/03/88 DATE OF 45TH DAY: 11/19/88  
DATE OF WEEKLY LIST:

REFERENCE NUMBER: 88002514

NOMINATOR: FEDERAL

REASONS FOR REVIEW:

APPEAL: N DATA PROBLEM: N LANDSCAPE: N LESS THAN 50 YEARS: N  
OTHER: N PDIL: N PERIOD: N PROGRAM UNAPPROVED: N  
REQUEST: N SAMPLE: N SLR DRAFT: N

COMMENT WAIVER: N

ACCEPT  RETURN  REJECT 11/17/88 DATE

ABSTRACT/SUMMARY COMMENTS:

RECOM./CRITERIA Return  
REVIEWER Savage  
DISCIPLINE Arch. History  
DATE 11-17-88

DOCUMENTATION see attached <sup>overall</sup> comments  Y/N see attached SLR Y/N

---

CLASSIFICATION

count       resource type

---

STATE/FEDERAL AGENCY CERTIFICATION

---

FUNCTION

historic       current

---

DESCRIPTION

architectural classification  
 materials  
 descriptive text

---

SIGNIFICANCE

Period      Areas of Significance--Check and justify below

Specific dates      Builder/Architect  
Statement of Significance (in one paragraph)

summary paragraph  
 completeness  
 clarity  
 applicable criteria  
 justification of areas checked  
 relating significance to the resource  
 context  
 relationship of integrity to significance  
 justification of exception  
 other

---

BIBLIOGRAPHY

---

GEOGRAPHICAL DATA

acreage       verbal boundary description  
 UTMs       boundary justification

---

ACCOMPANYING DOCUMENTATION/PRESENTATION

sketch maps       USGS maps       photographs       presentation

---

OTHER COMMENTS

Questions concerning this nomination may be directed to

\_\_\_\_\_ Phone \_\_\_\_\_

Signed \_\_\_\_\_

Date \_\_\_\_\_

UNITED STATES DEPARTMENT OF THE INTERIOR  
NATIONAL PARK SERVICE

NATIONAL REGISTER OF HISTORIC PLACES  
EVALUATION/RETURN SHEET

REQUESTED ACTION: RESUBMISSION

PROPERTY US Post Office--Ithaca  
NAME:

MULTIPLE US Post Offices in New York State, 1858-1943, TR  
NAME:

STATE & COUNTY: NEW YORK, Tompkins

DATE RECEIVED: 3/27/89

DATE OF PENDING LIST:

DATE OF 16TH DAY:

DATE OF 45TH DAY:

5/11/89

DATE OF WEEKLY LIST:

REFERENCE NUMBER: 88002514

NOMINATOR: FEDERAL

DETAILED EVALUATION: Y

ACCEPT  RETURN  REJECT 5/11/89 DATE

ABSTRACT/SUMMARY COMMENTS:

RECOM./CRITERIA

REVIEWER BL SAVAGE

DISCIPLINE \_\_\_\_\_

DATE MAY 11 1989

DOCUMENTATION see attached comments Y/N see attached SLR Y/N

CLASSIFICATION

\_\_\_ count \_\_\_ resource type

STATE/FEDERAL AGENCY CERTIFICATION

FUNCTION

\_\_\_ historic \_\_\_ current

DESCRIPTION

\_\_\_ architectural classification  
\_\_\_ materials  
\_\_\_ descriptive text

SIGNIFICANCE

Period Areas of Significance--Check and justify below

Specific dates Builder/Architect  
Statement of Significance (in one paragraph)

\_\_\_ summary paragraph  
\_\_\_ completeness  
\_\_\_ clarity  
\_\_\_ applicable criteria  
\_\_\_ justification of areas checked  
\_\_\_ relating significance to the resource  
\_\_\_ context  
\_\_\_ relationship of integrity to significance  
\_\_\_ justification of exception  
\_\_\_ other

BIBLIOGRAPHY

GEOGRAPHICAL DATA

\_\_\_ acreage \_\_\_ verbal boundary description  
\_\_\_ UTMs \_\_\_ boundary justification

ACCOMPANYING DOCUMENTATION/PRESENTATION

\_\_\_ sketch maps \_\_\_ USGS maps \_\_\_ photographs \_\_\_ presentation

OTHER COMMENTS

Questions concerning this nomination may be directed to

\_\_\_\_\_ Phone \_\_\_\_\_

Signed \_\_\_\_\_

Date \_\_\_\_\_



NO  
TURN  
ON  
RED

Ithaca Post Office  
213 N. Tioga Street, Ithaca  
Tompkins County, New York State

United States Post Offices in  
New York State --1858-1943--  
Thematic Resources  
Photo: Peter Shaver  
Neg: Division for Historic  
Preservation, Albany, New York

Date: 1986  
View: Main facade, looking southeast  
1 out of 4



Ithaca Post Office  
213 N. Tioga Street, Ithaca  
Tompkins County, New York State

United States Post Offices in  
New York State --1858-1943--  
Thematic Resources  
Photo: Peter Shaver  
Neg: Division for Historic  
Preservation, Albany, New York

Date: 1986  
View: Front entrance  
2 out of 4



NO  
TURN  
ON  
RED

Ithaca Post Office  
213 N. Tioga Street, Ithaca  
Tompkins County, New York State

United States Post Offices in  
New York State --1858-1943--  
Thematic Resources  
Photo: Peter Shaver  
Neg: Division for Historic  
Preservation, Albany, New York

Date: 1986  
View: North elevation, looking south-  
east  
3 out of 4



Ithaca Post Office  
213 N. Tioga Street, Ithaca  
Tompkins County, New York State

United States Post Offices in  
New York State --1858-1943--  
Thematic Resources  
Photo: Peter Shaver  
Neg: Division for Historic  
Preservation, Albany, New York

Date: 1986  
View: Interior, lobby  
4 out of 4



NEW YORK STATE  
DEPARTMENT OF TRANSPORTATION

ITHACA EAST QUADRANGLE  
NEW YORK - TOMPKINS CO.  
7.5 MINUTE SERIES PLANIMETRIC



United States Post Offices in New York State -- 1858-1943 -- Thematic Resources  
Ithaca, Tompkins County, New York  
UTM Reference Points  
Ithaca East Quad, 1:24000, Zone 18  
376910/4699620

Prepared and published in 1978 by the New York State Department of Transportation, in cooperation with the U.S. Department of Transportation, Federal Highway Administration.  
Map base from 1969 U.S. Geological Survey 7.5-minute quadrangle.  
Map revisions made using 1977 aerial photography, construction plans, official records and other sources. Features revised include: highways and other transportation facilities; civil boundaries; recreation sites; hydrography; and buildings. Grey tint indicates intensely developed areas in which only landmark buildings are shown.  
Revisions may not comply with National Map Accuracy Standards.  
Correspondence concerning this and other maps of the Department of Transportation should be directed to: Map Information Unit, New York State Department of Transportation, State Campus, Albany, New York 12232.  
1978 revisions by F. G. Califano



SCALE 1:24000  
1 MILE  
1000 0 1000 2000 3000 4000 5000 6000 7000 FEET  
1 0 1 2 3 4 5 6 7 8 9 10 KILOMETER

Polyconic projection, 1927 North American datum.  
1000-meter ticks based on the New York Transverse Mercator grid.  
Between 72° and 78° West Longitude, the grid is identical to Zone 18 of the Universal Transverse Mercator grid. Areas east of 72° and west of 78° are direct mathematical extensions of Zone 18.  
10,000-foot ticks based on the New York Plane Coordinate grid, Central Zone.  
SPECIAL TOPOGRAPHIC EDITION  
Contours, at 10-foot intervals, shown unrevised from 1969 U.S. Geological Survey map. Datum is mean sea level.

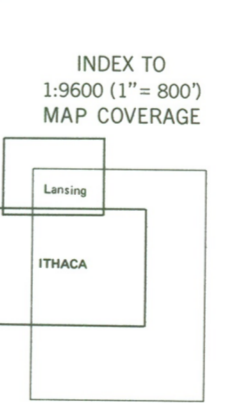

BOUNDARIES:  
State.....  
County.....  
Town or City.....  
Incorporated Village.....

ROADS:  
Touring Route markers:  
Interstate..... (I)  
U. S. .... (U.S.)  
State..... (S)  
State Highway number and limit..... (S)  
County road..... (C)  
Interchange number..... (I)

Divided highways and streets:  
Wide mall.....  
Narrow mall or barrier.....  
Undivided highways and streets:  
4 or more lanes.....  
Less than 4 lanes.....  
Vehicle track; trail.....

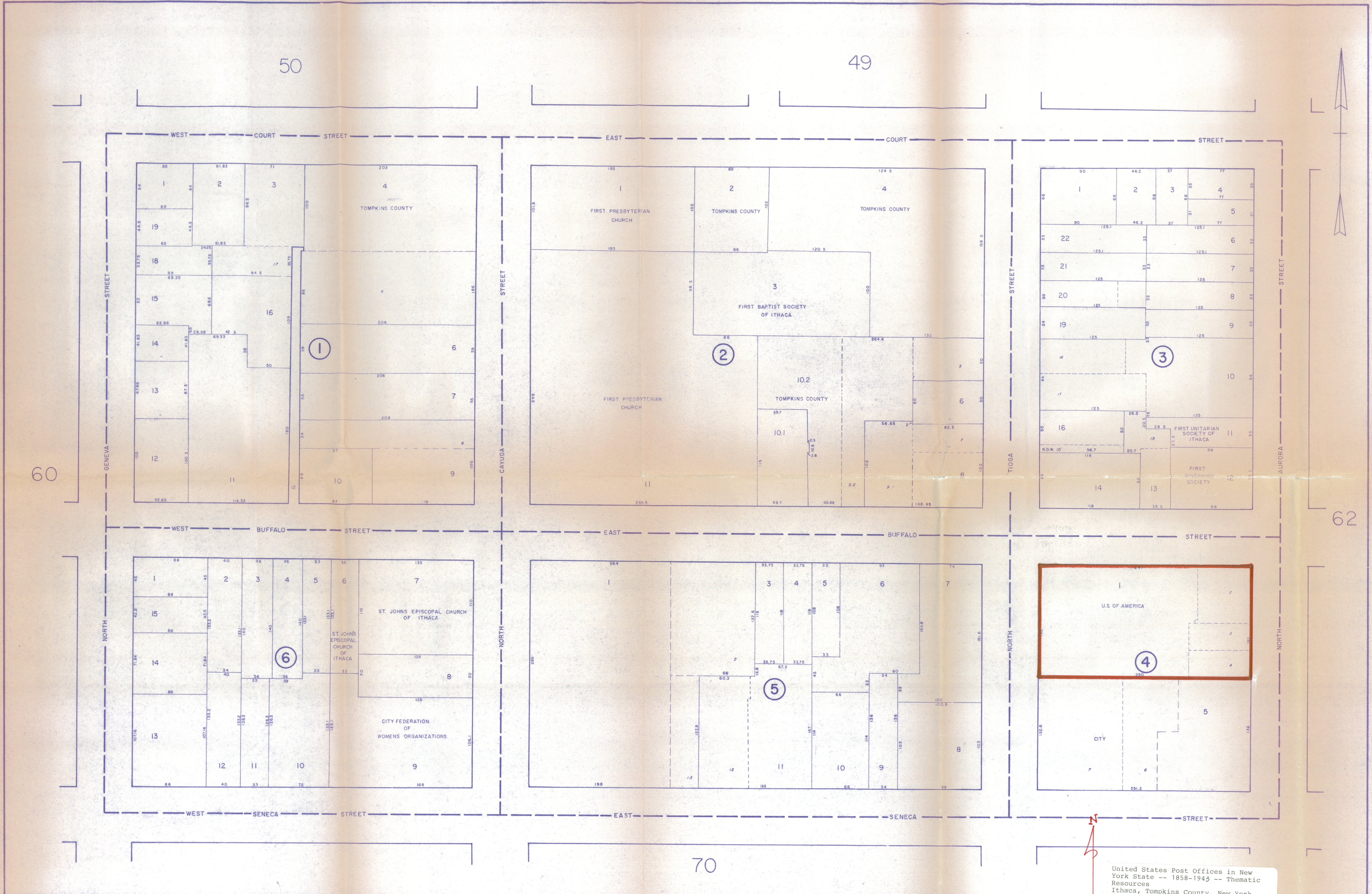

United States Post Offices in New York State -- 1858-1945 -- Thematic Resources  
 Ithaca, Tompkins County, New York  
 213 N. Tioga Street

1" = 50' Map #61-4-1

CITY OF ITHACA  
 TOMPKINS COUNTY, N.Y.  
 DATE, AERIAL PHOTOGRAPHY

MAP: 61  
 SCALE: 1" = 50'  
 PHOTO NO:  
 DATE, MAP: 6/1/64

FOR TAX PURPOSES ONLY  
 NOT TO BE USED FOR CONVEYANCE  
 PREPARED BY  
 AMERICAN AIR SURVEYS, INC.  
 907 PENN. AVE.  
 PITTSBURGH, PA. 15222

REVISIONS	
1 MAY 1, 1966	9 MAR. 1, 1975
2 JAN. 1, 1967	10 MAR. 1, 1976
3 JAN. 1, 1968	11 MAR. 1, 1976
4 MAR. 1, 1969	12 MAR. 1, 1979
5 MAR. 1, 1971	13 MAR. 1, 1983
6 MAR. 1, 1972	14
7 MAR. 1, 1973	15
8 MAR. 1, 1974	16

SPECIAL DISTRICT INFORMATION	

LEGEND	
PROPERTY LINE	---
ORIGINAL LOT LINE	- - - - -
EDGE OF PAVEMENT OR ROADWAY	---
RAILROAD	—+—+—+—
STREAM	~~~~~
ROAD OR RAILROAD R/W	---
STATE LINE	---
COUNTY LINE	---
TOWN LINE	---
VILLAGE LINE	---
BLOCK LIMIT	---
SCHOOL DISTRICT LINE	—SCH—
FIRE DISTRICT LINE	—F—
WATER DISTRICT LINE	—W—
LIGHT DISTRICT LINE	—L—
PARK DISTRICT LINE	—P—
SEWER DISTRICT LINE	—S—
HYDRANT DISTRICT LINE	—H—
BLOCK NUMBER	①
PARCEL NUMBER	②
DEED LOT NUMBER	③
DEED DIMENSION	D
SCALED DIMENSION	S
CALCULATED AREA	CAL



**UNITED STATES POSTAL SERVICE**  
**FACILITIES SERVICE CENTER**  
**REAL ESTATE DIVISION**  
**WINDSOR, CONNECTICUT 06006-0330**

May 19, 1988

The Honorable John Gutenberger  
Mayor  
City of Ithaca  
City Hall  
Ithaca, NY 14850

Re: Ithaca, NY 14850 - Main Post Office

Dear Mayor Gutenberger:

We are pleased to inform you that the U.S. Postal Service, in consonance with the New York State Historic Preservation Officer, plans to nominate the above referenced post office facilities to the National Register of Historic Places. Our nomination will be forwarded to the keeper of the National Register on June 20, 1988.

We would very much appreciate your endorsement to this nomination. Please let us know if you may have any additional comments or recommendations at this time.

Signed by WSM

William S. Moncrief  
Historic Preservation Coordinator

WSM/bb/0046E1



## CITY OF ITHACA

108 EAST GREEN STREET

ITHACA, NEW YORK 14850

ITHACA LANDMARKS  
PRESERVATION COMMISSION

TELEPHONE: 272-1713  
CODE 607

June 20, 1988

William S. Moncrief  
Historic Preservation Coordinator  
United State Postal Service  
Facilities Service Center  
Real Estate Division  
Windsor, CT 06006-0330

Dear Mr. Moncrief:

At the regular monthly meeting held on June 11, 1988, the Ithaca Landmarks Preservation Commission discussed the Postal Service's proposal to nominate Ithaca's main post office to the National Register. The Commission considers this building to be one of the most important contributions to the DeWitt Park Historic District, locally designated in 1971 and listed on the National Register by 1978. The structure is one of the prime examples of Beaux Arts architecture in the city and the Commission is delighted with the action undertaken by your agency. We strongly endorse this nomination.

Sincerely,

Leslie A. Chatterton  
Secretary  
Ithaca Landmarks Preservation Commission

LAC/mc

IBM-ILPC-PostOff.LAC



## CITY OF ITHACA

108 EAST GREEN STREET  
ITHACA, NEW YORK 14850

OFFICE OF  
MAYOR

TELEPHONE: 272-1713  
CODE 607

June 20, 1988

William S. Moncrief  
Historic Preservation Coordinator  
Unites States Postal Service  
Facilities Service Center  
Real Estate Division  
Windsor, CT 06006-0330

Dear Mr. Moncrief:

Thank you for your notification of the proposal by the Postal Service to nominate Ithaca's main post office to the National Register of Historic Places.

I strongly support the nomination and feel that this recognition of one of our most architecturally significant public buildings is especially gratifying in the year of the City of Ithaca's Centennial celebration.

Sincerely,

John C. Gutenberger  
Mayor  
City of Ithaca

JCG/mc

IBM-ILPC-PostOff.JCG



..... Celebrating ..... 1888 - 1988