

OCT 03 1988
2217

BUILDING-STRUCTURE INVENTORY FORM

FOR OFFICE USE ONLY
UNIQUE SITE NO. _____
QUAD _____
SERIES _____
NEG. NO. _____

DIVISION FOR HISTORIC PRESERVATION
NEW YORK STATE PARKS AND RECREATION
ALBANY, NEW YORK (518) 474-0479

YOUR NAME: JoAnn Beck, EDR, P.C. DATE: February 21, 1986

309 South Franklin Street

YOUR ADDRESS: Syracuse, NY 13202 TELEPHONE: 315-425-8894

ORGANIZATION (if any): St. Lawrence Eastern Ontario Commission

IDENTIFICATION

- 1. BUILDING NAME(S): Charles M. Salisbury House (#9)
- 2. COUNTY: Oswego TOWN/CITY: Sandy Creek VILLAGE: Lacona
- 3. STREET LOCATION: 9089 Church Street
- 4. OWNERSHIP: a. public b. private
- 5. PRESENT OWNER: Mrs. Crichton ADDRESS: 9089 Church Street, Lacona, NY
- 6. USE: Original: Residence Present: Residence
- 7. ACCESSIBILITY TO PUBLIC: Exterior visible from public road: Yes No
Interior accessible: Explain With permission

DESCRIPTION

- 8. BUILDING MATERIAL: a. clapboard b. stone c. brick d. board and batten
e. cobblestone f. shingles g. stucco other: _____
- 9. STRUCTURAL SYSTEM: (if known) a. wood frame with interlocking joints
b. wood frame with light members
c. masonry load bearing walls
d. metal (explain) _____
e. other _____
- 10. CONDITION: a. excellent b. good c. fair d. deteriorated
- 11. INTEGRITY: a. original site b. moved if so, when? _____
c. list major alterations and dates (if known): _____

12. PHOTO:

13. MAP:

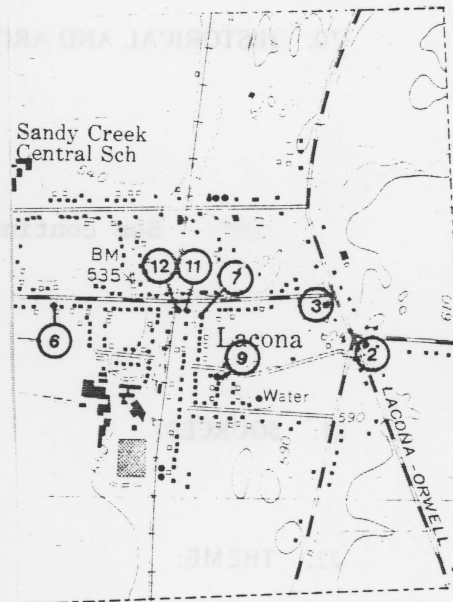

14. THREATS TO BUILDING: a. none known b. zoning c. roads
 d. developers e. deterioration
 f. other: _____
15. RELATED OUTBUILDINGS AND PROPERTY:
 a. barn b. carriage house c. garage
 d. privy e. shed f. greenhouse
 g. shop h. gardens
 i. landscape features: _____
 j. other: Secondary residence - hired man quarters/rental unit
16. SURROUNDINGS OF THE BUILDING (check more than one if necessary):
 a. open land b. woodland
 c. scattered buildings
 d. densely built-up e. commercial
 f. industrial g. residential
 h. other: _____

17. INTERRELATIONSHIP OF BUILDING AND SURROUNDINGS:
 (Indicate if building or structure is in an historic district)

See continuation sheet.

18. OTHER NOTABLE FEATURES OF BUILDING AND SITE (including interior features if known):

See continuation sheet.

SIGNIFICANCE

19. DATE OF INITIAL CONSTRUCTION: 1907-8

ARCHITECT: _____

BUILDER: _____

20. HISTORICAL AND ARCHITECTURAL IMPORTANCE:

See continuation sheet.

21. SOURCES:

22. THEME:

Town of Sandy Creek Multiple Resource Area
Sandy Creek, Oswego County, New York
Charles M. Salisbury House (Building No. 9)

17. The Charles M. Salisbury House is located on the southwest corner of Church Street and Prospect Street in the village of Lacona. The nominated parcel, slightly more than a quarter acre in area, is the property historically associated with the house; it includes two contributing outbuildings, a carriage house and a small residence (which served either as a servant's quarters or a rental unit), both from the early twentieth century. The property is located in a quiet residential area of the village and is surrounded by altered late-nineteenth century houses of similar scale. There is no historic district potential. (3 contributing buildings)

18. The Charles M. Salisbury House is a one and one-half story clapboard residence with a square plan, steeply pitched multi-gabled roof, an asymmetrical facade and irregular fenestration. The facade features a large fixed-pane window with stained glass, a gabled dormer and a recessed entry porch topped by an enclosed gable with three grouped windows. The porch features paired square columns and a simple balustrade, with a matching frieze suspended from the porch ceiling. The porch walls are sided with flush horizontal boards and feature a single one-over-one sash window and an entry with sidelights and wide surrounds. The original wide front door with bevelled glass retains its molded garland detail, hardware and doorbell. The sidelights, the upper sash in the gable windows and the dormer window feature diamond-shaped panes. The north side has a polygonal-bay window and an enclosed gable above.

The interior remains substantially intact, featuring a large central hall and open stairway with a second-floor balcony, as well as original floors and woodwork.

The property contains the original one and one-half story clapboard carriage house with a gambrel roof, hay door, replacement garage door and a side entry to the basement stable. Behind the carriage house, facing Prospect Street, is a small two-bay, one and one-half story clapboard residence with a gambrel roof and wide cornice with returns. The one-story porch across the full facade features square columns, a balustrade and a frieze that are identical to those on the main house. The facade features a front door and a paired multi-paned windows. There is a single one-over-one sash window in the gable.

20. The Charles M. Salisbury House is architecturally significant as an intact representative example of an early-twentieth century middle-class residence in Sandy Creek that reflects the progressive ideas of the period in form and detail. It is historically associated with Charles M.

Town of Sandy Creek Multiple Resource Area
Sandy Creek, Oswego County, New York
Charles M. Salisbury House (Building No. 9)

Salisbury, one of Sandy Creek's most prominent businessmen and civic leaders. Built in 1908, the house embodies such distinctive characteristics of modern residential design as simple square massing, board horizontal proportions, a uniform clapboard surface, and economy of detail. The small scale and simplicity of form and detail of this house signalled a departure from the elaborate Queen Anne style houses built in the previous decade by two other local builders, Fred Smart and Smith H. Barlow (individual components) and probably reflects both Mr. Salisbury's access to the pattern books and architecture journals which proliferated at the time, as well as his own progressive thinking as a businessman and a builder. The house was ample yet functional for Mr. and Mrs. Salisbury, who had no children. The two contributing outbuildings, the single-bay carriage house and a secondary residence employ the same materials, scale, simplicity of form and economy of detail as the house. Together they remain a remarkably intact domestic complex from the early twentieth century reflecting Mr. Salisbury's interest in the adaptation of the popular building styles of the period, as well as his own domestic needs. The residence survives as an intact and significant example of a type of residence that emerged as the preferred alternative to what was perceived to be the frivolous historicism of late Victorian design. Inexpensive, yet commodious, comfortable, restrained, modern, progressive, healthy, cozy, and artistic were words commonly used to describe those residences. The Salisbury House reflects these characteristic better than any other residence in the multiple resource area.

Charles M. Salisbury was born in Ellisburgh in 1857, a descendant of some of the area's early settlers. He attended Sandy Creek High School, worked on his father's farm until 1883, then worked for the JC Snyder Lumber and Feed Co. He was also a house-builder, co-owner of the Salisbury and Ward Lumber Co. (from 1910) and an amateur woodworker of some renown, specializing in inlay work. He designed and helped construct the Baptist Church (1917) (individual component), where he also served as treasurer, deacon and active member of the men's organization (Baracca Class). He was a founder and the first vice president of the First National Bank of Lacona in 1912. He became president of the bank in 1927 and chairman of the board in 1932. The bank was an important local institution in promoting economic growth and stability in the community. The bank directors, including Mr. Salisbury, are credited with its progressive management and its solvency throughout the Great Depression. Mr. Salisbury served on the Board of Education and as the Town Assessor. He was also the last surviving member of Coles Cornet Band (organized in 1876).

Mr. Salisbury was shot to death by two youths during an attempted bank robbery in May 1936. The event was probably the most notorious in the history of the town. Both the

Town of Sandy Creek Multiple Resource Area
Sandy Creek, Oswego County, New York
Charles M. Salisbury House (Building No. 9)

Charles M. Salisbury house and the secondary residence
remain in use as residences.

10/3/88

United States Department of the Interior
National Park Service

National Register of Historic Places
Continuation Sheet

Section number _____ Page _____

Multiple Resource Area
Thematic Group

Name Sandy Creek MRA
State Oswego County, NY

Nomination/Type of Review	Date/Signature
Cover <u>Substantive Review</u>	Sr Keeper <u>Beth A. Savage 11-15-88</u>
1. Barlow, Smith H., House <u>Substantive Review</u>	Sr Keeper <u>Beth A. Savage 11-15-88</u> Attest _____
2. First Baptist Church <u>Entered in the National Register</u>	Keeper <u>Delores Byers 11-15-88</u> Attest _____
3. First National Bank of Lacona <u>Entered in the National Register</u>	Keeper <u>Delores Byers 11-15-88</u> Attest _____
4. Holyoke Cottage <u>Entered in the National Register</u>	Keeper <u>Delores Byers 11-15-88</u> Attest _____
5. Lacona Clock Tower <u>Entered in the National Register</u>	Keeper <u>Delores Byers 11-15-88</u> Attest _____
6. Methodist Church <u>Entered in the National Register</u>	Keeper <u>Delores Byers 11-15-88</u> Attest _____
7. Pitt, Newton M., House <u>Entered in the National Register</u>	Keeper <u>Delores Byers 11-15-88</u> Attest _____
8. Sadler, Samuel, House <u>Entered in the National Register</u>	Keeper <u>Delores Byers 11-15-88</u> Attest _____
9. Sandy Creek Historic District <u>Substantive Review</u>	Sr Keeper <u>Beth A. Savage 11-15-88</u> Attest _____
10. Salisbury, Charles, M., House <u>Entered in the National Register</u>	Keeper <u>Delores Byers 11-15-88</u> Attest _____

UNITED STATES DEPARTMENT OF THE INTERIOR
NATIONAL PARK SERVICE

NATIONAL REGISTER OF HISTORIC PLACES
EVALUATION/RETURN SHEET

REQUESTED ACTION: NOMINATION

PROPERTY Salisbury, Charles, M., House
NAME:

MULTIPLE Sandy Creek MRA
NAME:

STATE & COUNTY: NEW YORK, Oswego

DATE RECEIVED: 10/03/88 DATE OF PENDING LIST: 10/18/88
DATE OF 16TH DAY: 11/03/88 DATE OF 45TH DAY: 11/17/88
DATE OF WEEKLY LIST:

REFERENCE NUMBER: 88002217

NOMINATOR: STATE

REASONS FOR REVIEW:

APPEAL: N DATA PROBLEM: N LANDSCAPE: N LESS THAN 50 YEARS: N
OTHER: N PDIL: N PERIOD: N PROGRAM UNAPPROVED: N
REQUEST: N SAMPLE: N SLR DRAFT: N

COMMENT WAIVER: N

ACCEPT RETURN REJECT 11-15-88 DATE

Entered in the
National Register

ABSTRACT/SUMMARY COMMENTS:

RECOM./CRITERIA _____
REVIEWER _____
DISCIPLINE _____
DATE _____

DOCUMENTATION see attached comments Y/N see attached SLR Y/N

CLASSIFICATION

count resource type

STATE/FEDERAL AGENCY CERTIFICATION

FUNCTION

historic current

DESCRIPTION

architectural classification
 materials
 descriptive text

SIGNIFICANCE

Period Areas of Significance--Check and justify below

Specific dates Builder/Architect
Statement of Significance (in one paragraph)

summary paragraph
 completeness
 clarity
 applicable criteria
 justification of areas checked
 relating significance to the resource context
 relationship of integrity to significance
 justification of exception
 other

BIBLIOGRAPHY

GEOGRAPHICAL DATA

acreage verbal boundary description
 UTM's boundary justification

ACCOMPANYING DOCUMENTATION/PRESENTATION

sketch maps USGS maps photographs presentation

OTHER COMMENTS

Questions concerning this nomination may be directed to

_____ Phone _____

Signed _____ Date _____

TOWN OF SANDY CREEK MULTIPLE RESOURCE AREA
SANDY CREEK, OSWEGO COUNTY, NEW YORK
CHARLES M. SALISBURY HOUSE (Building #9)



Carriage House to the west of the house.



Secondary residence to the west of the house.

TOWN OF SANDY CREEK MULTIPLE RESOURCE AREA
SANDY CREEK, OSWEGO COUNTY, NEW YORK
CHARLES M. SALISBURY HOUSE (Building #9)



Interior: staircase and balcony.



Front entry porch detail.

GEOGRAPHICAL DATA

BLDG. #	BLDG. NAME & ADDRESS	UTM REFERENCE: ALL ZONE 18
1	P.M. NEWTON HOUSE 8114 Harwood Dr. Sandy Creek	E 412620 N 4832630
2	MATTHEW SHOECRAFT HOUSE Ridge Rd. & Smartsville Rd. Lacona	E 414300 N 4832500
3	NEWMAN TUTTLE HOUSE Rt. 15 & 22 Lacona	E 414180 N 4832620
4	SAMUEL SADLER HOUSE 9278 N. Main St. Sandy Creek	E 412480 N 4833190
5	METHODIST CHURCH Harwood Dr. Sandy Creek	E 412660 N 4832640
6	SMITH H. BARLOW HOUSE Harwood Dr. Lacona	E 413300 N 4832610
7	FRED SMART HOUSE Salina St. Lacona	E 413780 N 4832580
8	HOLYOKE COTTAGE Seber Shore Rd. Sandy Creek	A. E 406130 N 4833280 B. E 406080 N 4832710 C. E 405780 N 4832960
9	CHARLES M. SALISBURY HOUSE Church Street Lacona	E 413830 N 4832390
10	FIRST BAPTIST CHURCH Harwood Dr. Sandy Creek	E 413070 N 4832660
11	FIRST NATIONAL BANK OF LACONA Harwood Dr. Lacona	E 413740 N 4832600
12	LACONA CLOCK TOWER Harwood Dr. Lacona	E 413700 N 4832600

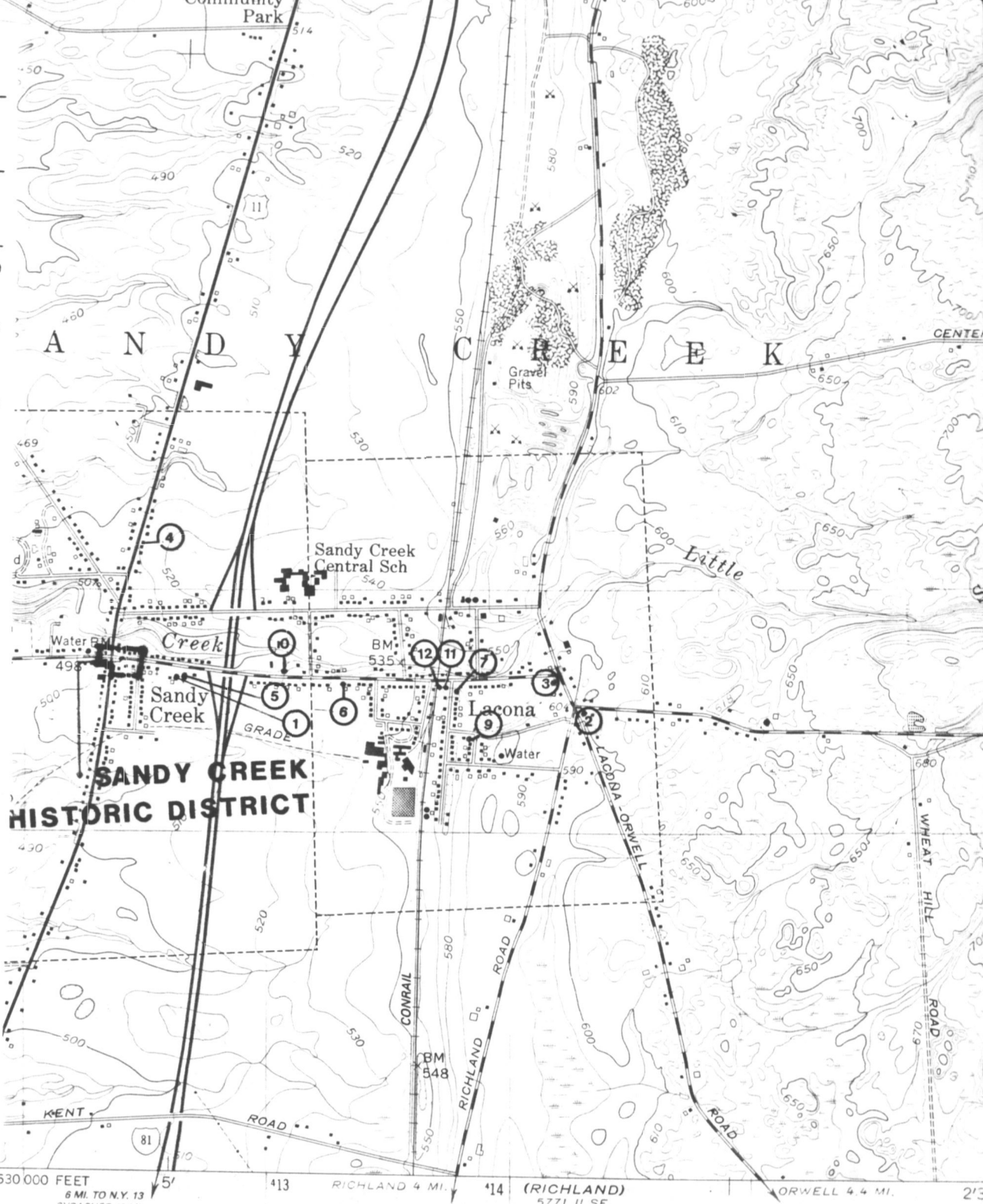

SANDY CREEK HISTORIC DISTRICT: 3.7 A. E 412400 N 4832710
Main Street & Harwood Drive
Sandy Creek

TOWN OF SANDY CREEK MULTIPLE RESOURCE AREA
SANDY CREEK, OSWEGO COUNTY, NEW YORK
CHARLES M. SALISBURY HOUSE (Building #9)

Oswego County Department of Real Property Tax Services

Map #030.08

Date: April 1974

Scale 1"=100'

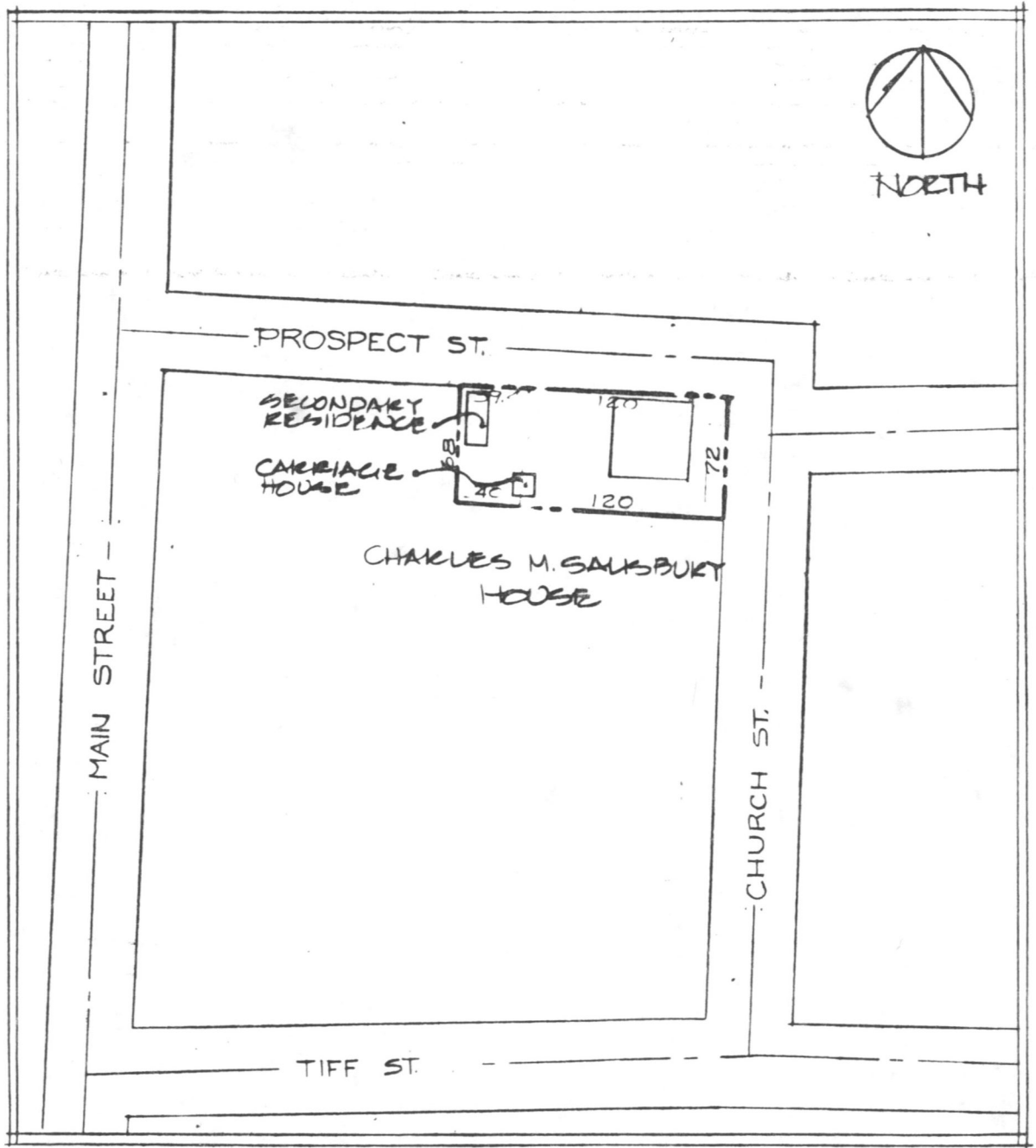

Box 101-G Lacona, N.Y.
February 14, 1986

FEB 18 1986

PRES.

Dear Mr. Lehman,

I am the sole owner of the property listed in your files as the Charles M. Salisbury House, 9089 Church St, Lacona, N.Y.

I have no objection to having the house nominated for inclusion in the National and State Registers of Historic Places. It was built around 1909 and the builder and owner was a man of local prominence. Among other places here, he designed and built the octagonal Baptist Church, located on Harwood Drive. For several years before his death, he was a director of the First National Bank of Lacona, now designated as The Merchants' Bank and Trust Company. He was shot and killed by bank robbers in 1938 - a bit of local folklore.

The property includes a three-story carriage house which still contains the original hay chute.

I have no intention of changing the exterior architecture in my lifetime.



Very truly yours,
Aileen R. Crichton

Mrs. John T. Crichton

RECEIVED

FEB 20 1986

DEPUTY COMMISSIONER
HISTORIC PRESERVATION

J. Stokes
approval
action