

BUILDING-STRUCTURE INVENTORY FORM

DIVISION FOR HISTORIC PRESERVATION
NEW YORK STATE PARKS AND RECREATION
ALBANY, NEW YORK (518) 474-0479

FOR OFFICE USE ONLY	
UNIQUE SITE NO.	<u>103-04-0043</u>
QUAD	_____
SERIES	_____
NEG. NO.	_____

YOUR NAME: NYS PARKS & RECREATION DATE: _____
AGENCY BLDG. #1
 YOUR ADDRESS: EMPIRE STATE PLAZA TELEPHONE: _____
ALBANY, NY 12230
 ORGANIZATION (if any): _____

IDENTIFICATION

- BUILDING NAME(S): John Rogers House
- COUNTY: Suffolk TOWN/CITY: Huntington VILLAGE: Half Hollow Hills
- STREET LOCATION: 627 Half Hollow Road
- OWNERSHIP: a. public b. private
- PRESENT OWNER: Barbara Dow ADDRESS: same
- USE: Original: residence Present: same
- ACCESSIBILITY TO PUBLIC: Exterior visible from public road: Yes No
Interior accessible: Explain by appointment only

DESCRIPTION

- BUILDING MATERIAL: a. clapboard b. stone c. brick d. board and batten
e. cobblestone f. shingles g. stucco other: _____
- STRUCTURAL SYSTEM: (if known) a. wood frame with interlocking joints
b. wood frame with light members
c. masonry load bearing walls
d. metal (explain) _____
e. other _____
- CONDITION: a. excellent b. good c. fair d. deteriorated
- INTEGRITY: a. original site b. moved if so, when? _____
c. list major alterations and dates (if known): _____

12. PHOTO:

See attached

13. MAP:

See attached

14. THREATS TO BUILDING: a. none known b. zoning c. roads
d. developers e. deterioration
f. other: _____

15. RELATED OUTBUILDINGS AND PROPERTY:
a. barn b. carriage house c. garage
d. privy e. shed f. greenhouse
g. shop h. gardens c, NON-CONTRIBUTING
i. landscape features: _____
j. other: _____

16. SURROUNDINGS OF THE BUILDING (check more than one if necessary):
a. open land b. woodland
c. scattered buildings
d. densely built-up e. commercial
f. industrial g. residential
h. other: _____

17. INTERRELATIONSHIP OF BUILDING AND SURROUNDINGS:
(Indicate if building or structure is in an historic district)

See attached

18. OTHER NOTABLE FEATURES OF BUILDING AND SITE (including interior features if known):

See attached

SIGNIFICANCE

19. DATE OF INITIAL CONSTRUCTION: 1732

ARCHITECT: unknown

BUILDER: John Rogers

20. HISTORICAL AND ARCHITECTURAL IMPORTANCE:

See attached

Ownership: 1837-Carl1; 1858-B.F. Bower; 1873-Wicks;
1909 and 1917-A.W. Wicks

21. SOURCES:

See item 9 on nomination form

22. THEME:

Huntington Multiple Resource Area
Suffolk Co., New York

John Rogers House, 627 Half Hollow Road

17. The John Rogers House is situated on a 1.2 acre plot along High Hollow Road. One of the earliest paths in the area, Half Hollow Road runs through the heart of Half Hollow Hills, an area located south of the village of Huntington near the Babylon town line. Half Hollow Hills is one of the few areas in Huntington which retains its eighteenth-century ambience and rural setting. It is lined with scattered historic properties, many of which are horse farms, located away from the narrow winding lanes. The house, which is situated near the road, is encircled by a picket fence and includes a modern non-contributing garage. Tax map #278-1-3.1. (1 contributing building)
18. The John Rogers House is a one and one-half story dwelling with dark weathered shingle sheathing and a saltbox profile. The gable roofed structure has a central chimney. The five-bay facade is punctuated by eight-pane frieze windows and six-over-six double-hung sash windows with wide, plain wood surrounds. The central entrance has a cornice supported on narrow pilasters with delicately detailed corner blocks.

Under the sweeping saltbox profile to the rear is a one-story kitchen wing and semi-enclosed porch. A two-storied, (of an original four-storied) square water tower with flared base is attached to the rear of the house. The shingle clad water tower has eight-pane fixed windows and a balustrade on top. The only exterior alterations to the house have been the mid-twentieth century additions of a bay window on the west side, a picture window on the east elevation, and gable roof dormers in the rear.

The house retains its original central hall floor plan, moldings, fireplaces, door and window surrounds, and corner cupboards. Period hardware also exists throughout the house. A modern, non-contributing garage is located to the rear of the house.

20. The John Rogers House, known locally as "Five Gates," is architecturally significant within the multiple resource area as one of the largest and most stylish examples of early settlement period architecture in the town of Huntington. Built in 1732, the dwelling exhibits the characteristics common to its settlement period such as timber-framing, shingle-sheathing, attic story windows, a central chimney, and minimal decorative detail. In addition, it has a restrained Federal style entrance with cornice, slender pilasters, and corner blocks. Although it exhibits the form and plan common to settlement period architecture, the John Rogers House is distinctive for its prominent size, symmetrical facade, and well-crafted details. The dwelling is historically significant as one of the oldest, most intact properties associated with the settlement and early growth of the Half Hollow Hills section of Huntington.

Huntington Multiple Resource Area
Suffolk Co., New York

John Rogers House, 627 Half Hollow Road

The residence was built on 257 acres of land originally granted to John Rogers in 1706 by Queen Anne of England. The dwelling is known locally as "Five Gates" because of the original five gates on the property leading to grazing areas. The John Rogers House has remained relatively unaltered, and survives as one of the most distinctive examples of eighteenth-century settlement period architecture recalling the early growth and development of Huntington.

United States Department of the Interior
National Park Service

National Register of Historic Places
Inventory—Nomination Form

For NPS use only
received 8/16/85
date entered

Continuation sheet

Item number

Page 6

Multiple Resource Area
Thematic Group

Name Huntington Town MRA
State NEW YORK

Nomination/Type of Review

Date/Signature

51. Potter--Williams House

Entered in the
National Register

for Keeper

Melona Byers 9/26/85

Attest

52. Prime House

Entered in the
National Register

for Keeper

Melona Byers 9/26/85

Attest

53. Prime--Octagon House

Entered in the
National Register

for Keeper

Melona Byers 9/26/85

Attest

54. Remp, Michael, House

Entered in the
National Register

for Keeper

Melona Byers 9/26/85

Attest

55. Rogers House

Entered in the
National Register

for Keeper

Melona Byers 9/26/85

Attest

56. Rogers, John, House

Entered in the
National Register

for Keeper

Melona Byers 9/26/85

Attest

57. Sammis, Silas, House

Entered in the
National Register

for Keeper

Melona Byers 9/26/85

Attest

58. Seaman Farm

Entered in the
National Register

for Keeper

Melona Byers 9/26/85

Attest

59. Shore Road Historic District

Entered in the
National Register

for Keeper

Melona Byers 9/26/85

Attest

60. Smith, Daniel, House

Entered in the
National Register

for Keeper

Melona Byers 9/26/85

Attest

Rev. 11
85002572

NATIONAL REGISTER OF HISTORIC PLACES
EVALUATION/RETURN SHEET

Rogers, John, House (Huntington Town MRA)
Suffolk County
NEW YORK

Working No. AUG 16 1985
Fed. Reg. Date: 2/4/86
Date Due: 9/12/85 9/30/85
Action: ACCEPT 9-26-85
 RETURN
 REJECT
Federal Agency: _____

Entered in the
National Register

- resubmission
- nomination by person or local government
- owner objection
- appeal

Substantive Review: sample request appeal NR decision

Reviewer's comments:

Recom./Criteria _____
Reviewer _____
Discipline _____
Date _____
_____ see continuation sheet

Nomination returned for: _____ technical corrections cited below
_____ substantive reasons discussed below

1. Name

2. Location

3. Classification

Category	Ownership	Status	Present Use
	Public Acquisition	Accessible	

4. Owner of Property

5. Location of Legal Description

6. Representation in Existing Surveys

Has this property been determined eligible? yes no

7. Description

Condition		Check one	Check one
<input type="checkbox"/> excellent	<input type="checkbox"/> deteriorated	<input type="checkbox"/> unaltered	<input type="checkbox"/> original site
<input type="checkbox"/> good	<input type="checkbox"/> ruins	<input type="checkbox"/> altered	<input type="checkbox"/> moved date _____
<input type="checkbox"/> fair	<input type="checkbox"/> unexposed		

Describe the present and original (if known) physical appearance

- summary paragraph
- completeness
- clarity
- alterations/integrity
- dates
- boundary selection

8. Significance

Period _____ Areas of Significance—Check and justify below

Specific dates _____ Builder/Architect _____

Statement of Significance (*in one paragraph*)

- summary paragraph
- completeness
- clarity
- applicable criteria
- justification of areas checked
- relating significance to the resource
- context
- relationship of integrity to significance
- justification of exception
- other

9. Major Bibliographical References

10. Geographical Data

Acreage of nominated property _____

Quadrangle name _____

UTM References _____

Verbal boundary description and justification

11. Form Prepared By

12. State Historic Preservation Officer Certification

The evaluated significance of this property within the state is:

____ national ____ state ____ local

State Historic Preservation Officer signature

title _____ date _____

13. Other

- Maps
- Photographs
- Other

Questions concerning this nomination may be directed to _____

Signed _____ Date _____ Phone: _____

HUNTINGTON TOWN MULTIPLE
RESOURCE AREA
SUFFOLK COUNTY, NEW YORK
PHOTOS: A.O'BRIEN, 1984
NEGATIVES: OPRHP

JOHN ROGERS HOUSE/
627 HALF HOLLOW ROAD
HALF HOLLOW HILLS



View from southwest



Garage to east

HUNTINGTON TOWN MULTIPLE
RESOURCE AREA
SUFFOLK COUNTY, NEW YORK
PHOTOS: A.O'BRIEN, 1984
NEGATIVES: OPRHP

JOHN **ROGERS HOUSE**
627 HALF HOLLOW ROAD
HALF HOLLOW HILLS



View from south



View from southeast

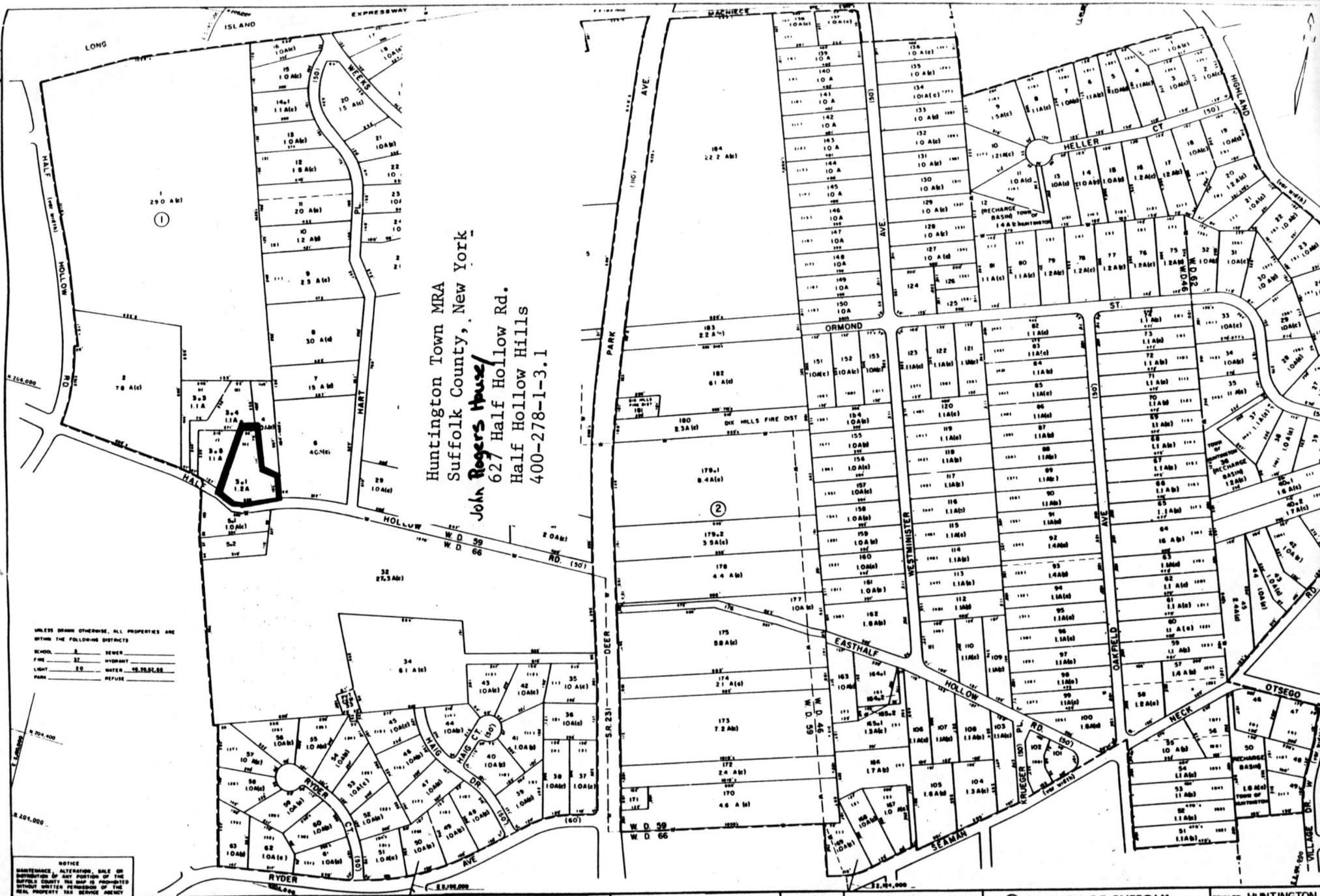

Huntington Town MRA
 Suffolk County, New York
John Rogers House
 627 Half Hollow Rd.
 Half Hollow Hills
 400-278-1-3.1

UNLESS SHOWN OTHERWISE, ALL PROPERTIES ARE WITHIN THE FOLLOWING DISTRICTS

SCHOOL	8	SEWER	
FIRE	32	HYDRANT	
LIGHT	12	WATER	19, 22, 45
PAVE		REFUSE	

NOTICE
 MAINTENANCE, ALTERATION, SALE OR DISTRIBUTION OF ANY PORTION OF THE SUFFOLK COUNTY TAX MAP IS PROHIBITED WITHOUT WRITTEN PERMISSION OF THE REAL PROPERTY TAX SERVICE AGENCY

Legend

Property or R/W Line	County Line	Fire District Line	Hydrant District Line	Subdivision Lot No.	(34)
Domestic Common Owner	Town Line	Water District Line	Refuse District Line	Deed Dimension	67
Subdivision Lot Line	Village Line	Light District Line	Park District Line	Scaled Dimension	67
Re-Road	Black Line	Park District Line	Parcel No.	Deed Area	124.4
Stream/Share	School District Line	Senior District Line	Subdivision Block No.	Calculated Area	124.1

KEY MAP

261	262	263
277	278	283
281		

SCALE IN FEET

© COUNTY OF SUFFOLK
 Real Property Tax Service Agency
 County Center
 Riverhead, L. I., New York

TOWN OF HUNTINGTON
 VILLAGE OF
 DISTRICT NO. 0400

627 Half Hollow Rd

