

**BUILDING-STRUCTURE INVENTORY FORM**

|                     |             |
|---------------------|-------------|
| FOR OFFICE USE ONLY |             |
| UNIQUE SITE NO.     | 103-04-0863 |
| QUAD                | _____       |
| SERIES              | _____       |
| NEG. NO.            | _____       |

DIVISION FOR HISTORIC PRESERVATION  
NEW YORK STATE PARKS AND RECREATION  
ALBANY, NEW YORK (518) 474-0479

YOUR NAME: NYS PARKS & RECREATION DATE: \_\_\_\_\_  
AGENCY BLDG. #1  
 YOUR ADDRESS: EMPIRE STATE PLAZA TELEPHONE: \_\_\_\_\_  
ALBANY, NY 12238  
 ORGANIZATION (if any): \_\_\_\_\_

\*\*\*\*\*

**IDENTIFICATION**

1. BUILDING NAME(S): Ezra Carll Homestead  
 2. COUNTY: Suffolk TOWN/CITY: Huntington VILLAGE: Huntington Station  
 3. STREET LOCATION: 49 Melville Road  
 4. OWNERSHIP: a. public  b. private   
 5. PRESENT OWNER: Marty & Kelly Lyons ADDRESS: same  
 6. USE: Original: residence Present: same  
 7. ACCESSIBILITY TO PUBLIC: Exterior visible from public road: Yes  No   
 Interior accessible: Explain by appointment only

**DESCRIPTION**

8. BUILDING MATERIAL: a. clapboard  b. stone  c. brick  d. board and batten   
 e. cobblestone  f. shingles  g. stucco  other: \_\_\_\_\_  
 9. STRUCTURAL SYSTEM: (if known) a. wood frame with interlocking joints   
 b. wood frame with light members   
 c. masonry load bearing walls   
 d. metal (explain) \_\_\_\_\_  
 e. other \_\_\_\_\_  
 10. CONDITION: a. excellent  b. good  c. fair  d. deteriorated   
 11. INTEGRITY: a. original site  b. moved  if so, when? \_\_\_\_\_  
 c. list major alterations and dates (if known): \_\_\_\_\_

12. PHOTO:  
See attached

13. MAP:  
See attached

14. THREATS TO BUILDING: a. none known  b. zoning  c. roads   
 d. developers  e. deterioration   
 f. other: \_\_\_\_\_
15. RELATED OUTBUILDINGS AND PROPERTY:  
 a. barn  b. carriage house  c. garage   
 d. privy  e. shed  f. greenhouse   
 g. shop  h. gardens  i. landscape features: \_\_\_\_\_  
 j. other: \_\_\_\_\_
16. SURROUNDINGS OF THE BUILDING (check more than one if necessary):  
 a. open land  b. woodland   
 c. scattered buildings   
 d. densely built-up  e. commercial   
 f. industrial  g. residential   
 h. other: \_\_\_\_\_

17. INTERRELATIONSHIP OF BUILDING AND SURROUNDINGS:  
 (Indicate if building or structure is in an historic district)

See attached

18. OTHER NOTABLE FEATURES OF BUILDING AND SITE (including interior features if known):

See attached

**SIGNIFICANCE**

19. DATE OF INITIAL CONSTRUCTION: south wing, c. 1700/main dwelling, c. 1740

ARCHITECT: unknown

BUILDER: unknown

20. HISTORICAL AND ARCHITECTURAL IMPORTANCE:

See attached

Ownership: 1836-Ezra Carll; 1850-E. Carll; 1873-P. Decker; 1909-Wm. W. Barker, 158 acres; 1917-Wm. W. Barker; 1937-Gaisser

21. SOURCES:

See item 9 on nomination form

22. THEME:

Ezra Carll Homestead, 49 Melville Road

17. The Ezra Carll Homestead is located on a one-quarter acre plot along Melville Road, one of the earliest roads to serve the South Huntington area. A narrow, winding thoroughfare, Melville Road now has several modern housing developments lining it which consist of contemporary structures on one-quarter acre plots. The Ezra Carll Homestead, which sits close to the street, is one of the few historic properties left along this early thoroughfare and one of the few unaltered historic dwellings surviving in South Huntington. A large wooden fence separates the site from the road and encloses the wooded property, which also contains a non-contributing modern garage. (1 contributing building)

18. The Ezra Carll Homestead is a two-story, gable-roof, wood shingled house with a lean-to profile and second-story overhang. The one and one-half story gable-roofed wing on the south is the oldest part of the structure. The dwelling has a rubblestone foundation and massive central chimney.

The five-bay facade has a center entrance with six-light transom and simple molded surround. A shed roof canopy shelters the entrance. The facade has sixteen-over-eight windows on the first floor and twelve-over-eight windows on the second floor, which are shaded by the overhanging eaves.

The rear of the residence has a variety of windows, and a one-room extension covered by the lean-to roof. The rear entrance has a simple molded surround. The one-and-one-half story two-bay south wing features six-over-six and eight-over-eight double-hung sash with simple flush wooden trim. The house's interior retains the original floor plan, fireplaces, moldings, beamed ceilings, panelled woodwork and period hardware.

The property also contains a modern, shingled, gable-roofed garage which is a non-contributing element. The garage has a shed roof side wing with entrance and four-light window.

20. The Ezra Carll Homestead is architecturally significant as an outstanding and well-preserved example of settlement period architecture in the town of Huntington. Recorded by the Historic American Buildings Survey, the original dwelling on the site, the present one and one-half story, gable roof south wing, is believed to date from c.1700. The five-bay, two-and-one-half story center entrance residence which was added c.1740 is distinguished by an unusual building technique in this region: a second-story overhang or jetty. Typical of the New England colonial houses of the seventeenth century, the use of the jetty on the Ezra Carll Homestead suggests a direct link between the architectural practices of New England and those in northeastern Long Island. The homestead is one of few surviving early eighteenth century properties in the town one of the only historic properties

20. remaining in South Huntington.

The Ezra Carll Homestead embodies the characteristic features of settlement period architecture on Long Island including simple form, use of local natural materials, and lack of decorative detail. The influence of New England regional architecture is revealed by its salt-box profile, two-story box-like massing, and second-story overhang or jetty. The jetty is a feature common to seventeenth-century building practices prevalent in New England; its use on the Carll Homestead is rare on Long Island. The Carll Homestead is also distinguished by the fine craftsmanship evident in its interior, which remains relatively intact.

**United States Department of the Interior  
National Park Service**

**National Register of Historic Places  
Inventory—Nomination Form**

For NPS use only  
received 8/26/85  
date entered \_\_\_\_\_

Continuation sheet

Item number

Page 2

Multiple Resource Area  
Thematic Group

Name Huntington Town MRA  
State NEW YORK

Nomination/Type of Review

Date/Signature

- |   |                                     |            |                              |
|---|-------------------------------------|------------|------------------------------|
| 11. Burr, Carll S., Mansion               | Entered in the<br>National Register | for Keeper | <u>Delores Byrum</u> 9/26/85 |
|   |                                     | Attest     | _____                        |
| 12. Burr, Carll, Jr., House               | Entered in the<br>National Register | for Keeper | <u>Delores Byrum</u> 9/26/85 |
|   |                                     | Attest     | _____                        |
| 13. Carll House (79 Wall St.)             | Entered in the<br>National Register | for Keeper | <u>Delores Byrum</u> 9/26/85 |
|   |                                     | Attest     | _____                        |
| 14. Carll House (380 Deer Park Rd.)       | Entered in the<br>National Register | for Keeper | <u>Delores Byrum</u> 9/26/85 |
|   |                                     | Attest     | _____                        |
| 15. Carll, Ezra, Homestead                | Entered in the<br>National Register | for Keeper | <u>Delores Byrum</u> 9/26/85 |
|   |                                     | Attest     | _____                        |
| 16. Chichester's Inn                      | Entered in the<br>National Register | for Keeper | <u>Delores Byrum</u> 9/26/85 |
|   |                                     | Attest     | _____                        |
| 17. Cold Spring Harbor Library            | Entered in the<br>National Register | for Keeper | <u>Delores Byrum</u> 9/26/85 |
|   |                                     | Attest     | _____                        |
| 18. Commack Methodist Church and Cemetery | Entered in the<br>National Register | for Keeper | <u>Delores Byrum</u> 9/26/85 |
|   |                                     | Attest     | _____                        |
| 19. Conklin, David, House                 | Entered in the<br>National Register | for Keeper | <u>Delores Byrum</u> 9/26/85 |
|   |                                     | Attest     | _____                        |
| 20. Delameter--Bevin Mansion              | Entered in the<br>National Register | for Keeper | <u>Delores Byrum</u> 9/26/85 |
|   |                                     | Attest     | _____                        |

UNITED STATES DEPARTMENT OF THE INTERIOR  
NATIONAL PARK SERVICE

rk  
REF #  
85002506

NATIONAL REGISTER OF HISTORIC PLACES  
EVALUATION/RETURN SHEET

Carll, Ezra, Homestead (Huntington Town MRA)  
Suffolk County  
NEW YORK

**AUG 16 1985**

Working No. \_\_\_\_\_  
Fed. Reg. Date: 2/4/86  
Date Due: 9/12/85 ~~9/30/85~~  
Action:  ACCEPT 9-26-85  
 RETURN  
 REJECT  
Federal Agency: \_\_\_\_\_

Entered in the  
National Register

- resubmission
- nomination by person or local government
- owner objection
- appeal

Substantive Review:  sample  request  appeal  NR decision

Reviewer's comments:

Recom./Criteria \_\_\_\_\_  
Reviewer \_\_\_\_\_  
Discipline \_\_\_\_\_  
Date \_\_\_\_\_  
\_\_\_\_\_ see continuation sheet

Nomination returned for: \_\_\_\_\_ technical corrections cited below  
\_\_\_\_\_ substantive reasons discussed below

1. Name

2. Location

3. Classification

| Category | Ownership<br>Public Acquisition | Status<br>Accessible | Present Use |
|----------|---------------------------------|----------------------|-------------|
|          |                                 |                      |             |

4. Owner of Property

5. Location of Legal Description

6. Representation in Existing Surveys

Has this property been determined eligible?  yes  no

7. Description

|                                    |                                       |   |
|------------------------------------|---------------------------------------|---|
| Condition                          | Check one                             | Check one                                 |
| <input type="checkbox"/> excellent | <input type="checkbox"/> deteriorated | <input type="checkbox"/> original site    |
| <input type="checkbox"/> good      | <input type="checkbox"/> ruins        | <input type="checkbox"/> moved date _____ |
| <input type="checkbox"/> fair      | <input type="checkbox"/> unexposed    |   |
|                                    | <input type="checkbox"/> unaltered    |   |
|                                    | <input type="checkbox"/> altered      |   |

Describe the present and original (if known) physical appearance

- summary paragraph
- completeness
- clarity
- alterations/integrity
- dates
- boundary selection

**8. Significance**

Period \_\_\_\_\_ Areas of Significance—Check and justify below

Specific dates \_\_\_\_\_ Builder/Architect \_\_\_\_\_  
Statement of Significance (*in one paragraph*)

- summary paragraph
- completeness
- clarity
- applicable criteria
- justification of areas checked
- relating significance to the resource
- context
- relationship of integrity to significance
- justification of exception
- other

**9. Major Bibliographical References**

**10. Geographical Data**

Acreage of nominated property \_\_\_\_\_

Quadrangle name \_\_\_\_\_

UTM References \_\_\_\_\_

Verbal boundary description and justification \_\_\_\_\_

**11. Form Prepared By**

**12. State Historic Preservation Officer Certification**

The evaluated significance of this property within the state is:

\_\_\_\_ national      \_\_\_\_ state      \_\_\_\_ local

State Historic Preservation Officer signature

title \_\_\_\_\_ date \_\_\_\_\_

**13. Other**

- Maps
- Photographs
- Other

Questions concerning this nomination may be directed to \_\_\_\_\_

Signed \_\_\_\_\_ Date \_\_\_\_\_ Phone: \_\_\_\_\_

HUNTINGTON TOWN MULTIPLE  
RESOURCE AREA  
SUFFOLK COUNTY, NEW YORK  
PHOTOS: A.O'BRIEN, 1984  
NEGATIVES: OPRHP  
EZRA CARLL HOMESTEAD  
49 MELVILLE ROAD  
HUNTINGTON STATION



View from east



View from west

HUNTINGTON TOWN MULTIPLE  
RESOURCE AREA  
SUFFOLK COUNTY, NEW YORK  
PHOTOS: A.O'BRIEN, 1984  
NEGATIVES: OPRHP  
EZRA CARLL HOMESTEAD  
49 MELVILLE ROAD  
HUNTINGTON STATION



View from southeast



View from south

HUNTINGTON TOWN MULTIPLE  
RESOURCE AREA  
SUFFOLK COUNTY, NEW YORK  
PHOTOS: A.O'BRIEN, 1984  
NEGATIVES: OPRHP

EZRA CARLL HOMESTEAD  
49 MELVILLE ROAD  
HUNTINGTON STATION



Garage to east

Huntington Town MRA  
 Suffolk County, New York  
 Ezra Carll Homestead  
 49 Melville Rd.  
 Huntington Station  
 400-201-1-103

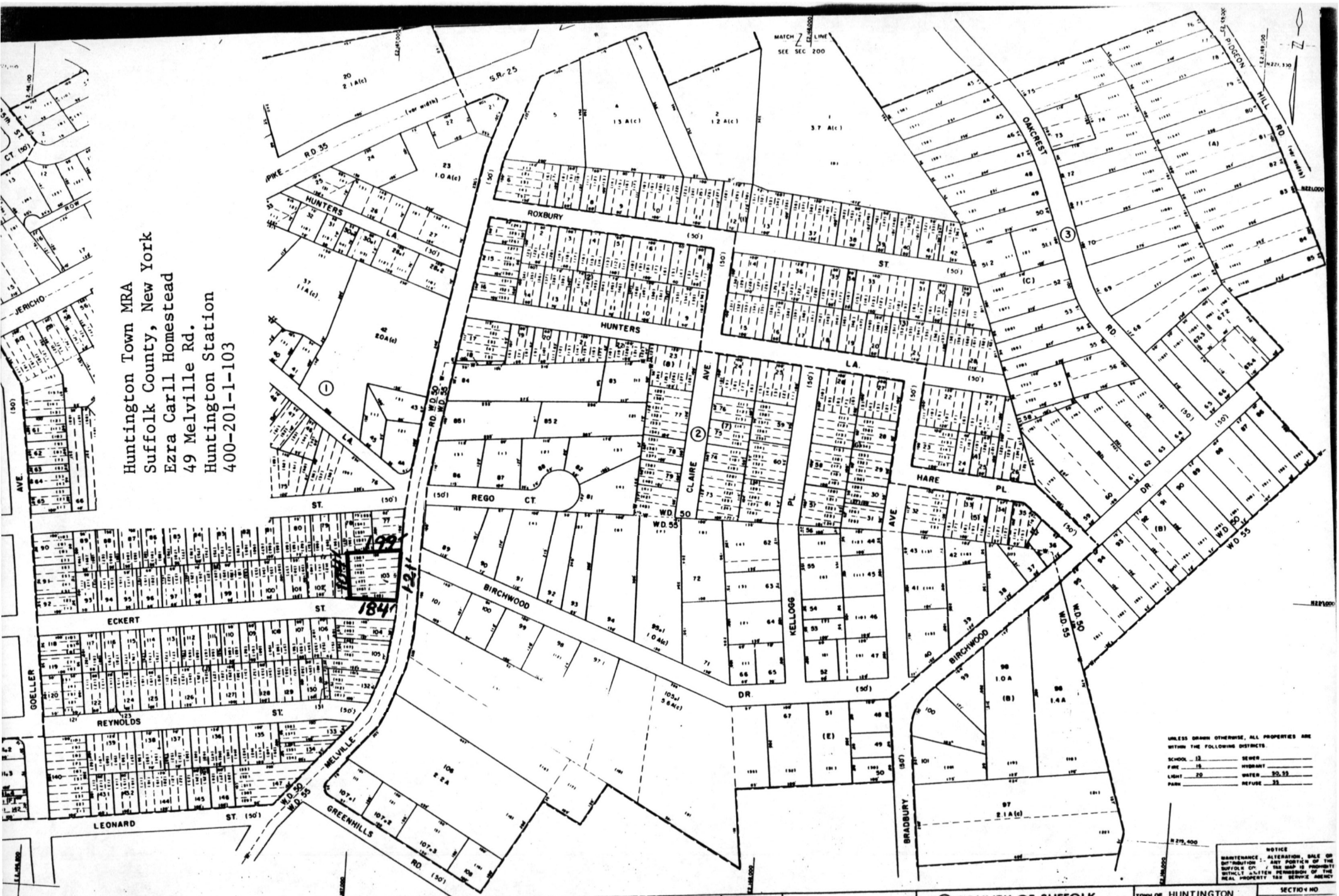

UNLESS SHOWN OTHERWISE, ALL PROPERTIES ARE WITHIN THE FOLLOWING DISTRICTS

|        |    |         |        |
|--------|----|---------|--------|
| SCHOOL | 33 | SEWER   |        |
| FIRE   | 15 | HYDRANT |        |
| LIGHT  | 20 | WATER   | 35, 33 |
| PAVE   |    | REFUSE  | 33     |

NOTICE: ALTERATION, SALE OR DISTRIBUTION OF ANY PORTION OF THIS MAP IS PROHIBITED WITHOUT WRITTEN PERMISSION OF THE REAL PROPERTY TAX SERVICE AGENCY

| Legend                   |     |
|--------------------------|-----|
| Property or R/W Line     | —   |
| County Line              | —   |
| Demarcation Common Owner | —   |
| Subdivision Lot Line     | —   |
| Revised                  | —   |
| Revised/Amended          | —   |
| Fire District Line       | F   |
| Water District Line      | W   |
| Light District Line      | L   |
| PA District Line         | P   |
| Sanitary District Line   | S   |
| Hydrant District Line    | H   |
| Refuse District Line     | R   |
| Black No.                | ①   |
| Parcel No.               | 33  |
| Subdivision Block No.    | 134 |
| Subdivision Lot No.      | 134 |
| Dead Dimension           | 67  |
| Scaled Dimension         | 63  |
| Acad Area                | 62  |
| Parcel No.               | 33  |
| Subdivision Block No.    | 134 |



© COUNTY OF SUFFOLK  
 Real Property Tax Service Agency  
 County Center  
 Riverhead, L.I., New York

TOWN OF HUNTINGTON  
 VILLAGE OF  
 DISTRICT NO 1420  
 SECTION NO  
**201**  
 PREPARED BY

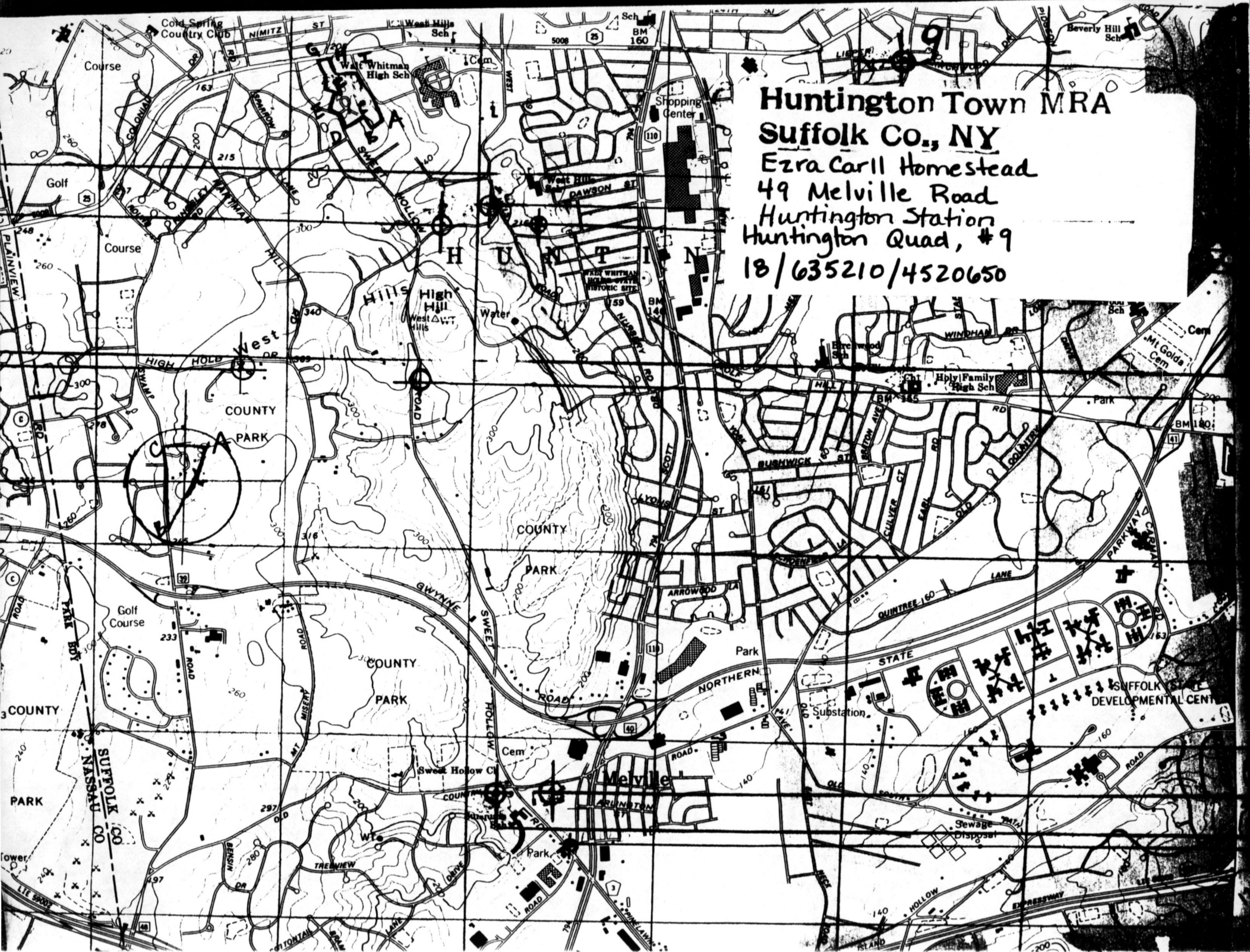

**Huntington Town MRA**  
**Suffolk Co., NY**  
Ezra Carll Homestead  
49 Melville Road  
Huntington Station  
Huntington Quad, #9  
18/635210/4520650