

**United States Department of the Interior
Heritage Conservation and Recreation Service**

**National Register of Historic Places
Inventory—Nomination Form**

See instructions in *How to Complete National Register Forms*
Type all entries—complete applicable sections

For HCRS use only

received JAN 28 1982

date entered FEB 25 1982

1. Name

historic Former Emigrant Industrial Savings Bank

and/or common 51 Chambers Street

2. Location

street & number 51 Chambers Street _____ not for publication

city, town New York _____ vicinity of _____ congressional district 17

state New York code 036 county New York code 061.

3. Classification

Category	Ownership	Status	Present Use
<input type="checkbox"/> district	<input checked="" type="checkbox"/> public	<input checked="" type="checkbox"/> occupied	<input type="checkbox"/> agriculture
<input checked="" type="checkbox"/> building(s)	<input type="checkbox"/> private	<input type="checkbox"/> unoccupied	<input type="checkbox"/> commercial
<input type="checkbox"/> structure	<input type="checkbox"/> both	<input type="checkbox"/> work in progress	<input type="checkbox"/> educational
<input type="checkbox"/> site	Public Acquisition	Accessible	<input type="checkbox"/> entertainment
<input type="checkbox"/> object	<input type="checkbox"/> in process	<input checked="" type="checkbox"/> yes: restricted	<input checked="" type="checkbox"/> government
	<input type="checkbox"/> being considered	<input type="checkbox"/> yes: unrestricted	<input type="checkbox"/> industrial
		<input type="checkbox"/> no	<input type="checkbox"/> military
			<input type="checkbox"/> museum
			<input type="checkbox"/> park
			<input type="checkbox"/> private residence
			<input type="checkbox"/> religious
			<input type="checkbox"/> scientific
			<input type="checkbox"/> transportation
			<input type="checkbox"/> other:

4. Owner of Property

name James F. Capalino, Commissioner
Department of General Services

street & number 1800 Municipal Building

city, town New York _____ vicinity of _____ state New York 10007

5. Location of Legal Description

courthouse, registry of deeds, etc. New York County Register's Office

street & number 31 Chambers Street

city, town New York _____ state New York 10007

6. Representation in Existing Surveys

(LP-1123)
title Landmarks Preservation Commission has this property been determined eligible? ☐ yes ☒ no

date January 8, 1980 _____ federal _____ state _____ county ☒ local

depository for survey records Landmarks Preservation Commission 20 Vesey Street

city, town New York _____ state New York 10007

7. Description

Condition

☐ excellent

☒ good

☐ fair

☐ deteriorated

☐ ruins

☐ unexposed

Check one

☒ unaltered

☐ altered

Check one

☒ original site

☐ moved

date _____

Describe the present and original (if known) physical appearance

Rising high above its closest neighbors, the fourteen-story former Emigrant Industrial Savings Bank building is located in downtown Manhattan, within New York's governmental center. It is on a north-south axis with City Hall and the Tweed Courthouse, and its tall form creates a backdrop for these smaller buildings. It fills its lot between Reade and Chambers streets and is flanked on one side by the Sun Building and on the other by a parking lot.

The Chambers Street facade has three entrances and the ornate center one leads to the main banking room. Its heavily ornamented bronze doors have recently been enclosed behind a plain glass door for protection. The granite enframing is topped by a curved pediment mounted on brackets. The tympanum of the pediment is filled with carved cornucopias. The two smaller doors are enframed by a plain granite surround with their street addresses marked above the doors. Linking the doorways on this ground level is a wide band of Greek fret molding. Tall windows fill a large area above the doorways and illuminate the double-height banking room within. These windows are divided into nine bays by a series of rusticated columns and piers which extend across the entire front of the building. These columns support a heavy entablature which crowns the base of the building and which carries a panel with the name of the bank.

Above this rusticated base, the building rises in an H-shaped plan which allows light and air to reach all the office spaces within the tower. From the street, the impression thus created is of twin towers, each three bays wide, rising from a solid base with a deep recess between them. The towers are linked to the base by a transitional story with carved geometric designs surrounding each of the squared windows on the towers. Centered between the towers, in front of the recess, is a large sculptural group composed of a crest set between two allegorical figures.

For the next ten stories, the building rises in a regular rhythm of copper-framed windows surrounded by flat, ashlar limestone. The stone piers continue in an unbroken line, emphasizing the height of the building. Each of the three bays of the towers contains square-headed windows while the fenestration pattern in the recessed area of the building varies from flat to rounded and angled bows, each window of the nine bays projecting out slightly more from the facade than the one beside it.

The eleventh floor serves as a transition to the top of the building. It surmounts a small cornice which rests on heavily sculpted brackets and is in turn topped by a larger cornice supported by heavy brackets and modillions. The high mansard roof rises above this, the three dormers of each tower encased in carved stonework. A large beehive is located above the central window with three copper bees mounted on it. This symbol of industriousness is found throughout the bank building. Surmounting the beehive is a heavy pediment encased in garlands. This in turn is topped by a large eagle with spread wings. The top ridge of the mansard is edged with a parapet with large urns located at each corner. The parapet continues around the recess, interspersed with sections of a balustrade or with ornamental panels.

On the western side, the building shares a party wall with the smaller, Sun Building. Another low building joined the bank on its eastern wall when it was constructed but has since been removed. Above the two smaller buildings, the side walls of the bank are plain brick with minimal fenestration.

**United States Department of the Interior
Heritage Conservation and Recreation Service**

**National Register of Historic Places
Inventory—Nomination Form**

For NCRS use only
received JAN 23 1982
date entered

Continuation sheet Emigrant Industrial Savings Bank, New York County Item number 7

Page 2

The rear of the building faces Reade Street and is a modified, less ornate version of the Chambers Street facade. Three entrances are located on the ground floor with the larger, central one providing access to the main banking room. The two doors on the sides are framed in granite which is inset with each street address. Three small square windows covered by iron grilles are located between each door on this level. Large expanses of windows fill the floors above this ground level, lighting the banking room within. These windows are separated by flat pilasters into a wide, central section with three bays on each side. An entablature above these pilasters carries a frieze embellished with the name of the bank. The "H" shape of the building continues on this elevation as on the front, creating twin towers twelve stories high with a deep recess between them. Each tower is three bays wide, each bay being filled by an angled bow window composed of three sections. The windows are framed in copper with iron spandrels between the floors. White brick piers rise between each bay and continue uninterrupted through the height of each tower. The recess between the towers is seven bays wide on this side, each bay projecting further from the wall in a varied pattern of flat, angled and rounded bows. In front of the recess, just above the base of the building, a small pediment spans the opening and marks the center of the building. The brick work continues up beyond the top of the building to create a straight, simple, parapet inset with panels, as a crowning element to the building. The western corner of this parapet is missing from the roof line.

The main floor of this building holds a large banking room faced with Italian white marble. Marble and iron tellers' cages ring the center of the room which is graced with five large elliptically shaped skylights filled with stained glass in allegorical design. The rest of the building is divided for office space.

8. Significance

Period	Areas of Significance—Check and justify below			
<input type="checkbox"/> prehistoric	<input type="checkbox"/> archeology-prehistoric	<input type="checkbox"/> community planning	<input type="checkbox"/> landscape architecture	<input type="checkbox"/> religion
<input type="checkbox"/> 1400–1499	<input type="checkbox"/> archeology-historic	<input type="checkbox"/> conservation	<input type="checkbox"/> law	<input type="checkbox"/> science
<input type="checkbox"/> 1500–1599	<input type="checkbox"/> agriculture	<input type="checkbox"/> economics	<input type="checkbox"/> literature	<input type="checkbox"/> sculpture
<input type="checkbox"/> 1600–1699	<input checked="" type="checkbox"/> architecture	<input type="checkbox"/> education	<input type="checkbox"/> military	<input type="checkbox"/> social/
<input type="checkbox"/> 1700–1799	<input type="checkbox"/> art	<input type="checkbox"/> engineering	<input type="checkbox"/> music	<input type="checkbox"/> humanitarian
<input type="checkbox"/> 1800–1899	<input type="checkbox"/> commerce	<input type="checkbox"/> exploration/settlement	<input type="checkbox"/> philosophy	<input type="checkbox"/> theater
<input checked="" type="checkbox"/> 1900–	<input type="checkbox"/> communications	<input type="checkbox"/> industry	<input type="checkbox"/> politics/government	<input type="checkbox"/> transportation
		<input type="checkbox"/> invention		<input type="checkbox"/> other (specify)

Specific dates 1912-13 **Builder/Architect** Raymond F. Almirall

Statement of Significance (in one paragraph)

Built in 1912-13 after the designs of Raymond F. Almirall, the former Emigrant Industrial Savings Bank building is an impressive and well-designed Beaux-Arts office tower with noteworthy features on its exterior as well as its interior. Its facade is highlighted by finely crafted sculptural groups over the base as well as on the high mansard roof. Upon its opening, the bank was praised for its innovative H-plan, the first ever used on a large office building. In addition, its opulent banking hall in the center of the ground floor is one of the few remaining intact banking halls in New York City and is especially unique for the date of its construction, before World War I.

The Emigrant Industrial Savings Bank was organized in 1850 under the auspices of Bishop John Hughes and the Irish Emigrant Society. Its purpose was to protect the savings of newly arrived immigrants from unscrupulous people who might take advantage of their naivete. The original quarters of the bank was on this same site and through the years it had occupied two smaller buildings here, before this office tower was constructed in the early twentieth century. Continued success and expansion of banking functions provided the impetus for ever larger buildings.

The Paris-trained architect Raymond F. Almirall was chosen to design this building. Known for the numerous churches and hospitals in the New York area which he designed, Almirall also served as consulting architect for the Brooklyn Library and was responsible for the designs of several buildings in that system. Almirall's Beaux-Arts training is evident in his design for the Emigrant Industrial Savings Bank building in which can be seen the careful planning, the fine command of space in the banking hall and the abundant yet judiciously placed ornament. In this building Almirall created grand and elegant interior and exterior spaces which were a reflection of the strength and dignity of the bank itself.

The building is now owned by the City of New York and houses various city offices. The banking room now serves the Parking Violations Bureau.

Raymond F. Almirall
58 Pl. 16

9. Major Bibliographical References

See continuation sheet

10. Geographical DataAcreage of nominated property less than one acreQuadrangle name Jersey City, N.J.-N.Y.Quadrangle scale 1:24,000

UMT References

✓ A

1	8
---	---

5	8	4	0	2	0
---	---	---	---	---	---

4	5	0	7	2	6	0
---	---	---	---	---	---	---

Zone Easting Northing

B

--	--

--	--	--	--	--	--

--	--	--	--	--	--

Zone Easting Northing

C

--	--

--	--	--	--	--	--

--	--	--	--	--	--

D

--	--

--	--	--	--	--	--

--	--	--	--	--	--

E

--	--

--	--	--	--	--	--

--	--	--	--	--	--

F

--	--

--	--	--	--	--	--

--	--	--	--	--	--

G

--	--

--	--	--	--	--	--

--	--	--	--	--	--

H

--	--

--	--	--	--	--	--

--	--	--	--	--	--

Verbal boundary description and justification

The nominated property occupies Borough of Manhattan Tax Map Block 153, Lot 1 in part, consisting of that section on which the building is located, being approximately 152x122 feet, and which is outlined on the attached map.

List all states and counties for properties overlapping state or county boundaries

state	code	county	code
state	code	county	code

state	code	county	code
state	code	county	code

11. Form Prepared By

name/title Virginia Kurshan, Landmarks Preservation Specialist Contact: Anne B. Covell, State Div. for Hist. Pres. (518)474-0479

organization Landmarks Preservation Commission date June 1981

street & number 20 Vesey Street telephone (212)566-7577

city or town New York state New York 10007

12. State Historic Preservation Officer Certification

The evaluated significance of this property within the state is:

☐ national ☐ state ☒ local

As the designated State Historic Preservation Officer for the National Historic Preservation Act of 1966 (Public Law 89-665), I hereby nominate this property for inclusion in the National Register and certify that it has been evaluated according to the criteria and procedures set forth by the Heritage Conservation and Recreation Service.

State Historic Preservation Officer signature

Anne Webster Smith

title Deputy Commissioner for Historic Preservation date 21 January 1982

For HCRS use only

I hereby certify that this property is included in the National Register

Entered in the
National Register

date

2/25/82

Keeper of the National Register

Attest:

date

Chief of Registration

**United States Department of the Interior
Heritage Conservation and Recreation Service**

**National Register of Historic Places
Inventory—Nomination Form**

For NCRS use only
received JAN 23 1982
date entered

Continuation sheet Emigrant Industrial Savings Item number 9

Page 2

Bank, New York County

Bennett, William H. A Chronological History of The Emigrant Industrial Savings Bank. Typescript, c.1931.

"Emigrant Industrial Savings Bank." Architecture and Building. 45 (January, 1913), 17.

"The H Plan for Office Buildings, Adopted for the Emigrant Savings Bank's New Operation." Real Estate Record and Guide. 84 (August 7, 1909), 254.

New York City Landmarks Preservation Commission research files: Emigrant Industrial Savings Bank.

PLATE 6

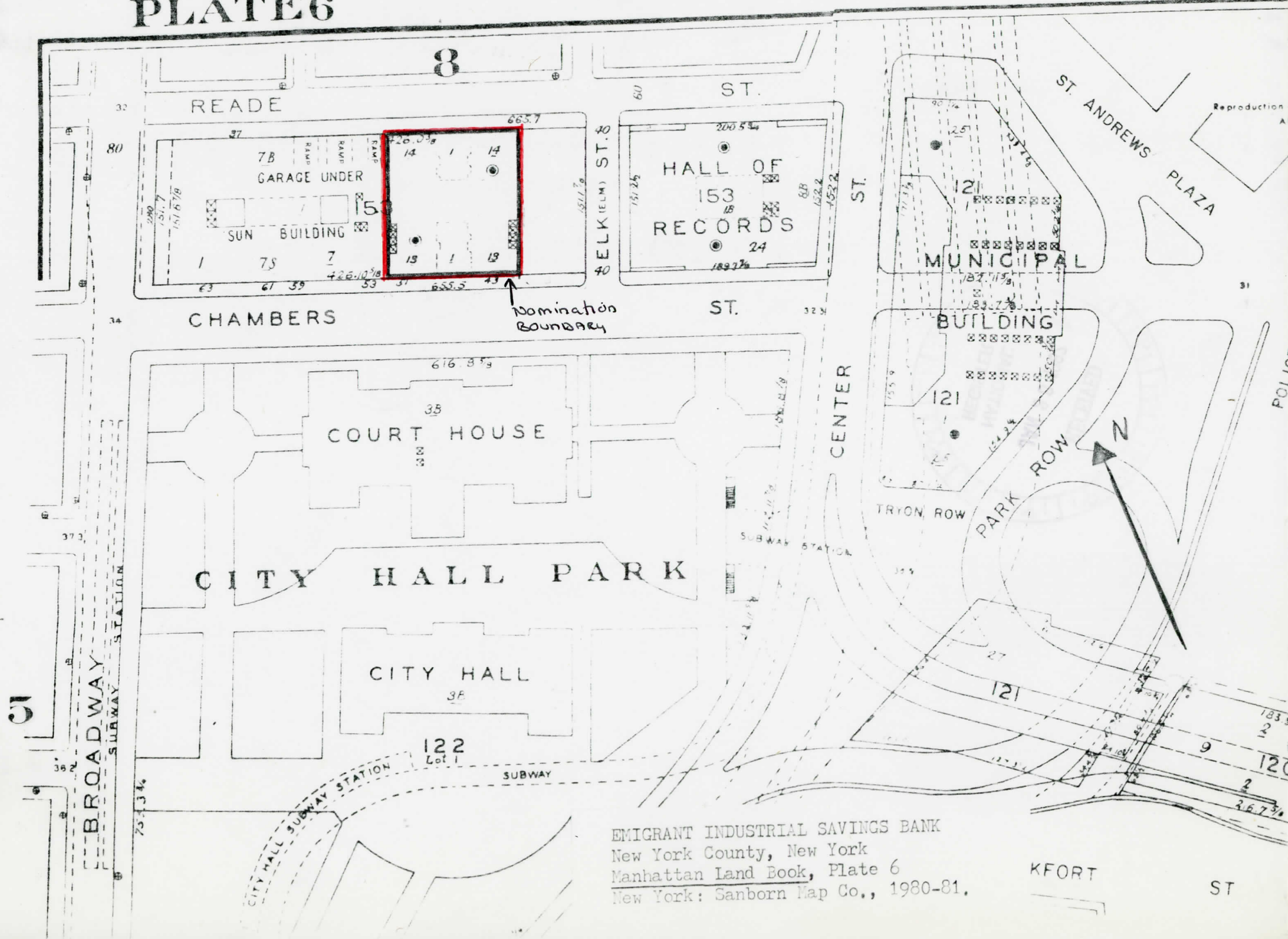

EMIGRANT INDUSTRIAL SAVINGS BANK
 New York County, New York
 Manhattan Land Book, Plate 6
 New York: Sanborn Map Co., 1980-81.

KFORT

ST

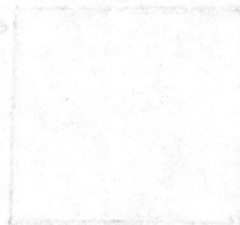

DUE 2/25/82 - 3/14/82

Farmer

Name Emigrant Industrial Savings Bank
State, County NY NY Fed Nom or Request-Agency
Working Number 1-28-82-913 Federal Register Date 2.7.83

gnr-3

☒ Nomination
☐ Determination of Eligibility
☐ On Nomination Form

☒ Bldg(s)
☐ Site
☐ Object
☐ Structure
☐ District

Within:
☐ Multiple Resource Area
☐ Thematic Group

Maps 4/5
Photos 5

Nomination prepared by:
☐ State Staff
☐ Local
☒ Other

Entered in the
Action: National Register
☒ ACCEPT 2/25/82
☐ RETURN
☐ REJECT

Check if Appropriate:
☐ State Request for Review
☐ Keeper's Decision to Review
☐ 2nd Return

I. Evaluation of Resource (cont. on back if necessary)

II. Evaluation of Nomination

	Good	Adequate	Poor	Comments
1. Descriptive Statement Short Format <input type="checkbox"/> Yes <input type="checkbox"/> No				
2. Significance Statement Short Format <input type="checkbox"/> Yes <input type="checkbox"/> No				
3. Concepts/Integrity				
4. Concepts/Criteria				
5. Concepts/Boundaries				
6. Contextual Evaluation				

General Comments (cont. on back if necessary):

Reviewer/Date _____

See Attached _____



1. Emigrant Industrial Savings Bank
New York County, New York

Photo: 1980

Neg. at: New York Landmarks
Preservation Commission

Chambers St. elevation, view from the
southeast

JAN 28 1982



2. Emigrant Industrial Savings Bank
New York County, New York

Photo: 1980

Neg. at: New York Landmarks
Preservation Commission

Reade St. elevation, view from the
northeast

JAN 28 1982



3. EMIGRANT INDUSTRIAL SAVINGS BANK
New York County, New York

Photo by: Carl Forster, 1981
Neg. at: New York Landmarks
Preservation Commission

Chambers Street elevation, view
from the south

JAN 28 1982



4. EMIGRANT INDUSTRIAL SAVINGS BANK
New York County, New York

Photo by: Carl Forster, 1981
Neg. at: New York Landmarks
Preservation Commission

Interior, view from the north

JAN 28 1982



5. EMIGRANT INDUSTRIAL SAVINGS BANK
New York County, New York

Photo by: Carl Forster, 1981
Neg. at: New York Landmarks
Preservation Commission

Ceiling detail

JAN 28 1982

UNITED STATES
DEPARTMENT OF THE INTERIOR
GEOLOGICAL SURVEY

JERSEY CITY QUADRANGLE
NEW JERSEY—NEW YORK
7.5 MINUTE SERIES (TOPOGRAPHIC)

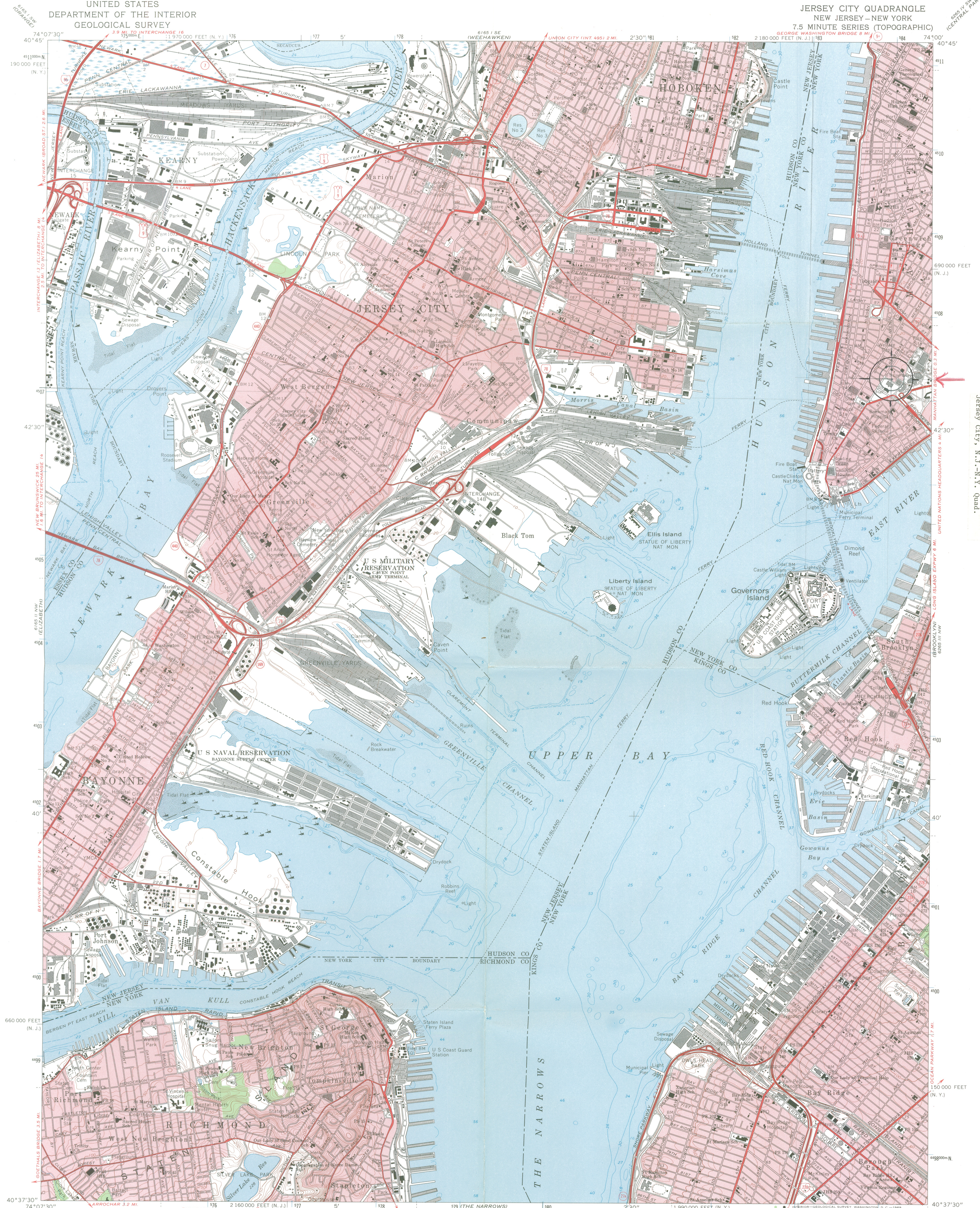

Emigrant Industrial Savings Bank
New York County, New York
UTM Reference:
18 5840 20 45072 60
Jersey City, N.J.—N.Y. Quad.

Mapped, edited, and published by the Geological Survey
Revised in cooperation with New York Department of Transportation
Control by USGS, USC&GS, USCE, New Jersey Geodetic Survey,
and City of New York Board of Estimate and Apportionment
Planimetry by photogrammetric methods and from USC&GS
Charts T-5111, T-5277, T-5332, T-5450, T-5453, T-5454,
T-5460, T-5461, T-5466, T-5468, T-5469, and T-5470
Topography by photogrammetric methods from aerial
photographs taken 1954 and planetable surveys 1955
Revised from aerial photographs taken 1966. Field checked 1967
Selected hydrographic data compiled from USC&GS Charts 285, 287, 541,
and 745 (1966). This information is not intended for navigational purposes
Polyconic projection, 1927 North American datum, 10,000-foot grids based on
New Jersey coordinate system, and New York coordinate system, Long Island zone
1000-meter Universal Transverse Mercator grid ticks, zone 18, shown in blue
Red tint indicates areas in which only landmark buildings are shown

UTM GRID AND 1987 MAGNETIC NORTH
DECLINATION AT CENTER OF SHEET
111° 03' 30" W
0° 37' 11" N
204 MILES
11 MILLS
1 KILOMETER
CONTOUR INTERVAL 10 FEET
DATUM IS MEAN SEA LEVEL
DEPTH CURVES AND SOUNDINGS IN FEET—DATUM IS MEAN LOW WATER
SHORELINE SHOWN REPRESENTS THE APPROXIMATE LINE OF MEAN HIGH WATER
THE MEAN RANGE OF TIDE IS APPROXIMATELY 4.4 FEET IN
UPPER BAY AND 4.8 FEET IN NEWARK BAY
THIS MAP COMPLIES WITH NATIONAL MAP ACCURACY STANDARDS
FOR SALE BY U.S. GEOLOGICAL SURVEY, WASHINGTON, D. C. 20242
A FOLDER DESCRIBING TOPOGRAPHIC MAPS AND SYMBOLS IS AVAILABLE ON REQUEST

ROAD CLASSIFICATION
Heavy-duty ——— Light-duty ———
Unimproved dirt ———
Interstate Route U.S. Route State Route
JERSEY CITY, N.J.—N.Y.
N4037.5—W7400/7.5
1967
AMS 6165 II NE—SERIES V822
RECEIVED
JAN 28 1982
NATIONAL
REGISTER

ENTRIES IN THE NATIONAL REGISTER OF HISTORIC PLACES

STATE NEW YORK

Date Entered FEB. 25, 1982

Name

Location

Bronx Borough Courthouse

Bronx
Bronx County

Boys' High School

Brooklyn
Kings County

Emigrant Industrial Savings Bank

New York
New York County

Notified

Honorable Daniel P. Moynihan
Honorable Alfonse D'Amato
Honorable Robert Garcia
Honorable Frederick W. Richmond
Honorable Guy V. Molinari

State Historic Preservation Officer
Mr. Orin Lehman
Commissioner, Office of Parks
Recreation and Historic
Preservation
Agency Building #1
Empire State Plaza
Albany, New York 12238

Mid-Atlantic Regional Office, NPS
North Atlantic Regional Office, NPS

For further information, please call the National Register at (202) 272-3504