

**NATIONAL REGISTER OF HISTORIC PLACES  
INVENTORY - NOMINATION FORM**

(Type all entries - complete applicable sections)

STATE: <b>New York</b>	
COUNTY: <b>New York</b>	
FOR NPS USE ONLY	
ENTRY NUMBER	DATE
<b>JUN 4 1973</b>	

**1. NAME**

COMMON:  
**Church of the Transfiguration and Rectory**

AND/OR HISTORIC:  
**"The Little Church Around the Corner"**

**2. LOCATION**

STREET AND NUMBER:  
**1 East 29th Street**

CITY OR TOWN:  
**New York**

STATE: **New York**      CODE: **36**      COUNTY: **New York**      CODE: **061**

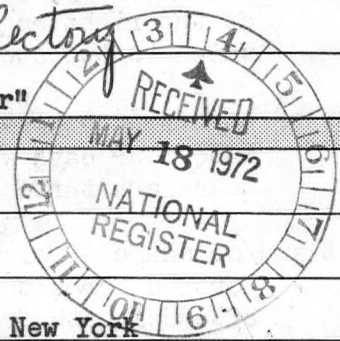

**3. CLASSIFICATION**

CATEGORY (Check One)	OWNERSHIP	STATUS	ACCESSIBLE TO THE PUBLIC
<input type="checkbox"/> District <input checked="" type="checkbox"/> Building <input type="checkbox"/> Site <input type="checkbox"/> Structure <input type="checkbox"/> Object	<input type="checkbox"/> Public <input checked="" type="checkbox"/> Private <input type="checkbox"/> Both	<input checked="" type="checkbox"/> Occupied <input type="checkbox"/> Unoccupied <input type="checkbox"/> Preservation work in progress	Yes: < <input type="checkbox"/> Restricted <input checked="" type="checkbox"/> Unrestricted <input type="checkbox"/> No
PRESENT USE (Check One or More as Appropriate)			
<input type="checkbox"/> Agricultural <input type="checkbox"/> Commercial <input type="checkbox"/> Educational <input type="checkbox"/> Entertainment	<input type="checkbox"/> Government <input type="checkbox"/> Industrial <input type="checkbox"/> Military <input type="checkbox"/> Museum	<input type="checkbox"/> Park <input type="checkbox"/> Private Residence <input checked="" type="checkbox"/> Religious <input type="checkbox"/> Scientific	<input type="checkbox"/> Transportation <input type="checkbox"/> Other (Specify) _____ _____ _____

**4. OWNER OF PROPERTY**

OWNER'S NAME:  
**Congregation, Church of the Transfiguration**

STREET AND NUMBER:  
**1 East 29th Street**

CITY OR TOWN: **New York**      STATE: **New York**      CODE: **36**

**5. LOCATION OF LEGAL DESCRIPTION**

COURTHOUSE, REGISTRY OF DEEDS, ETC.:  
**New York County Hall of Records**

STREET AND NUMBER:  
**31 Chambers Street**

CITY OR TOWN: **New York**      STATE: **New York**      CODE: **36**

**6. REPRESENTATION IN EXISTING SURVEYS**

TITLE OF SURVEY:  
**New York City Landmarks Preservation Commission**

DATE OF SURVEY: **May 25, 1967**       Federal       State       County       Local

DEPOSITORY FOR SURVEY RECORDS:  
**New York City Landmarks Preservation Commission**

STREET AND NUMBER:  
**305 Broadway**

CITY OR TOWN: **New York**      STATE: **New York**      CODE: **36**

SEE INSTRUCTIONS

STATE: <b>New York</b>
COUNTY: <b>New York</b>
ENTRY NUMBER: <b>JUN 4 1973</b>
DATE: <b>JUN 4 1973</b>

FOR NPS USE ONLY

## 7. DESCRIPTION

CONDITION	(Check One)					
	<input checked="" type="checkbox"/> Excellent	<input type="checkbox"/> Good	<input type="checkbox"/> Fair	<input type="checkbox"/> Deteriorated	<input type="checkbox"/> Ruins	<input type="checkbox"/> Unexposed
	(Check One)			(Check One)		
	<input checked="" type="checkbox"/> Altered	<input type="checkbox"/> Unaltered	<input type="checkbox"/> Moved	<input type="checkbox"/> Original Site		

DESCRIBE THE PRESENT AND ORIGINAL (if known) PHYSICAL APPEARANCE

Number of stories: East of the three story main tower the church proper is one story, except for the projecting octagonal tower, located at the right angle formed by the meeting of nave and transept, which is two stories.

Number of bays: East of the main tower three buttresses divide the wall into four bays with varied window arrangement. West of the tower there are three bays.

Layout and/or shape of plan: The plan is an irregular 'L'. The longer portion forms the nave. The shorter arm of the 'L' (the transept) extends south from the nave ending in a small apse.

Wall construction: Wall construction is red brick and brownstone trim - five (occasionally six) rows of stretchers bounded above and below by a single row of headers.

Structural system: The structural system is masonry bearing wall.

Roof: The roof is green copper, except that <sup>of</sup> the octagonal tower, which is gray slate. East of the main tower the roof slopes gently over the side aisle, then rises at a steep angle to the ridge above the nave.

Porches, dormers: The main entrance, in the buttressed tower, has a small semi-circular glass canopy decorated at its edges by the same free-standing, metal, Gothic ornament that crowns the masonry walls of the tower. To the East, two dormers serve as clerestory windows for the nave. To the west two larger dormers form the fenestration for the second floor room.

Important interior features: A continuous series of large wooden beams in the form of the letter 'X' extends the length of the nave having some structural relation to the sloping sides of the ceiling composed of panels of narrow wooden strips set in a herringbone pattern. In the west wall of the transept two tall stained glass windows extend through the eaves.

Other notable features: A distinguishing feature of the church is the lich-gate (Frederick C. Withers architect), a small structure carried on stone Gothic arches supporting the pyramidal-shaped nubby green copper roof.

Alterations and additions: The original one story building of the church was completed in 1849. Additions and alterations began in 1852. In 1854 the main or entrance tower was erected and the transept was built, being further extended in 1861. In 1856 the cast iron fence was given. The lich-gate was presented in 1896. In 1906 the Lady Chapel was constructed and in 1908 St. Joseph's Mortuary Chapel.

SEE INSTRUCTIONS

NATIONAL REGISTER OF HISTORIC PLACES  
INVENTORY - NOMINATION FORM

(Continuation Sheet)

STATE	
New York	
COUNTY	
New York	
FOR NPS USE ONLY	
ENTRY NUMBER	DATE
	JUN 4 1973

(Number all entries) 7.1

Like the Church of the Transfiguration, with which it is connected, the five-story, Gothic Revival Rectory stands back from the street in its quiet garden. Dating from about 1849-50, (architect unknown), it is constructed of masonry bearing walls of red brick with brownstone veneer at the front facade. The plan is rectangular in shape, with a five-sided, tower-like, extension projecting from the east elevation.

The main (south) front is of smooth, brownstone, ashlar veneer and three windows in width. The ground floor remodelled at a later date, now has a low-arched, off-center entrance, which, together with the windows on either side of it, have a light limestone trim. Above them, a horizontal molding of the same material extends across the front, framing the carved shield over the door and unifying the disparate rectangular shapes of the three openings. Except for the third story oriel window, each of the symmetrically placed windows-- in the second, third and fourth stories-- has a prominently molded dripstone. A bracketed cornice supports the steeply sloping slate mansard roof that contains three pedimented dormer windows.

The east wall and projecting extension are of red brick. The north and south walls of this five-sided extension are wider than the other three. In the center of the south wall, a handsome three sided wooden bay window rises four stories and is topped by the same continuous bracketed cornice which wraps around the house. Above this bay window is a mansard roof with a small dormer in the center. It relates closely to the design of the roof above the main extension. The eastern portion of the wing has diagonal corners, all with windows, some of which are blind. It is crowned by a mansard roof.

As the third story oriel window becomes a focal point of the front elevation, so attention is drawn to the third story of the bay window by a balcony with ornamental cast iron railing and Gothic tracery design just above the window.

**8. SIGNIFICANCE**

PERIOD (Check One or More as Appropriate)

- |  |                                       |  |                                       |
|--|---------------------------------------|--|---------------------------------------|
| <input type="checkbox"/> Pre-Columbian | <input type="checkbox"/> 16th Century | <input type="checkbox"/> 18th Century            | <input type="checkbox"/> 20th Century |
| <input type="checkbox"/> 15th Century  | <input type="checkbox"/> 17th Century | <input checked="" type="checkbox"/> 19th Century |                                       |

SPECIFIC DATE(S) (If Applicable and Known) **See continuation sheet**

AREAS OF SIGNIFICANCE (Check One or More as Appropriate)

- |  |   |  |
|--|---|--|
| <input type="checkbox"/> Aboriginal              | <input type="checkbox"/> Education              | <input type="checkbox"/> Political           |
| <input type="checkbox"/> Prehistoric             | <input type="checkbox"/> Engineering            | <input type="checkbox"/> Religion/Philosophy |
| <input type="checkbox"/> Historic                | <input type="checkbox"/> Industry               | <input type="checkbox"/> Science             |
| <input type="checkbox"/> Agriculture             | <input type="checkbox"/> Invention              | <input type="checkbox"/> Sculpture           |
| <input checked="" type="checkbox"/> Architecture | <input type="checkbox"/> Landscape Architecture | <input type="checkbox"/> Social/Humanitarian |
| <input type="checkbox"/> Art                     | <input type="checkbox"/> Literature             | <input checked="" type="checkbox"/> Theater  |
| <input type="checkbox"/> Commerce                | <input type="checkbox"/> Military               | <input type="checkbox"/> Transportation      |
| <input type="checkbox"/> Communications          | <input type="checkbox"/> Music                  |  |
| <input type="checkbox"/> Conservation            |   |  |

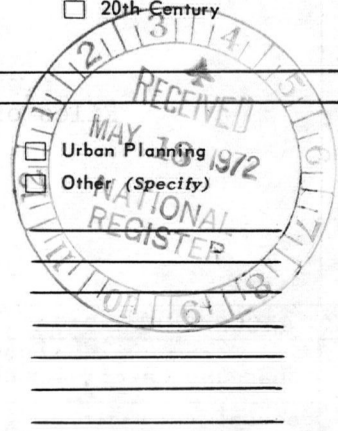

STATEMENT OF SIGNIFICANCE

The Church of the Transfiguration is a Gothic Revival building dating from 1849 with subsequent additions. Located in the shadow of the Empire State Building and almost hidden from view by tall surrounding buildings, it stands in its quiet garden, fenced off from the busy street. Its picturesque character and human scale, reminiscent of an English village church, make it look like a stage set standing in the heart of Manhattan. Nothing could be more fitting, since for many years it has been known as the actor's church.

From the eighteen sixties on the church began to play a role in the life of the city. The names of prominent New York families appear in the records of births, deaths and marriages. During the Civil War it is thought to have served as an underground station for escaped slaves, and at the time of the New York Draft Riots in 1863, the church offered refuge to negroes. In 1864 the rector established a bread line for the many unemployed, and this was reinstated in 1907 and 1930.

In 1896, Mrs. Franklin Hughes Delano, the former Laura Astor, whose grandnephew was Franklin Delano Roosevelt, presented the lich-gate, an architectural feature more common in England than in the United States. Its function originally was to provide a covered resting place at the entrance of the churchyard where the pallbearers could rest the coffin while awaiting the arrival of the priest. Lich is an Anglo-Saxon word meaning body or corpse.

Since 1870 The Church of the Transfiguration has been widely known as The Little Church Around the Corner. Joseph Jefferson, the well known American actor, had called at another church to arrange for the funeral of a friend. On learning that the friend was an actor, the minister hesitated a moment and then said he would be unable to conduct the service. Jefferson asked to be directed to another church and the minister replied, "There is a little church around the corner where it might be done". Under this name the church has become famous in verse and song, pictures and plays. In 1920 the lich-gate, with the church in the background, was the setting for the finale of Ziegfeld's musical comedy Sally.

The bond between the church and the arts continued to grow. Dion Boucicault, O. Henry and Edwin Booth were buried from here. Sir Henry

SEE INSTRUCTIONS

**9. MAJOR BIBLIOGRAPHICAL REFERENCES**

Files of New York City Landmarks Preservation Commission

18/585-300/4510780  
 4-19-76  
 CIVIL RIGHTS

**10. GEOGRAPHICAL DATA**

LATITUDE AND LONGITUDE COORDINATES DEFINING A RECTANGLE LOCATING THE PROPERTY			O R	LATITUDE AND LONGITUDE COORDINATES DEFINING THE CENTER POINT OF A PROPERTY OF LESS THAN TEN ACRES		
CORNER	LATITUDE	LONGITUDE		LATITUDE	LONGITUDE	
	Degrees Minutes Seconds	Degrees Minutes Seconds		Degrees	Minutes	Seconds
NW	0 ' "	0 ' "		40°	44'	45"
NE	0 ' "	0 ' "		73°	59'	15"
SE	0 ' "	0 ' "				
SW	0 ' "	0 ' "				

APPROXIMATE ACREAGE OF NOMINATED PROPERTY: **Under one acre**

LIST ALL STATES AND COUNTIES FOR PROPERTIES OVERLAPPING STATE OR COUNTY BOUNDARIES

STATE:	CODE	COUNTY	CODE

**11. FORM PREPARED BY**

NAME AND TITLE: **Max Kahn, Associate**

ORGANIZATION: **New York City Landmarks Preservation Commission**      DATE: **August 31, 1971**

STREET AND NUMBER: **305 Broadway**

CITY OR TOWN: **New York**      STATE: **New York**      CODE: **36**

**12. STATE LIAISON OFFICER CERTIFICATION      NATIONAL REGISTER VERIFICATION**

As the designated State Liaison Officer for the National Historic Preservation Act of 1966 (Public Law 89-665), I hereby nominate this property for inclusion in the National Register and certify that it has been evaluated according to the criteria and procedures set forth by the National Park Service. The recommended level of significance of this nomination is:

National       State       Local

Name: *Max Kahn*

Title: **Chairman, New York State Historic Trust**

Date: **28 10 '72**

I hereby certify that this property is included in the National Register.

*Robert M. Utley*  
 Chief, Office of Archeology and Historic Preservation

Date: **6/4/73**

ATTEST:

*Robert M. Utley*  
 Keeper of The National Register

Date: **5/31/73**

SEE INSTRUCTIONS

NATIONAL REGISTER OF HISTORIC PLACES  
INVENTORY - NOMINATION FORM

(Continuation Sheet)

STATE	New York	
COUNTY	New York	
FOR NPS USE ONLY		
ENTRY NUMBER		DATE
	JAN 4	1973

(Number all entries)  
8.1 STATEMENT OF SIGNIFICANCE (continued)

Irving, Dame Ellen Terry and Sarah Bernhardt attended services. There are memorial windows to some of America's most distinguished actors: Richard Mansfield, Joseph Jefferson, John Drew and Edwin Booth. The window for the latter was designed by the painter John LaFarge. A bronze plaque by the sculptor Paul Manship honors the actor Otis Skinner. Another memorial tablet is a tribute to three generations of the Benet family, distinguished in arts and letters. The church's deep shadowed interior has rightly been described as "a storehouse of assorted belongings".

In 1923 the Episcopal Actors Guild (a non-denominational membership group despite its name) set up headquarters in the second floor room with the large dormer windows west of the entrance tower. This was the first addition to the original church in 1852, thus continuing to the present day the association between the church and stage which Joseph Jefferson had first established more than a hundred years ago.

The church's historical and aesthetic interest is part of the cultural heritage and development of New York City. For more than a hundred years it has been linked to the culture of the city and the country and, through its history and tradition, it has become inseparably associated with the theatre and the arts.



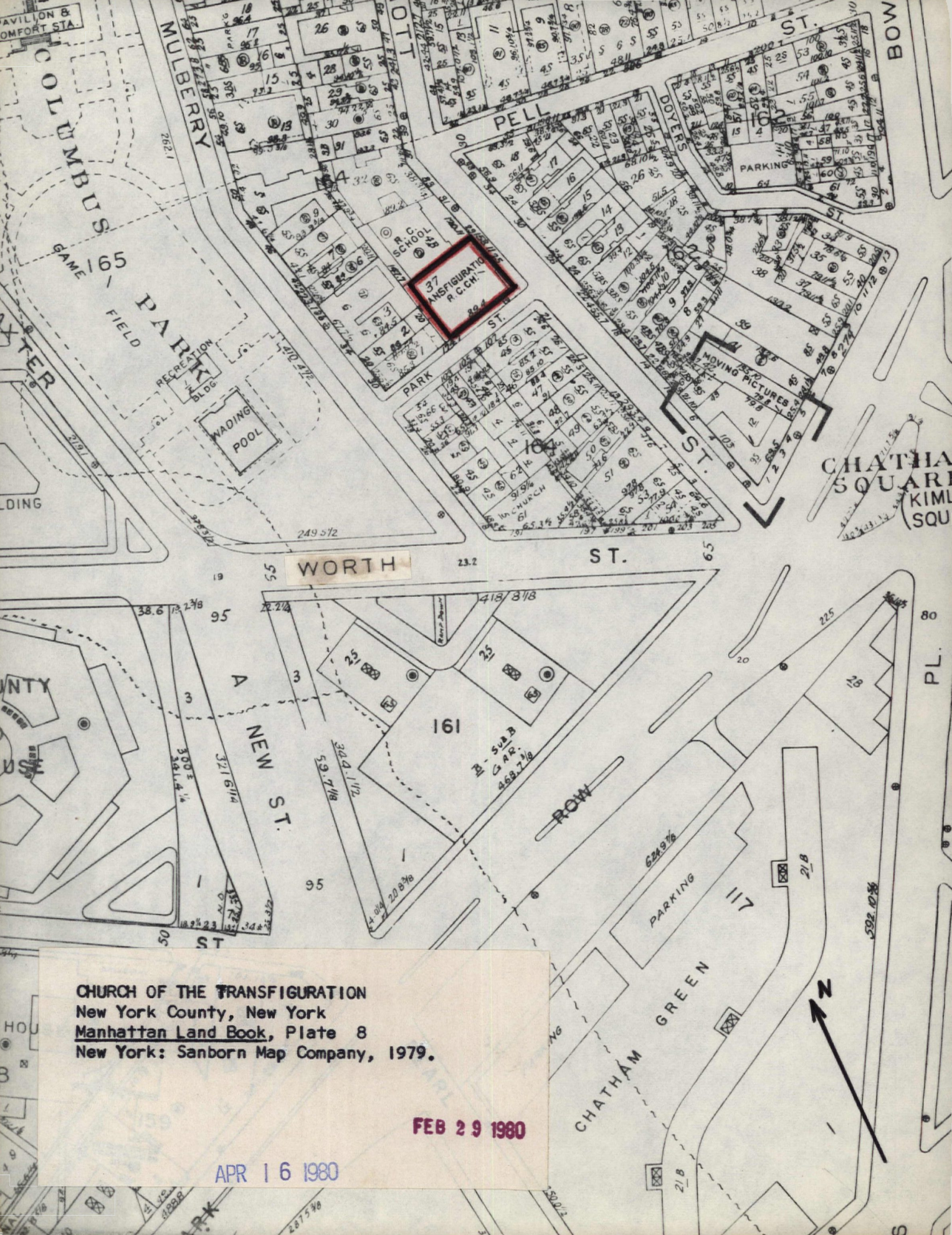

37  
TRANSFIGURATIO  
R.C. CH.

WORTH ST.

ST.

NEW ST.

ROW

CHATHAM GREEN

CHURCH OF THE TRANSFIGURATION  
 New York County, New York  
 Manhattan Land Book, Plate 8  
 New York: Sanborn Map Company, 1979.

FEB 29 1980

APR 16 1980

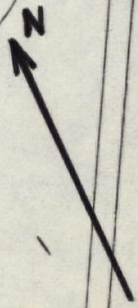

7300/216

Property Church of Transfiguration

State New York Working Number 12.17.76.4772

New York

**TECHNICAL**

Photos 5  
Maps 1

**CONTROL**

*OK pl*  
*12.22.76*

**HISTORIAN**

*OK*  
*Shaw*  
*4/4/77*

*Accept*  
*R.B. Frankler*  
*4.11.77*

**ARCHITECTURAL HISTORIAN**

*Accept*  
*MJ Hutz*  
*4-5-77*

**ARCHEOLOGIST**

**OTHER**

**HAER**

Inventory \_\_\_\_\_  
Review \_\_\_\_\_

**REVIEW UNIT CHIEF**

*Accept*  
*Cole*  
*4-22-77*

**BRANCH CHIEF**

**KEEPER**

*Hump*  
*7.6.77*

National Register Write-up \_\_\_\_\_  
Federal Register Entry 9.6.77

Send-back \_\_\_\_\_  
Re-submit \_\_\_\_\_

Entered JUL 26 1977

INT:2106-74

UNITED STATES  
DEPARTMENT OF THE INTERIOR  
GEOLOGICAL SURVEY

BROOKLYN QUADRANGLE  
NEW YORK  
7.5 MINUTE SERIES (TOPOGRAPHIC)  
NW/4 BROOKLYN 15' QUADRANGLE

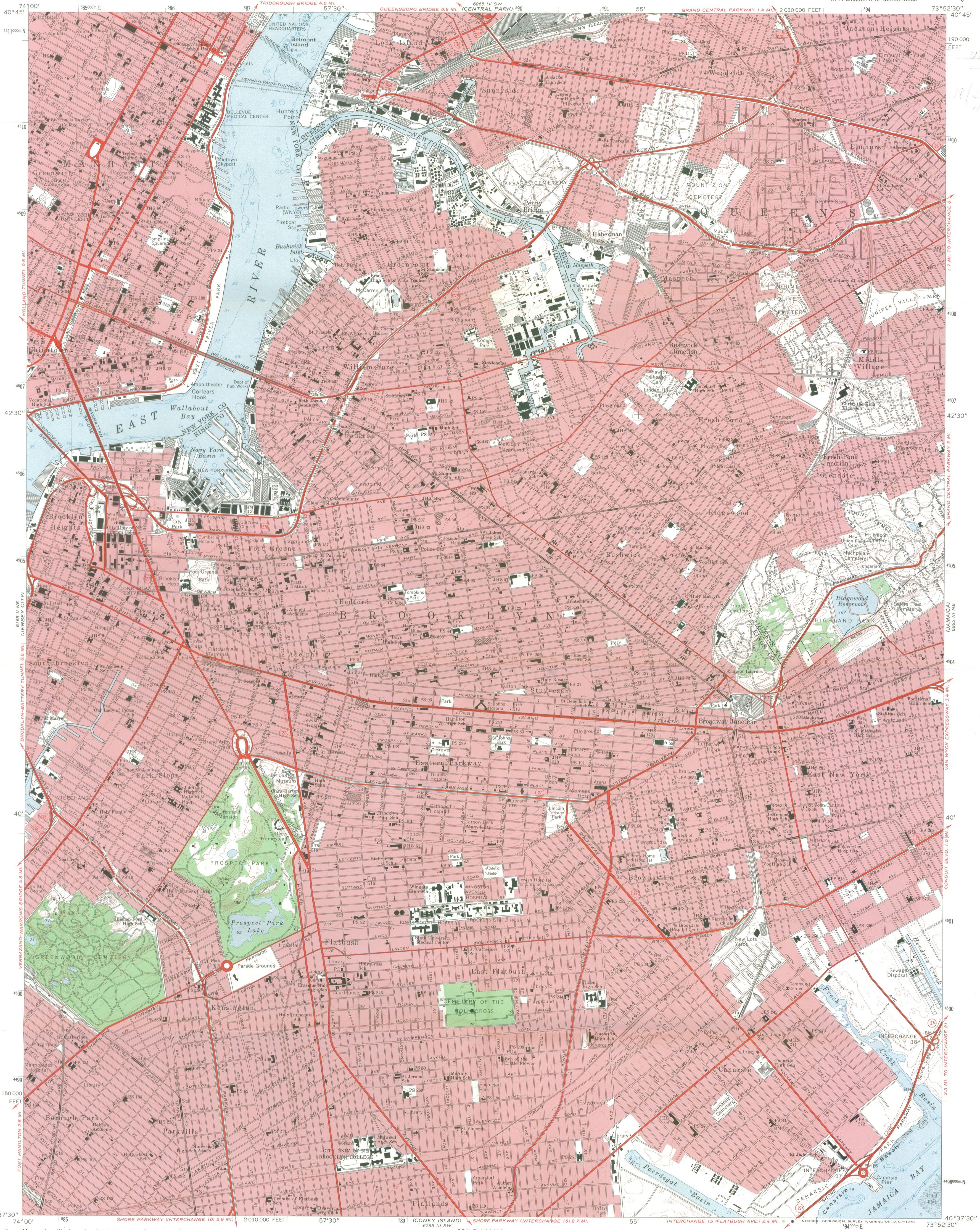

UTM REF. UN  
4510 16  
10/25/00  
4510 16

UTM GRID AND 1967 MAGNETIC NORTH DECLINATION AT CENTER OF SHEET

113° 07' 42" 204 MILS

UTM REF. UN  
4510 16

Maped, edited, and published by the Geological Survey  
Revised in cooperation with New York Department of Transportation  
Control by USGS, USC&GS, USCE, and City of New York Board of  
Estimate and Apportionment

Planimetry by photogrammetric methods from aerial photographs  
taken 1954, and from USC&GS Charts T-5094, T-5335, T-5454  
T-5459, T-5460, and T-8449

Topography by planetable surveys 1955-1956. Revised from  
aerial photographs taken 1966. Field checked 1967

Selected hydrographic data compiled from USC&GS Charts  
275 (1964), 542 (1967), and 745 (1966). This information is  
not intended for navigational purposes

Polygonic projection. 1927 North American datum  
10,000-foot grid based on New York coordinate system, Long Island zone  
1000-meter Universal Transverse Mercator grid ticks, zone 18, shown in blue  
Red tint indicates areas in which only landmark buildings are shown  
Entire area lies within New York City

SCALE 1:24,000

1000 0 1000 2000 3000 4000 5000 6000 7000 FEET  
0 1 2 3 4 5 KILOMETER

CONTOUR INTERVAL 10 FEET  
DOTTED LINES REPRESENT 5-FOOT CONTOURS  
DATUM IS MEAN SEA LEVEL

DEPTH CURVES AND SOUNDINGS IN FEET—DATUM IS MEAN LOW WATER  
SHORELINE SHOWN REPRESENTS THE APPROXIMATE LINE OF MEAN HIGH WATER  
THE MEAN RANGE OF TIDE IS APPROXIMATELY 4.2 FEET IN THE EAST RIVER  
AND 5.2 FEET IN JAMAICA BAY

THIS MAP COMPLIES WITH NATIONAL MAP ACCURACY STANDARDS  
FOR SALE BY U.S. GEOLOGICAL SURVEY, WASHINGTON, D. C. 20242  
A FOLDER DESCRIBING TOPOGRAPHIC MAPS AND SYMBOLS IS AVAILABLE ON REQUEST

ROAD CLASSIFICATION  
Heavy-duty Light-duty  
Unimproved dirt Interstate Route State Route

NEW YORK  
QUADRANGLE LOCATION

BROOKLYN, N. Y.  
NW/4 BROOKLYN 15' QUADRANGLE  
N4037.5—W7352.7/7.5

1967  
AMS 6265 III NW—SERIES V821

NATIONAL REGISTER OF HISTORIC PLACES  
PROPERTY MAP FORM

(Type all entries - attach to or enclose with map)

STATE	New York	
COUNTY	New York	
FOR NPS USE ONLY		
ENTRY NUMBER	4	DATE
	JUN 4	1973

SEE INSTRUCTIONS

1. NAME

COMMON: Church of the Transfiguration  
AND/OR HISTORIC: "The Little Church Around the Corner"

2. LOCATION

STREET AND NUMBER: 1 East 29th Street

CITY OR TOWN: New York

STATE: New York	CODE: 36	COUNTY: New York	CODE: 061
-----------------	----------	------------------	-----------

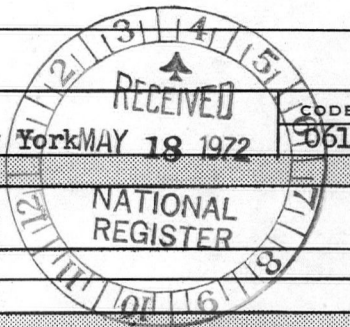

3. MAP REFERENCE

SOURCE: VSGS Quadrangle, 7.5' Series, Brooklyn, New York

SCALE: 1:24,000

DATE: 1966

4. REQUIREMENTS

TO BE INCLUDED ON ALL MAPS

1. Property boundaries where required.
2. North arrow.
3. Latitude and longitude reference.

PH0030546



RECTORY

Church of the Transfiguration

1 East 29<sup>th</sup> St NYC

"Little Church Around the Corner"

NPS Number 6/4/73

Title: Church of the Transfiguration

and Rectory

Loc. New York, N.Y.

②

LANDMARKS PRESERVATION COMMISSION

305 Broadway, New York, N.Y. 10002

**PROPERTY OF THE NATIONAL REGISTER**



NPS Number 6/4/73

Title: Church of the Transfiguration

AND Rectory

Loc. NEW YORK, N. Y.

VIEW OF SOUTH FACADE ON EAST

29th St.

①

**PROPERTY OF THE NATIONAL REGISTER**

UNITED STATES  
DEPARTMENT OF THE INTERIOR  
GEOLOGICAL SURVEY

Church of the Transfiguration

6151 SE  
TWEEDHAWKEN

74°00'  
40°45'

585000m.E.

586

587 TRIBOROUGH BRIDGE 4.6 MI. 57'30"

4511000m.N.



12/13  
18  
19  
20  
21  
22  
23  
24  
25  
26  
27  
28  
29  
30  
31  
32  
33  
34  
35  
36  
37  
38  
39  
40  
41  
42  
43  
44  
45  
46  
47  
48  
49  
50  
51  
52  
53  
54  
55  
56  
57  
58  
59  
60  
61  
62  
63  
64  
65  
66  
67  
68  
69  
70  
71  
72  
73  
74  
75  
76  
77  
78  
79  
80  
81  
82  
83  
84  
85  
86  
87  
88  
89  
90  
91  
92  
93  
94  
95  
96  
97  
98  
99  
100

4507

42°30"

55

56

57

58

59

60

61

62

63

64

65

66

67

68

69

70

71

72

73

74

75

76

77

78

79

80

81

82

83

84

85

86

87

88

89

90

91

92

93

94

95

96

97

98

99

100

101

102

103

104

105

106

107

108

109

110

111

112

113

114

115

116

117

118

119

120

121

122

123

124

125

126

127

128

129

130

131

132

133

134

135

136

137

138

139

140

141

142

143

144

145

146

147

148

149

150

151

152

153

154

155

156

157

158

159

160

161

162

163

164

165

166

167

168

169

170

Louis C. Jones  
Chairman  
Conrad L. Wirth  
Vice-Chairman  
Ewald B. Nyquist  
Seymour H. Knox  
John H. G. Pell  
Laurance S. Rockefeller  
Mildred F. Taylor  
C. Mark Lawton  
Director

May 10, 1972

Dr. William Murtagh  
Keeper of the National Register  
Room 3209  
1100 L Street, N. W.  
Washington, D. C. 20005



Dear Dr. Murtagh:

As Chairman of the New York State Historic Trust, the officially designated State Preservation Agency, and as the State Liaison Officer, I am forwarding the enclosed nomination to the National Register of Historic Places:

Church of the Transfiguration, New York County

The above nomination has been reviewed and approved by the Governor's Advisory Committee on Historic Preservation, in accordance with the criteria outlined in Section 2.2 of the Grants Guide.

The staff of the Trust would welcome the opportunity to discuss this submission with your office.

Sincerely,

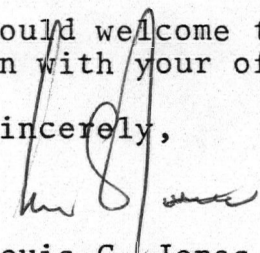
  
Louis C. Jones  
Chairman





NEW YORK STATE PARKS & RECREATION

• South Swan Street Building, South Mall, Albany, N.Y. 12223

Alexander Aldrich  
Commissioner

March 1, 1973

MAR 26 1973

MAR 1 1973

Mrs. Marguerite Mott  
National Register of Historic Places  
National Park Service  
18th and C Streets, N.W.  
Washington, D.C. 20240

Dear Mrs. Mott:

I have enclosed the continuation sheet and photograph for the Rectory of the Church of the Transfiguration in New York County. The Landmarks Preservation Commission would like the nomination submitted to you earlier amended to include the Rectory, as we discussed a few weeks ago. In addition the Commission requested that the nomination be entitled "Church of the Transfiguration and Rectory."

Thank you for your assistance.

Sincerely yours,

*Lynn Beebe Weaver*

Lynn Beebe Weaver  
Research Assistant  
Division for Historic  
Preservation

LBW/11

1810 Portsmouth  
Candace Worse  
Ross  
Dante Mc  
Ross

April 16, 1985

Sir

Please find enclosed 2 articles concerning  
The "Church of The Transfiguration & Rectory,"  
(the little church around the corner)

I am interested in receiving a copy of  
the complete article in connection with  
designating it as a National Landmark.

I am specifically interested in the original  
group of people that started the church  
and who deeded the land to the church.

Please forward this to whom ever  
it may concern.

Please let me know what it would  
cost.

Sincerely

Robert C. Morris

Return address

ROBERT C. MORRIS  
6421 GOLDFINCH ST.  
SARASOTA FLA. 33583

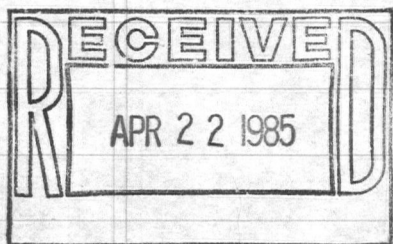

mailed 4-26-85

AFTER FIVE DAYS RETURN TO

Robert C Morris  
16421 Goldfinch St.  
Sarasota Fla.

ZIP CODE

33583

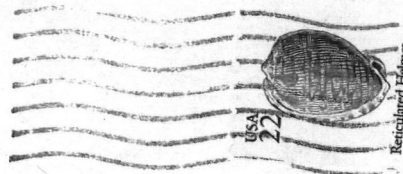

U. S. Dept of Interior  
National Park Service  
Washington D. C.

National Register  
of Historical Places

*Sept. 1974*

*Copy of  
Memorandum NY/NY*

*1848*

**CHURCH OF THE TRANSFIGURATION:** At 1 E. 29th St. is a church known all over the world as "the little church around the corner." It has probably witnessed more weddings than any other church its size, and there is, in fact, a "bride's altar," built with funds donated by the thousands of couples (including lots of famous ones) who were married here. Recently designated as a national landmark, the church celebrated its 125th anniversary in 1973. Sunday services are at 8, 9, and 11 a.m.; a tour is given after the last service.

NEW YORK COUNTY  
New York  
**CHURCH OF THE  
TRANSFIGURATION AND RECTORY**  
1 E. 29th Street  
19th century

The church proper is 1 story with a 3-story main tower and an octagonal projecting tower. The church plan is in the shape of an L with the longer portion forming the nave and the smaller portion forming the transept and ending in a small apse. The roof is copper except over the octagonal tower where it is gray slate. Joined to the Gothic Revival church is a 5-story rectory, also Gothic Revival and constructed of red brick with brownstone veneer on the main facade. A 5-sided tower-like extension projects from the east of the rectory. The church is believed to have been a station on the underground railway during the Civil War. *Private*

NEW YORK COUNTY  
New York

*From*  
←  
*The National Register  
of Historic Places,  
Supplement 1974*

ENTRIES IN THE NATIONAL REGISTER

STATE NEW YORK

Date Entered JUN 4 1973

<u>Name</u>	<u>Location</u>
Lowertown Historic District	Lockport Niagara County
Haskell House	New Windsor vicinity Orange County
Steinheim (Allen) Museum	Alfred Allegany County
Church of the Holy Cross	Troy Rensselaer County
Phelps Mansion	Binghamton Broome County
John Street Methodist Church	New York New York County
Church of the Transfiguration <i>And Rectory</i>	New York New York County

Hon. Howard W. Robison  
 Hon. Charles Rangel  
 Hon. John Murphy

Also Notified

Hon. Jacob K. Javits  
 Hon. James L. Buckley  
 Hon. Henry P. Smith  
 Hon. Benjamin Gilman  
 Hon. James F. Hastings  
 Hon. Carlton J. King

State Historic Preservation Officer  
 Mr. Alexander Aldrich, Commissioner  
 Parks and Recreation  
 Room 303, South Swan Street  
 Building  
 Albany, New York 12223

Director, Northeast Region

PHR NRowland: pcl 6/12/73