

1002

United States Department of the Interior
National Park Service

National Register of Historic Places
Registration Form

This form is for use in nominating or requesting determinations for individual properties and districts. See instructions in *How to Complete the National Register of Historic Places Registration Form* (National Register Bulletin 16A). Complete each item by marking "x" in the appropriate box or by entering the information requested. If an item does not apply to the property being documented, enter "N/A" for "not applicable." For functions, architectural classification, materials, and areas of significance, enter only categories and subcategories from the instructions. Place additional entries and narrative items on continuation sheets (NPS Form 10-900a). Use a typewriter, word processor, or computer, to complete all items.

1. Name of Property

historic name Christ Building

other name/site number Harian's General Store

2. Location

street & number 357-359 Sea Cliff Avenue not for publication

city or town Sea Cliff N/A vicinity

state New York code NY county Nassau code 059 zip code 11579

3. State/Federal Agency Certification

As the designated authority under the National Historic Preservation Act, as amended, I hereby certify that this nomination request for determination of eligibility meets the documentation standards for registering properties in the National Register of Historic Places and meets the procedural and professional requirements set forth in 36 CFR Part 60. In my opinion, the property meets does not meet the National Register criteria. I recommend that this property be considered significant nationally statewide locally. (See continuation sheet for additional comments.)

Ruth A. Purpant DSHPD
Signature of certifying official/Title

11/14/11
Date

New York State Office of Parks, Recreation and Historic Preservation
State or Federal agency and bureau

In my opinion, the property meets does not meet the National Register criteria. (See continuation sheet for additional comments.)

Signature of certifying official/Title Date

State or Federal agency and bureau

4. National Park Service Certification

I hereby certify that the property is:

- entered in the National Register. See continuation sheet.
- determined eligible for the National Register See continuation sheet.
- determined not eligible for the National Register.
- removed from the National Register.
- other, (explain:)

Signature of the Keeper

Date of Action

Christ Building
Name of Property

Nassau County, New York
County and State

5. Classification

Ownership of Property
(check as many boxes as apply)

Category of Property
(check only one box)

Number of Resources within Property
(Do not include previously listed resources in the count.)

- public-local
- private
- public-State
- public-Federal

- district
- building(s)
- site
- structure
- object

Contributing	Noncontributing	
1	0	buildings
0	0	sites
0	0	structures
0	0	objects
1	0	Total

Name of related multiple property listing
(Enter "N/A" if property is not part of a multiple property listing.)

Number of contributing resources previously listed in the National Register

N/A

0

6. Function or Use

Historic Function
(Enter categories from instructions)

Current Function
(Enter categories from instructions)

COMMERCE/TRADE/bakery

COMMERCE/TRADE/general store

DOMESTIC/boarding house

COMMERCE/TRADE/specialty store

DOMESTIC/apartments

7. Description

Architectural Classification
(Enter categories from instructions)

Materials
(Enter categories from instructions)

Late Victorian Second Empire

foundation brick

walls wood

roof slate

other concrete porch

Narrative Description

(Describe the historic and current condition of the property on one or more continuation sheets.)

Christ Building
Nassau County, New York

**NATIONAL REGISTER OF HISTORIC PLACES
CONTINUATION SHEET**

Section number 7 Page 1

DESCRIPTION

Sea Cliff is an incorporated village in northern Nassau County, New York in the western part of the Town of Oyster Bay. The village is bounded on the west by Hempstead Harbor and by the City of Glen Cove on the north and east. The Christ Building is located at 357-359 Sea Cliff Avenue in the northwest section of the village. The building is at the point where Summit Avenue intersects with Sea Cliff Avenue at a sharp angle. Sea Cliff Avenue is a major east-west route through the village, containing a number of commercial structures. The buildings immediately to the east of the Christ Building range in age from early to mid-twentieth century and are mostly commercial. Buildings to the west are mostly residential buildings, several being constructed in the late-nineteenth century. The Christ Building marks the transition from the residential to the commercial portion of the road.

When viewed from Sea Cliff Avenue, the building is a three-story, French Second Empire style commercial structure with a store in the main level and two rental properties in the upper floors. The building is wood framed and clad with wood shingles. The third floor is a straight sided Mansard roof with evenly spaced gabled dormers. A chimney can be seen rising from the center of the roof. The Mansard roof is clad in hexagonal slate shingles and has an overhanging base that creates a decorative cornice with evenly spaced scrolled brackets. Between each bracket is a raised panel. A smaller cornice extends over the first level. The building has a brick foundation. A concrete walk and porch run along the main façade that fronts Sea Cliff Avenue. The west end of the porch has a small section of fencing consisting of urn-shaped concrete balusters. There is a vacant lot behind the building, which is surrounding by modern wooden fencing.

The main façade faces north and is roughly divided into six bays as indicated by the evenly spaced fenestration in the second and third (Mansard) stories. The ground level has four doors and four windows, with two doors on the ends providing access to the rental properties and the remaining doors entering into the first floor store. There is one window between the outer flanking doors and the store entrances and two windows in the center between the store entrances. The outer flanking doors are two-panel wooden slab doors with a locking rail that has a circular floral brass knob in middle. The store doors are wood and glass. All doors have plain door moldings and glass transoms. The windows in the first level were replaced in 1966 and consist of curved bay windows with nine lights (three over three). The upper levels retain the original two-over-two double hung sash and the third level also has exterior storm windows.

Both the east and west elevations are similar with one window in the ground level, two windows in the south end of the second level and three dormers in the Mansard. The decorative cornice continues between the Mansard and second level. The windows are the original two-over-two double hung sash. The south elevation has four more windows in the second level and four dormers above. The decorative cornice is also between the roof and second story. The ground level has two more windows, two entrances and two small square windows between the doors and the larger two-over-two windows.

The interior is divided into the store on the ground level and two, two-story rental properties in the upper level. The ground floor commercial store is essentially one large front interior room (main retail area) with two brick archways dividing the space into sections. The store retains its decorative wood wainscoting and has its original

Christ Building
Nassau County, New York

**NATIONAL REGISTER OF HISTORIC PLACES
CONTINUATION SHEET**

Section number 7 Page 2

wood ceiling. The rear area also retains the original six-paneled and beveled wood door. On the western end of the rear area is another exit that leads to a staircase to the upstairs apartment on the western end of the building.

The second and third floors have two, two-story apartments, renovated in 1956 when the boarding rooms were no longer needed. There is one apartment on the eastern side and one on the western side of the structure. Each apartment has three bedrooms, a formal dining room, a kitchen, a bathroom and a living room. Interior details include plaster walls, decorative crown molding, a brick fireplace with mantel and decorative rail balustrade leading from the second to the third floor.

Christ Building
Name of Property

Nassau County, New York
County and State

8. Significance

Applicable National Register Criteria

(Mark "x" in one or more boxes for the criteria qualifying the property for National Register listing.)

- A** Property is associated with events that have made a significant contribution to the broad patterns of our history.
- B** Property is associated with the lives of persons significant in our past.
- C** Property embodies the distinctive characteristics of a type, period, or method of construction or represents the work of a master, or possesses high artistic values, or represents a significant and distinguishable entity whose components lack individual distinction.
- D** Property has yielded, or is likely to yield, information important in prehistory or history.

Criteria Considerations

(Mark "x" in all the boxes that apply.)

Property is:

- A** owned by a religious institution or used for religious purposes.
- B** removed from its original location.
- C** a birthplace or grave.
- D** a cemetery.
- E** a reconstructed building, object, or structure.
- F** a commemorative property.
- G** less than 50 years of age or achieved significance within the past 50 years.

Narrative Statement of Significance

(Explain the significance of the property on one or more continuation sheets.)

9. Major Bibliographical References

Bibliography

(Cite the books, articles, and other sources used in preparing this form on one or more continuation sheets.)

Previous documentation on file (NPS):

- preliminary determination of individual listing (36 CFR 67) has been requested
- previously listed in the National Register
- previously determined eligible by the National Register
- designated a National Historic Landmark
- recorded by Historic American Buildings Survey # _____
- recorded by Historic American Engineering Record # _____

Areas of Significance

(enter categories from instructions)

Commerce

Architecture

Period of Significance

Ca.1880-1958

Significant Dates

ca. 1880, 1946, 1956, 1958

Significant Persons

(Complete if Criterion B is marked above)

N/A

Cultural Affiliation

N/A

Architect/Builder

unknown

Primary location of additional data:

- State Historic Preservation Office
- Other State agency
- Federal agency
- Local government
- University
- Other Name of repository:

Long Island Traditions

Christ Building
Nassau County, New York

**NATIONAL REGISTER OF HISTORIC PLACES
CONTINUATION SHEET**

Section number 8 Page 1

STATEMENT OF SIGNIFICANCE

Built circa 1880, the Christ Building is significant under Criterion A as one of the oldest commercial properties extant in the Village of Sea Cliff. Located at the beginning (west end) of Sea Cliff Avenue, the building was well sited to accommodate the needs of seasonal residents along the harbor and serve the permanent residents living further inland. The building opened as a store and bakery, responding to a need in the community for the latter type of business. The upper floors of the building also functioned as a boarding house, which were divided into two apartments in the mid-twentieth century. The building is also significant in architecture under Criterion C as a late nineteenth century Second Empire style building. Although the historic storefronts were removed in 1946, the building retains its iconic Mansard roof and historic fenestration in the upper floors and remaining elevations. The building also retains other period details such as cornices, doors and wood shingle siding.

HISTORICAL SIGNIFICANCE

Sea Cliff was formally incorporated as a village in 1883, but its history can be traced back to the seventeenth century. In 1653, New England settlers obtained lands from the Matinecock Indians and established villages in the Town of Oyster Bay. Most of these early settlements were in the eastern part of the town until 1668 when Joseph Carpenter acquired title to the western lands around Mosquito Cove along the east shore of Hempstead Harbor. These lands were mostly farms until the late eighteenth century when a milling industry began to develop in Glen Cove along the northeast side of the harbor. In 1855, the Glen Cove Manufacturing Company opened a starch factory, which became the largest impetus for growth north of Mosquito Cove. Development south of the cove began in 1871 when the Metropolitan Camp Ground Association bought 240 acres of land along the harbor shoreline. The community they established was a seasonal religious camp of tents and cottages that over time became the summer resort village of Sea Cliff.

By the mid 1880s, camp meeting attendance began to steadily decline and members began selling their properties to those looking to build summer homes and hotels. In the 1890s, Sea Cliff was well on its way to becoming a summer resort town that was a convenient travelling distance from New York City. The village had railroad service since the 1860s, but the new wave of building brought such an influx of travelers that the Long Island Rail Road offered regular weekend excursions to the village. It also owned a steamboat operation that initially provided transportation from New York City, mostly patronized by the members of the Metropolitan Camp Ground Association, but quickly transitioned to offering daily steamboat service from the city during the summer season. Sea Cliff's location along Hempstead Harbor made it a popular summer vacation spot. Summer visitors took advantage of the many sandy beaches. Private bathing pavilions lined the waterfront during the height of the season. The protected harbor areas along the waterfront made it a popular boating spot as well.

Early in the twentieth century, Sea Cliff's popularity as a summer vacation spot began to wane as tastes and methods of transportation changed. The increased use of automobiles led to a demand for better roads, which in turn opened more areas of Long Island to travel. People could still travel by train and steamboat to Sea Cliff, but they were no longer limited to the north coast locations that were the closest to the city. As more people ventured further east onto the island, Sea Cliff's summer population dramatically decreased and the large hotels

Christ Building
Nassau County, New York

**NATIONAL REGISTER OF HISTORIC PLACES
CONTINUATION SHEET**

Section number 8 Page 2

and plentiful rental properties were no longer needed. Over time, the boardwalk and beach fronts were neglected and people began looking to the village as a year round, bedroom community for those working in New York City. Many of the summer homes were winterized and new construction created densely packed streets in what were formerly resort properties. By the mid-twentieth century, Sea Cliff achieved a more suburban appearance and was overshadowed by its northern neighbor, the City of Glen Cove.

Around 1880, German immigrant Louis Christ opened a bakery on Sea Cliff Avenue where it intersected with Summit Avenue. Little is known about Louis Christ but census records revealed that he, his wife Mary and their four young children were living in Sea Cliff by 1880.¹ German Methodists bought tenting properties in 1874 from the Metropolitan Camp Ground Association for separate camp meetings but additional research needs to be done to see if the Christ family was part of the summer German Methodist campers. The campers came from the large Methodist churches in New York City near Second and Fortieth streets, the Eastern District of Brooklyn and Hoboken, New Jersey.² Louis and Mary Christ are absent from census records for these areas. Judging from the age of the oldest child and census records, it can be assumed that Louis and Mary Christ emigrated from Prussia in the mid 1870s. As a baker by trade, Louis Christ found his way to Sea Cliff where his shop was located in the east end of the building on Sea Cliff Avenue.

When first built, the Christ Building housed a bakery and a store in the first level and boarding rooms in the second and third floors. The Christ Family owned the building until 1967 and, in that time, it housed a general store, telegraph office and a hardware store along with the bakery. According grandson Arthur Christ, the family lived in an addition in the rear of the property that was connected to the bakery in front. Historic Sanborn maps reveal this rear portion had the bake ovens in the basement. The rear structure was removed in 1958 as were the bake ovens. By 1900, Louis Christ was working as a telephone operator and his son Jacob was running the bakery. The west portion of the building housed the Postal Telegraph Company and later the Hendrickson Bus Company. According to building records, the storefronts and store were altered in 1946 and from 1950 to 1980, Harian's General Store operated in the first level. When the building opened in 1880, the boarding rooms were rented to local workers until the rooms were made into two apartments in 1956.

Sea Cliff's buildings from the summer resort era reflect a variety of architectural styles popular from the late nineteenth century. Although most of these buildings were built as residences, a few early commercial buildings were also built in popular period styles including the Christ Building. When considered collectively, the buildings are noteworthy in style and detail, revealing that particular attention was paid to the latest, most up-to-date building practices of the time. The buildings shared a similarity in building materials of mostly wood balloon construction sheathed by clapboarding or wood shingles. The buildings featured design details of decorative roofline brackets, porches, slate and wood shingled gables and decorative cornices. Several featured Mansard style roofs such as the residences at 285 Glen Avenue and 362 Sea Cliff Avenue, the latter being directly across from the Christ Building.

The Christ Building is believed to be one of the oldest commercial structures surviving from the Sea Cliff Summer Resort Era, the period following the Methodist Camp Meetings. The building shared the characteristics

¹ 1880 US Census for Oyster Bay (Sea Cliff), New York, Enumeration District 294, page 21.

² "Open Air Worship: The Germans in Camp at Sea Cliff," *New York Times*, 19 August 1874, 8.

Christ Building
Nassau County, New York

**NATIONAL REGISTER OF HISTORIC PLACES
CONTINUATION SHEET**

Section number 8 Page 3

found in many of the residences built during the period such as the Mansard Roof, brackets and wood frame construction. The rear addition basement housed an underground arched brick oven, believed to be the only one of its type on Long Island at that time. The special fire brick for the oven was made by an oven-building company from Sullivan, Pennsylvania. The brick was transported by rail and steamboat to Sea Cliff and then trucked by horses and wagon to the site. With the building being wood construction, it made sense to secure the ovens in a self-contained section separate from the rest of the building. As previously mentioned, these ovens were removed in 1958.

In recent years, the Village of Sea Cliff has been reexamining its past and documenting the historic resources extant from the Methodist Camp and Resort eras. The documented properties are significant because they reflect the economic diversity of the community, along with the architectural range available to carpenters and builders during these historic periods. The majority of the documented properties are residences and the Christ Building is one of a very few commercial buildings reflecting this time period. Whether residential or commercial, local preservation committees support the owners of the properties in their efforts to preserve original features including windows, staircases, exterior cladding and other decorative features through finding support for documentation and encouraging listings in the National Register of Historic Places.

Christ Building
Nassau County, New York

**NATIONAL REGISTER OF HISTORIC PLACES
CONTINUATION SHEET**

Section number 9 Page 1

BIBLIOGRAPHY

Braynard, Frank O. *One Square Mile, a Sea Cliff Sketchbook*. Detroit, MI : Edward Brothers Press, 1967.

_____. *The Village of Sea Cliff 100 Years*. Sea Cliff, NY: Sea Cliff Centennial Commission, 1983.

“The Family.” *Newsday*, 4 October 1969.

O’Brien, Austin. *Sea Cliff Summer Resort Thematic Group National Register of Historic Places Nomination Form*, 8 October 1986.

“Open Air Worship: The Germans in Camp at Sea Cliff.” *New York Times*, 19 August 1874, 8.

United States Census 1870-1920, available online at *HeritageQuest online at*
<http://persi.heritagequestonline.com.dbgateway.nysed.gov/hqoweb/library/do/census/search/basic>.

Interviews:

Affidavit by Arthur F. Christ on January 16, 1967.

Interview by Nancy Solomon of Ivan Fedichev on July 23, 2009, Long Island Traditions collection.

Christ Building
Name of Property

Nassau County, New York
County and State

10. Geographical Data

Acreage of Property less than one acre

UTM References

(Place additional boundaries of the property on a continuation sheet.)

1 18 613836 4522905
Zone Easting Northing

2 18
Zone Easting Northing

3 18
Zone Easting Northing

4 18
Zone Easting Northing

See continuation sheet

Verbal Boundary Description

(Describe the boundaries of the property on a continuation sheet.)

Boundary Justification

(Explain why the boundaries were selected on a continuation sheet.)

11. Form Prepared By

name/title Virginia L. Bartos, Ph.D, Historic Preservation Program Analyst

organization NYS Office of Parks, Recreation and Historic Preservation date October 2011

street & number Peebles Island State Park PO Box 189 telephone 518-237-8643

city or town Waterford state NY zip code 12188

Additional Documentation

Submit the following items with the completed form:

Continuation Sheets

Maps

A **USGS map** (7.5 or 15 minute series) indicating the property's location.

A **Sketch map** for historic districts and properties having large acreage or numerous resources.

Photographs

Representative black and **white photographs** of the property.

Additional items

(Check with the SHPO or FPO for any additional items)

Property Owner

(Complete this item at the request of SHPO or FPO.)

name/title Ivan Fedichev

street & number 70 14th Avenue telephone N/A

city or town Sea Cliff state NY zip code 11579

Paperwork Reduction Act Statement: This information is being collected for applications to the National Register of Historic Places to nominate properties for listing or determine eligibility for listing, to list properties, and to amend existing listings. Response to this request is required to obtain a benefit in accordance with the National Historic Preservation Act, as amended (16 U.S.C. 470 *et seq.*).

Estimated Burden Statement: Public reporting burden for this form is estimated to average 18.1 hours per response including time for reviewing instructions, gathering and maintaining data, and completing and reviewing the form. Direct comments regarding this burden estimate or any aspect of this form to the Chief, Administrative Services Division, National Park Service, P.O. Box 37127, Washington, DC 20013-7127; and the Office of Management and Budget, Paperwork Reductions Projects (1024-0018), Washington, DC 20503.

Christ Building
Nassau County, New York

**NATIONAL REGISTER OF HISTORIC PLACES
CONTINUATION SHEET**

Section number 10 Page 1

VERBAL BOUNDARY DESCRIPTION

The building is located on a rectangular plot identified as lot #19 that is approximately 90 feet on the north and south boundaries and 50 feet along the east and west boundaries, as illustrated on the attached map.

BOUNDARY JUSTIFICATION

The property boundary reflects the remaining parcel that was acquired by Louis Christ. The original property included the adjacent south lot that was divided and sold to another owner in 1975.

Christ Building
Nassau County, New York

**NATIONAL REGISTER OF HISTORIC PLACES
CONTINUATION SHEET**

Section number 11 Page 1

Original research and text by:

Nancy Solomon and Kelly McCauley
Long Island Traditions
382 Main Street
Port Washinton NY 11050
(631) 767-8803

Christ Building
Nassau County, New York

**NATIONAL REGISTER OF HISTORIC PLACES
CONTINUATION SHEET**

Section number Page 1

PHOTOGRAPH LIST

Christ Building, 357-359 Sea Cliff Avenue, Sea Cliff NY 11579

Digital photographs provided by Long Island Traditions, taken 28 July 2009. Copy of CD-R with images on file in the offices of the Field Services Bureau of the New York State Office of Parks, Recreation and Historic Preservation, Peebles Island State Park, Waterford, New York.

Photo # 1: Christ Building showing north and east elevations, viewed from Sea Cliff Avenue looking southwest.

Photo # 2: View of east elevation looking southwest.

Photo #3: Detail view of roof brackets.

Photo #4: Interior view of store looking toward Sea Cliff Avenue (north). View shows historic wall and ceiling fabric and moldings.

Photo #5: Interior view of store showing historic fabric on walls and original radiators.

Photo #6: View of historic interior store door.

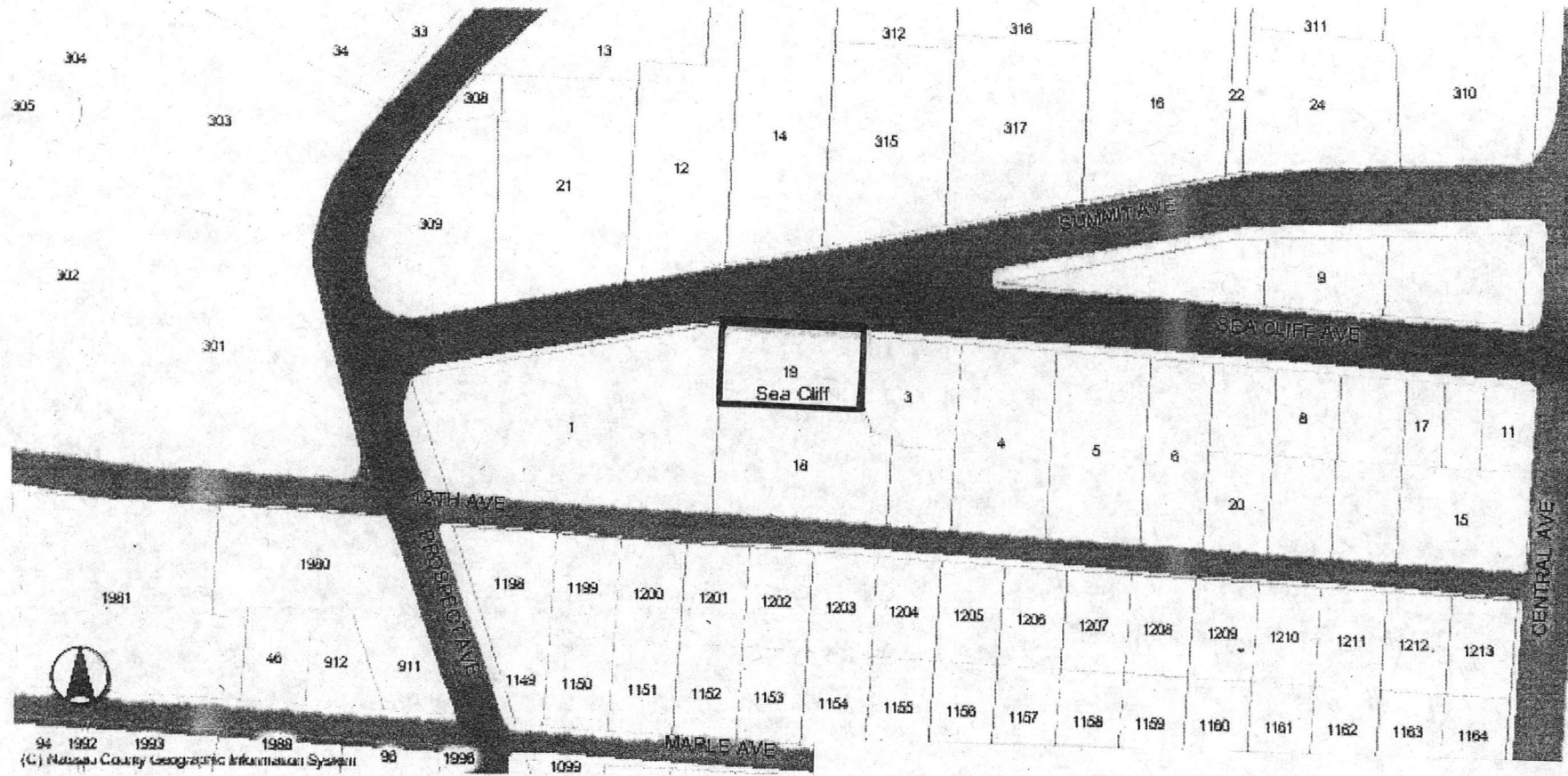

CHRIST BUILDING
SEA CLIFF, NASSAU COUNTY NY
.75 INCES= ±50 FEET
NR BOUNDARY: _____

UNITED STATES DEPARTMENT OF THE INTERIOR
NATIONAL PARK SERVICE

NATIONAL REGISTER OF HISTORIC PLACES
EVALUATION/RETURN SHEET

REQUESTED ACTION: NOMINATION

PROPERTY NAME: Christ Building

MULTIPLE NAME:

STATE & COUNTY: NEW YORK, Nassau

DATE RECEIVED: 11/25/11 DATE OF PENDING LIST: 12/16/11
DATE OF 16TH DAY: 1/03/11 DATE OF 45TH DAY: 1/10/12
DATE OF WEEKLY LIST:

REFERENCE NUMBER: 11001002

REASONS FOR REVIEW:

APPEAL: N DATA PROBLEM: N LANDSCAPE: N LESS THAN 50 YEARS: N
OTHER: N PDIL: N PERIOD: N PROGRAM UNAPPROVED: N
REQUEST: N SAMPLE: N SLR DRAFT: N NATIONAL: N

COMMENT WAIVER: N

ACCEPT RETURN REJECT 1.4.12 DATE

ABSTRACT/SUMMARY COMMENTS:

**Entered in
The National Register
of
Historic Places**

RECOM./CRITERIA _____

REVIEWER _____ DISCIPLINE _____

TELEPHONE _____ DATE _____

DOCUMENTATION see attached comments Y/N see attached SLR Y/N

If a nomination is returned to the nominating authority, the nomination is no longer under consideration by the NPS.



07/28/2009

Christ Building
Nassau County, NY
Photo # 1



07/28/2009

Christ Building
Nassau County NY

Photo # 2



07/28/2009

Christ Building
Nassau County, NY

Photo # 3



WELCOME BACK!

Some things in Home Life
are important.
In fact, it's the first,
second & the last.
It's hard to be last.
-Marilyn vos Savant

WELCOME BACK!

The Weight Floor
Dance Mat



Get a grip on the ground
with our new
Weight Floor
Dance Mat.
The Weight Floor
Dance Mat is
made of
recycled plastic
and is
perfect for
anywhere.



Christ Building
Nassau County, NY
Photo #4



Christ Building
Nassau County, NY
Photo #5

לא ידע לא תנב
לא תשא לא תגנב
כבוד אב לא תענה
כבוד אב לא תחמוד

PSYCHIC
READINGS
AVAILABLE
TODAY

As Featured by
NEWSWEEK
As heard on
WABC, WJZ, Fox
Radio
Have Tables 177
Only at Christmas Court
The West Washington

THERE WILL BE A
\$2.00 SURCHARGE
WHEN USING A
CREDIT CARD OR
DEBIT CARD FOR
PSYCHIC READINGS

Have a seat

exploreTeam

福
祿
壽

May
Mary
The Christmas Court
The West Washington

exploreTeam



Christ Building
Nassau County, NY
Photo # 6

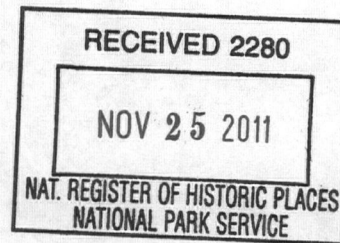

Andrew M. Cuomo
Governor

Rose Harvey
Commissioner

New York State Office of Parks, Recreation and Historic Preservation

Historic Preservation Field Services Bureau • Peebles Island, PO Box 189, Waterford, New York 12188-0189

518-237-8643

www.nysparks.com

15 November 2011

Alexis Abernathy
National Park Service
National Register of Historic Places
1201 Eye St. NW
8th Floor
Washington, D.C. 20005

Re: National Register Nominations

Dear Ms. Abernathy:

I am pleased to enclose nine new National Register nominations to be considered for listing by the Keeper of the National Register:

Boardman-Mitchell House, Richmond County
Christ Building, Nassau County
John Lehman House, Schoharie County
Watkins Glen Commercial Historic District, Schuyler County
Tabernacle Baptist Church, Oneida County
Potter Hollow District #19 School, Albany County
Temple B'Nai Israel, Cattaraugus County
John P. Somers House, Erie County
Mica Insulator Company, Schenectady County

Thank you for your assistance in processing these proposals. Please feel free to call me at 518.237.8643 x 3261 if you have any questions.

Sincerely:

Kathleen LaFrank
National Register Coordinator
New York State Historic Preservation Office