

1534

United States Department of the Interior
National Park Service

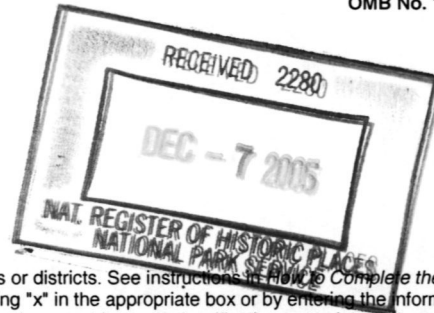

National Register of Historic Places
Registration Form

This form is for use in nominating or requesting determinations of eligibility for individual properties or districts. See instructions in HOW to Complete the National Register of Historic Places Registration Form (National Register Bulletin 16A). Complete each item by marking "x" in the appropriate box or by entering the information requested. If an item does not apply to the property being documented, enter "N/A" for "not applicable." For functions, architectural classification, materials and areas of significance, enter only categories and subcategories listed in the instructions. Place additional entries and narrative items on continuation sheets (NPS Form 10-900a). Use a typewriter, word processor, or computer, to complete all items.

1. Name of Property

historic name West Hill Cemetery

other names/site number _____

2. Location

street & number NY 80 not for publication

city or town Sherburne vicinity

state New York code NY county Chenango code 017 zip code 13460

3. State/Federal Agency Certification

As the designated authority under the National Historic Preservation Act, as amended, I certify that this nomination request for determination of eligibility meets the documentation standards for registering properties in the National Register of Historic Places and meets the procedural and professional requirements set forth in 36 CFR Part 60. In my opinion, the property meets does not meet the National Register criteria. I recommend that this property be considered significant nationally statewide locally See continuation sheet for additional comments.

Signature of certifying official/Title [Signature]

Date 11/18/05

State or Federal agency and bureau _____

In my opinion, the property meets does not meet the National Register criteria. See continuation sheet for additional comments.

Signature of certifying official/Title _____

Date _____

State or Federal agency and bureau _____

4. National Park Service Certification

I hereby certify that this property is:

entered in the National Register. See continuation sheet.

determined eligible for the National Register. See continuation sheet.

determined not eligible for the National Register.

removed from the National Register.

other, (explain:) _____

Signature of the Keeper [Signature]

Date of Action 1.19.06

Edson H. Beall

West Hill Cemetery

Name of Property

Chenango County, New York

County and State

5. Classification

Ownership of Property

(Check as many boxes as apply)

- private
- public-local
- public-State
- public-Federal

Category of Property

(Check only one box)

- building(s)
- district
- site
- structure
- object

Number of Resources within Property

(Do not include previously listed resources in the count.)

Contributing	Noncontributing	
1	0	buildings
1	0	sites
0	0	structures
0	0	objects
2	0	Total

Name of related multiple property listing

(Enter "N/A" if property is not part of a multiple property listing.)

N/A

Number of contributing resources previously listed in the National Register

0

6. Function or Use

Historic Functions

(Enter categories from instructions)

FUNERARY/cemetery

Current Functions

(Enter categories from instructions)

FUNERARY/cemetery

7. Description

Architectural Classification

(Enter categories from instructions)

na

Materials

(Enter categories from instructions)

foundation stone

walls brick

roof clay

other

Narrative Description

(Describe the historic and current condition of the property on one or more continuation sheets.)

United States Department of the Interior
National Park Service

West Hill Cemetery
Sherburne Vicinity, Chenango County, New York

National Register of Historic Places Continuation Sheet

Section number 7 Page 1

The West Hill Cemetery is located on the north side of NY 80 in the town of Sherburne, New York. The town of Sherburne is in the northeast corner of Chenango County near the Madison County border. NY 80, which crosses the southern portion of the town, was once a major east-west turnpike across the state. The cemetery is between the small villages of Sherburne and Smyrna. The 9.35-acre parcel is surrounded by agricultural land that retains much of its nineteenth-century organization into field and woodlots. The cemetery occupies a plateau. North of the cemetery, the land slopes steeply down to the Chenango River, affording the burial ground a wide view of the valley beyond. Adjoining the cemetery to the north and east are approximately 123 acres of New York State land accessible to the public for recreation. At least one building (the Second Calvinistick Congregational Society meeting house) and possibly a second (referred to as the "society house") were located on or adjacent to the cemetery site in the first half of the nineteenth century. The meeting house was moved from the site in the mid-nineteenth century and the fate of the society house is unknown. There is no apparent evidence of either building, although an old well at the western edge of the burial grounds may be associated with this early development.

The West Hill Cemetery has records of approximately 4,683 burials, two-thirds of which predate 1950. The cemetery is divided into two distinct sections, each of which occupies about half of the parcel. The western half, which includes the parcel once associated with the Second Calvinistick Church, contains the oldest burials, with the earliest apparently that of an infant buried in 1803. The oldest graves are in the northwest corner, where stones are far apart and some appear to be missing. Other burials in the older half are relatively close together, arranged in north-south rows along an informal path. Several mature trees dot the landscape.

The eastern section, acquired in two sections by a cemetery association in 1897, includes burials from the late nineteenth and, primarily, the first half of the twentieth centuries. The eastern half is laid out in a formal

See continuation sheet

United States Department of the Interior
National Park Service

West Hill Cemetery
Sherburne Vicinity, Chenango County, New York

National Register of Historic Places Continuation Sheet

Section number 7 Page 2

cloverleaf plan with burials in each of the four quadrants arranged in east-west rows. There is space for about three or four thousand additional burials, particularly in northeast quadrant, which is relatively empty.

Cemetery markers in the older section are typical of their period and include many fine examples of funerary art. Early stones feature rounded tops, delicate carving, foliate decoration, weeping willows, and other typical motifs. Many are inscribed with verses, some of them religious, typical of the period. In particular there are about a dozen examples of the work of "Crandall and Crandall," well-known early nineteenth century local carvers. The cemetery also features several vaults and approximately eighty family monuments. One of the largest marks the grave of William Smith, a prominent landholder and aid to George Washington during the Revolution, and recalls his wife, Abigail Adams Smith (only daughter of John Adams, second president of the United States), who is buried in Quincy, Massachusetts. The interred include at least thirteen Revolutionary War veterans, forty-one Civil War or Civil War era veterans, and a number who served in World Wars I and II. The cemetery also contains the small Howard family cemetery, which was moved to West Hill from the Jackson Howard Farm in northeast Sherburne. The thirteen members of the Howard family are apparently four Howard brothers, wives of three (and possibly all four) of them, and children of two of the couples. Dates of death range from 1844 and 1845 (two young children) to 1894 for Thomas J. Howard, who was predeceased by his wife and child. It is not known when or why the cemetery was moved to West Hill.

A small brick chapel, constructed in 1905 and surrounded by three burr oaks, marks the center of the cloverleaf. The chapel is a one-story building constructed of roman brick on a raised, cut-stone foundation with stone trim. The building is rectangular in form (25 feet by 30 feet) with a gable roof and large stepped and multi-curved decorative parapets with concrete caps at each gable end. Both the north and south elevations feature large round-arched openings within corbelled brick enframements with stone keystones and sills. Each features a stained-glass memorial window. Side elevations are broken by small round-arched openings with clear glass

See continuation sheet

United States Department of the Interior
National Park Service

West Hill Cemetery
Sherburne Vicinity, Chenango County, New York

National Register of Historic Places Continuation Sheet

Section number 7 Page 3

windows. At the southeast corner of the building is a large, two-story tower, nearly square in form (12 feet by 13 feet), surmounted by a belfry with a pyramidal roof and overhanging eaves supported on large brackets. The lower story of the tower is characterized by large round-arched openings on each of the three non-engaged sides. The corbelled brick arches spring from square piers with stone imposts and feature oversized stone keystones. Each of the four sides of the belfry is characterized by a triple arcade. Both the chapel and the tower roofs are clad in red, ceramic roofing tiles. There is a small one-story entrance on the rear (north) elevation of the chapel. The gabled roof pavilion is constructed of the same brick and features a tiled roof. Adjacent to this is a small contemporary concrete wing with a flat roof. Entrance is through double doors in the southeast corner of the building, sheltered by the tower. The interior is a single room with two brick corner fireplaces, several pews, and a small lectern and chairs. A trap door provided access to the basement, where brick compartments allow storage of coffins. The chapel retains an outstanding level of integrity.

See continuation sheet

West Hill Cemetery

Name of Property

Chenango County, New York

County and State

8 Statement of Significance

Applicable National Register Criteria

(Mark "x" in one or more boxes for the criteria qualifying the property for National Register listing.)

- A** Property is associated with events that have made a significant contribution to the broad patterns of our history.
- B** Property is associated with the lives of persons significant in our past.
- C** Property embodies the distinctive characteristics of a type, period or method of construction or represents the work of a master, or possesses high artistic values, or represents a significant and distinguishable entity whose components lack individual distinction.
- D** Property has yielded, or is likely to yield, information important in prehistory or history.

Criteria considerations

(mark "x" in all the boxes that apply.)

Property is:

- A** owned by a religious institution or used for religious purposes.
- B** removed from its original location.
- C** a birthplace or grave.
- D** a cemetery.
- E** a reconstructed building, object or structure.
- F** a commemorative property.
- G** less than 50 years of age or achieved significance within the past 50 years.

Narrative Statement of Significance

(Explain the significance of the property on one or more continuation sheets.)

9. Major Bibliographical References

Bibliography

(cite the books, articles, and other sources used in preparing this form on one or more continuation sheets.)

Previous documentation on file (NPS):

- preliminary determination of individual listing (36 CFR 67) has been requested
- previously listed in the National Register
- previously determined eligible by the National Register
- designated a National Historic Landmark
- recorded by Historic American Buildings Survey

- recorded by Historic American Engineering
Record # _____

Areas of Significance

(Enter categories from instructions)

- _____ settlement
- _____ architecture
- _____ funerary art
- _____
- _____
- _____

Period of Significance

_____ c1800-c1955

Significant Dates

_____ 1905

Significant Person

(Complete if Criterion B is marked above)

_____ ma

Cultural Affiliation

_____ na

Architect/Builder

_____ F.A. Jaerschky, chapel architect

Primary location of additional data

- State Historic Preservation Office
- Other State agency
- Federal agency
- Local government
- University
- Other

Name of repository:

United States Department of the Interior
National Park Service

West Hill Cemetery
Sherburne Vicinity, Chenango County, New York

National Register of Historic Places Continuation Sheet

Section number 8 Page 1

The West Hill Cemetery is significant for its association with the early settlement and development of the town of Sherburne and for its fine examples of nineteenth and early twentieth century funerary art. The cemetery was established as early as 1803 in conjunction with the Second Calvinistick Society of Sherburne, which apparently also had a meeting house on or near the site. The church disbanded by 1820 and the meeting house was gone by the middle of the nineteenth century, but the burial ground became of the largest in the town, used by residents of Sherburne and the adjacent town of Smyrna to the west. The cemetery contains the graves of a number of the town's earliest land owners and settlers, veterans of the Revolutionary and Civil Wars, and numerous other nineteenth and twentieth century citizens. There are distinctive stones from all periods, particularly a number of finely carved examples from the first half of the nineteenth century by the family of carvers known as "Crandall School." The size of the cemetery was significantly enlarged with the addition of two parcels by the West Hill Cemetery Association (formed in 1892) in 1897. Shortly after, a memorial chapel was donated by an unknown benefactor. The c1905 chapel forms the centerpiece of the "new" section of the cemetery, which is laid out in a formal cloverleaf pattern. The chapel is architecturally significant as a distinctive example of a small picturesque chapel in the Spanish mission style. With more than four thousand burials, the West Hill Cemetery is important for the information that it provides about the settlement and development of the town of Sherburne over two centuries.

Town of Sherburne

In 1788, the Oneida Indians sold an area now known as the "twenty towns" to the state of New York as part of the Treaty of Fort Schuyler. Also known as the Governor's Purchase, this area of nearly 500,000 acres included parts of what are now Oneida, Madison, and Chenango Counties. In 1789, Horace P. Schuyler surveyed the area into twenty numbered townships, which were sold at auction to speculators, and settlement began as early as 1791. Eleven of these towns fall within northern Chenango County.

See continuation sheet

United States Department of the Interior
National Park Service

West Hill Cemetery
Sherburne Vicinity, Chenango County, New York

National Register of Historic Places Continuation Sheet

Section number 8 Page 2

One of the most prominent individuals to purchase land in the twenty towns was William Stephen Smith. Smith, born on Long Island in 1755, graduated from Princeton and studied law for several years before beginning a military career at the beginning of the Revolution. During the war he served under General Sullivan and as aid to camp to George Washington. He later served as secretary to John Adams when the latter was sent to London as the American ambassador after the war. In 1786, during Smith's stay in England, he married Adams's daughter, Abigail. While overseas, William Smith formed a syndicate for the purchase of six of the twenty towns, or approximately 6,222 acres. Smith's purchase (c1791) included what is now the town of Sherburne. He sold four of the towns but retained the rest, a tract that bordered the Chenango River and included the sites of Smyrna, Sherburne, Eaton, Madison, Hamilton, and Earlville. Although Smith profited from these transactions, what has been described as his "expensive lifestyle" left him in financial difficulty, and in 1808 Smith decided to move his family (which included his wife and the couple's three children) to land that he owned with his brother Justus in the Chenango Valley tract. He settled on a tract near Middleport, where he had already begun construction of a residence. In 1812, Smith was elected to the United States Congress, serving Madison and Herkimer Counties. Abigail Adams Smith was unhappy in the wilderness and, either tired or ill, in 1813, she returned to her parents' home in Quincy, Massachusetts, where she died shortly thereafter. William Smith died only a few years later, in 1816. Although his wife was interred in Quincy, William Smith was buried in a plot in the West Hill Cemetery. The West Hill Cemetery marker includes a tribute to both of the Smiths.

Smith sold land within the tract as early as 1791, and in 1792, the land was resurveyed by Cornelius Clark and divided into twenty equal parts, each including both bottom land along the river and upland. In the same year, the first permanent settlers arrived. Many of the twenty settlement families were originally from Connecticut but moved here from Duanesburg, where they were unable to acquire title to the land that they wished to settle. They included Abraham Raymond, Nathaniel Gray, Amos Cole, Joseph Dixon, Newcomb Raymond, Elijah

See continuation sheet

United States Department of the Interior
National Park Service

West Hill Cemetery
Sherburne Vicinity, Chenango County, New York

National Register of Historic Places Continuation Sheet

Section number 8 Page 3

Gray, Eleazer Lathrop, Josiah Lathrop, James Raymond, Joel Hatch, John Gray Jr., Timothy Hatch, and Cornelius Clark. The town of Sherburne was divided off from Paris, Oneida County in 1795 and the first town meeting was held at the residence of Timothy Hatch in the same year. Nathaniel Gray was the first justice of the peace. Sherburne reached its current size in 1852.

The first mill was erected on the Handsome Brook, in the north part of the town, in 1794, and a second mill was developed near falls known as Sulphur Springs. The early nineteenth century was a period of economic growth for the town, which profited first from agriculture and then, more significantly, from the construction of the Chenango Canal through the town in the 1830s. Almost all of the town was cleared for farming during the nineteenth century, and the town's New England settlers adapted well to farming the hilly upland areas. The four-year-long canal construction project attracted a large number of workers, including many Irish immigrants.

By 1835 the population of the town had doubled. Although many of the new settlers did not stay, the canal spurred the growth of a number of small industries in the town, including manufacturers of stoneware and cotton; it also provided a boost to the regional agricultural economy, particularly the dairy industry. After 1869, the town was served by the railroad, promoting further agricultural and industrial growth.

Sherburne Congregational Churches

The First Congregational Church of Sherburne was organized in 1794. Its seventeen original members included members of the Gray, Newcomb, Raymond, Hatch, and Lathrop families. Nathaniel Gray and Abraham Raymond were chosen as deacons. The society was incorporated in 1798 and elected trustees included Eli Marsh, Joel Northrop, Orsamus Holmes, and others. In its early days, the congregation lacked both a pastor and a church, meeting when missionaries were available. The group worshipped in a schoolhouse north of the village of Sherburne; however, by 1802, a permanent meeting house was planned. Building commenced on a

See continuation sheet

United States Department of the Interior
National Park ServiceWest Hill Cemetery
Sherburne Vicinity, Chenango County, New York

National Register of Historic Places

Continuation Sheet

Section number 8 Page 4

site near the village of Sherburne in 1803-04 after, as local records note, “the effort to unite the two societies on a ‘common’ center had failed.”¹ The second society referred to was the Second Calvinistick Congregational Society of Sherburne, which had been formed in 1800 at the home of James Guthrie. This congregation was formed to serve members who lived on the west side of the Chenango River and in the hamlet of Smyrna, further west on NY 80. Its eleven founding members included Isaac Foote, Sedate Foote, Henry Finn, Margaret Finn, David Dixon, Triphena Dixon, Sarah Talcott, Elizabeth Merrill, Elijah Sexton, Ebenezer Baker, and Gambo Dasset, who was described a “colored man, a native of Gambia, Africa.”² Trustees included Orsamus Holmes and Eli Marsh. In 1803, as the First Congregational set about to construct its church, the Second Calvinistick built a meeting house on or near the site of the West Hill cemetery. The meeting house was constructed adjacent to a smaller building described as a “society house,” perhaps an earlier meeting house for the congregation. Sources indicate that the Second Calvinistick Church (sometimes referred to as the West Hill Church) disbanded in 1820 and members divided between a new church in Smyrna and the First Congregational in Sherburne. Apparently the Second Calvinistick meeting house of 1803 was moved from the West Hill site in 1847 and reused as a barn; it was certainly gone by 1893, when a writer in the town’s centennial booklet described missing the old meeting house, “in olden times the most conspicuous feature in the landscape.” The author went on to note that “there is still the church yard green, and God’s acre just beyond, where sleep the beloved dead.”³ There is no evidence of either of these two early buildings in the cemetery today; however, a well near the western edge of the burial ground may indicate a possible building location.

West Hill Cemetery

The West Hill Cemetery is one of Sherburne’s largest burial grounds, with more than 1,500 interments. The cemetery’s early history is not clear. Tradition holds that the cemetery was established in connection with the

¹ *Souvenir of the Sherburne Centennial Celebration.*

² *Souvenir of the Sherburne Centennial Celebration.*

³ *Souvenir of the Sherburne Centennial Celebration.*

United States Department of the Interior
National Park Service

West Hill Cemetery
Sherburne Vicinity, Chenango County, New York

National Register of Historic Places Continuation Sheet

Section number 8 Page 5

Second Calvinistick Society and that the earliest parcel was a gift from Justus Bosch Smith, brother of William Smith. Both of the Smith brothers are interred here. No documentation or date has been established for this gift, which apparently included approximately two acres in the northwestern quadrant. The Second Calvinistick Church, which had been established in 1800, did not construct its meeting house until 1803; however, the congregation may have worshipped at the building referred to as the society house, reportedly still on the site when the meeting house was constructed. The earliest known burial, Julius Talcott, an infant, was the child of Joshua Talcott, a member of the Second Calvinistick congregation. The Talcott child died in 1803, suggesting that the congregation had established its meeting place and a burial ground by that date. An examination of the layout of the cemetery shows the earliest graves in the northwest corner, far from the road. South of them, closer to the road, the graves date from a later period. Records indicate that this parcel was acquired in 1892, although some of the burials predate its acquisition. Members of the Second Calvinistick church are buried here; however, the cemetery was also used by other early settlers, and while the church had disbanded by 1820, the cemetery grew into one of the largest in the town and was heavily used until the mid twentieth century. Thus, is it perhaps more accurately described as a community cemetery.

Prominent individuals from the town's settlement period include five of the original proprietors and several founding members of both churches. In addition to William and Justus Smith, among the most prominent was Cornelius Clark, one of the proprietors, who moved with his family from Duanesburg. Clark fought in the Revolution and he was the land surveyor for the Sherburne colony. He was awarded lot 7, on which he resided till his death in 1810. In addition to being a farmer and surveyor, Clark was also noted as a cooper and a blacksmith. His marker compliments him for his services to the town.

Elijah Sexton (d. 1839), another early and prominent citizen, was a founding member of the Second Calvinistick Church. Sexton, a Revolutionary War veteran, is buried here along with his two wives, Sibyl (d. 1808) and

See continuation sheet

United States Department of the Interior
National Park Service

West Hill Cemetery
Sherburne Vicinity, Chenango County, New York

National Register of Historic Places Continuation Sheet

Section number 8 Page 6

Thankful (d. 1862). The Talcott family included Joshua Sr., an early settler from Connecticut. Talcott, a member of the Second Calvinistick, was the father of the child buried here in 1803, apparently the first burial on the site. A relative of Joshua Talcott, Judge Hezekiah Talcott, was born in Connecticut and moved to Sherburne from Herkimer County. The Allen family, which came from Massachusetts in 1797, was also prominent in the West Hill Church. The family included Noah Allen, Sr. (d. 1802), his son Apollos (d. 1807), the latter's wife (Deborah d. 1807), and their children.

Newcomb and Abraham Raymond, both proprietors, arrived in the 1790s and established adjoining farms. Abraham Raymond (d. 1830) was a deacon of the First Congregational Church and his wife, Betsey (d. 1858), was among its first members. Newcomb Raymond (d. 1832) fought in the Revolution. He and his wife, Mabel (d. 1826), were founding members of the First Congregational Church.

Joseph Dixon, a proprietor, was noted as a "prominent citizen in the pioneer days." Dixon (1754-1839) was born in Connecticut and served in the Revolution. He emigrated to Sherburne from Vermont in the 1790s, purchasing a large farm. Two of his two sons (buried elsewhere) studied at Yale and became prominent in their fields. Other members of the Dixon family are also buried at West Hill. Joseph Guthrie (d. 1845), another of the town's early settlers, was also a veteran of the Revolution. Among the many other members of the Guthrie family buried in the West Hill Cemetery is James Guthrie (d. 1804), also noted as a Revolutionary War veteran. Amos Cole (d. 1852) was another proprietor and Revolutionary War veteran. All four of Amos Cole's wives (who died in 1806, 1807, 1816, and 1846) are buried near him at West Hill.

The Pratt family was noted in Sherburne for its prominence in business and financial affairs. There are three generations of Pratts at West Hill, including Joshua Pratt (d. 1827), his son Joshua Jr. (d. 1860), and his grandson Joshua (1906). The senior Pratt arrived from Columbia County. A farmer, the elder Pratt was also

See continuation sheet

United States Department of the Interior
National Park Service

West Hill Cemetery
Sherburne Vicinity, Chenango County, New York

National Register of Historic Places Continuation Sheet

Section number 8 Page 7

associated with West Hill Church. Joshua Jr. was also a farmer but moved to the village and was engaged in business. The youngest Pratt, a merchant and banker for sixty years, was the most prominent of the three.

A prominent citizen from the second period of Sherburne's history was Dr. Devillo White, who is buried in the cemetery along with his wife, Caroline Pratt White. Dr. White (1801-1882), the son of one of Sherburne's first settlers, was remembered as "one of the most potent individual forces" in the community. White was a physician who took over a practice from his father [the latter having perished in a snowstorm in Illinois] and carried it on with "skill and energy." The younger White was also active in politics and finance. He is said to have had a "controlling power among men" and is noted as having a wide influence in the town of Sherburne for a long period.

The cemetery also holds the remains of thirteen soldiers who fought in the Revolution, forty-one veterans of the Civil War, and a handful noted for their service in World Wars I and II.

The West Hill Cemetery Association was formed in 1892. By the turn of the century, the association had added two parcels, both purchased in 1897: a three-acre parcel for \$509.56 and a four-acre parcel for \$800. These two purchases are the area known as the "new section," or the eastern half of the burial ground. These two parcels plus the two in the old section constitute the 9.35-acre nominated property.

In 1905 an unknown benefactor donated a memorial chapel to the cemetery. Not much is known about the origin or history of the chapel. Local tradition holds that the donor saw a similar building while traveling in Mexico and had it replicated here. The architect was F.A. Jaerschky of Binghamton and roofing tile was purchased from Ludowici Roofing Tile Company of New York. The chapel, a small brick building in a picturesque Spanish Revival style, forms the centerpiece of the new section of the cemetery.

See continuation sheet

United States Department of the Interior
National Park Service

West Hill Cemetery
Sherburne Vicinity, Chenango County, New York

National Register of Historic Places Continuation Sheet

Section number 8 Page 8

Crandall School⁴

The West Hill Cemetery contains many notable examples of funerary art, particularly from the first half of the nineteenth century. Among those are approximately a dozen examples of the work of the so-called "Crandall School." Joseph Crandall (1777-1851), a Massachusetts native, moved to the town of Plymouth, Chenango County, in 1806. Crandall was a stone engraver and mason and he is believed to have constructed foundations and stone walls throughout the region. He taught the trade to his sons, who joined him in the business, which was continued by several generation of Crandalls.

The Crandalls specialized in grave markers, and many examples of their work can be seen in the town of Norwich and surrounding region. Joseph Crandall, his wife and daughter are buried in the Aldrich Cemetery, which is between Norwich and South Pitcher. Like other examples from this period, Crandall's stones are distinguished by their complex rounded forms and the use of draped urns, willows, and other motifs. However, Crandall's stones are especially ornate. Epitaphs are set within elaborate frames and nearly all of the space is filled in with geometrical and foliate forms, including pinwheels, stylized flowers, philodendron leaves, and stippling. He was responsible for at least one decorated footstone (grave of James McCullough, McCullough Cemetery). Joseph Crandall's work can be identified by the distinctive serpentine carved "T" used in the "In memory of...." Stones carved by Crandall's sons are similar but lack the signature elements.

⁴ Information on the Crandall School was provided by the Chenango County historian.

United States Department of the Interior
National Park Service

West Hill Cemetery
Sherburne Vicinity, Chenango County, New York

National Register of Historic Places Continuation Sheet

Section number 9 Page 1

“Brief History of Sherburne, New York.” Copy on file at Chenango County Planning Office, Norwich, New York.

Child, Hamilton, “History of Sherburne, New York.” *Gazetteer and [sic] Business Directory of Chenango County, N.Y. for 1869-70*. Syracuse: Hamilton Child, 1869.
<http://history.rays-place.com/ny/sherburne-ny.htm> (29 July 2005)

“Col. William Smith.” From George W. Walters, *Chips and Shavings*, n.p., n.d.; revised by “historian.” also n.d.

“Col. William S. Smith: A Distinguished Soldier of the Revolution –A Sketch of his Life and Public Services.” clipping from unknown publication. Scrapbook, Sherburne Library.

History of Sherburne, Chenango County
<http://www.rootsweb.com/~nychanan/h-shrbrn.htm> (29 July 2005)

McFee, Michele. *Limestone Locks and Overgrowth: The Rise and Descent of the Chenango Canal*. Fleischmanns, NY: Purple Mountain Press, 1993.

Sherburne Hill West Cemetery. Burial records.
<http://www.rootsweb.com/~nychenan/wsthill.htm>. (21 August 2005).

“Sherburne.” *Gazetteer of Towns*. [1869-70]
<http://www.rootsweb.com/~nychenan/gzshrbrn.htm> (4 August 2005)

Souvenir of the Sherburne Centennial Celebration. [held on June 21st 1893] Tarrytown: Marcius D. Raymond, 1893.
<http://www.rootsweb.com/~nychenan/shr100-3htm> (5 July 2005)

West Hill Cemetery
Name of Property

Chenango County, New York
County and State

10. Geographical Data

Acreage of property 9.35 acres

UTM References

(Place additional UTM references on a continuation sheet.)

1	18	456399	4726775	3			
	Zone	Easting	Northing		Zone	Easting	Northing
2				4			

See continuation sheet

Verbal Boundary Description

(Describe the boundaries of the property on a continuation sheet.)

Boundary Justification

(Explain why the boundaries were selected on a continuation sheet.)

11. Form Prepared By

name/title Kathleen LaFrank, Program Analyst

organization New York State Historic Preservation Office date August 2005

street & number Peebles Island State Park, Box 189 telephone 518-237-8643 x 3261

city or town Waterford state New York zip code 12188

Additional Documentation

Submit the following items with the completed form:

Continuation Sheets

Maps

- A **USGS map** (7.5 or 15 minute series) indicating the property's location.
- A **Sketch map** for historic districts and properties having large acreage or numerous resources.

Photographs

Representative **black and white photographs** of the property.

Additional items

(Check with the SHPO or FPO for any additional items)

Property Owner

(Complete this item at the request of the SHPO or FPO.)

name _____

street & number _____ telephone _____

city or town _____ state _____ zip code _____

Paperwork Reduction Act Statement: This information is being collected for applications to the National Register of Historic Places to nominate properties for listing or determine eligibility for listing, to list properties and to amend existing listings. Response to this request is required to obtain a benefit in accordance with the National Historic Preservation Act, as amended (16 U.S.C.470 *et seq.*)

Estimated Burden Statement: Public reporting burden for this form is estimated to average 18.1 hours per response including time for reviewing instructions, gathering and maintaining data and completing and reviewing the form. Direct comments regarding this burden estimate or any aspect of this form to the Chief, Administrative Services Division, National Park Service, P.O. Box 37127, Washington, DC 20013-7127; and the Office of Management and Budget, Paperwork Reductions Projects (1024-0018), Washington, DC 20503.

United States Department of the Interior
National Park Service

West Hill Cemetery
Sherburne Vicinity, Chenango County, New York

National Register of Historic Places Continuation Sheet

Section number 10 Page 1

Verbal Boundary Description

The boundary is indicated by a heavy line on the enclosed map with scale.

Boundary Justification

The boundary was drawn to include the parcel that was associated with the cemetery historically and conveys information about its significance. The land owned by the cemetery association today includes six parcels acquired in at least four transactions between c1803 and c1900. The developed portion of the cemetery includes four of the six parcels, which occupy the eastern two-thirds of the property. These parcels are included in the nomination. The two western parcels are empty land, contain no burials, and were recently under cultivation. There is no information about when or why these parcels were acquired. The western two parcels were excluded from the nomination.

See continuation sheet

West Hill Cemetery
Sherburne Vicinity
Chenango Co. NY

SHERBURNE WEST HILL CEMETERY

In 1936, the New York State Education Department placed a marker at the west entrance to this cemetery reading as follows:

" WEST HILL - 1802"

"Colonel W. A. Smith, Aide to Washington, owned 150,000 acres hereabout in 1791; married Abigail Adams. Buried at rear, due north."

This cemetery was started in connection with the church used by the Second Congregational Society of Sherburne which flourished until about 1820 when the church disbanded and its members transferred to the Congregational Churches in Smyrna and Sherburne. This location, on fairly high ground, furnishes a wide view of the surrounding countryside.

In 1897 the Cemetery Association purchased over three acres of additional land adjoining on the east, and later added a plot on the west. It is the most widely used Protestant cemetery in Sherburne and is kept in excellent condition.

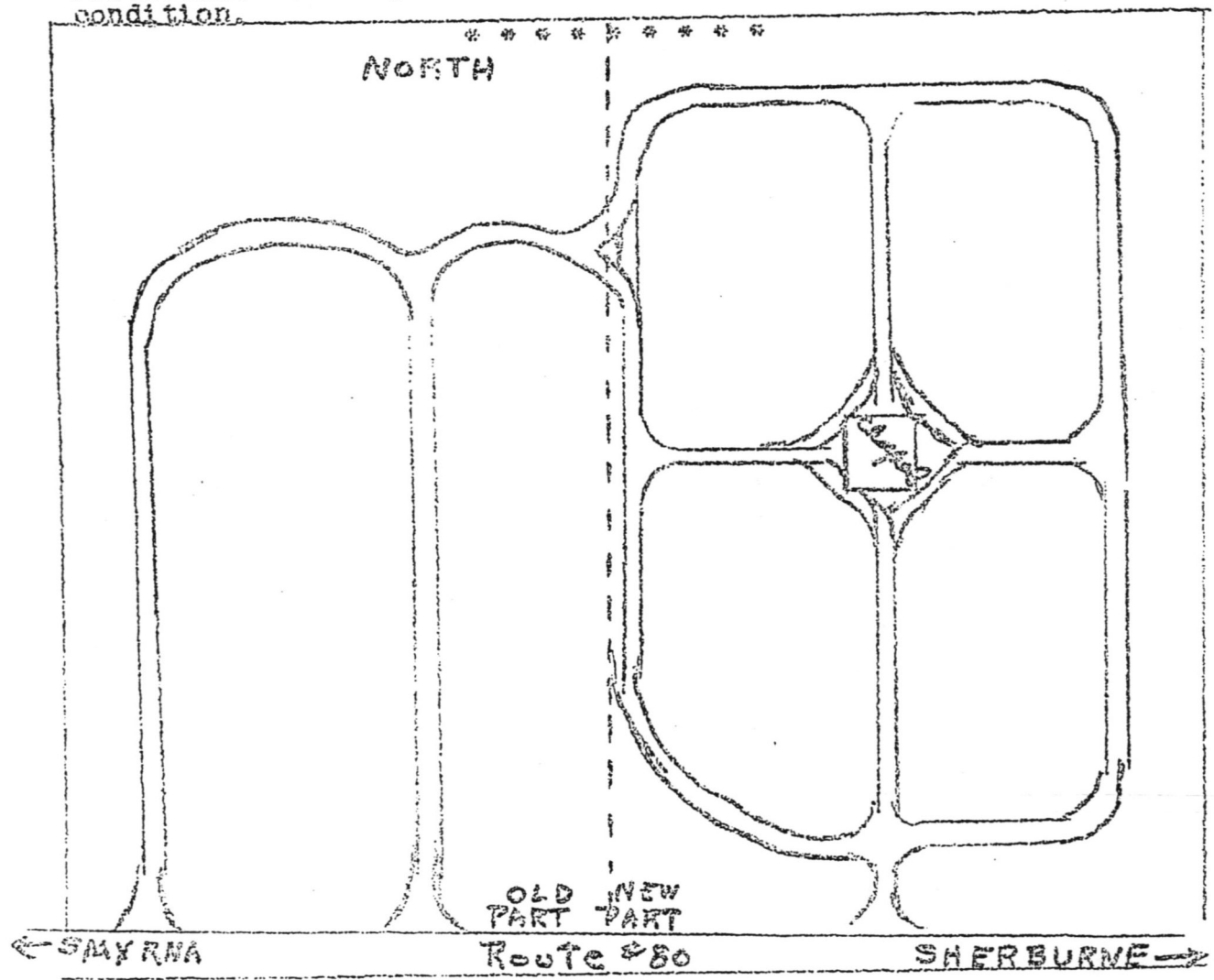

Cemetery Plan - NOT to scale



1 inch equals 200 feet

West Hill Cemetery, Sherburne Vic. Chenango Co. New York
Nomination boundary = Heavy Blackline

UNITED STATES DEPARTMENT OF THE INTERIOR
NATIONAL PARK SERVICE

NATIONAL REGISTER OF HISTORIC PLACES
EVALUATION/RETURN SHEET

REQUESTED ACTION: NOMINATION

PROPERTY NAME: West Hill Cemetery

MULTIPLE NAME:

STATE & COUNTY: NEW YORK, Chenango

DATE RECEIVED: 12/07/05 DATE OF PENDING LIST: 12/27/05
DATE OF 16TH DAY: 1/11/06 DATE OF 45TH DAY: 1/20/06
DATE OF WEEKLY LIST:

REFERENCE NUMBER: 05001534

REASONS FOR REVIEW:

APPEAL: N DATA PROBLEM: N LANDSCAPE: N LESS THAN 50 YEARS: N
OTHER: N PDIL: N PERIOD: N PROGRAM UNAPPROVED: N
REQUEST: N SAMPLE: N SLR DRAFT: N NATIONAL: N

COMMENT WAIVER: N

ACCEPT RETURN REJECT 1-19-06 DATE

ABSTRACT/SUMMARY COMMENTS:

Entered in the
National Register

RECOM./CRITERIA _____

REVIEWER _____ DISCIPLINE _____

TELEPHONE _____ DATE _____

DOCUMENTATION see attached comments Y/N see attached SLR Y/N

If a nomination is returned to the nominating authority, the nomination is no longer under consideration by the NPS.



West Hill Cemetery

Sherburne vic

Chenango Co. NY

photo: nancy todd, 2005

view: looking northwest
at chapel

1



DIED
AUGUST 18
1860
RUTH
WIFE OF
SARGENT
1815

HEAVENLY REST
HENRY CARROLL
DIED
JANUARY 1862
AGED 60 Y.
1802

West Hill Cemetery

Sherburne vic

Chenango Co NY

photo: nancy todd, 2005

view: looking east

in northwest

corner of the

cemetery

(oldest section)

#2



West Hill Cemetery

Sherburne Vic

Chenango Co NY

photo: nancy todd, 2005

view: looking east in
older section
of cemetery

#3



West Hill Cemetery
Sherburne vic

Chenango Co NY

photo: nancy todd, 2005

view: looking east

in northeast part

of dd section

#4

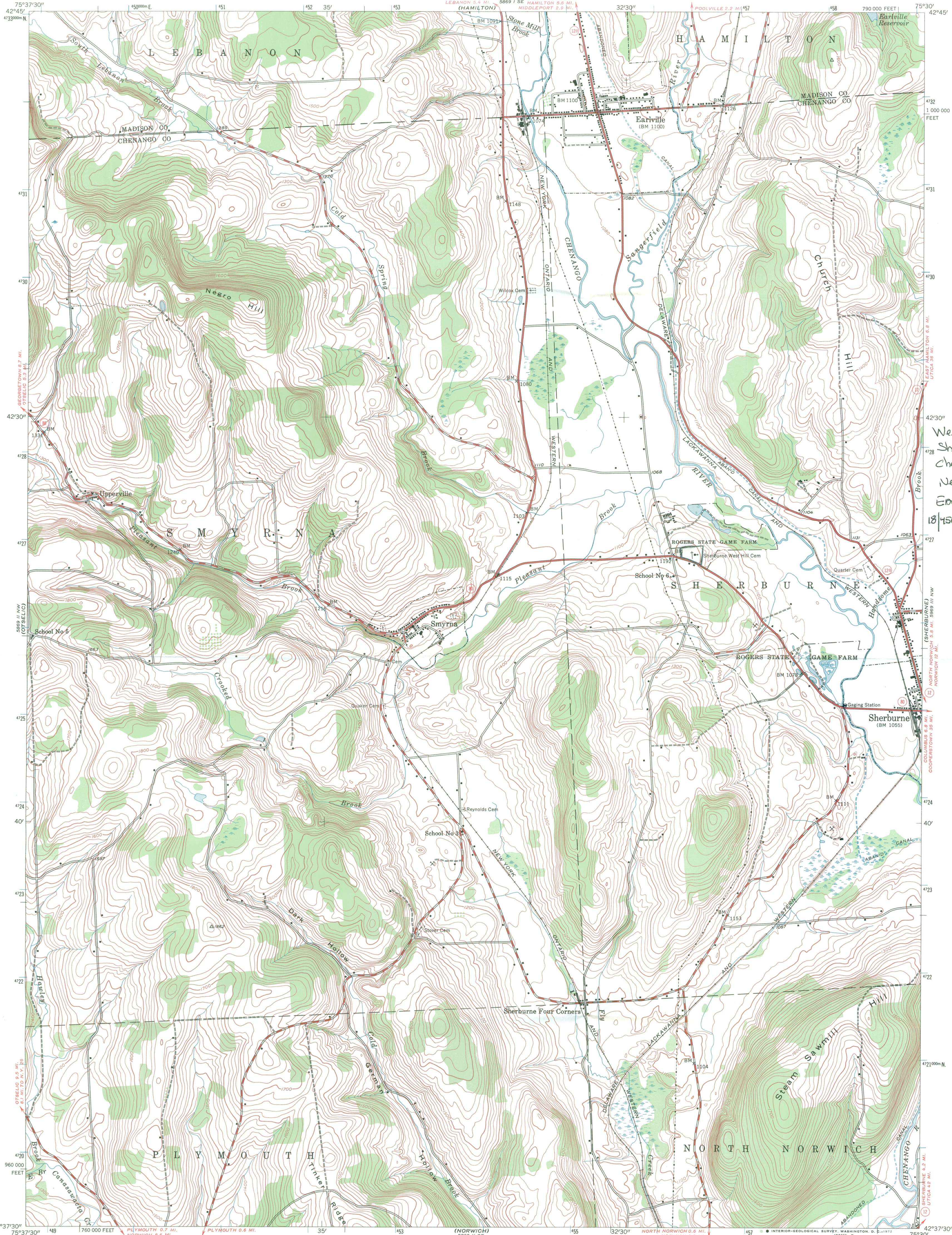

West Hill Cemetery
Sherburne Vic
Chenango Co
New York
Earlville QUA. 3
18/456399/4726775

Maped by the Army Map Service
Published for civil use by the Geological Survey
Control by USGS, USC&GS, and TVA
Topography from aerial photographs by photogrammetric methods
Aerial photographs taken 1942. Field check 1943
Polyconic projection. 1927 North American datum
10,000-foot grid based on New York coordinate system, central zone
1000-meter Universal Transverse Mercator grid ticks,
zone 18, shown in blue

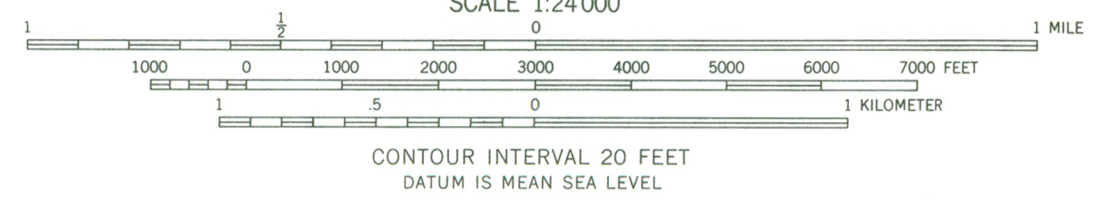
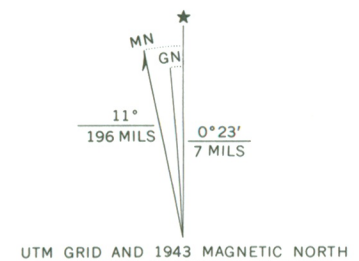

EARLVILLE, N. Y.
NE 1/4 NORWICH 15' QUADRANGLE
N4237.5-W7530/7.5

1943
AMS 5869 II NE-SERIES 7821

THIS MAP COMPLIES WITH NATIONAL MAP ACCURACY STANDARDS
FOR SALE BY U. S. GEOLOGICAL SURVEY, WASHINGTON, D. C. 20242
A FOLDER DESCRIBING TOPOGRAPHIC MAPS AND SYMBOLS IS AVAILABLE ON REQUEST

Sherburne West Hill Cemetery Association

SHERBURNE, NEW YORK 13460

September 19, 2005

New York State Office of Parks, Recreation
Historic Preservation
Peebles Island
PO Box 189
Waterford, New York 12188-0189
Attention: Kathleen LaFrank

RE: Sherburne West Hill Cemetery
Chenango County, Sherburne, New York

Dear Ms. LaFrank:

The Sherburne West Hill Cemetery Association would like to offer our support to place the Sherburne West Hill Cemetery on the National and State Historic Registers.

The West Hill Cemetery holds a much history. The first burial in West Hill Cemetery was in 1796. The cemetery also holds a beautiful chapel, which was built in 1905.

The Sherburne West Hill Cemetery lies in a beautiful setting and adds much to the community with its history and beauty.

The cemetery would make it a wonderful addition to the historic registers.

Very truly yours,

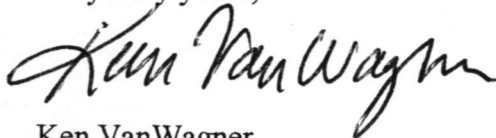

Ken VanWagner
President
Sherburne West Hill Cemetery Association

**COUNTY OF CHENANGO
BOARD OF SUPERVISORS**

Harry W. Conley, Supervisor
TOWN OF SHERBURNE
P.O. Box 860
Sherburne, N. Y. 13460



5 Court Street
Norwich, N. Y. 13815

Telephone:
Office: (607) 674-4481
Home: (315) 691-4884

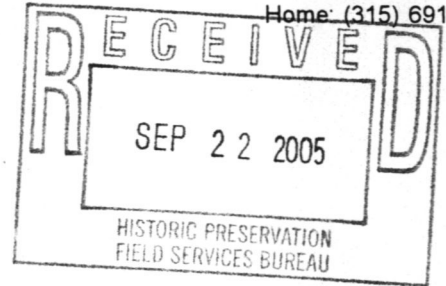

September 19, 2005

New York State Office of Parks, Recreation
Historic Preservation
Peebles Island
PO Box 189
Waterford, New York 12188-0189
Attention: Kathleen LaFrank

RE: Sherburne West Hill Cemetery
Chenango County, Sherburne, New York

Dear Ms. LaFrank:

The Town of Sherburne would like to offer our support to place the Sherburne West Hill Cemetery on the National and State Historic Registers.

The West Hill Cemetery is of great importance to our community. The cemetery is over 200 years old which includes a 100 year old chapel.

The Sherburne West Hill Cemetery holds much history in a beautiful setting that would make it a wonderful addition to the historic registers.

Very truly yours,

Harry W. Conley
Supervisor
Town of Sherburne