

United States Department of the Interior
National Park Service

National Register of Historic Places
Registration Form

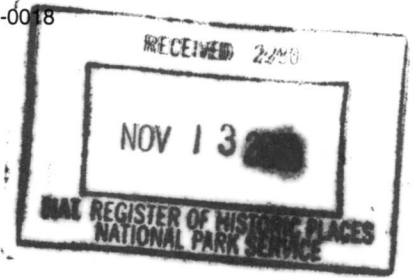

This form is for use in nominating or requesting determinations for individual properties and districts. See instructions in *How to Complete the National Register of Historic Places Registration Form* (National Register Bulletin 16A). Complete each item by marking "x" in the appropriate box or by entering the information requested. If an item does not apply to the property being documented, enter "N/A" for "not applicable." For functions, architectural classification, materials, and areas of significance, enter only categories and subcategories from the instructions. Place additional entries and narrative items on continuation sheets (NPS Form 10-900a). Use a typewriter, word processor, or computer, to complete all items.

1. Name of Property

historic name Chichester House

other name/site number n/a

2. Location

street & town 116 Fair Street not for publication

city or town Kingston vicinity

state New York code NY county Ulster code 111 zip code 12401

3. State/Federal Agency Certification

As the designated authority under the National Historic Preservation Act, as amended, I hereby certify that this nomination request for determination of eligibility meets the documentation standards for registering properties in the National Register of Historic Places and meets the procedural and professional requirements set forth in 36 CFR Part 60. In my opinion, the property meets does not meet the National Register criteria. I recommend that this property be considered significant nationally statewide locally. (See continuation sheet for additional comments.)

William Carter SAPO 10/15/01
Signature of certifying official/Title Date
Commissioner, NY State Office of Parks, Recreation & Historic Preservation
New York State Historic Preservation Officer

State of Federal agency and bureau

In my opinion, the property meets does not meet the National Register criteria. (See continuation sheet for additional comments.)

Signature of certifying official/Title Date

State or Federal agency and bureau

4. National Park Service Certification

I hereby certify that the property is:

- entered in the National Register. See continuation sheet.
- determined eligible for the National Register See continuation sheet.
- determined not eligible for the National Register.
- removed from the National Register.
- other, (explain:)

Signature of the Keeper Date of Action

Edson H. Beall 12/28/01

Chichester House
Name of Property

Ulster, New York
County and State

5. Classification

Ownership of Property
(check as many boxes as apply)

Category of Property
(check only one box)

Number of Resources within Property
(Do not include previously listed resources in the count.)

- public-local
- private
- public-State
- public-Federal

- district
- building(s)
- site
- structure
- object

Contributing	Noncontributing	
2		buildings
		sites
		structures
		objects
2	0	Total

Name of related multiple property listing
(Enter "N/A" if property is not part of a multiple property listing.)
n/a

Number of contributing resources previously listed in the National Register
n/a

6. Function or Use

Historic Function
(Enter categories from instructions)

DOMESTIC/Single dwelling

Current Function
(Enter categories from instructions)

DOMESTIC/Single dwelling

7. Description

Architectural Classification
(Enter categories from instructions)

LATE VICTORIAN/Second Empire

Materials
(Enter categories from instructions)

foundation Stone
walls Brick
Slate shingle
roof
other

Narrative Description

(Describe the historic and current condition of the property on one or more continuation sheets.)

Chichester House
Kingston, Ulster County, New York

**NATIONAL REGISTER OF HISTORIC PLACES
CONTINUATION SHEET**

Section number 7 Page 1

The Chichester house is located on the east-side of Fair Street on a residential parcel of land.¹ The west-facing house is visible from the road. The house and property are bounded on the west by Fair Street; on the north and south by fine nineteenth century residential development; and on the east by the rear lots of homes on Pine Street.

The Chichester residence is a large, three-story, three by three-bay brick dwelling with a three-story, slightly recessed north wing. Built as a single unit, the entire building rests on a stone and brick foundation and is covered by a patterned slate shingle clad concave mansard roof. The roof is enlivened with an overhanging, bracketed eave, ornate cornice details and evenly spaced round arched dormers with decorative trim work.

The facade (west elevation) faces Fair Street. This elevation is divided into five bays. The southern three bays form the main block of the house, while the north two bays are recessed back from the façade creating the illusion of a side wing. A single story, finely crafted porch spans the full width of the five-bay façade. The porch is crafted in a Classical Revival style with the porch posts supported on stone piers. The south end of the porch is rounded forward providing a unique counter balance to the recessed northern two bays of this elevation. The main entrance to the house is situated in the center bay of the façade. It is composed of a pair of glazed and paneled doors set within a molded frame. The entry opens into a narrow vestibule. The central entrance bay serves as the architectural focal point of the facade. Windows on the façade and all other elevations retain their original two-over-two light sash. Three round-arched dormers pierce the mansard roof, on this elevation.

Symmetrically arranged windows on each floor highlight the north and south elevations of the house. Two round arched dormers pierces the mansard roof on each of these elevations. A large narrow single story wing dominates the rear (east) elevation of the house.

On the interior the building features a traditional side hall plan. The entry vestibule opens into a wide hall, which is highlighted by finely crafted ceiling moldings. A stair, which rises up to the attic level is finely detailed with delicately carved newels and ornate balusters. Flanking the stair hall on the south are two parlors. Each feature elaborately modillioned ceiling cornices, finely crafted architraves and fireplace surrounds. The two rooms located on the north side of the hall display an equally high degree of architectural ornamentation. The second floor of the house contains two chambers with smaller anterooms. The third floor (attic level) retains is original configuration of smaller chambers.

Located behind the house is an intact ca.1870 carriage house now used for storage.

¹ Fair Street is a designated Historic District under the city of Kingston's Historic Preservation Ordinance. The street is under consideration for listing in the New York State and National Registers of Historic Districts at some point in the future.

8. Description

Applicable National Register Criteria

(Mark "x" in one or more boxes for the criteria qualifying the property for National Register listing.)

- A** Property is associated with events that have made a significant contribution to the broad patterns of our history.
- B** Property is associated with the lives of persons significant in our past.
- C** Property embodies the distinctive characteristics of a type, period, or method of construction or represents the work of a master, or possesses high artistic values, or represents a significant and distinguishable entity whose components lack individual distinction.
- D** Property has yielded, or is likely to yield, information important in prehistory or history.

Criteria Considerations

(Mark "x" in all the boxes that apply.)

Property is:

- A** owned by a religious institution or used for religious purposes.
- B** removed from its original location.
- C** a birthplace or grave.
- D** a cemetery.
- E** a reconstructed building, object, or structure.
- F** a commemorative property.
- G** less than 50 years of age or achieved significance within the past 50 years.

Narrative Statement of Significance

(Explain the significance of the property on one or more continuation sheets.)

Areas of Significance

(enter categories from instructions)

Architecture

Period of Significance

ca.1870

Significant Dates

ca.1870

Significant Persons

(Complete if Criterion B is marked above)

n/a

Cultural Affiliation

n/a

Architect/Builder

n/a

9. Major Bibliographical References

Bibliography

(Cite the books, articles, and other sources used in preparing this form on one or more continuation sheets.)

Previous documentation on file (NPS):

- preliminary determination of individual listing (36 CFR 67) has been requested
- previously listed in the National Register
- previously determined eligible by the National Register
- designated a National Historic Landmark
- recorded by Historic American Buildings Survey # _____
- recorded by Historic American Engineering Record # _____

Primary location of additional data:

- State Historic Preservation Office
- Other State agency
- Federal agency
- Local government
- University
- Other Name of repository: _____

Chichester House
Kingston, Ulster County, New York

**NATIONAL REGISTER OF HISTORIC PLACES
CONTINUATION SHEET**

Section number 8 Page 1

The Chichester house is architecturally significant as an outstanding example of French Second Empire residential architecture in the city of Kingston. Built ca.1870, the building displays a variety of architectural elements associated with this sophisticated style. These features include the building's signature concave mansard roof, patterned slate shingles, bracketed cornice, double entrance doors and lavish exterior and interior moldings, architraves and architectural details.

Fair Street is situated in the east-side of the city of Kingston and extends southerly from the city's historic Stockade District (NR Listed 1975). Little is know about the evolution of this neighborhood. A survey of the homes lining the street reveal it to be one of the city's most prosperous mid-nineteenth century residential neighborhoods. An 1870 map of the city of Kingston indicates that a Mrs. Chichester owned the house at this time.

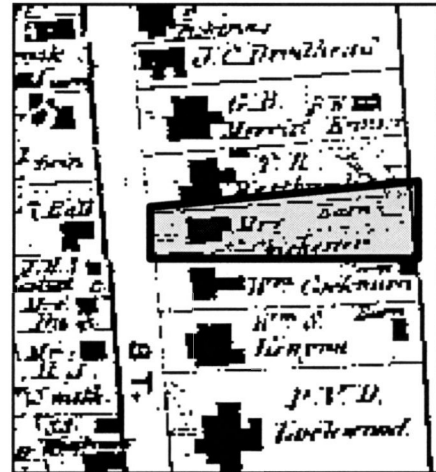

As built, the Chichester house is an outstanding example of the Second Empire style. Named for the French Second Empire period and the reign of Napoleon III, it is based on the grand public architecture of Second Empire Paris. The most important feature of the style is the high mansard roof with prominent dormer windows. The mansard may have straight, convex or concave (also called bellcast) sides and is almost always sheathed with multi-colored and patterned slate tiles. Second Empire style buildings are generally symmetrical and boldly three-dimensional in both massing and details. Windows are generally round or segmental arched. Cornice brackets, often smaller and more closely spaced than those associated with the Italianate style, are common. The house retains a high degree of integrity of setting, location, feeling, association, design, materials and craftsmanship and is an important local landmark.

The house retains a high degree of architectural integrity from its period of significance. The architectural character of this property is further enhanced by the survival of its companion carriage house and its intact urban setting. The Chichester house is particularly sophisticated example of late nineteenth century residential design in the community and is a visual reminder of the region's agricultural prosperity of the period.

Chichester House
Name of Property

Ulster, New York
County and State

10. Geographical Data

Acreage of Property Less than one acre

UTM References

(Place additional boundaries of the property on a continuation sheet.)

1 18 581570 4642030
Zone Easting Northing

2
Zone Easting Northing

3
Zone Easting Northing

4
Zone Easting Northing

See continuation sheet

Verbal Boundary Description

(Describe the boundaries of the property on a continuation sheet.)

Boundary Justification

(Explain why the boundaries were selected on a continuation sheet.)

11. Form Prepared By

name/title John A. Bonafide, Historic Preservation Program Analyst

organization NYSOPRHP

date June, 2001

street & number P.O. 189

telephone (518) 237-8643

city or town Waterford

state NY zip code 12188-0189

Additional Documentation

Submit the following items with the completed form:

Continuation Sheets

Maps

A **USGS map** (7.5 or 15 minute series) indicating the property's location.

A **Sketch map** for historic districts and properties having large acreage or numerous resources.

Photographs

Representative black and **white photographs** of the property.

Additional items

(Check with the SHPO or FPO for any additional items)

Property Owner

(Complete this item at the request of SHPO or FPO.)

name/title Mr. And Mrs. Robert J. DiBella

street & number 116 Fair Street

telephone n/a

city or town Kingston

state NY zip code 12401

Paperwork Reduction Act Statement: This information is being collected for applications to the National Register of Historic Places to nominate properties for listing or determine eligibility for listing, to list properties, and to amend existing listings. Response to this request is required to obtain a benefit in accordance with the National Historic Preservation Act, as amended (16 U.S.C. 470 *et seq.*).

Estimated Burden Statement: Public reporting burden for this form is estimated to average 18.1 hours per response including time for reviewing instructions, gathering and maintaining data, and completing and reviewing the form. Direct comments regarding this burden estimate or any aspect of this form to the Chief, Administrative Services Division, National Park Service, P.O. Box 37127, Washington, DC 20013-7127; and the Office of Management and Budget, Paperwork Reductions Projects (1024-0018), Washington, DC 20503.

Chichester House
Kingston, Ulster County, New York

**NATIONAL REGISTER OF HISTORIC PLACES
CONTINUATION SHEET**

Section number 9 Page 1

Bibliography

Schoonmaker, Marius. The History of Kingston, New York. New York: Burr Publishing House. 1888.

Chichester House
Kingston, Ulster County, New York

**NATIONAL REGISTER OF HISTORIC PLACES
CONTINUATION SHEET**

Section number 10 page 1

10. Geographical Data

Verbal Boundary Description

The boundary for the nominated property is shown as the heavy black outline on the accompanying map entitled "Chichester House, Kingston, Ulster County, New York."

Boundary justification

The boundary for the nomination has been drawn to coincide with the current legal lot for the property.

Chichester House
Kingston, Ulster County, New York

**NATIONAL REGISTER OF HISTORIC PLACES
CONTINUATION SHEET**

Section number Photographs

Chichester House

Kingston, Ulster County

Photo by: John A. Bonafide, 2001

NYS OPRHP, Waterford, NY

Neg. at: NYS OPRHP, Waterford, NY

Photographs

1. West façade
2. West façade and south elevation
3. East elevation, note original elongated service wing
4. Interior detail, stair hall
5. Interior detail, parlor
6. Interior detail, parlor
7. Oubuilding

Chichester House
Kingston, Ulster County, New York

NATIONAL REGISTER OF HISTORIC PLACES
CONTINUATION SHEET

Section number PHOTO

Chichester House
Kingston, Ulster County, New York

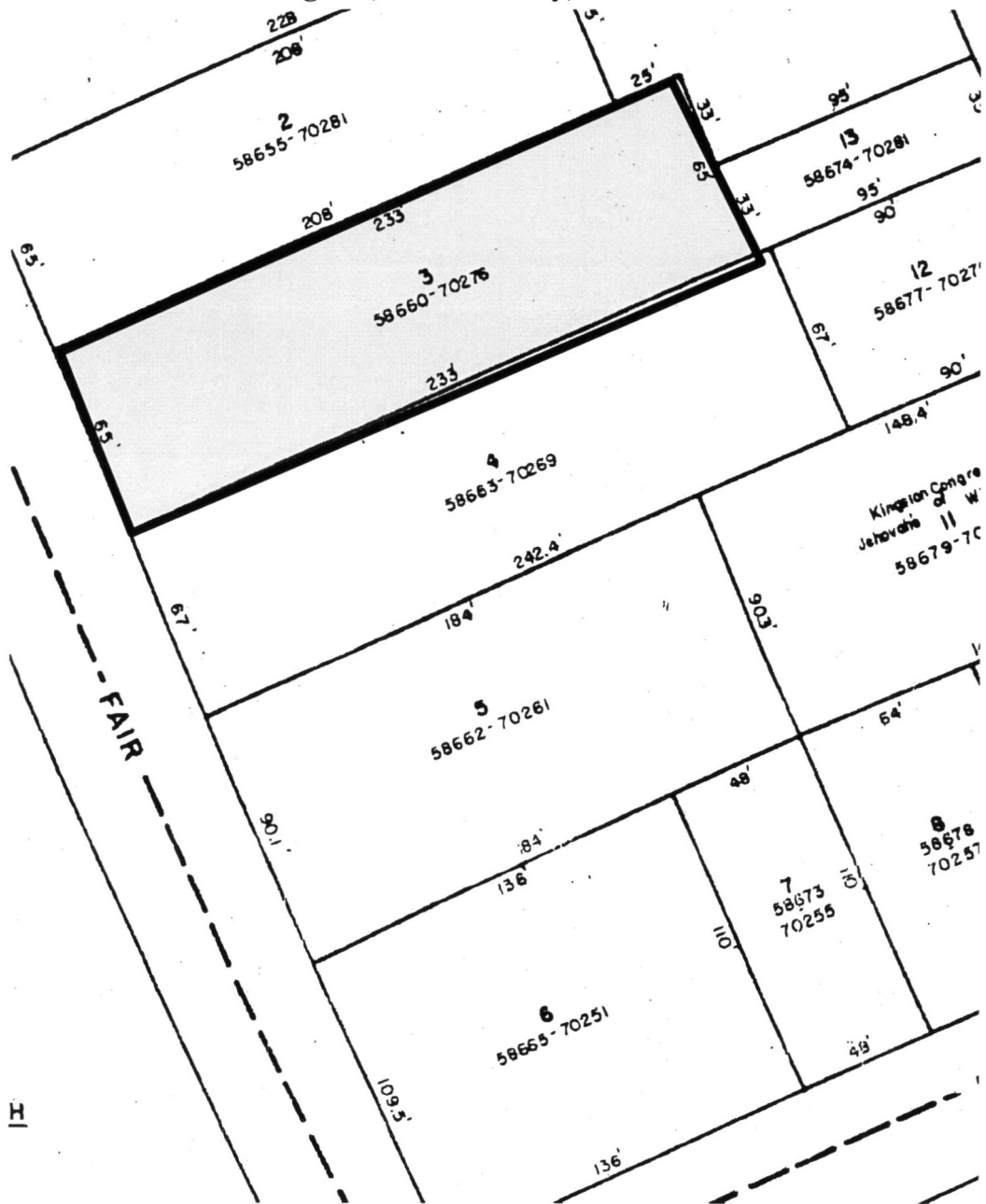

NORTH



scale
boundary
photo key

1 inch equals 60 feet



UNITED STATES DEPARTMENT OF THE INTERIOR
NATIONAL PARK SERVICE

NATIONAL REGISTER OF HISTORIC PLACES
EVALUATION/RETURN SHEET

REQUESTED ACTION: NOMINATION

PROPERTY NAME: Chichester House

MULTIPLE NAME:

STATE & COUNTY: NEW YORK, Ulster

DATE RECEIVED: 11/13/01 DATE OF PENDING LIST: 12/07/01
DATE OF 16TH DAY: 12/23/01 DATE OF 45TH DAY: 12/29/01
DATE OF WEEKLY LIST:

REFERENCE NUMBER: 01001392

REASONS FOR REVIEW:

APPEAL: N DATA PROBLEM: N LANDSCAPE: N LESS THAN 50 YEARS: N
OTHER: N PDIL: N PERIOD: N PROGRAM UNAPPROVED: N
REQUEST: N SAMPLE: N SLR DRAFT: N NATIONAL: N

COMMENT WAIVER: N

ACCEPT RETURN REJECT 12/28/01 DATE

ABSTRACT/SUMMARY COMMENTS:

**Entered in the
National Register**

RECOM./CRITERIA _____

REVIEWER _____ DISCIPLINE _____

TELEPHONE _____ DATE _____

DOCUMENTATION see attached comments Y/N see attached SLR Y/N



Chichester House
Kingston, Ulster Co.

1

025 044 NNNB --- 22.06.01 ELITE PHOTO



Chichesler House
Kingston, Ulster Co.

2

027 044 NNNB --- 22.06.01 ELITE PHOTO



Chichesler House
Kingston, Ulster Co.

3

022 044 MNMB --- 22.06.01 ELITE PHOTO



Chichester House
Kingston, Ulster Co.

4

008 077 NMMC --- 04.10.01 ELITE PHOTO



Chichester House
Kingston, Ulster Co.

5

007 077 NNNB ----- 04.10.01 ELITE PHOTO



Chichester House
Kingston, Ulster Co
6

006 077 NNNB --- 04*10*01 ELITE PHOTO



Chichester House
Kingston, Ulster Co

7

001 079 NNNN --- 04.10.01 ELITE PHOTO



NEW YORK STATE
DEPARTMENT OF TRANSPORTATION

KINGSTON WEST QUADRANGLE
NEW YORK-ULSTER CO.
7.5 MINUTE SERIES

BEARSVILLE

SAUGERTIES



Chichestee House
Kingston, Ulster Co.
Kingston West Quad
Zone 18 Scale 1:17000
581570 4642030

Published in 1989 by the New York State Department of Transportation, in cooperation with the U.S. Department of Transportation, Federal Highway Administration.
Map base from 1964 U.S. Geological Survey 7.5-minute quadrangle.
Map revisions made using aerial photography dated 1988, construction plans, official records and other sources. Features revised include: highways and other transportation facilities; civil boundaries; recreation sites; hydrography; and buildings. Gray tint indicates developed areas in which only landmark buildings are shown. Darker gray tint indicates open water features.
Revisions may not comply with National Map Accuracy Standards.
Correspondence concerning this and other maps of the Department of Transportation should be directed to: Map Information Unit, New York State Department of Transportation, State Campus, Albany, New York 12232.
Revisions by P.V. Fasano



SCALE 1:24 000
1000-METER TICKS based on the New York Transverse Mercator grid. Between 72° and 78° West Longitude, this grid is identical to Zone 18 of the Universal Transverse Mercator grid. Areas east of 72° and west of 78° are direct mathematical extensions of Zone 18.
10,000-foot ticks based on the New York State Plane Coordinate System, East Zone.
Magnetic declination for 1989 is approximately 13.5° West
Contours, at 20-foot intervals, shown unrevised from 1964 U.S. Geological Survey map. Datum is mean sea level.

INDEX TO 1:9600 (1"=800') MAP COVERAGE

KINGSTON WEST (north)	KINGSTON WEST (south)
-----------------------	-----------------------

BOUNDARIES:
State
County
Town or City
Incorporated Village

ROADS:
Touring Route Markers:
Interstate
U.S. State
County
State Highway number and limit
County road
Interchange number

Divided:
Wide mall
Narrow mall or barrier

Undivided:
4 or more lanes
Less than 4 lanes

Vehicle track; trail