

United States Department of the Interior
National Park Service

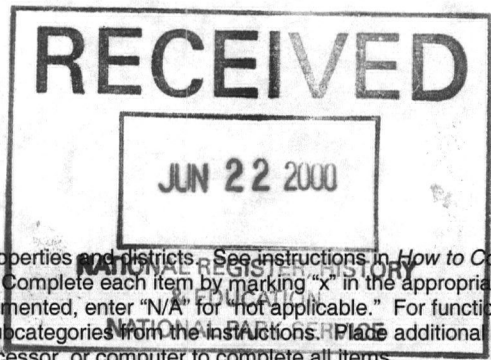

National Register of Historic Places Registration Form

This form is for use in nominating or requesting determinations for individual properties and districts. See instructions in *How to Complete the National Register of Historic Places Registration Form* (National Register Bulletin 16A). Complete each item by marking "X" in the appropriate box or by entering the information requested. If an item does not apply to the property being documented, enter "N/A" for "not applicable." For functions, architectural classification, materials, and areas of significance, enter only categories and subcategories from the instructions. Place additional entries and narrative items on continuation sheets (NPS Form 10-900a). Use a typewriter, word processor, or computer to complete all items.

1. Name of Property

historic name Memorial Church of the Holy Cross

other names/site number _____

2. Location

street & number 841 Bleecker Street [] not for publication

city or town Utica [] vicinity

state New York code NY county Oneida code 065 zip code 13501

3. State/Federal Agency Certification

As the designated authority under the National Historic Preservation Act, as amended, I hereby certify that this [X] nomination [] request for determination of eligibility meets the documentation standards for registering properties in the National Register of Historic Places and meets the procedural and professional requirements as set forth in 36 CFR Part 60. In my opinion, the property [X] meets [] does not meet the National Register criteria. I recommend that this property be considered significant [] nationally [] statewide [X] locally. ([] see continuation sheet for additional comments.)

JW. Asch
Signature of certifying official/Title

Deputy Commissioner for Historic Preservation 9 June '00
Date

New York State Office of Parks, Recreation & Historic Preservation
State or Federal agency and bureau

In my opinion, the property [] meets [] does not meet the National Register criteria. ([] see continuation sheet for additional comments.)

Signature of certifying official/Title _____ Date _____

State or Federal agency and bureau _____

4. National Park Service Certification

I hereby certify that the property is:

- entered in the National Register [] see continuation sheet
- determined eligible for the National Register [] see continuation sheet
- determined not eligible for the National Register

removed from the National Register

other (explain) _____

John E. Beall
Signature of the Keeper _____ date of action 7/20/00

Name of Property

County and State

5. Classification

Ownership of Property

(check as many boxes as apply)

- private
- public-local
- public-State
- public-Federal

Category of Property

(Check only one box)

- building(s)
- district
- site
- structure
- object

Number of Resources within Property

(Do not include previously listed resources in the count)

Contributing	Non-contributing	
1	0	buildings
_____	_____	sites
_____	_____	structures
_____	_____	objects
1	0	TOTAL

Name of related multiple property listing

(Enter "N/A" if property is not part of a multiple property listing)

N/A

Number of contributing resources previously listed in the National Register

N/A

6. Function or Use

Historic Functions

(enter categories from instructions)

RELIGION/religious facility

Current Functions

(Enter categories from instructions)

RELIGION/religious facility

7. Description

Architectural Classification

(Enter categories from instructions)

LATE VICTORIAN/Gothic

Materials

(Enter categories from instructions)

foundation STONE

walls STONE

roof SLATE

other

Narrative Description

(See continuation sheet)

**United States Department of the Interior
National Park Service**

**National Register of Historic Places
Continuation Sheet**

Section 7 Page 1

Memorial Church of the Holy Cross
Name of Property
Utica, Oneida Co. NY
County and State

Description

The Memorial Church of the Holy Cross is located on the north side of Bleecker Street in the eastern portion of the city of Utica, Oneida County. A major center of transportation and manufacturing, Utica grew rapidly during the nineteenth and early twentieth centuries. The area surrounding the church is characterized by a mixture of urban residential, commercial and industrial buildings, most of which have experienced substantial alteration. The nominated property occupies a parcel of less than one acre bounded on the south by Bleecker Street, on the north by Jay Street and on the east and west by two-story commercial properties.

The main block of the church is cruciform in plan. The rectangular nave portion of the building intersects the two flanking transepts at the apse. A polygonal chancel extends from the north end of the sanctuary to complete the cross. The whole of the main block is sheltered by steeply pitched, intersecting gable roofs sheathed in slate. An engaged, three stage, square entrance/bell tower with louvered belfry is located at the southwest corner of the main block. The tower is surmounted by a tall steeple built entirely of stone. An attached, rectangular, 1½-story wing was added at the northeast corner of the original church building in 1932 to serve as a choir room and rector's office.

The walls of the church are constructed of rough-cut quarry stone. Staged buttresses spaced at regular intervals support the corners of the church and the tower and divide the walls into a series of bays. A water table of contrasting dark smooth sandstone surrounds the main block above the foundation. Buttress caps, copings and Gothic-arched window openings are also trimmed in contrasting dark, smooth bluestone.

The principal (south) elevation is organized around a projecting center entrance. A Gothic-arched architrave encloses double-leaf doors with ornamental strap hinges. A tall, Gothic-arched window flanks each side of the entrance vestibule. A second entrance is located at the base of the corner bell tower; both are approached by means of cut stone steps. Fenestration is varied. Paired Gothic windows containing art glass and simple tracery are located along the east and west side walls, each pair separated by stone buttresses. More ornate stained glass windows are located in the transepts and the chancel areas. A large circular window opening is located in each of the gable fields; those in the transepts contain stained glass rose windows.

The interior of the Memorial Church of the Holy Cross retains substantial integrity to its Late Victorian Gothic form, with few changes over time. The main entrance opens into a small vestibule or narthex. The sanctuary is organized around a center-aisle plan. Banks of varnished oak pews flank the aisle, with additional pews located in both transepts. A small chapel is located in the west transept flanking the chancel. The walls of the sanctuary are plastered to the height of the window arches; the open ceiling is sheathed in horizontal beaded wainscoting. The roof is supported by Gothic spring arches embellished with gilded consoles and open fretwork trusses. The arches converge to form a vaulted ceiling at the apse. The chancel is recessed beneath a tall

**United States Department of the Interior
National Park Service**

**National Register of Historic Places
Continuation Sheet**

Section 7 Page 2

Memorial Church of the Holy Cross
Name of Property
Utica, Oneida Co. NY
County and State

arch with molded Gothic trim at the north end of the sanctuary. The chancel is approached by a set of risers extending across the width of the arch. The polygonal chancel exhibits the same finishes as the remainder of the worship space, and is lighted by a series of lancet windows.

A connecting interior door leads from the east transept to the attached parish hall wing of 1932. The wing contains a dining/reception room, kitchen, lavatory and a small apartment. A separate entrance to the parish wing is located on the south elevation near the angle of intersection with the church proper.

Minor modifications to the worship space occurred after 1957, the result of liturgical changes when the former Episcopal church building was purchased by the present Ukrainian Orthodox congregation. The organ originally located in the east transept was removed from the building and an iconostasis was installed to separate the former chancel from the sanctuary. These changes have not affected the architectural integrity of the interior, and are reversible.

Name of Property

County and State

8. Statement of Significance

Applicable National Register Criteria

(Mark "x" in one or more boxes for the criteria qualifying the property for National Register listing.)

- [] A Property associated with events that have made a significant contribution to the broad patterns of our history.
[] B Property is associated with the lives of persons
[X] C Property embodies the distinctive characteristics of a type, period, or method of construction or represents the work of a master, or possesses high artistic values, or represents a significant and distinguishable entity whose components lack individual distinction.
[] D Property has yielded, or is likely to yield, information important in prehistory or history.

Criteria Considerations

(Mark "x" in all boxes that apply.)

- [X] A owned by a religious institution or used for religious purposes.
[] B removed from its original location
[] C a birthplace or grave
[] D a cemetery
[] E a reconstructed building, object, or structure
[] F a commemorative property
[] G less than 50 years of age or achieved significance within the past 50 years

Areas of Significance:

(Enter categories from instructions)

ARCHITECTURE

Period of Significance:

1891--1932

Significant Dates:

1891

Significant Person:

N/A

Cultural Affiliation:

N/A

Architect/Builder:

James Constable, Jr. (Architect)

Narrative Statement of Significance

(See continuation sheet)

9. Major Bibliographical References

Bibliography

Clarke, T. Wood. Utica for a Century and a Half. Utica, 1952.
Utica Daily Press, December 26, 1955.

Previous documentation on file (NPS):

- [] preliminary determination of individual listing (36 CFR 67) has been requested.
[] previously listed in the National Register
[] previously determined eligible by the National Register
[] designated a National Historic Landmark
[] recorded by historic American Building Survey #
[] recorded by Historic American Engineering Record #

Primary location of additional data:

- [X] State Historic Preservation Office
[] Other State agency
[] Federal Agency
[] Local Government
[] University
[] Other repository:

**United States Department of the Interior
National Park Service**

**National Register of Historic Places
Continuation Sheet**

Section 8 Page 1

Memorial Church of the Holy Cross
Name of Property
Utica, Oneida Co. NY
County and State

Statement of Significance

The Memorial Church of the Holy Cross is significant under Criterion C as a distinguished and substantially intact example of High Victorian Gothic style religious architecture in the city of Utica. Built in 1891 to the design of architect James Constable, Jr., the Church of the Holy Cross incorporates the range of design and decorative features characteristic of Episcopal church architecture and the High Victorian Gothic Style of the late nineteenth century. With its cruciform plan, polychrome masonry walls, pointed arches, steeply pitched gable roofs and tall steeple built entirely of stone, the Memorial Church of the Holy Cross remains an imposing architectural landmark in east Utica. Originally erected to serve an Episcopal mission congregation established in the 1870s, Holy Cross retained its Episcopal affiliation until 1960, when the building was sold to a Ukrainian Orthodox congregation. (The period of significance, 1891-1932, encompasses the period from the beginning of construction until the building achieved its final, present architectural configuration.) Despite minor modifications associated with this change in denomination, the Memorial Church of the Holy Cross remains in regular use for religious services and retains substantial architectural integrity to the period of significance.

Over the course of the nineteenth century, the city of Utica (incorporated 1832) evolved into the premier manufacturing and transportation center of the western Mohawk Valley. From its origins as Fort Schuyler, a frontier outpost during the colonial period, Utica grew to prominence as a seat of milling, heavy industry and regional commerce. Located astride the principal transportation route between the Great Lakes and the Hudson River Valley, the city and its fortunes rose with the building of the Erie Canal (1817-1825), the Chenango Canal (1836) and the New York Central Railroad (1853). Utica's population reached 60,000 by 1900 and continued to expand steadily until the onset of regional economic decline after World War II. Throughout this period, the east side of Utica developed into a vital working-class section characterized by small businesses and ethnic residential neighborhoods located near sources of employment and served by trolley lines.

The Memorial Church of the Holy Cross was established in 1871 as the Mission of the Good Shepherd. This was the second mission congregation sponsored by Grace Church, which was then, as now, Utica's largest Episcopal parish. Various clergy from other Utica churches conducted the first weekly services at the mission congregation. The first permanent church building was a small wood frame structure erected on Mohawk Street in 1874. In later years, this building was moved to Bleecker Street, where it remained in use until the present nominated stone building was constructed.

East Utica grew and prospered rapidly during the late nineteenth century. The mission congregation evolved into a permanent, self-sustaining parish during the 1870s. By the end of the following decade, the congregation had outgrown its church building and initiated a capital campaign for a new church. Led by the Rev. James J. Bird (who became rector in 1889 and served Holy Cross for the next 37 years), the congregation commissioned architect and engineer James Constable, Jr.

United States Department of the Interior
National Park Service

National Register of Historic Places
Continuation Sheet

Section 8 Page 2

Memorial Church of the Holy Cross
Name of Property
Utica, Oneida Co. NY
County and State

to design a new church building. James Constable was born at Constable Hall (National Register, 1973), Constableville, Lewis County, in 1840. Little information exists regarding Constable's background. After receiving training in civil engineering at Cambridge, Massachusetts, he arrived at Utica in 1888. Constable is identified as city surveyor in 1890 and is known to have designed a number of buildings in Utica during the late nineteenth-early twentieth centuries.

The source of Constable's design for Holy Cross church is unknown. The proliferation of pattern books and architectural journals during the last quarter of the nineteenth century made plans and designs widely available to builder-architects such as Constable. The publications of architects John Ruskin and Frederick Clark Withers defined the theoretical basis for High Victorian Gothic architecture, which achieved widespread popularity in post-Civil War America. Emphasis upon structural honesty combined with polychrome exterior treatments and continued spatial reflection of liturgical function characterized Episcopal church design during the period ca. 1860-1900. (For a comprehensive discussion of this architectural context, see the Multiple Property Documentation Form, "Historic Churches of the Episcopal Diocese of Central New York" currently on file with the National Register).

The cornerstone of the new church building was laid with appropriate ceremony on October 9, 1890. The church was completed and opened for worship October 28, 1891; consecration by Bishop Dr. Frederick Huntington of the Episcopal Diocese of Central New York followed on January 5, 1892. As built, the Memorial Church of the Holy Cross reflects many of the design and practical considerations espoused by leading proponents of the High Victorian Gothic. These include polychromatic stone walls, a steeply pitched slate roof, a staged bell tower surmounted by a soaring steeple, buttressed walls, pointed arched openings and an interior arrangement based upon liturgical function. The simplified Gothic forms reflected in the exposed structural system embody the trend toward "honesty" of materials advocated by Ruskin. The Memorial Church of the Holy Cross retains substantial integrity of design and materials to the period of significance and continues to reflect the exuberant, defining characteristics of the High Victorian Gothic Style as applied to church architecture.

The Holy Cross congregation grew and prospered through the 1930s. A compatible stone addition was constructed in 1932 to accommodate a choir room and sexton's apartment. As the character of east Utica changed after World War II, the parish of Holy Cross church experienced a gradual decline in membership. In 1957, the congregation merged with nearby St. Luke's Episcopal Church, and the Holy Cross property was offered for sale. Ultimately, the building was sold out of the Episcopal Diocese of Central New York with the stipulation that the property remain in religious use. In 1960, a Ukrainian Orthodox congregation acquired the building, making minor modifications to adapt it to a different form of worship. As the Holy Cross Ukrainian Autocephalic Orthodox Church, this successor congregation continues to use and maintain the former Episcopal church building. The Memorial Church of the Holy Cross remains a distinguished architectural landmark in east Utica and a prominent visual element of Bleecker Street.

10. Geographical Data

Acreage of Property less than 1 acre

Utica East quad.

UTM References

1 | 1 | 8 | | 4 | 8 | 2 | 6 | 0 | 5 | | 4 | 7 | 7 | 1 | 4 | 1 | 0 |
Zone Easting Northing

3 | 1 | 8 | | | | | | | | | | | | | |
Zone Easting Northing

2 | 1 | 8 | | | | | | | | | | | | | |

4 | 1 | 8 | | | | | | | | | | | | | |

Verbal Boundary Description

The nominated property includes all that parcel encompassed within the boundaries delineated on the enclosed survey map.

Boundary Justification

The nominated property includes the historic church building on its current parcel, as delineated on the enclosed survey map.

11. Form Prepared By

name/title Raymond W. Smith, Program Analyst

organization New York State Office of Parks, Rec. & Historic Preservation date June, 2000

street & number Peebles Island, PO Box 189

telephone 518-237-8643

city or town Waterford

state NY zip code 12188-0189

Additional Documentation

Submit the following items with the completed form:

Continuation Sheets

Maps

A USGS map (7.5 or 15 minute series) indicating the property's location

A Sketch map for historic districts and properties having large acreage or numerous resources.

Photographs

Representative black and white photographs of the property.

Additional items

(Check with SHPO or FPO for any additional items)

Property Owner (Complete this item at the request of the SHPO or FPO)

name

street & number telephone

city or town state zip code

Paperwork Reduction Act Statement: This information is being collected for applications to the National Register of Historic Places to nominate properties for listing or determine eligibility for listing, to list properties, and to amend existing listings. Response to this request is required to obtain a benefit in accordance with the National Historic Preservation Act, as amended (16 U.S.C. 470 et seq.)

Estimated Burden Statement: Public reporting burden for this form is estimated to average 18.1 hours per response including time for reviewing instructions, gathering and maintaining data, and completing and reviewing the form. Direct comments regarding this burden estimate or any aspect of this form to the Chief, Administrative Services Division, National Park Service, P.O. Box 37127, Washington, D.C. 20503

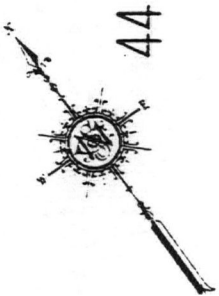

44

HUBBELL

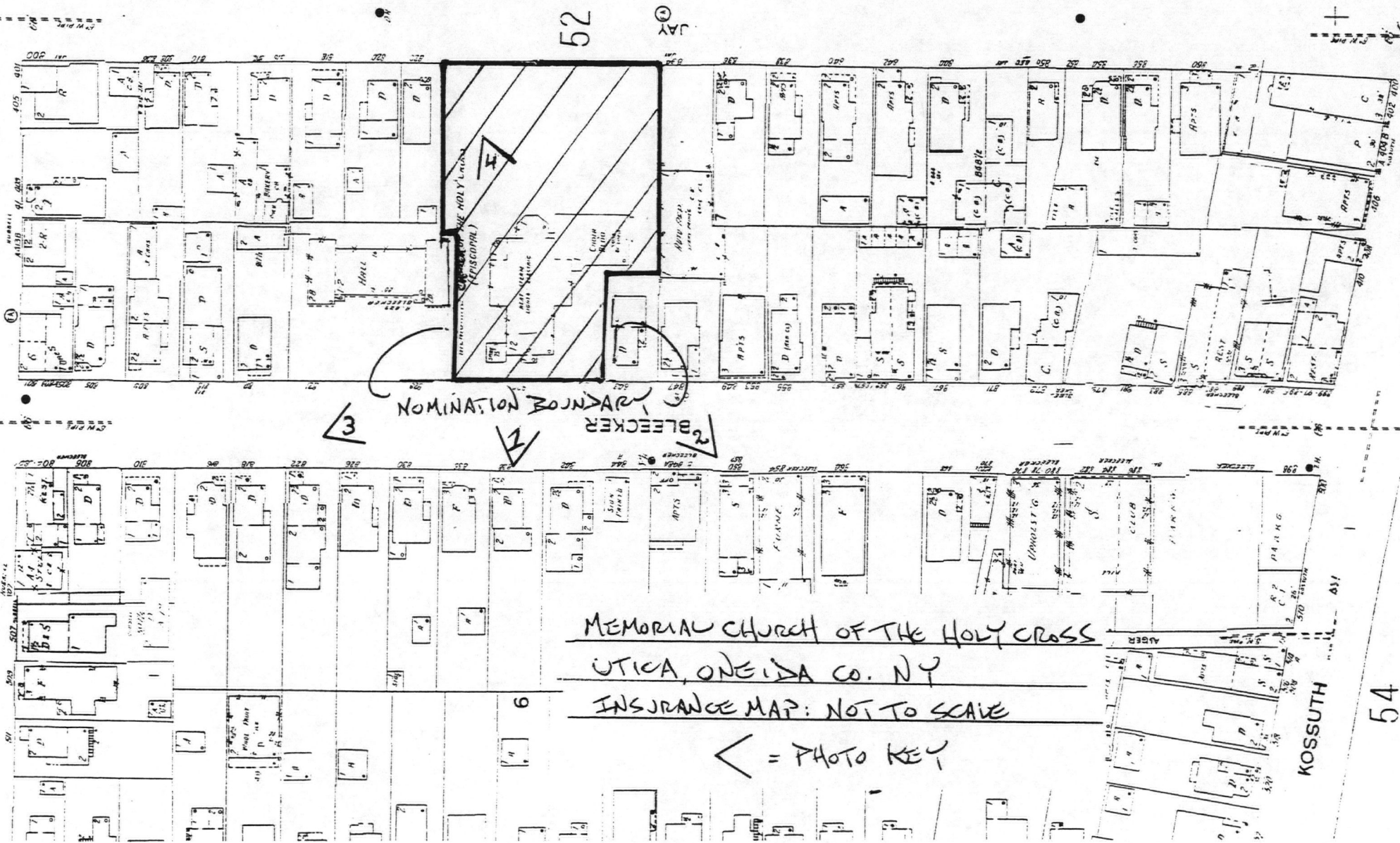

54

UNITED STATES DEPARTMENT OF THE INTERIOR
NATIONAL PARK SERVICE

NATIONAL REGISTER OF HISTORIC PLACES
EVALUATION/RETURN SHEET

REQUESTED ACTION: NOMINATION

PROPERTY NAME: Memorial Church of the Holy Cross

MULTIPLE NAME:

STATE & COUNTY: NEW YORK, Oneida

DATE RECEIVED: 6/22/00 DATE OF PENDING LIST: 7/03/00
DATE OF 16TH DAY: 7/19/00 DATE OF 45TH DAY: 8/06/00
DATE OF WEEKLY LIST:

REFERENCE NUMBER: 00000823

REASONS FOR REVIEW:

APPEAL: N DATA PROBLEM: N LANDSCAPE: N LESS THAN 50 YEARS: N
OTHER: N PDIL: N PERIOD: N PROGRAM UNAPPROVED: N
REQUEST: N SAMPLE: N SLR DRAFT: N NATIONAL: N

COMMENT WAIVER: N

ACCEPT RETURN REJECT 7/26/00 DATE

ABSTRACT/SUMMARY COMMENTS:

Entered in the
National Register

RECOM./CRITERIA _____

REVIEWER _____ DISCIPLINE _____

TELEPHONE _____ DATE _____

DOCUMENTATION see attached comments Y/N see attached SLR Y/N



MEMORIAL CHURCH OF THE HOLY CROSS
UTICA, ONEIDA CO. NY

T. OPALKA, 2000

NY STATE ARCHIVES → NY

SOUTH ELBURN, ILL. VIEW NE

PHOTO 1



MEMORIAL CHURCH OF THE HOLY ²CROSS

UTICA, ONEIDA CO. NY

R. SMITH, 1999

NBG @ NY SHPO, WATGARDEN NY

SOUTH (L.) & EAST ELEVATIONS,
VIEW N.

PHOTO 2



MEMORIAL CHURCH OF THE HOLY CROSS

UTICA, ONEIDA CO. NY

R. CARTER, 1999

NEB. @ NY SHPO, WATERFORD NY

WEST (L.) & SOUTH ELEVATIONS,
VIEW E.

PHOTO 3



MEMORIAL CHURCH OF THE HOLY CROSS

UTICA, ONEIDA CO. NY

R. SMITH, 1999

NEG @ NY SHPO, WATERFORD NY

DETAIL: NORTH ELEVATION, VIEW SE

PHOTO 4



5

MEMORIAL CHURCH OF THE HOLY CROSS

UTICA, ONEIDA CO. NY

20 054 NNNN --- 11MAY00 ELITE PHOTO

T. OPAKA, 2000

NE @ NY SH RD, WATERFORD NY

SANCTUARY, VIEW S.

PHOTO 5



MEMORIAL CHURCH OF THE HOLY CROSS

UTICA, ONEIDA CO. NY

16 054 NNNN --- 11MAY00 ELITE PHOTO

T. OJALKA, 2000

NEG@NY SHPO, WATENTON NY

SANCTUARY, VIEW N.

PHOTO 6



MEMORIAL CHURCH OF THE HOLY CROSS
UTICA, ONEIDA CO. N.Y.
18/482605/4771410

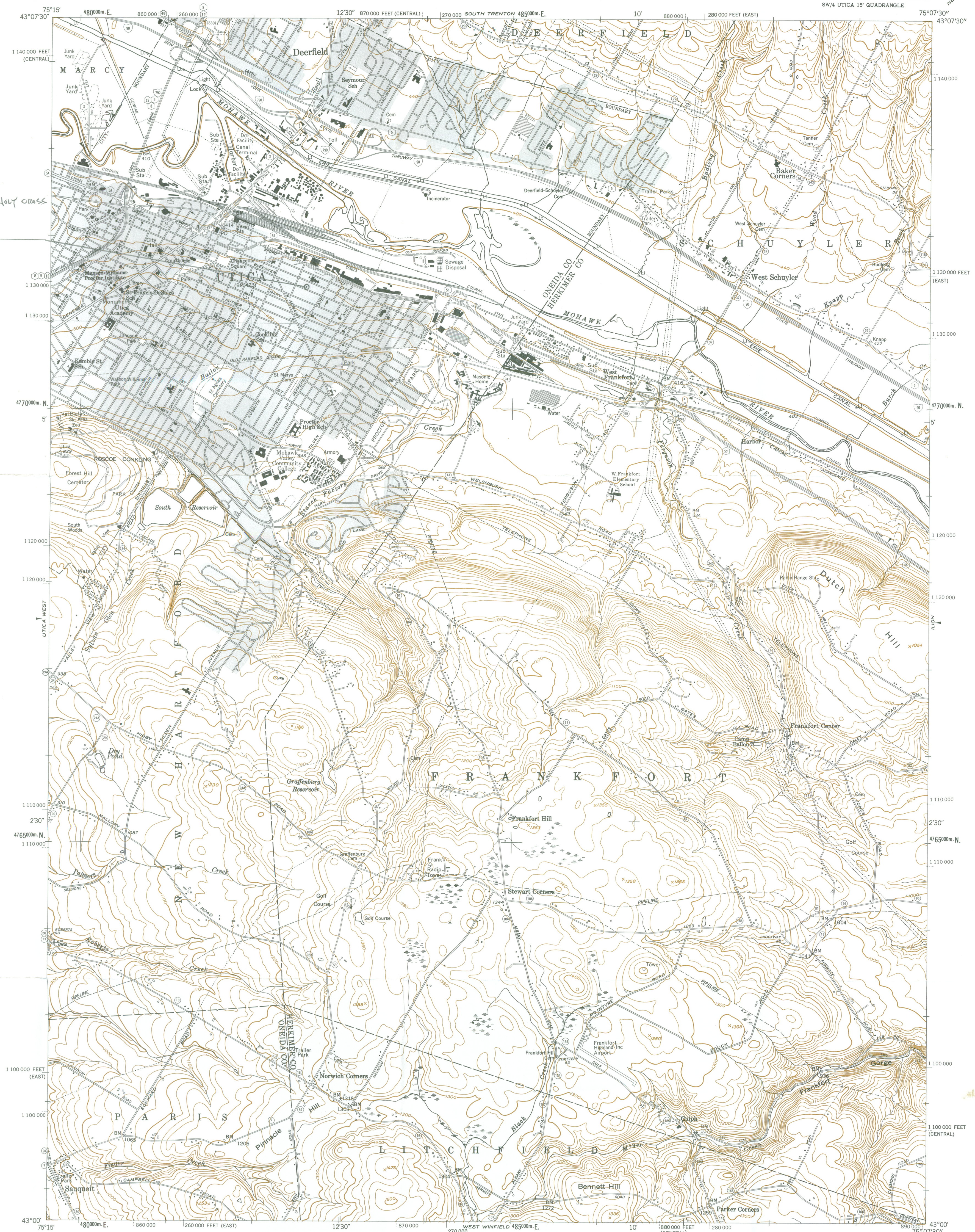

Prepared and published in 1978 by the New York State Department of Transportation, in cooperation with the U.S. Department of Transportation, Federal Highway Administration.

Map base from 1955 U.S. Geological Survey 7.5-minute quadrangle.

Map revisions made using 1977 aerial photography, construction plans, official records and other sources. Features revised include: highways and other transportation facilities; civil boundaries; recreation sites; hydrography; and buildings. Grey tint indicates intensively developed areas in which only landmark buildings are shown.

Revisions may not comply with National Map Accuracy Standards.

Correspondence concerning this and other maps of the Department of Transportation should be directed to: Map Information Unit, New York State Department of Transportation, State Campus, Albany, New York 12232.

1978 revisions by G. D. Schmidt



QUADRANGLE LOCATION



SCALE 1:24,000

1000-meter ticks based on the New York Transverse Mercator grid. Between 72° and 78° West Longitude, this grid is identical to Zone 18 of the Universal Transverse Mercator grid. Areas east of 72° and west of 78° are direct mathematical extensions of Zone 18.

10,000-foot ticks based on the New York Plane Coordinate grid, East Zone and Central Zone.

SPECIAL TOPOGRAPHIC EDITION
Contours, at 20-foot intervals, shown unrevised from 1955 U.S. Geological Survey map. Datum is mean sea level.

INDEX TO 1:9600 (1" = 800') MAP COVERAGE

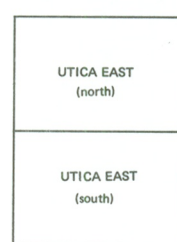

BOUNDARIES:

- State.....
- County.....
- Town or City.....
- Incorporated Village.....

ROADS:

- Touring Route markers:
 - Interstate..... (I)
 - U.S. (U.S.)
 - State..... (S)
- State Highway number and limit..... (SH)
- County road..... (CR)
- Interchange number..... (I)
- Divided highways and streets:
 - Wide mall.....
 - Narrow mall or barrier.....
- Undivided highways and streets:
 - 4 or more lanes.....
 - Less than 4 lanes.....
- Vehicle track; trail.....