

United States Department of the Interior  
National Park Service

National Register of Historic Places  
Registration Form

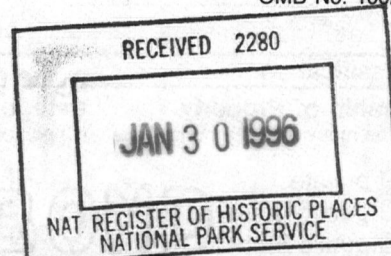

This form is for use in nominating or requesting determinations for individual properties and districts. See instructions in *How to Complete the National Register of Historic Places Registration Form* (National Register Bulletin 16A). Complete each item by marking "x" in the appropriate box or by entering the information requested. If an item does not apply to the property being documented, enter "N/A" for "not applicable." For functions, architectural classification, materials, and areas of significance, enter only categories and subcategories from the instructions. Place additional entries and narrative items on continuation sheets (NPS Form 10-900a). Use a typewriter, word processor, or computer, to complete all items.

1. Name of Property

historic name Goffstown Congregational Church

other names/site number N/A

2. Location

street & number 10 Main Street N/A  not for publication

city or town Goffstown N/A  vicinity

state New Hampshire code NH county Hillsborough code 011 zip code 03045

3. State/Federal Agency Certification

As the designated authority under the National Historic Preservation Act, as amended, I hereby certify that this  nomination  request for determination of eligibility meets the documentation standards for registering properties in the National Register of Historic Places and meets the procedural and professional requirements set forth in 36 CFR Part 60. In my opinion, the property  meets  does not meet the National Register criteria. I recommend that this property be considered significant  nationally  statewide  locally. ( See continuation sheet for additional comments.)

Nancy A. Muller 01/25/96  
Signature of certifying official/Title Date  
NEW HAMPSHIRE  
State of Federal agency and bureau

In my opinion, the property  meets  does not meet the National Register criteria. ( See continuation sheet for additional comments.)

\_\_\_\_\_  
Signature of certifying official/Title Date  
\_\_\_\_\_  
State or Federal agency and bureau

4. National Park Service Certification

I hereby certify that the property is:

- entered in the National Register.  
 See continuation sheet.
- determined eligible for the National Register  
 See continuation sheet.
- determined not eligible for the National Register.
- removed from the National Register.
- other, (explain): \_\_\_\_\_

Edson H. Beall  
Signature of the Keeper  
Entered in the National Register

3/1/96  
Date of Action

Goffstown Congregational Church  
Name of Property

Hillsborough, NH  
County and State

**5. Classification**

**Ownership of Property**  
(Check as many boxes as apply)

- private
- public-local
- public-State
- public-Federal

**Category of Property**  
(Check only one box)

- building(s)
- district
- site
- structure
- object

**Number of Resources within Property**  
(Do not include previously listed resources in the count.)

Contributing	Noncontributing	
1	0	buildings
0	0	sites
0	0	structures
0	0	objects
1	0	Total

**Name of related multiple property listing**  
(Enter "N/A" if property is not part of a multiple property listing.)

N/A

**Number of contributing resources previously listed in the National Register**

0

**6. Function or Use**

**Historic Functions**  
(Enter categories from instructions)

RELIGION: religious facility

**Current Functions**  
(Enter categories from instructions)

RELIGION: religious facility

**7. Description**

**Architectural Classification**  
(Enter categories from instructions)

Queen Anne

**Materials**  
(Enter categories from instructions)

foundation STONE: granite

walls WOOD: weatherboard

WOOD: shingle

roof STONE: slate

other

**Narrative Description**

(Describe the historic and current condition of the property on one or more continuation sheets.)

Entered in the  
National Register

United States Department of the Interior  
National Park Service

National Register of Historic Places  
Continuation Sheet

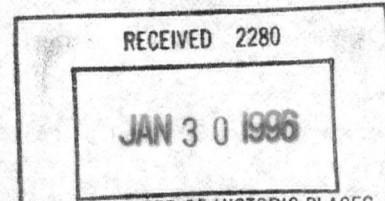

NATIONAL REGISTER OF HISTORIC PLACES  
Goffstown Congregational Church  
Goffstown (Hillsborough County)  
New Hampshire

Section number 7 Page 1

Located at the southwest corner of Main and Church Streets in Goffstown Village, the Goffstown Congregational Church is a clapboarded Queen Anne style structure with stickwork trim and wood shingle detailing. Resting on a granite foundation, the church is basically L-shaped in plan with an offset square tower at the southeast corner of the gablefront and a vestry building extending to the south. Although parts of the church building may date back to 1845, the appearance of the present structure is largely the result of alterations in the Queen Anne style made in 1890. The property is in excellent condition and retains a high degree of integrity for the period after it was remodeled in 1890. Limited later alterations including the construction of a handicapped ramp in the front of the structure do not seriously detract from the integrity of the structure.

Resting on a granite foundation, the Church is oriented with its gablefront facing Main Street and the main sanctuary oriented in a east-west direction fronting Church Street. A single story vestry section projects to the south giving the structure an L-shaped plan. The focal point of the church facade is the two story tower offset at the southeast corner of the gablefront sanctuary. Above a bracketed cornice, the tower is capped by a flared, elongated pyramidal roof sheathed in asphalt shingles. A steeply pitched gable wall dormer with a pointed arch opening decorated by turned trusswork and brackets punctuating the base of the roof on each side. Louvered openings decorated by sawtooth jigsaw trim punctuate the four sides of the belfry. Below the louvered section is a horizontal panel decorated by projecting moldings in a geometric design. Underneath this panel is a fishscale-shingled panel, outlined by applied stickwork. That on the front of the tower is decorated with knobs at the bottom corners. At the base of the tower is a doubledoor entrance with five raised horizontal and vertical panels. The doorway is sheltered by a gable doorhood with a simple truss supported by decorative braces. A matching entrance is located on the north side of the gable front, also fronted by granite steps with a wrought iron railing. Centered on the gablefront is a three part rectangular leaded glass window capped by a semicircular arch ending in decorative knobs. The semicircle is divided by horizontal and vertical lines into nine panels of various sizes, outlined by moldings raised panels with a central floral medallion. The projecting eaves of the gable are embellished by a decorative king post truss with pendants and brackets supporting filled-in cornice returns. With the exception of the front tower, the roof is sheathed in slate shingles.

The north elevation of the church measures five bays wide. With the exception of a single window closest to the facade, the openings contain double windows filled with colored leaded glass in geometric patterns. The windows are outlined by stickwork with slip lintels and fishscale shingles filling the space between the top of the windows and the horizontal band which spans over the windows. Four courses of clapboards fill the area between the stickwork and the plain frieze under the projecting eaves. A simple watertable and plain cornerboards outline the structure. The south side of the main sanctuary displays similar fenestration consisting of two pairs of windows with another pair punctuating the south side of the tower.

Projecting southward from the main body of the church is a somewhat lower hip roofed vestry building resting on a brick foundation which is faced with granite on the facade. A projecting gabled entrance porch faces the street with a modern paneled door with a modern globe light to the side. The rakeboard of the entrance is decorated by incised lines and the front of the entrance is sheathed in a combination of clapboards and wood shingles, separated by stickwork. Lighting the sides of the entrance porch are two fixed Queen Anne colored sash. Elsewhere, windows on the vestry consist of two part leaded glass windows divided into two vertical sections, as opposed to the three vertical sections capped by fishscale shingles

**United States Department of the Interior  
National Park Service**

**National Register of Historic Places  
Continuation Sheet**

Goffstown Congregational Church  
Goffstown (Hillsborough County)  
New Hampshire

Section number 7 Page 2

---

characterizing the windows lighting the main church sanctuary. A wooden handicapped ramp, constructed in the 1980s, extends in front of the ell. A brick chimney is located on the rear slope of the slate roof; a knob decorates the ridge of the roof.

The rear elevation of the main sanctuary displays a gabled profile with a shorter projecting gabled section on a granite foundation centered on the elevation. The side elevations of the projection are punctuated by long doublehung 1/1 windows with Queen Anne sash and fishscale shingles above. The front of the projection features a 1/1 window at the top framed by a plain cornerboard and frieze with an applied raking displaying rounded edges. To the north of the gable is a single 1/1 window while a single 6/6 window with entablature lintel lights the attic, apparently a solitary surviving element from the original 1845 period of construction. Two-light basement windows punctuate the granite foundation.

The rear elevation of the addition displays two sets of 1/1 Queen Anne sash with colored glass. The simple lintels extend to the frieze which is outlined by bold moldings. The lower section of the wall, adjacent to the main sanctuary's granite foundation, has been sheathed in vinyl siding and is lit by 3/3 and 2/2 windows. Projecting from the rear elevation is a gabled basement entrance, accessed by a modern door.

The south side of the vestry is lit by three pairs of Queen Anne 1/1 sash with colored lights. The foundation on this elevation is brick, laid in a stretcher bond alternating seven courses of stretchers to a single row of headers with a row of rowlock brick on top.

Inside, the church is dominated by the beauty of the leaded glass windows, outlined by cornerblock moldings. The sanctuary still retains the curvilinear oak pews purchased for the building in 1890. The chandeliers have given way to glass light fixtures suspended on chains. A modern accordion door separates the sanctuary and vestry. The walls and ceilings are painted white and are without ornament. In 1981 a new organ case was installed over the organ pipes at the front of the sanctuary. The antique, wooden case came from the Dedham, Massachusetts Unitarian Church where it was installed in 1857 by E & G Hook of Boston.

As originally constructed, the contrasting materials and detailing of the church building was enhanced by a polychromatic paint scheme. The exterior of the building is presently painted white, as it has been for much of the 20th century. The church building is surrounded on all but the rear elevation by a level, grassy lawn crossed by a number of concrete sidewalks leading from the church entrances and vestry to the front sidewalk and rear parking lot. Granite curbing runs along the edge of the property on Main Street and Church Street. A signboard is located to the southeast of the vestry. Some small evergreen shrubs are located in front of the church, along the handicapped ramp and by the signboard. The shrubbery in front of the memorial windows was planted in 1958. At the rear of the building is a paved parking area.

**8. Statement of Significance**

**Applicable National Register Criteria**

(Mark "x" in one or more boxes for the criteria qualifying the property for National Register listing.)

- A** Property is associated with events that have made a significant contribution to the broad patterns of our history.
- B** Property is associated with the lives of persons significant in our past.
- C** Property embodies the distinctive characteristics of a type, period, or method of construction or represents the work of a master, or possesses high artistic values, or represents a significant and distinguishable entity whose components lack individual distinction.
- D** Property has yielded, or is likely to yield, information important in prehistory or history.

**Criteria Considerations**

(Mark "x" in all the boxes that apply.)

Property is:

- A** owned by a religious institution or used for religious purposes.
- B** removed from its original location.
- C** a birthplace or grave.
- D** a cemetery.
- E** a reconstructed building, object, or structure.
- F** a commemorative property.
- G** less than 50 years of age or achieved significance within the past 50 years.

**Areas of Significance**

(Enter categories from instructions)

ARCHITECTURE

**Period of Significance**

1890

**Significant Dates**

1890

**Significant Person**

(Complete if Criterion B is marked above)

N/A

**Cultural Affiliation**

N/A

**Architect/Builder**

William M. Butterfield, architect

**Narrative Statement of Significance**

(Explain the significance of the property on one or more continuation sheets.)

**9. Major Bibliographical References**

**Bibliography**

(Cite the books, articles, and other sources used in preparing this form on one or more continuation sheets.)

**Previous documentation on file (NPS):**

- preliminary determination of individual listing (36 CFR 67) has been requested
- previously listed in the National Register
- previously determined eligible by the National Register
- designated a National Historic Landmark
- recorded by Historic American Buildings Survey # \_\_\_\_\_
- recorded by Historic American Engineering Record # \_\_\_\_\_

**Primary location of additional data:**

- State Historic Preservation Office
- Other State agency
- Federal agency
- Local government
- University
- Other

Name of repository:

Goffstown Congregational Church

Goffstown Congregational Church  
Name of Property

Hillsborough, NH  
County and State

## 10. Geographical Data

Acreeage of Property less than one acre

### UTM References

(Place additional UTM references on a continuation sheet.)

1 

1	9	2	8	8	0	7	0	4	7	6	6	0	5	0
Zone	Easting				Northing									

3 

Zone	Easting				Northing									

4 

Zone	Easting				Northing									

See continuation sheet

### Verbal Boundary Description

(Describe the boundaries of the property on a continuation sheet.)

### Boundary Justification

(Explain why the boundaries were selected on a continuation sheet.)

## 11. Form Prepared By

name/title Lisa B. Mausolf, Historic Preservation Consultant

organization for the Goffstown Historic District Commission date September 1995

street & number 20 Terrace Park telephone (617) 942-2173

city or town Reading state MA zip code 01867

### Additional Documentation

Submit the following items with the completed form:

#### Continuation Sheets

#### Maps

A **USGS map** (7.5 or 15 minute series) indicating the property's location.

A **Sketch map** for historic districts and properties having large acreage or numerous resources.

#### Photographs

Representative **black and white photographs** of the property.

#### Additional items

(Check with the SHPO or FPO for any additional items)

### Property Owner

(Complete this item at the request of SHPO or FPO.)

name Goffstown Congregational Church

street & number 10 Main Street

telephone \_\_\_\_\_

city or town Goffstown

state NH

zip code 03045

**Paperwork Reduction Act Statement:** This information is being collected for applications to the National Register of Historic Places to nominate properties for listing or determine eligibility for listing, to list properties, and to amend existing listings. Response to this request is required to obtain a benefit in accordance with the National Historic Preservation Act, as amended (16 U.S.C. 470 *et seq.*).

**Estimated Burden Statement:** Public reporting burden for this form is estimated to average 18.1 hours per response including time for reviewing instructions, gathering and maintaining data, and completing and reviewing the form. Direct comments regarding this burden estimate or any aspect of this form to the Chief, Administrative Services Division, National Park Service, P.O. Box 37127, Washington, DC 20013-7127; and the Office of Management and Budget, Paperwork Reductions Projects (1024-0018), Washington, DC 20503.

**United States Department of the Interior  
National Park Service****National Register of Historic Places  
Continuation Sheet**Goffstown Congregational Church  
Goffstown (Hillsborough County)  
New HampshireSection number 8 Page 1

The Goffstown Congregational Church, rebuilt in 1890, is an excellent example of Queen Anne style architecture. The church meets National Register Criterion C in the area of Architecture as one of the best local examples of the Queen Anne Style. It was constructed according to the design of prominent turn-of-the-century New Hampshire architect, William M. Butterfield.

Typical of the Queen Anne style, the Goffstown Congregational Church displays an asymmetrical massing and a variety of building materials including the use of clapboards, wood shingles and decorative stickwork. Other decorative elements which are typical of the style include decorative braces and trusses, Queen Anne sash, and roof knobs. The church is considered the best local example of the Queen Anne style and was constructed according to the design of Manchester architect, William Butterfield. Other local examples of the Queen Anne style include the Grasmere Schoolhouse #9 and Town Hall (listed on the National Register 9/15/1990). Another Queen Anne style structure, the Goffstown Town Hall, built south of the Congregational Church in 1889, also designed by William Butterfield, was a fitting companion for the Church until it was destroyed by fire in 1937.

The history of the Congregational Church in Goffstown dates back to 1768 when a meeting house was constructed in Grasmere on land donated by Capt. James Karr. The meeting house was used jointly by the town and the church for about 70 years. In 1816 a second meeting house was erected on South Mast Street, near Prospect Street. The present Congregational Church is the congregation's fourth edifice. As originally constructed in 1845 at a cost of \$2500, the structure was Greek Revival in style, the gablefront displaying a portico of four colossal Doric columns and capped by a two stage domed tower, with a bell added about 1855. The building was subsequently enlarged in 1869 with the addition of twenty pews which added a distance of five pews to the length of the church. Additional alterations were made to the church in 1882 at which time the gallery and singing seats were cut down, new windows were installed, the stoves were placed under the floor and the ceilings were replastered.

The church achieved its present appearance in 1890 when it was substantially rebuilt and remodeled in the Queen Anne style. The initial impetus for the remodeling was a proposed gift of a new organ by Miss Mary Hadley which necessitated interior alterations. In addition, the existing seats were a source of complaint, more seating was desired and church members were apparently no longer pleased with the church's appearance. At a meeting of the church held on June 7, 1890 it was voted to remodel the church at a cost not to exceed \$4500. A building committee consisting of John M. Parker, Kendrick Kendall, L.H. Stark, and Edwin Blaisdell was elected at that time. According to remarks made at the dedication of the church on February 11, 1891, "Kendrick Kendall devised and drew a plan and through the assistance of Mr. William M. Butterfield, an architect of Manchester, procured a drawing of the front elevation and general outline of the necessary changes". Kendrick Kendall was a partner of Kendall, Hadley & Co., a local manufactory of sash, blinds and window frames. Records show that William M. Butterfield was paid \$80 for his drawings while the contractor, William U. Carlton of Goffstown, received \$3,000. Funds were raised by public subscription and by the sale of the vestry on Church Street (presently the Stark Building).

Following the 1890 renovations, the church building retained little of its 1845 form other than the gablefront orientation to Main Street. As described by the president of the day at the dedication, "Our plain and uninviting house of worship has been transformed with this new beautiful and convenient structure". The alterations included a new roof and higher

United States Department of the Interior  
National Park ServiceNational Register of Historic Places  
Continuation SheetGoffstown Congregational Church  
Goffstown (Hillsborough County)  
New HampshireSection number 8 Page 2

elevation, the removal of the old tower and the building of a new fifteen foot square tower at the southeast corner and a vestibule at the northeast corner. Inside, the choir gallery was removed from the rear of the sanctuary and an arched organ loft and place for the choir was constructed in the front of the sanctuary. The pulpit itself was removed and replaced with a desk, purchased from the Charles A. Hoitt Company. New pews were purchased from the Grand Rapids School Furniture Company and new chandeliers were installed. Sullivan and Dunbar of Manchester were responsible for frescoes, which were paid for by the Ladies' Social Circle. The organ which Mary Hadley donated in honor of her brother, Alvin Hadley, was purchased from G.S. Hutchins of Boston. The new leaded glass memorial windows were made by Redding, Baird (?) & Co. of Boston. The front windows, representing the parable of the sower, were the gift of Mrs. Mary A. Stinson, in memory of her husband, Capt. Charles Stinson. The first window on the north side was the gift of Mrs. Jones of Minneapolis in memory of her former husband Mr. G. B. Morse. The second window was the gift of Mrs. Frank Hadley in memory of her parents, Luther and Mary Hadley. The third was donated by Mrs. Mary Hadley and daughter Mrs. Henry Bowell of San Diego, and Miss Edith Hadley in memory of Mr. Henry Hadley. The fourth is the gift of John Parker in honor of his parents. The first window on the south side is in memory of Robert and Sophia Shirley and the next was the gift of Kendrick Kendall and L.H. Shirt. One of the two memorial windows in the vestry was the gift of the Young Peoples' Christian Endeavor Society; the other by the Kings' Daughters.

At the same time that the church was altered, an addition measuring 45 x 33 feet was built on the southwest end of the church building, containing a vestry, ladies' parlor and pastor's room, with a kitchen and dining room in the basement. The vestry room, measuring 28 x 33 feet, connected with the "audience room" of the church by means of sliding doors and windows. The church sanctuary or "audience room" contained 86 pews with a seating capacity of 430 while the adjacent vestry seating capacity of 170 gave the church a total seating capacity of 600 persons. The interior of the sanctuary remained substantially unchanged until 1958 when it was remodeled. At this time the accordion sliding door was installed between the sanctuary and vestry to replace the four triple-hung windows that were constructed in 1890. The interior was painted and a new pipe organ was also installed in front of the choir with a maroon tapestry covering the pipes and rooms on either side of the enlarged choir loft built.

The architect of the church, William M. Butterfield (1860-1932), was a prominent New Hampshire architect practicing at the turn of the century. Born in Sidney, Maine, he came to Manchester in 1881 and by 1895 had designed 500 buildings in New England. At one time, during the height of his career, Butterfield had 30 buildings designed by himself under construction. Butterfield's commissions included a wide variety of building types, including schools, churches, public buildings, commercial blocks and residences. Among the church buildings he designed are St. Paul's Church in Manchester (1882; no longer extant); the People's Methodist Episcopal Church Chapel on Penacook Street in Manchester (1882); the Swedish Evangelical Lutheran Church at Pine and Sagamore Streets in Manchester (1886) and the Globe Congregational Church in Woonsocket, Rhode Island (1900). In addition to the Goffstown Town Hall, Butterfield also designed the Hollis Town Hall (1886), the Hillsborough County Buildings in Grasmere (1894) and the Stone Memorial Building in Weare (1896). Butterfield was a member of the Franklin Street Congregational Church in Manchester.

United States Department of the Interior  
National Park Service

National Register of Historic Places  
Continuation Sheet

Goffstown Congregational Church  
Goffstown (Hillsborough County)  
New Hampshire

Section number 9 Page 1

---

**BIBLIOGRAPHY and/or REFERENCES:**

Goffstown Congregational Church records.

Goffstown Historical Society, Photographic Collection.

Goffstown, New Hampshire Bicentennial 1761-1961. Town of Goffstown, 1961.

Hadley, George Plummer. History of the Town of Goffstown 1733-1920. Concord: Rumford Press, 1922., 2 vols.

“Heritage Quilt: Goffstown Bicentennial, 1776-1976”, 1976.

Manchester Historic Association. File information on William Butterfield.

Mausolf, Lisa. Unpublished notes on William Butterfield.

Sanborn Insurance Maps, Town of Goffstown, 1892, 1898, 1912, 1921. [Microfilm collection, NH Historical Society, Concord, NH].

Shirley, Moses Gage, “The Town of Goffstown”, Granite Monthly, vol. XXIV, May 1898, pp. 249-282.

Town and County Atlas of the State of New Hampshire. Boston: D.H. Hurd & Co., 1892.

The Union, July 7, 1932 [obituary of William Butterfield].

**United States Department of the Interior  
National Park Service**

**National Register of Historic Places  
Continuation Sheet**

Goffstown Congregational Church  
Goffstown (Hillsborough County)  
New Hampshire

Section number 10 Page 1

---

**VERBAL BOUNDARY DESCRIPTION**

The nominated property occupies Map 34/85 in the local assessors' records.

**BOUNDARY JUSTIFICATION**

The boundary of the nominated property is drawn to include that acreage which survives from the original parcel and which is eligible for listing on the National Register of Historic Places.

1983

United States Department of the Interior  
National Park Service

National Register of Historic Places  
Continuation Sheet

Goffstown Congregational Church  
Goffstown (Hillsborough County)  
New Hampshire

Section number \_\_\_\_\_ Page \_\_\_\_\_ Additional Documentation (Sketch Map)

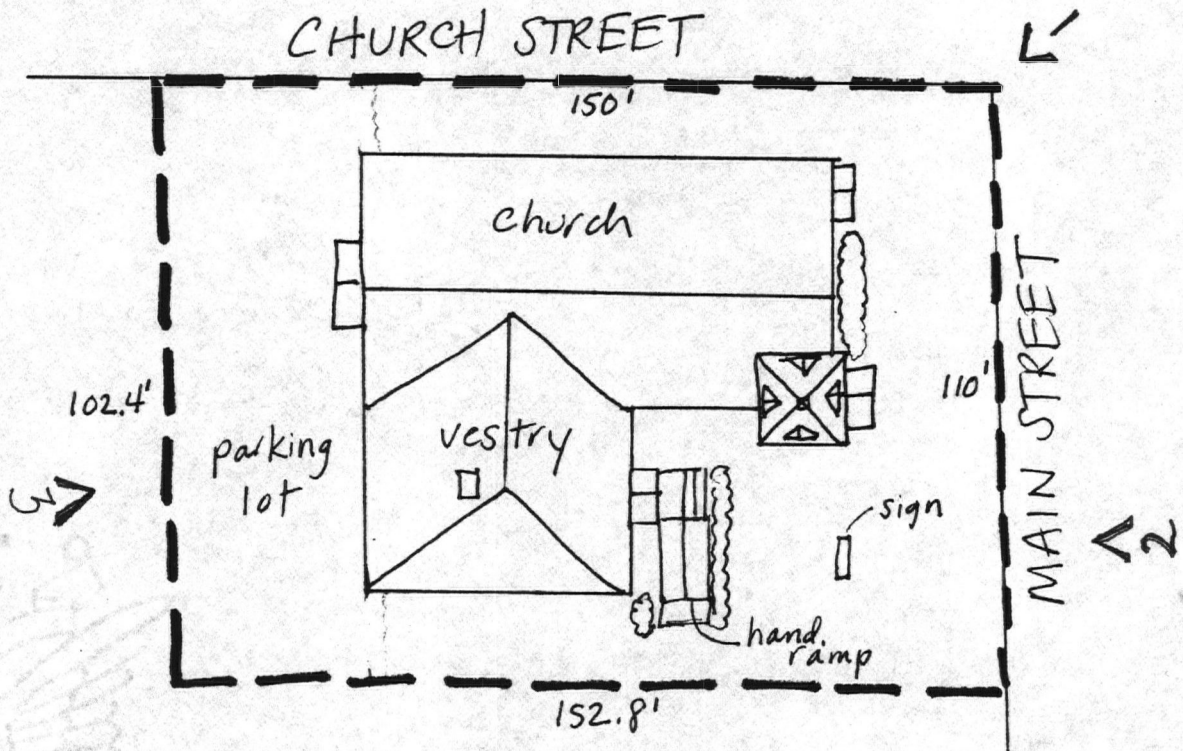

GOFFSTOWN CONGREGATIONAL CHURCH  
GOFFSTOWN, NEW HAMPSHIRE

APPROX. SCALE 1" = 35'

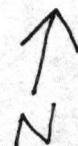

— Property boundary

UNITED STATES DEPARTMENT OF THE INTERIOR  
NATIONAL PARK SERVICE

NATIONAL REGISTER OF HISTORIC PLACES  
EVALUATION/RETURN SHEET

REQUESTED ACTION: NOMINATION

PROPERTY NAME: Goffstown Congregational Church

MULTIPLE NAME:

STATE & COUNTY: NEW HAMPSHIRE, Hillsborough

DATE RECEIVED: 1/30/96 DATE OF PENDING LIST: 2/14/96  
DATE OF 16TH DAY: 3/01/96 DATE OF 45TH DAY: 3/15/96  
DATE OF WEEKLY LIST:

REFERENCE NUMBER: 96000193

NOMINATOR: STATE

REASONS FOR REVIEW:

APPEAL: N DATA PROBLEM: N LANDSCAPE: N LESS THAN 50 YEARS: N  
OTHER: N PDIL: N PERIOD: N PROGRAM UNAPPROVED: N  
REQUEST: N SAMPLE: N SLR DRAFT: N NATIONAL: N

COMMENT WAIVER: N

ACCEPT  RETURN  REJECT 3/1/96 DATE

ABSTRACT/SUMMARY COMMENTS:

Entered in the  
National Register

RECOM./CRITERIA \_\_\_\_\_

REVIEWER \_\_\_\_\_ DISCIPLINE \_\_\_\_\_

TELEPHONE \_\_\_\_\_ DATE \_\_\_\_\_

DOCUMENTATION see attached comments Y/N see attached SLR Y/N



Goffstown Congregational Church

10 Main Street

Goffstown, NH

August 1995

Lisa Mausolf, Photographer

Negatives: Goffstown Hist. Dist. Comm.

View looking SW at east facade + north elevation

#1



Goffstown Congregational Church

10 Main Street

Goffstown, NH

August 1995

Lisa Mausolf, Photographer

Negatives: Goffstown Hist. Dist. Comm.

View looking NW at east facade + south elevation

#2



Goffstown Congregational Church

10 Main Street

Goffstown, NH

August 1995

Lisa Mausolf, Photographer

Negatives: Goffstown Hist. Dist Comm.

View looking east at rear (west) elevation

#3

670 II NW  
(SUNCOON)

6670 II SW  
(HOPKINTON)



Goffstown Congregational Church  
10 Main Street  
Goffstown, NH  
219 E288070 N4766050

Mapped, edited, and published by the Geological Survey  
Control by USGS, NOS/NOAA, and New Hampshire Geodetic Survey  
Topography by photogrammetric methods from aerial photographs  
taken 1965. Field checked 1969  
Polyconic projection. 10,000-foot grid ticks based on New Hampshire  
coordinate system  
1000-meter Universal Transverse Mercator grid ticks,  
zone 19, shown in blue  
1927 North American Datum  
To place on the predicted North American Datum 1983  
move the projection lines 5 meters south and  
40 meters west as shown by dashed corner ticks  
Fine red dashed lines indicate selected fence and field lines where  
generally visible on aerial photographs. This information is unchecked

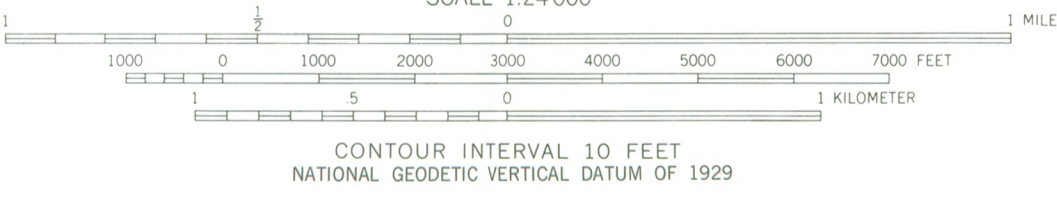
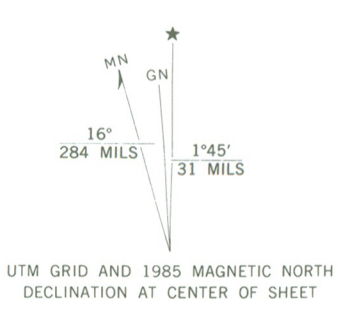

ROAD CLASSIFICATION

Primary highway, all weather, hard surface	Light-duty road, all weather, improved surface
Secondary highway, all weather, hard surface	Unimproved road, fair or dry weather
State Route	

THIS MAP COMPLIES WITH NATIONAL MAP ACCURACY STANDARDS  
FOR SALE BY U. S. GEOLOGICAL SURVEY  
DENVER, COLORADO 80225, OR RESTON, VIRGINIA 22092  
A FOLDER DESCRIBING TOPOGRAPHIC MAPS AND SYMBOLS IS AVAILABLE ON REQUEST

Revisions shown in purple and woodland compiled  
from aerial photographs taken 1982 and other sources  
This information not field checked. Map edited 1985

GOFFSTOWN, N. H.  
SE/4 CONCORD 15' QUADRANGLE  
43071-A5-TF-024  
1969  
PHOTOREVISED 1985  
DMA 6670 II SE - SERIES V812

NEW BOSTON  
6669 I NW

MANCHESTER SOUTH  
670 III SW

OCT 6 1995



# Town of Goffstown

BOARD OF SELECTMEN

September 18, 1995

Ms. Christine Fonda  
National Register Coordinator  
NH Div. of Historical Resources  
PO Box 2043  
Concord, NH 03302-2043

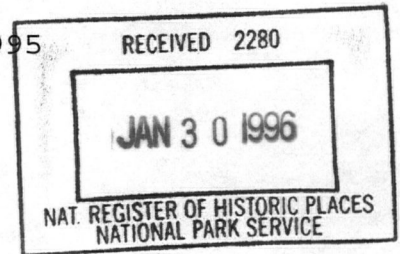

Dear Ms. Fonda:

The Goffstown Board of Selectmen recommends the nomination of the Congregational Church in Goffstown to be placed on the National Historic Register. Much of the building dates from 1891, with some of the building dating to 1845. It is the Queen Anne style on a granite foundation.

This stately building is one of the recognizable landmarks distinctive to Goffstown. It is clearly historic. Last year the Selectmen placed a photograph of the church on the Annual Town Report cover. We are very pleased that it is being considered for the Register. It is our hope that you will support the addition of this building to the Register, which continues to house many valuable services in the community.

Sincerely,  
Board of Selectmen

*Philip D'Avanza*  
Chairman,

Philip D'Avanza

*Henry Boyle*  
Selectman,

Henry Boyle

*John Davis*  
Selectman,

John Davis

*Barbara J. Griffin*  
Selectman,

Barbara J. Griffin

*Robert Wheeler*  
Selectman,

Robert Wheeler

OCT 6 1995

CERTIFIED LOCAL GOVERNMENT NATIONAL REGISTER REVIEW SHEET

Name of CLG: Goffstown Historic District Commission

Name of Nominated Property: Congregational Church

Street Address: Main Street #10

Town/City: Goffstown

Owner: Congregational Church

Owner Address: 10 Main St  
Goffstown, NH 03045

EVALUATION: (Refer to attached National Register Criteria listing)

Applicable National Register Criteria: (specify area of significance)

- A.)  It is of historic interest as 1 of 2 churches of the 19th Century
- B.) \_\_\_\_\_
- C.)  The structure retains high degree of integrity for the period it was <sup>re-</sup>modeled in 1891
- D.) \_\_\_\_\_

Applicable Criteria Considerations (Exceptions):

- A.) \_\_\_\_\_
- B.) \_\_\_\_\_
- C.) \_\_\_\_\_
- D.) \_\_\_\_\_
- E.) \_\_\_\_\_
- F.) \_\_\_\_\_
- G.) \_\_\_\_\_

Possesses Sufficient Integrity: YES  NO

Additional Comments: The Congregational Church retains a high degree of integrity for the period it was remodeled in 1891. A good example of Queen Anne style displays a number of distinctive characteristics of the style including contrasting materials including clapboards, stickwork, wood shingles, asymmetrical massing, decorative braces and truss work with roof knobs. This is the only present Queen Anne Style downtown.

[Signature]  
Signature of CLG Representative

19 Sept 95  
Date

OCT 6 1995

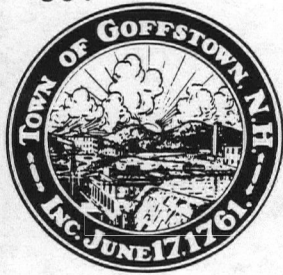

**TOWN OF GOFFSTOWN**  
*Goffstown Historic District Commission*

Post Office Box 461  
Goffstown, New Hampshire 03045



29 September 1995

Ms. Christine Fonda  
National Register Co-ordinator  
NH Div. of Historical Resources  
P.O. Box 2043

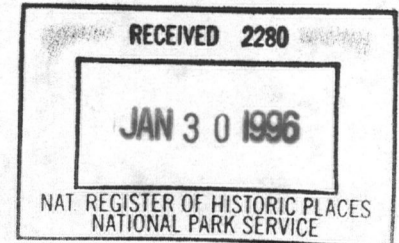

Dear Ms. Fonda,

It is with great pride and pleasure that we, the Goffstown Historic District Commission, bring forth the Goffstown Congregational Church as the second nomination to the National Register of Historic Places.

As you know, this nomination has been part of our CLG project this year.

The Congregational Church has long been a landmark of Goffstown's Main Street dating back as far as 1845. It seems appropriate that in 1995, one hundred and fifty years later, it attains National Register status.

Please do not hesitate to call me if you have any question regarding this nomination.

Sincerely,

Brenda Henk  
Goffstown HDC Treasurer/CLG co-ordinator



NEW HAMPSHIRE DIVISION OF HISTORICAL RESOURCES

State of New Hampshire, Department of Cultural Affairs  
19 Pillsbury Street, Box 2043, Concord, NH 03302-2043

603-271-3483  
603-271-3558

FAX 603-271-3433 Voice/TDD RELAY ACCESS 1-800-735-2964

January 25, 1996

Carol D. Shull  
Chief of Registration  
Keeper of the National Register  
National Register of Historic Places  
Department of the Interior  
National Park Service  
Washington, D.C. 20240

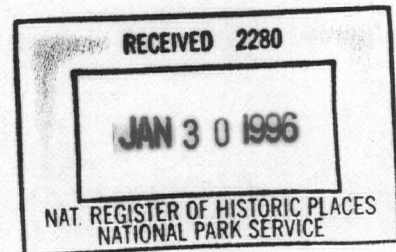

Dear Ms. Shull:

As New Hampshire State Historic Preservation Officer, I am pleased to nominate the following properties to the National Register of Historic Places:

- ✓ Goffstown Congregational Church, Goffstown NH
- Peterborough Town House, Peterborough NH

The National Register Inventory-Nomination forms have been reviewed and approved by the New Hampshire State Historical Resources Council. The owners and officials have been notified and any comments received are enclosed.

In cases where photographs were taken more than six months ago, it has been noted that the appearance has not changed.

Sincerely,

Nancy C. Muller, Director  
NH State Historic Preservation Officer

NCM:dmf

cc: Goffstown Congregational Church  
Lisa Mausolf  
Town of Peterborough  
Craig Hicks