

United States Department of the Interior
National Park Service

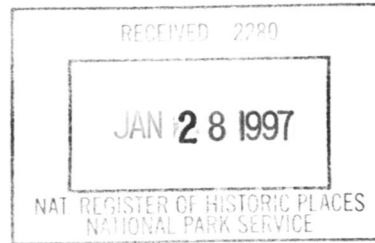

National Register of Historic Places
Registration Form

This form is for use in nominating or requesting determinations for individual properties and districts. See instructions in *How to Complete the National Register of Historic Places Registration Form* (National Register Bulletin 16A). Complete each item by marking "X" in the appropriate box or by entering the information requested. If an item does not apply to the property being documented, enter "N/A" for "not applicable." For functions, architectural classification, materials, and areas of significance, enter only categories and subcategories from the instructions. Place additional entries and narrative items on continuation sheets (Form 10-900-a). Use a typewriter, word processor, or computer, to complete all items.

1. Name of Property

Historic name: Grace City Bridge

Other names/site number: James River Bridge; 32F013

2. Location

Street & number: unnamed county road not for publication

City or town: Grace City vicinity

State: North Dakota Code: ND County: Foster Code: 031 Zip code: 58445

3. State/Federal Agency Certification

As the designated authority under the National Historic Preservation Act of 1966, as amended, I hereby certify that this nomination request for determination of eligibility meets the documentation standards for registering properties in the National Register of Historic Places and meets the procedural and professional requirements set forth in 36 CFR Part 60. In my opinion, the property meets does not meet the National Register criteria. I recommend that this property be considered significant nationally statewide locally. (See continuation sheet for additional comments.)

James E. Sperry January 8, 1997
Signature and title of certifying official James E. Sperry Date
State Historic Preservation Officer (North Dakota)

In my opinion, the property meets does not meet the National Register criteria. (See continuation sheet for additional comments.)

Signature of the Keeper Date of Action

4. National Park Service Certification

I hereby certify that the property is:

- entered in the National Register See continuation sheet.
- determined eligible for the National Register See continuation sheet.
- determined not eligible for the National Register.
- removed from the National Register.
- other, (explain:)

Edson H. Beall Signature of the Keeper Date of Action 2/27/97

Grace City Bridge
Name of Property

Foster, North Dakota
County and State

5. Classification

Ownership of Property
(Check as many boxes as apply)

- private
- public - local
- public - State
- public - Federal

Category of Property
(Check only one box)

- building(s)
- district
- site
- structure
- object

Number of Resources within Property
(Do not include previously listed resources in the count.)

Contributing	Noncontributing	
_____	_____	buildings
_____	_____	sites
<u>1</u>	_____	structures
_____	_____	objects
<u>1</u>	_____	Total

Name of related multiple property listing
(Enter "N/A" if property is not part of a multiple property listing.)

Historic Roadway Bridges of N.D.

Number of contributing resources previously listed in the National Register

0

6. Function or Use

Historic Functions
(Enter categories from instructions)

TRANSPORTATION: Road-related

Current Functions
(Enter categories from instructions.)

TRANSPORTATION: Road-related

7. Description

Architectural Classification
(Enter categories from instructions)

OTHER: Pratt through truss bridge

Materials
(Enter categories from instructions.)

foundation concrete
walls _____
roof _____
other steel

Narrative Description

(Describe the historic and current condition of the property on one or more continuation sheets.)

United States Department of the Interior
National Park Service

National Register of Historic Places
Continuation Sheet

Section number 7 Page 1

GRACE CITY BRIDGE
FOSTER COUNTY, NORTH DAKOTA

Narrative Description:

The Grace City Bridge is located on an unpaved county road in rural Foster County, North Dakota. The site is located approximately one mile west and one mile south of Grace City. The bridge, constructed on an east-west axis, carries a gravel "section-line" road through an isolated and lightly-settled portion of the county. The surrounding land is generally subject to intensive cultivation, although some grazing land is also present. The bridge crosses the Sheyenne River, the largest watercourse in the county. Here, the river runs in an approximate north-south direction through a pronounced draw. The road leading up to the bridge is lightly used, leading only to a single farmstead about one-half mile west of the bridge.

The bridge itself is a pin-connected Pratt through truss, with a steel superstructure. The Pratt design, which saw widespread use nationally and in North Dakota during the late nineteenth and early twentieth centuries, is characterized by the presence of relatively-heavy vertical members designed to handle the compressive stress of a bridge load. The use of pinned rather than riveted connections in a bridge built as late as this one is unusual. The bridge contains a single truss span, six panels in length; there are no approach spans. Overall, the bridge is approximately 101 feet long, with a vehicle deck 18 feet wide.

Design details of the bridge's substructure and superstructure are outlined below:

Substructure: reinforced concrete abutments, with substantial wing walls at both ends

Superstructure:

upper chords: two channel sections with continuous cover plate along the upper flanges

lower chords: paired punched eyebars

verticals: two channel sections with lacing bars along both sets of flanges, for the 3 center verticals; two angle sections with batten plates, for the 2 hip verticals

diagonals: paired punched eyebars

counters: eyebars

bracing (portal): paired angle sections

bracing (sway): angle sections with lacing bars

laterals (top): round rods

laterals (bottom): round rods

moveable end: rollers

floor system: I-beam stringers, resting on I-beam floor beams, bolted to the superstructure

United States Department of the Interior
National Park Service

National Register of Historic Places Continuation Sheet

Section number 7 Page 2

GRACE CITY BRIDGE
FOSTER COUNTY, NORTH DAKOTA

decking: concrete, with concrete curb
railing: angle sections; railings on wing walls, too
steelmaker's marks: Illinois Steel Co. (U.S. Steel), South Chicago or
Gary

A metal plaque mounted on the bridge's end chord displays the following lettering: "FARGO BRIDGE / & / IRON CO. / 1925."

The bridge retains a very high level of integrity; it remains in its original location, and all major structural components appear to retain their as-built appearance.

The Grace City Bridge is owned and maintained by Eddy County. It carries the state numerical designation 16-121-03.0.

Grace City Bridge

Name of Property

Foster, North Dakota

County and State

8. Statement of Significance

Applicable National Register Criteria

(Mark "x" in one or more boxes for the criteria qualifying the property for National Register listing.)

- A** Property is associated with events that have made a significant contribution to the broad patterns of our history.
- B** Property is associated with the lives of persons significant in our past.
- C** Property embodies the distinctive characteristics of a type, period, or method of construction or represents the work of a master, or possesses high artistic values, or represents a significant and distinguishable entity whose components lack individual distinction.
- D** Property has yielded, or is likely to yield, information important in prehistory or history.

Criteria Considerations

(Mark "x" in all the boxes that apply.)

Property is:

- A** owned by a religious institution or used for religious purposes.
- B** removed from its original location.
- C** a birthplace or grave.
- D** a cemetery.
- E** a reconstructed building, object, or structure.
- F** a commemorative property.
- G** less than 50 years of age or achieved significance within the past 50 years.

Narrative Statement of Significance

(Explain the significance of the property on one or more continuation sheets.)

9. Major Bibliographical References

Bibliography

(Cite the books, articles, and other sources used in preparing this form on one or more continuation sheets.)

Previous documentation on file (NPS):

- preliminary determination of individual listing (36 CFR 67) has been requested
- previously listed in the National Register
- previously determined eligible by the National Register
- designated a National Historic Landmark
- recorded by Historic American Buildings Survey Name of repository: # _____
- recorded by Historic American Engineering Record # _____

Areas of Significance

(Enter categories from instructions)

TRANSPORTATION

ENGINEERING

Period of Significance

1925-1946

Significant Dates

1925

Significant Person

(Complete if Criterion B is marked above)

N/A

Cultural Affiliation

N/A

Architect/Builder

Builder: Fargo Bridge & Iron Co.

Primary location of additional data:

- State Historic Preservation Office
- Other State agency
- Federal agency
- Local government
- University
- Other

United States Department of the Interior
National Park Service

National Register of Historic Places Continuation Sheet

Section number 8 Page 3

GRACE CITY BRIDGE
FOSTER COUNTY, NORTH DAKOTA

Narrative Statement of Significance:

In accordance with the guidelines established in the Multiple Property Documentation form for "Historic Roadway Bridges in North Dakota," the Grace City Bridge is eligible for listing in the National Register of Historic Places with local significance under Criteria "A" and "C." The bridge is significant under Criterion A for its association with attempts by North Dakota counties to expand and improve transportation networks prior to 1926 by construction of through truss bridges, relatively costly structures. Through truss bridges with documented construction dates and builders, such as this one, best illustrate this important trend in North Dakota bridge construction. The bridge is eligible under Criterion "C" as a well-preserved, representative example of the Pratt through-truss type, which was the primary structural form for long-span bridges in North Dakota during the late nineteenth and early twentieth centuries.

Historical information: The bridge located at this site as of early 1925 was in poor condition. In late spring of that year, the county commissioners visited the site and declared the bridge "to be unsafe for ordinary traffic." On June 3d of that year, the county board ordered, under its authority granted by the state, that the Fargo Bridge & Iron Co. "rebuild said bridge at a cost not to exceed last prices paid for this class of work..." (This apparently was not competitively bid; Fargo Bridge & Iron Co. received all the bridge contracts let by Foster County and recorded in the commissioners' minute books in the first three decades of the twentieth century.) Although the commissioners used the term "rebuild" in describing the 1925 project, the bridge's substantial design and high price both suggest that an entirely new bridge was constructed. The Fargo Bridge & Iron Co. received partial payments for their work on this span in October (\$4,500.00) and December (\$6,778.13), with perhaps a final payment in May 1926 (\$593.59).

The bridge's construction history is supported by plaques on two of the end chords reading:

FARGO BRIDGE
&
IRON CO.
1925

Fargo Bridge and Iron was easily the largest North Dakota-based builder of bridges in the state during the first two decades of the twentieth century, with a particularly strong presence in the southern and eastern regions of the state. At least fifty historic Fargo Bridge & Iron bridges are believed to survive in North Dakota.

United States Department of the Interior
National Park Service

National Register of Historic Places Continuation Sheet

Section number 9 Page 4

GRACE CITY BRIDGE
FOSTER COUNTY, NORTH DAKOTA

Bibliography:

Bridge plaque.

Foster County Commission, "Minute Book D," p. 354 (June 3, 1925), p. 367 (September 9, 1925), p. 370 (December 3, 1925), p. 379 (May 4, 1926).

Johnson, Lon, et.al. "Historic Bridges in North Dakota." Bismarck: North Dakota Department of Transportation, 1992.

State Highway Department, "Structure Inventory & Appraisal Sheet," Bridge No. 16-121-03.0, December 1987.

Grace City Bridge
Name of Property

Foster, North Dakota
County and State

10. Geographical Data

Acreage of Property Less than one acre.

UTM References

(Place additional UTM references on a continuation sheet.)

1	1 4	5 1 2 7 0 0	5 2 6 5 4 3 0	2	_ _	_ _	_ _	_ _	_ _	_ _	_ _	_ _	_ _
	Zone	Easting	Northing		Zone	Easting	Northing						
3	_ _	_ _	_ _	_ _	4	_ _	_ _	_ _	_ _	_ _	_ _	_ _	_ _

See continuation sheet

Verbal Boundary Description

(Describe the boundaries of the property on a continuation sheet.)

Boundary Justification

(Explain why the boundaries were selected on a continuation sheet.)

11. Form Prepared by

Name/Title: Mark Hufstetler / Historian
Organization: Renewable Technologies, Incorporated Date: December 10, 1996
Street & Number: 511 Metals Bank Building Telephone: (406) 782-0494
City or Town: Butte State: Montana Zip code: 59701

Additional Documentation

Submit the following items with the completed form:

Continuation Sheets

Maps

A USGS map (7.5 or 15 minute series) indicating the property's location.

A Sketch map for historic districts and properties having large acreage or numerous resources.

Photographs

Representative black and white photographs of the property.

Additional items

(Check with the SHPO or FPO for any additional items.)

Property Owner

(Complete this item at the request of SHPO or FPO.)

Name: Foster County
Street & Number: Courthouse; P.O. Box 257 Telephone: (701) 652-1001
City or Town: Carrington State: North Dakota Zip code: 58421

Paperwork Reduction Act Statement: This information is being collected for applications to the National Register of Historic Places to nominate properties for listing or determine eligibility for listing, to list properties, and to amend existing listings. Response to this request is required to obtain a benefit in accordance with the National Historic Preservation Act, as amended (16 U.S.C. 470 et seq.).

Estimated Burden Statement: Public reporting burden for this form is estimated to average 18.1 hours per response including the time for reviewing instructions, gathering and maintaining data, and completing and reviewing the form. Direct comments regarding this burden estimate or any aspect of this form to the Chief, Administrative Services Division, National Park Service, P.O. Box 37127, Washington, DC 20013-7127; and the Office of Management and Budget, Paperwork Reductions Project (1024-0018), Washington, DC 20503.

United States Department of the Interior
National Park Service

National Register of Historic Places Continuation Sheet

Section number 10 Page 5

GRACE CITY BRIDGE
FOSTER COUNTY, NORTH DAKOTA

Verbal Boundary Description:

The bridge is located in the Southwest quarter of Section 16, Township 147 North, Range 64 West. The boundary consists of a rectangle, measuring 151 feet north-south and 68 feet east-west, and centered on the bridge superstructure.

Boundary Justification:

The boundary is constructed to include the area occupied by the bridge superstructure and substructure, as well as a 25-foot buffer of land immediately surrounding the structure.

United States Department of the Interior
National Park Service

National Register of Historic Places Continuation Sheet

Section number Photographs Page 6

GRACE CITY BRIDGE
FOSTER COUNTY, NORTH DAKOTA

Index to Photographs

Photographer: Mark Hufstetler

Date: April 1996

Location of original negatives: State Historical Society of North Dakota,
Bismarck.

Photograph Number	Description	Direction of View
1	North elevation and west portal	SE
2	West portal	E
3	Bridge plaque	E

UNITED STATES DEPARTMENT OF THE INTERIOR
NATIONAL PARK SERVICE

NATIONAL REGISTER OF HISTORIC PLACES
EVALUATION/RETURN SHEET

REQUESTED ACTION: NOMINATION

PROPERTY Grace City Bridge
NAME:

MULTIPLE Historic Roadway Bridges of North Dakota MPS
NAME:

STATE & COUNTY: NORTH DAKOTA, Foster

DATE RECEIVED: 1/28/97 DATE OF PENDING LIST: 2/11/97
DATE OF 16TH DAY: 2/27/97 DATE OF 45TH DAY: 3/14/97
DATE OF WEEKLY LIST:

REFERENCE NUMBER: 97000174

NOMINATOR: STATE

REASONS FOR REVIEW:

APPEAL: N DATA PROBLEM: N LANDSCAPE: N LESS THAN 50 YEARS: N
OTHER: N PDIL: N PERIOD: N PROGRAM UNAPPROVED: N
REQUEST: N SAMPLE: N SLR DRAFT: N NATIONAL: N

COMMENT WAIVER: N

ACCEPT RETURN REJECT 2/27/97 DATE

ABSTRACT/SUMMARY COMMENTS:

Entered in the
National Register

RECOM./CRITERIA _____

REVIEWER _____ DISCIPLINE _____

TELEPHONE _____ DATE _____

DOCUMENTATION see attached comments Y/N see attached SLR Y/N





Grace City Bridge
Foster County, MO
Photo No. 2

THIS PAPER
MANUFACTURED
BY KODAK

A rectangular cast iron manufacturer's mark with a decorative top and bottom. The top and bottom features are semi-circular with a central raised circular knob. The text is embossed in the center of the rectangle.

FARGO BRIDGE

&

IRON CO

1925

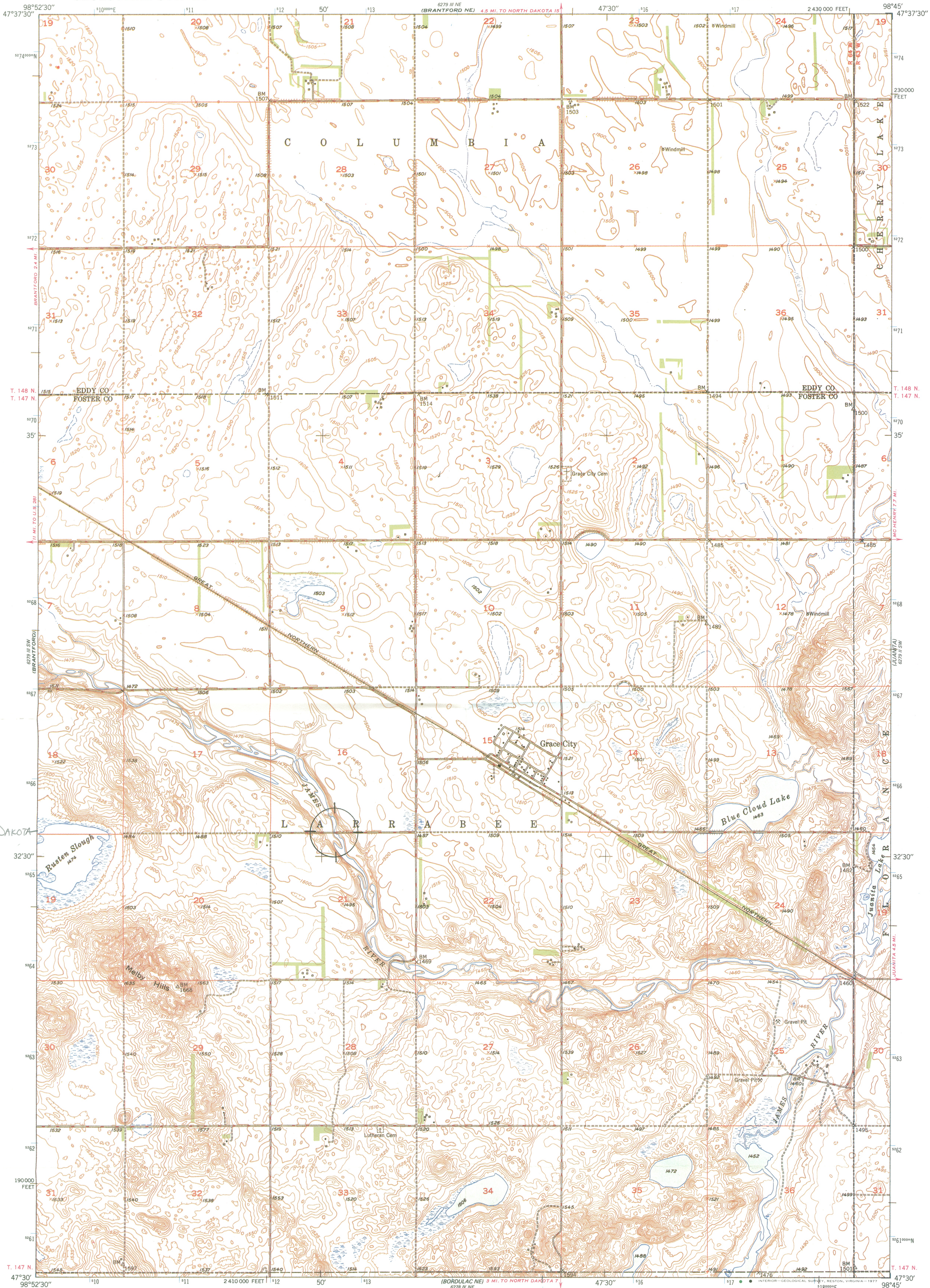

GRACE CITY BRIDGE
FOSTER CO., NORTH DAKOTA
UTM: ZONE 14
E: 512700
N: 5265430

Maped, edited, and published by the Geological Survey as part of the Department of the Interior program for the development of the Missouri River Basin. Culture and drainage in part compiled from aerial photographs taken 1944. Topography by plane-table methods 1948-1949. Polyconic projection. 1927 North American datum 10,000-foot grid based on North Dakota coordinate system, north zone. 1000-meter Universal Transverse Mercator grid ticks, zone 14, shown in blue. Map photoinsppected 1971. No major culture or drainage changes observed.

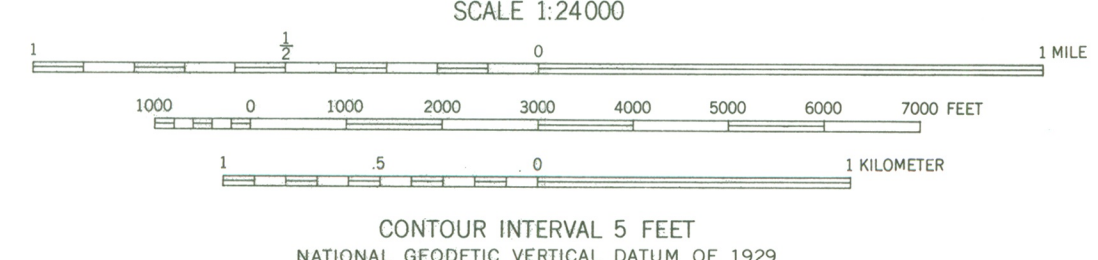

ROAD CLASSIFICATION

HARD-SURFACE ALL WEATHER ROADS	DRY WEATHER ROADS
Heavy-duty <u>4-LANE IS LANE</u>	Improved dirt
Medium-duty <u>4-LANE IS LANE</u>	Unimproved dirt
Loose-surface, graded, or narrow hard-surface	
U. S. Route	State Route

GRACE CITY, N. DAK.
SE/4 BRANTFORD 15' QUADRANGLE
N4730-W9845/7.5

THIS MAP COMPLIES WITH NATIONAL MAP ACCURACY STANDARDS
FOR SALE BY U. S. GEOLOGICAL SURVEY, DENVER, COLORADO 80225, OR RESTON, VIRGINIA 22092
A FOLDER DESCRIBING TOPOGRAPHIC MAPS AND SYMBOLS IS AVAILABLE ON REQUEST

1949
PHOTOINSPECTED 1971
AMS 6279 III SE—SERIES V81
This map was reproduced by electronic color scanning of an earlier printing (1950).



State Historical Society

of north dakota

(State Historical Board)

North Dakota Heritage Center, 612 East Blvd. Ave., Bismarck, N.D. 58505
Telephone 701-328-2666 — Fax 701-328-3710

January 13, 1997

Ms. Carol Shull
Chief of Registration
National Register of Historic Places
National Park Service
United States Department of the Interior
P. O. Box 37127
W434
Washington, DC 20243

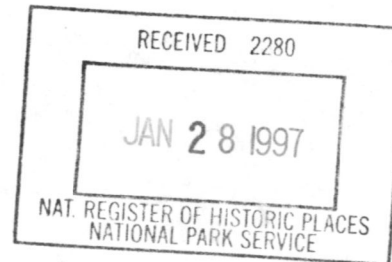

Dear Ms. Shull:

Enclosed please find one Multiple Property Documentation Form and twenty-six completed and documented nomination forms for the:

- Historic Roadway Bridges of North Dakota, Multiple Property Documentation Form;
- Cedar Creek Bridge, 32AD50, Adams County;
- West Park Bridge, 32BA39, Barnes County;
- Rainbow Arch Bridge, 32BA42, Barnes County;
- West Antelope Bridge, 32BE41, Benson County;
- Liberty Memorial Bridge, 32BL114 Burleigh County;
- New Rockford Bridge, 32ED223, Eddy County;
- ✓ Grace City Bridge, 32FO13, Foster County;
- Northwood Bridge, 32GF282, Grand Forks County;
- Midway Bridge, 32GF283, Grand Forks County;
- Ost Valle Bridge, 32GF292, Grand Forks County;
- Romness Bridge, 32GG93, Griggs County;
- Westgaard Bridge, 32MH124, McHenry County;
- Elliott Bridge, 32MH131, McHenry County;
- Great Northern Railway Underpass, 32MN499, Mountrail County;
- Nesheim Bridge, 32NE49, Nelson County;
- Lisbon Bridge, 32RM78, Ransom County;
- Colton's Crossing Bridge, 32RM84, Ransom County;
- Midland Continental Overpass, 32SN171, Stutsman County;
- Beaver Creek Bridge, 32ST146, Steele County;
- Portland Park Bridge, 32TR681, Traill County;
- Norway Bridge, 32TR684, Traill County;
- Porter Elliott Bridge, 32TR690, Traill County;



Page 2
January 13, 1997

Goose River Bridge, 32TR693, Traill County;
Caledonia Bridge, 32TR695, Traill County;
Blanchard Bridge, 32TR698, Traill County;
Viking Bridge, 32TR700, Traill County, North Dakota

The properties have been reviewed by the North Dakota State Historic Preservation Review Board, who after reviewing the historical, architectural, and archeological facts pertaining to the properties and after apply the criteria for eligibility to them agreed that the criteria were met and recommended that the properties be nominated.

The property owners have been notified by letter of the proposed nomination action and invited to comment.

If you have any questions about the nominations please feel free to contact Rolene Schliesman of our staff at (701)328-2033.

Sincerely,

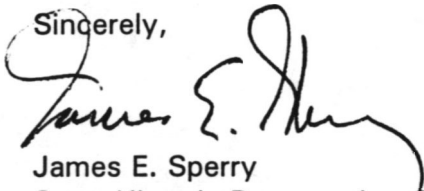
A handwritten signature in black ink, appearing to read "James E. Sperry". The signature is written in a cursive style with a large, looping initial "J".

James E. Sperry
State Historic Preservation Officer
(North Dakota)

RRS/je
Enclosures