

**United States Department of the Interior
Heritage Conservation and Recreation Service**

**National Register of Historic Places
Inventory—Nomination Form**

See instructions in *How to Complete National Register Forms*
Type all entries—complete applicable sections

For HCRS use only

received JUN 5 1980
date entered AUG 6 1980

1. Name

historic Graves Hotel

and/or common

2. Location

street & number 106 South Central Ave _____ not for publication

city, town Harlowton _____ vicinity of _____ congressional district 2nd

state Montana code 30 county Wheatland code 107

3. Classification

Category	Ownership	Status	Present Use
<input type="checkbox"/> district	<input type="checkbox"/> public	<input checked="" type="checkbox"/> occupied	<input type="checkbox"/> agriculture
<input checked="" type="checkbox"/> building(s)	<input checked="" type="checkbox"/> private	<input type="checkbox"/> unoccupied	<input checked="" type="checkbox"/> commercial
<input type="checkbox"/> structure	<input type="checkbox"/> both	<input type="checkbox"/> work in progress	<input type="checkbox"/> educational
<input type="checkbox"/> site	Public Acquisition	Accessible	<input type="checkbox"/> entertainment
<input type="checkbox"/> object	<input type="checkbox"/> in process	<input type="checkbox"/> yes: restricted	<input type="checkbox"/> government
	<input type="checkbox"/> being considered	<input checked="" type="checkbox"/> yes: unrestricted	<input type="checkbox"/> industrial
		<input type="checkbox"/> no	<input type="checkbox"/> military
			<input type="checkbox"/> museum
			<input type="checkbox"/> park
			<input type="checkbox"/> private residence
			<input type="checkbox"/> religious
			<input type="checkbox"/> scientific
			<input type="checkbox"/> transportation
			<input type="checkbox"/> other:

4. Owner of Property

name The Graves Corporation, J.D. Bain, President; D. Swanz, Sec-Treas.

street & number 106 South Central Ave

city, town Harlowton _____ vicinity of _____ state Montana

5. Location of Legal Description

courthouse, registry of deeds, etc. Wheatland County Courthouse

street & number Clerk and Recorder's Office

city, town Harlowton _____ state Montana

6. Representation in Existing Surveys

title NONE has this property been determined eligible? _____ yes _____ no

date _____ federal _____ state _____ county _____ local

depository for survey records

city, town _____ state

7. Description

Condition

excellent
 good
 fair

deteriorated
 ruins
 unexposed

Check one

unaltered
 altered

Check one

original site
 moved date _____

Describe the present and original (if known) physical appearance

Built in 1908, the Graves Hotel is a three story sandstone "L" shaped building standing atop "Main Street Hill" in Harlowton, Montana, overlooking the Mussellshell Valley.

The Southern and Eastern exposures of the "L" (measuring 100 feet and 80 feet respectively) are each interspaced by ten inset, double-pane windows on all three floors. The convergence of the two sides of the "L" present a 'flat' corner on the main floor and on the second and third floors introduce five-windowed projecting wooden bays which are topped by a unique metal cupola on the roof which supports a flag pole. The entire corner interest demonstrates a Gothic Revival influence in the structure. The roof is in need of general repair and the bay area and cupola need painting.

The second floor veranda is surrounded by a four foot high white banister and measures a total of 150 feet along the southern and eastern exposures of the Hotel. The veranda is supported by fourteen white Doric columns, seven on each exposure, which are set upon a cement porch following the contours of the hilltop lots, leveling off the understructure of the building.

A wooden cornice centrally located on the roof edge of the Hotel's eastern exposure bears the legend: Graves Hotel - 1908. The Hotel's flat roof is edged on the southern, eastern and northern exposures by a metal moulding, simple with dentils.

The back of the building is simple, plain and utilitarian with back entrances for tradesmen, fire exits, garbage areas, air conditioners, and loading and unloading areas. All of the trim of the Hotel needs painting.

A partial basement sits under the building and contains freezers, food storage areas, furnace and hot water heater, storage areas and a small laundry. Basement is not fully under hotel, rather it extends under two wings and ends before the lobby, or middle square of the building.

The stone for the Graves Hotel was quarried out of the cliff under the Graves Hotel and was cut and laid by a German immigrant named August Pollman. August was assisted with the handiwork, all manual labor, by a crew of Harlowton men who also helped with numerous other local buildings and private homes in the town, all sandstone.

After 70 years, these sandstone buildings still attest to the excellent workmanship of Stonemason, August Pollman.

INTERIOR: Oak is a treasured wood and it is shown in all its beauty in the Graves Hotel woodwork throughout the building. No where is it more beautifully presented than in the front staircase beginning on the Main floor Lobby and on up to the second and third floors. Even the back staircase shows workmanship and design seldom seen in modern buidings.

The Hotel still has its large, spacious lobby with large picture windows overlooking the Mussellshell Valley. The lobby, main floor public areas (Optometrist office, office, cafe, bar and dining areas), and sleeping rooms and suite have all been extensively remodeled through the years. The Hotel maintains much of its original charm particularly on the second and third floors.

**United States Department of the Interior
Heritage Conservation and Recreation Service
National Register of Historic Places
Inventory—Nomination Form**

For HCRS use only
received JUN 5 1980
date entered AUG 6 1980

Continuation sheet

Item number 7

Page 1

The second floor has seventeen sleeping rooms, eight baths, one public restroom, and one suite and storage areas.

A unique feature of the Graves Hotel are the four 'inside' rooms. Inside rooms are rooms which were rented cheaper to overnighters in the 'old days' because there was no outside ventilation. The light and air was furnished to the rooms by the three large windows facing the hall which were of course covered with shades for privacy. The windows have now been painted over and the rooms are used for storage only.

The high ceilings of the rooms, old light fixtures, porcelain sinks, beautiful woodwork, period dressers, tables, chairs, mirrors and so on all add to the general old-fashioned and victorian feeling of the Graves Hotel.

8. Significance

Period	Areas of Significance—Check and justify below			
<input type="checkbox"/> prehistoric	<input type="checkbox"/> archeology-prehistoric	<input type="checkbox"/> community planning	<input type="checkbox"/> landscape architecture	<input type="checkbox"/> religion
<input type="checkbox"/> 1400–1499	<input type="checkbox"/> archeology-historic	<input type="checkbox"/> conservation	<input type="checkbox"/> law	<input type="checkbox"/> science
<input type="checkbox"/> 1500–1599	<input type="checkbox"/> agriculture	<input type="checkbox"/> economics	<input type="checkbox"/> literature	<input type="checkbox"/> sculpture
<input type="checkbox"/> 1600–1699	<input checked="" type="checkbox"/> architecture	<input type="checkbox"/> education	<input type="checkbox"/> military	<input checked="" type="checkbox"/> social/
<input type="checkbox"/> 1700–1799	<input type="checkbox"/> art	<input type="checkbox"/> engineering	<input type="checkbox"/> music	<input type="checkbox"/> humanitarian
<input type="checkbox"/> 1800–1899	<input checked="" type="checkbox"/> commerce	<input type="checkbox"/> exploration/settlement	<input type="checkbox"/> philosophy	<input type="checkbox"/> theater
<input checked="" type="checkbox"/> 1900–	<input type="checkbox"/> communications	<input type="checkbox"/> industry	<input type="checkbox"/> politics/government	<input type="checkbox"/> transportation
		<input type="checkbox"/> invention		<input type="checkbox"/> other (specify)

Specific dates 6/1/08:6/19/09 **Builder/Architect** A.C. Graves/Kent & Shanley

Statement of Significance (in one paragraph)

The Graves Hotel was the first large structure rebuilt after the Harlowton fire of 1907, a disaster that almost completely destroyed the business district of the town. The Hotel has been a center of community life since its opening in 1909 by being a business and social meeting place for all residents of Wheatland County these many years. The Graves Hotel was the first sandstone building erected in Harlowton and is a good example of the stone architecture common and peculiar to this area. The Hotel was built on top of "Main Street Hill" (Central Avenue) overlooking the Mussellshell Valley, site of the first big cattle drives in Montana, and overseeing the Milwaukee Railroad Yards.

At the time of his death in 1913 at the age of 47, A.C. "Chris" Graves was fondly called the "Father of Harlowton". His sudden and tragic death, the result of an auto accident, left the entire community bereft: Never had Harlowton seen such a demonstration of reverent admiration as this funeral called forth...¹

"The many, varied and active interests of Chris Graves..., had brought him in contact with every facet of the community and business life of the town and surrounding area. He started businesses and helped others start them, bought and sold real estate, started a brick making plant, operated a meat business continuously, and in 1909 advertised "Townsite Owner of Harlowton"....²

Mr. Graves' most lasting monument was to be a hotel. Harlowton had not had a hotel since the Leland burned in 1907. On June 1, 1908 in the office of H.E. Marshall, the paper reported, the Graves Hotel Company was organized. The capital stock was \$40,000 and the life of the company would be 20 years. The work for excavating the cellar for the hotel was started on June 2 with Shueman & McNeese having the contract.

By late October, work on the hotel was progressing nicely..."Carpenters are busy putting up the framework on the second story and by Saturday night the stone masons will have the stonework finished for the first story." On January 1, 1909 readers were told, "The Harlowton Light and Water Company has commenced the electric wiring in the Graves Hotel. It will be illuminated by 150 electric lights and wired for intercommunicating telephone system."³ It would be a three story structure containing 45 rooms, with modern plumbing and heating. The hotel was expected to be completed by June and it was.

The formal and grand opening of the Graves Hotel was held on Saturday, June 19, 1909. "It was a proud and happy day for the promoter, A.C. Graves, and the proprietor, J.N. Kleber" the news reported in a lengthy article on the event..."At nine o'clock the guests began to gather at the hotel, which was brilliant in the most elaborate electrical display in this section of Montana. The building dazzled... The Harlowton Band played special music for the occasion..the lobby and dining room were festooned in colors of the flag.. costly bouquets of cut flowers gave a finishing touch. At 9:20 the guests formed a procession in the lobby and spacious hall on the second floor. The orchestra struck up a smart two-step...Mr. and Mrs. A.C. Graves led the Grand March, followed by Mr. and Mrs. Kleber... Dancing was resumed and "the merry making did not break up until nearly dawn."⁴

9. Major Bibliographical References

HARLOWTON TIMES, Issues of 1913, March. HARLOWTON TIMES CLARION, January 5, 1978
 MUSSELLSHELL NES, Issues of 1907, 1908, 1909
 "Specifications of Heating and Plumbing, Notice to Contractors", 1908
 "Yesteryears and Pioneers" Harlowton Women's Club, cc 1976

10. Geographical Data

UTM NOT VERIFIED

Acreege of nominated property less than 1/2 acre

Quadrangle name unsurveyed area

ACREAGE NOT VERIFIED

Quadrangle scale _____

UMT References

A
 Zone Easting Northing

B
 Zone Easting Northing

C

D

E

F

G

H

Verbal boundary description and justification

Lots 1, 2, 3, 4, 5, 6 of Milwaukee 2nd Addition, Block no. 27 Harlowton, Wheatland Co.,
 Montana T8N, R15E

SE¹/₄SW¹/₄SE¹/₄ section 22

List all states and counties for properties overlapping state or county boundaries

state None code county code

state code county code

11. Form Prepared By

name/title Nancy E. Widdicombe, Researcher

organization Graves Hotel

date March 6, 1980

street & number 106 South Central Ave

telephone 406-632-5679

city or town Harlowton

state Montana

12. State Historic Preservation Officer Certification

The evaluated significance of this property within the state is:

national state local

As the designated State Historic Preservation Officer for the National Historic Preservation Act of 1966 (Public Law 89-665), I hereby nominate this property for inclusion in the National Register and certify that it has been evaluated according to the criteria and procedures set forth by the Heritage Conservation and Recreation Service.

State Historic Preservation Officer signature 

title State Historic Preservation Officer

date 5-29-80

For HCERS use only

I hereby certify that this property is included in the National Register

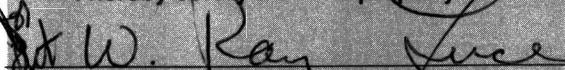
 W. Ray Luce

date 8/6/80

Keeper of the National Register

Attest: 
 Paula Spurr Rad

date 1/31/80

Chief of Registration

**United States Department of the Interior
Heritage Conservation and Recreation Service**

**National Register of Historic Places
Inventory—Nomination Form**

For HCRS use only

received JUN 5 1980

date entered AUG 6 1980

Continuation sheet

Item number 8

Page 1

¹The Harlowton Times, March 1913 "A.C. Graves Obituary" as preached by Rev. H.G. Klemme

²Times Clarion Article "The Story of A.C. Graves as told by ... Jan. 5, 1978 Grace Pound, Historian

³ibid.

⁴ibid.

Copies of this
 nominal cost of
 of Highways

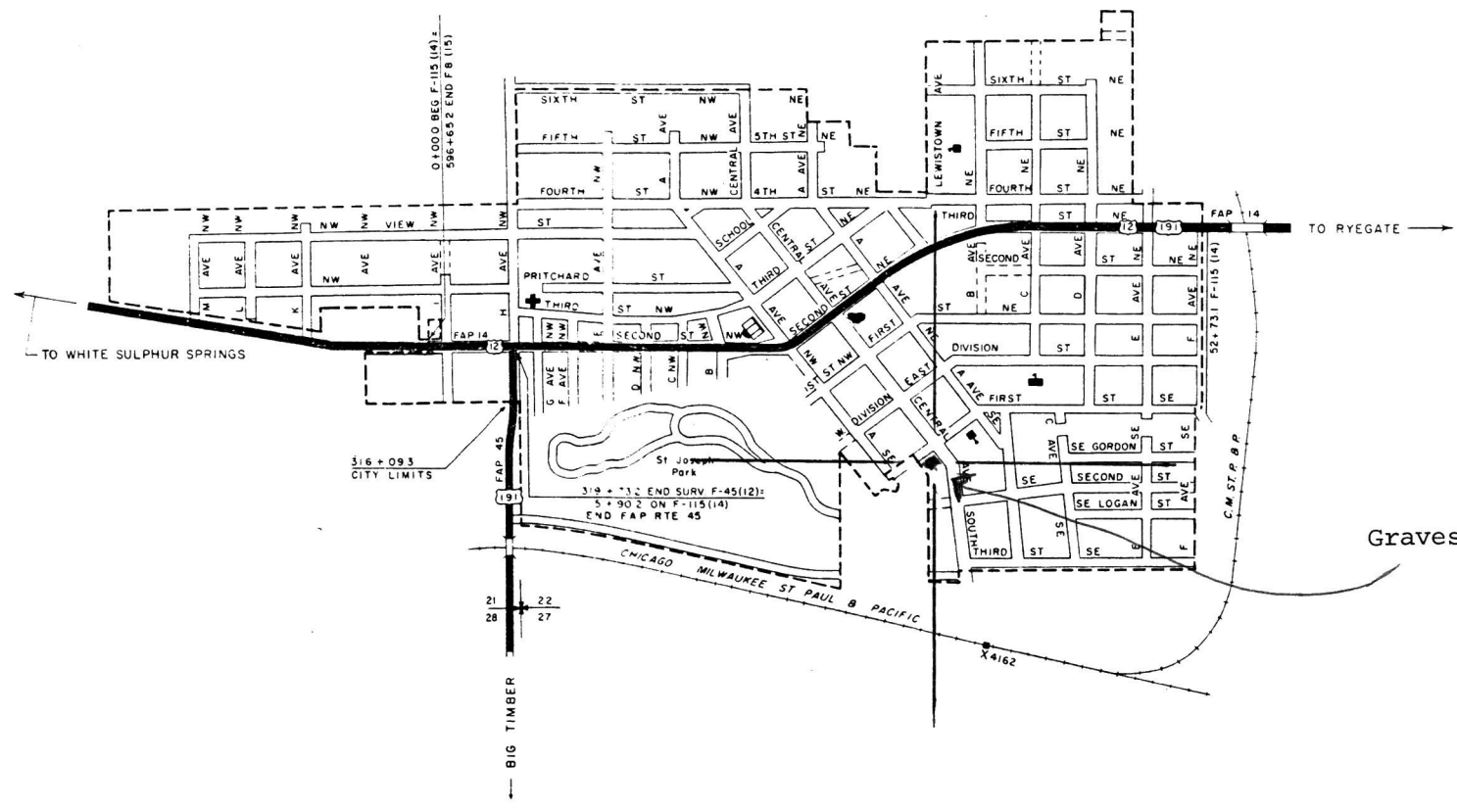

LEGEND

- PROPOSED ROAD
- ▬ GRADED AND DRAINED ROAD
- ▬ GRAVEL OR STONE ROAD
- ▬ LOW TYPE BITUMINOUS ROAD
- ▬ PAVED ROAD
- ▬ DIVIDED ROAD - TRAFFIC FLOW
- F A I FEDERAL AID INTERSTATE SYSTEM
- F A P FEDERAL AID PRIMARY SYSTEM

- F A S FEDERAL AID SECONDARY SYSTEM
- 90 INTERSTATE ROUTE MARKER
- 10 U S NUMBERED ROUTE MARKER
- 13 STATE ROUTE MARKER
- 382 OTHER ROUTE MARKER
- CORPORATE BOUNDARY LINE
- NON-EXISTENT DEDICATED STREET
- CENTRAL BUSINESS DISTRICT

- ▬ URBAN EXTENSION BOUNDARY
- ▬ RAILROAD AND STATION
- ▬ POST OFFICE
- ▬ COURT HOUSE
- ▬ ELEMENTARY SCHOOL
- ▬ HIGH SCHOOL
- ▬ HOSPITAL
- X 5858 ELEVATION



CITY PLAT
HARLOWTON
 WHEATLAND COUNTY
 MONTANA
 1970 CENSUS 1,375
 SCALE IN FEET
 600 0 600

JUN 5 1980

Property Graves Hotel

State MT, Wheatland Working Number 6.5.80.1515

80002434

CONTROL

TECHNICAL

Photos 4
Maps 1

HISTORIAN

This 1908 sandstone hotel building is prominent as **ARCHITECTURAL HISTORIAN** the first large structure built in ~~Wheatland~~ after a devastating fire in 1907. It is built of local stone and regarded as exemplary of local stone construction of the area. It is also significant as a community focal point for many years. Despite inadequacies in the nomination form (confusion about terms and wording) the hotel merits listing.

ARCHEOLOGIST

Paula Reed
Accept 7/30/80

OTHER

HAER

Inventory _____
Review _____

REVIEW UNIT CHIEF

Accept. 7/30/80 P Reed

BRANCH CHIEF

KEEPER

National Register Write-up _____
Federal Register Entry 2.3.81

Send-back _____
Re-submit _____

Entered AUG 6 1980



GRAVES
1908
HOTEL

GRAVES
HOTEL
CAFE
LOUNGE

GRAVES HOTEL
Harlowton, Montana
Wheatland, County
Street Facade
Photo & Neg: Graves Corp.
106 S. Central Ave
Harlowton, MT

1979

AUG #1
6 1980
JUN 5 1980

1084

Graves HOTEL
Harlowton, MT 59036
18X10

#1A



GRAVES HOTEL

Harlowton, Montana

Wheatland County

Detail of Sandstone Work

Photo & Neg; 106 S. Central
Harlowton, MT

1979

JUN 5 1980

#3
AUG 6 1980
4

Harlowton mt

59036



Graves Hotel
Harlowton, Montana
Wheatland County

#2 of 4

Rear View

Photo & Neg: 106 S. Central Av
Harlowton, MT

1979

AUG

6 1980

1980

JUN 5

1036
Harlowton, MT.

#2 Graves Hotel
Rear Exterior



Graves Hotel
Harlowton, Montana
Wheatland County
2nd Floor Staircase to 3rd Floor
Photo & Neg: 106 S. Central Ave
Harlowton, MT

JUN 5

#474

1980

1979

AUG

6 1980

Second floor staircase
to third floor

Harlowton mt 59036

Map #1

JUDITH BASIN COUNTY

FERGUS COUNTY

R.12 E. R.13 E. R.14 E. R.15 E. R.16 E. R.17 E. R.18 E.

T.11 N. T.10 N. T.9 N. T.8 N. T.7 N. T.6 N.

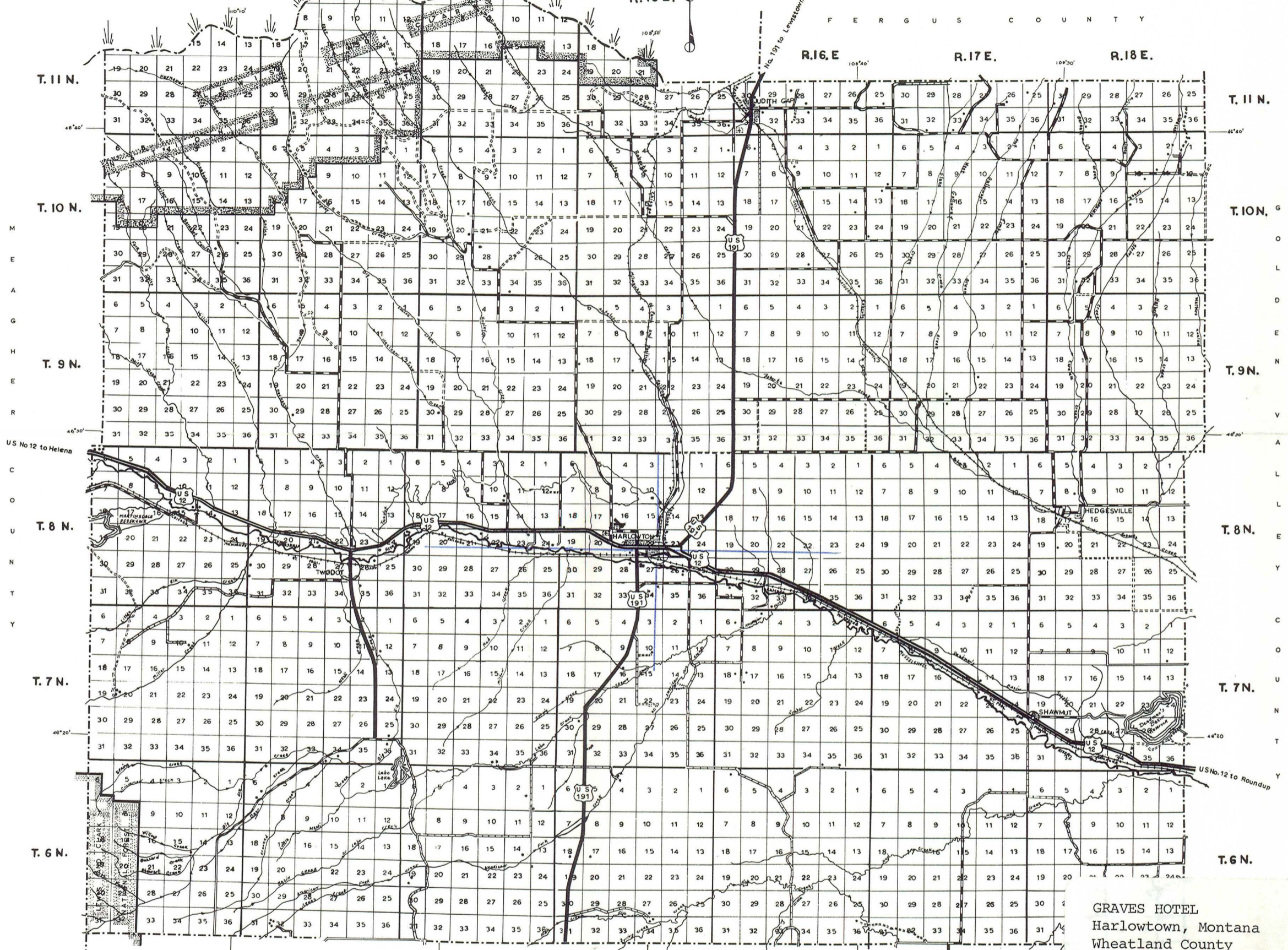

SWEET GRASS COUNTY GOLDEN VALLEY

GRAVES HOTEL
 Harlowtown, Montana
 Wheatland County
 Unsurveyed area
 SE $\frac{1}{4}$ SW $\frac{1}{4}$ SE $\frac{1}{4}$ section 22
 Township 18N, Range 15E

- LEGEND
- US highway No. 12 (asphalt)
 - US highway No. 191 & secondary
 - gravelled county road
 - graded & drained road
 - unimproved road
 - primitive road
 - railroads

MAP OF WHEATLAND COUNTY MONTANA

SCALE
 1 0 1 2 3 4 miles

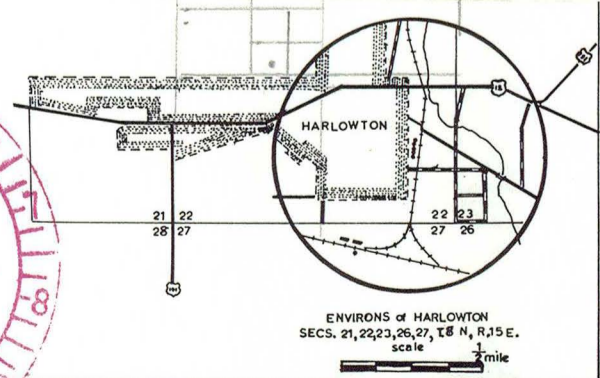
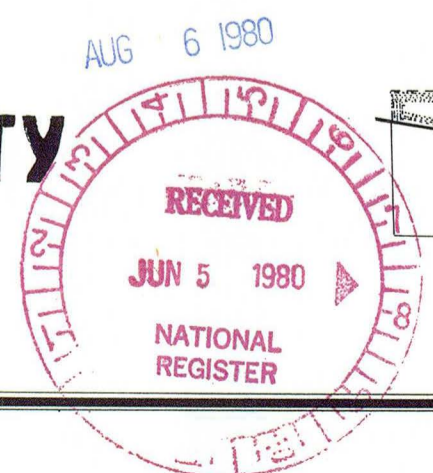

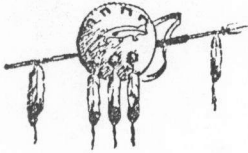

Harold G. "Hal" Stearns

RECEIVED
MAY 5 1979

Dr. Robert Archibald
Director, Montana Historical Society
Helena:

Dear Bob:

May I recommend the old Graves Hotel in Harlowton for inclusion in Register of Historic Places?

The distinctive native sandstone stone work and the architecture are outstanding—also the Hotel has been the center of the entire Musselshell valley activity since 1909.

It is the most important structure in the locality.

Sincerely
Harlowton, Montana 59036

Harold Stearns

Harold Stearns - 33 years publisher of

Harlowton newspaper

ENTRIES IN THE NATIONAL REGISTER

MONTANA

STATE

Date Entered

<u>Name</u>	<u>Location</u>
Kleinschmidt, T.H., House	Helena Lewis and Clark County
Graves Hotel	Harlowton Wheatland County

Honorable John Malcher
Honorable Max Baucus
Honorable Pat Williams
Honorable Ronald C. Marleese

Also notified

Acting State Historic Preservation Officer
Mr. Robert R. Archibald
Montana Historical Society
225 North Roberts Street
Veterans Memorial Building
Helena, Montana 59601

NR

Byers/mjd

8/14/80

For further information, please call the National Register at (202)343-6401.