

National Register of Historic Places Continuation Sheet

Amendment to Smith Park
Architectural District
Jackson, Hinds County,
Mississippi

Section number 1,2,&3 Page 1

RECEIVED

AMENDMENT

OCT 01 1993

Smith Park Architectural District
(Boundary Increase)
Jackson, Hinds County, Mississippi

10/1/93
10/1/93

The purpose of this amendment is to increase the boundaries of the Smith Park Architectural District, listed on the National Register of Historic Places on 4/27/76, to add one additional building that is immediately adjacent to the previous boundary. It is not intended as a complete update of the district documentation, though some updated information has been included.

Section 1: Name of Property

Smith Park Architectural District (Boundary Increase)

Section 2: Location (of added property)

235 East Capitol Street, Jackson, Hinds County, Mississippi 39201

Section 3: Classification

Original nomination: 1 district containing 22 buildings (several of which are non-historic)

In keeping with current policies, the original nomination should be considered to consist of

- 16 contributing buildings,
- 1 contributing site
- 1 building which was already listed, and
- 5 noncontributing buildings.

Amendment: add one contributing building

Update of documentation: remove one contributing building which has been demolished (the surviving later rear wing by itself is noncontributing)

Total count of elements after boundary increase and update:
17 contributing elements (16 buildings and 1 site)
1 previously listed
6 noncontributing elements

United States Department of the Interior
National Park Service

National Register of Historic Places Continuation Sheet

Amendment to Smith Park
Architectural District
Jackson, Hinds County,
Mississippi

Section number 6 & 7 Page 2

Section 6: Function or use (for added property)

Historic functions: COMMERCE/TRADE: business
 COMMERCE/TRADE: restaurant

Current functions: COMMERCE/TRADE: business

Section 7: Description (for added property)

Architectural Classification: Other: Eclectic Mediterranean

Materials: Foundation: concrete
 Walls: terra cotta; brick
 Roof: ceramic tile
 Other: glass

Description:

The Smith Park Architectural District was originally nominated to the National Register in 1976. The inventory of components at that time consisted of 22 buildings, though one of these (#13, the J. V. Hough house at 228 North Congress Street) has since been demolished. Smith Park itself was not shown on the original inventory, although it is in the district and should have been identified as a contributing site (Inventory #23). As stated in the original nomination, the district is a collection of architecturally-significant buildings in the center of downtown Jackson, built between 1840 and 1940. Most are large, important civic, commercial, and religious buildings, but a smaller commercial building, the Thompson Building (#9) was also included.

This boundary increase is being made to add to the district one architecturally-significant smaller commercial building that dates to the period of significance, shares certain architectural characteristics with other buildings in the district, and is immediately adjacent to the original district boundary. It is not known why this building was not originally included within the district; possibly it was excluded because unsympathetic changes to the storefront detracted from its apparent integrity. However the building has recently undergone a substantial rehabilitation and its integrity and architectural character can be much more readily appreciated.

United States Department of the Interior
National Park Service

National Register of Historic Places Continuation Sheet

Section number 7 Page 3

Amendment to Smith Park
Architectural District
Jackson, Hinds County,
Mississippi

Update of District Inventory

C = contributing element; NC = non-contributing element

1. C 245 East Capitol Street. Redesignated as Eastland Federal Courthouse.
2. NC 248 East Capitol Street. Now houses Trustmark National Bank.
3. C 300 East Capitol Street. Mississippi Governor's Mansion.
4. C 305 East Capitol Street. St. Andrew's Episcopal Cathedral.
5. C 315 East Capitol Street. Lamar Life Building.
6. C 329 East Capitol Street. Now houses Sunburst Bank.
7. C 400 East Capitol Street. Emporium Building.
8. C 401 East Capitol Street. Originally housed Kennington's Department Store; later McRae's Department Store; now called Heritage Building
9. C 116 North Congress Street. Thompson Building.
10. C 120 North Congress Street. Originally, and still properly, called the Plaza Building.
11. NC 200 North Congress Street. Magnolia Federal Bank
12. NC 210 North Congress Street. Spencer-Murphee Building.
13. NC 228 North Congress Street. J. V. Hough House. Demolished in 1988; site now occupied by a parking lot. The rear wing of the house, which was a later addition of uncertain date, remains standing but does not contribute to the district.
14. C 304 North Congress Street. Bishop Charles B. Galloway House. Inaccurately termed "Second Empire" in the original nomination, the house is actually of much more eclectic Late Victorian design, incorporating Gothic, Eastlake, and Italianate elements; the Second Empire character is seen mainly in the mansard-roofed tower.
15. C 305 North Congress Street. Galloway Memorial Methodist Church.
16. NC 321 Mississippi Street. Methodist Building.
17. C 401 Mississippi Street. Originally built as offices for the Mississippi Fire Insurance Company, later acquired by the State of Mississippi and used as State Executive Building; now called the Heber Ladner Building, it houses state offices.
18. C 123 North West Street. St. Peter's Rectory.
19. C 203 North West Street. St. Peter's Catholic Cathedral.
20. C 259 North West Street. (Former) Central High School.
21. C 304 North West Street (though it faces onto Yazoo Street). Old First Baptist Church; later offices for the Consolidated American Life Insurance Company; recently acquired by Galloway Memorial Methodist Church.
22. NC 237 East Amite Street. Catholic Diocese Office.

National Register of Historic Places Continuation Sheet

Amendment to Smith Park
Architectural District
Jackson, Hinds County,
Mississippi

Section number 7,8 Page 4

Additions to district inventory

23. C Smith Park, which is in the originally nominated area but was not shown on the original inventory. It was, however, described in the text of the nomination, on Continuation Sheet 2 of Item 7.
24. C 235 East Capitol Street: Ridgway-McGehee Building, built in 1928. C. H. Lindsley, architect. Eclectic Mediterranean style. Two-story brick commercial office building located immediately west of the former U.S. Post Office (now Eastland Federal Courthouse) (Inventory #1). The facade, which is flush with the sidewalk, has two levels. The upper level retains much of its original appearance. It consists of a set of three one-over-one windows, between a matching pair of gabled flanking elements, each of which has a round-arched double-hung window trimmed with glazed terra cotta ornamentation. The wall surface is also faced in glazed terra cotta, and the upper facade is surmounted by a short section of false roof made of bright blue glazed roofing tiles. (The main roof is flat and is hidden behind the false roof and the brick side walls.) The new lower facade consists of a recessed center bay from which doors open on either side, flanked by narrower side bays that align with the gable-topped end windows above. Each bay consists of glass panels with tile bulkheads, framed by wood piers.

Section 8: Significance (of added property)

The Smith Park Architectural District is locally significant under Criterion C because it is an important concentration of buildings of architectural distinction built between 1840 and 1940.

The Ridgway-McGehee Building, built in 1928, is contemporary with several other buildings in the district and contributes to the architectural achievement and architectural diversity of the district. One of Jackson's most architecturally elaborate small commercial buildings, it was designed by prominent Jackson architect C. H. Lindsley, who was also the designer of Central High School (Inventory #20), built in 1925. Lindsley's other surviving works in Jackson include the Hinds County Courthouse, an elegant Art Deco public building erected in 1930 (listed on the National Register in 1986); and the Robert E. Lee Building, an imposing 12-story building in the Commercial Style with Mediterranean features built in 1930. Taken together, these buildings demonstrate Lindsley's ability to work capably in a wide range of architectural styles and building types.

The Ridgway-McGehee Building contributes to the richness and diversity of architectural form and style that characterizes the Smith Park Architectural District.

United States Department of the Interior
National Park Service

National Register of Historic Places Continuation Sheet

Amendment to Smith Park
Architectural District
Jackson, Hinds County,
Mississippi

Section number 10,11 Page 5

Section 10: Geographical Data

Acreage of original nomination: approximately 20 acres
Acreage of Amendment area: .092 acre (approximately one tenth of an acre)
Total acreage of amended nomination will remain approximately 20 acres.

Because the amendment area consists of less than one acre adjacent to the irregular western edge of the existing boundary of the district and within the area encompassed by the district's original UTM reference points, no further UTM reference points are needed.

Verbal Boundary Description:

From the northwest corner of the property of the former U. S. Post Office, (located 200 feet west along the line of Capitol Street from the corner of Capitol Street and West Street), the amendment area proceeds southward along the edge of the Post Office property for 161.5 feet, then westward along a line parallel to Capitol Street for 25 feet, then northward parallel to the first line for 161.5 feet, then eastward along the south edge of Capitol Street for 25 feet to the starting point.

Boundary Justification:

This boundary increase delineates the single parcel of about one tenth of an acre on which the Ridgway-McGehee building is located. This parcel lies immediately alongside the original western edge of the district.

Section 11: Form Prepared By:

Richard J. Cawthon, Chief Architectural Historian
Mississippi Department of Archives and History
P. O. Box 571
Jackson, Mississippi 39205
(601) 359-6940
23 June 1993

Certification

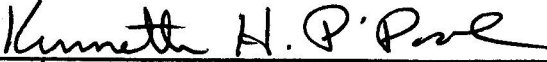

Kenneth H. P'Pool
Deputy State Historic Preservation Officer

SEPT. 22, 1993
Date

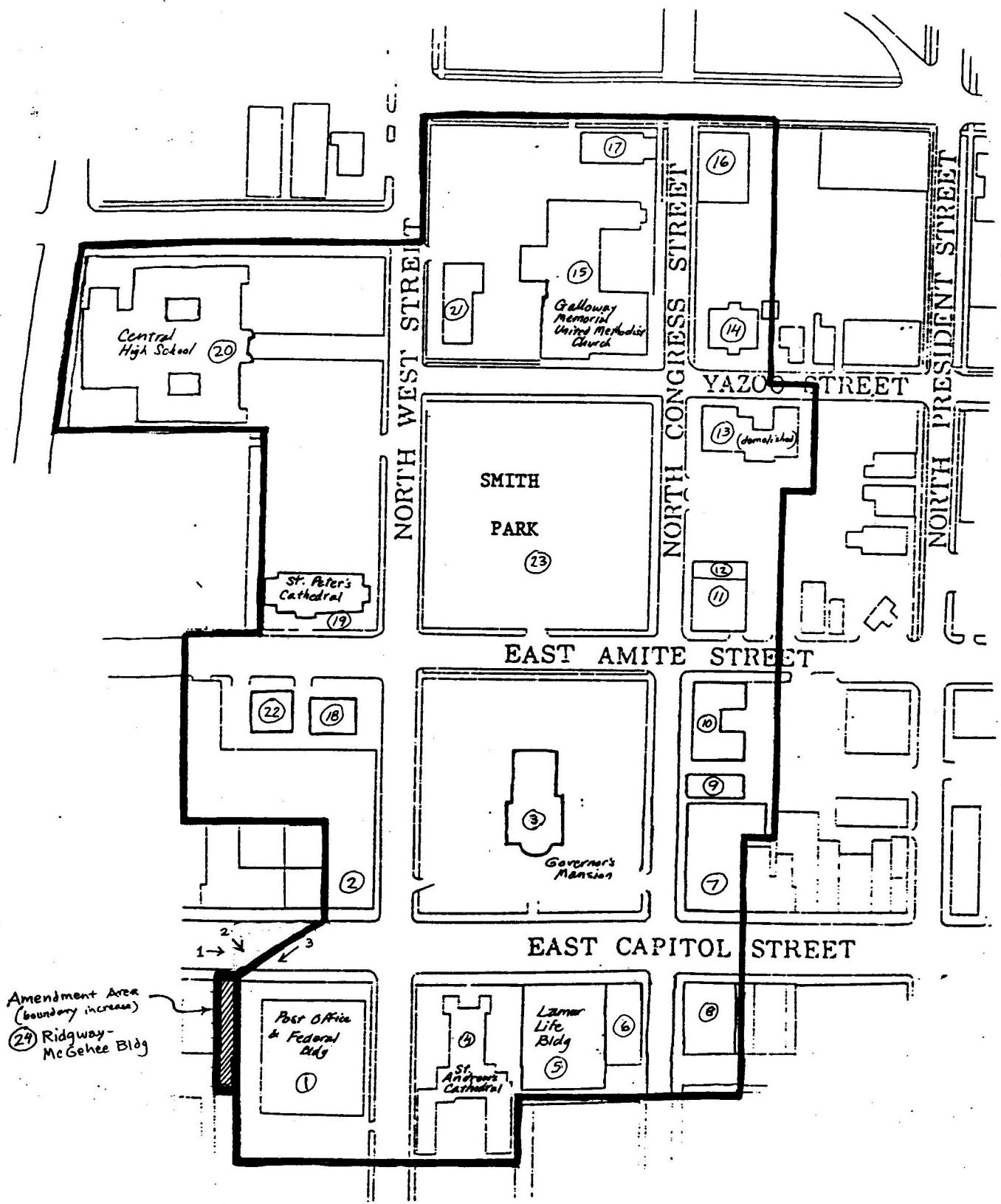

SMITH PARK ARCHITECTURAL DISTRICT

**United States Department of the Interior
National Park Service**

**National Register of Historic Places
Continuation Sheet**

Section number _____ Page _____

Smith Park Architectural District Hinds County, MISSISSIPPI

Entered in the
National Register

BOUNDARY INCREASE APPROVAL
93001152

Delmar Byrd 10/29/93

ADDITIONAL DOCUMENTATION APPROVAL
7001107

UNITED STATES DEPARTMENT OF THE INTERIOR
NATIONAL PARK SERVICE

NATIONAL REGISTER OF HISTORIC PLACES
EVALUATION/RETURN SHEET

REQUESTED ACTION: BOUNDARY INCREASE

PROPERTY NAME: Smith Park Architectural District (Boundary Increase)

MULTIPLE NAME:

STATE & COUNTY: MISSISSIPPI, Hinds

DATE RECEIVED: 10/01/93
DATE OF 16TH DAY: 10/29/93
DATE OF WEEKLY LIST:

DATE OF PENDING LIST: 10/13/93
DATE OF 45TH DAY: 11/15/93

REFERENCE NUMBER: 93001152

NOMINATOR: STATE

REASONS FOR REVIEW:

APPEAL: N DATA PROBLEM: N LANDSCAPE: N LESS THAN 50 YEARS: N
OTHER: N PDIL: N PERIOD: N PROGRAM UNAPPROVED: N
REQUEST: N SAMPLE: N SLR DRAFT: N NATIONAL: N

COMMENT WAIVER: N

ACCEPT RETURN REJECT 10/29/93 DATE

Entered in the
National Register

ABSTRACT/SUMMARY COMMENTS:

RECOM./CRITERIA _____
REVIEWER _____
DISCIPLINE _____
DATE _____

DOCUMENTATION see attached comments Y/N see attached SLR Y/N

CLASSIFICATION

count resource type

STATE/FEDERAL AGENCY CERTIFICATION

FUNCTION

historic current

DESCRIPTION

architectural classification
 materials
 descriptive text

SIGNIFICANCE

Period Areas of Significance--Check and justify below

Specific dates Builder/Architect
Statement of Significance (in one paragraph)

summary paragraph
 completeness
 clarity
 applicable criteria
 justification of areas checked
 relating significance to the resource
 context
 relationship of integrity to significance
 justification of exception
 other

BIBLIOGRAPHY

GEOGRAPHICAL DATA

acreage verbal boundary description
 UTM's boundary justification

ACCOMPANYING DOCUMENTATION/PRESENTATION

sketch maps USGS maps photographs presentation

OTHER COMMENTS

Questions concerning this nomination may be directed to

_____ Phone _____

Signed _____ Date _____

Ridgway McGehee Building, amendment to Smith Park Architectural District
Jackson, Hinds County, Mississippi
Photo by C.R. Ridgway IV
January 1993
Negative: C.R. Ridgway IV
View east along Capitol Street
Showing relationship of Ridgway-McGehee Building to nearby buildings in
the district

Photo 1 of 3

**Ridgway McGehee Building
235 East Capitol Street
Jackson, Mississippi
January 1993
East along Capitol St. showing
Federal Courthouse, St. Andrews Church,
Lamar Life Bldg, Ms. Bank Bldg, and
Heritage Bldg.**



Ridgway-McGehee Bldg., Amendment to Smith Park Architectural District
Jackson, Hinds County, Miss.

Photo by C. R. Ridgway IV, January 1993

Negative: C. R. Ridgway IV

View to Southeast showing Ridgway-McGehee Building and former
U.S. Post Office

Photo 2 of 213-52

**Ridgway McGehee Building
235 East Capitol Street
Jackson, Mississippi
January 1993
Building as it relates to the
Federal Courthouse in the Smith
Park Historic District
Facing Southeast**



Ridgeway-McGehee Building; Amendment to Smith Park Architectural District
Jackson, Hinds County, Mississippi

Photo by C.R. Ridgway IV, January 1993

Negatives: C.R. Ridgeway IV

View toward S.W. showing facade and east side of Ridgeway-McGehee
Building

Photo 3 of 3.

**Ridgeway McGehee Building
235 East Capitol Street
Jackson, Mississippi
January 1993
Building as it relates to the
Federal Courthouse in the Smith
Park Historic District
Facing Southwest**



Mississippi Department of Archives and History

Historic Preservation Division • Post Office Box 571 • Jackson, Mississippi 39205-0571
Telephone 601-359-6940

September 22, 1993

RECEIVED

OCT 01 1993

NATIONAL
REGISTER

Ms. Carol D. Shull
Chief of Registration
National Register of Historic Places
Interagency Resources Division
National Park Service
P.O. Box 37127
Code 710
Washington, DC 20013-7127

Dear Ms. Shull:

We are pleased to submit the nomination form, site map, and photographs for the Amendment to the Smith Park Architectural District (Boundary Increase) in Jackson, Hinds County, Mississippi. This property was approved for nomination by the Mississippi Historic Preservation Professional Review Board at its meeting on September 16, 1993.

Please note that because the amendment area falls within the area encompassed by the district's original UTM reference points, a new USGS map is not being submitted and no further UTM reference points are needed. If this poses a problem, please let us know.

We trust that you will find the enclosed materials in order and will let us hear from you at your convenience.

Sincerely,

Kenneth H. P'Pool
Deputy State Historic
Preservation Officer

brc

Enclosures

