

United States Department of the Interior  
National Park Service

For NPS use only

National Register of Historic Places  
Inventory—Nomination Form

received NOV 25 1986  
date entered

See instructions in How to Complete National Register Forms  
Type all entries—complete applicable sections

1. Name

historic Rockland Residential Historic District

and or common

2. Location

street & number Various

not for publication

city, town Rockland,

vicinity of

state Maine

code 23

county Knox

code 013

3. Classification

<b>Category</b>	<b>Ownership</b>	<b>Status</b>	<b>Present Use</b>	
<input checked="" type="checkbox"/> district	<input type="checkbox"/> public	<input checked="" type="checkbox"/> occupied	<input type="checkbox"/> agriculture	<input checked="" type="checkbox"/> museum
<input type="checkbox"/> building(s)	<input type="checkbox"/> private	<input type="checkbox"/> unoccupied	<input type="checkbox"/> commercial	<input type="checkbox"/> park
<input type="checkbox"/> structure	<input checked="" type="checkbox"/> both	<input type="checkbox"/> work in progress	<input checked="" type="checkbox"/> educational	<input checked="" type="checkbox"/> private residence
<input type="checkbox"/> site	<b>Public Acquisition</b>	<b>Accessible</b>	<input type="checkbox"/> entertainment	<input checked="" type="checkbox"/> religious
<input type="checkbox"/> object	<input checked="" type="checkbox"/> N/A in process	<input checked="" type="checkbox"/> yes: restricted	<input checked="" type="checkbox"/> government	<input type="checkbox"/> scientific
	<input type="checkbox"/> being considered	<input type="checkbox"/> yes: unrestricted	<input type="checkbox"/> industrial	<input type="checkbox"/> transportation
		<input type="checkbox"/> no	<input type="checkbox"/> military	<input type="checkbox"/> other:

4. Owner of Property

name Multiple Owners

street & number

city, town

vicinity of

state

5. Location of Legal Description

courthouse, registry of deeds, etc. Knox County Registry of Deeds

street & number

Union Street

city, town

Rockland,

state Maine

6. Representation in Existing Surveys

title Rockland Building Survey

has this property been determined eligible?  yes  no

date 1986

federal  state  county  local

depository for survey records Maine Historic Preservation Commission

city, town

Augusta,

state Maine

## 7. Description

<b>Condition</b>		<b>Check one</b>	<b>Check one</b>
<input type="checkbox"/> excellent	<input type="checkbox"/> deteriorated	<input type="checkbox"/> unaltered	<input checked="" type="checkbox"/> original site
<input checked="" type="checkbox"/> good	<input type="checkbox"/> ruins	<input checked="" type="checkbox"/> altered	<input type="checkbox"/> moved    date _____
<input type="checkbox"/> fair	<input type="checkbox"/> unexposed		

### Describe the present and original (if known) physical appearance

The Rockland Residential Historic District is a neighborhood of residential and public buildings located in the center of the city. The eastern boundary, Union Street, separates this area from the central business district. Several public buildings (the County Courthouse, the County Jail, the County hospital, the library, and the community building, as well as the Episcopal church) front the west side of Union Street and constitute a transitional zone to the residential areas. The southern boundary is the north side of Masonic Street and the western boundary is the east side of Broadway, a major north-south thoroughfare. The rear lots of the north side of Talbot Street roughly completes the area included in this nomination.

There are 142 buildings which contribute to this historic district. All but seven are residential. The following is a list of contributing structures:

NO. 1    ADDRESS: 38 Talbot Avenue  
PROPERTY/DATE: Hemingway-Bartlett Hse., 1885  
ARCH/BLDR: Unknown  
STYLE: Eclectic                      ROOF: Gable  
STRUCTURE: Wood Fram, 2½    WINDOWS: 2/1 Lights  
EXTERIOR: Aluminum siding  
ORNAMENT: Brackets, octagonal corner tower  
  
ALTERATIONS: Enclosed 1920s porch on west,  
                  sleeping porch, siding

NO. 3    ADDRESS: 44 Talbot Avenue  
PROPERTY/DATE: House, c. 1870  
ARCH/BLDR: Unknown  
STYLE: Greek Rev./Ital.    ROOF: Gable  
STRUCTURE: Wood Fram, 2½    WINDOWS: 6/6 Lights  
EXTERIOR: Aluminum siding  
ORNAMENT: Cornice returns, round arched frieze  
                  under eaves and over windows and doors  
ALTERATIONS: Ell remodelled this century with  
                  sleeping porch, siding

NO. 5    ADDRESS: 48 Talbot Avenue  
PROPERTY/DATE: Thos. Pillsbury Hse., 1855-1873  
ARCH/BLDR: Unknown  
STYLE: Greek Rev./Ital.    ROOF: Gable  
STRUCTURE: Wood Fram, 2½    WINDOWS: 6/6 Lights  
EXTERIOR: Aluminum siding  
ORNAMENT: Cornice returns and brackets  
  
ALTERATIONS: Siding

NO. 2    ADDRESS: 41 Talbot Avenue  
PROPERTY/DATE: House, c. 1860-70  
ARCH/BLDR: Unknown  
STYLE: Greek Revival            ROOF: Gable  
STRUCTURE: Wood Frame, 2½    WINDOWS: 6/6 Lights  
EXTERIOR: Clapboard  
ORNAMENT: Cornice returns, pilasters with pediment  
                  over east entrance.  
ALTERATIONS: N/A

NO. 4    ADDRESS: 45 Talbot Avenue  
PROPERTY/DATE: House, c. 1870  
ARCH/BLDR: Unknown  
STYLE: Italianate                ROOF: Gable  
STRUCTURE: Wood Frame, 2½    WINDOWS: 6/6 Lights  
EXTERIOR: Aluminum siding  
ORNAMENT: Round arched windows in gable end  
  
ALTERATIONS: Siding, porch rebuilt without  
                  trim, modern garage

NO. 6    ADDRESS: 49 Talbot Avenue  
PROPERTY/DATE: House, c. 1870  
ARCH/BLDR: Unknown  
STYLE: Italianate                ROOF: Gable  
STRUCTURE: Wood Frame, 2½    WINDOWS: 6/6 Lights  
EXTERIOR: Clapboard  
ORNAMENT: Window and roof cornice with brackets, Queen  
                  Anne style veranda with decorative trim  
ALTERATIONS: N/A

## 8. Significance

Period	Areas of Significance—Check and justify below			
<input type="checkbox"/> prehistoric	<input type="checkbox"/> archeology-prehistoric	<input type="checkbox"/> community planning	<input type="checkbox"/> landscape architecture	<input type="checkbox"/> religion
<input type="checkbox"/> 1400-1499	<input type="checkbox"/> archeology-historic	<input type="checkbox"/> conservation	<input type="checkbox"/> law	<input type="checkbox"/> science
<input type="checkbox"/> 1500-1599	<input type="checkbox"/> agriculture	<input type="checkbox"/> economics	<input type="checkbox"/> literature	<input type="checkbox"/> sculpture
<input type="checkbox"/> 1600-1699	<input checked="" type="checkbox"/> architecture	<input type="checkbox"/> education	<input type="checkbox"/> military	<input type="checkbox"/> social
<input type="checkbox"/> 1700-1799	<input type="checkbox"/> art	<input type="checkbox"/> engineering	<input type="checkbox"/> music	<input type="checkbox"/> humanitarian
<input checked="" type="checkbox"/> 1800-1899	<input type="checkbox"/> commerce	<input type="checkbox"/> exploration settlement	<input type="checkbox"/> philosophy	<input type="checkbox"/> theater
<input checked="" type="checkbox"/> 1900-	<input type="checkbox"/> communications	<input type="checkbox"/> industry	<input type="checkbox"/> politics government	<input type="checkbox"/> transportation
		<input type="checkbox"/> invention		<input type="checkbox"/> other (specify)

Specific dates      various      Builder Architect      various

### Statement of Significance (in one paragraph)

The Rockland Residential Historic District is a large neighborhood of nineteenth and early twentieth century structures representing the city's most prosperous period of development, which occurred between 1880-1920. The buildings are historically important as a concentration of major public edifices and houses built by Rockland's leading citizens. Architecturally, the area is significant for examples of the work of prominent builders and architects.

The City of Rockland's early 19<sup>th</sup> century development was based on shipbuilding and the lime industry. Originally part of the Town of Thomaston, Rockland broke away in 1848 and soon outstripped the older community in industrial development. This initial pre-Civil War period of prosperity included the construction of a number of large homes and commercial blocks and culminated in 1860, with the creation of Knox County with Rockland as the county seat. This development did not, however, extend into the area of the proposed historic district, which consisted largely of undeveloped side streets with scattered small homes. The Civil War brought a depression in the lime export industry with the close of southern markets and a decline in building activity nationally which reduced demand for plaster. Sustained economic prosperity did not get underway until after the depression of 1873-76.

The earliest major building activity in the district occurred in 1873 and 1874 with the erection of two large Mansard style homes for William H. Glover and A. F. Ames, respectively, on Talbot Avenue. They were followed, in 1875, by the erection of the Knox County Courthouse on Main Street (N.R.), and a group of Italianate style homes on Masonic Street. With Talbot Avenue forming the north edge, Union Street on the east and Masonic Street on the south, the construction of these important buildings established the parameters of what became the most desirable neighborhood in the city.

By 1888 Rockland was the largest city in the mid-coast region with over 80 lime kilns shipping 1.5 million casks of lime annually in 20 ships, 40 barks and 150 schooners. As was typical of a city this size, Rockland also manufactured boots and shoes, carriages, harnesses, and machinery. Leading businessmen frequently chose to build homes in the proposed district. Prominent among them were the Bird family, the Cobb family, A. F. Crockett, the Glover family, Fred Spear, and H. G. Tibbetts. Some of these men, such as Francis Cobb and Fred

United States Department of the Interior  
National Park Service

National Register of Historic Places  
Inventory—Nomination Form



ROCKLAND RESIDENTIAL HISTORIC DISTRICT  
Continuation sheet

Item number 7 Page 1

NO. 7 ADDRESS: 53 Talbot Avenue  
PROPERTY/DATE: James Farwell House, c. 1850  
ARCH/BLDR: Unknown  
STYLE: Greek Revival ROOF: Gable  
STRUCTURE: Wood Frame, 2½ WINDOWS: 2/2 Lights  
EXTERIOR: Aluminum siding  
ORNAMENT: Cornice returns, Queen Anne style porch  
w/decorative trim on N. side, added 1889  
ALTERATIONS: Siding

NO. 9 ADDRESS: 57 Talbot Avenue  
PROPERTY/DATE: Snow House, 1886  
ARCHITECT: Palliser, Palliser & Co., New York  
BUILDER: R. C. Guphill  
STYLE: Queen Anne ROOF: Gable  
STRUCTURE: Wood Frame, 2½ WINDOWS: 2/2 Lights  
EXTERIOR: Vinly siding  
ORNAMENT: Brackets and vergeboard, ornate  
veranda  
ALTERATIONS: Siding

NO. 11 ADDRESS: 66 Talbot Avenue  
PROPERTY/DATE: House, c. 1870  
ARCH/BLDR: Unknown  
STYLE: Italianate ROOF: Gable  
STRUCTURE: Wood Fram, 2½ WINDOWS: 6/6 Lights  
EXTERIOR: Asbestos shingles  
ORNAMENT: Brackets, round arched attic windows  
ALTERATIONS: Siding, porch enclosed with windows

NO. 13 ADDRESS: 72 Talbot Avenue  
PROPERTY/DATE: W. H. Priest House, 1855-73  
ARCH/BLDR: Unknown  
STYLE: Italianate ROOF: Gable  
STRUCTURE: Wood Frame, 2½ WINDOWS: 1/1 Lights  
EXTERIOR:  
ORNAMENT: Brackets under cornice, Colonial  
Revival porch on north side  
ALTERATIONS: Porch and bay window, early 1900

NO. 8 ADDRESS: 56 Talbot Avenue  
PROPERTY/DATE: House, c. 1870  
ARCH/BLDR: Unknown  
STYLE: Italianate ROOF: Gable  
STRUCTURE: Wood Frame, 2½ WINDOWS: 6/6 Lights  
EXTERIOR: Clapboard  
ORNAMENT: Brackets under cornice, porch roof and over  
main entrance  
ALTERATIONS: Porch on east side enclosed

NO. 10 ADDRESS: 61 Talbot Avenue  
PROPERTY/DATE: House, c. 1870  
ARCH/BLDR: Unknown  
STYLE: Italianate ROOF: Gable  
STRUCTURE: Wood Frame, 2½ WINDOWS: 6/6 Lights  
EXTERIOR: Clapboard  
ORNAMENT: Brackets and cornice returns, round arched  
windows in attic and bay window  
ALTERATIONS: Porch removed on east side

NO. 12 ADDRESS: 67 Talbot Avenue  
PROPERTY/DATE: William H. Glover House, 1873  
ARCH/BLDR: Charles F. Douglas, Lewiston, Architect  
STYLE: Mansard ROOF: Mansard  
STRUCTURE: Wood Frame, 3 WINDOWS: 2/2 Lights  
EXTERIOR: Vinyl siding  
ORNAMENT: Brackets, window caps, dormers, tower,  
portico over entrance  
ALTERATIONS: Siding

NO. 14 ADDRESS: 73 Talbot Avenue  
PROPERTY/DATE: A. F. Ames House, 1874  
ARCH/BLDR: Kimball & Coombs, Lewiston, Architect  
STYLE: Mansard ROOF: Mansard  
STRUCTURE: Wood Frame, 3 WINDOWS: 2/2 Lights  
EXTERIOR: Vinyl siding  
ORNAMENT: Brackets, window caps, dormers, veranda  
with posts.  
ALTERATIONS: Siding, cupola removed

United States Department of the Interior  
National Park Service

National Register of Historic Places  
Inventory—Nomination Form

ROCKLAND RESIDENTIAL HISTORIC DISTRICT

Continuation sheet

Item number

7

Page

2



NO. 15 ADDRESS: 78 Talbot Avenue  
PROPERTY/DATE: Nathaniel Jones House, c. 1860-70  
ARCH/BLDR: Unknown  
STYLE: Italianate ROOF: Hipped  
STRUCTURE: Wood Frame, 2½ WINDOWS: 6/6 Lights  
EXTERIOR: Vinyl siding  
ORNAMENT: Brackets, window caps, segmental arched  
stair window, portico w/paired columns  
ALTERATIONS: Siding

NO. 17 ADDRESS: 84 Talbot Avenue  
PROPERTY/DATE: House, c. 1870-73  
ARCH/BLDR: Unknown  
STYLE: Italianate ROOF: Gable  
STRUCTURE: Wood Frame, 2½ WINDOWS: 2/2 Lights  
EXTERIOR: Clapboard  
ORNAMENT: Wide eaves, brackets, bay windows,  
entrance portico  
ALTERATIONS: N/A

NO. 19 ADDRESS: 89 Talbot Avenue  
PROPERTY/DATE: Leighton House, c. 1890/c. 1920  
ARCH/BLDR: Unknown  
STYLE: Tudor ROOF: Gable  
STRUCTURE: Wood Frame, 2½ WINDOWS: Multi pane  
EXTERIOR: Stucco  
ORNAMENT: Half-timbered walls, gable, portico,  
porte cochere  
ALTERATIONS: N/A

NO. 21 ADDRESS: 45 Summer Street  
PROPERTY/DATE: House, c. 1905  
ARCH/BLDR: Unknown  
STYLE: Colonial Revival ROOF: Hipped  
STRUCTURE: Wood Frame, 2½ WINDOWS: 2/2 Lights  
EXTERIOR: Clapboard  
ORNAMENT: Porch w/roof & deck balustrade, bay  
windows, large single bracket under  
projecting eaves  
ALTERATIONS: N/A

NO. 16 ADDRESS: 81 Talbot Avenue  
PROPERTY/DATE: Charles Berry House, 1899  
ARCH/BLDR: Attributed to Austin Pease, Architect  
STYLE: Colonial Revival ROOF: Hipped  
STRUCTURE: Wood Frame, 2½ WINDOWS: 1/1 Lights  
EXTERIOR: Shingles and clapboards  
ORNAMENT: Large porch and porte cochere, bowed front,  
Palladian stair window, ornamented dormers  
ALTERATIONS: N/A

NO. 18 ADDRESS: 88-90 Talbot Avenue  
PROPERTY/DATE: Gay Double House, 1887  
ARCH/BLDR: William H. Glover & Co., Builders  
STYLE: Queen Anne ROOF: Hipped and gable  
STRUCTURE: Wood Frame, 2½ WINDOWS: 2/2 Lights  
EXTERIOR: Clapboard  
ORNAMENT: Brackets, octagonal bays, decorative fans in  
gable ends, bay windows  
ALTERATIONS: Porch on north enclosed

NO. 20 ADDRESS: 38 Summer Street  
PROPERTY/DATE: House, c. 1897  
ARCH/BLDR: Unknown  
STYLE: Queen Anne ROOF: Gable  
STRUCTURE: Wood Frame, 2½ WINDOWS: 1/1 Lights  
EXTERIOR: Clapboard  
ORNAMENT: Over-hanging gable, oriel window, octagonal  
corner tower, pedimented portico  
ALTERATIONS: 2 story wing with sleeping porch on  
on east side

NO. 22 ADDRESS: 49 Summer Street  
PROPERTY/DATE: Pillsbury House, c. 1840-50  
ARCH/BLDR: Unknown  
STYLE: Greek Revival ROOF: Gable  
STRUCTURE: Wood Frame, 2½ WINDOWS: 6/6 Lights  
EXTERIOR: Clapboard  
ORNAMENT: Corner pilasters and entablature on main  
section and around main entry  
ALTERATIONS: N/A

**United States Department of the Interior  
National Park Service**

**National Register of Historic Places  
Inventory—Nomination Form**

ROCKLAND RESIDENTIAL HISTORIC DISTRICT

Continuation sheet

Item number

7

Page

3



NO. 23 ADDRESS: 50-52 Summer Street  
PROPERTY/DATE: Park House, c. 1875-80  
ARCH/BLDR: Unknown  
STYLE: Greek Rev./Ital. ROOF: Gable  
STRUCTURE: Wood Frame, 2½ WINDOWS: 2/2 Lights  
EXTERIOR: Clapboard  
ORNAMENT: Window & door cornices, round arched  
stairhall & bay windows, dentil under  
cornice  
ALTERATIONS: N/A

NO. 25 ADDRESS: 60 Summer Street  
PROPERTY/DATE: House, between 1855-1865  
ARCH/BLDR: Unknown  
STYLE: Greek Revival ROOF: Gable  
STRUCTURE: Wood Frame, 2½ WINDOWS: 1/1 Lights  
EXTERIOR: Aluminum siding  
ORNAMENT: Cornice returns

ALTERATIONS: Siding, windows replaced

NO. 27 ADDRESS: 63 Summer Street  
PROPERTY/DATE: Fred Berry House, 1887-88  
ARCH/BLDR: W. H. Glover & Co., Builders  
STYLE: Queen Anne ROOF: Gable  
STRUCTURE: Wood Frame, 3½ WINDOWS: 2/2 Lights  
EXTERIOR: Clapboard  
ORNAMENT: Projecting gable ends with oriel  
windows, round corner tower, lunettes,  
bay windows, decorative trim  
ALTERATIONS: Large veranda removed, carriage  
house replaced with small garage

NO. 29 ADDRESS: 73 Summer Street  
PROPERTY/DATE: Hemenway House, 1872  
ARCH/BLDR: Unknown  
STYLE: Greek Revival ROOF: Gable  
STRUCTURE: Wood Frame, 1½ WINDOWS: 2/2 Lights  
EXTERIOR: Vinyl  
ORNAMENT: Cornice returns, sidelights

ALTERATIONS: Vinyl siding, ell re-built

NO. 24 ADDRESS: 55 Summer Street  
PROPERTY/DATE: Amos Williams House  
ARCH/BLDR: George T. Barber, Knoxville, Tennessee  
STYLE: Queen Anne ROOF: Gable and hipped  
STRUCTURE: Wood Frame, 2½ WINDOWS: 1/1 Lights  
EXTERIOR: Clapboard  
ORNAMENT: Oriel window, brackets, vergeboard, Queen  
Anne sash, bay windows, porch posts

ALTERATIONS: Possible reductions and/or enclosures of  
porches

NO. 26 ADDRESS: 62-64 Summer Street  
PROPERTY/DATE: Double House, mid-19<sup>th</sup> century  
ARCH/BLDR: Unknown  
STYLE: Greek Revival ROOF: Gable  
STRUCTURE: Wood Frame, 2½ WINDOWS: 1/1 Lights  
EXTERIOR: N/A  
ORNAMENT: Cornices over windows and doors, dentils  
under eaves

ALTERATIONS: Windows replaced, siding

NO. 28 ADDRESS: 71 Summer Street  
PROPERTY/DATE: George Smith House, 1893  
ARCH/BLDR: William F. Glover & Co., Builders  
STYLE: Queen Anne ROOF: Gable  
STRUCTURE: Wood Frame, 2½ WINDOWS: 2/2 Lights  
EXTERIOR: Clapboard, shingle  
ORNAMENT: Porches with turned posts, novelty siding  
and patterned shingles

ALTERATIONS: N/A

NO. 30 ADDRESS: 79 Summer Street  
PROPERTY/DATE: William Fisk House, 1890  
ARCH/BLDR: Unknown  
STYLE: Italianate ROOF: Gable  
STRUCTURE: Wood Frame, 2½ WINDOWS: 2/2 Lights  
EXTERIOR: Asbestos shingles  
ORNAMENT: Round arched gable windows, Queen Anne  
style porch

ALTERATIONS: Asbestos shingles

United States Department of the Interior  
National Park Service

National Register of Historic Places  
Inventory—Nomination Form

ROCKLAND RESIDENTIAL HISTORIC DISTRICT

Continuation sheet

Item number

7

Page

4



NO. 31 ADDRESS: 81-83 Summer Street  
PROPERTY/DATE: Harrington House, 1889-90  
ARCH/BLDR: William H. Glover & Co., Builders  
STYLE: Queen Anne ROOF: Gable  
STRUCTURE: Wood Frame, 2½ WINDOWS: 2/2 Lights  
EXTERIOR: Clapboard  
ORNAMENT: Gable trim, brackets, bay windows,  
porch with spindle work  
ALTERATIONS: N/A

NO. 33 ADDRESS: 87-89 Summer Street  
PROPERTY/DATE: Weeks Double House, 1889-90  
ARCH/BLDR: J. F. Waterhouse of Rockland, Architect  
STYLE: Queen Anne ROOF: Gable  
STRUCTURE: Wood Frame, 2½ WINDOWS: 2/2 Lights  
EXTERIOR: Clapboard  
ORNAMENT: Porches with turned posts, bay windows,  
decorative trim in gable ends  
ALTERATIONS: N/A

NO. 35 ADDRESS: 92 Summer Street  
PROPERTY/DATE: House, c. 1840-60  
ARCH/BLDR: Unknown  
STYLE: Greek Revival ROOF: Gable  
STRUCTURE: Wood Frame, 1½ WINDOWS: 2/1 Lights  
EXTERIOR: Clapboard  
ORNAMENT: Corner pilasters, entablature  
ALTERATIONS: Portico over main entry, dormers,  
stone foundation c. 1892, when house  
moved

NO. 37 ADDRESS: 5 Beech Street  
PROPERTY/DATE: Edward Butler House, 1888  
ARCH/BLDR: William H. Glover & Co., Builders  
STYLE: Queen Anne ROOF: Hipped  
STRUCTURE: Wood Frame, 2½ WINDOWS: 4/1 Lights  
EXTERIOR: Shingles and clapboards  
ORNAMENT: Shingles second story, octagonal corner  
bay, gable and hipped roof dormers,  
porch over main entrance  
ALTERATIONS: N/A

NO. 32 ADDRESS: 86 Summer Street  
PROPERTY/DATE: Campbell House, c. 18850  
ARCH/BLDR: Unknown  
STYLE: Queen Anne Period ROOF: Gable  
STRUCTURE: Wood Frame, 1½ WINDOWS: 2/2 Lights  
EXTERIOR: Clapboard  
ORNAMENT: Brackets, side porch, decorative fan in  
gable end  
ALTERATIONS: N/A

NO. 34 ADDRESS: 88 Summer Street  
PROPERTY/DATE: Arthur Crockett House, c. 1896  
ARCH/BLDR: Unknown  
STYLE: Queen Anne ROOF: Gable  
STRUCTURE: Wood Frame, 2½ WINDOWS: 2/1 Lights  
EXTERIOR: N/A  
ORNAMENT: Large veranda with turned posts  
ALTERATIONS: N/A

NO. 36 ADDRESS: 93 Summer Street  
PROPERTY/DATE: William Sawtell House, 1889  
ARCH/BLDR: Unknown  
STYLE: Queen Anne ROOF: Gable  
STRUCTURE: Wood Frame, 2½ WINDOWS: 2/2 Lights  
EXTERIOR: Vinyl  
ORNAMENT: Porch with turned posts and brackets  
ALTERATIONS: Upper section of tower removed, siding

NO. 38 ADDRESS: 11 Beech Street  
PROPERTY/DATE: True Pierce House, 1885  
ARCH/BLDR: Unknown  
STYLE: Italianate ROOF: Gable  
STRUCTURE: Wood Frame, 2½ WINDOWS:  
EXTERIOR: Asphalt shingles  
ORNAMENT: Large veranda with brackets, Tuscan  
columns, bay windows  
ALTERATIONS: Siding

**United States Department of the Interior  
National Park Service**

**National Register of Historic Places  
Inventory—Nomination Form**



ROCKLAND RESIDENTIAL HISTORIC DISTRICT  
Continuation sheet

Item number

7

Page

5

NO. 31 ADDRESS: 81-83 Summer Street  
PROPERTY/DATE: Harrington House, 1889-90  
ARCH/BLDR: William H. Glover & Co., Builders  
STYLE: Queen Anne ROOF: Gable  
STRUCTURE: Wood Frame, 2½ WINDOWS: 2/2 Lights  
EXTERIOR: Clapboard  
ORNAMENT: Gable trim, brackets, bay windows,  
porch with spindle work  
ALTERATIONS: N/A

NO. 32 ADDRESS: 86 Summer Street  
PROPERTY/DATE: Campbell House, c. 18850  
ARCH/BLDR: Unknown  
STYLE: Queen Anne Period ROOF: Gable  
STRUCTURE: Wood Frame, 1½ WINDOWS: 2/2 Lights  
EXTERIOR: Clapboard  
ORNAMENT: Brackets, side porch, decorative fan in  
gable end  
ALTERATIONS: N/A

NO. 33 ADDRESS: 87-89 Summer Street  
PROPERTY/DATE: Weeks Double House, 1889-90  
ARCH/BLDR: J. F. Waterhouse of Rockland, Architect  
STYLE: Queen Anne ROOF: Gable  
STRUCTURE: Wood Frame, 2½ WINDOWS: 2/2 Lights  
EXTERIOR: Clapboard  
ORNAMENT: Porches with turned posts, bay windows,  
decorative trim in gable ends  
ALTERATIONS: N/A

NO. 34 ADDRESS: 88 Summer Street  
PROPERTY/DATE: Arthur Crockett House, c. 1896  
ARCH/BLDR: Unknown  
STYLE: Queen Anne ROOF: Gable  
STRUCTURE: Wood Frame, 2½ WINDOWS: 2/1 Lights  
EXTERIOR: N/A  
ORNAMENT: Large veranda with turned posts  
ALTERATIONS: N/A

NO. 35 ADDRESS: 92 Summer Street  
PROPERTY/DATE: House, c. 1840-60  
ARCH/BLDR: Unknown  
STYLE: Greek Revival ROOF: Gable  
STRUCTURE: Wood Frame, 1½ WINDOWS: 2/1 Lights  
EXTERIOR: Clapboard  
ORNAMENT: Corner pilasters, entablature  
ALTERATIONS: Portico over main entry, dormers,  
stone foundation c. 1892, when house  
moved

NO. 36 ADDRESS: 93 Summer Street  
PROPERTY/DATE: William Sawtell House, 1889  
ARCH/BLDR: Unknown  
STYLE: Queen Anne ROOF: Gable  
STRUCTURE: Wood Frame, 2½ WINDOWS: 2/2 Lights  
EXTERIOR: Vinyl  
ORNAMENT: Porch with turned posts and brackets  
ALTERATIONS: Upper section of tower removed, siding

NO. 37 ADDRESS: 5 Beech Street  
PROPERTY/DATE: Edward Butler House, 1888  
ARCH/BLDR: William H. Glover & Co., Builders  
STYLE: Queen Anne ROOF: Hipped  
STRUCTURE: Wood Frame, 2½ WINDOWS: 4/1 Lights  
EXTERIOR: Shingles and clapboards  
ORNAMENT: Shingles second story, octagonal corner  
bay, gable and hipped roof dormers,  
porch over main entrance  
ALTERATIONS: N/A

NO. 38 ADDRESS: 11 Beech Street  
PROPERTY/DATE: True Pierce House, 1885  
ARCH/BLDR: Unknown  
STYLE: Italianate ROOF: Gable  
STRUCTURE: Wood Frame, 2½ WINDOWS:  
EXTERIOR: Asphalt shingles  
ORNAMENT: Large veranda with brackets, Tuscan  
columns, bay windows  
ALTERATIONS: Siding

**United States Department of the Interior  
National Park Service**

**National Register of Historic Places  
Inventory—Nomination Form**



ROCKLAND RESIDENTIAL HISTORIC DISTRICT

Continuation sheet

Item number

7

Page

6

NO. 38 ADDRESS: 15-17 Beech Street  
PROPERTY/DATE: House, c. 1870  
ARCH/BLDR: Unknown  
STYLE: Italianate ROOF: Gable  
STRUCTURE: Wood Frame, 2½ WINDOWS: 2/2 Lights  
EXTERIOR: Vinyl siding  
ORNAMENT: Wide over-hanging eaves supported on brackets, small portico over main entrance, bay window  
ALTERATIONS: Siding

NO. 41 ADDRESS: 29 Beech Street  
PROPERTY/DATE: Nathan Cobb House, 1855-1873  
ARCH/BLDR: Unknown  
STYLE: Italianate ROOF: Gable  
STRUCTURE: Wood Frame, 2½ WINDOWS: 2/2 Lights  
EXTERIOR: Clapboards  
ORNAMENT: Brackets, cornice returns, window caps  
ALTERATIONS: N/A

NO. 43 ADDRESS: 41 Beech Street  
PROPERTY/DATE: Henry Ulmer House, c. 1845-55  
ARCH/BLDR: Unknown  
STYLE: Greek Revival ROOF: Gable  
STRUCTURE: Wood Frame, 2½ WINDOWS:  
EXTERIOR: Vinyl  
ORNAMENT: Cornice returns, cornice over door  
ALTERATIONS: Vinyl siding, garage replaced attached carriage barn

NO. 45 ADDRESS: 45 Beech Street  
PROPERTY/DATE: William O. Fuller House, 1905  
ARCH/BLDR: Unknown  
STYLE: Tudor ROOF: Gable  
STRUCTURE: Stone/Wood Fr. 2½ WINDOWS:  
EXTERIOR: Clapboards, stone  
ORNAMENT: Stylized half-timbered gable ends, stone piers, oriel windows, Palladian stair window  
ALTERATIONS: N/A

NO. 40 ADDRESS: 19 Beech Street  
PROPERTY/DATE: Maynard Bird House, c. 1910  
ARCH/BLDR: Unknown  
STYLE: Shingle style ROOF: Gable  
STRUCTURE: Wood Frame, 2½ WINDOWS: Multi-pane & plate glass  
EXTERIOR: Cedar shingles  
ORNAMENT: Shingle siding, round corner tower, art glass, varied fenestration

ALTERATIONS: Porch reduced in size, early 1920s

NO. 42 ADDRESS: 35 Beech Street  
PROPERTY/DATE: House, c. 1885  
ARCH/BLDR: Unknown  
STYLE: Italianate ROOF: Gable  
STRUCTURE: Wood Frame, 2½ WINDOWS: 2/2 Lights  
EXTERIOR: Vinyl siding  
ORNAMENT: Brackets supporting console over door  
ALTERATIONS: Siding, window trim removed

NO. 44 ADDRESS: 42 Beech Street  
PROPERTY/DATE: Charles Snow House, c. 1850s  
ARCH/BLDR: Unknown  
STYLE: Greek Revival ROOF: Gable  
STRUCTURE: Wood Frame, 2½ WINDOWS: 6/6 Lights  
EXTERIOR: Clapboard  
ORNAMENT: Cornice returns, pilasters and cornice over doorway  
ALTERATIONS: N/A

NO. 46 ADDRESS: 59 Beech Street  
PROPERTY/DATE: Fred Spear House, 1896  
ARCH/BLDR: Unknown  
STYLE: Colonial Revival ROOF: Hipped  
STRUCTURE: Wood Frame, 2½ WINDOWS:  
EXTERIOR: Clapboard  
ORNAMENT: Projecting gable ends, oriel window, bowed facade, porch with pediments, brackets  
ALTERATIONS: Porch enclosed

**United States Department of the Interior  
 National Park Service**

**National Register of Historic Places  
 Inventory—Nomination Form**

ROCKLAND RESIDENTIAL HISTORIC DISTRICT

Continuation sheet

Item number

7

Page

7



NO. 47 ADDRESS: 60 Beech Street  
 PROPERTY/DATE: House, c. 1900  
 ARCH/BLDR: Unknown  
 STYLE: Queen Anne period ROOF: Gable  
 STRUCTURE: Wood Fr. 2½ WINDOWS: 2/1  
 EXTERIOR: Aluminum siding  
 ORNAMENT: Porch with turned posts

ALTERATIONS: Siding

NO. 49 ADDRESS: 66 Beech Street  
 PROPERTY/DATE: House, 1898  
 ARCH/BLDR: Unknown  
 STYLE: Queen Anne period ROOF: Hipped and gable  
 STRUCTURE: Wood Fr. 2½ WINDOWS: 2/2  
 EXTERIOR: Aluminum siding  
 ORNAMENT: Porch with turned posts and decorative  
 balustrade

ALTERATIONS: Siding

NO. 51 ADDRESS: 70 Beech Street  
 PROPERTY/DATE: Old Baptist Parsonage, 1898  
 ARCH/BLDR:  
 STYLE: Colonial Revival ROOF: Hipped  
 STRUCTURE: Wood Fr. 2½ WINDOWS: 1/1  
 EXTERIOR: Clapboards  
 ORNAMENT: Porch with turned posts and modillions,  
 projecting gable end and bay window,  
 wide eaves

ALTERATIONS: N/A

NO. 53 ADDRESS: 74 Beech Street  
 PROPERTY/DATE: P. Willard Pease House, 1909  
 ARCH/BLDR: Keith & White, Architects, Spokane, WA.  
 STYLE: Bungalow ROOF: Gable  
 STRUCTURE: Wood Fr., 1½ WINDOWS:  
 EXTERIOR: Clapboards  
 ORNAMENT: Vergeborad, brackets, porch posts

ALTERATIONS: N/A

NO. 48 ADDRESS: 65 Beech Street  
 PROPERTY/DATE: George Copeland House, 1894  
 ARCH/BLDR: Unknown  
 STYLE: Queen Anne ROOF: Gable  
 STRUCTURE: Wood Frame, 2½ WINDOWS: 2/1  
 EXTERIOR: Clapboard  
 ORNAMENT: Decorative porch, hipped roof dormer, Queen  
 Anne sash

ALTERATIONS: N/A

NO. 50 ADDRESS: 69 Beech Street  
 PROPERTY/DATE: Samuel Burpee House, c. 1897  
 ARCH/BLDR: George F. Barber, Knoxville, Tennessee  
 STYLE: Queen Anne ROOF: Hipped  
 STRUCTURE: Wood Frame, 1½ WINDOWS: 2/1  
 EXTERIOR: Aluminum siding  
 ORNAMENT: Large veranda, octagonal tower, decorative  
 trim in gable ends

ALTERATIONS: Siding

NO. 52 ADDRESS: 73 Beech Street  
 PROPERTY/DATE: Veazie-Moran House, 1895-1897  
 ARCH/BLDR: Unknown  
 STYLE: Queen Anne period ROOF: Gable  
 STRUCTURE: Wood Frame, 2½ WINDOWS: 2/2  
 EXTERIOR: Clapboards  
 ORNAMENT: Large veranda and rear porch with turned  
 posts and brackets, pedimented gable ends

ALTERATIONS: N/A

NO. 54 ADDRESS: 77 Beech Street  
 PROPERTY/DATE: Gardner House, c. 1910-20  
 ARCH/BLDR: Unknown  
 STYLE: Bungalow ROOF: Gable  
 STRUCTURE: Wood Frame, 1½ WINDOWS: Multi-pane  
 EXTERIOR: Cedar shingles  
 ORNAMENT: Windows

ALTERATIONS: N/A

United States Department of the Interior  
National Park Service

National Register of Historic Places  
Inventory—Nomination Form



ROCKLAND RESIDENTIAL HISTORIC DISTRICT

Continuation sheet

Item number

7

Page

8

NO. 55 ADDRESS: 9 Lincoln Street  
PROPERTY/DATE: Martin Labe House, c. 1893  
ARCH/BLDR: Unknown  
STYLE: Queen Anne period ROOF: Gable  
STRUCTURE: Wood Fr., 1½ WINDOWS: 2/2  
EXTERIOR: Vinyl  
ORNAMENT: Portico with turned posts and brackets  
ALTERATIONS: Siding

NO. 57 ADDRESS: 16 Lincoln Street  
PROPERTY/DATE: William Hill House, 1889/93  
ARCH/BLDR: W. H. Glover & Co., Builders  
STYLE: Queen Anne ROOF: Hipped  
STRUCTURE: Wood Frame 2½ WINDOWS:  
EXTERIOR: Aluminum siding  
ORNAMENT: Octagonal corner tower, balustrade on  
roof peak, large veranda with turned  
posted balustrade  
ALTERATIONS: Siding

NO. 59 ADDRESS: 40 Lincoln Street  
PROPERTY/DATE: McLain Grammar School, 1892  
ARCH/BLDR: Elmer I. Thomas, Lewiston  
STYLE: Romanesque ROOF: Hipped  
STRUCTURE: Brick WINDOWS: Alum. combo  
EXTERIOR: Brick  
ORNAMENT: Large Syrian entry arch, small entry  
arch for rear wing, flat arched lintels  
ALTERATIONS: Windows replaced

NO. 61 ADDRESS: 62 Limerock Street  
PROPERTY/DATE: Knox County Jail, 1892  
ARCH/BLDR: Pauley Jail Co., Cleveland, Ohio  
STYLE: Romanesque ROOF: Gable  
STRUCTURE: Brick WINDOWS: 4/4  
EXTERIOR: Brick  
ORNAMENT: Round arched windows, stair tower,  
brick belt courses, entrance portico,  
stone capping  
ALTERATIONS: N/A

NO. 56 ADDRESS: 12 Lincoln Street  
PROPERTY/DATE: Eugene Stubbs House, 1888  
ARCH/BLDR: William H. Glover & Co., Builder  
STYLE: Queen Anne ROOF: Gable  
STRUCTURE: Wood Frame, 2½ WINDOWS:  
EXTERIOR: Aluminum siding  
ORNAMENT: Corner bay, porch with decorative trim in  
pediment  
ALTERATIONS: Siding, porch posts replaced with iron

NO. 58 ADDRESS: 38 Lincoln Street  
PROPERTY/DATE: Rockland Jr. High School, 1929  
ARCH/BLDR: Bunker & Savage, Augusta  
STYLE: Neo-classical ROOF: Flat with parapet  
STRUCTURE: Brick, steel WINDOWS: Aluminum combo  
EXTERIOR: Brick and stone trim  
ORNAMENT: Brick parapet, granite portico, decorative  
modillions  
ALTERATIONS: Windows replaced

NO. 60 ADDRESS: 44 Limerock Street  
PROPERTY/DATE: Community Building, 1936  
ARCH/BLDR: Unknown  
STYLE: Art Deco ROOF: Flat  
STRUCTURE: Brick, steel WINDOWS:  
EXTERIOR: Brick, cast stone  
ORNAMENT: Polygonal center section and porch, cast  
stone parapet, multi-light sash  
ALTERATIONS: N/A

NO. 62 ADDRESS: 76 Limerock Street  
PROPERTY/DATE: Dr. Soule House, c. 1927  
ARCH/BLDR: Unknown  
STYLE: Colonial Revival ROOF: Gable  
STRUCTURE: Wood Frame, 2½ WINDOWS: 6/6  
EXTERIOR: Aluminum siding  
ORNAMENT: N/A  
ALTERATIONS: Siding

**United States Department of the Interior  
National Park Service**

**National Register of Historic Places  
Inventory—Nomination Form**

ROCKLAND RESIDENTIAL HISTORIC DISTRICT

Continuation sheet

Item number

7

Page

9

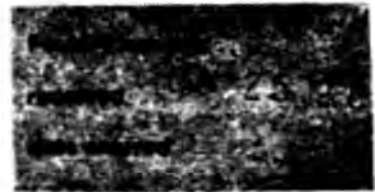

NO. 63 ADDRESS: 82 Limerock Street  
PROPERTY/DATE: Hyde House, c. 1875  
ARCH/BLDR: Unknown  
STYLE: Greek Revival ROOF: Gable  
STRUCTURE: Wood Frame, 2½ WINDOWS: 2/2  
EXTERIOR: Clapboard  
ORNAMENT: Corner pilasters, dentils, cornice  
returns  
ALTERATIONS: Enclosed porch on rear

NO. 65 ADDRESS: 88 Limerock Street  
PROPERTY/DATE: Genthner House, c. 1840-55  
ARCH/BLDR: Unknown  
STYLE: Greek Revival ROOF: Gable  
STRUCTURE: Wood Frame, 1½ WINDOWS: 2/2  
EXTERIOR: Clapboard  
ORNAMENT: Pilasters, cornice, sidelights around  
door, cornice returns  
ALTERATIONS: Enclosed porch and second story on  
east side

NO. 67 ADDRESS: 100 Limerock Street  
PROPERTY/DATE: Frank Lamb House, 1888  
ARCH/BLDR: W. H. Glover & Co., Builders  
STYLE: Queen Anne ROOF: Gable  
STRUCTURE: Wood Frame, 2½ WINDOWS: 2/2  
EXTERIOR: Clapboard  
ORNAMENT: Dormer, gable end, porch with decorative  
woodwork, cornice with brackets, window  
caps  
ALTERATIONS: N/A

NO. 69 ADDRESS: 104 Limerock Street  
PROPERTY/DATE: G. A. R. Hall, c. 1900  
ARCH/BLDR: Unknown  
STYLE: Queen Anne ROOF: Hipped  
STRUCTURE: Wood Frame, 2 WINDOWS: 2/2  
EXTERIOR: Asbestos shingles  
ORNAMENT: Two bay windows, porch with posts,  
balustrade, frieze  
ALTERATIONS: Shingles

NO. 64 ADDRESS: 87 Limerock Street  
PROPERTY/DATE: Howard House, c. 1850-55  
ARCH/BLDR: Unknown  
STYLE: Greek Revival ROOF: Gable  
STRUCTURE: Wood Frame, 2½ WINDOWS: 2/1  
EXTERIOR: Clapboard  
ORNAMENT: N/A

ALTERATIONS: Enclosed porches on front and side,  
large dormers on front

NO. 66 ADDRESS: 96 Limerock Street  
PROPERTY/DATE: Charles E. Littlefield House, 1890  
ARCH/BLDR: E. E. Lewis, Gardiner, Architect  
STYLE: Queen Anne ROOF: Hipped, gable  
STRUCTURE: Wood Frame, 1½ WINDOWS: 2/2  
EXTERIOR: Clapboard  
ORNAMENT: Large veranda with balustrade and spindle-  
work, round corner tower with conical roof,  
novelty siding  
ALTERATIONS: Corner tower added early 1900s

NO. 68 ADDRESS: 101 Limerock Street  
PROPERTY/DATE: House, c. 1840-55  
ARCH/BLDR: Unknown  
STYLE: Greek Revival ROOF: Gable  
STRUCTURE: Wood Frame, 1½ WINDOWS: 2/2  
EXTERIOR: Clapboard  
ORNAMENT: Cornice returns, brackets over door  
ALTERATIONS: Porch added on rear wing

NO. 70 ADDRESS: 105 Limerock Street  
PROPERTY/DATE: H. Hatch House, c. 1840-55  
ARCH/BLDR: Unknown  
STYLE: Greek Revival ROOF: Gable  
STRUCTURE: Wood Frame, 1½ WINDOWS: 2/1  
EXTERIOR: Clapboard  
ORNAMENT: N/A  
ALTERATIONS: Large dormers, enclosed porch, enclosed  
vestibule

**United States Department of the Interior  
 National Park Service  
 National Register of Historic Places  
 Inventory—Nomination Form**



ROCKLAND RESIDENTIAL HISTORIC DISTRICT  
 Continuation sheet

Item number 7 Page 10

NO. 71 ADDRESS: 107 Limerock Street  
 PROPERTY/DATE: Nathan Allen House, 1910-11  
 ARCH/BLDR: Freeman Stanley, Rockland  
 STYLE: Arts and Crafts ROOF: Gable  
 STRUCTURE: Wood Frame, 1½ WINDOWS: Multi-pane  
 EXTERIOR: Clapboard  
 ORNAMENT: Over-hanging eaves with exposed rafters,  
 porch posts with seralled consoles,  
 casement windows  
 ALTERATIONS: N/A

NO. 73 ADDRESS: 111 Limerock Street  
 PROPERTY/DATE: Burnham House, c. 1850s0-11  
 ARCH/BLDR: Unknown  
 STYLE: Italianate ROOF: Gable  
 STRUCTURE: Wood Frame, 2½ WINDOWS: 2/2, 1/1  
 EXTERIOR: Aluminum siding  
 ORNAMENT: Central pavilion, brackets under  
 cornices  
 ALTERATIONS: Siding, building moved to site in  
 1890

NO. 75 ADDRESS: 119-123 Limerock Street  
 PROPERTY/DATE: Apartment House, c. 1895-11  
 ARCH/BLDR: Unknown  
 STYLE: N/A ROOF: Gable  
 STRUCTURE: Wood Frame, 2½ WINDOWS: 2/1  
 EXTERIOR: Aluminum siding  
 ORNAMENT: Bay windows  
 ALTERATIONS: Siding, porch added, one story wing  
 on west side

NO. 77 ADDRESS: 129 Limerock Street  
 PROPERTY/DATE: Arthur Roak House, between 1931-35  
 ARCH/BLDR: Freeman Stanley, Rockland, Architect  
 STYLE: Arts and Crafts ROOF: Gable  
 STRUCTURE: Wood Frame, 1½ WINDOWS: 4 Vert. over 1  
 EXTERIOR: Clapboard  
 ORNAMENT: Wide eaves with exposed rafters, square  
 porch, posts and balustrade, decorative  
 windows  
 ALTERATIONS: N/A

NO. 72 ADDRESS: 110 Limerock Street  
 PROPERTY/DATE: Woodbridge-Blockington House, c. 1865  
 ARCH/BLDR: Unknown  
 STYLE: Italianate ROOF: Gable  
 STRUCTURE: Wood Frame, 2½ WINDOWS: 6/6  
 EXTERIOR: Aluminum siding  
 ORNAMENT: Brackets, dentils, quoins, window caps,  
 portico  
 ALTERATIONS: Siding

NO. 74 ADDRESS: 117 Limerock Street  
 PROPERTY/DATE: Frank Whitney House, c. 1895  
 ARCH/BLDR: Unknown  
 STYLE: Queen Anne ROOF: Gable  
 STRUCTURE: Wood Frame, 2½ WINDOWS: 2/2  
 EXTERIOR: Aluminum siding  
 ORNAMENT: Bay windows, porch with turned post and  
 decorative balustrade  
 ALTERATIONS: Siding

NO. 76 ADDRESS: 125 Limerock Street  
 PROPERTY/DATE: Guy Douglas House, by 1931  
 ARCH/BLDR: Freeman Stanley of Rockland, Architect  
 STYLE: Colonial Revival ROOF: Hipped  
 STRUCTURE: Wood Frame, 2 WINDOWS: 6/1  
 EXTERIOR: Aluminum siding  
 ORNAMENT: Wide eaves with modillions, porch with  
 Tuscan columns  
 ALTERATIONS: Siding

NO. 78 ADDRESS: 131 Limerock Street  
 PROPERTY/DATE: Richard Lufkin House, by 1931  
 ARCH/BLDR: Freeman Stanley of Rockland, Architect  
 STYLE: N/A ROOF: Hipped  
 STRUCTURE: Wood Frame, 1 WINDOWS: 6/6  
 EXTERIOR: Cedar shingling  
 ORNAMENT: Entrance portico with columns and pediment  
 ALTERATIONS: N/A

**United States Department of the Interior  
National Park Service**

**National Register of Historic Places  
Inventory—Nomination Form**

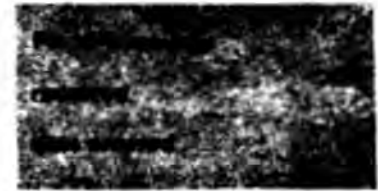

ROCKLAND RESIDENTIAL HISTORIC DISTRICT

Continuation sheet

Item number

7

Page

11

NO. 73 ADDRESS: 9 Masonic Street  
PROPERTY/DATE: Francis Case House, c. 1870  
ARCH/BLDR: Unknown  
STYLE: Greek Revival ROOF: Gable  
STRUCTURE: Wood Frame, 2½ WINDOWS: 6/6

EXTERIOR: Aluminum siding  
ORNAMENT: Cornice returns, mouldings around main  
entrance  
ALTERATIONS: Bay window added to east, one story  
wing added to north, mid-20th century

NO. 81 ADDRESS: 17 Masonic Street  
PROPERTY/DATE: Edward Ingraham House  
ARCH/BLDR: Unknown  
STYLE: Queen Anne ROOF: Hipped  
STRUCTURE: Wood Frame, 2½ WINDOWS:  
EXTERIOR: Asphalt shingles  
ORNAMENT: Projecting corner bay, vergeboard, porch  
with turned posts  
ALTERATIONS: Shingles, porch balusters removed

NO. 83 ADDRESS: 25 Masonic Street  
PROPERTY/DATE: House, c. 1840-55  
ARCH/BLDR: Unknown  
STYLE: Greek Revival ROOF: Gable  
STRUCTURE: Wood Frame, 1½ WINDOWS: 2/1  
EXTERIOR: Aluminum siding  
ORNAMENT: Cornice returns, cornice and sidelights  
around door  
ALTERATIONS: Siding

NO. 85 ADDRESS: 41 Masonic Street  
PROPERTY/DATE: House, c. 1840-50  
ARCH/BLDR: Unknown  
STYLE: Greek Revival ROOF: Gable  
STRUCTURE: Wood Frame, 1½ WINDOWS: 6/6  
EXTERIOR: Aluminum siding  
ORNAMENT: Cornice returns and door mouldings  
ALTERATIONS: Siding

NO. 80 ADDRESS: 11 Masonic Street  
PROPERTY/DATE: Ingraham House, c. 1865  
ARCH/BLDR: Unknown  
STYLE: Mansard ROOF: Mansard  
STRUCTURE: Wood Frame, 2 WINDOWS: 4/4

EXTERIOR: Aluminum siding  
ORNAMENT: Segmental arched dormers, round arched  
windows with brackets in bay window  
ALTERATIONS: Porch enclosed, carriage house doors  
replaced with garage doors

NO. 82 ADDRESS: 21 Masonic Street  
PROPERTY/DATE: Walter Wood House, 1865-1873  
ARCH/BLDR: Unknown  
STYLE: Italianate ROOF: Gable  
STRUCTURE: Wood Frame, 2½ WINDOWS: 6/6  
EXTERIOR: Clapboard  
ORNAMENT: Window caps, round-arched frieze, cornice  
returns, round arched window in gable end  
ALTERATIONS: N/A

NO. 84 ADDRESS: 31 Masonic Street  
PROPERTY/DATE: Brainard House, between 1873-77  
ARCH/BLDR: Attributed to W. H. Glover, Builder  
STYLE: Italianate ROOF: Hipped  
STRUCTURE: Wood Frame, 2½ WINDOWS: 2/2  
EXTERIOR: Clapboards  
ORNAMENT: Paired brackets, cupola, bay window, porch  
central pavilion  
ALTERATIONS: N/A

NO. 86 ADDRESS: 45 Masonic Street  
PROPERTY/DATE: Stephen Gould House, c. 1850-55  
ARCH/BLDR: Unknown  
STYLE: Italianate ROOF: Gable  
STRUCTURE: Wood Frame, 2½ WINDOWS: 6/6  
EXTERIOR: Clapboards  
ORNAMENT: Cornice returns, window and door caps  
ALTERATIONS: N/A

United States Department of the Interior  
National Park Service

National Register of Historic Places  
Inventory—Nomination Form



ROCKLAND RESIDENTIAL HISTORIC DISTRICT  
Continuation sheet

Item number 7 Page 12

NO. 87 ADDRESS: 47 Masonic Street  
PROPERTY/DATE: Russell B. Miller House, 1886  
ARCH/BLDR: W. H. Glover & Co., Builders  
STYLE: Queen Anne ROOF: Gable  
STRUCTURE: Wood Frame, 2½ WINDOWS:  
EXTERIOR: Cedar shingles  
ORNAMENT: Corner tower, large veranda with turned  
columns, brackets, bay window  
ALTERATIONS: Shingles over siding

NO. 89 ADDRESS: 55 Masonic Street  
PROPERTY/DATE: Edwin Lawry House, c. 1865-75/1888  
ARCH/BLDR: Unknown  
STYLE: Queen Anne ROOF: Gable  
STRUCTURE: Wood Frame, 2½ WINDOWS: 1/1  
EXTERIOR: Aluminum siding  
ORNAMENT: Larger corner tower  
ALTERATIONS: Two story addition and tower, 1888,  
siding, portico removed, windows  
replaced

NO. 91 ADDRESS: 63 Masonic Street  
PROPERTY/DATE: George Kaler House, between 1873-77  
ARCH/BLDR: Attributed to W. H. Glover & Co., Bldrs.  
STYLE: Italianate ROOF: Hipped  
STRUCTURE: Wood Frame, 2 WINDOWS: 2/2  
EXTERIOR: Clapboard  
ORNAMENT: Cupola, brackets, window caps, central  
pavilion  
ALTERATIONS: N/A

NO. 93 ADDRESS: 9 White Street  
PROPERTY/DATE: St. Peters' Episcopal Church,  
1883-84/1891  
ARCH/BLDR: William Ralph Emerson, Boston, Architect  
STYLE: Shingle Style ROOF: Gable  
STRUCTURE: Wood Frame, 1½ WINDOWS: Diamond-pane  
EXTERIOR: Shingles  
ORNAMENT: Shingle siding, stylized gables, dormer  
ALTERATIONS: N/A

NO. 89 ADDRESS: 51 Masonic Street  
PROPERTY/DATE: Gilbert Atherton House, c. 1876  
ARCH/BLDR: Unknown  
STYLE: Vernacular ROOF: Gable  
STRUCTURE: Wood Frame, 1½ WINDOWS: 5/6  
EXTERIOR: Aluminum siding  
ORNAMENT: N/A  
ALTERATIONS: Siding, picture window

NO. 90 ADDRESS: 59 Masonic Street  
PROPERTY/DATE: Charles Wood House, between 1873-87  
ARCH/BLDR: Attributed to W. H. Glover & Co., Builders  
STYLE: Italianate ROOF: Hipped  
STRUCTURE: Wood Frame, 2½ WINDOWS: 2/2  
EXTERIOR: Clapboards  
ORNAMENT: Cupola, brackets, window caps, portico,  
bay window, central pavilion  
ALTERATIONS: N/A

NO. 92 ADDRESS: 67 Masonic Street  
PROPERTY/DATE: Edward K. Glover Hse., between 1877-82  
ARCH/BLDR: Attributed to W. H. Glover & Co., Builders  
STYLE: Italianate ROOF: Hipped  
STRUCTURE: Wood Frame, 2 WINDOWS: 2/2  
EXTERIOR: Clapboards  
ORNAMENT: Brackets, cupola, portico, central pavilion,  
dentils, window caps, bay window  
ALTERATIONS: N/A

NO. 94 ADDRESS: (No Number) White Street  
PROPERTY/DATE: Bole Nurses Home, 1928  
ARCH/BLDR: Unknown  
STYLE: Georgian Revival ROOF: Gable  
STRUCTURE: Masonry, 2½ WINDOWS: 8/12  
EXTERIOR: Brick  
ORNAMENT: Pedimented gable ends, quoins, pediment over  
entrance, stone trim, lunettes  
ALTERATIONS: N/A

United States Department of the Interior  
National Park Service

National Register of Historic Places  
Inventory—Nomination Form

ROCKLAND RESIDENTIAL HISTORIC DISTRICT

Continuation sheet

Item number

7

Page

13



NO. 95 ADDRESS: 1 Walker Place  
PROPERTY/DATE: George McLaughlin House, c. 1895  
ARCH/BLDR: Unknown  
STYLE: Queen Anne period ROOF: Gable  
STRUCTURE: Wood Frame, 1½ WINDOWS: 1/1  
EXTERIOR: Clapboard  
ORNAMENT: Portico over entrance

ALTERATIONS: N/A

NO. 97 ADDRESS: 5 Walker Place  
PROPERTY/DATE: Rev. John Moody House, 1892  
ARCH/BLDR: Unknown  
STYLE: Queen Anne ROOF: Gable  
STRUCTURE: Wood Frame, 2½ WINDOWS: 2/1  
EXTERIOR: Aluminum siding  
ORNAMENT: N/A

ALTERATIONS: Siding

NO. 99 ADDRESS: 11 Maple Street  
PROPERTY/DATE: Spear House, c. 1845-55c. 1894  
ARCH/BLDR: Unknown  
STYLE: Greek Revival ROOF: Gable  
STRUCTURE: Wood Frame, 2½ WINDOWS: 6/6  
EXTERIOR: Clapboards  
ORNAMENT: Cornic returns, window caps

ALTERATIONS: N/A

NO. 101 ADDRESS: 18 Maple Street  
PROPERTY/DATE: House, c. 1875  
ARCH/BLDR: Unknown  
STYLE: Greek Revival ROOF: Gable  
STRUCTURE: Wood Frame, 2½ WINDOWS: 2/2  
EXTERIOR: Clapboards  
ORNAMENT: Cornice returns, window and door caps  
ALTERATIONS: N/A

NO. 103 ADDRESS: 24 Maple Street  
PROPERTY/DATE: House, c. 1898  
ARCH/BLDR: Unknown  
STYLE: N/A ROOF: Gable  
STRUCTURE: Wood Frame, 1½ WINDOWS:  
EXTERIOR: Clapboards  
ORNAMENT: Stained Glass picture window

ALTERATIONS: N/A

NO. 96 ADDRESS: 3 Walker Place  
PROPERTY/DATE: Alden Hayden House, 1894  
ARCH/BLDR: Unknown  
STYLE: Queen Anne ROOF: Gable  
STRUCTURE: Masonry, 2½ WINDOWS: 1/1  
EXTERIOR: Aluminum siding  
ORNAMENT: Porch with turned posts, balustrade and spindle-work

ALTERATIONS: Siding

NO. 98 ADDRESS: 2-6 Maple Street  
PROPERTY/DATE: Knox Co. Gen. Hosp., 1916 w/additions  
ARCH/BLDR: R. Clipston Sturgis of Boston  
STYLE: Georgian Revival ROOF: Gable, hipped  
STRUCTURE: Masonry, 2½ WINDOWS: Multi-pane  
EXTERIOR: Brick  
ORNAMENT: Pedimented gable ends with round arched windows

ALTERATIONS: Wings added: 1922, 1928, 1959, 1969

NO. 100 ADDRESS: 17 Maple Street  
PROPERTY/DATE: House, c. 1840  
ARCH/BLDR: Unknown  
STYLE: Queen Anne ROOF: Gable  
STRUCTURE: Wood Frame, 2½ WINDOWS: 2/1  
EXTERIOR: Clapboards  
ORNAMENT: Two porches with turned posts, balustrade, spindle-work

ALTERATIONS: N/A

NO. 102 ADDRESS: 20-22 Maple Street  
PROPERTY/DATE: Dr. Fuller Cook House, between 1855-73  
ARCH/BLDR: Unknown  
STYLE: Greek Revival ROOF: Gable  
STRUCTURE: Wood Frame, 1½ WINDOWS: 6/6  
EXTERIOR: Clapboards  
ORNAMENT: Entrance vestibule, cornice returns  
ALTERATIONS: N/A

NO. 104 ADDRESS: 23-25 Maple Street  
PROPERTY/DATE: Bird Tenement, c. 1900  
ARCH/BLDR: Unknown  
STYLE: Tudor ROOF: Gable  
STRUCTURE: Wood Frame, 2½ WINDOWS: 1/1  
EXTERIOR: Shingles, clapboards  
ORNAMENT: Second story over-hang with joist ends, oriel windows, battens in gable ends, porch with posts and balustrade

ALTERATIONS: N/A

**United States Department of the Interior  
National Park Service**

**National Register of Historic Places  
Inventory—Nomination Form**

ROCKLAND RESIDENTIAL HISTORIC DISTRICT

Continuation sheet

Item number

7

Page

14

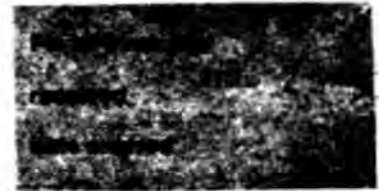

NO. 105 ADDRESS: 7-9 Grove Street  
PROPERTY/DATE: House, between 1855-1875  
ARCH/BLDR: Unknown  
STYLE: Greek Revival ROOF: Gable  
STRUCTURE: Wood Frame, 1½ WINDOWS: 6/6  
EXTERIOR: Clapboards  
ORNAMENT: Corner pilasters, entablature and  
pilasters around door  
ALTERATIONS: Late 19th century wings removed

NO. 107 ADDRESS: 12 Grove Street  
PROPERTY/DATE: House, c. 1845-55  
ARCH/BLDR: Unknown  
STYLE: Gothic Revival ROOF: Gable  
STRUCTURE: Wood Frame, 1½ WINDOWS: 6/6  
EXTERIOR: Clapboards  
ORNAMENT: Vergeboard  
ALTERATIONS: Dormer additions on wing

NO. 109 ADDRESS: 15 Grove Street  
PROPERTY/DATE: House, c. 1820  
ARCH/BLDR: Att. to Freeman Stanley, Rockland, Arch.  
STYLE: Bungalow ROOF: Gable  
STRUCTURE: Wood Frame, 1½ WINDOWS: Ribbon windows  
EXTERIOR: Aluminum siding  
ORNAMENT: Porch with large posts and balustrade,  
wide eaves and vergeboard  
ALTERATIONS: Siding

NO. 111 ADDRESS: 18 Grove Street  
PROPERTY/DATE: Samuel Magridge House, c. 1875  
ARCH/BLDR: Unknown  
STYLE: Greek Revival ROOF: Gable  
STRUCTURE: Wood Frame, 2½ WINDOWS: 2/1  
EXTERIOR: Clapboard  
ORNAMENT: Cornice returns, brackets  
ALTERATIONS: Siding

NO. 113 ADDRESS: 22 Grove Street  
PROPERTY/DATE: A. J. Pierce House, c. 1850-55  
ARCH/BLDR: Unknown  
STYLE: Italianate ROOF: Gable  
STRUCTURE: Wood Frame, 2½ WINDOWS: 2/1  
EXTERIOR: Asbestos shingles  
ORNAMENT: Brackets, round arched bay windows  
ALTERATIONS: Siding, porch removed

NO. 106 ADDRESS: 11 Grove Street  
PROPERTY/DATE: House, mid-19th century  
ARCH/BLDR: Unknown  
STYLE: Greek Revival ROOF: Gable  
STRUCTURE: Wood Frame, 1½ WINDOWS: 1/1  
EXTERIOR: Clapboards  
ORNAMENT: Cornice returns  
ALTERATIONS: Enclosed porch and large dormer, east side

NO. 108 ADDRESS: 14 Grove Street  
PROPERTY/DATE: House, c. 1850-55  
ARCH/BLDR: Unknown  
STYLE: N/A ROOF: Gable  
STRUCTURE: Wood Frame, 1½ WINDOWS: 1/1  
EXTERIOR: Clapboards  
ORNAMENT: N/A  
ALTERATIONS: Porch posts and railing removed

NO. 111 ADDRESS: 17 Grove Street  
PROPERTY/DATE: Peck House, c. 1845-1855  
ARCH/BLDR: Unknown  
STYLE: Greek Revival ROOF: Gable  
STRUCTURE: Wood Frame, 2½ WINDOWS: 2/2  
EXTERIOR: Clapboards  
ORNAMENT: Pedimented gable end, bay window  
ALTERATIONS: N/A

NO. 112 ADDRESS: 19-21 Grove Street  
PROPERTY/DATE: J. D. May Tenement, 1893  
ARCH/BLDR: Austin Pease, Portland, Architect  
STYLE: Colonial Revival ROOF: Hipped, gambrel  
STRUCTURE: Wood Frame, 2½ WINDOWS: 2/1  
EXTERIOR: Clapboards  
ORNAMENT: Bay windows, gambrel roof pavilion, novelty  
siding  
ALTERATIONS: Porch posts and railing removed

NO. 114 ADDRESS: 25 Grove Street  
PROPERTY/DATE: John D. May House, 1889  
ARCH/BLDR: J. F. Waterhouse of Rockland, Architect  
STYLE: Queen Anne ROOF: Hipped  
STRUCTURE: Wood Frame, 2½ WINDOWS: Unknown  
EXTERIOR: Clapboards  
ORNAMENT: Large veranda with turned posts and  
balustrade, pedimented gable ends with  
Queen Anne sash  
ALTERATIONS: N/A

**United States Department of the Interior  
National Park Service**

**National Register of Historic Places  
Inventory—Nomination Form**



ROCKLAND RESIDENTIAL HISTORIC DISTRICT

Continuation sheet

Item number

7

Page

15

NO. 115 ADDRESS: 26 Grove Street  
PROPERTY/DATE: House, c. 1845-55  
ARCH/BLDR: Unknown  
STYLE: Greek Revival ROOF: Gable  
STRUCTURE: Wood Frame, 1½ WINDOWS: 6/6  
EXTERIOR: Vinyl siding  
ORNAMENT: Cornice and sidelights around door  
ALTERATIONS: Siding

NO. 117 ADDRESS: 33 Grove Street  
PROPERTY/DATE: Albert McLeon House, c. 1898  
ARCH/BLDR: Unknown  
STYLE: Queen Anne ROOF: Hipped, gable  
STRUCTURE: Wood Frame, 2½ WINDOWS: 2/2  
EXTERIOR: Asbestos shingle  
ORNAMENT: Large veranda with turned posts,  
balustrade and spindle-work, pedimented  
gable ends  
ALTERATIONS: Siding

NO. 119 ADDRESS: 39 Grove Street  
PROPERTY/DATE: Keene House, c. 1850-55  
ARCH/BLDR: Unknown  
STYLE: Greek Revival ROOF: Gable  
STRUCTURE: Wood Frame, 2½ WINDOWS: 6/6  
EXTERIOR: Aluminum siding  
ORNAMENT: Window caps, entablatures over doorway  
ALTERATIONS: Siding

NO. 121 ADDRESS: 45 Grove Street  
PROPERTY/DATE: House, c. 1860-70  
ARCH/BLDR: Unknown  
STYLE: N/A ROOF: Gable  
STRUCTURE: Wood Frame, 2½ WINDOWS: 6/6  
EXTERIOR: Aluminum siding  
ORNAMENT: Window and door caps  
ALTERATIONS: Siding

NO. 123 ADDRESS: 75 Broad Street  
PROPERTY/DATE: House, c. 1875  
ARCH/BLDR: Unknown  
STYLE: Italianate ROOF: Gable  
STRUCTURE: Wood Frame, 2½ WINDOWS: 2/2  
EXTERIOR: Clapboards  
ORNAMENT: Brackets under cornice, window and door  
caps  
ALTERATIONS: N/A

NO. 116 ADDRESS: 30-32 Grove Street  
PROPERTY/DATE: House, between 1855-1873  
ARCH/BLDR: Unknown  
STYLE: Greek Revival ROOF: Gable  
STRUCTURE: Wood Frame, 2½ WINDOWS: 2/2  
EXTERIOR: Clapboards  
ORNAMENT: Dentils under cornice  
ALTERATIONS: Porch enclosed

NO. 118 ADDRESS: 36 Grove Street  
PROPERTY/DATE: House, c. 1860-70  
ARCH/BLDR: Unknown  
STYLE: N/A ROOF: Gable  
STRUCTURE: Wood Frame, 2½ WINDOWS: 2/2  
EXTERIOR: Clapboards  
ORNAMENT: Cornice over door  
ALTERATIONS: N/A

NO. 120 ADDRESS: 40 Grove Street  
PROPERTY/DATE: House, c. 1850-55  
ARCH/BLDR: Unknown  
STYLE: Greek Revival ROOF: Gable  
STRUCTURE: Wood Frame, 2½ WINDOWS: 6/6  
EXTERIOR: Aluminum siding  
ORNAMENT: N/A  
ALTERATIONS: Siding

NO. 122 ADDRESS: 69 Broad Street  
PROPERTY/DATE: William A. Glover House, c. 1920  
ARCH/BLDR: W. H. Glover & Co., Builders  
STYLE: Colonial Revival ROOF: Hipped, gambrel  
STRUCTURE: Wood Frame, 2 WINDOWS: 6/1, paired  
EXTERIOR: Clapboard  
ORNAMENT: Porch with Tuscan columns, gambrel roof  
central pavilion, wide eaves  
ALTERATIONS: N/A

NO. 124 ADDRESS: 77-79 Broad Street  
PROPERTY/DATE: Double House, c. 1875  
ARCH/BLDR: Unknown  
STYLE: Italianate ROOF: Gable  
STRUCTURE: Wood Frame, 1½ WINDOWS: 6/6  
EXTERIOR: Vinyl siding  
ORNAMENT: Dentils, round arched attic windows  
ALTERATIONS: Siding

**United States Department of the Interior  
 National Park Service**

**National Register of Historic Places  
 Inventory—Nomination Form**

ROCKLAND RESIDENTIAL HISTORIC DISTRICT

Continuation sheet

Item number

7

Page

16



NO. 125 ADDRESS: Union Street  
 PROPERTY/DATE: Rockland Public Library, 1903 (NR)  
 ARCH/BLDR: George Clough of Boston  
 STYLE: Renaissance ROOF: Gable  
 STRUCTURE: Masonry, 1½ WINDOWS: Multi-pane  
 EXTERIOR: Stone  
 ORNAMENT: Pedimented central pavilion with columns  
 in antis and large lunette; polygonal  
 reading room with pilasters  
 ALTERATIONS: N/A

NO. 127 ADDRESS: 2 Claremont Street  
 PROPERTY/DATE: E. F. Glover House, 1917-1921  
 ARCH/BLDR: E. F. Glover, architect  
 STYLE: Colonial Revival ROOF: Gambrel  
 STRUCTURE: Wood Frame, 2 WINDOWS: 6/6  
 EXTERIOR: Cedar shingles  
 ORNAMENT: Enclosed porches with balustrades at  
 each gable end, classical portico over  
 entry, door with sidelights and lunette  
 ALTERATIONS: N/A

NO. 129 ADDRESS: 10 Claremont Street  
 PROPERTY/DATE: Horatio Keene House, bet. 1873-77  
 ARCH/BLDR: Unknown  
 STYLE: Mansard ROOF: Mansard  
 STRUCTURE: Wood Frame, 3 WINDOWS: 2/2  
 EXTERIOR: Clapboard  
 ORNAMENT: Dormers with gable roofs, double porches,  
 cornices, and window caps with brackets  
 ALTERATIONS: N/A

NO. 131 ADDRESS: 13 Claremont Street  
 PROPERTY/DATE: House, c. 1875-80  
 ARCH/BLDR: Unknown  
 STYLE: Italianate ROOF: Gable  
 STRUCTURE: Wood Frame, 2½ WINDOWS: 2/2  
 EXTERIOR: Clapboard  
 ORNAMENT: Brackets, bay windows portico over  
 entry window caps, porte cochere,  
 Palladian window  
 ALTERATIONS: Colonial Revival style ornament  
 added

NO. 126 ADDRESS: 62 Union Street  
 PROPERTY/DATE: Knox County Courthouse, 1874 (NR)  
 ARCH/BLDR: Bryant & Rogers of Boston  
 STYLE: Italianate ROOF: Hipped  
 STRUCTURE: Masonry, 3 WINDOWS: 4/4  
 EXTERIOR: Brick with stone trim  
 ORNAMENT: Cornice with brackets; round and segmental  
 arched windows; central pavilion with  
 columned portico; high basement  
 ALTERATIONS: Large two story brick and stone wing, on  
 south, 1970s

NO. 128 ADDRESS: 9 Claremont Street  
 PROPERTY/DATE: House, c. 1875-80  
 ARCH/BLDR: Unknown  
 STYLE: Italianate ROOF: Gable  
 STRUCTURE: Wood Frame, 2½ WINDOWS: 6/6  
 EXTERIOR: Clapboards  
 ORNAMENT: Front and side porches with turned  
 columns, balustrade, window caps, bay  
 window  
 ALTERATIONS: Large two story wing on rear (west),  
 mid-20th century

NO. 130 ADDRESS: 16 Claremont Street  
 PROPERTY/DATE: House, c. 1875-80  
 ARCH/BLDR: Unknown  
 STYLE: Italianate ROOF: Gable  
 STRUCTURE: Wood Frame, 2½ WINDOWS: 2/2  
 EXTERIOR: Clapboard  
 ORNAMENT: Multiple bay windows, cornice with  
 dentils, portico and brackets over main  
 entry, round arched attic window  
 ALTERATIONS: N/A

NO. 132 ADDRESS: 29 High Street  
 PROPERTY/DATE: House, c. 1920-30  
 ARCH/BLDR: Unknown  
 STYLE: Colonial Revival ROOF: Modified Gable  
 STRUCTURE: Wood Frame, 1½ WINDOWS: 6/6  
 EXTERIOR: Clapboard  
 ORNAMENT:  
 ALTERATIONS: Roof raised in rear

United States Department of the Interior  
National Park Service

National Register of Historic Places  
Inventory—Nomination Form

ROCKLAND RESIDENTIAL HISTORIC DISTRICT

Continuation sheet

Item number

7

Page

17



NO. 133 ADDRESS: 30 High Street  
PROPERTY/DATE: Henry Tibbetts House, c. 1890  
ARCH/BLDR: Unknown  
STYLE: Queen Anne ROOF: Hipped  
STRUCTURE: Wood Frame, 2½ WINDOWS:  
EXTERIOR: Asbestos shingles  
ORNAMENT: Octagonal corner tower, oriel window,  
modillions under cornice  
ALTERATIONS: Porch removed, siding

NO. 135 ADDRESS: 38 High Street  
PROPERTY/DATE: Levi Ulmer House, c. 1830-35  
ARCH/BLDR: Unknown  
STYLE: Greek Revival ROOF: Gable  
STRUCTURE: Wood Frame, 1½ WINDOWS: 6/6  
EXTERIOR: Clapboard  
ORNAMENT: Entry with pilasters and sidelights

ALTERATIONS: N/A

NO. 137 ADDRESS: 223 Broadway  
PROPERTY/DATE: Lincoln McRae House, c. 1927-31  
ARCH/BLDR: Unknown  
STYLE: Colonial Revival ROOF: Gambrel  
STRUCTURE: Wood Frame, 2 WINDOWS: 6/1  
EXTERIOR: Aluminum siding  
ORNAMENT: Gambrel roof, enclosed vestibule  
sleeping porch

ALTERATIONS: Siding

NO. 139 ADDRESS: 235 Broadway  
PROPERTY/DATE: William Healey House, c. 1896-1900  
ARCH/BLDR: Unknown  
STYLE: Queen Anne ROOF: Gable  
STRUCTURE: Wood Frame, 2½ WINDOWS: 2/1  
EXTERIOR: Vinyl siding  
ORNAMENT:  
ALTERATIONS: Siding, decorative trim removed

NO. 134 ADDRESS: 34 High Street  
PROPERTY/DATE: Benjamin Littlefield House, c. 1850  
ARCH/BLDR: Unknown  
STYLE: Greek Revival ROOF: Gable  
STRUCTURE: Wood Frame, 2½ WINDOWS: 2/2  
EXTERIOR: Aluminum siding  
ORNAMENT:

ALTERATIONS: Siding, entrance vestibule

NO. 136 ADDRESS: 215 Broadway  
PROPERTY/DATE: Charles Richardson House, 1925  
ARCH/BLDR: Unknown  
STYLE: Colonial Revival ROOF: Hipped  
STRUCTURE: Wood Frame, 2½ WINDOWS: 6/1  
EXTERIOR: Clapboard  
ORNAMENT: Wide eaves with modillions, columned  
portico over entry, sun porch with  
pilasters and brackets

ALTERATIONS: N/A

NO. 138 ADDRESS: 233 Broadway  
PROPERTY/DATE: Chester Walker House, c. 1891  
ARCH/BLDR: Edward F. Glover, Rockland, Architect  
STYLE: Queen Anne ROOF: Gable  
STRUCTURE: Wood Frame, 2½ WINDOWS: 2/2  
EXTERIOR: Clapboard  
ORNAMENT: Two porches with turned posts, spindle  
work and balustrade, novelty siding in  
gable end

ALTERATIONS: N/A

NO. 140 ADDRESS: 239 Broadway  
PROPERTY/DATE: Eugene Rose House, c. 1896-1900  
ARCH/BLDR: Unknown  
STYLE: Queen Anne ROOF: Gable  
STRUCTURE: Wood Frame, 2½ WINDOWS: 2/2  
EXTERIOR: Aluminum siding  
ORNAMENT: Bay window, porch with turned posts  
ALTERATIONS: N/A

**United States Department of the Interior  
National Park Service**

**National Register of Historic Places  
Inventory—Nomination Form**

ROCKLAND RESIDENTIAL HISTORIC DISTRICT  
Continuation sheet



Item number 7 Page 18

NO. 141 ADDRESS: 241 Broadway  
PROPERTY/DATE: Lewis Starrett House, c. 1890-95  
ARCH/BLDR: Unknown  
STYLE: Queen Anne ROOF: Gable  
STRUCTURE: Wood Frame, 2½ WINDOWS: 1/1  
EXTERIOR: Cedar shingles  
ORNAMENT: Brackets, bay windows, novelty siding  
in gable ends, porch with turned posts  
ALTERATIONS: Shingles

NO. 142 ADDRESS: 249 Broadway  
PROPERTY/DATE: Charles S. Crockett House, 1889  
ARCH/BLDR: W. H. Glover & Co., Builders  
STYLE: Queen Anne ROOF: Gable  
STRUCTURE: Wood Frame, 2½ WINDOWS: 2/2  
EXTERIOR: Clapboards  
ORNAMENT: Queen Anne sash in multiple gable ends  
ALTERATIONS: Front porch removed, sun porch added  
in 1940, rear porch added in 1980,  
door remodelled

The following buildings do not contribute to the historic district:

No. 143 Office Building  
12 Maple Street  
1 story  
wood and metal exterior  
gable roof  
built c. 1960-70

No. 144 House  
50 Talbot Avenue  
1½ story  
wood frame, clapboard siding  
gable roof, Cape Cod style  
built c. 1960

**United States Department of the Interior  
National Park Service**

**National Register of Historic Places  
Inventory—Nomination Form**

ROCKLAND RESIDENTIAL HISTORIC DISTRICT

Continuation sheet

Item number

8

Page 2

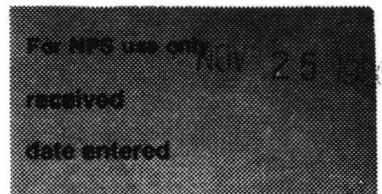

Spear, operated lime kilns. Others owned interests in kilns, or the schooners which exported the lime, in addition to their principal concerns. As was typical of 19<sup>th</sup> century entrepreneurs, the wealthier citizens of Rockland derived their income, which fueled the city's prosperity, from a variety of sources.

The increase in residential construction coincided with the erection of a variety of public and semi-public buildings in the district. Following the construction of the County Courthouse in 1875 was the Episcopal Church of 1883-84, the McLain Grammar School of 1892, the County Jail of 1892, the public library of 1903, and the County hospital of 1916. The erection of these buildings, followed by the high school and the Nurses Home of 1928, and the Community Building of 1936, kept this neighborhood a desirable area despite the end of shipbuilding and the lime industry in the 1920s. In keeping with national trends, new residential construction consisted generally of smaller homes. By the middle of this century, there were few vacant lots available and new homes tended to be constructed on larger lots in outlying areas of the city. At the same time, many of the spacious 19<sup>th</sup> century residences underwent conversion into multi-family dwellings.

The architectural character of the district is dominated by large homes in the Queen Anne style and public buildings in variations of Neo-Classical modes. For the latter, leading architects from outside Rockland were hired. These included Boston's Bryant and Rogers (the County Courthouse), George Clough (the public library), R. Clipston Sturgis (the County hospital), and William Ralph Emerson (the Episcopal Church). Also important were Lewiston's Elmer I. Thomas (the McLain School), and Augusta's Bunker and Savage (the high school). Prominent Maine architects designed a few of the residences, such as Charles F. Douglas (the William H. Glover House), Kimball and Coombs (the A. F. Ames House) and E. E. Lewis (the Charles Littlefield House). Local architects and builders, however, were primarily responsible for shaping the architectural character of the residential areas.

Among Rockland's 19<sup>th</sup> century architects, builders and carpenters, one firm, W. H. Glover and Company, clearly dominated the building trades. This firm, which figured prominently throughout the state, sold lumber, sash, doors and blinds, mill-work and cast iron elements, as well as architectural designs. Indeed, one member of the family, Edward F. Glover, apparently served as the company architect. That this firm based its architectural designs on published sources or on the work of architects for whom they had erected buildings, seems clear. Each of the four Glover family members who lived in the proposed district owned houses either designed by prominent architects or borrowed from

**United States Department of the Interior  
National Park Service**

**National Register of Historic Places  
Inventory—Nomination Form**

ROCKLAND RESIDENTIAL HISTORIC DISTRICT  
Continuation sheet

Item number 8

Page 3

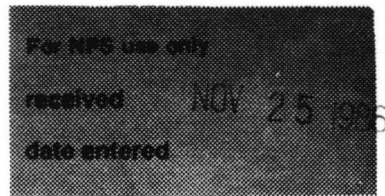

locally-known architect-designed residences.

Large Queen Anne style homes in the District, built by the Glover firm, include 12 Lincoln Street, 16 Lincoln Street, 88-90 Talbot Street, 63 Summer Street, 81-83 Summer Street, 5 Beech Street, 100 Limerock Street, 47 Masonic Street, and 249 Broadway. Regardless of design sources, these houses display a splendid variety of ornamental treatment, each with its own character. Also identified are houses constructed from designs sold by prominent mail order firms such as Palliser, Palliser and Company (57 Talbot Avenue), and George F. Barber and Company (69 Beech Street, 55 Summer Street).

By the early 20<sup>th</sup> century, building activity in Rockland declined. For the smaller homes typical of this period, local architect Freeman Stanley apparently supplanted the Glovers. The district includes several examples of this man's work, mostly in the Bungalow style. Stanley's designs are finely detailed and among the best examples of this mode in the state. The Allen House at 107 Limerock Street and the Roakes House at 129 Limerock Street are particularly outstanding.

The research for this nomination was based on primary sources such as 19<sup>th</sup> century newspapers, tax records, maps, and city directories. This material was developed in a local building survey conducted in 1986. Based on this research, District boundaries were established which reflect the historical development of the area and exclude large concentrations of residential buildings which are altered and/or have minimal architectural significance.

United States Department of the Interior  
National Park Service

National Register of Historic Places  
Inventory—Nomination Form

ROCKLAND RESIDENTIAL HISTORIC DISTRICT  
Continuation sheet

Item number 8

Page 3



locally-known architect-designed residences.

Large Queen Anne style homes in the District, built by the Glover firm, include 12 Lincoln Street, 16 Lincoln Street, 88-90 Talbot Street, 63 Summer Street, 81-83 Summer Street, 5 Beech Street, 100 Limerock Street, 47 Masonic Street, and 249 Broadway. Regardless of design sources, these houses display a splendid variety of ornamental treatment, each with its own character. Also identified are houses constructed from designs sold by prominent mail order firms such as Palliser, Palliser and Company (57 Talbot Avenue), and George F. Barber and Company (69 Beech Street, 55 Summer Street).

By the early 20<sup>th</sup> century, building activity in Rockland declined. For the smaller homes typical of this period, local architect Freeman Stanley apparently supplanted the Glovers. The district includes several examples of this man's work, mostly in the Bungalow style. Stanley's designs are finely detailed and among the best examples of this mode in the state. The Allen House at 107 Limerock Street and the Roakes House at 129 Limerock Street are particularly outstanding.

The research for this nomination was based on primary sources such as 19<sup>th</sup> century newspapers, tax records, maps, and city directories. This material was developed in a local building survey conducted in 1986. Based on this research, District boundaries were established which reflect the historical development of the area and exclude large concentrations of residential buildings which are altered and/or have minimal architectural significance.

## 9. Major Bibliographical References

Courier-Gazette (Rockland), 1885-1890.

Tax Records, City of Rockland.

Shore Village Story, edited by Brian R. Harden, Rockland, 1976.

## 10. Geographical Data

Acreage of nominated property \_\_\_\_\_ 54 \_\_\_\_\_

Quadrangle name Rockland

Quadrangle scale 1:24,000

UTM References

A 

1	9	4	9	0	6	8	0	4	8	8	3	1	3	0
Zone	Easting			Northing										

B 

1	9	4	9	1	0	5	0	4	8	8	3	1	3	0
Zone	Easting			Northing										

C 

1	9	4	9	0	9	8	0	4	8	8	3	6	5	0
Zone	Easting			Northing										

D 

1	9	4	9	0	6	4	0	4	8	8	3	7	3	0
Zone	Easting			Northing										

E 

1	9	4	9	0	5	6	0	4	8	8	3	3	5	0
Zone	Easting			Northing										

F 

1	9	4	9	0	7	0	1	4	8	8	3	3	0	1
Zone	Easting			Northing										

G 

Zone	Easting			Northing										

H 

Zone	Easting			Northing										

Verbal boundary description and justification

Boundaries to follow property lines as indicated on district map. Area included is roughly bounded by Masonic, Broad, Limerock, Broadway, Granite and Union streets.

List all states and counties for properties overlapping state or county boundaries

state	code	county	code

## 11. Form Prepared By

name/title Roger G. Reed, Architectural Historian

organization Maine Historic Preservation Commission date September, 1986

street & number 55 Capitol Street, Station #65 telephone 207/289-2132

city or town Augusta, state Maine 04333

## 12. State Historic Preservation Officer Certification

The evaluated significance of this property within the state is:

national  state  local

As the designated State Historic Preservation Officer for the National Historic Preservation Act of 1966 (Public Law 89-665), I hereby nominate this property for inclusion in the National Register and certify that it has been evaluated according to the criteria and procedures set forth by the National Park Service.

State Historic Preservation Officer signature *Eileen S. Peterson*

title S.H.P.O. date 11/17/86

For NPS use only

I hereby certify that this property is included in the National Register

date

Keeper of the National Register

Attest:

date

NATIONAL REGISTER OF HISTORIC PLACES  
EVALUATION/RETURN SHEET

Rockland Residential Historic District  
Knox County  
MAINE

NOV 25 1986

Working No. \_\_\_\_\_  
Fed. Reg. Date: \_\_\_\_\_  
Date Due: 12/20/86 - 1/9/87  
Action: RETURN 1-9-87  
 ACCEPT  
 REJECT  
Federal Agency: \_\_\_\_\_

- resubmission
- nomination by person or local government
- owner objection
- appeal

Substantive Review:  sample  request  appeal  NR decision

Reviewer's comments:

*The district is clearly eligible for listing for its architectural significance as a collection of residential styles in Rockland. Please note corrections needed to enable listing.*

Recom./Criteria Return  
Reviewer Savage  
Discipline Architectural History  
Date 1-7-87  
\_\_\_\_\_ see continuation sheet

Nomination returned for:  technical corrections cited below  
 substantive reasons discussed below

1. Name

2. Location

3. Classification

Category

4. Owner of Property

5. Location of Legal D

6. Representation in E

Has this property been

7. Description

Condition

- excellent
- good
- fair
- unexposed

late \_\_\_\_\_

Describe the present and original (if known) physical appearance

- summary paragraph
- completeness
- clarity
- alterations/integrity
- dates
- boundary selection

*Sheets # 7, pages 4+5 are the same. Please delete one and renumber accordingly.*

*Roughly bounded by Granite Union, masonic, Broad, Lunerock, and Broadway Sts.*

8. Significance

Period Areas of Significance—Check and justify below

Specific dates Builder/Architect  
Statement of Significance (in one paragraph)

- summary paragraph
- completeness 29
- clarity
- applicable criteria
- justification of areas checked
- relating significance to the resource
- context
- relationship of integrity to significance
- justification of exception
- other

The period of significance for the district appears to be 1880-1920 according to #8, topic sentence. However, some properties dating from outside the period of significance are classified as contributing (such as: # 76-78, 60, 62, 94, 136-137) in the inventory. Please either adjust and justify a period of significance which includes all C properties, or provide further info. which may document their individual eligibility, or change their classification to nc. Recommend reevaluation of dates also due to the number of properties classified as C which were constructed prior to the now defined period.

9. Major Bibliographical References

10. Geographical Data

Acreage of nominated property \_\_\_\_\_  
 Quadrange name \_\_\_\_\_  
 UTM References \_\_\_\_\_

Verbal boundary description and justification

11. Form Prepared By

12. State Historic Preservation Officer Certification

The evaluated significance of this property within the state is:

\_\_\_ national \_\_\_ state \_\_\_ local

State Historic Preservation Officer signature

title date

13. Other

- Maps
- Photographs
- Other

Questions concerning this nomination may be directed to Both Savage (202) 343-9850.

Signed Kitrick Andrus Date 1/9/87 Phone: \_\_\_\_\_

## 7. Description

Condition		Check one		Check one	
<input type="checkbox"/> excellent	<input type="checkbox"/> deteriorated	<input type="checkbox"/> unaltered	<input checked="" type="checkbox"/> original site		
<input checked="" type="checkbox"/> good	<input type="checkbox"/> ruins	<input checked="" type="checkbox"/> altered	<input type="checkbox"/> moved	date	
<input type="checkbox"/> fair	<input type="checkbox"/> unexposed				

### Describe the present and original (if known) physical appearance

The Rockland Residential Historic District is a neighborhood of residential and public buildings located in the center of the city. The eastern boundary, Union Street, separates this area from the central business district. Several public buildings (the County Courthouse, the County Jail, the County hospital, the library, and the community building, as well as the Episcopal church) front the west side of Union Street and constitute a transitional zone to the residential areas. The southern boundary is the north side of Masonic Street and the western boundary is the east side of Broadway, a major north-south thoroughfare. The rear lots of the north side of Talbot Street roughly completes the area included in this nomination.

There are 142 buildings which contribute to this historic district. All but seven are residential. The following is a list of contributing structures:

NO. 1 ADDRESS: 38 Talbot Avenue  
PROPERTY/DATE: Hemingway-Bartlett House, 1865  
ARCH/BLDR: Unknown  
STYLE: Eclectic ROOF: Gable  
STRUCTURE: Wood Fram, 2½ WINDOWS: 2/1 Lights  
EXTERIOR: Aluminum siding  
ORNAMENT: Brackets, octagonal corner tower

ALTERATIONS: Enclosed 1920s porch on west, sleeping, porch, siding

NO. 3 ADDRESS: 44 Talbot Avenue  
PROPERTY/DATE: House, c. 1870  
ARCH/BLDR: Unknown  
STYLE: Greek Rev./Ital. ROOF: Gable  
STRUCTURE: Wood Fram, 2½ WINDOWS: 6/6 Lights  
EXTERIOR: Aluminum siding  
ORNAMENT: Cornice returns, round arched frieze under eaves and over windows and doors

ALTERATIONS: Ell remodelled this century with sleeping, porch, siding

NO. 5 ADDRESS: 48 Talbot Avenue  
PROPERTY/DATE: Thos. Pillsbury Hse., 1855-1873  
ARCH/BLDR: Unknown  
STYLE: Greek Rev./Ital. ROOF: Gable  
STRUCTURE: Wood Fram, 2½ WINDOWS: 6/6 Lights  
EXTERIOR: Aluminum siding  
ORNAMENT: Cornice returns and brackets

ALTERATIONS: Siding

NO. 2 ADDRESS: 41 Talbot Avenue  
PROPERTY/DATE: House, c. 1860-70  
ARCH/BLDR: Unknown  
STYLE: Greek Revival ROOF: Gable  
STRUCTURE: Wood Frame, 2½ WINDOWS: 6/6 Lights  
EXTERIOR: Clapboard  
ORNAMENT: Cornice returns, pilasters with pediment over east entrance.

ALTERATIONS: N/A

NO. 4 ADDRESS: 45 Talbot Avenue  
PROPERTY/DATE: House, c. 1870  
ARCH/BLDR: Unknown  
STYLE: Italianate ROOF: Gable  
STRUCTURE: Wood Frame, 2½ WINDOWS: 6/6 Lights  
EXTERIOR: Aluminum siding  
ORNAMENT: Round arched windows in gable end

ALTERATIONS: Siding, porch rebuilt without trim, modern garage

NO. 6 ADDRESS: 49 Talbot Avenue  
PROPERTY/DATE: House, c. 1870  
ARCH/BLDR: Unknown  
STYLE: Italianate ROOF: Gable  
STRUCTURE: Wood Frame, 2½ WINDOWS: 6/6 Lights  
EXTERIOR: Clapboard  
ORNAMENT: Window and roof cornice with brackets, Queen Anne style veranda with decorative trim

ALTERATIONS: N/A

resub

United States Department of the Interior  
National Park Service

National Register of Historic Places  
Inventory—Nomination Form

For NPS use only

received MAR 5 1987

date entered APR 15 1987

See instructions in *How to Complete National Register Forms*  
Type all entries—complete applicable sections

1. Name

historic Rockland Residential Historic District

and or common

2. Location

street & number Various not for publication

city, town Rockland, vicinity of

state Maine code 23 county Knox code 013

3. Classification

Category	Ownership	Status	Present Use
<input checked="" type="checkbox"/> district	<input type="checkbox"/> public	<input checked="" type="checkbox"/> occupied	<input type="checkbox"/> agriculture
<input type="checkbox"/> building(s)	<input type="checkbox"/> private	<input type="checkbox"/> unoccupied	<input type="checkbox"/> commercial
<input type="checkbox"/> structure	<input checked="" type="checkbox"/> both	<input type="checkbox"/> work in progress	<input checked="" type="checkbox"/> educational
<input type="checkbox"/> site	<b>Public Acquisition</b>	<b>Accessible</b>	<input type="checkbox"/> entertainment
<input type="checkbox"/> object	<input type="checkbox"/> N/A in process	<input checked="" type="checkbox"/> yes: restricted	<input checked="" type="checkbox"/> government
	<input type="checkbox"/> being considered	<input type="checkbox"/> yes: unrestricted	<input type="checkbox"/> industrial
		<input type="checkbox"/> no	<input type="checkbox"/> military
			<input checked="" type="checkbox"/> museum
			<input type="checkbox"/> park
			<input checked="" type="checkbox"/> private residence
			<input checked="" type="checkbox"/> religious
			<input type="checkbox"/> scientific
			<input type="checkbox"/> transportation
			<input type="checkbox"/> other:

4. Owner of Property

name Multiple Owners

street & number

city, town \_\_\_\_\_ vicinity of \_\_\_\_\_ state \_\_\_\_\_

5. Location of Legal Description

courthouse, registry of deeds, etc. Knox County Registry of Deeds

street & number Union Street

city, town Rockland, state Maine

6. Representation in Existing Surveys

title Rockland Building Survey has this property been determined eligible?  yes  no

date 1986 federal  state  county  local

depository for survey records Maine Historic Preservation Commission

city, town Augusta state Maine

**United States Department of the Interior  
National Park Service**

**National Register of Historic Places  
Inventory—Nomination Form**

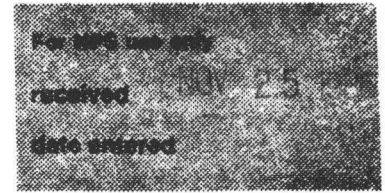

ROCKLAND RESIDENTIAL HISTORIC DISTRICT  
Continuation sheet

Item number 7 Page 1

NO. 7 ADDRESS: 53 Talbot Avenue  
PROPERTY/DATE: James Farwell House, c. 1850  
ARCH/BLDR: Unknown  
STYLE: Greek Revival ROOF: Gable  
STRUCTURE: Wood Frame, 2½ WINDOWS: 2/2 Lights  
EXTERIOR: Aluminum siding  
ORNAMENT: Cornice returns, Queen Anne style porch  
w/decorative trim on N. side, added 1889  
ALTERATIONS: Siding

NO. 9 ADDRESS: 57 Talbot Avenue  
PROPERTY/DATE: Snow House, 1886  
ARCHITECT: Palliser, Palliser & Co., New York  
BUILDER: R. C. Guptill  
STYLE: Queen Anne ROOF: Gable  
STRUCTURE: Wood Frame, 2½ WINDOWS: 2/2 Lights  
EXTERIOR: Vinyl siding  
ORNAMENT: Brackets and vergeboard, ornate  
veranda  
ALTERATIONS: Siding

NO. 11 ADDRESS: 66 Talbot Avenue  
PROPERTY/DATE: House, c. 1870  
ARCH/BLDR: Unknown  
STYLE: Italianate ROOF: Gable  
STRUCTURE: Wood Fram, 2½ WINDOWS: 6/6 Lights  
EXTERIOR: Asbestos shingles  
ORNAMENT: Brackets, round arched attic windows  
ALTERATIONS: Siding, porch enclosed with windows

NO. 13 ADDRESS: 72 Talbot Avenue  
PROPERTY/DATE: W. H. Priest House, 1855-73  
ARCH/BLDR: Unknown  
STYLE: Italianate ROOF: Gable  
STRUCTURE: Wood Frame, 2½ WINDOWS: 1/1 Lights  
EXTERIOR:  
ORNAMENT: Brackets under cornice, Colonial  
Revival porch on north side  
ALTERATIONS: Porch and bay window, early 1900

NO. 8 ADDRESS: 56 Talbot Avenue  
PROPERTY/DATE: House, c. 1870  
ARCH/BLDR: Unknown  
STYLE: Italianate ROOF: Gable  
STRUCTURE: Wood Frame, 2½ WINDOWS: 6/6 Lights  
EXTERIOR: Clapboard  
ORNAMENT: Brackets under cornice, porch roof and over  
main entrance  
ALTERATIONS: Porch on east side enclosed

NO. 10 ADDRESS: 61 Talbot Avenue  
PROPERTY/DATE: House, c. 1870  
ARCH/BLDR: Unknown  
STYLE: Italianate ROOF: Gable  
STRUCTURE: Wood Frame, 2½ WINDOWS: 6/6 Lights  
EXTERIOR: Clapboard  
ORNAMENT: Brackets and cornice returns, round arched  
windows in attic and bay window  
ALTERATIONS: Porch removed on east side

NO. 12 ADDRESS: 67 Talbot Avenue  
PROPERTY/DATE: William H. Glover House, 1873  
ARCH/BLDR: Charles F. Douglas, Lewiston, Architect  
STYLE: Mansard ROOF: Mansard  
STRUCTURE: Wood Frame, 3 WINDOWS: 2/2 Lights  
EXTERIOR: Vinyl siding  
ORNAMENT: Brackets, window caps, dormers, tower,  
portico over entrance  
ALTERATIONS: Siding

NO. 14 ADDRESS: 73 Talbot Avenue  
PROPERTY/DATE: A. F. Ames House, 1874  
ARCH/BLDR: Kimball & Coombs, Lewiston, Architect  
STYLE: Mansard ROOF: Mansard  
STRUCTURE: Wood Frame, 3 WINDOWS: 2/2 Lights  
EXTERIOR: Vinyl siding  
ORNAMENT: Brackets, window caps, dormers, veranda  
with posts.  
ALTERATIONS: Siding, cupola removed

**United States Department of the Interior  
National Park Service**

**National Register of Historic Places  
Inventory—Nomination Form**



ROCKLAND RESIDENTIAL HISTORIC DISTRICT

Continuation sheet

Item number

7

Page

2

NO. 15 ADDRESS: 78 Talbot Avenue  
PROPERTY/DATE: Nathaniel Jones House, c. 1860-70  
ARCH/BLDR: Unknown  
STYLE: Italianate ROOF: Hipped  
STRUCTURE: Wood Frame, 2½ WINDOWS: 6/6 Lights  
EXTERIOR: Vinyl siding  
ORNAMENT: Brackets, window caps, segmental arched  
stair window, portico w/paired columns  
ALTERATIONS: Siding

NO. 17 ADDRESS: 84 Talbot Avenue  
PROPERTY/DATE: House, c. 1870-73  
ARCH/BLDR: Unknown  
STYLE: Italianate ROOF: Gable  
STRUCTURE: Wood Frame, 2½ WINDOWS: 2/2 Lights  
EXTERIOR: Clapboard  
ORNAMENT: Wide eaves, brackets, bay windows,  
entrance portico  
ALTERATIONS: N/A

NO. 19 ADDRESS: 89 Talbot Avenue  
PROPERTY/DATE: Leighton House, c. 1890/c. 1920  
ARCH/BLDR: Unknown  
STYLE: Tudor ROOF: Gable  
STRUCTURE: Wood Frame, 2½ WINDOWS: Multi pane  
EXTERIOR: Stucco  
ORNAMENT: Half-timbered walls, gable, portico,  
porte cochere  
ALTERATIONS: N/A

NO. 21 ADDRESS: 46 Summer Street  
PROPERTY/DATE: House, c. 1905  
ARCH/BLDR: Unknown  
STYLE: Colonial Revival ROOF: Hipped  
STRUCTURE: Wood Frame, 2½ WINDOWS: 2/2 Lights  
EXTERIOR: Clapboard  
ORNAMENT: Porch w/roof & deck balustrade, bay  
windows, large single bracket under  
projecting eaves  
ALTERATIONS: N/A

NO. 16 ADDRESS: 81 Talbot Avenue  
PROPERTY/DATE: Charles Berry House, 1899  
ARCH/BLDR: Attributed to Austin Pease, Architect  
STYLE: Colonial Revival ROOF: Hipped  
STRUCTURE: Wood Frame, 2½ WINDOWS: 1/1 Lights  
EXTERIOR: Shingles and clapboards  
ORNAMENT: Large porch and porte cochere, bowed front,  
Palladian stair window, ornamented dormers  
ALTERATIONS: N/A

NO. 18 ADDRESS: 88-90 Talbot Avenue  
PROPERTY/DATE: Gay Double House, 1887  
ARCH/BLDR: William H. Glover & Co., Builders  
STYLE: Queen Anne ROOF: Hipped and gable  
STRUCTURE: Wood Frame, 2½ WINDOWS: 2/2 Lights  
EXTERIOR: Clapboard  
ORNAMENT: Brackets, octagonal bays, decorative fans in  
gable ends, bay windows  
ALTERATIONS: Porch on north enclosed

NO. 20 ADDRESS: 38 Summer Street  
PROPERTY/DATE: House, c. 1897  
ARCH/BLDR: Unknown  
STYLE: Queen Anne ROOF: Gable  
STRUCTURE: Wood Frame, 2½ WINDOWS: 1/1 Lights  
EXTERIOR: Clapboard  
ORNAMENT: Over-hanging gable, ovriel window, octagonal  
corner tower, pedimented portico  
ALTERATIONS: 2 story wing with sleeping porch on  
on east side

NO. 22 ADDRESS: 49 Summer Street  
PROPERTY/DATE: Pillsbury House, c. 1840-50  
ARCH/BLDR: Unknown  
STYLE: Greek Revival ROOF: Gable  
STRUCTURE: Wood Frame, 2½ WINDOWS: 6/6 Lights  
EXTERIOR: Clapboard  
ORNAMENT: Corner pilasters and entablature on main  
section and around main entry  
ALTERATIONS: N/A

United States Department of the Interior  
National Park Service

National Register of Historic Places  
Inventory—Nomination Form

ROCKLAND RESIDENTIAL HISTORIC DISTRICT

Continuation sheet

Item number

7

Page

3



NO. 23 ADDRESS: 50-52 Summer Street  
PROPERTY/DATE: Park House, c. 1875-80  
ARCH/BLDR: Unknown  
STYLE: Greek Rev./Ital. ROOF: Gable  
STRUCTURE: Wood Frame, 2½ WINDOWS: 2/2 Lights  
EXTERIOR: Clapboard  
ORNAMENT: Window & door cornices, round arched  
stairhall & bay windows, dentil under  
cornice  
ALTERATIONS: N/A

NO. 25 ADDRESS: 60 Summer Street  
PROPERTY/DATE: House, between 1855-1865  
ARCH/BLDR: Unknown  
STYLE: Greek Revival ROOF: Gable  
STRUCTURE: Wood Frame, 2½ WINDOWS: 1/1 Lights  
EXTERIOR: Aluminum siding  
ORNAMENT: Cornice returns  
ALTERATIONS: Siding, windows replaced

NO. 27 ADDRESS: 63 Summer Street  
PROPERTY/DATE: Fred Berry House, 1887-88  
ARCH/BLDR: W. H. Glover & Co., Builders  
STYLE: Queen Anne ROOF: Gable  
STRUCTURE: Wood Frame, 3½ WINDOWS: 2/2 Lights  
EXTERIOR: Clapboard  
ORNAMENT: Projecting gable ends with oriel  
windows, round corner tower, lunettes,  
bay windows, decorative trim  
ALTERATIONS: Large veranda removed, carriage  
house replaced with small garage

NO. 29 ADDRESS: 73 Summer Street  
PROPERTY/DATE: Hemenway House, 1872  
ARCH/BLDR: Unknown  
STYLE: Greek Revival ROOF: Gable  
STRUCTURE: Wood Frame, 1½ WINDOWS: 2/2 Lights  
EXTERIOR: Vinyl  
ORNAMENT: Cornice returns, sidelights  
ALTERATIONS: Vinyl siding, ell re-built

NO. 24 ADDRESS: 55 Summer Street  
PROPERTY/DATE: Amos Williams House  
ARCH/BLDR: George T. Barber, Knoxville, Tennessee  
STYLE: Queen Anne ROOF: Gable and hipped  
STRUCTURE: Wood Frame, 2½ WINDOWS: 1/1 Lights  
EXTERIOR: Clapboard  
ORNAMENT: Oriel window, brackets, vergeboard, Queen  
Anne sash, bay windows, porch posts  
ALTERATIONS: Possible reductions and/or enclosures of  
porches

NO. 26 ADDRESS: 62-64 Summer Street  
PROPERTY/DATE: Double House, mid-19th century  
ARCH/BLDR: Unknown  
STYLE: Greek Revival ROOF: Gable  
STRUCTURE: Wood Frame, 2½ WINDOWS: 1/1 Lights  
EXTERIOR: N/A  
ORNAMENT: Cornices over windows and doors, dentils  
under eaves  
ALTERATIONS: Windows replaced, siding

NO. 28 ADDRESS: 71 Summer Street  
PROPERTY/DATE: George Smith House, 1893  
ARCH/BLDR: William F. Glover & Co., Builders  
STYLE: Queen Anne ROOF: Gable  
STRUCTURE: Wood Frame, 2½ WINDOWS: 2/2 Lights  
EXTERIOR: Clapboard, shingle  
ORNAMENT: Porches with turned posts, novelty siding  
and patterned shingles  
ALTERATIONS: N/A

NO. 30 ADDRESS: 79 Summer Street  
PROPERTY/DATE: William Fisk House, 1890  
ARCH/BLDR: Unknown  
STYLE: Italianate ROOF: Gable  
STRUCTURE: Wood Frame, 2½ WINDOWS: 2/2 Lights  
EXTERIOR: Asbestos shingles  
ORNAMENT: Round arched gable windows, Queen Anne  
style porch  
ALTERATIONS: Asbestos shingles

**United States Department of the Interior  
National Park Service**

**National Register of Historic Places  
Inventory—Nomination Form**

ROCKLAND RESIDENTIAL HISTORIC DISTRICT

Continuation sheet

Item number

7

Page

4

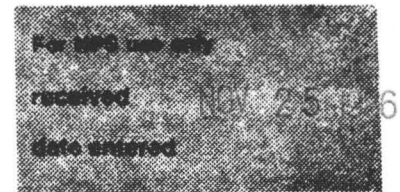

NO. 31 ADDRESS: 81-83 Summer Street  
PROPERTY/DATE: Harrington House, 1889-90  
ARCH/BLDR: William H. Glover & Co., Builders  
STYLE: Queen Anne ROOF: Gable  
STRUCTURE: Wood Frame, 2½ WINDOWS: 2/2 Lights  
EXTERIOR: Clapboard  
ORNAMENT: Gable trim, brackets, bay windows,  
porch with spindle work  
ALTERATIONS: N/A

NO. 33 ADDRESS: 87-89 Summer Street  
PROPERTY/DATE: Weeks Double House, 1889-90  
ARCH/BLDR: J. F. Waterhouse of Rockland, Architect  
STYLE: Queen Anne ROOF: Gable  
STRUCTURE: Wood Frame, 2½ WINDOWS: 2/2 Lights  
EXTERIOR: Clapboard  
ORNAMENT: Porches with turned posts, bay windows,  
decorative trim in gable ends  
ALTERATIONS: N/A

NO. 35 ADDRESS: 92 Summer Street  
PROPERTY/DATE: House, c. 1840-60  
ARCH/BLDR: Unknown  
STYLE: Greek Revival ROOF: Gable  
STRUCTURE: Wood Frame, 1½ WINDOWS: 2/1 Lights  
EXTERIOR: Clapboard  
ORNAMENT: Corner pilasters, entablature  
ALTERATIONS: Portico over main entry, dormers,  
stone foundation c. 1892, when house  
moved

NO. 37 ADDRESS: 5 Beech Street  
PROPERTY/DATE: Edward Butler House, 1888  
ARCH/BLDR: William H. Glover & Co., Builders  
STYLE: Queen Anne ROOF: Hipped  
STRUCTURE: Wood Frame, 2½ WINDOWS: 4/1 Lights  
EXTERIOR: Shingles and clapboards  
ORNAMENT: Shingles second story, octagonal corner  
bay, gable and hipped roof dormers,  
porch over main entrance  
ALTERATIONS: N/A

NO. 32 ADDRESS: 86 Summer Street  
PROPERTY/DATE: Campbell House, c. 18850  
ARCH/BLDR: Unknown  
STYLE: Queen Anne Period ROOF: Gable  
STRUCTURE: Wood Frame, 1½ WINDOWS: 2/2 Lights  
EXTERIOR: Clapboard  
ORNAMENT: Brackets, side porch, decorative fan in  
gable end  
ALTERATIONS: N/A

NO. 34 ADDRESS: 88 Summer Street  
PROPERTY/DATE: Arthur Crockett House, c. 1896  
ARCH/BLDR: Unknown  
STYLE: Queen Anne ROOF: Gable  
STRUCTURE: Wood Frame, 2½ WINDOWS: 2/1 Lights  
EXTERIOR: N/A  
ORNAMENT: Large veranda with turned posts  
ALTERATIONS: N/A

NO. 36 ADDRESS: 93 Summer Street  
PROPERTY/DATE: William Sawtell House, 1889  
ARCH/BLDR: Unknown  
STYLE: Queen Anne ROOF: Gable  
STRUCTURE: Wood Frame, 2½ WINDOWS: 2/2 Lights  
EXTERIOR: Vinyl  
ORNAMENT: Porch with turned posts and brackets  
ALTERATIONS: Upper section of tower removed, siding

NO. 38 ADDRESS: 11 Beech Street  
PROPERTY/DATE: True Pierce House, 1885  
ARCH/BLDR: Unknown  
STYLE: Italianate ROOF: Gable  
STRUCTURE: Wood Frame, 2½ WINDOWS:  
EXTERIOR: Asphalt shingles  
ORNAMENT: Large veranda with brackets, Tuscan  
columns, bay windows  
ALTERATIONS: Siding

United States Department of the Interior  
National Park Service

National Register of Historic Places  
Inventory—Nomination Form

ROCKLAND RESIDENTIAL HISTORIC DISTRICT

Continuation sheet

Item number

7

Page

5



NO. 35 ADDRESS: 15-17 Beech Street  
PROPERTY/DATE: House, c. 1870  
ARCH/BLDR: Unknown  
STYLE: Italianate ROOF: Gable  
STRUCTURE: Wood Frame, 2½ WINDOWS: 2/2 Lights  
EXTERIOR: Vinyl siding  
ORNAMENT: Wide over-hanging eaves supported on brackets, small portico over main entrance, bay window  
ALTERATIONS: Siding

NO. 41 ADDRESS: 29 Beech Street  
PROPERTY/DATE: Nathan Cobb House, 1855-1873  
ARCH/BLDR: Unknown  
STYLE: Italianate ROOF: Gable  
STRUCTURE: Wood Frame, 2½ WINDOWS: 2/2 Lights  
EXTERIOR: Clapboards  
ORNAMENT: Brackets, cornice returns, window caps  
ALTERATIONS: N/A

NO. 43 ADDRESS: 41 Beech Street  
PROPERTY/DATE: Henry Ulmer House, c. 1845-55  
ARCH/BLDR: Unknown  
STYLE: Greek Revival ROOF: Gable  
STRUCTURE: Wood Frame, 2½ WINDOWS:  
EXTERIOR: Vinyl  
ORNAMENT: Cornice returns, cornice over door  
ALTERATIONS: Vinyl siding, garage replaced attached carriage barn

NO. 45 ADDRESS: 45 Beech Street  
PROPERTY/DATE: William O. Fuller House, 1905  
ARCH/BLDR: Unknown  
STYLE: Tudor ROOF: Gable  
STRUCTURE: Stone/Wood Fr. 2½ WINDOWS:  
EXTERIOR: Clapboards, stone  
ORNAMENT: Stylized half-timbered gable ends, stone piers, oriel windows, Palladian stair window  
ALTERATIONS: N/A

NO. 40 ADDRESS: 19 Beech Street  
PROPERTY/DATE: Maynard Bird House, c. 1910  
ARCH/BLDR: Unknown  
STYLE: Shingle style ROOF: Gable  
STRUCTURE: Wood Frame, 2½ WINDOWS: Multi-pane & plate glass  
EXTERIOR: Cedar shingles  
ORNAMENT: Shingle siding, round corner tower, art glass, varied fenestration

ALTERATIONS: Porch reduced in size, early 1920s

NO. 42 ADDRESS: 35 Beech Street  
PROPERTY/DATE: House, c. 1885  
ARCH/BLDR: Unknown  
STYLE: Italianate ROOF: Gable  
STRUCTURE: Wood Frame, 2½ WINDOWS: 2/2 Lights  
EXTERIOR: Vinyl siding  
ORNAMENT: Brackets supporting console over door  
ALTERATIONS: Siding, window trim removed

NO. 44 ADDRESS: 42 Beech Street  
PROPERTY/DATE: Charles Snow House, c. 1850s  
ARCH/BLDR: Unknown  
STYLE: Greek Revival ROOF: Gable  
STRUCTURE: Wood Frame, 2½ WINDOWS: 6/6 Lights  
EXTERIOR: Clapboard  
ORNAMENT: Cornice returns, pilasters and cornice over doorway  
ALTERATIONS: N/A

NO. 46 ADDRESS: 59 Beech Street  
PROPERTY/DATE: Fred Spear House, 1896  
ARCH/BLDR: Unknown  
STYLE: Colonial Revival ROOF: Hipped  
STRUCTURE: Wood Frame, 2½ WINDOWS:  
EXTERIOR: Clapboard  
ORNAMENT: Projecting gable ends, oriel window, bowed facade, porch with pediments, brackets  
ALTERATIONS: Porch enclosed

**United States Department of the Interior  
National Park Service**

**National Register of Historic Places  
Inventory—Nomination Form**

ROCKLAND RESIDENTIAL HISTORIC DISTRICT  
Continuation sheet



Item number 7 Page 6

NO. 47 ADDRESS: 60 Beech Street  
PROPERTY/DATE: House, c. 1900  
ARCH/BLDR: Unknown  
STYLE: Queen Anne period ROOF: Gable  
STRUCTURE: Wood Fr. 2½ WINDOWS: 2/1  
EXTERIOR: Aluminum siding  
ORNAMENT: Porch with turned posts

ALTERATIONS: Siding

NO. 49 ADDRESS: 66 Beech Street  
PROPERTY/DATE: House, 1898  
ARCH/BLDR: Unknown  
STYLE: Queen Anne period ROOF: Hipped and gable  
STRUCTURE: Wood Fr. 2½ WINDOWS: 2/2  
EXTERIOR: Aluminum siding  
ORNAMENT: Porch with turned posts and decorative  
balustrade

ALTERATIONS: Siding

NO. 51 ADDRESS: 70 Beech Street  
PROPERTY/DATE: Old Baptist Parsonage, 1898  
ARCH/BLDR:  
STYLE: Colonial Revival ROOF: Hipped  
STRUCTURE: Wood Fr. 2½ WINDOWS: 1/1  
EXTERIOR: Clapboards  
ORNAMENT: Porch with turned posts and modillions,  
projecting gable end and bay window,  
wide eaves

ALTERATIONS: N/A

NO. 53 ADDRESS: 74 Beech Street  
PROPERTY/DATE: P. Willard Pease House, 1909  
ARCH/BLDR: Keith & White, Architects, Spokane, WA.  
STYLE: Bungalow ROOF: Gable  
STRUCTURE: Wood Fr., 1½ WINDOWS:  
EXTERIOR: Clapboards  
ORNAMENT: Vergeborad, brackets, porch posts

ALTERATIONS: N/A

NO. 48 ADDRESS: 65 Beech Street  
PROPERTY/DATE: George Copeland House, 1894  
ARCH/BLDR: Unknown  
STYLE: Queen Anne ROOF: Gable  
STRUCTURE: Wood Frame, 2½ WINDOWS: 2/1  
EXTERIOR: Clapboard  
ORNAMENT: Decorative porch, hipped roof dormer, Queen  
Anne sash

ALTERATIONS: N/A

NO. 50 ADDRESS: 69 Beech Street  
PROPERTY/DATE: Samuel Burpee House, c. 1897  
ARCH/BLDR: George F. Barber, Knoxville, Tennessee  
STYLE: Queen Anne ROOF: Hipped  
STRUCTURE: Wood Frame, 1½ WINDOWS: 2/1  
EXTERIOR: Aluminum siding  
ORNAMENT: Large veranda, octagonal tower, decorative  
trim in gable ends

ALTERATIONS: Siding

NO. 52 ADDRESS: 73 Beech Street  
PROPERTY/DATE: Veazie-Moran House, 1895-1897  
ARCH/BLDR: Unknown  
STYLE: Queen Anne period ROOF: Gable  
STRUCTURE: Wood Frame, 2½ WINDOWS: 2/2  
EXTERIOR: Clapboards  
ORNAMENT: Large veranda and rear porch with turned  
posts and brackets, pedimented gable ends

ALTERATIONS: N/A

NO. 54 ADDRESS: 77 Beech Street  
PROPERTY/DATE: Gardner House, c. 1910-20  
ARCH/BLDR: Unknown  
STYLE: Bungalow ROOF: Gable  
STRUCTURE: Wood Frame, 1½ WINDOWS: Multi-pane  
EXTERIOR: Cedar shingles  
ORNAMENT: Windows

ALTERATIONS: N/A

**United States Department of the Interior  
National Park Service**

**National Register of Historic Places  
Inventory—Nomination Form**

ROCKLAND RESIDENTIAL HISTORIC DISTRICT

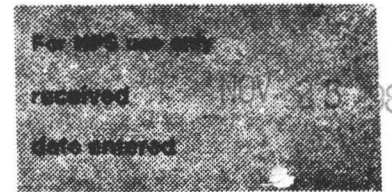

Continuation sheet

Item number

7

Page

7

NO. 55 ADDRESS: 9 Lincoln Street  
PROPERTY/DATE: Martin Labe House, c. 1893  
ARCH/BLDR: Unknown  
STYLE: Queen Anne period ROOF: Gable  
STRUCTURE: Wood Fr., 1½ WINDOWS: 2/2  
EXTERIOR: Vinyl  
ORNAMENT: Portico with turned posts and brackets  
  
ALTERATIONS: Siding

NO. 57 ADDRESS: 16 Lincoln Street  
PROPERTY/DATE: William Hill House, 1888/93  
ARCH/BLDR: W. H. Glover & Co., Builders  
STYLE: Queen Anne ROOF: Hipped  
STRUCTURE: Wood Frame 2½ WINDOWS:  
EXTERIOR: Aluminum siding  
ORNAMENT: Octagonal corner tower, balustrade on  
roof peak, large veranda with turned  
posted balustrade  
ALTERATIONS: Siding

NO. 59 ADDRESS: 40 Lincoln Street  
PROPERTY/DATE: McLain Grammar School, 1892  
ARCH/BLDR: Elmer I. Thomas, Lewiston  
STYLE: Romanesque ROOF: Hipped  
STRUCTURE: Brick WINDOWS: Alum. combo  
EXTERIOR: Brick  
ORNAMENT: Large Syrian entry arch, small entry  
arch for rear wing, flat arched lintels  
ALTERATIONS: Windows replaced

NO. 61 ADDRESS: 62 Limerock Street  
PROPERTY/DATE: Knox County Jail, 1892  
ARCH/BLDR: Pauley Jail Co., Cleveland, Ohio  
STYLE: Romanesque ROOF: Gable  
STRUCTURE: Brick WINDOWS: 4/4  
EXTERIOR: Brick  
ORNAMENT: Round arched windows, stair tower,  
brick belt courses, entrance portico,  
stone capping  
ALTERATIONS: N/A

NO. 56 ADDRESS: 12 Lincoln Street  
PROPERTY/DATE: Eugene Stubbs House, 1888  
ARCH/BLDR: William H. Glover & Co., Builder  
STYLE: Queen Anne ROOF: Gable  
STRUCTURE: Wood Frame, 2½ WINDOWS:  
EXTERIOR: Aluminum siding  
ORNAMENT: Corner bay, porch with decorative trim in  
pediment  
ALTERATIONS: Siding, porch posts replaced with iron

NO. 58 ADDRESS: 38 Lincoln Street  
PROPERTY/DATE: Rockland Jr. High School, 1929  
ARCH/BLDR: Bunker & Savage, Augusta  
STYLE: Neo-classical ROOF: Flat with parapet  
STRUCTURE: Brick, steel WINDOWS: Aluminum combo  
EXTERIOR: Brick and stone trim  
ORNAMENT: Brick parapet, granite portico, decorative  
modillions  
ALTERATIONS: Windows replaced

NO. 60 ADDRESS: 44 Limerock Street  
PROPERTY/DATE: Community Building, 1936  
ARCH/BLDR: Unknown  
STYLE: Art Deco ROOF: Flat  
STRUCTURE: Brick, steel WINDOWS:  
EXTERIOR: Brick, cast stone  
ORNAMENT: Polygonal center section and porch, cast  
stone parapet, multi-light sash  
ALTERATIONS: N/A

NO. 62 ADDRESS: 76 Limerock Street  
PROPERTY/DATE: Dr. Soule House, c. 1927  
ARCH/BLDR: Unknown  
STYLE: Colonial Revival ROOF: Gable  
STRUCTURE: Wood Frame, 2½ WINDOWS: 6/6  
EXTERIOR: Aluminum siding  
ORNAMENT: N/A  
ALTERATIONS: Siding

**United States Department of the Interior  
National Park Service**

**National Register of Historic Places  
Inventory—Nomination Form**

ROCKLAND RESIDENTIAL HISTORIC DISTRICT

Continuation sheet

Item number

7

Page

8

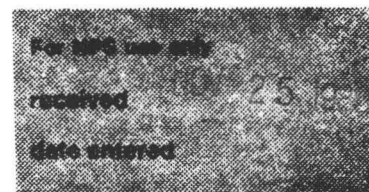

NO. 63 ADDRESS: 82 Limerock Street  
PROPERTY/DATE: Hyde House, c. 1875  
ARCH/BLDR: Unknown  
STYLE: Greek Revival ROOF: Gable  
STRUCTURE: Wood Frame, 2½ WINDOWS: 2/2  
EXTERIOR: Clapboard  
ORNAMENT: Corner pilasters, dentils, cornice  
returns  
ALTERATIONS: Enclosed porch on rear

NO. 64 ADDRESS: 87 Limerock Street  
PROPERTY/DATE: Howard House, c. 1850-55  
ARCH/BLDR: Unknown  
STYLE: Greek Revival ROOF: Gable  
STRUCTURE: Wood Frame, 2½ WINDOWS: 2/1  
EXTERIOR: Clapboard  
ORNAMENT: N/A

ALTERATIONS: Enclosed porches on front and side,  
large dormers on front

NO. 65 ADDRESS: 88 Limerock Street  
PROPERTY/DATE: Genthner House, c. 1840-55  
ARCH/BLDR: Unknown  
STYLE: Greek Revival ROOF: Gable  
STRUCTURE: Wood Frame, 1½ WINDOWS: 2/2  
EXTERIOR: Clapboard  
ORNAMENT: Pilasters, cornice, sidelights around  
door, cornice returns  
ALTERATIONS: Enclosed porch and second story on  
east side

NO. 66 ADDRESS: 96 Limerock Street  
PROPERTY/DATE: Charles E. Littlefield House, 1890  
ARCH/BLDR: E. E. Lewis, Gardiner, Architect  
STYLE: Queen Anne ROOF: Hipped, gable  
STRUCTURE: Wood Frame, 1½ WINDOWS: 2/2  
EXTERIOR: Clapboard  
ORNAMENT: Large veranda with balustrade and spindle-  
work, round corner tower with conical roof,  
novelty siding  
ALTERATIONS: Corner tower added early 1900s

NO. 67 ADDRESS: 100 Limerock Street  
PROPERTY/DATE: Frank Lamb House, 1888  
ARCH/BLDR: W. H. Glover & Co., Builders  
STYLE: Queen Anne ROOF: Gable  
STRUCTURE: Wood Frame, 2½ WINDOWS: 2/2  
EXTERIOR: Clapboard  
ORNAMENT: Dormer, gable end, porch with decorative  
woodwork, cornice with brackets, window  
caps  
ALTERATIONS: N/A

NO. 68 ADDRESS: 101 Limerock Street  
PROPERTY/DATE: House, c. 1840-55  
ARCH/BLDR: Unknown  
STYLE: Greek Revival ROOF: Gable  
STRUCTURE: Wood Frame, 1½ WINDOWS: 2/2  
EXTERIOR: Clapboard  
ORNAMENT: Cornice returns, brackets over door  
ALTERATIONS: Porch added on rear wing

NO. 69 ADDRESS: 104 Limerock Street  
PROPERTY/DATE: G. A. R. Hall, c. 1900  
ARCH/BLDR: Unknown  
STYLE: Queen Anne ROOF: Hipped  
STRUCTURE: Wood Frame, 2 WINDOWS: 2/2  
EXTERIOR: Asbestos shingles  
ORNAMENT: Two bay windows, porch with posts,  
balustrade, frieze  
ALTERATIONS: Shingles

NO. 70 ADDRESS: 105 Limerock Street  
PROPERTY/DATE: H. Hatch House, c. 1840-55  
ARCH/BLDR: Unknown  
STYLE: Greek Revival ROOF: Gable  
STRUCTURE: Wood Frame, 1½ WINDOWS: 2/1  
EXTERIOR: Clapboard  
ORNAMENT: N/A  
ALTERATIONS: Large dormers, enclosed porch, enclosed  
vestibule

**United States Department of the Interior  
 National Park Service**

**National Register of Historic Places  
 Inventory—Nomination Form**



ROCKLAND RESIDENTIAL HISTORIC DISTRICT  
 Continuation sheet

Item number

7

Page

9

NO. 71 ADDRESS: 107 Limerock Street  
 PROPERTY/DATE: Nathan Allen House, 1910-11  
 ARCH/BLDR: Freeman Stanley, Rockland  
 STYLE: Arts and Crafts ROOF: Gable  
 STRUCTURE: Wood Frame, 1½ WINDOWS: Multi-pane  
 EXTERIOR: Clapboard  
 ORNAMENT: Over-hanging eaves with exposed rafters,  
 porch posts with seralled consoles,  
 casement windows  
 ALTERATIONS: N/A

NO. 73 ADDRESS: 111 Limerock Street  
 PROPERTY/DATE: Burnham House, c. 1850s0-11  
 ARCH/BLDR: Unknown  
 STYLE: Italianate ROOF: Gable  
 STRUCTURE: Wood Frame, 2½ WINDOWS: 2/2, 1/1  
 EXTERIOR: Aluminum siding  
 ORNAMENT: Central pavilion, brackets under  
 cornices  
 ALTERATIONS: Siding, building moved to site in  
 1890

NO. 75 ADDRESS: 119-123 Limerock Street  
 PROPERTY/DATE: Apartment House, c. 1895-11  
 ARCH/BLDR: Unknown  
 STYLE: N/A ROOF: Gable  
 STRUCTURE: Wood Frame, 2½ WINDOWS: 2/1  
 EXTERIOR: Aluminum siding  
 ORNAMENT: Bay windows  
 ALTERATIONS: Siding, porch added, one story wing  
 on west side

NO. 77 ADDRESS: 129 Limerock Street  
 PROPERTY/DATE: Arthur Roak House, between 1931-35  
 ARCH/BLDR: Freeman Stanley, Rockland, Architect  
 STYLE: Arts and Crafts ROOF: Gable  
 STRUCTURE: Wood Frame, 1½ WINDOWS: 4 Vert. over 1  
 EXTERIOR: Clapboard  
 ORNAMENT: Wide eaves with exposed rafters, square  
 porch, posts and balustrade, decorative  
 windows  
 ALTERATIONS: N/A

NO. 72 ADDRESS: 110 Limerock Street  
 PROPERTY/DATE: Woodbridge-Blockington House, c. 1865  
 ARCH/BLDR: Unknown  
 STYLE: Italianate ROOF: Gable  
 STRUCTURE: Wood Frame, 2½ WINDOWS: 6/6  
 EXTERIOR: Aluminum siding  
 ORNAMENT: Brackets, dentils, quoins, window caps,  
 portico  
 ALTERATIONS: Siding

NO. 74 ADDRESS: 117 Limerock Street  
 PROPERTY/DATE: Frank Whitney House, c. 1895  
 ARCH/BLDR: Unknown  
 STYLE: Queen Anne ROOF: Gable  
 STRUCTURE: Wood Frame, 2½ WINDOWS: 2/2  
 EXTERIOR: Aluminum siding  
 ORNAMENT: Bay windows, porch with turned post and  
 decorative balustrade  
 ALTERATIONS: Siding

NO. 76 ADDRESS: 125 Limerock Street  
 PROPERTY/DATE: Guy Douglas House, by 1931  
 ARCH/BLDR: Freeman Stanley of Rockland, Architect  
 STYLE: Colonial Revival ROOF: Hipped  
 STRUCTURE: Wood Frame, 2 WINDOWS: 6/1  
 EXTERIOR: Aluminum siding  
 ORNAMENT: Wide eaves with modillions, porch with  
 Tuscan columns  
 ALTERATIONS: Siding

NO. 78 ADDRESS: 131 Limerock Street  
 PROPERTY/DATE: Richard Lufkin House, by 1931  
 ARCH/BLDR: Freeman Stanley of Rockland, Architect  
 STYLE: N/A ROOF: Hipped  
 STRUCTURE: Wood Frame, 1 WINDOWS: 6/6  
 EXTERIOR: Cedar shingleng  
 ORNAMENT: Entrance portico with columns and pediment  
 ALTERATIONS: N/A

**United States Department of the Interior  
National Park Service**

**National Register of Historic Places  
Inventory—Nomination Form**

ROCKLAND RESIDENTIAL HISTORIC DISTRICT

Continuation sheet

Item number

7

Page

10

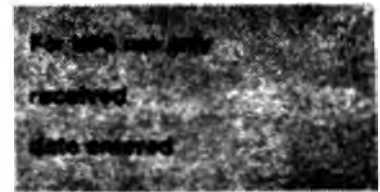

NO. 73 ADDRESS: 9 Masonic Street  
PROPERTY/DATE: Francis Case House, c. 1870  
ARCH/BLDR: Unknown  
STYLE: Greek Revival ROOF: Gable  
STRUCTURE: Wood Frame, 2½ WINDOWS: 6/6

EXTERIOR: Aluminum siding  
ORNAMENT: Cornice returns, mouldings around main entrance  
ALTERATIONS: Bay window added to east, one story wing added to north, mid-20th century

NO. 81 ADDRESS: 17 Masonic Street  
PROPERTY/DATE: Edward Ingraham House  
ARCH/BLDR: Unknown  
STYLE: Queen Anne ROOF: Hipped  
STRUCTURE: Wood Frame, 2½ WINDOWS:  
EXTERIOR: Asphalt shingles  
ORNAMENT: Projecting corner bay, vergeboard, porch with turned posts  
ALTERATIONS: Shingles, porch balusters removed

NO. 83 ADDRESS: 25 Masonic Street  
PROPERTY/DATE: House, c. 1840-55  
ARCH/BLDR: Unknown  
STYLE: Greek Revival ROOF: Gable  
STRUCTURE: Wood Frame, 1½ WINDOWS: 2/1  
EXTERIOR: Aluminum sidings  
ORNAMENT: Cornice returns, cornice and sidelights around door  
ALTERATIONS: Siding

NO. 85 ADDRESS: 41 Masonic Street  
PROPERTY/DATE: House, c. 1840-50  
ARCH/BLDR: Unknown  
STYLE: Greek Revival ROOF: Gable  
STRUCTURE: Wood Frame, 1½ WINDOWS: 6/6  
EXTERIOR: Aluminum siding  
ORNAMENT: Cornice returns and door mouldings  
ALTERATIONS: Siding

NO. 80 ADDRESS: 11 Masonic Street  
PROPERTY/DATE: Ingraham House, c. 1865  
ARCH/BLDR: Unknown  
STYLE: Mansard ROOF: Mansard  
STRUCTURE: Wood Frame, 2 WINDOWS: 4/4

EXTERIOR: Aluminum siding  
ORNAMENT: Segmental arched dormers, round arched windows with brackets in bay window  
ALTERATIONS: Porch enclosed, carriage house doors replaced with garage doors

NO. 82 ADDRESS: 21 Masonic Street  
PROPERTY/DATE: Walter Wood House, 1865-1873  
ARCH/BLDR: Unknown  
STYLE: Italianate ROOF: Gable  
STRUCTURE: Wood Frame, 2½ WINDOWS: 6/6  
EXTERIOR: Clapboard  
ORNAMENT: Window caps, round-arched frieze, cornice returns, round arched window in gable end  
ALTERATIONS: N/A

NO. 84 ADDRESS: 31 Masonic Street  
PROPERTY/DATE: Brainard House, between 1873-77  
ARCH/BLDR: Attributed to W. H. Glover, Builder  
STYLE: Italianate ROOF: Hipped  
STRUCTURE: Wood Frame, 2½ WINDOWS: 2/2  
EXTERIOR: Clapboards  
ORNAMENT: Paired brackets, cupola, bay window, porch central pavilion  
ALTERATIONS: N/A

NO. 86 ADDRESS: 45 Masonic Street  
PROPERTY/DATE: Stephen Gould House, c. 1850-55  
ARCH/BLDR: Unknown  
STYLE: Italianate ROOF: Gable  
STRUCTURE: Wood Frame, 2½ WINDOWS: 6/6  
EXTERIOR: Clapboards  
ORNAMENT: Cornice returns, window and door caps  
ALTERATIONS: N/A

United States Department of the Interior  
National Park Service

# National Register of Historic Places Inventory—Nomination Form

ROCKLAND RESIDENTIAL HISTORIC DISTRICT  
Continuation sheet

Item number

7

Page

11



NO. 87 ADDRESS: 47 Masonic Street  
PROPERTY/DATE: Russell B. Miller House, 1886  
ARCH/BLDR: W. H. Glover & Co., Builders  
STYLE: Queen Anne ROOF: Gable  
STRUCTURE: Wood Frame, 2½ WINDOWS:  
EXTERIOR: Cedar shingles  
ORNAMENT: Corner tower, large veranda with turned  
columns, brackets, bay window  
ALTERATIONS: Shingles over siding

NO. 89 ADDRESS: 55 Masonic Street  
PROPERTY/DATE: Edwin Lawry House, c. 1865-75/1888  
ARCH/BLDR: Unknown  
STYLE: Queen Anne ROOF: Gable  
STRUCTURE: Wood Frame, 2½ WINDOWS: 1/1  
EXTERIOR: Aluminum siding  
ORNAMENT: Larger corner tower  
ALTERATIONS: Two story addition and tower, 1888,  
siding, portico removed, windows  
replaced

NO. 91 ADDRESS: 63 Masonic Street  
PROPERTY/DATE: George Kaler House, between 1873-77  
ARCH/BLDR: Attributed to W. H. Glover & Co., Bldrs.  
STYLE: Italianate ROOF: Hipped  
STRUCTURE: Wood Frame, 2 WINDOWS: 2/2  
EXTERIOR: Clapboard  
ORNAMENT: Cupola, brackets, window caps, central  
pavilion  
ALTERATIONS: N/A

NO. 93 ADDRESS: 9 White Street  
PROPERTY/DATE: St. Peters' Episcopal Church,  
1883-84/1891  
ARCH/BLDR: William Ralph Emerson, Boston, Architect  
STYLE: Shingle Style ROOF: Gable  
STRUCTURE: Wood Frame, 1½ WINDOWS: Diamond-pane  
EXTERIOR: Shingles  
ORNAMENT: Shingle siding, stylized gables, dormer  
ALTERATIONS: N/A

NO. 89 ADDRESS: 51 Masonic Street  
PROPERTY/DATE: Gilbert Atherton House, c. 1876  
ARCH/BLDR: Unknown  
STYLE: Vernacular ROOF: Gable  
STRUCTURE: Wood Frame, 1½ WINDOWS: 6/6  
EXTERIOR: Aluminum siding  
ORNAMENT: N/A  
ALTERATIONS: Siding, picture window

NO. 90 ADDRESS: 59 Masonic Street  
PROPERTY/DATE: Charles Wood House, between 1873-87  
ARCH/BLDR: Attributed to W. H. Glover & Co., Builders  
STYLE: Italianate ROOF: Hipped  
STRUCTURE: Wood Frame, 2½ WINDOWS: 2/2  
EXTERIOR: Clapboards  
ORNAMENT: Cupola, brackets, window caps, portico,  
bay window, central pavilion  
ALTERATIONS: N/A

NO. 92 ADDRESS: 67 Masonic Street  
PROPERTY/DATE: Edward K. Glover Hse., between 1877-82  
ARCH/BLDR: Attributed to W. H. Glover & Co., Builders  
STYLE: Italianate ROOF: Hipped  
STRUCTURE: Wood Frame, 2 WINDOWS: 2/2  
EXTERIOR: Clapboards  
ORNAMENT: Brackets, cupola, portico, central pavilion,  
dentils, window caps, bay window  
ALTERATIONS: N/A

NO. 94 ADDRESS: (No Number) White Street  
PROPERTY/DATE: Bole Nurses Home, 1928  
ARCH/BLDR: Unknown  
STYLE: Georgian Revival ROOF: Gable  
STRUCTURE: Masonry, 2½ WINDOWS: 8/12  
EXTERIOR: Brick  
ORNAMENT: Pedimented gable ends, quoins, pediment over  
entrance, stone trim, lunettes  
ALTERATIONS: N/A

**United States Department of the Interior  
National Park Service**

**National Register of Historic Places  
Inventory—Nomination Form**

ROCKLAND RESIDENTIAL HISTORIC DISTRICT

Continuation sheet

Item number

7

Page

12



NO. 95 ADDRESS: 1 Walker Place  
PROPERTY/DATE: George McLaughlin House, c. 1895  
ARCH/BLDR: Unknown  
STYLE: Queen Anne period ROOF: Gable  
STRUCTURE: Wood Frame, 1½ WINDOWS: 1/1  
EXTERIOR: Clapboard  
ORNAMENT: Portico over entrance  
  
ALTERATIONS: N/A

NO. 97 ADDRESS: 5 Walker Place  
PROPERTY/DATE: Rev. John Moody House, 1892  
ARCH/BLDR: Unknown  
STYLE: Queen Anne ROOF: Gable  
STRUCTURE: Wood Frame, 2½ WINDOWS: 2/1  
EXTERIOR: Aluminum siding  
ORNAMENT: N/A  
  
ALTERATIONS: Siding

NO. 99 ADDRESS: 11 Maple Street  
PROPERTY/DATE: Spear House, c. 1845-55c. 1894  
ARCH/BLDR: Unknown  
STYLE: Greek Revival ROOF: Gable  
STRUCTURE: Wood Frame, 2½ WINDOWS: 6/6  
EXTERIOR: Clapboards  
ORNAMENT: Cornic returns, window caps  
  
ALTERATIONS: N/A

NO. 101 ADDRESS: 18 Maple Street  
PROPERTY/DATE: House, c. 1875  
ARCH/BLDR: Unknown  
STYLE: Greek Revival ROOF: Gable  
STRUCTURE: Wood Frame, 2½ WINDOWS: 2/2  
EXTERIOR: Clapboards  
ORNAMENT: Cornice returns, window and door caps  
ALTERATIONS: N/A

NO. 103 ADDRESS: 24 Maple Street  
PROPERTY/DATE: House, c. 1898  
ARCH/BLDR: Unknown  
STYLE: N/A ROOF: Gable  
STRUCTURE: Wood Frame, 1½ WINDOWS:  
EXTERIOR: Clapboards  
ORNAMENT: Stained Glass picture window  
  
ALTERATIONS: N/A

NO. 96 ADDRESS: 3 Walker Place  
PROPERTY/DATE: Alden Hayden House, 1894  
ARCH/BLDR: Unknown  
STYLE: Queen Anne ROOF: Gable  
STRUCTURE: Masonry, 2½ WINDOWS: 1/1  
EXTERIOR: Aluminum siding  
ORNAMENT: Porch with turned posts, balustrade and  
spindle-work  
ALTERATIONS: Siding

NO. 98 ADDRESS: 2-6 Maple Street  
PROPERTY/DATE: Knox Co. Gen. Hosp., 1916 w/additions  
ARCH/BLDR: R. Clipston Sturgis of Boston  
STYLE: Georgian Revival ROOF: Gable, hipped  
STRUCTURE: Masonry, 2½ WINDOWS: Multi-pane  
EXTERIOR: Brick  
ORNAMENT: Pedimented gable ends with round arched  
windows  
ALTERATIONS: Wings added: 1922, 1928, 1959, 1969

NO. 100 ADDRESS: 17 Maple Street  
PROPERTY/DATE: House, c. 1840  
ARCH/BLDR: Unknown  
STYLE: Queen Anne ROOF: Gable  
STRUCTURE: Wood Frame, 2½ WINDOWS: 2/1  
EXTERIOR: Clapboards  
ORNAMENT: Two porches with turned posts, balustrade,  
spindle-work  
ALTERATIONS: N/A

NO. 102 ADDRESS: 20-22 Maple Street  
PROPERTY/DATE: Dr. Fuller Cook House, between 1855-73  
ARCH/BLDR: Unknown  
STYLE: Greek Revival ROOF: Gable  
STRUCTURE: Wood Frame, 1½ WINDOWS: 6/6  
EXTERIOR: Clapboards  
ORNAMENT: Entrance vestibule, cornice returns  
ALTERATIONS: N/A

NO. 104 ADDRESS: 23-25 Maple Street  
PROPERTY/DATE: Bird Tenement, c. 1900  
ARCH/BLDR: Unknown  
STYLE: Tudor ROOF: Gable  
STRUCTURE: Wood Frame, 2½ WINDOWS: 1/1  
EXTERIOR: Shingles, clapboards  
ORNAMENT: Second story over-hang with joist ends,  
oriel windows, battens in gable ends, porch  
with posts and balustrade  
ALTERATIONS: N/A

**United States Department of the Interior  
National Park Service**

**National Register of Historic Places  
Inventory—Nomination Form**

ROCKLAND RESIDENTIAL HISTORIC DISTRICT

Continuation sheet

Item number

7

Page

13



NO. 105 ADDRESS: 7-9 Grove Street  
PROPERTY/DATE: House, between 1855-1875  
ARCH/BLDR: Unknown  
STYLE: Greek Revival ROOF: Gable  
STRUCTURE: Wood Frame, 1½ WINDOWS: 6/6  
EXTERIOR: Clapboards  
ORNAMENT: Corner pilasters, entablature and  
pilasters around door  
ALTERATIONS: Late 19<sup>th</sup> century wings removed

NO. 107 ADDRESS: 12 Grove Street  
PROPERTY/DATE: House, c. 1845-55  
ARCH/BLDR: Unknown  
STYLE: Gothic Revival ROOF: Gable  
STRUCTURE: Wood Frame, 1½ WINDOWS: 6/6  
EXTERIOR: Clapboards  
ORNAMENT: Vergeboard  
ALTERATIONS: Dormer additions on wing

NO. 109 ADDRESS: 15 Grove Street  
PROPERTY/DATE: House, c. 1820  
ARCH/BLDR: Att. to Freeman Stanley, Rockland, Arch.  
STYLE: Bungalow ROOF: Gable  
STRUCTURE: Wood Frame, 1½ WINDOWS: Ribbon windows  
EXTERIOR: Aluminum siding  
ORNAMENT: Porch with large posts and balustrade,  
wide eaves and vergeboard  
ALTERATIONS: Siding

NO. 111 ADDRESS: 18 Grove Street  
PROPERTY/DATE: Samuel Magridge House, c. 1875  
ARCH/BLDR: Unknown  
STYLE: Greek Revival ROOF: Gable  
STRUCTURE: Wood Frame, 2½ WINDOWS: 2/1  
EXTERIOR: Clapboard  
ORNAMENT: Cornice returns, brackets  
ALTERATIONS: Siding

NO. 113 ADDRESS: 22 Grove Street  
PROPERTY/DATE: A. J. Pierce House, c. 1850-55  
ARCH/BLDR: Unknown  
STYLE: Italianate ROOF: Gable  
STRUCTURE: Wood Frame, 2½ WINDOWS: 2/1  
EXTERIOR: Asbestos shingles  
ORNAMENT: Brackets, round arched bay windows  
ALTERATIONS: Siding, porch removed

NO. 106 ADDRESS: 11 Grove Street  
PROPERTY/DATE: House, mid-19<sup>th</sup> century  
ARCH/BLDR: Unknown  
STYLE: Greek Revival ROOF: Gable  
STRUCTURE: Wood Frame, 1½ WINDOWS: 1/1  
EXTERIOR: Clapboards  
ORNAMENT: Cornice returns  
ALTERATIONS: Enclosed porch and large dormer, east side

NO. 108 ADDRESS: 14 Grove Street  
PROPERTY/DATE: House, c. 1850-55  
ARCH/BLDR: Unknown  
STYLE: N/A ROOF: Gable  
STRUCTURE: Wood Frame, 1½ WINDOWS: 1/1  
EXTERIOR: Clapboards  
ORNAMENT: N/A  
ALTERATIONS: Porch posts and railing removed

NO. 111 ADDRESS: 17 Grove Street  
PROPERTY/DATE: Peck House, c. 1845-1855  
ARCH/BLDR: Unknown  
STYLE: Greek Revival ROOF: Gable  
STRUCTURE: Wood Frame, 2½ WINDOWS: 2/2  
EXTERIOR: Clapboards  
ORNAMENT: Pedimented gable end, bay window  
ALTERATIONS: N/A

NO. 112 ADDRESS: 19-21 Grove Street  
PROPERTY/DATE: J. D. May Tenement, 1893  
ARCH/BLDR: Austin Pease, Portland, Architect  
STYLE: Colonial Revival ROOF: Hipped, gambrel  
STRUCTURE: Wood Frame, 2½ WINDOWS: 2/1  
EXTERIOR: Clapboards  
ORNAMENT: Bay windows, gambrel roof pavilion, novelty  
siding  
ALTERATIONS: Porch posts and railing removed

NO. 114 ADDRESS: 25 Grove Street  
PROPERTY/DATE: John D. May House, 1889  
ARCH/BLDR: J. F. Waterhouse of Rockland, Architect  
STYLE: Queen Anne ROOF: Hipped  
STRUCTURE: Wood Frame, 2½ WINDOWS: Unknown  
EXTERIOR: Clapboards  
ORNAMENT: Large veranda with turned posts and  
balustrade, pedimented gable ends with  
Queen Anne sash  
ALTERATIONS: N/A

**United States Department of the Interior  
National Park Service**

**National Register of Historic Places  
Inventory—Nomination Form**

ROCKLAND RESIDENTIAL HISTORIC DISTRICT  
Continuation sheet

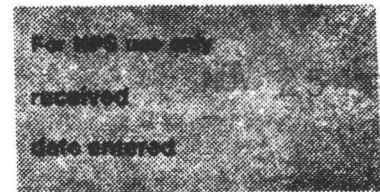

Item number 7 Page 14

NO. 115 ADDRESS: 26 Grove Street  
PROPERTY/DATE: House, c. 1845-55  
ARCH/BLDR: Unknown  
STYLE: Greek Revival ROOF: Gable  
STRUCTURE: Wood Frame, 1½ WINDOWS: 6/6  
EXTERIOR: Vinyl siding  
ORNAMENT: Cornice and sidelights around door  
ALTERATIONS: Siding

NO. 116 ADDRESS: 30-32 Grove Street  
PROPERTY/DATE: House, between 1855-1873  
ARCH/BLDR: Unknown  
STYLE: Greek Revival ROOF: Gable  
STRUCTURE: Wood Frame, 2½ WINDOWS: 2/2  
EXTERIOR: Clapboards  
ORNAMENT: Dentils under cornice  
ALTERATIONS: Porch enclosed

NO. 117 ADDRESS: 33 Grove Street  
PROPERTY/DATE: Albert McLeon House, c. 1898  
ARCH/BLDR: Unknown  
STYLE: Queen Anne ROOF: Hipped, gable  
STRUCTURE: Wood Frame, 2½ WINDOWS: 2/2  
EXTERIOR: Asbestos shingle  
ORNAMENT: Large veranda with turned posts,  
balustrade and spindle-work, pedimented  
gable ends  
ALTERATIONS: Siding

NO. 118 ADDRESS: 36 Grove Street  
PROPERTY/DATE: House, c. 1860-70  
ARCH/BLDR: Unknown  
STYLE: N/A ROOF: Gable  
STRUCTURE: Wood Frame, 2½ WINDOWS: 2/2  
EXTERIOR: Clapboards  
ORNAMENT: Cornice over door  
ALTERATIONS: N/A

NO. 119 ADDRESS: 39 Grove Street  
PROPERTY/DATE: Keene House, c. 1850-55  
ARCH/BLDR: Unknown  
STYLE: Greek Revival ROOF: Gable  
STRUCTURE: Wood Frame, 2½ WINDOWS: 6/6  
EXTERIOR: Aluminum siding  
ORNAMENT: Window caps, entablatures over doorway  
ALTERATIONS: Siding

NO. 120 ADDRESS: 40 Grove Street  
PROPERTY/DATE: House, c. 1850-55  
ARCH/BLDR: Unknown  
STYLE: Greek Revival ROOF: Gable  
STRUCTURE: Wood Frame, 2½ WINDOWS: 6/6  
EXTERIOR: Aluminum siding  
ORNAMENT: N/A  
ALTERATIONS: Siding

NO. 121 ADDRESS: 45 Grove Street  
PROPERTY/DATE: House, c. 1860-70  
ARCH/BLDR: Unknown  
STYLE: N/A ROOF: Gable  
STRUCTURE: Wood Frame, 2½ WINDOWS: 6/6  
EXTERIOR: Aluminum siding  
ORNAMENT: Window and door caps  
ALTERATIONS: Siding

NO. 122 ADDRESS: 69 Broad Street  
PROPERTY/DATE: William A. Glover House, c. 1920  
ARCH/BLDR: W. H. Glover & Co., Builders  
STYLE: Colonial Revival ROOF: Hipped, gambrel  
STRUCTURE: Wood Frame, 2 WINDOWS: 6/1, paired  
EXTERIOR: Clapboard  
ORNAMENT: Porch with Tuscan columns, gambrel roof  
central pavilion, wide eaves  
ALTERATIONS: N/A

NO. 123 ADDRESS: 75 Broad Street  
PROPERTY/DATE: House, c. 1875  
ARCH/BLDR: Unknown  
STYLE: Italianate ROOF: Gable  
STRUCTURE: Wood Frame, 2½ WINDOWS: 2/2  
EXTERIOR: Clapboards  
ORNAMENT: Brackets under cornice, window and door  
caps  
ALTERATIONS: N/A

NO. 124 ADDRESS: 77-79 Broad Street  
PROPERTY/DATE: Double House, c. 1875  
ARCH/BLDR: Unknown  
STYLE: Italianate ROOF: Gable  
STRUCTURE: Wood Frame, 1½ WINDOWS: 6/6  
EXTERIOR: Vinyl siding  
ORNAMENT: Dentils, round arched attic windows  
ALTERATIONS: Siding

**United States Department of the Interior  
National Park Service**

**National Register of Historic Places  
Inventory—Nomination Form**

ROCKLAND RESIDENTIAL HISTORIC DISTRICT

Continuation sheet

Item number

7

Page

15



NO. 125 ADDRESS: Union Street  
PROPERTY/DATE: Rockland Public Library, 1903 (NR)  
ARCH/BLDR: George Clough of Boston  
STYLE: Renaissance ROOF: Gable  
STRUCTURE: Masonry, 1½ WINDOWS: Multi-pane  
EXTERIOR: Stone  
ORNAMENT: Pedimented central pavilion with columns  
in antis and large lunette; polygonal  
reading room with pilasters  
ALTERATIONS: N/A

NO. 127 ADDRESS: 2 Claremont Street  
PROPERTY/DATE: E. F. Glover House, 1917-1921  
ARCH/BLDR: E. F. Glover, architect  
STYLE: Colonial Revival ROOF: Gambrel  
STRUCTURE: Wood Frame, 2 WINDOWS: 6/6  
EXTERIOR: Cedar shingles  
ORNAMENT: Enclosed porches with balustrades at  
each gable end, classical portico over  
entry, door with sidelights and lunette  
ALTERATIONS: N/A

NO. 129 ADDRESS: 10 Claremont Street  
PROPERTY/DATE: Horatio Keene House, bet. 1873-77  
ARCH/BLDR: Unknown  
STYLE: Mansard ROOF: Mansard  
STRUCTURE: Wood Frame, 3 WINDOWS: 2/2  
EXTERIOR: Clapboard  
ORNAMENT: Dormers with gable roofs, double porches,  
cornices, and window caps with brackets  
ALTERATIONS: N/A

NO. 131 ADDRESS: 13 Claremont Street  
PROPERTY/DATE: House, c. 1875-80  
ARCH/BLDR: Unknown  
STYLE: Italianate ROOF: Gable  
STRUCTURE: Wood Frame, 2½ WINDOWS: 2/2  
EXTERIOR: Clapboard  
ORNAMENT: Brackets, bay windows portico over  
entry window caps, porte cochere,  
Palladian window  
ALTERATIONS: Colonial Revival style ornament  
added

NO. 126 ADDRESS: 62 Union Street  
PROPERTY/DATE: Knox County Courthouse, 1874 (NR)  
ARCH/BLDR: Bryant & Rogers of Boston  
STYLE: Italianate ROOF: Hipped  
STRUCTURE: Masonry, 3 WINDOWS: 4/4  
EXTERIOR: Brick with stone trim  
ORNAMENT: Cornice with brackets; round and segmental  
arched windows; central pavilion with  
columned portico; high basement  
ALTERATIONS: Large two story brick and stone wing, on  
south, 1970s

NO. 128 ADDRESS: 9 Claremont Street  
PROPERTY/DATE: House, c. 1875-80  
ARCH/BLDR: Unknown  
STYLE: Italianate ROOF: Gable  
STRUCTURE: Wood Frame, 2½ WINDOWS: 6/6  
EXTERIOR: Clapboards  
ORNAMENT: Front and side porches with turned  
columns, balustrade, window caps, bay  
window  
ALTERATIONS: Large two story wing on rear (west),  
mid-20th century

NO. 130 ADDRESS: 16 Claremont Street  
PROPERTY/DATE: House, c. 1875-80  
ARCH/BLDR: Unknown  
STYLE: Italianate ROOF: Gable  
STRUCTURE: Wood Frame, 2½ WINDOWS: 2/2  
EXTERIOR: Clapboard  
ORNAMENT: Multiple bay windows, cornice with  
dentils, portico and brackets over main  
entry, round arched attic window  
ALTERATIONS: N/A

NO. 132 ADDRESS: 29 High Street  
PROPERTY/DATE: House, c. 1920-30  
ARCH/BLDR: Unknown  
STYLE: Colonial Revival ROOF: Modified Gable  
STRUCTURE: Wood Frame, 1½ WINDOWS: 6/6  
EXTERIOR: Clapboard  
ORNAMENT:  
ALTERATIONS: Roof raised in rear

**United States Department of the Interior  
National Park Service**

**National Register of Historic Places  
Inventory—Nomination Form**



ROCKLAND RESIDENTIAL HISTORIC DISTRICT  
Continuation sheet

Item number 7 Page 16

NO. 133 ADDRESS: 30 High Street  
PROPERTY/DATE: Henry Tibbetts House, c. 1890  
ARCH/BLDR: Unknown  
STYLE: Queen Anne ROOF: Hipped  
STRUCTURE: Wood Frame, 2½ WINDOWS:  
EXTERIOR: Asbestos shingles  
ORNAMENT: Octagonal corner tower, oriel window,  
modillions under cornice  
ALTERATIONS: Porch removed, siding

NO. 135 ADDRESS: 38 High Street  
PROPERTY/DATE: Levi Ulmer House, c. 1830-35  
ARCH/BLDR: Unknown  
STYLE: Greek Revival ROOF: Gable  
STRUCTURE: Wood Frame, 1½ WINDOWS: 5/6  
EXTERIOR: Clapboard  
ORNAMENT: Entry with pilasters and sidelights

ALTERATIONS: N/A

NO. 137 ADDRESS: 223 Broadway  
PROPERTY/DATE: Lincoln McRae House, c. 1927-31  
ARCH/BLDR: Unknown  
STYLE: Colonial Revival ROOF: Gambrel  
STRUCTURE: Wood Frame, 2 WINDOWS: 5/1  
EXTERIOR: Aluminum siding  
ORNAMENT: Gambrel roof, enclosed vestibule  
sleeping porch

ALTERATIONS: Siding

NO. 139 ADDRESS: 235 Broadway  
PROPERTY/DATE: William Healey House, c. 1896-1900  
ARCH/BLDR: Unknown  
STYLE: Queen Anne ROOF: Gable  
STRUCTURE: Wood Frame, 2½ WINDOWS: 2/1  
EXTERIOR: Vinyl siding  
ORNAMENT:  
ALTERATIONS: Siding, decorative trim removed

NO. 134 ADDRESS: 34 High Street  
PROPERTY/DATE: Benjamin Littlefield House, c. 1850  
ARCH/BLDR: Unknown  
STYLE: Greek Revival ROOF: Gable  
STRUCTURE: Wood Frame, 2½ WINDOWS: 2/2  
EXTERIOR: Aluminum siding  
ORNAMENT:

ALTERATIONS: Siding, entrance vestibule

NO. 136 ADDRESS: 215 Broadway  
PROPERTY/DATE: Charles Richardson House, 1925  
ARCH/BLDR: Unknown  
STYLE: Colonial Revival ROOF: Hipped  
STRUCTURE: Wood Frame, 2½ WINDOWS: 5/1  
EXTERIOR: Clapboard  
ORNAMENT: Wide eaves with modillions, columned  
portico over entry, sun porch with  
pilasters and brackets

ALTERATIONS: N/A

NO. 138 ADDRESS: 233 Broadway  
PROPERTY/DATE: Chester Walker House, c. 1891  
ARCH/BLDR: Edward F. Glover, Rockland, Architect  
STYLE: Queen Anne ROOF: Gable  
STRUCTURE: Wood Frame, 2½ WINDOWS: 2/2  
EXTERIOR: Clapboard  
ORNAMENT: Two porches with turned posts, spindle  
work and balustrade, novelty siding in  
gable end

ALTERATIONS: N/A

NO. 140 ADDRESS: 239 Broadway  
PROPERTY/DATE: Eugene Rose House, c. 1896-1900  
ARCH/BLDR: Unknown  
STYLE: Queen Anne ROOF: Gable  
STRUCTURE: Wood Frame, 2½ WINDOWS: 2/2  
EXTERIOR: Aluminum siding  
ORNAMENT: Bay window, porch with turned posts  
ALTERATIONS: N/A

United States Department of the Interior  
National Park Service

National Register of Historic Places  
Inventory—Nomination Form

ROCKLAND RESIDENTIAL HISTORIC DISTRICT

Continuation sheet

Item number

7

Page

17



NO. 141 ADDRESS: 241 Broadway  
PROPERTY/DATE: Lewis Starrett House, c. 1890-95  
ARCH/BLDR: Unknown  
STYLE: Queen Anne ROOF: Gable  
STRUCTURE: Wood Frame, 2½ WINDOWS: 1/1  
EXTERIOR: Cedar shingles  
ORNAMENT: Brackets, bay windows, novelty siding  
in gable ends, porch with turned posts  
ALTERATIONS: Shingles

NO. 142 ADDRESS: 249 Broadway  
PROPERTY/DATE: Charles S. Crockett House, 1889  
ARCH/BLDR: W. H. Glover & Co., Builders  
STYLE: Queen Anne ROOF: Gable  
STRUCTURE: Wood Frame, 2½ WINDOWS: 2/2  
EXTERIOR: Clapboards  
ORNAMENT: Queen Anne sash in multiple gable ends  
ALTERATIONS: Front porch removed, sun porch added  
in 1940, rear porch added in 1980,  
door remodelled

The following buildings do not contribute to the historic district:

No. 143 Office Building  
12 Maple Street  
1 story  
wood and metal exterior  
gable roof  
built c. 1960-70

No. 144 House  
50 Talbot Avenue  
1½ story  
wood frame, clapboard siding  
gable roof, Cape Cod style  
built c. 1960

## 8. Significance

Period	Areas of Significance—Check and justify below			
<input type="checkbox"/> prehistoric	<input type="checkbox"/> archeology-prehistoric	<input type="checkbox"/> community planning	<input type="checkbox"/> landscape architecture	<input type="checkbox"/> religion
<input type="checkbox"/> 1400-1499	<input type="checkbox"/> archeology-historic	<input type="checkbox"/> conservation	<input type="checkbox"/> law	<input type="checkbox"/> science
<input type="checkbox"/> 1500-1599	<input type="checkbox"/> agriculture	<input type="checkbox"/> economics	<input type="checkbox"/> literature	<input type="checkbox"/> sculpture
<input type="checkbox"/> 1600-1699	<input checked="" type="checkbox"/> architecture	<input type="checkbox"/> education	<input type="checkbox"/> military	<input type="checkbox"/> social
<input type="checkbox"/> 1700-1799	<input type="checkbox"/> art	<input type="checkbox"/> engineering	<input type="checkbox"/> music	<input type="checkbox"/> humanitarian
<input checked="" type="checkbox"/> 1800-1899	<input type="checkbox"/> commerce	<input type="checkbox"/> exploration/settlement	<input type="checkbox"/> philosophy	<input type="checkbox"/> theater
<input checked="" type="checkbox"/> 1900-	<input type="checkbox"/> communications	<input type="checkbox"/> industry	<input type="checkbox"/> politics government	<input type="checkbox"/> transportation
		<input type="checkbox"/> invention		<input type="checkbox"/> other (specify)

Specific dates      Various

Builder/Architect

Various

### Statement of Significance (in one paragraph)

The Rockland Residential Historic District embraces a large cluster of the city's most significant nineteenth and early twentieth century buildings including residential, governmental and public structures. Although the principal period of construction lies in the decades between the 1870s and 1920s the district contains significant contributing buildings dating to the 1840s and 1850s through 1936 when the Art Deco style Community Building was erected. The buildings are historically important as a concentration of major public edifices and houses built by Rockland's leading citizens. Architecturally, the area is significant for examples of the work of prominent builders and architects.

The City of Rockland's early 19<sup>th</sup> century development was based on shipbuilding and the lime industry. Originally part of the Town of Thomaston, Rockland broke away in 1848 and soon outstripped the older community in industrial development. This initial pre-Civil War period of prosperity included the construction of a number of large homes and commercial blocks and culminated in 1860, with the creation of Knox County with Rockland as the county seat. This antebellum growth touched the area within the proposed district only in a limited way. Initial development here consisted chiefly of the laying off of side streets along which a few houses were built. The small-scale Greek Revival dwellings which remain reflect on this period of Rockland's growth. The Civil War brought a depression in the lime export industry with the close of southern markets and a decline in building activity nationally which reduced demand for plaster. Sustained economic prosperity did not get underway until after the depression of 1873-76.

The earliest major building activity in the district occurred in 1873 and 1874 with the erection of two large Mansard style homes for William H. Glover and A. F. Ames, respectively, on Talbot Avenue. They were followed, in 1875, by the erection of the Knox County Courthouse on Main Street (N.R.), and a group of Italianate style homes on Masonic Street. With Talbot Avenue forming the north edge, Union Street on the east and Masonic Street on the south, the construction of these important buildings established the parameters of what became the most desirable neighborhood in the city.

By 1888 Rockland was the largest city in the mid-coast region with over 80 lime kilns shipping 1.5 million casks of lime annually in 20 ships, 40 barks and

## 9. Major Bibliographical References

Courier-Gazette (Rockland), 1885-1890.

Tax Records, City of Rockland.

Shore Village Story, edited by Brian R. Harden, Rockland, 1976.

## 10. Geographical Data

Acreage of nominated property 54

Quadrangle name Rockland

Quadrangle scale 1:24,000

UTM References

A 

1	9	4	9	10	6	8	10	4	8	8	3	1	3	0
Zone			Easting				Northing							

B 

1	9	4	9	10	5	0	4	8	8	3	1	3	0
Zone			Easting				Northing						

C 

1	9	4	9	10	9	8	10	4	8	8	3	6	5	0
Zone			Easting				Northing							

D 

1	9	4	9	0	6	4	0	4	8	8	3	7	3	0
Zone			Easting				Northing							

E 

1	9	4	9	0	5	6	0	4	8	8	3	3	5	0
Zone			Easting				Northing							

F 

1	9	4	9	0	7	0	1	4	8	8	3	3	0	1
Zone			Easting				Northing							

G 

Zone			Easting				Northing							

H 

Zone			Easting				Northing							

Verbal boundary description and justification

Boundaries to follow property lines as indicated on district map. Area included is roughly bounded by Masonic, Broad, Limerock, Broadway, Granite, and Union Streets.

List all states and counties for properties overlapping state or county boundaries

state code county code

state code county code

## 11. Form Prepared By

name/title Roger G. Reed, Architectural Historian

organization Maine Historic Preservation Commission date September, 1986

street & number 55 Capitol Street, Station #65 telephone 207/289-2132

city or town Augusta, state Maine 04333

## 12. State Historic Preservation Officer Certification

The evaluated significance of this property within the state is:

national  state  local

As the designated State Historic Preservation Officer for the National Historic Preservation Act of 1966 (Public Law 89-665), I hereby nominate this property for inclusion in the National Register and certify that it has been evaluated according to the criteria and procedures set forth by the National Park Service.

State Historic Preservation Officer signature Eileen S. Fitzpatrick

title S.H.P.O.

date 11/17/87

For NPS use only

I hereby certify that this property is included in the National Register

William B. Bushong  
Keeper of the National Register

date 4/15/87

Attest: Beth L. Savage  
Chief of Registration

date 4-15-87

United States Department of the Interior  
National Park Service

National Register of Historic Places  
Inventory—Nomination Form

For NPS use only

received

5 1987

date entered

ROCKLAND RESIDENTIAL HISTORIC DISTRICT

Continuation sheet

Item number

8

Page

2

150 schooners. As was typical of a city this size, Rockland also manufactured boots and shoes, carriages, harnesses, and machinery. Leading businessmen frequently chose to build homes in the proposed district. Prominent among them were the Bird family, the Cobb family, A. F. Crockett, the Glover family, Fred Spear, and H. G. Tibbetts. Some of these men, such as Francis Cobb and Fred Spear, operated lime kilns. Others owned interests in kilns, or the schooners which exported the lime, in addition to their principal concerns. As was typical of 19<sup>th</sup> century entrepreneurs, the wealthier citizens of Rockland derived their income, which fueled the city's prosperity, from a variety of sources.

The increase in residential construction coincided with the erection of a variety of public and semi-public buildings in the district. Following the construction of the County Courthouse in 1875 was the Episcopal Church of 1883-84, the McLain Grammar School of 1892, the County Jail of 1892, the public library of 1903, and the County hospital of 1916. The erection of these buildings, followed by the high school and the Nurses Home of 1928, and the Community Building of 1936, kept this neighborhood a desirable area despite the end of shipbuilding and the lime industry in the 1920s. In keeping with national trends, new residential construction consisted generally of smaller homes built in the bungalow and period revival styles. By the middle of this century, there were few vacant lots available and new homes tended to be constructed on larger lots in outlying areas of the city. At the same time, many of the spacious 19<sup>th</sup> century residences underwent conversion into multi-family dwellings.

The architectural character of the district is dominated by large homes in the Queen Anne style and public buildings in variations of Neo-Classical modes. For the latter, leading architects from outside Rockland were hired. These included Boston's Bryant and Rogers (the County Courthouse), George Clough (the public library), R. Clipston Sturgis (the County hospital), and William Ralph Emerson (the Episcopal Church). Also important were Lewiston's Elmer I. Thomas (the McLain School), and Augusta's Bunker and Savage (the high school). Prominent Maine architects designed a few of the residences, such as Charles F. Douglas (the William H. Glover House), Kimball and Coombs (the A. F. Ames House) and E. E. Lewis (the Charles Littlefield House). Local architects and builders, however, were primarily responsible for shaping the architectural character of the residential areas.

Among Rockland's 19<sup>th</sup> century architects, builders and carpenters, one firm, W. H. Glover and Company, clearly dominated the building trades. This firm, which figured prominently throughout the state, sold lumber, sash, doors

United States Department of the Interior  
National Park ServiceNational Register of Historic Places  
Inventory—Nomination Form

For NPS use only	
received	MAR 5 1987
date entered	

ROCKLAND RESIDENTIAL HISTORIC DISTRICT

Continuation sheet

Item number

8

Page

3

and blinds, mill-work and cast iron elements, as well as architectural designs. Indeed, one member of the family, Edward F. Glover, apparently served as the company architect. That this firm based its architectural designs on published sources or on the work of architects for whom they had erected buildings, seems clear. Each of the four Glover family members who lived in the proposed district owned houses either designed by prominent architects or borrowed from locally-known architect-designed residences.

Large Queen Anne style homes in the District, built by the Glover firm, include 12 Lincoln Street, 16 Lincoln Street, 88-90 Talbot Street, 63 Summer Street, 81-83 Summer Street, 5 Beech Street, 100 Limerock Street, 47 Masonic Street, and 249 Broadway. Regardless of design sources, these houses display a splendid variety of ornamental treatment, each with its own character. Also identified are houses constructed from designs sold by prominent mail order firms such as Palliser, Palliser and Company (57 Talbot Avenue), and George F. Barber and Company (69 Beech Street, 55 Summer Street).

By the early 20<sup>th</sup> century, building activity in Rockland declined. For the smaller homes typical of this period, local architect Freeman Stanley apparently supplanted the Glovers. The district includes several examples of this man's work, mostly in the Bungalow style. Stanley's designs are finely detailed and among the best examples of this mode in the state. The Allen House at 107 Limerock Street and the Roakes House at 129 Limerock Street are particularly outstanding.

The research for this nomination was based on primary sources such as 19<sup>th</sup> century newspapers, tax records, maps, and city directories. This material was developed in a local building survey conducted in 1986. Based on this research, District boundaries were established which reflect the historical development of the area and exclude large concentrations of residential buildings which are altered and/or have minimal architectural significance.

NATIONAL REGISTER OF HISTORIC PLACES  
EVALUATION/RETURN SHEET

Rockland Residential Historic District  
Knox County  
MAINE

NOV 25 1986

Substantive Review

Working No. \_\_\_\_\_  
Fed. Reg. Date: 2/2/88  
Date Due: 4/19/87  
Action:  ACCEPT 4-15-87  
 RETURN  
 REJECT  
Federal Agency: \_\_\_\_\_

- resubmission
- nomination by person or local government
- owner objection
- appeal

Substantive Review:  sample  request  appeal  NR decision

Reviewer's comments:

*Fine collection of representative architectural styles in Rockland.*

Recom./Criteria Accept C  
Reviewer Savage  
Discipline Architectural History  
Date 4/15/87

*Initial return comments have been rectified.*

see continuation sheet

Nomination returned for: \_\_\_\_\_ technical corrections cited below  
\_\_\_\_\_ substantive reasons discussed below

1. Name

2. Location

3. Classification

Category Ownership Status Present Use  
Public Acquisition Accessible

4. Owner of Property

5. Location of Legal Description

6. Representation in Existing Surveys

Has this property been determined eligible?  yes  no

7. Description

Condition

- excellent
- good
- fair
- deteriorated
- ruins
- unexposed

Check one

- unaltered
- altered

Check one

- original site
- moved date \_\_\_\_\_

Describe the present and original (if known) physical appearance

- summary paragraph
- completeness
- clarity
- alterations/integrity
- dates
- boundary selection

---

**8. Significance**

Period \_\_\_\_\_ Areas of Significance—Check and justify below

Specific dates \_\_\_\_\_ Builder/Architect \_\_\_\_\_

Statement of Significance *(in one paragraph)*

- summary paragraph
- compliances *2001 25 VOM*
- clarity
- applicable criteria
- justification of areas checked
- relating significance to the resource
- context
- relationship of integrity to significance
- justification of exception
- other

---

**9. Major Bibliographical References**

---

**10. Geographical Data**

Acreage of nominated property \_\_\_\_\_

Quadrangle name \_\_\_\_\_

UTM References \_\_\_\_\_

---

Verbal boundary description and justification

---

**11. Form Prepared By**

---

**12. State Historic Preservation Officer Certification**

The evaluated significance of this property within the state is:

\_\_\_\_ national    \_\_\_\_ state    \_\_\_\_ local

State Historic Preservation Officer signature

title \_\_\_\_\_ date \_\_\_\_\_

---

**13. Other**

- Maps
- Photographs
- Other

Questions concerning this nomination may be directed to \_\_\_\_\_

Signed \_\_\_\_\_ Date \_\_\_\_\_ Phone: \_\_\_\_\_



Rockland Res. His. Dis.  
Rockland, KNox Co., Me  
Hospital, Nurses Home and  
Episcopal church.  
9/86, R.Reed, MHPC

NOV 25 1986



Rockland Res. His. Dis.  
Rockland, Knox Co., Me  
96 Limerock St.  
9/86, R.Reed, MHPC

NOV 25 1986



Rockland Res. His. Dis.  
Rockland, Knox Co., Me.  
31 Masonic St.  
9/86, R.Reed, MHPC

NOV 25 1986



Rockland Res. His. Dis.

Rockland, Knox Co., Me.

55, 59 Masonic St.

9/86, R.Reed, MHPC

NOV 25 1986



Rockland Res. His. Dis.  
Rockland, Knox Co., Me  
96, 100 Limerock St.  
3/86, R.Reed, MHPC

NOV 25 1986



Rockland Res. His. Dis.  
Rockland, Knox Co., Me.  
107 Limerock St.  
9/86, R.Reed, MHPC

NOV 25 1986



Rockland Res. His. Dis.  
Rockland, Knox Co., Me  
Courthouse and Jail, Limerock St  
9/86, R.Reed, MHPC

NOV 25 1986



Rockland Res. His. Dis.  
Rockland, Knox Co., Me.  
129 Limerock St.  
9/86, R.Reed, MHPC

NOV 25 1986



Rockland Res. His. Dis.  
Rockland, Knox Co., mMe  
5 Beech St.  
9/86, R. Reed, MHPC

NOV 25 1986



Rockland Res. His. Dis.  
Rockland, Knox Co., Me.  
55, 63 Summer St.  
9/86, R. Reed, MHPC

NOV 25 1986



Rockland Res. His. Dis.  
Rockland, Knox Co., Me.  
McLain School, Lincoln St.  
9/86, R.Reed, MHPC

NOV 25 1986



Rockland Res. His. Dis.

Rockland, Knox Co., Me.

19-21, 25 Grove St.

9/86, R.Reed, MHPC

NOV 25 1986



Rockland Res. His. Dis.  
Rockland, Knox Co., Me  
81 Talbot Ave.  
9/86, R.Reed, MHPC

NOV 25 1986



Rockland Res. His. Dis.  
Rockland, Knox Co., Me.  
89 Talbot Ave.  
9/86, R.Reed, MHPC

NOV 25 1986



Rockland Res. His. Dis.  
Rockland, Knox Co., Me.  
73, 67 Talbot Ave.  
9/86, R.Reed, MHPC

NOV 25 1986



Rockland Res. His. Dis.  
Rockland, Knox Co., Me.  
23-25 Maple St.  
9/86, R.Reed, MHPC

NOV 25 1986



Rockland Res. His. Dis.  
Rockland, Knox Co., Me.  
UTM References:  
A. 19/490680 4883130  
B. 19/491050 4883130  
C. 19/490980 4883650  
D. 19/490640 4883730  
E. 19/490560 4883350  
F. 19/490701 4883301

NOV 25 1936

Maped by U. S. Coast and Geodetic Survey  
Edited and published by the Geological Survey  
Control by USCGS (C), USCE (E), and Maine Geodetic Survey (S)  
Culture and drainage in part compiled from aerial photographs  
taken 1952 and 1953. Topography from aerial photographs by  
photogrammetric methods and by planetable surveys 1953.  
Field check 1955  
Hydrography compiled from surveys dated 1950 and 1955 and  
supplementary information  
Polyconic projection. 1927 North American datum  
10,000-foot grid based on Maine coordinate system, east zone  
1000-meter Universal Transverse Mercator grid ticks,  
zone 19, shown in blue  
Red tint indicates area in which only  
landmark buildings are shown  
Unchecked elevations are shown in brown

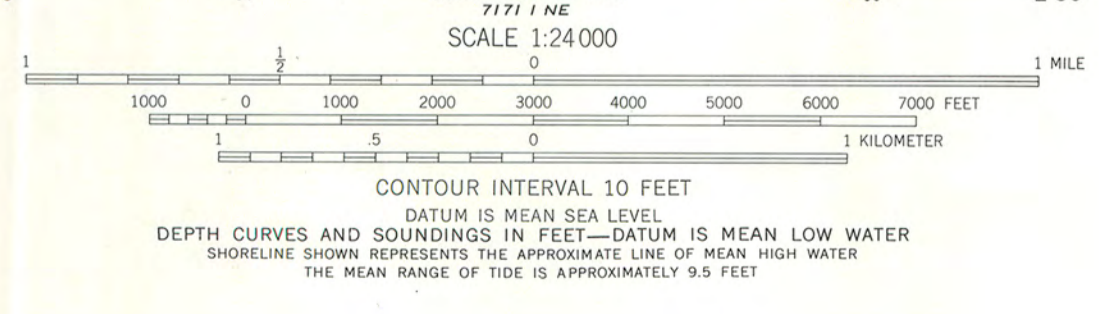
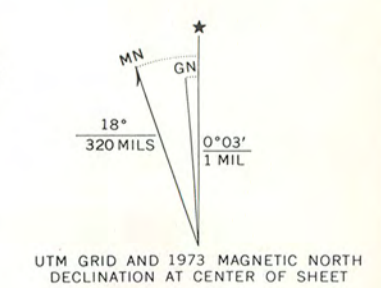

ROAD CLASSIFICATION

Heavy-duty ——— Light-duty ———  
Medium-duty ——— Unimproved dirt ———  
U. S. Route (circle with U.S.) State Route (circle with S)



ROCKLAND, MAINE

N4400—W6900/7.5  
PHOTOINSPECTED 1979  
1955  
PHOTOREVISED 1973  
AMS 7172 II SE—SERIES V811

THIS MAP COMPLIES WITH NATIONAL MAP ACCURACY STANDARDS  
FOR SALE BY U. S. GEOLOGICAL SURVEY, RESTON, VIRGINIA 22092  
A FOLDER DESCRIBING TOPOGRAPHIC MAPS AND SYMBOLS IS AVAILABLE ON REQUEST

Revisions shown in purple compiled by Geological Survey from  
aerial photographs taken 1973. This information not field checked

Map photoinspected 1979  
No major culture or drainage changes observed

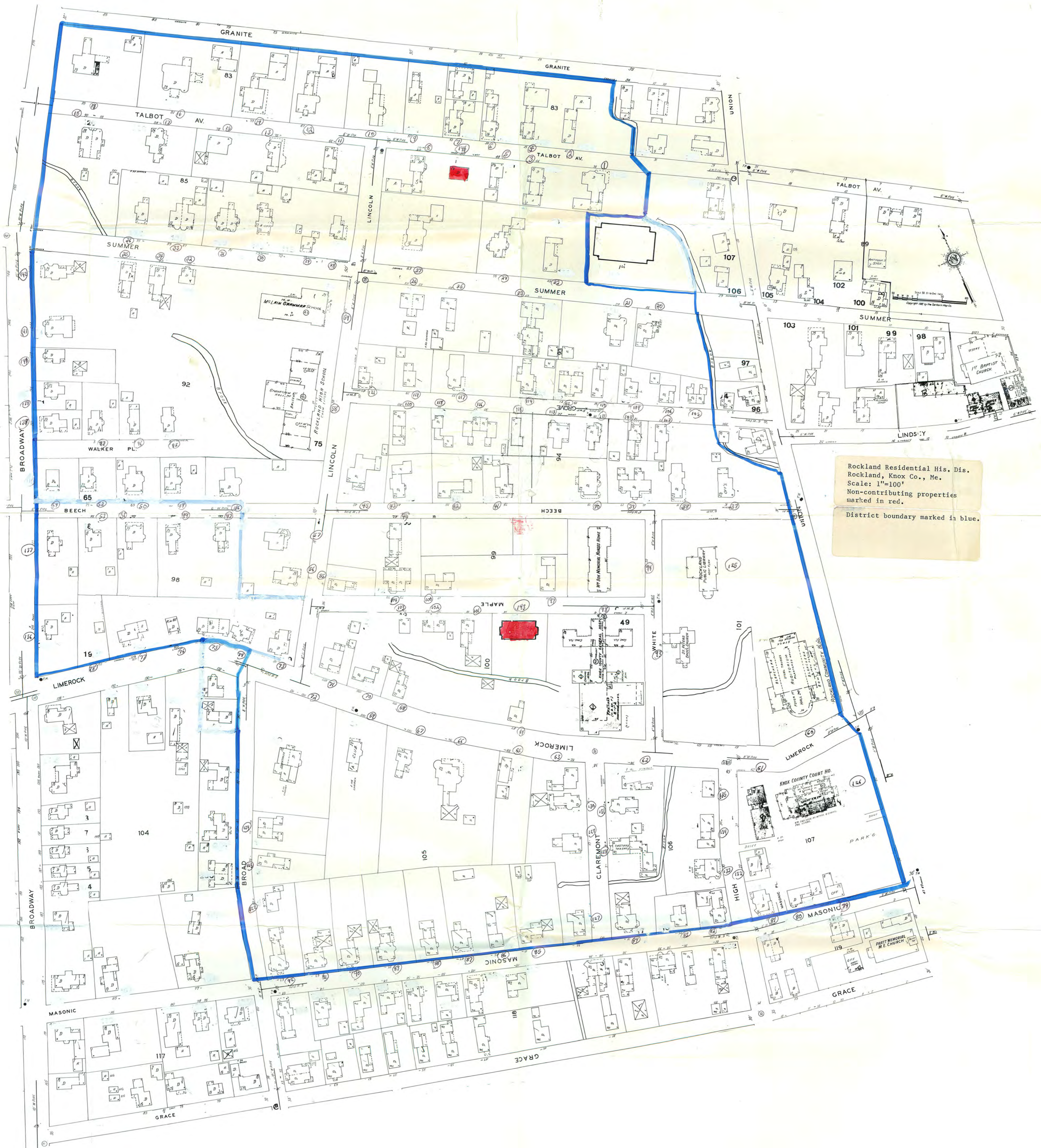

Rockland Residential His. Dis.  
Rockland, Knox Co., Me.  
Scale: 1"=100'  
Non-contributing properties  
marked in red.  
District boundary marked in blue.





MAINE HISTORIC PRESERVATION COMMISSION

55 Capitol Street  
State House Station 65  
Augusta, Maine 04333

Earle G. Shettleworth, Jr.  
*Director*

*Telephone:*  
207-289-2133

February 27, 1987

Beth Savage  
Architectural Historian  
National Park Service  
United States Department of the Interior  
1100 L. Street, N.W.  
Washington, D.C. 20240

Dear Beth:

Enclosed please find the corrected nominations for the Nathaniel Dyer House and the Stephen Coffin House/Skidompha Library. I have also revised the Rockland Residential Historic District by expanding the period of significance to include the many contributing buildings which lie on either side of the years 1880-1920.

You will also find a revised and expanded nomination for Laudholm Farm (NR 10/20/1983). The nominated area has been greatly enlarged, the property better described and the statement of significance thoroughly revised.

Sincerely,

*Kirk F. Mohney*  
Kirk F. Mohney  
Architectural Historian

Enc.

MAR 5 1987