

PH0682128

UNITED STATES DEPARTMENT OF THE INTERIOR
NATIONAL PARK SERVICE

FOR NPS USE ONLY	
RECEIVED	AUG 14 1978
DATE ENTERED	DEC 20 1978

NATIONAL REGISTER OF HISTORIC PLACES INVENTORY -- NOMINATION FORM

SEE INSTRUCTIONS IN *HOW TO COMPLETE NATIONAL REGISTER FORMS*
TYPE ALL ENTRIES -- COMPLETE APPLICABLE SECTIONS

1 NAME

HISTORIC

Calais Historic District

AND/OR COMMON

2 LOCATION

STREET & NUMBER Church, Main and North Streets

CITY, TOWN

Calais

VICINITY OF

NOT FOR PUBLICATION

CONGRESSIONAL DISTRICT
2nd

STATE

Maine

CODE

23

COUNTY

Washington

CODE

029

3 CLASSIFICATION

CATEGORY	OWNERSHIP	STATUS	PRESENT USE
<input checked="" type="checkbox"/> DISTRICT	<input checked="" type="checkbox"/> PUBLIC	<input checked="" type="checkbox"/> OCCUPIED	<input type="checkbox"/> AGRICULTURE <input type="checkbox"/> MUSEUM
<input type="checkbox"/> BUILDING(S)	<input checked="" type="checkbox"/> PRIVATE	<input type="checkbox"/> UNOCCUPIED	<input checked="" type="checkbox"/> COMMERCIAL <input type="checkbox"/> PARK
<input type="checkbox"/> STRUCTURE	<input type="checkbox"/> BOTH	<input type="checkbox"/> WORK IN PROGRESS	<input type="checkbox"/> EDUCATIONAL <input type="checkbox"/> PRIVATE RESIDENCE
<input type="checkbox"/> SITE	PUBLIC ACQUISITION	ACCESSIBLE	<input type="checkbox"/> ENTERTAINMENT <input type="checkbox"/> RELIGIOUS
<input type="checkbox"/> OBJECT	<input type="checkbox"/> IN PROCESS	<input type="checkbox"/> YES: RESTRICTED	<input checked="" type="checkbox"/> GOVERNMENT <input type="checkbox"/> SCIENTIFIC
	<input type="checkbox"/> BEING CONSIDERED	<input checked="" type="checkbox"/> YES: UNRESTRICTED	<input type="checkbox"/> INDUSTRIAL <input type="checkbox"/> TRANSPORTATION
		<input type="checkbox"/> NO	<input type="checkbox"/> MILITARY <input type="checkbox"/> OTHER:

4 OWNER OF PROPERTY

NAME

Multiple Ownership

STREET & NUMBER

CITY, TOWN

VICINITY OF

STATE

5 LOCATION OF LEGAL DESCRIPTION

COURTHOUSE,
REGISTRY OF DEEDS, ETC.

Washington County Registry of Deeds

STREET & NUMBER

CITY, TOWN

Machias

STATE

Maine

6 REPRESENTATION IN EXISTING SURVEYS

TITLE

DATE

FEDERAL STATE COUNTY LOCAL

DEPOSITORY FOR
SURVEY RECORDS

CITY, TOWN

STATE

7 DESCRIPTION

CONDITION		CHECK ONE	CHECK ONE
<input checked="" type="checkbox"/> EXCELLENT	<input type="checkbox"/> DETERIORATED	<input type="checkbox"/> UNALTERED	<input checked="" type="checkbox"/> ORIGINAL SITE
<input checked="" type="checkbox"/> GOOD	<input type="checkbox"/> RUINS	<input checked="" type="checkbox"/> ALTERED	<input type="checkbox"/> MOVED DATE _____
<input type="checkbox"/> FAIR	<input type="checkbox"/> UNEXPOSED		

DESCRIBE THE PRESENT AND ORIGINAL (IF KNOWN) PHYSICAL APPEARANCE

The Main Street Historic District in Calais is comprised of two blocks on the south side of Main Street facing the St. Croix River, and several buildings extending up Church Street, Sawyer Avenue and North Street. The majority of the buildings were constructed after the 1870 fire of Calais, though a few date back to the mid nineteenth century. None of the buildings have had major alterations.

Map #	Street #	
		<u>Church Street</u>
1	15	City Building, Romanesque Revival, 1901 Architect: H.A. Crosby Builder: Robert Walker Brick with granite trim, three stories
2	13	Old Fire House, Italianate, 1874 Two stories with tower, brick construction with granite trim Hose tower and bell added 1895-6
		<u>Main Street</u>
3	189	J. Perkins Store, Italianate, 1871 Brick with granite trim, three stories Decorative trim removed
4	185	J.G. Beckett Building, Italianate, 1870 Three stories with gable roof, brick with granite trim
5	183	W. & F. Todd Building, Italianate, 1870 Three stories, brick with granite trim
6	181	Blake and Taylor Building, Italianate, 1870 Three stories, brick with granite trim.
7	175	T. Horton Building, Italianate, 1871 Three stories, brick with granite trim
8	169-173	J. Murray Hill Building, Italianate, 1871 Three stories, brick with granite trim
9	167	F. Ross Building, Italianate, c. 1890 Two stories, brick construction with granite trim
10	165	J.G. Hamilton & J. Pickari Building, Italianate, 1878, Two stories, brick construction, wood trim Height and trim on store front remodeled to match 163 Main Street c. 1886

UNITED STATES DEPARTMENT OF THE INTERIOR
NATIONAL PARK SERVICE

**NATIONAL REGISTER OF HISTORIC PLACES
INVENTORY -- NOMINATION FORM**

FOR NPS USE ONLY	
RECEIVED	AUG 14 1978
DATE ENTERED	DEC 20 1978

CONTINUATION SHEET

ITEM NUMBER 7 PAGE 2

Map #	Street #	<u>Main Street</u>
11	163	M. Silverstone Building, Italianate , 1878 Two stories, brick construction with granite trim
12	159-161	A. Spence Building, Italianate, 1886 Two stories, brick with granite trim
13	157	E.H. & I. Macalester Building, Italianate, 1886 Originally two stories, added third and fourth stories in 1886 or shortly thereafter, Brick construction with granite trim
14	155	C.P. Robbins Building, Italianate, 1886 Two stories, brick with granite trim
15	153	Hill Building, Greek Revival, 1847 Three and one-half stories, gambrel roof Brick with granite trim
		<u>North Street</u>
16	22	J.W. Todd Building, Greek Revival, 1846 Two stories, brick with granite trim
17	28	M. Vickery Building, Greek Revival, 1852-1856 Three and one-half stories, frame with clapboarded exterior

UNITED STATES DEPARTMENT OF THE INTERIOR
NATIONAL PARK SERVICE

**NATIONAL REGISTER OF HISTORIC PLACES
INVENTORY -- NOMINATION FORM**

FOR NPS USE ONLY	
RECEIVED	DEC 15 1978
DATE ENTERED	DEC 20 1978

CONTINUATION SHEET

ITEM NUMBER 7 PAGE 3

The delineation of the Calais Historic District was arrived at after careful on site inspection by the State Historic Preservation Officer, a member of the Historic Preservation Commission staff and a representative of the Community Planning Center.

The area of the district was chosen excluding neighboring buildings for the following reasons:

1. Those structures on the west side of North Street are of much more recent construction than those within the district and thus not chronologically homogeneous.
2. The commercial buildings on the north side of Main Street include a number of recent commercial intrusions and those of the period which remain have been severely altered.
3. The area east of Church Street contains a mixture of residential and commercial properties not suitable for a commercial district.
4. The area south of the district is largely residential.

8 SIGNIFICANCE

PERIOD	AREAS OF SIGNIFICANCE -- CHECK AND JUSTIFY BELOW				
<input type="checkbox"/> PREHISTORIC	<input type="checkbox"/> ARCHEOLOGY-PREHISTORIC	<input type="checkbox"/> COMMUNITY PLANNING	<input type="checkbox"/> LANDSCAPE ARCHITECTURE	<input type="checkbox"/> RELIGION	
<input type="checkbox"/> 1400-1499	<input type="checkbox"/> ARCHEOLOGY-HISTORIC	<input type="checkbox"/> CONSERVATION	<input type="checkbox"/> LAW	<input type="checkbox"/> SCIENCE	
<input type="checkbox"/> 1500-1599	<input type="checkbox"/> AGRICULTURE	<input type="checkbox"/> ECONOMICS	<input type="checkbox"/> LITERATURE	<input type="checkbox"/> SCULPTURE	
<input type="checkbox"/> 1600-1699	<input checked="" type="checkbox"/> ARCHITECTURE	<input type="checkbox"/> EDUCATION	<input type="checkbox"/> MILITARY	<input type="checkbox"/> SOCIAL/HUMANITARIAN	
<input type="checkbox"/> 1700-1799	<input type="checkbox"/> ART	<input type="checkbox"/> ENGINEERING	<input type="checkbox"/> MUSIC	<input type="checkbox"/> THEATER	
<input checked="" type="checkbox"/> 1800-1899	<input checked="" type="checkbox"/> COMMERCE	<input type="checkbox"/> EXPLORATION/SETTLEMENT	<input type="checkbox"/> PHILOSOPHY	<input type="checkbox"/> TRANSPORTATION	
<input type="checkbox"/> 1900-	<input type="checkbox"/> COMMUNICATIONS	<input type="checkbox"/> INDUSTRY	<input checked="" type="checkbox"/> POLITICS/GOVERNMENT	<input type="checkbox"/> OTHER (SPECIFY)	
		<input type="checkbox"/> INVENTION			

SPECIFIC DATES

BUILDER/ARCHITECT

STATEMENT OF SIGNIFICANCE

The Historic District in Calais exhibits commercial ^{and} governmental, residential architecture of the mid to late nineteenth century. The cohesive block has not undergone any major exterior changes nor been encroached upon by modern intrusions. The buildings in the district were constructed at a time when Calais was a thriving shipbuilding and lumber port, and are an excellent tribute to that era.

Calais was incorporated as a city in 1850, with a population of 4,749. The city is situated at the head of tide water on the St. Croix River twelve miles from the Passamaquoddy Bay, and was an excellent port for ship building and the lumber industry as well as an ideal site for water powered mills. The excavation of granite was another source of income which drew settlers to the area. These industries were at their peak at the end of the nineteenth century, and the border city had continual traffic up and down its' wharves.

In August of 1870 a major fire destroyed much of the downtown area. It began to the east of the Main Street Historic District block behind the Old Post Office. The fire spread down Main Street and consumed the wooden frame buildings up to the location of the present Ross' Store. Construction was resumed immediately following the fire, and all new building was done in brick. The Beckett, Todd and Blake and Taylor buildings were erected in the Fall of 1870. The remaining buildings in the block were completed by 1886 and are all constructed in the Italianate style of architecture. The Hill and J. Todd stores are the only brick buildings in the district which pre-date the fire. The Greek Revival wood residences also survived the fire.

After this disaster the Fire Department's equipment supply grew substantially to demand a new Engine House, which was constructed in 1874. The fire department moved out in 1970, but the buildings is currently used as a Senior Citizen's Center and Community Planning Center.

The City Building, constructed in 1901, was the last addition to the Historic District. It is still the central location for all town offices.

Calais was able to rebuild much of its downtown area within one year of a major fire in 1870, due to the ample supply of carpenters and builders from its shipbuilding industry. The Main Street Historic District is comprised of buildings both architecturally and historically significant to this period when Calais was a leading salt water port.

9 MAJOR BIBLIOGRAPHICAL REFERENCES

- ¹Bacon, George, Calais, Its Representative Business Men and its Points of Interest, Glenwood Publishing Co., Newark, 1892.
- ²Davis, Harold, An International Community on the St. Croix, University Press, Orono, 1950.
- ³The Way We Were, Print'N Press Ltd., St. Stephen, 1908.

10 GEOGRAPHICAL DATA

ACREAGE OF NOMINATED PROPERTY 2

UTM REFERENCES

A. 45° 11' 20"N 67° 16' 36"W
 B. 45° 11' 17"N 67° 16' 38"W
 C. 45° 11' 18"N 67° 18' 45"W
 D. 45° 11' 20"N 67° 16' 43"W

OK-

A
 ZONE EASTING NORTHING
 C

B
 ZONE EASTING NORTHING
 D

VERBAL BOUNDARY DESCRIPTION Beginning at the southern corner of the City Hall property

on the northwest side of Church Street, the district boundary line follows this side of Church Street northeasterly to Main Street, thence westerly on the south side of Main Street to North Street and from there southwesterly along the southeast side of North Street to the westerly corner of the M. Vickery Building property. From this point the line runs southeasterly along the southwest property line of the M. Vickery building to the southern corner, thence northeasterly, easterly and southwesterly along the rear property lines on ~~North Main and Church Streets~~ to the west corner of the City Hall property where it turns south-

LIST ALL STATES AND COUNTIES FOR PROPERTIES OVERLAPPING STATE OR COUNTY BOUNDARIES

STATE	CODE	COUNTY	CODE
STATE	CODE	COUNTY	CODE

11 FORM PREPARED BY

NAME / TITLE Ann Fernald, Architectural Surveyor
Frank A. Beard, Historian

ORGANIZATION Maine Historic Preservation Commission

DATE July, 1978

STREET & NUMBER 242 State Street

TELEPHONE (207)-289-2133

CITY OR TOWN Augusta,

STATE Maine 04333

12 STATE HISTORIC PRESERVATION OFFICER CERTIFICATION

THE EVALUATED SIGNIFICANCE OF THIS PROPERTY WITHIN THE STATE IS:

NATIONAL STATE LOCAL

As the designated State Historic Preservation Officer for the National Historic Preservation Act of 1966 (Public Law 89-665), I hereby nominate this property for inclusion in the National Register and certify that it has been evaluated according to the criteria and procedures set forth by the National Park Service.

STATE HISTORIC PRESERVATION OFFICER SIGNATURE Carol S. Feltzworth

TITLE SHPO

DATE 7/31/78

FOR NPS USE ONLY

I HEREBY CERTIFY THAT THIS PROPERTY IS INCLUDED IN THE NATIONAL REGISTER

DIRECTOR, OFFICE OF ARCHAEOLOGY AND HISTORIC PRESERVATION
 ATTEST: William Telouch

DATE 12/20/78
 KEEPER OF THE NATIONAL REGISTER

KEEPER OF THE NATIONAL REGISTER

UNITED STATES DEPARTMENT OF THE INTERIOR
NATIONAL PARK SERVICE

**NATIONAL REGISTER OF HISTORIC PLACES
INVENTORY -- NOMINATION FORM**

FOR NPS USE ONLY	
RECEIVED	AUG 14 1978
DATE ENTERED	DEC 20 1978

CONTINUATION SHEET

ITEM NUMBER 10 PAGE 2

easterly and returns to the point of beginning.

CALAIS HISTORIC DISTRICT



<u>Building</u>	<u>Owner</u>
1. City Building	- City of Calais
2. Old Fire House	- City of Calais
3. J. Perkins Building	Taylor Furniture Inc. ✓ River Rd. Calais, ME. 04619
4. J.G. Beckett Building	Eastern Maine Appliances, Inc. ✓ 177 Main St. Calais, ME. 04619
5.+6. Wm. Todd Building Blake and Taylor Building	Jean G. Eaton ✓ 329 Main St. Calais, ME. 04619
7. T. Horton Building	Border Investment Co. ✓ Main St. Calais, ME. 04619
8. J. Murray Hill Building	Elizabeth Tingley ✓ Swan St. Calais, ME. 04619
9. F.T. Ross Building	Nellie T. Ross ✓ 167 Main St. Calais, ME. 04619
10. J.G. Hamilton Building	Bror Olsson - 282 Main St. Calais, ME. 04619
11. M. Silverstone Building	✓ E. Leonard and Nancy T. Scott 159 Main St. Calais, ME. 04619
12. Spence Building	✓ Sunrise Realty Corp. Main St. Calais, ME 04619
13. Macalester Building	- Bruce and Shirley J. Ashmore 157 Main St. Calais, ME. 04619
14. C.R. Robbins Building	✓ Mainline Graphics Main St. Calais, ME. 04619



15. H. Hill Building

Gary L. Diffin
153 Main St.
Calais, ME. 04619

16. J.W. Todd Building

Lloyd Wells
Crawford P.O.
Crawford ME. 04610

17. M. Vickery Building

Robert Olsson
Route 1
Baring ME. 04610

~~Sawyer House~~

~~Robert Olsson
Route 1
Baring, ME. 04610~~

~~W.H. Young House~~

~~Gail Waycott
6 Sawyer Avenue
Calais, ME. 04619~~

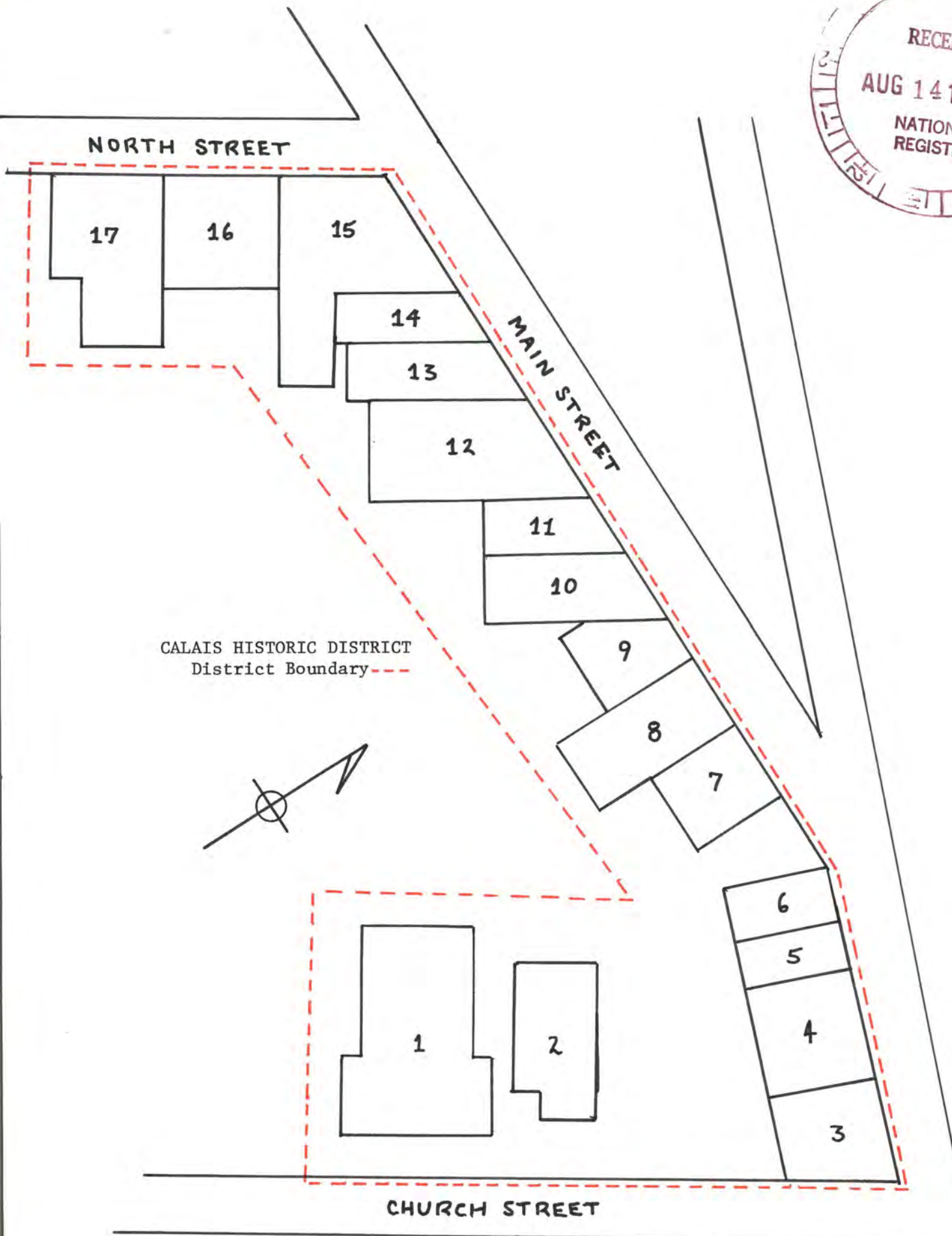

NORTH STREET

MAIN STREET

CHURCH STREET

CALAIS HISTORIC DISTRICT
District Boundary ---

17

16

15

14

13

12

11

10

9

8

7

6

5

4

3

1

2

DEC 20 1978

Property

Calais Historic District

State

Me.

Working Number

8.14.78.3860

TECHNICAL

Photos

Maps

6

1

Under review for photo

CONTROL

pl

8.16.78

OK

HISTORIAN

Accept

Lightman

12-15-78

significant as a relatively unaltered example of a late 19th century commercial & gov't district. Buildings associated with the period when Calais was a leading port, & reflect the ability of the town to quickly recover & rebuild after a major fire.

ARCHITECTURAL HISTORIAN

ARCHEOLOGIST

OTHER

HAER

Inventory _____

Review _____

ARCHITECTURAL SIGNIFICANCE IS NOT JUSTIFIED BUT WILL ACCEPT BECAUSE PRIMARY SIGNIFICANCE IS THAT IT IS AN INTACT COMMERCIAL AND GOV'T DISTRICT.

REVIEW UNIT CHIEF

*Accept
M. K. D. [unclear]
12/15/78*

BRANCH CHIEF

KEEPER

National Register Write-up _____

Send-back _____

Entered **DEC 20 1978**

Federal Register Entry

2.6.79

Re-submit _____

INT:2106-74



Historic District

Calais Historic District
Calais, Maine

1 Ann Fernald 5/78

Me. Historic Preservation Comm.

Aerial view of district (1)

St.

DEC 20 1978

AUG 14 1978

Carroll



City Building, no. 1
Calais Historic District
Calais, Maine
Ann Fernald 5/78
Me. Historic Preservation Comm.
View from the south (2)

AUG 14 1978

DEC 20 1978



Calais Historic District

13 Church St.

Old Fire House

DEC 20 1978
Old Fire House, no. 2
Calais Historic District
Calais, Maine
Ann Fernald 5/78
Me. Historic Preservation Comm.
View from the southeast (3)

AUG 14 1978



181-189 main st.

DEC 20 1978

AUG 14 1978

Buildings no. 3,4,5,6
Calais Historic District
Calais, Maine
Ann Fernald 5/78
Me. Historic Preservation Comm.
View from the east (4)



Calais Historic District

163-175 Main St.

Buildings no. 7,8,9,10
Calais Historic District
Calais, Maine
Ann Fernald 5/78 DEC 20 1978
Me. Historic Preservation Comm.
View from the northwest (5)

AUG 14 1978



Calais Historic District

153-163 Main St.

Buildings no. 12, 13, 14, 15
Calais Historic District
Calais, Maine
Ann Fernald 5/78
Me. Historic Preservation Comm.
View from the northwest (6)
AUG 14 1978

DEC 20 1978

(KELLYLAND 1:62,500)

(KELLYLAND 1:62,500)

800 000 FEET



Calais Historic District
A. 45°11'20"N 67°16'36"W
B. 45°11'17"N 67°16'38"W
C. 45°11'18"N 67°16'45"W
D. 45°11'20"N 67°16'43"W

Maped by the U. S. Coast & Geodetic Survey
Edited and published by the Geological Survey
Control by USC&GS (C) and International Boundary Commission (I)
U. S. topography from aerial photographs by multiplex methods
Aerial photographs taken 1946. Field check 1949
Hydrography from surveys dated 1949
Canadian topography from International Boundary Commission and
Canadian Department of Mines and Resources surveys dated 1938 to 1950
Polyconic projection. 1927 North American datum
10,000-foot grid based on Maine coordinate system,
east zone
Red tint indicates areas in which only
landmark buildings are shown

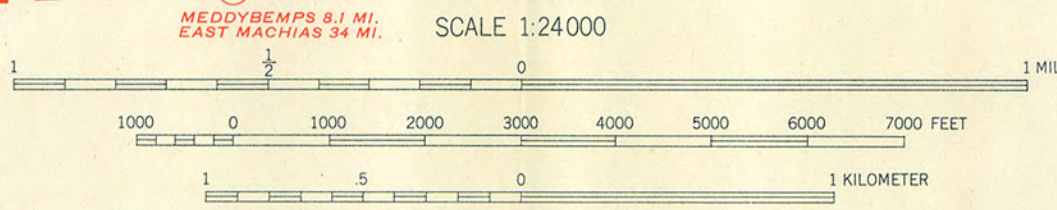

CONTOUR INTERVAL 20 FEET IN THE UNITED STATES AND 50 FEET IN CANADA
DATUM IS MEAN SEA LEVEL
DEPTH CURVES AND SOUNDINGS IN FEET—DATUM IS MEAN LOW WATER
SHORELINE SHOWN REPRESENTS THE APPROXIMATE LINE OF MEAN HIGH WATER
THE AVERAGE RANGE OF TIDE IS APPROXIMATELY 20 FEET
THE U. S. PORTION OF THIS MAP COMPLIES WITH NATIONAL MAP ACCURACY STANDARDS
FOR SALE BY U. S. GEOLOGICAL SURVEY, WASHINGTON 25, D. C.
A FOLDER DESCRIBING TOPOGRAPHIC MAPS AND SYMBOLS IS AVAILABLE ON REQUEST

ROAD CLASSIFICATION
Heavy-duty 4 LANE, 16 LANE Light-duty
Medium-duty 4 LANE, 16 LANE Unimproved dirt
U. S. Route State Route

CALAIS, ME.
NE/4 CALAIS 15' QUADRANGLE
N4507.5-W6715/7.5

1949



DEC 20 1978

TELEPHONE REPORT

OFFICE OF ARCHEOLOGY AND HISTORIC PRESERVATION

PROJECT: *Calais Historic District*

To/~~FROM~~: *Frank Beard*

DATE: *12-4-78*

ADDRESS:

PHONE:

STAFF MEMBER: *Lightner*

DIVISION: *NR*

REPORT:

I told him sense of district does not seem to be strong. Questioned why buildings on other side of Main Street were not included. Asked for boundary justification. He said he would get it this week.

*justification
received 12-15-78
PDL*

ENTRIES IN THE NATIONAL REGISTER

STATE MAINE

Date Entered DEC 20 1978

Name

Location

Calais Historic District

Calais
Washington County

Also Notified

Honorable William S. Cohen
Honorable Edmmd S. Muskie
Honorable Olympia J. Snowe

State Historic Preservation Officer
Mr. Earle G. Shettleworth, Jr.
Director
Maine Historic Preservation Commission
242 State St.
Augusta, Maine 04330

NR

Byers/bjr 1/15/79

For further information, please call the National Register at (202)343-6401.

VP

*Listed
Dec 20, 1978*

BORDER INVESTMENT COMPANY
REAL ESTATE AND INVESTMENTS
94-96 Main Street
Johnson Block
CALAIS, MAINE

January 2, 1979

U. S. Department of the Interior
Heritage Conservation and Recreation Service
Washington, D. C. 20240

Gentlemen:

This letter may be considered as an application for placing on the historical building list of the Calais Historical District, the T. Horton Building situated at 173-177 Main Street, in Calais, Maine. *Washington Co.*

Yours sincerely,

BORDER INVESTMENT COMPANY

By *[Signature]*, *Vice Pres.*
Harold V. Jewett, Pres.

HVJ:LM

THE NATIONAL REGISTER OF HISTORIC PLACES

DATE REC'D **JAN 09 1979**

INDIVIDUAL RESPONSE (ATTACHED)

INFORMATIONAL MATERIAL SENT

TELEPHONE CALL (ATTACHED)

DATE ACTION TAKEN

INITIALS **R/S ALM**

NATIONAL REGISTER DATA SHEET

1 NAME as it appears on federal register: Calais Historic District		2 OTHER NAMES:		3 date of entry: DEC 20 1978	4 county code: 29	
5 LOCATION street & number Church, Main, and North Sts.		city / town Calais	vicinity of	state ME	county Washington	
7 OWNER <input type="checkbox"/> PRIVATE <input type="checkbox"/> STATE <input type="checkbox"/> MUNICIPAL <input type="checkbox"/> COUNTY <input type="checkbox"/> <input checked="" type="checkbox"/> MULTIPLE <input type="checkbox"/> FEDERAL (agency name)		8 ADMINISTRATOR:		6 NPS REGION: NA		
9 EXISTING SURVEYS <input type="checkbox"/> HABS <input type="checkbox"/> HAER <input type="checkbox"/> NHL <input type="checkbox"/> 10 FUNDED? <input type="checkbox"/> YES <input type="checkbox"/> NO		11 CONGRESS. DISTRICT 2nd	12 SOURCE OF NOMINATION <input checked="" type="checkbox"/> STATE <input type="checkbox"/> FEDERAL		13 WITHIN NATIONAL REGISTER HISTORIC DISTRICT? <input type="checkbox"/> YES, NAME <input type="checkbox"/> NO	
14 WITHIN NATIONAL HISTORIC LANDMARK? <input type="checkbox"/> YES, NAME <input type="checkbox"/> NO		15 ACREAGE		if state, who prepared form? ME Hist. Preser. Comm. <input type="checkbox"/> LOCAL <input type="checkbox"/> PRIVATE ORGANIZATION		
16 CONDITION <input type="checkbox"/> excellent <input type="checkbox"/> good <input type="checkbox"/> fair <input type="checkbox"/> deteriorated <input type="checkbox"/> ruins <input type="checkbox"/> unexposed <input type="checkbox"/> unexcavated <input type="checkbox"/> altered <input type="checkbox"/> unaltered <input type="checkbox"/> reconstructed <input type="checkbox"/> excavated <input type="checkbox"/> original site <input type="checkbox"/> moved <input type="checkbox"/> unknown		17 features: INTERIOR <input type="checkbox"/> SUBSTANTIALLY INTACT-1 <input type="checkbox"/> NOT INTACT-0 <input type="checkbox"/> UNKNOWN-4 <input type="checkbox"/> NOT APPLICABLE-7 EXTERIOR <input type="checkbox"/> SUBSTANTIALLY INTACT-2 <input type="checkbox"/> NOT INTACT-0 <input type="checkbox"/> UNKNOWN-5 <input type="checkbox"/> NOT APPLICABLE-8 ENVIRONS <input type="checkbox"/> SUBSTANTIALLY INTACT-3 <input type="checkbox"/> NOT INTACT-0 <input type="checkbox"/> UNKNOWN-6 <input type="checkbox"/> NOT APPLICABLE-9		18 ACCESS <input type="checkbox"/> YES-Restricted <input type="checkbox"/> YES-Unrestricted <input type="checkbox"/> No Access <input type="checkbox"/> Unknown		
19 ADAPTIVE USE <input type="checkbox"/> YES <input type="checkbox"/> NO		20 SAVED? <input type="checkbox"/> YES		21 IS PROPERTY A HISTORIC DISTRICT? <input type="checkbox"/> yes <input type="checkbox"/> no		
21 AREAS OF SIGNIFICANCE: <input type="checkbox"/> ARCHEOLOGY-prehistoric-2 <input type="checkbox"/> ARCHEOLOGY-historic-1 <input type="checkbox"/> AGRICULTURE-3 <input type="checkbox"/> ARCHITECTURE-4 <input type="checkbox"/> ART-5		<input type="checkbox"/> ENGINEERING-11 <input type="checkbox"/> ENTERTAINMENT-26 <input type="checkbox"/> EXPLORATION-12 <input type="checkbox"/> HEALTH-27 <input type="checkbox"/> INDUSTRY-13 <input type="checkbox"/> EDUCATION-10	<input type="checkbox"/> LANDSCAPE ARCH.-15 <input type="checkbox"/> LAW-16 <input type="checkbox"/> LITERATURE-17 <input type="checkbox"/> MILITARY-18 <input type="checkbox"/> MUSIC-19 <input type="checkbox"/> PHILOSOPHY-20	<input type="checkbox"/> POLITICS / GOVT.-21 <input type="checkbox"/> RELIGION-22 <input type="checkbox"/> SCIENCE-23 <input type="checkbox"/> SOCIAL / HUMANITARIAN-24 <input type="checkbox"/> SOCIAL / CULTURAL-30 <input type="checkbox"/> TRANSPORTATION-25	22 CLAIMS: explain 'first' <input type="checkbox"/> 'oldest' <input type="checkbox"/> 'only' <input type="checkbox"/>	
23 functions WHEN HISTORICALLY SIGNIFICANT: CURRENTLY:		24 dates of initial construction: major alterations: historic events:		25 ETHNIC GROUP ASSOCIATION		
26 architectural style(s):		27 architect:		28 master builder:		
29 landscape architect / garden designer:		30 interior decorator:		31 artist:		
32 artisan:		33 builder/contractor:				
34 NAMES give role & date PERSONAL: EVENTS: INSTITUTIONAL:						

35 NATIONAL REGISTER WRITE-UP