

Iowa Site Inventory

Office of Historic Preservation
Iowa State Historical Department
East 12th & Grand Avenue
Des Moines, Iowa 50319

Site Number 59

District Name _____

Map Reference # 59

Identification

1. Site Name Octagon Barn, Richland Twp., Guthrie County
2. Village/Town/City Jamaica vic. Township Richland County Guthrie
3. Street Address Off IA 141
4. Legal Location 81 N 30 W 15 NE 1/4 of SE 1/4
Urban: Rural: subdivision township block range parcel section subparcel 1/4 section of 1/4 section
5. UTM Location: zone 15 easting 389,030 northing 4,630,800; Acreage less than one acre
6. Owner(s) Name Elmer and Beulah Burk
7. Owner(s) Address _____
(Street address) (City) (State) (Zip)
8. Use: Present Gen'l purpose barn Original Gen'l purpose barn

Description

9. Date of Construction 1881 Architect/Builder _____
10. Building Type:
 single-family dwelling industrial other institutional religious
 multiple-family dwelling educational public agricultural
 commercial
11. Exterior Walls: clapboard stone brick board and batten shingles stucco
 other Horizontal sawed wood.
12. Structural System: wood frame with interlocking joints wood frame with light members (balloon frame)
 masonry load-bearing walls iron frame steel frame with curtain walls reinforced concrete
 other _____
13. Condition: excellent good fair deteriorated
14. Integrity: original site moved—if so, when? _____
 Notes on alterations, additions (with dates and architect, if known) and any other notable features of building and site:
See reverse side.
15. Related Outbuildings and Property: barn other farm structures carriage house garage privy
 other _____
16. Is the building endangered? no yes—if so, why? _____
17. Surroundings of the building: open land woodland scattered outbuildings densely built-up commercial
 industrial residential other _____

18. Map

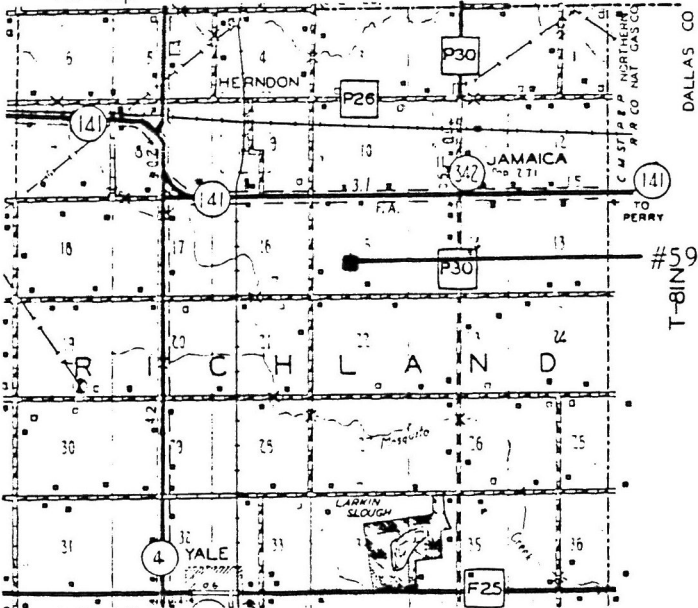

19. Photo Roll 641 Frame 23 View _____

VBD: A circle 90' in diameter, based on center point of barn, includes barn only.

MAY 27 1986

Significance

(Indicate sources of information for all statements)

20. Architectural significance

- a. Key structure/individually may qualify for the National Register
- b. Contributing structure
- c. Not eligible/intrusion

N/A

Continuation of 14. Integrity.

Approximately 70' diameter 28' on a side. Bank barn style with drive to loft floor. Cupola missing. Modified hip roof. Wood shingles. Stone foundation.

21. Historical Significance

Theme(s) Octagon; Coffin type.

- a. Key structure/individually may qualify for the National Register
- b. Contributing structure
- c. Not eligible/intrusion

Oldest known octagon barn still existing on an Iowa farm. The modified hip roof of this barn specifically characterizes it as a Coffin type, most likely influenced by the 1867 Webster County barn of Lorenzo S. Coffin. Other identifying characteristics include the heavy timber construction, rectangular plan, and general purpose use. Lorenzo S. Coffin, a stock breeder, and farm editor of the Fort Dodge Messenger, is credited with building the first round barn in Iowa.

22. Sources (for primary and secondary sources, give complete facts of publication: author, title, place of publication, date, etc.):

Elmer and Beulah Burk, Jamaica, IA 50128
Soike, Lowell J. Without Right Angles. Des Moines, Iowa: Iowa State Historical Department, Office of Historic Preservation, 1983.

Prepared by _____ Date _____
 Address _____ Telephone _____
 Organization _____

For Office of Historic Preservation Use Only

1. Office Information Sources on this Property

- County Resource File
- Windshield Survey
- National Register
- Grants-In-Aid: _____
- Determination of Eligibility

Review and Compliance Project:

- Other _____
- Other _____
- Other _____

2. Subject Traces

- a. _____
- b. _____
- c. _____
- d. _____
- e. _____

3. Photo Images

United States Department of the Interior
National Park Service

National Register of Historic Places
Inventory—Nomination Form

For NPS use only
received 5-27-86
date entered

Continuation sheet

Item number

Page 3-6

Multiple Resource Area
Thematic Group

Name Iowa Round Barns: The Sixty Year Experiment TR
State IOWA

Nomination/Type of Review

Date/Signature

- | | | | |
|--|-------------------------------------|------------|-----------------------------|
| 21. Miller Round Barn | Entered in the
National Register | for Keeper | <u>Alvora Byers</u> 6/30/86 |
| | | Attest | _____ |
| 22. Nebergall "Knoll Crest"
Round Barn | Entered in the
National Register | for Keeper | <u>Alvora Byers</u> 6/30/86 |
| | | Attest | _____ |
| 23. Nus, August, Polygonal
Barn | Entered in the
National Register | for Keeper | <u>Alvora Byers</u> 6/30/86 |
| | | Attest | _____ |
| 24. Oakland, William, Round
Barn | Entered in the
National Register | for Keeper | <u>Alvora Byers</u> 6/30/86 |
| | | Attest | _____ |
| 25. Octagon Barn, Indian
Creek Township | Entered in the
National Register | for Keeper | <u>Alvora Byers</u> 6/30/86 |
| | | Attest | _____ |
| 26. Octagon Barn, Otter Township | Entered in the
National Register | for Keeper | <u>Alvora Byers</u> 6/30/86 |
| | | Attest | _____ |
| 27. Octagon Barn, Polk Township | Entered in the
National Register | for Keeper | <u>Alvora Byers</u> 6/30/86 |
| | | Attest | _____ |
| 28. Octagon Barn, Richland
Township | Entered in the
National Register | for Keeper | <u>Alvora Byers</u> 6/30/86 |
| | | Attest | _____ |
| 29. Plagmann Round Barn | Entered in the
National Register | for Keeper | <u>Alvora Byers</u> 6/30/86 |
| | | Attest | _____ |
| 30. Polygonal Barn, Lincoln
Township | Entered in the
National Register | for Keeper | <u>Alvora Byers</u> 6/30/86 |
| | | Attest | _____ |

86001433

NATIONAL REGISTER OF HISTORIC PLACES
EVALUATION/RETURN SHEET

Octagon Barn, Richland Township (Iowa Round
Barns: The Sixty Year Experiment TR)
Guthrie County
IOWA

Working No. MAY 27 1986
Fed. Reg. Date: 2/3/87
Date Due: 6/26/86 - 7/11/86
Action: ACCEPT 6-30-86
 RETURN
 REJECT
Federal Agency: _____

Entered in the
National Register

- resubmission
- nomination by person or local government
- owner objection
- appeal

Substantive Review: sample request appeal NR decision

Reviewer's comments:

Recom./Criteria _____
Reviewer _____
Discipline _____
Date _____
_____ see continuation sheet

Nomination returned for: _____ technical corrections cited below
_____ substantive reasons discussed below

1. Name

2. Location

3. Classification

Category	Ownership Public Acquisition	Status Accessible	Present Use

4. Owner of Property

5. Location of Legal Description

6. Representation in Existing Surveys

Has this property been determined eligible? yes no

7. Description

Condition	Check one	Check one
<input type="checkbox"/> excellent	<input type="checkbox"/> deteriorated	<input type="checkbox"/> original site
<input type="checkbox"/> good	<input type="checkbox"/> ruins	<input type="checkbox"/> moved date _____
<input type="checkbox"/> fair	<input type="checkbox"/> unexposed	
	<input type="checkbox"/> unaltered	
	<input type="checkbox"/> altered	

Describe the present and original (if known) physical appearance

- summary paragraph
- completeness
- clarity
- alterations/integrity
- dates
- boundary selection

8. Significance

Period _____ Areas of Significance—Check and justify below

Specific dates _____ Builder/Architect _____

Statement of Significance (*in one paragraph*)

- summary paragraph
- completeness
- clarity
- applicable criteria
- justification of areas checked
- relating significance to the resource
- context
- relationship of integrity to significance
- justification of exception
- other

9. Major Bibliographical References

10. Geographical Data

Acreage of nominated property _____

Quadrangle name _____

UTM References _____

Verbal boundary description and justification

11. Form Prepared By

12. State Historic Preservation Officer Certification

The evaluated significance of this property within the state is:

____ national ____ state ____ local

State Historic Preservation Officer signature

title _____ date _____

13. Other

- Maps
- Photographs
- Other

Questions concerning this nomination may be directed to _____

Signed _____ Date _____ Phone: _____



59

641/23

Octagon Barn

**Iowa Round Barns: The Sixty Year
Experiment, Site #59**

Richland Township, Guthrie County

Photo No. 59

Date: July 1979

View: east

By: Frank Hunter

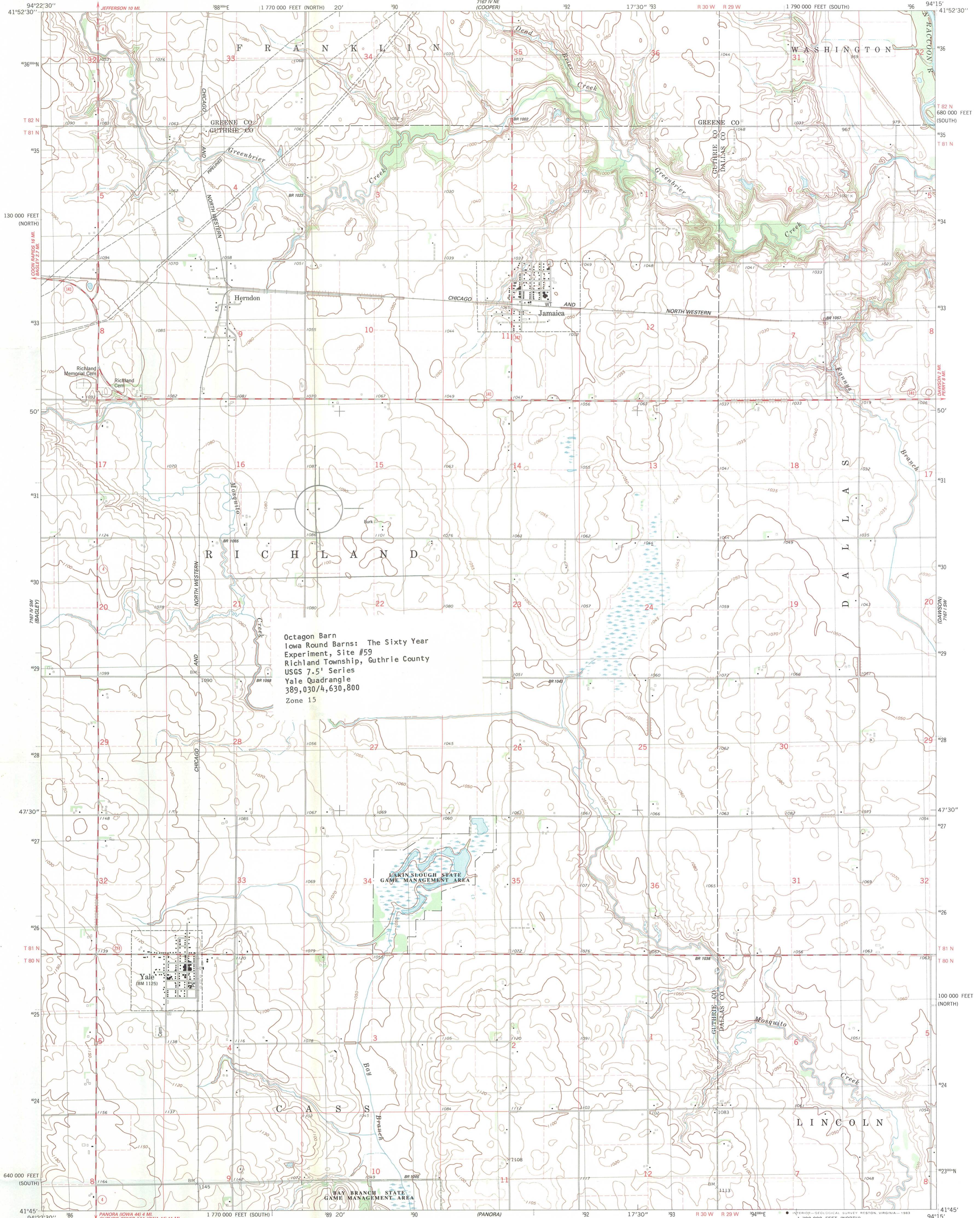

Octagon Barn
Iowa Round Barns: The Sixty Year
Experiment, Site #59
Richland Township, Guthrie County
USGS 7.5' Series
Yale Quadrangle
389,030/4,630,800
Zone 15

Mapped, edited, and published by the Geological Survey
in cooperation with the Iowa Geological Survey
Control by USGS and NOS/NOAA
Topography by photogrammetric methods from aerial photographs
taken 1979. Field checked 1980. Map edited 1982
Projection: Iowa coordinate system, south zone
(Lambert conformal conic)
10,000-foot grid ticks based on Iowa coordinate
system, south and north zones
1000-meter Universal Transverse Mercator grid, zone 15
1927 North American Datum
To place on the predicted North American Datum 1983
move the projection lines 4 meters north and
20 meters east as shown by dashed corner ticks
There may be private inholdings within the boundaries of
the National or State reservations shown on this map
Fine red dashed lines indicate selected fence and field lines where
generally visible on aerial photographs. This information is unchecked

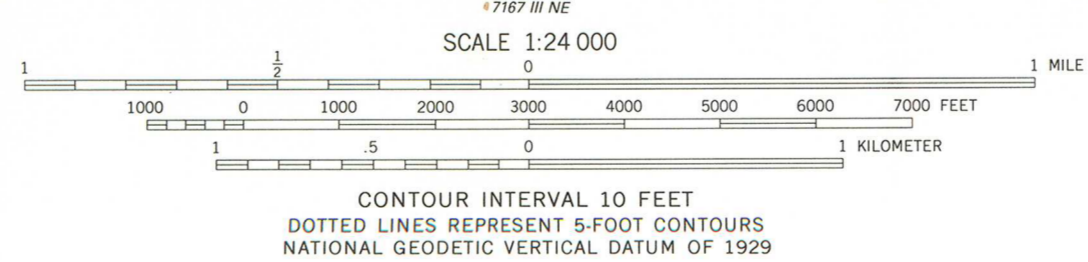
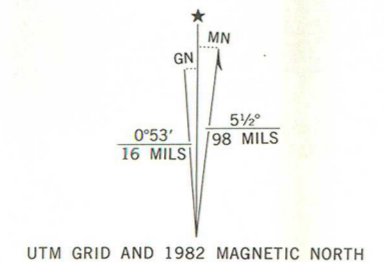

ROAD CLASSIFICATION

Primary highway, hard surface	Light-duty road, hard or improved surface
Secondary highway, hard surface	Unimproved road
Interstate Route	U. S. Route
	State Route

YALE, IOWA
8E4 BAGLEY 15' QUADRANGLE
N4145-W9415/7.5
1982
DMA 7167 IV SE-SERIES V876

THIS MAP COMPLIES WITH NATIONAL MAP ACCURACY STANDARDS
FOR SALE BY U. S. GEOLOGICAL SURVEY, DENVER, COLORADO 80225, OR RESTON, VIRGINIA 22092
AND BY THE IOWA GEOLOGICAL SURVEY, IOWA CITY, IOWA 52240
A FOLDER DESCRIBING TOPOGRAPHIC MAPS AND SYMBOLS IS AVAILABLE ON REQUEST