

**NATIONAL REGISTER OF HISTORIC PLACES  
INVENTORY -- NOMINATION FORM**

FOR HCRS USE ONLY

RECEIVED

DATE ENTERED

CONTINUATION SHEET

ITEM NUMBER 4 PAGE 1

1. Las Casitas Court  
656 No. Summit Ave.  
Anna A. Gabriel  
1085 N. Hill Ave.  
Pasadena, CA 91104
2. Colonial Court  
291 - 301 N. Garfield Ave.  
  
291 Robert D. Chambers  
236 N. 6th St.  
Burbank, CA 91501  
  
293 John Chilton  
2215 Ocean Ave., Unit 8  
Santa Monica, CA 90405  
  
295 John Chilton  
2215 Ocean Ave., Unit 8  
Santa Monica, CA 90405  
  
297 Richard D. Norris  
297 N. Garfield Ave.  
Pasadena, CA 91101  
  
299 Richard Deschwanden  
299 N. Garfield Ave.  
Pasadena, CA 91101  
  
301 Delores A. Walker  
301 N. Garfield Ave.  
Pasadena, CA 91101
3. Reinway Court  
380 East Parke Street  
Crosby A. Doe  
Dean Whitter Reynolds, Inc.  
800 Wilshire Boulevard  
Los Angeles, CA 90017
4. Mission Court  
567 N. Oakland Ave.  
John Sugar  
1204 Orange Grove Ave.  
S. Pasadena, CA 91030
5. Bowen Court  
539 East Villa Street  
Constantinos Fergadis  
3710 Stewart  
Los Angeles, CA 90066
6. Gartz Court  
270 N. Madison  
Montgomery Engineering Center  
555 East Walnut Street  
Pasadena, CA 91101
7. Court  
497 - 503-1/2 N. Madison Ave.  
Carl W. Cooper  
2485 Loma Vista St.  
Pasadena, CA 91104
8. Cypress Court  
623 - 641 N. Madison Ave.  
David G. & Virginia S.  
Stringer  
60 Hanapepe Place  
Honolulu, HI 96825
9. Orange Grove Court  
745 E. Orange Grove Ave.  
Margaret D. Curry  
745 E. Orange Grove Ave.  
Pasadena, CA 91104

FOR HCRS USE ONLY  
RECEIVED  
DATE ENTERED

**NATIONAL REGISTER OF HISTORIC PLACES  
INVENTORY -- NOMINATION FORM**

2

CONTINUATION SHEET

ITEM NUMBER 7 PAGE 2

proximity to central business district

proximity to other courts

association with architect or builder who had a substantial impact on Pasadena's architecture or design of bungalow courts

exemplification of an architectural trend or a particular aspect of the evolution of bungalow courts

association with historic personages

age of court

It should be noted, in passing, that although some of these courts are threatened by development pressures, all are fully inhabited and many have waiting lists of prospective tenants. Thus, the desirability of the courts and the value with which they are viewed by the community formed a context in which the selections were made.

CA ✓  
Los Angeles  
county ✓  
Pasadena

- 1. ✓ Las Casitas Court (Bungalow Courts of Pasadena TR)  
656 North Summit Ave.

Date: 1916

Acreage: 0.4

UTM: 11-394300-3779990

Verbal Description:  
book 5725/page 14/parcel 12

Twelve-unit Craftsman style court of two rows of five stuccoed one-story structures plus a two-story shingle-sided building across the rear. First four buildings on each side contain front-facing gables, broad eaves, exposed rafters, gable vents, and shed-roofed porches with wooden posts and low concrete wall. Last building on each side and rear structure have wooden pergolas over entrances. Two walkways in center of narrow courtyard with two overgrown light standards. Low concrete wall, entrance torii, and gate at front property line. Boulders arranged on treelawn.

- 2. ✓ Colonial Court  
✓ 291 - 301 North Garfield Ave.

Date: 1916

Acreage: 0.2

Architect: Cyril Bennett

UTM: 11-394530-3779300

Verbal Description:  
book 5723/page 3/parcels 27-32

**NATIONAL REGISTER OF HISTORIC PLACES  
INVENTORY -- NOMINATION FORM**

FOR HCRS USE ONLY

RECEIVED

DATE ENTERED

CONTINUATION SHEET

ITEM NUMBER 8 PAGE 1

Each of the bungalow courts included in this thematic nomination maintains a high degree of integrity of both the bungalow court form and the various architectural styles associated with it. As a group, the courts embody a living document of the historic, economic, social, and architectural forces which fostered their development and popularity. Individually, the courts chronicle the evolution of a highly influential and visible housing form. Today, as in the past, the courts offer some of the most attractive affordable housing in the community, a commodity for which the demand far exceeds the supply.

1. Las Casitas Court

The bungalow court evolved during an era whose residential design was dominated by the Craftsman aesthetic. Las Casitas is one of the few remaining examples of the Craftsman court, complete with a Japanese-inspired torii and artfully placed boulders in front of it. A good illustration of the efficient use of a single lot as income property, Las Casitas is harmoniously integrated into a largely single-family (originally) neighborhood of the Victorian and Craftsman periods.

2. Colonial Court

Cyril Bennett, one of the dominant figures in Pasadena architecture from the teens until the second World War, designed this early example of a Colonial Revival style court. Today enhanced by luxuriant landscaping, Colonial Court is in close proximity to downtown and the Civic Center, making it as desirable today as when originally built. In fact, each unit is individually owned, a precedent which offers a viable approach for the continued existence of the courts.

3. Reinway Court

One of the three finest remaining Craftsman courts in Pasadena, Reinway Court, designed by Charles Buchanan and Leon Brockway, is distinguished for its architecture as well as for its exemplification of the court form. A variety of details, culled from the Tudor, Swiss, and Oriental vocabularies, are intertwined, personalizing each unit and enhancing the public spaces. A large court, amenities such as entrance toriis with stained glass and a garden pergola testify to the attention to detail paid by the designers.

Bungalow Courts  
Pasadena  
California  
#1 La Casitas Court  
656 N. Summit Ave.

1 inch=60 feet

EAST ORANGE GROVE BLVD.

NORTH  
SUMMIT  
AVE.

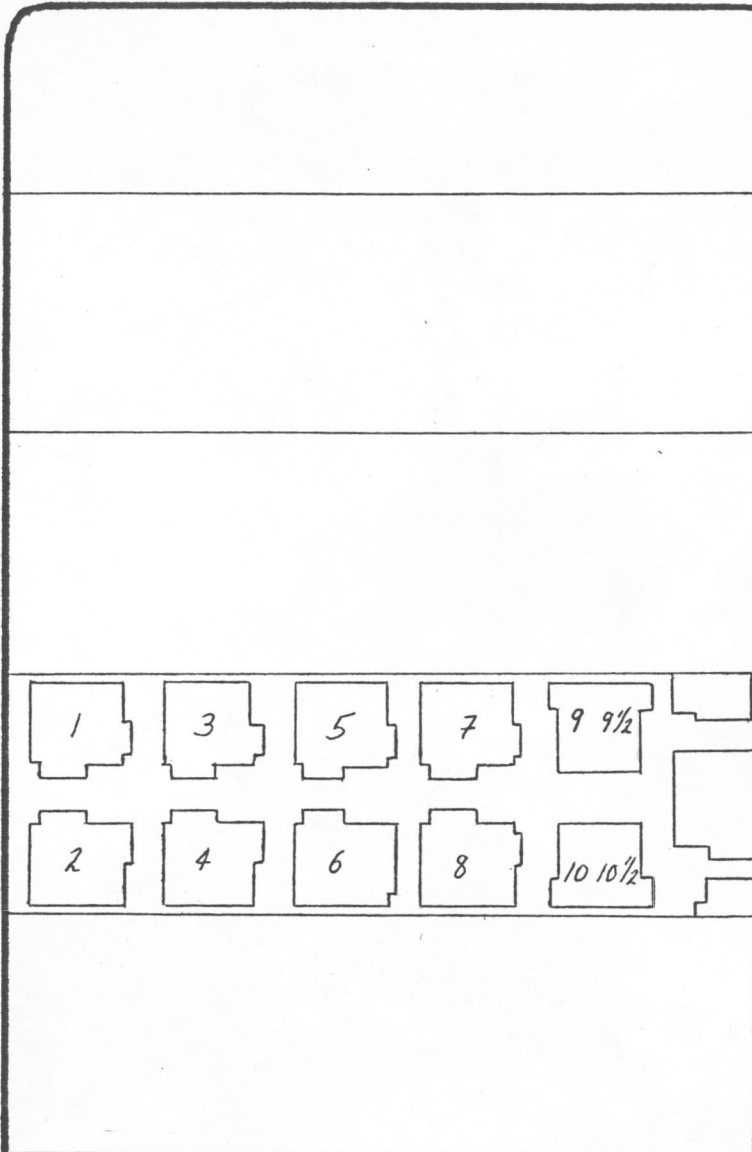

United States Department of the Interior  
National Park Service

National Register of Historic Places  
Inventory—Nomination Form

For NPS use only

received

date entered

Continuation sheet

Item number

Page 1 of 3

Multiple Resource Area  
Thematic Group

dnr-11

Name Bungalow Courts of Pasadena Thematic Resources  
State California

DE-DOE-9  
L/S

Nomination/Type of Review

Date/Signature

1. **Las Casitas Court**

Entered in the  
National Register

for Keeper

Alonzo Byers 7/11/83

Attest

2. Colonial Court

Entered in the  
National Register

for Keeper

Alonzo Byers 7/11/83

Attest

3. Mission Court

Entered in the  
National Register

for Keeper

Alonzo Byers 7/11/83

Attest

4. Gartz Court

DOE/COWNER OBJECTION  
Substantive Review

Determined Eligible

Keeper

Judith McClelland 7/11/83  
*Owner objection with drawing  
Lull McClelland 8/2/83*

Entered in the  
National Register

5. Court  
(497-503 1/2 N. Madison Ave.)

for Keeper

Alonzo Byers 7/11/83

Attest

6. Cypress Court

Substantive Review

Keeper

Judith McClelland 7/11/83

Attest

7. Orange Grove Court

Entered in the  
National Register

for Keeper

Alonzo Byers 7/11/83

Attest

8. Court  
(732-744 Santa Barbara St.)

Entered in the  
National Register

for Keeper

Alonzo Byers 7/11/83

Attest

9. Palmetto Court

Entered in the  
National Register

for Keeper

Alonzo Byers 7/11/83

Attest

10. Don Carlos Court

Entered in the  
National Register

for Keeper

Alonzo Byers 7/11/83

Attest

United States Department of the Interior  
National Park Service

Las Casitas Court (Bungalow Courts of  
Pasadena TR)  
Los Angeles County  
CALIFORNIA

Working No. 6-2-83  
Fed. Reg. Date: 2/7/84  
Date Due: 6/30/83 — 7/17/83

Action:  ACCEPT 7/11/83  
Entered in the  RETURN  
National Register  REJECT

Federal Agency: \_\_\_\_\_

- resubmission
  - nomination by person or local government
  - owner objection
  - appeal
- Substantive Review:  sample  request  appeal  NR decision

Reviewer's comments:

Recom./Criteria \_\_\_\_\_  
Reviewer \_\_\_\_\_  
Discipline \_\_\_\_\_  
Date \_\_\_\_\_  
see continuation sheet

Nomination returned for:  technical corrections cited below  
 substantive reasons discussed below

1. Name

2. Location

3. Classification

Category	Ownership	Status	Present Use
	Public Acquisition	Accessible	

4. Owner of Property

5. Location of Legal Description

6. Representation in Existing Surveys

Has this property been determined eligible?  yes  no

7. Description

Condition		Check one	Check one
<input type="checkbox"/> excellent	<input type="checkbox"/> deteriorated	<input type="checkbox"/> unaltered	<input type="checkbox"/> original site
<input type="checkbox"/> good	<input type="checkbox"/> ruins	<input type="checkbox"/> altered	<input type="checkbox"/> moved date _____
<input type="checkbox"/> fair	<input type="checkbox"/> unexposed		

Describe the present and original (if known) physical appearance

- summary paragraph
- completeness
- clarity
- alterations/integrity
- dates
- boundary selection

---

## 8. Significance

Period \_\_\_\_\_ Areas of Significance—Check and justify below

Specific dates \_\_\_\_\_ Builder/Architect \_\_\_\_\_

Statement of Significance (in one paragraph)

- \_\_\_\_\_ summary paragraph
- \_\_\_\_\_ completeness
- \_\_\_\_\_ clarity
- \_\_\_\_\_ applicable criteria
- \_\_\_\_\_ justification of areas checked
- \_\_\_\_\_ relating significance to the resource
- \_\_\_\_\_ context
- \_\_\_\_\_ relationship of integrity to significance
- \_\_\_\_\_ justification of exception
- \_\_\_\_\_ other

---

## 9. Major Bibliographical References

---

## 10. Geographical Data

Acreage of nominated property \_\_\_\_\_

Quadrangle name \_\_\_\_\_

USFT Reference \_\_\_\_\_

Verbal boundary description and justification \_\_\_\_\_

---

## 11. Form Prepared By

---

## 12. State Historic Preservation Officer Certification

The evaluated significance of this property within the state is:

\_\_\_\_\_ national \_\_\_\_\_ state \_\_\_\_\_ local

State Historic Preservation Officer signature \_\_\_\_\_

title \_\_\_\_\_ date \_\_\_\_\_

---

## 13. Other

- \_\_\_\_\_ Maps
- \_\_\_\_\_ Photographs
- \_\_\_\_\_ Other

Questions concerning this nomination may be directed to \_\_\_\_\_

Signed \_\_\_\_\_ Date \_\_\_\_\_ Phone: 202 272-3504

Comments for any item may be continued on an attached sheet





Please refer to the map in the  
Multiple Property Cover Sheet  
for this property

Multiple Property Cover Sheet Reference Number: 64000063