

United States Department of the Interior
National Park Service

National Register of Historic Places
Inventory—Nomination Form

For NPS use only
received SEP 30 1982
date entered

See instructions in *How to Complete National Register Forms*
Type all entries—complete applicable sections

1. Name

historic MOIR BUILDING

and/or common ST. JAMES HOTEL

2. Location

street & number 227-247 North First Street n/a not for publication

city, town San Jose n/a vicinity of n/a

state California code 06 county Santa Clara code 085

3. Classification

Category	Ownership	Status	Present Use
<input type="checkbox"/> district	<input type="checkbox"/> public	<input checked="" type="checkbox"/> occupied	<input type="checkbox"/> agriculture
<input checked="" type="checkbox"/> building(s)	<input checked="" type="checkbox"/> private	<input type="checkbox"/> unoccupied	<input checked="" type="checkbox"/> commercial
<input type="checkbox"/> structure	<input type="checkbox"/> both	<input type="checkbox"/> work in progress	<input type="checkbox"/> educational
<input type="checkbox"/> site	Public Acquisition	Accessible	<input type="checkbox"/> entertainment
<input type="checkbox"/> object	<input type="checkbox"/> in process	<input checked="" type="checkbox"/> yes: restricted	<input type="checkbox"/> government
	<input type="checkbox"/> being considered	<input type="checkbox"/> yes: unrestricted	<input type="checkbox"/> industrial
	<input checked="" type="checkbox"/> - N/A	<input type="checkbox"/> no	<input type="checkbox"/> military
			<input type="checkbox"/> museum
			<input type="checkbox"/> park
			<input type="checkbox"/> private residence
			<input type="checkbox"/> religious
			<input type="checkbox"/> scientific
			<input type="checkbox"/> transportation
			<input type="checkbox"/> other:

4. Owner of Property

name Burton Wines and Archie S. Robinson

street & number 1625 The Alameda

city, town San Jose n/a vicinity of state California 95126

5. Location of Legal Description

courthouse, registry of deeds, etc. Santa Clara County Building

street & number 70 W. Hedding Street

city, town San Jose state California

6. Representation in Existing Surveys

title Santa Clara County Heritage Resource Inventory has this property been determined eligible? yes no

date 1979 federal state county local

depository for survey records Santa Clara Coutny Historic Resources Commission, 70 W. Hedding Street

city, town San Jose state California

7. Description

Condition		Check one	Check one	
<input type="checkbox"/> excellent	<input type="checkbox"/> deteriorated	<input type="checkbox"/> unaltered	<input checked="" type="checkbox"/> original site	
<input checked="" type="checkbox"/> good	<input type="checkbox"/> ruins	<input checked="" type="checkbox"/> altered	<input type="checkbox"/> moved	date <u>n/a</u>
<input type="checkbox"/> fair	<input type="checkbox"/> unexposed			

Describe the present and original (if known) physical appearance

The Moir Building is a rectangular, three story structure constructed of brick with sandstone (possibly terr-cotta), cast iron and wood embellishments. The Composition is eclectic, drawn upon Queen Anne and Romanesque Revival styles. Slanted bay windows and a round corner tower dominate the upper stories of this 1893 commercial/residential structure. The building is oriented with the main facade on the eastern side. Some architectural detailing appears on the northern side, but the western and southern sides are undistinguished. The building measures 107 feet in length by 76 feet wide. The exterior has been painted.

The facade is divided into six bays at the street level. Sandstone piers with acanthus capitals occur at the south end and the center of the building (Originally a third occurred at the northeast corner). Secondary divisions are created by the sandstone arch (the entrance to the upper floors) and the modified piers that remain of an identical sandstone arch also leading to the upper floors; this entrance was altered prior to 1938. Between the arches and piers are four store fronts. Cast iron columns define the original window pattern of all the shops, but only the southernmost retains the original configuration, design and materials. The remaining three, and the one created within the former entrance arch are of a later (c. 1950) design, set back behind the cast iron columns. The rusticated Romanesque entrance contains three marble steps leading to the double, French style, pane-over-panel doors.

The facade of the upper stories is divided into seven bays with a round tower originally crowned with a victorian cap and weathercock at the corner. Four bays are defined by slanted bay windows. There are three sets of paired windows, round headed at the third floor. Round port hole windows have been added between the slanted bays on the eastern facade, over the original upper story entrances. Decorative panels, dentils and archivolt trim with elongated key stones give texture to the facade. Two metal fire escape structures, c. 1938, and a neon sign proclaiming "Hotel St. James" have been added to the facade. The bracketed cornice features a band of dentils above a plain frieze; an ornamental frame containing MOIR BUILDING is centered in the frieze. Above the cornice a parapet surrounds the flat roof and is capped with a string moulding. Treatment of the north side is similar to the facade, but limited to two slanted bay windows and four round-headed window units with keystones.

The rear wall fenestration is a repetitive pattern of segmentally-arched windows separated by a similarly styled doors in between. The lower floor has been modified (c. 1930) to include metal casement windows. A porch (in deteriorated condition) serves the second floor and provides a landing for the exit stairs from the third floor.

The southern side of the structure is devoid of ornamentation except for a coursing at the second level which is obscured by an adjacent structure. A recess occurs in the wall at the second and third level which contains rectangular double hung windows.

The interior features include stairways with turned balusters, paneled wainscot, plaster ornamentation including rosettes, mouldings, and cherubs in the tower windows rooms. Light shafts, a large skylight and two-story light well provide the interior with natural light. The building has been occupied, until recent years when the upper floors were closed, and is in good condition.

8. Significance

Period	Areas of Significance—Check and justify below			
<input type="checkbox"/> prehistoric	<input type="checkbox"/> archeology-prehistoric	<input type="checkbox"/> community planning	<input type="checkbox"/> landscape architecture	<input type="checkbox"/> religion
<input type="checkbox"/> 1400-1499	<input type="checkbox"/> archeology-historic	<input type="checkbox"/> conservation	<input type="checkbox"/> law	<input type="checkbox"/> science
<input type="checkbox"/> 1500-1599	<input type="checkbox"/> agriculture	<input type="checkbox"/> economics	<input type="checkbox"/> literature	<input type="checkbox"/> sculpture
<input type="checkbox"/> 1600-1699	<input checked="" type="checkbox"/> architecture	<input type="checkbox"/> education	<input type="checkbox"/> military	<input type="checkbox"/> social/
<input type="checkbox"/> 1700-1799	<input type="checkbox"/> art	<input type="checkbox"/> engineering	<input type="checkbox"/> music	<input type="checkbox"/> humanitarian
<input checked="" type="checkbox"/> 1800-1899	<input checked="" type="checkbox"/> commerce	<input type="checkbox"/> exploration/settlement	<input type="checkbox"/> philosophy	<input type="checkbox"/> theater
<input type="checkbox"/> 1900-	<input type="checkbox"/> communications	<input type="checkbox"/> industry	<input type="checkbox"/> politics/government	<input type="checkbox"/> transportation
		<input type="checkbox"/> invention		<input type="checkbox"/> other (specify)

Specific dates 1893-94 **Builder/Architect** Unknown

Statement of Significance (in one paragraph)

The Moir Building is a locally significant example of late 19th century commercial architecture; played an important role in the development of local commerce through its prime tenant, the San Jose Board of Trade, forerunner of the Chamber of Commerce; and is directly associated with an important local developer-entrepreneur, William Moir.

The architectural style represented in the Moir Building is an eclectic combination of Queen Anne and Romanesque Revival styles. It is an excellent representative of late nineteenth century commercial architecture and is one of the last remaining examples of its type and period in San Jose.

The prime tenant, occupying the southern divisions of the first floor, was the San Jose Board of Trade. During the time the Board of Trade occupied the building it promoted effectively the attributes of life in the Santa Clara Valley. It advertised the high potential for growth in agriculture and business in publications, and organized displays in offices and at fairs. Its promotional activities were an important factor in the growth and development of the area.

The developer, William Moir, was a young businessman in his early twenties when he built this structure. This may have been his first major mixed use development; it was located in the expanding commercial area north of downtown. Records indicate that several tenants living in flats had their business on the ground floor.- This included Moir who was a bicycle enthusiast and had a bicycle shop next to the Board of Trade. Moir also served as director of the Board of Trade. After completing several developments in the city, Moir and his family moved to the south county area where he developed and managed a large agricultural interest.

9. Major Bibliographical References

San Jose Mercury, Santa Clara County and Its Resources, San Jose, 1895.
San Jose City Directory, 1889, 1892, 1895, 1899
 Sanborn Fire Insurance Maps, 1889, 1895, 1899
 Dixon, P. and Zavlaris, W.N., San Jose Historic Survey, 1978.

10. Geographical Data

Acreage of nominated property .25 acre

Quadrangle name San Jose West

Quadrangle scale 1:24000

UTM References

A 10 598130 4312920
 Zone Easting Northing

B
 Zone Easting Northing

C

D

E

F

G

H

Verbal boundary description and justification Block 259, P. 33, parcel 58, Santa Clara County Assessor, the structure is located at the southwest corner of N. First St and Devine St. Beginning at this corner, the boundary extends S 107.5 ft, W 100 ft., N 107.5 ft., and E 100 ft. to the point of beginning. Bldg. occupies full lot.

List all states and counties for properties overlapping state or county boundaries

state NA code county code

state NA code county code

11. Form Prepared By

name/title Bonnie L. Bamburg

organization Bonnie L. Bamburg & Associates

date January 20, 1982

street & number 1017 Meridian Avenue

telephone (408) 267-2947

city or town San Jose

state California 95125

12. State Historic Preservation Officer Certification

The evaluated significance of this property within the state is:

 national state XX local

As the designated State Historic Preservation Officer for the National Historic Preservation Act of 1966 (Public Law 89-665), I hereby nominate this property for inclusion in the National Register and certify that it has been evaluated according to the criteria and procedures set forth by the National Park Service.

State Historic Preservation Officer signature

K. Mallon

title State Historic Preservation Officer

date 9-29-82

For NPS use only

I hereby certify that this property is included in the National Register

Entered in the
National Register

date

10/29/82

Delores Byers
Keeper of the National Register

Attest:

date

Chief of Registration

407

PLATE
PAGE
33
259

San Jose

4 R. I. N.

ST.

ST.

ST.

DEVINE

ST.

W. ST. JAMES

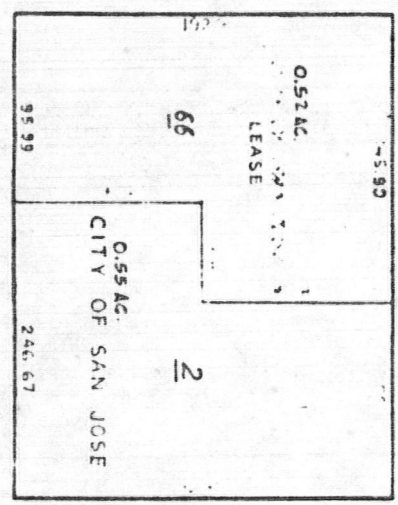
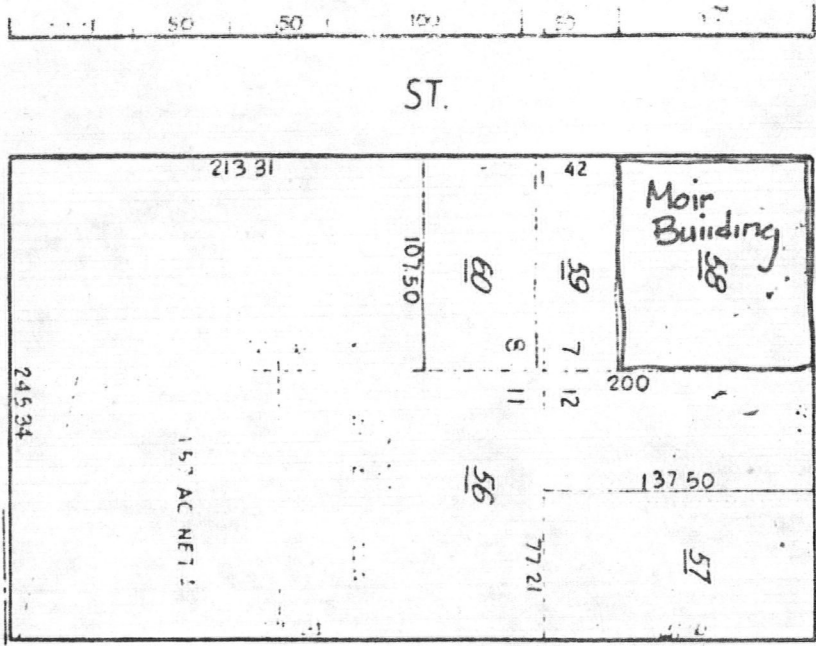

SCALE 1" = 100'

(34)

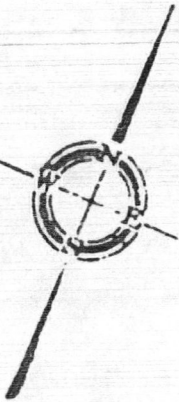

MOIR BUILDING (ST. JAMES HOTEL)
 227-247 N. First Street
 San Jose, Santa Clara County
 California

United States Department of the Interior
National Park Service

Moir Building
Santa Clara County
CALIFORNIA

Working No. 9/30/82-2549
Fed. Reg. Date: 2.1.83
Date Due: 10/29/82 > 11/14/82
Action: ACCEPT 10/29/82
 RETURN
 REJECT
Federal Agency: _____

Entered in the
National Register

- resubmission
- nomination by person or local government
- owner objection
- appeal

Substantive Review: sample request appeal NR decision

Reviewer's comments:

Recom./Criteria _____
Reviewer _____
Discipline _____
Date _____
 see continuation sheet

Nomination returned for: technical corrections cited below
 substantive reasons discussed below

1. Name

2. Location

3. Classification

Category Ownership Status Present Use
 Public Acquisition Accessible

4. Owner of Property

5. Location of Legal Description

6. Representation in Existing Surveys

has this property been determined eligible? yes no

7. Description

Condition excellent deteriorated Check one unaltered Check one original site
 good ruins altered moved date _____
 fair unexposed

Describe the present and original (if known) physical appearance

- summary paragraph
- completeness
- clarity
- alterations/integrity
- dates
- boundary selection

8. Significance

Period _____ Areas of Significance—Check and justify below

Specific dates _____ Builder/Architect _____

Statement of Significance (in one paragraph)

- summary paragraph
- completeness
- clarity
- applicable criteria
- justification of areas checked
- relating significance to the resource
- context
- relationship of integrity to significance
- justification of exception
- other _____

9. Major Bibliographical References

10. Geographical Data

Acres of nominated property _____

Quadrangle name _____

UNIT References _____

Verbal boundary description and justification _____

11. Form Prepared By

12. State Historic Preservation Officer Certification

The evaluated significance of this property within the state is:

national state local

State Historic Preservation Officer signature _____

Site _____ date _____

13. Other

- Maps
- Photographs
- Other _____

Questions concerning this nomination may be directed to _____

Signed _____ Date _____ Phone: 202 272-3504

Comments for any item may be continued on an attached sheet



MOIR BUILDING

ORIENT TRADING Co

211
ST. W.





CUSTOMER PARKING ONLY - 1 HR. LIMIT



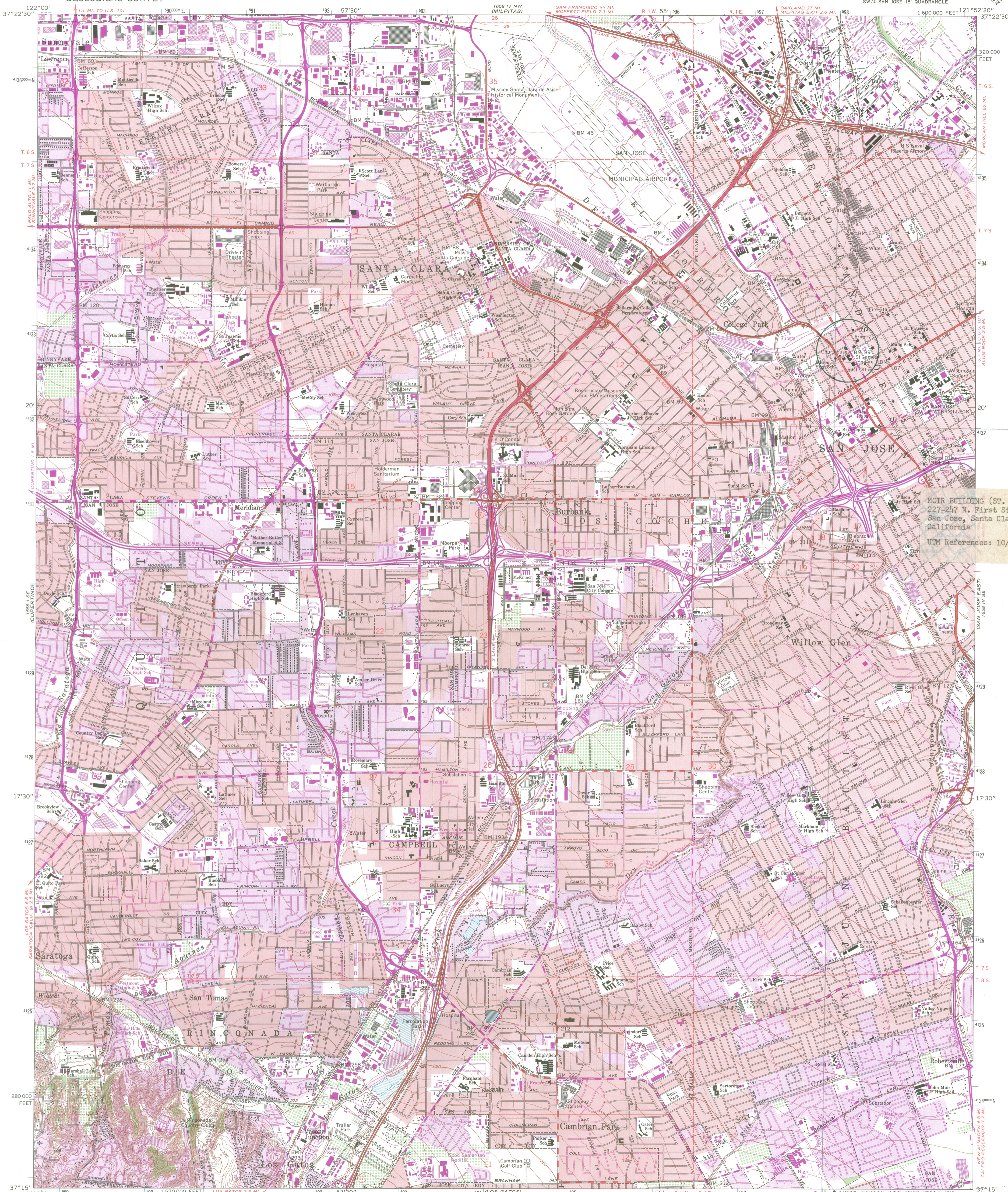

MOIR BUILDING (ST. JAMES HOTEL)
227-247 N. First Street
San Jose, Santa Clara County
California
UTM References: 10/598130/4312920

Mapped, edited, and published by the Geological Survey
with cooperation by the California Department of Water Resources
Control by USGS, NOS/NOAA, and USCE

Topography from aerial photographs by photogrammetric methods
and by planetable surveys 1953. Aerial photographs taken 1948
Revised from aerial photographs and by planetable surveys 1961
Aerial photographs taken 1960.

Polygonic projection. 10,000-foot grid based on California coordinate
system, zone 3. 1000-meter Universal Transverse Mercator grid ticks,
zone 10, shown in blue. 1927 North American Datum. To place on the
predicted North American Datum 1983 move the projection lines
13 meters north and 94 meters east as shown by dashed corner ticks
Red tint indicates areas in which only landmark buildings are shown
Dashed land lines indicate approximate locations
The north two-thirds of this map lies within a subsidence area

Revisions shown in purple and woodland compiled from
aerial photographs taken 1979 and other source data
This information not field checked. Map edited 1980
Purple tint indicates extension of urban areas

THIS MAP COMPLIES WITH NATIONAL MAP ACCURACY STANDARDS
FOR SALE BY U.S. GEOLOGICAL SURVEY, DENVER, COLORADO 80225, OR RESTON, VIRGINIA 22092
A FOLDER DESCRIBING TOPOGRAPHIC MAPS AND SYMBOLS IS AVAILABLE ON REQUEST

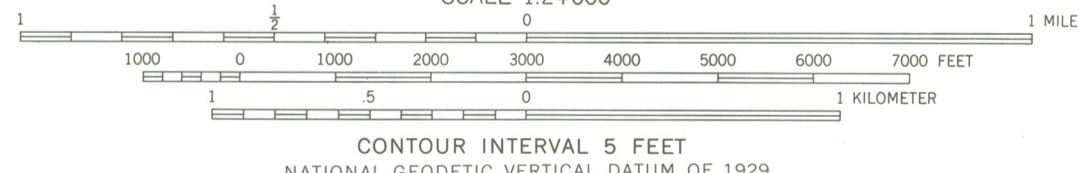

ROAD CLASSIFICATION

Heavy-duty	Light-duty
Medium-duty	Unimproved dirt
Interstate Route	U.S. Route
	State Route

SAN JOSE WEST, CALIF.
SW/4 SAN JOSE 15' QUADRANGLE
N3715-W12152.5/7.5
1961
PHOTOREVISED 1980
DMA 1658 IV SW-SERIES V895



JUN 28 1982

CITY OF SAN JOSÉ, CALIFORNIA

UN 20 1982

801 NORTH FIRST STREET
SAN JOSE, CALIFORNIA 95110
(408) 277-4000

CITY MANAGER

June 23, 1982

Dr. Knox Mellon
State Historic Preservation Officer
P.O. Box 2390
Sacramento, CA 95811

RE: MOIR BUILDING
227-247 NORTH FIRST STREET
SAN JOSE

Dear Dr. Mellon:

This letter is in response to your request for comments on the nomination of the Moir Building, 227-247 North First Street, for listing on the National Register of Historic Places. On behalf of the City administration let me state our support for this nomination.

The Moir Building, most recently known as the St. James Hotel, has been designated as a city landmark by the City Council. Its architectural integrity, location and size substantiate this building's value to our city not only as an historical resource but also as an economically viable component of the downtown development master plan.

Please forward our words of support for the nomination of the Moir Building to the State Historical Resource Commission.

Very truly yours,

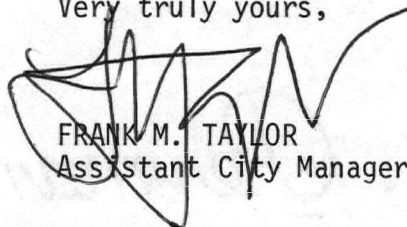

FRANK M. TAYLOR
Assistant City Manager

JUL 13 1982

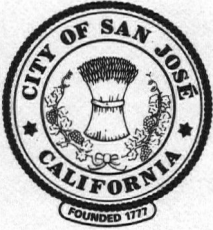

CITY OF SAN JOSÉ, CALIFORNIA

HISTORIC LANDMARKS
COMMISSION

July 6, 1982

Dr. Knox Mellon
Office of Historic Preservation
P. O. Box 2390
Sacramento, California 95811

Dear Dr. Mellon:

The San Jose Historic Landmarks Commission is fully in accord with the nomination of the City's historic Moir Building to the National Register. The Moir Building is one of the finest residential-retail structures left in our downtown.

The restoration of this fine historic and architectural landmark will make it a leading attraction in our downtown historic redevelopment which will be intersected by the proposed new transit mall. National Register status will be an asset to the developer and raise the consciousness of many of our citizens to the aesthetic value of preserving our past.

Please feel free to consult us if there is any further information necessary to make this nomination successful.

Sincerely yours,

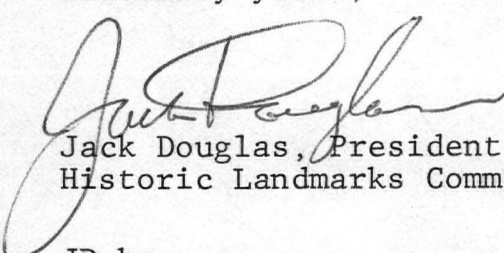
Jack Douglas, President
Historic Landmarks Commission

JD:bc

STRATHMORE BOND
85% COTTON FIBER USA

OFFICE OF HISTORIC PRESERVATION
DEPARTMENT OF PARKS AND RECREATION
POST OFFICE BOX 2390
SACRAMENTO, CALIFORNIA 95811



September 28, 1982

Mr. Jerry Rogers, Keeper
National Register of Historic Places
National Park Service
U.S. Department of the Interior
440 G Street, NW
Washington, DC 20243



Dear Mr. Rogers:

We submit the Moir Building for nomination to the National Register of Historic Places. This property is located in San Jose, Santa Clara County, California. This property has been determined eligible for listing in the National Register through the tax certification process and through the 106 process.

Sincerely,

A handwritten signature in cursive script, appearing to read "Knox Mellon".

Dr. Knox Mellon
State Historic Preservation Officer