



NATURAL

TOFFEE

SABLE

SEDONA

KONA

SENECA RIDGE MAPLE

Framed Door Styles

Traditional Overlay Raised Panel

Wood veneered raised panel doors feature concealed nickel-finished self-closing hinges. Drawer fronts are solid wood. Wall and vanity cabinets are offered with a choice of square or arch raised panel doors. Top and bottom edges of doors and drawer fronts have a 15° reverse bevel. Decorative hardware is optional.

Interior cabinet color is Natural Maple laminate.

Seneca Ridge/Seneca Ridge Arch

Cherry available in:

Paprika Finish: a medium red cherry finish

Cider Finish: light yellow/brown

Maple available in:

*Kona Finish: deep semi-transparent dark brown

Natural Finish: clear sealer and topcoat

Sable Finish: rich medium brown

Sedona Finish: rich traditional cherry finish on maple

Toffee Finish: warm brown

Oak available in:

Cider Finish: light yellow-brown oak

Medium Finish: medium oak

Natural Finish: clear sealer and topcoat

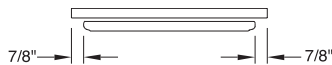
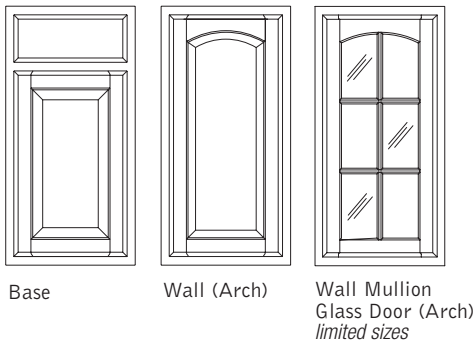

Top view – wall and base

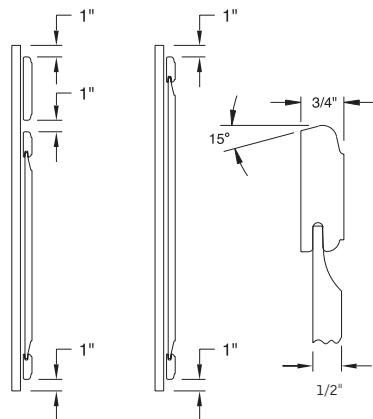

Base side view

Wall side view

Reverse bevel profile on top/bottom edges only

Traditional Overlay Raised Panel with Accent Glaze

Wood veneered raised panel doors feature concealed nickel-finished self-closing hinges. Drawer fronts are solid wood. Not available with arch doors. Accent glaze hand applied to door and drawer front profiles (see below for details). Top and bottom edges of doors and drawer fronts have a 15° reverse bevel. Decorative hardware is optional.

Interior cabinet color is Natural Maple laminate.

Seneca Ridge

Maple available in:

Granite Finish: Sable with charcoal (black) accent glaze

Java Finish: Toffee with sienna (dark brown) accent glaze

Mocha Finish: Natural with sienna (dark brown) accent glaze

Slate Finish: Sedona with charcoal (black) accent glaze

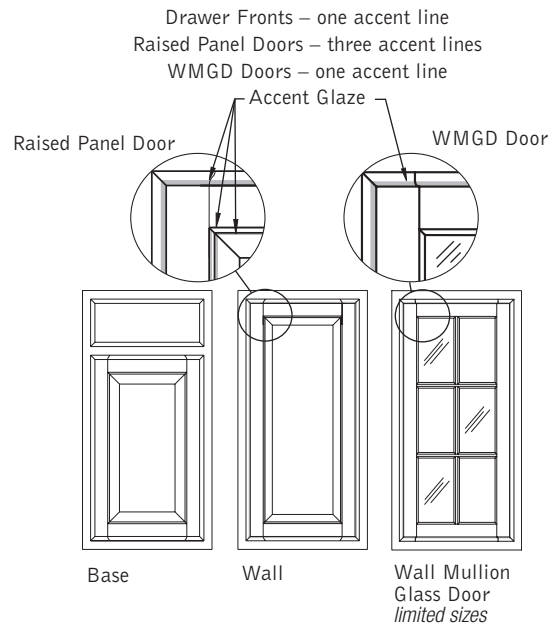

Top view – wall and base

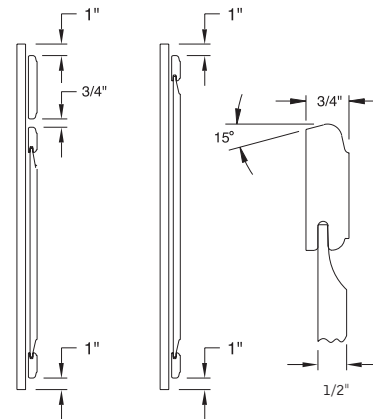

Base side view

Wall side view

Reverse bevel profile on top/bottom edges only

Cabinet Features

Standard Merillat

Listed below are the features found in the offering of Standard Merillat cabinetry.

1. *3/4" thick moisture- and stain-resistant, easy clean laminated adjustable shelves
2. Clear polycarbonate shelf supports
3. Full-depth 1/2" thick moisture- and stain-resistant, easy clean laminated drawer cores
4. 3/4 extension side-mounted dual-captive roller drawer guide system
5. Single roll-out Trays (ST) behind most base cabinet doors at mid-height position
6. 3/8" thick moisture- and stain-resistant, easy clean laminated end panels
7. M-Guard™, a high performing, moisture- and stain-resistant, easy clean laminated surface with printed wood grain

Merillat Deluxe (DELUX)

Listed below are the features found in the offering of Merillat Deluxe cabinetry.

1. 3/4" thick moisture- and stain-resistant, easy clean laminate adjustable shelves
2. Clear polycarbonate shelf supports
3. **Full-depth 3/4" thick hardwood dovetail drawer cores**
4. **Full-extension concealed under-mount guide system with **integrated SoftAction+™ closing mechanism on dovetail drawer cores**
5. Single roll-out Trays (ST) behind most base cabinet doors at mid-height position
6. 3/8" thick moisture- and stain-resistant, easy clean laminated end panels
7. M-Guard™, a high performing, moisture- and stain-resistant, easy clean laminated surface with printed wood grain

Merillat Deluxe Optional Plywood End Panel (MDP)

Listed below are the features found in the offering of Merillat Deluxe Optional Plywood End Panel.

1. 3/4" thick moisture- and stain-resistant, easy clean laminate adjustable shelves
2. Clear polycarbonate shelf supports
3. **Full-depth 3/4" thick hardwood dovetail drawer cores**
4. **Full-extension concealed under-mount guide system with **integrated SoftAction+™ closing mechanism on dovetail drawer cores**
5. Single roll-out Trays (ST) behind most base cabinet doors at mid-height position
6. **3/8" thick matching veneer plywood end panels with moisture- and stain-resistant, easy clean laminate interior surface**
7. M-Guard™, a high performing, moisture- and stain-resistant, easy clean laminated surface with printed wood grain

Installed options available in most Standard Merillat base cabinets

- *3/4" thick **Half-Depth** adjustable Shelf (**HDS**)
- *3/4" thick **Full-Depth** adjustable Shelf (**FDS**).
Note: FDS Included with cabinet but not installed.
- **Double** (2 behind each door) roll-out **Trays (DT)**
- **Double** (2 behind each door) **Deep** full-depth 1/2" thick hardwood dovetail roll-out **Trays (DDT)** with 3/4 extension side-mount dual-captive roller drawer guide system

Installed options available in most Merillat Deluxe and Merillat Deluxe Optional Plywood End Panel base cabinets

- 3/4" thick **Half-Depth** adjustable Shelf (**HDS**)
- 3/4" thick **Full-Depth** adjustable Shelf (**FDS**).
Note: FDS Included with cabinet but not installed.
- **Double** (2 behind each door) roll-out **Trays (DT)**
- **Double** (2 behind each door) **Deep** full-depth 1/2" thick hardwood dovetail roll-out **Trays (DDT)** with side-mount dual-captive roller drawer guide system

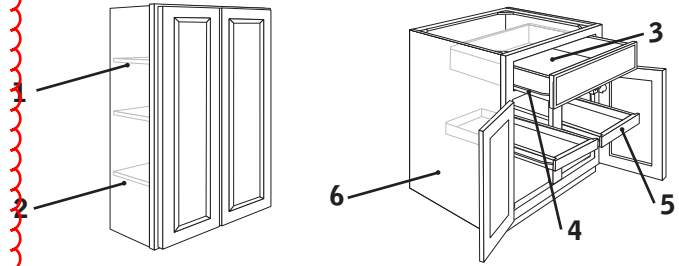

Wall Cabinets (42" high shown) & Base Cabinets (B 36 ST shown)

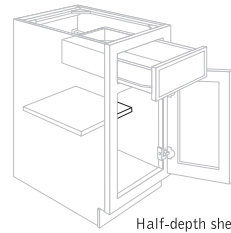

Half-depth shelf

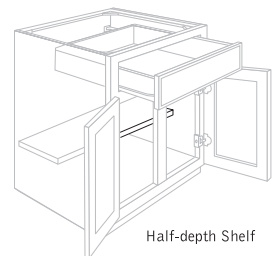

Half-depth Shelf

Base Cabinets with Half Depth Shelf option — HDS

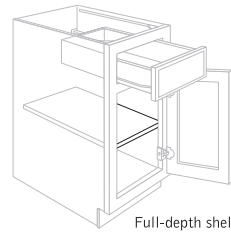

Full-depth shelf

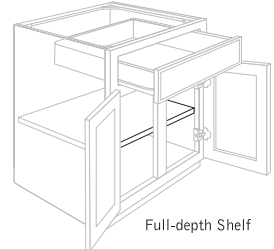

Full-depth Shelf

Base Cabinets with Full Depth Shelf option — FDS

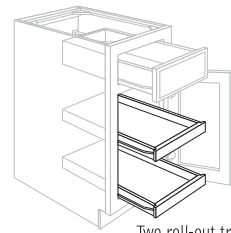

Two roll-out trays

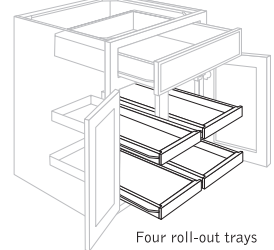

Four roll-out trays

Base Cabinets with Double Trays option — DT

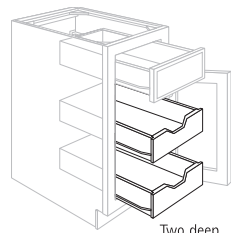

Two deep roll-out trays

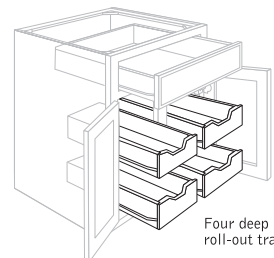

Four deep roll-out trays

Base Cabinets with Double Deep Trays option — DDT

Options: An Introduction

Customize your Merillat Classic cabinetry by adding options to provide more function and design that will make your home work exactly the way you want it to. Want to learn more? Go to www.merillat.com.



Merillat Standard Wood Cabinet Construction

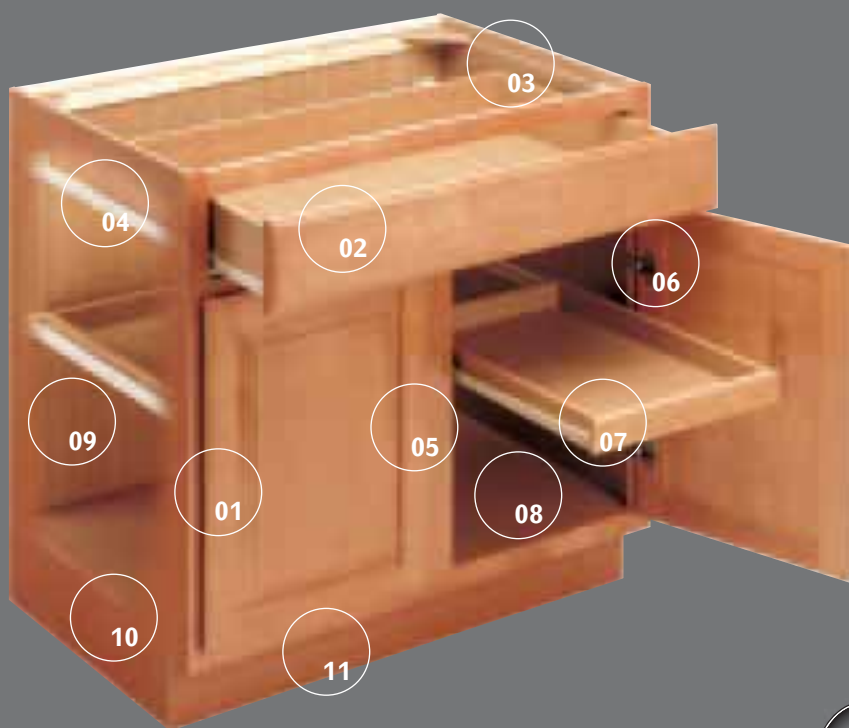

MERILLAT STANDARD WOOD CABINET CONSTRUCTION DETAILS

- 01 Solid thinking.** The Front Frame is 3/4" thick solid wood in Oak, Maple, Cherry, or Hickory.
- 02 Up front style.** The drawer fronts are created with 3/4" thick solid wood that is hand selected and inspected for as close to a uniform grain pattern as possible.
- 03 Built to last.** The drawers are constructed using 4-sided, 1/2" thick laminated engineered board and lap-joined corners, with moisture- and stain-resistant easy clean interiors.
- 04 All's quiet.** The exclusive extra quiet WhisperGlide® drawer guide system includes nylon resin rollers for longer lasting durability.
- 05 Door, prized.** Our 3/4" thick wood doors are finished using a unique high-grade furniture quality process.
- 06 It all hinges on this.** Six-way adjustable, self-closing concealed hinges offer a clean appearance backed by a lifetime warranty.
- 07 Roll with it.** Standard on base cabinets and exclusive to Merillat, our single roll-out trays offer easy access. Exclusive WhisperGlide guide system on all roll-out trays.
- 08 Bottoms up.** The bottom panels are engineered from 1/2" thick wood with moisture- and stain-resistant easy clean interiors.
- 09 Back strength.** The back panel is made from 1/4" thick engineered wood that extends the entire width and height of the cabinet to the floor for extra box strength and stability. Made with moisture- and stain-resistant easy clean interiors. Clear plastic plug in drill holes on back panel.
- 10 The end in mind.** The end panels are created from 3/8" engineered wood with precision machined grooves to accept back, bottoms (and tops on wall cabinets). Made with moisture- and stain-resistant easy clean interiors.
- 11 The kick is good.** Our toe kick covers are crafted with matching wood grain and color.
- 12 Long shelf life.** Base and wall cabinets are built with 3/4" thick shelves made of durable engineered wood for added strength with moisture- and stain-resistant, easy clean interiors.
- 13 25-year warranty.** Merillat Classic cabinetry are guaranteed free of defects in material and workmanship under normal use for twenty five (25) years from date of purchase.



Merillat Classic®



25 YEAR LIMITED WARRANTY

Masco Builder Cabinet Group warrants to the original consumer purchaser that our Merillat Classic® cabinetry will be free from defects in material and workmanship under normal use for a period of TWENTY-FIVE (25) YEARS from date of purchase. This warranty is not transferable. No representative of Merillat has the authority to modify this warranty.

As with other natural materials, wood is affected by environmental factors such as natural and artificial lighting. Darkening or mellowing of the wood can be expected and is a natural process of wood as it ages. Each wood specie also exhibits its own distinctive patterns and characteristics which add to its natural beauty. These variations in color and characteristics are not considered imperfections or defects. This warranty does not cover the natural aging and darkening of wood color nor does it apply to the inherent growth characteristic of wood.

We further provide a LIFETIME LIMITED WARRANTY to the original purchaser on the door hinges and drawer glides for as long as you own the product. This LIFETIME LIMITED WARRANTY provides that the door hinges and drawer glides will be free from defects in material and workmanship under normal use. Replacement hinges and drawer glides are subject to their availability from our suppliers.

Masco Builder Cabinet Group may elect to repair or replace any defective Merillat product covered by our warranty. Our warranty does not cover defects caused by misuse, abuse, negligence, alterations, environmental conditions, improper installation, storage and handling, nor any labor expenses.

From time to time, we will change design, specifications and materials as conditions require and improvements are developed, but we have no obligation to incorporate such changes in products we previously manufactured.

TO THE EXTENT PERMITTED BY LAW, ANY IMPLIED WARRANTIES, INCLUDING THE IMPLIED WARRANTIES OF MERCHANTABILITY AND FITNESS FOR A PARTICULAR PURPOSE, ARE LIMITED TO THE DURATION OF THIS EXPRESS WARRANTY. THIS WARRANTY EXCLUDES ANY INCIDENTAL OR CONSEQUENTIAL DAMAGES.

This warranty is only valid in the United States of America. Some states do not allow limitations on how long an implied warranty lasts or the exclusion or limitation of incidental or consequential damages, so the above limitations or exclusion may not apply. This warranty gives you specific legal rights, and you may also have other rights which vary from state to state.

To obtain performance under this warranty, the purchaser must contact the Merillat supplier and report, in writing, all defects claimed. If you have difficulty obtaining assistance, write to: Merillat Classic® Warranty Department, Masco Builder Cabinet Group, P.O. Box 1946, Adrian, Michigan 49221.

Warranty effective with orders placed 01/05/09 and after.



SECTION 12356 – RESIDENTIAL CASEWORK

1.1 RELATED DOCUMENTS

- A. Drawings and general provisions of the contract, including General and Supplementary Conditions and Division 1 Specification Sections, apply to this Section.

1.2 SUMMARY

- A. This section includes the following:
 - 1. Wood-faced kitchen cabinets.
 - 2. Wood-faced vanity cabinets.
 - 3. Plastic laminate countertops.
 - 4. Solid-surfacing-material countertops.
- B. Related Sections include the following:
 - 1. Division 11 Section Residential Appliances for appliances mounted in the kitchen casework.
 - 2. Division 22 Section Plumbing Fixtures for sink units mounted in countertops.

1.3 REFERENCES

- A. American National Standards Institute (ANSI).
- B. Builders Hardware Manufacturers Association (BHMA).
- C. Hardwood Plywood & Veneer Association (HPVA).
- D. Kitchen Cabinet Manufacturers Association (KCMA).
- E. Laminating Materials Association (LMA).
- F. National Electrical Manufacturers Association (NEMA).

1.4 DEFINITIONS

- A. Exposed Surfaces of Casework: Surfaces visible when doors and drawers are closed, including visible surfaces in open cabinets or behind glass doors.
- B. Semi exposed Surfaces of Casework:
 - 1. Surfaces visible when behind opaque doors and drawer fronts are open, including interior faces of doors and interiors and sides of drawers.
 - 2. Bottoms of wall cabinets are defined as semi exposed.
- C. Concealed Surfaces of Casework:
 - 1. Surfaces not usually visible after installation, including sleepers, web frames, dust panels, bottoms of drawers, and ends of cabinets installed directly against and completely concealed by walls or other cabinets.
 - 2. Tops of wall cabinets and utility cabinets are defined as concealed.

1.5 SUBMITTALS

- A. Product Data: For the Following:
 - 1. Cabinets.
 - 2. Plastic-laminate countertops.
 - 3. Solid-surfacing material.
 - 4. Cabinet hardware.
- B. Shop Drawings: For cabinets and countertops, include plans, elevations, details, and attachments to other work. Show materials, finishes, filler panels, hardware, edge and backsplash profiles, cutouts for plumbing fixtures, and methods of joining countertops.
- C. Material Samples for Initial Selection: Manufacturer's color charts showing the full range of colors, textures, and patterns available for each type of material exposed to view.
- D. Material Samples for Verification: For the following materials; in sets showing full range of color, texture, and pattern variations expected:
 - 1. Wood-veneered panels with transparent finish, 3 1/4 x 5 3/4 inches (80 x 145mm), for each species.
 - 2. Solid wood with transparent finish, 50 sq. in. (300 sq. cm.), for each species.
 - 3. Plastic laminate for countertops, 8 by 10 inches (200 by 250mm).
 - 4. Solid surfacing for material for countertops, 6 inches (150mm) square.
 - 5. One unit of each type of exposed hardware.
- E. Product Samples for Verification: As Follows:
 - 1. One full-size, finished 15" base cabinet complete with hardware, doors, and drawers, but without countertop.

2. One full sized, finished 15" wall cabinet complete with hardware, doors, and adjustable shelves.
 3. Plastic laminate for countertops, 8 by 10 inches (200 by 250mm)
 4. Solid surfacing for material for countertops, 6 inches (150mm) square.
- F. Product Certificates: Signed by manufacturers of casework certifying that products furnished comply with specified requirements.

1.6 QUALITY ASSURANCE

- A. Source Limitations for Cabinets: Obtain cabinets through one source from a single manufacturer
- B. Product Designations: Drawings indicate size, configurations, and finish material of casework by referencing designated manufacturer's catalog numbers. Other manufacturer's casework of similar sizes, similar door and drawer configurations, similar finish materials, and complying with the Specifications may be considered. Refer to Division 1 Section Substitutions.
- C. Quality Standards: Unless otherwise indicated, comply with the following standards:
 1. Cabinets: KCMA A161.1.
 2. Plastic Laminate Countertops: KCMA A161.2.

1.7 PROJECT CONDITIONS

- A. Environmental Limitations: Do not deliver or install residential casework until building is enclosed, wet-work is complete, and HVAC system is operating and will maintain temperature and relative humidity at occupancy levels during the remainder of the construction period.
- B. Established Dimensions: Where residential casework is indicated to fit to other construction, establish dimensions for areas where casework is to fit. Coordinate construction to ensure that the actual dimensions correspond to established dimensions. Provide fillers and scribes to allow for trimming and fitting.
- C. Field Measurements:
 1. For cabinets: Where residential casework is indicated to fit existing construction, verify dimensions of existing construction by field measurements before fabrication and indicate measurements on Shop Drawings. Provide filler and scribe if necessary.
 2. Field Measurements For Countertops: Verify dimensions of countertops by field measurements after base cabinets are installed but before countertop fabrication is complete. Coordinate fabrication schedule with construction progress to avoid delaying the Work.

1.8 COORDINATION

- A. Coordinate layout installation of blocking and reinforcement in partitions for support of residential casework.

2.1 MANUFACTURERS

- A. Acceptable Manufacturers: Subject to compliance with requirements, manufacturers offering products that may be incorporated into the Work include the following:
 1. Merillat
 2. Sustainability Certifications: ISO14001, KCMA ESP & EPP
- B. Manufacturers: Subject to compliance with specified requirements, provide products by one of the following:
 1. Plastic Laminate for Countertops:
 - a. Formica Corp
 - b. Laminart
 - c. Nevamar Corp.
 - d. Pioneer Plastics Corp.
 - e. Westinghouse Electric Corp.; Specialty Products Div.
 - f. Wilson: Ralph Wilson Plastics Co.
 2. Solid-Surfacing Material for Countertops:
 - a. DeNova Solid Surface
- D. Acceptable Products: Subject to compliance with specified requirements, provide
 1. Merillat Classic Seneca Ridge Maple available in assorted finishes.
 2. Warranty: 25 years

2.2 COLORS, TEXTURES, AND PATTERNS

- A. Colors, Textures, and Patterns: As indicated by referencing manufacturer's designations.
- B. Colors, Textures, and Patterns: As selected by Architect from manufacturer's full range for these characteristics.

2.3 CABINET MATERIALS

- A. Exposed Materials: Comply with the following:
 - 1. Exposed Wood Species:
 - a. Unless otherwise indicated, do not use two adjacent exposed faces shall be similar that are noticeably dissimilar in color, grain, figure, and or natural character markings.
 - b. Maple.
 - 2. Solid Wood: Clear hardwood lumber of species indicated, free of defects, selected for compatible grain and color, kiln dried to 7 percent moisture content.
- B. Semi-exposed Materials: Unless otherwise noted, provide the following:
 - 1. Medium Density Particleboard: Moisture- and stain-resistant, easy clean laminate with printed wood grain complying with ANSI A208.1, Grade M-1 adhesively bonded to particleboard.
 - a. Provide laminate film on both sides of shelves, dividers, and other components with two semi-exposed surfaces and semi-exposed edges.
- C. Concealed Materials: Comply with the following:
 - 1. Plywood: Any hardwood or softwood species, with no defects affecting strength or utility.
 - 2. Particleboard: ANSI A208.1, Grade M-1

2.4 COUNTERTOP MATERIALS

- A. Plastic Laminate: High-pressure decorative laminate complying with NEMA LD 3.
 - 1. Grade: HGS.
 - 2. Grade: HGP.
 - 3. Provide through-color plastic laminate
 - 4. Grade for Backer Sheet: BKL
- B. Particleboard: ANSI A208.1, Grade M-2
- C. Plywood: Exterior softwood plywood complying with PS 1, Grade C-C plugged, touch sanded.
- D. Solid-surfacing : Homogeneous solid sheet of filled plastic resin complying with material and performance requirements of ANSI Z124.3, Type 5 or Type 6, without pre-coated finish.
- E. Solid Wood Edges and Trim: Clear hardwood lumber of species indicated, free of defects, selected for compatible grain and color, kiln dried to 7 percent moisture content.
 - 1. Wood Species: Maple

2.5 CASEWORK HARDWARE

- A. General: Manufacturer's standard units complying with BHMA A156.9, type, material, size, and finish as selected from manufacturer's standard choices.
- B. Hinges: All doors shall be mounted on concealed, nickel-finished self-closing hinges. Door hinges will self-close within 10 degrees of cabinet face. All hinges shall have six-way (vertical, horizontal and front-to-back) adjustability except for 42" high WMGD, WGD, WCMGD, WCGD, WAMGD and WAGD wall Glass Door cabinets. **All hinges have a LIMITED LIFETIME WARRANTY to the original purchaser.**
- C. Drawer Guides: The 3/4 extension side-mount dual-captive roller drawer guide system shall be used on all standard Merillat drawers, roll-out trays and deep roll-out trays. The system shall consist of a pair of epoxy coated 1.25mm steel slides that roll on close-tolerance nylon wheels. **All guides have a LIMITED LIFETIME WARRANTY to the original purchaser** and comply with BHMA A156.9.

2.6 CABINET CONSTRUCTION

- A. Face Style: Reveal overlay: Door and drawer faces partially cover body or face frame.
- B. Face Frames: 3/4-by-1 1/2-inch (19-by-38mm) solid wood.
- C. Door and Drawer Fronts:
 - 1. Solid wood stiles and rails, 3/4-inch (19mm) thick, with 1/2-inch (12.7mm) thick, veneer-faced particleboard center panels
 - 2. Seneca Ridge doors are machined with reverse bevel to eliminate the need for

hardware.

- D. Exposed Cabinet Ends:
 - 1. 3/8-inch (9.5mm) thick, moisture- and stain-resistant, easy clean laminate faced particleboard.
- E. Cabinet Tops and Bottoms: Wall cabinet tops and bottoms shall be 1/2" thick-48 lb. density engineered wood. Both sides shall be covered with M-Guard™, with printed wood grain. The upper portion of base cabinets shall be reinforced with 1/2" thick engineered wood corner gussets in all four corners with adhesive which.
- G. Base Unit Back Panels: Base and bath cabinet back panels shall be 1/4"-thick 50 lb. density engineered wood covered on the interior surface only with M-Guard™, with printed wood grain.
- H. Wall-Hung Unit Backs: Wall cabinet back panels shall be 3/8" thick-48 lb. density engineered wood covered on the interior surface only with M-Guard™, with printed wood grain.
- I. Wall-Hung Unit Top and Bottom Rails: Wall cabinet backs shall be reinforced with a 2 3/4" wide x 3/8" thick-48 lb. density engineered wood full-length hang rail across the top and bottom held in place with staples. Additionally, shall be a 3/8" thick engineered wood spacer centered on the back panel rear side of cabinets 27" wide and wider secured with adhesive. Hang rails and spacer are fully concealed behind cabinet back panel.
- J. Front Face Frame Drawer Rails: Cabinet frames shall have 3/4" thick x 1 1/2" wide solid hardwood rail and stile members.
- K. Shelves: 3/4" thick-48 lb. density engineered wood. Full-depth shelves shall be covered on both sides with M-Guard™, matching the cabinet interior. Half-depth shelves are laminated on the top surface only and not on the underside. End panels are drilled for clear polycarbonate shelf supports on 2 1/2" increments. Shelves are designed to support 15 lbs. per square foot, not to exceed 50 lbs. per shelf.
- M. Joinery:
 - 1. Wall cabinet back panels shall be retained by a dado in the end panels and secured with adhesive. For extra strength, full-length dadoes shall be machined in the back panel near the top and bottom edges like the dadoes in the end panels to accept the top panels and secured with adhesive and staples.
 - 2. Base cabinets: A dado joint and adhesive shall be used to join the bottom to end panels. The upper portion of base cabinets shall be reinforced with 1/2" thick engineered wood corner gussets.
 - 3. The back panel shall be retained by a dado in the end panels secured with adhesive. The top of base and bath cabinets shall have an 11/16" x 2 1/4" solid wood screw rail retained by the same groove as the back panel in the end panels and secured with adhesive. The screw rail shall be grooved full length on the underside to accept the top edge of the back panel.
- N. Factory Finishing: To the greatest extent possible, finish casework at the factory. Defer only final touch up until after installation.

3.1 INSTALLATION

- A. Install casework with no variations in flushness of adjoining surfaces; use concealed shims. Where casework abuts other finished work, scribe and cut for accurate fit. Provide filler strips, scribe strips, and moldings in finish to match casework face.
- B. Install casework without distortion so doors and drawers fit openings and are aligned. Complete installation of hardware and accessories as indicated.
- C. Install casework and countertop level and plumb to a tolerance of 1/8-inch in 8 feet (3mm in 2.4m).
- D. Fasten cabinets to adjacent units and to backing.
 - 1. Fasten wall cabinets through back, near top and bottom, at ends and not less than 24 inches o. c.
- E. Protect finished surfaces from damage or staining resulting from subsequent work until Date of Substantial Completion. Repair or replace damaged cabinet work, including warped or loose members.