

Welcome to the  
K Ranch

\* = Cattle Fence  
put up by  
Neighboring  
Ranchers

+ = White  
Packet Fence  
 ← 4" 10"

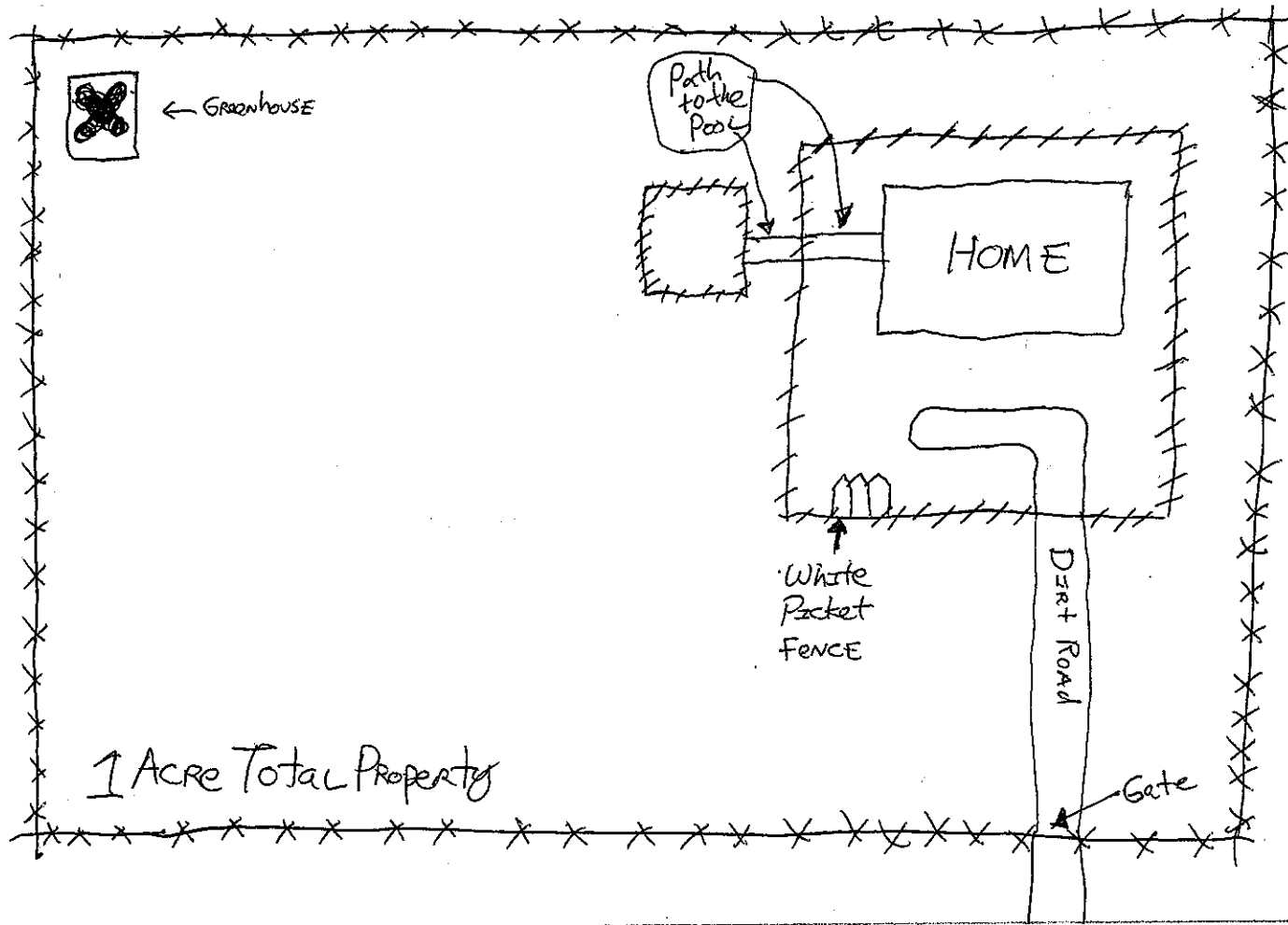

Nevada State Police are on the hunt for missing diamonds and other gold jewelry that were recently stolen from a Las Vegas pawn shop.

During their investigation, detectives come to believe that the missing diamonds and other gold jewelry are located somewhere at the Circle K ranch (which is located outside of town.) Although they cannot identify exactly where the diamonds and other gold jewelry are located, the investigation points toward one of two locations --

(1) the greenhouse

OR

(2) at the bottom of the pool

The detectives would like to do a search of premises AND/OR a fly-over of the property.

May the detectives undertake either, neither or both?