

Inola to Tiawah

From: Inola To: Tiawah Distance: 50 miles

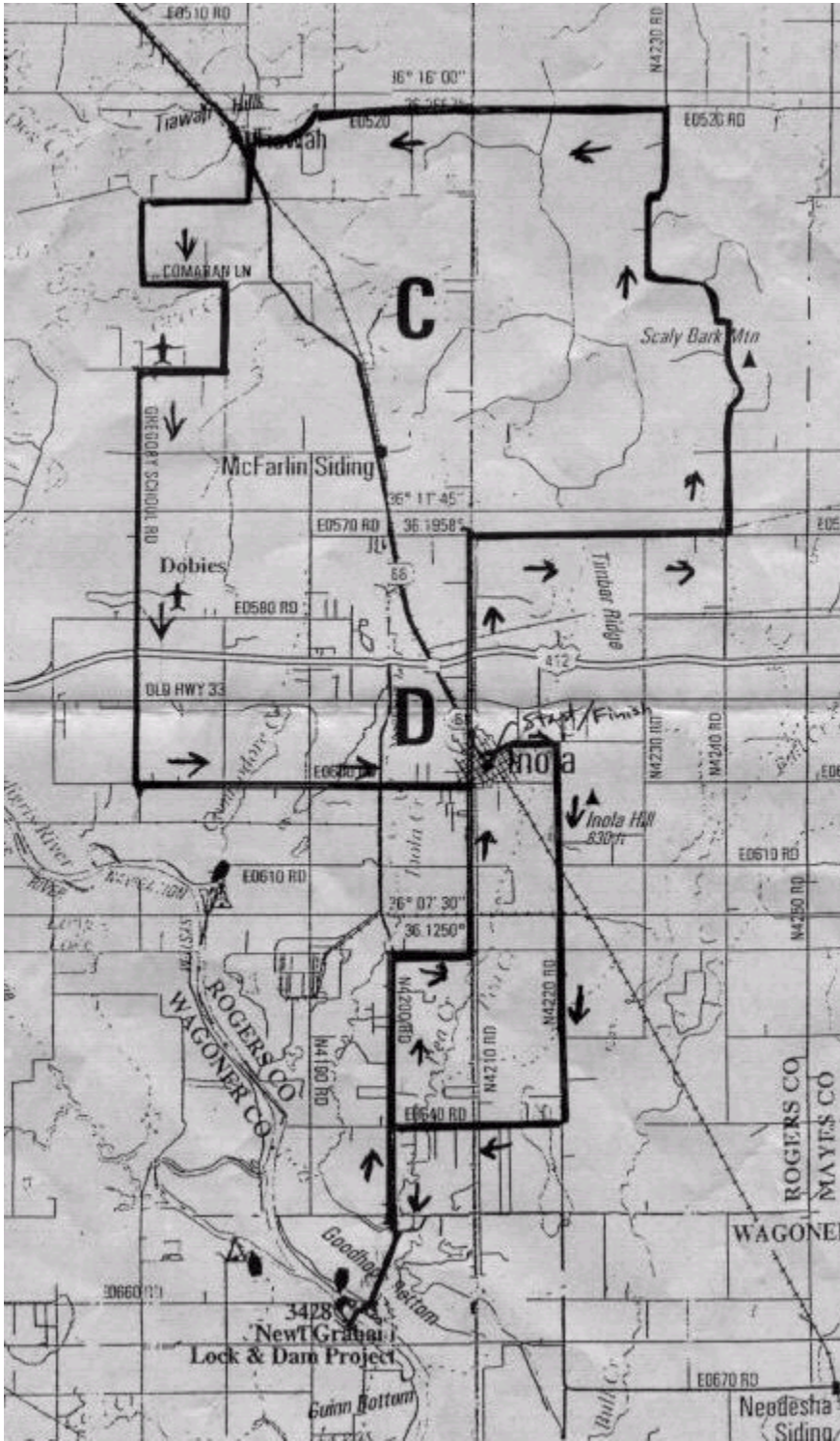

Directions

Distance	Instruction
0.0	Begin at Inola High School. Turn right out of parking lot (onto Main Street or West Commercial)
0.2	Left on EW 595
0.7	Right on NS 422
1.2	Straight across EW 60 -- Caution cars don't stop from right.
2.2	Right on T on EW 61 and immediately left across RR tracks and around curve. Continue South on NS 422
2.7	Rail Road tracks
5.2	Right onto EW 64
7.2	Left (South) on NS 420. Continue to Newt-Graham Lock & Dam
9.4	Turn around and head back North on NS 420
13.7	Right (East) on EW 620
14.7	Left (North) on NS 421
15.2	Rail Road tracks. Veer towards the left at Yield sign.
16.9	Right on Bill North Drive or Commercial St. (where 421 or B St. SW ends)
17.3	Left on C Street NE
17.6	Left on NE 3rd Street,
17.7	Right on B Street NE
17.8	Right on NS 421
18.2	Straight across EW 59 (Old Hwy 33). Caution Cross traffic does not stop. Continue North on NS 421.
20.2	Right onto EW 57
23.2	Left onto NS 4240. Follow road around -- it changes names and eventually becomes NS 423
29.0	Caution. Dirt & gravel
29.3	Left onto EW 52
34.4	Left at the T in Tiawah (just past the school). Caution Rail Road tracks. Cross Hwy 88.
34.7	Stop at Tiawah Hills General Store. South from store on NS 4180.
35.2	Right on EW 530
36.5	Left (South) onto NS 417 (Peterson Rd.)
37.4	Around the curve to the left onto Comaron (also EW54)
38.4	Curve Right on NS 418
39.4	Right (West) on EW 550 (Yocham)
40.4	Left (South) on NS 4170. Cross Hwy 412 and continue south on NS 417.
45.4	Left (East) on EW 60
49.2	Curve around to the left (North) onto Bill North Drive (also West Commercial)
50.4	Arrive back at Inola High School