

# Florida Floodplain Managers Association 11<sup>th</sup> Annual Conference

## Diamond

Florida Division  
of Emergency  
Management



## Platinum

**ECT** Environmental  
Consulting &  
Technology, Inc.

## Gold

CRS  MAX  
CONSULTANTS, INC.

CELEBRATING **40** YEARS  
**JONES EDMUNDS**  
INTEGRITY | KNOWLEDGE | SERVICE

## Bronze

**CDM  
Smith**



 **Dewberry**  
www.dewberry.com

**BANKERS**  
INSURANCE GROUP



**URS**

## Nickel



# 2014

**FFMA WOULD LIKE TO THANK OUR SPONSORS**

# Conference Schedule

March 26-28, 2014

Wednesday, March 26, 2014

7:30 am - 4:30 pm

Registration

7:30 am - 5:00 pm

Plantation Foyer

Exhibits Open

7:30 am - 8:30 am

Piano Foyer

Continental Breakfast

8:00 am - 11:00 am

Plantation Ballroom

Plenary Sessions

8:00 am - 8:15 am Introductions

Des Companion, CFM, FFMA Chair  
*Sarasota County*

8:15 am - 8:30 am Welcome from  
Mayor McDonald

Troy McDonald

8:30 am - 8:45 am Things to Know

Cece McKiernan, CFM, LEED AP *ECT*

8:45 am - 9:45 am Collaborative Work with  
Extreme Weather, Floodplain  
Management, and Sea-Level  
Rise

Libby Carnahan  
Thomas Ruppert  
*Florida Sea Grant*

9:45 am - 10:15 am

Piano Foyer

Coffee Break

10:15 am - 11:00 am

ASFPM & ASFPM Foundation  
Updates

Chad Berginnis, CFM  
*Executive Director, ASFPM*

11:00 am - 12:00 pm

Stuart Hall  
Flamingo  
Elliott Amphitheatre  
Egret  
Blue Heron

Concurrent Regional Meetings

Region 1  
Region 2  
Region 3  
Region 4  
Region 5

12:00 pm - 1:30 pm

Plantation Ballroom

Pondering Environmental and Estuary Issues in Martin County  
*Lunch with Featured Speaker Mark Perry, Executive Director, Florida  
Oceanographic Society*

1:30 pm - 5:00 pm

Concurrent Sessions

1:30 pm - 3:00 pm

Stuart Hall

CRS Track:  
Developing a Program for  
Public Information

*Earl King, CRS Max*

## Wednesday, March 26 Continued

1:30 pm - 3:00 pm Stuart Hall	<b>CRS Track:</b> CRS Activity 610 Flood Warning Credit	Danny Hinson, CFM, FPDM <i>FDEM</i>
1:30 pm - 3:00 pm Egret	<b>Floodplain Mitigation Track:</b> Mitigation Success - Reducing Flood Risk through a Decade of Proactive Planning and Retrofit Measures This Water Wasn't Here When I Built My House: How Minimum Floodplain Management Requirements Can Increase Flood Hazards	Michael Saxton, PE, CFM <i>Tetra Tech</i>  Del Schwalls, PE, CFM <i>CDM Smith</i>
1:30 pm - 3:00 pm Elliott Amphitheatre	<b>Insurance Track</b> BW-12 Flood Insurance Changes Becoming Effective in 2014	Donald Beaton Jr., CFM Region 5 Director, FFMA Katherine Howington, CFM <i>Bankers Insurance Group</i>
1:30 pm - 5:00 pm Crane	<b>ISO One-on-One Track:</b> By Appointment	Lori Lehr, CFM; Heidi Liles, CFM <i>ISO</i>
1:30 pm - 5:00 pm Flamingo	<b>Training Track:</b> Hydrology and Hydraulic Concepts for a Flood Insurance Study	M. Krishnamurthy, PhD, PE, CFM <i>Hydro Modeling</i>

3:00 pm - 3:30 pm  
Piano Foyer

## Afternoon Break

3:30 pm - 5:00 pm Stuart Hall	<b>CRS Track:</b> Timing is Everything: The CRS and Notice Provisions	Thomas Ruppert <i>Florida Sea Grant</i>
3:30 pm - 5:00 pm Egret	<b>Floodplain Mitigation Track:</b> Floodplain Permitting Best Practices from Florida Communities Pondering the Roles of Today's Floodplain Manager - Have You Managed Your Floodplain Today?	Daniel Fitz-Patrick, CFM <i>FDEM</i>  Steve Martin, CFM Marlee McCleary, CFM Jason Smalley, CFM <i>FDEM</i>
3:30 pm - 5:00 pm Elliott Amphitheatre	<b>Insurance Track:</b> Communicating Flood Risk and BW-12 at the local Level: Lessons Learned	Bruce Bender, CFM <i>Bender Consulting Services</i>

5:00 pm - 7:00 pm

Reception (Live music from *ReelTing*, Cash Bar, and Hors d'oeuvres)

**Thursday, March 27, 2014**

**8:00 am - 4:30 pm**

**Registration**

**7:30 am - 5:00 pm**  
Plantation Foyer

**Exhibits Open**

**7:30 am - 8:30 am**  
Piano Foyer

**Continental Breakfast**

**8:30 am - 4:30 am**  
Blue Heron

**CFM Exam Refresher**

**Susan Wilson, CFM**  
*FEMA Region IV*

**8:00 am - 12:00 pm**  
Plantation Ballroom

**Plenary Sessions**

**8:00 am - 8:15 am** Welcome from the Nominated  
Chair

**James Linkogle, CFM**  
*Town of Longboat Key*

**8:15 am - 8:30 am** Things to Know

**Cece McKiernan, CFM, LEED AP**  
FFMA Executive Director

**8:30 am - 9:15 am** Seven Secrets to Superior  
Presentations

**Chuck Roberts, CEO**  
*Performance Management Group*

**9:15 am - 10:00 am** Panel Discussion - BW-12 and  
Homeowner Flood Insurance  
Affordability Act of 2014

**Susan Wilson, CFM**  
**Joy Duperault, CFM**  
**Don Beaton, CFM**  
**Chad Berginnis, CFM**  
**Des Companion, CFM**  
**Bruce Bender, CFM, Moderator**

**10:00 am - 10:30 am**  
Piano Foyer

**Coffee Break**

**10:30 am - 11:15 am** FEMA Updates

**Susan Wilson, CFM**  
FEMA Region IV

**11:15 am - 12:00 pm** Updates on State NFIP  
Activities

**Joy Duperault, CFM**  
State Floodplain Manager  
*FDEM*

**12:00 pm - 1:30 pm**  
Plantation Ballroom

**Lunch and Annual Member's Meeting**

## Thursday, March 27 Continued

1:30 pm - 5:00 pm

### Concurrent Sessions

1:30 pm - 3:00 pm  
Stuart

CRS Track:  
CRS Activity 330 Outreach  
Projects

Lori Lehr, CFM  
ISO

Pondering FDEM, CRS, and You

Danny Hinson, CFM, FPEM  
FDEM

1:30 pm - 3:00 pm  
Egret

Floodplain Mitigation Track:  
Presentation of FFMA Coastal  
Committee's White Paper on  
Policy and Design Options for  
Public Restrooms in SFHA's

*Des Companion, Coastal Committee Chair  
Sarasota County*

1:30 pm - 5:00 pm  
Crane

ISO One-on-One Track:  
By Appointment

Lori Lehr, CFM  
Heidi Liles, CFM  
ISO

1:30 pm - 3:00 pm  
Elliott Amphitheatre

Outreach Track:  
RAMPP's Ongoing West  
Florida Coastal Analyses and  
Outreach

Christopher Moss, PE  
URS

The Risk Conversation:  
Engaging the Insurance Agent

Kamer Davis, CFM  
FloodSmart

Meeting Risk Map Metrics in  
the Suwannee River Water  
Management District

Bradley Heilwagen, PE, CFM  
AMEC

1:30 pm - 3:00 pm  
Flamingo

Training Track:  
The Making of an Advisory Sea  
Level Rise Flood Hazard Layer

Charlene Johnston, PE  
RAMPP

Analyzing Preliminary Flood  
Zones with LiDAR

Frank Veldhuis, PSM  
NorthStar Geomatics

Pondering Rainfall

Camyllyn Lewis, PE, CFM  
Aqua-Assets

3:00 pm - 3:30 pm  
Piano Foyer

### Afternoon Break

## Thursday, March 26 Continued

3:30 pm - 5:00 pm Stuart Hall	<u>CRS Track:</u> The CRS Program's Repetitive Loss Area Analysis - A Substitute or Additional Credit for Your Community's Hazard Mitigation Plan	David A. Stroud, CFM <i>AMEC</i>
3:30 pm - 5:00 pm Elliott Amphitheatre	<u>Outreach Track:</u> Success and Challenges of Communicating Flood Risk and Map Updates to Stakeholders in Martin County, Florida  Risk Reduction through Innovation and Partnerships	Michael O'Brien, PSM, CFM <i>Martin County</i> Katrina Myers, PE, CFM <i>Taylor Engineering</i>  Kristen Martinenza, PE, CFM Richard S. Flood, PE, CFM <i>FEMA</i>
3:30 pm - 5:00 pm Egret	<u>Training Track:</u> Elevation Certificate Training	Martin Duran, CFM <i>Sarasota County</i>
3:30 pm - 5:00 pm Flamingo	<u>Training Track:</u> Floodplain Residents of the Future: Educating the Next Generation of Property Owners  Pondering Level-of-Service	Mike Rimoldi, MPA, CBO, CBC <i>Bracken Engineering</i>  David Jones, PE, GISP Crissy Mehle, PE, CFM <i>Jones Edmunds</i>
5:00 pm	Free Night / Dinner on Your Own	

## SECOND FLOOR

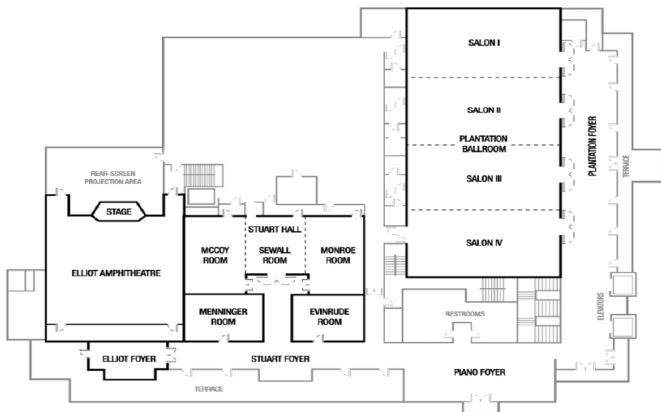

## THIRD FLOOR

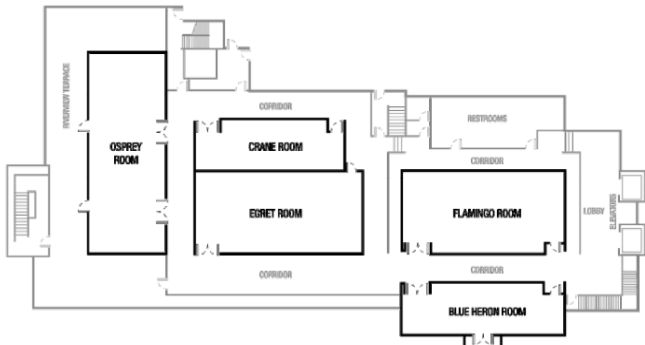

Friday, March 28

7:30 am - 8:30 am  
Piano Foyer

## Continental Breakfast

8:30 am - 12:00 pm

## Field Trip to Martin County Tropical Farms Water Quality/Flood Control and ACOE St. Lucie Locks facility

8:30 am - 12:00 pm

## Concurrent Sessions

8:30 am - 12:00 pm  
Osprey

Mock Open House

8:30 am - 12:00 pm  
Blue Heron

CFM Exam

Karen Thornhill, CFM

8:30 am - 10:00 am

Communications Committee Meeting

*Sandy Shook, CFM, Communications Chair*

8:30 am - 10:00 am  
Flamingo

### Professional Development

#### Track:

CEO and Executive Succession Planning

Rachel Cantor Fogarty  
*RC Associates*

Committing Inward to Improving Outcomes: Identifying and Addressing the Challenge of Organizational Change

Chris Carew, MPA  
Performance Management Group

8:00 am - 10:00 am  
Egret

### Training Track:

The Flood Provisions of the 2010 Florida Existing Building Code

John Farinelli, CBO, MCP, CFM, LEED AP  
*JC Code & Construction Consultants*

10:00 am - 10:30 am  
Piano Foyer

## Coffee Break

10:30 am - 12:00 pm  
Flamingo

Floodplain Mitigation Track:  
Stormwater Management:  
Where Are We Now?

Cheryl Moore

10:30 am - 12:00 pm  
Egret

Training Track:  
Understanding Foundation Flood Vents and FEMA's Technical Bulletin 1

Bruce Sherlock, CFM, CGP  
*Smart Vent*