

THIS IS A PORTION OF SECTION 7226, STATE EDUCATION LAW FOR ANY USE APPEARING ON THIS DRAWING. ON THIS DRAWING, IF ANY PART IS ALTERED, THE ALTERNATE NUMBERED SET AND THE ALTERNATE NUMBERED AND THE DATE OF SUCH ALTERATION OF THE ALTERNATE.

| NO. | MADE BY | APPROVED BY | DATE | DESCRIPTION |
|-----|---------|-------------|------|-------------|
| | | | | |
| | | | | |
| | | | | |
| | | | | |

DESIGNED BY: -
 DRAWN BY: ELB
 CHECKED BY: -
 PROJ. ENGR. MCD

URS Corporation
 New York
 77 Grand Street, 15th Floor, New York, NY 10038
 (212) 904-5000 - (212) 904-2545 fax

JOB NO. 11174823

HARBLE RIVER, LLC
 3 COLUMBIA PLACE
 ALBANY, NEW YORK 12207

HARBLE RIVER WIND FARM
 CLINTON COUNTY
 NEW YORK

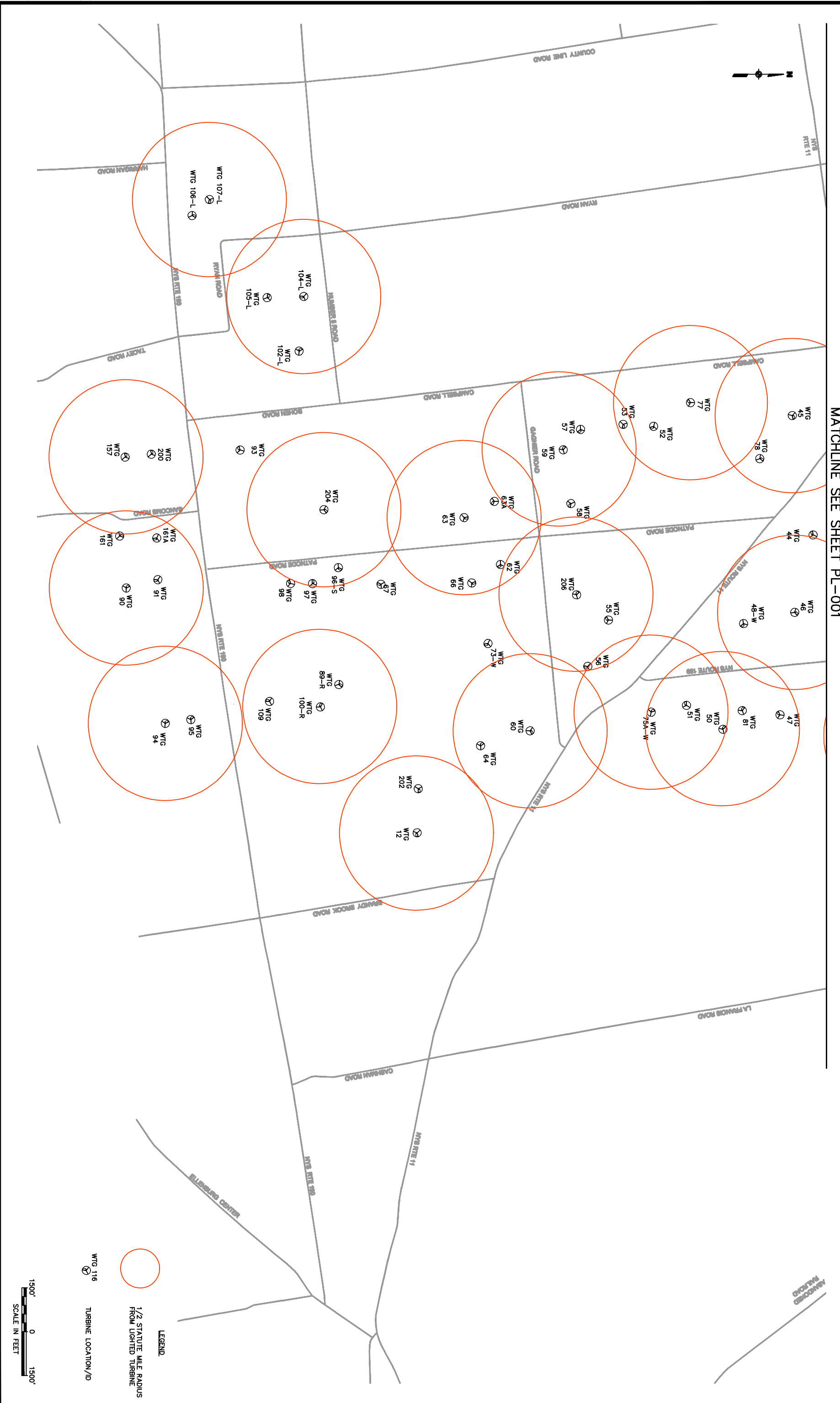

PROPOSED LIGHTING PLAN
 Scale: AS SHOWN Date: MAY 2007

This drawing was computer generated. No other software or hardware should be used to create or modify this drawing. Only the original CAD drawing file.



MATCHLINE SEE SHEET PL-001

1500'
 0
 1500'
 SCALE IN FEET

LEGEND
 1/2 STATUTE MILE RADIUS FROM LIGHTED TURBINE
 WTG 116 TURBINE LOCATION/ID

Only copies from the original of this drawing that are marked with the original seal and signature of the Engineer, shall be considered as true valid copies.



Appendix A

Proposed Lighting Plan Marble River Wind Farm

June 22, 2007

The proposed lighting plan for Marble River Wind Farm was developed by Marble River, LLC based on guidelines in the U.S. Department of Transportation Federal Aviation Administration Advisory Circular AC 70/7460-1K "Obstruction Marking and Lighting" effective February 1, 2007.

The lighting plan calls for lighting 43 of 109 proposed wind turbine generators (WTG's). Table 1 identifies the coordinates and elevations for each WTG and identifies which WTG's will be lighted. Figure 1 shows red circles of ½ statute mile radius centered on each lighted WTG.

Marble River, LLC will submit a Notice of Proposed Construction or Alteration (FAA Form 7460-1) for each proposed WTG and the Lighting Plan will be finalized based on requirements determined by the FAA's Obstruction Evaluation Service.

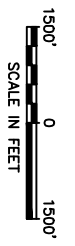
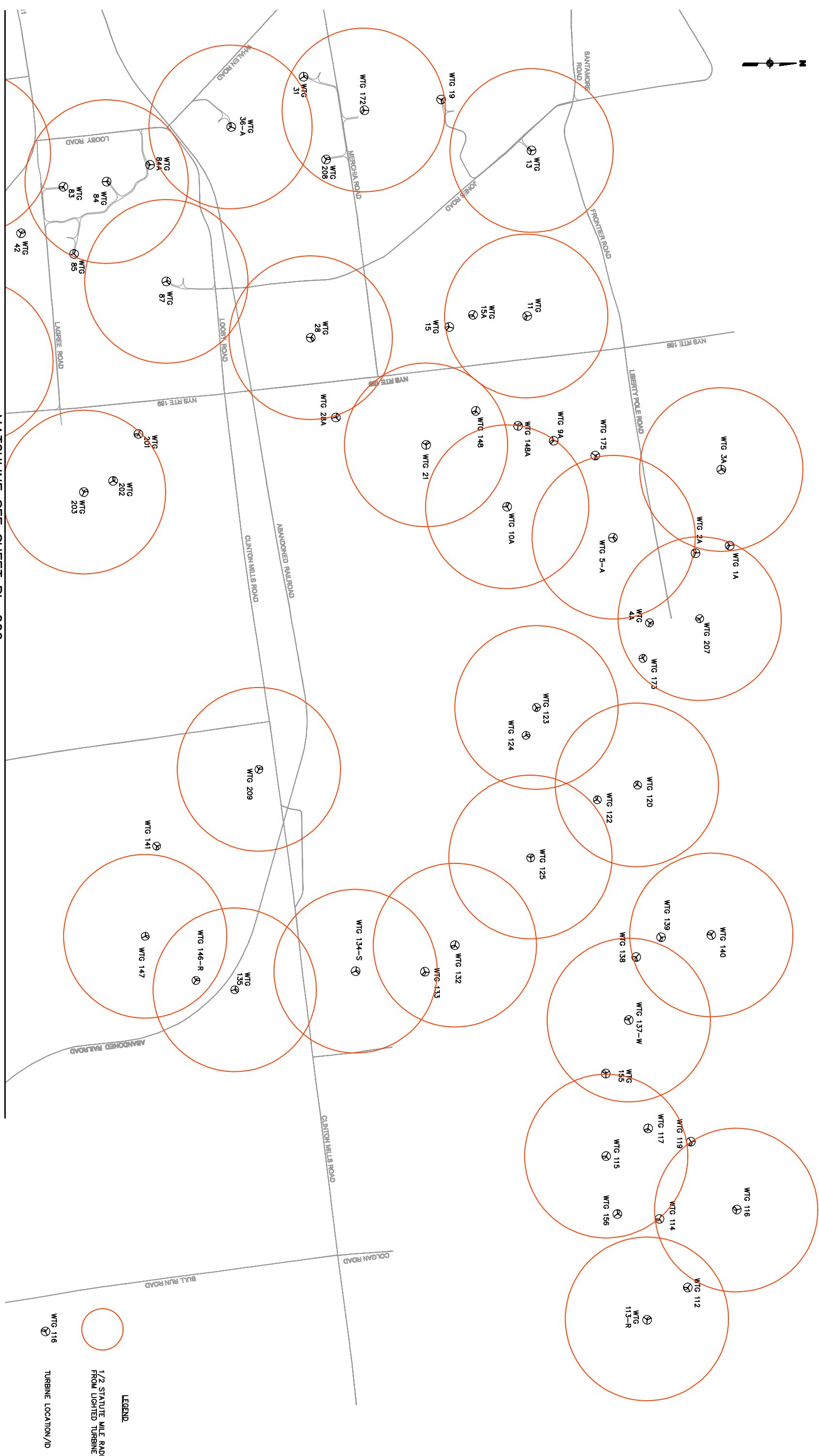

LEGEND

1/2 STATUTE MILE RADIUS FROM LIGHTED TURBINE

TURBINE LOCATION/ID

THIS IS A PORTION OF SECTION 220A, STATE ENGINEERING LAW FOR ANY USE APPEARING ON THIS DRAWING. ON THIS DRAWING, IF ANY ITEM IS ALTERED, THE ALTERING ENGINEER SHALL SIGN AND THE DATE OF SUCH ALTERATION, AND A SPECIFIC DESCRIPTION OF THE ALTERATION.

| NO. | MADE BY | APPROVED BY | DATE | DESCRIPTION |
|-----------|---------|-------------|------|-------------|
| REVISIONS | | | | |
| | | | | |
| | | | | |
| | | | | |
| | | | | |

DESIGNED BY: —
 DRAWN BY: ELB
 CHECKED BY: —
 PROJ. ENGR. MCD

URS Corporation
 New York
 77 Gould Street, 14th Floor, New York, NY 10038
 (212) 904-4000 • (212) 904-2545 fax

MARBLE RIVER, LLC
 3 COLUMBIA PLACE
 ALBANY, NEW YORK 12207

MARBLE RIVER WIND FARM
 CLINTON COUNTY
 NEW YORK

PROPOSED LIGHTING PLAN

Scale: AS SHOWN Date: MAY 2007

PL-001

This drawing was computer generated. No responsibility is assumed for any errors or omissions. The user shall be responsible for verifying the accuracy of the data used in the drawing. Only copies from the original of this drawing that are marked with the original seal and signature of the Engineer, shall be considered as true valid copies.

THIS IS A PORTION OF SECTION 220A OF THE STATE ELECTION LAW FOR ANY USE APPEARING ON THIS DRAWING. ON THIS DRAWING, IF ANY PART IS ALTERED, THE ALTERNATE NUMBERED SET AND THE NOTATION "ALTERED" AND THE DATE OF SUCH ALTERATION OF THE DRAWING SHALL BE INDICATED.

| NO. | MADE BY | APPROVED BY | DATE | DESCRIPTION |
|-----------|---------|-------------|------|-------------|
| REVISIONS | | | | |
| | | | | |
| | | | | |
| | | | | |
| | | | | |

DESIGNED BY: —
 DRAWN BY: ELB
 CHECKED BY: —
 PROJ. ENGR. MCD

URS Corporation
 New York
 77 Grand Street, 15th Floor, New York, NY 10013
 (212) 904-4000 - (212) 904-2545 fax

HARBLE RIVER, LLC
3 COLUMBIA PLACE
ALBANY, NEW YORK 12207

HARBLE RIVER
WIND FARM
 CLINTON COUNTY
 NEW YORK

PROPOSED LIGHTING PLAN
 Scale: AS SHOWN Date: MAY 2007
PL-002

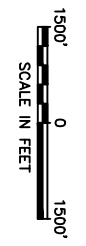
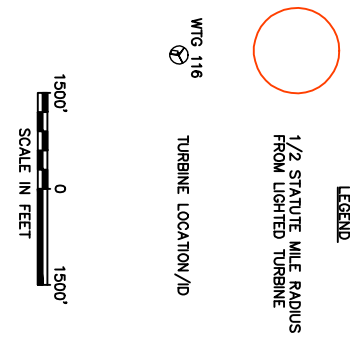
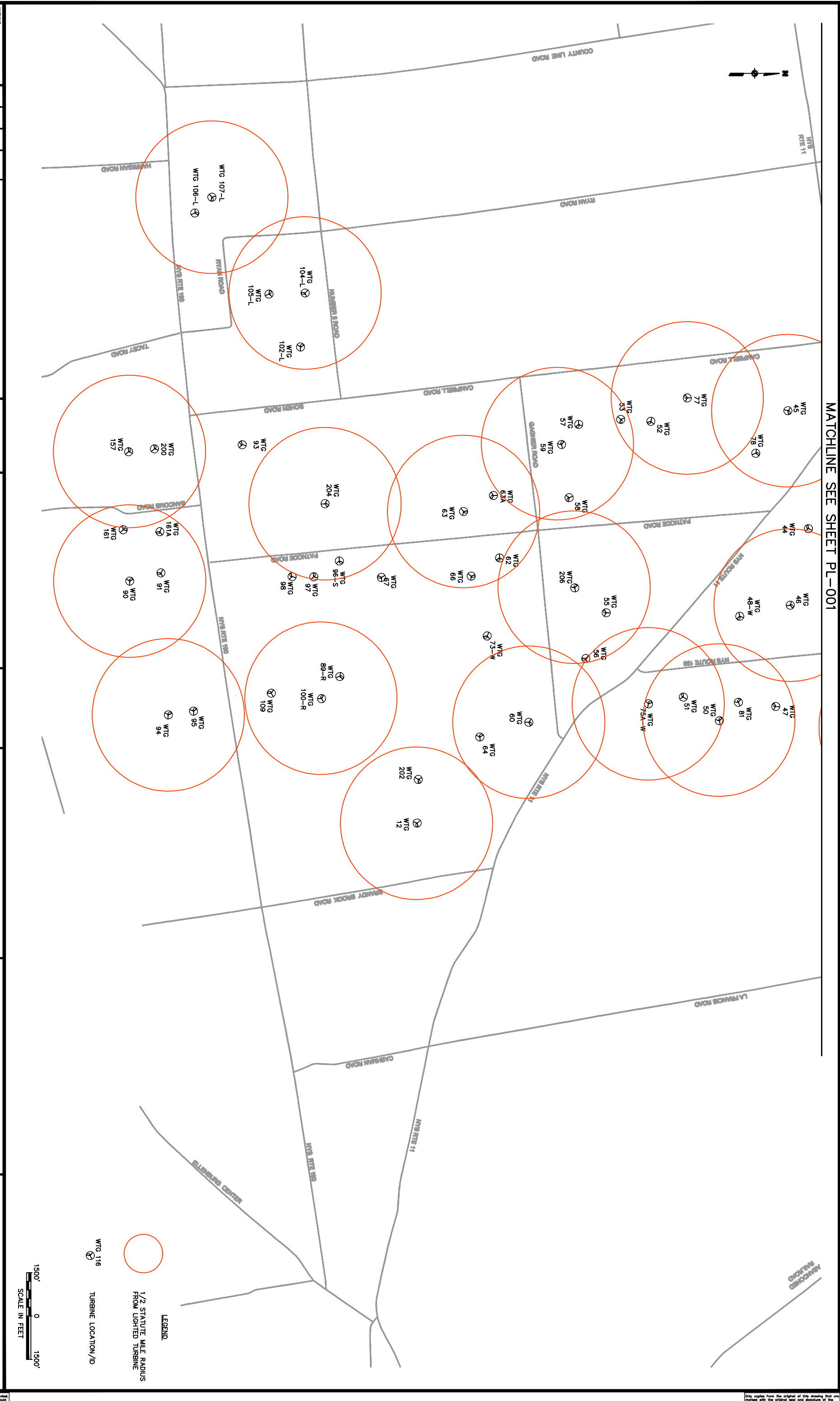

MATCHLINE SEE SHEET PL-001

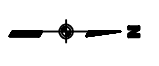

Only copies from the original of this drawing that are marked with the original seal and signature of the Engineer, shall be considered as true valid copies.