



Fort Worth Convention Center
Fort Worth, TX ★ June 7-9, 2012

EXHIBITOR PACKET

As of March, 2012

Rena Peden
State Republican Executive Committee
Exhibit Coordinator



Republican Party of Texas 2012 Convention

To: Exhibitor

From: Steve Munisteri, Chairman

Re: 2012 Republican Party of Texas Convention - Invitation to Exhibit

The state convention is the biennial convention of the Republican Party of Texas (RPT). Delegates to the convention formulate the platform for the Republican Party of Texas, determine rules and elect a State Chairman, a State Vice Chairman, and the State Republican Executive Committee members. Additionally, it provides an opportunity for attendees to meet candidates and to purchase a variety of goods and services.

We invite you to review the Exhibitor Packet for the State Convention and consider the advantages of participating as an exhibitor. You will have two and one-half days (from June 7th to 9th) to reach as many as 12,500 delegates, alternates, family members, elected officials and dignitaries who will be in Fort Worth for the convention. The exhibit area will be in the Fort Worth Convention Center, which allows easy and continual accessibility throughout the hours of the convention. The Omni Hotel has been designated as the convention hotel.

The convention gives you a tremendous opportunity to market your products, ideas or organization to thousands of Texans from the grassroots level to elected office holders. To ensure consideration as an exhibitor at the Convention, please complete the forms in the **Exhibitor Packet** and return with your payment as soon as possible. The deadline to be guaranteed space is May 31, 2012 or until space is sold out – whichever occurs first. Booth selection will be determined on a first-come, first-served basis, by suitability, availability and as set forth in the Party rules and regulations. We will make a decision regarding your application as quickly as possible.

For questions regarding the application process please contact:

Rena Peden, SREC
Exhibits Coordinator
204 Covered Bridge Drive
Ft. Worth, Texas 76108
(817) 946-9911

rena.peden@sbcglobal.net



Republican Party of Texas 2012 Convention

EXHIBITOR RULES

1. A representative should be present in your booth during exhibit hours.
2. Only approved material is to be distributed, sold, or displayed per the rules stated in the *Exhibitor Packet*.
3. No helium-filled balloons permitted in the Fort Worth Convention Center.
4. A designated coordinator will be made available, and questions or needs should be directed to that person.
5. Food items may not be sold.
6. The Convention Center has an exclusive agreement with Owens Service Co., and outside electrical or utilities are not permitted.
7. No signs, banners, fliers or other materials are to be hung, attached to or placed on walls, drapes, railings, doors, or other fixtures within the Convention Center.
8. Exhibitors may not block the normal flow of traffic.
9. All exhibitor registrations will be approved by the Republican Party of Texas or its representative in a timely manner.
10. The Republican Party of Texas, or its representatives, reserves the right to approve any and all merchandise or material before it is sold or distributed.
11. Security personnel will be provided 24 hours per day within the exhibit area.
12. Offensive, sexually oriented, racially biased or suggestive material is not permitted.
13. No protesting or demonstrating will be allowed in the exhibit area.
14. No mechanical forklifts or electric pallet jacks are allowed by exhibitors.
15. A decorating service will be available to coordinate additional needs or items not provided as part of the booth price.
16. These rules are intended as an overview not to be all inclusive of all rules and policies.



Republican Party of Texas 2012 Convention

Exhibit Space Information

Exhibits will be set up in Bays C and D in the Exhibit Hall in the Fort Worth Convention Center. You will have secured an exhibit space once the *Exhibitor Agreement* and associated documents are received, reviewed and accepted by the Republican Party of Texas or its representative by May 31, 2012. Space is not guaranteed for contracts received after May 31, 2012.

Booth Fee

Pavilion (30' x 20') – very limited number	\$6,000.00
Premium Location (10' x 10') - limited number	\$1,800.00
Standard Location (10' x 10')	\$1,000.00

Payment Policy

Payment is due in full, with receipt of the Exhibitor Contract, May 31, 2012. Only checks and credit cards will be accepted for payment. No refunds for cancellations after April 30, 2012 (the Republican Party of Texas reserves the right to keep all or part of booth fees upon cancellation).

Booth Assignment

Exhibit spaces will be assigned by the Republican Party of Texas based on the following:

1. the number of days prior to the time that the application, contract, and other required document are received with payment in full.
2. the number of booths requested.
3. suitability.

Exhibit Hours

Setup/Registration:

Wednesday, June 6, 2012, 7 AM to 4 PM

- No mechanical forklifts or electric pallet jacks are allowed by exhibitors.

Thursday, June 7, 2012, 7 AM to 7 PM

Friday, June 8, 2012, 7 AM to 7 PM

Saturday, June 9, 2012, 7 AM to 4 PM

Tear down:

Saturday, June 9, 2012, 2 PM to 9 PM

- You may not depart from Exhibit Hall E dock until after 3 PM.

Installation/Dismantling

Set-up

Wednesday, June 6, 2012, 7 AM to 7 PM.

- Set-up shall be completed no later than 7 PM, Wednesday, June 6, 2012.
- Exhibitor registration will take place in the registration area at the exhibitor desk.
- The loading dock area on the east side of the Convention Center will be open from 7 AM until 5 PM
- Space not claimed by 5 PM on June 6, 2012, will be reassigned without refund.

The exhibitor agrees not to dismantle or do any packaging before 2 PM on Saturday, June 9, 2012. The complete exhibit must be removed, boxed, or crated for shipment by the exhibitor immediately after the close of the exhibits. The loading dock will be open from 4 PM until 9 PM on Saturday, June 9, 2012. Texas is a right-to-work state, which means that exhibitors and their full time employees may install and dismantle their own exhibits using their own equipment.



Republican Party of Texas 2012 Convention

Decorating Services

For **Standard** and **Premium Booths**, a 10' X 10' booth will be provided with an 8' high back wall, 36" high side dividers, one 6' skirted table, and two chairs. Special builds or additional furnishings may be ordered by the exhibitor. All builds are subject to approval by the Republican Party of Texas.

For **Pavilion Booths**, a 30' X 20' booth will be provided with 8' high back wall, 36" high side dividers, five 6' skirted tables and ten chairs. Special builds or additional furnishings may be ordered by the exhibitor. All builds are subject to approval by the Republican Party of Texas.

A standard 7" X 44" sign is furnished free for each exhibitor. This sign will consist of your firm or organizational name and your booth number(s). The Company/Organization listed on your Exhibitor Registration Form will be printed on your sign. If you have additional requests, please contact Rena Peden at 817-946-9911.

Special signs, extra furnishings, booth carpet, utility connections, telephones, and other services may be ordered using information provided in the *Exhibitor Service Kit*. Kit information will be included with the notification of acceptance of the exhibitor's request for booth space.

The service providers listed in the exhibitor kit are exclusive providers. No other outside providers are permitted to deliver or install items in your booth. An Exhibitor Coordinator will maintain a presence in the exhibit hall to assist you.

Shipping/Drayage Instructions

Material, handling and shipping instructions will be included in the *Exhibitor Service Kit*.

Badges

Three complimentary badges will be provided at registration for each 10' X 10' booth purchased. Each additional person connected with the exhibitor wishing to attend the convention may purchase a badge for \$25.00. A badge request form is included in this Exhibitor Packet. Valid government identification is required before badges will be issued.

Selling Policy

Exhibitors may sell products on the exhibit floor during regular exhibit hours. Exhibitors must conform to the policies included in the *Exhibitor Packet*. A completed *Exhibitor Registration Form* describing items to be sold, displayed, distributed, or given away by exhibitors must be approved prior to booth award. The Republican Party of Texas reserves the right to restrict or refuse exhibition space. If questions arise as to the suitability of the indicated use of booth space, the Officials Committee will review the *Exhibitor Agreement* and *Registration Form* and make a written determination as to the awarding of booth space.

Exhibitors are responsible for any and all permits required by law or local ordinance. An exhibitor without a Texas location needs a use tax permit. Please contact the State of Texas Comptroller of Public Accounts at (800) 688-6829 for more information.

Food and Beverage

Trinity Food & Beverage Services, Inc., is the official concessionaire for the Fort Worth Convention Center. No selling of food or beverage is allowed. All sampling of food or beverage items must be cleared through Trinity Food and Beverage Services. Their information will be in the *Exhibitor Service Kit*.



Republican Party of Texas 2012 Convention

Exhibitor Registration Form

Name of Exhibitor:

Name Requested to appear on Booth:

Contact Name:

Phone: _____ Alternate: _____

Fax (required): _____ Email (required): _____

Address:

City: _____ State: _____ Zip: _____

Booth: Standard booth \$1,000.00* Premium booth \$1,800.00*
 Pavilion (30' x 20') \$6,000*

*a \$50 expedite fee will apply if application accepted after April 30.

(Check One Below)

Trade Craft Retail Candidate
 Production Consulting Public Institution Other

Give a brief description of your product or information:

NOTE: COMMERCIAL EXHIBITORS MUST ATTACH PROOF OF INSURANCE

Premium booths are located in the highest traffic area and have limited availability.

Special Requirements (at your own cost):

I/we agree that the above information is accurate and true; that no misrepresentation of any information, insured status or data is inherent or implied.

All applications are subject to approval. Booth allocation will be determined by suitability, availability, and on a first-come, first-served basis. The RPT reserves the right to restrict or refuse exhibition space.

Signature: _____ Date: _____

Contributions to the Republican Party of Texas are not deductible for federal income tax purposes

Personal and PAC checks are welcome. Corporate contributions are also acceptable and will be used for administrative expenses as outlined and in compliance with state and federal election law. By law, political committees are required to use their best efforts to obtain and report the name, address, occupation, and employer for each individual whose contributions aggregate in excess of \$200 per calendar year. Contributions up to \$10,000 from individuals and up to \$5,000 from federal PACs will be deposited into the Party's federal account. All other donations will be deposited into the Party's state or corporate account, as appropriate. Contributions from foreign nationals and federal contractors are prohibited by law.

Paid for by the Republican Party of Texas. www.texasgop.org



Republican Party of Texas 2012 Convention

FORT WORTH CONVENTION CENTER
1201 HOUSTON ST.
FORT WORTH, TEXAS



Republican Party of Texas June 7-9, 2012 Halls C-D

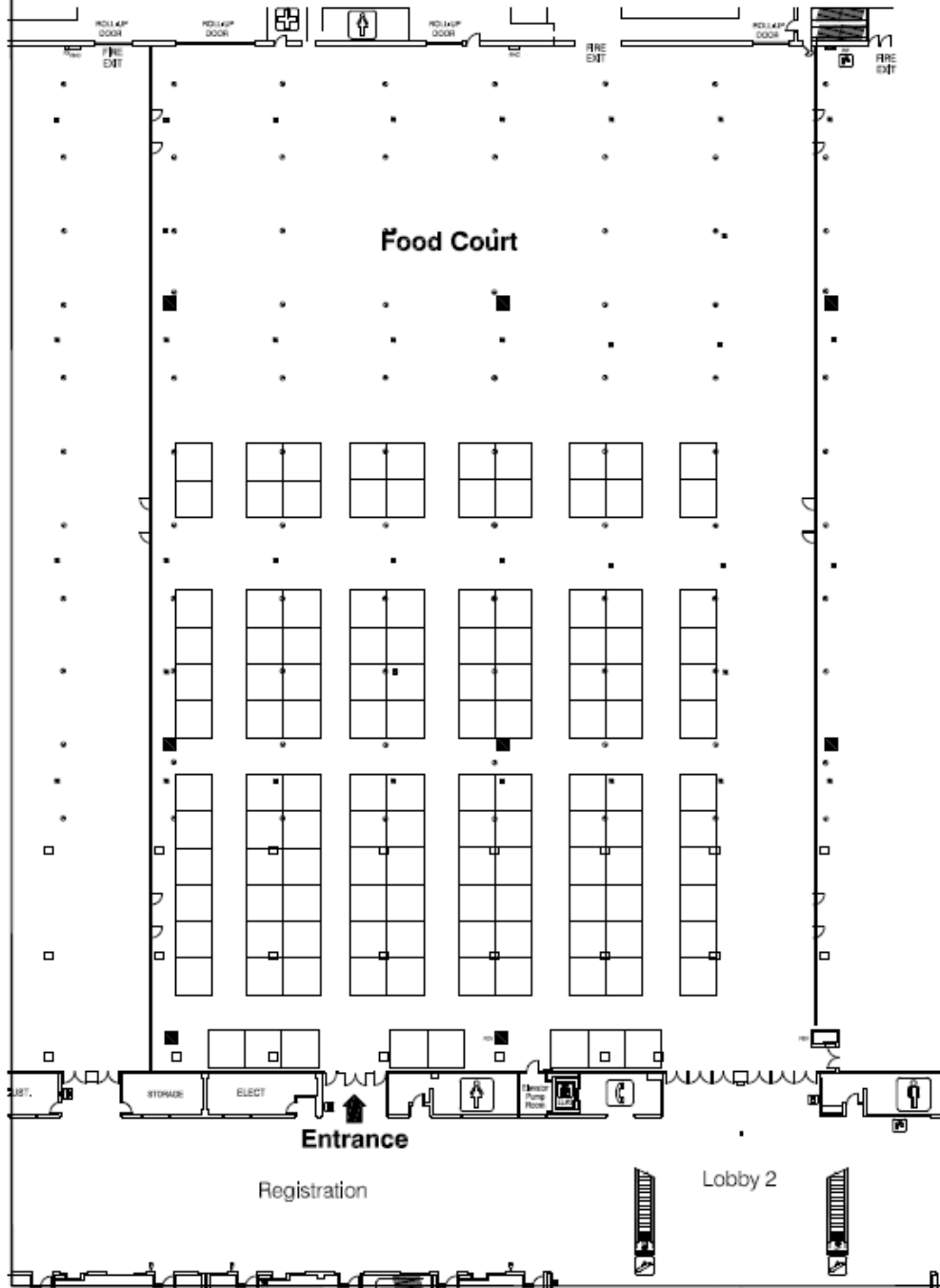

REVISION DATE:
8/16/2011 ****

BOOTH COUNT

128-10x10's

BLDG. LEGEND:

FREEMAN

DRAWING STARTED:
8/16/2011

FILE PATH:
N:\2012\RP\Repub\lean Party of
Texas\Republican Party Tx
0812.dwg
DRAWING NAME:
REPUBLICAN PARTY TX 0812
HALL NAME:

JOB NUMBER:

ACCT. EXEC.:

NOT TO SCALE

DISCLAIMER
EVERY EFFORT HAS BEEN MADE TO
ENSURE THE ACCURACY OF ALL
INFORMATION CONTAINED ON THIS
FLOORPLAN, HOWEVER NO WARRANTIES,
EXPRESS OR IMPLIED ARE
MADE WITH RESPECT TO THIS FLOORPLAN.
IF THE LOCATION OF BUILDING COLUMNS,
UTILITIES OR OTHER ARCHITECTURAL
COMPONENTS OF THE FACILITY IS
A CONSIDERATION IN THE CONSTRUCTION
OR USAGE OF AN EXHIBIT, IT IS THE SOLE
RESPONSIBILITY OF THE EXHIBITOR TO
PHYSICALLY INSPECT THE FACILITY TO
VERIFY ALL DIMENSIONS AND LOCATIONS.
COPYRIGHT 2007, FREEMAN CO.
ALL RIGHTS RESERVED.



Republican Party of Texas 2012 Convention

EXHIBIT/PROGRAM POLICY FOR RPT STATE CONVENTION

Purpose

At each Republican Party of Texas (RPT) Convention, the Party may offer space for advertisements in the official Convention Program and may provide exhibit space adjacent to meeting facilities for candidates, organizations, businesses, and vendors to offer attendees information and merchandise. The purpose being to 1) raise money to defray the cost of the convention, 2) provide convention attendees the opportunity to gather information about Republican candidates and issues, including those considered non-partisan, that promote the Republican philosophy, and 3) provide attendees the opportunity to purchase political, patriotic, and other merchandise.

Procedure/Policies

Space for exhibition and advertisement will be primarily by invitation and will be granted at the sole discretion of the RPT. The preferred method of communication will be by electronic means (email) except for those instances where paper copies are preferable or mandatory. Securing exhibit or advertising space is accomplished by completing the RPT registration form and forwarding it along with payment, a signed copy of the Exhibitor Agreement, and other pertinent documents requested in the invitation. All submissions will be reviewed and recommended by the Exhibit Committee to the RPT Officials Committee. Acceptance or denial will be based on availability, completion of packet, adherence to policy, RPT By-laws, and RPT Rules or principles.

Should an individual, group or entity who did not receive an invitation desire one, they may contact the Exhibit Coordinator or the RPT state headquarters to make a request that one be sent.

Offensive, sexually oriented, racially biased, or suggestive material is not permitted. In addition, no protesting or demonstrating will be allowed in the exhibit area.

Individuals, groups or entities that intend to distribute literature or other information that is contrary to RPT principles may be denied space at the discretion of the RPT.

Exhibitors are required follow rules of the Convention Center and the exhibit hall.

The Officials Committee of the RPT will have the final authority to approve or disapprove all requests for exhibit space, advertisement space and distribution of literature. The Officials Committee may, at its own discretion, refer matters to the full SREC for a vote giving that body the final authority for the decision. When time is of the essence, email or telephone approvals may occur.



Republican Party of Texas 2012 Convention

Exhibitor Agreement

NO LIABILITY

The exhibitor agrees that neither the Republican Party of Texas, nor the management of the convention facilities, or any individual connected with either of these groups is responsible for the safety of the property of exhibits from theft, fire, accident or other causes. The Republican Party of Texas will hire independent security personnel for the exhibits from 7:00 a.m., Wednesday, June 6, 2012 to 9:00 p.m., Saturday, June 9, 2012. However, the Republican Party of Texas assumes no responsibility and hereby provides notice that no security will be provided for goods or material delivered to the exhibit area before setup day, or for goods or material left at the exhibit area after closing.

LABOR

Personnel will be available to assist setting up and dismantling your display. Labor charges will be at the prevailing rate. The workday is from 8:00 a.m. to 4:30 p.m., Monday through Friday. All other time is calculated at the overtime rate. All labor is charged in one-hour increments. Texas is a right-to-work state which means that exhibitors, and their full time employees, may install and dismantle their own exhibits using their own equipment. Please refer to the *Exhibitor Kit* for specific details.

USE OF SPACE

All exhibitor activities must be confined to the limits of the exhibit booth. No exhibitor shall share or sub-lease its allocated space without the knowledge and consent of the Republican Party of Texas. All exhibits must conform to the description in your application, and any changes or revisions to your stated exhibit description must conform to the guidelines and policies of the Republican Party of Texas. Displays shall not be placed in such a manner as to interfere with other exhibitors or the flow of traffic in the exhibit hall. Anything displayed above the top of the backdrop must be approved by the Republican Party of Texas. Exhibitors renting back-to-back spaces are cautioned not to use draping or other types of displays that will block the view of the booths on either side. Floor lights or spotlights may be installed. Headphones, rather than speakers, must be utilized for sound equipment and noise levels should not be disruptive to other exhibitors.

FIRE PROTECTION

Table decorations must be fireproof. Electrical wiring must conform to National Electric Code Safety Rules. Exhibits must not obstruct exits, fire stations, and fire extinguisher equipment. Exhibits must conform to the ordinances and regulations contained in the City of Fort Worth Fire Code. This includes but not limited to the following:

1. Decorative and construction materials must be noncombustible or flameproof.
2. All exit doors and aisles serving any occupied area of the building must remain unobstructed.
3. All curtains, drapes, or decorations, must be noncombustible or flameproof.
4. Any merchandise or material attached to drapes or table skirts must be noncombustible or flameproof.
5. The following materials may not be used without approval of the fire marshal:
 - a. display or storage of Liquefied Petroleum Gas (propane)
 - b. flammable liquid
 - c. flammable gas
 - d. straw, sawdust, or shavings
 - e. lit candles, or lanterns

Failure to comply with these regulations is sufficient cause for the Republican Party of Texas' Exhibits Chairman to cancel all or such part of the exhibit as may be appropriate. Exhibitors may be asked to vacate the premises without refund.

CIRCULATION AND SOLICITATION

Distribution of circulars and promotional materials approved by the Republican Party of Texas in its sole discretion are permitted only within the space assigned to the exhibitor. No firm, organization, other entity, or individual not assigned space in the exhibit area is permitted to solicit business within the exhibit area.

OPERATIONS SUBJECT TO PARTY RULES

Exhibitors are subject to all the policies, rules and regulations set forth in the exhibitor agreement as well as rules, regulations, and policies of the Republican Party of Texas. The Republican Party of Texas reserves the right to restrict or refuse exhibits which, because of rude or loud noise, method of operation, material, content, or any other reason are, or become, objectionable to the Republican Party of Texas, as the Republican Party of Texas determines within its sole discretion. No literature may be distributed outside the exhibit area without prior approval. Notwithstanding anything to the contrary, if an exhibitor breaches any provision of the rules and regulations at any time prior to or during the convention, the Republican Party of Texas, at its option, may require the exhibitor to peacefully pack its exhibit and leave the convention facilities immediately. In the event of any restriction, refusal or eviction, the Republican Party of Texas is not liable for any refunds of any rental expenditure or other exhibitor expenses.

CARE OF FACILITY

Nothing shall be pasted, tacked, nailed, screwed, or otherwise attached to columns, walls, floors or other parts of the convention center, its contents or furniture.

RPT INVITATION TO MAKE OFFER

An invitation to complete an exhibitor application package will not be considered an offer by the Republican Party of Texas to provide the invitee with advertisement or exhibition space. Rather, an invitation will constitute an opportunity for the invitee to make an offer by completing the exhibitor application package and returning it with the required documentation and payment to the Republican Party of Texas. Each submission will be reviewed and either accepted or rejected based on space availability, suitability, as set forth in all rules, regulations, and policies of the Republican Party of Texas.

NO ASSIGNMENT

The exhibitor agreement must not be assigned, in whole or part, without the prior written consent of the Republican Party of Texas.

COMPLIANCE WITH LAW

Exhibitors shall comply with all applicable statutes, laws, ordinances, codes, orders, rules, regulations, proclamations and other governmental requirements. Exhibitors will assume responsibility for the payment of all federal, state and local taxes, licenses, fees and/or duties for its business, including, but not limited to sales and use taxes or any other taxes, fees and licenses that may arise from the exhibitor agreement.

WAIVER

No waiver is effective unless made in writing and signed by an authorized representative of the Republican Party of Texas. Said waiver is limited only to the circumstances described in same and does not constitute a waiver of any other provision of the agreement between the exhibitor and the Republican Party of Texas.

FORCE MAJEURE

The Republican Party of Texas will not be liable for failure or delay in performance due to an act of God, strike, lockout or other labor dispute, civil commotion, sabotage, fire, flood, explosion, acts of any government, and any other causes or events which are not within the Republican Party of Texas' reasonable control, whether or not specifically enumerated herein.

GENERAL PROVISIONS

This Agreement shall be governed by, construed, and enforced in accordance with and subject to the internal laws of the State of Texas, without regard to its conflicts of law principles, and venue for any dispute arising out of or concerning this Agreement shall be proper only in Travis or Williamson County, Texas. For purposes of the agreement, including without limitation, these rules and regulations, unless the context otherwise requires, the headings of the paragraphs and exhibits are inserted for convenience only and shall not be used in the interpretation of the exhibitor agreement. In the event that any provision of the agreement is held illegal or otherwise unenforceable, that provision will be severed and the balance of the agreement will continue in full force and effect if commercially reasonable.

REFUNDS

The application cut-off-date for the purposes of exhibit space refunds will be March 31, 2012. Any refund requests subsequent to that date should be made in writing to the RPT. Decisions on approval or denial will be at the sole discretion of the RPT.

ENTIRETY

If the Republican Party of Texas accepts the exhibitor's offer to purchase space and confirms such acceptance in writing, the exhibitor registration form and agreement submitted by the exhibitor and all attachments, including without limitation these rules and regulations, the request and exhibitor description, the hold harmless agreement and the exhibitor guidelines, will constitute the agreement between the parties. Further, such agreement is intended to be the final, complete and exclusive embodiment of the agreement about the matters covered, and no prior stipulation, agreement or understanding of the parties, their employees or agents is valid or enforceable. The agreement may not be altered, amended or changed in any way except by a written instrument executed by both parties.

I have read the all information, rules and policies contained in the Republican Party of Texas 2012 Convention Exhibitor Packet. I understand the aforementioned Rules and Regulations and agree to comply with their provisions:

Signature

Date

Printed Name

Title

Organization

Address

City, State **Zip Code**

Contributions to the Republican Party of Texas are not deductible for federal income tax purposes

Personal and PAC checks are welcome. Corporate contributions are also acceptable and will be used for administrative expenses as outlined and in compliance with state and federal election law. By law, political committees are required to use their best efforts to obtain and report the name, address, occupation, and employer for each individual whose contributions aggregate in excess of \$200 per calendar year. Contributions up to \$10,000 from individuals and up to \$5,000 from federal PACs will be deposited into the Party's federal account. All other donations will be deposited into the Party's state or corporate account, as appropriate. Contributions from foreign nationals and federal contractors are prohibited by law.

Paid for by the Republican Party of Texas. www.texasgop.org



Republican Party of Texas 2012 Convention

Hold Harmless Agreement

In consideration of the Republican Party of Texas waiving its requirement that I/we obtain sufficient insurance to cover my/our operation of an exhibit space at the Republican Party of Texas Convention 2012,

I/we the undersigned, do hereby agree to hold the Republican Party of Texas, its officers and staff members and its affiliates and representatives harmless from any responsibility of injury, loss, theft or bodily harm due to my/our exhibitor booth or any of its contents prior to, during or following the conduct of the exhibits area in the Fort Worth Convention Center.

Finally, in lieu of providing an insurance certificate to the Republican Party of Texas and its representatives, I/we release the Republican Party of Texas and its representatives from any responsibility for any claims, damages, loss, theft, injury or bodily harm during my/our move-in and move-out of my/our exhibit booth.

I/we understand that booth selection will be determined by suitability, availability and on a first-come, first-served basis.

Signature

Date

Print

Title

Company



Republican Party of Texas 2012 Convention

Badge Request Form

Dear Exhibitor:

Each exhibitor may have up to three (3) persons receive registration badges per 10'X10' booth space purchased. Each additional person connected with the exhibiting company or organization wishing to attend the convention may purchase a badge for an additional \$25.00. Please attach payment if ordering over 3 badges per booth.

Each person must show government issued ID when the badge is picked up at the Convention.

Badges must be displayed and a valid government issued ID must be shown to gain access to the exhibit area.

Name of Company or Organization (as you want it to appear on the badge):

Name(s) on Badges (please type or print)



Republican Party of Texas 2012 Convention

EXHIBITOR CHECKLIST

Please ensure that you are returning the following information:

- Exhibitor Registration Form (one page)
- Signed copy of Exhibitor Agreement (three pages)
- Signed copy of the Hold Harmless Agreement (one page)
- Badge Request Form (one page)

Please Return Information to:

Rena Peden, Exhibit Coordinator
204 Covered Bridge Drive
Fort Worth, Texas 76108
rena.peden@sbcglobal.net

Please return check or credit card information for payment in full to:

Please Return Payment to:

Republican Party of Texas
1108 Lavaca Street Suite 500
Austin, Texas 78701

Method of Payment

- Check enclosed payable to "Republican Party of Texas"
- Amex Discover MC Visa

Card #	Expiration Date	\$ Amount
Cardholder's Name	Cardholder's Signature	
Cardholder's Employer	Occupation	

Is this a personal credit card? Yes No

Card billing address _____

May FAX card information to 512-480-0709

Contributions to the Republican Party of Texas are not deductible for federal income tax purposes

Personal and PAC checks are welcome. Corporate contributions are also acceptable and will be used for administrative expenses as outlined and in compliance with state and federal election law. By law, political committees are required to use their best efforts to obtain and report the name, address, occupation, and employer for each individual whose contributions aggregate in excess of \$200 per calendar year. Contributions up to \$10,000 from individuals and up to \$5,000 from federal PACs will be deposited into the Party's federal account. All other donations will be deposited into the Party's state or corporate account, as appropriate. Contributions from foreign nationals and federal contractors are prohibited by law.

Paid for by the Republican Party of Texas. www.texasgop.org



Republican Party of Texas 2012 Convention

Program Advertisement Reservation

Date Submitted: _____
 Contact: _____ Company/Organization: _____
 Address: _____ City/State/Zip: _____
 Phone: _____ Fax: _____ Email: _____

ALL ADS SUBJECT TO APPROVAL BY THE OFFICIALS COMMITTEE OF THE REPUBLICAN PARTY OF TEXAS.

Ad Size	Image Size (w x h)	Price	Check
Full Page	8" x 10" (w/bleed: 8.75" x 11.25")	\$2000	<input type="checkbox"/>
Half Page	5" x 7.5"	\$1000	<input type="checkbox"/>
Quarter Page	2.5" x 3.75"	\$750	<input type="checkbox"/>

Total Due: \$ _____

Method of Payment

- Check enclosed payable to "Republican Party of Texas"
 Amex Discover MC Visa

Card # _____ Expiration Date _____

Cardholder's Name _____ Cardholder's Signature _____

Cardholder's Employer _____ Occupation _____

Is this a personal credit card? Yes No

Advertisement Requirements:

4-color ads may be provided as camera-ready art in TIF, EPS, PDF format, CMYK, 300 dpi minimum, with all text converted to out-lines. Ads may be submitted by email (AngieLKing@gmail.com) or supplied on CD. (Disc must be clearly labeled with name of office-holder, candidate or organization, contact name, phone number and e-mail address of graphic artist, and a laser proof.) All other prices based on camera-ready art or film. Without camera-ready art, there will be an additional 25% production fee that includes scanning photographs for input into your ad (photos will not be returned). All fees must be received with advertisement copy prior to deadline for ad to be included in program. Rates are not commissionable. Ad size requests will be granted based upon availability. No press proof will be made available; electronic proof available upon request.

For Program Ad questions,
call Angie King: 940-368-0672

Program Ads must be
received by April 16, 2012.

Return to:
Republican Party of Texas
ATTN: Program Ads

- Email to: AngieLKing@gmail.com
- Fax to: 512.480.0709
- Mail with check:
1108 Lavaca St., Suite 500
Austin, TX 78701

Contributions to the Republican Party of Texas are not deductible for federal income tax purposes

Personal and PAC checks are welcome. Corporate contributions are also acceptable and will be used for administrative expenses as outlined and in compliance with state and federal election law. By law, political committees are required to use their best efforts to obtain and report the name, address, occupation, and employer for each individual whose contributions aggregate in excess of \$200 per calendar year. Contributions up to \$10,000 from individuals and up to \$5,000 from federal PACs will be deposited into the Party's federal account. All other donations will be deposited into the Party's state or corporate account, as appropriate. Contributions from foreign nationals and federal contractors are prohibited by law.

Paid for by the Republican Party of Texas. www.texasgop.org



Republican Party of Texas 2012 Convention

Tentative Schedule for 2012 Republican State Convention June 7, 8, and 9			
	Thursday	Friday	Saturday
8:00		2nd SD CAUCUS State Chairman Election State Vice-Chair Election	2nd CD CAUCUS Natl Committeeman Election Natl Committeewoman Election
8:30	CAUCUS TRAINING SESSION 2 Note: Session 1 part of SREC Mtg. Wednesday - 4:00 PM	SREC Committeeman Election SREC Committeewoman Election State Nominations Rep. Election Note: State Nominations meets at 10:00 AM	Natl Delegate Elections (3) Natl Alternate Elections (3) Presidential Elector Election
10:00	1st GENERAL SESSION	2nd GENERAL SESSION	
12:00	LUNCH BREAK Special Lunch Event for Grassroots Club members in Convention Center	LUNCH BREAK TFRW Luncheon - two hours Noon to 2 pm	LUNCH BREAK
1:00		BREAKOUT SESSION Parliamentary Procedures optional	4th GENERAL SESSION
2:00	1st SD CAUCUS Permanent SD Chair Election Temp. Committee Reports Perm. Cmte. Member Elections	3rd GENERAL SESSION Permanent Credentials Report Permanent Organization Report Permanent Rules Report Permanent Platform Report State Nominations Report Floor votes (if necessary)	
3:00	BREAKOUT SESSION optional sessions on a host of topics with dynamic speakers each session lasting 30 minutes		
4:30		1st CD CAUCUS Permanent CD Chair Election Natl Nomination Rep Election	
6:00 on	RPT "Salute to Veterans" Watergardens - Conv. Ctr. Non-RPT Banquets & Functions	National Nominations Cmte. RPT Banquet @ 6:30 PM	AFTER CONVENTION SREC - at adjournment National Delegates/Alternates 30 min. after SREC start

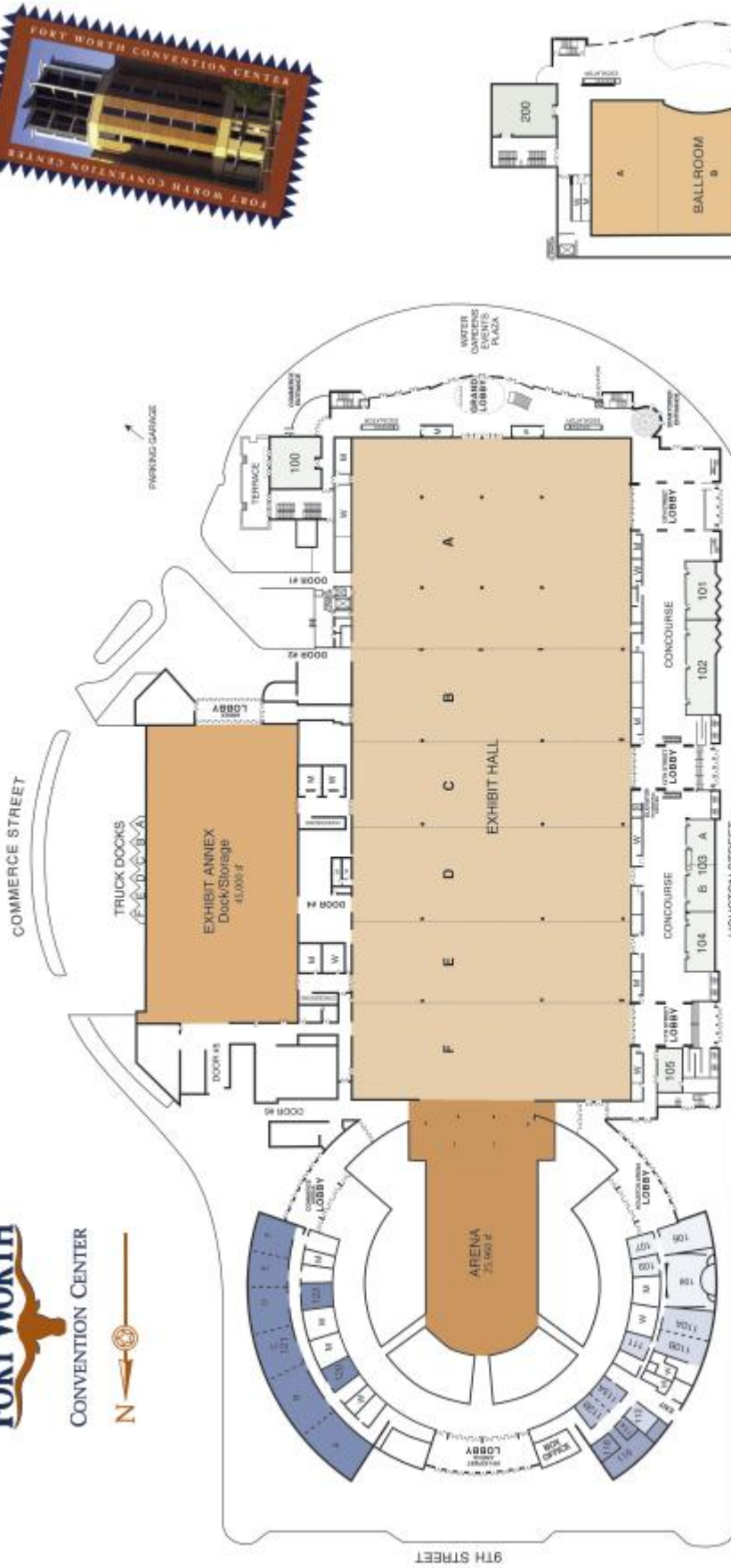

First Level/Ground



Second Level



- 253,226 SQUARE FEET MAXIMUM EXHIBIT SPACE
- 41 BREAKOUT ROOMS FOR MAXIMUM FLEXIBILITY
- 28,160-SQUARE-FOOT BALLROOM
- EXPANDED DOCK FACILITIES
- 13,500-SEAT ARENA