

# Navigator 3000

---

## User's Manual

### Congratulations

We would like to thank you for choosing a watch from Tissot®, one of the most highly renowned Swiss brands in the world.

Your Navigator watch forms part of the Tissot® touch screen range and benefits from the most recent technical innovations, including the famous touch screen technology. Via the touch screen, you can select from the various functions available, namely the local time and the time in four other time zones (150 countries and cities stored in memory), 2 alarms, calendar (automatic\* summer/winter switchover and perpetual calendar up to 2099), chronograph and timer.

The dual display, analog and digital, informs the user simply and logically concerning the function selected.

Modern, at once sporty and elegant, and featuring useful functions, the Navigator 3000 watch will satisfy all men of action who are frequent travelers.

**Important:** Your Navigator watch is water-resistant to 5 bar (50 m / 165 ft). However, no function can be activated if the crystal is in contact with a liquid.

\* According to the data valid in the country when the watch was programmed





Official service  
centers addresses  
[www.tissot.ch](http://www.tissot.ch)



# WARNING

## Customer Service Center

**TISSOT TACTILE  
WATCHES MUST  
ONLY BE SERVICED BY  
TISSOT'S AUTHORIZED  
CUSTOMER SERVICE  
CENTERS, WHICH ARE  
LOCATED IN  
OVER 160 COUNTRIES**

Recommended  
service prices  
[support.tissot.ch](http://support.tissot.ch)





## Basic principles

### Crown



A press for about one second on the crown activates the touch screen, and can confirm a setting (Enter) and start/stop the chronograph function and the timer function.

Each setting is confirmed by a short press (< 1 s) on the crown.

### Tactile functions

The touch screen is active only after the crown has been pressed for about one second (activation is confirmed by a beep). It remains active for 10 seconds after the last operation. Once the touch screen has been activated, a mere touch of the finger on one of the six tactile zones of the screen activates the corresponding function, namely:

- 1 the local time function;
- 2 the time function in four other time zones;
- 3 the timer /  $\oplus$  incrementing function;
- 4 the chronograph /  $\ominus$  decrementing function;
- 5 the alarm function;
- 6 the calendar function.

- Once one of these functions has been selected, the display modes can be changed in succession by touching the same zone again.
- The  symbol indicates that you have to press the crown to enter the function displayed.
- When the digital display indicates **SET** , a setting can be made.
- When the digital display flashes, it is possible either to make a correction with **3** ( $\oplus$ ) or **4** ( $\ominus$ ), or to confirm the setting by pressing the crown (short press < 1 s).  
If no operation is performed during 10 seconds, the last setting is not validated and the touch screen is deactivated.
- After validating a setting, the watch returns automatically to the time mode and the digital display indicates the last setting made.
- When the crown is pressed, the watch emits a high-pitched beep for confirmation, while a low-pitched beep indicates an inappropriate action\*.

\* You can remove the confirmation sound from your watch; please refer to the time function in "TONE ON" mode.

### Tactile zones

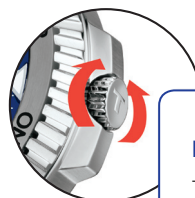

### Lighting Activation/Adjustment

To activate lighting of the digital display, turn the crown to the left or right. Once the lighting has been activated, turn the crown to the right to increase the intensity, or to the left to reduce it.

The lighting remains active for 10 seconds after the last operation.

## Local time mode



At delivery, the hands on your watch indicate the local time. The digital display indicates either the local time, or the region of the local time.

If for whatsoever reason you wish to change the local time, you can select a new time zone according to the procedure indicated below.

You can also select the display language (French, English, German, Spanish, Italian and Portuguese), activate the audible alarm or not, and go into "battery saving" mode.

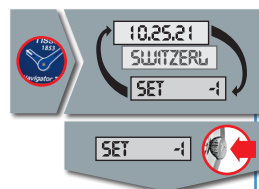

Touch the screen several times to select one of the display modes or to navigate through to the "SET" function.

To access the settings, select the "SET" function and press the crown.



Touch the screen several times until you reach the setting you wish to change, then press the crown to confirm your choice.

SET T1 -1

### Local time setting

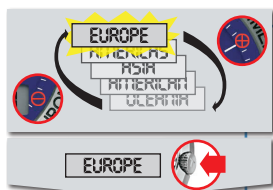

Select a continent. Use the tactile zone  $\oplus$  or  $\ominus$  to scroll the continents.

Confirm by pressing the crown.

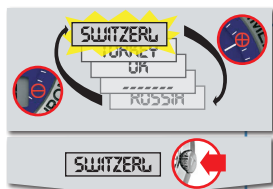

Select a country. Use the tactile zone  $\oplus$  or  $\ominus$  to scroll the countries.

Confirm by pressing the crown.

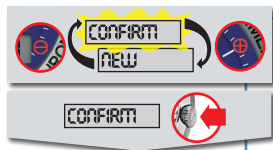

Confirm your choice by means of tactile zone  $\oplus$  or  $\ominus$ .

Confirm by pressing the crown.

NEW

### Add the name of a city See Expert mode

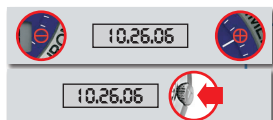

If necessary perform setting of the hours and minutes by means of tactile zone  $\oplus$  or  $\ominus$ .

Confirm each setting by pressing the crown.

**Note :** Setting the second pulse

- from 0 to 30 sec., the display is rounded off to the next lower minute;
- from 31 to 59 sec., the display is rounded off to the next higher minute.

ENGLISH -1

### Selecting a language

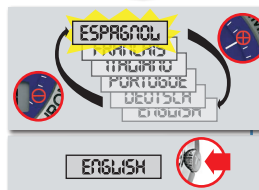

You can select one of the six available languages: French, German, English, Spanish, Italian or Portuguese. Use the tactile zone  $\oplus$  or  $\ominus$  to scroll the languages.

Confirm your choice by pressing the crown.

TONE ON -1

### Deactivating the sound (except for the alarm bell)

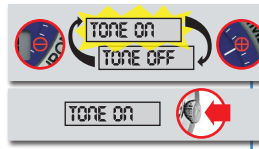

Select the "sound activated" or "sound deactivated" mode by means of tactile zone  $\oplus$  or  $\ominus$ .

Confirm by pressing the crown.

ECO BAT -1

### Energy saving

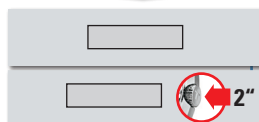

If you plan not to use your watch for a long period of time, you can select the "ECO BAT" mode to economize the battery. The watch goes into sleep mode, the LCD screen goes out, and the hands indicate 6.30 am. To reactivate the watch, press the crown for 2".

ECO BAT -1

### Synchronization of digital time / analog time See Expert mode.

EXIT -1

### Exit setting mode.

## Expert mode

### Add the name of a city

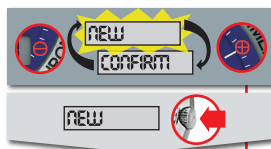

To add the name of a city, select the "NEW" function by means of tactile zone  $\oplus$  or  $\ominus$ .  
Confirm by pressing the crown.



One after the other, select the letters of the name to be created by means of tactile zone  $\oplus$  or  $\ominus$  (8 letters at most).  
Confirm each letter by pressing the crown.  
After the final confirmation, you can set the time if necessary (see above).

### Synchronization of digital time / analog time

If you detect a difference between the time displayed by the hands and the digital display, you can reset the hands:

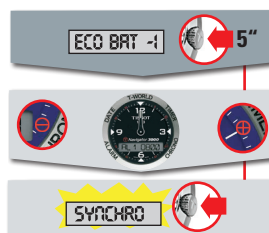

When the "ECO BAT" function is displayed, press the crown for 5", and the hands should be positioned on midday. Otherwise, they should then be positioned as indicated below.

Press tactile zone  $\oplus$  to move the minute hand forward;  
Press tactile zone  $\ominus$  to move the hour hand forward.

Confirm by pressing the crown.

## Time zone mode



Through its T-World function, your watch can display the time in four other time zones, parameterizable. The standard settings give the local time in New York, Rio de Janeiro, Thailand and Sydney, but they can be changed by selecting one of the 150 other pre-memorized zones.

You can also select the reference time with the SWAP function, display the absolute time or the time difference with the ABS function, and even, in Expert mode, alter the date for changing summer time and winter time (DST or daylight saving time function).

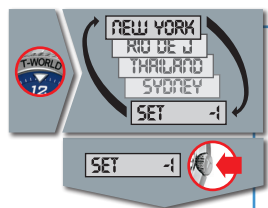

Touch the screen to select the desired region or to navigate through to the "SET" function.

To access the settings, select the "SET" function and then press the crown.



Absolute time  
(GMT)

or



Time difference

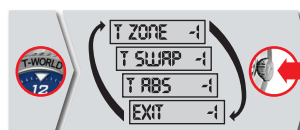

Touch the screen several times until you reach the setting you wish to change, then press the crown to confirm your choice.

### Selecting another time zone

By means of tactile zone or , select from the four pre-memorized time zones the one you want to change.

Confirm your choice by pressing the crown.

First select a destination continent. Use the tactile zone or to scroll the continents.

Confirm your choice by pressing the crown.

Then select a country. Use the tactile zone or to scroll the countries.

Confirm your choice by pressing the crown.

Then select a city (if it is available). Use the tactile zone or to scroll the cities.

Confirm your choice by pressing the crown; you then exit setting mode.

### DST setting (daylight saving time)

See Expert mode

### Change of reference time

By means of tactile zone or , select from the four pre-memorized time zones the one you want to use as reference time.

Confirm your choice by pressing the crown. This time becomes the reference time.

**Warning!**

The "SWAP" function changes the local time with the time of one of your time zones. As a result, your local time is now in the "T-WORLD" function and the time of your time zone can be found in the "TIME" function.

The alarms are synchronized with the analog display.

### Changing the time display

#### Absolute time - Time difference

Select "T ABS" to display the absolute time or "T DIF" to display the time difference.

Confirm your choice by pressing the crown.

### Exit setting mode.

## Expert mode

### DST setting (daylight saving time)

From the "T ZONE" function, press the crown for 5" to access the "DST" function.

Confirm to access the settings.

By means of tactile zone or , select from the four time zones the one you want to change.

Confirm to access the settings.

**Note:** If you remove the country/city from the "T-world" function, manual setting of the daylight saving time will also be eliminated.

By means of tactile zone or , select the "DST ON" function to change the date, or "DST OFF" to eliminate the daylight saving time change.

Confirm to access the settings.

Select the day and month of the start of daylight saving time for the current year by means of tactile zone or .

Press the crown to confirm the setting.

Select the day and month of the end of daylight saving time for the current year by means of tactile zone or .

Press the crown to confirm the setting.

## Alarm mode



Your watch has two different day alarms, which can be set separately over 24 hours and/or over 7 days (see Expert mode).  
At the programmed time, an audible alarm is triggered.  
To stop the alarm, press the crown briefly.

**Note:** 5 tunes are available to choose from.

RL1 21:30      RL1  
Alarm activated      Alarm not activated

Touch the screen to select alarm 1 or 2 or to navigate through to the "SET" function.

To access alarm setting, select the "SET" function and confirm by pressing the crown.

Touch the screen several times to access the alarm you wish to change, then press the crown to confirm your choice.

### Setting the selected alarm

Activate the alarm by means of the tactile zone ⊕ or ⊖.

Confirm by pressing the crown.  
(by deactivating the "AL1 OFF" alarm, you exit setting mode).

### Setting the alarm over 7 days

See Expert mode.

Select a tune by means of the tactile zone ⊕ or ⊖.  
(the tune sounds after 2").

Confirm by pressing the crown.

Set the hour and minutes by means of the tactile zone ⊕ or ⊖.

Confirm each setting by pressing the crown.

### Exit setting mode.

## Expert mode

Alarm activated over 7 days

### Setting the alarm over 7 days

You can set an alarm so that it sounds on different days of the week at a fixed time.

When an alarm is activated, press the crown for 5" to access weekly setting of this alarm.

All the days of the week are activated by default.  
Deselect the days that you don't wish to activate by means of the tactile zone ⊕ or ⊖.  
Confirm the day and go to the following day by pressing the crown.

**Comments:** Day 1 corresponds to Monday, day 2 to Tuesday, and so on...  
By combining your two alarms and the setting for the days, you can very easily create one alarm for the week and another for the weekend.

## Chrono mode



Your watch has a chronograph function.

When the period timed is less than 1 hour, the minutes, seconds and hundredths of seconds are displayed.

When the period timed is greater than 1 hour, the hours, minutes and seconds are displayed.

Touch the chronograph function on the screen.

Press the crown to activate the chronograph.

Press the crown to stop the chronograph.

Press the crown for at least 2" to reset the chronograph.



## Mode date

Your watch has a calendar function available on the digital display, with 3 modes:

- day/date
- second/date
- week number.

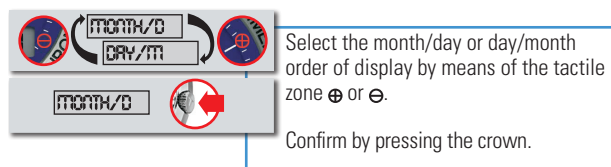
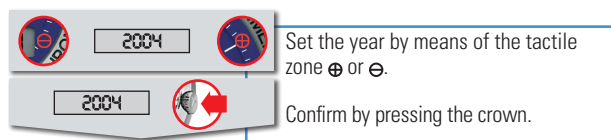
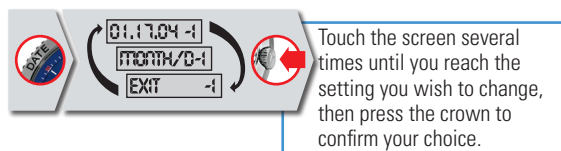
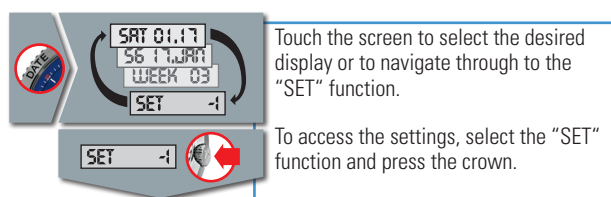

**Note:** Your watch being set in factory, there is no need to correct the date

**Reminder:** It is possible to change the language (see Time function).

## Timer mode

Your watch has a timer function. Once the programmed period of time has elapsed, an audible alarm is triggered.

To stop the alarm, press the crown briefly.

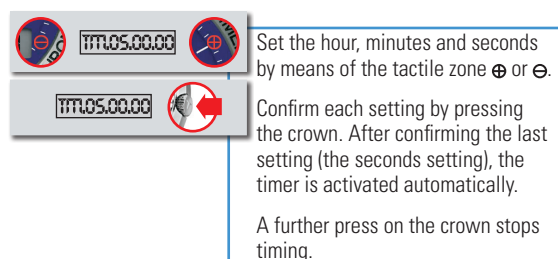
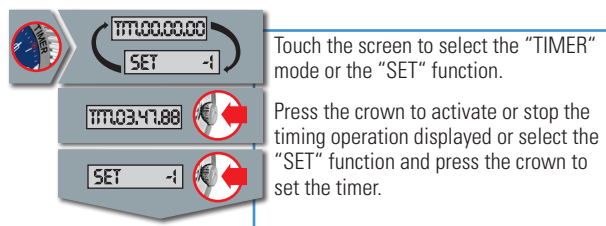

**Note:** The last time set remains displayed by default 5 seconds before the timing ends, and a beep sounds for each remaining second.

## Care and maintenance

We would advise you to clean your watch regularly (except for the leather strap) using a soft cloth and warm soapy water. After immersion in salty water, rinse it in fresh water and leave it to dry completely. Do not leave it anywhere where it might be subjected to major variations in temperature or humidity, in direct sunlight or near strong magnetic fields.

To benefit from the highest standards of service and to ensure your guarantee remains in force, please always contact an approved TISSOT® representative or retailer.

TISSOT® Quartz watches benefit from the incomparable precision of quartz. Their power reserve usually enables them to operate for more than 2 years in continuous use. If you ever plan not to be wearing your watch for a period of several weeks, or even several months, we would advise you to activate the "economy" mode before putting your watch away. This reduces the electrical power supply to the motors, thereby extending battery life considerably.

### Replacing the battery

Once the battery has run flat, it must be replaced without delay by an approved TISSOT® representative or retailer. Battery type: button-type lithium-manganese dioxide primary battery cell, ref. Renata CR 2025

**Note:** Battery end of life is indicated to you by continuous flashing of the digital display.

### Collection and treatment of end of life quartz watches\*

 This symbol indicates that this product should not be disposed with household waste. It has to be returned to a local authorized collection system. By following this procedure you will contribute to the protection of the environment and human health. The recycling of the materials will help to conserve natural resources.

\* valid in the EU member states and in any countries with corresponding legislation.