

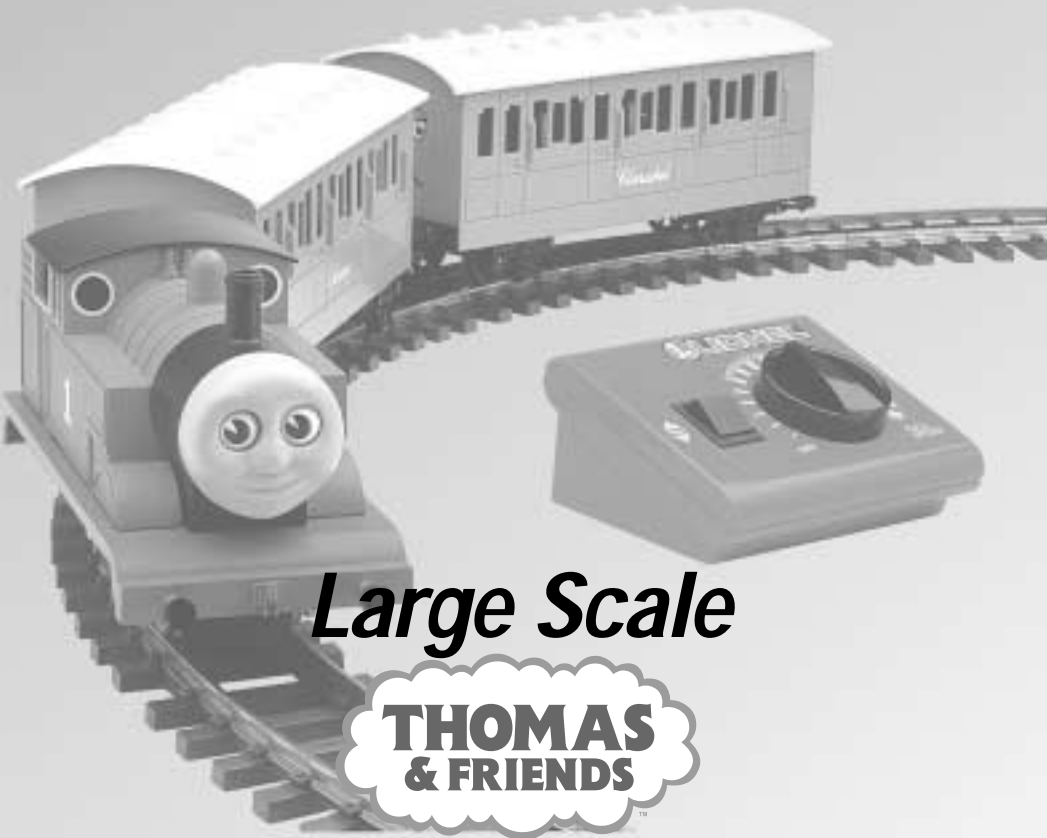

78-1011-250
9/02



Large Scale

**THOMAS
& FRIENDS**

Owner's Manual

CAUTION-ELECTRIC TOY

NOT RECOMMENDED FOR CHILDREN UNDER EIGHT YEARS OF AGE. AS WITH ALL ELECTRIC PRODUCTS, PRECAUTIONS SHOULD BE OBSERVED DURING HANDLING AND USE TO REDUCE THE RISK OF ELECTRIC SHOCK.

TRANSFORMER RATINGS - INPUT: 120 VAC 60 HZ 28W
DC OUTPUT: 6-16V; 19.2 VA TOTAL.

 **GULLANE**

Introduction

Congratulations on your purchase of the Large Scale Thomas & Friends Train Set! Before you assemble your train set for operation, this instruction book should be read by everyone who will be operating it. You will learn important information on train set operation and the proper use of your set in order to avoid damage. If you have any remaining questions about your train set or accessories, contact your authorized Lionel Service Center using the listing included in a separate flyer in your train set box. After you have read this booklet, assembled your train, and plugged in the trans-

former, you will be ready to enjoy many hours of railroading fun.

As with all LIONEL LARGE SCALE engines, this set was designed to run on Lionel Large Scale Track and has an operating voltage range of 6-16 volts D.C. only. **CAUTION: USING A.C. POWER WILL DAMAGE THE MOTOR IN YOUR LOCOMOTIVE.**

Parents should periodically inspect the power pack for potential hazards and have it repaired if necessary. See the Lionel Service Station listing for the address of the nearest authorized Service Station.

Table of contents

Track Layout

Joining the track sections	3
Creating a Large Scale layout	4
Attaching the Lock-On to the track	5
Connecting the Lock-On to the track	6

Controller operations

Understanding short circuits	7
Connecting the power supply	8
Operating the power supply	9

Train operations

Arranging the train on the track	10
Operating the knuckle couplers	10
Installing and operating hook and loop couplers	11
Attaching the 3 Thomas Faces	12
Picking Up Thomas	13
Locomotive Care	14
Troubleshooting	15
Limited Warranty/Lionel Service	16

Visit the Thomas & Friends website at:
www.thomasthetankengine.com

© Gullane (Thomas) Limited 2002

The following Lionel marks may be used throughout this instruction manual and are protected under law. All rights reserved.

Lionel®, *TrainMaster®*, *Odyssey®*, *RailSounds™*, *CrewTalk™*, *TowerCom™*, *DynaChuff™*, *StationSounds™*, *Pullmor®*, *ElectroCoupler™*, *Magne-Traction®*, *CAB-1 Remote Controller®*, *PowerMaster®*, *Lionel ZW®*, *ZW®*, *PowerHouse®*, *TMCC™*, *Lionelville™*

Track layout

Joining the track sections

Join the track sections together by inserting the pins of each track section into the rail openings of another section. Refer to Figure 1. Track joints must be tight for good electrical contact, and the track should fit together firmly.

If the rail openings have become enlarged so that the track fits loosely together, pinch the rail around a track pin with a pair of pli-

ers. If any pins fall out of the track and are missing, replace them immediately. The rails should be kept clean, dry, and free from oil and grease. Clean off tarnish and dirt spots with any commercial metal polishing pad to keep your track in top condition. Wipe the track with a clean soft cloth dampened with track cleaner from the Lionel Maintenance Kit (available separately, 6-62927).

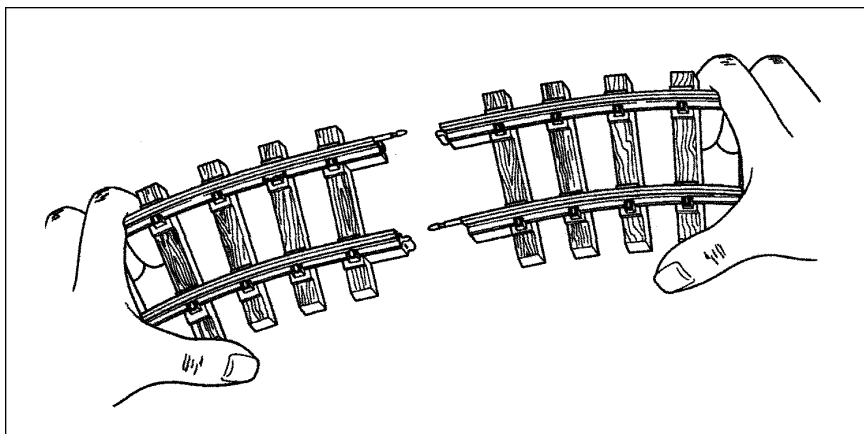

Figure 1. Track assembly

Track layout

Creating a Large-Scale layout

The layout shown in Figure 2 can be assembled using the twelve track sections supplied with this set.

Extra sections of track are available from your authorized Lionel dealer. Add on to your circle to build your own railroad empire!



NOTE: 12 curved track sections = circle layout
Track Diameter 51"

Figure 2. Circle of track

Track layout

Attaching the Lock-On to the track

To attach the Lock-On onto the track, first place the Lock-On under any curved section of the track between the rail ties. Fit the flange of the outside rail into the squared brass contact on the Lock-On. Next, press

the Lock-On upward so the spring contact snaps onto the inner rail. See Figure 3. The Lock-On should now be attached to the track as shown in Figure 5 on page 6.

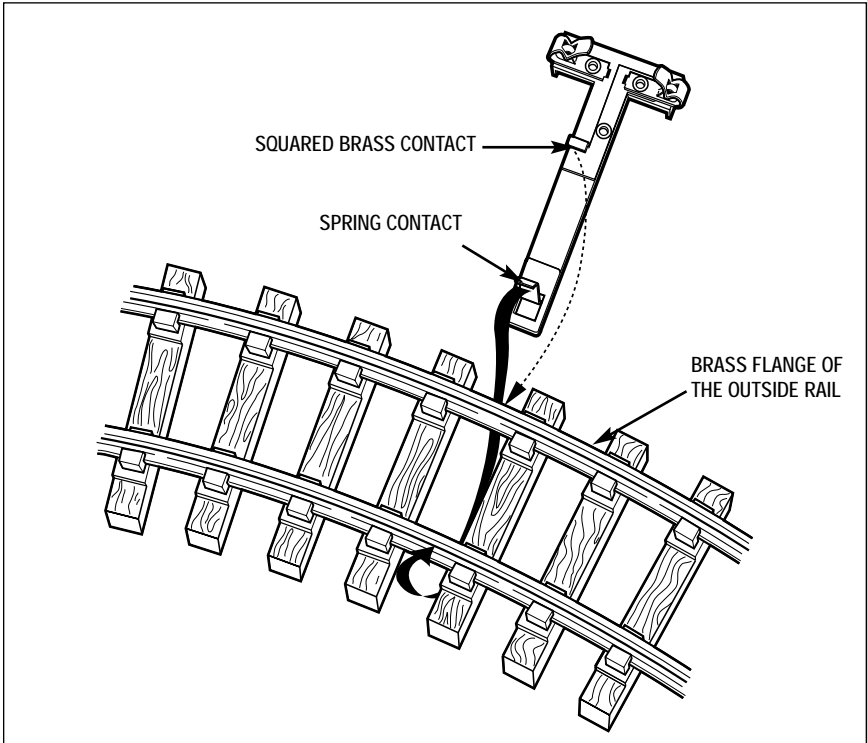

Figure 3. Lock-On attachment

Track layout

Connecting the controller wires to the Lock-On

The wire coming out of the controller splits into two thinner wires that are stripped on the ends. These stripped wires will be inserted into the Lock-On. This is done by pressing down the upper half of the clip until the metal loop in the lower part

projects through the top. Insert the bare wire end into the loop and release the clip, as illustrated in Figure 4 below. Spring tension will hold the wire tight. The wire positions are interchangeable.

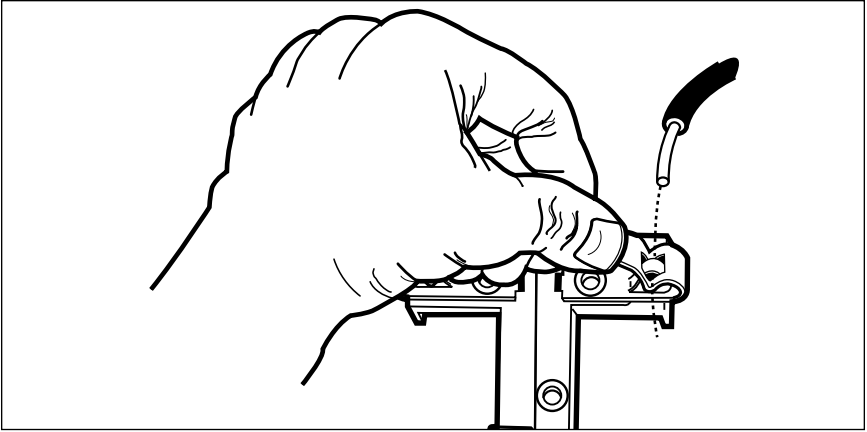

Figure 4. Wire connections

The set-up should now look something like the one in Figure 5. You will find the wire

on the actual controller is much longer than appears in the illustration.

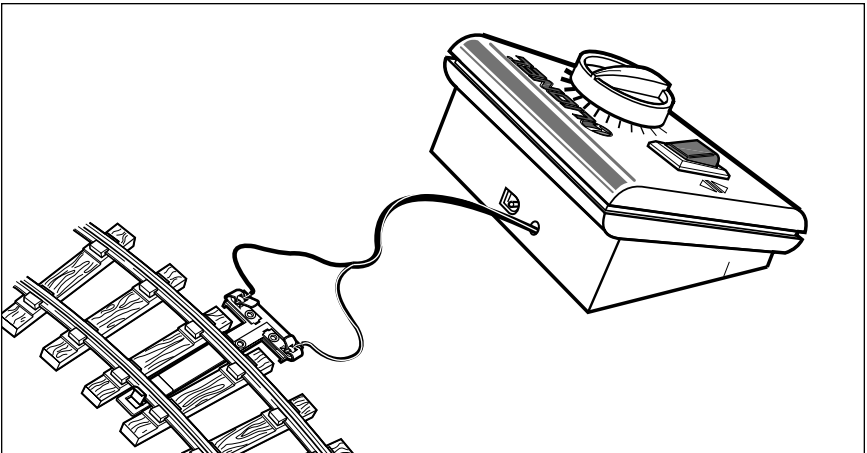

Figure 5. Completed track connections

Controller operations

Understanding short circuits

The power pack furnished with this train set has been listed by the Underwriters Laboratories, Inc. and has been carefully tested to assure proper performance. This controller is equipped with a built-in circuit breaker that will alternately cut off and restore the flow of power to the track whenever a short circuit exists until the cause of the short circuit is eliminated. This circuit breaker is incorporated into the controller to protect the power pack from possible permanent damage. It will not protect the locomotive or electrically operated accessories.

NOTE: The transformer must be unplugged from the wall socket when a short circuit is noticed, and the short circuit must be corrected.

A short circuit is caused by a direct connection across the rails (such as a derailed

engine), or by two bare wires touching each other at the track Lock-On. Some other causes of short circuits might be staples, nails, paper clips, or other metallic objects lying across the rails.

An overload condition could be caused by carrying too much weight inside the cars, or by holding the engine while it is under power, or by a sudden start or direction change.

After operating the power pack for a while you will find it warm to the touch. It is the nature of all electrical power equipment to become warm when in use. If your power pack is loaded to capacity, it is a good idea to let it cool down after an hour or two of continuous use. Be sure to unplug the power pack when not in use.

Parents should periodically inspect the power pack for potential hazards such as a broken or damaged case and have it repaired or replaced. See the Lionel Service Station listing for information and the address of the nearest Authorized Service Station.

Controller operations

Connecting the power supply

With the throttle in the OFF position, plug in the wall power pack to a stan-

dard wall outlet, then plug the power pack into the controller jack. See Figure 6.

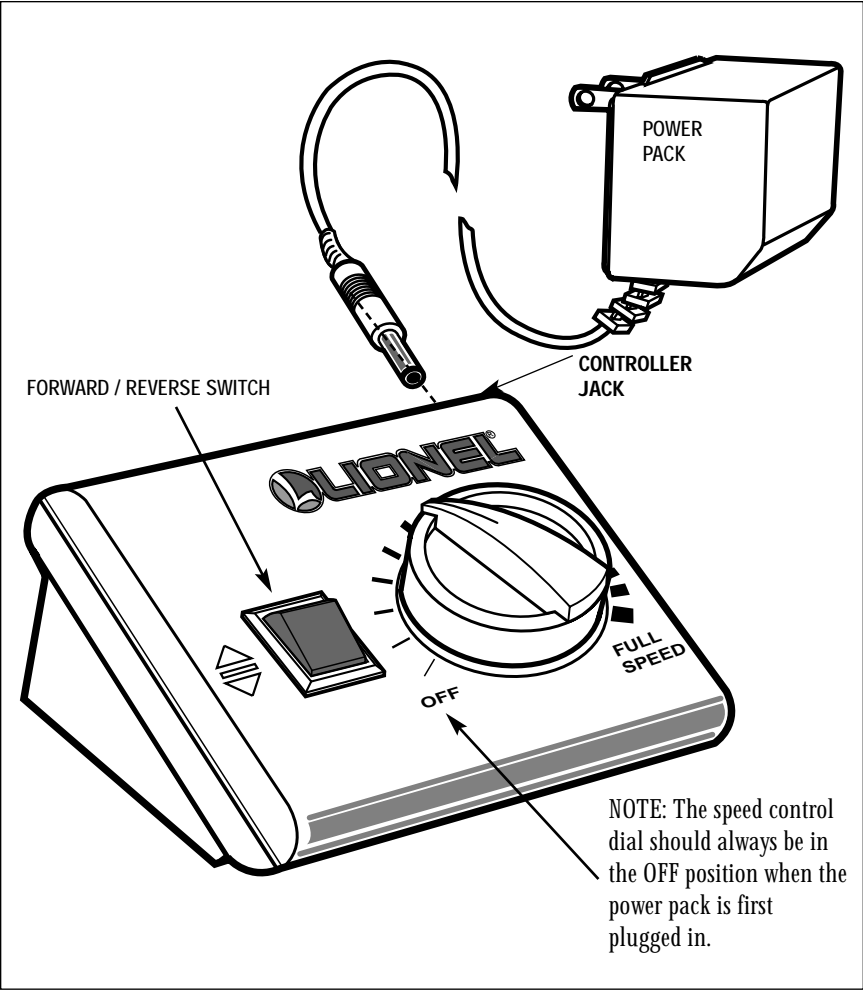

Figure 6. Power supply connection

Controller operations

Operating the train

After you have assembled the track layout, place the locomotive and cars on the track (see page 10 and 11). Before coupling the cars, make sure the wheels are properly set on the rails. Once your train is ready, have an adult plug the wall pack into any wall outlet. Next, advance the transformer dial until the train begins to move.

To change directions, turn the speed control to off to stop the train, then change the position of the direction switch. Increase the

throttle, and the engine is now traveling in the reverse direction. Refer to Figure 7.

It should be noted that, while power is continually increased as the controller knob is turned to the right, it will not drive the train until the knob is in the approximate position shown in the illustration above. As the load on the engine increases, (by adding cars for the engine to pull for example) the amount that the knob needs to be turned to the right to run the train will increase.

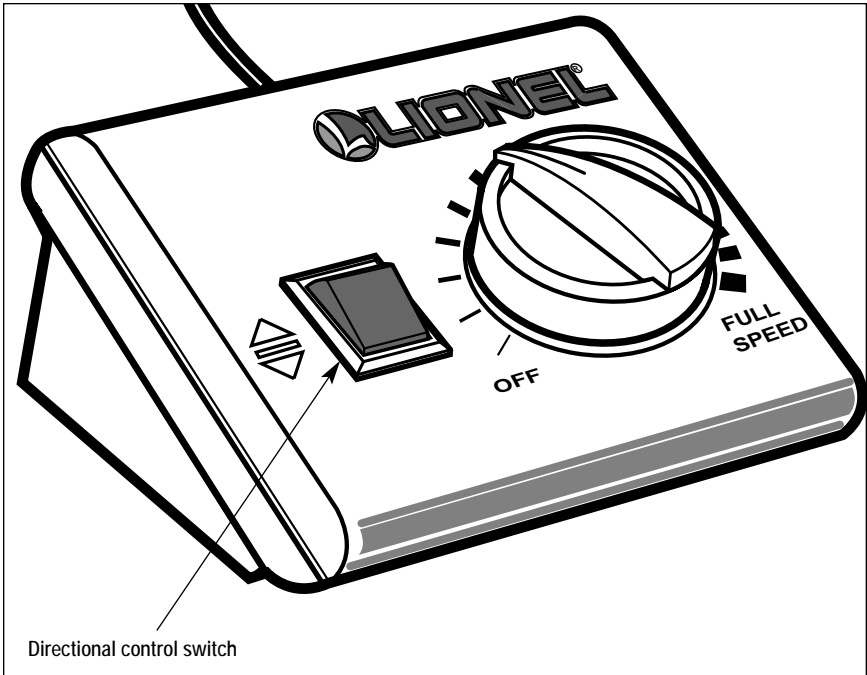

Figure 7. Direction control switch

Train operations

Arranging the train on the track

After the track is assembled, place Thomas, Annie, and Clarabel on the track, making sure that all wheels are properly set on the rails. The engine and two coaches should be positioned as follows:

Thomas the Tank Engine - Annie - Clarabel. You may want to arrange the coaches as they appear in the books and on TV. Annie travels facing Thomas, and Clarabel travels facing away from Thomas. Refer to Figure 8.

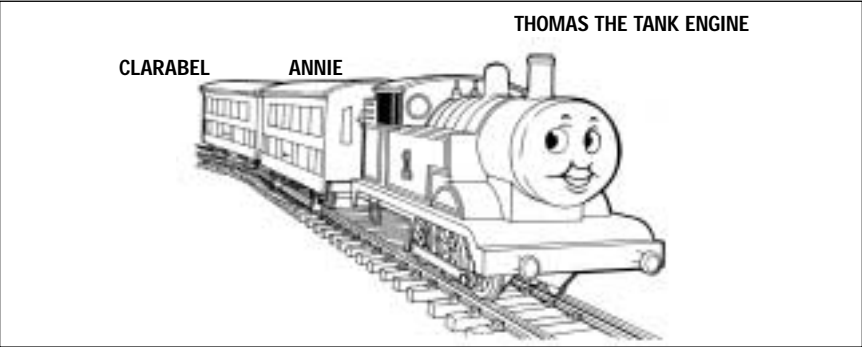

Figure 8. Arranging the set on the track

Operating the knuckle couplers

To join the cars together, open at least one coupler by pressing up on the plunger located on the bottom of the coupler, then push

the cars together on any part of your track with the couplers lined up.

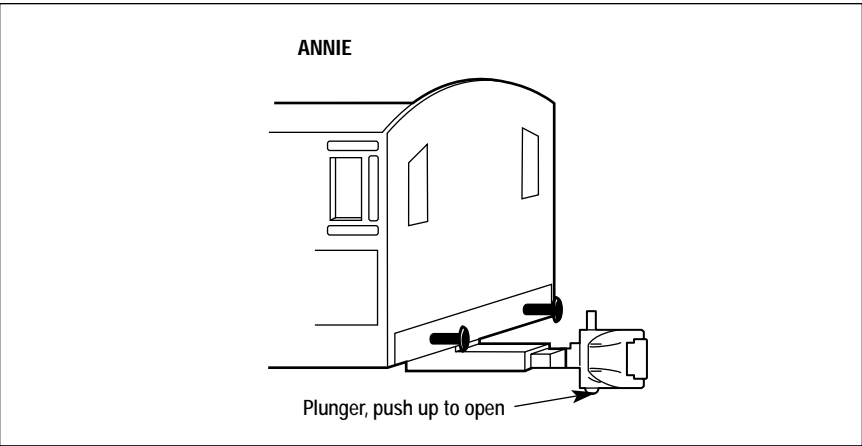

Figure 9. Knuckle couplers

Train operations

Installing and operating hook and loop couplers

The hook and loop style couplers included with this set may be used in place of the knuckle couplers that are installed on the engine and coaches. To replace the couplers follow the instructions below.

Annie and Clarabel

Turn the coach over and remove the screw securing each coupler. Remove the knuckle coupler and place the hook or loop coupler in its place, aligning the screw post with the third hole in the coupler mounting tab (the hole that is furthest away from the end of the coupler). Replace the screw to secure the coupler.

On Clarabel, place one coupler with an attached hook on the end of the coach with the painted face. Place a coupler with loop only on the other end of the coach.

On Annie, place a coupler with loop only on the end of the coach with the painted

face. Place a coupler with hook and loop on the other end of the coach.

Engine installation

Loosen the two rear screws on the bottom of the engine. Carefully lift the rear cover plate off the gear box and slide the coupler off its pivot post.

Slide a coupler with hook and loop over the pivot post. Be sure the centering tab pin fits in the support post inside the gear box. Use the first coupler mounting hole (nearest the end of the coupler). Tighten the two cover screws.

To couple the Annie and Clarabel coaches together, simply push the hook into the center of the loop, being careful to locate the hook between the ribs. To uncouple the coaches, push the tab on the hooked coupler of the Annie coach. Refer to Figure 10.

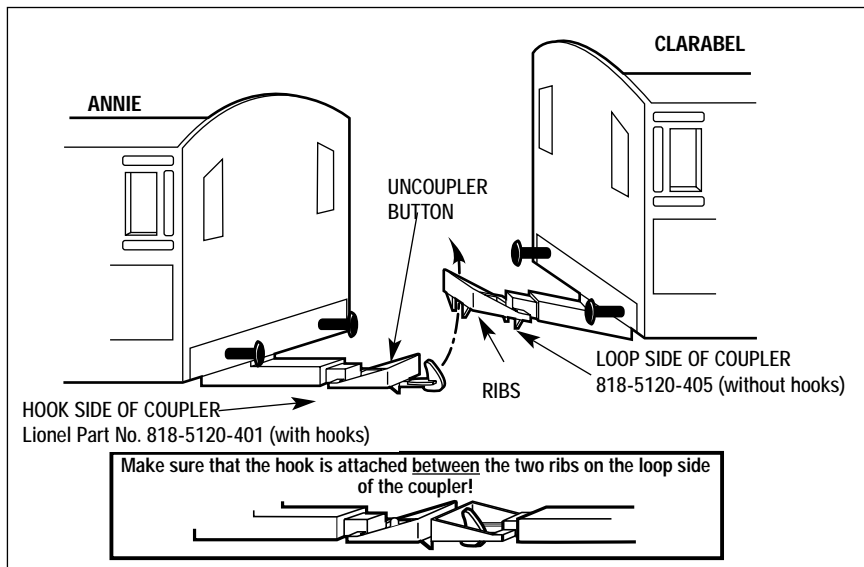

Figure 10. Hook and loop coupler.

Train operations

Attaching the 3 Thomas Faces

Three interchangeable facial expressions (surprised, tired and angry) easily slip

on and off Thomas for fun and imaginative play. Refer to Figure 11.



Figure 11. Interchangeable faces

To attach one of the faces, carefully position it in front of the permanent smiling Thomas face and push it straight on. To remove it, simply pull it straight off. Please remember

that the smiling Thomas face cannot be removed. Refer to Figure 12.

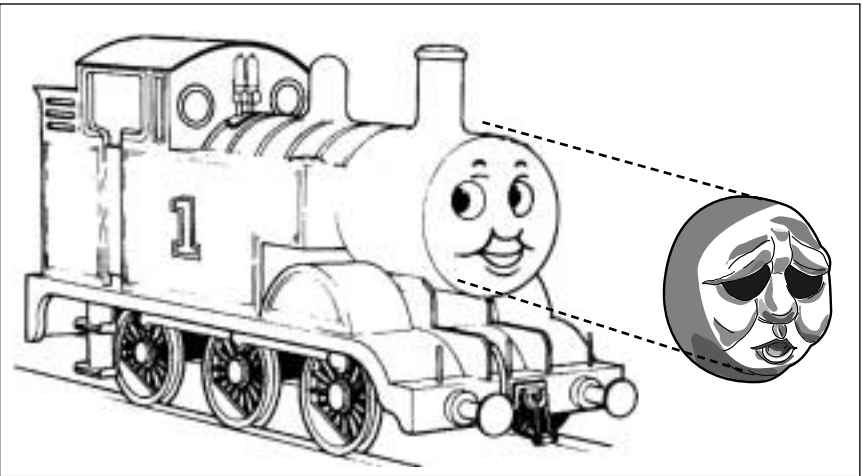

Figure 12. Attaching the faces

Train operations

Picking Up Thomas

Never pick up the Thomas Engine by the cab since the removable cab top may come loose and the engine may drop. This is illustrated in Figure 13.

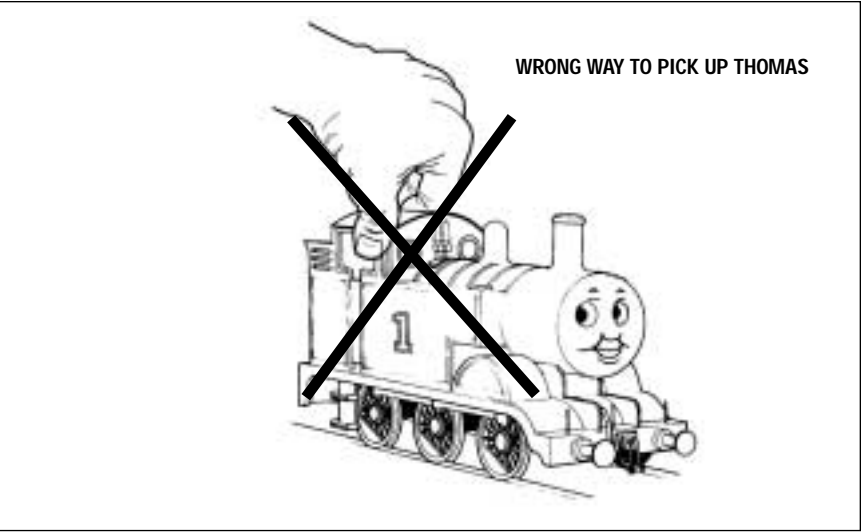

Figure 13. Picking up Thomas incorrectly

Be sure to pick up the engine around the middle as illustrated in Figure 14. This provides better stability.

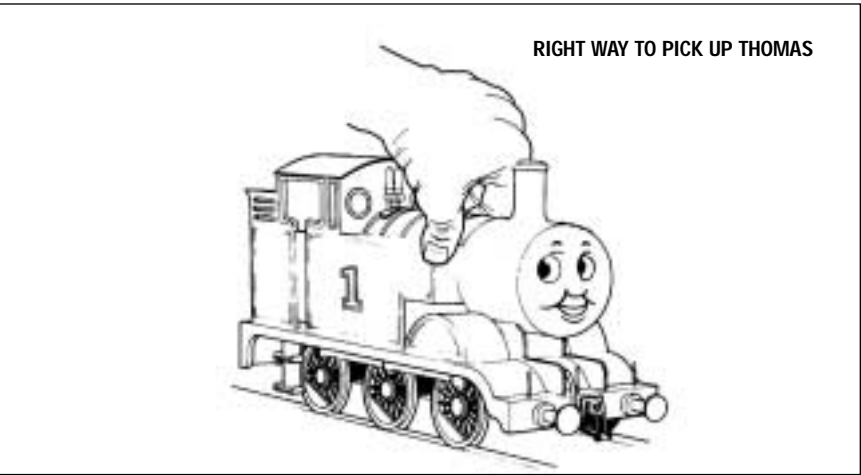

Figure 14. Picking up Thomas correctly

Train operations

Locomotive Care

Do not attempt to disassemble and/or lubricate your locomotive. All locomotives have been pretested and the necessary moving parts have been sufficiently lubricated for life at the factory and should run correctly. If you have difficulty with the operation of your locomotive, please return it to an authorized Lionel Trains Service

Center or the Factory Service Department for proper service. See the Service section on page 16 for additional information.

It is very important to keep the track and wheels free from dirt and grease. Wipe them with a soft cloth whenever they get dirty. This will help the engine run more efficiently.

Troubleshooting

PROBLEM				CORRECTIVE ACTION			
PROBABLE CAUSE	ENGINE WILL NOT RUN						See POWER PACK & SHORT CIRCUITS
	ENGINE HESITATES						See LOCKON
	ENGINE RUNS VERY SLOWLY OR OVERHEATS						See POWER PACK & SHORT CIRCUITS
	CARS WON'T COUPLE						See POWER PACK & SHORT CIRCUITS
	POWER PACK UNPLUGGED	⚡					See POWER PACK & SHORT CIRCUITS
	INCORRECT WIRING BETWEEN TRACK & CONTROLLER	⚡					See POWER PACK & SHORT CIRCUITS
	SHORT CIRCUIT ON CONTROLLER	⚡					See POWER PACK & SHORT CIRCUITS
	SHORT CIRCUIT ON TRACK	⚡					See TRACK ASSEMBLY
	TRACK CONNECTIONS NOT SECURE	⚡	⚡				See TRACK ASSEMBLY
	DIRTY TRACK	⚡	⚡	⚡			See LOCKON
	DIRTY ENGINE WHEELS	⚡	⚡	⚡			See COUPLING
	LOOSE WIRING / LOOSE CONNECTIONS	⚡	⚡				See TRACK ASSEMBLY
	CAR TURNED WRONG WAY				⚡		See TRACK ASSEMBLY
							See LOCKON
							See COUPLING
							See TRACK ASSEMBLY
							See TRACK ASSEMBLY
							See POWER PACK & SHORT CIRCUITS
							See POWER PACK & SHORT CIRCUITS
							See LOCKON

Limited Warranty/Lionel Service

This Lionel product, including all mechanical and electrical components, moving parts, motors and structural components, except for light bulbs, is warranted to the original consumer-purchaser, for **one year** against original defects in materials or workmanship when purchased through an authorized Lionel merchant.

This warranty does NOT cover normal wear and tear, light bulbs, defects appearing in the course of commercial use, or damage resulting from abuse or misuse of the product by the purchaser. Transfer of this product by the original consumer-purchaser to another person voids this warranty. Modification of this product voids this warranty.

Any warranted product which is defective in original materials or workmanship and is delivered by the original consumer-purchaser to Lionel L.L.C. or an authorized Lionel L.L.C. Service Center, together with proof of original purchase will, at the option of Lionel L.L.C., be repaired or replaced, without charge for parts or labor. In the event the defective product cannot be repaired, and a replacement is not available, a refund of the original purchase price will be granted. Any products on which warranty service is sought must be sent freight or postage prepaid, as transportation and shipping charges are not covered by the warranty.

In no event shall Lionel L.L.C. be liable for incidental or consequential damages.

Some states do not allow the exclusion or limitation of incidental or consequential damages, so the above exclusion may not apply to you.

This limited warranty gives you specific legal rights, and you may have other rights which vary from state to state.

Instructions for Obtaining Service

If service for this Lionel L.L.C. product is required, bring the item, along with your dated sales receipt and completed warranty information

to the nearest Authorized Lionel Service Center. Your nearest Lionel Service Center can be found by calling 1-800-4-Lionel, or by accessing our Website at www.lionel.com.

If you prefer to send your product back to Lionel L.L.C. for repair in Michigan, you must first call 586-949-4100 or FAX 586-949-5429, or write to Customer Service, P.O. Box 748, New Baltimore, MI 48047-0748, stating what the item is, when it was purchased and what seems to be the problem. You will be sent a return authorization letter and label to ensure your merchandise will be properly handled upon receipt.

Once you have received your return authorization and label, make sure that the item is packed to prevent damage during shipping and handling. We suggest that you use the product's original packaging. This shipment must be prepaid and we recommend that it be insured.

Please make sure you have followed all of the above instructions carefully before returning any merchandise for service. You may choose to have your product repaired by one of our Authorized Lionel Service Centers after its warranty has expired. A reasonable service fee will be charged.

Warranty Information

Please complete the information below and keep it, along with your dated sales receipt. You must present this and your dated sales receipt when requesting warranty service.

Name _____

Address _____

Place of Purchase _____

Date of Purchase _____

Product Number _____

Product Description _____

