

Goodmans

MICRO1470DABI

CD Micro System with Digital Radio and iPhone Dock
User Guide

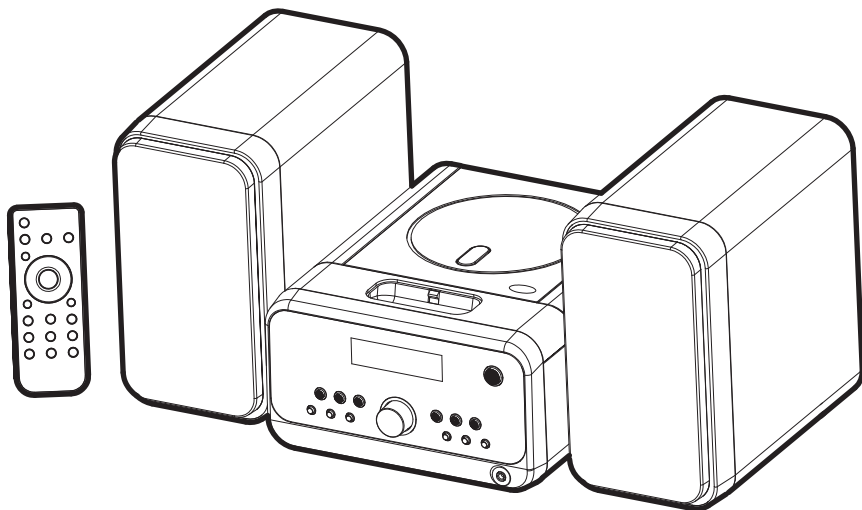

IMPORTANT: Please read all instructions carefully before use and keep for future reference

Introduction

Thank you for choosing this Micro System with Docking Station. Not only can you listen to your favourite radio stations and CDs, but you can also listen to all the songs stored on your iPod.

It's really simple to use; you can fully operate your Micro System with Docking Station using the supplied Remote Control.

Throughout this User Guide the Micro System with Docking Station will be referred to as the Micro System.

Safety is important

Use of any electrical equipment should be undertaken with care. Please read the Safety instructions on pages 20 and 21 before you operate this Micro System.

Made for



iPod



iPhone

What's in the box

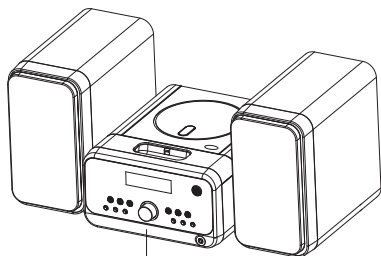

CD Micro System with Digital Radio and iPhone Dock

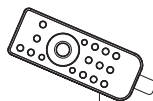

Remote Control
(1 x battery for remote control)



This User Guide

Contents

01	Your Micro system.....	4	07	Using the CD.....	14
02	Get going.....	6	08	Using the Aux Input	17
03	Daily Use.....	7	09	Other functions.....	17
04	Using the Clock or Timer and Sleep.....	8	10	Trouble shooting.....	18
05	Using the radio.....	9	11	Specifications.....	19
06	Using the iPhone dock.....	13	12	Safety.....	20

Top

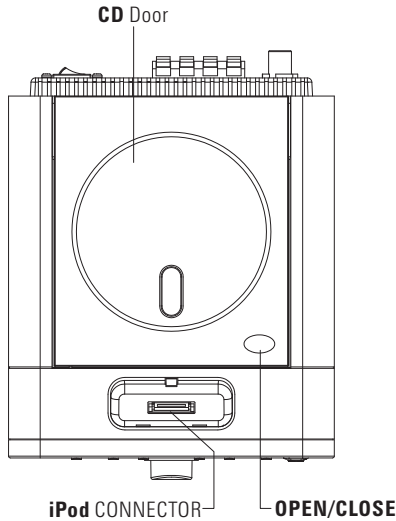

Front

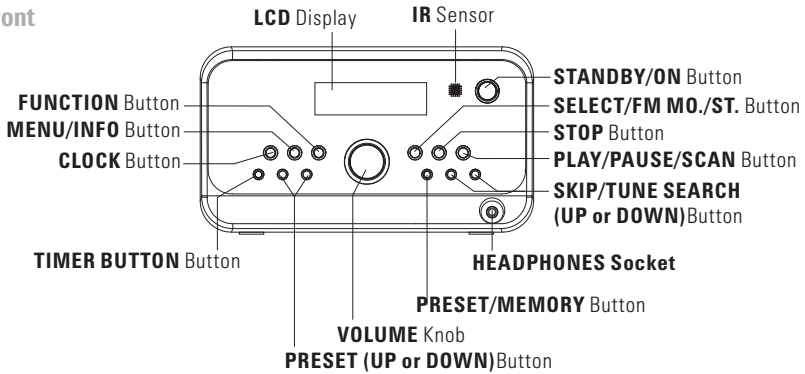

Rear

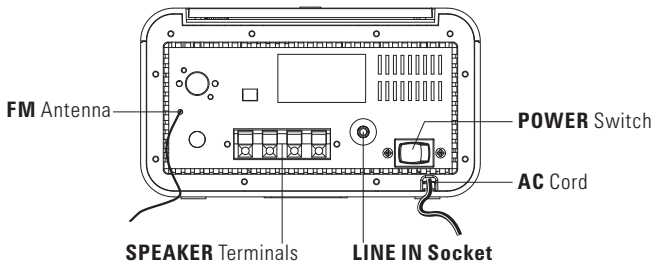

Remote control

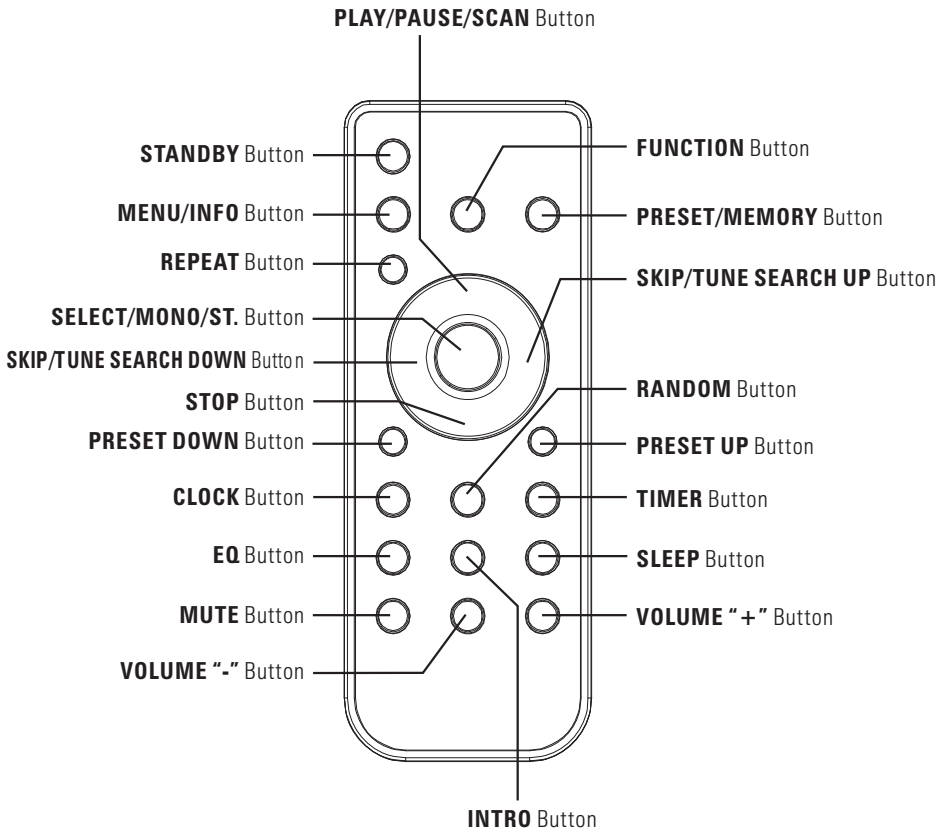

1

Using remote control

Press down on the compartment cover, and slide the cover off to open the compartment. Place the CR2032 battery in the remote control according to the polarity markings ("+" and "-"). Place the cover into the compartment, press down lightly, and push it inside until it snaps on.

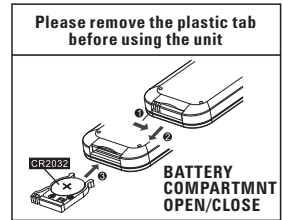

2

iPod/iPhone dock

Any iPod/iPhone can be connected to the Micro System to allow all your songs to be played through the Micro System speakers.

Place your iPod/iPhone Adaptor into the recess on the top of the Micro System and carefully insert your iPod/iPhone into the Adaptor.

Remark: The dock adaptor is not included.

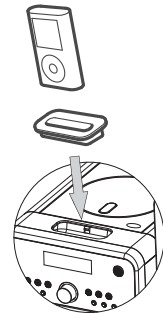

3

Installing the speaker wire to the speaker terminals

1. Speaker Connection;
Extend the SPEAKER WIRES and connect them to the SPEAKER TERMINALS.

2. Power Cord Connection;
Before using the unit, connect the AC Power Cord to the AC outlet. Turn on the main switch on the rear of the unit.

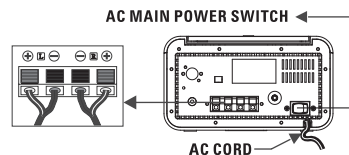

4**Using Earphones**

Connect earphones to the earphone socket on the right hand side of the front panel. When earphones are used the speaker sound will be muted.

Power/standby

- 1** Press the STANDBY/ON button on the unit or on the remote control to switch the unit on.
- 2** Select the desired source (DAB, FM, iPod, CD, AUX) by pressing the FUNCTION button.
- 3** Adjust the volume with the VOLUME (+ or -) control on the unit or the remote control.
- 4** Press the STANDBY/ON button on the unit or the remote control again to switch the unit into standby mode.

DON'T FORGET!

To save energy when the Micro System is not used for long periods, turn the power off at the main power switch on the rear of the unit.

Clock Setting

The clock will be automatically synchronized to the DAB clock if you can receive DAB signals in your location. If you can only receive FM, then you can set the clock manually. The manual clock setting must be done in standby mode.

Manual clock setting

Ensure the unit is in Standby mode.

- 1 Press the CLOCK button, the hour digits flash in the display, press the SKIP/TUNE SEARCH (UP or DOWN) button on the unit or the remote control to set the correct hour, then press the CLOCK button again to confirm.
- 2 After the hour is set, the minute digits will then flash, press the SKIP/TUNE SEARCH (UP or DOWN) button to set the correct minute.
- 3 When the display shows the correct time, press the CLOCK button again to confirm, the manual clock setting is now complete.

DON'T FORGET!

Press the CLOCK button in any mode to briefly display the current time. The clock will display for 5 seconds then the unit will return to the previous operation.

Synchronise the clock to DAB local time

- 1 Press the STANDBY/ON button on the unit (or remote control) once to switch the unit on.
- 2 Press the FUNCTION button on the unit (or remote control) to select DAB mode.
- 3 Tune to a DAB station and the clock will be automatically synchronized to the DAB local time.

Timer Setting

This function allows you to switch on and off the system at a desired time and mode:

- 1 Press the TIMER button to toggle the timer function between on and off, the display will show "Timer on" or "Timer Off". The display will show "🕒" to indicate timer function is on.
- 2 To set the On timer, press and hold the TIMER button until the display shows "On Timer" and the "hour" digit of the timer will flash.
- 3 Press the SKIP/TUNE SEARCH (UP or DOWN) button to set to the desired hour, then press the TIMER button to confirm, first set the hour and finally the minute.

- 4 The unit will now enter the timer off setting, the display will show "Off Timer" and the "hour" digit will flash. Press the SKIP/TUNE SEARCH (UP or DOWN) button to set to the desired hour, then press the TIMER button on the remote control to confirm, first set the hour and finally the minute.
- 5 Finally press the SKIP/TUNE SEARCH (UP or DOWN) button to select the timer on mode - DAB, FM, CD or iPod then press the TIMER button to confirm. The timer setting is now completed.
- 6 Press the TIMER button again, the timer Volume indicator will flash on the display, adjust the timer volume higher or lower by pressing the SKIP/TUNE SEARCH (UP or DOWN) button.
- 7 To check the timer setting, repeatedly press the TIMER button, until the display shows the on timer and the off timer setting.

To Set Sleep Function (on the remote control)

This function allows you to program the system to switch off itself after a set period of time. You can set the sleep time in power on mode:

- 1 To activate the sleep function, press the SLEEP button on the remote control, the display will show "Sleep Timer-OFF,90, 80,70,60, 50, 40,30,20,10" and flash.
- 2 When the display shows your desired sleep time, release the button, the sleep timer is now activated. When the desired sleep time is reached, the unit will switch off to standby mode.
- 3 To cancel the sleep timer, press the SLEEP button once again, the sleep function will turn off.

Listening to radio

This unit carries a single lead wire DAB/FM antenna. To obtain the best performance, you should fully extend the wire antenna and adjust the position as well as the direction until you find the best reception for ideal DAB reception. Always maintain the wire antenna in a vertical position (Fixing it upward or downward behind the unit) is highly recommended.

DAB mode

When the unit is powered up for the first time, it will be in standby mode, and the display will show "Welcome to digital radio".

Press the STANDBY/ON button on the unit (or remote control) to turn the radio on, it will automatically enter into the DAB mode and perform the Autotune Quick scan function. During the scan, the display will show "Searching ..." together with a slide bar that indicates the progress of the scan and the amount of stations that have been found so far. Once the scan has finished, the radio will select the first alphanumerically found station. To explore the found stations, Press the SKIP/TUNE SEARCH (UP or DOWN) buttons to scroll through the station list.

DAB Autotune Full scan mode

Full scan will search for all DAB Band III channels. After the scan has finished, the first alphanumerically found station will be automatically selected.

- 1 To activate autotune full scan, press and hold the PLAY/PAUSE/SCAN button on the unit (or remote control) to enter into the "Autotune Full scan" mode, the display will show "Searching..." and a slower progressing slide bar.
- 2 All the stations that have been found will be stored automatically, to explore the stations that have been found, press the SKIP/TUNE SEARCH (UP or DOWN) to scroll through the station list.

DAB Manual tune

- 1 To select manual tune, press and hold the SELECT button on the unit (or remote control) to enter the "Manual tune" mode.
- 2 Press the SKIP/TUNE SEARCH (UP or DOWN) button to scroll through the DAB channels, the display will show "5A to 13F" and their associated frequencies.
- 3 When your desired frequency appears in the display, press the SELECT button to confirm. The name of the station group (ensemble/multiplex) will be displayed.
- 4 Press the MENU/INFO button to see what stations are present on the found ensemble/multiplex.

DON'T FORGET!

Secondary Services

On some occasions you will see a ">" symbol after the name of the station, this indicates that there are secondary services available to that station. These secondary services contain extra services that relate to the primary station. E.g. a sports station may want to add extra commentaries. The secondary services are inserted directly after the primary station. To select the secondary station, press the SELECT button on the remote control when the ">" appears in the display.

FM mode

- 1 Press the FUNCTION button on the unit (or remote control) to select FM mode, the display will show FM and the frequency.
- 2 To activate frequency auto search, press the PLAY/PAUSE/SCAN button on the unit (or remote control) it will stop automatically once a station has been found. To scan backwards through the waveband, press and hold the PLAY/PAUSE/SCAN button.
- 3 You can also press the SKIP/TUNE SEARCH(UP or DOWN) button on the unit (or remote control) to manually select your desired frequency.
- 4 Press the SELECT button on the unit (or remote control) to toggle select between FM "STEREO" and "MONO" reception.

Storing and recalling stored preset stations

In either DAB or FM mode, you can store up to 20 stations to the favourite presets; this will enable you to get direct access to your favourite stations.

- 1 To store a preset, first tune to your desired station, then press and hold the PRESET/MEMORY button on the remote control, the display will show frequency and "#" will flash.
- 2 Press the PRESET (UP or DOWN) button to select your desired station preset number, then press the PRESET/MEMORY button on the remote control to confirm your selection; the display will show "Preset # stored" in DAB/FM mode.
- 3 To recall a preset station, press the PRESET/MEMORY button once and then press the PRESET(UP or DOWN) button to select the desired station that you have stored, then press the PRESET/MEMORY button to confirm your selection.

DON'T FORGET!

The stored stations will be saved into the preset memory. Storing a new station into a preset location will erase the previously stored station in that location.

Display modes

Every time you press the MENU/INFO button, the display will cycle through the following display modes:

In FM mode:

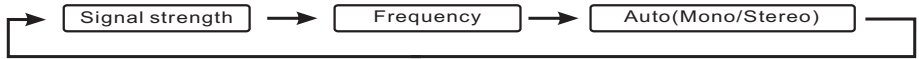

In DAB mode:

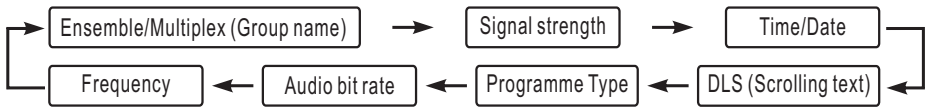

Auto(Mono)

FM Stereo and FM Mono.

Signal strength

The display will show a slide bar to indicate the signal strength, the stronger the signal, the longer the bar will be.

Time and date

The time and date will be automatically updated by the broadcasted information; there is no need to set the clock manually. In the unlikely event that no clock information is received, the display will show "<Time/Date>".

Audio bit rate

The display will show the digital audio bit rate being received.

Frequency

The frequency of the present station will be displayed.

Ensemble/Multiplex (Group name)

The Ensemble/Multiplex is a collection of radio stations that are bundled and transmitted together in a single frequency. There are national and local multiplexes, local ones contain stations that are specific to that area.

Programme type

This describes the style of the programme that is being broadcast. If the information is not available, the display will show "<Programme Type>".

DLS

DLS stands for Dynamic Label Segment which is a scrolling message that the broadcaster may include in their transmissions.

The message usually includes information such as programme details.

iPod/iPhone Operation

- 1 Carefully insert your iPod or iPhone in the iPod dock on the top of the unit.
- 2 Press the STANDBY/ON button on the unit or on the remote control to switch the unit on.
- 3 Press the FUNCTION button on the unit (or remote control) to select the iPod mode.
- 4 Press the PLAY/PAUSE/SCAN button on the unit (or remote control) to begin playback of the tracks on your iPod/iPhone.
- 5 Adjust the volume with the VOLUME (+ or -) control knob on the unit .
- 6 Press the PLAY/PAUSE/SCAN button on the unit (or remote control) once to pause the current track.
- 7 To skip forwards or backwards, press the SKIP/TUNE SEARCH (UP or DOWN) button on the unit (or remote control) to select the desired track.
- 8 Press the REPEAT or RANDOM buttons on the remote control to make the iPod or iPhone play tracks repeatedly or randomly.

DON'T FORGET!

When the iPod touch iPhone screen has been locked, the above operations are still available.

DON'T FORGET!

Your ipod or iPhone battery will charge whenever it is docked on the unit. It will charge in any mode and also when the unit is in standby mode.

DON'T FORGET!

When an iPhone is playing through the unit and an incoming call is received, the music level will reduce so that you can hear the iPhone ringing tone.

DON'T FORGET!

To navigate through the menu system on your iPod or iPhone:
Press the MENU button to enter the various menus and use the PRESET/ARROW buttons on the remote control to navigate through the options or tracks. To select a track press the SELECT button.

CD Operation

Listening To a compact Disc

- 1 Press the FUNCTION button to select CD mode.
- 2 Press the CD DOOR OPEN/CLOSE button on the main unit to open the CD door.
- 3 Insert the CD disc into the CD compartment, press the CD DOOR to close the CD door, the unit will read the CD disc automatically.

Door Opened CD

DON'T FORGET!

This unit can play CD, CD-R, CD-RW discs.

Playing a CD

- 1 Insert the CD disc into the CD compartment, the main unit will automatically read the total number of tracks and time will be displayed.
- 2 Press the PLAY/PAUSE/SCAN button once, the unit will play the first track of the CD disc.
- 3 Press the PLAY/PAUSE/SCAN button once again to pause the current track. Press the PLAY/PAUSE/SCAN button again to resume playback of the current track.
- 4 Press the SKIP/TUNE SEARCH(UP or DOWN) button once to skip the current track. press and hold the SKIP/TUNE SEARCH (UP or DOWN) button to fast forward or backward through the currently playing track.
- 5 Press the STOP button to stop playback of the current track.

Track 01 CD
00:01

Pause CD

Repeat

- 1 Press the REPEAT button once, REP1 will show in the display. The current track will play repeatedly.
- 2 Press the REPEAT button twice, REP ALL will show in the display. All tracks on the CD will play repeatedly.

- 3 Press the REPEAT button once more to cancel the repeat function and resume normal playback.

Program

You can program up to 20 of your favourite tracks to play in any order.

DON'T FORGET!

To program tracks the CD must be in STOP mode.

- 1 **In STOP mode**
 - a. Press the PRESET/MEMORY button to enter program memory mode.
 - b. Press the SKIP/TUNE SEARCH(UP or DOWN) button, the track number will be changed.
 - c. Press the PRESET/MEMORY button to confirm the track number.
 - d. Repeat the above steps to continue programming up to 20 tracks.

- 2 **PROGRAM PLAY**

Press the PLAY/PAUSE/SCAN button. The unit will play the first track of the program. When all tracks have been played, the display will show the number of tracks and the playing time.

- 3 **CANCEL PROGRAM**

Press the STOP button twice.

DON'T FORGET!

When you play your programmed tracks, the REPEAT function can be used in the same way as when playing tracks normally.

Random play

You can play CD tracks in a random order.

DON'T FORGET

You can select random playback either in STOP mode or while the CD is playing.

- 1 Press the RANDOM button once to select random playback. "RAND" will show in the display and the CD will begin to play any track.

- 2 During Random playback, press the SKIP/TUNE (UP/DOWN) buttons to skip to another random track.
- 3 To resume normal playback, press the RANDOM button again.

Intro play

- 1 Press the INTRO button once, "INTRO" will show in the display. The Micro System will play the first 10 seconds of each track on the CD in sequence.
- 2 Press the INTRO button again to resume normal playback.

Compact disc

- 1 Always use a compact discs bearing the mark as shown.



- 2 **Notes on handling discs**

Removing the disc from its storage case and loading it.

- * Do not touch the reflective recorded surface.
- * Do not stick paper or write anything on the surface.
- * Do not bend the disc.

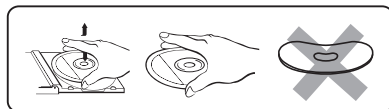

- 3 **Storage**

- * Store the disc in its case.
- * Do not expose discs to direct sunlight or high temperatures, high humidity or dusty places.

- 4 **Cleaning a disc**

- * Should the disc become soiled, wipe off dust, dirt and fingerprints with a soft cloth.
- * The disc should be cleaned from the centre to the edge.
- * Never use benzene, thinners, record cleaner fluid or anti static spray.
- * Be sure to close the CD door so the lens is not contaminated by dust.
- * Do not touch the lens.

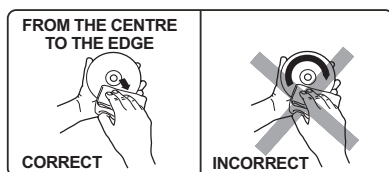

Aux in

The AUX input is located at the rear of the unit. Use a 3.5mm stereo jack cable to connect audio equipment through the LINE IN socket.

- 1 To select the AUX input function, repeatedly press the FUNCTION button on the Micro System (or remote control) until AUX IN is indicated on the display.
- 2 Press the play button on the auxiliary device and then adjust the VOLUME control on the Micro System to a comfortable level.

DON'T FORGET!

A line-in or aux cable is not supplied with the Micro System.

Other functions

EQ control (on the remote control)

When you press the EQ button, the sound tone changes as below:



Mute setting (on the remote control)

Press the MUTE button on the remote control to stop the sound from the speakers temporarily, the sound stops and the display will show "MUTE". To cancel mute, press the MUTE button again or use the volume control, "MUTE" disappears in the display and the sound is restored.

PROBLEM	POSSIBLE CAUSE	SOLUTION
No sound	Connections incorrect or loose. Volume knob at zero.	Check all connections and correct as required. Turn up the volume knob.
Poor radio reception	The wire antenna is not extended and arranged correctly.	Extend the wire antenna to ensure the best reception.
No CD playback	The disc is dirty. The disc is upside down. The CD player is on Pause.	Clean or replace the disc. Turn it over, placing the label upwards. Remove the Pause mode.
The remote control does not work.	An obstacle blocks the signal between the remote control and the unit's sensor. The remote control's batteries are low.	Remove any obstacles. Replace the batteries.
All functions are inoperative.	The microprocessor is disturbed by exterior electronic disturbances.	Unplug the Micro System the unit for a few minutes, then turn it back on.

POWER SUPPLY :	AC 230V~50Hz
OUTPUT POWER :	5 Watts x 2
UNIT DIMENSIONS :	180 (W) x 210 (D) x 100 (H) mm
SPEAKER BOX DIMENSIONS :	100 (W) x 180 (D) x 180 (H) mm
WEIGHT (including Speakers):	4.1kg

RADIO SECTION

FREQUENCY RANGE :	FM 87.5 - 108 MHz
	DAB/DAB+ 174 - 240 MHz

COMPACT DISC SECTION

OPTICAL PICKUP :	3 - BEAM LASER
FREQUENCY RESPONSE :	100Hz - 16kHz

SPECIFICATION SUBJECT TO CHANGE WITHOUT PRIOR NOTICE.

Sound Levels

Your hearing is important to you and to us so please take care when operating this equipment. It is strongly recommended that you follow the guidelines in order to prevent possible damage to, or loss of hearing. Over time your hearing will adapt to continuous loud sounds and will give the impression that the volume has in fact been reduced. What seems normal to you may in fact be harmful. To guard against this, set the initial volume of the equipment to a low level.

Follow the steps below to ensure that the product can be enjoyed at a comfortable listening level:

- 1 Slowly increase the level until you can hear comfortably and clearly and without distortion.
- 2 Damage to your hearing is accumulative and irreversible. Any "ringing" or discomfort in the ears indicates that the volume is too loud.
- 3 Once you have established a comfortable listening level, do not increase the volume level.

General Safety

This equipment has been designed and manufactured to meet European safety standards, but like any electrical equipment, care must be taken if you are to obtain the best results and safety is to be assured.

Do read these operating instructions before you attempt to use the equipment.

Do ensure that all electrical connections (including the mains plug, extension leads

and interconnections between pieces of equipment) are properly made in accordance with the manufacturer's instructions.

Switch off and remove the mains plug when making or changing any connections.

Do consult your dealer if you are ever in doubt about the installation, operation or safety of your equipment.

Don't continue to operate the equipment if you are ever in doubt about it working normally, or if it is damaged in any way. Switch it off withdraw the mains plug and consult your dealer.

Don't remove any fixed covers as this may expose you to dangerous voltages.

Don't leave the equipment switched On when it is unattended, unless it is specifically stated that it is designed for unattended operation or has a standby mode.

Switch off using the switch on the equipment and make sure that other people in your household are conversant with the equipment.

Special arrangements may need to be made for infirm or handicapped people.

Don't obstruct the ventilation vents on the equipment, for example with curtains or soft furnishings. Overheating will cause damage and shorten the life of the product.

Don't allow electrical equipment to be exposed to rain or moisture.

Electrical Information

This Micro system is fitted with a BS1363/A 13 amp plug. If it is not suitable for your supply sockets it must be removed and replaced with an appropriate plug. If the plug becomes damaged and/or needs to be replaced please follow the wiring instructions below. The plug removed must be disposed of immediately. It must not be plugged into a supply socket as this will be an electrical hazard. If the fuse needs to be replaced it must be of the same rating and ASTA approved to BS1362. If the plug is changed, a fuse of the appropriate rating must be fitted in the plug, adapter or at the distribution board. If the fuse in a moulded plug is replaced, the fuse cover must be refitted before the appliance can be used. Wiring Instructions The supply cable will be either 2-core or 3-core. Follow the appropriate wiring instructions given below. In both cases ensure that the outer sheath of the cable is firmly held by the cable clamp.

Wiring Instructions

The supply cable will be either 2-core or 3-core. Follow the appropriate wiring instructions given below. In both cases ensure that the outer sheath of the cable is firmly held by the cable clamp.

2- Core plug

⚠ WARNING : Do not connect either wire to the earth terminal.

 This symbol indicates that this 2-core appliance is Class II and does not require an earth connection.

The wire coloured blue must be connected to the terminal marked with the letter N or coloured black.

The wire coloured brown must be connected to the terminal marked with the letter L or coloured red

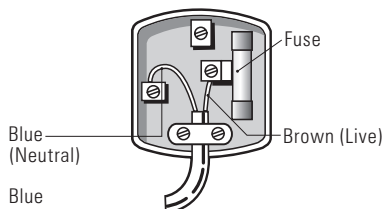

3- Core plug

⚠ WARNING : This appliance must be earthed.

The wire coloured green and yellow must be connected to the terminal marked with the letter E, or by the earth symbol , or coloured green or green and yellow.

The wire coloured blue must be connected to the terminal marked with the letter N or coloured black.

The wire coloured brown must be connected to the terminal marked with the letter L or coloured red.

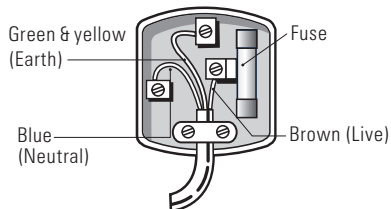

WEEE



This appliance is labelled in accordance with European Directive 2002/96/EG concerning used electrical and electronic appliances (Waste Electrical and Electronic Equipment - WEEE). The guideline determines the framework for the return and recycling of used appliances.

Goodmans

Helpline 0871 230 1777

www.goodmans.co.uk