

# NETGEAR®

---

## NeoTV Prime with Google TV GTV100 User Manual



350 East Plumeria Drive  
San Jose, CA 95134  
USA

January 2013  
202-11067-01  
v1

## Support

Thank you for choosing NETGEAR.

After installing your device, locate the serial number on the label of your product and use it to register your product at <https://my.netgear.com>. You must register your product before you can use NETGEAR telephone support. NETGEAR recommends registering your product through the NETGEAR website. For product updates and web support, visit <http://support.netgear.com>.

Phone (US & Canada only): 1-888-NETGEAR.

Phone (Other Countries): Check the list of phone numbers at <http://support.netgear.com/general/contact/default.aspx>.

NETGEAR recommends that you use only the official NETGEAR support resources.

## Trademarks

NETGEAR, the NETGEAR logo, and Connect with Innovation are trademarks and/or registered trademarks of NETGEAR, Inc. and/or its subsidiaries in the United States and/or other countries. Information is subject to change without notice. © NETGEAR, Inc. All rights reserved.

## Chapter 1 Getting Started

Package Contents . . . . .	6
Getting to Know Your NeoTV Prime . . . . .	6
Restore Factory Settings . . . . .	7
Connect the NeoTV Prime to Your Audio System . . . . .	7
Remote Control . . . . .	8
LED Indicator . . . . .	8
Directional Navigation . . . . .	9
Activate and Exit the Touchpad . . . . .	9
Touchpad Navigation . . . . .	10
Remote Control Keyboard . . . . .	11
Remote Control Pairing . . . . .	11
Replace the Remote Control Batteries . . . . .	12
Accessories . . . . .	12

## Chapter 2 Onscreen Guided Setup

Guided Setup . . . . .	14
Tips and Troubleshooting . . . . .	17
Tips for Wireless Network Connections . . . . .	17
I See the Picture but I Do Not Hear Any Sound . . . . .	17
My Remote Is Not Working . . . . .	17
How to Exit Netflix or LiveTV . . . . .	17
How to Deactivate Netflix . . . . .	17

## Chapter 3 Play Media and More

Home Screen . . . . .	19
All Apps . . . . .	19
Search . . . . .	20
Watch TV & Movies . . . . .	21
Selection Icons . . . . .	21
Favorites . . . . .	22
Surf the Web with Chrome . . . . .	23
View Photos . . . . .	23
Play Music . . . . .	24

## Chapter 4 Settings

Settings Screen . . . . .	26
Network Settings . . . . .	27
Wi-Fi Internet Connection . . . . .	27
Ethernet Internet Connection . . . . .	28
Bluetooth Settings . . . . .	28
Standby . . . . .	29
Picture & Sound . . . . .	29
Adjust the Picture Display . . . . .	29
Filter Your Searches and Manage Shortcuts . . . . .	30

Video Input . . . . . 30  
TV . . . . . 32  
Applications . . . . . 33  
Date, Time, & Location . . . . . 33  
Language & Input . . . . . 34  
Accounts & Sync . . . . . 34  
About . . . . . 34  
    Update Firmware . . . . . 34

**Appendix A Technical Specifications**

**Appendix B Notification of Compliance**

# Getting Started

---

# 1

The NeoTV Prime uses Google TV to offer you an integrated way to play media, use apps, and interact with the Internet from your TV.

This chapter covers the following topics:

- *Package Contents*
- *Getting to Know Your NeoTV Prime*
- *Restore Factory Settings*
- *Connect the NeoTV Prime to Your Audio System*
- *Remote Control*
- *Accessories*

For help with installation, see the installation guide that came in the package.

For more information about the topics covered in this manual, visit the support website at <http://support.netgear.com>.

## Package Contents

The following items are in the package.



NeoTV Prime



Power adapter



AAA batteries (2)



Remote control



IR blaster cable



Installation guide

## Getting to Know Your NeoTV Prime

**Tip:** The NeoTV is compatible with most keyboards and mouse devices, which can connect to the USB port on the NeoTV.

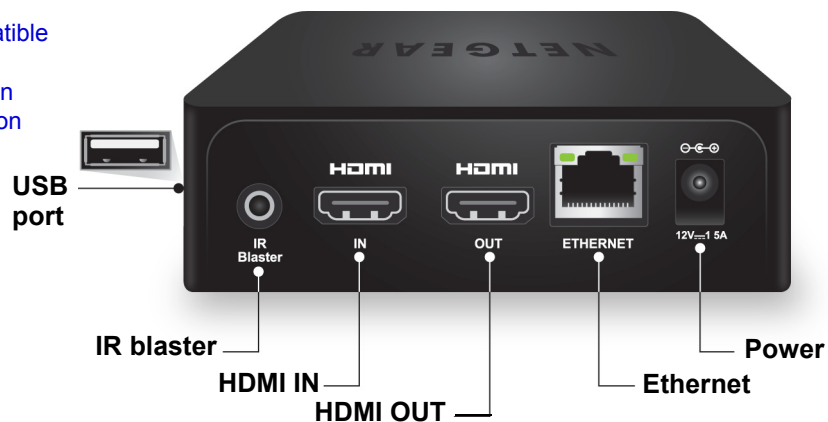

## Restore Factory Settings

You can restore the NeoTV Prime to its factory settings.

➤ **To restore factory settings:**

Press and hold the **Reset** button for at least 9 seconds.

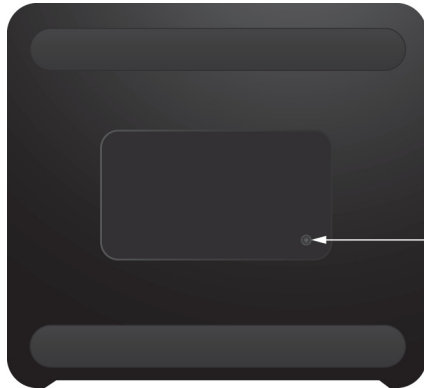

The Reset button is on the bottom.

## Connect the NeoTV Prime to Your Audio System

The following figures show how you can connect the NeoTV Prime to your audio system.

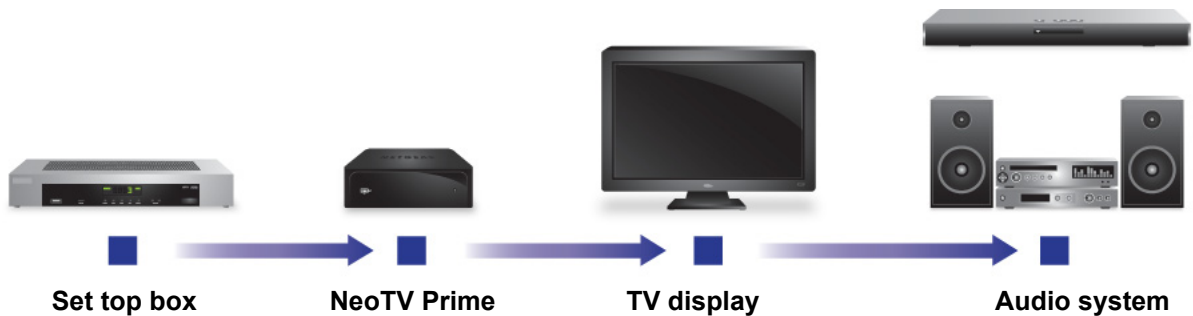

## Remote Control

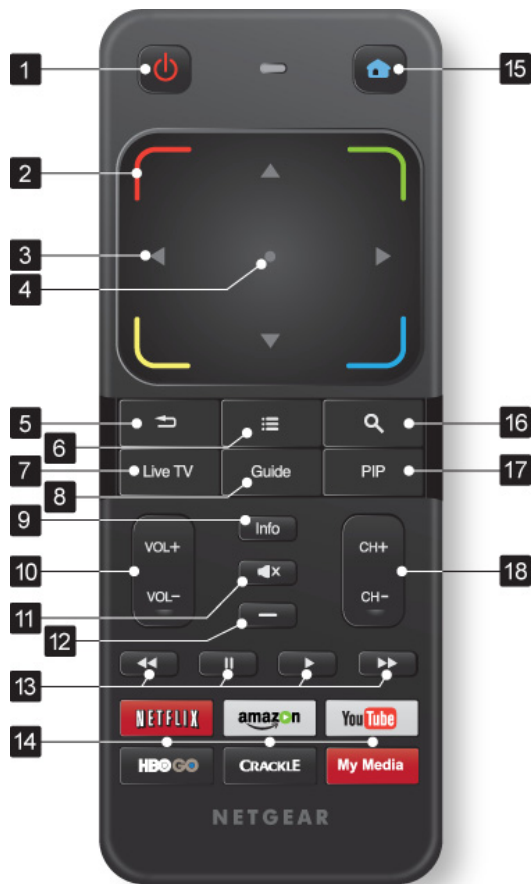

- 1 **Power.** Turn the NeoTV on or off (standby).
- 2 **Color Shortcut.** Depending on the application, use as directed on the TV screen.
- 3 **Arrows.** Use to navigate onscreen menus.
- 4 **OK.** Press to select the highlighted option.
- 5 **Back.** Navigate to the previous step.
- 6 **Menu.** Open the menu for more selections.
- 7 **Live TV.** Watch TV from your cable or satellite box.
- 8 **Guide.** Displays the guide for live TV.
- 9 **Info.** Display additional information.
- 10 **Volume.** Increase or decrease the loudness of the sound (audio).
- 11 **Mute.** Mute the audio.
- 12 **Dash.** Mouse-click for touchpad.
- 13 **Playback controls.** Press to play, pause, fast forward or rewind.
- 14 **Quick Start buttons.** Shortcuts to launch Netflix, Amazon Instant Video, HBOGo, and so on.
- 15 **Home.** Return to the Home screen.
- 16 **Search.** Open the search bar.
- 17 **PIP.** Opens a small picture in the picture window.
- 18 **Channel.** Change the channel.

You can use the NeoTV remote to navigate the screen selections by directional pad or by using a cursor with the touchpad navigation as shown in the following sections.

## LED Indicator

The LED indicator on the front of the remote control lights when the remote control is pairing or connecting with the NeoTV and when the battery is low.

LED color	Description
Blue	<ul style="list-style-type: none"> <li>• <b>Slow blinking (1 blink per second).</b> The remote control is in the process of pairing with the NeoTV.</li> <li>• <b>Fast blinking (2 blinks per second).</b> The remote control is paired with the NeoTV and is in the process of connecting to the NeoTV.</li> </ul>
Orange	Low battery. Please change the battery.

## Directional Navigation

You can use the remote directional buttons.

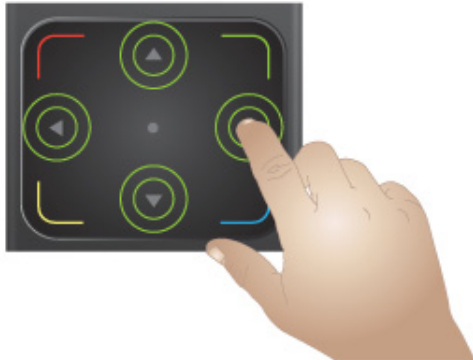

**Navigate with the arrow buttons.**



**Press the dot in the center to select the highlighted option.**

## Activate and Exit the Touchpad

To activate the touchpad, swipe your finger across the touchpad until you see the cursor on the screen. To exit the touchpad and return to directional navigation, tap any of the four directional buttons.

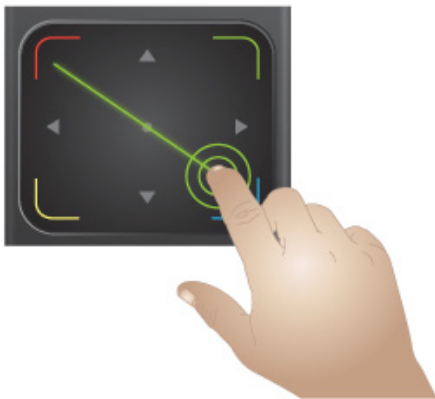

**To activate the touchpad, swipe your finger across the touchpad.**

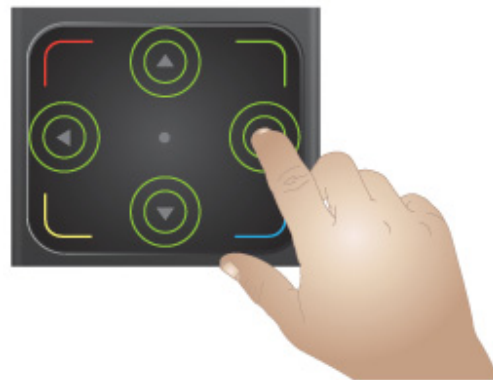

**To exit the touchpad, tap any of the four directional buttons.**

## Touchpad Navigation

When the touchpad is active, you can use it like a mouse to control the cursor on the screen.



To move the cursor, slide your finger.



To select the highlighted option, tap or double-tap the touchpad, or press the dot in the center.



To drag and drop, swipe across the touchpad while you press and hold the Dash button.

## Remote Control Keyboard



1. **Lock.** To lock the keyboard, press the **Lock** key. When the keyboard is locked, the LED lights and the keyboard is disabled. Press the **Lock** key again to unlock the keyboard.
2. **Fn (Function).** To enter one of the orange characters on the keyboard, press and hold the **Fn** key while pressing a key with an orange character. For example, you can press Fn + 2 to enter the @ symbol.

## Remote Control Pairing

The first time you turn on the NeoTV player, the Bluetooth remote control automatically pairs with your NeoTV. Automatic Bluetooth pairing also occurs when you restore the factory settings (see [Restore Factory Settings](#) on page 7). In case the remote control does not pair automatically, you can use the following steps to pair the NeoTV and remote manually.

### ➤ To perform Bluetooth pairing:

- 1 Press the **Reset** button on the bottom of the NeoTV player for 1 to 5 seconds.  
A pairing notification displays on the TV screen.
- 2 Press and hold both the **Rewind** and **Fast forward** buttons for 5 seconds.



The blue LED blinks slowly (once per second) while the remote control is pairing with the Neo TV.

A successful pairing message displays on the TV and the LED on the remote stops blinking.

## Replace the Remote Control Batteries

The remote control uses two AAA batteries that came in the package. To replace them, open the remote control battery compartment doors as shown.



Slide the battery compartment doors open.

When the battery is low, the LED indicator on the front of the remote lights and turns orange.

## Accessories

The NeoTV Prime is compatible with the following accessories.



**USB keyboard or mouse**



**Bluetooth keyboard or mouse**

# 2 Onscreen Guided Setup

---

# 2

This chapter covers the following topics:

- *Guided Setup*
- *Tips and Troubleshooting*

## Guided Setup

When you install the NeoTV Prime, the Onscreen Guided Setup automatically displays. If you want to change the settings after installation, use the Settings menu. See [Chapter 4, Settings](#).

➤ **To use guided set up for your NeoTV Prime:**

- 1 Select **Next** to advance through the setup.

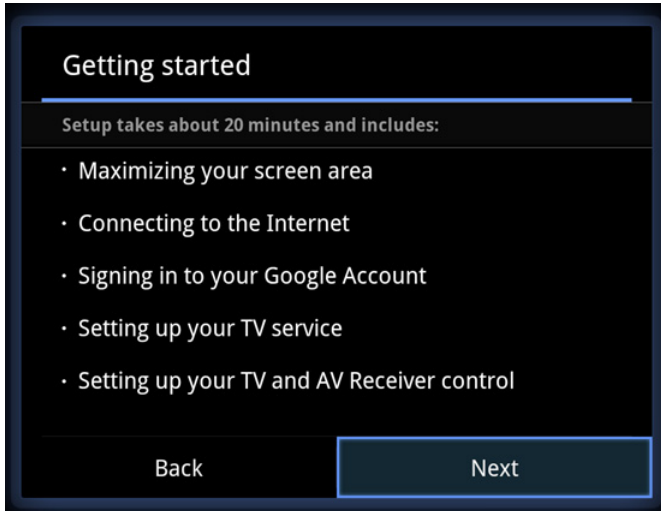

- 2 Maximize your screen area.

On the remote control, press up, down, left, and right, selecting **Next** as you adjust the screen in each direction..

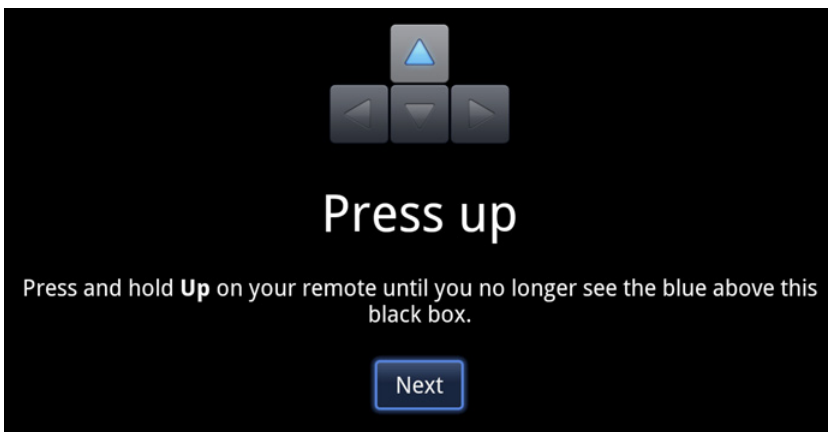

- 3 Connect to the Internet.

Select the type of network connection that you want to use, Ethernet or wireless, and follow the onscreen instructions to connect.



- 4 Sign in to your Google account, or create a new one.

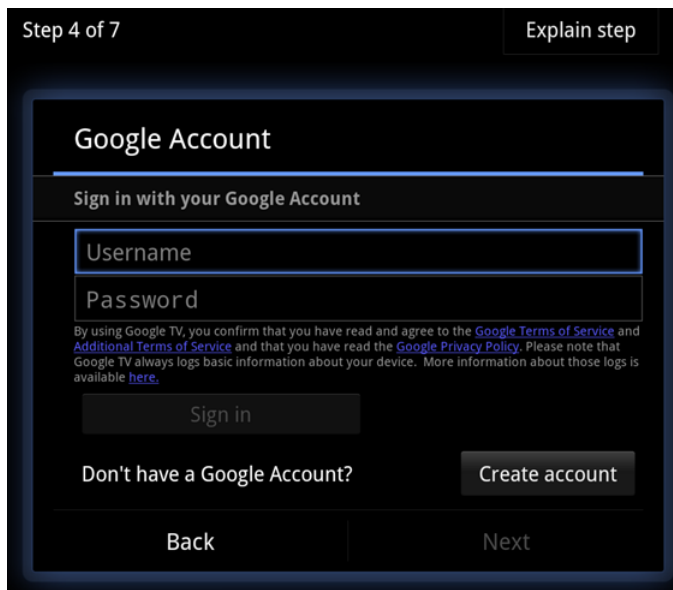

- 5 If you want to send information to Google, select the check box.

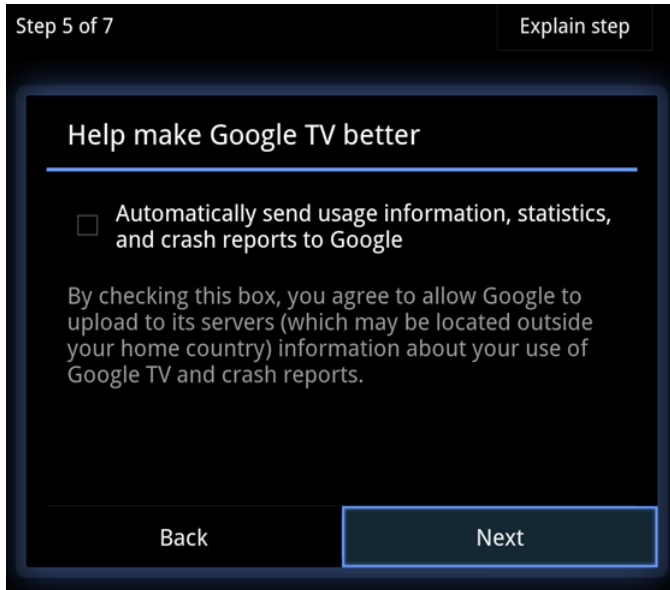

- 6 Enter the ZIP code for your location so that you receive accurate programming information.  
7 Set up your TV service.



If you have a satellite or other TV service, follow the onscreen instructions to specify which equipment you use. For more information about configuring your TV or set top box, see [Video Input](#) on page 30.

## Tips and Troubleshooting

### Tips for Wireless Network Connections

- 1 Place your player within range of your wireless network.  
For best wireless reception, avoid enclosing your player in a cabinet.
- 2 Make sure that the NeoTV Wi-Fi is turned on and connected to your wireless network. See [Wi-Fi Internet Connection](#) on page 27.  
If you do not receive a strong signal during the onscreen setup, rotate your player or move it closer to your router.

### I See the Picture but I Do Not Hear Any Sound

- 1 Make sure that your NeoTV and your TV are not muted.
- 2 Increase the volume on the TV.
- 3 Increase the volume on the cable or satellite box if you are using one.

### My Remote Is Not Working

- 1 Check to see if the batteries are installed correctly.
- 2 Replace the batteries.
- 3 Try pairing the remote by following steps in [Remote Control Pairing](#) on page 11.

### How to Exit Netflix or LiveTV

Press and hold the **Back** button on the remote control. An exit screen displays and asks you to confirm that you want to exit.

### How to Deactivate Netflix

- 1 Select the **All Apps** icon on the Home screen.
- 2 Use the directional navigation buttons on the remote control to select the Netflix app.
- 3 Press and hold the **OK** button on the remote control. An application information screen displays.
- 4 Select **Clear Data** on the application information screen.

# Play Media and More

---

# 3

This chapter covers the following topics:

- *Home Screen*
- *All Apps*
- *Search*
- *Watch TV & Movies*
- *Favorites*
- *Surf the Web with Chrome*
- *View Photos*
- *Play Music*

## Home Screen

Pressing the Home button on the remote control displays the Home screen, which has application and menu icons at the bottom.

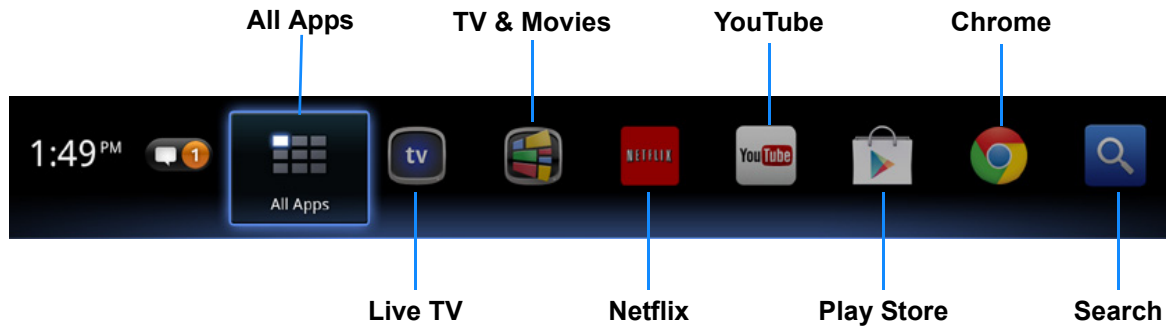

In this example, the All Apps icon is selected.

## All Apps

Display icons for all apps and NeoTV Prime menu selections.

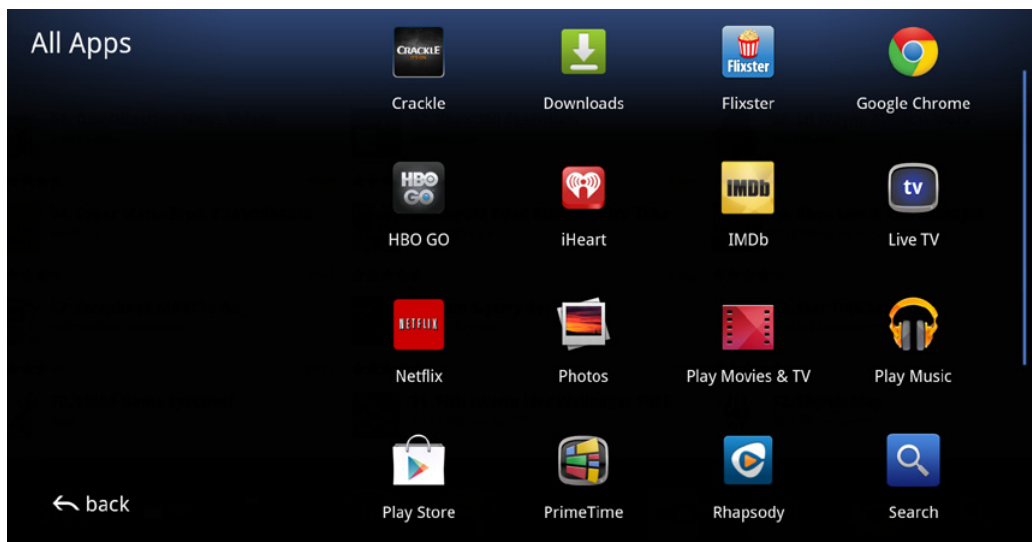

The apps displayed on your screen might differ from the ones shown here. The following icons are commonly shown:

- **Clock.** View the time and set an alarm.
- **Downloads.** Access files that you downloaded from the Internet.
- **Photos.** View photos. See [View Photos](#) on page 23.
- **Play Movies & TV.** Visit the Play Store movies and TV selections.
- **Play Music.** Visit the Play Store music selections.

- **Play Store.** Visit the Play Store.
- **Search.** Search for content, as described in the following section.
- **Settings.** Display the Settings menu. See [Chapter 4, Settings](#).
- **SlingPlayer.** Access your SlingPlayer.
- **Spotlight.** Visit Google TV optimized websites.
- **TuneIn.** Visit Tunein.
- **YouTube.** Visit YouTube.

## Search

You can search for content that is both local and on the Internet.

► **To search for content:**

- 1 Select the  **Search** icon.
- 2 Type the word that you want to search for.

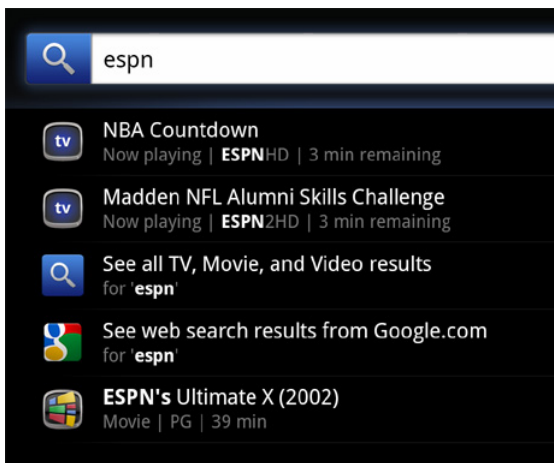

- 3 Press **Enter**.

You can specify the scope of the search in the Settings menu. For instance, you can search for only Internet content, or you can exclude Internet content from your search. See [Filter Your Searches and Manage Shortcuts](#) on page 30.

## Watch TV & Movies

You can watch TV and movies from a variety of sources. Use the selection icons to narrow down your choices.

### Selection Icons

When you select TV & Movies, icons display in the upper left corner of the TV screen.

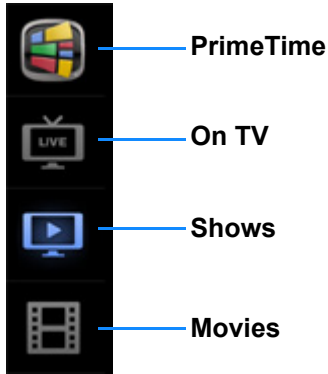

You can use these icons to narrow down the kind of movies and TV that you want to watch. You can also use the two fields at the top of the screen to specify the price and quality.

- **Price.** Free & Paid, or Free.
- **Quality.** HD & SD, HD, or SD.

#### ➤ To use PrimeTime:

Select the **PrimeTime** icon.

You are prompted to specify your viewing preferences. If you do so, then your responses are used to create recommendations.

#### ➤ To watch live TV:

- 1 Use the IR blaster cable to connect the NeoTV Prime to your set top box as described in the installation guide that came in the package.
- 2 Select the **On TV** icon.
- 3 Browse and select the show that you want to watch.

#### ➤ To watch a show:

- 1 Select the **Shows** icon.
- 2 Browse and select the show that you want to watch.

#### ➤ To watch movies:

- 1 Select the **Movies** icon.
- 2 Browse and select the movie that you want to watch.

## Favorites

You can add favorites for PrimeTime, On TV, Shows, and Movies.

➤ **To add a favorite:**

- 1 Select the show or movie that you like.
- 2 Press the **Menu** button on the remote control.

The menu that displays depends on your selection. For instance, you might see Favorite Show, Movie Queue, or Favorite Channel.



- 3 Select **Save** (or **Save to queue**) to save your favorite.

➤ **To remove a favorite:**

- 1 Select the item that is displayed in Favorites.
- 2 Press the **Menu** button on the remote control.
- 3 Select **Remove**.

## Surf the Web with Chrome

You can use Chrome from your TV.

➤ **To use Chrome:**

- 1 Select the  **Chrome** icon.

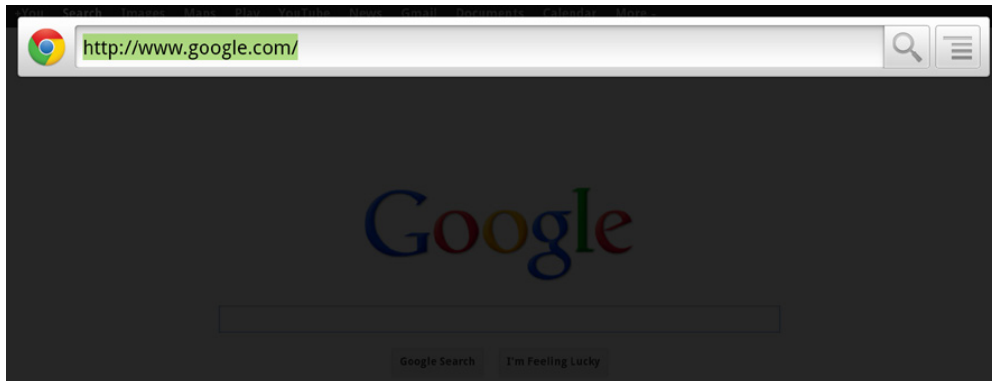

- 2 Use Chrome to browse the Internet.

## View Photos

You can add your photo accounts at Picassa or Flickr, or switch to local media.

➤ **To view photos:**

- 1 Select **All Apps**.
- 2 Select the **Photos** icon.

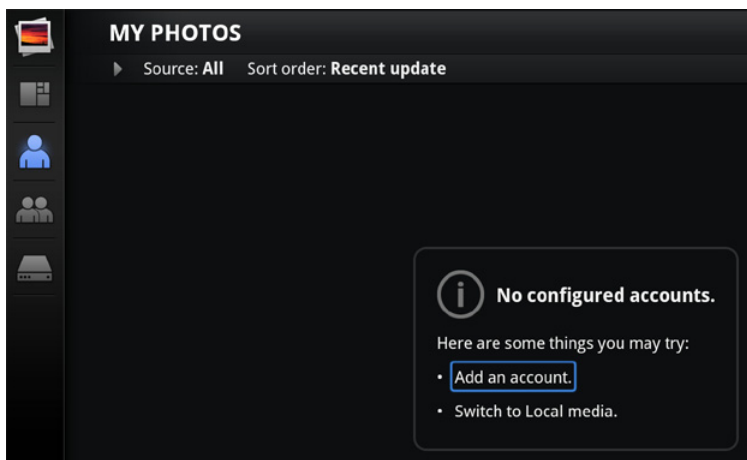

- 3 Select the source for your photos.

You can add your accounts or switch to local media.

## Play Music

Use this icon to access Google Music at the Play Store. You can access your account or play music.

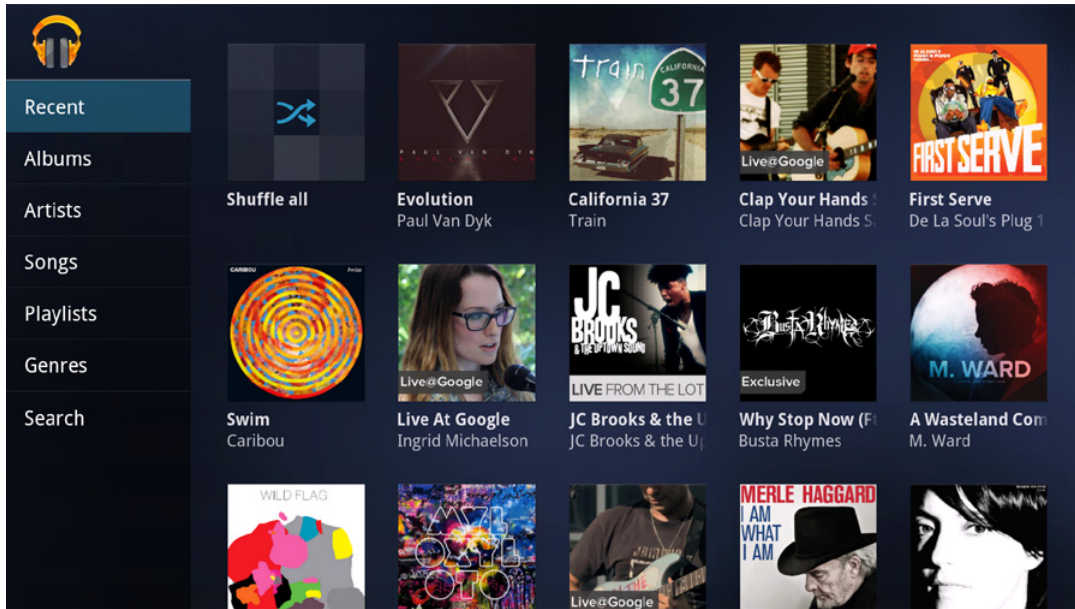

You can use the categories on the left to narrow your search.

---

**Note:** To access local media, use My Media.

---

# Settings

---

# 4

This chapter covers the following topics:

- *Settings Screen*
- *Network Settings*
- *Standby*
- *Picture & Sound*
- *Filter Your Searches and Manage Shortcuts*
- *Video Input*
- *TV*
- *Applications*
- *Date, Time, & Location*
- *Language & Input*
- *Accounts & Sync*
- *About*

## Settings Screen

View and change the NeoTV Prime settings.

➤ **To display the settings screen:**

Select **Home > All Apps > Settings**.

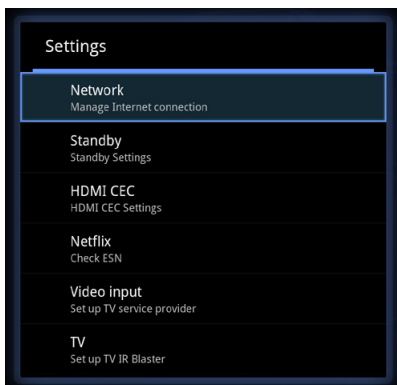

The following settings are available on the Settings menu:

**Network.** Configure your network settings. See [Network Settings](#) on page 27.

**Standby.** Customize the standby settings. See [Standby](#) on page 29.

**HDMI CEC.** Enable or disable CEC. CEC allows the GTV100 remote control to automatically control HDMI-connected devices.

**Netflix.** Check the ESN.

**Video input.** Select an available source, add a device manually, or use a generic video source. See [Video Input](#) on page 30.

**TV.** If you have a satellite box or cable TV device, specify the settings for the IR blaster cable connection. See [TV](#) on page 32.

**Picture & sound.** Adjust the picture and sound settings. See [Picture & Sound](#) on page 29.

**Search.** Adjust the search results. See [Filter Your Searches and Manage Shortcuts](#) on page 30.

**Applications.** Manage your applications. See [Applications](#) on page 33.

**Language & input devices.** Customize the language and input settings for the NeoTV Prime. See [Language & Input](#) on page 34.

**Accounts & sync.** Enter your accounts and synchronize your online information with the NeoTV Prime. See [Accounts & Sync](#) on page 34.

**About.** View information about your NeoTV Prime and update the firmware. See [About](#) on page 34.

## Network Settings

When you install the NeoTV Prime, the onscreen setup prompts you to specify your network settings. You can use the Network screen to view these settings and to change them.

The following settings are available on the Network menu:

**Ethernet.** Shows if the NeoTV Prime is connected to a network with an Ethernet cable.

**Wi-Fi.** Shows if the NeoTV Prime has joined a network with a Wi-Fi connection.

**Bluetooth settings.** Customize the Bluetooth settings. See [Bluetooth Settings](#) on page 28.

**Status.** Displays the following:

- IP address
- Ethernet MAC address
- Wi-Fi MAC address
- Local network
- Internet

## Wi-Fi Internet Connection

You can connect the NeoTV Prime to your Wi-Fi home network to access the Internet.

### ➤ To set up a Wi-Fi network connection.

- 1 On the Settings menu, select **Network > Wi-Fi**.

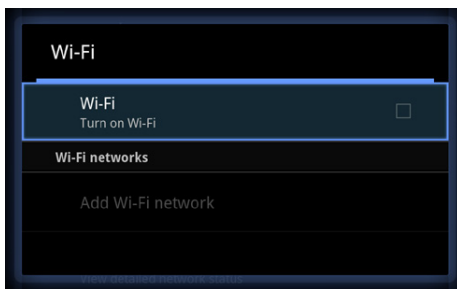

- 2 Select **Turn on Wi-Fi**.

The check box is now selected to show that Wi-Fi is turned on, and the Wi-Fi networks in your area are displayed.

- 3 If you do not see your Wi-Fi network, select **Add Wi-Fi network**, and type in the network name.

- 4 Select your Wi-Fi network and type the password.

The IP setting is displayed. By default, the NeoTV Prime is set to get IP settings dynamically, which works for most networks.

- 5 If you want to use a static IP address (this is an advanced feature), select **Static IP address** and type the IP address.

**6 Select Connect.**

The NeoTV Prime joins the Wi-Fi network.

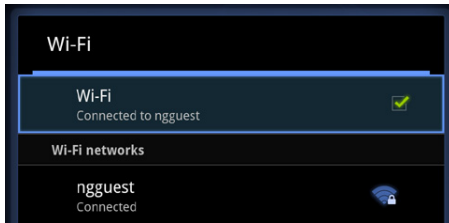

## Ethernet Internet Connection

You can use an Ethernet cable to connect the NeoTV Prime to your home network to access the Internet.

➤ **To set up a wired network connection:**

- 1 Use an Ethernet cable to connect the Ethernet port on the NeoTV Prime to a LAN Ethernet port on your router.
- 2 On the NeoTV Prime Settings menu, select **Network > Ethernet**.

The screen displays the status as Connected.

## Bluetooth Settings

By default, the NeoTV Prime is set up to communicate with Bluetooth devices.

➤ **To view or change the Bluetooth settings:**

Select **Settings > Network Settings > Bluetooth Settings**.

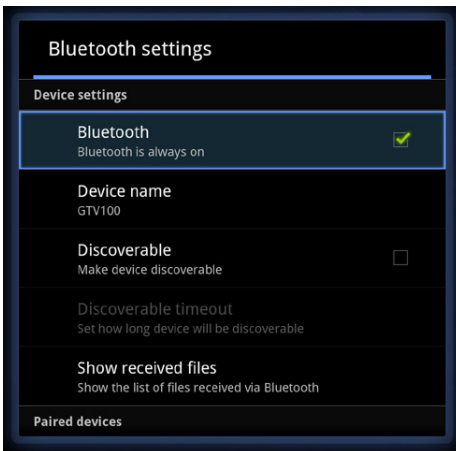

The following settings are available:

**Bluetooth.** Turn Bluetooth on and off. It is on by default.

**Device name.** By default this shows the NeoTV Prime model, which is GTV100.

**Discoverable.** Allow the GTV100 to be discovered by other Bluetooth devices for pairing.

**Discoverable timeout.** Specify the length of time the GTV100 is discoverable.

**Show received files.** View a list of received files.

**Paired devices.** This should show Netgear NeoTV Prime Connected.

**Find nearby devices.** Locate nearby Bluetooth devices.

## Standby

Standby mode conserves energy while the NeoTV Prime is not in use. Specify the standby settings to prioritize wake time or energy conservation.

**Suspend.** Allows the NeoTV Prime to wake faster, but conserves less energy than passive mode.

**Passive.** Conserves more energy than suspend mode, but takes longer to wake the NeoTV Prime.

The NeoTV Prime enters standby mode when you press the Power button. To turn on and wake the NeoTV Prime, press the **Power** button again.

## Picture & Sound

Specify the picture and sound settings.

**Resolution.** Specify the resolution. The options are Auto, 720p, 1080i, and 1080p.

**Picture size.** Adjust the NeoTV Prime display to fit the dimensions of your TV screen.

**Screen saver.** Customize the screen saver.

**Screen off timeout.** Specify how long the screen continues displays when no media is being played and no one is using the remote control.

**Sound.** Adjust the volume.

### Adjust the Picture Display

You can adjust the NeoTV Prime picture display to match the size of your TV.

#### ➤ To adjust the picture display:

- 1 On the Picture & Sound menu, select **Picture size**.
- 2 When prompted, return the picture size to its factory settings.
- 3 Follow the onscreen instructions to use the up, down, left, and right arrow buttons on the remote control to set the dimensions of the display.

## Filter Your Searches and Manage Shortcuts

Control the search results and display.

**Searchable items.** Select or remove the items included in search results, such as Web, Apps, aVia, Browser, and Play Movies & TV.

**Clear shortcuts.** Remove the shortcuts from the display.

## Video Input

You can select the source that the NeoTV Prime uses to receive video input.

The NeoTV Prime detects and displays a list of available sources. If your device does not display in the list or if you use a satellite box or cable TV device, you must add your device manually.

### ➤ To add a video input device manually:

- 1 On the Video input menu, select **Add device manually**.

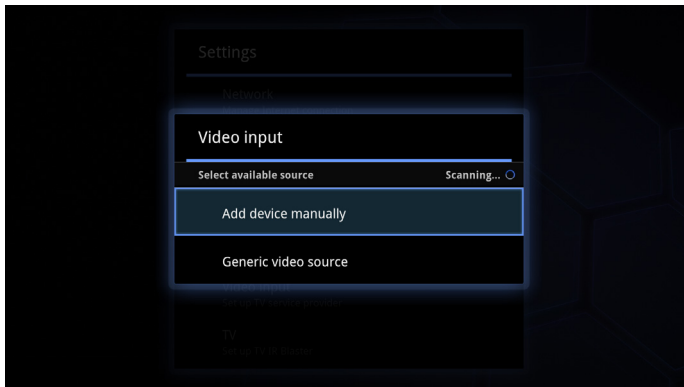

The NeoTV Prime attempts to display the video signal from your device. You might need to use your device's remote control to display video.

- 2 When you see your device's video signal playing on the TV screen, select **Next**.

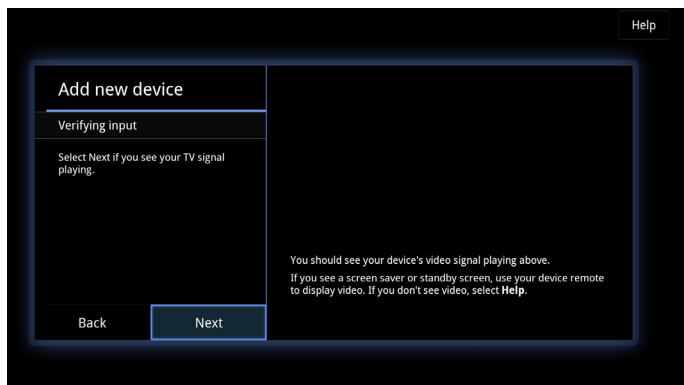

3 Select your device type from the list.

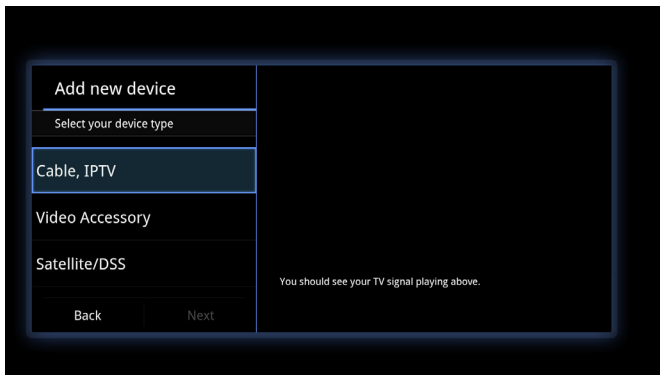

- If you use a satellite box or cable TV device, you must enter information about your device, including the brand (manufacturer) and model number. (The Command set field should be filled in automatically after you enter the brand and model number.)
- If the model of your device does not appear in the list of selections after you enter the brand, update the firmware on the NeoTV Prime. See [Update Firmware](#) on page 34. When the firmware update is complete, repeat Steps 1-3. Firmware updates sometimes add more devices and model numbers to the list of selections.

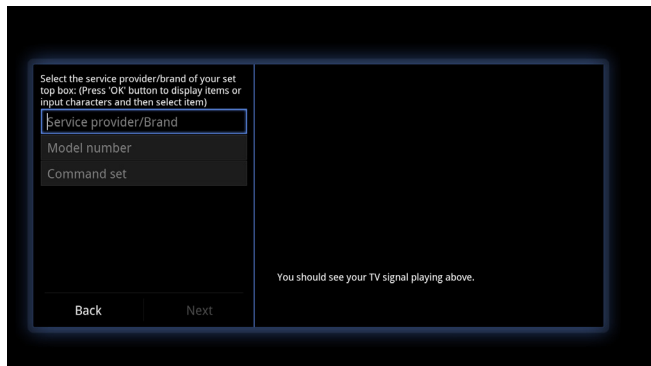

4 Select **Next** and follow the onscreen instructions to complete video input setup.

## TV

You can use the IR blaster and GTV100 remote control to adjust your TV settings such as the channel and volume.

➤ **To set up the GTV100 remote control for your TV:**

- 1 Connect the IR blaster cable to the NeoTV Prime and position the IR blaster near your TV.



← Position this end of the cable near your TV.

**IR blaster cable**

- 2 On the TV menu, select **TV setting**.



- If you use a satellite box or cable TV device, enter the brand (manufacturer) and model number of your device. (The Command set field should be filled in automatically after you enter the brand and model number.)
- If the model of your device does not appear in the list of selections after you enter the brand, try entering your service provider in the top field instead.

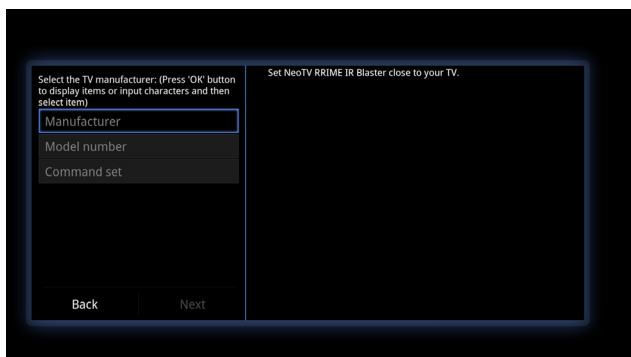

- 3 Select **Next** and follow the onscreen instructions to complete the setup process.

## Applications

Control which applications you can access through the NeoTV Prime.



**WARNING:**

The Applications settings are for advanced users. Changing these settings can prevent your NeoTV Prime from working correctly or reduce performance.

**Unknown sources.** Allow applications from sources other than Google.

**Manage applications.** Manage the applications that you use.

**Running services.** View which services are currently running.

**Development.** Work with applications that you are developing. For more information, visit <https://developers.google.com/tv/>.

## Date, Time, & Location

Specify how you want to control the date and time, and specify your location so that TV information is accurate.

### *Date & Time*

**Automatic.** If you select this option, the date and time are automatically updated from the Internet based on your location. NETGEAR highly recommends that you select this option since certain services require the correct date and time.

**Set date.** Manually set the date.

**Set time.** Manually set the time.

**Select the time zone.** Manually select the time zone.

**Use 24-hour format.** Specify a 24-hour time display. For instance, display 13:00 instead of 1:00 pm.

**Select date format.** Select the date format that you prefer.

### *Location*

**Select country.** Select the country where you are located.

**Set location.** Specify the local ZIP code.

## Language & Input

Customize the language and input settings for the NeoTV Prime.

**Manage IP remotes.** If you use an IP remote, you can specify the setup here.

**Chrome to TV.** Download your Chrome settings to the TV so that they are available when you use NeoTV Prime.

**Pointer speed.** Adjust the speed of the cursor on the TV display.

**Select language.** Select the language for the TV display.

**Current keyboard.** Specify details about a keyboard currently connected to the USB port on the side of the NeoTV Prime.

## Accounts & Sync

Enter your accounts and synchronize your online information with the NeoTV Prime.

**Background data.** Selected by default.

**Auto-sync.** Automatically synchronize your online accounts with the NeoTV Prime. This is selected by default.

**Manage accounts.** Enter your accounts for services such as Netflix so that you can access them through the NeoTV Prime.

**Privacy.** Specify settings for reporting, reset the data, or enable video history.

**Storage.** View available storage on a USB storage device connected to the USB port of the NeoTV Prime, or unmount the device.

**Accessibility.** Set up accessibility features such as TalkBack and allow accessibility scripts to be downloaded.

## About

View information about your NeoTV Prime, including the firmware version, build number, and serial number. You can also update the NeoTV Prime firmware and access the system tutorial.

### Update Firmware

#### ➤ To update the NeoTV Prime firmware:

Select **System updates** to check whether a firmware update is available. If a firmware update is available, follow the onscreen instructions to install the new firmware on your NeoTV Prime.

# Technical Specifications

---



The following table includes technical specifications for the NeoTV Prime.

Feature	
Data and routing protocol	TCP/IP, DHCP
Power adapter	12V, 1.5A
Dimensions	113 mm x 113 mm x 24 mm
Weight	138 g
Interface	LAN: 10BASE-T or 100BASE-Tx, RJ-45 WLAN: 802.11.n/g/b

# Notification of Compliance

---

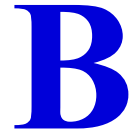

## NeoTV Prime with Google TV GTV100

### **Regulatory Compliance Information**

Note: This section includes user requirements for operating this product in accordance with National laws for usage of radio spectrum and operation of radio devices. Failure of the end-user to comply with the applicable requirements may result in unlawful operation and adverse action against the end-user by the applicable National regulatory authority.

Note: This product's firmware limits operation to only the channels allowed in a particular Region or Country. Therefore, all options described in this user's guide may not be available in your version of the product.

### **FCC Requirements for Operation in the United States**

#### **FCC Information to User**

This product does not contain any user serviceable components and is to be used with approved antennas only. Any product changes or modifications will invalidate all applicable regulatory certifications and approvals.

#### **FCC Guidelines for Human Exposure**

This equipment complies with FCC radiation exposure limits set forth for an uncontrolled environment. This equipment should be installed and operated with minimum distance of 20 cm between the radiator and your body.

This transmitter must not be co-located or operating in conjunction with any other antenna or transmitter.

#### **FCC Declaration of Conformity**

We, NETGEAR, Inc., 350 East Plumeria Drive, San Jose, CA 95134, declare under our sole responsibility that the NeoTV Prime with Google TV GTV100 complies with Part 15 Subpart B of FCC CFR47 Rules. Operation is subject to the following two conditions:

- This device may not cause harmful interference, and
- This device must accept any interference received, including interference that may cause undesired operation.

#### **FCC Radio Frequency Interference Warnings & Instructions**

This equipment has been tested and found to comply with the limits for a Class B digital device, pursuant to Part 15 of the FCC Rules. These limits are designed to provide reasonable protection against harmful interference in a residential installation. This equipment uses and can radiate radio frequency energy and, if not installed and used in accordance with the instructions, may cause harmful interference to radio communications. However, there is no guarantee that interference will not occur in a particular installation. If this equipment does cause harmful interference to radio or television reception, which can be determined by turning the equipment off and on, the user is encouraged to try to correct the interference by one or more of the following methods:

- Reorient or relocate the receiving antenna.
- Increase the separation between the equipment and the receiver.
- Connect the equipment into an electrical outlet on a circuit different from that which the radio receiver is connected.
- Consult the dealer or an experienced radio/TV technician for help.

**FCC Caution**

- Any changes or modifications not expressly approved by the party responsible for compliance could void the user's authority to operate this equipment.
- This device complies with Part 15 of the FCC Rules. Operation is subject to the following two conditions: (1) This device may not cause harmful interference, and (2) this device must accept any interference received, including interference that may cause undesired operation.
- For product available in the USA market, only channel 1~11 can be operated. Selection of other channels is not possible.
- This device and its antenna(s) must not be co-located or operation in conjunction with any other antenna or transmitter.

**IMPORTANT NOTE: Radiation Exposure Statement:**

This equipment complies with IC radiation exposure limits set forth for an uncontrolled environment. This equipment should be installed and operated with minimum distance 20cm between the radiator & your body.

**Caution:**

Ce dispositif est conforme à la norme CNR-210 d'Industrie Canada applicable aux appareils radio exempts de licence. Son fonctionnement est sujet aux deux conditions suivantes: (1) le dispositif ne doit pas produire de brouillage préjudiciable, et (2) ce dispositif doit accepter tout brouillage reçu, y compris un brouillage susceptible de provoquer un fonctionnement indésirable.

**NOTE IMPORTANTE: Déclaration d'exposition aux radiations:**

Cet équipement est conforme aux limites d'exposition aux rayonnements IC établies pour un environnement non contrôlé. Cet équipement doit être installé et utilisé avec un minimum de 20 cm de distance entre la source de rayonnement et votre corps.

**Interference Reduction Table**

The table below shows the recommended minimum distance between NETGEAR equipment and household appliances to reduce interference (in feet and meters).

Household Appliance	Recommended Minimum Distance (in feet and meters)
Microwave ovens	30 feet / 9 meters
Baby Monitor - Analog	20 feet / 6 meters
Baby Monitor - Digital	40 feet / 12 meters
Cordless phone - Analog	20 feet / 6 meters
Cordless phone - Digital	30 feet / 9 meters
Bluetooth devices	20 feet / 6 meters
ZigBee	20 feet / 6 meters