

BABYBJÖRN®

OWNER'S MANUAL

BABYBJÖRN BABY CARRIER MIRACLE

Soft cotton mix

www.babybjorn.com



ADJUSTABLE DESIGN WITH ERGONOMIC WAIST BELT
PROVIDES SUPERIOR COMFORT



Fits your baby perfectly
from day one.



Extra soft and gentle on
baby's sensitive skin.



Once a little older (approx.
4 months) you can carry your
child facing forwards.

IMPORTANT!

Please read this manual carefully
before using the baby carrier.
Save it for later reference.

¡IMPORTANTE!

Lee con atención este manual antes
de usar el producto. Consérvalo para
usarlo en el futuro.

IMPORTANTE!

Leia este manual com atenção antes
de usar. Depois guarde-o para uso
posterior.

VIKTIGT!

Vänligen läs denna manual noggrant
före användning. Behåll den för senare
bruk.

VIKTIG!

Vennligst les denne manualen grundig før bruk. Behold den for senere referanse.

VIGTIGT!

Læs venligst denne manual grundigt inden anvendelse. Opbevar den til senere brug.

TÄRKEÄÄ!

Lue tämä käyttöohje tarkasti ennen käyttöä. Sästä ohje myöhempää tarvetta varten.

WAŻNE!

Przed przystąpieniem do użytkowania nosidełka prosimy uważnie przeczytać niniejszą instrukcję i zachować ją na przyszłość.

English	6-9
Español	10-13
Português	14-17
Svenska	18-21
Norsk	22-25
Dansk	26-29
Suomi	30-33
Polski	34-37

CONGRATULATIONS ON YOUR LITTLE MIRACLE!

Correct support and the perfect fit are vital in a baby carrier that embraces the delicate body of a newborn. BABYBJÖRN Baby Carrier Miracle has been specially designed to fit your child from the moment it is born (at least 3,5 kg and 53 cm long) all the way up to 12 kg (approx. 15 months old).

The baby carrier's design ensures you can carry your child in comfort in a variety of ways, even when your child grows and gains weight. Simple adjustments transfer the weight between your waist, hips and shoulders until you find the position that suits you best. You also have the option of carrying the child high on your chest – which we recommend for newborns – or lower down when your child is bigger.

We hope that you and your child will both enjoy using BABYBJÖRN Baby Carrier Miracle. Please do get in touch with us if you have any questions or comments.

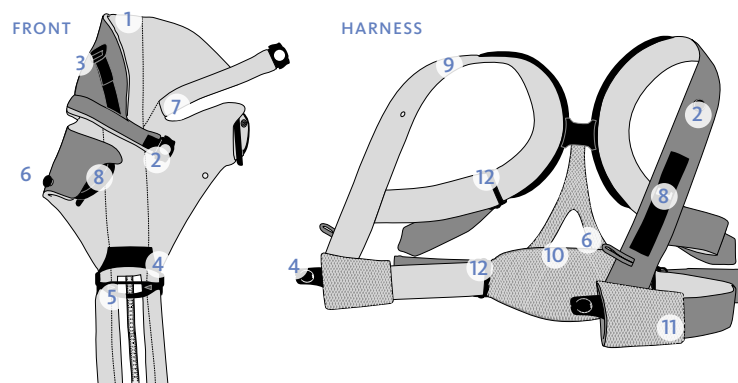

1: Head support • 2: Head support buckle • 3: Head support strap • 4: Double-buckle • 5: Size adjustment
6: Leg strap • 7: Armhole • 8: Side latch • 9: Shoulder strap • 10: Back support • 11: Support belt • 12: Adjuster buckle

USING THE BABYBJÖRN BABY CARRIER MIRACLE

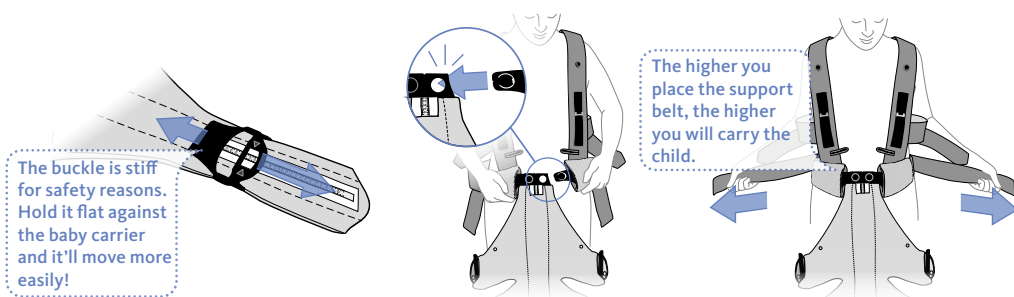

1. Set the baby carrier to your child's approximate length (in centimetres). You may need to adjust the length setting once the child is in the baby carrier.
2. Put on the harness and fasten it to the front of the baby carrier by locking the double buckle. It's locked when you hear a click. Leave the shoulder straps loose!
3. Adjust the support belt by pulling the lower straps. Check that they are the same length so that the back support is centred.

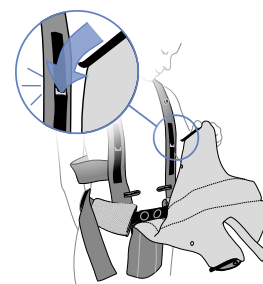

4. Fasten the latch on one side by inserting the hook into the slot. Check that it is firmly locked.



5. Place the child in the baby carrier, facing you. Each leg should be on its respective side of the baby carrier front and the child's arms should be placed through the armholes.

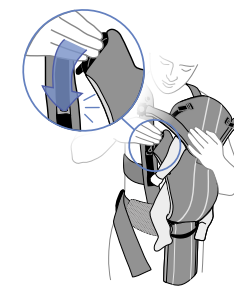

6. Fasten the latch on the other side by inserting the hook into the slot. For smaller children weighing between 3,5 and 4,5 kg (8–11 lbs), fasten the leg straps on both sides as well.

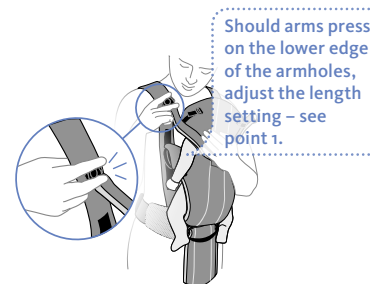

7. Fasten the head support on both sides. Place your thumb behind the knob on the harness. Click into place!

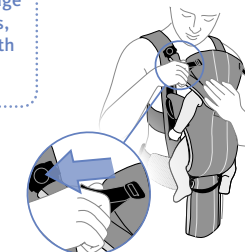

8. You can adjust the head support by carefully pulling on the head support straps. Make sure that there is enough air space around your child's head.

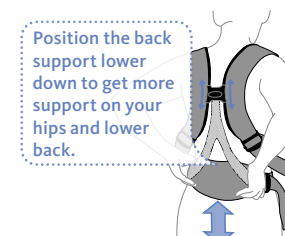

9. Adjust the back support to a comfortable position.

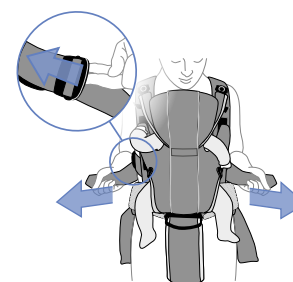

10. Adjust the shoulder straps. The more you tighten them, the more weight you will take on your shoulders. To reduce the load on your shoulders, simply lift the outer edges of the adjuster buckles.

THE CHILD'S POSITION IN THE BABY CARRIER



For secure closeness and control of your child, carry your newborn facing you high up on your chest.

Once a bit bigger, your child can be carried lower down to relieve pressure on your shoulders. From approx. 4 months old (or when their neck is strong enough) you can also switch between carrying your child facing you or forwards.

REMOVING THE CHILD/TAKING THE BABY CARRIER OFF

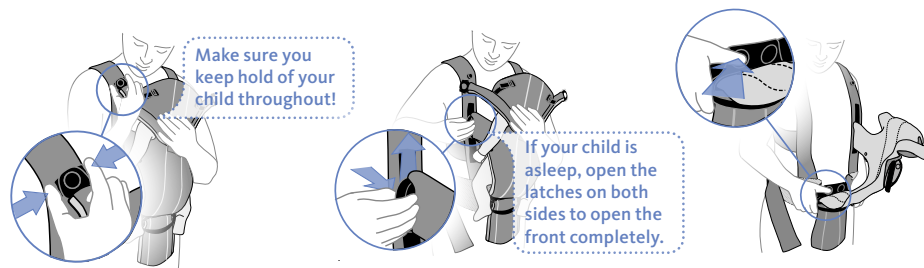

1. Start by unfastening the leg straps, if they are being used. Then unfasten the head support on both sides. Place your thumb and index finger on either side of the button. Press and lift off.
2. Unfasten the latch on one side. Place your thumb on the grooved marking on the coloured back of the hook, press and pull upwards. You can now lift the child out.
3. Unfasten the double buckle. For safety reasons, you must push the buckle together before pressing the button.

VARIATION FOR INCREASED CARRYING COMFORT

Varying the load points is the best way to optimise carrying comfort and duration. Try out different positions to find out what feels best for you and your child. Try some of the tips below.

- **TAKE MORE WEIGHT ON YOUR WAIST/HIPS**
Loosen the shoulder straps slightly to take the load off your shoulders and transfer it to the support belt.
- **TAKE MORE WEIGHT ON YOUR SHOULDERS**
Loosen the support belt and tighten the shoulder straps to increase the load on your shoulders. You can also vary the load point on your shoulders by moving the back support up or down.
- **CARRY YOUR CHILD HIGHER UP**
Tighten the shoulder straps while lifting the child from underneath to move the child closer to you and higher up on your chest.
- **CARRY YOUR CHILD LOWER DOWN**
Loosen both the upper and lower straps. Pull the support belt and back support down until the child is in the desired position. Tighten the straps.

WASHING INSTRUCTIONS

Wash separately.
Use an eco-friendly, gentle, bleach-free detergent.



TECHNICAL INFORMATION

Main material:
60% cotton
40% polyester

Lining:
100% cotton

All of the materials used in the baby carrier are guaranteed free from harmful and allergenic substances, and comply with the requirements of the Oeko-Tex Standard 100, class 1 for baby products.

SAFETY APPROVAL

BABYBJÖRN Baby Carrier Miracle meets the safety requirements of EN 13209-2:2005.

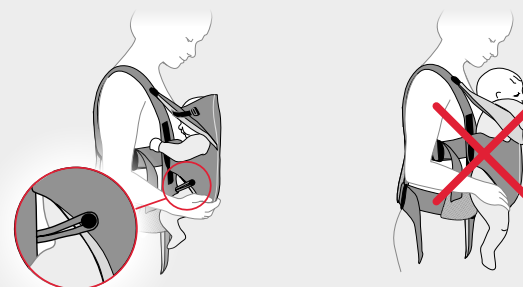

IMPORTANT! The leg straps should be used for children weighing between 3.5 and 4.5 kg (8–11 lbs) in order to reduce the size of the leg openings.

IMPORTANT! The child's arms should always go through the armholes and never hang over the head support.

⚠ WARNING! FALL HAZARD!

- Carefully read and follow all instructions before assembling and using the baby carrier.
- This baby carrier is intended for use by adults only.
- Only use this baby carrier for children weighing between 3.5 kg and 12 kg (8–26 lbs).
- Always adjust the baby carrier to your child's size (minimum 53 cm) according to instructions.
- Adjust the leg openings to fit the baby's legs snugly.
- The leg straps must be used for children weighing between 3.5 and 4.5 kg (8–11 lbs).
- Small children can fall through a leg opening.
- The child must face you (inwards) until he/she can hold his/her head upright (approx. 4 months).
- The baby carrier must not be used as a back carrier.
- The baby carrier may only be used when you are walking, sitting or standing.
- The baby carrier is NOT suitable for use during sports or other leisure activities.
- The baby carrier must not be used as a car seat.
- Your balance may be adversely affected by your own or your child's movements.
- To keep the child safe in the baby carrier when you bend over or lean forward, remember to bend at the knees NOT the waist.
- Make sure the child's nose and mouth have sufficient space for breathing in the baby carrier.
- Avoid dressing your child too warmly.
- Check that all buckles are securely buttoned/closed before using the baby carrier.
- Never use a damaged baby carrier.

BABYBJÖRN®

Denmark Tel: +45 33 939 499

FinlandTel: +358 020 7914313

Norway Tel: +47 21 31 94 30

Poland Tel: +48 22 727 02 69

Portugal Tel: +34 902 111 881

Spain Tel: +34 902 111 881

Sweden Tel: +46 (0)370 838 50

UKTel: +44 (0) 844 8154 813



Read more about our collaboration with paediatricians at

www.babybjorn.com

Art. 096

The mark BABYBJÖRN is protected by trademark registrations in several countries. Design and patent applications pending.
Baby Carrier Miracle © BabyBjörn AB 2011.

For more information, please contact info@babybjorn.se

© BabyBjörn AB, 2011. BabyBjörn AB, SE-330 10 Bredaryd, Sweden

www.babybjorn.com