

FOAM DOOR: CUT DOOR SHAPE OUT OF ¼" LUAN. APPLY 4" WIDE FOAM TO FRONT AND BACK TO FRAME OUT PANELS AND MAKE THE DOOR 2¼" THICK.

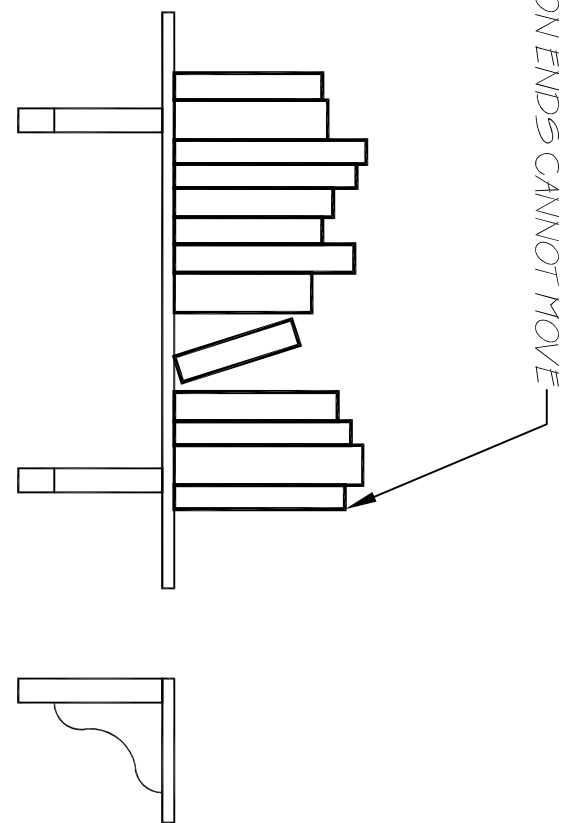

MIDDLE BOOKS CAN BE KNOCKED OFF FROM BEHIND WALL

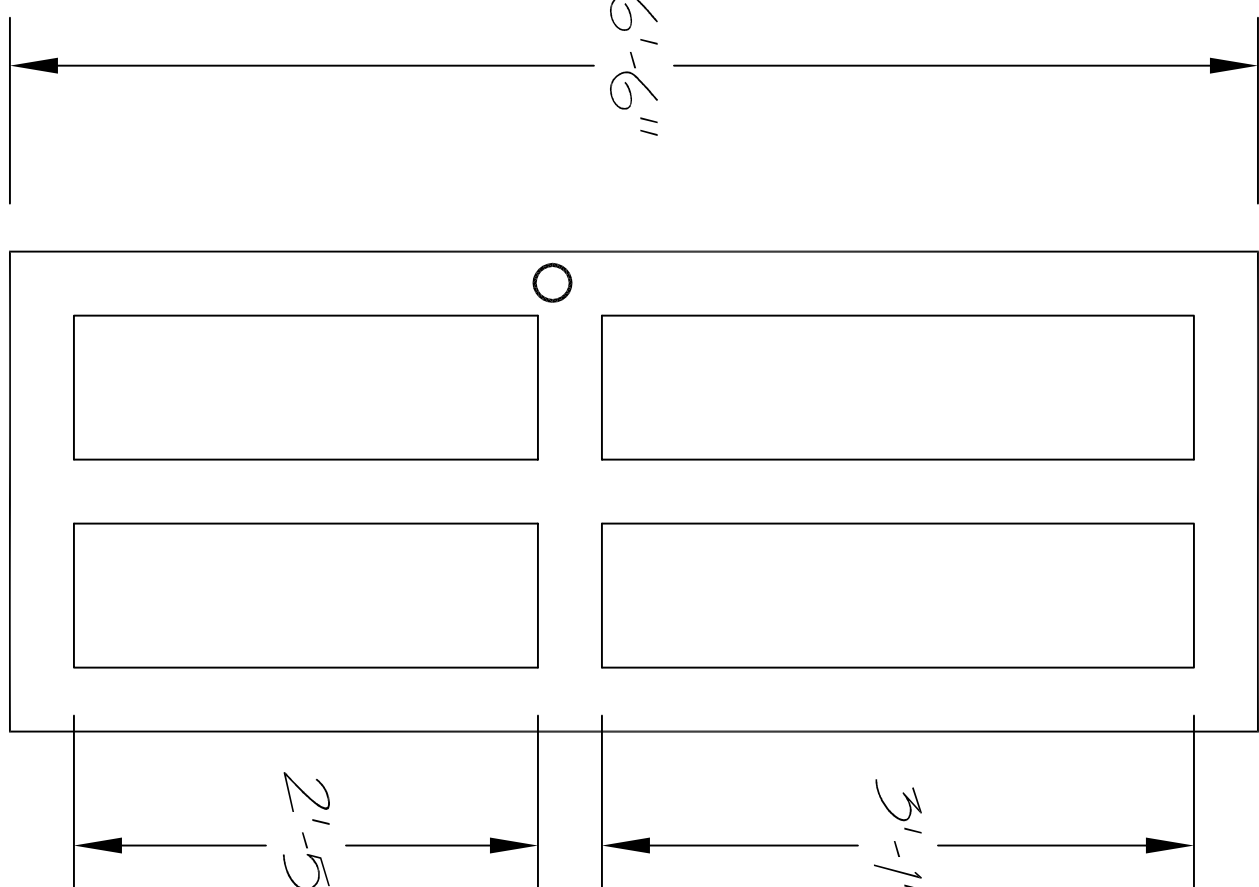

WOODEN DOOR: CUT DOOR SHAPE OUT OF ¼" LUAN. APPLY ¼" FRONT AND BACK TO FRAME OUT PANELS AND MAKE THE DOOR 1¾" THICK.

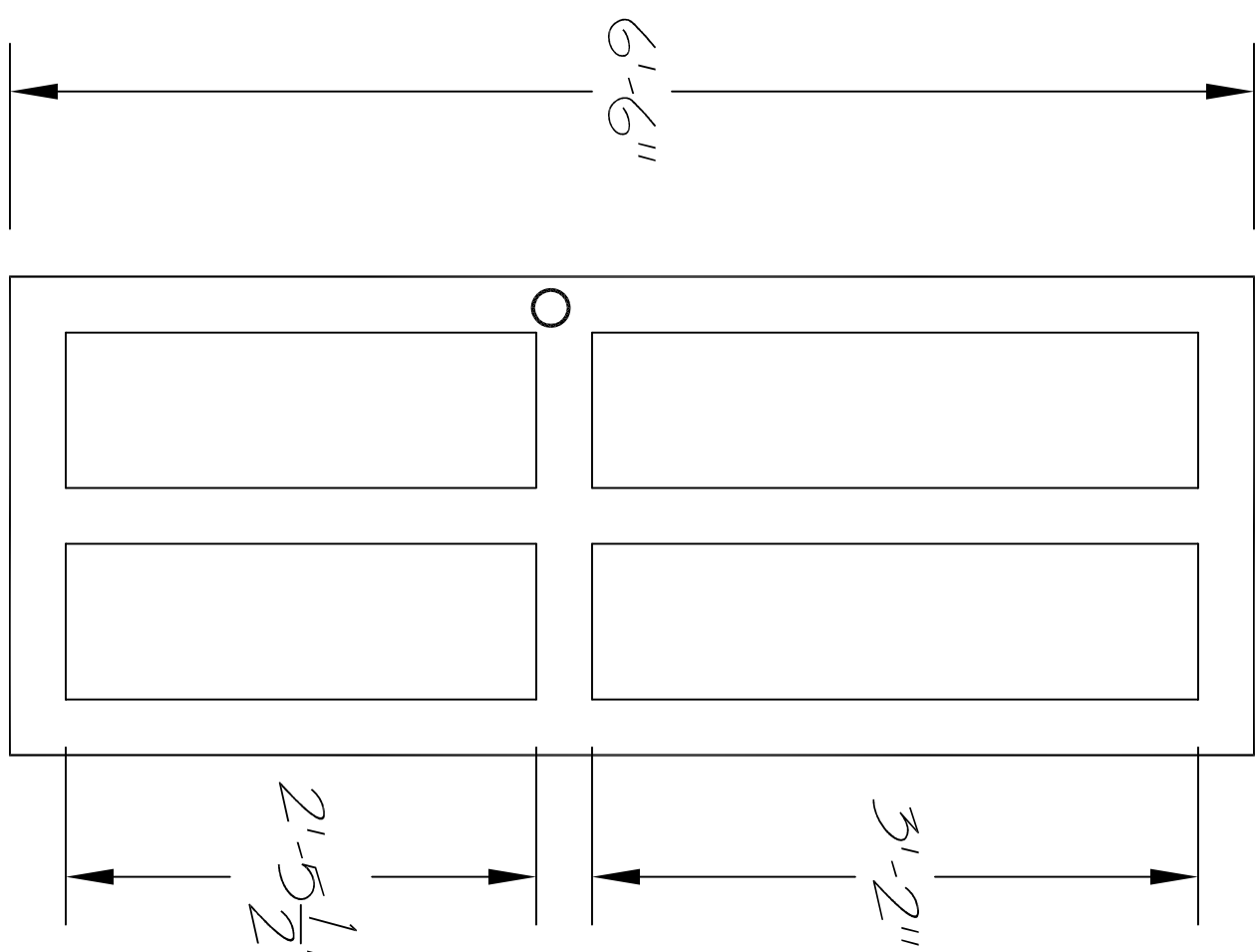

EITHER OF THESE METHODS FOR THE DOOR IS FINE. BUILD ONLY ONE.

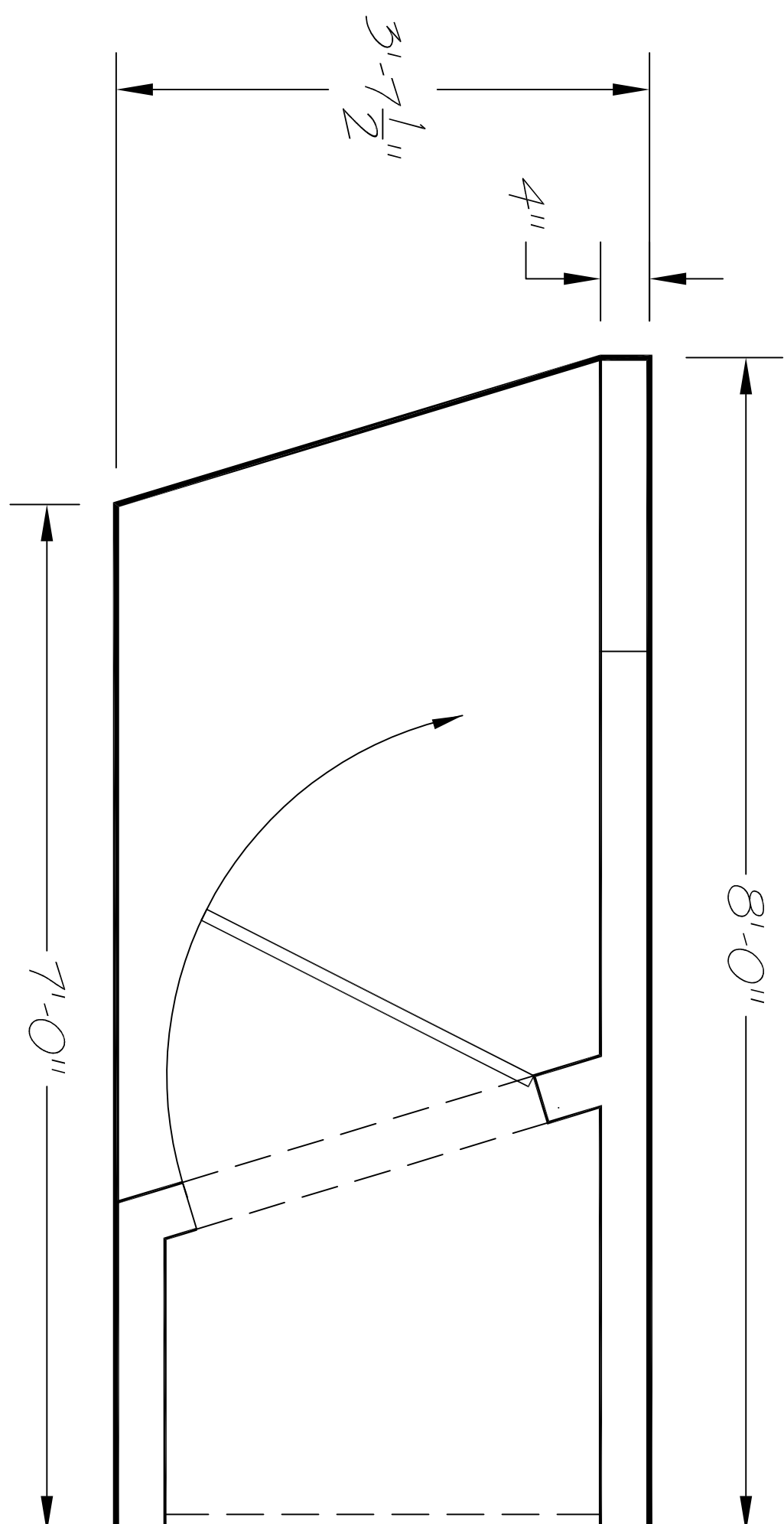

CONNECT THESE TWO WALLS WITH A SINGLE STICK ABOVE HEAD HEIGHT.

APPLY 5½" LUAN STRIPS AS BASEBOARD AND CORNICE.

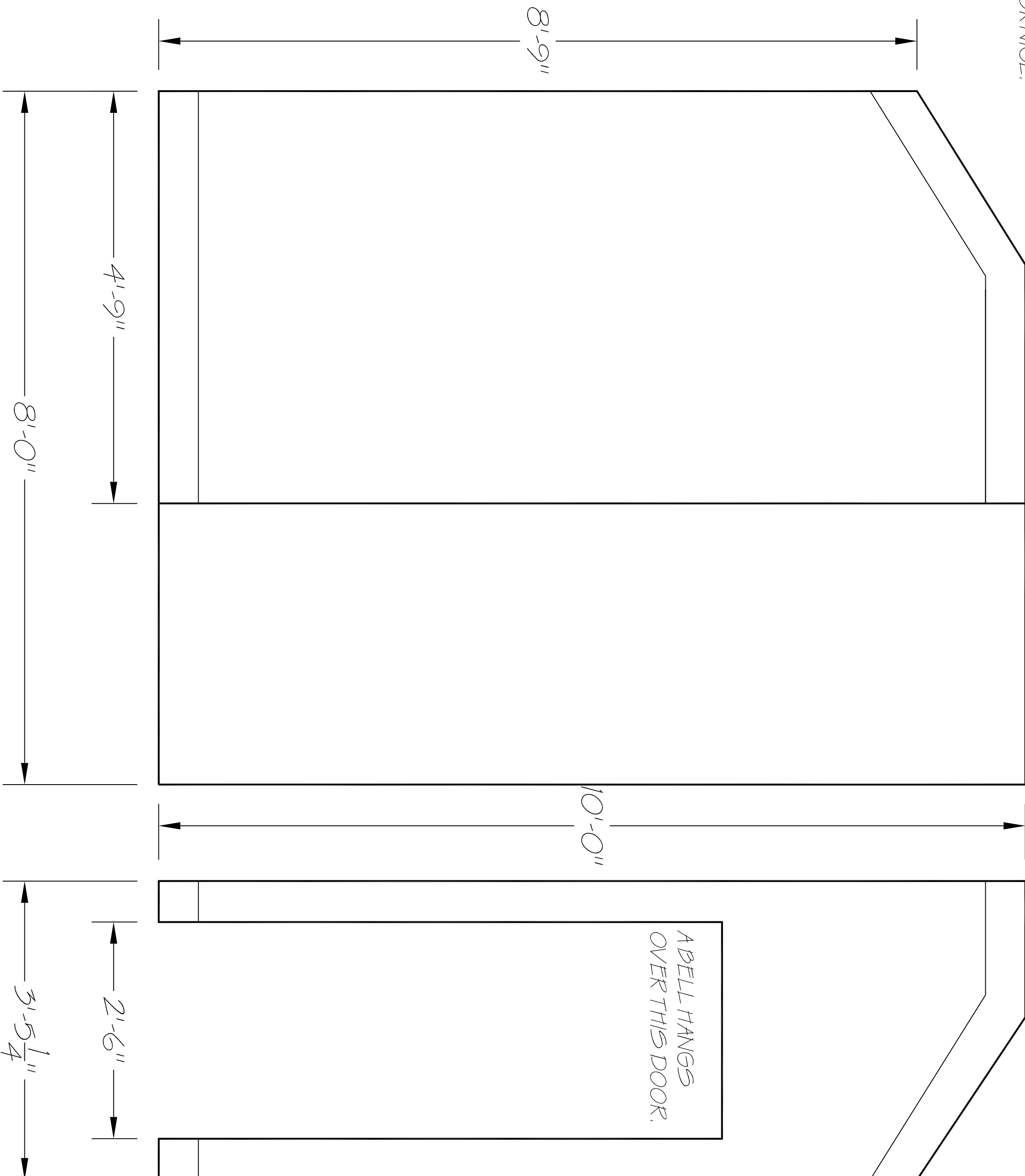

A BELL HANGS OVER THIS DOOR.

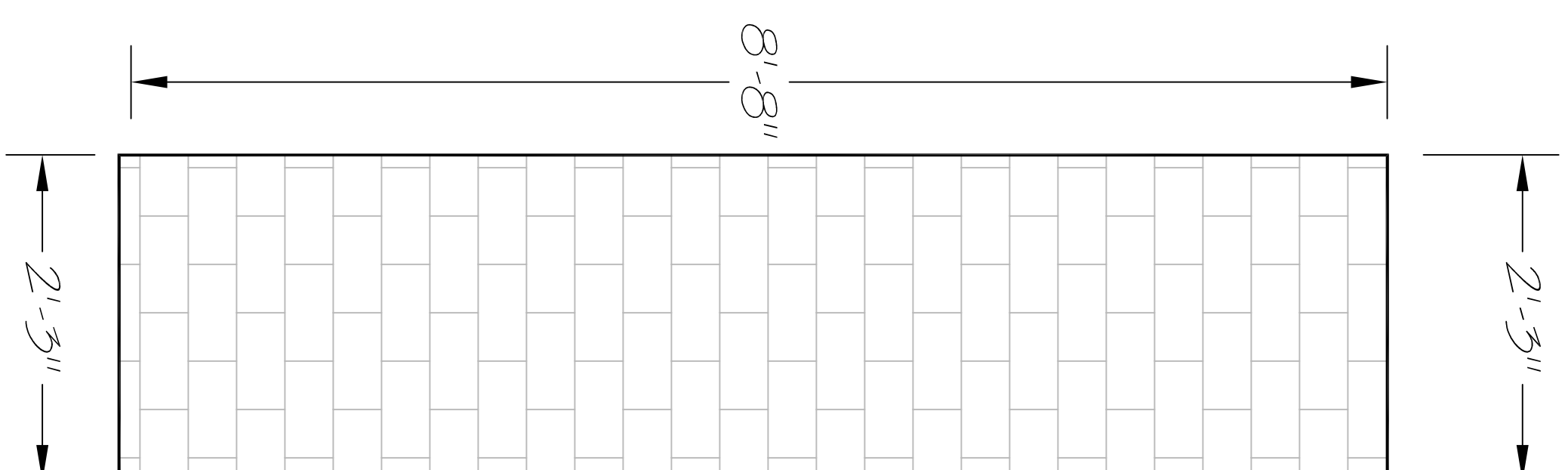

PREFER STRAIGHT-CASTERS WITH OFF-STAGE WAGON BRAKES.)
THESE WALLS SHOULD COME APART FROM EACH OTHER AND FROM THE WAGON FOR STORAGE ON THE TRUCK.

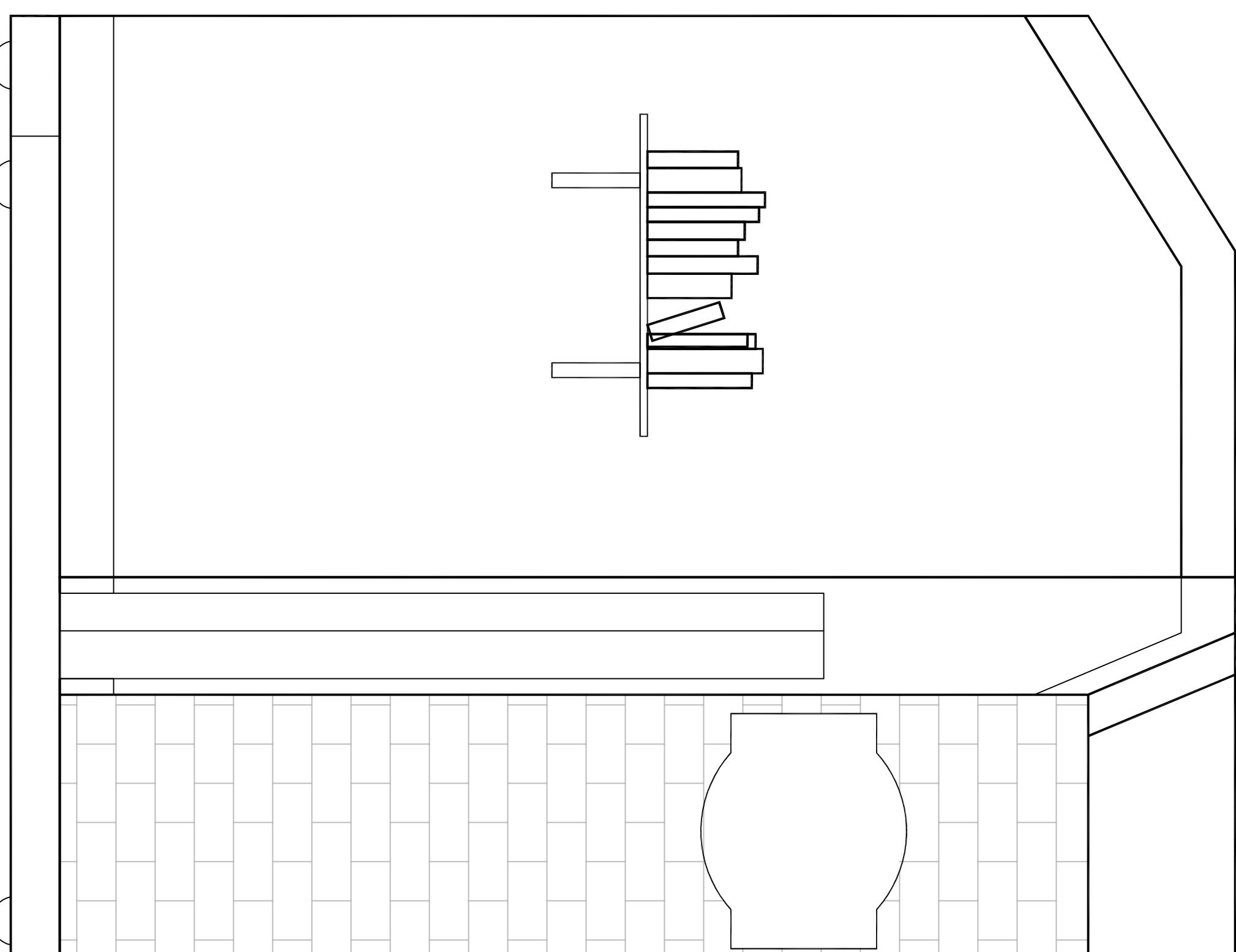

THIS WILL BE PAINTED TO LOOK LIKE AN EXTERIOR WALL.

A SIGN GETS HUNG ON IT. THE SIGN SPINS MYSTERIOUSLY AT ONE POINT. IT IS OPERATED FROM BEHIND. USE WOOD OR FOAM.

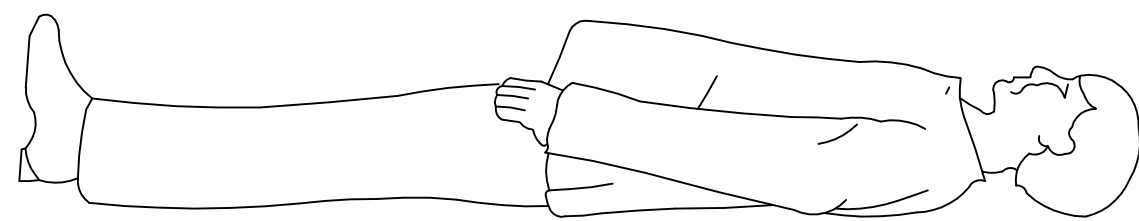
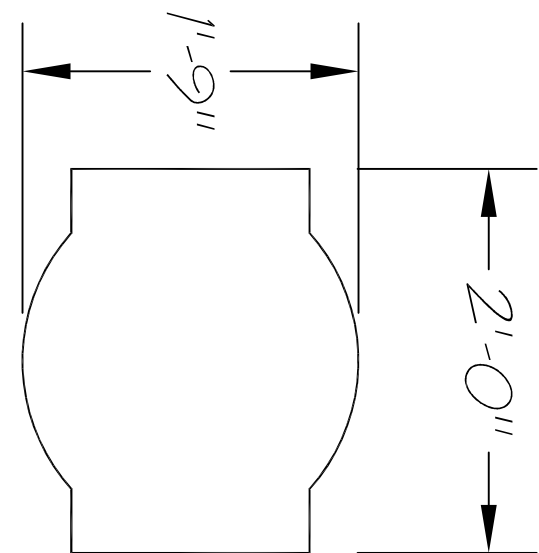

PerSeverence Productions
ACHRISTMAS CAROL
DIRECTED BY SCOTT SEVERENCE
SET DESIGN BY MATT KIZER
TECHNICAL DIRECTOR STAN ZABECKI

WALLS FOR
SCROOGE'S OFFICE
SCALE: 1" = 1'-0"