

SIDE WALLS SEPARATE FROM FRONT AND BACK.
ALL FOUR SIDES LOAD ONTO THE TRUCK SEPARATELY.

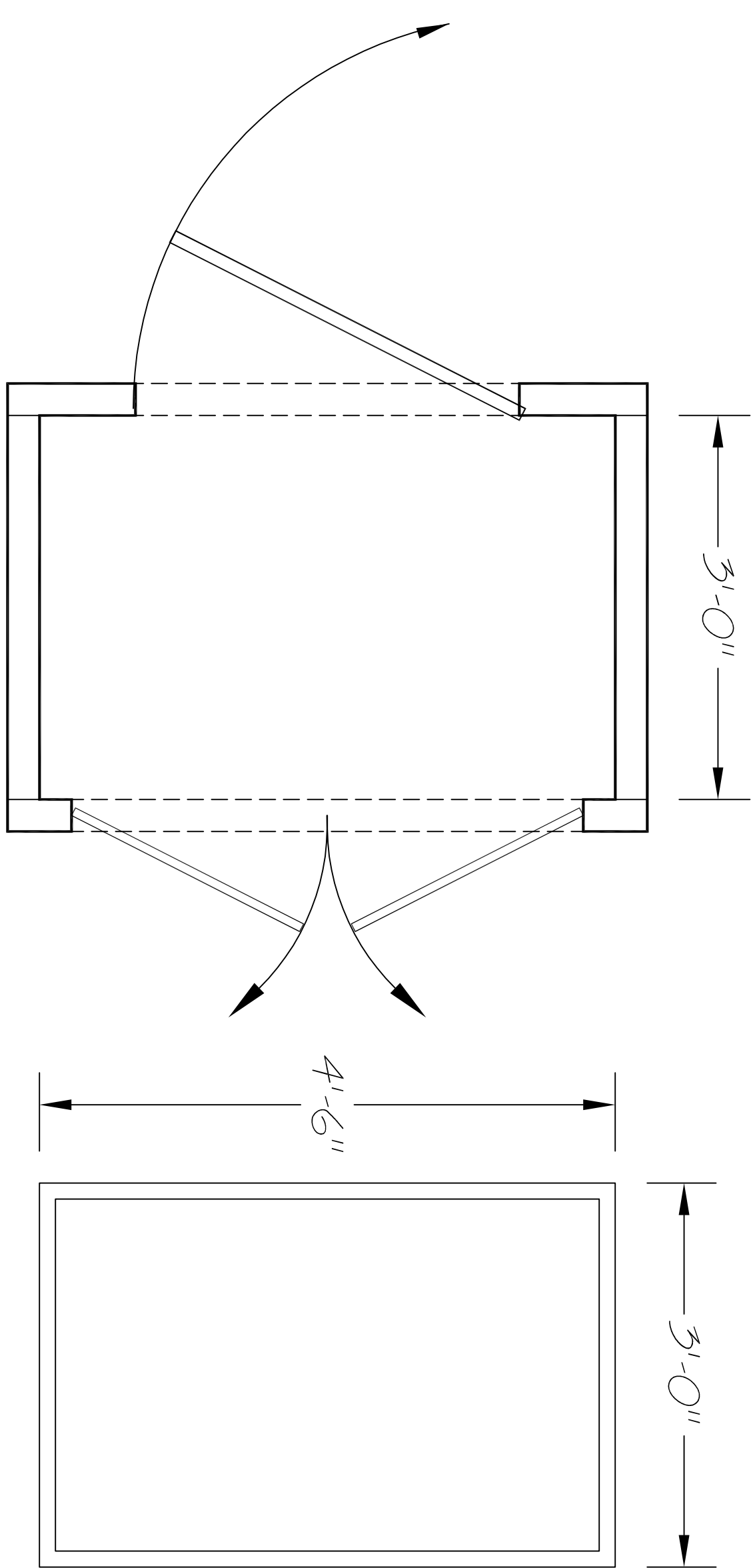
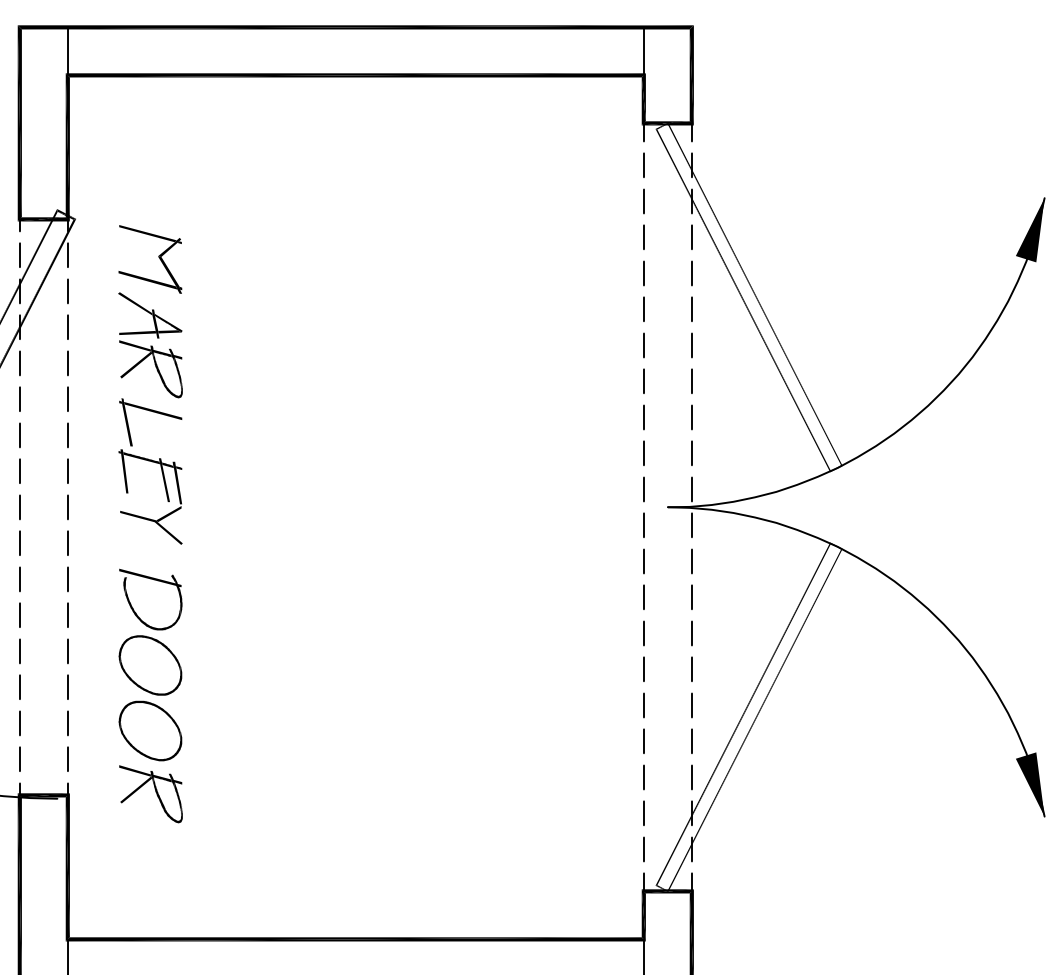
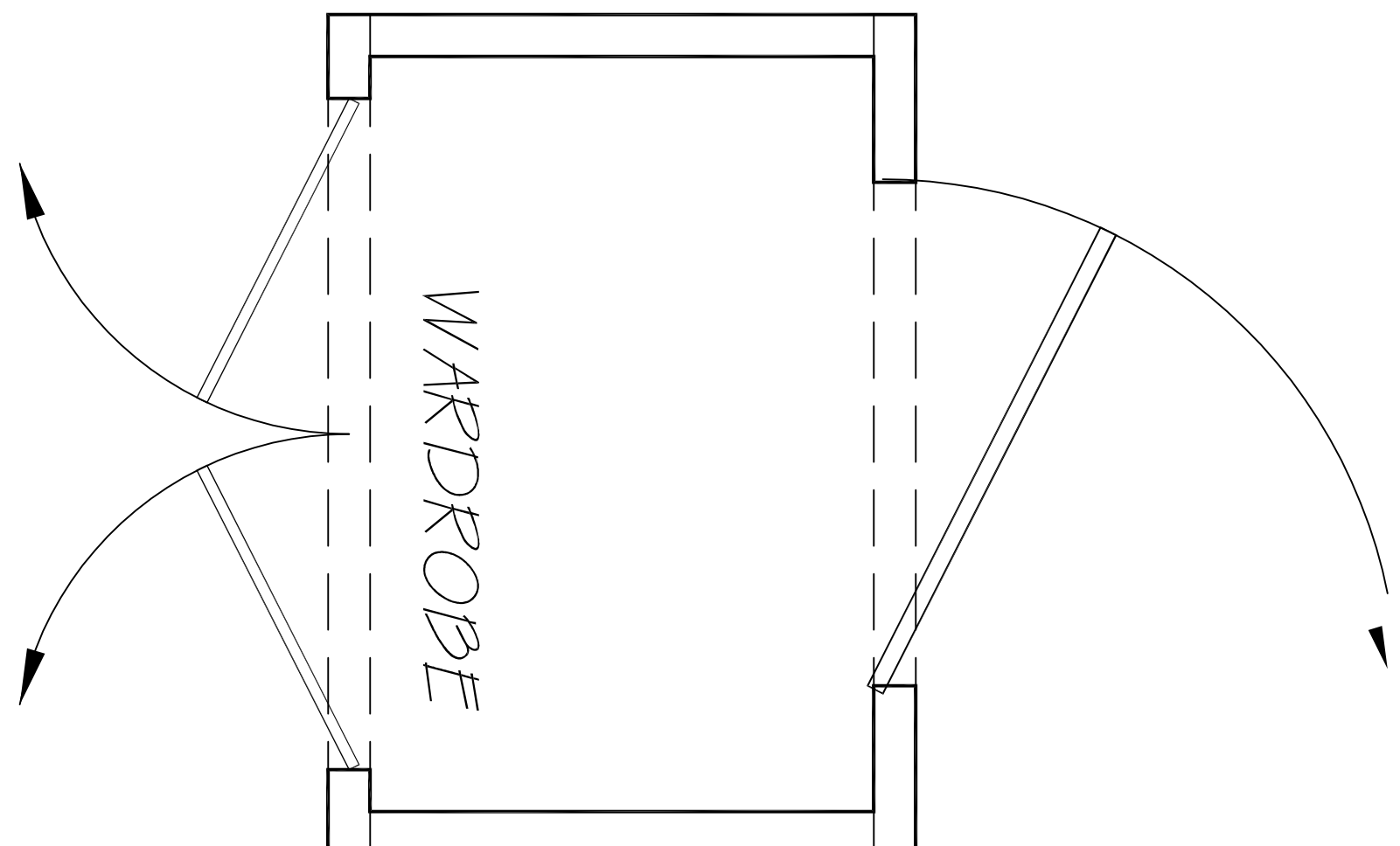

BUILD A 2x4 OR STEEL ROLLING FRAME FOR THE UNIT TO RIDE ON. WALLS CONNECT TO IT. IT IS AN OPEN-TOP WAGON, ALLOWING AN ACTOR INSIDE THE WARDROBE TO WALK THE UNIT AROUND FROM INSIDE.

THIS TRIM IS AT THE FRONT
EDGE OF THE WARDROBE.

CROWN MOLDING

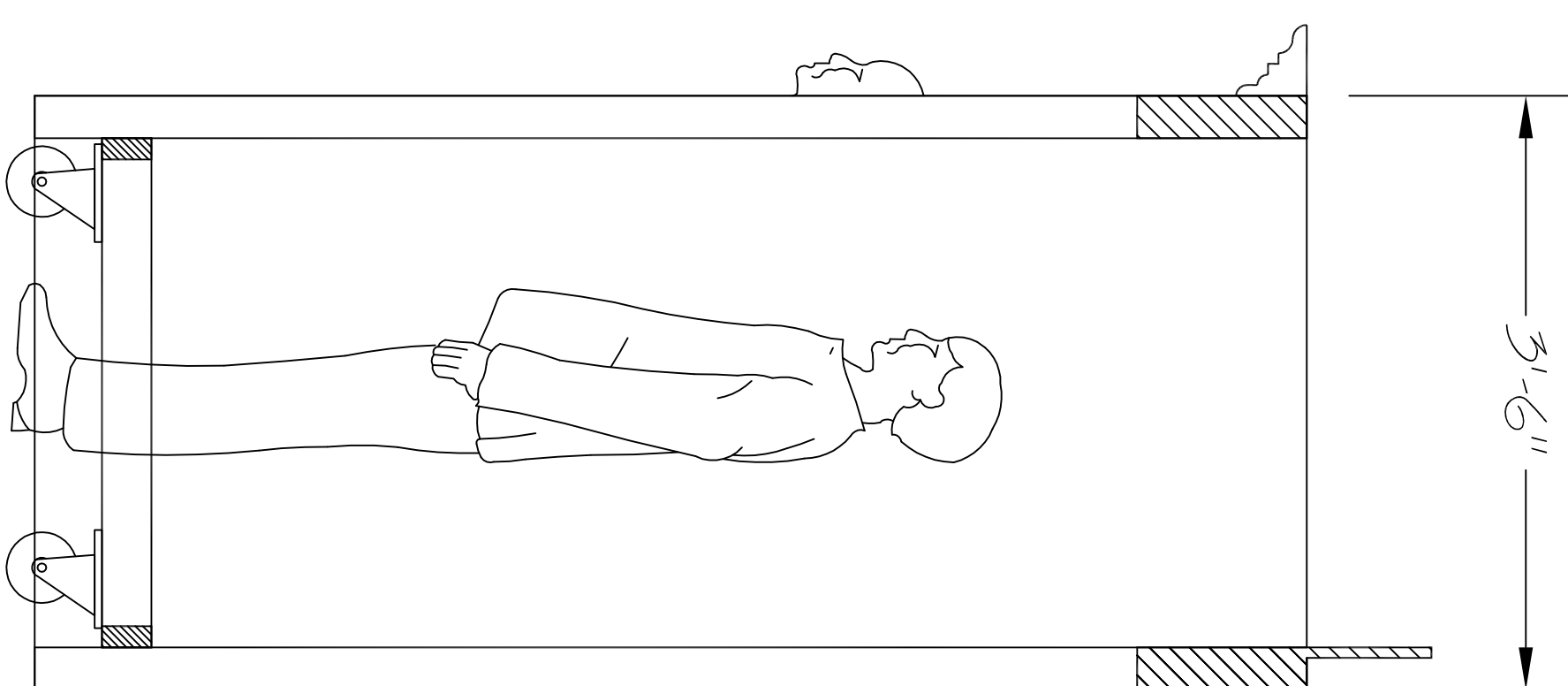
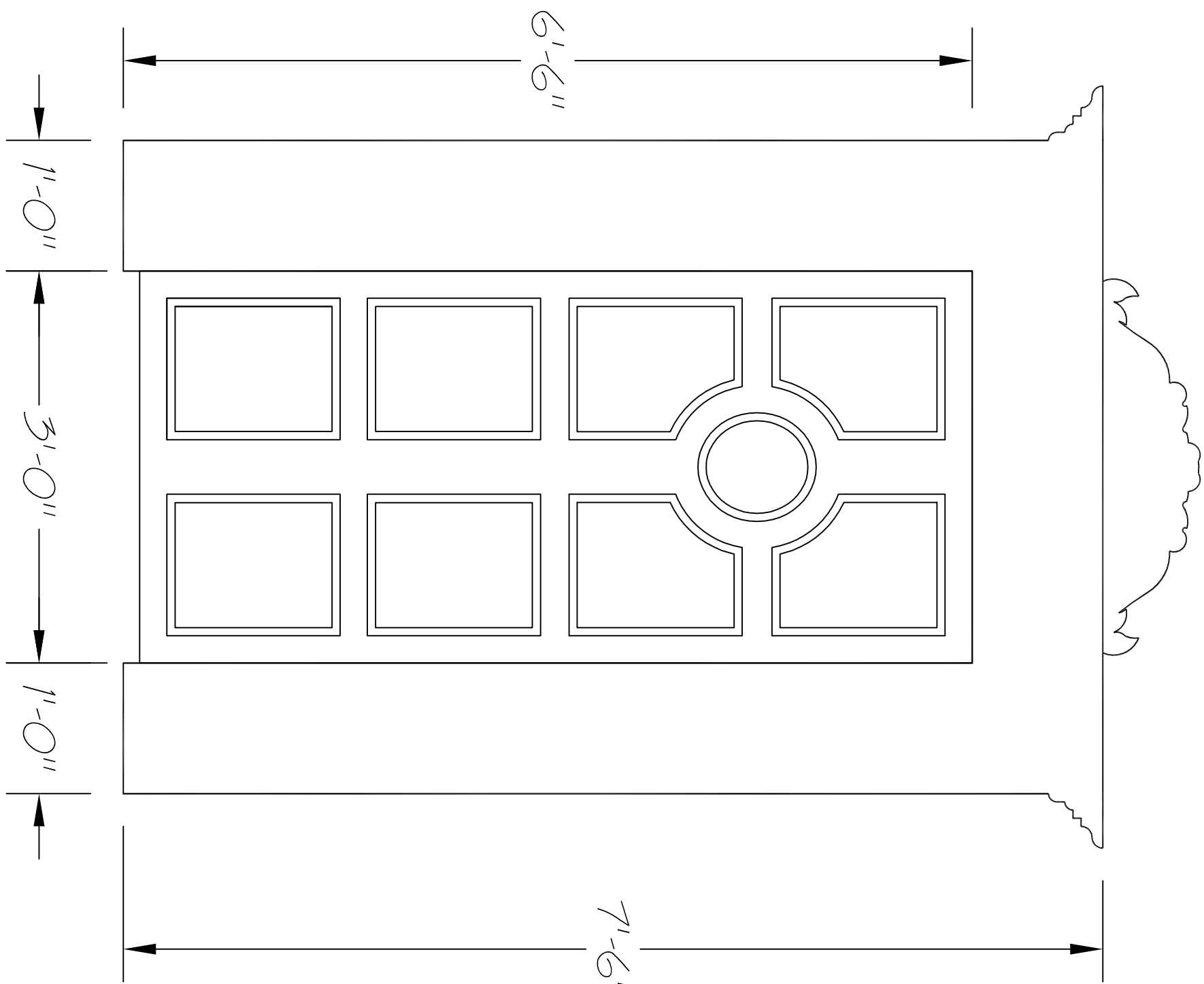
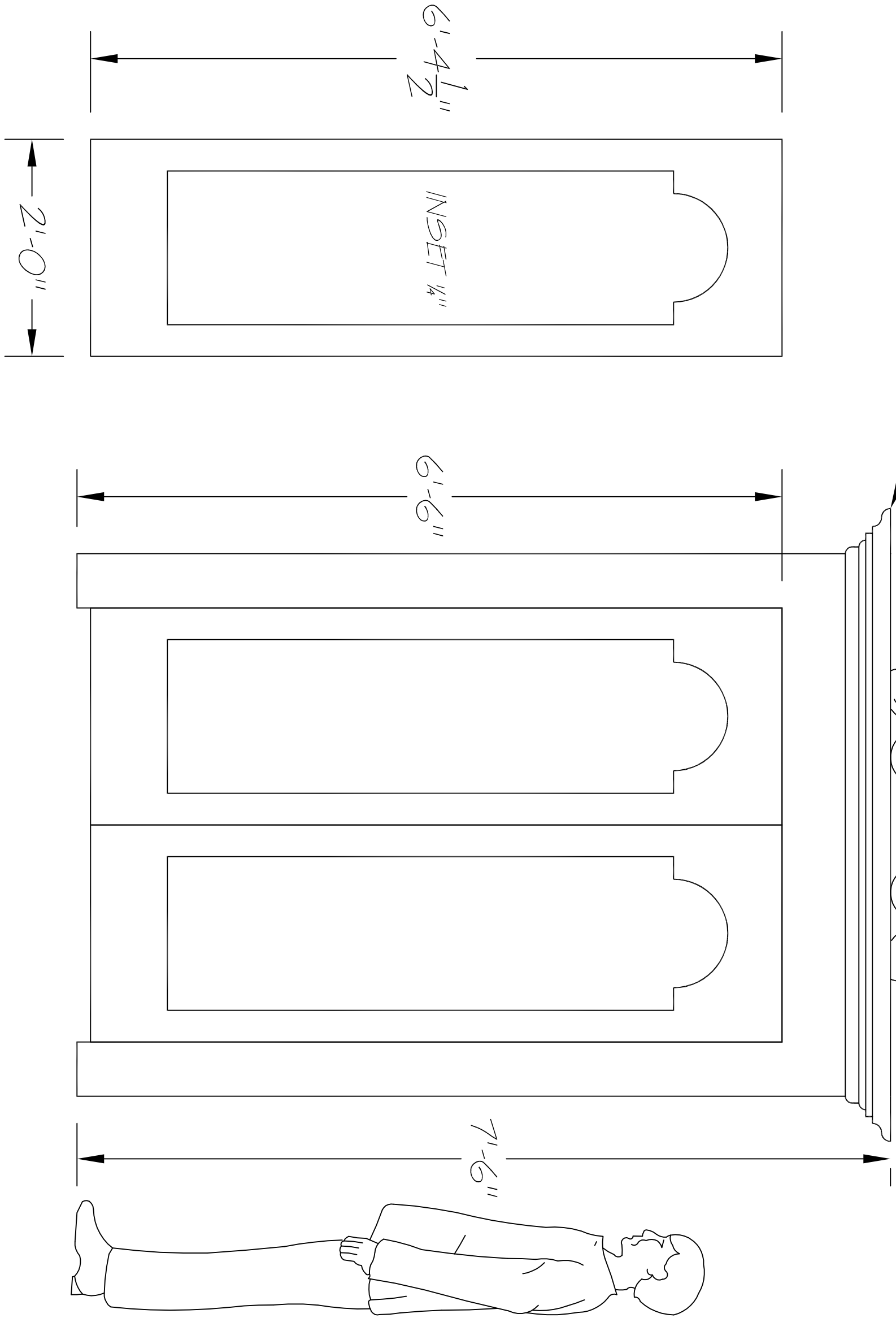

ATTACH SWIVEL
CASTERS TO
ROLLING FRAME
BASE.

APPLY DUVETINE
SKIRT TO HIDE
CASTERS.

APPLY RAISED TRIM TO DOOR IN
PANELS AS SHOWN. THIS NEEDS
TO ACCOMMODATE THE MARLEY
EFFECT. 1/4" THICK TRIM IS
SUFFICIENT.

Perseverence Productions
A CHRISTMAS CAROL
DIRECTED BY SCOTT SEVERENCE
SET DESIGN BY MATT KIZER
TECHNICAL DIRECTOR STAN ZABECKI

WARDROBE
SCALE: 1" = 1'-0"

PLATE
4
OF 8