



## Externally Mounted Ventilators – Install Quick Specs VEN100E

### Installation Type & Discharge Direction

Mounted outside of house on exterior roof or wall.

### Ventilator Carton Weight:

VEN100E = 80 lbs.

### CFM Rating

1000 CFM = VEN100E

### Minimum Duct Size

10" round

### Maximum Equivalent Straight Duct Length

50 feet

### Equivalent Straight Lengths

- 1 foot of 8" or 10" duct = 1 foot
- 1 foot of 3 ¼" x 14" rectangular = 1 foot
- 8" round 90 degree Elbow = 5 feet
- 10" round 90 degree Elbow = 3 feet
- Wall or Roof Cap = 2 feet

### Standard Features

- Adaptable to all Wind Crest hoods
- Weather-resistant galvanized steel construction
- Thermally protected, permanently lubricated motor
- Dynamically balanced 11" diameter blower wheel
- Neoprene resilient anti-vibration mounted
- Built-in Flashing plate for roof or wall mount
- Easily removed blower cover for periodic cleaning

### Ventilator Motor Ratings\*

*Hoods without Heat Lamps:*

8.0 Amps @ 120 V AC, 60 Hz

*Hoods with Heat Lamps:*

12.4 Amps @ 120 V AC, 60 Hz

\*For maximum power supply required, refer to hood series selected.

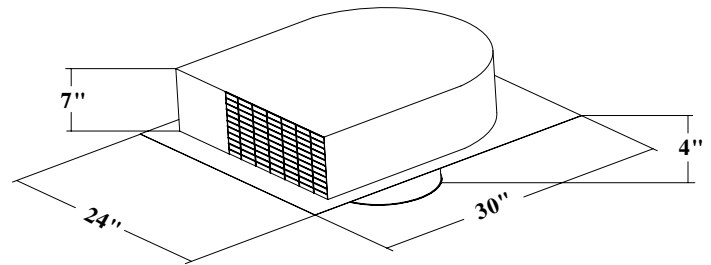

VEN100E





**Hood Transitions Available – Install Quick Specs**

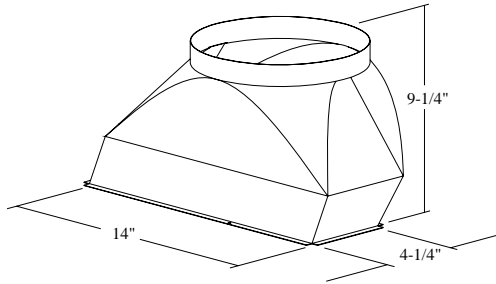

**#10100** = Rectangular to 8" Round duct  
**#10287** = Rectangular to 10" Round duct

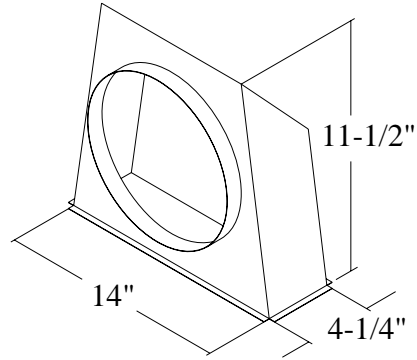

10377.00

**#10377** = 10" Round Rear Discharge

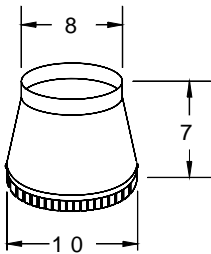

**#10173** = 10" to 8" Round Adapter

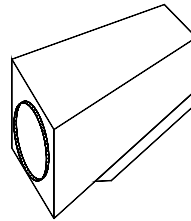

11 1/2" h x 16" w

**#10376** = 10" Round Left Side Discharge

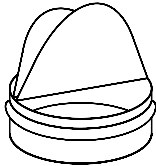

**#10288** = 8" Round Backdraft Damper  
**#10289** = 10" Round Backdraft Damper

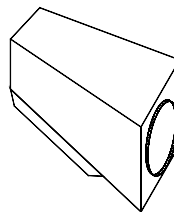

11 1/2" h x 16" w

**#10378** = 10" Round Right Side Discharge

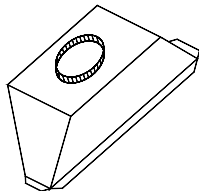

11 1/2" h x 32 3/4" w

**#10542** = Plenum Transition to 10" round (use with dual Internal or Remote blower on 48" and larger WSL, WCL, WER60 or PSL66 hoods)