



Installation Instructions

PowerBoard®

Automatic Retracting Running Board

Vehicle Application

- Ford F150 Super Crew Cab
2004 – 2008 (6.5 ft.)
Part Number: 75105-15

www.Bestop.com - We're here to help! Visit our web site and click on ["Ask a Question"](#). Click here for more [Truck Accessories by Bestop](#).

INSTALLATION TIME



4 Hours

SKILL LEVEL



4 - Difficult

TOOLS



Tape Measure



Flat-Head Screwdriver

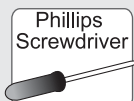

Phillips Screwdriver

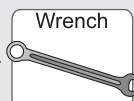

Wrench

13mm

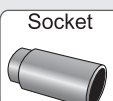

Socket

8mm, 10mm & 13mm

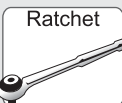

Ratchet

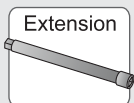

Extension

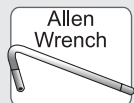

Allen Wrench

5 mm



Crimp Tool

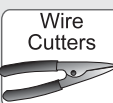

Wire Cutters

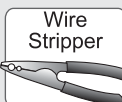

Wire Stripper



Electrical Tape



Silicone Sealant



Safety Glasses



WARNING

The manufacturer strongly recommends that this product be professionally installed.



WARNING

Failure to carefully follow the electrical installation steps could result in severe electrical shock which could harm the installer and/or damage the vehicle.



WARNING

This product is designed primarily to enhance the appearance of the vehicle and to shield the occupants from ordinary weather conditions. Do not rely in any way on the components of this product to contain occupants within the vehicle, or to protect against injury or death in the event of an accident. This product will not protect the occupants from falling objects. Never operate the vehicle in excess of manufacturer's specifications.

WEAR SEAT BELTS AT ALL TIMES

Read and follow, precisely, all installation instructions provided when installing product. Failure to do so may result in a poor fit and could place occupants of the vehicle in a potentially dangerous situation.

PowerBoard® – Installation Instructions

Parts List and Hardware Identification

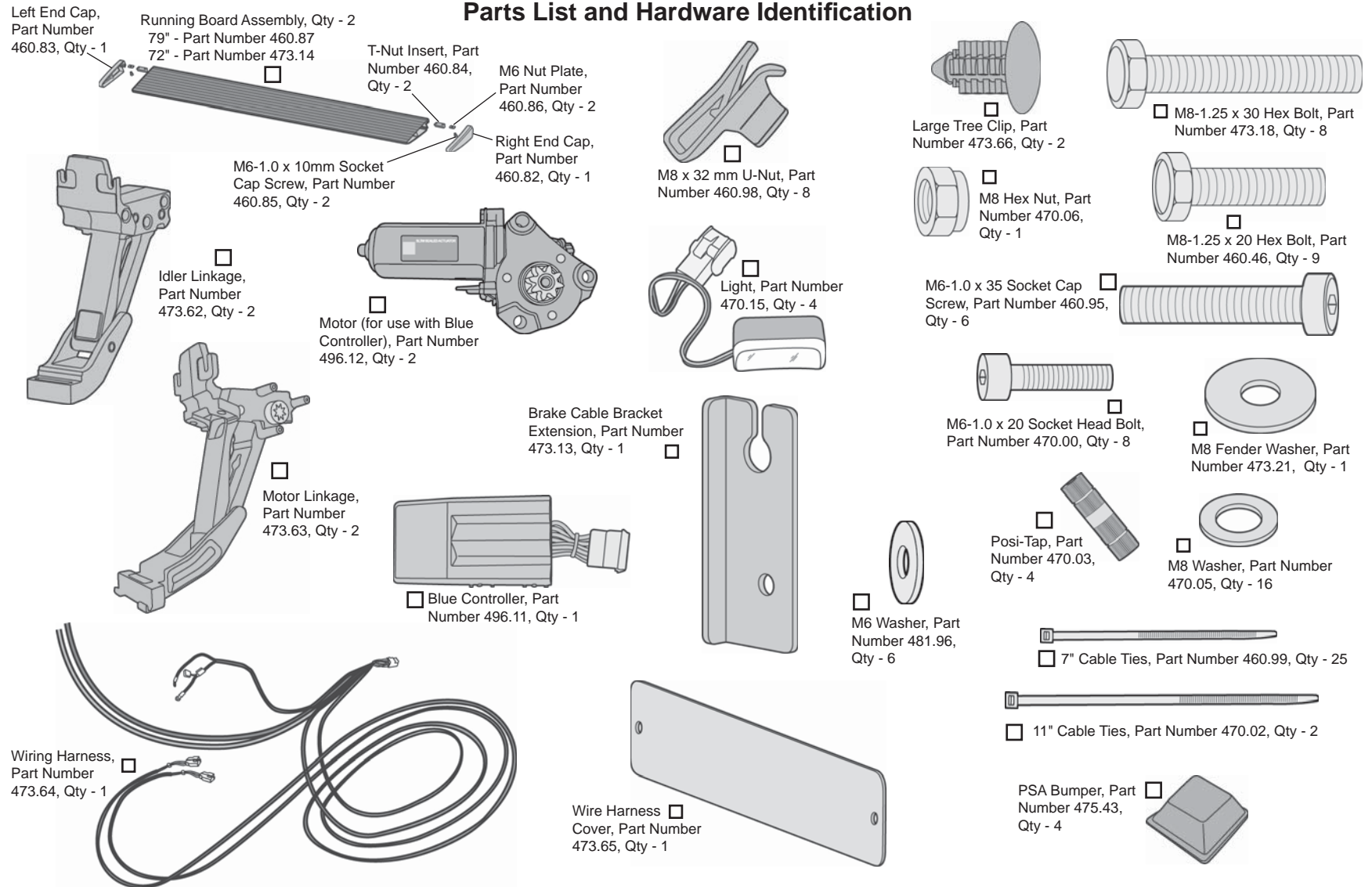

PowerBoard® – Installation Instructions

1 Remove Original Wire Harness Cover and Install New Wire Harness Cover

Locate the Wire Harness Cover attached to the frame under the door on the driver's side of the vehicle. Remove the two Tree Clips that secure the cover to the frame and remove the cover.

Bend the new Wire Harness Cover supplied in the parts kit into position and use the two Large Tree Clips from the parts kit to attach it to the same holes in the frame.

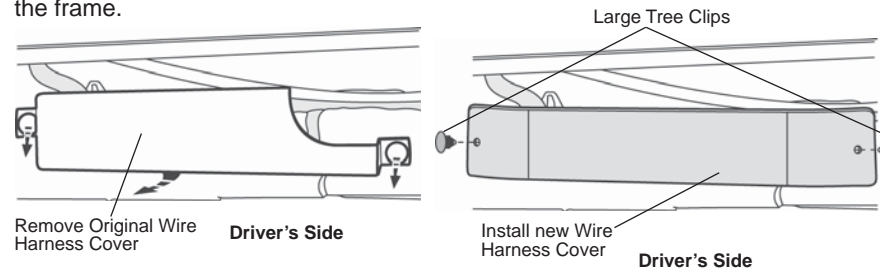

2 Install Brake Cable Bracket Extension

Locate the Brake Cable Bracket Extension in the parts kit.

Slide the brake cable out of the Brake Cable Bracket on the vehicle. Use a Small Hex Bolt, the Large Washer and the Hex Nut to attach the Brake Cable Bracket Extension to the Brake Cable Bracket through the hole for the brake cable. Raise the brake cable into the opening in the Brake Cable Bracket Extension.

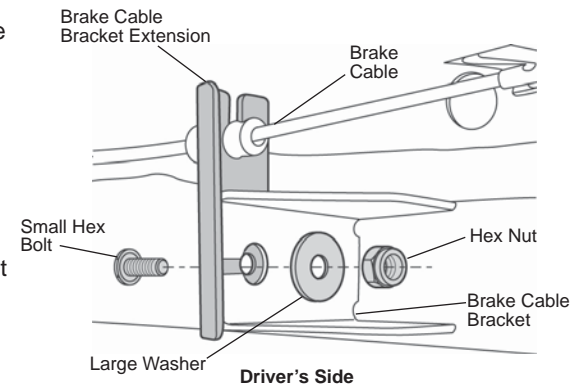

NOTE When you raise the brake cable into position, first pull downward to create slack.

3 Install Mounting Clips - Driver's Side

Counting from the front, locate the first (1st) and last set of mounting holes on the inner sill. Use a Small Hex Bolt and a Small Washer to install a Mounting Clip on each side of each hole. Do not tighten the bolts at this time.

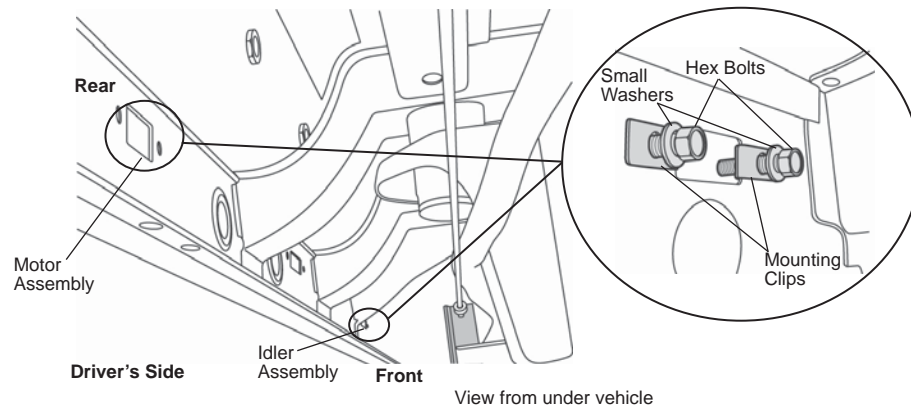

PowerBoard® – Installation Instructions

4 Install Linkage and Trim Clip - Driver's Side

The Motor Linkage mounts to the rear of the vehicle, except for the passenger side of Super Cabs. If you have a Super Cab, mount the Motor Linkage to the front on the passenger side only. Slip the notches in the Arms under the bolts and washers installed in Step One. Tighten these bolts to 16 ft./lbs (22Nm).

Secure the bottom of the Arms with two Small Hex Bolts and Small Washers.

Do not tighten the bolts at this time.

NOTE If the sheet metal holes are misaligned, you may need to file off the edge of the sheet metal.

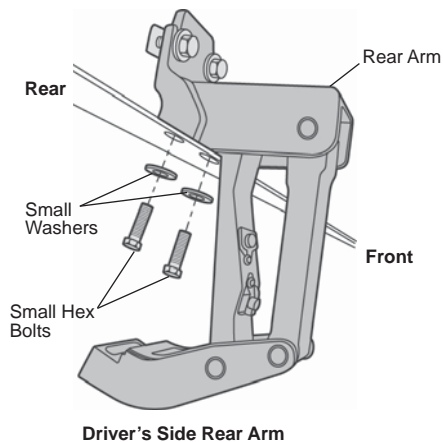

5 Remove Fan Shroud

Remove the fan shroud. Set it aside to be reinstalled later.



6 Install Controller

Use the 11" Cable Ties to mount the Controller to the factory conduit. Route the Wire Harness under the core support and down to the Controller. Connect the harness to the Controller. Make sure the Connector locking tabs are fully engaged.

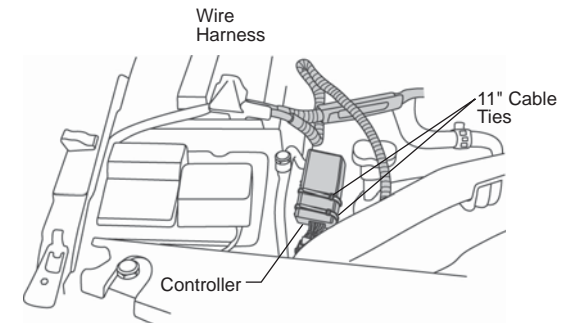

! WARNING Remove the fuse from the Wiring Harness.

7 Remove Fuse from Wiring Harness

Remove the fuse from the Wiring Harness. Failure to do so could result in severe electrical shock which could harm the installer and/or damage the vehicle.

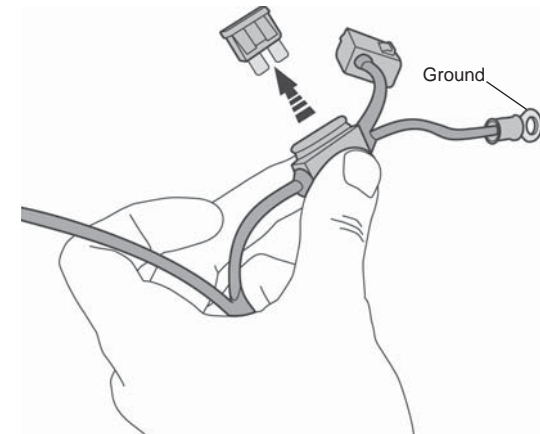

PowerBoard® – Installation Instructions

8 Attach Wiring Harness to Battery

Connect the red power lead to the positive battery terminal and the black lead to the negative terminal. Route the longer leg of the harness across the front of the engine compartment and down to driver's side wheel well. Route the shorter leg to the wheel well on the passenger's side. Use the wire ties in the parts kit to secure the harness out of the way.

Reinstall the Fan Shroud.

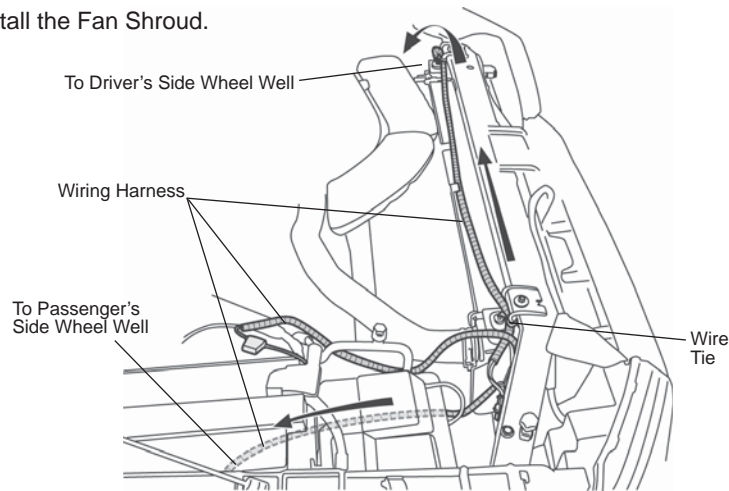

9 Install Trigger Wires

Puncture the grommet in the firewall and thread the four Trigger Wires from the Wiring Harness through the firewall.

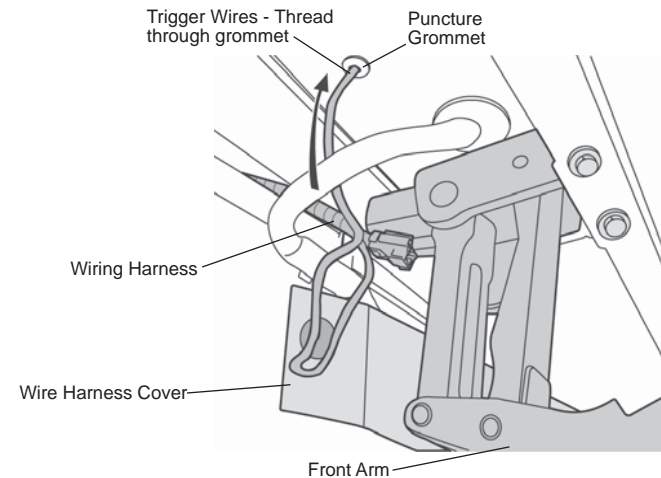

10 Remove Driver's Side Front and Rear Step Plates

Remove the Step Plates from the front and rear door openings on the driver's side. Roll back the carpet to access the wiring underneath.

Pull the wires from the grommet along the door opening next to the wire harness to the rear door opening.

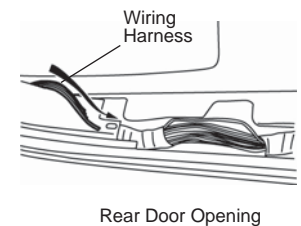
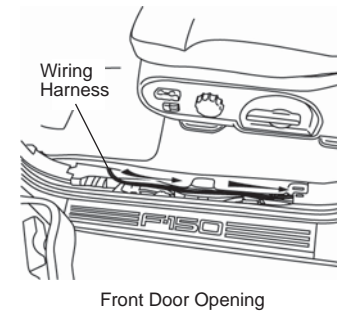
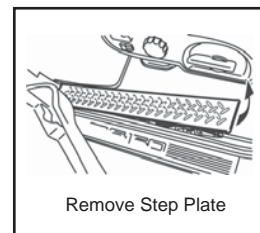

PowerBoard® – Installation Instructions

11 Connect Wires

Locate the appropriate signal wires as shown in the table.

Use the Posi-Taps™ to splice the trigger wires into the corresponding door ajar wires. The SuperCrew is the only application with four doors so it is the only one that will use all four (4) wires. Tape off the unused trigger wires on the SuperCab and Regular Cab.

NOTE There will be three (3) Black wires with Blue Stripes. Use the one that looks unique (ie. has a different blue stripe either weight or shade).

SUPERCREW	SUPERCAB	REGULAR CAB
Black / Yellow	Black / Yellow	Black / Yellow
Black / Pink	Black / Pink	Black / Pink
Black / Blue		
Black / White		

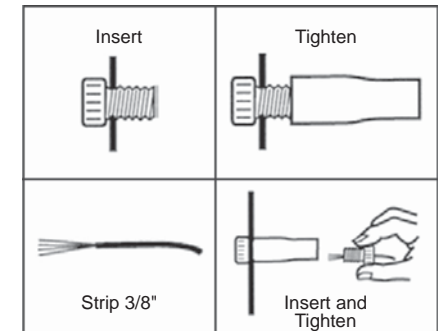
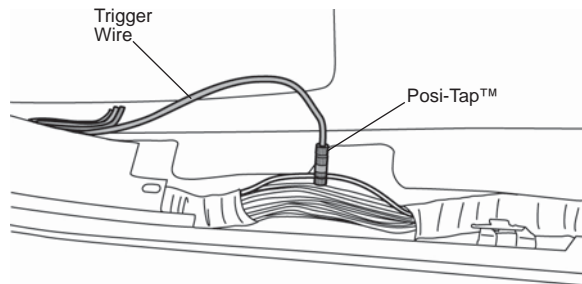

Posi-Tap™ Instructions

12 Install Lights

Clean the outboard surface of the of the Linkage below the bottom mounting bolt. Peel the adhesive liner off the back of the Light and firmly press it 1/8" below the mounting bolt. Plug the light into the connector with the black and orange wires in the wire harness. Repeat with the other three lights. Secure loose wires with Cable Ties.

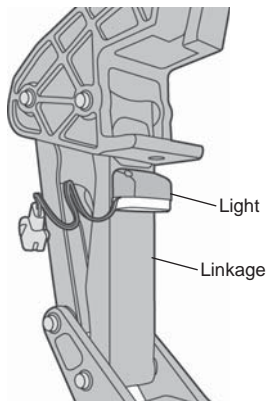

13 Install Running Boards

Mount the Steps to the linkages. Slide the mounting T-Nut into position. Install M6-1.0 x 20mm Socket Head Bolts to secure the boards. Use a 5mm Allen Wrench to tighten the bolts.

Make sure the board moves up and down freely by hand. If it binds, loosen the linkage to body attachment bolts and adjust the linkage position until the boards move freely. **Do not tighten the bolts at this time.**

NOTE *Tightening the fasteners before cycling the step several times may create a bind, causing a squeaking sound and preventing the boards from retracting completely and evenly.*

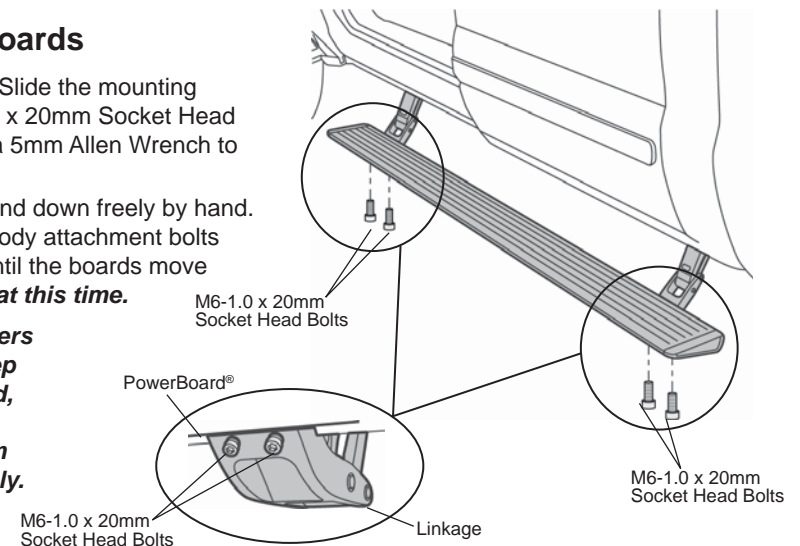

PowerBoard® – Installation Instructions

14 Install Motor

Slide Motor assembly onto drive shaft and mounting bosses of Motor Linkage assembly. Use three (3) M6-1.0 x 35mm Socket Cap Screws and (3) M6 Flat Washers to secure Motor. Plug female connector into Motor. Wrap any exposed wires from the motor with electrical tape. Torque the screws to 5–7 ft. lbs. (6.78–9.49 Nm or 60–84 in. lbs.).

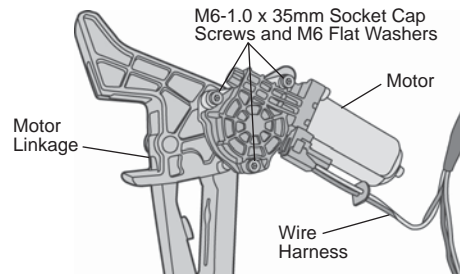

15 Reinstall Fuse

Reinstall the fuse in the harness.

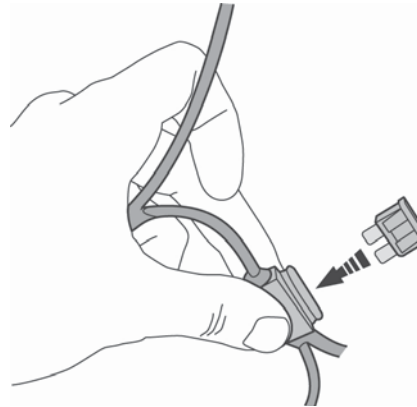

16 Test Doors and PowerBoards®

Open the doors to make sure that the PowerBoard® drops into position on each side of the vehicle.

Cycle boards several times and then fully tighten all bolts.

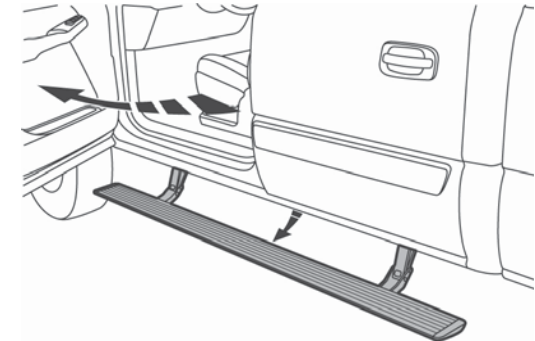

17 Install PSA Bumper – Optional

Due to variations in vehicle build, the PowerBoard®s may contact the vehicle body when in the up position. If you would like to stop the board's travel earlier, install the supplied PSA Bumpers to the inner links or stick the bumper to the body at the location of contact.

To stop the board travel earlier, look for the area on the inner link where the Stop Bumper on the outer link would make contact if the board did not stop early (see gap in illustration).

Open the door to lower the board. Stand on the board to keep it in the down position and shut the door. Remove the fuse. Peel the backing off of the PSA Bumper and stick it to the surface on the inner link where the Stop Bumper will contact it. Do this on both idler and motor links. Reinstall the fuse and check to make sure the Stop Bumper hits the PSA Bumper when the doors are shut.

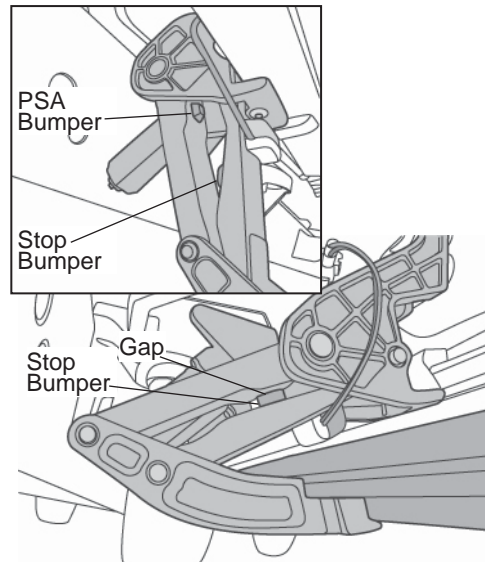

18 Reinstall Step Plates

Once you have checked that the Steps function properly, reinstall the Step Plates.

PowerBoard® – Installation Instructions

PowerBoard® Troubleshooting

Issue:

- Possible cause

Boards do not operate:

- Connected to incorrect vehicle wire
- Wire connections not secure
- Fuse burned
- Factory door-ajar circuit inoperable

Board creaks or squeaks during operation:

- Gear shaft wedge bolt is loose
- Loosen mounting bracket and board attachment screws. Adjust linkages so they are parallel to each other and the noise is gone. Tighten all fasteners.

Intermittent operation:

- Wire connections not secure
- Bad ground
- Bad battery connection

Boards operate randomly:

- Wire connections not secure
- Connected to incorrect vehicle wire

Board stays down all the time and can be moved by hand:

- Gear shaft wedge screw is missing or loose

Board shakes and or shutters during operation:

- Bad ground
- Wire connections not secure
- Bad battery connection

One or more doors operate the board and other do not:

- Wire connections not secure

Board Hits Body:

- Install supplied PSA bumper per the installation instructions.

PowerBoard® Service Tips

Confirming PowerBoard® is functional-black controller:

To test if the black controller (460.91), wire harness, motor and lights work, hook up to battery and touch any of the 4 door trigger wires to ground. The board for that side should go down and the lights should turn on. The board should go up and the lights should turn off when the wire is removed from ground.

Boards don't operate correctly when connected to wires identified in instructions:

Unfortunately vehicle manufactures do not consistently keep the same wire colors in their wire harnesses. The PowerBoard® trigger wires need to be connected the factory door-ajar wire that is connected to each door latch switch. The correct wire is likely in the same bundle that is identified in the instructions. If none of them work you can locate the correct wire by removing the door panel and tracing the wire bundle that leads to the door latch.

Use an ohm meter or continuity tester to find the door-ajar wire on PowerBoards® with black controllers. The correct wire will go from neutral to ground when the door is opened and return to neutral when the door is shut. Connect one test lead to the negative battery terminal and probe the wires with the other lead. You can use a pin or a Posi-Tap connector to pierce the wire insulation. The correct wire will make the tester go from no continuity to complete continuity when the door opened and return to no continuity when the door is shut. You can also shut the door latch with the door open by pushing on the latch catch with a screw driver.

Linkage Component Identification

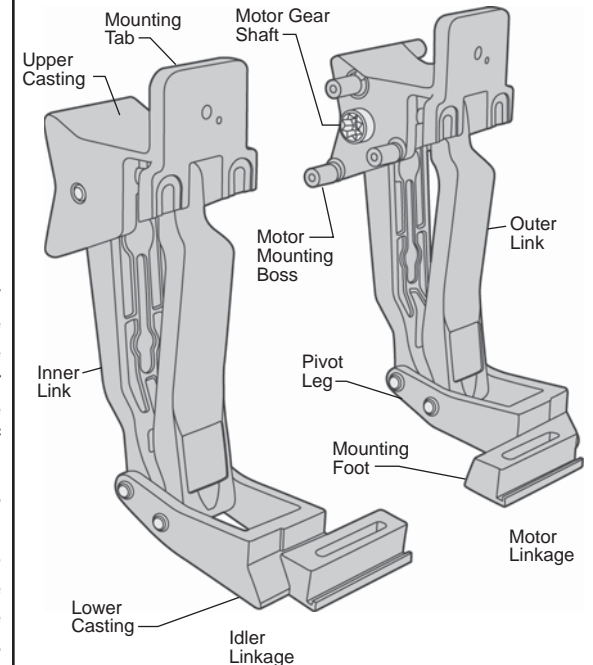

PowerBoard® – Installation Instructions

LIMITED WARRANTY

We warrant our product to be free from defects in material and workmanship, for the terms specified below, provided there has been normal use and proper maintenance. This warranty applies to the original purchaser only. All remedies under this warranty are limited to the repair or replacement of any item or items found by the factory to be defective within the time period specified. If you have a warranty claim, first you must call our factory at the number below for instructions. You must retain proof of purchase and submit a copy with any items returned for warranty work. Upon completion of warranty work, if any, we will return the repaired or replaced item or items to you freight prepaid. Damage to our products caused by accidents, fire, vandalism, negligence, misinstallation, misuse, Acts of God, or by defective parts not manufactured by us, is not covered under this warranty.

THE WARRANTY TIME PERIOD IS AS FOLLOWS FOR ALL PowerBoards® MANUFACTURED BY OUR COMPANY: THREE YEARS / 36,000 MILES FROM DATE OF PURCHASE.

ANY IMPLIED WARRANTIES OF MERCHANTABILITY AND/OR FITNESS FOR A PARTICULAR PURPOSE CREATED HEREBY ARE LIMITED IN DURATION TO THE SAME DURATION AND SCOPE AS THE EXPRESS WRITTEN WARRANTY. OUR COMPANY SHALL NOT BE LIABLE FOR ANY INCIDENTAL OR CONSEQUENTIAL DAMAGE.

Some states do not allow limitations on how long an implied warranty lasts, or the exclusion or limitation of incidental or consequential damages, so the above limitations or exclusions may not apply to you. This warranty gives you specific legal rights, and you may also have other rights which vary from state to state.



For further information or request for warranty work, please contact:
Bestop Inc. Customer Service
Toll-Free: (800)845-3567
Main: (303)465-1755
E-mail: csbestop@Bestop.com
Website: www.Bestop.com