



Piper Aircraft, Inc.
2926 Piper Drive
Vero Beach, FL, U.S.A. 32960

SERVICE NO. 1299 BULLETIN

PIPER CONSIDERS COMPLIANCE MANDATORY

Date: January 6, 2017

(M)

SUBJECT:

PERIODIC REPLACEMENT OF MAIN LANDING GEAR DRAG LINK BOLT

MODELS AFFECTED:

PA-23-150 Apache
PA-23-160 Apache
PA-23-235 Apache
PA-23-250 Aztec

SERIAL NUMBERS AFFECTED:

23-1 through 23-1176, 23-1178 through 23-1182
23-1177, 23-1183 through 23-2046
27-505 through 27-622
27-1 through 27-504; 27-2000 through 27-4916;
27-7304917 through 27-8154030

COMPLIANCE TIME:

For main landing gear drag links, installed on affected aircraft, that have accumulated 1,000 or more hours time in service (TIS), compliance with this service bulletin is to coincide with the next regularly scheduled maintenance event, but not to exceed the next 100 hours TIS. Main landing gear drag link bolts with less than 1,000 hours TIS are not affected by this service bulletin until either drag link bolt accrues a minimum of 1,000 hours TIS.

APPROVAL:

The engineering aspects of this service document have been shown to comply with the applicable Federal Aviation Regulations and are FAA approved.

PURPOSE:

Under certain conditions, the bolt that fastens the upper and lower main gear (MG) drag links can develop wear in a manner that may not be detectable during routine maintenance and inspection. Specifically, score marks have been discovered around the circumference of the bolt shank, midway along the length of the bolt.

By design, the main landing gear drag link bolt is free to rotate inside a set of bushings to allow relative movement between the upper and lower drag links during landing gear strut extension and retraction. Over extensive operating hours, this rotation can generate the score marks described, causing stress concentrations to develop in the bolt, which, if left uncorrected, could result in bolt fatigue failure and subsequent main gear collapse.

This service bulletin provides a 1,000 hour recurring requirement for the removal and replacement of this bolt (and associated hardware) and the inspection of the mating bushings. The applicable service manual will be updated to include the contents of this service bulletin at its next revision.

ATA/JASC: 3210

(OVER)

INSTRUCTIONS:

NOTE: The following applies to both the left and right main landing gear.

1. Jack the aircraft per Section II of the appropriate service manual.
2. Disassemble the upper drag link from the lower drag link by removing the bolt, and associated hardware, which functions as a hinge pin for the two parts. See Figure 1.
3. Inspect the washers and castellated nuts for corrosion, damage and excessive wear, and replace on condition. Retain all serviceable hardware for later reassembly. Discard the used bolt and cotter pin.
4. Reassemble the upper and lower drag links, using new bolts and new cotter pins as listed in the Material Required section of this service bulletin. Existing nuts and washers may be reused, if they are in serviceable condition. If replacement nuts and/or bolts are required, order and install new parts as listed in the Material Required section of this service bulletin.
5. Lubricate per Section II of the applicable service manual, as required.
6. Verify proper operation of the landing gear.
7. Remove the aircraft from jacks.
8. Make a logbook entry documenting compliance with this service bulletin.

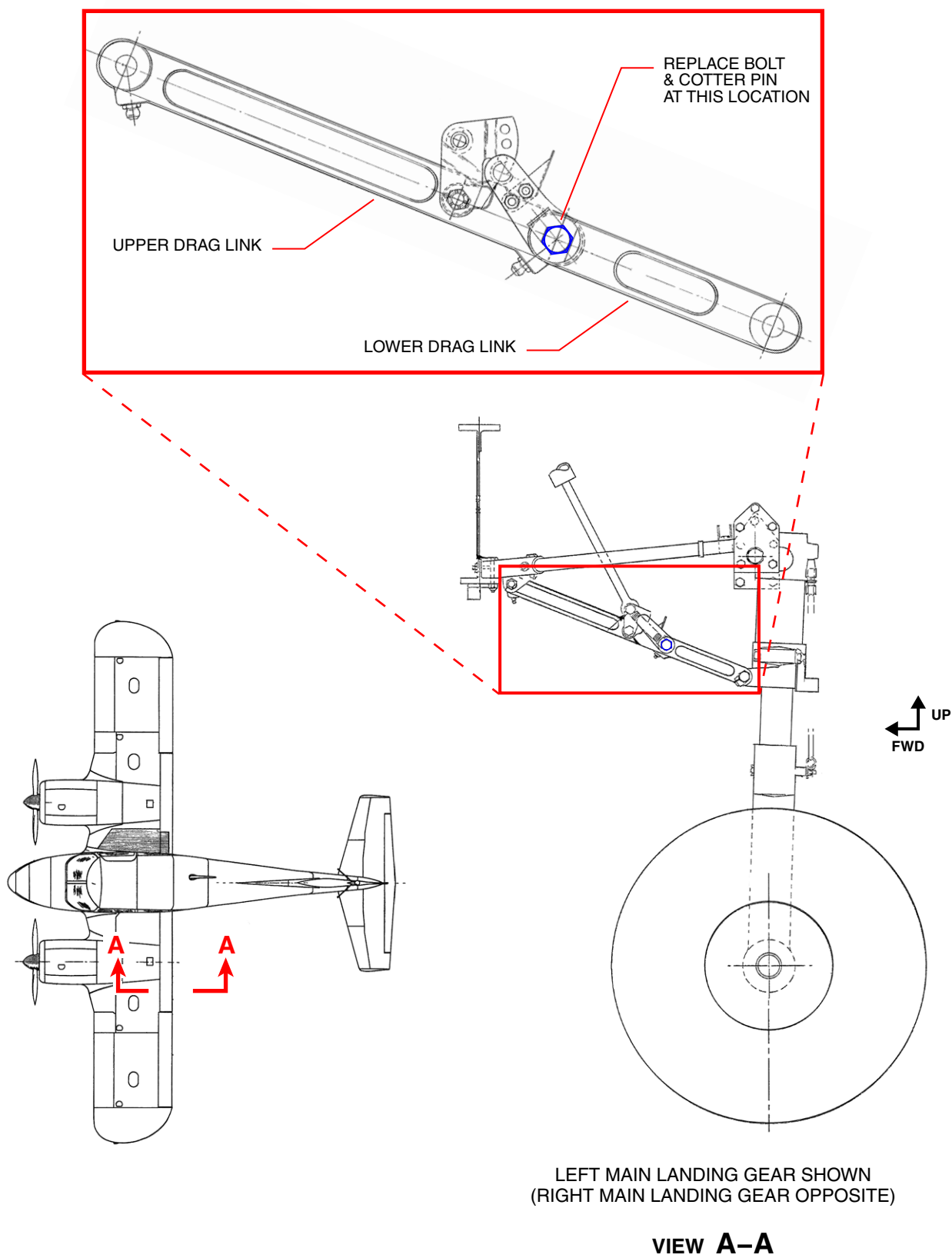

Figure 1
Drag Link Bolt Assembly Location

MATERIAL REQUIRED:

Per aircraft, required or on condition:

- On S/Ns 23-1 through 23-1837:

QUANTITY	PIPER CODE	DESCRIPTION
2 (required)	402-356 – or – 691-367	BOLT (AN176-26) BOLT (NAS6606D36)
2 (required)	424-059	COTTER PIN (MS24665-283)
A/R (on condition)	407-567 – or – 690-629	WASHER (AN960-616) WASHER (NAS1149F0663P)
A/R (on condition)	404-103	CASTELLATED NUT (AN310-6)

- On all other affected aircraft:

QUANTITY	PIPER CODE	DESCRIPTION
2 (required)	402-427 – or – 691-327	BOLT (AN177-27) BOLT (NAS6607D38)
2 (required)	424-059	COTTER PIN (MS24665-283)
A/R (on condition)	407-568 – or – 690-630	WASHER (AN960-716) WASHER (NAS1149F0763P)
A/R (on condition)	404-104	CASTELLATED NUT (AN310-7)

AVAILABILITY OF PARTS:

Your Factory Authorized Piper Service Facility

EFFECTIVITY DATE:

This service bulletin is effective upon receipt.

SUMMARY:

Please contact your Factory Authorized Piper Service Facility to make arrangements for compliance with this service bulletin in accordance with the compliance time indicated.

NOTE: Please notify the factory of any address/ownership corrections. Changes should include aircraft model, serial number, and current owner's name and address.

Corrections and/or changes should be directed to:

PIPER AIRCRAFT, INC.
Attn: Customer Service
2926 Piper Drive
Vero Beach, FL 32960