

DWG

LUGS064423

FINAL INSPECTION FOR INTERNAL THREADS SHALL CONSIST OF A STANDARD THREAD GAUGE FOR PARTS WITH ELECTROPLATED OR CHEMICALLY DEPOSITED FINISHES. FOR OTHER FINISHES, THREAD INSPECTION WILL MEET A GO TEST CONDUCTED WITH AN UNCOATED (OR ZN PLATED) MATING BOLT, AND A NO-GO TEST CONDUCTED WITH THE THREAD ELEMENT OF A STANDARD GAUGE.

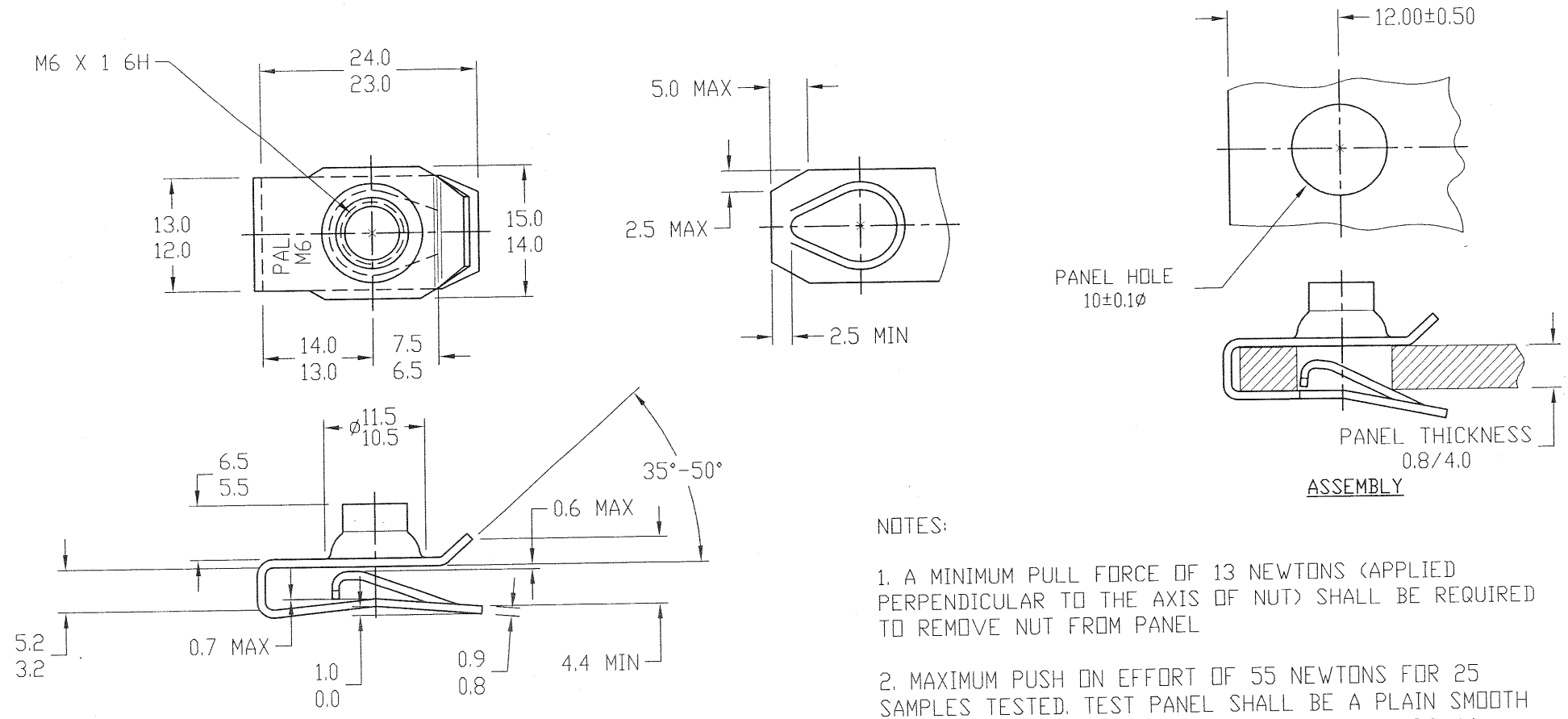

NOTES:

1. A MINIMUM PULL FORCE OF 13 NEWTONS (APPLIED PERPENDICULAR TO THE AXIS OF NUT) SHALL BE REQUIRED TO REMOVE NUT FROM PANEL
2. MAXIMUM PUSH ON EFFORT OF 55 NEWTONS FOR 25 SAMPLES TESTED. TEST PANEL SHALL BE A PLAIN SMOOTH  $R_a$  LESS THAN OR EQUAL TO 2.5 MICROMETERS 3.0-4.1mm THICK PANEL HRC-50-58 WITH 1.0mm EDGE RADIUS.

Controlled copy must be in Rev **CONTROLLED**

**TINNERMAN PALNUT**  
ENGINEERED PRODUCTS, LLC  
MOUNTAINSIDE, NJ

MATERIAL:  
SPRING STEEL-SAE1050

HARDNESS: ROCKWELL C 42-50 (AUSTEMPER)

PAL® PALNUT® ON SERT® PUSHNUT®			
TITLE PALNUT MULTI-THREAD NUT "U" TYPE, SHORT CLIP STYLE FOR 0.80 - 4.00 PANEL THICKNESS			
DRAWN:	JSB	RELEASED	SCALE
DATE:	8/15/05	PART No: LUGZ064423	NONE
CHECKED:	<i>JSB</i>	DWG No.	
APPROVED:	<i>JSB</i>	LUGS064423	

DATE	REV	DESCRIPTION	BY
9/16/05	A	REMOVED BARREL DIM 2.25/1.75 PER ECD744	JSB
8/15/05	-	RELEASE	JSB