

DESIGN 1

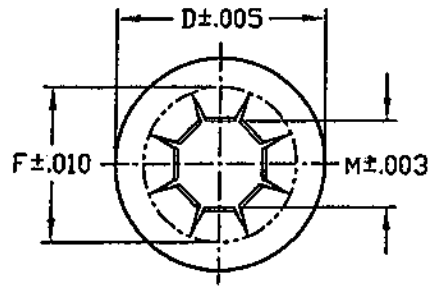

DESIGN 2

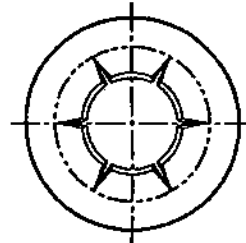

DESIGN 3

UNCONTROLLED

OPTIMUM PERFORMANCE DEPENDS ON ADHERENCE TO THESE STUD, ROD OR WIRE SPECIFICATIONS.

1. MATERIAL MAY BE MILD STEEL, ALUMINUM, BRASS, ZINC OR OTHER MALLEABLE METAL.
2. SURFACE HARDNESS MUST NOT EXCEED ROCKWELL 30T-78.
3. RECOMMENDED DIAMETER TOLERANCE $+0.002'$ $-0.003'$
4. ENDS MUST BE FREE OF DISTORTION OR BURRS. CHAMFER $1/32'$ x $45'$ FOR EASIER ASSEMBLY.
5. NICKEL, CHROMIUM OR OTHER HARD FINISHES ON STEEL STUDS ARE NOT RECOMMENDED.
6. NICKEL-CHROMIUM PLATING ON DIE CAST STUDS MUST NOT EXCEED .003 THICKNESS. THIS FINISH IS NOT RECOMMENDED ON STUDS SMALLER THAN $1/8'$ DIAMETER.

STUD, ROD OR WIRE DIA.	PALNUT PART NO.	CUSTOMER PART NO.	OVERALL HEIGHT "H"	HEIGHT TOL. ±	INSIDE WASHER DIA. "F"	OUTSIDE WASHER DIA. "D"	STEEL THICK.	HOLE DIA. "M"	DESIGN
1/16	PS062032		.038	.005	.142	.195	.010	.052	3
3/32	PS094032		.038	.005	.161	.195	.010	.083	3
1/8	PS125006		.052	.005	.228	3/8	.014	.115	1
3/16	PS188007		.064	.005	.320	7/16	.014	.176	2
.240	PS240085		.069	.005	.388	17/32	.016	.226	2
1/4	PS250085		.066	.005	.388	17/32	.016	.236	2
5/16	PS312010		.070	.007	.456	5/8	.020	.298	2
3/8	PS375012		.081	.007	.546	3/4	.026	.360	2
7/16	PS438014		.097	.007	.638	7/8	.029	.422	2
.453	PS453014		.092	.007	.638	7/8	.029	.436	2
1/2	PS500016		.112	.007	.730	1	.034	.482	2

DATE	REV	DESCRIPTION	BY
10/6/00	A	REDRAWN TO AUTOCAD 2000	MS
4/1/99	-	PS094032 J61 DIA WAS .142 PER EC# 2015	BAD
9/25/90	-	PS125006 MATL. THK. WAS .013	DF
11/4/86	-	PS453014 MATL. THK. WAS .030 PER EC# 583	RAS
3/13/86	-	PS438014 MATL. THK. WAS .030 PER EC# 583	DB
3/13/86	-	PS188007 MATL. THK. WAS .013	DB
3/13/86	-	PS312010 MATL. THK. WAS .021 PER EC# 583	DB
10/31/85	-	PS250085 MATL. THK. WAS .017 PER EC# 583	GL
10/31/85	-	PS375012 MATL. THK. WAS .027 PER EC# 583	GL
10/31/85	-	PS500016 MATL. THK. WAS .035 PER EC# 583	GL
6/23/85	-	REVISED PS062032 & PS094032 MATL. THICK. WAS .009	GL
2/26/85	-	PS240085 MATL. THK. WAS .017 PER EC# 583	CF
8/10/73	-	REDRAWN WITHOUT CHANGE, SUPERSEDES DWG. REV. 5-6-66; RELEASED PART# PS453014	BKS

TINNERMAN PALNUT
ENGINEERED PRODUCTS, LLC

MATERIAL:
50 CARBON SPRING STEEL

HARDNESS: ROCKWELL 30N 58-68

PAL [®]	PALNUT [®]	DN SERT [®]	PUSH-NUT [®]
TITLE PUSHNUT FASTENERS ROUND FLAT TYPE, STYLE 'PS' FOR STUDS, RODS OR WIRE			
DRAWN R.S.		RELEASED	SCALE
DATE: 8/1/60		PART No: VARIOUS	NONE
CHECKED CNCAL 11-1700		DWG No.	
APPROVED [Signature]		PS-ENGLISH	