

DWG

PS-PD

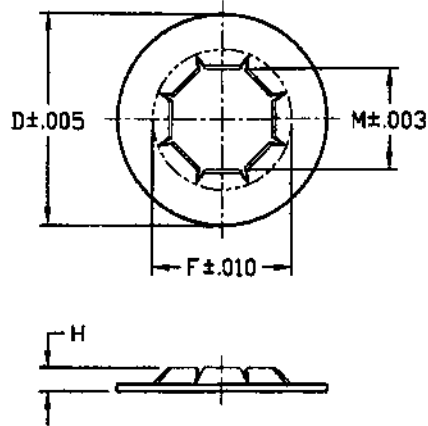

OPTIMUM PERFORMANCE DEPENDS ON ADHERENCE TO
THESE STUD, ROD OR WIRE SPECIFICATIONS.

1. MATERIAL MAY BE MILD STEEL, ALUMINUM, BRASS, ZINC OR OTHER MALLEABLE METAL.
2. SURFACE HARDNESS MUST NOT EXCEED ROCKWELL 30T-78.
3. RECOMMENDED DIAMETER TOLERANCE $^{+.002}$
 $_{-.003}$.
4. ENDS MUST BE FREE OF DISTORTION OR BURRS. CHAMFER $1/32^{\circ} \times 45^{\circ}$ FOR EASIER ASSEMBLY.
5. NICKEL, CHROMIUM OR OTHER HARD FINISHES ON STEEL STUDS ARE NOT RECOMMENDED.
6. NICKEL-CHROMIUM PLATING ON DIE CAST STUDS MUST NOT EXCEED .003 THICKNESS. THIS FINISH IS NOT RECOMMENDED ON STUDS.

TOLERANCE
CONVERSION

ENGLISH	METRIC
.002	.05
.003	.076
.005	.127
.010	.254
1/32	.794

WHERE THE STUD SIZE IS SHOWN IN INCHES OR MILLIMETERS, ALL DIMENSIONS ON THAT LINE ARE ALSO IN INCHES OR MILLIMETERS.

DECIMAL EQUIV. (INCHES)	STUD, ROD OR WIRE DIA.		PALNUT PART NO.	SERIES	OVERALL HEIGHT "H"	HEIGHT TOL. ±	INSIDE WASHER DIA. "F"	OUTSIDE WASHER DIA. "D"	STEEL THICK.	HOLE DIA. "M"	
	INCH	MM									
.125	1/8	-	PS125306	LIGHT	.045	.005	2.28	.375	.009	.115	EQUIVALENT
.126	-	3.2	PS030309	LIGHT	1.14	.13	5.79	9.5	.23	2.92	
.125	1/8	-	PS125006	MEDIUM	.052	.005	2.28	.375	.013	.115	EQUIVALENT
.126	-	3.2	PS030009	MEDIUM	1.32	.13	5.79	9.5	.33	2.92	
.156	5/32	-	PD156307	LIGHT	.047	.005	.320	.437	.010	.140	EQUIVALENT
.157	-	4.0	PD040311	LIGHT	1.19	.13	8.13	11.1	.25	3.56	
.156	5/32	-	PD156007	MEDIUM	.058	.005	.320	.437	.013	.140	EQUIVALENT
.157	-	4.0	PD040011	MEDIUM	1.47	.13	8.13	11.1	.33	3.56	
.188	3/16	-	PS188307	LIGHT	.056	.005	.320	.437	.010	.176	
.188	3/16	-	PS188007	MEDIUM	.064	.005	.320	.437	.015	.176	
.196	-	5.0	PS050311	LIGHT	1.33	.13	8.13	11.1	.25	4.70	
.196	-	5.0	PS050011	MEDIUM	1.52	.13	8.13	11.1	.38	4.70	
.250	1/4	-	PS250385	LIGHT	.057	.005	.388	.531	.012	.236	EQUIVALENT
.248	-	6.3	PS060313	LIGHT	1.45	.13	9.85	13.5	.25	5.69	
.250	1/4	-	PS250085	MEDIUM	.066	.005	.388	.531	.017	.236	EQUIVALENT
.248	-	6.3	PS060013	MEDIUM	1.68	.13	8.58	13.5	.43	5.99	
.312	5/16	-	PS312310	LIGHT	.059	.007	.456	.625	.015	.298	EQUIVALENT
.315	-	8.0	PS080316	LIGHT	1.50	.18	11.58	15.9	.38	7.51	
.312	5/16	-	PS312016	MEDIUM	.070	.007	.456	.625	.021	.298	EQUIVALENT
.315	-	8.0	PS080016	MEDIUM	1.78	.18	11.58	15.9	.53	7.57	
.375	3/8	-	PS375312	LIGHT	.061	.007	.546	.750	.017	.360	
.375	3/8	-	PS375012	HEAVY	.081	.007	.546	.750	.027	.360	
.394	-	10.0	PS100319	LIGHT	1.37	.18	12.99	19.0	.43	9.57	
.394	-	10.0	PS100019	HEAVY	1.88	.18	13.87	19.0	.68	9.57	
.438	7/16	-	PS438014	-	.097	.007	.638	.875	.030	.422	EQUIVALENT
.433	-	11.0	PS110022	-	2.46	.18	16.20	22.25	.76	10.72	
.500	1/2	-	PS500016	-	.112	.007	.730	1	.035	.482	
.511	-	13.0	PS130025	-	2.72	.18	18.54	25.4	.89	12.55	

DATE	REV	DESCRIPTION	BY
6/14/04	B	INSIDE WASHER DIA WAS CHANGED TO 9.85. HOLE DIAMETER WAS CHANGED TO 5.69 FOR PART PS060313 PER ECD 505	H.W.
9/19/00	A	REDRAWN TO AUTOCAD 2000	HS
6/11/99		REDRAWN TO CAD; PART PS100319 12.99 WAS 13.87	BAD
12/4/86		PS312310- 298 WAS 289	EJB

TINNERMAN PALNUT
ENGINEERED PRODUCTS, LLC

MATERIAL:
CARBON SPRING STEEL-SAE1050

HARDNESS: ROCKWELL 30N 58-68

TOLERANCES, UNLESS SPECIFIED:
mm $\pm .38$ in $\pm .015$

PAL[®] PALNUT[®] ON SERT[®] PUSHNUT[®]

TITLE

PUSHNUT FASTENERS,
ROUND FLAT TYPE,
STYLE PS & PD
FOR STUDS, ROD OR WIRE

DRAWN:	CL	RELEASED	SCALE
DATE:	6/5/75	PART No: VARIOUS	NONE
CHECKED:	DWG No. PS-PD		
APPROVED:			