

# Brass Inserts for Plastic

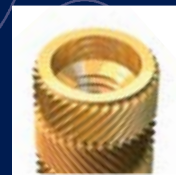

Lancaster Fastener Co Ltd  
Threadforming Screw Specialists

# Contents



## Sonic-Fix

Unheaded (UHDSOIFIX)  
Headed (HDSOIFIX)



## Tech-Fix

Unheaded (UHDTECFIX)

page

1



## Heat-Fix

Unheaded (UHDHEAFIX)  
Headed (HDHEAFIX)



## Flow-Fix

Unheaded (UHDFLOFIX)

2



## Fin-Fix

Unheaded (UHDFINIFIX)  
Headed (HDFINIFIX)



## Spirol-Fix

Unheaded (UHDSPIFIX)  
Headed (HDSPIFIX)

3



## Expansion-Fix

Unheaded (UHDEXPFIX)  
Headed (HDEXPFIX)



## Thread-Fix

Unheaded (UHDTHRIFIX)  
Headed (HDTHRIFIX)

4

## Conversion Table & Part Number Examples

5



For further product details, including information for designers, product advantages & installation data, visit:  
[www.lancasterfastener.co.uk/insertsforplastic](http://www.lancasterfastener.co.uk/insertsforplastic)

# Sonic-Fix

Unheaded (UHDSOIFIX) Headed (HDSOIFIX)

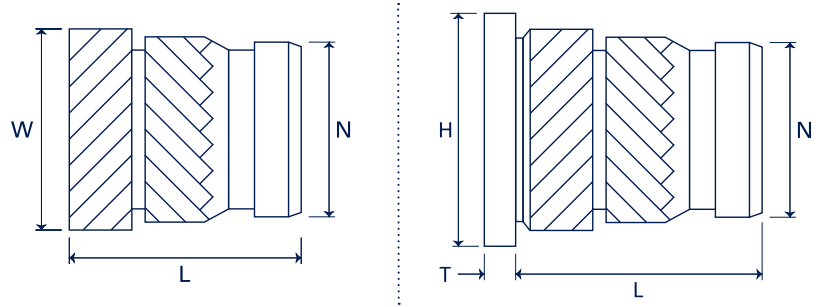

Metric and Unified Dimensions

Brass / Self Colour

Thread size	Metric	M2*	M2.5*	M3	M3.5	M4	M5	M6	M8*	M10*
	Unified*	2.56 UNC*	-	4.40 UNC*	6.32 UNC*	8.32 UNC*	10.24 UNC*	1/4-20 UNC*	5/16-18 UNC*	3/8-16 UNC*
L mm		4.0	5.7	5.7	7.1	8.1	9.5	12.7	12.7	12.7
W mm		3.6	4.6	4.6	5.4	6.3	7.1	8.7	10.2	12.6
T mm		0.53	0.61	0.61	0.76	0.91	1.09	1.35	1.35	1.60
H mm		4.8	5.5	5.5	6.4	7.1	7.9	9.5	11.1	14.0
N mm		3.1	3.9	3.9	4.7	5.5	6.3	7.9	9.5	11.8
Recommended Hole Size mm (-0.0/+0.1)		3.2	4.0	4.0	4.8	5.6	6.4	8.0	9.6	11.9
Minimum Wall Thickness mm		1.3	1.6	1.6	1.8	2.1	2.6	3.3	4.5	6.0

\* Non preferred - Please contact our sales team to enquire for availability. Unified variations can be manufactured with either fine or coarse threads. Please state when enquiring.

# Tech-Fix

Unheaded (UHDTTECFIX)

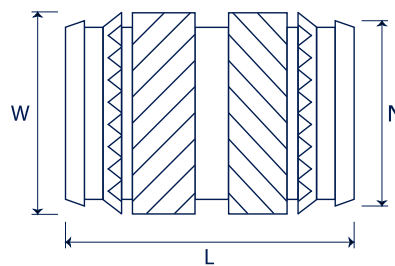

Metric and Unified Dimensions

Brass / Self Colour

Thread size	Metric	M2*	M2.5*	M3	M3.5	M4	M5	M6	M8*	M10*
	Unified*	2.56 UNC*	-	4.40 UNC*	6.32 UNC*	8.32 UNC*	10.24 UNC*	1/4-20 UNC*	5/16-18 UNC*	3/8-16 UNC*
L mm		4.0	5.7	5.7	7.1	8.1	9.5	12.7	12.7	12.7
W mm		3.5	4.4	4.4	5.2	6.1	6.8	8.5	10.0	12.3
N mm		3.1	3.9	3.9	4.7	5.5	6.3	7.9	9.5	11.8
Recommended Hole Size mm (-0.0/+0.1)		3.2	4.0	4.0	4.8	5.6	6.4	8.0	9.6	11.9
Minimum Wall Thickness mm		1.3	1.6	1.6	1.8	2.1	2.6	3.3	4.5	6.0

\* Non preferred - Please contact our sales team to enquire for availability. Unified variations can be manufactured with either fine or coarse threads. Please state when enquiring.

# Heat-Fix

Unheaded (UHDHEAFIX) Headed (HDHEAFIX)

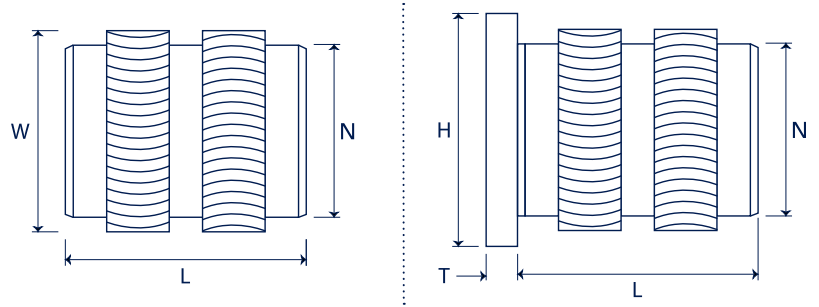

Metric and Unified Dimensions

Brass / Self Colour

Thread size	Metric	M2*	M2.5*	M3	M3.5	M4	M5	M6	M8*
	Unified*	2.56 UNC*	-	4.40 UNC*	6.32 UNC*	8.32 UNC*	10.24 UNC*	1/4-20 UNC*	5/16-18 UNC*
L mm		3.9	5.8	5.8	7.1	8.1	9.5	12.7	12.7
W mm		3.5	4.4	4.4	5.2	6.1	6.9	8.5	10.0
T mm		0.51	0.58	0.58	0.74	0.89	1.07	1.32	1.32
H mm		4.8	5.5	5.5	6.4	7.1	7.9	9.5	11.1
N mm		3.1	3.9	3.9	4.7	5.5	6.3	7.9	9.5
Recommended Hole Size mm (-0.0/+0.1)		3.2	4.0	4.0	4.8	5.6	6.4	8.0	9.6
Minimum Wall Thickness mm		1.4	1.8	1.8	2.1	2.4	2.8	3.6	5.0

\* Non preferred - Please contact our sales team to enquire for availability. Unified variations can be manufactured with either fine or coarse threads. Please state when enquiring.

# Flow-Fix

Unheaded (UHDFLOFIX)

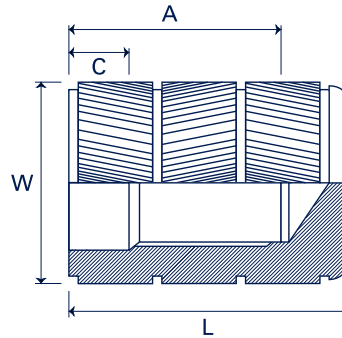

Metric and Unified Dimensions

Brass / Self Colour

Thread size	Metric	M2*	M2.5*	M3	M3.5	M4	M5	M6	M8*	M10*
	Unified*	2.56 UNC*	-	4.40 UNC*	6.32 UNC*	8.32 UNC*	10.24 UNC*	1/4-20 UNC*	5/16-18 UNC*	3/8-16 UNC*
L mm		5.5	6.4	7.3	9.2	10.2	11.2	14.4	16.5	17.9
W mm		3.4	4.3	4.7	5.5	6.3	7.3	9.8	11.4	13.8
A min. mm		3.6	4.0	4.6	6.0	6.7	7.4	8.1	11.1	11.9
C mm		1.0	1.2	1.3	1.6	1.8	2.0	2.0	2.3	2.4

\* Non preferred - Please contact our sales team to enquire for availability. Unified variations can be manufactured with either fine or coarse threads. Please state when enquiring.

# Fin-Fix

Unheaded (UHDFINFIX) Headed (HDFINFIX)

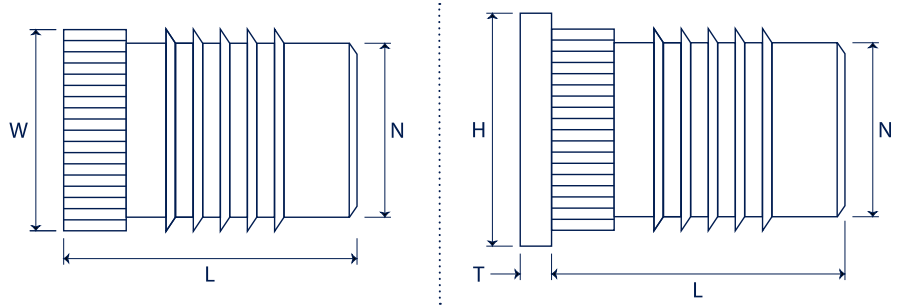

Metric and Unified Dimensions

Brass / Self Colour

Thread size	Metric	M2*	M2.5*	M3	M3.5	M4	M5	M6	M8*
	Unified*	2.56 UNC*	-	4.40 UNC*	6.32 UNC*	8.32 UNC*	10.24 UNC*	1/4-20 UNC*	5/16-18 UNC*
L mm		4.0	4.8	4.8	6.4	7.9	9.5	12.7	12.7
W mm		3.7	4.5	4.5	5.3	6.1	7.0	8.6	10.2
T mm		0.45	0.58	0.58	0.74	0.89	1.07	1.32	1.32
H mm		4.8	5.5	5.5	6.4	7.1	7.9	9.5	11.0
N mm		3.1	3.9	3.9	4.7	5.5	6.3	7.9	9.5
Recommended Hole Size mm (-0.0/+0.1)		3.2	4.0	4.0	4.8	5.6	6.4	8.0	9.6
Minimum Wall Thickness mm		1.6	2.0	2.0	2.4	2.8	3.2	4.0	4.8

\* Non preferred - Please contact our sales team to enquire for availability. Unified variations can be manufactured with either fine or coarse threads. Please state when enquiring.

# Spirol-Fix

Unheaded (UHDSPIFIX) Headed (HDSPIFIX)



Metric and Unified Dimensions

Brass / Self Colour

Thread size	Metric	M2*	M2.5*	M3	M3.5	M4	M5	M6	M8*	M10*
	Unified*	2.56 UNC*	-	4.40 UNC*	6.32 UNC*	8.32 UNC*	10.24 UNC*	1/4-20 UNC*	5/16-18 UNC*	3/8-16 UNC*
L mm		4.1	5.3	5.3	6.3	7.4	8.3	9.2	9.2	9.2
W mm		3.3	4.2	4.2	5.0	5.8	6.6	8.2	9.7	12.7
T mm		0.51	0.58	0.58	0.74	0.89	1.07	1.32	1.32	1.57
H mm		4.8	5.5	5.5	6.4	7.1	7.9	9.5	11.1	14.0
N mm		3.0	3.7	3.7	4.5	5.3	6.1	7.7	9.3	12.3
Recommended Hole Size mm (-0.0/+0.1)		3.1	3.8	3.8	4.6	5.4	6.2	7.8	9.3	12.3
Minimum Wall Thickness mm		1.6	2.0	2.0	2.5	2.5	2.5	2.8	3.8	5.0

\* Non preferred - Please contact our sales team to enquire for availability. Unified variations can be manufactured with either fine or coarse threads. Please state when enquiring.

# Expansion-Fix

Unheaded (UHDEXPFIX) Headed (HDEXPFIX)

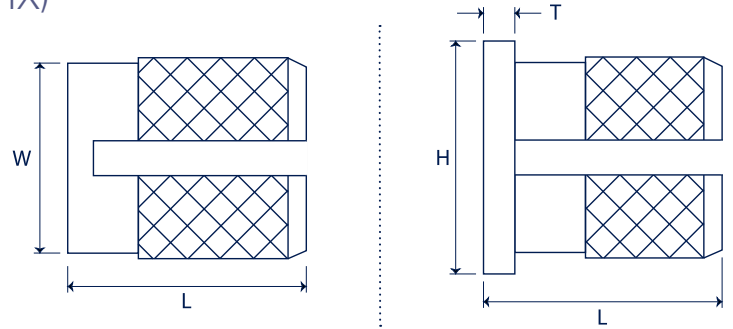

Metric and Unified Dimensions

Brass / Self Colour

Thread size	Metric	M2*	M2.5*	M3	M3.5	M4	M5	M6	M8*
	Unified*	2.56 UNC*	-	4.40 UNC*	6.32 UNC*	8.32 UNC*	10.24 UNC*	1/4-20 UNC*	5/16-18 UNC*
L mm		3.9	4.7	4.7	6.3	7.9	9.4	12.6	12.6
T mm		0.43	0.51	0.51	0.66	0.82	0.99	1.25	1.25
H mm		4.8	5.5	5.5	6.4	7.1	7.9	9.5	11.1
W max mm		3.2	4.0	4.0	4.7	5.5	6.3	7.9	9.5
Recommended Hole Size mm (-0.0/+0.1)		3.2	4.0	4.0	4.8	5.6	6.4	8.0	9.6
Minimum Wall Thickness mm		2.4	3.2	3.2	3.6	4.0	4.8	6.0	7.0

\* Non preferred - Please contact our sales team to enquire for availability. Unified variations can be manufactured with either fine or coarse threads. Please state when enquiring.

# Thread-Fix

Unheaded (UHDTHRFX) Headed (HDTHRFX)

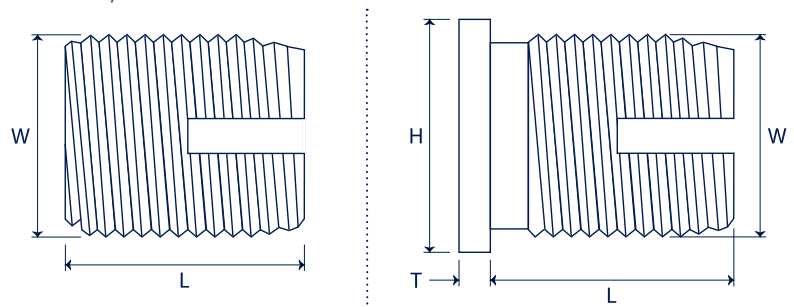

Metric and Unified Dimensions

Brass / Self Colour

Thread size	Metric	M2.5*	M3	M3.5	M4	M5	M6	M8*	M10*
	Unified*	-	4.40 UNC*	6.32 UNC*	8.32 UNC*	10.24 UNC*	1/4-20 UNC*	5/16-18 UNC*	3/8-16 UNC*
L mm		6.0	6.0	8.0	8.0	10.0	14.0	15.0	18.0
T mm		0.58	0.58	0.73	0.89	1.06	1.32	1.32	1.57
H mm		6.0	6.5	7.5	8.0	9.5	12.0	14.0	16.0
W mm max		4.5	5.0	6.0	6.5	8.0	10.0	12.0	14.0
Recommended Hole Size Thermoplastics mm		4.0-4.1	4.5-4.6	5.3-5.4	5.8-5.9	7.1-7.2	8.6-8.8	10.6-10.8	12.6-12.8
Recommended Hole Size Thermosets mm		4.1-4.3	4.6-4.8	5.5-5.7	6.0-6.2	7.3-7.6	9.0-9.4	11.0-11.4	13.0-13.4

\* Non preferred - Please contact our sales team to enquire for availability. Unified variations can be manufactured with either fine or coarse threads. Please state when enquiring.

## Conversion Table

Lancaster Fastener Insert Range		PSM Insert Range		TR Fastenings Insert Range	
Abbr. Part No	Description	Part No	Description	Part No	Description
UHDSOIFIX	Sonic-Fix	SL	Sonic-Lok	UHBRSO	Sonic-Sert
HDSONFIX	Headed Sonic-Fix	SHK	Headed Sonic-Lok	HEBRSO	Headed Sonic-Sert
UHDTECFIX	Tech-Fix	TEC	Tech-Sonic	UHBRTE	Tec-Sert
UHDHEAFIX	Heat-Fix	HL	Heat-Lok	UHBRHE	Heat-Sert
HDHEAFIX	Headed Heat-Fix	HLH	Headed Heat-Lok	HEBRHE	Headed Heat-Sert
UHDFLOFIX	Flow-Fix	FTC	Flo-Sert	UHBRFL	Flow-Sert
UHDFINFIX	Fin-Fix	FL	Fin-Lok	UHBRFI	Fin-Sert
HDFINFIX	Headed Fin-Fix	FLH	Headed Fin-Lok	HEBRFI	Headed Fin-Sert
UHDSPIFIX	Spirol-Fix	SP	Spiro	UHBRSP	Spirol-Sert
HDSPIFIX	Headed Spirol-Fix	HSR	Headed Spiro	HEBRSP	Headed Spirol-Sert
UHDEXPFIX	Expansion-Fix	N41	Banc-Lok	UHBREX	Expansion-Sert
HDEXPFIX	Headed Expansion-Fix	N42	Headed Banc-Lok	HEBREX	Headed Expansion-Sert
UHDTHRFIX	Thread-Fix	SCT	Screw-Sert	UHBRTH	Thread-Sert
HDTHRFIX	Headed Thread-Fix	HSCT	Headed Screw-Sert	HEBRTH	Headed Thread-Sert

## Lancaster Fastener Complete Part Number Examples

Thread	Complete Part Number	Product Description
METRIC	IPMUHDSOIFIX002BRSC	M2 Unheaded Sonic-Fix Brass Insert for Plastic Self Colour
UNIFIED COARSE	IPUCUHDSOIFIX063BRSC	1/4-20 UNC Unheaded Sonic-Fix Brass Insert for Plastic Self Colour
UNIFIED FINE	IPUFUHDSOIFIX095BRSC	3/8-24 UNF Unheaded Sonic-Fix Brass Insert for Plastic Self Colour



## Can't find what you're looking for?

This brochure summarises our range of Brass Inserts for Plastic; however, we can also offer other variations.

If you can't find the Brass Inserts you're looking for in this brochure, contact our sales team who will be happy to discuss your requirements.



# Lancaster Fastener Co Ltd

Threadforming Screw Specialists

Stevant Way, Northgate, White Lund Industrial Estate, Morecambe, England, LA3 3PU

Tel: +44 (0)1524 389232 Fax: +44 (0)1524 66367

Website: [www.lancasterfastener.co.uk](http://www.lancasterfastener.co.uk) Email: [enquiries@lancasterfastener.co.uk](mailto:enquiries@lancasterfastener.co.uk)



CERT No. BS28449 BS EN ISO 9001:2000

A  
TRIFAST PLC GROUP  
COMPANY



INVESTOR IN PEOPLE

60/60